

## GHQ/SCAP Records (RG 331, National Archives and Records Service)

## Description of contents

- (1) Box no. 2866
- (2) Folder title/number: (22) (end)  
Nihon Denki Yakin K.K. - Moroe Kojo
- (3) Date: Oct. 1945 - Aug. 1950
- (4) Subject:
- | Classification | Type of record |
|----------------|----------------|
| 9230, 9621     | z              |
- (5) Item description and comment:  
Kanazawa, Ishikawa-ken
- (6) Reproduction:  Yes  No
- (7) Film no. \_\_\_\_\_ Sheet no. \_\_\_\_\_

(Compiled by National Diet Library)

*To. Civil Affairs Region**File**Check 2/3/54*

Report on Rescission of Authorized  
Use Equipment

Date : 23 August 1950

## Plant Name &amp; Location

Chuetsu Kogyo K.K. ( Not Designated )  
861 Uenohon, Isurugi-machi, Nishitonami-gun, Toyama-ken

User : Maeda Jisaburo

President of Chuetsu Kogyo K.K.  
861 Uenohon, Isurugi-machi, Nishitonami-gun, Toyama-ken

## Reason of Rescission :

We purchased from Japan Electric Metallurgy K.K. Moroe Plant a Horizontal Milling Machine that was a non-reparations and was same by type and size with one for which we applied removal for use. Consequently, there should be a withdrawal of the application previously submitted. This is the reason why we now apply for the cancellation of it.

Total No. of Rescinded Equipaent : 1 set

Name of Reporter :

*Jisaburo Maeda*

\_\_\_\_\_  
Jisaburo Maeda  
President of Chuetsu Kogyo K.K.

## List of Rescinded Equipaent

| Inventory No. | Name of Equipment              | Remarks   |
|---------------|--------------------------------|---|
| 15-6-339      | Milling Machine-<br>Horizontal | Present location<br>Moroe Plant, Japan Electric<br>Metallurgy K.K.<br>21 Haruwa-machi, Kanazawa-<br>shi, Ishikawa-ken |

GENERAL HEADQUARTERS  
 SUPREME COMMANDER FOR THE ALLIED POWERS  
 Economic and Scientific Section  
 APO 500

387.6 ( 7 Jul 50 ) ESS/IND

7 July 1950

MEMORANDUM FOR : Reparations Agency, Tokyo

SUBJECT : Application for Movement and Authorized Use of Items Listed for Reparations

1. Reference is attached R.A.R. No. 535(MS), 6 June 1950, subject: Application for Movement and Authorized Use of Reparations Equipment of Moroe Plant (Code No. 15-06), Nippon Denki Yakin K.K., Filed by Chuetsu Kogyo K.K. (Non-reparations plant).

2. The application requesting permission for the transfer and authorized use of one (1) item of reparations machinery listed in reference 1, above, is approved as indicated below:

| <u>Present Location</u>                         | <u>No. of Items</u> | <u>To Be Transferred To</u>   |
|---|---------------------|---|
| Nippon Denki Yakin K.K.,<br>Moroe Plant (15-06) | 1<br>( 15-06-339 )  | Chuetsu Kogyo K.K.<br>361 Kaminomoto-machi,<br>Isurugi-cho, Nishitonami-<br>gun, Toyama Pref. |

3. This permit is issued subject to any and all directives affecting reparations plants which have been issued or may hereafter be issued by the Supreme Commander for the Allied Powers. Reports will be rendered as required by current directives and instructions.

FOR THE CHIEF, ECONOMIC AND SCIENTIFIC SECTION:

1 Incl  
 as indicated  
 (dup)

MAURICE M. CLASS  
 Chief, Industry Division

*Recession  
 23 Aug. 50*

TO : GENERAL HEADQUARTERS, SUPREME COMMANDER FOR THE ALLIED POWERS .

FROM : Reparation Agency, Tokyo.

SUBJECT : Application for Movement and Authorized Use of Reparatons Equipment of Moroe Plant (Code No. 15-06), Nippon Denki Yakin K.K., Filed by Chuetsu Kogyo K.K. (Non-reparations plant)

R.A.R. No. 535 (MB)

6 June 1950

1. The Reparations Agency hereby submits to your Headquarters an application for movement and authorized use of 1 set of reparations equipment now lying idle in the Moroe Plant (Code No. 15-06), Nippon Denki Yakin K.K. filed by the Chuetsu Kogyo K.K. (Non-reparations plant), together with an application of the Ministry of International Trade and Industry, as enclosed herewith.
2. This application has been investigated and has been coordinated with other interested government agencies.
3. It is requested that your most favorable consideration be given to this application at the earliest practicable date.

(Y. Katsuno)  
Director, Reparations Division,  
Reparations Agency.

## Incls:

- a. Application of the Ministry of International Trade & Industry.
- b. Application of the subject plant.

The Details of the Reparation Machines  
which we want to use.

Chuetsu Kogyo K.K.

| <u>Article</u>  | <u>Maker</u>            | <u>Type and Capacity</u> | <u>Inventory No. (15-06)</u> | <u>Difference of Operating or Non-operating</u> | <u>Quantity</u> |
|-----------------|-------------------------|--------------------------|------------------------------|---|-----------------|
| Milling Machine | Nippon Denki Yakin K.K. | Horizontal No. 2         | 339                          | Non-operating                                   | 1               |

GENERAL HEADQUARTERS  
 SUPREME COMMANDER FOR THE ALLIED POWERS  
 Economic and Scientific Section  
 APO 500

WT/ABO/MWH/RAS/bd  
 25 April 1950

387.6(25 Apr 50)ESS/IND

MEMORANDUM FOR: Reparations Agency, Tokyo

SUBJECT: Application for Movement and Authorized Use of Items Listed for Reparations

1. Reference is attached R.A.R. No. 293 (MS), 8 April 1950, subject: Application for Movement and Authorized Use of Reparations Equipment of Moroe Plant (Code No. 15-06) & Awada Plant (Code No. 15-16) of Nippon Denki Yakin K.K. Filed by Shiragikucho Plant (Non-reparations plant) of the same Company.

2. The application requesting permission for the interplant transfer and authorized use of the three (3) items of reparations machinery and equipment listed in reference 1, above, is approved as indicated below:

Nippon Denki Yakin K.K. Interplant Transfer

| <u>Present Location</u>   | <u>No. of Items</u> | <u>To Be Transferred To</u>                    |
|---------------------------|---------------------|--|
| a. Moroe Plant<br>(15-06) | 2                   | Shiragikucho Plant<br>Nakamura-cho<br>Kanazawa |
| b. Awada Plant<br>(15-16) | 1                   | shikawa Pref.                                  |
| TOTAL                     | 3                   |  |

3. This permit is issued subject to any and all directives affecting reparations plants which have been issued or may hereafter be issued by the Supreme Commander for the Allied Powers. Reports will be rendered as required by current directives and instructions.

FOR THE CHIEF, ECONOMIC AND SCIENTIFIC SECTION

1 Incl  
 as Indicated  
 Cys furnished:  
 CA Sec (dup)  
 CPC

*check*

MAURICE M. CLASS  
 Chief, Industry Division

MEMO FOR RECORD:

The above ltr is self-explanatory

M.M.C.

Mr. R.A. Steele, 26-6552

*Aug  
Mr. Jones*

TOKAI-HOKURIKU  
INFORMATION: **ECON**

O.D. EDW

AUG - 8 1950

GENERAL HEADQUARTERS  
SUPREME COMMANDER FOR THE ALLIED POWERS  
Economic and Scientific Section  
APO 500

387.6(1 Aug 50)ESS/IND

WT/MWH/RAS/bd  
1 August 1950

MEMORANDUM FOR: Reparations Agency, Tokyo

SUBJECT: Application for Movement and Authorized Use of Items Listed for Reparations

1. Reference is attached R.A.R. No. 642 (MS), 23 June 1950, subject: Application for Movement and Authorized Use of Reparations Equipment of Moroe Plant (Code No. 15-06), Nippon Denki Yakin K.K. Filed by Mena Seisakusho (Non-reparations plant).

2. The application requesting permission for the transfer and authorized use of the three (3) items of reparations machinery and equipment listed in reference 1, above, is approved as indicated below:

| <u>Present Location</u>                           | <u>No. of Items</u> | <u>To Be Transferred To</u>   |
|---|---------------------|---|
| Nippon Denki Yakin K.K.<br>Moroe Plant<br>(15-06) | 3                   | Mena Seisakusho<br>0-47 Tsurugi-machi<br>Ishikawa-gun<br>Ishikawa Pref. |

3. This permit is issued subject to any and all directives affecting reparations plants which have been issued or may hereafter be issued by the Supreme Commander for the Allied Powers. Reports will be rendered as required by current directives and instructions.

FOR THE CHIEF, ECONOMIC AND SCIENTIFIC SECTION:

1 Incl  
as indicated

Cys furnished:  
CA Sec (dup)  
CPC

MEMO FOR RECORD:

The above ltr is self-explanatory.

Mr. R. A. Steele  
26-7842

MAURICE M. CLASS  
Chief, Industry Division

*check*

M. M. C.

CA SEC

To : General Headquarters, Supreme Commander for the Allied Powers.

From : Reparations Agency, Tokyo.

Subject: Application for Movement and Authorized Use of Reparations Equipment of Moroe Plant (Code No. 15-06), Nippon Denki Yakin K.K. filed by Mena Seisakusho (Non-reparations plant).

R.A.R. No. 642 (MS)

23 June 1950.

1. The Reparations Agency hereby submits to your Headquarters an application for movement and authorized use of 3 sets of reparations equipment now lying idle in the Moroe Plant (Code No. 15-06), Nippon Denki Yakin K.K. filed by the Mena Seisakusho (Non-reparations plant), together with an application of the Ministry of International Trade and Industry, as enclosed herewith.
2. This application has been investigated and has been coordinated with other interested government agencies.
3. It is requested that your most favorable consideration be given to this application at the earliest practicable date.

(Y. Katsuno)  
Director, Reparations Division,  
Reparations Agency.

Incls:

~~a) Application of the Ministry of  
International Trade & Industry.~~

b) Application of the subject plant.

done!



LIST OF THE DESIRED REPARATION DESIGNATED  
MACHINERY AND EQUIPMENT

Applicant: Mens Seisakusho

| Name of Items             | Name of MFG Co.                            | Type and Dimension   | Inventory No.                | Operation or Idle | No. of Items | Re-marks |
|---------------------------|--|--|------------------------------|-------------------|--------------|----------|
| Milling Machine           | Unknown                                    | No. 2<br>Horizontal,<br>Universal,<br>Plain Belt                     | <del>15-06-342</del><br>-333 | Idle              | 1            |          |
| Drilling Machine          | S.T.S.<br>Kawashima<br>K.K.                | 16"<br>Twing shape<br>Ordinary<br>Plain Belt                         | 15-06-382                    | "                 | 1            |          |
| <del>Sawing Machine</del> | <del>K.T.C.<br/>Vicker<br/>M.F.G.Co.</del> | <del>200 m.m.<br/>Direct Con-<br/>nection with<br/>motor (1HP)</del> | <del>15-06-401</del>         | <del>"</del>      | <del>1</del> |          |
| Slotting Machine          | Nakayama<br>Shoten                         | 200 m.m.,<br>Plain Belt  | 15-06-404                    | "                 | 1            |          |
|                           | Total                                      |  |                              |                   | 3            |          |

775013

*Cr2*  
*Reparations*  
*Mr. Souard*

TOKAI-HOKURIKU *Econ.*

INFORMATION:

O.D. *11*  
*SEA*  
~~JUN 20 1950~~  
JUN 22 1950

GENERAL HEADQUARTERS  
SUPREME COMMANDER FOR THE ALLIED POWERS  
Economic and Scientific Section  
APO 500

WT/ABO/MWH/RAS/bd  
10 June 1950

387.6(10 Jun 50)ESS/IND

MEMORANDUM FOR: Reparations Agency, Tokyo

SUBJECT: Application for Movement and Authorized Use of Items Listed for Reparations

1. Reference is attached R.A.R. No. 487 (MS), 23 May 1950, subject: Application for Movement and Authorized Use of Reparations Equipment of Moroe Plant (Code No. 15-06), Nippon Denki Yakin K.K. Filed by Okizaki Genhichi Plant (Non-reparations plant).

2. The application requesting permission for the transfer and authorized use of one (1) item of reparations equipment listed in reference 1, above, is approved as indicated below:

| <u>Present Location</u>                           | <u>No. of Items</u> | <u>To Be Transferred To</u>   |
|---|---------------------|---|
| Nippon Denki Yakin K.K.<br>Moroe Plant<br>(15-06) | 1<br>(15-06-372)    | Okizaki-Genhichi Plant<br>11 Fugeshihama-cho<br>Wajima, Fugoshi-gun<br>Ishikawa Pref. |

3. This permit is issued subject to any and all directives affecting reparations plants which have been issued or may hereafter be issued by the Supreme Commander for the Allied Powers. Reports will be rendered as required by current directives and instructions.

FOR THE CHIEF, ECONOMIC AND SCIENTIFIC SECTION:

1 Incl  
as indicated  
  
Cys furnished:  
CA Sec (dup)  
CPC



*check*  
MAURICE M. CLASS  
Chief, Industry Division

*Seto / class*

MEMO FOR RECORD:

The above ltr is self-explanatory.

Mr. R. A. Steele, 26-6552 M. M. C.

CA

To : General Headquarters, Supreme Commander for the Allied Powers.

From : Reparations Agency, Tokyo.

Subject: Application for Movement and Authorized Use of Reparations Equipment of Moroe Plant (Code No. 15-06), Nippon Denki Yakin K.K. Filed by Okizaki Gennichi Plant (Non-reparations plant).

R.A.R. No. 487 (MS)

23 May 1950.

1. The Reparations Agency hereby submits to your Headquarters an application for movement and authorized use of 1 set of reparations equipment now lying idle in the Moroe Plant (Code No. 15-06) of the Nippon Denki Yakin K.K. filed by the Okizaki Gennichi Plant (Non-reparations plant), together with an application of the Ministry of International Trade and Industry, as enclosed herewith.

2. This application has been investigated and has been coordinated with other interested government agencies.

3. It is requested that your most favorable consideration be given to this application at the earliest practicable date.

(Y. Katsuno)  
Director, Reparations Division,  
Reparations Agency.

Incls:

- a) ~~Application of the Ministry of International Trade & Industry.~~
- b) Application of the subject plant.

Attached Paper. B

Table No.1

The Details of the Reparation Machines which we want to use.

| Article          | Maker          | Type and Capacity | Inventory No.(15-6) | Difference of Operating or Non-operating | Quantity |
|------------------|----------------|-------------------|---------------------|--|----------|
| Drilling Machine | Kawasnima K.K. | Up-right 16"      | 372                 | Non-operating                            | 1        |

*Okizaki Genshichi Plant.*  
*(Non Reparation plant.)*

GENERAL HEADQUARTERS  
SUPREME COMMANDER FOR THE ALLIED POWERS  
APO 500

387.6(25 Apr 50)ESS/IND

WT/ABO/MWH/RAS/bd  
25 April 1950

MEMORANDUM FOR: Reparations Agency, Tokyo

SUBJECT: Application for Movement and Authorized  
Use of Items Listed for Reparations

1. Reference is attached R.A.R. No. 291 (MS), 8 April 1950, subject: Application for Movement and Authorized Use of Reparations Equipment of Moroe Plant (Code No. 15-06) & Awada Plant (Code No. 15-16) of Nippon Denki Yakin K.K. filed by Daimon Plant (Non-reparations plant) of the same company.

2. The application requesting permission for the interplant transfer and authorized use of the twenty (20) items of reparations machinery and equipment listed in reference 1, above, is approved as indicated below:

Nippon Denki Yakin K.K. Interplant Transfer

| <u>Present Location</u>   | <u>No. of<br/>Items</u> | <u>To Be<br/>Transferred To</u>                                    |
|---------------------------|-------------------------|--|
| a. Moroe Plant<br>(15-06) | 18                      | Daimon Plant<br>Kojima<br>Oshima-mura<br>Imizu-gun<br>Toyama Pref. |
| b. Awada Plant<br>(15-16) | 2                       | "  |
| TOTAL                     | 20                      |  |

3. This permit is issued subject to any and all directives affecting reparations plants which have been issued or may hereafter be issued by the Supreme Commander for the Allied Powers. Reports will be rendered as required by current directives and instructions.

FOR THE CHIEF, ECONOMIC AND SCIENTIFIC SECTION:

1 Incl  
as indicated

MAURICE M. CLASS  
Chief, Industry Division

775013

*C. J. ...  
1. Mr. Jones  
2. Mr. Jones*

TOKAI-HOKURIKU

*Gen*

INFORMATION:

O.D. //

GENERAL HEADQUARTERS  
SUPREME COMMANDER FOR THE ALLIED POWERS  
Economic and Scientific Section  
APO 500

MAY 18 1950

WT/ABO/MWH/RAS/jtt

9 May 1950

*6459*

387.6(9 May 50)ESS/IND

MEMORANDUM FOR: Reparations Agency, Tokyo

SUBJECT: Application for Movement and Authorized Use  
of Items Listed for Reparations

1. Reference is attached R.A.R. No. 39(MS), 30 January 1950, subject: Application of Ishikawa Fabrics Co. for Movement of Reparations Equipment of Moroe Plant, Nippon Denki Yakin K.K. (Japan Electric Metallurgy Co.) (15-6).

2. The application requesting permission for the movement of the 493 items of reparations equipment as amended in reference 1, above, is approved as indicated below:

| <u>Present Location</u>  | <u>No. of Items</u> | <u>To Be Transferred To</u>  |
|--|---------------------|--|
| Ishikawa Fabrics Co., Ltd. successor to Japan Electric Metallurgy Co., Ltd., Moroe Plant (15-06) | 493                 | Japan Electric Metallurgy Co., Ltd., Main Plant, Naruwa-machi, Kanazawa Shi, Ishikawa Prefecture |

3. This permit is issued subject to any and all directives affecting reparations plants which have been issued or may hereafter be issued by the Supreme Commander for the Allied Powers. Reports will be rendered as required by current directives and instructions.

FOR THE CHIEF, ECONOMIC AND SCIENTIFIC SECTION:

1 Incl as indicated.

MAURICE M. CLASS  
Chief, Industry Division

Copy furnished:  
CA Sec (dup)  
CPC

MEMO FOR RECORD:

The above ltr is self-explanatory.

*check  
see '49 completed*

Mr. R.A. Steele:  
26-6552

M. M. C.

CA SEC COPY

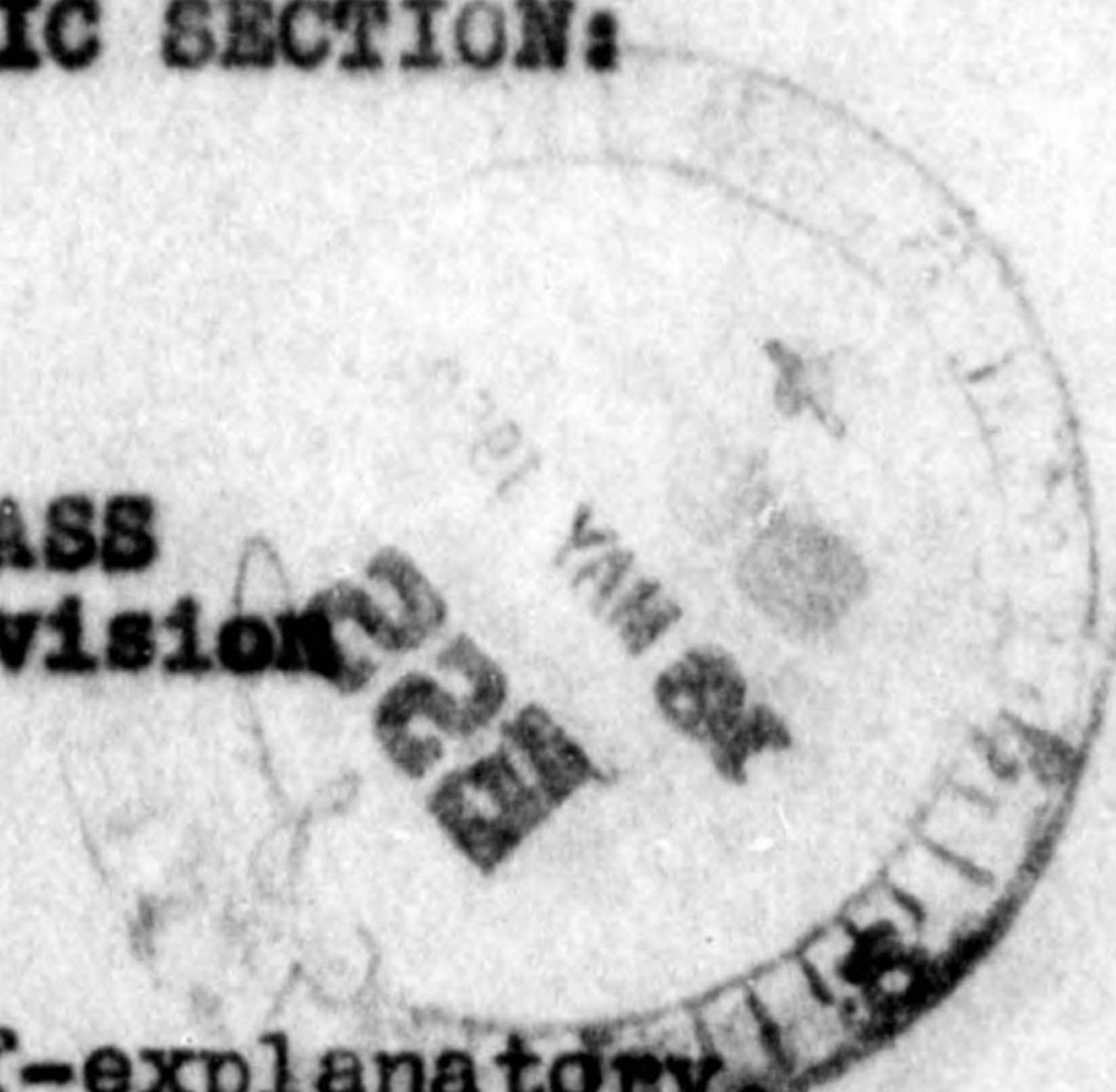

6460  
To : General Headquarters, Supreme Commander for the Allied Powers.  
From : Reparations Agency, Tokyo.  
Subject: Application of Ishikawa Fabrics Co. for Movement of Reparations Equipment of Moroe Plant, Nippon Denki Yakin K.K. (Japan Electric Metallurgy Co.) (15-6)

RAR No. 39 (MS)

30 January 1950.

## 1. References:

- a) SCAPIN-1355 (22 Nov 46), subject: "Permits for Conversion and Reconversion of Industrial Plants".
- b) SCAPIN-1263 (11 Oct 46), subject: "Revised List No. 2 Aircraft Factories, Military and Naval Arsenals and Research Laboratories".

2. The Reparations Agency hereby submits to your Headquarters an application of Ishikawa Fabrics Co., for movement of the reparations equipment of Moroe Plant, Nippon Denki Yakin K.K. (15-6) for improving its productive efficiency, together with a recommendation of the Ministry of International Trade and Industry, as enclosed herewith.

3. The Ishikawa Fabrics Co., which had purchased and is using the most part of land and buildings of the said plant, wishes to utilize a part of the building where the reparations equipment of this plant have been stored, and, therefore, to move these idle equipment totalling 506 sets into a warehouse of the Main Plant, Nippon Denki Yakin K.K. for overcoming many difficulties existing in the production process and thus improving its productive efficiency.

4. The subject company, which possesses the production system ranging from manufacture of silk yarn to weaving of silk textiles, is noted for its excellent products in markets abroad as well as domestic.

5. The Nippon Denki Yakin K.K. is willing to receive and store the reparations equipment in a warehouse of its Main Plant. The movement and store would be more convenient and proper from the viewpoint of maintenance and custody of the reparations equipment.

6. Such being the case, it is requested that your Headquarters be good enough to give a most favorable consideration to this application at the earliest practicable date.

## Incls:

1. ~~Recommendation of the Ministry of I.T. & I.~~
2. Application of the subject company.

( Y. Kasuno )  
Director, Reparations Division,  
Reparations Agency.

Description of Reparation Machine in Moroe Plant (15-6)

| Inventory No. | Machine Name  | Type and Capacity  | No. |
|---------------|---------------|--------------------|-----|
| 1-33          | Lathe Engine  | 3' S type          | 33  |
| 34-36         | do.           | 4,5' American type | 3   |
| 37            | do.           | 4,5' English type  | 1   |
| 38            | do.           | 4,5' American type | 1   |
| 39            | do.           | 4,5' English type  | 1   |
| 40-46         | do.           | 4' S type          | 7   |
| 47            | do.           | 4' do.             | 1   |
| 48-49         | do.           | 3' do.             | 2   |
| 50            | do.           | 4' do.             | 1   |
| 51            | do.           | 4' do.             | 1   |
| 52-54         | do.           | 4,5' American type | 3   |
| 55-59         | Lapping Lathe | 4,5' do.           | 5   |
| 60-64         | do.           | 4,5' do.           | 5   |
| 65            | do.           | 4,5' do.           | 1   |
| 66-67         | do.           | 4,5' do.           | 2   |
| 68-69         | Lathe Engine  | 4,5' do.           | 2   |
| 70            | do.           | 4,5' do.           | 1   |
| 71-74         | do.           | 4,5' do.           | 4   |
| 75            | do.           | 4,5' do.           | 1   |
| 76            | do.           | 4,5' do.           | 1   |
| 77-78         | do.           | 5' do.             | 2   |
| 79-88         | do.           | 4,5' do.           | 10  |
| 89            | do.           | 5' S type          | 1   |
| 90            | do.           | 5' do.             | 1   |
| 91            | do.           | 5' do.             | 1   |
| 92            | do.           | 4,5' American type | 1   |
| 93            | do.           | 4,5' do.           | 1   |
| 94-98         | do.           | 5' Stype           | 5   |
| 99            | do.           | 5' do.             | 1   |
| 100           | do.           | 5' do.             | 1   |
| 101-109       | do.           | 4,5' American type | 9   |
| 110-111       | do.           | 5' S type          | 2   |
| 112-114       | do.           | 4,5' American type | 3   |
| 115           | do.           | 5' S type          | 1   |
| 116-118       | do.           | 5' do.             | 3   |
| 119-136       | do.           | 5' do.             | 18  |
| 137           | Lapping Lathe | 4,5' American type | 1   |
| 138-152       | Lathe Engine  | 5' S type          | 15  |
| 153-156       | do.           | 6' American type   | 4   |
| 157           | do.           | 6' S type          | 1   |
| 158           | do.           | 6' do.             | 1   |
| 159           | do.           | 6' American type   | 1   |
| 160           | do.           | 6' Stype           | 2   |
| 162           | do.           | 6' American type   | 1   |
| 163-164       | do.           | 5' do.             | 2   |
| 165-167       | do.           | 6' do.             | 3   |
| 168           | do.           | 6' S type          | 1   |
| 169-172       | do.           | 7' do.             | 4   |
| 173           | do.           | 8' All gear        | 1   |



| Inventory No. | Machine Name     | Type and Capacity        | No. |
|---------------|------------------|--------------------------|-----|
| 174-175       | Turret Lathe     | 6" Universal             | 2   |
| 176           | Lathe Engine     | Bench Type               | 1   |
| 177-186       | Drilling Machine | 8"                       | 10  |
| 187-190       | do.              | 8"                       | 4   |
| 191-215       | do.              | 8"                       | 25  |
| 216-217       | do.              | 8"                       | 2   |
| 218           | do.              | 8"                       | 1   |
| 219-234       | do.              | 9"                       | 16  |
| 235           | do.              | 8"                       | 1   |
| 236-240       | do.              | 8"                       | 5   |
| 241           | do.              | 8"                       | 1   |
| 242           | do.              | 8"                       | 1   |
| 243           | Grinding Machine | 16" Vertical type        | 1   |
| 244           | do.              | 16" do.                  | 1   |
| 245           | do.              | 16" do.                  | 1   |
| 246           | do.              | 16" do.                  | 1   |
| 247-254       | Milling Machine  | No.2 do.                 | 8   |
| 255-285       | do.              | No.2 do.                 | 31  |
| 286-288       | do.              | No.2 do.                 | 3   |
| 289-293       | do.              | No.2 do.                 | 5   |
| 294-298       | do.              | No.2 do.                 | 5   |
| 299-300       | do.              | No.2 do.                 | 2   |
| 301-302       | do.              | No.2 do.                 | 2   |
| 303-306       | do.              | No.2 do.                 | 4   |
| 307           | do.              | No.2 do.                 | 1   |
| 308           | do.              | No.2 do.                 | 1   |
| 309-312       | do.              | No.3 do.                 | 4   |
| 313           | do.              | No.3 do.                 | 1   |
| 314-316       | do.              | No.2 do.                 | 3   |
| 317-326       | do.              | No.2 do.                 | 10  |
| 327           | do.              | No.2 Horizontal          | 1   |
| 328-329       | do.              | No.2 do.                 | 2   |
| 330           | do.              | No.2 do.                 | 1   |
| 331           | do.              | No.1 do.                 | 1   |
| 332           | do.              | No.2 do.                 | 1   |
| 333           | do.              | No.2 do.                 | 1   |
| 334-335       | do.              | No.2 do.                 | 2   |
| 336-339       | do.              | No.2 do.                 | 4   |
| 340           | do.              | No.2 do.                 | 1   |
| 341           | do.              | No.2 do.                 | 1   |
| 342           | do.              | No.1 do.                 | 1   |
| 343-362       | Grinding Machine | 8" Internal Cylindrical  | 20  |
| 363           | do.              | 8" do.                   | 1   |
| 364           | do.              | 100 do.                  | 1   |
| 365           | do.              | 24" External Cylindrical | 1   |
| 366           | do.              | 36" do.                  | 1   |
| 367           | do.              | 36" Internal Cylindrical | 1   |
| 368           | do.              | 36" do.                  | 1   |
| 369           | do.              | 28" External Cylindrical | 1   |
| 370           | do.              | 28" do.                  | 1   |
| 371           | do.              | 16" do.                  | 1   |
| 372-379       | Drilling Machine | 16" Upright              | 8   |
| 380           | Air Compressor   | 15" Horizontal type      | 1   |

| Inventory No.      | Machine Name                  | Type and Capacity  | No.          |
|--------------------|-------------------------------|--------------------|--------------|
| 381-382            | Drilling Machine              | 16" Upright        | 2            |
| 383                | do.                           | 16" do.            | 1            |
| 384-387            | do.                           | 16" do.            | 4            |
| 388-389            | do.                           | 16" do.            | 2            |
| 390                | do.                           | 20" do.            | 1            |
| 391                | do.                           | 20" do.            | 1            |
| 392-393            | do.                           | 22" do.            | 2            |
| 394                | do.                           | 16" do.            | 1            |
| 395                | do.                           | 22" do.            | 1            |
| 396                | Radial Drilling Machine       | 45"                | 1            |
| 397                | do.                           | 45"                | 1            |
| 398                | Drilling Machine              | 22" Upright        | 1            |
| 399                | Center-ing Machine            | 20" Double Spindle | 1            |
| 400                | Sawing-back                   | 200"               | 1            |
| 401                | do.                           | 200"               | 1            |
| 402                | do.                           | 200"               | 1            |
| 403                | Sawing-abrasive               | 16"                | 1            |
| 404                | Sletting Machine              | 200"               | 1            |
| 405                | Shapping Machine              | 24"                | 1            |
| 406                | Cutter Grinder                | 250"               | 1            |
| 407                | Grinding Machine              | 8" Dupex type      | 1            |
| 408                | do.                           | 12" do.            | 1            |
| 409                | do.                           | 12" do.            | 1            |
| 410-411            | do.                           | 8" do.             | 2            |
| 412                | do.                           | 12" do.            | 1            |
| 413-418            | do.                           | 8" do.             | 6            |
| 419                | do.                           | 6" do.             | 1            |
| 420-421            | do.                           | 12" do.            | 2            |
| 422                | do.                           | 8" do.             | 1            |
| 423                | do.                           | 8" do.             | 1            |
| 424                | do.                           | 12" do.            | 1            |
| 425                | do.                           | 12" do.            | 1            |
| 426-439            | do.                           | 8" do.             | 14           |
| 440-448            | do.                           | 12" do.            | 9            |
| 449-459            | do.                           | 8" do.             | 11           |
| 460-466            | do.                           | 12" do.            | 7            |
| 467-473            | do.                           | 8" do.             | 7            |
| 474                | Cutter Grinder                | 250                | 1            |
| 475                | Testing and Measuring Machine |                    | 1            |
| 476                | Hardness testing Machine      | Brinell 300 KI     | 1            |
| 477                | do.                           | Rockwell 150 ky    | 1            |
| 478-480            | Transformer                   | 100 K.V.A.         | 3            |
| <del>481</del>     | do.                           | 50 K.W.            | <del>1</del> |
| <del>482</del>     | do.                           | <del>20 K.W.</del> | <del>1</del> |
| <del>483</del>     | do.                           | <del>20 K.W.</del> | <del>1</del> |
| <del>484-485</del> | do.                           | <del>15 K.W.</del> | <del>1</del> |
| <del>486-488</del> | do.                           | <del>10 K.W.</del> | <del>1</del> |
| <del>489</del>     | do.                           | <del>10 K.W.</del> | <del>1</del> |
| 495-496            | Furnace-Electric-Muffle       | 50 K.W.            | 2            |
| 497                | do.                           | 70 K.W.            | 1            |
| 498                | Air Compressor                | 30 Vertical type   | 1            |
| 499                | Electric Motor                | 15                 | 1            |

| Inventory No. | Machine Name   | Type and Capacity | No.                          |
|---------------|----------------|-------------------|------------------------------|
| 500           | Electric Motor | 5                 | 1                            |
| 501           | do.            | 7.5               | 1                            |
| 502           | do.            | 7.5               | 1                            |
| 503           | do.            | 10                | 1                            |
| 504           | do.            | 10                | 1                            |
| 505           | do.            | 10                | 1                            |
| 506           | do.            | 10                | 1                            |
| Total         |                |                   | <del>506</del><br><u>493</u> |

775013

*M. Juand*

*cut one  
2 copies*

TOKAI-HOKURIKU *Econ*

INFORMATION:

O.D. 11

*DSW*

GENERAL HEADQUARTERS  
SUPREME COMMANDER FOR THE ALLIED POWERS  
Economic and Scientific Section  
APO 500  
MAY -2. 1950  
WT/ABO/MWH/RAS/bd  
25 April 1950

*5700*

387.6(25 Apr 50)ESS/IND

MEMORANDUM FOR: Reparations Agency, Tokyo

SUBJECT: Application for Movement and Authorized Use of Items Listed for Reparations

1. Reference is attached R.A.R. No. 291 (MS), 8 April 1950, subject: Application for Movement and Authorized Use of Reparations Equipment of Moroe Plant (Code No. 15-06) & Awada Plant (Code No. 15-16) of Nippon Denki Yakin K.K. filed by Daimon Plant (Non-reparations plant) of the same company.

2. The application requesting permission for the interplant transfer and authorized use of the twenty (20) items of reparations machinery and equipment listed in reference 1, above, is approved as indicated below:

Nippon Denki Yakin K.K., Interplant Transfer

| <u>Present Location</u>          | <u>No. of Items</u> | <u>To Be Transferred To</u>  |
|----------------------------------|---------------------|--|
| a. Moroe Plant (15-06) <i>70</i> | 18                  | Daimon Plant<br>Kojima<br>Oshima-mura<br>Imizu-gun<br>Toyama Pref. |
| b. Awada Plant (15-16) <i>74</i> | 2                   | "  |
| Total                            | 20                  |  |

3. This permit is issued subject to any and all directives affecting reparations plants which have been issued or may hereafter be issued by the Supreme Commander for the Allied Powers. Reports will be rendered as required by current directives and instructions.

FOR THE CHIEF, ECONOMIC AND SCIENTIFIC SECTION

1 Incl  
as indicated

MAURICE H. CLASS  
Chief, Industry Division



CA SEC

Memo for Reparations Agency, Tokyo fr GHQ, SCAP, ESS/IND,  
25 Apr 50, subj: Application for Movement and Authorized  
Use of Items Listed for Reparations, ref R.A.R. No. 291  
(MS), 8 Apr 50.

Cys furnished:  
CA Sec (dup)  
CPC

MEMO FOR RECORD:

The above ltr is self-explanatory.

Mr. R. A. Steele  
26-6552

M. M. C.

TO : GENERAL HEADQUARTERS, SUPREME COMMANDER FOR THE ALLIED POWERS.

FROM : Reparations Agency, Tokyo.

SUBJECT: Application for Movement and Authorized Use of Reparations Equipment of Moroe Plant (Code No. 15-06) & Awada Plant (Code No. 15-16) of Nippon Denki Yakin K.K. filed by Daimon Plant (Non-reparations plant) of the same company.

R.A.R. No. 291 (MS)

8 April 1950.

1. The Reparations Agency hereby submits to your Headquarters an application for movement and authorized use of 20 sets of reparations equipment now lying idle in the following plants filed by the Daimon Plant (Non-reparations plant) of the Nippon Denki Yakin K.K., together with an application of the Ministry of International Trade and Industry as enclosed herewith:

| <u>Name of Plant</u> | <u>Code No.</u> | <u>Machines to be moved</u> | <u>Remarks</u> |
|----------------------|-----------------|-----------------------------|----------------|
| Moroe Plant          | 15-06           | 18                          | Non-operating  |
| Awada Plant          | 15-16           | 2                           | "              |

Both plants belong to the same Nippon Denki Yakin K.K.

2. This application has been investigated and has been coordinated with other interested government agencies.
3. It is requested that your most favorable consideration be given to this application at the earliest practicable date.

(Y. Katsuno)  
Director, Reparations Division,  
Reparations Agency.

## Incls:

- a) ~~Application of the Ministry of International Trade & Industry.~~
- b) Application of the subject plant.

Incl

Attached Paper.

Table No.1

The details of the reparation machines which we want to use.

| Machine Name | Maker | Type and Capacity | Inventory No. | Difference of Operating or Non-operating | Quantity |
|--------------|-------|-------------------|---------------|--|----------|
|--------------|-------|-------------------|---------------|--|----------|

(1) Machines in possession of Moroe Plant (15-8)

|                              |                            |                   |     |               |        |
|------------------------------|----------------------------|-------------------|-----|---------------|--------|
| Lathe engine                 | Tokyo K.B. Machine K.K.    | English Type 4.5' | 37  | Non-operating | 1      |
| Double head Grinding machine | Mizuho Seisaku-sho         | 0.5 HP            | 411 | "             | 1      |
| "                            | "                          | 1 HP              | 420 | "             | 1      |
| Motor                        | Hidachi Seisaku-sho        | 15 HP             | 499 | "             | 1      |
| "                            | Yasukawa Denki Seisaku-sho | 5 HP              | 500 | "             | 1      |
| "                            | Shibaura Denki K.K.        | 7.5 HP            | 501 | "             | 1      |
| "                            | Fuji Denki Seisaku-sho     | 10 HP             | 505 | "             | 1      |
| "                            | Chuo Denki K.K.            | 3 HP              | 507 | "             | 1      |
| Pulley                       |                            |                   | 555 | "             | 8 Pcs, |
| Line Shaft                   |                            | Diameter 2"       | 561 | "             | 2 "    |

(2) Machines in possession of Awada Plant(15-16)

|                  |                   |     |     |   |   |
|------------------|-------------------|-----|-----|---|---|
| Drilling machine | Suzuki Tekko-sho  | 20" | 243 | " | 1 |
| Shapping machine | Higashi Tekko-sho | 16" | 246 | " | 1 |

GENERAL HEADQUARTERS  
 SUPREME COMMANDER FOR THE ALLIED POWERS  
 Economic and Scientific Section  
 APO 500

WT/ABO/MWH/RAS/bd  
 25 April 1950

387.6(25 Apr 50)ESS/IND

MEMORANDUM FOR: REparations Agency, Tokyo

SUBJECT: Application for Movement and Authorized  
 Use of Items Listed for Reparations

1. Reference is attached R.A.R. No. 293 (MS), 6 April 1950, subject: Application for Movement and Authorized Use of Reparations Equipment of Moroe Plant (Code No. 15-06) & Awada Plant (Code No. 15-16) of Nippon Denki Yakin K.K. Filed by Shiragikucho Plant (Non-reparations plant) of the same Company.

2. The application requesting permission for the inter-plant transfer and authorized use of the three (3) items of reparations machinery and equipment listed in reference 1, above, is approved as indicated below:

| <u>Nippon Denki Yakin K.K. Interplant Transfer</u> |                     |  |
|--|---------------------|--|
| <u>Present Location</u>                            | <u>No. of Items</u> | <u>To Be Transferred To</u>                                      |
| a. Moroe Plant (15-06)                             | 2                   | Shiragikucho Plant<br>Nakamura-cho<br>Kanazawa<br>Ishikawa Pref. |
| b. Awada Plant (15-26)                             | 1                   |  |
| Total  | 3                   |  |

3. This permit is issued subject to any and all directives affecting reparations plants which have been issued or may hereafter be issued by the Supreme Commander for the Allied Powers. Reports will be rendered as required by current directives and instructions.

FOR THE CHIEF, ECONOMIC AND SCIENTIFIC SECTION:

1 Inc  
 as indicated

MAURICE M. CLASS  
 Chief, Industry Division

Cys furnished:  
 CA Sec (dup)  
 CPC

MEMO FOR RECORD:

The above ltr is self-explanatory

Mr. R.A. Steele, 26-6552

M.M.C.



775013

*Ms Journal*  
3 2 26

*Ishikawa ICOM*

TO: AI-HOKURIKU

INFORMATION:

O.D. 11  
*DSW*

APR. 22. 1950

GENERAL HEADQUARTERS  
SUPREME COMMANDER FOR THE ALLIED POWERS  
Economic and Scientific Section  
APO 500

WT/ABO/MWH/RAS/jtt  
17 April 1950

387.6(17 Apr 50)ESS/IND

MEMORANDUM FOR: Reparations Agency, Tokyo

SUBJECT: Application for Movement and Authorized Use of Items Listed for Reparations

1. Reference is attached R.A.R. No. 217 (MS), 23 March 1950, subject: Application for Movement and Authorized Use of Reparations Equipment of Moroe Plant (Code No. 15-6) & Awada Plant (Code No. 15-16) of Nippon Denki Yakin K.K. Filed by Higashikanazawa Plant (Non-reparations plant) of the same company.

2. The application requesting permission for the transfer and authorized use of the thirty-four (34) items of reparations machinery and equipment listed in reference 1, above, is approved as indicated below:

Nippon Denki Yakin K.K. Interplant Transfer

| <u>Present Location</u> | <u>No. of Items</u> | <u>To Be Transferred To</u>                           |
|-------------------------|---------------------|---|
| a. Moroe Plant (15-6)   | 33                  | Higashikanazawa Plant<br>Sa-1, Naruwa-cho<br>Kanazawa |
| b. Awada Plant (15-16)  | 1                   | Ishikawa Pref.  |
| Total                   | 34                  |   |

3. This permit is issued subject to any and all directives affecting reparations plants which have been issued or may hereafter be issued by the Supreme Commander for the Allied Powers. Reports will be rendered as required by current directives and instructions.

FOR THE CHIEF, ECONOMIC AND SCIENTIFIC SECTION:

MAURICE M. CLASS  
Chief, Industry Division

1 Incl  
as indicated

Cys furnished:  
CA Sec (dup), CPC  
MEMO FOR RECORD:

The above ltr is self-explanatory.  
Mr. R. A. Steele, 26-6552 M. M. C.

472

CA SEC

TO : GENERAL HEADQUARTERS, SUPREME COMMANDER FOR THE ALLIED POWERS.

FROM : Reparations Agency, Tokyo.

SUBJECT: Application for Movement and Authorized Use of Reparations Equipment of Horoe Plant (Code No. 15-8) & Awada Plant (Code No. 15-16) of Nippon Denki Yakin K.K. Filed by Higashikanasawa Plant (Non-reparations plant) of the same company.

R.A.R. No. 217 (NS)

23 March 1950.

1. The Reparations Agency hereby submits to your Headquarters an application for movement and authorized use of 24 sets of reparations equipment now lying idle in the Horoe Plant (Code No. 15-8) & Awada Plant (Code No. 15-16) of the Nippon Denki Yakin K.K. filed by the Higashikanasawa Plant (Non-reparations plant) of the same company, together with an application of the Ministry of International Trade and Industry as enclosed herewith.

2. This application has been investigated and has been coordinated with other interested government agencies.

3. It is requested that your most favorable consideration be given to this application at the earliest practicable date.

(Y. Matsuno)

Director, Reparations Division,  
Reparations Agency.

Incls:

- ~~a) Application of the Ministry of International Trade and Industry.~~
- b) Recommendation of Governor of Ishikawa Prefecture.
- c) Application of the subject plant.

Incl 1

## Attached Paper

Table No.1

The details of the reparation machines which we want to use.

| Machine Name                                     | Maker                     | Type and Capacity          | Inventory No. | Difference of Operating or Non-operating | Quantity |
|--|---------------------------|----------------------------|---------------|--|----------|
| (1) Machines in possession of Moroe Plant (15-6) |                           |                            |               |  |          |
| Lathe engine                                     | Nippon Denki Yakin K.K.   | 6'                         | 158           | Non-operating                            | 1        |
| "  | "                         | "                          | 160-161       | "  | 2        |
| "  | "                         | "                          | 168           | "  | 1        |
| Turret lathe                                     | Tokyo Kikai K.K.          | 6'                         | 174-175       | "  | 2        |
| Drilling machine                                 | Nippon Denki Yakin K.K.   | Bench type                 | 187-188       | "  | 2        |
| Milling machine                                  | "                         | Vertical -standard No.3    | 310-311       | "  | 2        |
| "  | Minoura Kikai K.K.        | Horizontal -universal No.2 | 334-335       | "  | 2        |
| Drilling machine                                 | Kawashima K.K.            | Upright 16"                | 373           | "  | 1        |
| "  | "                         | " 20"                      | 391           | "  | 1        |
| "  | Nishiyama Tekko-sho       | " 22"                      | 392-393       | "  | 2        |
| "  | Kawashima K.K.            | " 16"                      | 394           | "  | 1        |
| "  | Nakayama Tekko-sho        | " 22"                      | 395           | "  | 1        |
| "  | Aikawa Tekko-sho          | Radial 45"                 | 396-397       | "  | 2        |
| "  | Harada Kinzoku Kogyo K.K. | Upright 22"                | 398           | "  | 1        |
| Hack-sawing machine                              | Hinomoto Seisaku-sho      | 200 m.m.                   | 400           | "  | 1        |



775013

*Co 9  
Reparations*

*Econ*

TOKAI-HOKURIKU  
INFORMATION:

O.D.   "  

JUL 13 1950

GENERAL HEADQUARTERS  
SUPREME COMMANDER FOR THE ALLIED POWERS  
Economic and Scientific Section  
APO 500

WT/ABO/MWH/RAS/jtt  
7 July 1950

387.6(7 Jul 50)ESS/IND

MEMORANDUM FOR: Reparations Agency, Tokyo

SUBJECT: Application for Movement and Authorized  
Use of Items Listed for Reparations

1. Reference is attached R.A.R. No. 535(MS), 6 June 1950, subject: Application for Movement and Authorized Use of Reparations Equipment of Moroe Plant (Code No. 15-06), Nippon Denki Yakin K.K., Filed by Chuetsu Kogyo K.K. (Non-reparations plant).

2. The application requesting permission for the transfer and authorized use of one (1) item of reparations machinery listed in reference 1, above, is approved as indicated below:

| <u>Present Location</u>                      | <u>No. of Items</u> | <u>To Be Transferred To</u>  |
|--|---------------------|--|
| Nippon Denki Yakin K.K., Moroe Plant (15-06) | 1<br>(15-06-339)    | Chuetsu Kogyo K.K.<br>861 Kaminomoto-machi, Isurugi-cho, Nishitonami-gun, Toyama Pref. |

3. This permit is issued subject to any and all directives affecting reparations plants which have been issued or may hereafter be issued by the Supreme Commander for the Allied Powers. Reports will be rendered as required by current directives and instructions.

FOR THE CHIEF, ECONOMIC AND SCIENTIFIC SECTION:

1 Incl  
as indicated.

MAURICE M. CLASS  
Chief, Industry Division

Cys furnished:  
CA Sec (dup)  
CPC

MEMO FOR RECORD:

The above ltr is self-explanatory.

Mr. R.A. Steele:  
26-6552

M. M. C.

CA SEC COPY

TO : GENERAL HEADQUARTERS, SUPREME COMMANDER FOR  
THE ALLIED POWERS.

FROM : Reparations Agency, Tokyo.

SUBJECT: Application for Movement and Authorized Use of  
Reparations Equipment of Moroe Plant (Code No.  
15-06), Nippon Denki Yakin K.K., Filed by Chuetsu  
Kogyo K.K. (Non-reparations plant)

R.A.R. No. 535 (MS)

6 June 1950.

1. The Reparations Agency hereby submits to your Headquarters an application for movement and authorized use of 1 set of reparations equipment now lying idle in the Moroe Plant (Code No. 15-06), Nippon Denki Yakin K.K. filed by the Chuetsu Kogyo K.K. (Non-reparations plant), together with an application of the Ministry of International Trade and Industry, as enclosed herewith.
2. This application has been investigated and has been coordinated with other interested government agencies.
3. It is requested that your most favorable consideration be given to this application at the earliest practicable date.

(Y. Katsuno)  
Director, Reparations Division,  
Reparations Agency.

## Incls:

- a. ~~Application of the Ministry of International Trade & Industry.~~
- b. Application of the subject plant.

Incl 1

The Details of the Reparation Machines  
which we want to use.

Chuetsu Kogyo K.K.

| <u>Article</u>  | <u>Maker</u>            | <u>Type and Capacity</u> | <u>Inventory No. (15-6)</u> | <u>Difference of Operating or Non-operating</u> | <u>Quantity</u> |
|-----------------|-------------------------|--------------------------|-----------------------------|---|-----------------|
| Milling Machine | Nippon Denki Yakin K.K. | Horizontal No. 2         | 339                         | Non-operating                                   | 1               |

*009*  
*Edward*

GENERAL HEADQUARTERS  
SUPREME COMMANDER FOR THE ALLIED POWERS  
Economic and Scientific Section  
APO 500

WT/MWH/RAS/tj  
11 December 1950

307.6(11 Dec 50)ESS/TNE

MEMORANDUM FOR: Reparations Agency, Tokyo

SUBJECT: Application for Movement and Authorized Use of Items Listed for Reparations

1. Reference is attached W.A.R.No. 1420(WS), 26 October 1950, subject: Application for Movement and Authorized Use of Reparations Equipment of 2 Plants (Code No. 15-06 15-16) of Nippon Denki Yakin K.K. Filed by Furuta Tekkosho (Non-Reparations Plant).

2. The application requesting permission for the transfer and authorized use of the four (4) items of reparations machinery and equipment listed in reference 1, above, is approved as indicated below:

| <u>Present Location</u> | <u>No. of Items</u> | <u>To Be Transferred To</u>                  |
|-------------------------|---------------------|--|
| Nippon Denki Yakin K.K. |                     | Furuta Tekkosho                              |
| 1. Morse Plant (15-06)  | 3                   | 88, Nagatshon-machi, Kanazawa, Ishikawa-ken. |
| 2. Asada Plant (15-16)  | 1                   |  |
| Total                   | 4                   |  |

3. This permit is issued subject to any and all directives affecting reparations plants which have been issued or may hereafter be issued by the Supreme Commander for the Allied Powers. Reports will be rendered as required by current directives and instructions.

FOR THE CHIEF, ECONOMIC AND SCIENTIFIC SECTION:

1 Incl  
as indicated (dup)

MAURICE W. CLARK  
Chief, Industry Division

Cys furnished:  
CA Sec (dup)  
CPC

MEMO FOR RECORD:

The above ltr is self-explanatory.

Mr. R.A. Steele  
26-7842

M.M.C.

TOKAI-HOKURIKU INFORMATION  
O.D. 11  
DEC 28 1950

CA Sec Copy



To : General Headquarters, Supreme Commander for the Allied Powers.

From : Reparations Agency, Tokyo.

Subject: Application for Movement and Authorized Use of Reparations Equipment of 2 Plants (Code No. 15-06 15-16) of Nippon Denki Yakin K.K. Filed by Murota Tekkosho (Non-reparations plant).

R.A.R. No. 1420 (MS)

26 October 1950.

1. The Reparations Agency hereby submits to your Headquarters an application for movement and authorized use of 4 sets of reparations equipment now lying idle in the following 2 Plants of Nippon Denki Yakin K.K. filed by Murota Tekko-sho (Non-reparations plant), together with an application of the Ministry of International Trade and Industry, as enclosed herewith.

| <u>Name of Plant</u> | <u>Code No.</u> | <u>No. of Items</u> |
|----------------------|-----------------|---------------------|
| Moroe Plant          | 15-06           | 3                   |
| Awada Plant          | 15-16           | 1                   |
|                      |                 | Total 4             |

2. This application has been investigated and has been coordinated with other interested government agencies.

3. It is requested that your most favorable consideration be given to this application at the earliest practicable date.

(Y. Katsuno)  
Director, Reparations Division,  
Reparations Agency.

Incls:

- a) Application of the Ministry of International Trade & Industry.
- b) Application of the subject plant.

*Incl 1*

Attached Paper

Table C

LIST OF THE DESIRED REPARATION  
DESIGNATED MACHINERY AND EQUIPMENTApplicant: Murota Tekko-sho

| Name of Item                 | Name of Mfg. Co.        | Type & Dimension | Inventory No. | Operation or Idle | No. of Item | Remarks           |                       |      |
|------------------------------|-------------------------|------------------|---------------|-------------------|-------------|-------------------|-----------------------|------|
|                              |                         |                  |               |                   |             | Evaluation or-non | Section               | Page |
| (Moroe Plant Code No. 15-06) |                         |                  |               |                   |             |                   |                       |      |
| (1) <u>Machine tool</u>      |                         |                  |               |                   |             |                   |                       |      |
| Lathe engine                 | Nippon Denki Yakin K.K. | 6'               | 15-06<br>152  | Idle              | 1           | Non-evaluation    | -                     | -    |
| "                            | Takata Tekko-sho        | 6'               | 162           | "                 | 1           | "                 |                       |      |
| Up-right drilling machine    | Kawashima K.K.          | 16"              | 386           | "                 | 1           | "                 |                       |      |
| Total                        |                         |                  |               |                   | 3           |                   |                       |      |
| (Awada Plant Code No. 15-16) |                         |                  |               |                   |             |                   |                       |      |
| (1) <u>Machine tool</u>      |                         |                  |               |                   |             |                   |                       |      |
| Lathe engine                 | Nippon Denki Yakin K.K. | 8'               | 15-16<br>166  | Idle              | 1           | Evaluation plant  | Integrated facilities | 17   |

775013

*CdG (Clow)  
econ*

GENERAL HEADQUARTERS  
SUPREME COMMANDER FOR THE ALLIED POWERS  
Economic and Scientific Section  
APO 500

WT/MWH/RAS/mcp  
11 January 1951

387.6(11 Jan 51)ESS/IND

MEMORANDUM FOR: Reparations Agency, Tokyo

SUBJECT: Application for Movement and Authorized Use  
of Items Listed for Reparations

1. Reference is attached R.A.R. No. 1450(MS), 27 October 1950, subject: Application for Movement and Authorized Use of Reparations Equipment of 2 Plants of Nippon Denki Yakin K.K. Filed by Futagi Tekko-sho (Non-reparations Plant).

2. The application requesting permission for the transfer and authorized use of the four (4) items of reparations machinery and equipment listed in reference 1, above, is approved as indicated below:

| <u>Present Location</u>   | <u>No. of Items</u> | <u>To be Transferred To</u>   |
|---------------------------|---------------------|---|
| Nippon Denki Yakin K.K.   |                     |   |
| 1. Moroe Plant<br>(15-06) | 3                   | Futagi Tekko-sho,<br>53, Shimo-ohi-cho,<br>Kanazawa, Ishikawa Pref. |
| 2. Awada Plant<br>(15-16) | 1                   |   |
| Total                     | 4                   |   |

3. This permit is issued subject to any and all directives affecting reparations plants which have been issued or may hereafter be issued by the Supreme Commander for the Allied Powers. Reports will be rendered as required by current directives and instructions.

FOR THE CHIEF, ECONOMIC AND SCIENTIFIC SECTION:

1 Incl  
as indicated (dup)

MAURICE M. CLASS  
Chief, Industry Division

Cys furnished:  
CA Sec (2)  
CPC

MEMO FOR RECORD:  
The above ltr is self-explanatory.

Mr. R.A.Steele  
26-7842

M. M. C.

TOKAI-HOKURIKU INFORMATION:  
JAN 22 1951  
O.D. 11

CA Sec Copy

TO : GENERAL HEADQUARTERS, SUPREME COMMANDER FOR THE ALLIED POWERS.

FROM : Reparations Agency, Tokyo.

SUBJECT: Application for Movement and Authorized Use of Reparations Equipment of 2 Plants of Nippon Denki Yakin K.K. Filed by Futagi Tekko-sho (Non-reparations plant).

R.A.R. No. 1450 (MS)

27 October 1950.

1. The Reparations Agency hereby submits to your Headquarters an application for movement and authorized use of 4 sets of reparations equipment now lying idle in the following 2 Plants of Nippon Denki Yakin K.K. filed by the Futagi Tekko-sho (Non-reparations plant), together with an application of the Ministry of International Trade and Industry, as enclosed herewith.

| <u>Name of Plant</u> | <u>Code No.</u> | <u>No. of Items</u> |
|----------------------|-----------------|---------------------|
| Moroe Plant          | 15-06           | 3                   |
| Awada Plant          | 15-16           | 1                   |
| <u>Total</u>         |                 | <u>4</u>            |

2. This application has been investigated and has been coordinated with other interested government agencies.

3. It is requested that your most favorable consideration be given to this application at the earliest practicable date.

(Y. Katsumo)  
Director, Reparations Division,  
Reparations Agency.

Incls:

- a) Application of the Ministry of International Trade & Industry.
- b) Application of the subject plant.

*Incl*

LIST OF THE DESIRED REPARATION  
DESIGNATED MACHINERY & EQUIPMENT

Applicant: Futagi Tekko-sho

| Name of Item                                  | Name of Manufacturing company | Type and dimension | Inventory No. | Operation or Idle | No. of Items | Remarks            |                                    |      |
|---|-------------------------------|--------------------|---------------|-------------------|--------------|--------------------|------------------------------------|------|
|   |                               |                    |               |                   |              | Evaluation or non- | Section                            | Page |
| (Moroe Plant)<br>Machine tool<br>Lathe engine | Takata<br>Tekko-sho           | 6'                 | 15-08-159     | Idle              | 1            | Non evaluation     | -                                  | -    |
| "   | "                             | 6'                 | 165           | "                 | 1            | "                  | "                                  | "    |
| Up right drilling machine                     | Kawashima<br>K.K.             | 16"                | 377           | "                 | 1            | "                  | "                                  | "    |
| Total .....                                   |                               |                    |               |                   | 3            |                    |                                    |      |
| (Awada Plant)<br>Machine tool<br>Lathe engine | Nippon<br>Denki Yakin<br>K.K. | 8'                 | 15-18-172     | Idle              | 1            | Evaluation Plant   | Integr-<br>ated<br>facili-<br>ties | 18   |
| Total .....                                   |                               |                    |               |                   | 1            |                    |                                    |      |

775013

*C+D (Log)*  
*Econ (R2)*

GENERAL HEADQUARTERS  
SUPREME COMMANDER FOR THE ALLIED POWERS  
Economic and Scientific Section  
APO 500

WT/MWH/RAS/mcp  
23 January 1951

387.6(23 Jan 51)ESS/IND

MEMORANDUM FOR: Reparations Agency, Tokyo

SUBJECT: Application for Movement and Authorized Use of Items Listed for Reparations

1. Reference is attached R.A.R. No. 1507(WS), 7 November 1950, subject: Application for Movement and Authorized Use of Reparations Equipment of 2 Plants (Code No. 15-06 & 16) of Nippon Denki Yakin K.K. Filed by Kita Tekko-sho (Non-Reparations Plant).

2. The application requesting permission for the transfer and authorized use of the two (2) items of reparations machinery and equipment listed in reference 1, above, is approved as indicated below:

| <u>Present Location</u>                           | <u>No. of Items</u> | <u>To be Transferred To</u>  |
|---|---------------------|--|
| Nippon Denki Yakin K.K.<br>Moroe Plant<br>(15-06) | 1                   | Kita Tekko-sho,<br>50, Hosai-machi, Kana-<br>zawa City, Ishikawa<br>Prefecture |
| Awada Plant<br>(15-16)                            | 1                   |  |
| Total   | 2                   |  |

3. This permit is issued subject to any and all directives affecting reparations plants which have been issued or may hereafter be issued by the Supreme Commander for the Allied Powers. Reports will be rendered as required by current directives and instructions.

FOR THE CHIEF, ECONOMIC AND SCIENTIFIC SECTION:

1 Incl  
as indicated (dup)

MAURICE M. CLASS  
Chief, Industry Division

Cys furnished  
CA Sec (dup)  
CPC

MEMO FOR RECORD:

The above ltr is self-explanatory.

Mr. R.A. Steele  
26-7842

M. M. C.

TOKAI-HOKURIKU INFORMATION: Sec Copy  
 JAN 29 1951  
 O.D. 11

**To :** General Headquarters, Supreme Commander for the Allied Powers.

**From :** Reparations Agency, Tokyo.

**Subject:** Application for Movement and Authorized Use of Reparations Equipment of 2 Plants (Code No. 15-06) & 16) of Nippon Denki Yakin K.K. Filed by Kita Tekko-sho (Non-Reparations Plant).

R.A.R. No. 1507 (MS)

7 November 1950.

1. The Reparations Agency hereby submits to your Headquarters an application for movement and authorized use of 2 items of reparations equipment now lying idle in the following 2 Plants of Nippon Denki Yakin K.K. filed by the Kita Tekko-sho (non-reparations plant), together with an application of the Ministry of International Trade and Industry, as enclosed herewith.

| <u>Name of Plant</u> | <u>Code No.</u> | <u>No. of Items</u> |
|----------------------|-----------------|---------------------|
| Moroe Plant          | 15-06           | 1                   |
| Awada Plant          | 15-16           | 1                   |
|                      |                 | Total 2             |

2. This application has been investigated and has been coordinated with other interested government agencies.
3. It is requested that your most favorable consideration be given to this application at the earliest practicable date.

(Y. Katsuno)  
 Director, Reparations Division,  
 Reparations Agency.

**Incls:**

- a) Application of the Ministry of International Trade & Industry.
- b) Application of the subject plant

*Incl*

Attached Paper

Table C

LIST OF THE DESIRED REPARATION  
DESIGNATED MACHINERY AND EQUIPMENT

Applicant: Kita Tekko-sho

| Name of Item   | Name of Mfg. Co. | Type & dimension | Inventory No. | Operation or idle | No. of item | Remarks              |                       |      |
|--|------------------|------------------|---------------|-------------------|-------------|----------------------|-----------------------|------|
|  |                  |                  |               |                   |             | Evaluation or non-   | Section               | Page |
| (Moroe Plant)<br>(1) Machine Tool<br>Up-right drilling machine | Kawashima K. K.  | 16"              | 15-06-379     | Idle              | 1           | Non-evaluation Plant |                       |      |
| Total:   |                  |                  |               |                   | 1           |                      |                       |      |
| (Awada Plant)<br>(1) Machine Tool<br>Lathe Engine              | Takata Tekko-sho | 6'               | 15-16-148     | Idle              | 1           | Evaluation Plant     | Integrated facilities | 15   |
| Total:   |                  |                  |               |                   | 1           |                      |                       |      |



3644  
 E. C. G. (L. M.)  
 (440)

GENERAL HEADQUARTERS  
 SUPREME COMMANDER FOR THE ALLIED POWERS  
 Economic and Scientific Section  
 APO 500

TOKAI-HOKURIKU  
 FEB - 8 1951  
 INFORMATION:  
 O.D. 11

387.6(1 Feb 51)ESS/IND

WT/MWH/RAS/vv  
 1 February 1951

MEMORANDUM FOR: Reparations Agency, Tokyo

SUBJECT: Application for Movement and Authorized Use of Items Listed for Reparations

1. Reference is attached R.A.R. No. 1690 (ME), 2 December 1950, subject: Application for Movement and Authorized Use of Reparations Equipment of 2 Plants (Code No's. 15-06 & 15-16) of Nippon Denki Yakin K.K. Filed by Takamatsu Tekkosho (Non-reparations Plant).

2. The application requesting permission for the transfer and authorized use of the two (2) items of reparations machinery and equipment listed in reference 1, above, is approved as indicated below:

| <u>Present Location</u> | <u>No. of Items</u> | <u>To Be Transferred To</u>                               |
|-------------------------|---------------------|---|
| Nippon Denki Yakin K.K. |                     | Takamatsu Tekkosho  |
| a. Moroe Plant (15-06)  | 1                   | 111, Daijime-nakadori, Kanazawa City, Ishikawa Prefecture |
| b. Awada Plant (15-16)  | 1                   |   |
| Total                   | 2                   |   |

3. This permit is issued subject to any and all directives affecting reparations plants which have been issued or may hereafter be issued by the Supreme Commander for the Allied Powers. Reports will be rendered as required by current directives and instructions.

FOR THE CHIEF, ECONOMIC AND SCIENTIFIC SECTION:

1 Incl  
 as indicated.  
 (dup)

MAURICE M. CLASS  
 Chief, Industry Division

MEMO FOR RECORD:

The above ltr is self-explanatory.

Cys furnished:  
 CA Sec (dup)  
 CPC

Mr. R.A. Steele:  
 26-7842

M. M. C.

CA Sec Copy

TO : GENERAL HEADQUARTERS, SUPREME COMMANDER FOR THE ALLIED POWERS.

FROM : Reparations Agency, Tokyo.

SUBJECT: Application for Movement and Authorized Use of Reparations Equipment of 2 Plants (Code Nos 15-06 & 15-16) of Nippon Denki Yakin K.K. Filed by Takamatsu Tekkocho (Non-reparations Plant).

R.A.R. No. 1690 (MS)

2 December 1950.

1. The Reparations Agency hereby submits to your Headquarters an application for movement and authorized use of 2 items of reparations equipment now lying idle in the following two (2) Plants (Code No. 15-06 and 15-16) of Nippon Denki Yakin K.K. filed by the Takamatsu Tekkocho (Non-reparations plant), together with an application of the Ministry of International Trade and Industry, as enclosed herewith

| <u>Name of Plant</u>                 | <u>Code No.</u> | <u>No. of Item.</u> |
|--------------------------------------|-----------------|---------------------|
| Moroe Plant, Nippon Denki Yakin K.K. | 15-06           | 1                   |
| Awada Plant, Nippon Denki Yakin K.K. | 15-16           | 1                   |
|                                      |                 | Total: 2 items      |

2. This application has been investigated and has been coordinated with other interested government agencies.

3. It is requested that your most favorable consideration be given to this application at the earliest practicable date.

( Y. Katsuno )  
Director, Reparations Division,  
Reparations Agency.

Incls:

- a) ~~Application of the Ministry of International Trade & Industry.~~
- b) Application of the subject plant.

*Incl 1*

Attached Paper

Table B

List of Reparation Designated Machinery & Equipment to be used

Applicant: Takamatsu Tekko-sho

| Name of Item                 | Name of Mfg. Co.            | Type and Dimension | Inventory No. | Operation or idle | No. of Item | Remark            |                      |      |
|------------------------------|-----------------------------|--------------------|---------------|-------------------|-------------|-------------------|----------------------|------|
|                              |                             |                    |               |                   |             | Evaluation or non | Section              | Page |
| (Moroe Plant, Code No.15-06) |                             |                    |               |                   |             |                   |                      |      |
| (1) Machine tool             |                             |                    |               |                   |             |                   |                      |      |
| Lathe Engine                 | Nippon Denki<br>Yakin K. K. | 7'                 | 15-06<br>171  | Idle              | 1           | Non-evaluation    | -                    | -    |
| Total: .....                 |                             |                    |               |                   | 1           |                   |                      |      |
| (Awada Plant, Code No.15-16) |                             |                    |               |                   |             |                   |                      |      |
| (1) Machine tool             |                             |                    |               |                   |             |                   |                      |      |
| Lathe Engine                 | Takata<br>Tekko-sho         | 6'                 | 15-16<br>134  | Idle              | 1           | Evaluation Plant  | Integrate facilities | 14   |
| Total: .....                 |                             |                    |               |                   | 1           |                   |                      |      |

775013

GENERAL HEADQUARTERS  
 SUPREME COMMANDER FOR THE ALLIED POWERS  
 Economic and Scientific Section  
 APO 500

WT/MWH/RAS/vv  
 1 February 1951

387.6(1 Feb 51)ESS/IND

MEMORANDUM FOR: Reparations Agency, Tokyo

SUBJECT: Application for Movement and Authorized Use  
 of Items Listed for Reparations

1. Reference is attached R.A.R. No. 1690 (MS), 2 December 1950, subject: Application for Movement and Authorized Use of Reparations Equipment of 2 Plants (Code No's. 15-06 & 15-16) of Nippon Denki Yakin K.K. Filed by Takamatsu Tekkosho (Non-reparations Plant).

2. The application requesting permission for the transfer and authorized use of the two (2) items of reparations machinery and equipment listed in reference 1, above, is approved as indicated below:

| <u>Present Location</u> | <u>No. of Items</u> | <u>To Be Transferred To</u>                                     |
|-------------------------|---------------------|---|
| Nippon Denki Yakin K.K. |                     | Takamatsu Tekkosho  |
| a. Moroe Plant (15-06)  | 1                   | 111, Daijime-nakadori,<br>Kanazawa City, Ishikawa<br>Prefecture |
| b. Awada Plant (15-16)  | $\frac{1}{2}$       |   |
| Total                   | 2                   |   |

3. This permit is issued subject to any and all directives affecting reparations plants which have been issued or may hereafter be issued by the Supreme Commander for the Allied Powers. Reports will be rendered as required by current directives and instructions.

FOR THE CHIEF, ECONOMIC AND SCIENTIFIC SECTION:

1 Incl  
 as indicated.  
 (dup)

MAURICE M. CLASS  
 Chief, Industry Division

MEMO FOR RECORD:

Cys furnished:  
 CA Sec (dup)  
 CPC

The above ltr is self-explanatory.

Mr. R.A. Steele:  
 26-7842

M. M. C.

CA Sec Copy

TO : GENERAL HEADQUARTERS, SUPREME COMMANDER FOR THE ALLIED POWERS.

FROM : Reparations Agency, Tokyo.

SUBJECT: Application for Movement and Authorized Use of Reparations Equipment of 2 Plants (Code Nos 15-06 & 15-16) of Nippon Denki Yakin K.K. Filed by Takamatsu Tekkosho (Non-reparations Plant).

R.A.R. No. 1690 (MS)

2 December 1950

1. The Reparations Agency hereby submits to your Headquarters an application for movement and authorized use of 2 items of reparations equipment now lying idle in the following two (2) Plants (Code No. 15-06 and 15-16) of Nippon Denki Yakin K.K. filed by the Takamatsu Tekkosho (Non-reparations plant), together with an application of the Ministry of International Trade and Industry, as enclosed herewith.

| <u>Name of Plant</u>                 | <u>Code No.</u> | <u>No. of Item.</u>   |
|--------------------------------------|-----------------|-----------------------|
| Moroe Plant, Nippon Denki Yakin K.K. | 15-06           | 1                     |
| Awada Plant, Nippon Denki Yakin K.K. | 15-16           | 1                     |
|                                      |                 | <u>Total: 2 items</u> |

2. This application has been investigated and has been coordinated with other interested government agencies.

3. It is requested that your most favorable consideration be given to this application at the earliest practicable date.

( Y. Katsuno )  
 Director, Reparations Division,  
 Reparations Agency.

Incls:

- a) ~~Application of the Ministry of International Trade & Industry.~~
- b) Application of the subject plant.

Incl 1

Attached Paper

Table B

List of Reparation Designated Machinery & Equipment to be used

Applicant: Takamatsu Tekko-sho

| Name of Item                                     | Name of Mfg. Co.            | Type and Dimension | Inventory No. | Operation or idle | No. of Item | Remark            |                      |      |
|--|-----------------------------|--------------------|---------------|-------------------|-------------|-------------------|----------------------|------|
|  |                             |                    |               |                   |             | Evaluation or non | Section              | Page |
| (Moroe Plant, Code No.15-06)<br>(1) Machine tool |                             |                    |               |                   |             |                   |                      |      |
| Lathe Engine                                     | Nippon Denki<br>Yakin K. K. | 7'                 | 15-06<br>171  | Idle              | 1           | Non-evaluation    | -                    | -    |
| Total: .....                                     |                             |                    |               |                   | 1           |                   |                      |      |
| (Awada Plant, Code No.15-16)<br>(1) Machine tool |                             |                    |               |                   |             |                   |                      |      |
| Lathe Engine                                     | Takata<br>Tekko-sho         | 6'                 | 15-16<br>134  | Idle              | 1           | Evaluation Plant  | Integrate facilities | 14   |
| Total: .....                                     |                             |                    |               |                   | 1           |                   |                      |      |

775013

Cy9 (M)  
ECON

4875

GENERAL HEADQUARTERS  
SUPREME COMMANDER FOR THE ALLIED POWERS  
Economic and Scientific Section  
APO 500

WT/MWH/RAS/yy  
15 February 1951

387.6(15 Feb 51)ESS/IND

MEMORANDUM FOR: Reparations Agency, Tokyo

SUBJECT: Application for Movement and Authorized Use  
of Items Listed for Reparations

1. Reference is attached R.A.R. No. 1858 (MS), 19 December 1950, subject: Application for Movement and Authorized Use of Reparations Equipment of 2 Plants of Nippon Denki Yakin K.K. Filed by Asai Tekkosho (Non-reparations plant).

2. The application requesting permission for the transfer and authorized use of the two (2) items of reparations machinery and equipment listed in reference 1, above, is approved as indicated below:

| <u>Present Location</u> | <u>No. of Items</u> | <u>To Be Transferred To</u>                |
|-------------------------|---------------------|--|
| Nippon Denki Yakin K.K. |                     | Asai Tekkosho                              |
| a. Moroe Plant (15-06)  | 1                   | 62, Ao-mura, Nomi-gun, Ishikawa Prefecture |
| b. Awada Plant (15-16)  | 1                   | "  |
| Total                   | 2                   |  |

3. This permit is issued subject to any and all directives affecting reparations plants which have been issued or may hereafter be issued by the Supreme Commander for the Allied Powers. Reports will be rendered as required by current directives and instructions.

FOR THE CHIEF, ECONOMIC AND SCIENTIFIC SECTION:

1 Incl  
as indicated. (dup)

MAURICE M. CLASS  
Chief, Industry Division

Cys furnished:  
CA Sec (dup)  
CPC

MEMO FOR RECORD:

The above ltr is self-explanatory.

Mr. R.A. Steele:  
26-7842

M. M. C.

TOKAI-HOKURIKU INFORMATION:  
FEB 27 1951  
O.D. 11

CA Sec Copy

TO : GENERAL HEADQUARTERS, SUPREME COMMANDER FOR THE ALLIED POWERS.

FROM : Reparations Agency, Tokyo.

SUBJECT: Application for Movement and Authorized Use of Reparations Equipment of 2 Plants of Nippon Denki Yakin K.K. Filed by Asai Tekkosho (Non-reparations plant).

R.A.R. No. 1858 (MS)

19 December 1950.

1. The Reparations Agency hereby submits to your Headquarters an application for movement and authorized use of 2 items of reparations equipment now lying idle in the following 2 plants of Nippon Denki Yakin K.K. filed by the Asai Tekkosho (Non-reparations plant), together with an application of the Ministry of International Trade and Industry, as enclosed herewith:

| <u>Name of Plant</u> | <u>Code No.</u> | <u>No. of Items</u> |
|----------------------|-----------------|---------------------|
| a. Moroe Plant.      | 15-06           | 1                   |
| b. Awada Plant.      | 15-16           | 1                   |
| Total:               |                 | <u>2 Items</u>      |

2. This application has been investigated and has been coordinated with other interested government agencies.

3. It is requested that your most favorable consideration be given to this application at the earliest practicable date.

(Y. Katsuno)  
Director, Reparations Division,  
Reparations Agency.

## Incls:

a. Application of the Ministry of International Trade & Industry.

b. Application of the subject plant.

*Incl 1*



## Attached Paper

Table BLIST OF DESIGNATED REPARATIONS  
MACHINERY AND EQUIPMENT TO BE USED

Applicant: Asai Tekko-sho

| Name of Item   | Name of Mfg. Co.        | Type and dimension | Inventory No. | Operation or Idle | No. of Item | Remark            |                       |      |
|--|-------------------------|--------------------|---------------|-------------------|-------------|-------------------|-----------------------|------|
|  |                         |                    |               |                   |             | Evaluation or non | Section               | Page |
| (Moroe Plant)<br>(1) Machine tool<br>Milling Machine | Nippon Denki Yakin K.K. | Horizontal No. 2   | 15-06-327     | Idle              | 1           | Non evaluation    |                       |      |
| Total:   |                         |                    |               |                   | 1           |                   |                       |      |
| (Awada Plant)<br>(1) Machine tool<br>Lathe engine    | Nippon Denki Yakin K.K. | 8'                 | 15-16-180     | Idle              | 1           | Evaluation plant  | Integrated facilities | 19   |
| Total:   |                         |                    |               |                   | 1           |                   |                       |      |

GENERAL HEADQUARTERS  
 SUPREME COMMANDER FOR THE ALLIED POWERS  
 Economic and Scientific Section  
 APO 500

WT/MWH/RAS/yy  
 15 February 1951

387.6(15 Feb 51)ESS/IND

MEMORANDUM FOR: Reparations Agency, Tokyo

SUBJECT: Application for Movement and Authorized Use  
 of Items Listed for Reparations

1. Reference is attached R.A.R. No. 1858 (MS), 19 December 1950, subject: Application for Movement and Authorized Use of Reparations Equipment of 2 Plants of Nippon Denki Yakin K.K. Filed by Asai Tekkosho (Non-reparations plant).

2. The application requesting permission for the transfer and authorized use of the two (2) items of reparations machinery and equipment listed in reference 1, above, is approved as indicated below:

| <u>Present Location</u> | <u>No. of Items</u> | <u>To Be Transferred To</u>                |
|-------------------------|---------------------|--|
| Nippon Denki Yakin K.K. |                     | Asai Tekkosho                              |
| a. Moroe Plant (15-06)  | 1                   | 62, Ao-mura, Nomi-gun, Ishikawa Prefecture |
| b. Awada Plant (15-16)  | 1                   | "  |
| Total                   | 2                   |  |

3. This permit is issued subject to any and all directives affecting reparations plants which have been issued or may hereafter be issued by the Supreme Commander for the Allied Powers. Reports will be rendered as required by current directives and instructions.

FOR THE CHIEF, ECONOMIC AND SCIENTIFIC SECTION:

1 Incl  
 as indicated. (dup)

MAURICE M. CLASS  
 Chief, Industry Division

Cys furnished:  
 CA Sec (dup)  
 CPC

MEMO FOR RECORD:

The above ltr is self-explanatory.

Mr. R.A. Steele:  
 26-7842

M. M. C.

CA Sec Copy

TO : GENERAL HEADQUARTERS, SUPREME COMMANDER FOR THE ALLIED POWERS.

FROM : Reparations Agency, Tokyo.

SUBJECT: Application for Movement and Authorized Use of Reparations Equipment of 2 Plants of Nippon Denki Yakin K.K. Filed by Asai Tekkosho (Non-reparations plant).

R.A.R. No. 1858 (MS)

19 December 1950.

1. The Reparations Agency hereby submits to your Headquarters an application for movement and authorized use of 2 items of reparations equipment now lying idle in the following 2 plants of Nippon Denki Yakin K.K. filed by the Asai Tekkosho (Non-reparations plant), together with an application of the Ministry of International Trade and Industry, as enclosed herewith:

| <u>Name of Plant</u> | <u>Code No.</u> | <u>No. of Items</u> |
|----------------------|-----------------|---------------------|
| a. Moroe Plant.      | 15-06           | 1                   |
| b. Awada Plant.      | 15-16           | 1                   |
| Total:               |                 | <u>2 Items</u>      |

2. This application has been investigated and has been coordinated with other interested government agencies.

3. It is requested that your most favorable consideration be given to this application at the earliest practicable date.

(Y. Katsuno)  
Director, Reparations Division,  
Reparations Agency.

**Incls:**

- a. Application of the Ministry of International Trade & Industry.
- b. Application of the subject plant.

*Incl 1*

Attached Paper

Table B

LIST OF DESIGNATED REPARATIONS  
MACHINERY AND EQUIPMENT TO BE USED

Applicant: Asai Tekko-sho

| Name of Item                      | Name of Mfg. Co.        | Type and dimension | Inventory No. | Operation or Idle | No. of Item | Remark            |                        |      |
|-----------------------------------|-------------------------|--------------------|---------------|-------------------|-------------|-------------------|------------------------|------|
|                                   |                         |                    |               |                   |             | Evaluation or non | Section                | Page |
| (Moroe Plant)<br>(1) Machine tool |                         |                    |               |                   |             |                   |                        |      |
| Milling Machine                   | Nippon Denki Yakin K.K. | Horizontal No. 2   | 15-06-327     | Idle              | 1           | Non evaluation    |                        |      |
| Total:                            |                         |                    |               |                   | 1           |                   |                        |      |
| (Awada Plant)<br>(1) Machine tool |                         |                    |               |                   |             |                   |                        |      |
| Lathe engine                      | Nippon Denki Yakin K.K. | 8'                 | 15-16-180     | Idle              | 1           | Evaluation plant  | Integrat-ed facilities | 19   |
| Total:                            |                         |                    |               |                   | 1           |                   |                        |      |

775013

Cr 9 (107)  
ECON

GENERAL HEADQUARTERS  
SUPREME COMMANDER FOR THE ALLIED POWERS  
Economic and Scientific Section  
APO 500

5729

387.6( 28 Feb 51 )ESS/IND

MWH/WT/yy  
28 February 1951

MEMORANDUM FOR: Reparations Agency, Tokyo

SUBJECT: Application for Movement and Authorized Use of Items Listed for Reparations

1. Reference is R.A.R. No. 1964 (MS), 28 December 1950, subject: Application for Movement and Authorized Use of Reparations Equipment of Two (2) Plants Filed by Tsune Tetsukogyo K.K. (Non-reparations plant).

2. The application requesting permission for the transfer and authorized use of the **five** ( 5 ) items of reparations machinery and equipment listed in reference 1, above, is approved as indicated in inclosure 1.

3. This permit is issued subject to any and all directives affecting reparations plants which have been issued or may hereafter be issued by the Supreme Commander for the Allied Powers. Reports will be rendered as required by current directives and instructions.

FOR THE CHIEF, ECONOMIC AND SCIENTIFIC SECTION:

- 2 Incls
- 1. Items author for mvmt & use. (dup)
- 2. R.A.R. No. 1964 (MS). 28 Dec 50. (dup)

MAURICE M. CLASS  
Chief, Industry Division

Cys furnished:  
CA Sec (dup)  
CPC

MEMO FOR RECORD:

The above ltr is self-explanatory.

Mr. W.A. Thurman:  
26-8485

M. M. C.

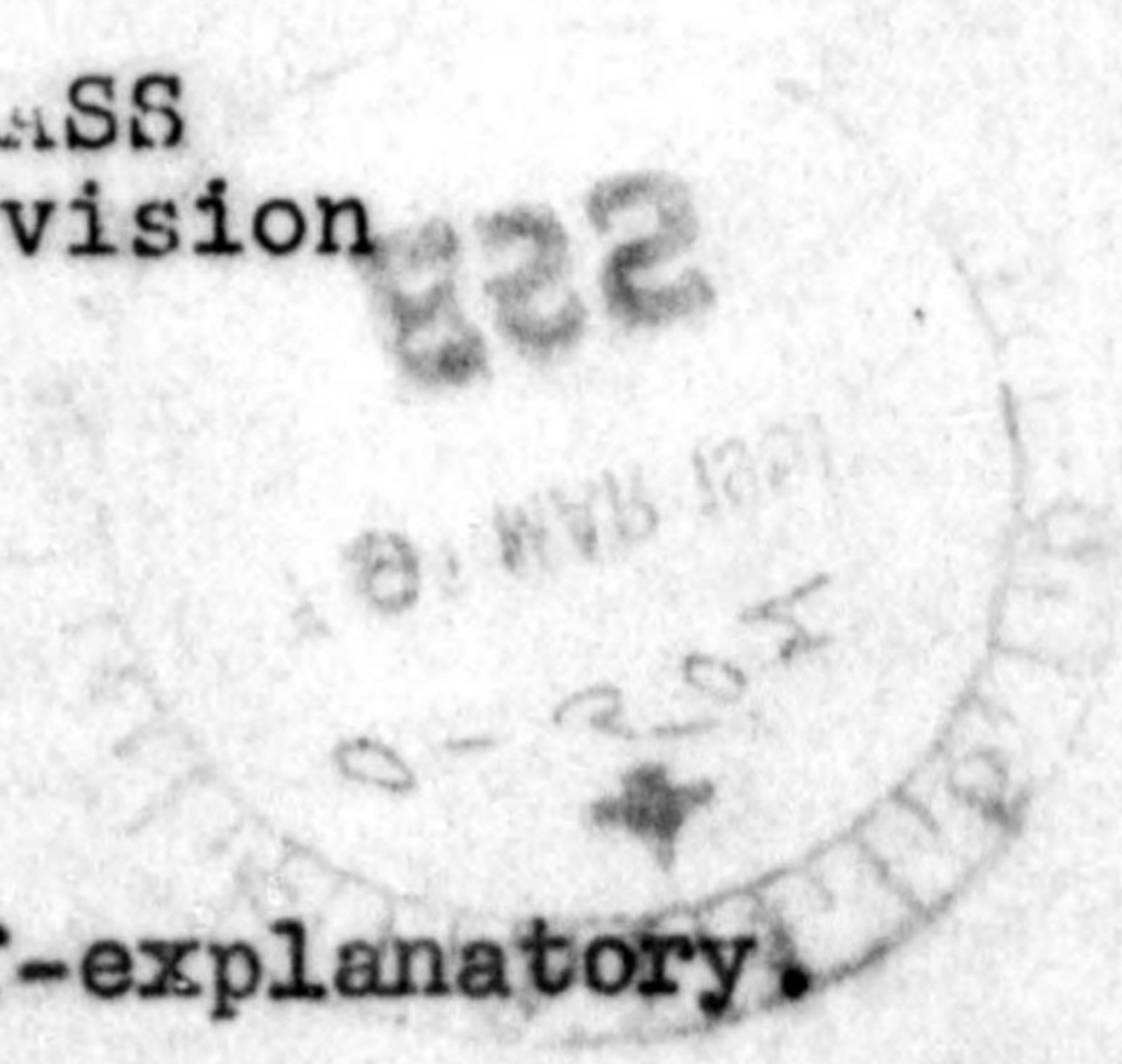

TOKAI-HOKURIKU  
INFORMATION: MAR 10 1951  
O.D. //

CA Sec Copy

Items Authorized for Movement and Use

The application requesting permission for the transfer and authorized use of the following **five** ( 5 ) items of reparations machinery and equipment is approved as listed below:

| <u>Present Location</u>   | <u>No. of Items</u> | <u>To Be Transferred To</u>                   |
|---------------------------|---------------------|---|
| Nippon Denki Yakin K.K.   |                     | Tsune Tetsukogyo K.K.                         |
| a. Moroe Plant<br>(15-06) | 4                   | Tera-machi, Toyama City,<br>Toyama Prefecture |
| b. Awada Plant<br>(15-16) | 1                   | "   |
|                           | <hr/>               |   |
| Total                     | 5                   |   |

- Nothing Follows -

*Encl 1*



TO : GENERAL HEADQUARTERS, SUPREME COMMANDER FOR THE ALLIED POWERS.

FROM : Reparations Agency, Tokyo.

SUBJECT: Application for Movement and Authorized Use of Reparations Equipment of Two (2) Plants Filed by Tsune Tetsukogyo K.K. (Non-reparations plant).

R.A.R. No. 1964 (MS)

28 December 1950.

1. The Reparations Agency hereby submits to your Headquarters an application for movement and authorized use of 5 items of reparations equipment now lying idle in the following two (2) plants filed by the Tsune Tetsukogyo K.K. (Non-reparations plant), together with an application of the Ministry of International Trade and Industry, as enclosed herewith.

| <u>Name of Arsenal</u>                     | <u>Code No.</u> | <u>No. of Items</u> |
|--|-----------------|---------------------|
| a. Moroe Plant, Nippon<br>Denki Yakin K.K. | 15-06           | 4                   |
| b. Awada Plant, Nippon<br>Denki Yakin K.K. | 15-16           | 1                   |
|  | <b>Total:</b>   | <u>5 Items</u>      |

2. This application has been investigated and has been coordinated with other interested government agencies.

3. It is requested that your most favorable consideration be given to this application at the earliest practicable date.

(Y. Katsuno)  
Director, Reparations Division,  
Reparations Agency.

## Incls:

a. Application of the Ministry  
of International Trade &  
Industry.

b. Application of the subject  
company.

Incl 2

Attached Paper  
Table B.

LIST OF REPARATION DESIGNATED  
MACHINERY AND EQUIPMENT TO BE USED

Applicant: Tsune Tetsukogyo K.K.

| Name of Item                 | Name of Mfg. Co.        | Type & Dimension | Inventory No. | Operation or Idle | No. of Item | Remark            |                      |      |
|------------------------------|-------------------------|------------------|---------------|-------------------|-------------|-------------------|----------------------|------|
|                              |                         |                  |               |                   |             | Evaluation or-non | Section              | Page |
| (Moroe Plant Code No. 15-06) |                         |                  |               |                   |             |                   |                      |      |
| (1) <u>Machine tool</u>      |                         |                  |               |                   |             |                   |                      |      |
| Lathe engine                 | Nippon Denki Yakin K.K. | 5'               | 15-06-134     | Idle              | 1           | Non-evaluation    | -                    | -    |
| "                            | "                       | 7'               | 15-06-169     | "                 | 1           |                   |                      |      |
| "                            | "                       | All 8' gear      | 15-06-173     | "                 | 1           |                   |                      |      |
| Milling machine              | "                       | No.2             | 15-06-330     | "                 | 1           |                   |                      |      |
| Total .....                  |                         |                  |               |                   | 4           |                   |                      |      |
| (Awada Plant Code No. 15-16) |                         |                  |               |                   |             |                   |                      |      |
| (1) <u>Machine tool</u>      |                         |                  |               |                   |             |                   |                      |      |
| Lathe engine                 | Takata Tekko-sho        | 6'               | 15-16-145     | Idle              | 1           | Evaluation Plant  | Integrate facilities | 15   |
| Total .....                  |                         |                  |               |                   | 1           |                   |                      |      |
| Grand total .....            |                         |                  |               |                   | 5           |                   |                      |      |



GENERAL HEADQUARTERS  
 SUPREME COMMANDER FOR THE ALLIED POWERS  
 Economic and Scientific Section  
 APO 500

387.6( 28 Feb 51 )ESS/IND

MWH/WT/yy  
28 February 1951

MEMORANDUM FOR: Reparations Agency, Tokyo

SUBJECT: Application for Movement and Authorized  
Use of Items Listed for Reparations

1. Reference is R.A.R. No. 1964 (MS), 28 December 1950,  
 subject: Application for Movement and Authorized Use of  
 Reparations Equipment of Two (2) Plants Filed by Tsune  
 Tetsukogyo K.K. (Non-reparations plant).

2. The application requesting permission for the trans-  
 fer and authorized use of the **five** ( 5 ) items of repara-  
 tions machinery and equipment listed in reference 1, above,  
 is approved as indicated in inclosure 1.

3. This permit is issued subject to any and all di-  
 rectives affecting reparations plants which have been issued  
 or may hereafter be issued by the Supreme Commander for the  
 Allied Powers. Reports will be rendered as required by cur-  
 rent directives and instructions.

FOR THE CHIEF, ECONOMIC AND SCIENTIFIC SECTION:

2 Incls

1. Items author for  
 mvmt & use. (dup)
2. R.A.R. No. 1964 (MS).  
 28 Dec 50. (dup)

MAURICE M. CLASS  
 Chief, Industry Division

Cys furnished:  
 CA Sec (dup)  
 CPC

MEMO FOR RECORD:

The above ltr is self-explanatory.

Mr. W.A. Thurman:  
 26-8485

M. M. C.

CA Sec Copy

E22

28 FEB 1951

0-2557

1951

Items Authorized for Movement and Use

The application requesting permission for the transfer and authorized use of the following **five ( 5 )** items of reparations machinery and equipment is approved as listed below:

| <u>Present Location</u>   | <u>No. of<br/>Items</u> | <u>To Be<br/>Transferred To</u>               |
|---------------------------|-------------------------|---|
| Nippon Denki Yakin K.K.   |                         | Tsune Tetsukogyo K.K.                         |
| a. Moroe Plant<br>(15-06) | 4                       | Tera-machi, Toyama City,<br>Toyama Prefecture |
| b. Awada Plant<br>(15-16) | 1                       | "   |
|                           | <hr/>                   |   |
| Total                     | 5                       |   |

- Nothing Follows -

Encl 1

TO : GENERAL HEADQUARTERS, SUPREME COMMANDER FOR THE ALLIED POWERS.

FROM : Reparations Agency, Tokyo.

SUBJECT: Application for Movement and Authorized Use of Reparations Equipment of Two (2) Plants Filed by Tsune Tetsukogyo K.K. (Non-reparations plant).

R.A.R. No. 1964 (MS)

28 December 1950.

1. The Reparations Agency hereby submits to your Headquarters an application for movement and authorized use of 5 items of reparations equipment now lying idle in the following two (2) plants filed by the Tsune Tetsukogyo K.K. (Non-reparations plant), together with an application of the Ministry of International Trade and Industry, as enclosed herewith.

| <u>Name of Arsenal</u>                     | <u>Code No.</u> | <u>No. of Items</u> |
|--|-----------------|---------------------|
| a. Moroe Plant, Nippon<br>Denki Yakin K.K. | 15-06           | 4                   |
| b. Awada Plant, Nippon<br>Denki Yakin K.K. | 15-16           | 1                   |
|  | <b>Total:</b>   | <u>5 Items</u>      |

2. This application has been investigated and has been coordinated with other interested government agencies.

3. It is requested that your most favorable consideration be given to this application at the earliest practicable date.

(Y. Katsuno)  
Director, Reparations Division,  
Reparations Agency.

## Incls:

a. ~~Application of the Ministry of International Trade & Industry.~~

b. Application of the subject company.

Incl 2

Attached Paper  
Table B.

LIST OF REPARATION DESIGNATED  
MACHINERY AND EQUIPMENT TO BE USED

Applicant: Tsune Tetsukogyo K.K.

| Name of Item                 | Name of Mfg. Co.        | Type & Dimension | Inventory No. | Operation or Idle | No. of Item | Remark            |                      |      |
|------------------------------|-------------------------|------------------|---------------|-------------------|-------------|-------------------|----------------------|------|
|                              |                         |                  |               |                   |             | Evaluation or-non | Section              | Page |
| (Moroe Plant Code No. 15-06) |                         |                  |               |                   |             |                   |                      |      |
| (1) <u>Machine tool</u>      |                         |                  |               |                   |             |                   |                      |      |
| Lathe engine                 | Nippon Denki Yakin K.K. | 5'               | 15-06-134     | Idle              | 1           | Non-evaluation    | -                    | -    |
| "                            | "                       | 7'               | 15-06-169     | "                 | 1           |                   |                      |      |
| "                            | "                       | All 8' gear      | 15-06-173     | "                 | 1           |                   |                      |      |
| Milling machine              | "                       | No.2             | 15-06-330     | "                 | 1           |                   |                      |      |
| Total .....                  |                         |                  |               |                   | 4           |                   |                      |      |
| (Awada Plant Code No. 15-16) |                         |                  |               |                   |             |                   |                      |      |
| (1) <u>Machine tool</u>      |                         |                  |               |                   |             |                   |                      |      |
| Lathe engine                 | Takata Tekko-sho        | 6'               | 15-16-145     | Idle              | 1           | Evaluation Plant  | Integrate facilities | 15   |
| Total .....                  |                         |                  |               |                   | 1           |                   |                      |      |
| Grand total .....            |                         |                  |               |                   | 5           |                   |                      |      |

775013

*Econ*  
*Forward*  
*7686*

*12/4/51*

GENERAL HEADQUARTERS  
SUPREME COMMANDER FOR THE ALLIED POWERS  
Economic and Scientific Section  
APO 500

387.6( 28 Mar 51 )ESS/IND

MWH/WT/yy  
28 March 1951

MEMORANDUM FOR: Reparations Agency, Tokyo

SUBJECT: Application for Movement and Authorized Use of Items Listed for Reparations

1. Reference is R.A.R. No. 385 (MS), 23 February 1951, subject: Application for Movement and Authorized Use of Reparations Equipment of 2 Plants (Code No. 15-06 & 16) of Nippon Denki Yakin K.K. Filed by Tsutaya Plant (Non-reparations plant).

2. The application requesting permission for the transfer and authorized use of the five ( 5 ) items of reparations machinery and equipment listed in reference 1, above, is approved as indicated in inclosure 1.

3. This permit is issued subject to any and all directives affecting reparations plants which have been issued or may hereafter be issued by the Supreme Commander for the Allied Powers. Reports will be rendered as required by current directives and instructions.

FOR THE CHIEF, ECONOMIC AND SCIENTIFIC SECTION:

- 2 Incls
- 1. Items author for mvmt & use. (dup)
- 2. R.A.R. No. 385 (MS).  
23 Feb 51. (dup)

MAURICE M. CLASS  
Chief, Industry Division

Cys furnished:  
CA Sec (dup)  
CPC

MEMO FOR RECORD:

The above ltr is self-explanatory.

Mr. W.A. Thurman:  
26-8485

M. M. C.

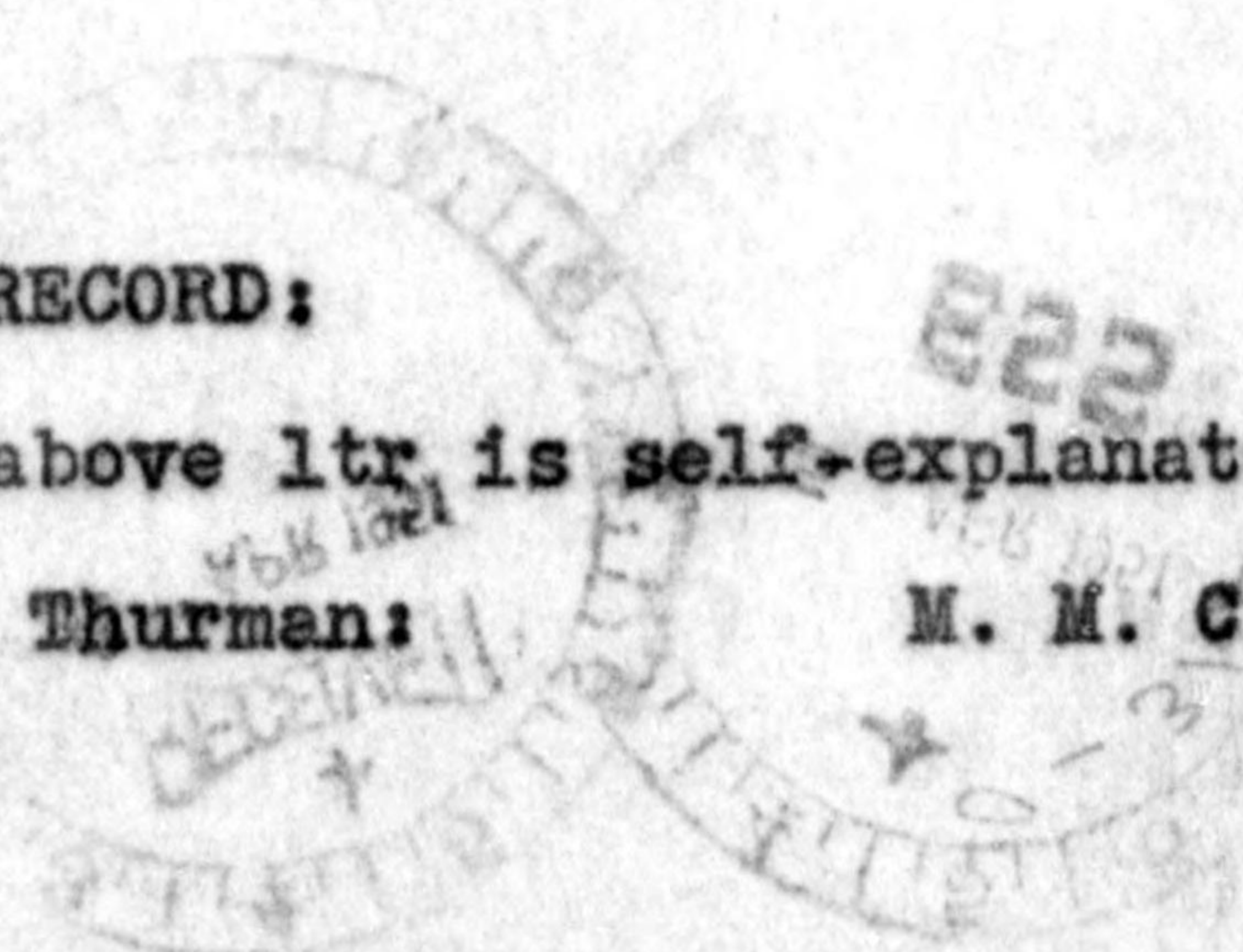

TOKAI-HOKURIKU

INFORMATION

O.D. //

APR 10 1951

CA Sec Copy

Items Authorized for Movement and Use

The application requesting permission for the transfer and authorized use of the following <sup>five</sup> ( 5 ) items of reparations machinery and equipment is approved as listed below:

| <u>Present Location</u> | <u>No. of<br/>Items</u> | <u>To Be<br/>Transferred To</u>                  |
|-------------------------|-------------------------|--|
| Nippon Denki Yakin K.K. |                         | Tsutaya Plant                                    |
| a. Moroe Plant (15-06)  | 2                       | 77, Naruwa-cho, Kanazawa<br>City, Ishikawa Pref. |
| b. Awada Plant (15-16)  | 3                       | "  |
|                         | <hr/>                   |  |
| Total                   | 5                       |  |

- Nothing Follows -

Incl 1

TO : GENERAL HEADQUARTERS, SUPREME COMMANDER FOR THE ALLIED POWERS.

FROM : Reparations Agency, Tokyo.

SUBJECT: Application for Movement and Authorized Use of Reparations Equipment of 2 Plants (Code No. 15-06 & 16) of Nippon Denki Yakin K.K. Filed by Tsutaya Plant (Non-reparations plant)

R.A.R. No. 385 (16)

23 February 1951.

1. The Reparations Agency hereby submits to your Headquarters an application for movement and authorized use of 5 items of reparations equipment now lying idle in the following 2 plants of Nippon Denki Yakin K.K. filed by the Tsutaya Plant (Non-reparations plant), together with an application of the Ministry of International Trade and Industry, as enclosed herewith.

| <u>Name of Plant</u>     | <u>Code No.</u> | <u>No. of Items</u> |
|--------------------------|-----------------|---------------------|
| Mor <sup>o</sup> e Plant | 15 - 06         | 2                   |
| Awada Plant              | 15 - 16         | 3                   |
|                          |                 | <u>Total 5</u>      |

2. This application has been investigated and has been coordinated with other interested government agencies.

3. It is requested that your most favorable consideration be given to this application at the earliest practicable date.

(Y. Katsumo)  
Director, Reparations Division,  
Reparations Agency.

**Incls:**

- a. Application of the Ministry of International Trade & Industry.
- b. Application of the subject plant.

*Incls*

LIST OF DESIGNATED REPARATION MACHINERY AND EQUIPMENT TO BE USED

Applicant: Tsutaya Kojyo

Moroe Plant

| Item                      | Maker            | Size | Inventory No. | Operating or Idle | No.      | Remark         |          |
|---------------------------|------------------|------|---------------|-------------------|----------|----------------|----------|
|                           |                  |      |               |                   |          | Work sheet     | Page No. |
| <u>(1) Machine Tool</u>   |                  |      | 15-06         |                   |          |                |          |
| Lathe Engine              | Takata Tekko-sho | 6'   | 15-08-166     | Suspention        | 1        | Non-Evaluation |          |
| Up-right Drilling Machine | Kawashima K.K.   | 16"  | 15-06-378     | "                 | 1        |                |          |
| <b>Total.....</b>         |                  |      |               |                   | <b>2</b> |                |          |

Awada Plant

|                         |                         |    |           |            |          |                      |    |
|-------------------------|-------------------------|----|-----------|------------|----------|----------------------|----|
| <u>(1) Machine Tool</u> |                         |    | 15-16     |            |          |                      |    |
| Lathe Engine            | Nippon Denki Yakin K.K. | 5' | 15-16-53  | Suspention | 1        | Integrate-facilities | 6  |
| "                       | Takata Tekko-sho        | 6' | 15-16-138 | "          | 1        | "                    | 14 |
| "                       | Nippon Denki Yakin K.K. | 6' | 15-16-151 | "          | 1        | "                    | 16 |
| <b>Total.....</b>       |                         |    |           |            | <b>3</b> |                      |    |



GENERAL HEADQUARTERS  
 SUPREME COMMANDER FOR THE ALLIED POWERS  
 Economic and Scientific Section  
 APO 500

387.6( 28 Mar 51 )ESS/IND

MWH/WT/yy  
28 March 1951

MEMORANDUM FOR: Reparations Agency, Tokyo

SUBJECT: Application for Movement and Authorized  
Use of Items Listed for Reparations

1. Reference is R.A.R. No. 385 (MS), 23 February 1951,  
 subject: Application for Movement and Authorized Use of  
 Reparations Equipment of 2 Plants (Code No. 15-06 & 16) of  
 Nippon Denki Yakin K.K. Filed by Tsutaya Plant (Non-  
 reparations plant).

2. The application requesting permission for the trans-  
 fer and authorized use of the **five ( 5 )** items of repara-  
 tions machinery and equipment listed in reference 1, above,  
 is approved as indicated in inclosure 1.

3. This permit is issued subject to any and all di-  
 rectives affecting reparations plants which have been issued  
 or may hereafter be issued by the Supreme Commander for the  
 Allied Powers. Reports will be rendered as required by cur-  
 rent directives and instructions.

FOR THE CHIEF, ECONOMIC AND SCIENTIFIC SECTION:

2 Incls

1. Items author for  
mvmt & use. (dup)
2. R.A.R. No. 385 (MS).  
23 Feb 51. (dup)

MAURICE M. CLASS  
Chief, Industry DivisionCys furnished:  
CA Sec (dup)  
CPC

MEMO FOR RECORD:

The above ltr is self-explanatory.

Mr. W.A. Thurman:  
26-8485

M. M. C.

CA Sec Copy

Items Authorized for Movement and Use

The application requesting permission for the transfer and authorized use of the following ( 5 ) items of reparations machinery and equipment is approved as listed below:

| <u>Present Location</u> | <u>No. of<br/>Items</u> | <u>To Be<br/>Transferred To</u>                  |
|-------------------------|-------------------------|--|
| Nippon Denki Yakin K.K. |                         | Tsutaya Plant                                    |
| a. Moroe Plant (15-06)  | 2                       | 77, Naruwa-cho, Kanazawa<br>City, Ishikawa Pref. |
| b. Awada Plant (15-16)  | 3                       | "  |
|                         | <hr/>                   |  |
| Total                   | 5                       |  |

- Nothing Follows -

*hml*

TO : GENERAL HEADQUARTERS, SUPREME COMMANDER FOR THE ALLIED POWERS.

FROM : Reparations Agency, Tokyo.

SUBJECT: Application for Movement and Authorized Use of Reparations Equipment of 2 Plants (Code No. 15-06 & 16) of Nippon Denki Yakin K.K. Filed by Tsutaya Plant (Non-reparations plant)

R.A.R. No. 385 (MS)

23 February 1951.

1. The Reparations Agency hereby submits to your Headquarters an application for movement and authorized use of 5 items of reparations equipment now lying idle in the following 2 plants of Nippon Denki Yakin K.K. filed by the Tsutaya Plant (Non-reparations plant), together with an application of the Ministry of International Trade and Industry, as enclosed herewith.

| <u>Name of Plant</u> | <u>Code No.</u> | <u>No. of Items</u> |
|----------------------|-----------------|---------------------|
| Morø Plant           | 15 - 06         | 2                   |
| Awada Plant          | 15 - 16         | 3                   |
|                      |                 | <u>Total 5</u>      |

2. This application has been investigated and has been coordinated with other interested government agencies.

3. It is requested that your most favorable consideration be given to this application at the earliest practicable date.

(Y. Katsumo)  
Director, Reparations Division,  
Reparations Agency.

## Incls:

- a. Application of the Ministry of International Trade & Industry.
- b. Application of the subject plant.

Incl 2

LIST OF DESIGNATED REPARATION  
MACHINERY AND EQUIPMENT TO BE USED

Applicant: Tsutaya Kojyo

Moroe Plant

| Item                      | Maker            | Size | Inventory No. | Operating or Idle | No. | Remark         |          |
|---------------------------|------------------|------|---------------|-------------------|-----|----------------|----------|
|                           |                  |      |               |                   |     | Work sheet     | Page No. |
| <u>(1) Machine Tool</u>   |                  |      | 15-06         |                   |     |                |          |
| Lathe Engine              | Takata Tekko-sho | 6'   | 15-08-166     | Suspention        | 1   | Non-Evaluation |          |
| Up-right Drilling Machine | Kawashima K.K.   | 16"  | 15-06-378     | "                 | 1   |                |          |
| Total.....                |                  |      |               |                   | 2   |                |          |

Awada Plant

|                         |                         |    |           |            |   |                      |    |
|-------------------------|-------------------------|----|-----------|------------|---|----------------------|----|
| <u>(1) Machine Tool</u> |                         |    | 15-16     |            |   |                      |    |
| Lathe Engine            | Nippon Denki Yakin K.K. | 5' | 15-16-53  | Suspention | 1 | Integrate-facilities | 6  |
| "                       | Takata Tekko-sho        | 6' | 15-16-138 | "          | 1 | "                    | 14 |
| "                       | Nippon Denki Yakin K.K. | 6' | 15-16-151 | "          | 1 | "                    | 16 |
| Total.....              |                         |    |           |            | 3 |                      |    |

775013

*Ishikawa ( )*

*12/4/51*

*7684*  
*Guard*

GENERAL HEADQUARTERS  
SUPREME COMMANDER FOR THE ALLIED POWERS  
Economic and Scientific Section  
APO 500

MWH/WT/ao  
28 March 1951

387.6( 28 Mar 51 )ESS/IND

MEMORANDUM FOR: Reparations Agency, Tokyo

SUBJECT: Application for Movement and Authorized Use of Items Listed for Reparations

1. Reference is R.A.R. No. 308 (MS), 12 February 1951, subject: Application for Movement and Authorized Use of Reparations Equipment of Two Plants (Code Nos. 15-06 and 15-16), Nippon Denki Yakin K.K. Filed by Izumi Tekko-sho (Non-reparations plant)

2. The application requesting permission for the transfer and authorized use of the **three ( 3 )** items of reparations machinery and equipment listed in reference 1, above, is approved as indicated in inclosure 1.

3. This permit is issued subject to any and all directives affecting reparations plants which have been issued or may hereafter be issued by the Supreme Commander for the Allied Powers. Reports will be rendered as required by current directives and instructions.

FOR THE CHIEF, ECONOMIC AND SCIENTIFIC SECTION:

2 Incls

- 1. Items author for mvmt & use. (dup)
- 2. R.A.R. No 308 (MS). 12 Feb 51 . (dup)

Cys furnished:  
CA Sec (dup)  
CPC

MAURICE M. CLASS  
Chief, Industry Division

MEMO FOR RECORD:

The above ltr is self-explanatory.

W. A. Thurman, 26-8485

M. M. C.

TOKAI-HOKURIKU INFORMATION  
O.D. //  
APR - 9 1951

CAS

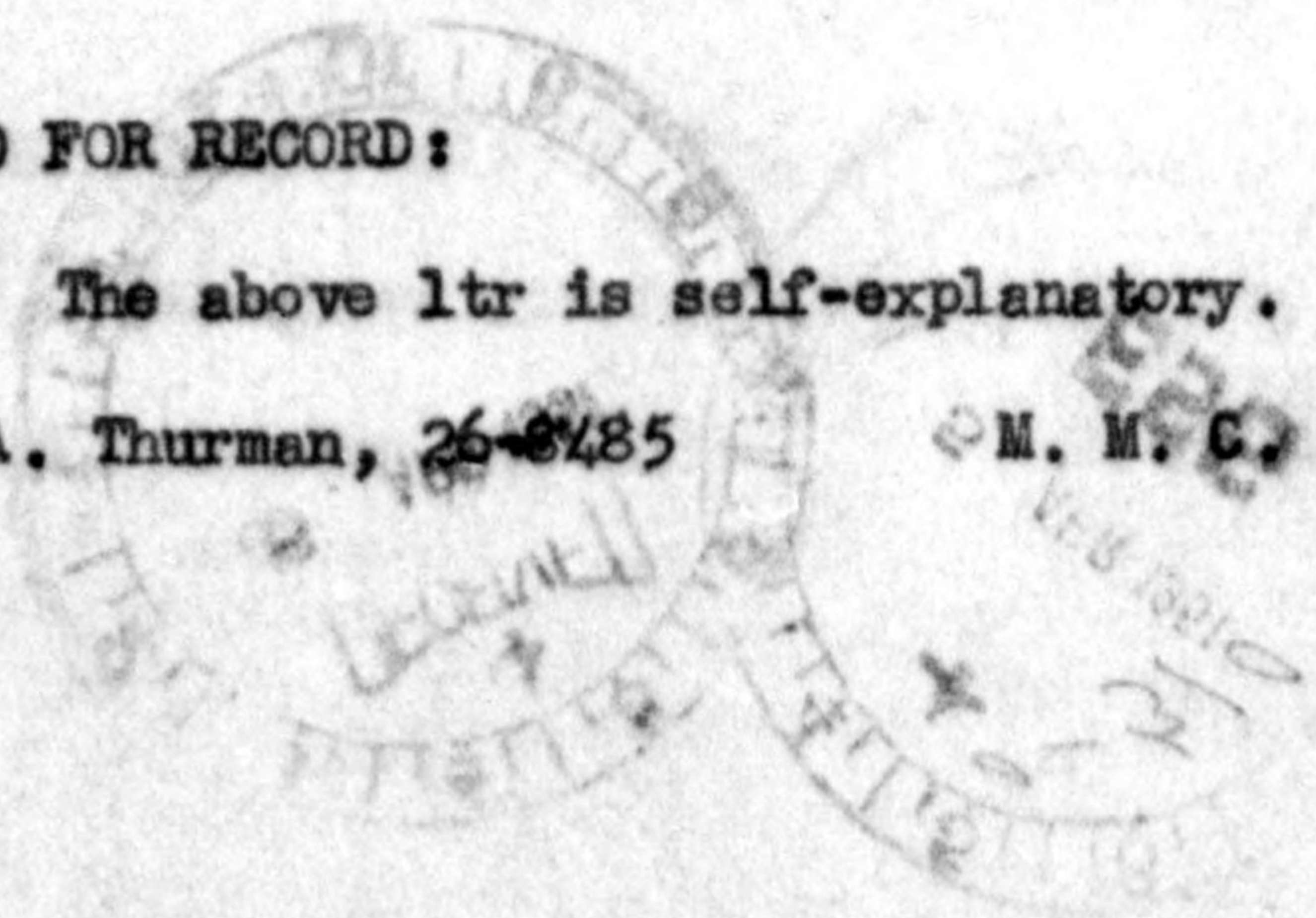

Items Authorized for Movement and Use

The application requesting permission for the transfer and authorized use of the following ~~three~~ (3) items of reparations machinery and equipment is approved as listed below:

| <u>Present Location</u> | <u>No. of Items</u> | <u>To Be Transferred To</u> |
|-------------------------|---------------------|-----------------------------|
| Nippon Denki Yakin K.K. |                     | Izumi Tekko-sho             |
| a. Moroe Plant (15-06)  | 1                   | 2, Nagadohei, 2-bancho,     |
| b. Awada Plant (15-16)  | 2                   | Kanazawa City, Ishikawa     |
|                         |                     | Pref.                       |
| Total                   | <u>3</u>            |                             |

- nothing follows -

*del*

**TO :** GENERAL HEADQUARTERS, SUPREME COMMANDER FOR THE ALLIED POWERS.

**FROM :** Reparations Agency, Tokyo.

**SUBJECT:** Application for Movement and Authorized Use of Reparations Equipment of Two Plants (Code Nos. 15-06 and 15-16), Nippon Denki Yakin K.K. Filed by Inami Tekko-sha (Non-reparations plant)

R.A.R. No. 308 (MS)

12 February 1951.

1. The Reparations Agency hereby submits to your Headquarters an application for movement and authorized use of 3 items of reparations equipment now lying idle in the following two Plants (Code Nos. 15-06 & 15-16), Nippon Denki Yakin K.K. filed by the Inami Tekko-sha (non-reparations plant), together with an application of the Ministry of International Trade and Industry, as enclosed herewith.

| <u>Name of plant</u>    | <u>Code No.</u> | <u>No. of items</u>   |
|-------------------------|-----------------|-----------------------|
| Nippon Denki Yakin K.K. |                 |                       |
| a. Norew plant          | 15 - 06         | 1                     |
| b. Asada plant          | 15 - 16         | 2                     |
|                         |                 | <u>Total: 3 items</u> |

2. This application has been investigated and has been coordinated with other interested government agencies.

3. It is requested that your most favorable consideration be given to this application at the earliest practicable date.

(Y. Katsura)  
Director, Reparations Division,  
Reparations Agency.

**Encs:**

- a. Application of the Ministry of International Trade & Industry.
- b. Application of the subject plant.

*incl 2*

Attached Paper

Table B.

LIST OF REPARATION DESIGNATED  
MACHINERY AND EQUIPMENT TO BE USED

Applicant: Izumi Tekko-sho

| Name of Item                 | Name of Mfg. Co.        | Type & dimension     | Inventory No. | Operation or Idle | No. of Item | Remark            |                       |      |
|------------------------------|-------------------------|----------------------|---------------|-------------------|-------------|-------------------|-----------------------|------|
|                              |                         |                      |               |                   |             | Evaluation or-non | Section               | Page |
| (Moroe Plant Code No. 15-06) |                         |                      |               |                   |             |                   |                       |      |
| (1) Machine tool             |                         |                      |               |                   |             |                   |                       |      |
| Milling Machine              | Nippon Denki Yakin K.K. | Horizontal type No.2 | 15-06-341     | Idle              | 1           | Non-evaluation    | -                     | -    |
| (Awada Plant Code No. 15-16) |                         |                      |               |                   |             |                   |                       |      |
| (1) Machine tool             |                         |                      |               |                   |             |                   |                       |      |
| Lathe engine                 | Takata Tekko-sho        | 6'                   | 15-16-155     | Idle              | 1           | Evaluation Plant  | Integrated facilities | 16   |
| "                            | "                       | 6'                   | 15-16-158     | "                 | 1           | "                 | "                     | 16   |
| Total .....                  |                         |                      |               |                   | 2           |                   |                       |      |
| Grand total .....            |                         |                      |               |                   | 3           |                   |                       |      |



GENERAL HEADQUARTERS  
 SUPREME COMMANDER FOR THE ALLIED POWERS  
 Economic and Scientific Section  
 APO 500

387.6( 28 Mar 51 )ESS/IND

MWH/WT/ao  
 28 March 1951

MEMORANDUM FOR: Reparations Agency, Tokyo

SUBJECT: Application for Movement and Authorized  
 Use of Items Listed for Reparations

1. Reference is R.A.R. No. 308 (MS), 12 February 1951 ,  
 subject: Application for Movement and Authorized Use of Repara-  
 tions Equipment of Two Plants (Code Nos. 15-06 and 15-16), Hippon  
 Denki Yakin K.K. Filed by Izumi Tekko-sho (Non-reparations plant)

2. The application requesting permission for the trans-  
 fer and authorized use of the three ( 3 ) items of repara-  
 tions machinery and equipment listed in reference 1, above,  
 is approved as indicated in inclosure 1.

3. This permit is issued subject to any and all di-  
 rectives affecting reparations plants which have been issued  
 or may hereafter be issued by the Supreme Commander for the  
 Allied Powers. Reports will be rendered as required by cur-  
 rent directives and instructions.

FOR THE CHIEF, ECONOMIC AND SCIENTIFIC SECTION:

2 Incls

1. Items author for  
 mvmt & use. (dup)
2. R.A.R. No. 308 (MS).  
 12 Feb 51 . (dup)

MAURICE M. CLASS  
 Chief, Industry Division

MEMO FOR RECORD:

Cys furnished:  
 CA Sec (dup)  
 CFC

The above ltr is self-explanatory.

W. A. Thurman, 26-8485

M. M. C.

Items Authorized for Movement and Use

The application requesting permission for the transfer and authorized use of the following three ( 3 ) items of reparations machinery and equipment is approved as listed below:

| <u>Present Location</u> | <u>No. of<br/>Items</u> | <u>To Be<br/>Transferred To</u> |
|-------------------------|-------------------------|---------------------------------|
| Nippon Denki Yakin K.K. |                         | Izumi Tekko-sho                 |
| a. Moroa Plant (15-06)  | 1                       | 2, Nagadohei, 2-bancho,         |
| b. Awada Plant (15-16)  | 2                       | Kanazawa City, Ishikawa         |
|                         |                         | Prof.                           |
| Total                   | <u>3</u>                |                                 |

- nothing follows -

incl 1

**TO :** GENERAL HEADQUARTERS, SUPREME COMMANDER FOR THE ALLIED POWERS.

**FROM :** Reparations Agency, Tokyo.

**SUBJECT:** Application for Movement and Authorized Use of Reparations Equipment of Two Plants (Code Nos. 15-06 and 15-16), Nippon Denki Yakin K.K. Filed by Izumi Tekko-sho (Non-reparations plant)

R.A.R. No. 308 (10)

12 February 1951.

1. The Reparations Agency hereby submits to your Headquarters an application for movement and authorized use of 3 items of reparations equipment now lying idle in the following two Plants (Code Nos. 15-06 & 15-16), Nippon Denki Yakin K.K. filed by the Izumi Tekko-sho (non-reparations plant), together with an application of the Ministry of International Trade and Industry, as enclosed herewith.

| <u>Name of plant</u>    | <u>Code No.</u> | <u>No. of item</u>    |
|-------------------------|-----------------|-----------------------|
| Nippon Denki Yakin K.K. |                 |                       |
| a. Noreo plant          | 15 - 06         | 1                     |
| b. Asada plant          | 15 - 16         | 2                     |
|                         |                 | <u>Total: 3 items</u> |

2. This application has been investigated and has been coordinated with other interested government agencies.

3. It is requested that your most favorable consideration be given to this application at the earliest practicable date.

(Y. Katano)  
Director, Reparations Division,  
Reparations Agency.

**Encs:**

- a. Application of the Ministry of International Trade & Industry.
- b. Application of the subject plant.

*enc 2*

Attached Paper

Table B.

LIST OF REPARATION DESIGNATED MACHINERY AND EQUIPMENT TO BE USED

Applicant: Izumi Tekko-sho

| Name of Item                 | Name of Mfg. Co.        | Type & dimension     | Inventory No. | Operation or Idle | No. of Item | Remark            |                       |      |
|------------------------------|-------------------------|----------------------|---------------|-------------------|-------------|-------------------|-----------------------|------|
|                              |                         |                      |               |                   |             | Evaluation or-non | Section               | Page |
| (Moroe Plant Code No. 15-06) |                         |                      |               |                   |             |                   |                       |      |
| (1) Machine tool             |                         |                      |               |                   |             |                   |                       |      |
| Milling Machine              | Nippon Denki Yakin K.K. | Horizontal type No.2 | 15-06-341     | Idle              | 1           | Non-evaluation    | -                     | -    |
| (Awada Plant Code No. 15-16) |                         |                      |               |                   |             |                   |                       |      |
| (1) Machine tool             |                         |                      |               |                   |             |                   |                       |      |
| Lathe engine                 | Takata Tekko-sho        | 6'                   | 15-16-155     | Idle              | 1           | Evaluation Plant  | Integrated facilities | 16   |
| "                            | "                       | 6'                   | 15-16-158     | "                 | 1           | "                 | "                     | 16   |
| Total .....                  |                         |                      |               |                   | 2           |                   |                       |      |
| Grand total .....            |                         |                      |               |                   | 3           |                   |                       |      |

Ishikawa Prefectural Government  
List of EX Kanagawa, Honshu during May

31 May June 1950

SUBJECT: EX Machine.

Name of Plant: Nippon Denki Yakin K.K. Moros Plant.  
(Code No. 15-08)TO : Chief, Tokai-Hokuriku Civil Affairs Region,  
APO 710, Nagoya, Japan.

THRU : Tokai-Hokuriku Liaison and Coordination Office.

| <u>No.</u> | <u>Name of machine</u> | <u>Remarks</u>                              |
|------------|------------------------|---|
| 507        | Motor 3 HP             | Lent to Nippon Denki<br>Yakin Daimon Plant. |

You are herewith reported as attached paper the  
 EX machine cancelled during May.

*E. Kuruma*

Eiko Kuruma  
 Chief, Commerce & Industry  
 Sec., Ishikawa Pref. Gov't.

APPROVED

*E. F. Jochid DAC*  
 Economics Div. THCAR

Date: *29 June '50*

*by Y. Goharashi*

List of EX Machine cancelled during May

31 May 1950

Name of Plant: Nippon Denki Yakin K.K. Moroe Plant.  
(Code No. 15-06)

| <u>No.</u> | <u>Name of machine</u> | <u>Remarks</u>                              |
|------------|------------------------|---|
| 507        | Motor 3 HP             | Lent to Nippon Denki<br>Yakin Daimon Plant. |

APPROVED

*E. F. Jodard*  
E. F. Jodard DAC  
Economics Div. THCARDate *29 June '50**by Y. G. Yamamoto*

775013

15-6

*File  
BME*

BASIC: Ltr. Nihon Denki Yakin K.K., subject: Application for the Permission of Carrying a Motor, dtd 25 February 1949.

1st Ind

Hq Ishikawa Mil Govt Team, APO 301, 3 March 1949

TO: Nihon Denki Yakin K.K., Moroe Plant

1. Approved
2. This motor will be marked with an "EX" to indicate that it is exempted from reparations.

BY ORDER OF THE COMMANDING OFFICER:

JOSEPH D. GILMORE  
Major, FA  
Economics Officer

NIHON DENKI YAKIN K.K.  
MOROE PLANT

Date: 25 Feb. 1949

Subject: Application for the permission of carrying  
a motor

To: - Commanding Officer, Ishikawa M.G. Team

From: Moroe Plant, Nippon Denki Yakin K.K.  
(15 - 5)

This time we wish to carry the following motor  
into our plant from our main plant, Nihon Denki Yakin  
K.K. Honsha Plant for test working of the reparation  
machinery.

Please authorized the motor as "EX"

| Name of Machine    | No. | Maker                         |
|--------------------|-----|-------------------------------|
| Electric Motor 3HP | 1   | Chuo Denki Kogyo-<br>sho K.K. |

J. Ono  
J. Ono  
Custodian, Moroe Plant  
Nippon Denki Yakin K.K.



15-6

Plant name: Nihon Denki Yakin Moroe Plant

Code no. 15-6

List of Transformers.

| No. of Machine | Capacity | No. of Machine | Capacity |
|----------------|----------|----------------|----------|
| 478            | 100 KVA  | ○ 488          | 15 KVA   |
| 479            | 100 "    | ○ 489          | 15 "     |
| 480            | 100 "    | ○ 490          | 10 "     |
| × 481          | 50 "     | ○ 491          | 10 "     |
| ○ 482          | 50 "     | ○ 492          | 10 "     |
| ○ 483          | 50 "     | ○ 493          | 10 "     |
| ○ 484          | 50 "     | ○ 494          | 10 "     |
| ○ 485          | 20 "     | EX             | 50 "     |
| ○ 486          | 20 "     | Total 18 sets  | ○ - 13   |
| ○ 487          | 15 "     |                | X - 1    |

Report of using machines in reparations plant

## Name and Location of the plant

Moroe Plant, Nippon Denki Yakin K. K.

No. Kamicho-306, Moroe-cho, Kanazawa Ishikawa Prefecture.

## Code No.

15 - 6

| Inventory No.        | Name of Machine                | No. | No. of building | Year purchased or installed | Use for                                       |
|----------------------|--------------------------------|-----|-----------------|-----------------------------|---|
| <del>481</del> - 482 | Electric transformer<br>50 KVA | 2   | Outdoor         | 1934                        | Motive power of reeling and weaving industry. |
| 483 - 484            | Ditto                          | 2   | A room          | 36                          | Ditto   |
| 485                  | 20 KVA                         | 1   | Outdoor         | 38                          | Illumination of the same industry.            |
| 486                  | 20 KVA                         | 1   | A room          | 30                          | Ditto   |
| 487 - 489            | 15 KVA                         | 3   | Outdoor         | 36                          | Motive power of the same industry.            |
| 490 - 494            | 10 KVA                         | 5   | Ditto           | 34                          | Illumination of the same industry.            |

# Moroe Work Shop (S)

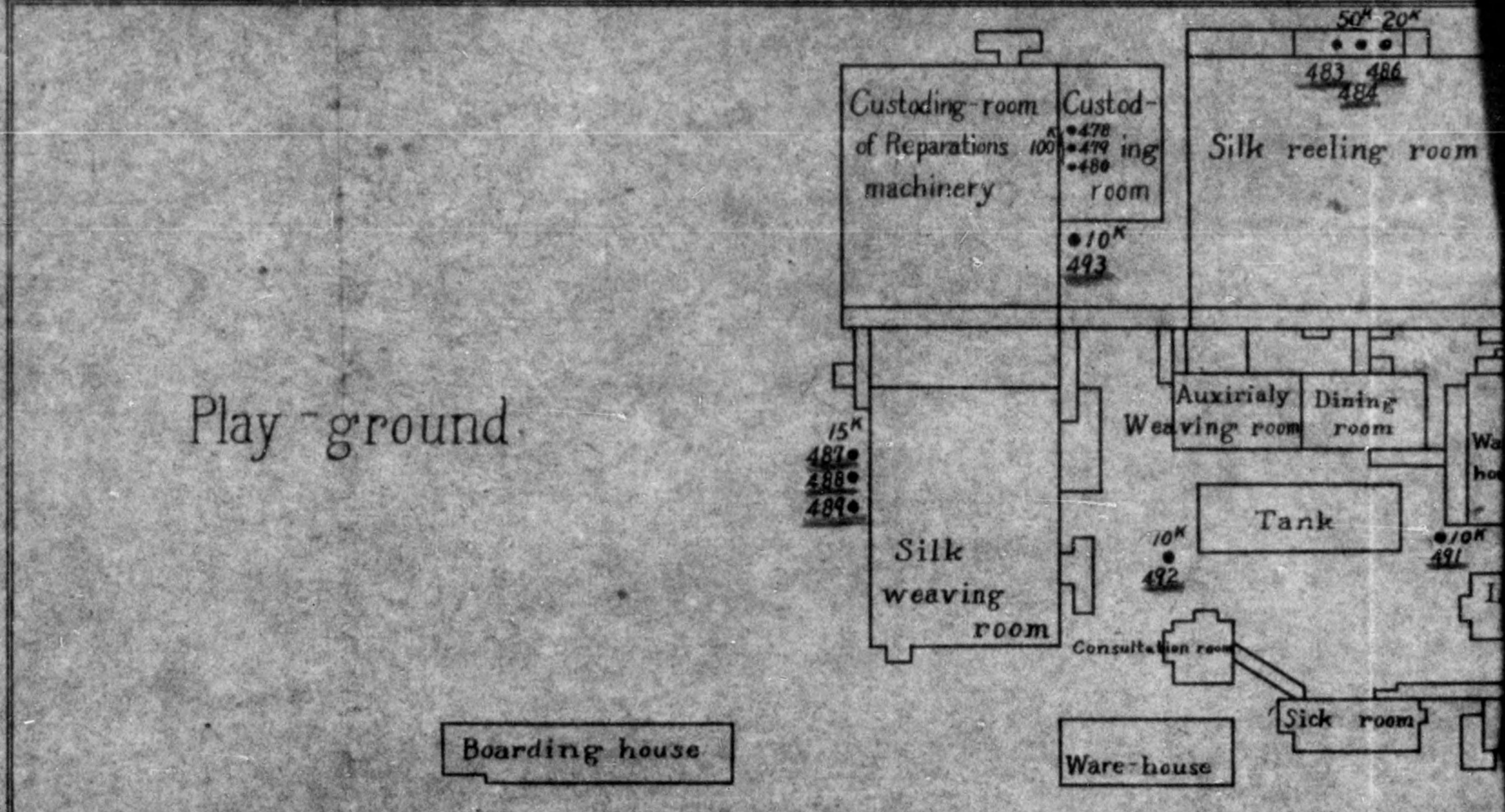

Shop (Spinning mill)

136° 39' 1" E. Long

36° 32' 0" N. Long

Scale =  $\frac{1}{1200}$

N

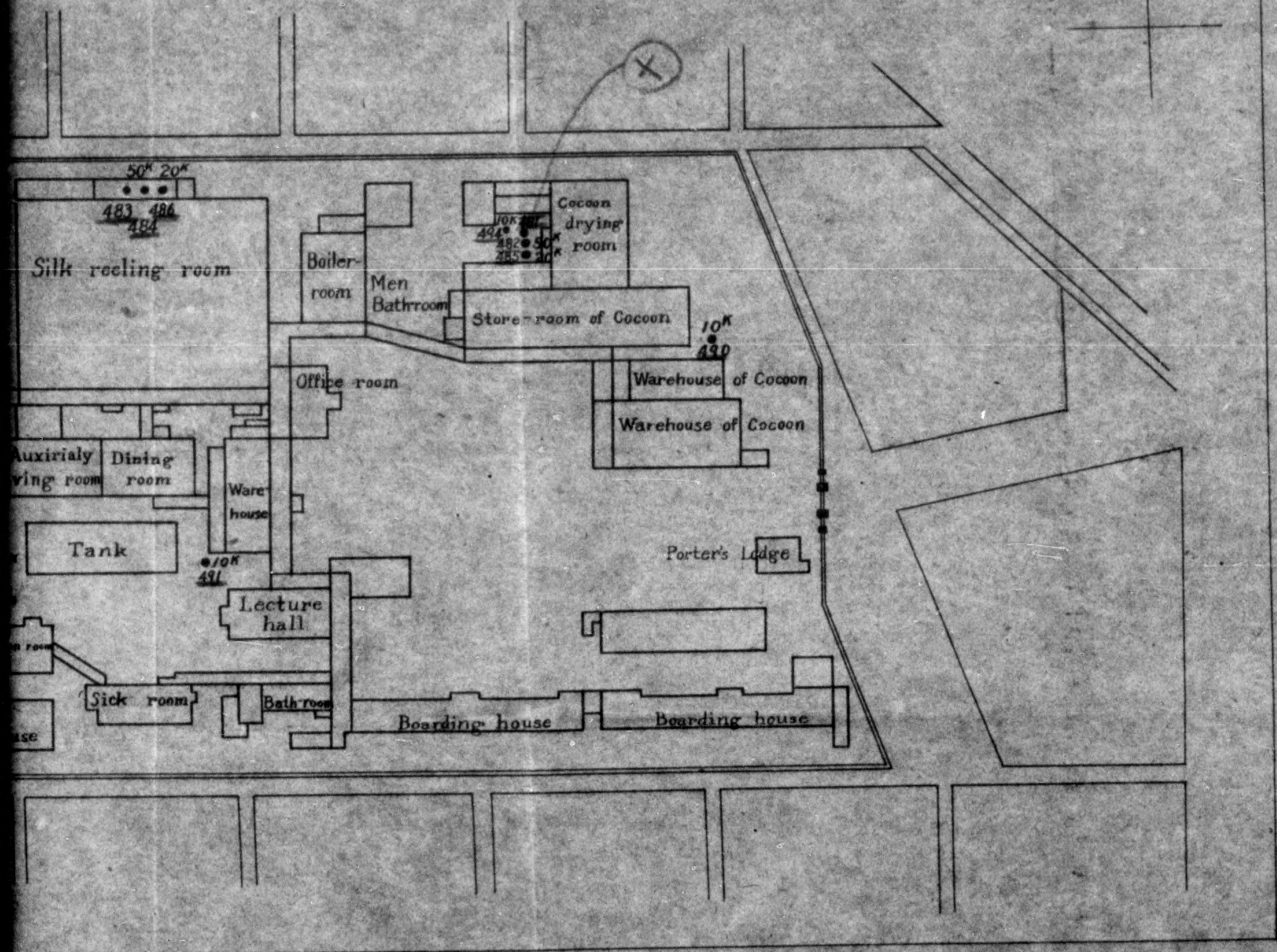

HEADQUARTERS  
ISHIKAWA MILITARY GOVERNMENT TEAM  
APO 301 (Kanazawa, Honshu)

15-6

22 March 1948

*File*  
*15-6*

SUBJECT: Authorize Use of Reparations Machinery and Equipment

THRU: Liaison Office, Ishikawa-ken

TO: Nippon Denki Yakin K.K., Moroe Plant  
Code No. 15-6

1. Under provisions of ltr. Hqs I Corps, AG 386.3-BA, dtd 10 February 1948, authority to operate the machinery and equipment listed in the attached application is hereby approved.

2. The symbol "U" will be marked on each piece of machinery or equipment following the code number. When a piece of machinery or equipment has been withdrawn from authorized use the symbol "U" will be removed.

BY ORDER OF THE COMMANDING OFFICER:

JOSEPH D. GILMORE  
Major, FA  
Economics Officer

Name of Plant: Nippon Denki Yakin K.K. Moroe Plant.  
 Address: *Moroe-machi, Kanazawa, Chikuzen-ken.*  
 Code No.: 15 - 16

*All Machines listed below  
 authorized 22 March 1948*

| Building No.            | Code No.  | Name of Machine | Use  |
|-------------------------|-----------|-----------------|--|
| Outdoor                 | 15-16-482 | Transformer     | Motive power of reeling and weaving industry |
| A room                  | 483       | Transformer     | "  |
| A room                  | 484       | Transformer     | "  |
| Outdoor                 | 485       | Transformer     | illumination of the same industry            |
| A room                  | 486       | Transformer     | "  |
| Transformer sub-station | 487       | Transformer     | "  |
| Outdoor                 | 488       | Transformer     | "  |
| A room                  | 489       | Transformer     | "  |
| Outdoor                 | 490       | Transformer     | "  |
| Outdoor                 | 491       | Transformer     | "  |
| Outdoor                 | 492       | Transformer     | "  |
| Outdoor                 | 493       | Transformer     | "  |
| Outdoor                 | 494       | Transformer     | "  |
| Total                   |           | 13              |  |

*"Authorized use"  
 Machine as of  
 31 Aug. 1949*

Inspector(s)

REPARATIONS INSPECTION CHECK SHEET

DATE 8 March 49

1. Plant Code # 15-06 Prefecture Ishikawa
2. Name Nippon Denki Kaisha, Ltd. (Mitsui Bussan Kaisha, Ltd. owned) Toyama
3. Category of Plant A/C Plant Established 1944
4. Made: new silk  
 Pre-war \_\_\_\_\_ During War A/C parts Now Nothing
5. Employed:  
 Pre-war \_\_\_\_\_ During War 1000 Now 20
6. Equipment (machine tool) classification:  
506 Total 473 #1 454 #2 6 #3 13 Avg. Age 5  
 % Foreign Made none Est. Desirable to Claimant \_\_\_\_\_
7. Equipment now in operation. Total 14 Its Maintenance? Good  
 Equipment now in "Authorized Use." Total 14 % in operation 100  
 Equipment reported in "Authorized Use." now not in "Authorized Use."  
 Total none (List inventory numbers on back.)
8. Classification deemed satisfactory/~~unsatisfactory~~ \_\_\_\_\_
9. Reclassification deemed ~~essential~~/not essential \_\_\_\_\_
10. Inventory Complete? yes Items not inventoried none
11. Overall maintenance: Excellent/Good/Fair/Poor Good to Excellent
12. Reconditioning in progress? complete To be completed by maintained 1948  
12 employees, 3 of them skilled mechanics, engaged in maintenance and reconditioning of equipment.
13. General appearance of plant/storage and equipment: good
14. General impression of management/custodian: good
15. Estimated removability of equipment (by value) 100 % of buildings  
none %.
16. Engineers available who installed equipment originally? none
17. Plant's experience in dismantling none, in preparation (packaging) for shipment none in re-assembly at destination

(Over)

18. Time required for dismantling & packing 3 Months for re-assembly unknown.
19. Recommended port for shipment Suehiki Mode of transp. to port Truck on Ry. spur IRR Ry to port pier 80 KM
20. Is plant well guarded? 6 Has plant been evaluated by JG? No
21. Petition on file for removal from reparations lists? yes
22. Is plant typical? yes Remarks \_\_\_\_\_
- 
23. Estimated weight and dimensions of largest package after dismantling and crating milling machine 4 ton 2m x 1.5 x 2m
24. How many buildings comprise this plant? 1 How many include reparations equipment? 1 How many contain immediately available reparations equipment? 1
25. What functional subdivisions are included in the plant and in which buildings are they located? machineshop, substation
26. Is a clear plant layout with adequate identification and description of all functional subdivisions available in Reparations (if more than one functional subdivision)? on file (If not, obtain one). If a plant evaluation report is available in Reparations, does the building identifications agree with plant layout? yes
27. Is plant large, medium, or small in comparison to other plants of similar type? \_\_\_\_\_ If large or medium, what possible breakdown or grouping of subordinate units into 2 or 3 allocation units appears most logical? \_\_\_\_\_
28. If major portions of the plant are less useful or less desirable than other portions, specify the poorer sections (and building locations) \_\_\_\_\_
29. If this plant is a dispersal area or is very small, could it be allocated with another nearby plant or dispersal area? \_\_\_\_\_ If so, what one(s) \_\_\_\_\_
30. Does the equipment in authorized use destroy the balance or impair the usefulness of available equipment? \_\_\_\_\_  
If so, how? \_\_\_\_\_



RECAP. SUMMARY: REPARATIONS INVENTORY UNDER MILITARY GOVERNMENT SUPERVISION

Prefecture

Present principle location of plant: \_\_\_\_\_  
 Plant Code No., Classification, SCAPIN name: \_\_\_\_\_

Name under which plant organization is now operating, if different from above: \_\_\_\_\_

Plant identification code numbers: : : : : : : :  
 : 15-06 : : : : : : :  
 Location at time of inventory (if : : : : : : :  
 different from that shown above): : : : : : : :

I. SUMMARY OF INVENTORY:

|  |        |       |   |   |   |   |   |
|--|--------|-------|---|---|---|---|---|
| A.1.   | ( 19 ) | : 498 | : | : | : | : | : |
| 2.   | ( 19 ) | : 8   | : | : | : | : | : |
| 3.   | ( 19 ) | :     | : | : | : | : | : |
| 4.   | ( 19 ) | :     | : | : | : | : | : |
| Total number of items originally included in inventories:  |        | : 506 | : | : | : | : | : |
| B. Above inventories included items classified as follows at time of inventories:  |        |       |   |   |   |   |   |
| 1. Exempt status (marked "EX"):  |        | : 0   | : | : | : | : | : |
| 2. Special purpose (marked "SP"):  |        | : 0   | : | : | : | : | : |
| 3. Looted property (marked "CPC"):   |        | : 0   | : | : | : | : | : |
| C. Exempt items brought into, or constructed in, this plant location since time of inventories, with permission of Milit. Govt., and marked "EX":                      |        |       |   |   |   |   |   |
|  |        | : 1   | : | : | : | : | : |
| D. Reparations items (other than those included under "A" above) transferred into principle plant location since time of inventories, with Milit. Govt. authorization: |        |       |   |   |   |   |   |
|  |        | : 0   | : | : | : | : | : |
| E. Disposition of former "Special Purpose" items:  |        |       |   |   |   |   |   |
| 1. Partially destroyed and reclassified to "Gen. Class." under original serial numbers:  |        | : 0   | : | : | : | : | : |
| 2. Reclassified to "Gen. Class." without destruction, by action of Milit. Govt. authorities:   |        | : 0   | : | : | : | : | : |
| 3. Items salvaged in destruction of "SP" items, and added to inventory under new serial identification numbers:  |        | : 0   | : | : | : | : | : |
| 4. Completely destroyed and dropped from records:  |        | : 0   | : | : | : | : | : |
| F. Totals (A + C + D + E3 - E4):   |        | : 506 | : | : | : | : | : |
| CHECK GRAND TOTAL:   |        | : 506 | : | : | : | : | : |
| G. Identification marking of individual items:*  |        |       |   |   |   |   |   |
| 1. Lowest serial no. used for identification of items:   |        | : 1   | : | : | : | : | : |
| 2. Highest serial no. used for identification of items:  |        | : 506 | : | : | : | : | : |

\* In event of discrepancy between identification serial numbers and total number of items shown above (A + C + E3), explain below:

Plant identification code numbers: : : : : :  
 Location at time of inventory (if : : : : :  
 different from that shown above): : (above) : : : :

II. SUMMARY OF PRESENT STATUS (Items summarized under I above):

|  |   |   |   |   |   |   |   |   |   |
|--|---|---|---|---|---|---|---|---|---|
| A. Items in dead storage for reparations claim at plant locations indicated:   | : | : | : | : | : | : | : | : | : |
| B. Items in use at plant locations as indicated (other than "EX" and "CPC"):   | : | : | : | : | : | : | : | : | : |
| 1. Officially classified and listed as "authorized use" (marked "U") for use by Japanese agencies:   | : | : | : | : | : | : | : | : | : |
| 2. In temporary operation by Japanese agencies with permission of local Milit. Govt. authorities (without official classification nor "U" marking):                          | : | : | : | : | : | : | : | : | : |
| 3. Officially classified and listed as "authorized use" (marked "U") for use by Occupation Force agencies:   | : | : | : | : | : | : | : | : | : |
| C. Items officially classified and listed as "exempt from reparations claim" (marked "EX"):  | : | : | : | : | : | : | : | : | : |
| 1. Remaining in plant locations as indicated:  | : | : | : | : | : | : | : | : | : |
| 2. Removed from plant locations as indicated, with permission of Milit. Govt. authorities:   | : | : | : | : | : | : | : | : | : |
| D. Dropped from records by action of Milit. Govt. authorities (other than "SP" items):   | : | : | : | : | : | : | : | : | : |
| 1. Improperly inventoried (considered as scrap):   | : | : | : | : | : | : | : | : | : |
| 2. Correction of duplicate inventory of items:   | : | : | : | : | : | : | : | : | : |
| 3. Destroyed by fire, flood, accident or calamity:   | : | : | : | : | : | : | : | : | : |
| E. Items officially classified and listed as "looted property" (marked "CPC"):   | : | : | : | : | : | : | : | : | : |
| 1. Remaining in plant locations as indicated:  | : | : | : | : | : | : | : | : | : |
| 2. Removed from plant locations as indicated (in custody of Civil Property Custodian):   | : | : | : | : | : | : | : | : | : |
| F. Items removed from plant locations as indicated for use by Occupation Forces, under Milit. Govt. procurement papers:  | : | : | : | : | : | : | : | : | : |
| G. Items removed from plant locations as indicated to locations other than those indicated (other than "EX" items) with Milit. Govt. approval, for use by Japanese agencies: | : | : | : | : | : | : | : | : | : |
| H. Items inventoried and remaining in dispersed locations (not in reparations plants) released from reparations custody:   | : | : | : | : | : | : | : | : | : |
| I. Items released to, and removed from plant locations by, Technical Intelligence Detachment, GHQ:   | : | : | : | : | : | : | : | : | : |
| J. Items not included above (explain below):   | : | : | : | : | : | : | : | : | : |
| K. Totals (A thru J):  | : | : | : | : | : | : | : | : | : |
| CHECK GRAND TOTAL:   | : | : | : | : | : | : | : | : | : |

Plant name: \_\_\_\_\_

Code No. 15-06

III. STATUS OF ELECTRIC UTILITIES EQUIPMENT (Pertaining to principle plant location)

|   | : In dead storage: |                | : In "authorized |             | : Total:    |             |           |
|---|--------------------|----------------|------------------|-------------|-------------|-------------|-----------|
|   | : Unit             | : or temporary | : use"           | : in this   | : plant     | : location: |           |
|   | : of               | : operation:   | : plant          | : location: | : location: | : location: |           |
|   | : Cap.             | : No. of:      | : Total          | : No. of:   | : Total     | : No. of:   |           |
|   | : Units            | : Capacity:    | : Units          | : Capacity: | : Units     | : Capacity: |           |
| A. Transformers:  | : KVA              | : 3            | : 300            | : 14        | : 335       | : 17        | : 635     |
| B. Rectifiers:  | : KVA              | : 0            | : 0              | : 0         | : 0         | : 0         | : 0       |
| C. Control panels and switch gear:  | : Units            | : 2            | : 150AMP         | : 1         | : 3500V     | : 3         | : 200AMP  |
| D. Motors which are an integral part of, and inventoried with, individual items of equipment: | : HP               | : 46           | : 81.75          | : 0         | : 0         | : 46        | : 81.75   |
| E. Separate motors (not included under "D"):  | : HP               | : 11           | : 91 H.P.        | : 0         | : 0         | : 11        | : 91 H.P. |
| F. Direct current generators:   | : KVA              | : 1            | : 40 AMP         | : 0         | : 0         | : 1         | : 40 AMP  |
| G. Alternating current generators:  | : KVA              | : 0            | : 5 KW           | : 0         | : 0         | : 0         | : 5 KW    |

IV. SUMMARY OF BUILDINGS (Pertaining to principle plant location):

|                                 | : Retained in |            | : Released from |            | : Total for plant: |         |
|---------------------------------|---------------|------------|-----------------|------------|--------------------|---------|
|                                 | : Reparations | : Custody: | : Reparations   | : Custody: | : Bldgs.:          | : Floor |
|                                 | : No. of:     | : Total    | : No. of:       | : Total    | : Bldgs.:          | : Floor |
|                                 | : Area:       | : Area:    | : Area:         | : Area:    | : Area:            | : Area: |
| A. Structural steel frame:      | : :           | : :        | : :             | : :        | : :                | : :     |
| B. Timber frame:                | : 1           | : 540      | : 1             | : 540      | : 1                | : 540   |
| C. Reinforced concrete frame:   | : :           | : :        | : :             | : :        | : :                | : :     |
| D. Brick and/or plain concrete: | : :           | : :        | : :             | : :        | : :                | : :     |
| TOTAL:                          | : :           | : :        | : :             | : :        | : :                | : :     |

V. GENERAL REMARKS:

Date of this Recap. Summary:

Above is believed to be true and correct:

004 Rep.

HEADQUARTERS  
ISHIKAWA MILITARY GOVERNMENT TEAM  
APO 713

VLC/ys

6 June 1947

SUBJECT: Application for the Sale of Land and Buildings Housing Repara-  
tions Equipment

TO: Commanding Officer, Tokai-Hokuriku Mil Govt Region, APO 710

1. Application is submitted by Nippon Denki Yakin KK, No. Sa 1, Naruwa-cho, Kanazawa-shi, Ishikawa-ken, Code No. 15-6 for the release and sale of land and buildings housing Repara-tions Equipment.

2. Subject plant has asked for permission to concentrate all their equipment into one building, with the exception of thirteen (13) trans-formers which are presently being used for silk reeling, as outlined in the application (Plant Layout) with custody and control by Nippon Denki Yakin KK after the release. Protection, maintenance and preservation of equipment can be satisfactorily maintained in the subject building.

3. Subject plant was established in 1930 by Nitto Boseki KK and in 1936 enterprised and corporated with Nippon Denki Yakin KK to contin-ue the manufacture of silk thread. On 1 Jan 1944 the concern was purchas-ed by Nippon Denki Yakin KK and converted into an air craft factory sole-ly for the purpose of manufacturing various air craft parts. Since the termination of war subject plant was granted a permit to reconvert by I Corps and to produce silk thread.

4. The continued uninterrupted production of silk thread in the opinion of this headquarters is important for the future economy of the local area. Should present plans materialize within twelve months the new company would use approximately five hundred (500) employees capable of producing 3154 lbs of silk thread monthly. Planned production also consists of 100,000 yds of woven material per month.

5. Application forwarded for your consideration.

FOR THE COMMANDING OFFICER:

2 Incl:  
Prefectural Recommendation  
Application

BEN. A. FALZGRAF  
Major, CMP  
Executive

541

BASIC: Ltr, Hq Ishikawa Mil Govt Team, Subj: "Application for the Sale of Land and Buildings Housing Reparations Equipment", dtd 6 Jun 47

1st Ind

Hq Tokai-Hokuriku Mil Govt Region, APO 710, 9 Jun 47

TO: CG, I Corps, APO 301  
ATTN: Mil Govt Section

1. Recommend that land and building, not needed for custody and control of machinery on reparations, be released to the Home Ministry for return to its rightful owner.

2. In the event that the land and buildings are returned to the rightful owner, and authorization is given subject company to use the thirteen (13) transformers, the company will be instructed that maintenance will be performed, and that transformers will be used only until such time as they are required for reparations claim.

FOR THE COMMANDING OFFICER:

FRANK M. WILKINS  
Maj, FA  
Adjutant

2 Incls:  
n/c  
lcc w/d

BASIC: Ltr, Hq Ishikawa Mil Govt Team, subj: "Application for the Sale of Land and Buildings Housing Reparations Equipment", dtd 6 June 1947

AG 004 - BA

2nd Ind

EHN/sy

Hq I Corps, APO 301,

13 JUN 1947

TO: CG, Tokai-Hokuriku Mil Govt Region, APO 710

1. The land and buildings of the Nippon Denki Yakin KK., which are not required for custody and control of reparations equipment may be released to the Home Ministry, provided that this is not an enemy installation as defined in Annex 10 Administrative Order 24, Headquarters I Corps, dated 11 April 1947.

2. In the event that this is an enemy installation, the release must be accomplished in accordance with the provisions of paragraph 2, Operational Directive No. 28/14, for 1945, Headquarters Eighth Army, dated 27 February 1947.

3. Procedure outlined in paragraph 2, 1st indorsement, is approved.

BY COMMAND OF MAJOR GENERAL WOODRUFF:

2 Incls:  
n/e

50202

HEADQUARTERS  
ISHIKAWA MILITARY GOVERNMENT TEAM  
APO 713

VLC/ys

17 April 1947

SUBJECT: Removal of Reparations Equipment

TO: Commanding Officer, Tokai-Hokuriku Mil Govt Region, APO 710

1. In accordance with provisions of par. 2 ltr Hq I Corps dated 13 Jan 47 Subject: "Deletion of Plants Subject to Reparations" the enclosed application is forwarded for your consideration.
2. On 20 Dec 46 subject Company submitted application for removal of 13 transformers and was denied by Hq 8th Army, 6 Feb 47.

FOR THE COMMANDING OFFICER:

BEN A. FALZGRAF  
Major, CMP  
Executive

2 Incls:

1. Prefectural Recommendation
2. Application for Release

BASIC: Ltr, Hq Ishikawa Mil Govt Team, subj: "Removal of Reparations Equipment", dtd 17 Apr 47

1st Ind

GWM/ss

Hq Tokai-Hokuriku Mil Govt Region, APO 710, 5 May 47

TO: CG, I Corps, APO 301  
(ATTN: Mil Govt Section)

1. Subject reparations aircraft plant, Nihon-Denki Yakin K.K., Moroe Kojo (15-6), previously submitted application for removal of the thirteen transformers, and the application was refused by Commanding General, Headquarters Eighth Army in 3rd indorsement to Ltr. Headquarters Ishikawa Military Government Team, subj: "Removal from Reparations", dated 15 Jan 1947.

2. This headquarters can see no new information offered in the present application to warrant the removal of the 13 transformers, and therefore forwards the application with unfavorable recommendation.

FOR THE COMMANDING OFFICER:

FRANK M. WILKINS  
Maj FA  
Adjutant

2 Incls:  
n/c  
lec w/d



**BASIC:** Ltr, Ishikawa Mil Govt Team, subj: "Removal of Reparations Equipment", dtd 17 April 47.

AG 004 - BA

2nd Ind

EHN/md

Hq I Corps, APO 301,

8 MAY 1947

TO: CG, Eighth Army, APO 343

1. Reference: letter, Ishikawa Military Government Team, subject: "Removal from Reparation," dated 15 January 1947, and 1st indorsement hereto, Headquarters I Corps, to Commanding General, Eighth Army, dated 1 February 1947.

2. A previous application of the Nippon Denki Yakin KK, Moroe Plant (15-6 Air C) for exclusion of thirteen (13) transformers from reparations was forwarded to your headquarters by reference letter, paragraph 1. This application was denied by your headquarters under date of 6 February 1947.

3. This headquarters has previously expressed the opinion that subject transformers are properly subject to reparations, and that no reason exists for giving special consideration for the release of these transformers over that of other machinery located in the plant. The opinion of this headquarters remains unchanged, and it is recommended that the application of the Nippon Denki Yakin KK, Moroe Plant for release of the thirteen (13) transformers be denied. M.C.

FOR THE COMMANDING GENERAL:

2 Incls:

1 copy ea w/d

45834

004 RP (C)

Ltr, Hq Ishikawa Mil Govt Team, subj: "Removal of Reparations Equipment", dated 17 April 1947.

AG 004 (MG-lm)

3rd Ind

14 May 1947

Headquarters Eighth Army, APO 343

TO: Commanding General, I Corps, APO 301

The recommendation contained in paragraph 3 of the 2nd indorsement is approved.

BY COMMAND OF LIEUTENANT GENERAL EICHELBERGER:

R. SCHAFER  
Lt. Col., AGD  
Asst. Adjutant General

MG

2 Incls:

1 copy each w/d

AG 004 - BA

4th Ind

EHN/lm

Hq I Corps, APO 301, 19 MAY 1947

TO: CO, Tokai-Hokuriku Mil Govt Region, APO 710

1. Your attention is directed to 3rd indorsement.
2. Application of Nippon Denki Yakin KK, Moroe Plant (15-6 Air C) for release of thirteen transformers from reparations claim has been denied.

BY COMMAND OF MAJOR GENERAL WOODRUFF:

2 Incls:  
n/c

44116

C. FILE

ISHIKAWA  
MILITARY GOVERNMENT TEAM  
APO 713

VLC/ys

16 January 1947

SUBJECT: Removal from Reparation

TO : Supreme Commander for the Allied Powers, APO 500  
THRU: Tokai-Hokuriku Mil Govt Region, APO 710

1. In accordance with provisions of letter AG 004-BA Hq. I Corps Subject, "Deletion of plants Subject to Reparations," dated 13 Jan 1947, the enclosed application for removal of one (1) air compressor is forwarded on:

Nippon Denki Yakin K.K., Moroe Plant  
No. Sa-1 Naruwa-cho, (15-6)  
Kanazawa-shi, Ishikawa-ken

2. Subject plant was established in 1930 by Nitto Boseki KK and in 1936 enterprised and cooperated with Nippon Denki Yakin KK to continue the manufacture of silk thread. On 1 Jan 1944 the concern was purchased by Nippon Denki Yakin and converted into aircraft production solely for the purpose of manufacturing various aircraft parts.

3. Since the termination of war, subject plant was granted a permit to reconvert from war production to essential civilian commodities from Headquarters I Corps to immediately start production of silk thread. Fifty percent (50%) of the machinery are now installed and in operation, and the maximum production currently authorized is 9,719 pounds. It is not known the degree of difficulty which will be encountered for the continued operation, if one (1) piece of machinery air compressor (which will be used to manufacture parts of spinning machine) be removed for reparation. Continued operation of subject plant is important for the future economy of local area.

4. This headquarters is forwarding the application for your consideration. Subject plant has made one previous application for the removal of 13 transformers from reparations.

FOR THE COMMANDING OFFICER:

/s/t/ GEORGE A. SMITH  
2nd Lt., INF  
AdjutantIncl:  
3 copies, Application

DISTRIBUTION: 3-Tokai-Hokuriku MGRRegion; 1-File

**BASIC:** Ltr, Hq Ishikawa Mil Govt Team, subj: "Removal  
from Reparation," dtd 16 Jan 47

1st Ind

GNM/ss

Hq Tokai-Hokuriku Mil Govt Region, APO 710, 28 Jan 47

TO: CG, I Corps, APO 301  
ATTN: Res Comm & Ind Officer

1. The air compressor has been inventoried and the inventory sheets forwarded to higher headquarters. This machine is a class I machine and is located in the Moroe Plant. It was moved from the main plant in 2 August 45 for use in aircraft production, but due to the end of hostilities the compressor was not put into operation. If this compressor is removed from reparations it will be used in the main plant in the manufacturing of spinning machines.

2. This application is being forwarded for consideration by higher Headquarters with unfavorable recommendation by this headquarters.

FOR THE COMMANDING OFFICER:

/s/t/ FRANK W. WILKINS  
Maj FA  
Adjutant

1 Incl:  
n/c  
lcc w/d

AG 004 - BA

2nd Ind

EHN/jyn

Hq I Corps, APO 301, 3 FEB 1947

TO: CG, Eighth Army, APO 343

1. The Moroe Plant (15-6) Aircraft, of Nippon Denki Yakin K.K. was originally organized in 1930 as a manufacturer of textiles. The name of the parent company at that time was the Nitto Boseki K.K. and the company remained in operation under that name until 1943.