

27  
701  
501

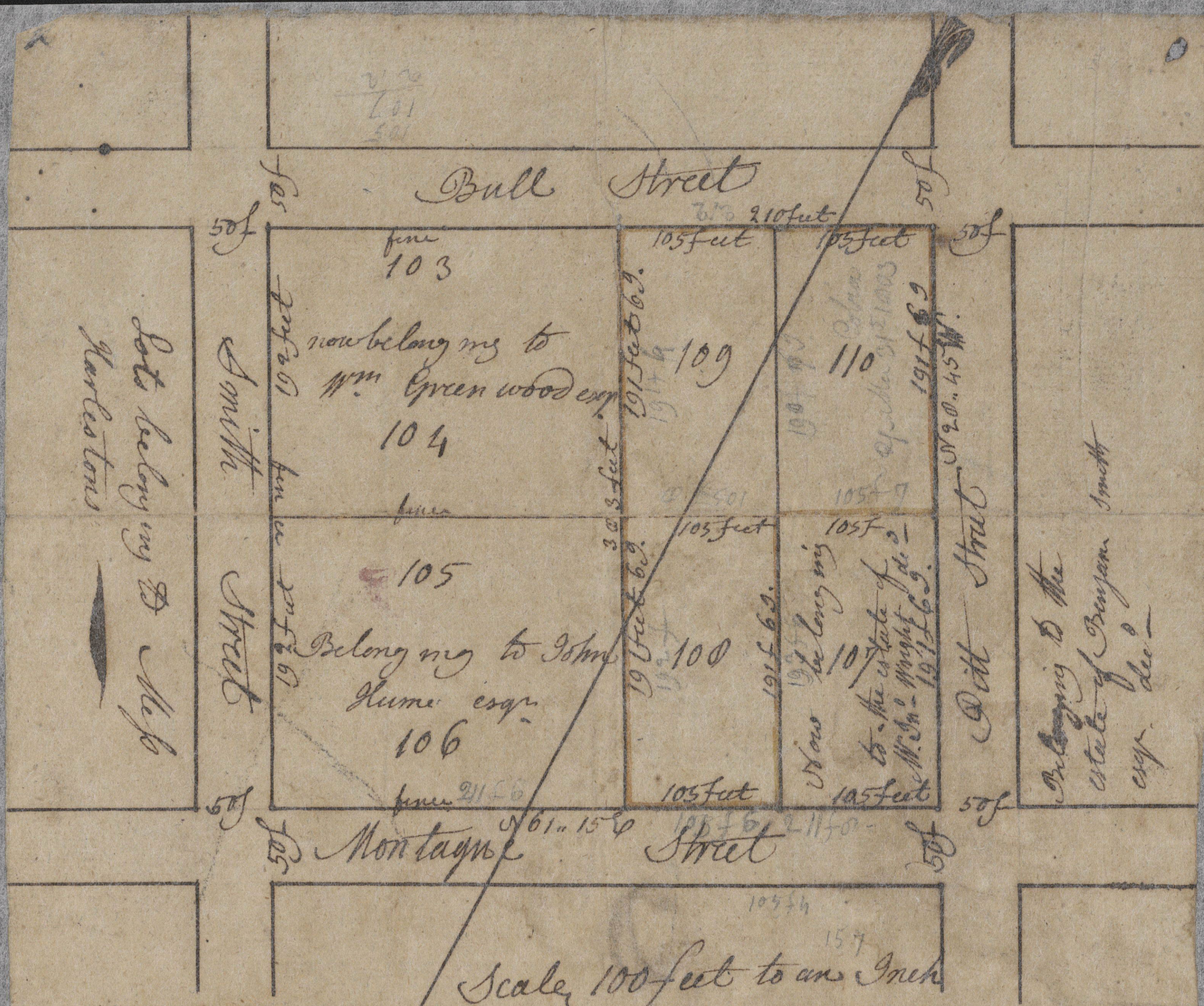

Scale 100 feet to an Inch

This Plan exhibits the shape and forms of three Lots of land <sup>situated</sup> in that part of <sup>the City of</sup> Charleston called Charleston known in the General plan of said part of said City by Numbers 100, 109 & 110, <sup>in Ward N<sup>o</sup> 13</sup> each lot containing <sup>the</sup> fourteenth of an acre and 2626 square feet. - Formerly belonging to Nicholas Charleston esq. & late to John Charleston esq. and now to Nicholas Charleston having such Bound and marks as expressed and represented by the above plat - from a Survey taken in August 1793 -

The Bound of which said three lots are coloured yellow -