

3 February 1947

C e r t i f i c a t e

To whom it may concern:

This is to certify that we have bought from Mr. S. Koyama of Koyama Kinzoku Kogyosho the following machines in November, 1936:

Hand winch ..... 5

*Y. Iida*

Yasuji Iida

Representative, Iida-gumi Head  
Office, 16, 1-chome, Ichinotsubo,  
Kuize, Amagasaki City.

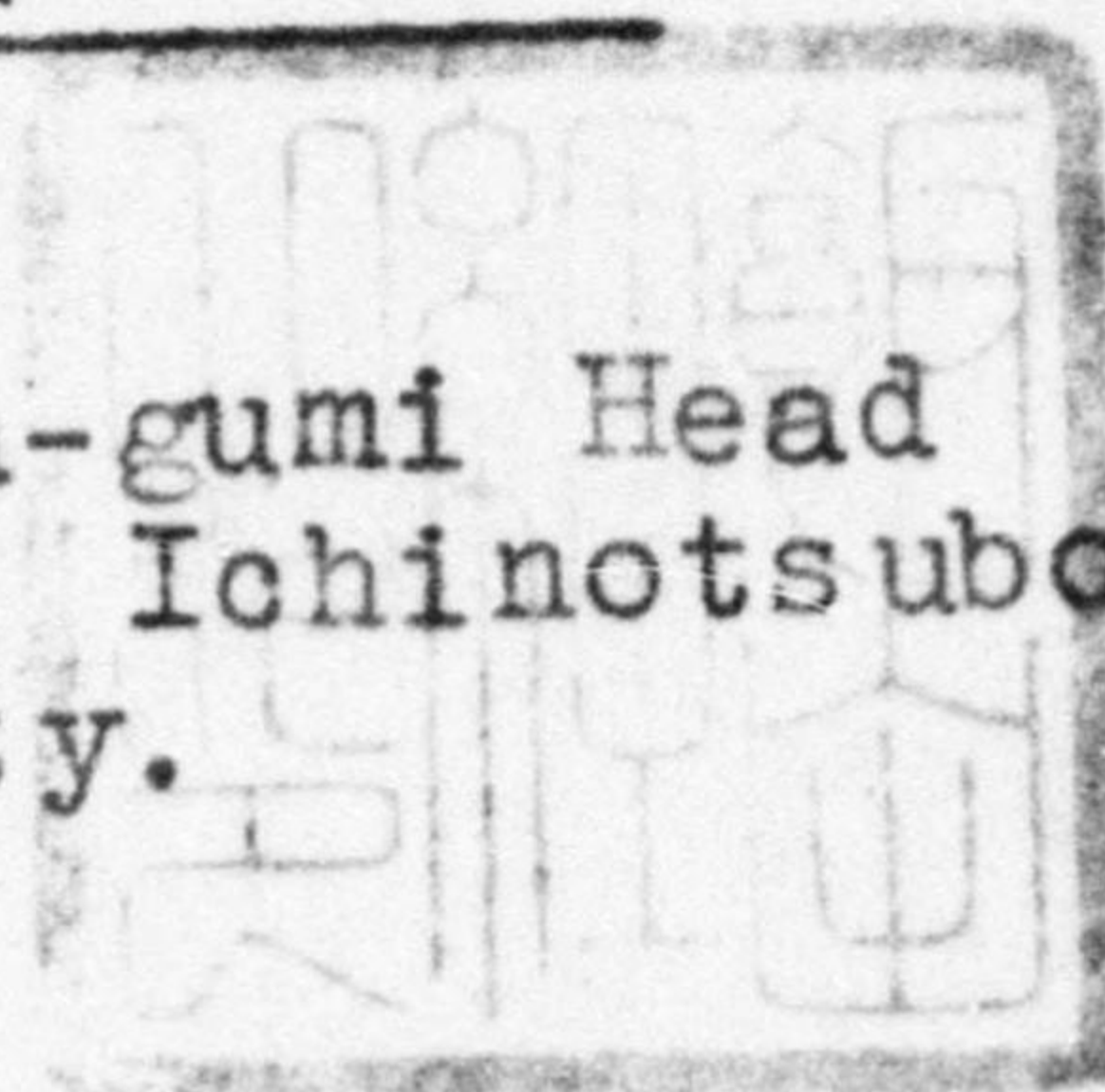



2 February 1947

C e r t i f i c a t e  
-----

To whom it may concern:

This is to certify that we have bought 2 "Sun" Super  
Gear Chain Blocks, 2 ton each, <sup>in May 1936</sup> from Koyama Kinzoku Kogyosho,  
which were later sold to Transportation Dept. of Kyoto City.

*C. Takahashi*

Chokichi Takahashi

Proprietor, Takahashi Shoten,  
27, Shimazu-cho, Nishiku, Osaka.



11 February 1947

C e r t i f i c a t e

To whom it may concern!

This is to certify that we have bought from the Koyama Shozo's Factory the following machines:

1936

Chain Block, 3 ton	.....	2
" " 2 ton	.....	2
Winch	.....	3

1937

Chain Block, 3 ton	.....	2
" " 2 ton	.....	3
Winch	.....	1

*M. Hamamoto*

Masakichi Hamamoto

Representative, Hamamoto-gumi  
149, 4-chome, Nishihon-machi  
Amagasaki-city. 



31 January 1947

C e r t i f i c a t e

To whom it may concern:

This is to certify that we have bought from Koyama  
Kinzoku Kogyosho (President: Shozo Koyama)

"Sun" Super Gear Chain Block, 1.5 ton .....2  
in April 1936.

*Yasaburo Okachi*  
Yasaburo Okachi

President, Asahi Denki K. Kaisha,  
Kinrakuji, Amagasaki City,  
Hyogo-ken.





13 February 1947

C e r t i f i c a t e  
-----

To whom it may concern:

This is to certify that we placed an order with Koyama Kinzoku Kogyosho to manufacture 35 Hand Winches with our plan in 1936.

In 1937 we ordered them to make 50 of the same machine.

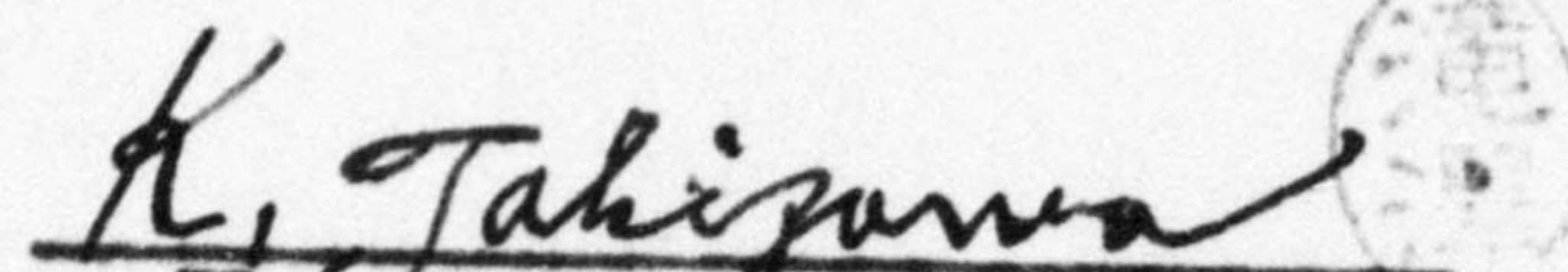
  
K. Takitsu

President, Tamajima Shipyard,  
Tamajima-cho, Okayama-ken.



5 February 1947

C e r t i f i c a t e

To whom it may concern!

This is to certify that we have bought the following machines from Koyama Kinzoku Kogyo-sho:

<u>1936</u>	"Sun" Super Gear Chain Block, 2 ton	... 5
	" " " " " 3 ton	... 5
<u>1937</u>	Chain Block, 2 ton	... 10
	" " 3 ton	... 10

from Dainichi Kinzoku Kogyo Kabushiki Kaisha:

<u>1938</u>	Tool Grinder	... 5
<u>1941</u>	" "	... 3
<u>1943</u>	Chain Block, 2 ton	... 15
	" " 3 ton	... 10

all for our own use.

S. Takizawa  
 Shichisaburo Takizawa  
 Representative

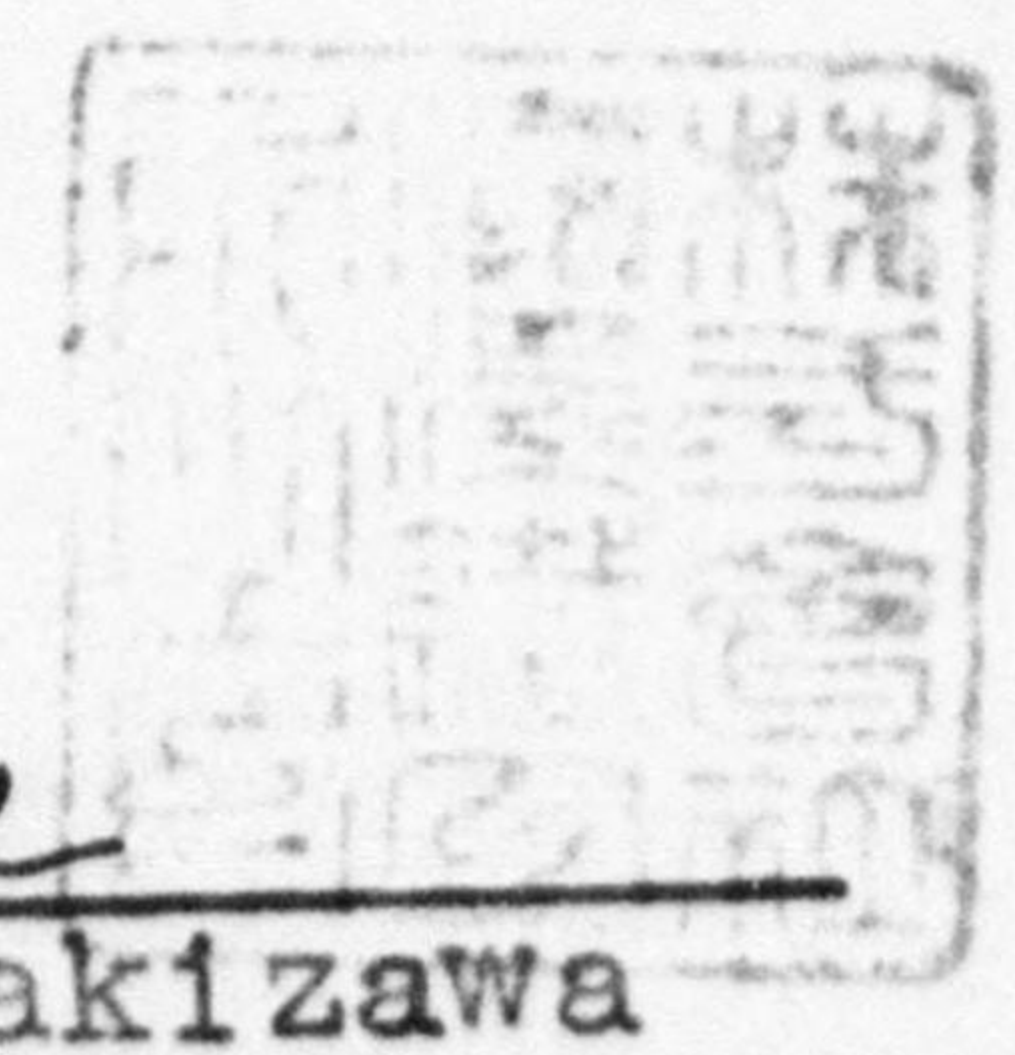

Takizawa Iron Works, 1-chome,  
Chodo, Fuse City, Osaka Pref.



10 February 1947

C e r t i f i c a t e

To whom it may concern:

This is to certify that we have bought the following machines from Dainichi Kinzoku Kogyo Kabushiki Kaisha for our own use:

1944

"Sun" super gear chain block, 2 ton .....	50
" " " " " 3 ton .....	50

1943

Tool Grinder	.....	3
--------------	-------	---

S. Ichinose  
Ichinose



Chief of Investigation Dept.  
Hatsudoki Seizo K. Kaisha,  
Ikeda City, Osaka Pref.







# 大日金屬工業株式會社

## 工場配置圖

總敷地坪數	總延坪數	總建坪數
一八六一坪	六八八坪	四九四坪

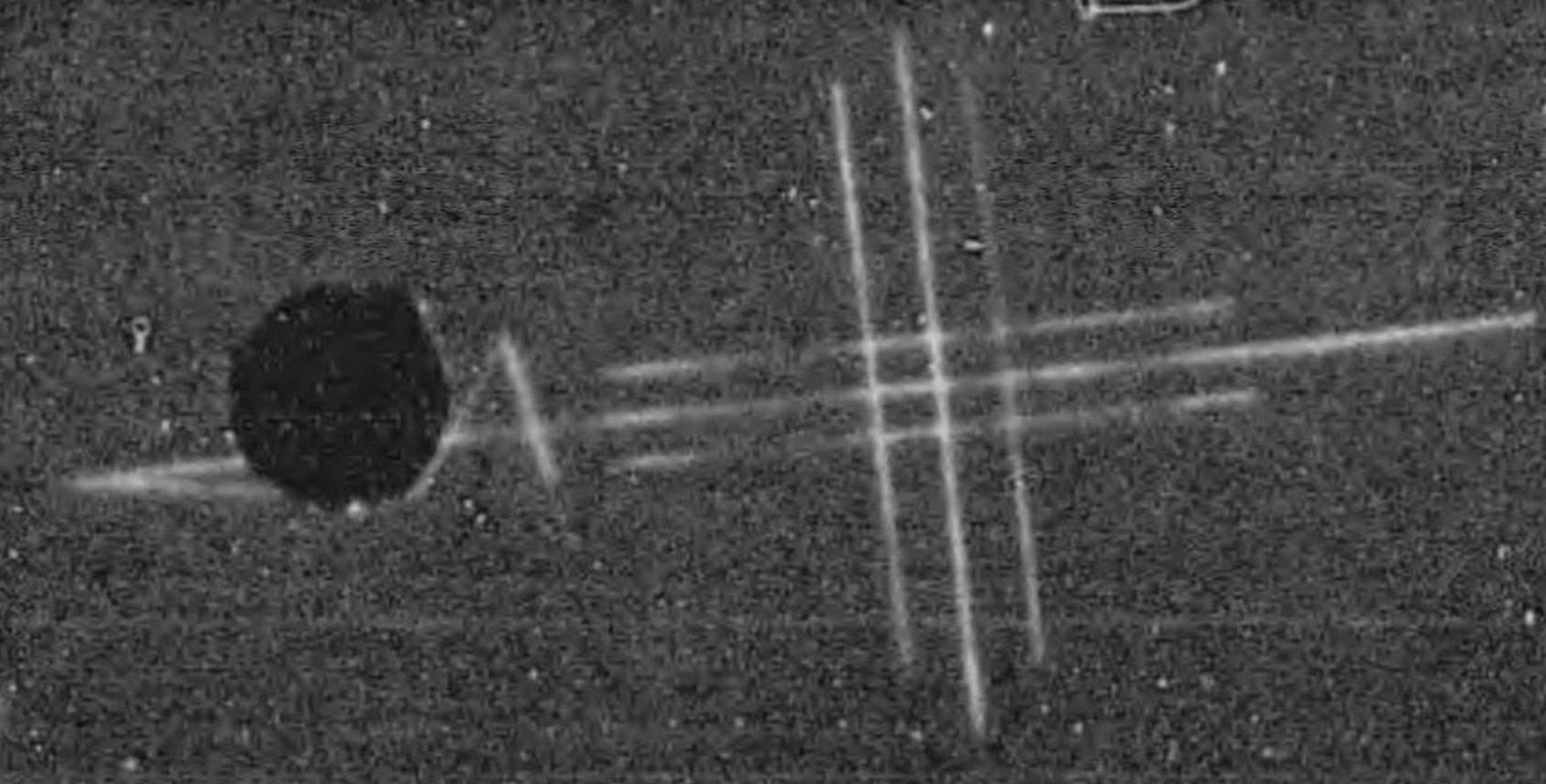
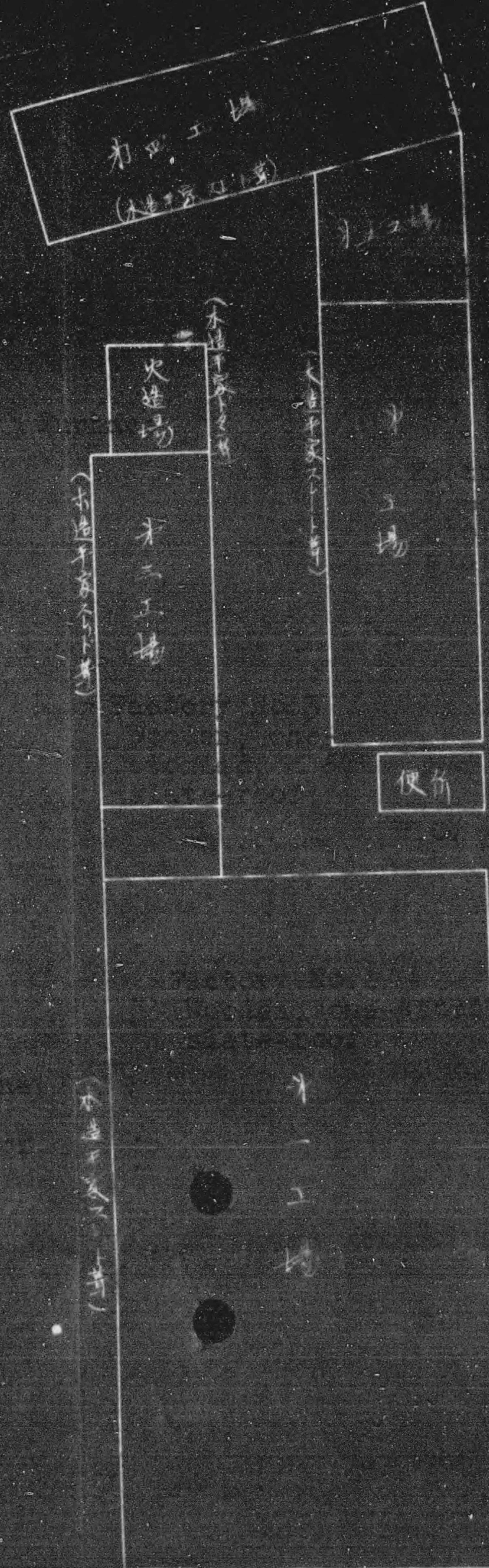



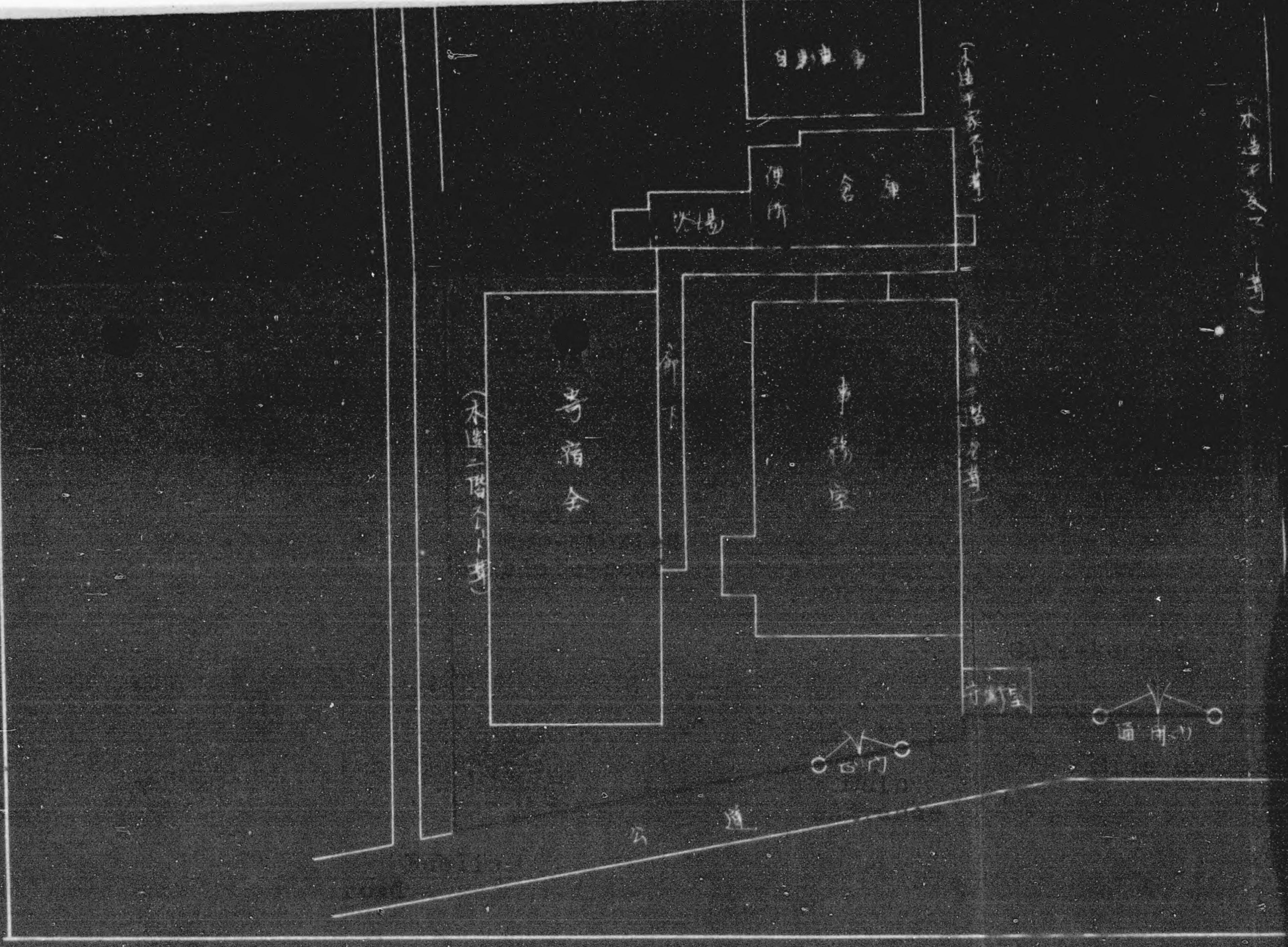



社

圖

九  
四  
坪

八  
八  
坪

六  
一  
坪

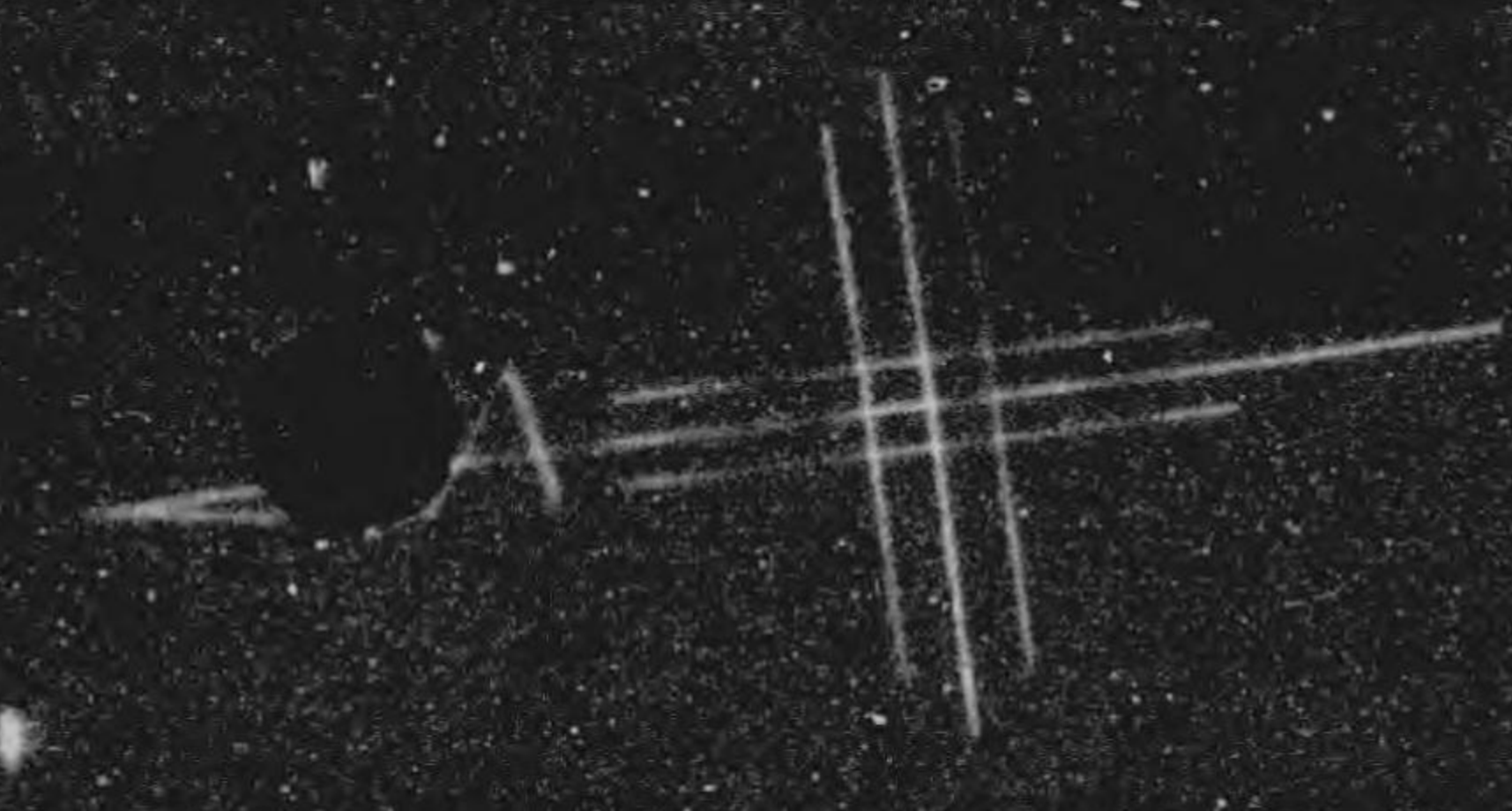

水

水





**“SUN”** 高速度三重式

スパーギヤ - 7.5:1



大 阪  
大日金属工業株式會社  
尼 崎



SUN

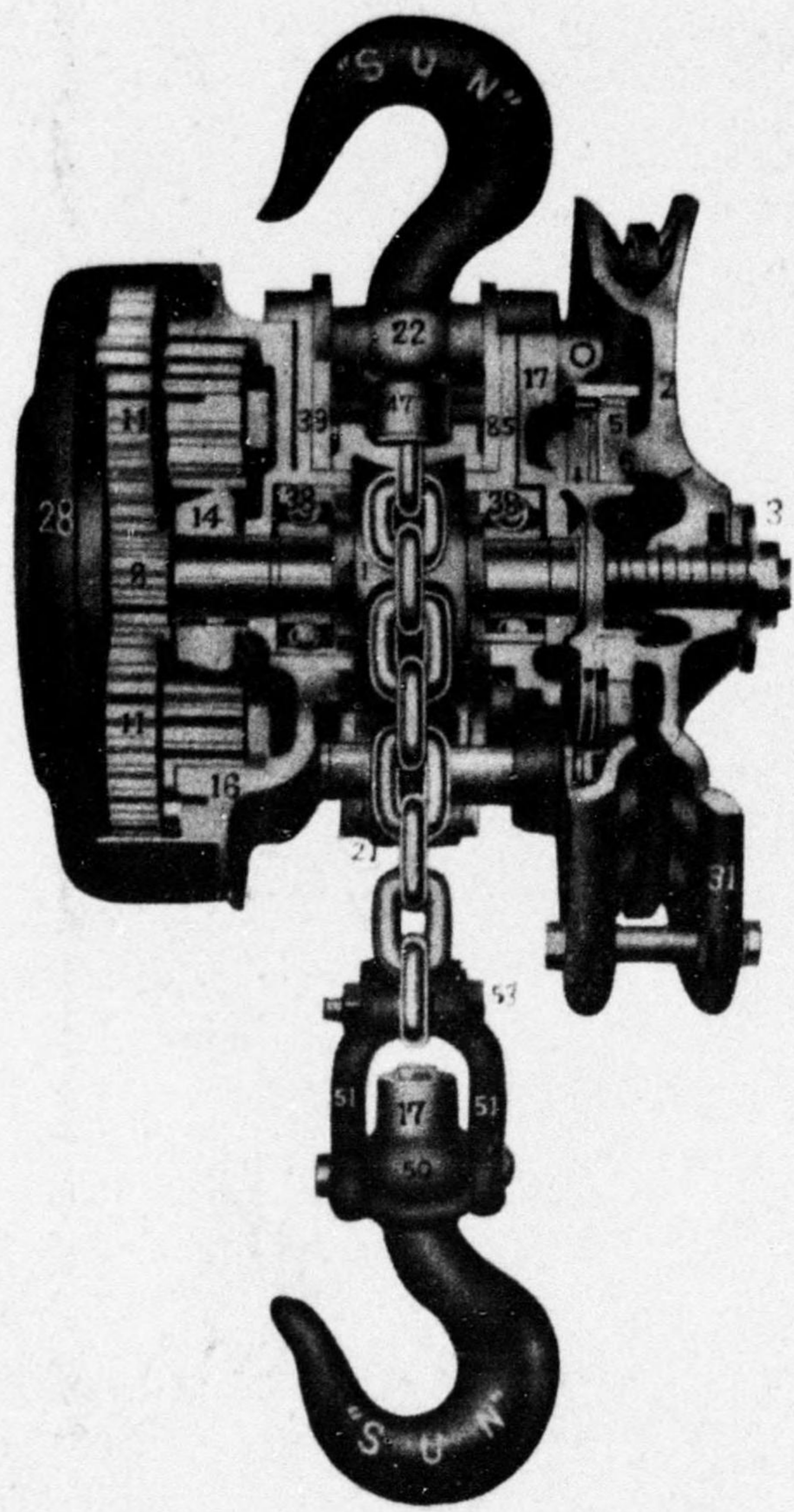

耐力 噸	試験 荷重 噸	電 略	揚程 M	ノック間 最短距離約 mm	重量 約 kg	箱 重量約 kg	箱 詰寸法 mm	手 捲力約 kg
		タチイ	2.4	335	31	40	365×315×325	25
1	1½	タチロ	2.4	400	45	55	424×385×370	40
1½	2¼	タチハ	2.4	470	62	75	470×430×415	55
2	3	タチニ	2.7	550	95	115	515×470×460	56
3	4½	タチホ	3	810	95	115	605×510×415	56
4	6	タチヘ	3	995	141	160	697×589×460	58
5	7½	タチト	3.7	1100	189	200	745×615×460	65
8	12	タチチ	3.7	1200	235	260	820×785×489	73
10	15	タチリ	3.7	1340	270	310	859×810×480	75

規 格

高速度三重歯車式スパーギヤーチェーンロック

一、"SUN" 印 チェンプロックハ弊社ニ於テ研究設計ナシ強靱ニシテ輕量ナルヲ以テ隨所ニ移動輕便且操作圓滑ニ意ヲ用ヒタル結果度々揚ゲ卸シニ使用スル場合ニ於テ人力時間ノ節約ヲナシ以テ能率ノ向上ニ製作致シテ居リマス。

二、型 式 "SUN" ハイスピードスパーギヤー型 (ボールベヤリング入)

力 量 1/2噸—50噸迄製作  
 試験荷重 力量ノ50%増  
 揚 程 御要求ノ通り  
 操作手鎖ノ長サ 全  
 捲揚ニ要スル力表標準以内

三、構 造

「インタナルギヤー」型ニシテ即チ四輪式齒車装置ハ手鎖ノ操作ニヨル手鎖車ノ四輪ハドライブングピニオンニヨリ二個ノ齒車ニ傳リ主体ノ「インタナルギヤー」ニ嚙合ツテ回轉セシメ楔ニヨリ安着セルピニオンケージ及ビ之ニ更ニ楔ニヨリ安着セルロードシーブヲ回轉セシメロードチエーンノ移動ニヨリ荷重ノ捲揚ヲナス。主軸ニハボールベヤリング(クローム鋼製)ヲ使用スハントチエーンノ操作停止ト全時ニ自動制動器ニ作用シ確實ニ荷重ヲ保持ス。

四、材 料 工 作

本機ハ各部ノ構成スル材料ハ精選セルモノヲ使用シ且、良ク其ノ目的ニ適合ノ金屬ヲ用ヒ工作ニ於テハゲージニヨリ入念ニ加工仕上ヲナシ組立ヲ行フモノトス。

五、主 鎖

チェンプロックノ生命タル主鎖ハ鎖用鋼材(ローカーボン)ヲ使用シ形狀寸法等均整ニシテ無疵且リングハ完全ニ「シーブポケット」ニ適合スル様製作シ尙特殊ノ熱處理ヲ施シテ磨滅防止ニ努メアリ、完成後常用ノ50% 荷重索引試験ヲ行ヒ點檢ナシ合格ノモノヲ使用ス。

六、部 分 品

本機ニ使用スル部分品ハ表ノ通り鍛鋼品硬鋼軟鋼等ヨク其ノ目的ニ適合ノモノヲ選擇シ鑄造品ニアリテハ總テ可鍛鑄鐵ヲ用ヒ(強靱ニ於テハ鋼材ニ比的スル様)且ゲージ式ニヨリ製作セルタメ互換性ニシテ何レノ機械ニモ取替容易デアリマス。

(常ニ多數在庫ニシテ有リマスカラ即時供給出來マス)



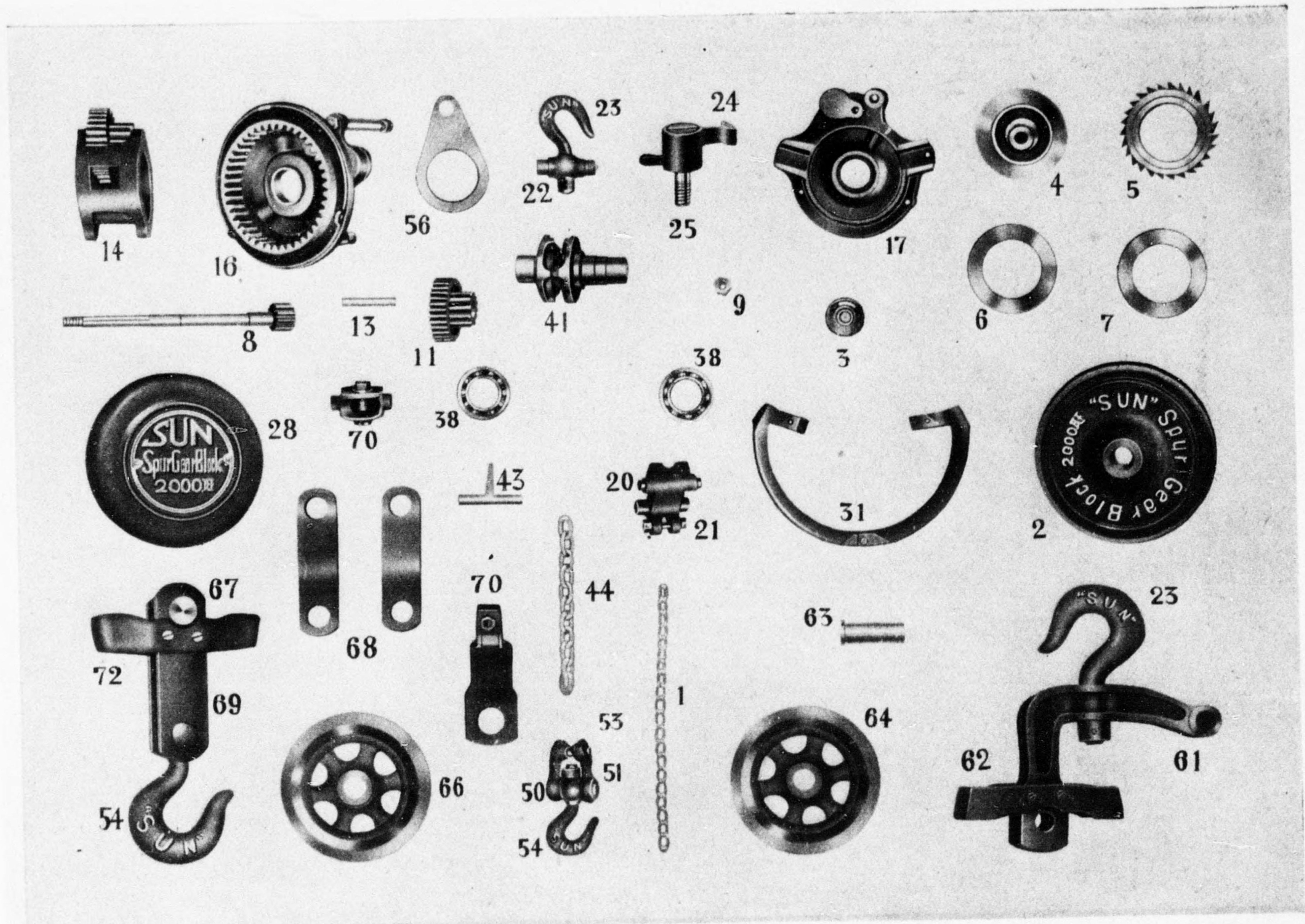

部 分 品 明 細		
番 号	材 質	名 稱
1.	特種軟鋼製	ハンドチェーン
2.	特種鑄鐵製	ハンドホ井ール
3.	可鍛鑄鐵製	チェックワッシャー
4.	可鍛鑄鐵製	ディスクハブ
5.	可鍛鑄鐵製	ラチェットディスク
6.	亞鉛引軟鋼板製	アイアンディスク
7.	革 製	レザーディスク
8.	硬 鋼 製	ドライビングピニオン
9.	軟 鋼 製	同上用 ナット
11.	可鍛鑄鐵製	ギヤエンドピニオン
13.	軟 鋼 製	同上用 ピン
14.	可鍛鑄鐵製	ピニオンケーシ-
16.	可鍛鑄鐵製	インターナルギヤ
17.	可鍛鑄鐵製	ラチェットケース
20.	可鍛鑄鐵製	ロードチェーンガイド
21.	軟 鋼 製	ロードチェーン用 ポ ー ル ド
22.	鍛 鋼 製	トップクロックスヘッド
23.	鍛 鋼 製	トップフック
24.	可鍛鑄鐵製	ホール
25.	軟 鋼 製	ホール用スタッド
28.	軟鋼板製 又ハ可鍛鑄鐵	ギヤカバー
31.	可鍛鑄鐵製	ハンドチェーンガイド
36.	軟鋼板製	サイドプレート
38.	鋼 鐵 製	ボールベヤリング
41.	可鍛鑄鐵製	ロードシーブ
43.	可鍛鑄鐵製	ストリッパー
44.	特殊軟鋼製	ロードチェーン
50.	鍛 鋼 製 又ハ可鍛鑄鐵	ポットムクロスヘッド
51.	鍛 鋼 製 又ハ可鍛鑄鐵	フック用リング
53.	軟 鋼 製	リング用ポールト
54.	軟 鋼 製	ポットムフック
61.	可鍛鑄鐵製	トップヨーク
62.	可鍛鑄鐵製	トップチェーンガイド
63.	軟 鋼 製	トップシーブ用ピン
64.	可鍛鑄鐵製 又ハ鑄鐵製	トップシーブ
66.	可鍛鑄鐵製 又ハ鑄鐵製	ポットムシーブ
67.	軟 鋼 製	ポットムシーブ用ピン
68.	軟鋼板製	バケツストラップ
69.	軟鋼板製	ポットム サイドプレート
70.	可鍛鑄鐵製	チェーンホルダー
72.	可鍛鑄鐵製	ポットム チェーンガイド
[38]	クローム鋼製	高級ボール ベヤリング



“SUN” 高速度三重式スパークヤ チェンブロック

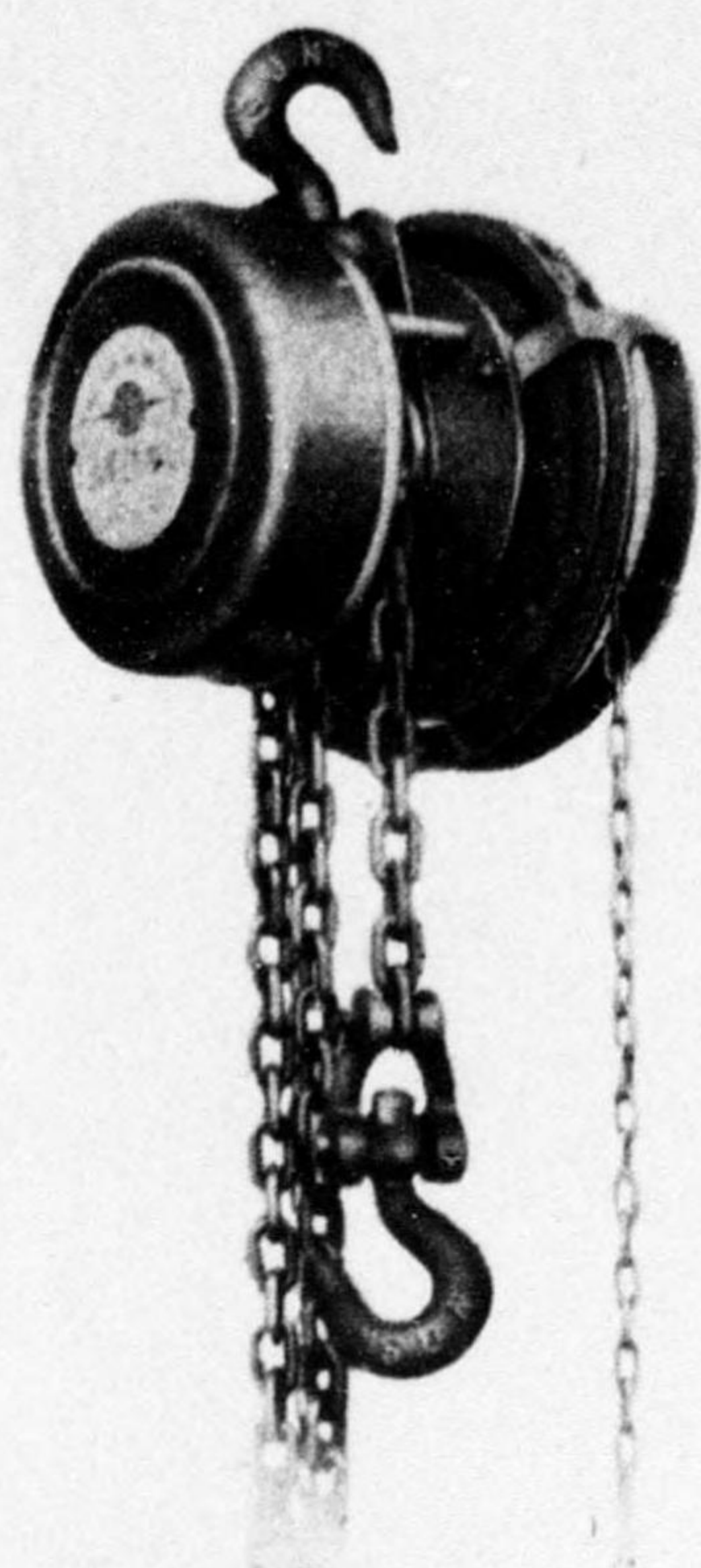

1/2, 1, 1 1/2, 2 吨型

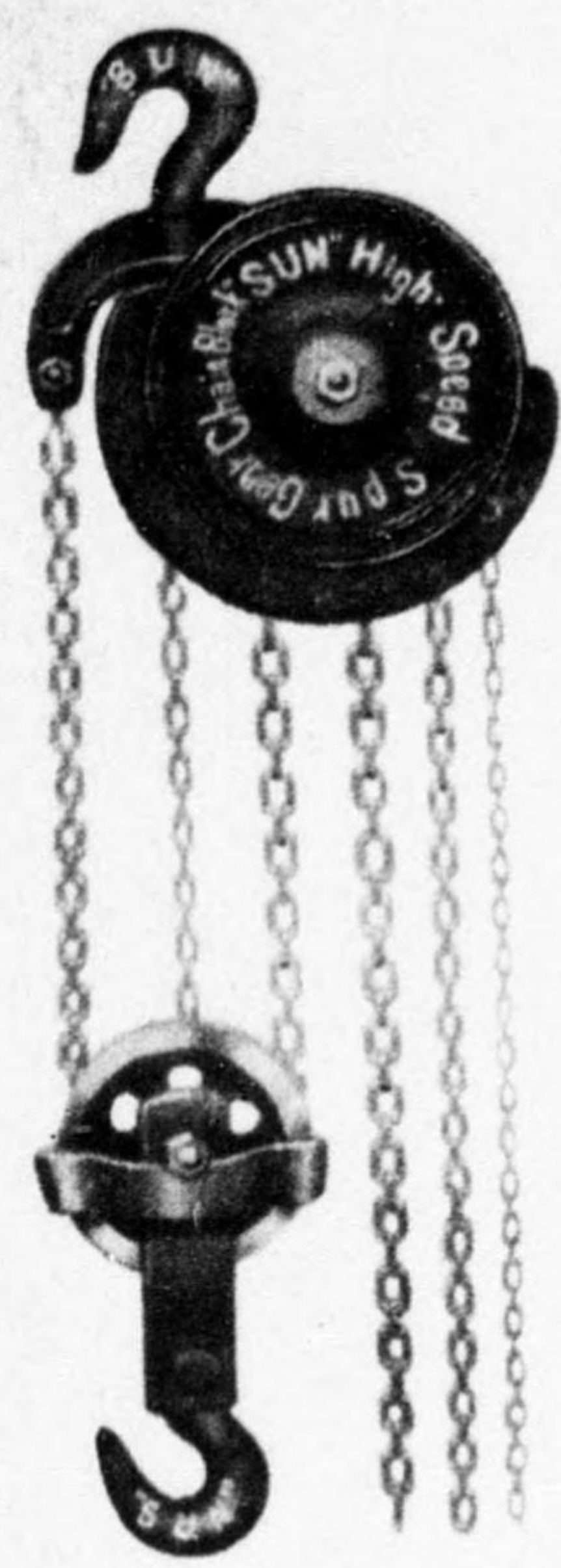

3, 4 吨型



5, 10 吨型



サイクロン型 5, 10 吨型



大日金属工業株式会社

◀ 製 作 品 目 ▶

高級チェンブロック各種 及 トロリー 一般機械器具

製 造 元

大日金属工業株式会社

本 社 大阪市西區薩摩堀南之町一番地

電話新町 ⑤三〇一八・五〇三六番

工場及營業所 尼崎市濱字丸田三九番地

電 話 福島六八〇九番  
尼崎二八七八番

販 賣 店





# 高速度強力金切鋸盤

## 電動單獨運轉型

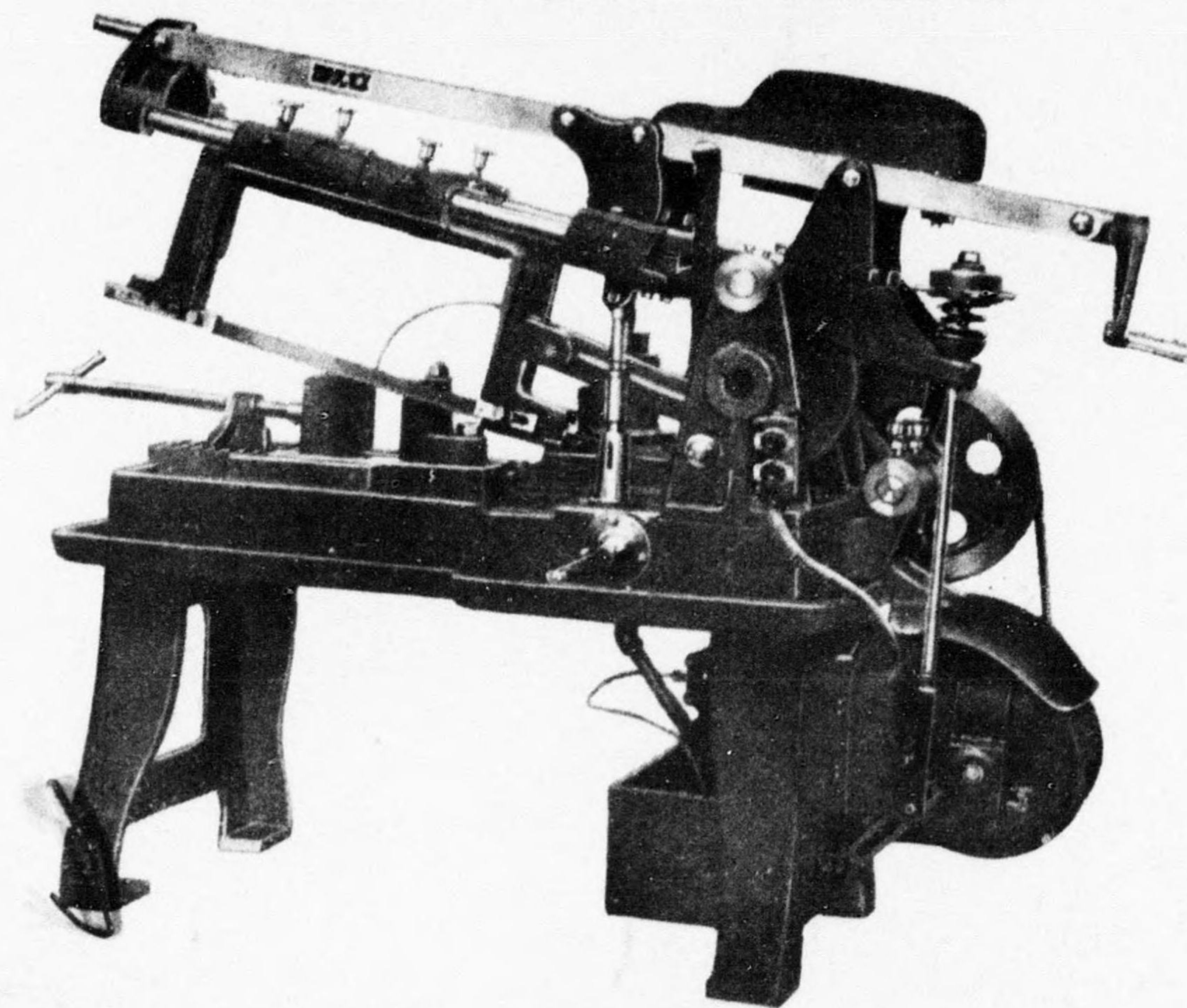

本機ハ弊社最新式ノ設計ニナリ、在來機ニ比シ四倍乃至五倍ノ切斷能力ヲ有スルモノニシテ内部ニ油壓ピストンヲ有スル鋸壓力加減裝置ヲ附シクランクニヨリ聯動スル油壓ポンプニヨリ油壓ヲピストン下面ニ送り鋸及其附帶裝置ノ荷重ニ抵抗セシム、ハンドルニヨリピストン下面ノ油壓ヲ任意ニ變化セシメ鋼、鐵、眞鍮、アルミニウム等其ノ材質ニ應ジ鋸刃ノ壓力ヲ調節スル事ヲ得、鋸裝置歸復運動ノ際ハ油壓全壓力ヲピストンニ作働シ鋸刃及其附帶裝置ニ仰角ヲ與ヘ鋸刃ヲ加工物ヨリ絶縁セシメ鋸刃ノ生命ヲ延長シ又切斷能率モ著シク大ナリ、鋸刃ノ磨減ニツレ重錘ニヨリ鋸壓力ヲ任意ニ増加スル事ヲ得、本機ハバイス及潤滑裝置ヲ有シ特ニ電動直結ニ有リテハ最新式ノ「自動ストツプ」マグネツトスイッチヲ裝置シ材料切斷終ルト同時ニ自動停止ス。本機ハベルト運轉型、電動機直結型、電動機直結移動型アリ、電動機直結型ハ工場離レタル材料庫等ニ設備シテ材料ノ整理及旋盤切斷作業ヲ助ケ工場能率増進トニ最適良機ナリ。

### 主 要 寸 法

鋸刃ノ最長	切斷能力	回轉數	所要電力	据付面積
16吋	8吋×8吋	70—100 R/M	1 H.P	1.030 <sup>m</sup> × 550 <sup>m</sup>
18吋	10吋×10吋	70—100 R/M	1 H.P	1.030 <sup>m</sup> × 550 <sup>m</sup>

附屬品 電動機、電磁開閉器、スパナ

## 大日金屬工業株式會社

本社 大阪市西區薩摩堀南之町一番地  
工場 尼崎市濱字丸田三番地

電話新町 ⑤ 3018  
5036  
電話福島 ⑤ 6809  
尼崎 2878





大日金屬工業株式會社

# バイト研磨盤

電動單獨運轉型

給水ポンプ装置付



本機ハ構造堅牢工作精巧ニシテ一般工具類バイト其他研磨用トシテ使用セラレ、自動水掛装置ハ循環ポンプガ働き給水ヲナシ以テ切削用具ノ研磨ヲナスニ最適タリ。皿型テーブルハ汚水ノ飛散スル事ナク、砥石並ニ電導装置ハ堅牢ナル危害豫防ヲ附ス。

## 主 要 寸 法

砥石直徑	砥石巾	馬力	電流	電壓	無負荷回轉數	重量
14吋	2吋	1	三相交流	200V~220V	60~1,200R/M	350 KG
20吋	2½吋	3	三相交流	200V~220V	60~1,200R/M	400 KG

附屬品 電動機、金剛砂砥石、電磁開閉器、危害豫防装置

# 大日金屬工業株式會社

本社 大阪市西區薩摩堀南之町一番地  
工場 尼崎市濱字丸田三番地

電話新町⑤ { 3018  
5036  
電話福島⑤ 6809  
電話尼崎 2878



# 47

HYOGO MILITARY GOVERNMENT TEAM  
APO 317

FILE

ABH/d1

P-15

21 March 1947

SUBJECT: Application for Partial Exemption of Dai  
Nichi Kinzoku Kogyo K.K., from SCAPIN-1134.

TO : Commanding Officer  
Kinki Military Government Region  
APO 301

1. Reference is made to the following:

a. Memorandum to the Imperial Japanese Government, Subject: "Reparations Selections Within the Privately Owned Munitions Industry," dated 13 August 1946, ESS/IN (SCAPIN-1134).

b. Letter, this headquarters, dated 21 October 1946, Subject: "Application for Removal of Dai Nichi Kinzoku Kogyo K.K., Amagasaki, Hyogo-ken from Reparations List," enclosures thereto, and subsequent indorsements.

c. Letter, Hq, I Corps, dated 13 January 1947, Subject: "Deletion of Plants Subject to Reparations."

2. Subject application is forwarded herewith in compliance with reference (c) above.

3. Original application of subject plant was denied by SCAP in 3rd indorsement to reference (b) above, on grounds that plant was organized in 1937 and that there was more than 100% expansion in the plant since the beginning of the recent war. In the present application the company endeavors to refute SCAP's arguments by means of explanations, signed documents from customers and trade associations, etc., which tend to indicate that the plant was not originally designed for munitions production, never engaged 100% in munitions production, did not increase over 100% in size, and is now 100% reconverted and essential to the communications industry.



DECLASSIFIED E.O. 11652 SECTION 5 (c), (d)

BASIC: Ltr, Hq, Hyogo Mil Govt Team, APO 317, Subj:  
"Application for Partial Exemption of Dai  
Nichi Kinzoku Kogyo K.K., from SCAPIN-1134,"  
dtd 21 Mar 47 - cont'd

4. The opinion and recommendation of this headquarters on subject company were fully outlined in cover letter to previous application, reference (b) above.

FOR THE COMMANDING OFFICER:

LOUIS C. HUTTON  
Major, Cav  
Executive Officer

1 Incl:  
Appl. for Partial Exemption of Dai Nichi Kinzoku Kogyo K.K., complete with recommendations, supporting documents, catalogs, and data sheets.  
(3 copies)



1 March 1947

TO: Hyogo Military Government Team,  
Attn: Commerce & Industry Section.

Petition for partial exemption of designated  
factory from reparations list

The petition for partial exemption of Dainichi Kinzoku Kogyo Kabushiki Kaisha from reparations list dated 16 Oct. 1946, submitted by the Dept. of Communications Tokyo, has been denied by a letter dated 29 Dec. 1946. However, in order to entreat your reinvestigation into the matter the Dept. of Communications and we have prepared 2nd petitions respectively as follows. We earnestly hope that these petitions be further studied carefully by you in favor of our company, in order that a part of our machineries mentioned therein may be removed from reparations list.

A) Object of establishment of our factory.

A factory under the name of Koyama Kinzoku Kogyosho equipped with machine tools and others necessary for manufacture of such civilian commodities as chain blocks, pumps, and miscellaneous machines, under the private management of Shozo Koyama, was established in 1935, where the actual manufacture of such commodities was started in 1936.

In 1937 the reorganization of our works was decided upon and in May 1938 it was legally incorporated with a capital of Y 450,000 under the changed name of Dainichi Kinzoku Kogyo Kabushiki Kaisha. Thereafter all reports and application etc. made by our company have been the above date of incorporation as that of establishment, hence the Inventory Report dated 1 Sept. 1946 and relative papers.

B) In order to demonstrate the fact mentioned under A) we attached the following papers, to which you will please refer:

- 1) Certificate issued by Amagasaki Factory Association (composed of all factories in Amagasaki)
- 2) A part of certificates issued by buyers to whom our products were delivered in 1936-7.
- 3) A part of certificates issued by buyers who bought our products manufactured during the war.
- 4) Some of catalogues of such civilian products and a factory plan.



- 2 -

C) Pre-war, wartime, and post-war activities

The main factory and others were so constructed as to be fit for the manufacture of peace-time machineries (for example: combined device of manufacturing and finishing, installation of a crane, etc.)

In autumn 1938 when our manufacturing was <sup>1</sup> picking up, we got the first order from the Japanese Army to work upon shell-cases. We were forced then to use a part of our lathes for the said purpose. All the other machines than lathes, however, were used for the manufacture of peace-time commodities as ever, and neither the increase of capital nor the expansion of factory was made.

Among a total of 93 machines, only 24 lathes were bought and 21 lathes were borrowed from Japanese Army during the war respectively.

Under the circumstances, we would appreciate it very much, if the machines, out of a total of 93 we now hold, mentioned separately, which were bought before the war and which were used exclusively for the manufacture of peace-time products even during the war, would be removed from the reparations list. We hereby sincerely solicit your reconsideration given in our favor.

Yours very truly,

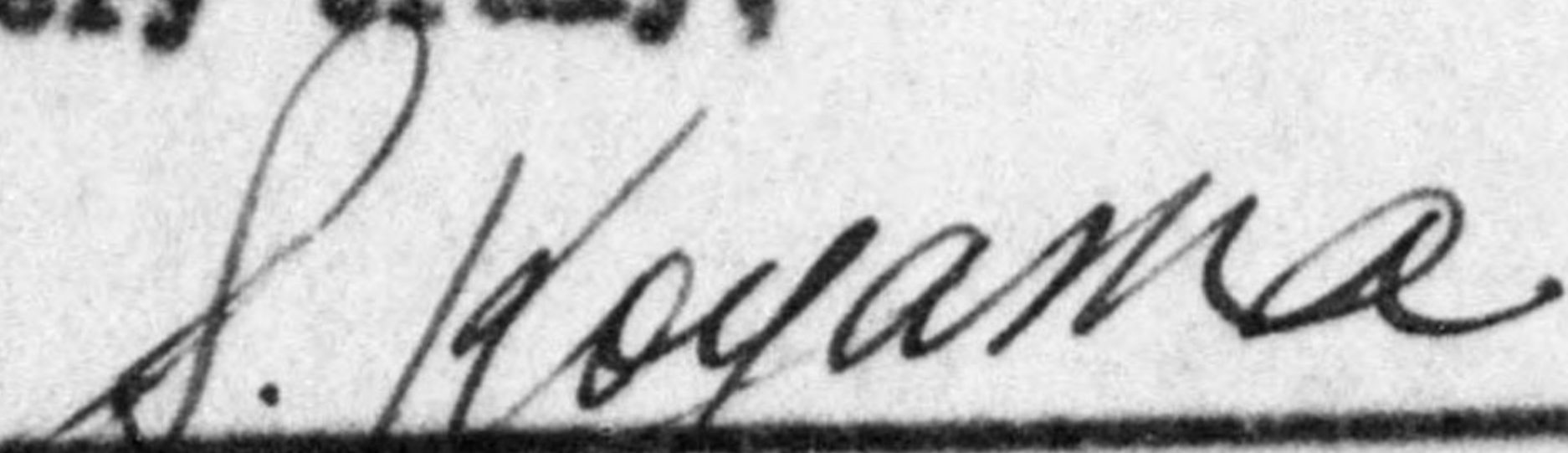

Shozo Koyama

President, Dainichi Kinzoku  
Kogyo Kabushiki Kaisha,  
3, Maruta, Hama, Amagasaki.



20 February 1947

**Subject:** 2nd Petition for Removal of Dainichi Kinzoku Kogyo Kabushiki Kaisha from Reparations List.

**To :** Hyogo Military Government Team,  
Kobe. Attn: Comm & Ind. Section.

**From :** Ichiro Hayashi, Chief of Materials Bureau,  
Dept. of Communications, Tokyo.

1. Upon learning that Dainichi Kinzoku Kogyo Kabushiki Kaisha, Amagasaki, had been designated as reparation factory on 13 August 1946, we, the Dept. of Communications Tokyo, collaborating with governmental and private agencies concerned, submitted to you a petition dated 16 October 1946 for removal of subject plant from reparations list. But the said petition has been denied by a letter dated 29 December 1946, to our great disappointment.

2. Herebelow is a correction of some defects contained in our reports already submitted which are apparently considered to have caused you to misunderstand our situation. We are very sorry to trouble you often, but please investigate into the matter closely again and be good enough to transmit the matter to your higher headquarters in favor of our factory.

a) Defects contained in our reports

We are exceedingly sorry for some defects contained in our Inventory Reports dated 1 September 1946 and related papers. This is attributed to the fact that on official papers Dainichi Kinzoku Kogyo K. Kaisha always used to mention the date on which they were incorporated. Mr. Koyama originally founded in 1935 "Koyama Kinzoku Kogyosho" under his private management for the purpose of manufacturing such civilian commodities as chain blocks, pumps, miscellaneous machinery, etc. And the said "Kogyosho" was legally incorporated in 1938 with a capital of Y 450,000.00 when the name was changed to Dainichi Kinzoku Kogyo Kabushiki Kaisha.

b) Attached hereto are some papers which will demonstrate the above fact.

c) Regarding manufacture

As we have already repeatedly stated, Dainichi Kinzoku Kogyo K. Kaisha was first ordered by the Japanese army in 1938 to manufacture shell-cases. Such cases, however, were not finished at Dainichi Kinzoku. Dainichi Kinzoku undertook only such simple interim operations using lathes as cutting and pressing cylindrical materials from army which occupy 50% of entire process.



As only lathes were used for the above operations, we used all the machine tools other than lathes, for the manufacture of civilian commodities as before even during the war.

d) Regarding factory

No extension whatever of factory was made during the war. Only lathes necessary for shell-cases manufacturing and a pressing machine were bought. Other lathes were borrowed from Japanese Army for financial reasons.

e) Regarding organization of company

The company was incorporated with a capital of Y450,000 which had remained unchanged until the war ended. S. Koyama and several others were major shareholders among a total of 20 odd shareholders. The factory had no connection whatever with Zaibatsu.

3. Dainichi Kinzoku Kogyo Kabushiki Kaisha is most indispensable to the Dept. of Communications Tokyo for the rehabilitation of telephone and telegraphic services in futures. An order covering a considerable quantity of special equipment has already been placed with the said company, and it is planned that the company would be utilized exclusively by the Dept. of Communications after 1947. In order to fulfil such an important mission, we hereby beg to apply again for permission to use following mentioned machine tools and a part of lathes which were never used for the manufacture of munitions during the war. Please give the matter your second thought so that such items would be removed from the list of reparations.

---

Ichiro Hayashi

Chief, Materials Bureau  
Dept. of Communications  
Tokyo.



Reasons for application for partial removal of  
machinery from Reparations List

The following 32 machines (bought in 1935) out of a total of 93, which have been used for production of civilian commodities since pre-war time, are needed for 100% production of communication equipment from 1947 as a designated factory of Dept. of Communications. Your special consideration given to the above circumstances will therefore be highly appreciated:

<u>Machinery</u>	<u>Type</u>	<u>Number</u>	<u>Remarks</u>
Power lathe	8 feet	5	Bought in 1935. 1935-38 for production of peace-time commodities.
"	6 feet	10	Bought in 1935. 1936-45 for production of peace-time commodities.
Horizontal boring machine	2.6 inches	1	"
Planing machine	8 feet	1	"
Upright drilling machine	20 inches	2	"
	Bench type	2	"
Shaping machine	18 inches	2	"
Gear Hobbing m/c	24 inches	1	"
Slotting machine	6 inches	1	"
Radial Drill'g m/c	36 "	1	"
Universal grinding machine	42 inches	1	"
Tool grinding m/c	20 inches	1	"
" " "	6 inches	1	"
Power hack saw	6 sq. inches	1	"
Milling machine	No.2	1	"
" " "	No.0	1	"
Friction Press	100 tons	1	



26 January 1947

C e r t i f i c a t e

To whom it may concern:

This is to certify that Shozo Koyama of Koyama Kinzoku Kogyosho founded a plant at 3 Maruta Hama, Amagasaki City, with necessary machines in 1935 for the purpose of manufacturing such civilian machines as chain blocks etc. He has then become a member of Amagasaki Industrial Society in January 1936. In June 1938 we were notified of the incorporation of the said plant. He is a member of our Society even now.

Tokujiro Fukui,

Chief Secretary, Amagasaki Industrial  
Society c/o Chamber of Comm & Ind.,  
Amagasaki City, Hyogo-ken.



3 February 1947

C e r t i f i c a t e

This is to certify that we have bought from Koyama Kinzoku Kogyosho 3 "Sun" super Gear Chain Block, 2 ton and 5 "Sun" Super Gear Chain Block, 3 ton in 1936. Also we have ordered them to manufacture 50 3" pumps (materials etc. supplied by us) as parts of rubber machines manufactured by us.

Also this is to certify that we have bought from them the following machines:

- 1937 - Chain Block, 3 ton ..... 3  
 Ordered manufacture of 60 pumps (materials etc. supplied by us)
- 1942 - Power Hack Saw Machine ..... 2  
 (from Dainichi Kinzoku Kogyo Kabushiki Kaisha)
- 1943 - Tool Grinding Machine ..... 2  
 (ditto)

Tadashi Nakada

President, Nakada Zoki K. Kaisha,  
7, 3-chome, Wakinohana, Fukiaku,  
Kobe City.



31 January 1947

**C e r t i f i c a t e**  
-----

**To whom it may concern:**

This is to certify that during 1936 - 1945 we had been acting as sale agent of Koyama Kinsoku Kogyo Kabushiki Kaisha buying from them at retail prices such civilian machines as Chain Block, Winch, Grinder, Hack Saw Machine, Universal Machine, etc., which had further been sold to Transportation Agencies, Warehouses, and various Factories.

We have been acting also as sale agent thereof after 1938 in which the said organization was reorganized as Joint-Stock Company.

Ryu Kawamura,

Vice-manager, Osaka Branch of  
Rokuroku Shokai Co., Ltd.,  
6-chome, Horikita-dori, Tachiuri,  
Nishi-ku, Osaka City.



3 February 1947

**C e r t i f i c a t e**  
-----

To whom it may concern:

This is to certify that we have bought from Mr. S. Koyama of Koyama Kinzoku Kogyosho the following machines in November, 1936:

Hand Winch ..... 5

\_\_\_\_\_  
Yasuji Iida

Representative, Iida-gumi Head Office, 16, 1-chome, Ichinotsubo, Kuise, Amagasaki City.



2 February 1947

C e r t i f i c a t e

To whom it may concern:

This is to certify that we have bought 2 "Sun" Super Gear Chain Blocks, 2 ton each, in May 1936, from Koyama Kinzoku Kogyosho, which were later sold to Transportation Dept. of Kyoto City.

Chokichi Takahashi

Proprietor, Takahashi Shoten,  
27, Shimazu-cho, Nishiku, Osaka.



11 February 1947

C e r t i f i c a t e

To whom it may concern:

This is to certify that we have bought from the Koyama Kogyosho's Factory the following machines:

1936

Chain Block, 3 ton	.....	2
" " 2 ton	.....	2
Winch	.....	3

1937

Chain Block, 3 ton	.....	2
" " 2 ton	.....	3
Winch	.....	1

Masakichi Hamamoto

Representative, Hamamoto-Gumi  
149, 4-chome, Nishihonmachi,  
Amagasaki City.



31 January 1947

C e r t i f i c a t e

To whom it may concern:

This is to certify that we have bought from Koyama  
Kinzoku Kogyosho (President: Shozo Koyama).

"Sun" Super Gear Chain Block, 1.5 ton .....2  
in April 1936.

Yasaburo Okachi

President, Asahi Denki K.Kaisha,  
Kinrakuji, Amagasaki City,  
Hyogo-ken.



13 February 1947

C e r t i f i c a t e

To whom it may concern:

This is to certify that we placed an order with Koyama Kinzoku Kogyosho to manufacture 35 Hand Winches with our plan in 1936.

In 1937 we ordered them to make 50 of the same machine.

K. Takitsu

President, Tamajima Shipyard,  
Tamajima-cho, Okayama-ken.



5 February 1947

C e r t i f i c a t e

To whom it may concern:

This is to certify that we have bought the following machines from Koyama Kinzoku Kogyo-sho:

1936 "Sun" Super Gear Chain Block, 2 ton ..... 5  
           "          "          "          "          "          3 ton ..... 5

1937 Chain Block, 2 ton .....10  
           "          "          3 ton .....10

from Dainichi Kinzoku Kogyo Kabushiki Kaisha:

1938 Tool Grinder ..... 5

1941 " " ..... 3

1943 Chain Block, 2 ton .....15

          "          "          3 ton .....10

all for our own use.

Shichisaburo Takizawa  
 Representative

Takizawa Iron Works, 1-chome,  
 Chodo, Fuse City, Osaka Pref.



10 February 1947

C e r t i f i c a t e

To whom it may concern:

This is to certify that we have bought the following machines from Dainichi Kinzoku Kogyo Kabushiki Kaisha for our own use:

1944

"Sun" Super Gear Chain Block, 2 ton .... 50  
" " " " " 3 ton .... 50

1943

Tool Grinder .... 3

Ichinose

Chief of Investigation Dept.,  
Hatsudoki Seizo K. Kaisha,  
Ikeda City, Osaka Pref.







# 大日金屬工業株式會社

## 工場配置圖

總敷地坪數	總延坪數	總建坪數
一八六一坪	六八八坪	四九四坪

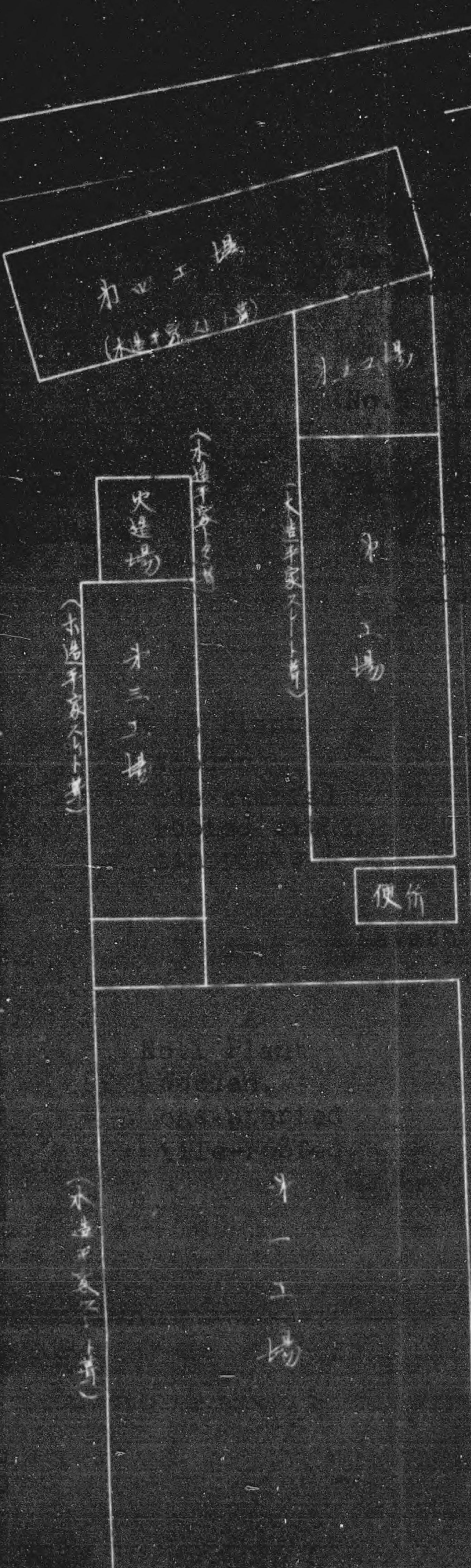



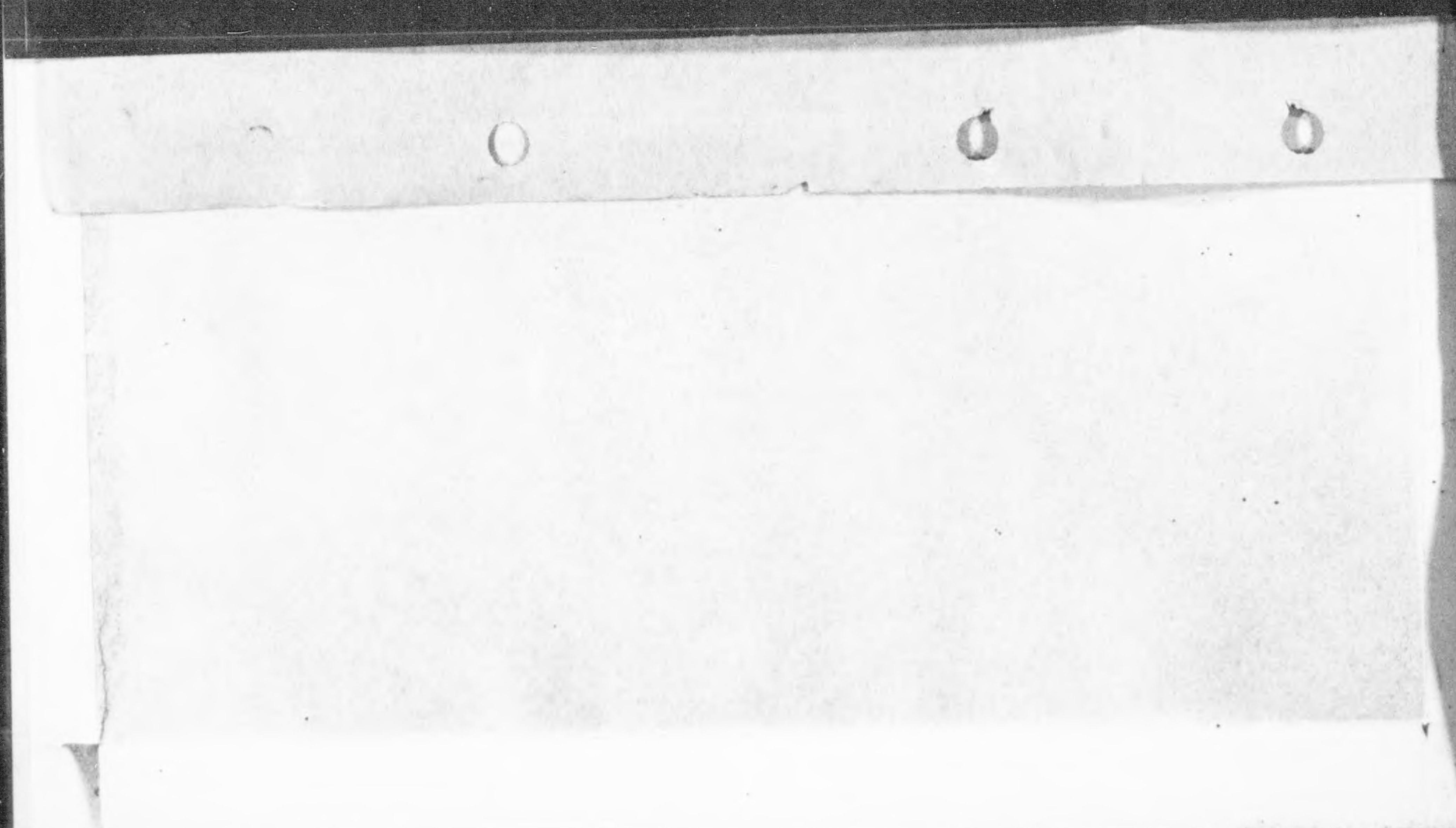
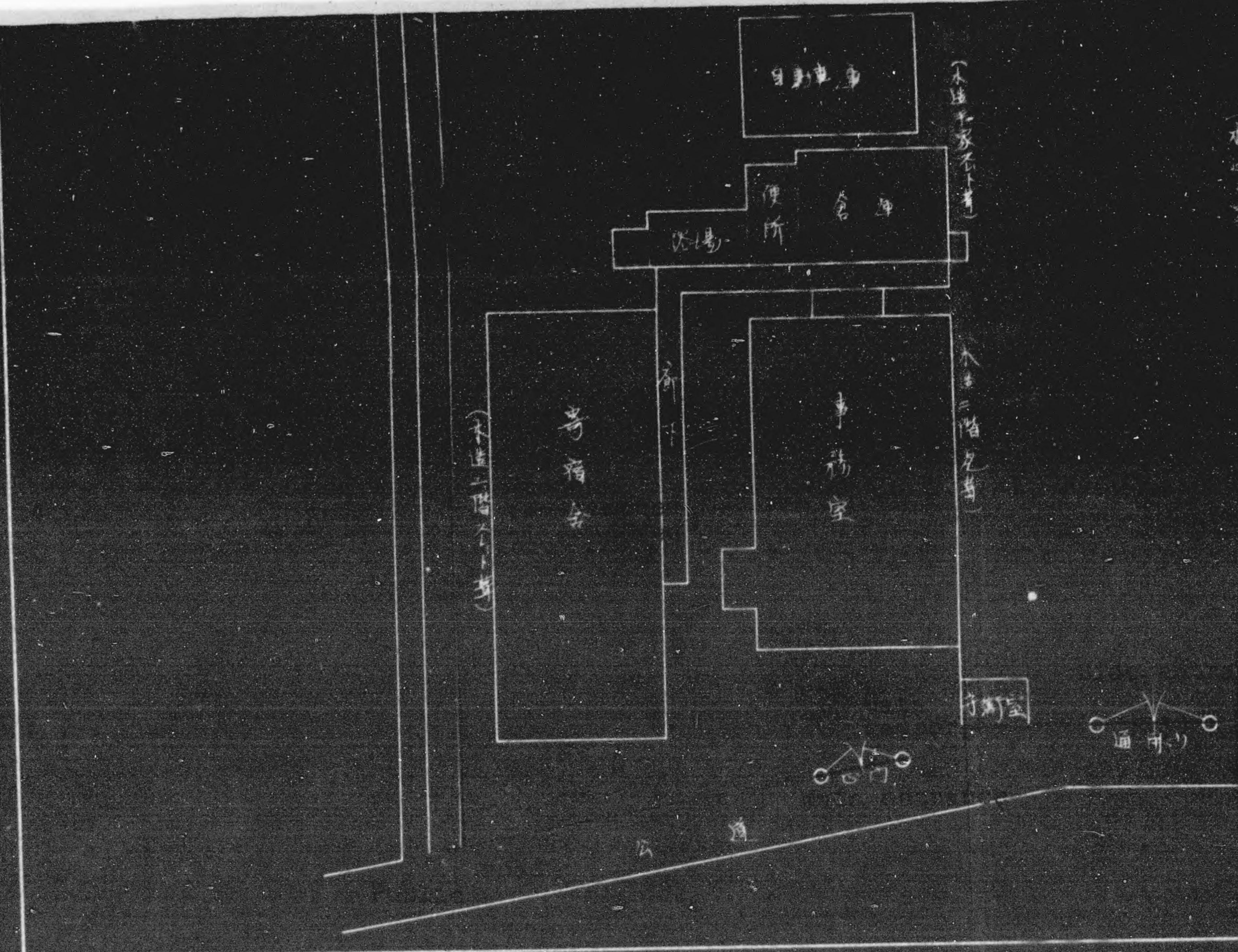



社  
圖

西九四坪  
六八八坪  
六一一坪



十一五坪

水邊(一坪)





“SUN”

高速度三重式

スパーギヤ

7.50



大 阪  
大日金属工業株式會社  
尼 崎



SUN

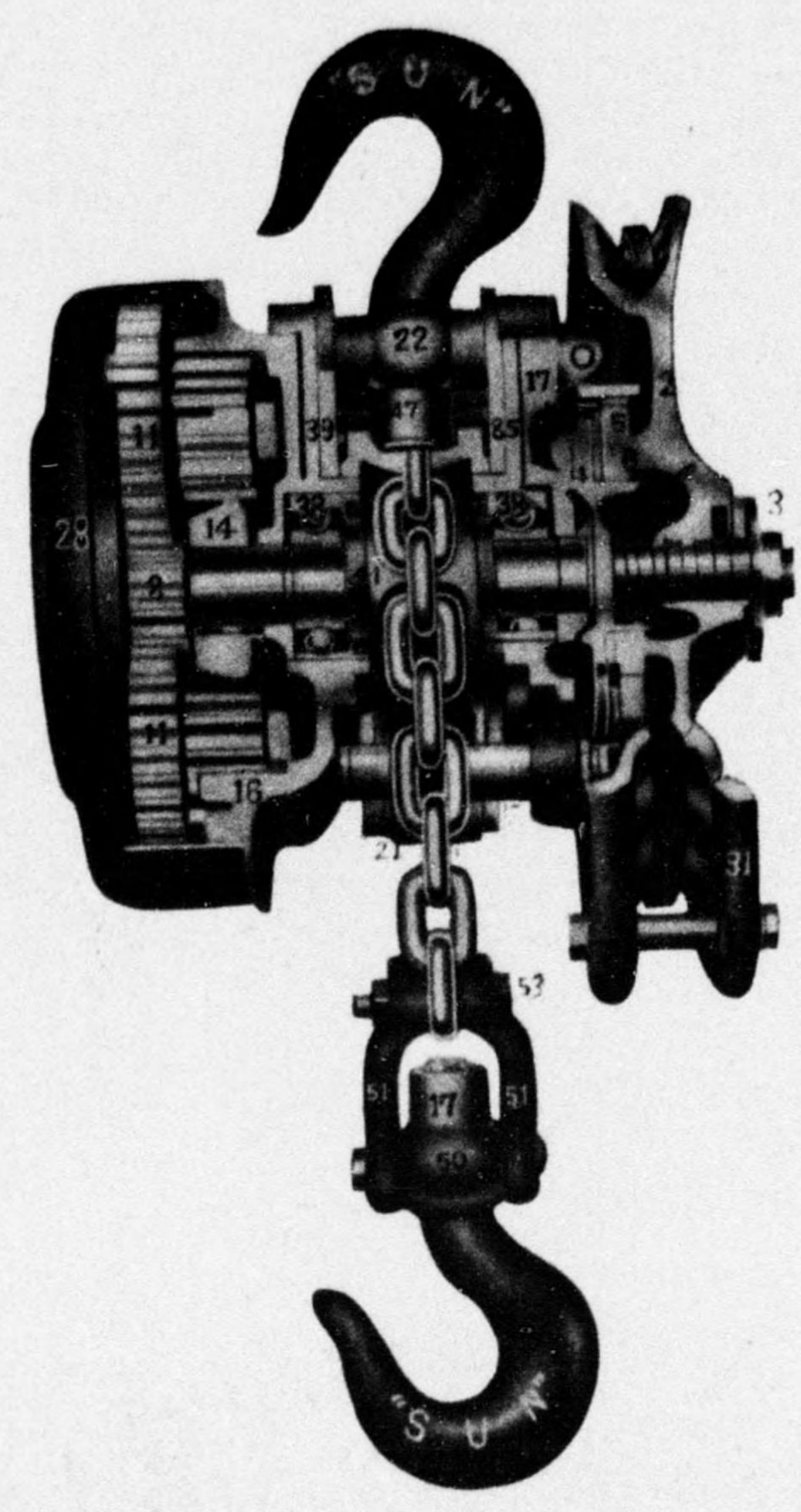

耐力 噸	試験 荷重 噸	電 略	揚程 M	フック間 最短距離約 mm	重量約		箱 詰 寸 法 mm	手 捲 力 量 約 kg
					kg	kg		
		タチイ	2.4	335	31	40	365×315×325	25
1	1½	タチロ	2.4	400	45	55	424×385×370	40
1½	2¼	タチハ	2.4	470	62	75	470×430×415	55
2	3	タチニ	2.7	550	95	115	515×470×460	56
3	4½	タチホ	3	810	95	115	695×510×415	56
4	6	タチヘ	3	995	141	160	697×580×460	58
5	7½	タチト	3.7	1100	180	200	745×615×460	65
8	12	タチチ	3.7	1200	235	260	820×785×480	73
10	15	タチリ	3.7	1340	270	310	850×810×480	75

規 格

高速度三重齒車式スパーギヤーチェーンブロック

一、"SUN" 印 チェンブロックハ弊社ニ於テ研究設計ナシ強靱ニシテ輕量ナルヲ以テ隨所ニ移動輕便且操作圓滑ニ意ヲ用ヒタル結果度々揚ゲ卸シニ使用スル場合ニ於テ人力時間ノ節約ヲナシ以テ能率ノ向上ニ製作致シテ居リマス。

二、 型 式 "SUN" ハイスピードスパーギヤー型 (ボールベヤリング入)

力 量 ½噸—50噸迄製作  
 試験荷重 力量ノ50%増  
 揚 程 御要求ノ通り  
 操作手鎖ノ長サ 全  
 捲揚ニ要スル力表標準以内

三、 構 造

「インタナルギヤー」型ニシテ即チ四輪式齒車装置ハ手鎖ノ操作ニヨル手鎖車ノ四輪ハドライブングピニオンニヨリ二個ノ齒車ニ傳リ主体ノ「インタナルギヤー」ニ啮合ツテ回轉セシメ楔ニヨリ安着セルピニオンケージ及ビ之ニ更ニ楔ニヨリ安着セルロードシーブヲ回轉セシメロードチエーンノ移動ニヨリ荷重ノ捲揚ヲナス。主軸ニハボールベヤリング(クロム鋼製)ヲ使用スハントチエーンノ操作停止ト全時ニ自動制動器ニ作用シ確實ニ荷重ヲ保持ス。

四、 材 料 工 作

本機ハ各部ノ構成スル材料ハ精選セルモノヲ使用シ且、良ク其ノ目的ニ適合ノ金屬ヲ用ヒ工作ニ於テハゲージニヨリ入念ニ加工仕上ヲナシ組立ヲ行フモノトス。

五、 主 鎖

チェンブロックノ生命タル主鎖ハ鎖用鋼材(ローカーボン)ヲ使用シ形狀寸法等均整ニシテ無疵且リングハ完全ニ「シーブポケット」ニ適合スル様製作シ尙特殊ノ熱處理ヲ施シテ磨滅防止ニ努メアリ、完成後常用ノ50% 荷重索引試験ヲ行ヒ點檢ナシ合格ノモノヲ使用ス。

六、 部 分 品

本機ニ使用スル部分品ハ表ノ通り鍛鋼品硬鋼軟鋼等ヨク其ノ目的ニ適合ノモノヲ選擇シ鑄造品ニアリテハ總テ可鍛鑄鐵ヲ用ヒ(強靱ニ於テハ鋼材ニ比スル様)且ゲージ式ニヨリ製作セルタメ互換性ニシテ何レノ機械ニモ取替容易デアリマス。  
 (常ニ多數在庫シテ有リマスカラ即時供給出來マス)



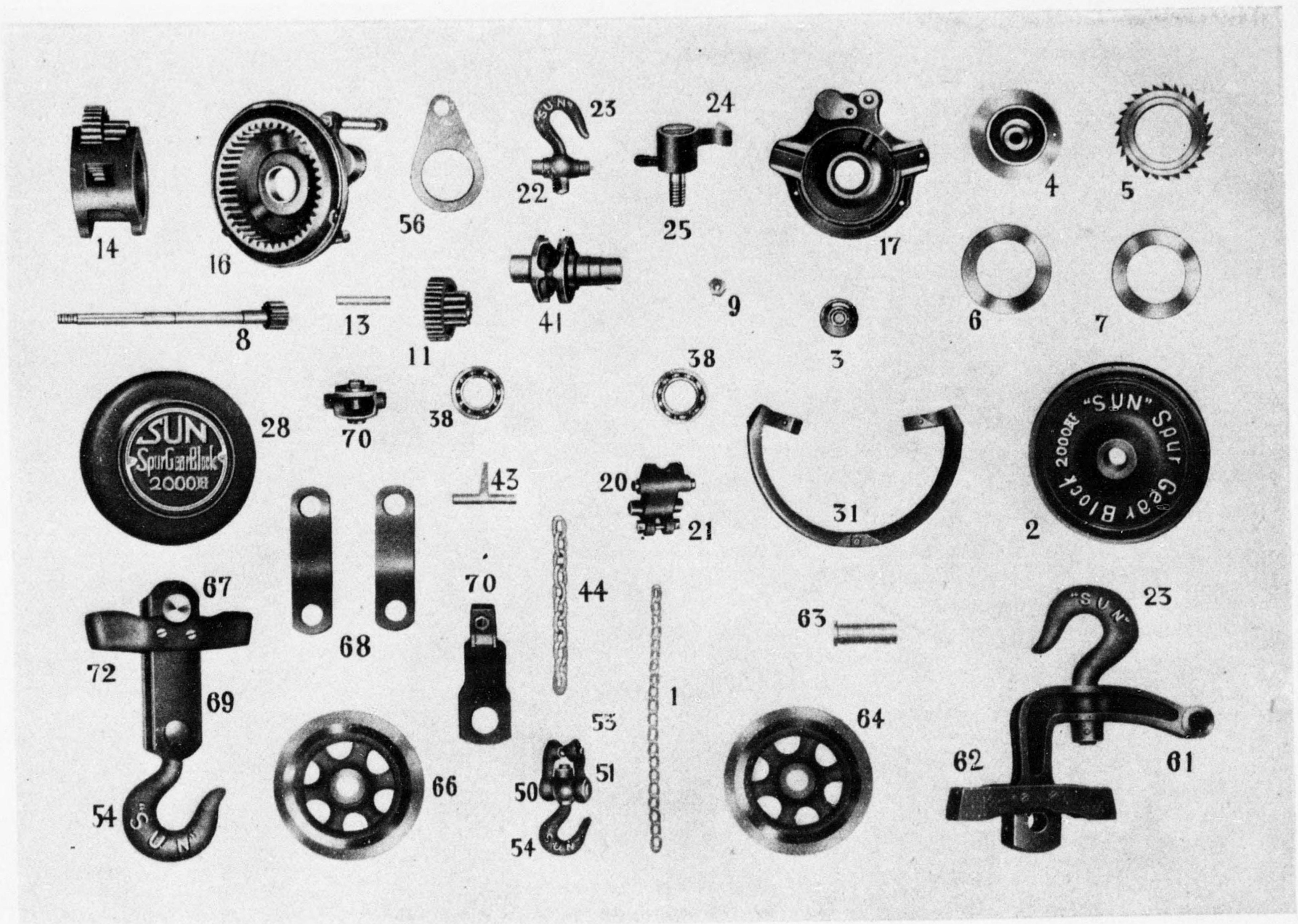

部 分 品 明 細					
番 號	材 質	名 稱	番 號	材 質	名 稱
1.	特種軟鋼製	ハンドチェーン	20.	可鍛鑄鐵製	ロードチェーンガイド
2.	特種鑄鐵製	ハンドホイール	21.	軟鋼製	ロードチェーン用 ボールド
3.	可鍛鑄鐵製	チェックワッシャー	22.	鍛鋼製	トップロックヘッド
4.	可鍛鑄鐵製	ディスクハブ	23.	鍛鋼製	トップフック
5.	可鍛鑄鐵製	ラチェットディスク	24.	可鍛鑄鐵製	ボール
6.	亜鉛引軟鋼板製	アイアンディスク	25.	軟鋼製	ボール用スタッド
7.	革製	レザーディスク	28.	軟鋼板製 又ハ可鍛鑄鐵	ギヤーカバー
8.	硬鋼製	ドライビングピニオン	31.	可鍛鑄鐵製	ハンドチェーンガイド
9.	軟鋼製	同上用 ナット	36.	軟鋼板製	サイドプレート
11.	可鍛鑄鐵製	ギヤーエンドピニオン	38.	鋼製	ボールベヤリング
13.	軟鋼製	同上用 ピン	41.	可鍛鑄鐵製	ロードシープ
14.	可鍛鑄鐵製	ピニオンケーシング	43.	可鍛鑄鐵製	ストリッパー
16.	可鍛鑄鐵製	インターナルギヤー	44.	特殊軟鋼製	ロードチェーン
17.	可鍛鑄鐵製	ラチェットケース	50.	鍛鋼製 又ハ可鍛鑄鐵	ボトムクロスヘッド
			51.	鍛鋼製 又ハ可鍛鑄鐵	フック用リング
			53.	軟鋼製	リング用ボルト
			54.	軟鋼製	ボトムフック
			61.	可鍛鑄鐵製	トップヨーク
			62.	可鍛鑄鐵製	トップチェーンガイド
			63.	軟鋼製	トップシープ用ピン
			64.	可鍛鑄鐵製 又ハ可鍛鑄鐵	トップシープ
			66.	可鍛鑄鐵 又ハ可鍛鑄鐵	ボトムシープ
			67.	軟鋼製	ボトムシープ用ピン
			68.	軟鋼板製	バケットストラップ
			69.	軟鋼板製	ボトム サイドプレート
			70.	可鍛鑄鐵製	チェーンホルダー
			72.	可鍛鑄鐵製	ボトム チェーンガイド
			[38]	クロム鋼製	高級ボール ベヤリング



“SUN” 高速度三重式スパーギヤ チェンブロック

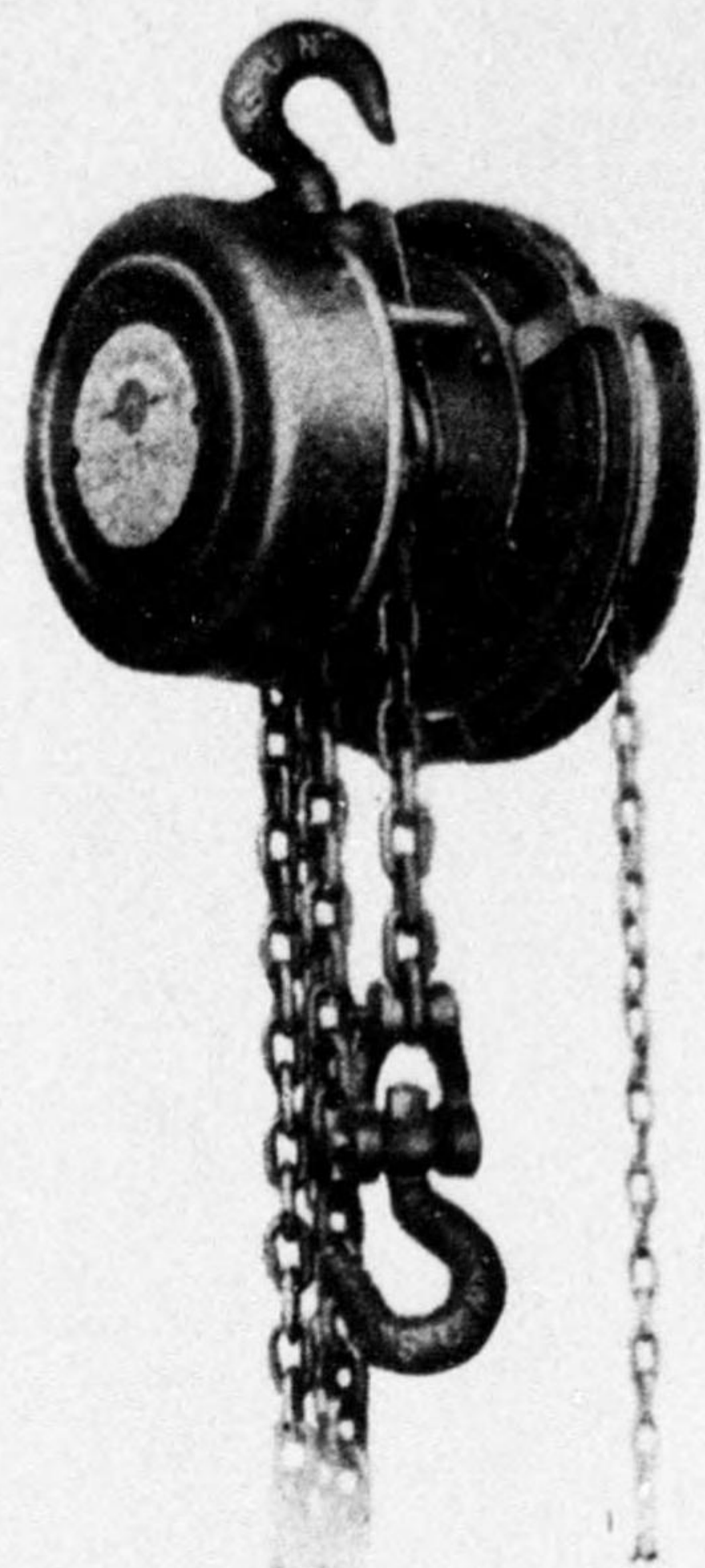

1/2, 1, 1 1/2, 2 吨型

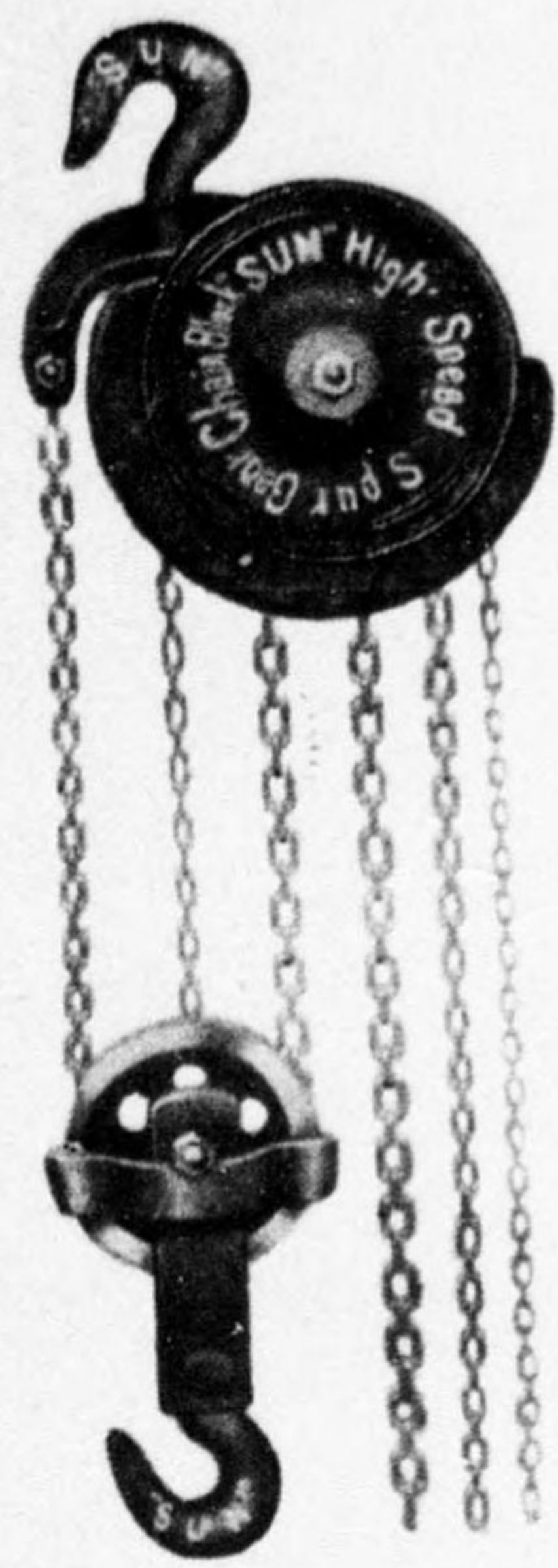

3, 4 吨型



5, 10 吨型



サイクロン型 5, 10 吨型



大日金属工業株式会社

◀ 製 作 品 目 ▶

高級チェンブロック各種 及 トロリー 一般機械器具

製 造 元

大日金属工業株式会社

本 社 大阪市西區薩摩城南之町一番地

電話新町 三〇一八・五〇三六番

工場及營業所 尼崎市濱字丸田三九番地

電 話 福島 六八〇九番  
尼崎 二八七八番

販 賣 店





# 高速度強力金切鋸盤

## 電動單獨運轉型

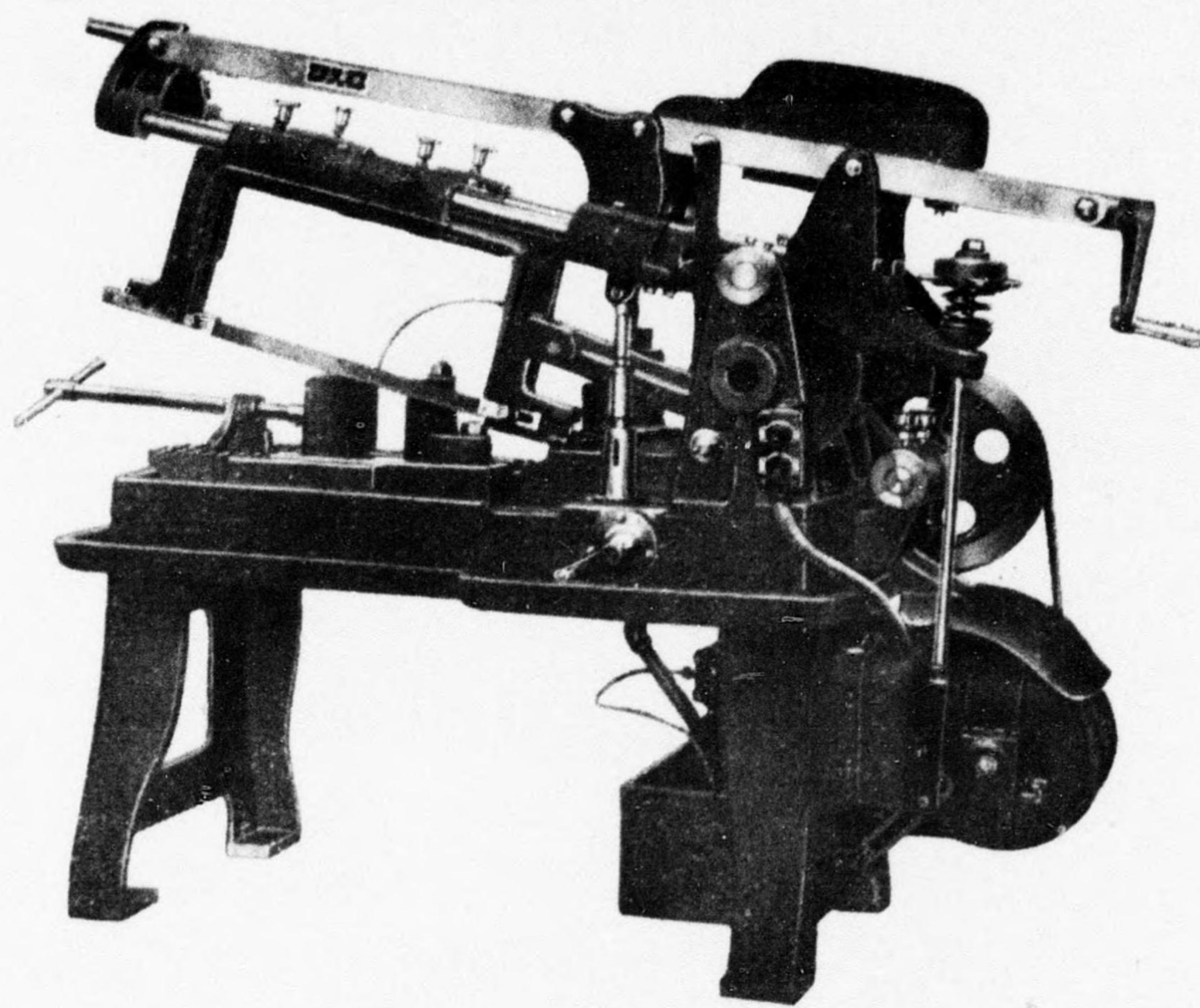

本機ハ弊社最新式ノ設計ニナリ、在來機ニ比シ四倍乃至五倍ノ切斷能力ヲ有スルモノニシテ内部ニ油壓ピストンヲ有スル鋸壓力加減裝置ヲ附シクランクニヨリ聯動スル油壓ポンプニヨリ油壓ヲピストン下面ニ送り鋸及其附帶裝置ノ荷重ニ抵抗セシム、ハンドルニヨリピストン下面ノ油壓ヲ任意ニ變化セシメ鋼、鐵、眞鍮、アルミニウム等其ノ材質ニ應ジ鋸刃ノ壓力ヲ調節スル事ヲ得、鋸裝置歸復運動ノ際ハ油壓全壓力ヲピストンニ作働シ鋸刃及其附帶裝置ニ仰角ヲ與ヘ鋸刃ヲ加工物ヨリ絶縁セシメ鋸刃ノ生命ヲ延長シ又切斷能率モ著シク大ナリ、鋸刃ノ磨滅ニツレ重錘ニヨリ鋸壓力ヲ任意ニ増加スル事ヲ得、本機ハパイプ及潤滑裝置ヲ有シ特ニ電動直結ニ有リテハ最新式ノ「自動ストツプ」マグネツトスイッチヲ裝置シ材料切斷終ルト同時ニ自動停止ス。本機ハベルト運轉型、電動機直結型、電動機直結移動型アリ、電動機直結型ハ工場離レタル材料庫等ニ設備シテ材料ノ整理及旋盤切斷作業ヲ助ケ工場能率増進トニ最適良機ナリ。

### 主 要 寸 法

鋸刃ノ最長	切斷能力	回轉數	所要電力	据付面積
16吋	8吋×8吋	70—100 R/M	1 H.P	1,030 <sup>mm</sup> × 550 <sup>mm</sup>
18吋	10吋×10吋	70—100 R/M	1 H.P	1,030 <sup>mm</sup> × 550 <sup>mm</sup>

附屬品 電動機、電磁開閉器、スパナ

## 大日金屬工業株式會社

本社 大阪市西區薩摩堀南之町一番地  
工場 尼崎市濱字丸田三番地

電話新町 ⑤ 3018  
5036  
電話福島 ⑤ 6809  
電話尼崎 2878