



DRAUGHTS

OF THE

190
896

PROPRIETARY MANORS

IN THE

Province of Pennsylvania,

AS PRESERVED IN THE LAND DEPARTMENT
OF THE COMMONWEALTH.

EDITED BY

WILLIAM HENRY EGLE, M. D.

HARRISBURG, PA. :

CLARENCE M. BUSCH, STATE PRINTER.

1895.

F182
-E21



78

PREFATORY NOTE.

[It will be seen by reference to the following list of Proprietary Manors, that many are wanting. It has been deemed proper, however in elucidation of the text and the volumes devoted to the "Minutes of the Board of Property," to preserve copies of such as have been found in a special volume of the present series of Pennsylvania Archives as a separate and distinct volume. The burning of the State printing office, which destroyed volume three, will only delay the publication of that volume a brief time. It is to be regretted that this record of the Manors of the Province of Pennsylvania cannot be made complete, but for the present it is wise to thus preserve what may now be secured. In this connection, it has been seen fit to reproduce Reed's Plan or Map, of Philadelphia, the copy in the Land Department, owing to frequent reference, being in almost illegible condition. Further search may bring to light other Draughts which, in time, may thus be preserved for futurity.]



The Proprietary Manors.

No.	Name.	To Whom Granted.	Date.	Acres.	Location.
1,	Amorland of Bilton, . . .	Wm. and Margaret Lowther.	1733	2,850	Chester County.
2,	Amsterdam, } Rotterdam, }	Proprietaries, . .	1768	2,770	Northumberland.
3,	Antolough or Andolhea,	Richard Penn. . .	1741	5,000	Lancaster (See Little Swatara.)
4,	Beaver Harbor,	Proprietaries, . .	1763	665	Northumberland.
5,	Bedford,	Proprietaries, . .	1762	2,810	Bedford.
6,	Bilton,	John Penn,	1701	9,840	Chester.
7,	Callowhill,	Thos. Callowhill, .	1702	5,000	Chester.
8,	Chawton,	John Page,	1735	1,500	Northampton.
9,	Cherry Hill,	Proprietaries, . .	1763	1,202	Westmoreland.
10,	Chest,	Proprietaries, . .	1760	1,123	Bedford.
11,	Conestoga,	William Penn, . .	1717	16,000	Lancaster.
12,	Cow-Pasture,	Proprietaries, . .	1763	3,603	Berks.
13,	Crooked Dale,	Proprietaries, . .	1769	1,026	Northumberland.
14,	Damascus,	Proprietaries, . .	1773	4,390	Northampton.
15,	Denmark,	Proprietaries, . .	1769	4,861	Westmoreland.
16,	Dundee,	Proprietaries, . .	1773	10,000	Northumberland.
17,	Elk Forest,	Proprietaries, . .	1763	11,526	Northampton.
18,	Fagg,	Letitia Aubrey, . .	1737	89,250	Chester.
19,	Fell,	Guiljelma Maria Fell.	1727	10,000	Lancaster.
20,	Fox Harbor,	Proprietaries, . .	1763	1,694	Northampton.
21,	Fermor,	Proprietaries, . .	1736	Northampton.
22,	Freame,	Thomas Freame, . .	1733	2,500	Bucks.
23,	Freame,	Thomas Freame, . .	1741	10,000	Lancaster.
24,	Gilberts,	Proprietaries, . .	1733	4,095	Philadelphia.
25,	Hempfield,	Proprietaries, . .	1720	2,816	Lancaster.
26,	Highland,	Proprietaries, . .	1755	7,750	Bucks.
27, 27½,	Highlands, " " " " " "	Proprietaries, . . " " " " " "	1762 } 1762 }	2,473 } 763 }	{ Bedford.
28,	Indian Landing,	Proprietaries, . .	1773	1,836	Northumberland.



Charles Pickering & Company.

N West
18

North East 396 Perches

one half in right of Jn: & Am. Sharlott Lowther
the other half in right of
William & Margaret Lowther
MANNOR OF BILTON 2850 Acres.

Along the touch line West by South 1200 perches.

Resurveyed
the 19th of 7^m 1737

Pickerings Creek

White Oak
Poplar
M.N.
d 06

N East 340 p^s

Sp Oak

See two Warrt. dated 31:10^m 1733
one to John Simpson
the other to Joseph Turner.

d 046

9400^s

Up School hill

White Oak
Valley Creek

Perqueoman









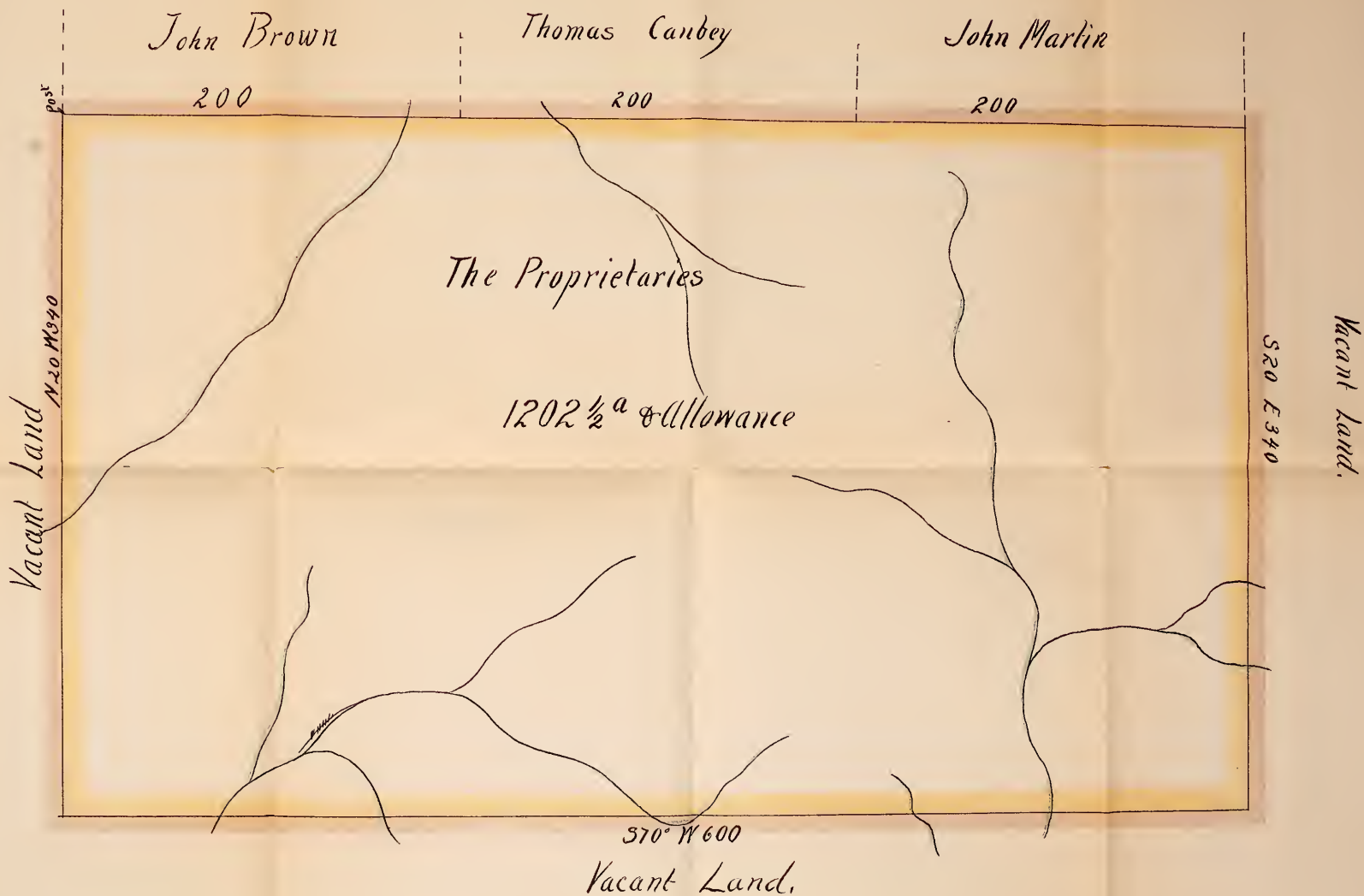

Survey'd to the Honorable Proprietaries, on the 23rd Day of July 1773, the above Described Tract of One Thousand two hundred & two Acres & a Quarter of an Acre & the Usual Allowance of Six p. Ct. Situate on the Waters of two Lick Creek about Seven Miles Easterly of the two Licks & on the Path leading from Frankstone to the Kittanning in the County of Westmoreland by Warrant of the 13th Day of October 1760.

To JQHN LUKENS, Esq., }
S. Genl.

p JOSHUA ELDERS, D. S.



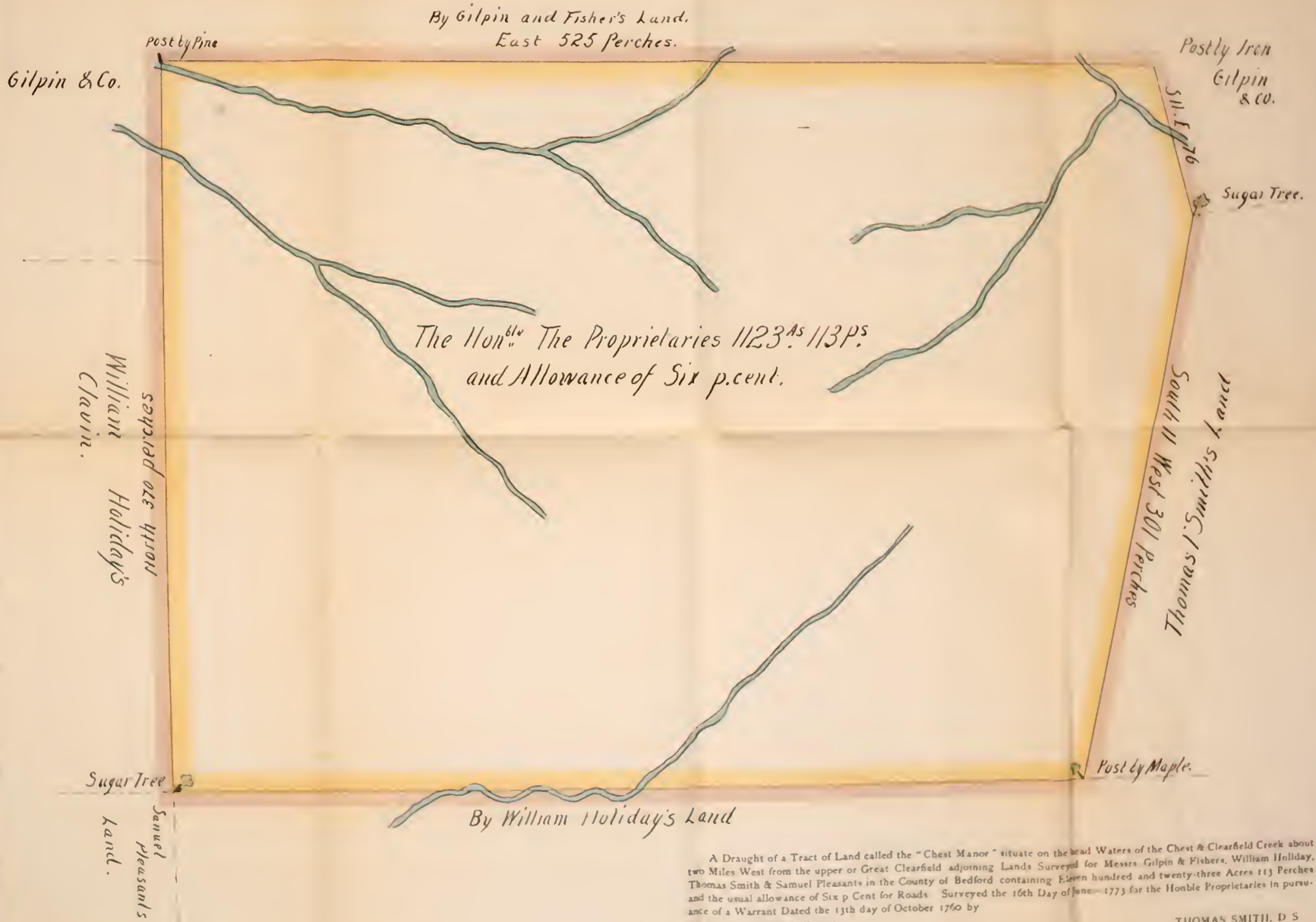

By Gilpin and Fisher's Land,
East 525 Perches.

Post by Iron
Gilpin
& Co.

Sugar Tree.

The Hon^{ble} The Proprietaries 1123^{As} 113P^S
and Allowance of Six p.cent.

By Thomas Smith's Land
South West 301 Perches

Post by Maple.

By William Holiday's Land

A Draught of a Tract of Land called the "Chest Manor" situate on the head Waters of the Chest & Clearfield Creek about two Miles West from the upper or Great Clearfield adjoining Lands Surveyed for Messrs. Gilpin & Fishers, William Holiday, Thomas Smith & Samuel Pleasants in the County of Bedford containing Eleven hundred and twenty-three Acres 113 Perches and the usual allowance of Six p Cent for Roads Surveyed the 16th Day of June 1773 for the Honble Proprietaries in pursuance of a Warrant Dated the 13th day of October 1760 by
To JOHN LUKENS, Esq., |
Surveyor General |

THOMAS SMITH, D S

1870

1870

1870







This tract of Land containing Sixteen thousand

acres was Surveyed for the proper use and behoof of William

Penn Esq. Proprietary and Governor in Chief of the Province of Pennsylvania

his heirs and assigns for-ever by Virtue of a Warrt. from his Commissioners of Property

dated the first day of the twelfth month February Dom. 1717-8.

Certified by

JACOB TAYLOR.

Isaac Taylor laid out to John Cartledge
500^{acs} to James Logan 500^{acs} without
James's knowledge or order & wth he
refused to take. But the Propriet.^{es} by
their Warrt require a return of 700^{acs}
within the 2 tracts to be made into the
Secretarys office.





A Draught of the Manor of Conestoga in the County of Lancaster.







1272 A

A Draught of a tract of land called Crooked Dale situate on the easterly side of the north east Branch of Susquehanna River on a Creek emptying into said River called Tunkhannock in the County of Nerthumberland containing One thousand and twenty six acres besides the usual allowance of Six p. cent. for roads, &c. Surveyed the 6th day of October 1769 For the Honorable the Proprietaries In pursuance of a Warrant dated the 17th day of March 1769.

To JOHN LUKENS, ESQR.,
Surveyr Genl.

by CHAS STEWART, Dy. Surv



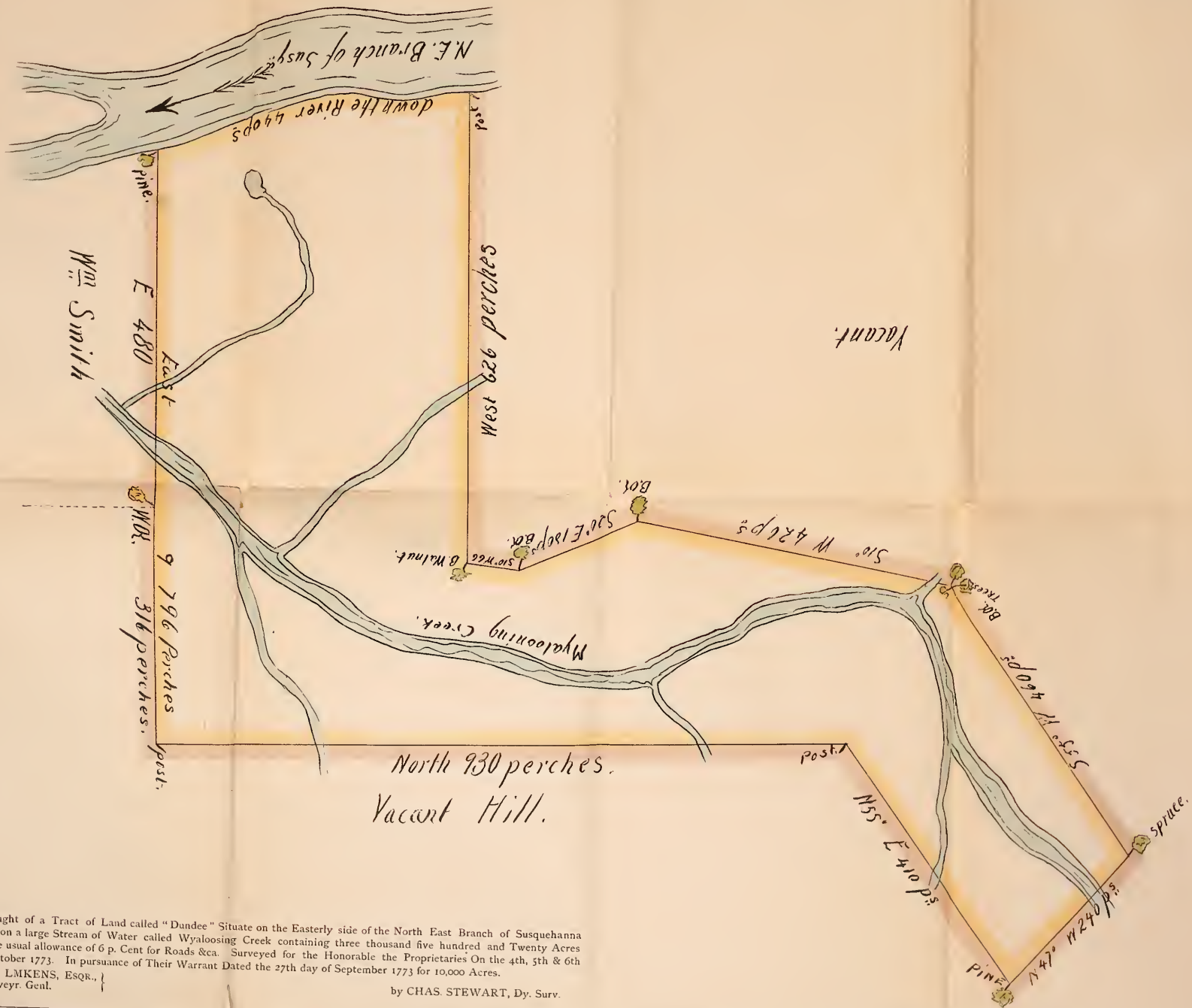

A Draught of a Tract of Land called "Dundee" Situate on the Easterly side of the North East Branch of Susquehanna River and on a large Stream of Water called Wyalloosing Creek containing three thousand five hundred and Twenty Acres besides the usual allowance of 6 p. Cent for Roads &c. Surveyed for the Honorable the Proprietaries On the 4th, 5th & 6th days of October 1773. In pursuance of Their Warrant Dated the 27th day of September 1773 for 10,000 Acres.
 To JOHN LMKENS, ESQR., }
 Surveyr. Genl.

by CHAS. STEWART, Dy. Surv.

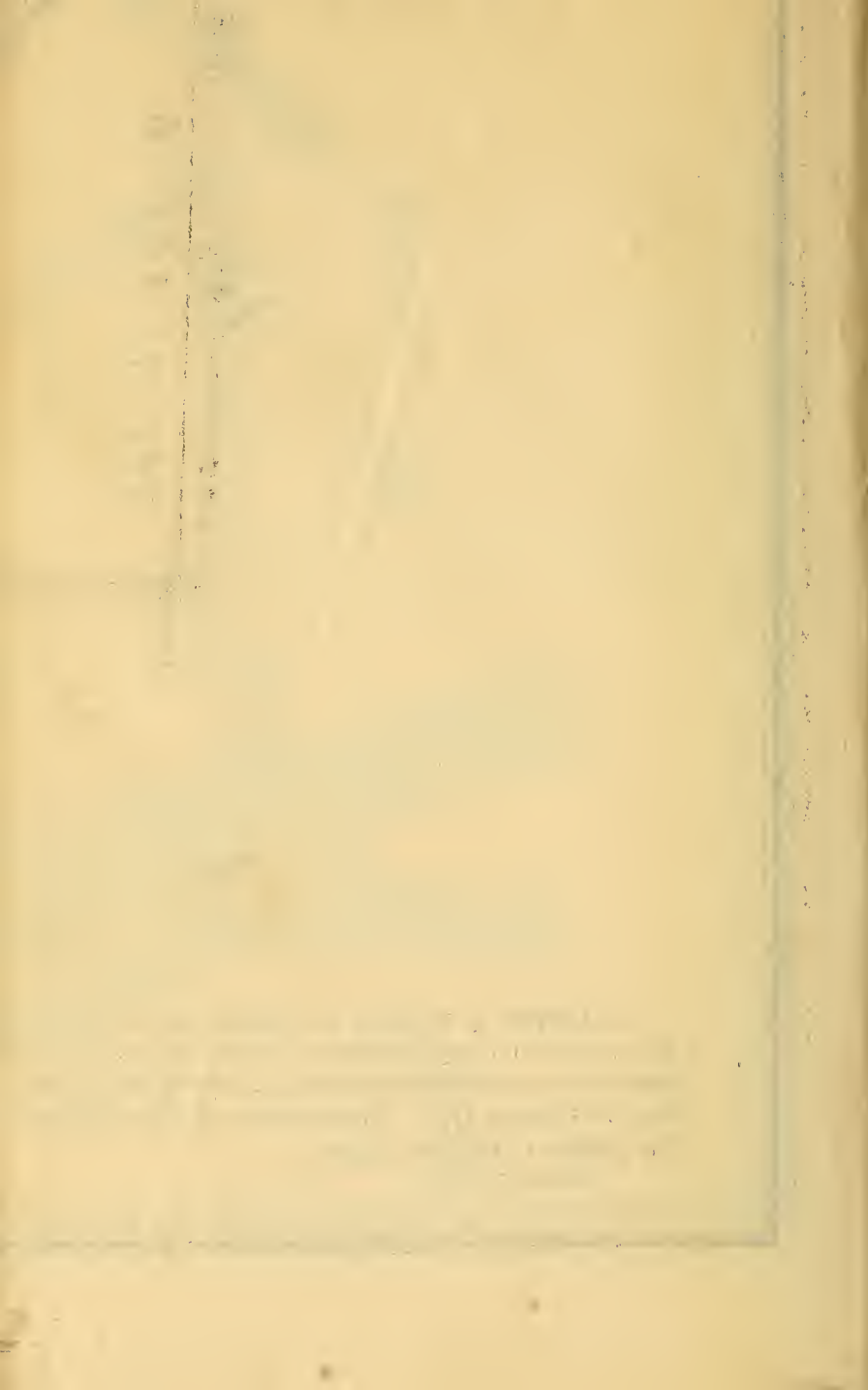



Faint, illegible text or a list of entries, possibly bleed-through from the reverse side of the page. The text is too light to read accurately.

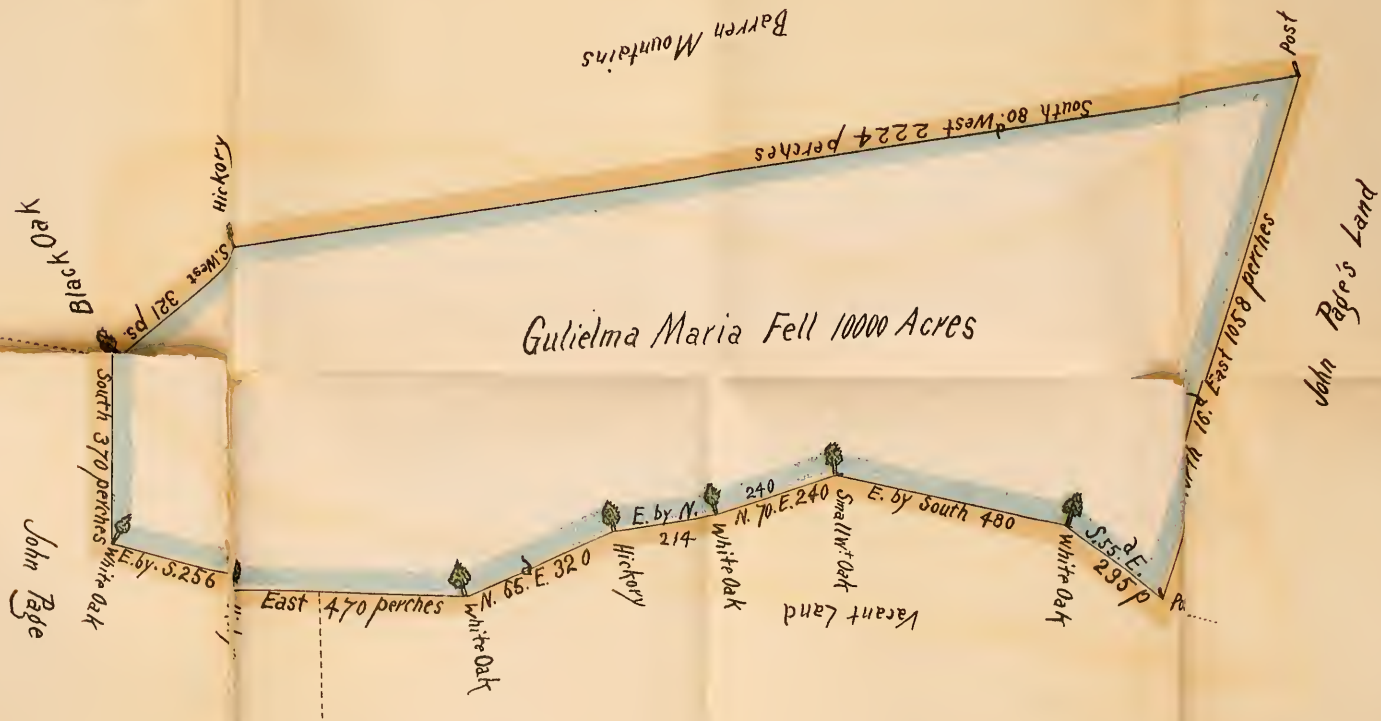

Gutielma Maria Fell 10000 Acres

Gutielma Maria Fell's Land Situate on Tulpehoceon Creek in the County of Leaster, Begins at a Black Oak being a Corner of John Page's land thence South by the Same 370 pches to a White Oak thence by the P. Page's land East by South 256 pches to a Hickory, East 470 pches to a White Oak. Thence by Vacant Land and North 65 d. East 320 pches to a Hickory, East by North 214 pches to a White Oak, North 70 d. East 240 pches to Small White Oak, East by South 480 pches to a White Oak, South 55 d. East 235 pches to a post, thence by the P. John Page's Land North 16 d. East 1058 ps to post. Thence South 80 d. West along the Barren 2224 pches to a Hickory, then South West 321 pches to the place of Beginning, Containing Ten thousand acres.



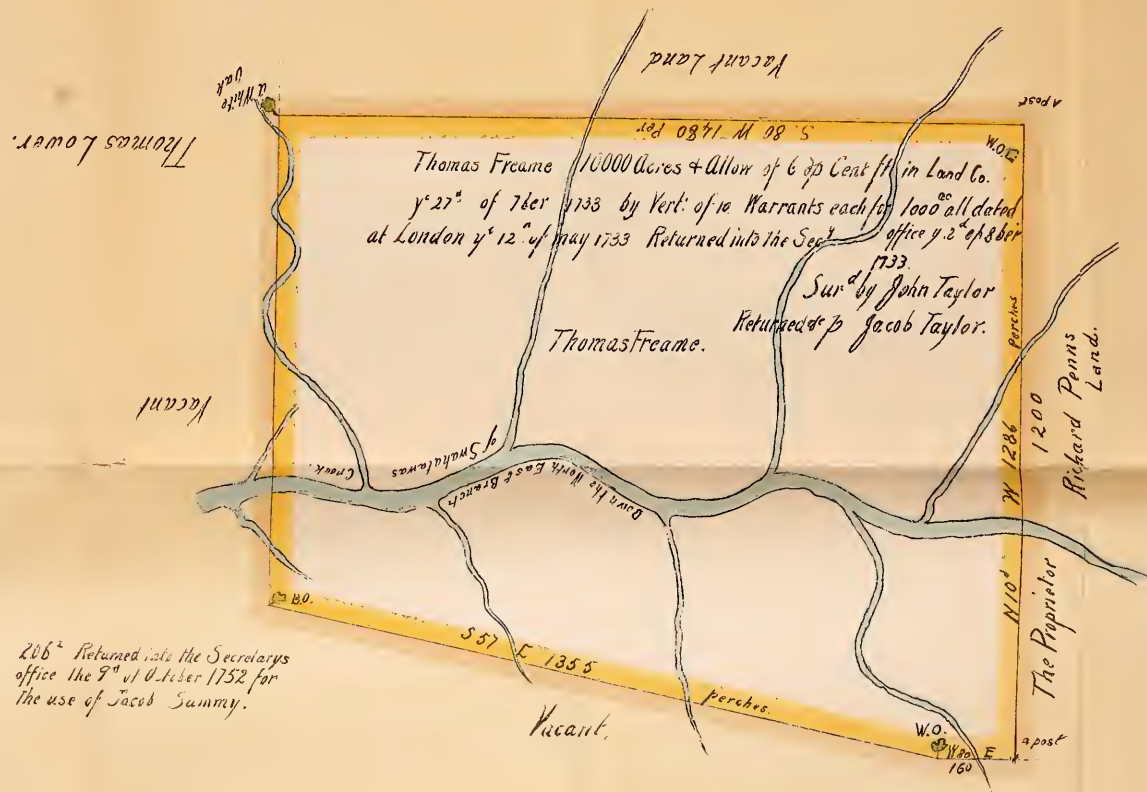

206^{ac} Returned into the Secretarys
 office the 9th of October 1752 for
 the use of Jacob Summy.





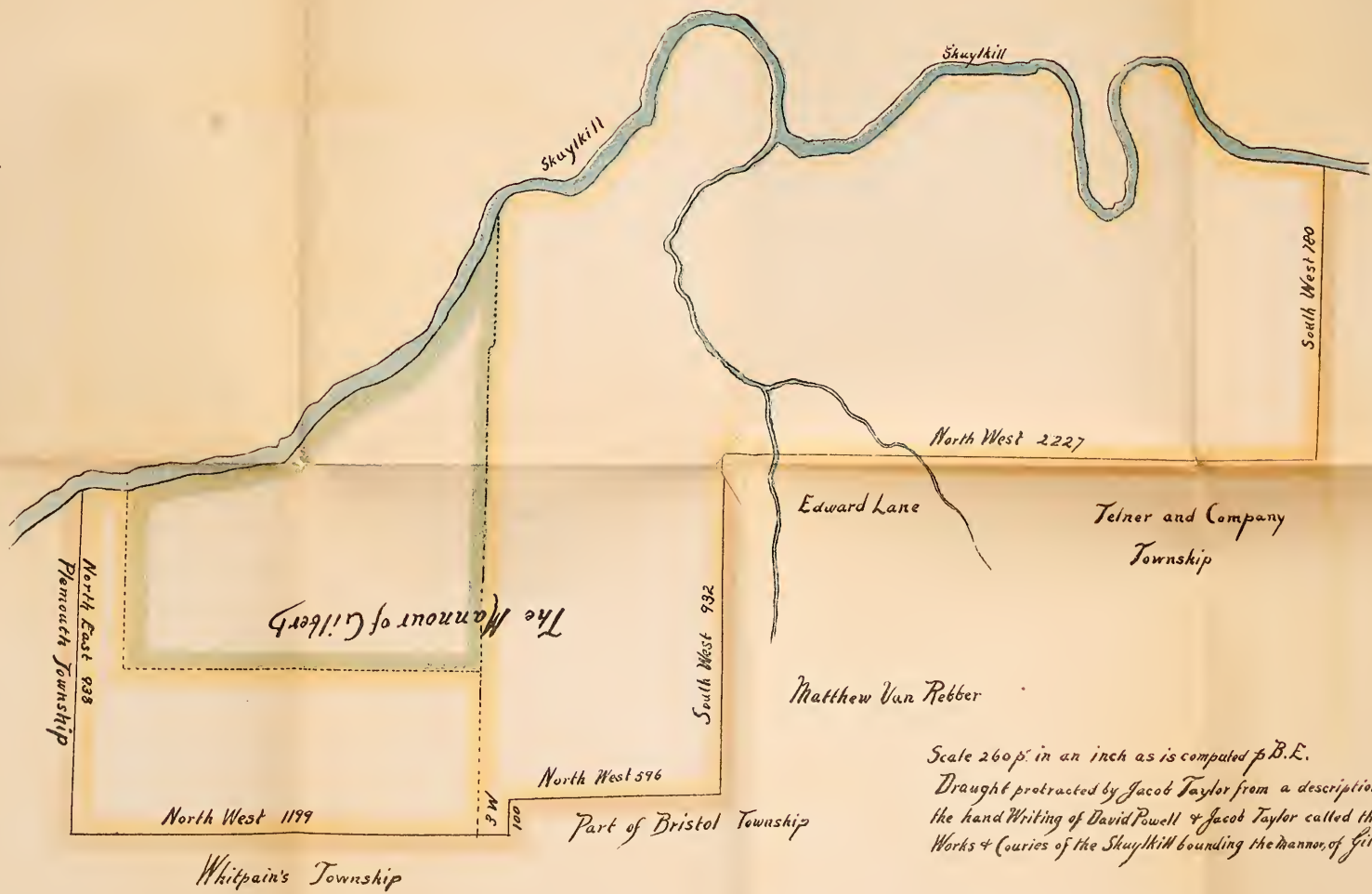

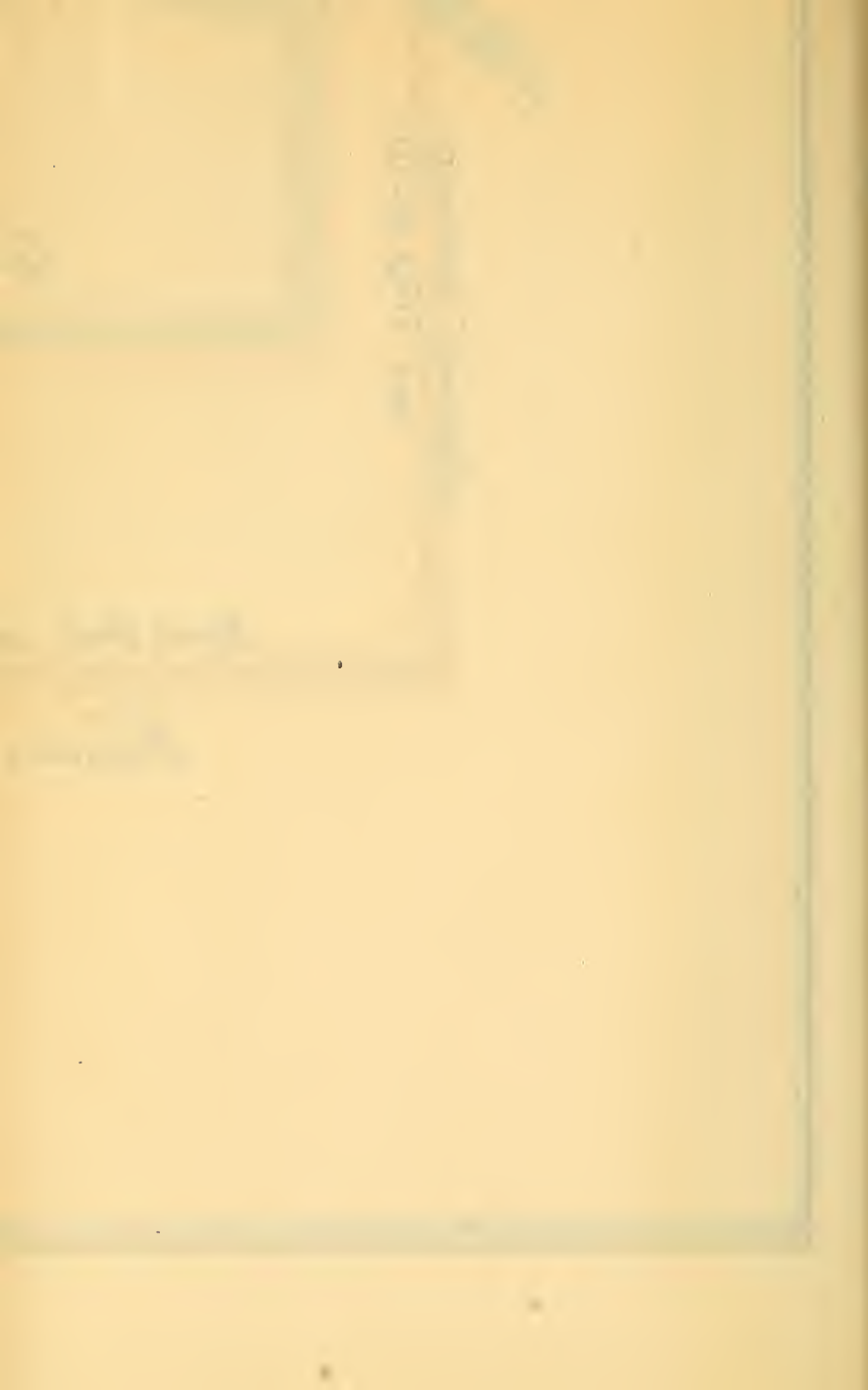

Highland
Highland

Highland
Highland

Highland

Highland



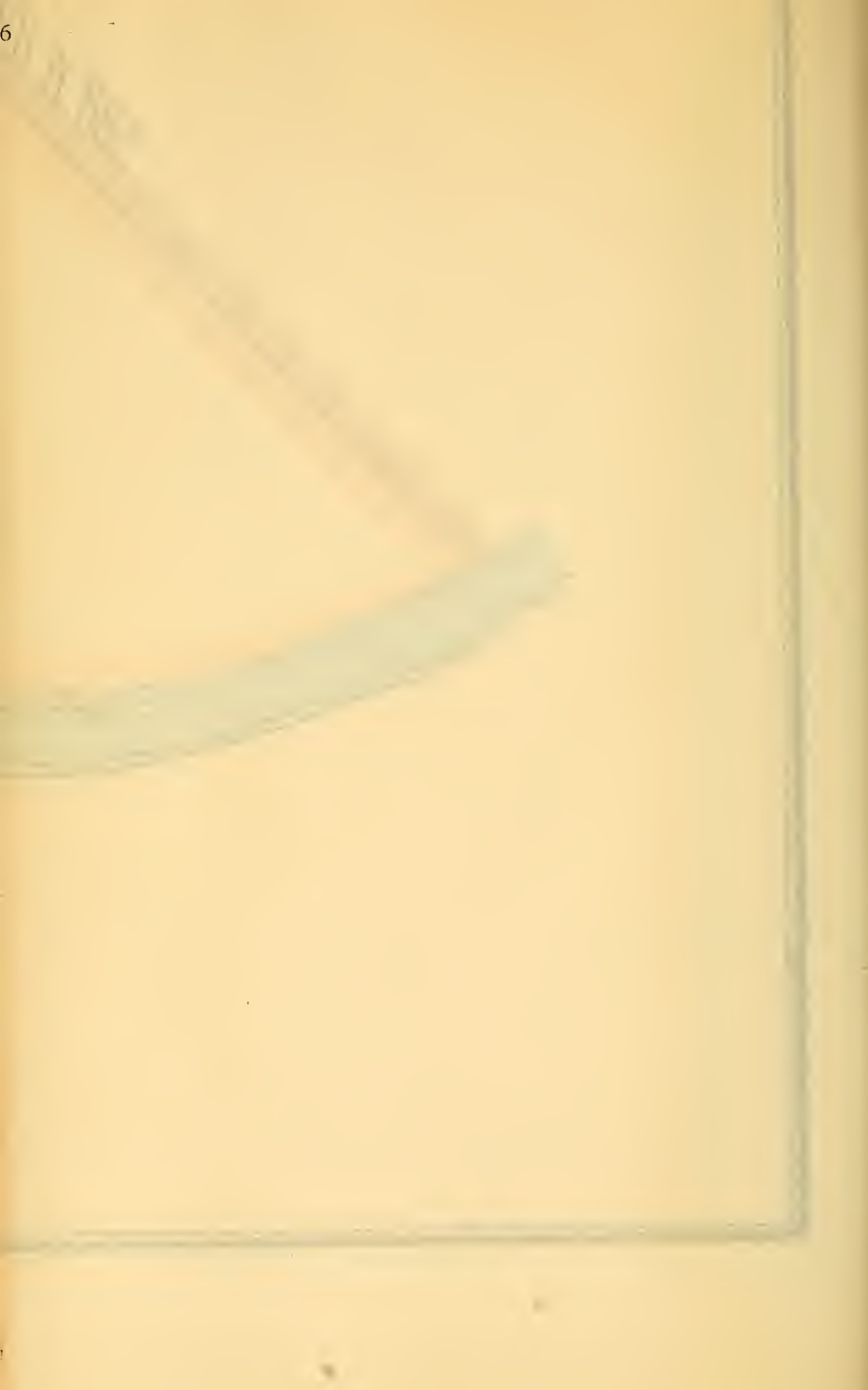

HIGHLANDS.

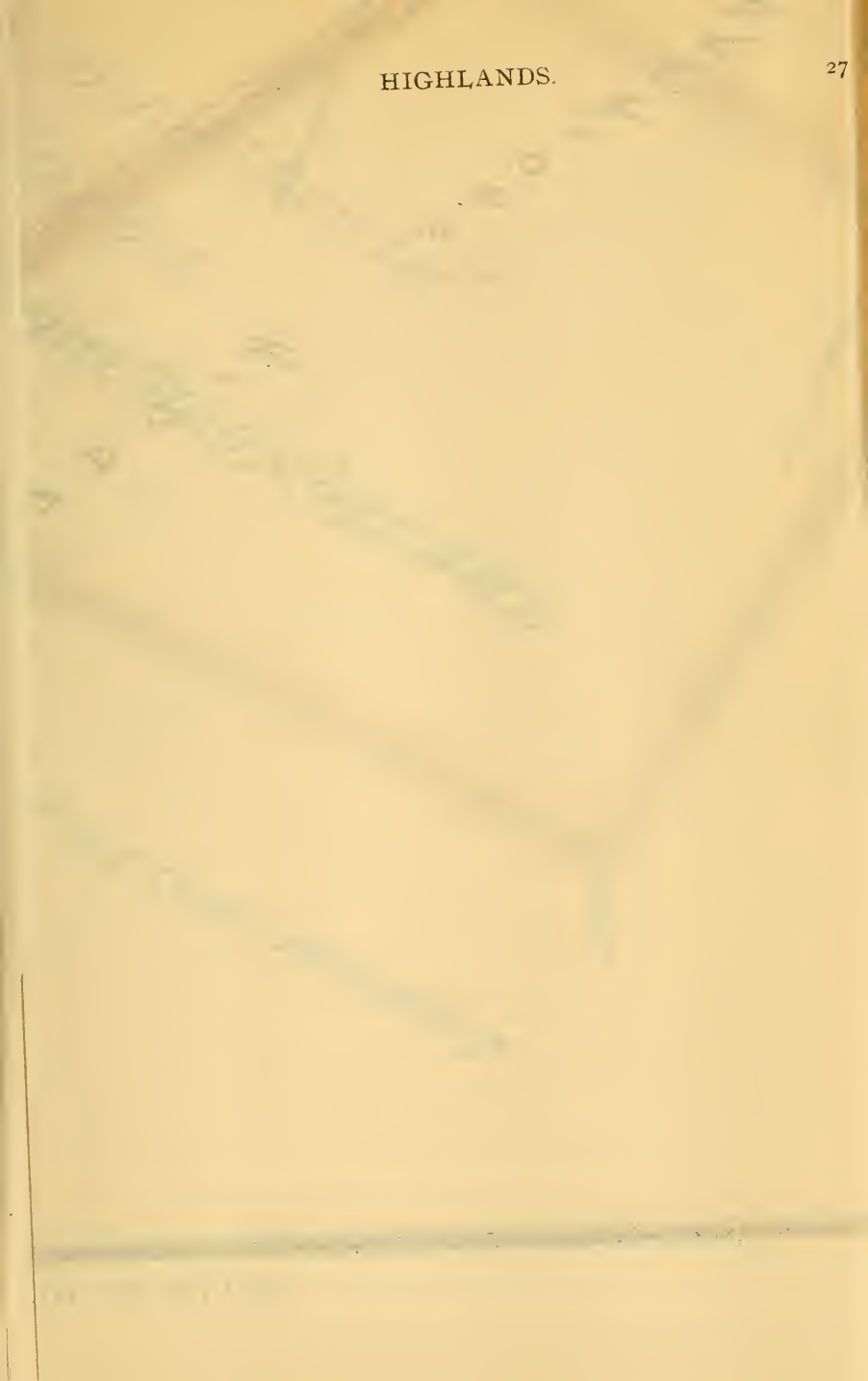

A Draught of a tract of land Situate in the Warriors Valley east side of the Cove Mountain in Cumberland County cont. one half acre; and the usual allowance of six pr. cent for roads the 25th 1762 In pursuance of the Honourable the Proprietors To JOHN LUKENS } Surveyor General.

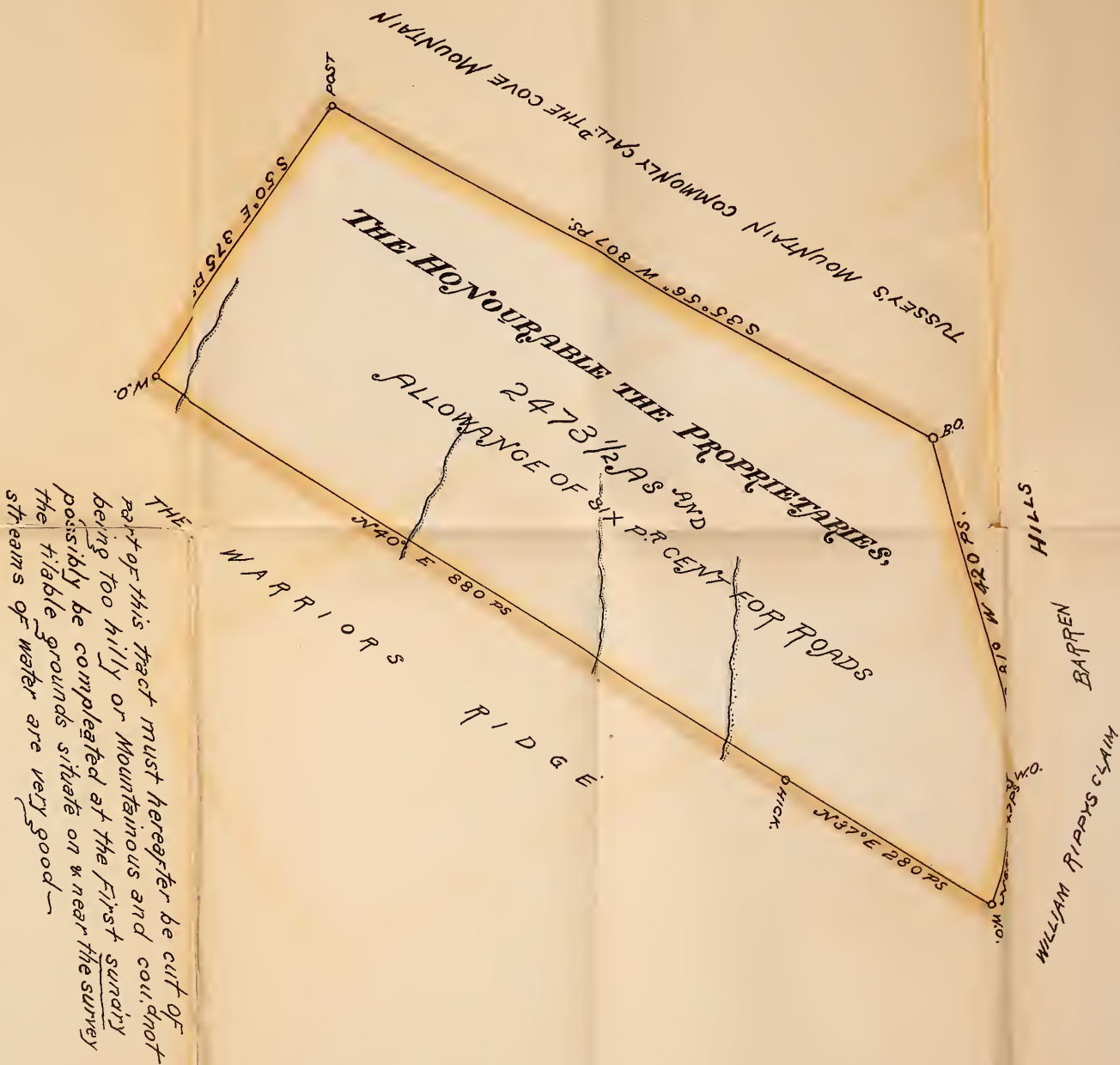

on the North West side of the Warriors Ridge and the South containing Two thousand five hundred and Seventy-three acres and Aids. Surveyed for the Honourable the Proprietaries August carries Warrant bearing date the thirteenth day of October, 1760.

by JOHN ARMSTRONG, D. S.

[Faint, illegible handwriting, possibly bleed-through from the reverse side of the page.]

Tusseys Mountain Commonly Called The Cove Mountain

N 26° E 660 PS.

THE HONOURABLE THE PROPRIETARIES.
and Allowance of Six Pr. Cent For Roads.

correct 763 acres & allow^e.

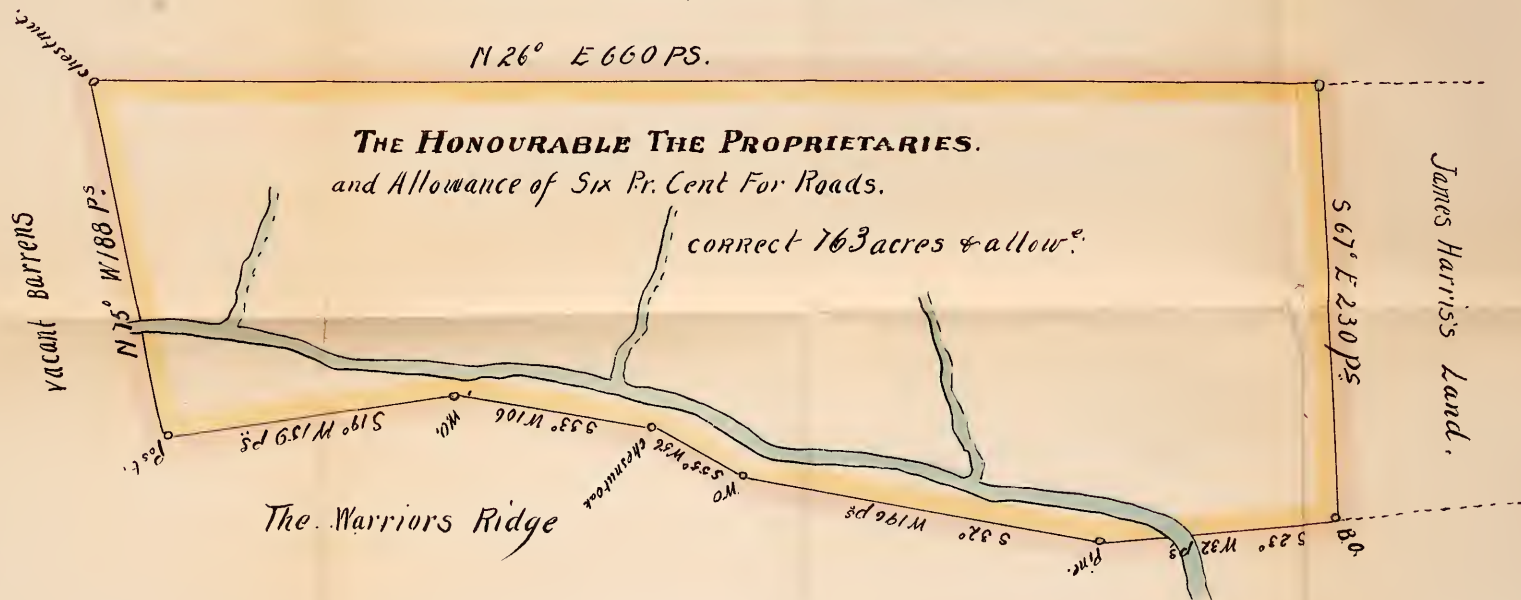

A Draught of a tract of land situate in the Warrior's Valley on the North west side of the Warrior's Ridge and on the south east side of Tusseys Mountain in Cumberland County containing seven hundred and sixty-three acres and the usual allowance of six per cent for Roads, Surveyed for the Honourable the Proprietaries August the 23rd 1762. In pursuance of the Honourable the Proprietaries Warrant bearing date the thirteenth day of October one thousand seven hundred and sixty.

To JOHN LUKENS, }
Surveyor General.

by JOHN ARMSTROG, D. S.

of this tract the high lands are good but not much Meadow ground.

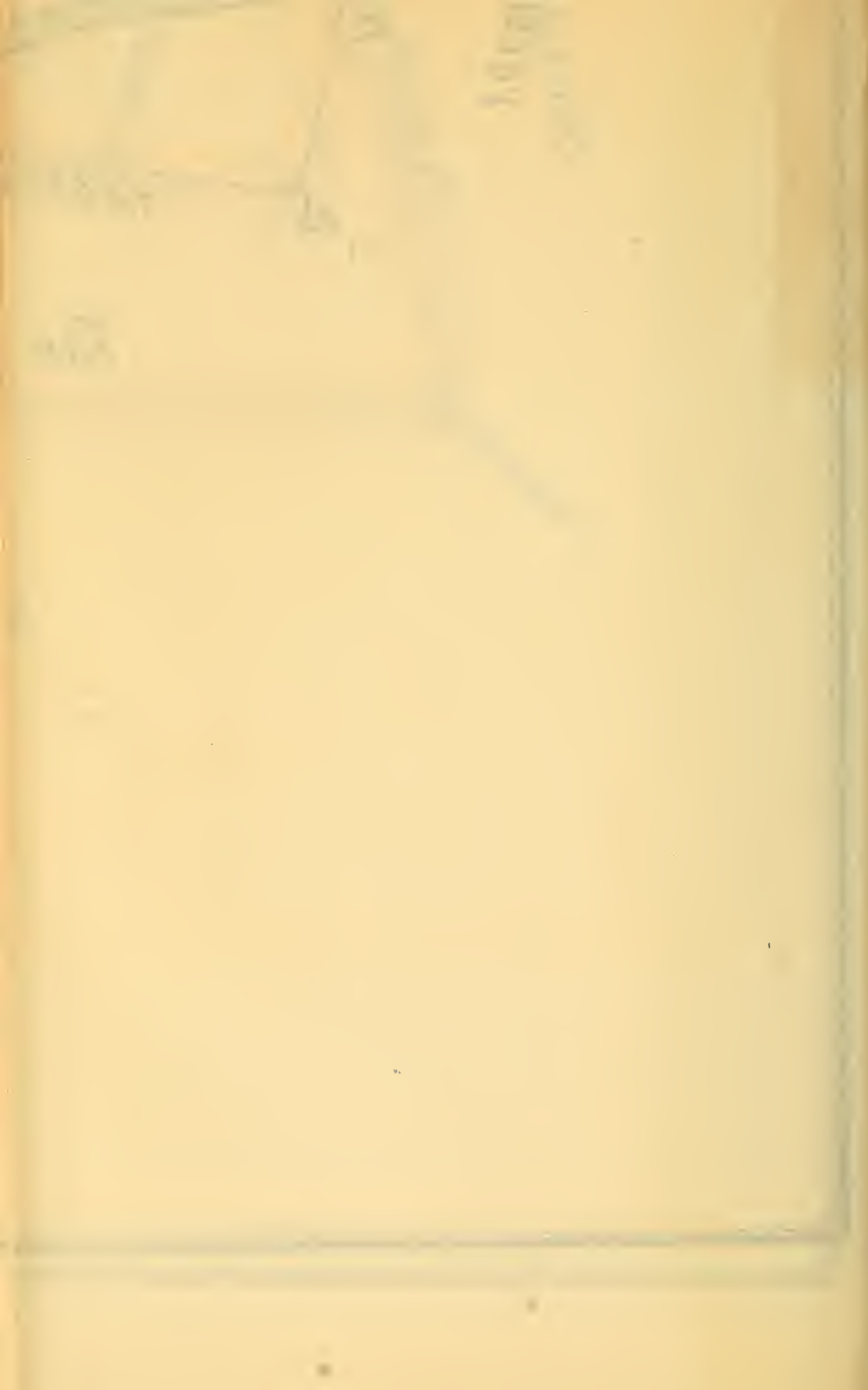



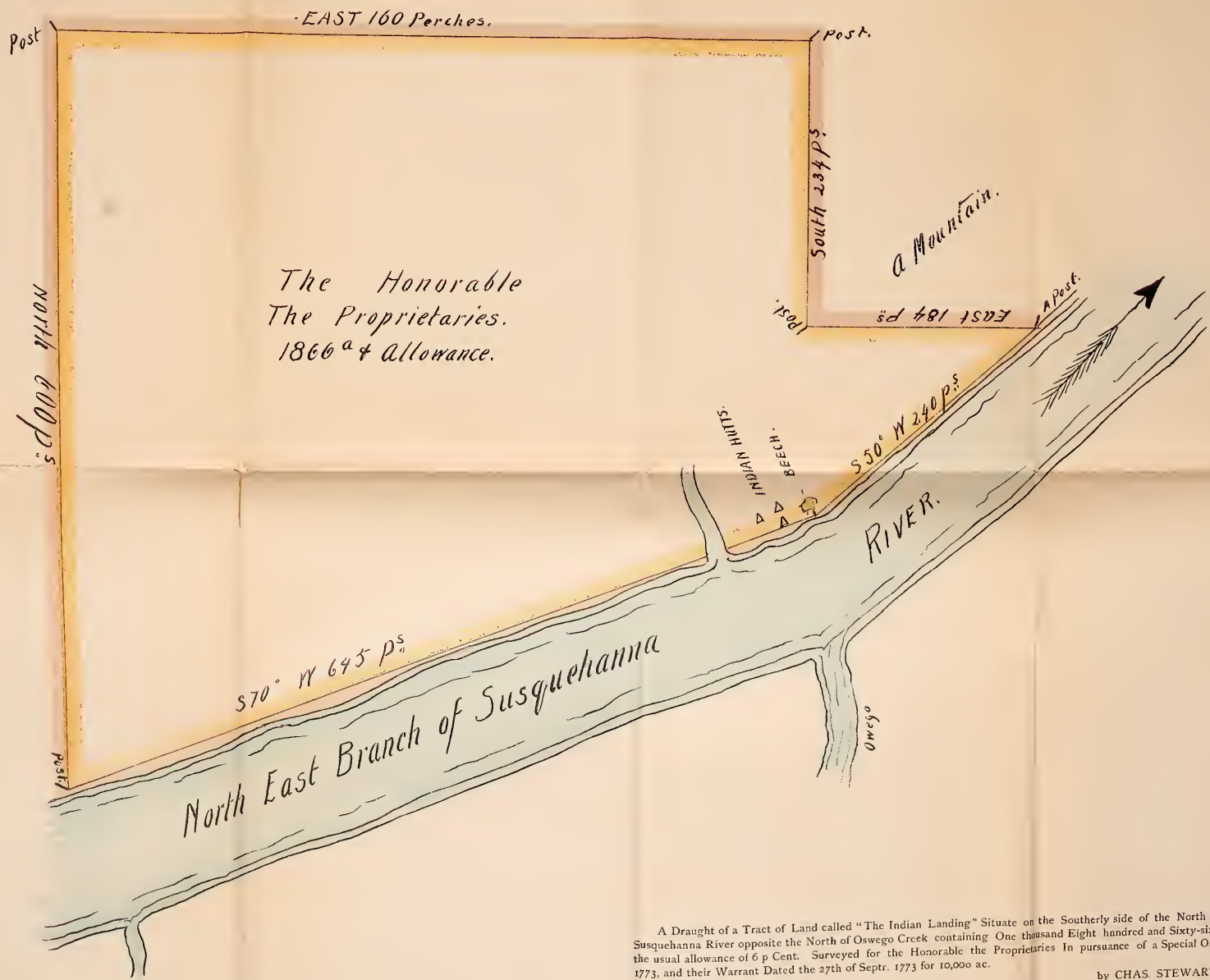

The Honorable
The Proprietaries.
1866^a & Allowance.

A Draught of a Tract of Land called "The Indian Landing" Situate on the Southerly side of the North East Branch of Susquehanna River opposite the North of Oswego Creek containing One thousand Eight hundred and Sixty-six acres besides the usual allowance of 6 p Cent. Surveyed for the Honorable the Proprietaries In pursuance of a Special Order Sepr. 21st 1773, and their Warrant Dated the 27th of Sepr. 1773 for 10,000 ac.
To JOHN LUKENS, EsqR., }
Surveyr. Genl. }

by CHAS. STEWART, Dy. Surv.

THE INDIAN LANDING.



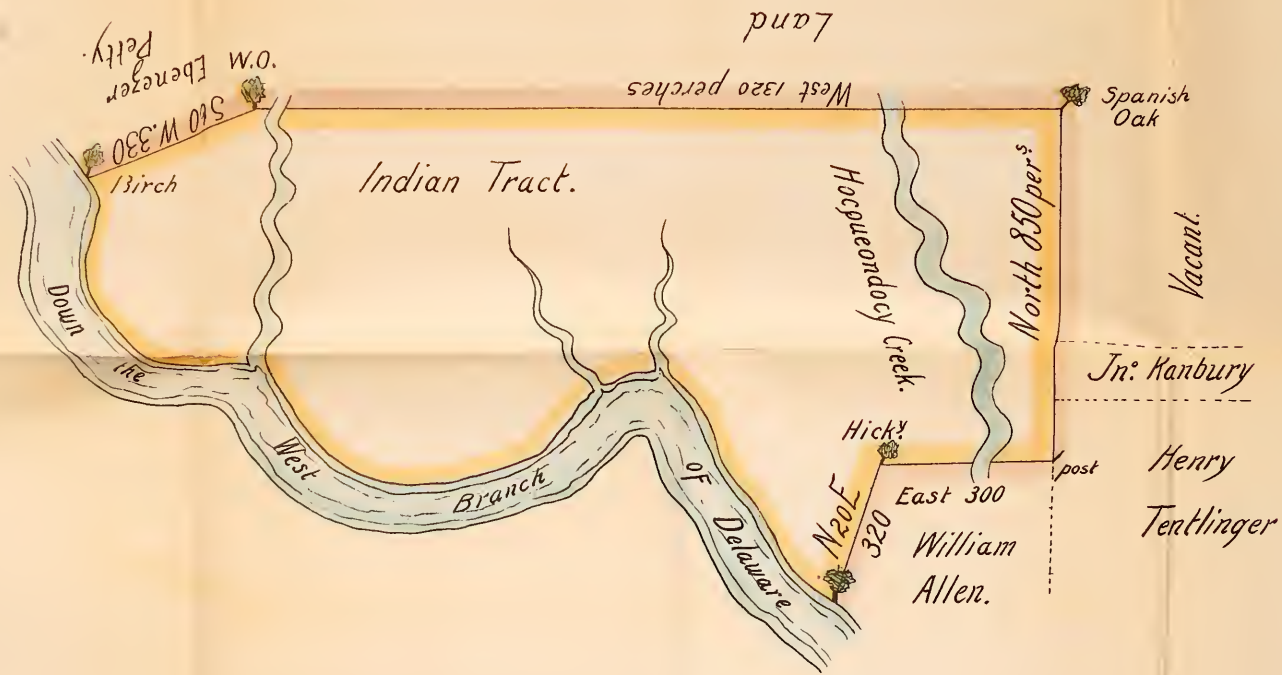

By Virtue of a Warrant dated the 31st day of December 1733. Survey'd the 24th day of June 1735 to the Honorable the Proprietaries the above described Tract of Land Situate on the Forks of Delaware in the County of Bucks containing six thousand five hundred Acres & allowance of 6 p. Cent. Taken from the Field Works of Nicolas Scull deceased.

P. JAMES SCULL.



The following is a list of the names of the streets in the town of Kittanning, Pa., as they appear on the map of the town of Kittanning, Pa., as published by the Kittanning, Pa., Map Co., in 1880.

1. Chestnut St.
2. Market St.
3. Main St.
4. Broadway St.
5. Washington St.
6. Adams St.
7. Franklin St.
8. Jefferson St.
9. Madison St.
10. Monroe St.
11. Taylor St.
12. Van Buren St.
13. Delaware St.
14. Pennsylvania St.
15. Maryland St.
16. Virginia St.
17. North Carolina St.
18. South Carolina St.
19. Georgia St.
20. Florida St.
21. Alabama St.
22. Louisiana St.
23. Mississippi St.
24. Arkansas St.
25. Missouri St.
26. Illinois St.
27. Indiana St.
28. Ohio St.
29. Kentucky St.
30. Tennessee St.
31. West Virginia St.
32. Maryland St.
33. Delaware St.
34. Pennsylvania St.
35. New Jersey St.
36. New York St.
37. Connecticut St.
38. Rhode Island St.
39. Massachusetts St.
40. Vermont St.
41. New Hampshire St.
42. Maine St.
43. New Brunswick St.
44. Nova Scotia St.
45. Prince Edward Island St.
46. Newfound Land St.
47. Newfoundland St.
48. Labrador St.
49. British Columbia St.
50. Alberta St.
51. Saskatchewan St.
52. Manitoba St.
53. Ontario St.
54. Quebec St.
55. New Brunswick St.
56. Nova Scotia St.
57. Prince Edward Island St.
58. Newfoundland St.
59. Labrador St.
60. British Columbia St.
61. Alberta St.
62. Saskatchewan St.
63. Manitoba St.
64. Ontario St.
65. Quebec St.



The Kittinging, Surveyed for the use of the Honble. Proprietaries on the 30th Day of March 1700.
 Containing Three thousand Nine Hundred and Sixty Acres & the usual allowance of Six p Ct. Situate
 on the East side of the Alleghany River about thirty-five Miles above Fort Pitt in Cumberland County
 By warrant of the 23rd Day of Feby 1700.
 To JOHN LUKENS. ESQR. }
 S. Genl. }
 p JOSHUA ELDERS. D S







By Virtue of a Warrant bearing date the 25th Day of November 1748. Surveyed the 22d day of October 1751 for the
 use of the Honourable the Proprietaries the above described tract of Land Situate within the new purchase in the County
 of Bucks Containing Twelve Thousand one Hundred and fifty acres beside the usual allowance of Six p Cent for Roads &c.

EDWD. SCULL.



LETITIA AUBREY.

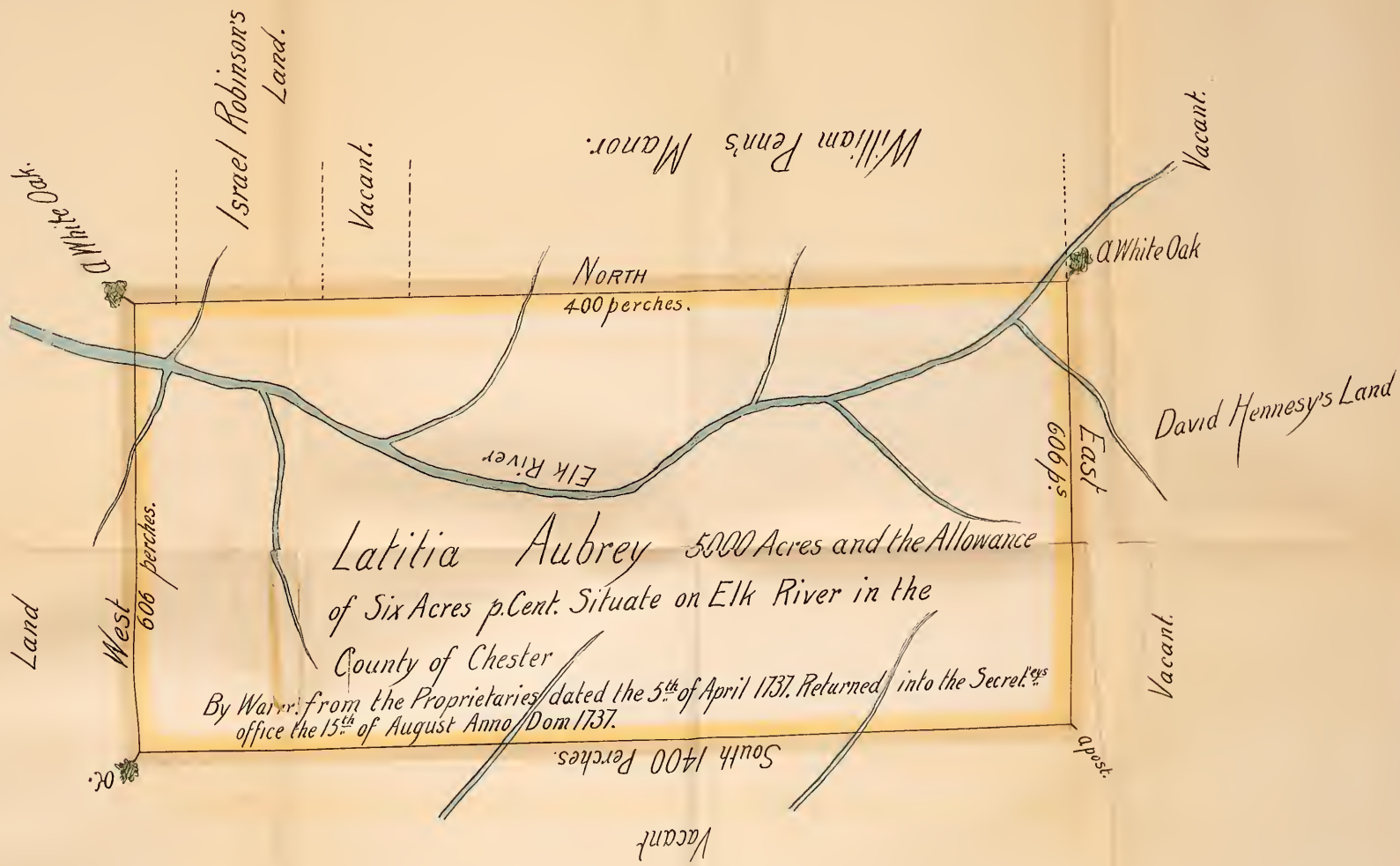

1400
606
8400
84000
8/4840/302½



This Tract is in general
Good farming land

A Draught of a Tract of Land Situate on the North Side of Franks Town Branch, A Branch of Juniata River and Between Little Juniata and the Canow Mountains in Cumberland County, Containing Five Thousand Nine Hundred and Thirteen Acres and the usual Allowance of Six Per Cent for Roads. Surveyed for the Honourable the Proprietaries November the Tenth Anno Domini one Thousand Seven Hundred & Sixty Two.
In pursuance of the Honourable the Proprietaries Warrant Bearing Date the thirteenth Day of October Anno Domini one thousand Seven Hundred and Sixty

To JOHN LUKENS
Surveyor General.

JOHN ARMSTRONG
D. S.



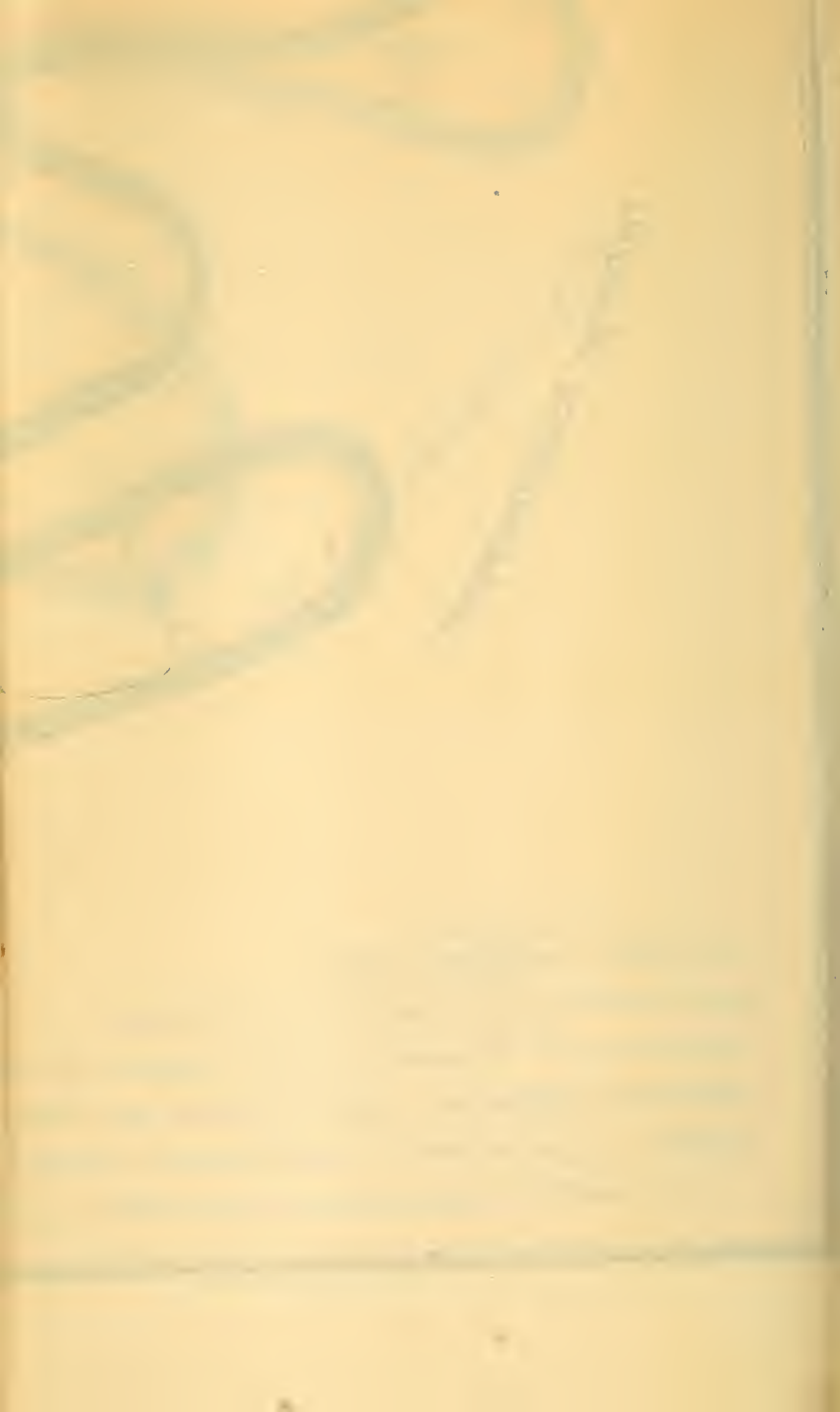

PART OF MARYLAND

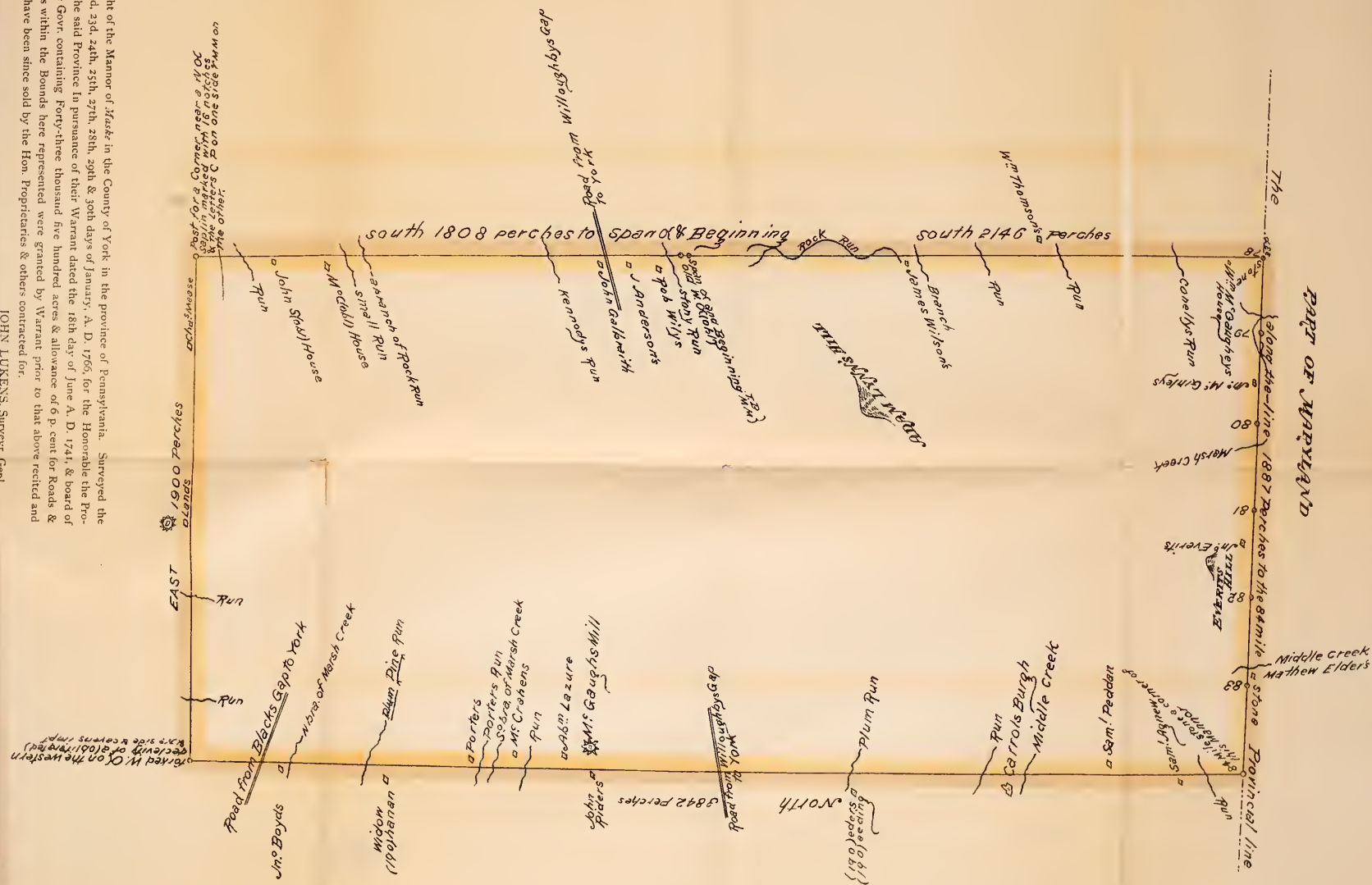

A Draught of the Manor of *Maste* in the County of York in the province of Pennsylvania. Surveyed the 17th, 18th, 22d, 23d, 24th, 25th, 27th, 28th, 29th & 30th days of January, A. D. 1766, for the Honorable the Proprietaries of the said Province In pursuance of their Warrant dated the 18th day of June A. D. 1741 & board of his Honor the Govr. containing Forty-three thousand five hundred acres & allowance of 6 p. cent for Roads & Several Tracts within the Bounds here represented were granted by Warrant prior to that above recited and sundry tracts have been since sold by the Hon. Proprietaries & others contracted for.

JOHN LUKENS, Surveyr. Genl.





Pursuant to an order of the Board of Property
to me directed Bearing date the 1st day of
April 1776. I have caused the Proprietaries
Manor of Muncy to be divided as above set
Forth and described.



A Draught of the Honorable the Proprietaries Manor of Muncy in the county Northumberland with the divisions therein made as above represented divided the fifth day of May 1776. In pursuance of His Honor the Governors order dated the first day of April 1776. Viz: No. 1 Containing Three hundred acres and 139 perches and an allowance of six pt. cent. etc. settled on and improved by Mordcai McKinnery; No. 2 Containing two hundred and ninety-nine acres and an allowance as aforesaid, settled on and improved by Peter Smith and Paulus Sheep; No. 3 Containing Three hundred acres and 76 perches & allowance, etc. allowance as aforesaid, settled on and improved by John Brady; No. 4 Containing Three hundred acres and 61 perches & allowance etc. Settled on and improved by Caleb Knapp. No. 5 Containing Three hundred and one acres & 105 perches and allowance etc. Settled on and improved by John Scutter, who is dissatisfied with the manner in which it is laid out alleging there is not Timber sufficient on it for fencing etc. and desires his lot may be laid out agreeable to the Red Lines which contains Two hundred and fifty-four acres & 74 perches and allowance etc. Which would greatly lessen the value of the Lot, Brady possesses. The S 30 E. Line runs thro a part of Brady's improvements & takes near all the tall Timber from Brady's Lot that is on the south side of the Glade run: So that upon the whole we judge it most convenient & to the General advantage of the Plantations that the black line should remain as the Boundary between Brady & Scutter we have Therefore laid down Scutter's complaint that it may be judged of by his Honor the Governor. It is by no means convenient that any of the Plantations should cross the creek as the Banks on the north side are high and the Creek in time of Freshes flows so very considerable that it is thereby rendered impassable for several days. It is Settled on and improved by Jerome Vanest and John Young as described in the Draught & ca in Young's improvements thirty acres and in Vanest's sixty-seven acres.

To JOHN LUKENS ESQ. }
Surveyor General.

JOHN J. WALLIS }
JNO. HENDERSON.

Open Business
1877

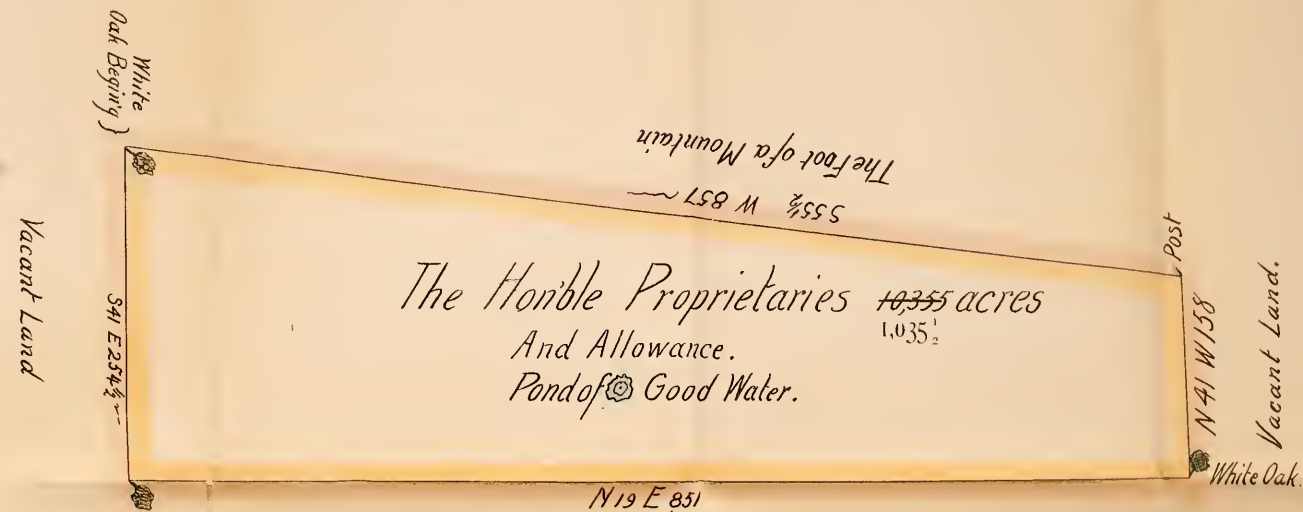

To John Lukens Esq. S. Gen.
of the province of Pennsylvania.

Open Barrers without Timber.

The Draught of a Tract of Land situate near the Indian Path leading from the Head of Penn's Creek to old Frankstown Where the waters seem to turn to Little Juniata in the County of Cumberland containing One thousand thirty Five acres one hundred Perches with the usual allowance of Six Acres p cent. Survey'd the 23d and 24th Day of September Anno Dom: 1766 For the Hon'ble Proprietaries In Pursuance of a Warrant Bearing Date at Philad'a the 11th Day of Decemler Anno Dom: 1763.
by WM. MACLAY, D. S.

The first of these is the
 fact that the number of
 cases is increasing rapidly
 and that the mortality rate
 is also high. This is due
 to the fact that the disease
 is highly contagious and
 that the incubation period
 is very short. The disease
 is also very fatal and
 the mortality rate is high.
 This is due to the fact that
 the disease is highly
 contagious and that the
 incubation period is very
 short. The disease is also
 very fatal and the mortality
 rate is high. This is due
 to the fact that the disease
 is highly contagious and
 that the incubation period
 is very short. The disease
 is also very fatal and the
 mortality rate is high.

N. 10 W. 3

Widow Arr

Land.

om
Chasit

James

Pot's
Land.





1400
 606
 8400
 84000
 8/48406/302½

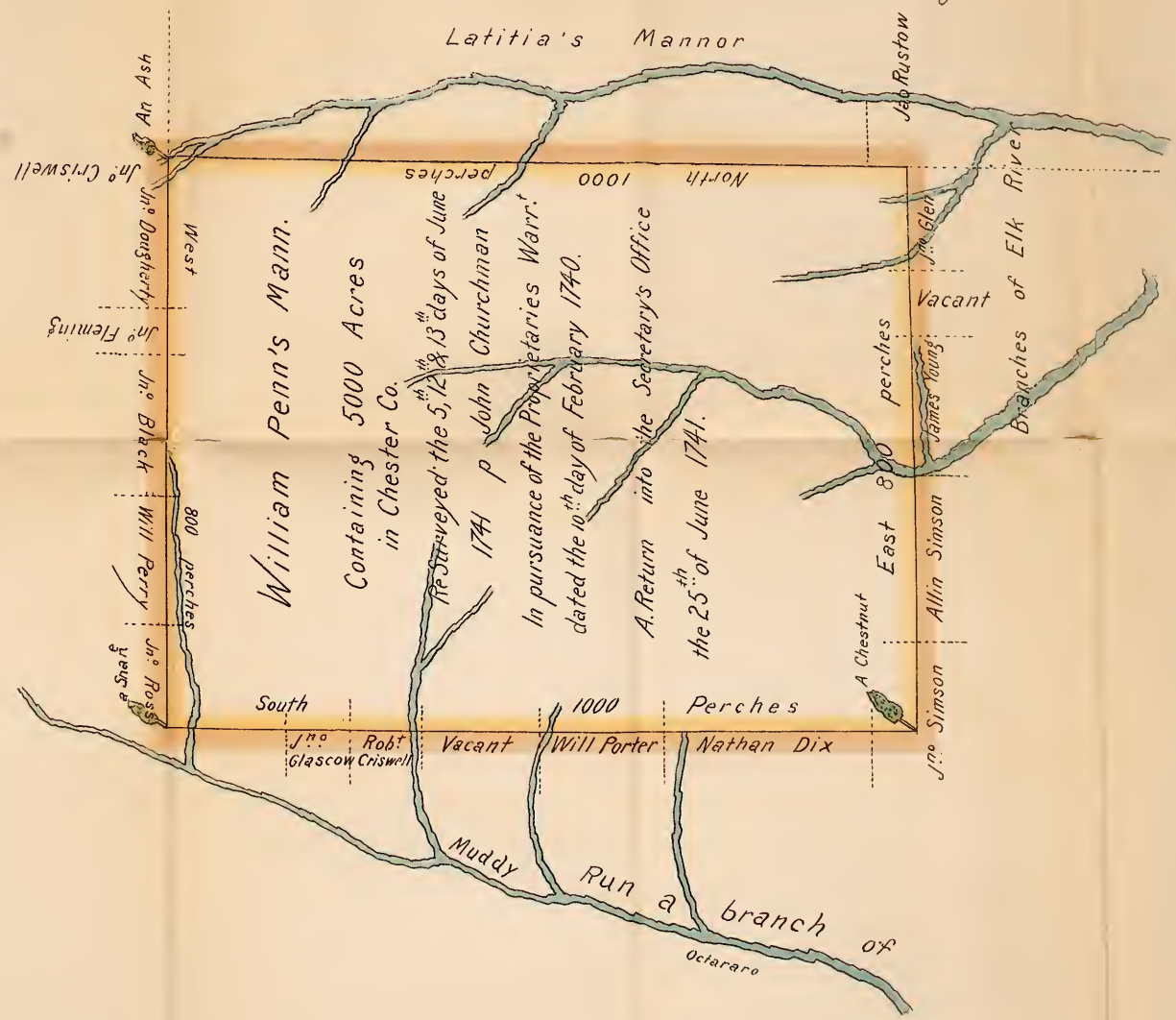

- A List of the Names of Those that are Settled on W. Penn's Manor
- | | |
|---------------|-------------------|
| Jno. Glen. | Jno. Dougherty. |
| Jas. Young. | Widow John. |
| Jno. Simson. | Jno. Scott. |
| Jno. Glasgow. | Robt. Criswell. |
| Jno. Ross. | Willm. Armstrong. |
| Will. Penn. | Hugh Miller. |
| Jno. Black. | Robt. Lunnar. |
| | David Fleming. |
| | Andrew Sim. |
-
- | | |
|--------------------|--------------------|
| Chals. Hedges. | Archie. Blackburn. |
| James Purtle. | Joseph Smith. |
| Jno. Beard. | Thomas Charlton. |
| Robt. McKee. | |
| Stephen Cornelius. | |





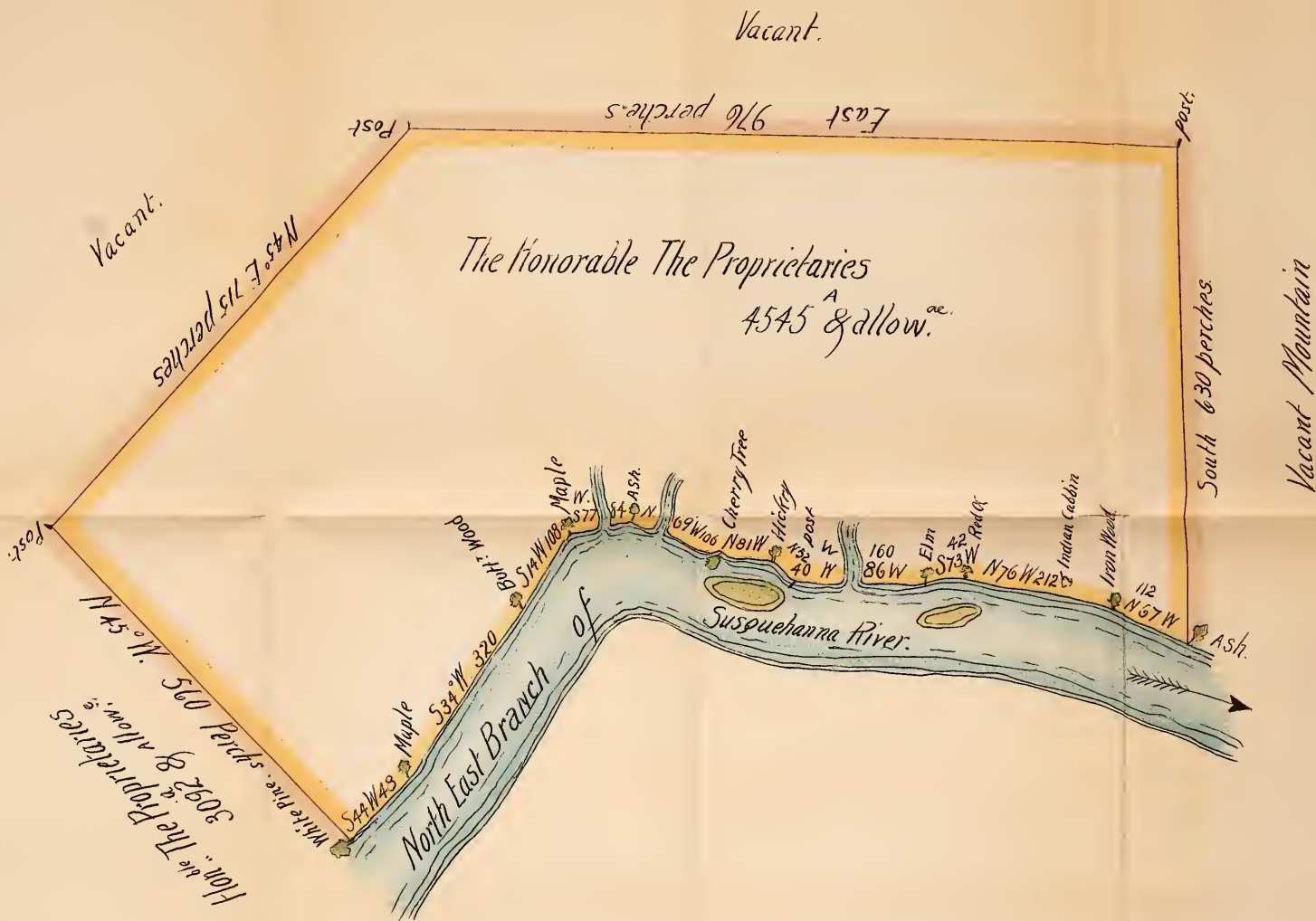

A Draught of a Tract of Land Called, "Pine Grove" Situate on the South East Side of the North East branch of Susquehanna River Beginning at a White Pine Tree Standing on the Bank of the River and marked for a corner to a Tract of 3092 ac. Surveyed for the Honorable The Proprietaries Then Running down the River side One thousand three hundred and eighty-four perches to an Ash Tree marked for a Corner On the aforesaid Bank Thence running South 630 perches to a post thence East 976 ps to post thence to North East 715 perches to a post Thence North West 560 along a Line of the said 3092 Acres To the Beginning Containing four thousand five hundred & forty five Acres besides the usual allowance of 6 p Cent for Roads &ca Surveyed In Pursuance of a Special Order the 22d & 23rd Day of September 1773 For the Honorable The Proprietaries And in part of a Warrant for Ten Thousand Acres, dated the 27th of September A. D. 1773.

To JOHN LUKENS, ESQR. by CHAS. STEWART, Dr. Surv.

[Faint, illegible handwriting, possibly bleed-through from the reverse side of the page.]





A Draught of a Tract of Land Situate South West of Proctor's Improvement and on the Waters of Swickley in the County of Cumberland containing Five Thousand Five Hundred & Sixty-eight acres and the allowance of Six Acres p. Cent for Road and Highways. Surveyed the Twenty-third day of April 1770 for the Use of the Honorable the Proprietaries in pursuance of a Warrant bearing date the 22d day of February 1769.

To JOHN LUKENS ESQ. }
Surv'r. General.

WM. THOMPSON, Dy. Sr.

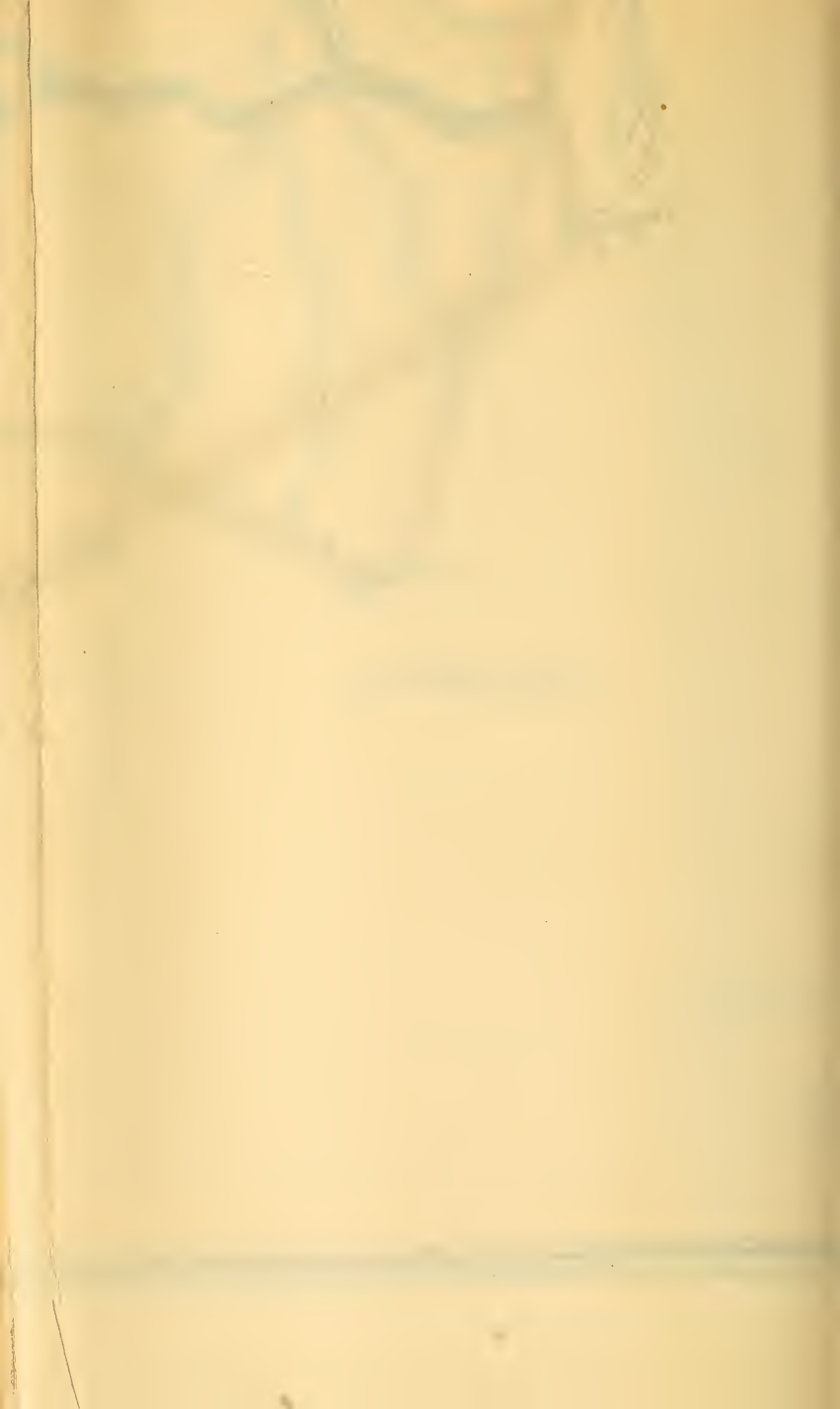





A Scale of perches 240 In an Inch

The Proprietaries Manor of Perkasié as Surveyed by John Chapman Anno 1730 is contained in the figure A. B. C. D., within the prick'd lines as by Tho: Fairman; is contained within the Red lines by the figure A. B. C. D. wh. contains 11,462 ac the greater part thereof has been since taken up in other Rights Viz: the figure D. F. C. D. wh. contains 6031 ac. wh. includes part of a Tract formerly called by the feigned name of Col. Mildmay's.



PITTSBURGH.





A Draught of a Tract of Land, situate on both sides of the Monanghehela River and on the South east side of the Alligeny River in the County of Cumberland, including Fort Pitt and the town of Pittsburg bounded and described as follows, Viz. Beginning at a marked Spanish oak standing on the South side of the Monanghala River Thence south 800 perches to a marked Hickory Thence West 150 perches to a marked White oak thence N 35 W 144 perches to a marked White oak thence West 518 perches to a marked White oak thence North 758 perches to a post thence East 60 perches to a Post thence N 14 E 218 perches to a White Walnut at the mouth of the Sawmill Creek on the Ohio River thence up the Ohio River S 62 E 212 perches to a White Walnut opposite the point thence crossing the Monanghehela River and up the South East side of the Alligeny River N 71 E 377 perches N 49 E 212 N 39 E 74 and N 50 E 99 ps. to a Spanish Oak on the said River thence by Mr. Croghans claim S 60 E 240 perches to a marked Sugar tree and S. 85 E 192 perches to a marked Sugar tree thence by Vacant land S. 18 E 236 perches to a marked White Oak thence by Barrens S 40 W 150 perches to a marked White oak thence by Sam Sample's Improvement West 192 perches to a marked Hickory and S 65 W 74 perches to a marked Red oak on the North side of the Monanghehela River thence crossing said River S 78 W 308 perches to the place of Beginning Containing Five thousand seven hundred & sixty six acres and the allowance of six acres p. cent. for roads & highways. Surveyed the 27th day of March 1769 for the Honble Thomas Penn & Richard Penn Esqs. True and absolute Proprietaries of the Province of Pennsylvania in pursuance of a Warrant bearing date the 5th day of January 1769.

To JOHN LUKENS, Esqr., }
 Survr. Genl. }

WM. THOMPSON, Dy. Surv.





PROPRIETARIES TRACT CALLED PLEASANT GARDEN



By Virtue of a Warrant dated the 31st day of May 1776 and surveyed from the 6th to the 12th of July 1776, to the Honorable the Proprietaries, the above tract of land Situate on the Waters of the Lechawaxin Creek on the Head Waters of Big Middle Creek in Northampton County containing Eleven thousand five hundred and twenty-six acres three quarters and the allowance of six p cent. &c.

To JOHN LUKENS, Esquire, }
Surveyor General.

P. GEO. PALMER, D. S.

The following is a list of the names of the persons who have been
 named in the report of the committee on the subject of the
 proposed amendment to the constitution of the State of New York.
 The names are given in the order in which they were named in the
 report.

[Faint, illegible text, likely bleed-through from the reverse side of the page.]



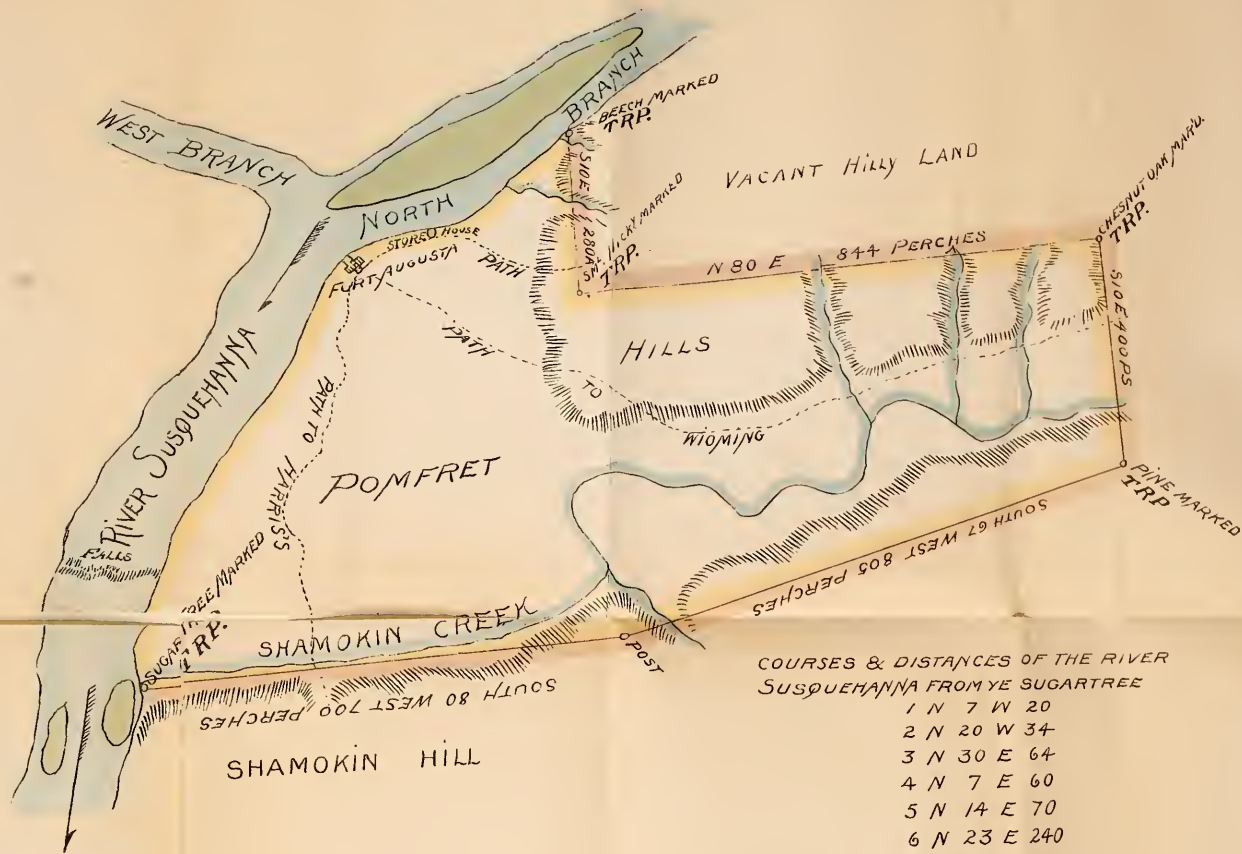

COURSES & DISTANCES OF THE RIVER
SUSQUEHANNA FROM YE SUGARTREE

- 1 N 7 W 20
- 2 N 20 W 34
- 3 N 30 E 64
- 4 N 7 E 60
- 5 N 14 E 70
- 6 N 23 E 240
- 7 N 32 E 60
- 8 N 15 E 200
- 9 N 23 E 24
- 10 N 46 E 54
- 11 N 70 E 101
- 12 N 75 E 21
- 13 N 5^(W) 34
- 15 N 48 E^(W)
- 15 N 39 E^(W)
- 16 N 35 E^(W)
- 17 N 39 E^(W)
- 18 NORTH EAST TO

YE BEECH 8 P.

N.E. OF SMALL RUN.

By Virtue of a Warrant dated the 29th Day of October 1768. Surveyed the 19th Day of December 1768. To the use of the Honorable the Proprietaries of the Province of Pennsylvania. The above described tract of land situate at Shamokin on the River Susquehanna, containing Four Thousand Seven hundred and sixty-six acres of land and allowance of six p. cent.





ADDED BY [unclear]
1858

MANOR OF RICHLAND.



Pursuant of a Warrant from the Honourable the Proprietaries dated the 5th day of March 1734, for the more certain finding out and fixing the lines and bounds of their Manour of Richland. I have run the lines of the said Manour Beginning at a post being a corner of a tract of land laid out to Griffith Jones dect'd thence West 230 perches to a White Oak thence North 1920 to a cypress, thence East 1920 to a small Black Oak Sapling thence South by the said Jones's tract 840 perches to a post in a line of James Logan's Land thence by that and land of Joseph Gilbert South 480 perches thence West 8 perches, thence 1735 by

Note that all the surveys within the above Manour were made by John Culter & John Chapman late Surveyors of the County of Bucks.
N. B. the Vacancies in the manour are Described by Pricked lines.

The Manour Contains
the lands Surveyed within the Mannours by the
Several returns of the same. { 5,736 as.
The land yet unsold within the Mannours is Com- { 10,577 as.
puted to be

Short of the Quantity Contained in the Manour

16,313 as.
436 as.

By the above Accont it appears that taking the Several tracts Surveyed within the Manour together, the quantity added to the Vacancy will not make the quantity Contained in the Manour by 436 as, which defect by Presumd arisen from to large measure in those Surveys.

RUSCOMBE.



In Pursuance of a Verbal Order from the Hon^{ble} the Proprietor Surveyed the 26th day of July, 1739 the above described tract of land, situate between Oley and Maiden Creek in the county of Philad'a. Containing 10,000 acres with allowance of six p. Ct.
 Surveyed by NICH'S SCULL.



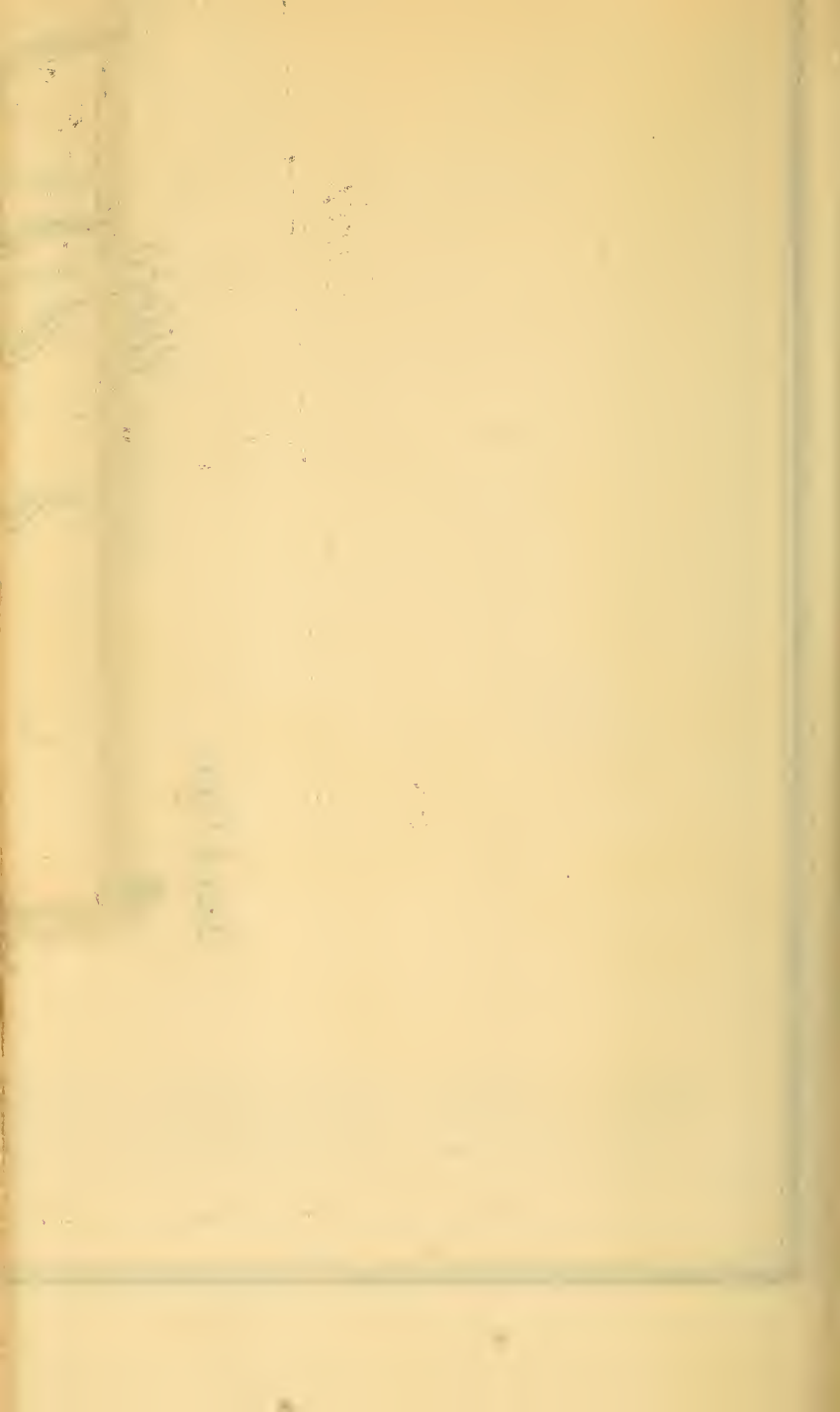



1876

A Draught of a Tract of land Called "St. David's" Situate on the Easterly Side of the North East Branch of Susquehanna River Beginning about two Miles below the Mouth of Owego & Extending in front along the North East Branch One thousand and twelve perches to a White Pine mark'd on the River bank Thence running South East five hundred and sixty perches Thence North thirty four degrees and forty-five minutes east nine hundred and three perches to a Corner Thence North West four hundred perches to two Pine Trees and a small Red Ok Tree Standing on the Bank of the River afore'd. Containing within the boundaries thereof the quantity of three thousand and ninety two Acres besides the usual allowance of 6 p. Cent for Roads &ta. Surveyed the 22d Day of Sepr. 1773 For The Honorable the Proprietaries In Pursuance of a Special Order and In part of a Warrant for Ten Thousand Acres dated 27th Sepr. 1773.

To JOHN LUKENS, ESQR.,
Surveyr. General. }

by CHAS. STEWART, Dy. Sur.

Vacant.

N. 34° 45' E 903 Perches.



The Honorable
The Proprietaries.

The Honorable The Proprietaries.
3092 + Allow.

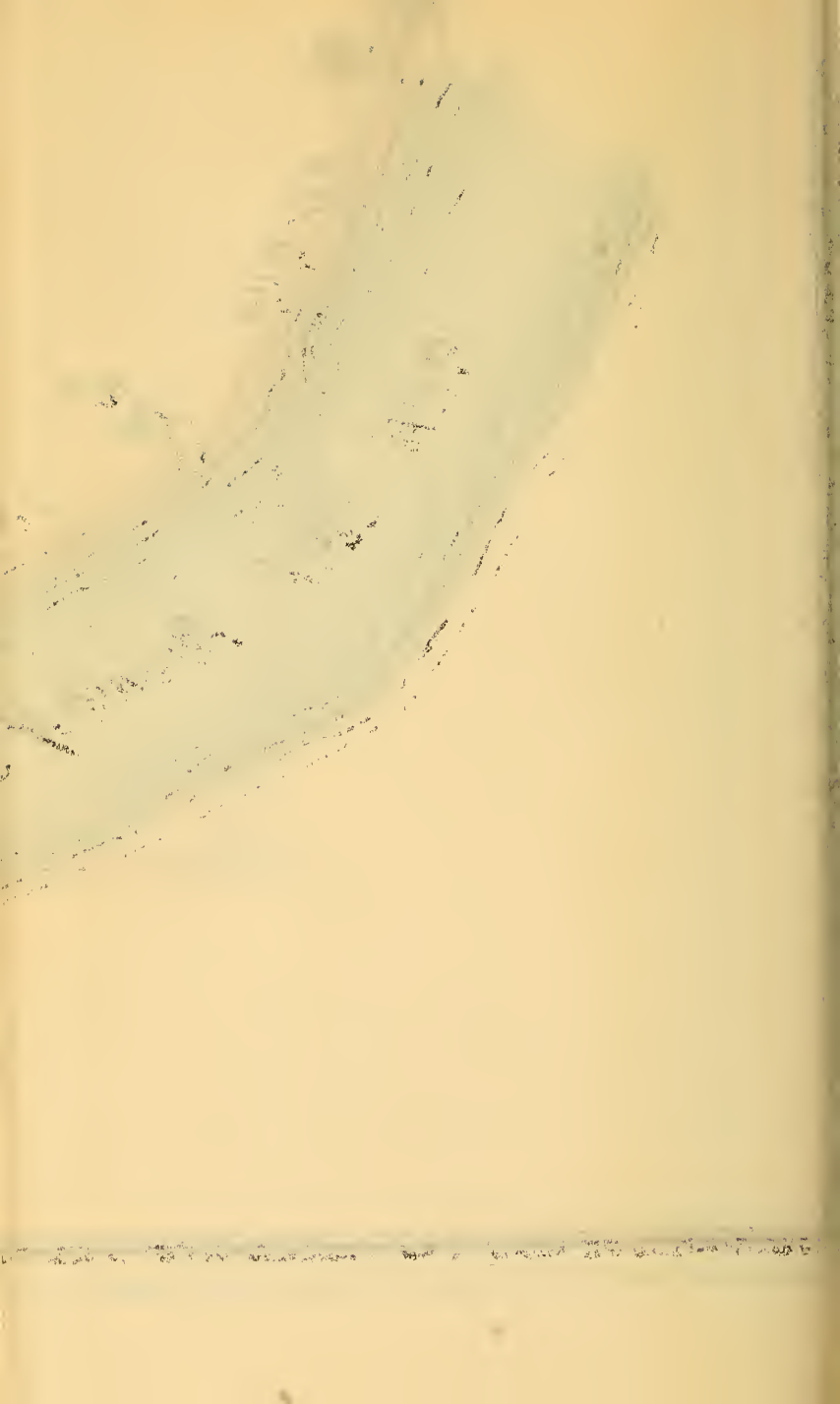

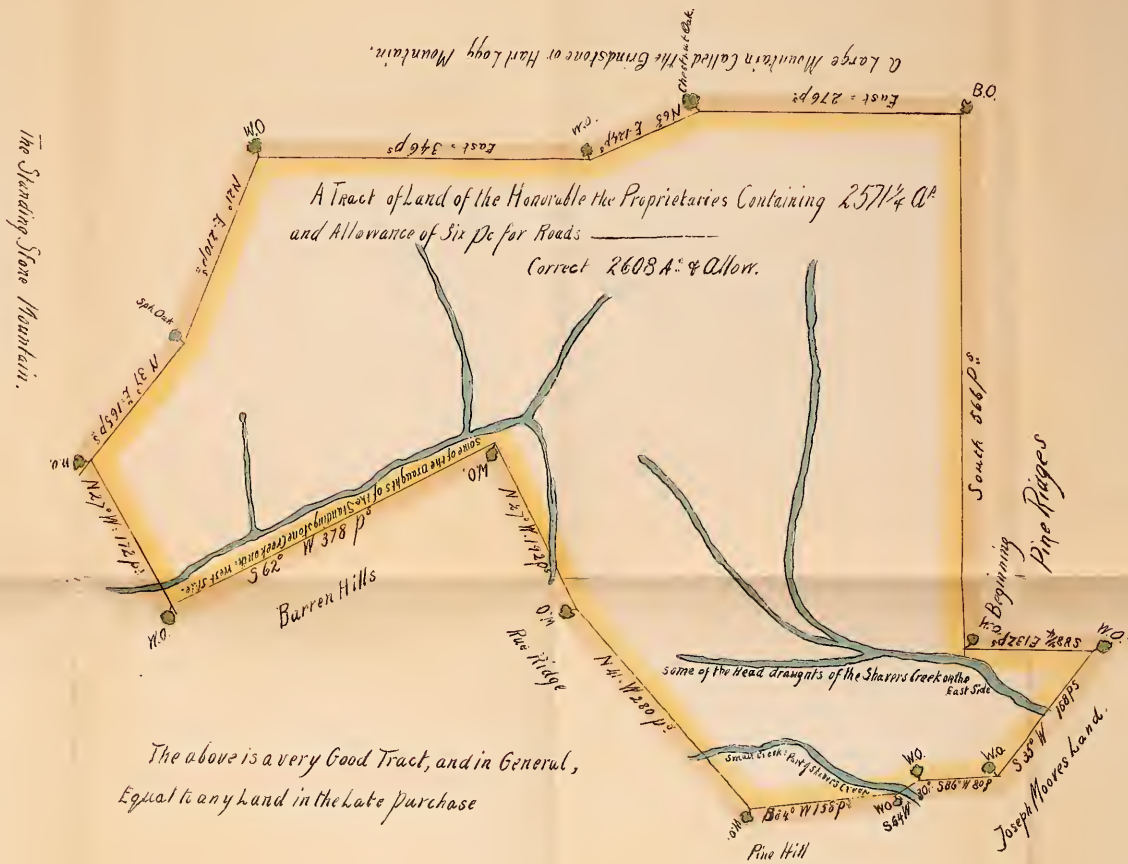

A Draught of a Tract of Land Situate on the North Side of Franks Town Branch, a Branch of Juniata River and Between part of the Head Draughts of the Standing Stone Creek; and on some of the Draughts of Shavers Creek, in Cumberland County Containing Two Thousand Six Hundred and Eight Acres and the usual Allowance of Six Pr Cent. For Roads—Surveyed for the Honourable the Proprietaries November the fifth day, one Thousand Seven Hundred & Sixty Two. In Pursuance of the Honourable the Proprietaries Warrant Dated the thirteenth Day of October Anno Domini one thousand Seven hundred and Sixty.

To JOHN LUKENS }
Surveyor General }

JOHN ARMSTRONG,
D. S.

SINKING VALLEY.



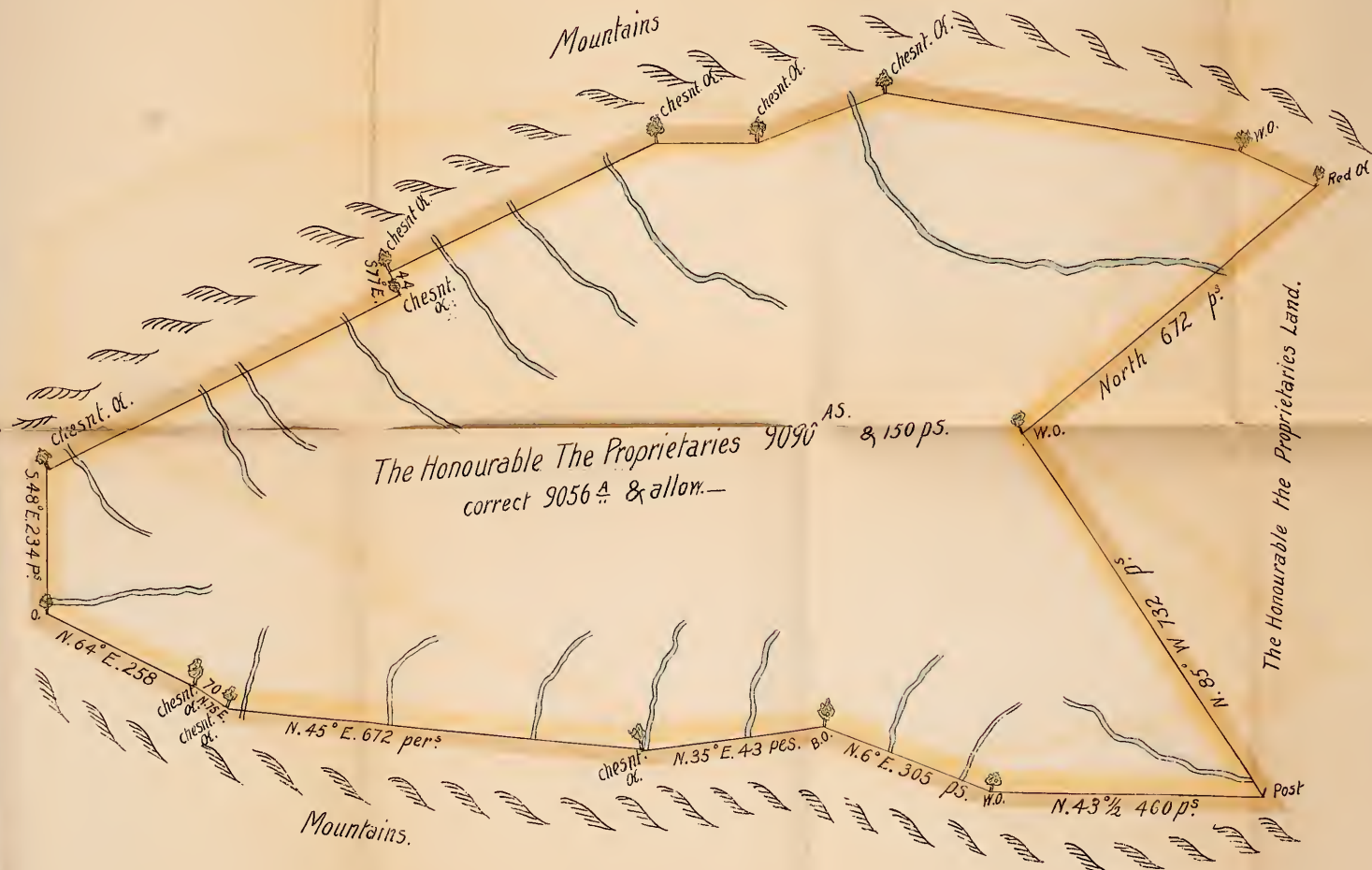

The Honourable The Proprietaries 9090 AS. & 150 ps.
 correct 9056 A & allow. -

A Draught of a Tract of Land Situate in Sinking Creek Valley about Eight Miles Northwest of Waterstreet in Cumberland County Containing Nine Thousand and fifty six acres, and the Usual Allowance of Six p Cent. Roads, Surveyed for the Honorable the Proprietaries in December 1762 in pursuance of a Warrant bearing date the thirteenth Day October Anno Domini one Thousand Seven Hundred & Sixty.

To JOHN LUKENS }
 Surveyor General. }

JOHN ARMSTRONG, D. S.

the above Tract is generally well timbered, the greater part of the Soil good, and the Water Sinks nearly as represented in the Draft; an inconvenience to which Limbstone lands mostly subjected. V: A:



In pursuance of a warrant of resurvey under the hand of James Hamilton Esqr. Lieut. Governor of the Province of Pennsylvania and the Seal of the Land Office dated the 21st day of May 1762, authorizing and requiring me to resurvey or cause to be resurveyed the Manor of Springetsbury in the county of York. These may certify that on the several days between the 12th & 13th days of June 1768 I did resurvey the said Manor agreeable to the annexed Draft Containing Sixty four thousand five hundred and twenty acres and the usual allowance of 6 Acres p Cent for Roads & etc. And further in pursuance of the said Warrant I did on the 1st & 2d days of July 1768, Resurvey a certain tract of land which was surveyed by Thomas Cookson in 1741 and resurveyed by George Stevenson in 1752 situate on both sides of Codorus Creek and within the aforesaid Manor of Springetsbury & Whereon the Town York in County of York hath been laid out and since built and find the same to be bounded as follows Viz: Beginning at a White Oak tree marked for a corner of land late Bartholomew Maul now of John Hays thence by the same and land of Baltzer Spangler South seventeen degrees and three quarters East two Hundred seventy four perches and a half to a post and Stone set for a corner thence by the said Spangler's land and the lands now of James Smith & Michael Swope Esqr. & Henry Spangler South seventy six degrees and a half West one hundred and thirteen perches to a corner of Bernard Lowman's Land thence by the same North Eighty three degrees West one hundred and thirteen perches to a white oak marked for a corner near the side of Codorus Creek a little above a high point of Rocks thence crossing said high point and down obliquely over the creek North Eleven degrees West twenty six perches and Eight tenths of a perch to a hickory tree marked for a corner thence land late of Hermannsotts. North sixty six degrees and a half West two hundred and four Perches to a white oak tree marked for a corner thence by land of John & James Wright North forty three degrees and a half East one Hundred & one perches and nine tenths of a perch to a black oak tree marked for a corner thence North fifty eight degrees East one hundred & thirteen perches to a white oak stump by the side of Codorus Creek afore said thence crossing over the said creek obliquely South nineteen degrees East Twenty two perches and four tenths of a perch to a stone set for a corner, (note in which this stone is set is two bricks) thence by the said John Hays' Land North seventy one degrees East one hundred and sixty seven perches and one tenth of a perch to the first mentioned white oak and place of beginning Containing within the aforesaid bounds the quantity of four hundred and twenty one acres and thirty seven perches and the allowance of six acres p. Cent for Roads etc. or four hundred and forty six acres & a half neat measure: Returned into the Secretary's Office for the Honble. Proprietaries owned proper Use & behoof this 12th day of July Anno Dom: 1768.

JNO. LUKENS, Survey. Genl.







VACANT

LAND



By Virtue of a Warrant dated the 29th day of October 1768. Surveyed the 9th etc., days of December 1768, to the use of the Honorable the Proprietaries of the province of Pennsylvania the above described tract of land Situate at Wyoming on the South East side of the North East branch of Susquehanna River containing eight hundred acres & allowance of six p. cent.

P. WM. SCULL.





[Faint, illegible text, possibly a signature or title]

[Faint, illegible text, possibly a paragraph of a letter or document]

[Faint, illegible text, possibly a signature]



SOUTH 55° WEST 2886 PERCHES

VACANT LAND
SPRING OAK
SOUTH 30 EAST 640 PERCHES

VACANT LAND
NORTH 30° WEST 1080 PERCHES
BIRCH MARKED T.R.P.

WIOMING FALLS

LARGE LEVEL BOTTOM LAND
BIRCH
PATH FROM SHAMOKIN

MANOUR OF SUNBURY,

OLD SHAWANUNGO
A PINE HILL

STONE & COAL

WHITE OAK MARKED T.R.P.
NEAR THE MOUTH OF A RUN

COURSES & DISTANCES UP SUSQUEHANNA.

1 S 41 E	134
2 S 80 E	114
3 N 72 E	157
4 S 67 E	100
5 S 74 E	154
6 N 88 E	90
7 N 68 E	160
8 N 49 E	126
9 N 63 E	109
10 N 3 E	218
11 N 73 E	228
12 N 76 E	204
13 N 42 E	116
14 S 80 E	90
15 N 73 E	120
16 N 42 E	170
17 N 20 E	72
18 EAST	54
19 S 54 E	80
20 S 36 E	64
21 S 28 E	154
22 S 80 E	50
23 N 76 E	64
24 N 55 E	80
25 N 44 E	120
26 N 42 E	334
27 N 7 E	56
28 N 14 W	60
29 N 22 W	60
30 N 28 W	60
31 N 18 W	40
32 N 10 W	36
33 N 5 E	58
34 N 14 E	34
35 N 37 E	26

To ye White Oak.

By Virtue of a Warrant dated 29th Day of October 1768. Surveyed the 8th, 9th, etc., days of December 1768, to the use of the Honorable the Proprietaries of the Province of Pennsylvania. The above described tract of land situate on the North west side of the North east branch of the Susquehanna River, opposite the Wioming Twenty Thousand acres of land and allowance of six p. cent.

P. WM. SCULL.



Top



1. The first part of the document discusses the importance of maintaining accurate records of all transactions and activities. It emphasizes that this is essential for ensuring transparency and accountability in the organization's operations.

2. The second part outlines the specific procedures and protocols that must be followed to collect, store, and retrieve data. It details the roles and responsibilities of various staff members involved in the process, as well as the necessary resources and equipment.

3. The third part addresses the challenges and risks associated with data management, such as data loss, corruption, and unauthorized access. It provides strategies and best practices to mitigate these risks and ensure the integrity and security of the data.

4. The fourth part discusses the importance of regular backups and disaster recovery plans. It explains how these measures can help protect the organization's data in the event of a system failure or natural disaster, and provides guidelines for testing and updating these plans.

5. The fifth part concludes by summarizing the key points and emphasizing the need for ongoing monitoring and improvement of the data management process. It encourages the organization to stay up-to-date with the latest technologies and industry standards to ensure its data remains secure and accessible.



A draught of a tract of Land situate in the county of Bucks about sixty miles from Philadelphia, surveyed on the 3d of January, 1734. to the Hon'ble Thomas Penn Esq'r, one of the Proprietaries, by virtue of the two warrants from the Proprietaries dated at London the 12th day of May, 1732. Each warrant for 1000 as.

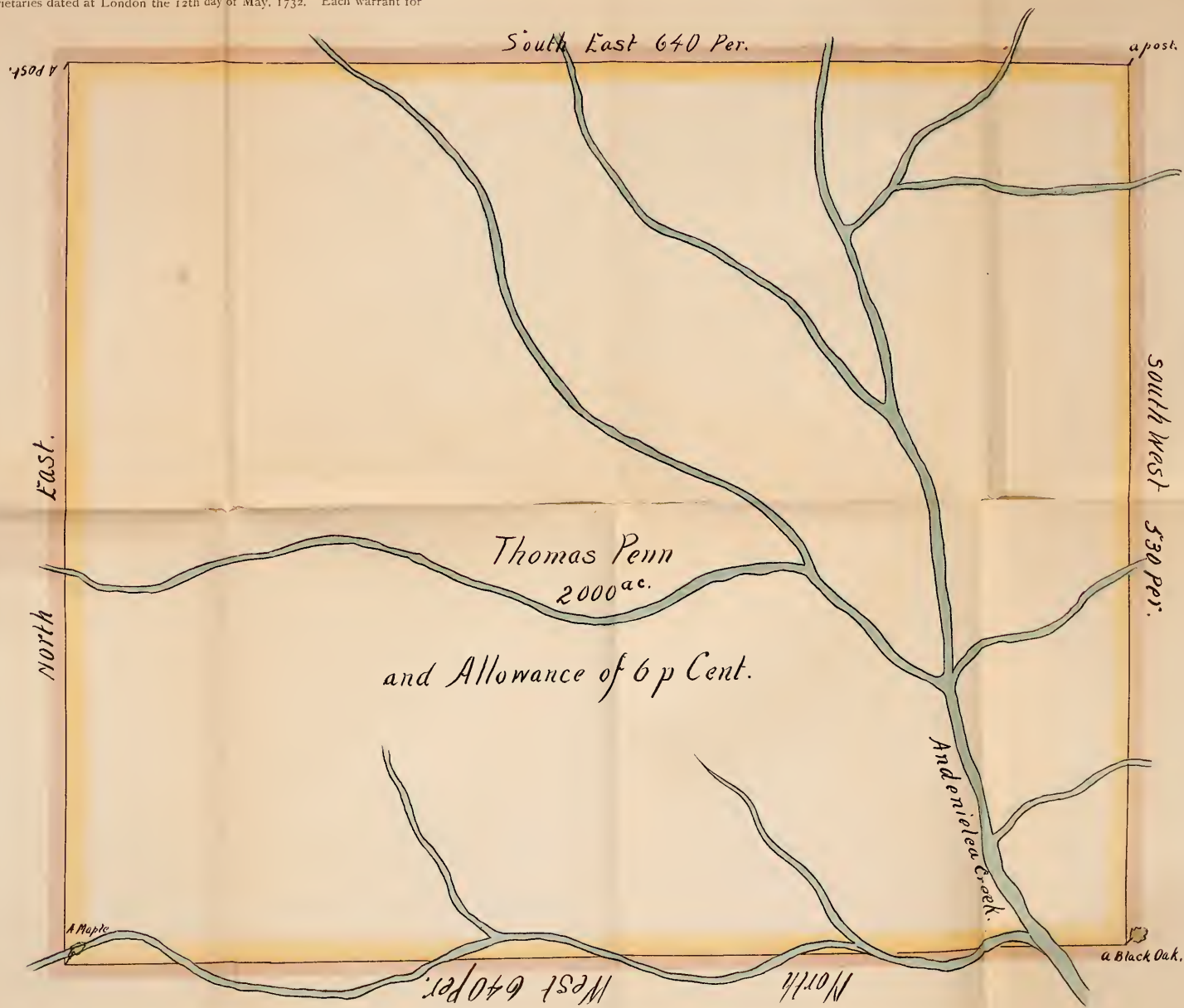



VINEYARD.

Thomas
1845

and Albion

1845-1846



[The text in this section is extremely faint and illegible. It appears to be a long passage of text, possibly a chapter or a section of a book, but the words cannot be discerned.]

Fare Mount



A Portraiture of the City
 Philadelphia
 in the Province of
PENNSYLVANIA
 in
 America
 by Thomas Holme Surveyor General.
 Sold by Andrew Sowle in Shoreditch
 London



a Bridge

Scool Kill River

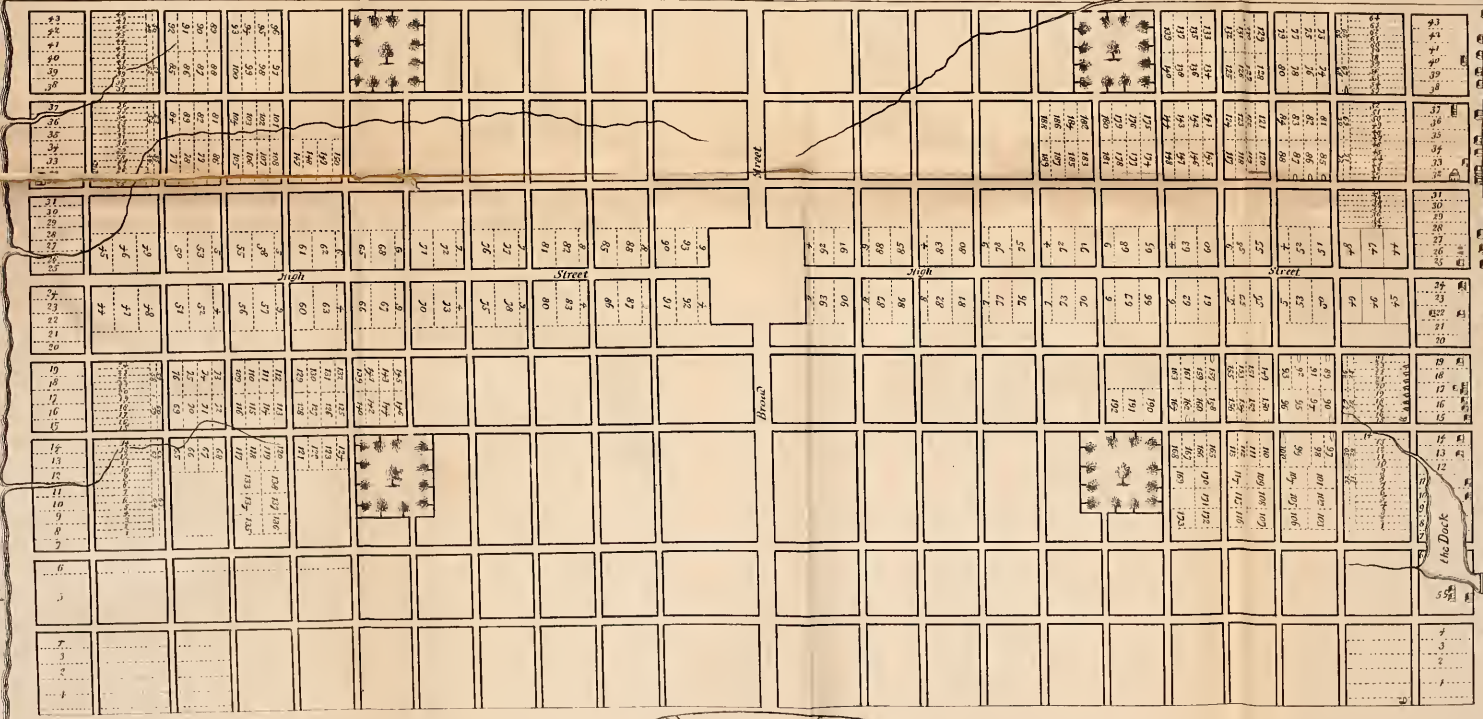

River Delaware

Jersey

New

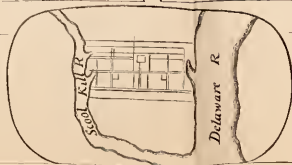







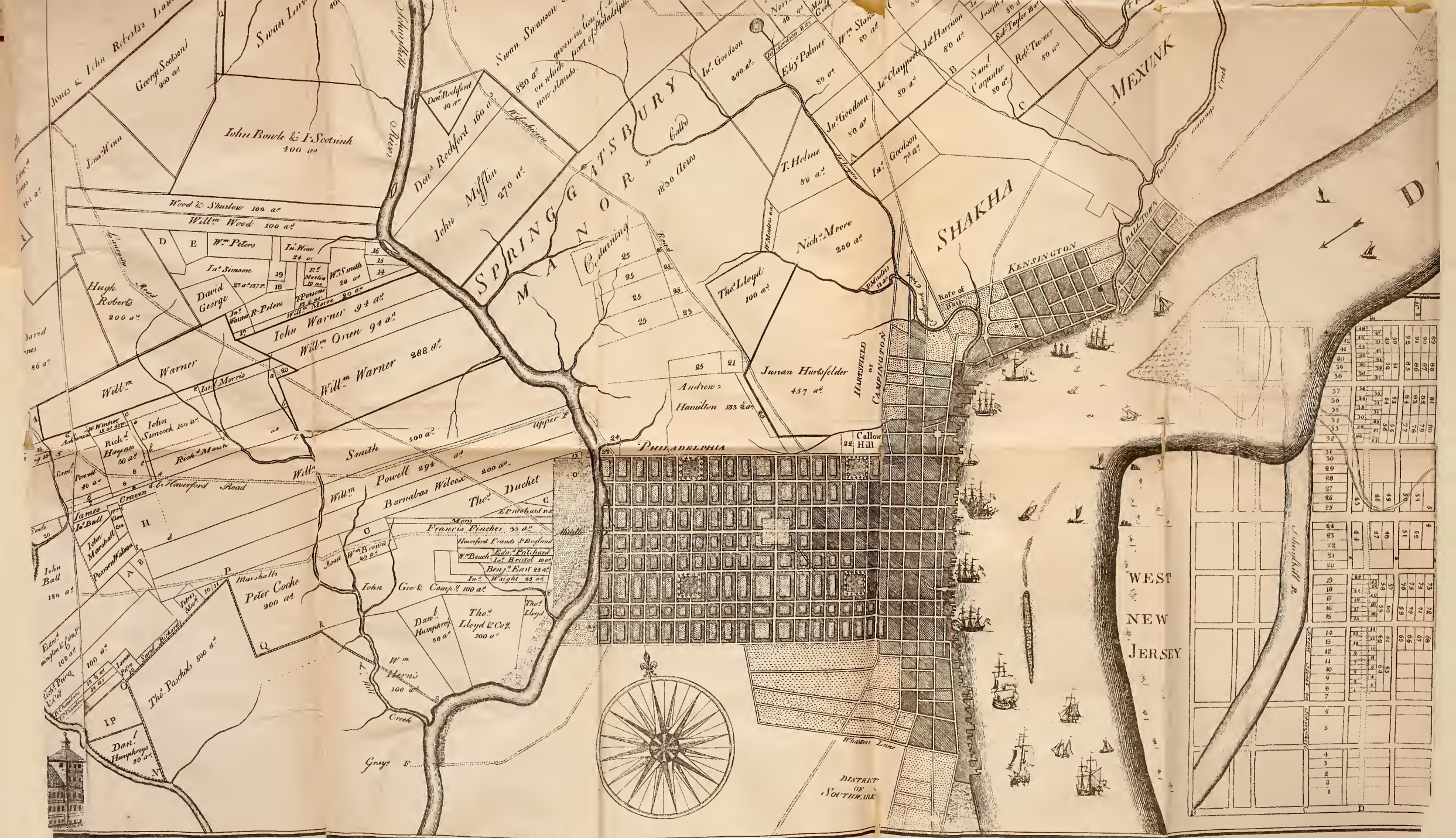

DELAWARE



State

House

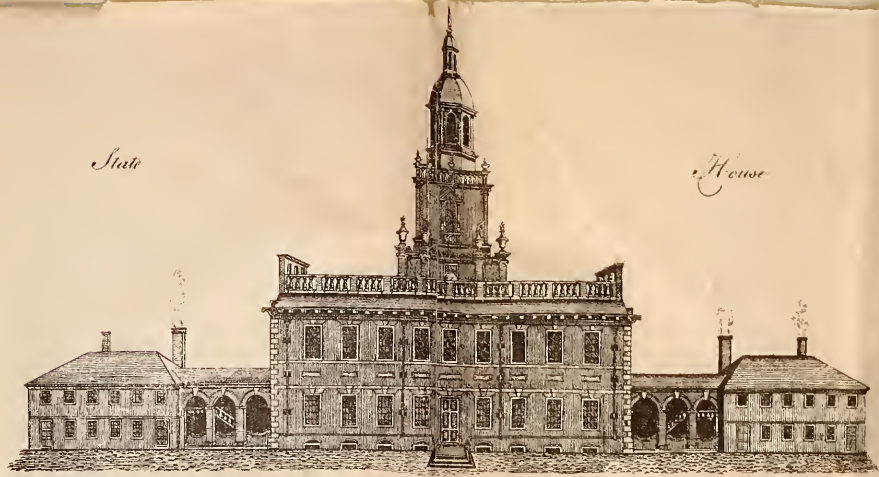

A Ground Plan of the City of Philadelphia

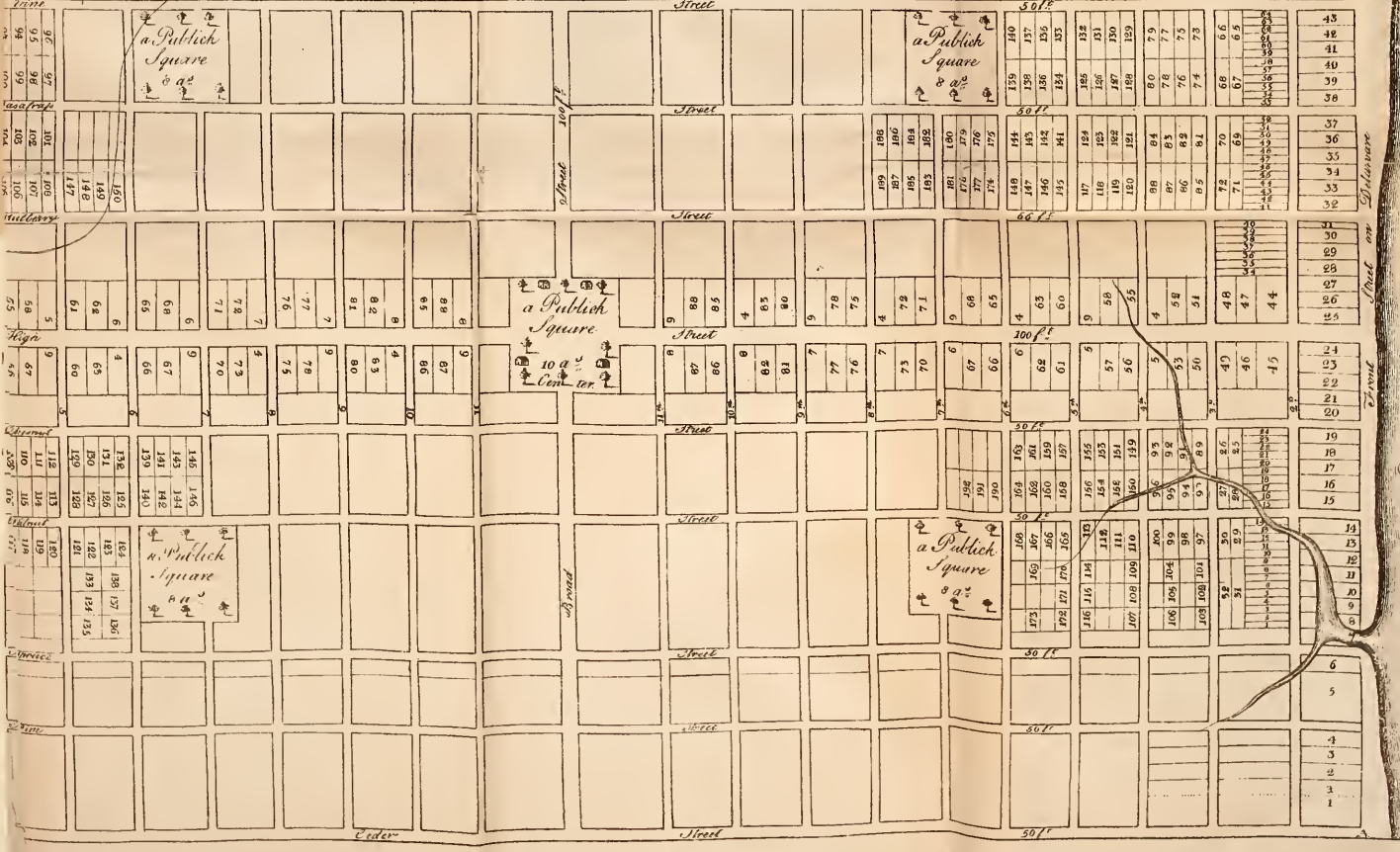

Delaware R.

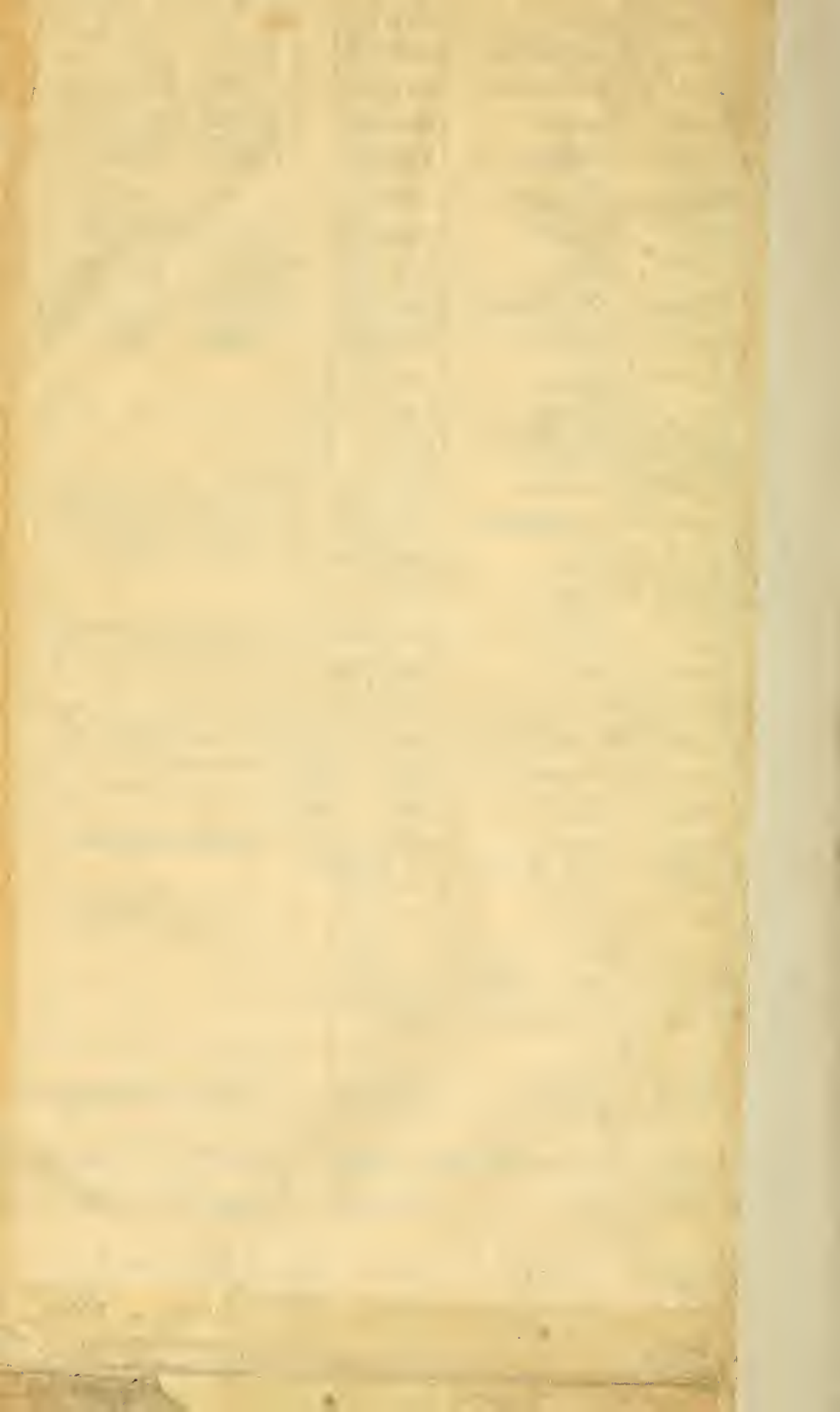





LIBRARY OF CONGRESS



0 014 223 164 5

