

At the request of Capt F.W. Wagener I have continued the red line laid down on the plat marked X-Y-Z to letter B-so as to show the division line agreed upon between Capt F.W. Wagener & The West Shore Corp. The point B being located on the land by an iron rod. Since this plat was made the location of the creek has changed. The point on the eastern line of Capt F.W. Wagener's land on this plat marked in red by letter B is nine hundred and fifty seven (957) feet from the point on Grove St marked C on this plat & which is located on the land by an iron bolt. Surveyed 1894 J.B. Myer C.E.

J. M. C. Coffin
 Charleston County S.C.
 Record 1st vol. p. 1114
 2nd vol. p. 112
 3rd vol. p. 112
 4th vol. p. 112
 5th vol. p. 112
 6th vol. p. 112
 7th vol. p. 112
 8th vol. p. 112
 9th vol. p. 112
 10th vol. p. 112

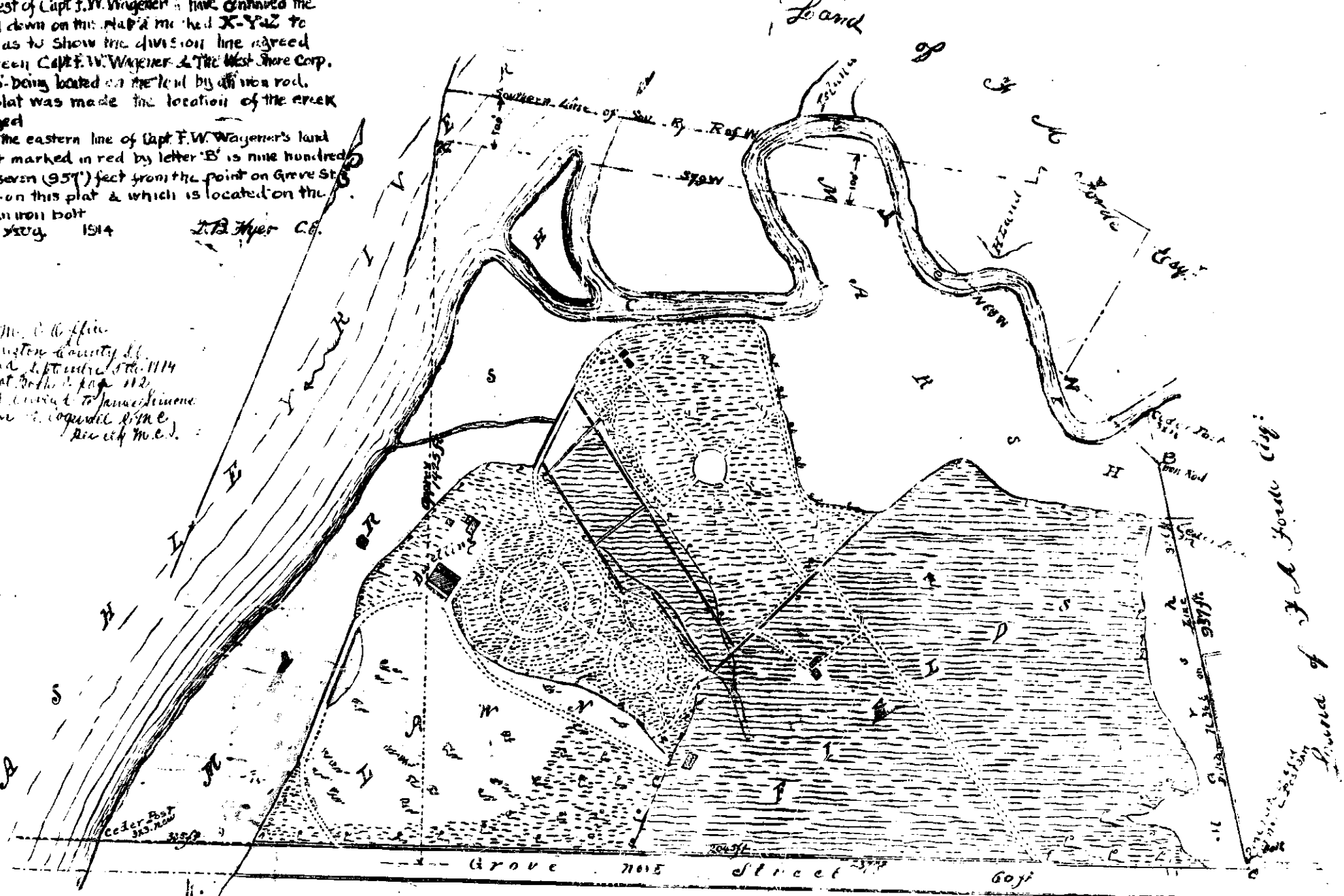

PLAN of a Farm on North River known as the GROVE

Charleston S.C. February 1st 1891.

I hereby certify that I have this day surveyed the tract of land shown by the above plat, known as Rose's Farm for J.W. Wagener & Co. and find that the lines of said farm are correctly set down on the above plat except the Eastern line which should read N 36 W instead of N 36 E. This I deem a clerical error in the plat. The old marks and boundaries are well defined.

Scale 150 ft per inch

Situate on the north side of Grove Street Ward No 8 in the City of Charleston containing in the whole Forty eight 1/2 acres of High land including gully reclaimed 522 Marsh land about to be reclaimed 154
 Belonging to Miss Amelia Rose, Miss Margaret B. Rose, and Miss Anna Maria Rose.

At the request of Capt F.W. Wagener I have placed the line X-Y-Z SURVEYED by me denoting what is to be here after the boundary line between F.W. Wagener and The West Shore Corporation north thereof. May 30 1893 J.B. Myer C.E.

The farm contains of High land including gully 62 1/2 acres. Marsh land 15 1/2 "

Louis J. Barbot
 City Engineer

Surveyed at the request of J.W. Wagener & Co. 20th Feb 1891

J.B. Myer C.E.