

## PROJECT 10073 RECORD

1. DATE - TIME GROUP 15/2/63 15/2/63	2. LOCATION St. Louis, Montana
3. SOURCE Civilian	10. CONCLUSION Possible (HOT AIR BALLOON)
4. NUMBER OF OBJECTS One	
5. LENGTH OF OBSERVATION 5 minutes	11. BRIEF SUMMARY AND ANALYSIS
6. TYPE OF OBSERVATION Semi-Visual	Observer sighted light that descended very quickly from estimated 40,000 feet to 3,000 feet. The light then traveled NE and disappeared in about 5 minutes. When descending the light appeared much more red and then traveling NE appeared star-like. Just before disappearing the light seemed to travel in an erratic fashion.
7. COURSE See Case	
8. PHOTOS <input type="checkbox"/> Yes <input checked="" type="checkbox"/> No	
9. PHYSICAL EVIDENCE <input type="checkbox"/> Yes <input checked="" type="checkbox"/> No	



I was in the air force 2-4 yrs ago and did some flying in B-24's & others. I never saw any thing move this fast. I wouldn't be able to estimate the speed.

17. DID YOU OBSERVE THE PHENOMENON THROUGH ANY OF THE FOLLOWING? INCLUDE INFORMATION ON MODEL, TYPE, FILTER, LENS PRESCRIPTION OR OTHER APPLICABLE DATA.

<input checked="" type="checkbox"/>	EYEGLASSES		CAMERA VIEWER
	SUNGLASSES		BINOCULARS
	WINDSHIELD		TELESCOPE
	SIDE WINDOW OF VEHICLE		THEODOLITE
	WINDOWPANE		OTHER

A. DO YOU ORDINARILY WEAR GLASSES?  YES  NO

B. DO YOU USE READING GLASSES?  YES  NO

18. WHAT WAS YOUR IMPRESSION OF THE SPEED OF THE PHENOMENON? GIVE ESTIMATE OF SPEED Very fast.

19. WHAT WAS YOUR IMPRESSION OF THE DISTANCE OF THE PHENOMENON? GIVE ESTIMATE OF DISTANCE 40,000 ft down to 30,000 ft.

20. IN ORDER THAT WE MAY OBTAIN AS CLEAR A PICTURE AS POSSIBLE OF WHAT YOU SAW, DESCRIBE IN YOUR OWN WORDS A COMMON OBJECT OR OBJECTS WHICH, WHEN PLACED IN THE SKY, SIMILAR TO WHERE YOU NOTED THE PHENOMENON, WOULD BEAR SOME RESEMBLANCE TO WHAT YOU SAW. DESCRIBE SIMILARITIES AND DIFFERENCES BETWEEN THE COMMON OBJECT AND WHAT YOU SAW.

When I first saw the UFO it was round and 2 or more times ~~as bright~~ bright as the brightest star. immediately after I saw it, it started down. Then it looked like a cigar and it turned from star light to a real red. It stayed that way until it stopped moving down. Then it went back to a round shape & more ~~like~~ like star light. It stayed that way until it moved out of sight.

21. DID YOU NOTICE ANY ODOR, NOISE, OR HEAT EMANATING FROM THE PHENOMENON OR ANY EFFECT ON YOURSELF, ANIMALS OR MACHINERY IN THE VICINITY?  YES  NO. IF "YES," DESCRIBE.

A. DID THE PHENOMENON DISTURB THE GROUND OR LEAVE ANY PHYSICAL EVIDENCE.  YES  NO. IF "YES," DESCRIBE.

27. INFORMATION WHICH YOU FEEL IS PERTINENT BUT WHICH IS NOT ADEQUATELY COVERED IN THIS QUESTIONNAIRE, ALTERNATIVELY PROVIDE A NARRATIVE EXPLANATION OF THE SIGHTING.

If it had been a plane at about 3000ft. to 5000ft. I'm sure I could have heard some noise, even if the engine had been cut I'm sure I could hear the swish of the air. With this thing I heard absolutely nothing.



DEPARTMENT OF THE AIR FORCE  
HEADQUARTERS 1400 AIR BASE WING (MAC)  
SCOTT AIR FORCE BASE, ILLINOIS 62225



REPLY TO  
ATTN OF: 1400(OB)

8 January 1969

SUBJECT: UFO Report

TO: FTD(TDPT(UFO))  
Wright Patterson AFB, Ohio

1. Attached AF Form 117 on a UFO sighting on 15 December 1968 by [REDACTED] is forwarded for appropriate action.
2. Weather information for Scott AFB during the applicable time period was as follows:

a. Winds

<u>Altitude</u>	<u>Degrees</u>	<u>Knots</u>
Surface	310	10
6,000	360	25
10,000	350	35
16,000	340	55
20,000	340	65
30,000	330	100
50,000	330	80

b. Ceiling: None

c. Visibility: 25 miles

d. Amount of cloud cover: None

*John B. Dodge*  
JOHN B. DODGE, Captain, USAF  
Assistant Base Operations Officer

1 Atch  
AF Form 117

6A. NOW IMAGINE YOU ARE AT THE CENTER OF THE COMPASS ROSE. PLACE AN "A" ON THE COMPASS TO INDICATE THE DIRECTION TO THE PHENOMENON WHEN FIRST SEEN. PLACE A "B" ON THE COMPASS TO INDICATE THE DIRECTION TO THE PHENOMENON WHEN LAST SEEN.

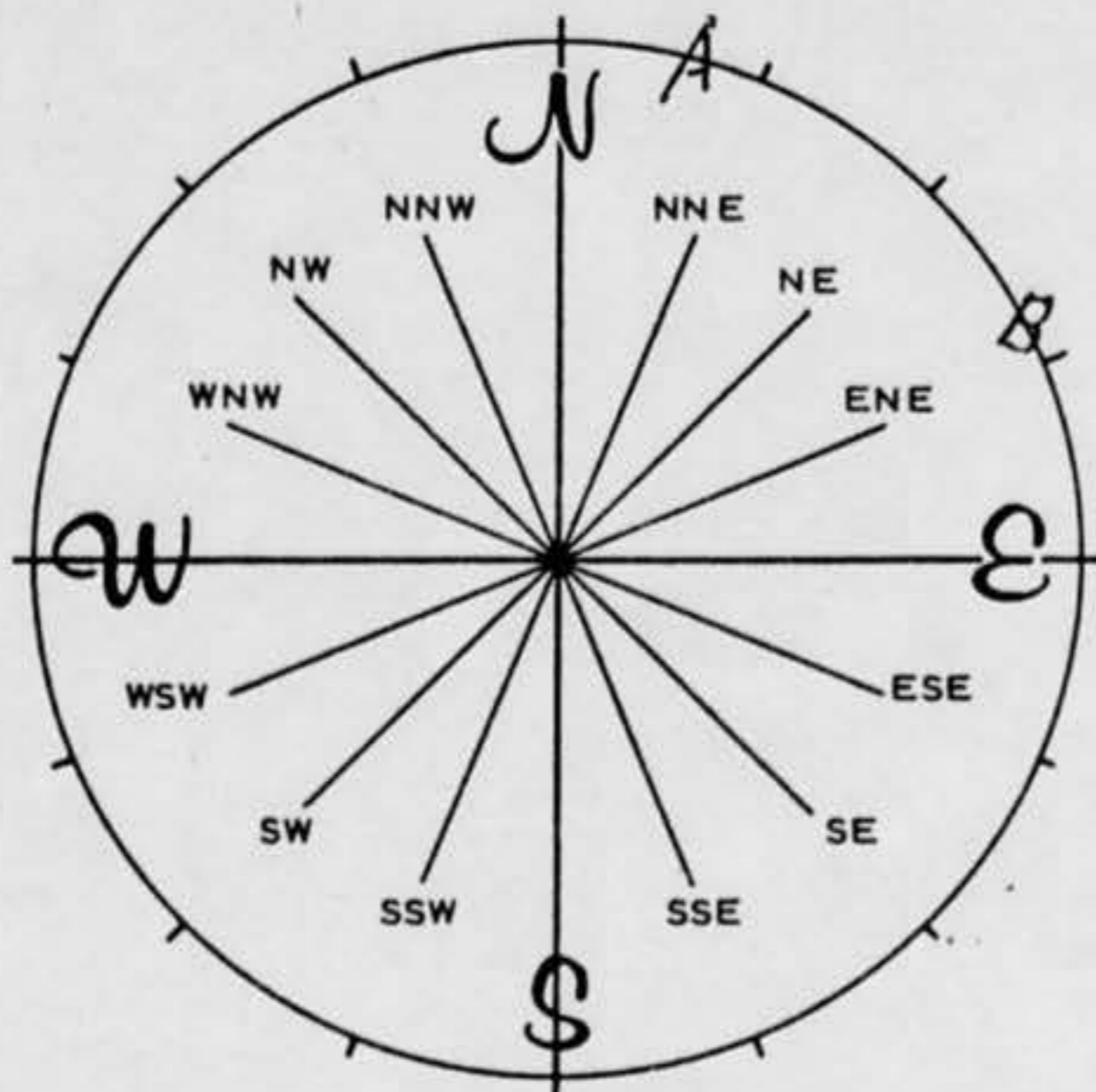

7. IN THE SKETCH BELOW, PLACE AN "A" AT THE POSITION OF THE PHENOMENON WHEN FIRST SEEN, AND A "B" AT THE POSITION OF THE PHENOMENON WHEN LAST SEEN. CONNECT THE "A" AND "B" WITH A LINE TO APPROXIMATE THE MOVEMENT OF THE PHENOMENON BETWEEN "A" AND "B". THAT IS, SCHEMATICALLY SHOW WHETHER THE MOVEMENT APPEARED TO BE STRAIGHT, CURVED OR ZIG-ZAG. REFER TO SMALLER SKETCH AS AN EXAMPLE OF HOW TO COMPLETE THE LARGER SKETCH.

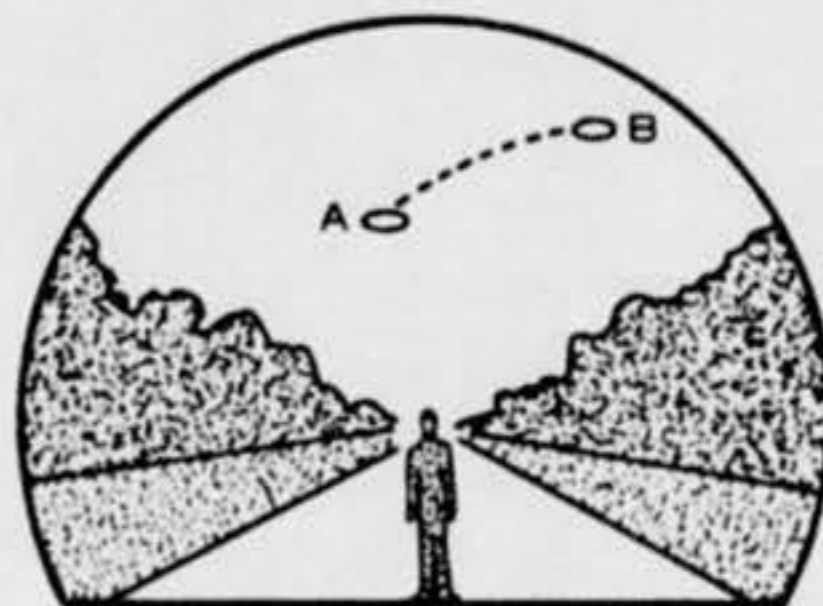
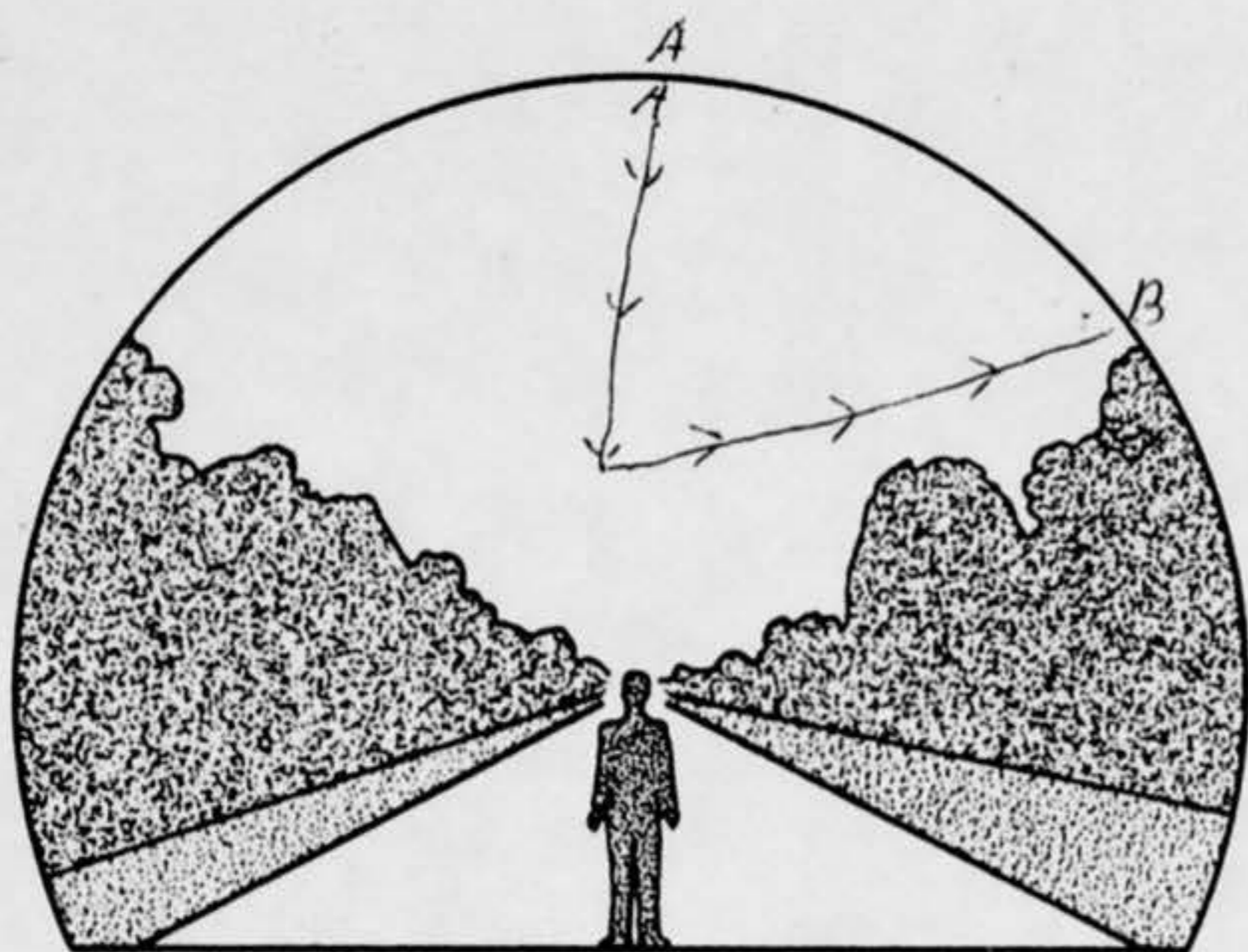



# SIGHTING OF UNIDENTIFIED PHENOMENA QUESTIONNAIRE

BUDGET BUREAU APPROVAL  
NUMBER 21-R258

THIS QUESTIONNAIRE HAS BEEN PREPARED SO THAT YOU CAN GIVE THE U.S. AIR FORCE AS MUCH INFORMATION AS POSSIBLE CONCERNING THE UNIDENTIFIED PHENOMENON THAT YOU HAVE OBSERVED. PLEASE TRY TO ANSWER ALL OF THE QUESTIONS. THE INFORMATION YOU GIVE WILL BE USED FOR RESEARCH PURPOSES. YOUR NAME WILL NOT BE USED IN CONNECTION WITH ANY OF YOUR STATEMENTS OR CONCLUSIONS WITHOUT YOUR PERMISSION. RETURN TO AIR FORCE BASE INVESTIGATOR FOR FORWARDING TO FTD (TDETR), WRIGHT-PATTERSON AFB, OHIO 45433, 1AW AFR 80-17. (IF ADDITIONAL SHEETS ARE NEEDED FOR NARRATIVE OR SKETCHES ATTACH SECURELY TO THIS FORM OR ANNOTATE WITH YOUR NAME FOR IDENTIFICATION.)

1. WHEN DID YOU SEE THE PHENOMENON?

DAY 15 MONTH Dec. YEAR 1968

2. WHAT TIME DID YOU FIRST SIGHT THE PHENOMENON?

HOUR 4 MINUTES 20  A.M.  P.M.

3. WHAT TIME DID YOU LAST SIGHT THE PHENOMENON?

HOUR 4 MINUTES 25 <sup>Approx.</sup>  A.M.  P.M.

4. TIME ZONE

EASTERN  CENTRAL  MOUNTAIN  PACIFIC  OTHER

DAYLIGHT SAVINGS  STANDARD

5. WHERE WERE YOU WHEN YOU SAW THE PHENOMENON? IF IN CITY, GIVE THE NEAREST STREET ADDRESS AND INDICATE ON A HAND DRAWN MAP WHERE YOU WERE STANDING WITH REFERENCE TO THE ADDRESS. IF IN THE COUNTRY, IDENTIFY THE HIGHWAY YOU WERE ON OR NEAR AND TRY TO FIX A DISTANCE AND DIRECTION FROM SOME RECOGNIZABLE LANDMARK.

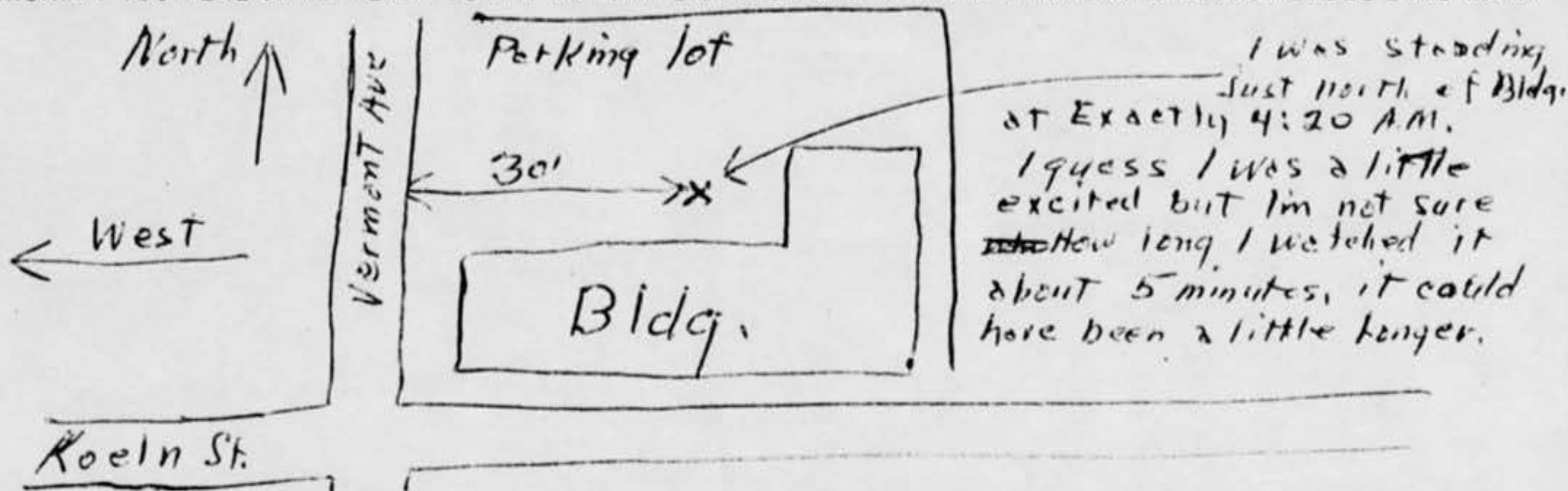

6. IMAGINE YOU ARE AT THE POINT SHOWN IN THE SKETCH, PLACE AN "A" ON THE CURVED LINE TO SHOW HOW HIGH THE PHENOMENON WAS ABOVE THE HORIZON, OR SKYLINE. WHEN FIRST SEEN. PLACE A "B" ON THE SAME CURVED LINE TO SHOW HOW HIGH ABOVE THE HORIZON THE PHENOMENON WAS WHEN LAST SEEN.

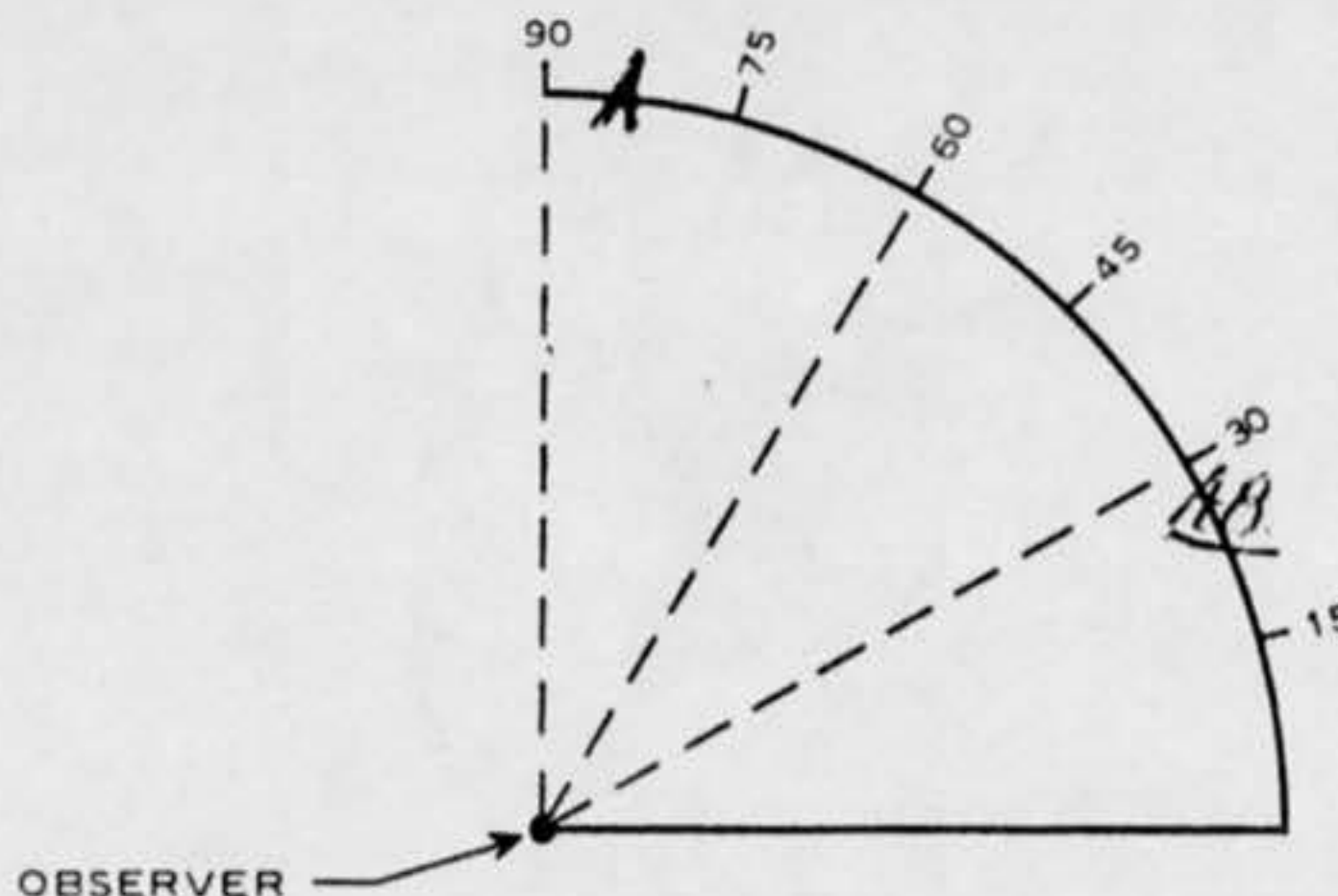



10. IF THERE WERE MORE THAN ONE PHENOMENON, HOW MANY WERE THERE? DRAW A PICTURE TO SHOW HOW THEY WERE ARRANGED. DID THIS ARRANGEMENT CHANGE DURING THE SIGHTING?

11. CONDITIONS (Check appropriate blocks.)

A. SKY		B. WEATHER			
<input type="checkbox"/>	DAY	<input type="checkbox"/>	CUMULUS CLOUDS (Low fluffy)	<input type="checkbox"/>	FOG OR MIST
<input type="checkbox"/>	TWILIGHT	<input type="checkbox"/>	CIRRUS CLOUDS (High fleecy or Herringbone)	<input type="checkbox"/>	HEAVY RAIN
<input checked="" type="checkbox"/>	NIGHT	<input type="checkbox"/>	NIMBUS CLOUDS (Rain)	<input type="checkbox"/>	LIGHT RAIN OR DRIZZLE
<input checked="" type="checkbox"/>	CLEAR	<input type="checkbox"/>	CUMULONIMBUS CLOUDS (Thunderstorms)	<input type="checkbox"/>	HAIL
<input type="checkbox"/>	PARTLY CLOUDY	<input type="checkbox"/>	HAZE OR SMOG	<input type="checkbox"/>	SNOW OR SLEET
<input type="checkbox"/>	COMPLETELY OVERCAST	<input type="checkbox"/>		<input type="checkbox"/>	UNKNOWN
				<input type="checkbox"/>	NONE OF THE ABOVE

C. IF THE SIGHTING WAS AT TWILIGHT OR NIGHT, WHAT DID YOU NOTICE ABOUT THE STARS AND MOON?

(1) STARS		(2) MOON			
<input type="checkbox"/>	NONE	<input type="checkbox"/>	BRIGHT MOONLIGHT	<input type="checkbox"/>	NO MOONLIGHT
<input checked="" type="checkbox"/>	A FEW	<input type="checkbox"/>	MOON WITH HALO	<input type="checkbox"/>	UNKNOWN
<input type="checkbox"/>	MANY	<input type="checkbox"/>	MOON HIDDEN BY CLOUDS	<input type="checkbox"/>	
<input type="checkbox"/>	UNKNOWN	<input type="checkbox"/>	PARTIAL (New or quarter)	<input type="checkbox"/>	

D. IF SIGHTING WAS IN DAYLIGHT, WAS THE SUN VISIBLE?  YES  NO. IF "YES," WHERE WAS THE SUN AS YOU FACED THE PHENOMENON?

<input type="checkbox"/>	IN FRONT OF YOU	<input type="checkbox"/>	TO YOUR RIGHT	<input type="checkbox"/>	OVERHEAD (Near noon)
<input type="checkbox"/>	IN BACK OF YOU	<input type="checkbox"/>	TO YOUR LEFT	<input type="checkbox"/>	UNKNOWN

E. SPECIFY THE MAJOR SOURCE OF ILLUMINATION PRESENT DURING THE SIGHTING, SUCH AS THE SUN, HEADLIGHTS OR STREET LAMP, ETC. FOR TERRESTRIAL ILLUMINATION, SPECIFY DISTANCE TO LIGHT SOURCE.

A good amount of light, as it always is, street lights, bldg. lights I was about 30 feet from bldg. light but was looking north or North East not much interference from light

12. GIVE A BRIEF DESCRIPTION OF THE PHENOMENON, INDICATING WHETHER IT APPEARED DARK OR LIGHT, WHETHER IT REFLECTED LIGHT OR WAS SELF-LUMINOUS AND WHAT COLORS YOU NOTICED. DESCRIBE YOUR IMPRESSION OF WHETHER IT WAS SOLID OR TRANSPARENT, WHETHER EDGES WERE SHARP OR FUZZY. DESCRIBE THE SHAPE OR INDICATE IF IT APPEARED AS A POINT OF LIGHT. INDICATE COMPARISONS WITH OTHER OBSERVED OBJECTS, LIKE STARS, A LIGHT OR OTHER OBJECT IN YOUR FIELD OF VIEW.

The U.F.O. was almost straight up, a little to the north. It came almost straight down to about the height of a air plane about 10 to 15 miles from airport to land. I'd say 3000 feet more or less, when I first saw the U.F.O. it was high, real high, "like a high flying jet" Maybe even higher, it descended real fast. From this great height to the 3000 to 5000 feet in just a few seconds, while it was descending it appeared to be long and fairly bright then when it got as low as it was going to get it appeared to be round again and stayed that way until it disappeared to the north East. I wouldn't say it was real bright, but it was easy to see. I would say the light was much more red while it descended and fluorescent or like a star light while it traveled North East.



**8. WHERE WERE YOU WHEN YOU SAW THE PHENOMENON? (Check appropriate blocks.)**

<input checked="" type="checkbox"/>	OUTDOORS		IN BUSINESS SECTION OF CITY
	IN BUILDING	<input checked="" type="checkbox"/>	IN RESIDENTIAL SECTION OF CITY
	IN CAR <input type="checkbox"/> AS DRIVER <input type="checkbox"/> AS PASSENGER		IN OPEN COUNTRYSIDE
	IN BOAT		NEAR AIRFIELD
	IN AIRPLANE <input type="checkbox"/> AS PILOT <input type="checkbox"/> AS PASSENGER		FLYING OVER CITY
	OTHER		FLYING OVER OPEN COUNTRY
			OTHER

**A. IF YOU WERE IN A VEHICLE, COMPLETE THE FOLLOWING:**

WHAT DIRECTION WERE YOU MOVING?		HOW FAST WERE YOU MOVING?
<input type="checkbox"/> NORTH	<input type="checkbox"/> EAST	DID YOU STOP ANYTIME WHILE OBSERVING THE PHENOMENON? <input type="checkbox"/> YES <input type="checkbox"/> NO
<input type="checkbox"/> SOUTH	<input type="checkbox"/> WEST	
<input type="checkbox"/> NORTHEAST	<input type="checkbox"/> SOUTHEAST	
<input type="checkbox"/> NORTHWEST	<input type="checkbox"/> SOUTHWEST	

EXPLAIN WHETHER SUCH MOVEMENT AFFECTS YOUR SKETCHES IN ITEMS 5 AND 6.

DESCRIBE TYPE OF VEHICLE YOU WERE IN AND TYPE OF ROAD, TERRAIN OR BODY OF WATER YOU TRAVERSED DURING THE SIGHTING. STATE WHETHER WINDOWS OR CONVERTIBLE TOP WERE UP OR DOWN.

HOW MUCH OTHER TRAFFIC WAS THERE?

DID YOU NOTICE ANY AIRPLANES?  YES  NO. IF "YES," DESCRIBE WHEN THEY WERE IN SIGHT RELATIVE TO THE TIME OF SIGHTING THE PHENOMENON AND WHERE THEY WERE IN THE SKY RELATIVE TO THE POSITION OF THE PHENOMENON.

**9. HOW LONG WAS THE PHENOMENON IN SIGHT?**

LENGTH OF TIME <i>Approx 5 minutes</i>	<input checked="" type="checkbox"/> CERTAIN OF TIME	<input type="checkbox"/> NOT VERY SURE
	<input type="checkbox"/> FAIRLY CERTAIN	<input type="checkbox"/> JUST A GUESS

HOW WAS TIME DETERMINED? *I looked at my watch to be sure of time 4:20AM but I guess I didn't look when I last saw UFO.*

WAS THE PHENOMENON IN SIGHT CONTINUOUSLY?  YES  NO. IF "NO," INDICATE WHETHER THIS IS DUE TO YOUR MOVEMENT OR THE BEHAVIOR OF THE PHENOMENON, AND DESCRIBE SUCH MOVEMENT OR BEHAVIOR. INDICATE DISAPPEARANCES ON PREVIOUS SKETCHES.



15. DRAW A PICTURE THAT WILL SHOW THE SHAPE OF THE PHENOMENON. INCLUDE AND LABEL ANY DETAILS THAT MIGHT HAVE APPEARED AS WINGS OR PROTRUSIONS, AND INDICATE EXHAUST OR VAPOR TRAILS. INDICATE BY AN ARROW THE DIRECTION THE PHENOMENON WAS MOVING.

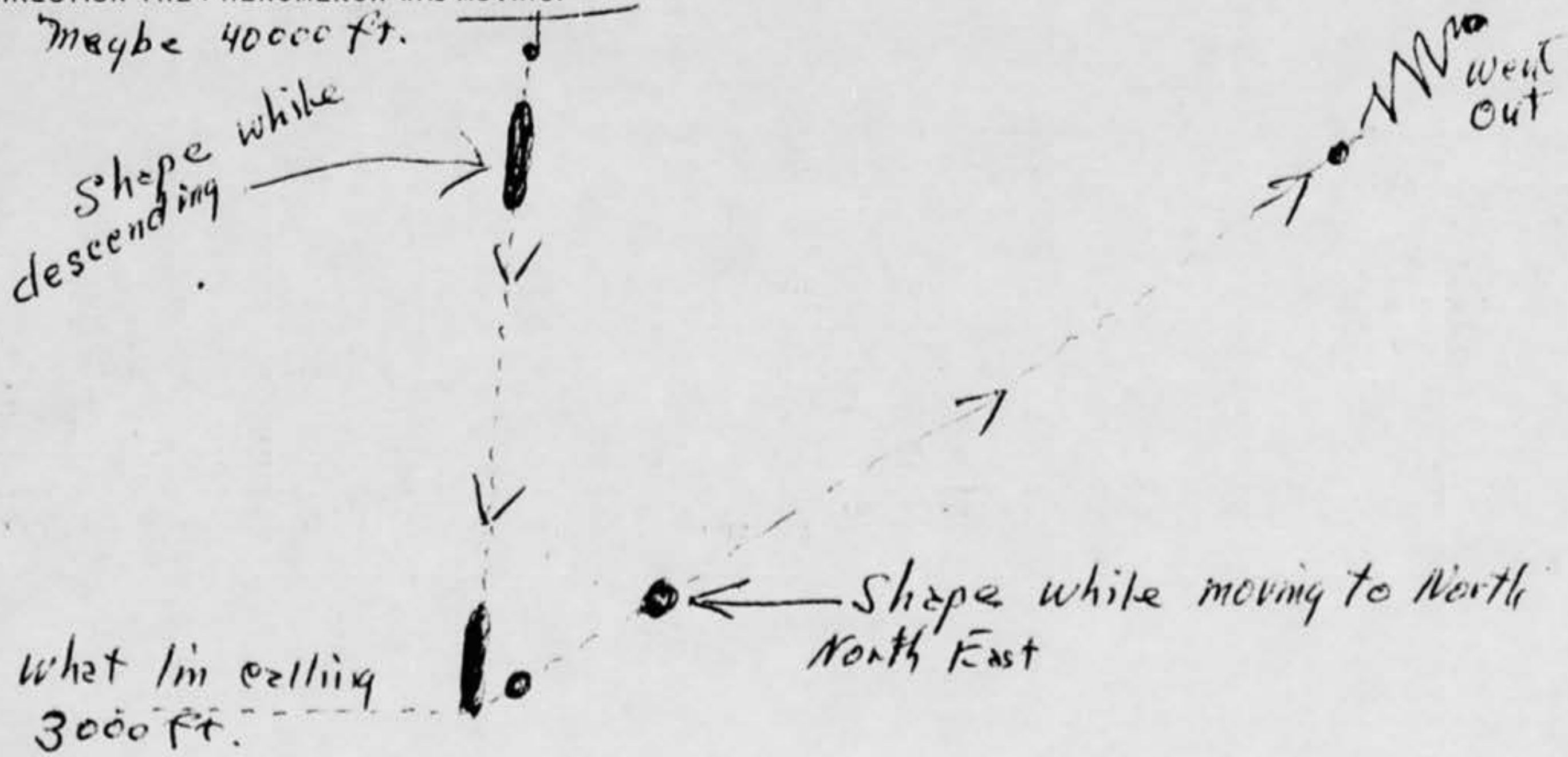

16. WHAT WAS THE ANGULAR SIZE? HOLD A MATCH AT ARM'S LENGTH IN FRONT OF A KNOWN OBJECT, SUCH AS A STREET LAMP OR THE MOON. NOTE HOW MUCH OF THE OBJECT IS COVERED BY THE HEAD OF THE MATCH. NOW IF YOU HAD BEEN ABLE TO PERFORM THIS EXPERIMENT AT THE TIME OF THE SIGHTING, ESTIMATE WHAT FRACTION OF THE PHENOMENON WOULD HAVE BEEN COVERED BY THE MATCH HEAD.

Just about 100%



13.	DID THE PHENOMENON	YES	NO	UNKNOWN
	MOVE IN A STRAIGHT LINE?		X	
	STAND STILL AT ANYTIME?		X	
	SUDDENLY SPEED UP AND RUN AWAY?		X	
	BREAK UP IN PARTS AND EXPLODE?		X	
	CHANGE COLOR?	X		
	GIVE OFF SMOKE?		X	
	CHANGE BRIGHTNESS?	X		
	CHANGE SHAPE?	X		
	FLASH OR FLICKER?		X	
	DISAPPEAR AND REAPPEAR?		X	
	SPIN LIKE A TOP?			X
	MAKE A NOISE?		X	
	FLUTTER OR WOBBLE?		X	

14. WHAT DREW YOUR ATTENTION TO THE PHENOMENON? *It was bright enough to get my attention  
I often look at the stars when I finish work, I'm not sure that's  
what happened but I'd just finished & was smoking a cig. when I saw  
it.*

A. HOW DID IT FINALLY DISAPPEAR?

*After it descended to the 3000 ft. it moved  
North, North East more or less straight until just before  
it disappeared, it seemed to have a very erratic flight  
'like this.' Then it just went out,*

B. DID THE PHENOMENON MOVE BEHIND OR IN FRONT OF SOMETHING, LIKE A CLOUD, TREE, OR BUILDING AT ANY TIME?

YES  NO. IF "YES," DESCRIBE.



22. HAVE YOU EVER SEEN THIS OR A SIMILAR PHENOMENON BEFORE?  YES  NO. IF "YES," GIVE DATE AND LOCATION.

23. WAS ANYONE WITH YOU AT THE TIME YOU SAW THE PHENOMENON?  YES  NO. IF "YES," DID THEY SEE IT TOO?  
 YES  NO.

A. LIST THEIR NAMES AND ADDRESSES

24. GIVE THE FOLLOWING INFORMATION ABOUT YOURSELF

LAST NAME, FIRST NAME, MIDDLE NAME

ADDRESS (Street, City, State and Zip Code)

TELEPHONE (Area code and number)

AGE

MALE

FEMALE

INDICATE ADDITIONAL INFORMATION INCLUDING OCCUPATION AND ANY EXPERIENCE WHICH MAY BE PERTINENT.

I'm self-employed

I was in the Air force, I saw lots of planes, This was not an air plane.

I don't think I usually see things wrong. I know things don't always look like it really is. But

I'll say this,

what ever it was, I got a very good look at this thing, It was by far the fastest thing I ever ~~say~~ saw, It was big, It had to be big to be so far away + look that big

I called Lambert airport, They gave me the Scott AFB number which I called about 15 minutes after I saw the thing

25. WHEN AND TO WHOM DID YOU REPORT THAT YOU HAD SIGHTED THIS PHENOMENON?

NAME  DAY 15 MONTH Dec YEAR 1968

26. DATE YOU COMPLETED THIS QUESTIONNAIRE.

DAY 3 MONTH Jan. YEAR 1969