

Storm Tide, Aug 26th 1885

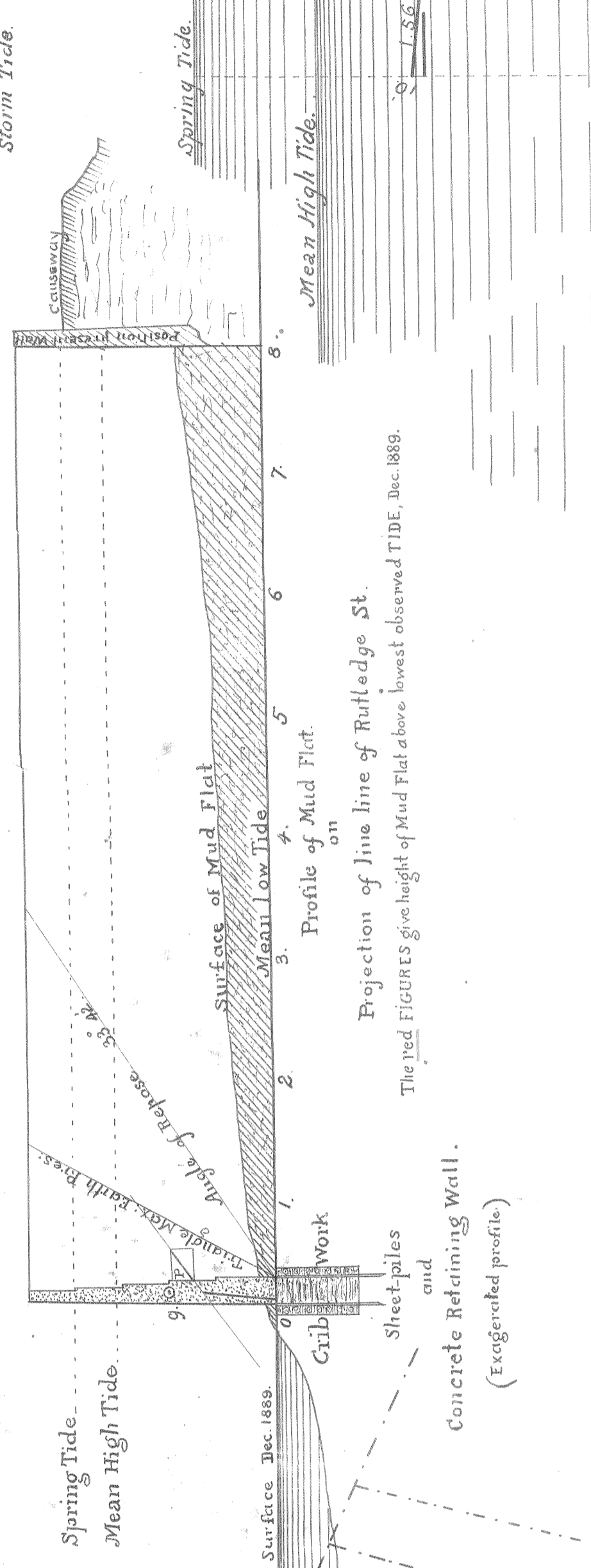

Centre line of South Bay, projected to Centre line of Church St.
 Fringed line showing by
 Channel in South Bay

(East Henry A Middleboro)
 R.M.C. p. 1, 20, May 17, 1880
 Carveys South Bay, 50 ft wide to channel.
 See Map Bk. 1, 33

N.B. The red line, intended as the location of the 50 ft. wide, will include on the mud flat, and form an extension westward of such walls as have been constructed by owners on south side of their lots and on the line of low water mark.

BAY ST. 50 F. wide.

Middleboro

Lessesne

GIBBS ST. 40 F. wide.

Mannigault

Barker

LEGARE ST

LIMEHOUSE ST.

GREENHILL ST.

COUNCIL ST.

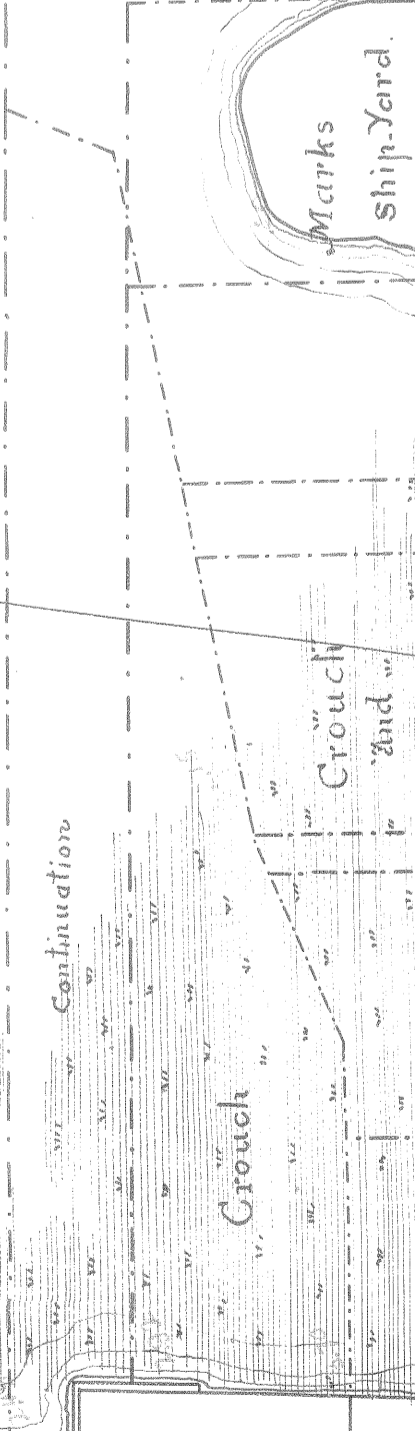

Ahrens' dashed lines

ASHLEY RIVER

CHANNEL LINE

CHANNAL LINE

WATERWAY

TRADD ST.

LOGAN ST.

FRIEND ST.

NEW ST.

RUTLEDGE ST.

LYNCH ST.

CHISOLM ST.

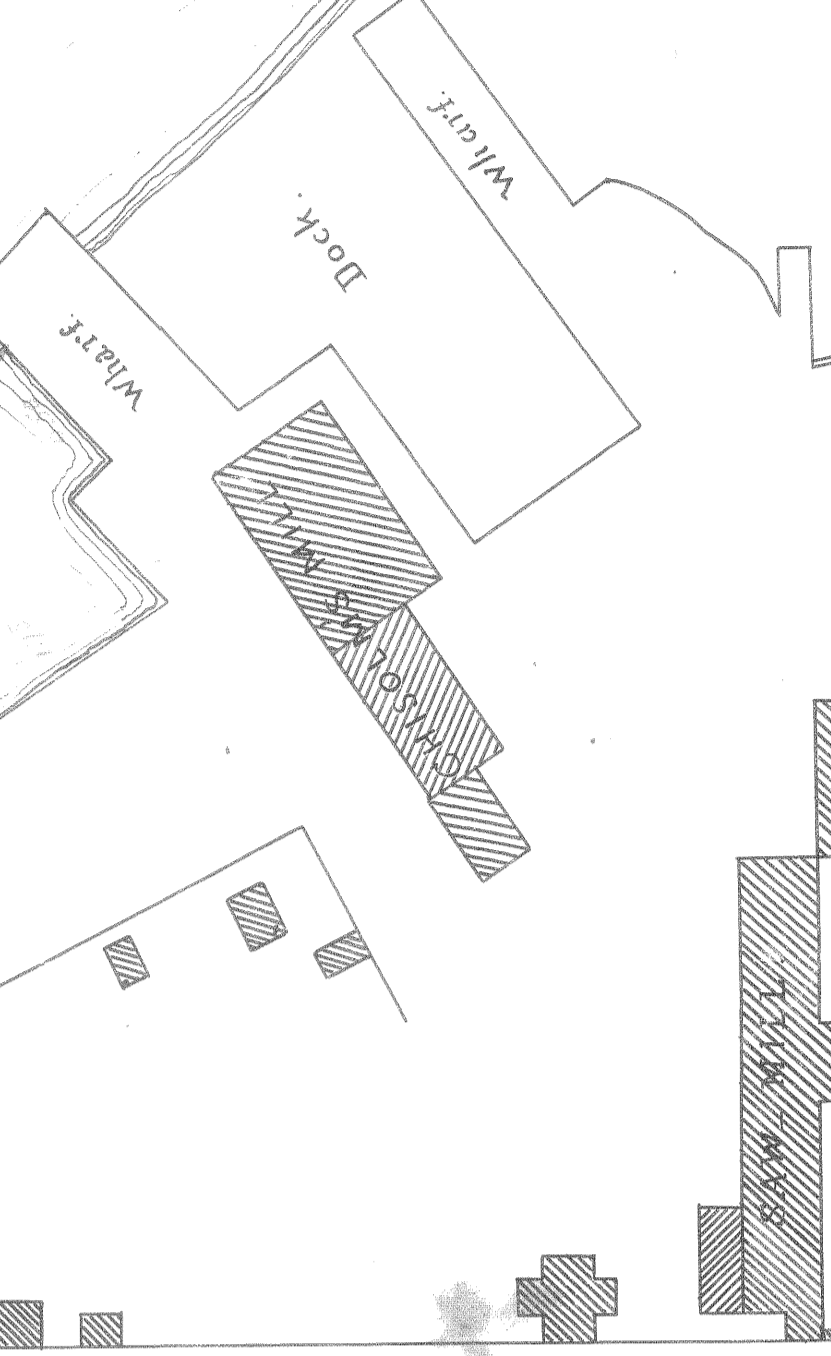

Net. Secant. 1.202

Average height of Mud Flat, 188

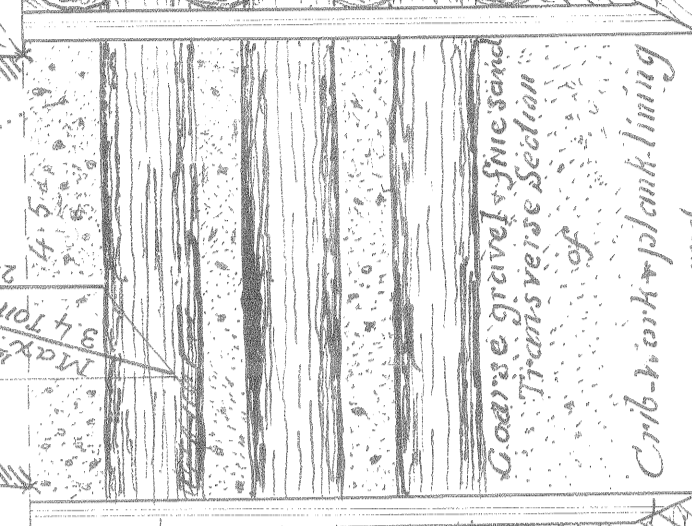

See wall with lines showing residuals of directions of the maximum pressures of earth. Water and stability of wall. N.B. Location to be corrected.

Sam J. Stewart
 P. E. & C. E.

Scale of MAP 100 ft to the Inch
 Scale of Crib Coffer-Dam 2 ft to the Inch

(85)

(85)

BROAD ST.