

- 2 -

a. Repairing ships, tuncars, railway equipment, tractors, refrigerating equipment, pumps, prime movers (diesel or steam turbine pumps) for water supply, boilers, turbines, and auxiliary equipment for electric power stations, wood-working machines.

(Nothing Follows)

(Signed) D. S. LOCKIE
1st Lt. F. D.

HYOGO MILITARY GOVERNMENT TEAM
APO 317

400.17

JHS/ryf/yy
11 February 1949

SUBJECT: Reconversion Permit.

TO : Mitsubishi Heavy Ind. Co., Kobe Shipyard (13-72)

THRU. : Hyogo Liaison Office.

1. Attached herewith, reconversion permit issued by GHQ, SCAP, FSS, authorizing production of listed items in your plant.

2. Care must be exercised by your plant to conform with the provisions contained in attached permit.

FOR THE COMMANDING OFFICER:

(Signed) LOUIS C. HUTTON
Major, Cavalry
Executive Officer

Incl. : As indicated.

GENERAL HEADQUARTERS
SUPREME COMMANDER FOR THE ALLIED POWERS
Economic and Scientific Section

Date: 22 January, 1949.

SUBJECT: Reconversion Permit for Reparations Plant.

TO : Mitsubishi Heavy Ind. Co., Kobe Shipyard, 3-chome
Wadasaki-cho, Hyogo-ku, Kobe.

1. In accordance with Memorandum from the Supreme Commander for the Allied Powers to the Japanese Government, dated 22 November 1946 (SCAPIN-1355), the Mitsubishi Heavy Ind., is permitted to produce at their Kobe Factory located at Hyogo-ku, Kobe the following additional items:

<u>Item</u>	<u>Maximum Quantity</u>
<u>Coal & ore cars</u>	<u>To be determined by availability of materials</u>
<u>Steam, reciprocating engines</u>	<u>"</u>
<u>Wheat rolling & cleaning machinery</u>	<u>"</u>
<u>Pumps & power equipment for factories</u>	<u>"</u>
<u>Welded steel pipe, refrigerating machinery, cigarette, match making & wood-working machines</u>	<u>"</u>

2. The temporary use of the following additional reparations machinery is authorized:

NOT APPLICABLE

3. A program will be immediately initiated to substitute non-reparations machinery for reparations machinery in temporary use.

4. The acquisition of material, parts and sub-assemblies as well as the disposition of finished products and the establishment of sales prices will be in accordance with the regulations of the Japanese Government.

- 2 -

5. This permit is issued subject to any and all directives affecting reparations plants which have been issued or may hereafter be issued by the Supreme Commander for the Allied Powers. Reports will be rendered as required by current directives and instructions.

FOR THE CHIEF, ECONOMIC AND SCIENTIFIC SECTION:

(SEAL)

(Signed) W. S. VAUGHAN
Chief, Industry Division

PRESENT PRODUCING OUTLOOK

November, 1950.

Kobe Shipyard and Engine Works,
Central Japan Heavy-Industries, Ltd.1. PRODUCTION

<u>Item</u>	<u>Demandant</u>	<u>Amount</u>
<u>For the Allied Forces:</u>		
Trestle (steel bridge)	8th Army	6 sets
Ship-repairing	Allied Forces, etc.	Several
Electric refrigerator	Tokyo S.P.D.	30 sets
<u>For Foreign Countries:</u>		
New cargo ship	Denmark	1 ship (10,100 D.W.)
"	India	2 ships (2,000 D.W.)
Ship-repairing	U.S.A., etc.	Several
Steam turbine for power station	Thailand	1 set
Boiler	Pakistan	3 boilers (9 t/h)
Water turbine	India	2 sets (2,800 HP)
Cigarette machine	Formosa	4 sets
Steel oil tank	Pakistan	1 set (24,000 C.F.)
"	Thailand	1 set (110,000 C.F.)
<u>For Domestic-use:</u>		
Ship-building:		
Cargo	O. S. K.	2 ships (9,200 D.W.)

- 2 -

<u>Item</u>	<u>Demandant</u>	<u>Amount</u>
Cargo & passenger	Kyosei Kaiun	1 ship (300 G.T.)
Patrol	Maritime Safety Bureau	2 ships (450 G.T.)
Ship-repairing	N. Y. K., etc.	Many
<u>Machinery for marine-use:</u>		
Diesel engine	Hitachi Dockyard & other	37 sets (400 HP - 4,900HP)
Marine auxiliaries	East Japan Heavy Ind., etc.	Many
<u>Machinery for land-use:</u>		
Parts & fittings of steam turbines	Nippon Hassoden, etc.	Many
Boiler	"	8 boilers (170 t/h, etc.)
Water turbine	"	8 sets (14,300KW, etc.)
Diesel engine	Dentsu-sho (Japanese Govt.)	14 sets
Blower	Shin-Nippon Chisso, etc.	2 " (350 HP, etc.)
Cigarette machine	Bureau of Mo- nopolies	21 sets
Machines for salt production	Sakada Engyo Co., & other	2 " (800t/y-13,000t/y)
<u>Steel structure:</u>		
Steel tower	Oita Pref., etc.	120 sets
Bridge	"	4 bridges
Coal-car	Taihei Kogyo Co.	200 cars
Other machinery		Many

- 3 -

2. WORKERS. (November, 1950)

Engineer	610
Clerk	580
Labourer	7,780

Total -	8,970
---------	-------

3. EQUIPMENT.

	<u>A. U.</u>	<u>T. O.</u>	<u>E. X.</u>	<u>TOTAL</u>
Industrial machinery & equipment	1,184	-	82	1,266
Machine tools	1,302	-	34	1,336
Electrical machine	641	-	149	790
Other equipment	67	-	10	77
Portable machine tools	1,037	-	3	1,040
TOTAL -	<u>4,231</u>	-	<u>278</u>	<u>4,509</u>

APPLICATION FOR MOVEMENT AND AUTHORIZED USE OF
DESIGNATED REPARATION MACHINERY AND EQUIPMENT

Date : Feb 20, 1951

To : Minister of **Finance**
From : President of Fuji Denki Seizo K.K.
Address : No.1 Tanabeshinden, Kawasaki City,
Kanagawa Prefecture.

- 1) Name (Code No.) and Location for the plant which intends to use designated reparation machinery and equipment.

Name : **Fuji Denki Seizo K.K. Matsumoto Factory**

Location : **No. 2666, Tsukama, Matsumoto City, Nagano Prefecture**

(Non designated reparation plant)

- 2) Name (Code No.) and Location of the plant which designated reparation machinery and equipment to be used actually exist.

Name : Hikari Naval Arsenal Code No. 45-4

Location : Mitsui, Hikari City, Yamaguchi Prefecture.

- 3) List of designated reparation machinery and equipment to be moved and used.

45-04
II
70-57

3) List of designated reparation machinery and equipment to be moved and used.

Machinery

Inv. No.	Name of Machinery	Brief Specifications	Quantity	Remarks
45-4-271	Radial drilling m/c	Drilling capacity 50 Max. distance between spindle to column 1290 Wakayama Tekko	1	Page Evaluation Integrated Facility 112
45-4-454	Horizontal milling m/c Knee type	Working surface of table 1500 x 350 Wanderer	1	87 Ditto
45-4-800	Horizontal boring m/c Table type	Dia. of boring for 75 Kawanishi	1	56 Ditto
45-4-1470	Turret lathe Saddle type	Swing over bed 150 Length of bed 800 Brown & sharp	1	425 Ditto
45-4-1753	Gear shaper Fellow type	Max. dia. of gear 213 Telloe	1	243 Ditto
45-4-3341	Vertical boring and turning mill	Dia. of table 1070 Karatsu Tekko	1	520 Ditto
		Total	6	

4) Necessity for movement and use of machinery and equipment.

Immediately after the termination of the last war, our company planned and realized conversion to peace time industry having increased the amount of our production since then and is now producing as much as ¥ 200,000,000 every month.

Also our export has amounted to ¥ 400,000,000 up to the present.

Accordingly the urgent necessary matter for us under the present circumstances consists in the advance both of the accuracy of workmanship and of efficiency whereas the equipments and machines in each factory of our company have already been superannuated a quarter of which is necessitated to be urgently substituted by new and efficient ones for which we made every effort but failed in finding out suitable ones in the civil circles and furthermore such machines as manufactured after the end of the war are not only of bad quality but also poor in sort.

Such being the case, we hereby submit our application for the approval of our wishing borrow of the abovementioned superior machines to instal and use in our Matsumoto factory for the purpose to improve the qualities of our manufactures as well as to advance our production efficiency and at the same time to augment our output raising up our export.

Impediments in the production of our factory whereto our applied machines shall be removed and the respective uses of these machines are as follows:

a) Status quo of our Matsumoto Factory.

Our Matsumoto Factory is one of the leading factories in Japan which manufacture watt-hour meters. To say the truth, our Matsumoto Factory had been a factory dispersed into a rural district to evade air raid in the war time and has been after the termination of the war converted to a factory for peace time industry. Accordingly its present machines are so obsolete and still short in perfect arrangement as to be

disadvantageous for the factory in view of its efficiency.

In addition, we have accepted an order for our watt-hour meters as much as 5,000 pieces every month and are going to conclude a contract with India to export thereto the parts for 10,000 pieces of our watt-hour meters per month, so that it is a pressing need for us to substitute and replenish these superannuated machines with more efficacious ones.

No.45-4-271 Radial drilling machine Wakayama Tekko made.

Our Matsumoto Factory does not at all possess this sort of machine so that the factory must spend many a day even for repairing, to say nothing of manufacturing, the special machinery equipments and fixture to be used for the mass-production of our watt-hour meters.

Furthermore the production of the factory is often embarrassed by the abovesaid defects. In view of this fact, we intend to install this machine in order to exclude these barriers.

This machine, however, is not manufactured at present so that it must necessitate too many days to meet our export schedule and other urgent needs.

No.45-4-454 Horizontal milling machine. Wanderer made.

We should like to use this machine to manufacture the punches and dies as well as the tools for watt-hour meters at our Matsumoto Factory. On account of the conveyor system in practice for manufacturing watt-hour meters at our Matsumoto Factory, the punches and dies as well as tools must be indiskensably supplemented while the present one cannot at all fully replenish these so that we should like to add one more to the existing one in order to supply and replenish the abovesaid punches, dies and fixtures for the purpose of the increase in our production by 30%.

Being foreign made, this machine is very hard to obtain in the present market.

No.45-4-800 Horizontal boring machine Kawanishi made.

This shall be used to manufacture the parts for the machinery equipments at our Matsumoto Factory. Horizontal boring machine is always used for manufacturing and repairing the special machinery equipments and fixtures necessary to manufacture watt-hour meter whereas our factory possesses none of such machines so that portion of the production at the factory is now dependent either upon our Kawasaki Factory far remote therefrom or upon outside makers and accordingly that production is apt to be not only prolonged but also lacking in smoothness embarrassing the intended increase of production. In view of these matters, we should like to install this machine for the purpose of increase in our production.

This machine, however, is stopped to be manufactured so that it will take too many days, if newly ordered, to comply with our export program and other pressing needs.

No.45-4-1470 Turret lathe saddle type Brown & sharp made.

Most of the parts for watt-hour meter are singular and manufactured by mono-functional turret lathe at our factory. However, any of the machines now in our use has been already superannuated on account of the reckless use during the war time. Therefore we intend to improve the qualities of our manufactures, reduce the number of unit works and rationalize our management in addition by automatizing the operations of our workers through substitution of these obsolete machines with automatic lathes.

Being foreign made, this machine for which we hereby apply cannot be found among home made machines.

No.45-4-1753 Fellow type gear shaper Telloe Co. made.

This shall be used for cutting the gear to be used for repairing the machines and equipments. On account of the conveyor system now adopted at the factory for the manufacture of watt-hour meters, special attention must be paid to supplement special machines and fixtures especially to the replenishment of gears at any time. Nevertheless, the factory possesses no gear shaper except only one piece of bevel gear shaper being always impeded in speedy repairing of gears. Consequently, the production of that factory is indirectly hindered.

Such being the case, we are wishing to equip this machine in that factory expecting it to do much for the programmed 30% increase in our production.

Being foreign made, this machine can not be obtained in the market.

No.45-4-3341 Vertical boring and turning mill

Karatsu Tekko made.

Use for this machine is same as for No.271 radial drilling machine.

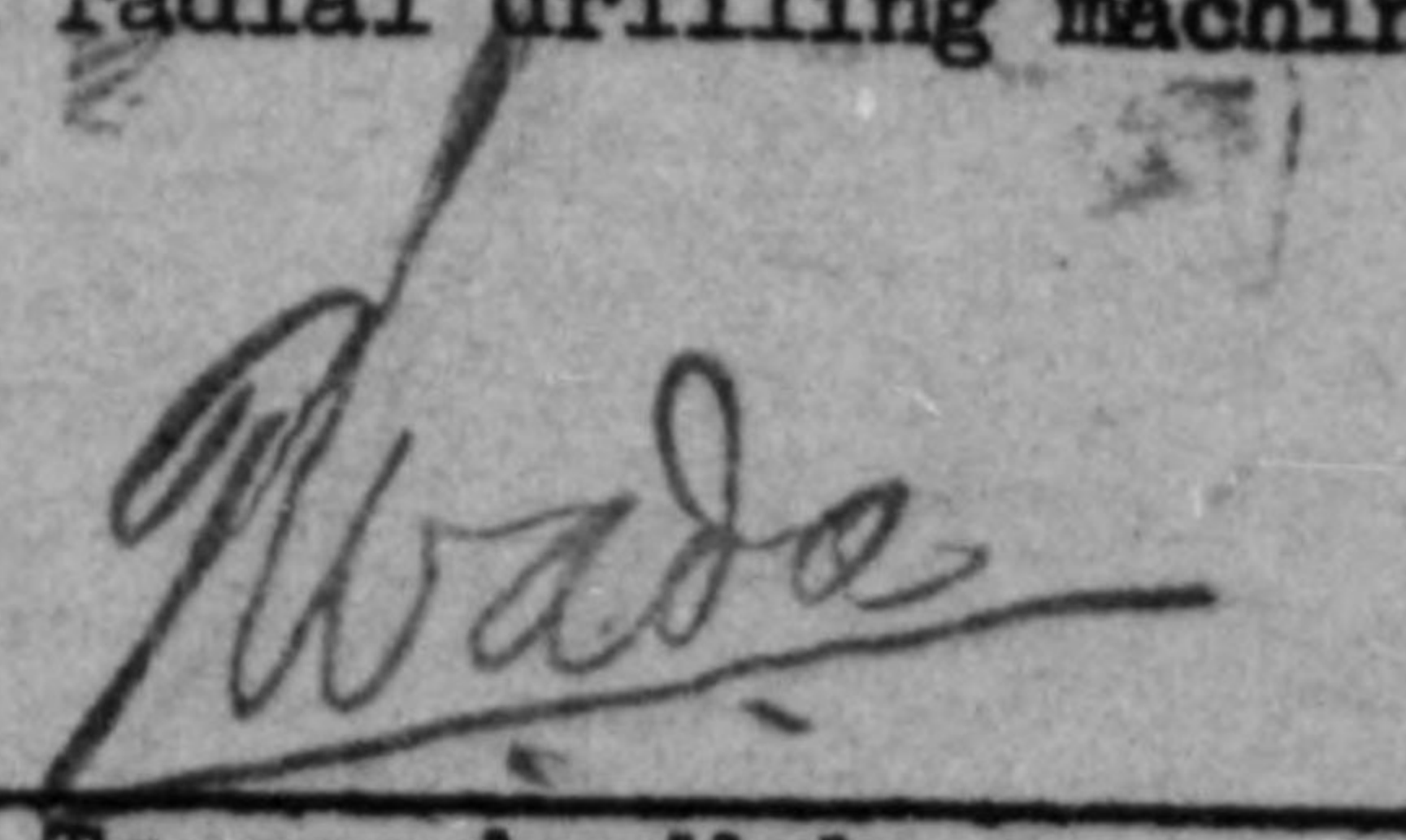
Signed: 

Tsunesuke Wada
President of Fuji Denki
Seizo K.K.

APPLICATION FOR MOVEMENT AND AUTHORIZED USE OF
DESIGNATED REPARATION MACHINERY AND EQUIPMENT

Date : Feb 20, 1951

To : Minister of Finance

From : President of Fuji Denki Seizo K.K.

Address : No.1 Tanabeshinden, Kawasaki City,
Kanagawa Prefecture.

- 1) Name (Code No.) and Location for the plant which intends to use designated reparation machinery and equipment.

Name : Fuji Denki Seizo K.K. Mie Factory

Location: No. Ko-4005, Hazu, Yokkaichi City, Mie Prefecture.

(Non designated reparation plant)

- 2) Name (Code No.) and Location of the plant which designated reparation machinery and equipment to be used actually exist.

Name : Hikari Naval Arsenal Code No. 45-4

Location: Mitsui, Hikari City, Yamaguchi Prefecture.

- 3) List of designated reparation machinery and equipment to be moved and used.

Machinery

Inv. No.	Name of Machinery	Brief Specifications	Quantity	Remarks
45-4-273	Radial drilling m/c	Drilling capacity 50 Max. distance between spindle to column 1290 Wakayama Tekko	1	Page Evaluation Integrated Facility 112
		Total	1	

45-04
Set II

4) Necessity of movement and use of machinery and equipment.

Immediately after the termination of the last war, our company planned and realized conversion to peace time industry having increased the amount of our production since then and is now producing as much as ¥ 200,000,000 every month. Also our export has amounted to ¥ 400,000,000 up to the present.

Accordingly the urgent necessary matter for us under the present circumstances consists in the advance both of the accuracy of workmanship and of efficiency whereas the equipments and machines in each factory of our company have already been superannuated a quarter of which is necessitated to be urgently substituted by new and efficient ones for which we made every effort but failed in finding out suitable one in the civil circles and furthermore such machines as manufactured after the end of the war are not only of bad quality but also poor in sort.

Such being the case, we hereby submit our application for the approval of our wishing borrow of the abovementioned superior machines to instal and use in our Mie factory for the purpose to improve the qualities of our manufactures as well as to advance our production efficiency and at the same times to augment our output raising up our export.

a) Our Mie Factory is one of the leading factories in Japan as standard motor manufacturing works. However, it is nothing but a dispersed factory during the last war and accordingly its equipments have already been superannuated and also are not still fully installed whereas demands for our motors are gradually increasing and inquiries are much in our hand.

Our export since the termination of the last war amounted to ¥ 100,000,000 and trends to be more and more in future so that in order to meet the increasing demands we must make every effort to quickly improve our present equipments aiming at the advancement of the qualities of our goods and reduction of the costs as well.

b) The uses of the machines we applied for are as below.

No.45-4-273 Radial drilling machine

Wakayama Tekko made.

This machine shall be used to drill the parts for medium size motors at our Mie Factory.

Two pieces are now installed in our Mie Factory either of which had been recklessly used during the war and damaged by the air raid having declined in accuracy and become so superannuated as its shaft violently vibrates with the result that the number of unit works for drilling the parts by this machine is necessarily increased by 20 or 30% as compared with other accurate drilling machines.

Under these circumstances, we should like to instal this machine for the purpose to contribute for the reduction of the number of the necessary unit works as well as for the advance in the amounts of our production and export.

Though this machine is Japanese made, its efficiency is high, but is not manufactured at present so that it can scarcely be obtained in the market in Japan.

Signed :

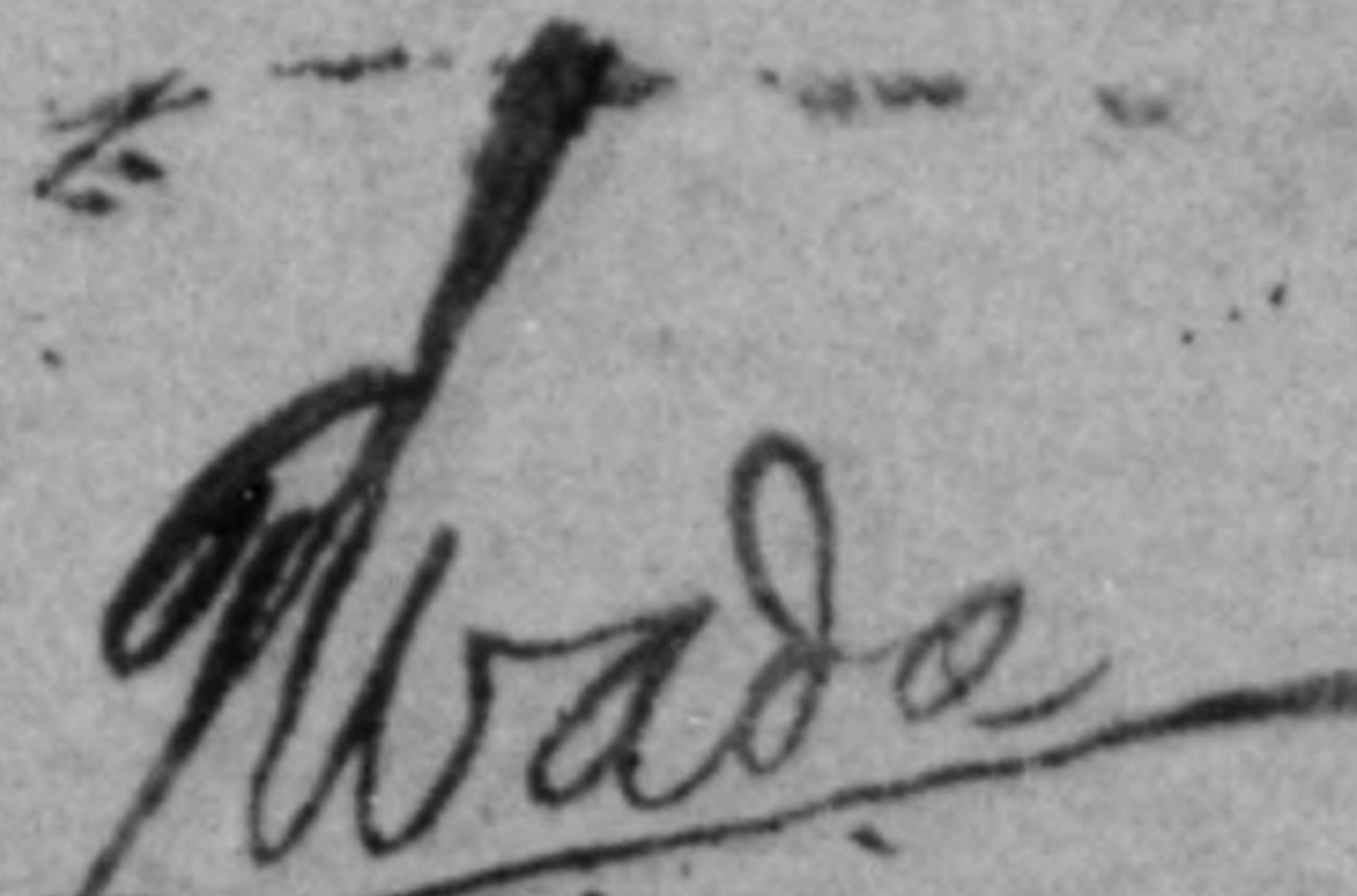

Tsunesuke Wada
President of Fuji Denki
Seizo K.K.

APPLICATION FOR MOVEMENT AND
 AUTHORIZED USE OF DESIGNATED REPAIRMENT
 MACHINERY AND EQUIPMENT

Date : Feb 20, 1951

To: Minister of **Finance**
 From: President of Fuji Denki Seizo K.K.

Address : No.1, Tanabeshinden, Kawasaki City,
 Kanagawa Prefecture.

1) Name (Code No.) and Location for the plant which intends to use
 designated reparation machinery and equipment.

Name : Fuji Denki Seizo K.K. Toyoda Factory
 Location : No.1880, Toyoda, Hinomachi, Miramitamagun
 Tokyo City.

(Non designated reparation plant)

2) Name (Code No.) and Location of the plant which designated reparation
 machinery and equipment to be used actually exist.

Name : Hikari Naval Arsenal Code No. 45-4
 Location : Mitsui, Hikari City, Yamaguchi Prefecture.

3) List of designated reparation machinery and equipment to be moved
 and used.

Inv. No.	Name of Machinery	Brief Specifications	Quantity	Remarks
45-4-134	Radial drilling m/c	Drilling capacity 50 Max. dis. between spindle to column 1290	1	Page 112 Evaluation Integrated Facility
45-4-1821	Gear shaper Fellow type	Wakayama Tekko Max. dia. of gear 260 Tokyo Kikai	1	244 Ditto
45-4-2020	Vertical milling m/c Knea type	Working surface of table 1500 x 350 Biernatzki	1	448 Ditto
Total			3	

Part II
 45-4

4) Necessity for movement and use of machinery and equipment.

Immediately after the termination of the last war, our company planned and realized conversion to peace time industry having increased the amount of our production since then and is now producing as much as ¥ 200,000,000 every month. Also our export has amounted to ¥ 400,000,000 up to the present.

Accordingly the urgent necessary matter for us under the present circumstances consists in the advance both of the accuracy of workmanship and of efficiency whereas the equipments and machines in each factory of our company have already been superannuated a quarter of which is necessitated to be urgently substituted by new and efficient ones for which we made every effort but failed in finding out suitable ones in the civil circles and furthermore such machines as manufactured after the end of the war are not only of bad quality but also poor in sort.

Such being the case, we hereby submit our application for the approval of our wishing borrow of the abovementioned superior machines to instal and use in our Toyoda factory for the purpose to improve the qualities of our manufactures as well as to advance our production efficiency and at the same time to augment our output raising up our export.

Impediments in the production of our factory whereto our applied machines shall be removed and the respective uses of these machines are as follows:

a) Status quo of our Toyoda Factory.

Our Toyoda Factory manufactures industrial measuring instruments and electric measuring instruments. This factory had been once nothing but a factory evacuated to the present site during the war time and afterwards converted into a factory for peace time industry so that precise machines are very short in number and not yet arranged.

Nevertheless, as for industrial measuring instrument, our Toyoda Factory is now counted as one of the prominent factories in Japan

being demanded to greatly increase its output so that tools, jigs, manufacturing precise machines, machines for accurate parts are the pressing needs for this factory whereas foreign made machines are hardly obtained and in addition even home made ones such as accurate enough to manufacture the abovementioned instruments are also very scarce in the market.

No. 45-4-134 Radial drilling machine

Wakayama Tekko made.

This shall be used to drill the parts for industrial measuring instruments. Drilling on the large size base for such instrument is now practised by manual operated drilling machine, but we intend to mechanize this work in order to raise up efficiency, reduce unit cost and at the same time increase our production amount by 50%. This machine is Japanese made, but its efficiency is very good. However, this not being manufactured now so that it can scarcely obtained in the present market.

No. 45-4-1821 Fellow type gear shaper

Tokyo Kikai made.

This shall be used at our Toyoda Factory to cut gears for repairing the machinery equipments installed therein. Also to our Toyoda Factory tool shop are attached and the tools, fixture and special machinery equipments necessary for manufacturing industrial measuring instruments are now manufactured by our own workers and furthermore repair of machines at large is executed thereat, but there exists no gear cutting machine in that factory.

Though this machine is Japanese made, its efficiency is very good. Under the present circumstances, however, this machine is not manufactured by the maker and accordingly it is extremely difficult for us to obtain this in the market.

No. 45-4-2020 Vertical milling machine

Birnatzkee made.

This machine shall be used to manufacture the parts for industrial measuring instruments. We have programmed to increase our production of industrial measuring instruments as much as 50% for which five pieces of vertical milling machines are necessary. This machine is one of the five machines, two of which are now in our possession and the rest two are now being looked for in the market. The abovesaid one is very high in efficiency so that if our application for borrowing this machine should be approved, we should be able to advance the accuracy of the parts to be manufactured at our factory and further to thoroughly perform our program. Being imported machine, this can hardly be obtained in the present Japanese market.

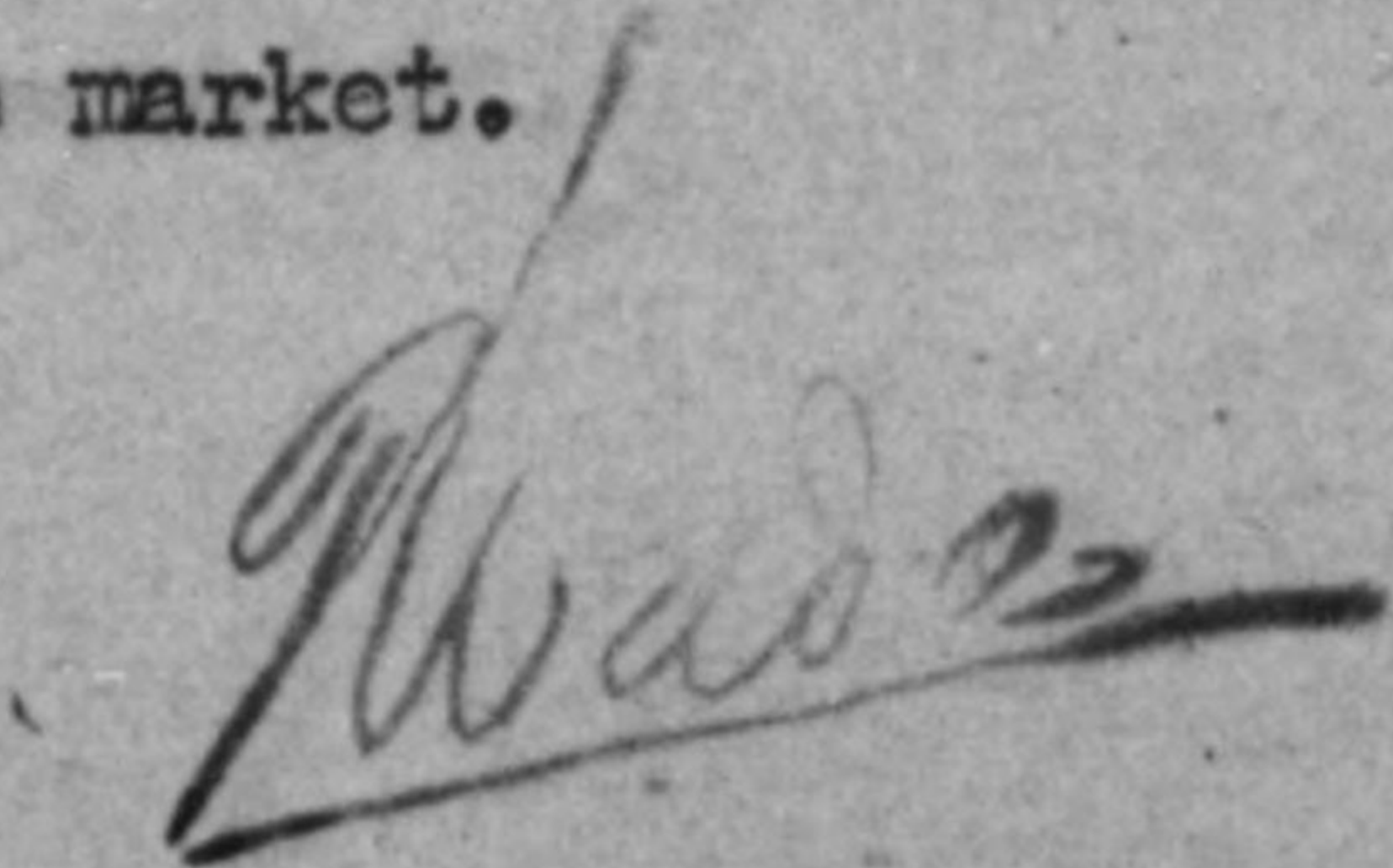
Signed: 

Tsunesuke Wada
President of Fuji Denki
Seizo K.K.

APPLICATION FOR MOVEMENT AND AUTHORIZED USE OF
DESIGNATED REPARATION MACHINERY AND EQUIPMENT

Date Feb 20, 1951

To : Minister of ~~Finance~~

From : President of Fuji Denki Seizo K.K.

Address : No.1, Tanabeshinden, Kawasaki City
Kanagawa Prefecture.

1) Name (Code No.) and Location for the plant which intends to use designated reparation machinery and equipment.

Name : Fuji Denki Seizo K.K. Kawasaki Factory

Location : No.1, Tanabeshinden, Kawasaki City
Kanagawa Prefecture.

(Non designated reparation plant)

2) Name (Code No.) and Location of the plant which designated reparation machinery and equipment to be used actually exist.

Name : Hikari Naval Arsenal Code No. 45-4

Location : Mitsui, Hikari City, Yamaguchi Prefecture.

3) List of designated reparation machinery and equipment to be moved and used.

Machinery

Inv.No.	Name of machinery	Brief Specifications	Quantity	Remarks
45-4-133	Radial drilling m/c	Drilling capacity 50 Max.dia. between spindle to column 1290 Wakayama Tekko	1	Page 109 Evaluation Integrated Facility
135	Ditto	Ditto	1	Ditto
215	Engine lathe	Swing over bed 460 Length of bed 2500 Hirao	1	168 Ditto

45-4
Sheet II

Inv.No.	Name of machinery	Brief Specifications	Quantity	Remarks
45-4-242	Engine lathe	Swing over bed 920 Length of bed 5400 Ikegai Tekko	1	Page 168 Evaluation Integrated Facility
252	Ditto	Swing over bed 820 Length of bed 5420 Ikegai Tekko	1	222 Ditto
253	Ditto	Swing over bed 920 Length of bed 5400 Ikegai Tekko	1	151 Ditto
364	Ditto	Swing over bed 720 Length of bed 4350 Ikegai Tekko	1	173 Ditto
430	Ditto	Swing over bed 670 Length of bed 4000 Okuma Tekko	1	102 Ditto
689	Ditto	Swing over bed 460 Length of bed 2500 Ikegai Tekko	1	Ditto
702	Ditto	Swing over bed 460 Length of bed 2000 Ikegai Tekko	1	171 Ditto
1407	Ditto	Swing over bed Length of bed Ikegai Tekko	1	Ditto
1941	Ditto	Swing over bed 480 Length of bed 2680 Hasse & Wrede	1	341 Ditto
3148	Horizontal boring m/c Floor type	Osaka Kiko	1	517 Ditto
3150	Planer-double housing	Max. stroke 5000 Kubota Tekko	1	605 Ditto
3326	Vertical boring and turning mill	Dia. of table 1070 Karatsu Tekko	1	520 Ditto
3328	Horizontal boring m/c Table type	Dia. of boring bar 90 Okuma Tekko	1	514 Ditto
			Total 16	

4) Necessity for movement and use of machinery and equipment.

This is the main factory of our company and its producing amount is ¥ 100,000,000 per month, but most of its machinery equipments had once been damaged by the air raid in the last war. Through some of them have been gradually repaired and put in use, most of them consist of such superannuated machines as were purchased at the time of the establishment of our company in 1923 and were of inferior manufacture.

Among our present machinery equipments of 1409 pieces, the 500 pieces, approximately one thirds of the total, are so inaccurate as are necessitated to be urgently substituted by more efficacious machines. The electric manufactures which we have exported up to this date reaches to a large sum, viz., enquiries received up to date amounts to more than ¥ 6,000,000,000 among which ¥ 400,000,000 is the sum of our goods delivered till the present day. Under these circumstances we should like to equip strong and precise machines from the view point of improvement of the qualities of our goods and the efficiency of our production. Nevertheless, not only such machines as made in foreign countries of course but also home made superior machines are quite hardly obtained. Impediments in the production of the factory where to our applied machines shall be removed and the respective uses for these machines are as follow:

No. 45-4-133 Radial drilling machine Wakayama Tekko made.

No. 45-4-135 Ditto

These shall be used to drill the parts for rotary machine and circuit breaker.

Having disused six pieces of the similar machines used for more than fifteen years, we should like to employ the above-mentioned machines in place of our existing ones.

Though we have applied for two machines in Government possession, we hereby submit our application for using these machines to replenish the present shortage.

Though these machines are Japanese made, its conditions and efficiency are very good. However they can scarcely be obtained in the Japanese market.

No. 45-4-215 Engine lathe Hiraio made.

To be used for processing the parts for rotary machine.

With the abovesaid machine, the existing similar machine of C class shall be substituted in order to increase our production efficiency by 20%.

Though this machine is Japanese made, its condition and efficiency is very good. Under the present circumstances, however, this machine is not manufactured by the maker and accordingly it is difficult for us to obtain this in the market.

No. 45-4-242 Engine lathe Ikegai Tekko made.

No. 45-4-252 Ditto Ditto

No. 45-4-253 Ditto Ditto

No. 45-4-364 Ditto Ditto

No. 45-4-430 Ditto Okuma Tekko made

These machines shall be used to manufacture the shaft of medium and large type rotary machine and its parts. The similar machines in our possession have been used for more than fifteen years and over half of them are very low in accuracy. In addition, we are in urgent need of medium and large size lathe due to the alteration of the kinds of our manufactures after the end of the war, so that we should like to use them in order to supplement and substitute our existing machines and by doing so we intend to increase our production efficiency as much as 20%.

Though these machine are Japanese made, they are superior ones and can scarcely be obtained in our market.

No. 45-4-689

No. 45-4-702

No. 45-4-1407

These are to be used for manufacturing the parts of rotary machine. We should like to substitute our present machines with the above in order to raise up our production efficiency by 20%.

These machines are superior ones and it is difficult to obtain these in the market.

No. 45-4-1941 Engine lathe Hasse & Wrede made.

To be used for processing the parts of rotary machine.

With the abovementioned machine, our present machine of C class shall be substituted in order to raise up our production efficiency by 20%.

Being foreign made, this machine is very hard to obtain in the present market.

No. 45-4-3148 Horizontal boring machine Osaka Kiko made.

This shall be used to manufacture the parts for rotary machine. Though we possess a large type boring machine which is very low in accuracy and efficiency on account of its damage by the last war.

No. 45-4-3150 Planer Kubota Tekko made.

To be used for processing the parts for rotary machine and shall be used for the supplement of our present machine which has been disused because of its war damage.

Though this machine is Japanese made, it is very good and the manufacturing of this machine is now stopped and accordingly too many days would be taken if ordered by us, to meet our urgent needs such as our export schedule and others.

No. 45-4-3326 Vertical boring and turning mill
Karatsu Tekko made.

This shall be used for manufacturing the parts of large type circuit breaker.

Though 8 pieces of small type lathes of the same kind are in our possession, most of them have been used for more than fifteen years and they are so obsolete as to be of low efficiency and accuracy. If these should be substituted by our applied machines, our production efficiency would be raised up by 20%.

Though this machine is Japanese made, it is very good one and it is very difficult to obtain in the market.

No. 45-4-3328 Horizontal boring machine

Okuma Tekko made.

This shall be used for manufacturing the parts of rotary machine. We should like to substitute our present boring machine of medium type which had been damaged by the last war being so much declined in accuracy and efficiency with our applied machine which will increase our production efficiency by 20%.

Though this machine is Japanese made, it is very difficult to obtain such a superior machine in the present market.

Signed :

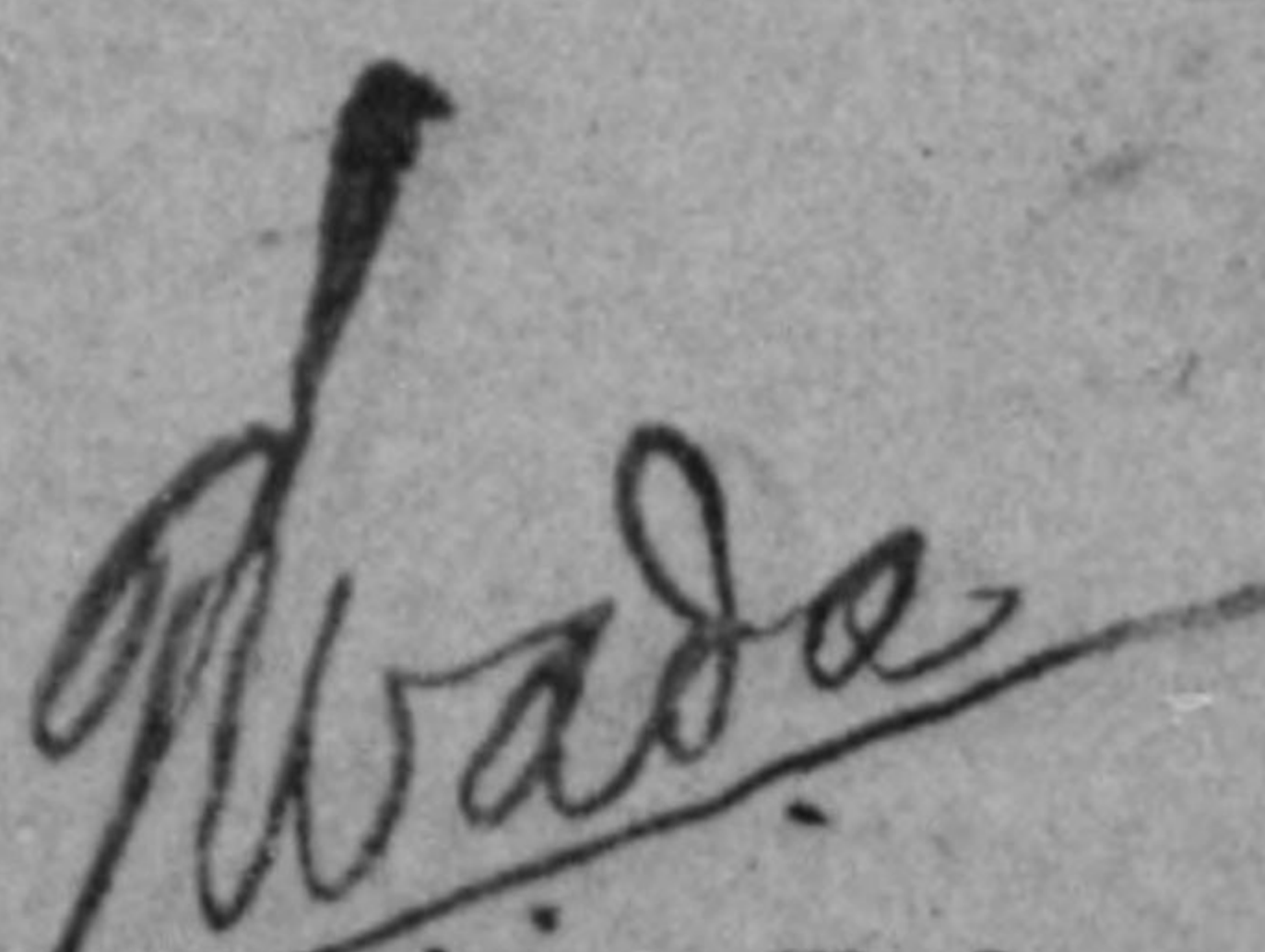
Tsunesuke Wada
President of
Fuji Denki Seizo K.K.

APPLICATION FOR MOVEMENT AND AUTHORIZED USE OF
DESIGNATED REPARATION MACHINERY AND EQUIPMENT

Date Feb 20, 1951

To: Minister of Finance

From: President of Fuji Denki Seizo K.K.

Address: No.1, Tanabechinden, Kawasaki City
Kanagawa Prefecture.

- 1) Name (Code No.) and Location for the plant which intends to use designated reparation machinery and equipment.

Name: Fuji Denki Seizo K.K. **Fukiage** Factory

Location: **No. 3050, Fukiage Machi, Kitadachi-gun, Saitama Prefecture**
(Non designated reparation plant)

- 2) Name (Code No.) and Location of the plant which designated reparation machinery and equipment to be used actually exist.

Name: Hikari Naval Arsenal Code No. 45-04

Location: Mitsui, Hikari City, Yamaguchi Prefecture

- 3) List of designated reparation machinery and equipment to be moved and used.

Inv. No.	Name of machinery	Brief Specifications	Quantity	Remarks
1354	Lathe engine	S.O.B. 360 Bed Length 1830 Ikegai Iron Works	1	Page 337 Evaluation Integrated Facility
1852	Ditto.	Ditto.	1	285 Ditto
Total			2	

45-4
Sub II

4) Necessity for movement and use of machinery and equipment.

Immediately after the termination of the last war, our company planned and realized conversion to peace time industry having increased the amount of our production since then and is now producing as much as ¥ 200,000,000 every month. Also our export has amounted to ¥ 400,000,000 up to the present.

Accordingly the urgent necessary matter for us under the present circumstances consists in the advance both of the accuracy of workmanship and of efficiency whereas the equipments and machines in each factory of our company have already been superannuated a quarter of which is necessitated to be urgently substituted by new and efficient ones for which we made every effort but failed in finding out suitable ones in the civil circles and furthermore such machines as manufactured after the end of the war are not only of bad quality but also poor in sort.

Such being the case, we hereby submit our application for the approval of our wishing borrow of the abovementioned superior machines to instal and use in our Fukiage factory for the purpose to improve the qualities of our manufactures as well as to advance our production efficiency and at the same time to augment our output raising up our export.

Impediments in the production of our factory whereto our applied machines shall be removed and the respective uses of these machines are as follows:

a) Status quo of our Fukiage Factory.

Our Fukiage Factory is one of our works dispersed to rural districts in order to evade air raid in the war time and the machines therein are those which had once been damaged by fire at our Kawasaki Factory and removed to the former rightly before the end of the war.

At present pole transformers, pumps, agricultural implements and controlling devices for motors are being manufactured at our Fukiage Factory, but evormous difficulties caused by the shortage of machines and their inaccuracy are embarrassing the factory, Accurate machines necessary to manufacture controlling device and agriculturel implement are very scarce in the market so that suitable ones can not be obtained now.

b) Respective uses for our applied machines.

4# No.45-04-1354 Engine lathe 360x1830 Ikegai iron works made.

We should like to use this machine for arranging the jig and fixture resultant from the manufacturing process researches this machine is made in Japan being superior in efficiency, but is very scarce in the present market in Japan.

No. 45-04-1852

Ditto.

Signed

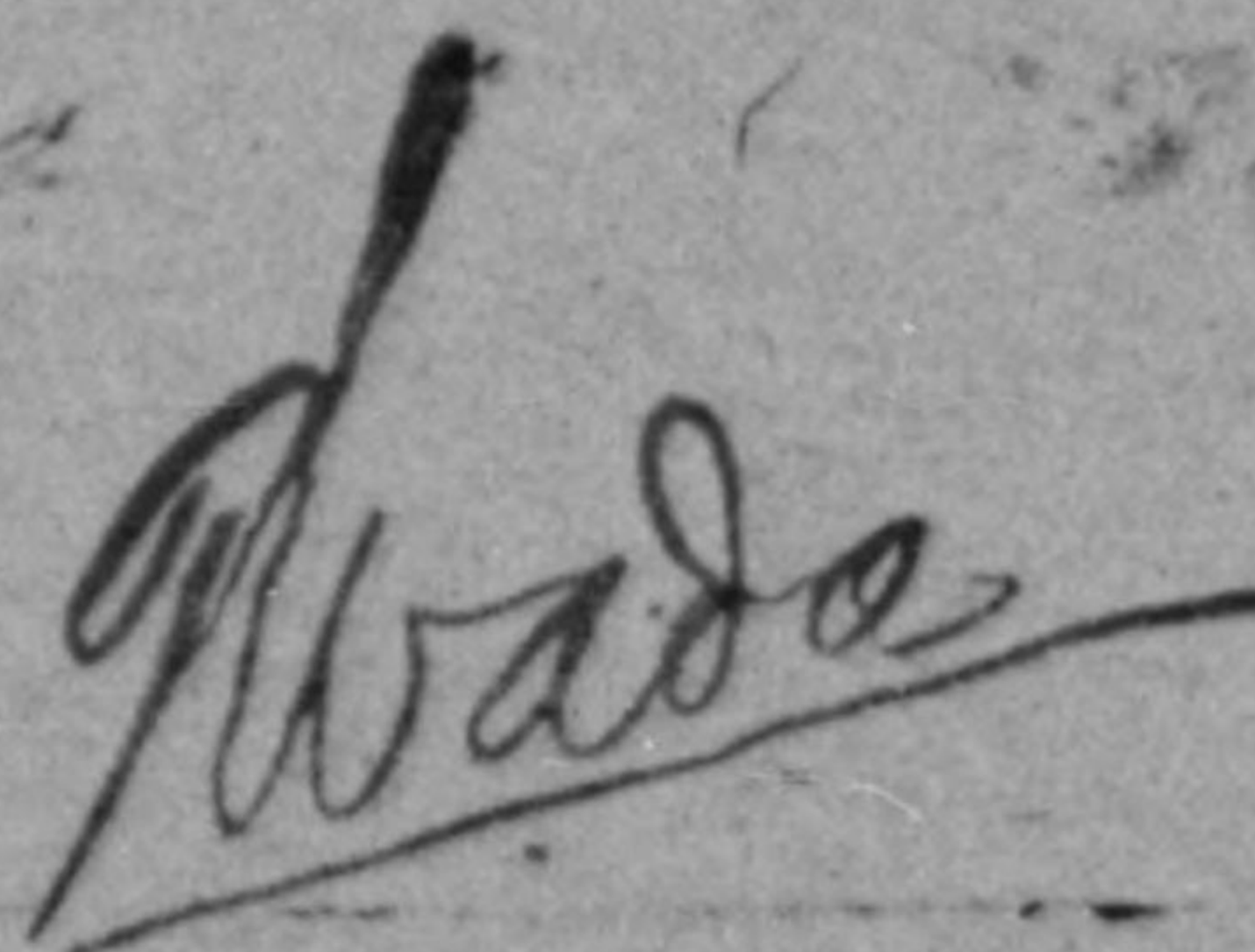

Tsunesuke Wada
President of
Fuji Danki Seizo K.K.

1 March 1951

NO: 26 KI 1208

TO: General Headquarters Supreme Commander for the Allied Powers.

THRU: Reparation Agency.

FROM: Ministry of International Trade and Industry.

SUBJECT: Recommendation For Conversion of Ex Hikari Naval Arsenal,
Filed by Tokuyama Teppan Kabushiki Kaisha.

1. Reference is attached Application for Conversion of Ex Hikari Naval Arsenal (Code No. 45-4) Filed by Tokuyama Teppan K.K.
2. The above conversion is regarded as necessary for the rehabilitation of Japan's economy, based on the below-mentioned reasons. The Ministry of International Trade and Industry solicit you, therefore, that this application for conversion be approved under your special consideration.
 - (a) The applicant is one of the most important rolling mill operators in this country. Especially, it has an excellent technique and long experience in steel strips manufacturing. Steel sheets, being manufactured in this company, are being supplied for Special Demand to the great extent.
 - (b) Owing to the increase of steel demand, the company has been compelled to promote above mentioned products. However, such promotion is checked due to the fact that the company has not any open hearth furnace. Namely, the main plant of the company, located in Tokuyama City, has no equipment of open hearth furnace. Sheet Bars, Billets and other materials, for operation of main plant, are being supplied from other steel makers. In view of present circumstances of raw materials in Japanese steel makers, advancement of rolling mill operation can be hardly expected as far as materials are being solely supplied from other steel makers.

45-4
Doc II

(c) For the purpose of increasing of steel sheet and steel strips production at the main plant, equipment of open hearth furnace is necessary. However, the company has no vacant land for construction of such furnaces as mentioned above in this plant. Accordingly, utilization of open hearth furnaces and its accessories of ex Hikari Naval Arsenal, locating at short distance therefrom, by this company, is most desirable to increase the production of Billet and Sheet Bars and other materials. By operating open hearth furnace, the production of steel products at Tokuyama Plant may be advanced so much.

Hikomichi Kawata

Chief, Facilities Utilization Section, Enterprise Bureau.

For

Takeo Ishihara,

Chief, Enterprise Bureau,

Ministry of International Trade and Industry.

*Mr. Armstrong
include no. of days
crane was used in
the February month
activities report
RHS*

Jan. 5, 1951

To : Chugoku Civil Affairs Region
Attn. Economic Section

Through : The Hikari Branch of Chugoku Finance Bureau.
Japanese Government.

Subject : Temporary Loan of Reparations Crane - Hikari Naval
Arsenal, Yamaguchi Prefecture

1. We contracted to sell the high carbon steel scrap
(the special iron ingots) Purchased from the committee of Ligu-
idating Companies (C.I.L.C.) to the Yahata Iron Producing Co
Yahata city Fukuoka Pref..

2. Therefore we are in good earnest to obtain the
permission as below for, above pieces of ingots are very big
weighting about 12 tons and difficulty to handle.

Terms. from Jan. 6 Feb, 6. (One month)
Items. the operation of overhead crane,
reparations code No. 45-4-2665,
Hikari Naval Arsenal, Yamaguchi Pref.

30 Ton capacity

45-4-4
F
H

Yours very truly.

Y. Kimura

Yoshio Kimura
Manager of Kure Takamori Sangyo K.K.
Agent of Marunouchi Shoji K.K.

*1450
F
H
approved*

Jan. 5, 1951

To : Chugoku Civil Affairs Region
Attn. Economic Section

Through : The Hikari Branch of Chugoku Finance Bureau.
Japanes Government.

Subject : Temporary Loan of Reparations Crane - Hikari Naval
Arsenal, Yamaguchi Prefecture

1. We contracted to sell the hight carbon steel scrap
(the special iron ingots) Puchased from the committe of Ligu-
idating Companies (C.I.L.C.) to the Yahata Iron Producing Co
Yahata city Fukuoka Pref..

2. Therefore we are in good earnest to obrain the
permission as below for, above pieces of ingots are very big
weighting about 12 tons and difficulty to handle.

Terms. from Jan. 6 Feb,6. (One month)
Items. the operation of overhead crane,
reparations code No. 45-4-2665,
Hikari Naval Arsenal, Yamaguchi Pref.

Yours very truly.

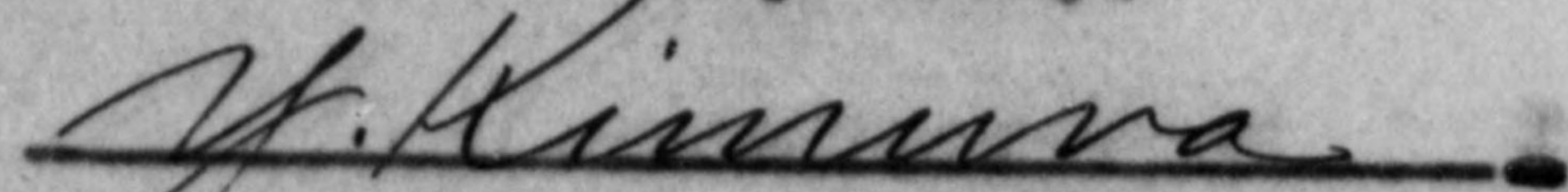

Yoshio Kimura
Manager of Kure Takamori Sangyo K.K.
Agent of Marunouchi Shoji K.K.

一時使用許可申請書

舊光海軍工廠製鋼工場に於ける閉鎖機關整理委員會所属インゴット
移動機出の爲左記起重機一時使用許可相賜度願申上げます。
尚起重機破損の場合には弊社責任を以て修理致します。

一、使用期間 昭和廿六年一月六日より昭和廿六年二月六日まで

一、使用機械 四五―四―二六六五 三〇吨吊天井起重機

四五―四―三五一三 變壓器

三五一四

三五一五

四五九二 配電盤

四五九四

昭和廿六年一月六日

吳市寺西町

高森 善



業株式會社

光管財支所長 殿

APPLICATION FOR MOVEMENT AND AUTHORIZED USE OF
DESIGNATED REPAIR MACHINERY AND EQUIPMENT

Date: 12 February, 1951.

To : Minister of Finance

From : President of Yamaoka Nainenki K.K.

Address : 62, Chayamachi, Kita-ku, Osaka City.

1) Name and location of the Plant which intends to use
designated reparation machinery and equipment.

a) Name : Nagahama Plant, Yamaoka Nainenki K.K.
(Non reparation Plant)

Location: 69, Funayama-cho, Nagahama City, Shiga Pref.

b) Name : Kanzaki Plant, Yamaoka Nainenki K.K.
(Non reparation Plant)

Location: 3, Nagasujikyo, Amagasaki City, Hyogo Pref.

2) Name (Code No.) and location of the Plant where designated
Reparation machinery and equipment to be used actually exist.

Name : Hikari Naval Arsenal.

Code No.: 45-04

Category: Arsenal.

Location: Yamaguchi Pref.

3) List of designated reparation machinery and equipment
to be moved and used.

See attached list of the desired reparation designated
machinery and equipment.

4) Necessity for movement and use of machinery and equipment.

We are/only single Maker of "small type diesel-engines" in Japan, having some forty years' experience. Before the war, we exported a great many engines to the various countries, while at home we widely satisfied the demands from agricultural and fishing use. After the end of war, we have already exported over ten thousand engines to India, Pakistan, Siam, Phillipines, and Okinawa. In the assembly plant in India which has been recently established, we are completing the engines with the imported parts from our plant and India-made ones, which have already amounted to about two thousand. And now monthly demand of the parts amounts to some three thousand sets.

45-04
Sect-II

- 3 -

Machinery and Equipment in Plant :

Name of Items	No. of Items	
	Nagahama Plant	Kanzaki Plant
Lathe	159	180
Grinding machine	43	15
Milling machine	42	38
Drilling machine	52	51
Boring machine	12	18
Lapping machine	54	69
Planner, Shapers, Slotter	11	16
Honing machine	2	1
Furnaces	5	26
Other equipment	32	18
Total	412	432

(Signed) for the President:

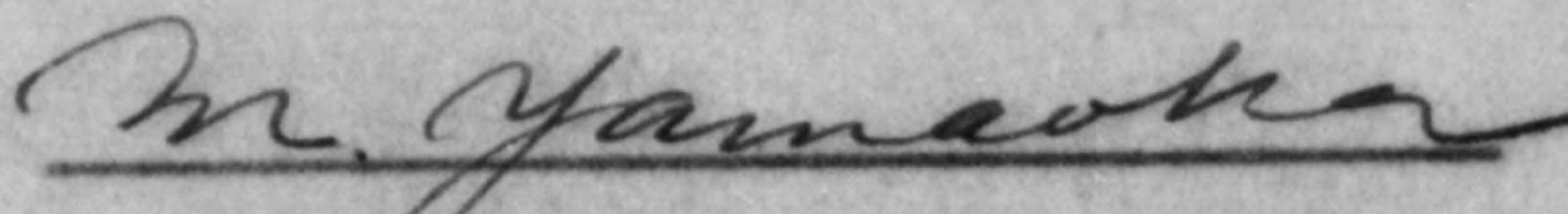

Mageshichi Yamaoka

President of Yamaoka Hainenki K.K.

Attached documents:

Approval of the applicant, concerning responsibility of custody for designated reparation machinery and equipment.

LETTER OF ASSENT

Date: February, 1951.

To : The Ministry of Finance

From : Yamaoka Sainenki K.K.

62, Chayamachi, Kita-ku, Osaka City.

Sirs;

I, the undersigned, hereby assent for the custodian of Hikari Naval Arsenal (Code No. 45-04) to take burden of the responsibility pertaining to maintenance of the reparation designated machinery and equipment, list of which is attached to the application herein, belong to the above Arsenal, after the same were moved into Nagahama Plant and Kanzaki Plant, Yamaoka Sainenki K.K.

For the President:

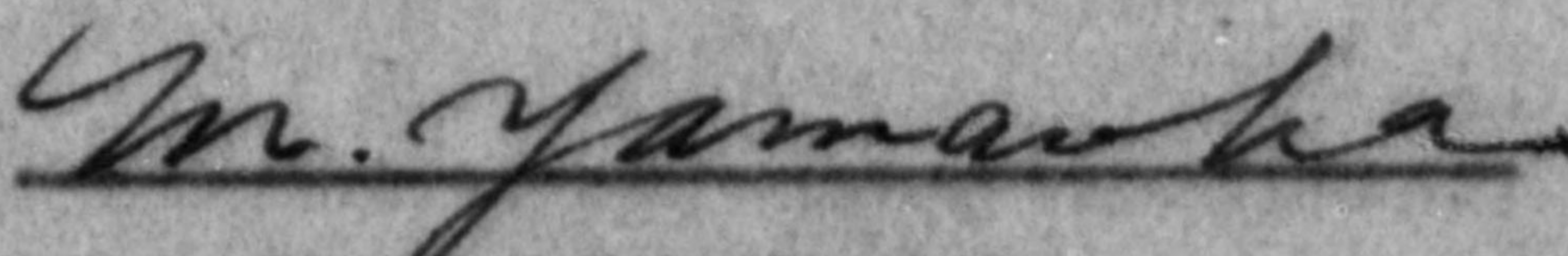

Magokichi Yamaoka

President of Yamaoka Sainenki K.K.

Attached Sheet

List of the desired reparation designatedMachinery and Equipment

Code No. 45-04

Applicant : Yamaoka Nainenki K.K.

Inventory No.	Name of Machinery	Type and Dimension	Name of Mfg. Co.	Quantity	Operation or idle	Evolution Work Sheets Sheet No.	Applicant Plant
<u>Machine Tool</u>							
45-4-1470	Lathe Turret	SOB. 150 mm B.L. 800 mm	Brown & Sharpl	1	idle	425	Kansaki Plant
" - 39	"	SOB. 400 mm B.L. 2100 mm	Warner Swasey	1	"	125	Nagahama Pl Plant
" - 51	Lathe-Automatic	SOB. 260 mm B.L. 1420 mm	Prattand Whitney	1	"	184	"
" - 206	Lathe-Relieving	SOB. 840 mm B.L. 2350 mm	Michigan Tool Co.	1	"	184	Kansaki Plant
" - 92	Lathe-Engine	SOB. 530 mm B.L. 2500 mm	Toyo-Kikai	1	"	157	"
" - 777	"	"	"	1	"	76	"
" - 429	"	"	"	1	"	75	"
" - 776	"	"	"	1	"	75	"
" -3120	"	"	"	1	"	548	"
" -3371	"	"	"	1	"	548	"
" - 773	"	SOB. 460 mm B.L. 2500 mm	Ikegai	1	"	79	"
" -3039	"	"	"	1	"	555	"
" - 77	Drilling m/c Upright aut-Feed	Capacity 15 x 150 mm Swing 380 mm	Unknown	1	"	110	"
" - 200	Boring m/c Horiz-Boring Drilling	Dia and Travel of Spindle 75 x 1200 mm	Okuma	1	"	105	"
" -2065	"	90x780 mm	"	1	"	227	"

45-4-1363	Milling m/c Knee Verti	Size of Working Surface table 2000x1000	Osaka- kiko	1	idle	456	Kanzaki Plant
" -9318	Water Brake Dynamometer	Capacity 300 H/P	Tokyo koki seisaku	1	"	951	"
" -3317	"	" 500 H/P	"	1	"	951	"
" - 415	"	" " 300 H/P	"	1	"	951	"
" -1877	Dividing m/c circle	Dividing Dia 1000 mm	Genevoise	1	"	634	"

Total 20

CMGR 386.3 (D-Ki)
(30 Mar 1949)

1st Ind

Subject: Loan of Reparations Equipment

Headquarters Chugoku Military Government Region, APO 248,
Kure, Honshu, 7 April 1949

TO: Commanding Officer, Yamaguchi Military Government Team,
APO 248

1. Permission has been granted by authority of telephone message from Major Trennaman, Headquarters Eighth Army dated 5 April 1949 for temporary use of reparations items listed in basic communication, and for purposes contained therein.

2. Subject equipment will be returned to initial custodial facility upon the completion of reparation removals at 45-05.

BY ORDER OF COLONEL SNYDER:

1 Incl:
n/c

JERRY W. TOM
1st Lt, USAF
Adjutant

Handwritten: 45-4
FF

5

ECONOMICS	
SEC.C.	<i>SM</i>
N.R.	<i>SM</i>
C&T.	<i>SM</i>
M&I.	<i>SM</i>
LABOR	
C.C.	

HEADQUARTERS
YAMAGUCHI MILITARY GOVERNMENT TEAM
YAMAGUCHI, HONSHU, JAPAN
APO 248

EMT/dn

30 March 1949

YMG 386

SUBJECT: Loan of Reparations Equipment

TO: Commanding Officer
Chugoku Military Government Region
APO 248

1. Attached application, submitted by the Yamaguchi Local Office of the Hiroshima Finance Bureau, is forwarded for consideration.
2. Recommend favourable action.

1 Incl:
As notedEUGENE J. McNAMARA
Lt. Col., Infantry
SMGO

5

IWAKUNI ADMINISTRATION OFFICE
HIROSHIMA FINANCE BUREAU

29 March 1949

SUBJECT: Petition of Reparations Equipments for Temporary Use.

TO: COMMANDING OFFICER
YAMAGUCHI MILITARY GOVERNMENT TEAM

Sir:

We hereby cordially beg you to grant permission for the reparations equipments of Hikari Ex-Naval Arsenal for temporary use according to the following reasons.

1. Name of Arsenal: Hikari Ex-Naval Arsenal
2. Reparations Equipments proposed for Temporary Use:

<u>Code No.</u>	<u>Item</u>	<u>Cap.</u>	<u>Qty.</u>	<u>Remarks</u>
45-4-5011	Weight Measuring Machine	3 tons	1	
45-4-5009	do.	10 tons	1	
45-4-5267	Trolley for Crane	5 tons	1)	1 set
45-4-5268	Operator for Crane	5 tons	1)	
45-4-580	Trolley	3 tons	1)	Part of Over-head Travelling Crane
45-4-580	Operator	3 tons	1)	
45-4-580	Motor	10 HP	1)	(1set)
45-4-580	Resistant		3)	

Total: 10 (within 6 are accessories)

3. Reasons for Proposal:

On 5 Feb. 49, we received an unofficial instruction for allocation from GHQ through the Japanese Government to make plans for dismantling, packaging and shipping of the whole facilities in Iwakuni Ex-Army Fuel Depot. Therefore, it is necessary to prepare the packaging shops.

in order to carry out these operations. But, in order to repair the overhead travelling cranes in our Depot, which are damaged, we should like to borrow the reparations equipments of Hikari Ex-Naval Arsenal

4. Period proposed for Use:

From the day permitted and until the end of the shipping operations.

We cordially beg for this petition be permitted urgently.

Yours remain,

Yours very respectfully,

Seiji Yamamoto

Seiji Yamamoto
Chief, Iwakuni Administration Office

Ichiro Tsukamoto

Ichiro Tsukamoto
Chief, Yamaguchi Local Office of
Hiroshima Finance Bureau

CMGR 386.3 (D-K1)
(30 Mar 1949)

1st Ind

Subject: Loan of Reparations Equipment

Headquarters Chugoku Military Government Region, APO 248,
Kure, Honshu, 7 April 1949

TO: Commanding Officer, Yamaguchi Military Government Team,
APO 248

1. Permission has been granted by authority of telephone message from Major Trennaman, Headquarters Eighth Army dated 5 April 1949 for temporary use of reparations items listed in basic communication, and for purposes contained therein.

2. Subject equipment will be returned to initial custodial facility upon the completion of reparation removals at 45-05.

BY ORDER OF COLONEL SNYDER:

1 Incl:
n/c

JERRY W. TOM
1st Lt, USAF
Adjutant

ECONOMICS	
SEC. C.	
N.R.	
C&T.	
M&I.	
LABOR	CM
C.C.	

MANUFACTURING
AND INDUSTRY
FILE 23

IWAKUNI ADMINISTRATION OFFICE
HIROSHIMA FINANCE BUREAU

29 March 1949

SUBJECT: Petition of Reparations Equipments for Temporary Use.

TO: COMMANDING OFFICER
YAMAGUCHI MILITARY GOVERNMENT TEAM

Sir:

We hereby cordially beg you to grant permission for the reparations equipments of Hikari Ex-Naval Arsenal for temporary use according to the following reasons.

1. Name of Arsenal: Hikari Ex-Naval Arsenal
2. Reparations Equipments proposed for Temporary Use:

<u>Code No.</u>	<u>Item</u>	<u>Cap.</u>	<u>Qty.</u>	<u>Remarks</u>
45-4-5011	Weight Measuring Machine	3 tons	1	
45-4-5009	do.	10 tons	1	
45-4-5267	Trolley for Crane	5 tons	1 (1 set
45-4-5268	Operator for Crane	5 tons	1 (
45-4-580	Trolley	3 tons	1)	Part of Over-head Travelling Crane
45-4-580	Operator	3 tons	1)	
45-4-580	Motor	10 HP	1	1 set
45-4-580	Resistant		3	

Total: 10 (within 6 are accessories)

3. Reasons for proposal:

On 5 Feb 49, we received an unofficial instruction for allocation from GHQ through the Japanese Government to make plans for dismantling, packaging and shipping of the whole facilities in Iwakuni Ex-Army Fuel Depot. Therefore, it is necessary to prepare the packaging shops in order to

C O P Y

carry out these operations. But, in order to repair the overhead travelling cranes in our depot, which are damaged, we should like to borrow the reparations equipments of Hikari Ex-Naval Arsenal.

4. Period proposed for use:

From the day permitted and until the end of the shipping operations.

We cordially beg for this petition be permitted urgently.

Yours Remain,

Yours very respectfully,

Seiji Yamamoto

Seiji Yamamoto
Chief, Iwakuni Administration Office

Ichiro Tsukamoto

Ichiro Tsukamoto
Chief, Yamaguchi Local Office of
Hiroshima Finance Bureau

COPY

BASIC: Ltr, Hq YMG, APO 317, Serial No. 999-B, dtd 12 Jul 48, subj: "Temporary Use of Reparations Equipment,"

CMGR 386.3 (D-No)

5th Ind

Headquarters, Chugoku Military Government Region, APO 317, Kure, Honshu, Japan, 23 September 1948

TO: Commanding Officer, Yamaguchi Military Government Team, APO 317

1. Attention is invited to the 3rd Indorsement.
2. Request that the Asahi Salt Manufacturing Company be notified of the authorized use of four lime roasting furnaces in the Hikari Naval Arsenal and that records in your office be corrected to indicate the increase in authorized use machinery.

BY ORDER OF COLONEL SNYDER:

1 Incl:
n/c

JERRY W. TOM
1st Lt, USAF
Adjutant

45-4
out II

1	SEC
2	NR
3	C&T
4	L
5	CC

Handwritten initials and signatures over the routing slip.

MANUFACTURING
AND INDUSTRY
FILE 12

Handwritten initials in a circle.

COPY

BASIC: Ltr, YMG, APO 317, Serial No. 999-E, subject: "Temporary Use of
Reparations Equipment," dated 12 July 1948.

AGMGEM 386.3

2nd Ind

HEADQUARTERS EIGHTH ARMY, APO 343

TO: Supreme Commander for the Allied Powers, APO 500
(ATTN: ESS/IN)

The lime to be produced in this plant is in great demand as fertilizer and its use will increase the agricultural production. It is recommended that the application for temporary use of the furnaces be approved.

FOR THE COMMANDING GENERAL:

1 Incl:
n/c

/s/t/ R. SCHAFER
Lt Col, AGD
Asst Adj Gen

A⁴ 387.6 (12 Jul 48)REP

3rd Ind

GENERAL HEADQUARTERS, SUPREME COMMANDER FOR THE ALLIED POWERS, APO 500
9 September 1948

TO: Commanding General, Eighth Army, APO 343

The Asahi Salt Manufacturing Co., Hikari City, Yamaguchi Prefecture is authorized to use four (4) lime roasting furnaces in Hikari Naval Arsenal (Code No. 45-4).

BY COMMAND OF GENERAL MacARTHUR:

1 Incl:
n/c

/s/t/ J. F. BRADSHAW
Major, AGD
Asst Adj Gen

AGMGEM 386.3

4th Ind

Headquarters, Eighth Army, APO 343

16 Sept 48

TO: Commanding Officer, Chugoku Military Government Region, APO 317

Attention is invited to the 3rd indorsement.

BY COMMAND OF LIEUTENANT GENERAL WALKER:

1 Incl:
n/c

COPY

107
/s/t/ R. SCHAFER
Lt Col, AGD
Asst Adj Gen

BASIC: Ltr, GHQ, SCAP, APO 500, AG 387.6 (14 Feb 1948)NR-MG, subj:
"Application for Loan of Reparations Machinery", dated 30
July 1948.

6 AUG 1948

AGMGEM 386.3

1st Ind

Headquarters Eighth Army, APO 343

TO: Commanding Officer, Chugoku Military Government Region, APO 317

Attention is invited to the basic communication.

BY COMMAND OF MAJOR GENERAL RYDER:

RECORDED
R. SCHAFER
Lt. Col., AGD
Asst. Adjutant General

1 Incl:
n/c

45-4
all II

CMGR 386.3 (D-No)

2nd Ind

Headquarters, Chugoku Military Government Region, APO 317, Kure, Honshu,
Japan, 12 August 1948

TO: Commanding Officer, Yamaguchi Military Government Region, APO 317

Your attention is invited to basic letter.

BY ORDER OF COLONEL SNYDER:

1 Incl:
n/c

JERRY W. TOM
1st Lt, USAF
Adjutant

RC&I
1 SECC
2 NR
3 C&I
4 L&S
5 CC

914

MANUFACTURING
AND INDUSTRY
FILE 12

8817

C O P Y

GENERAL HEADQUARTERS
SUPREME COMMANDER FOR THE ALLIED POWERS
APO 500

AG 387.6 (14 Feb 48) NR-MG

30 Jul 1948

SUBJECT: Application for Loan of Reparations Machinery

TO: Commanding General
Eighth Army
APO 343
ATTENTION: Military Government Section

1. Reference is made to letter from Yamaguchi Finance Office, Hiroshima Finance Bureau, subject as above, 14 February 1948, a copy of which was delivered by Yamaguchi Military Government Team to personnel of Natural Resources Section, General Headquarters, Supreme Commander for the Allied Powers, during a staff visit on 13 May 1948.

2. General Headquarters, Supreme Commander for the Allied Powers, considers it economically unsound at this time to encourage capital outlays for establishing shops and factories based on the use of equipment marked for reparations, since the equipment may be withdrawn at any time.

BY COMMAND OF GENERAL MacArthur:

1 Incl:
as indic, par 1/s/t/ J. F. BRADSHAW
Major, AGD
Asst Adj Gen

C O P Y

Handwritten initials and a circled number 52.

Yamaguchi

Major Adams

MACHINERY and EQUIPMENT BEING USED

HIKARI NAVAL ARSENAL

(45-4)

NAME OF USER	MACHINERY AUTHORIZED FOR USE BY HQ 8th ARMY	NUMBER IN USE	NUMBER NOT BEING USED	BEING USED WITHOUT AUTHORITY	TOTAL MACHINES ACTUALLY USED	REMARKS
Asahi Salt Co.	53	47	6	12	59	6 extra
Takeda Pharmaceutical Co.	89	55	34	13	68	21 less
Hiroshima Division of Govt Railways	294	247	47	43	290	4 less

D

MACHINERY and EQUIPMENT BEING USED

HIKARI NAVAL ARSENAL

(45-4)

NAME OF USER	MACHINERY AUTHORIZED FOR USE BY HQ 8th ARMY	NUMBER IN USE	NUMBER NOT BEING USED	BEING USED WITHOUT AUTHORITY	TOTAL MACHINES ACTUALLY USED	REMARKS
Asahi Salt Co.	53	47	6	12	59	6 extra
Takeda Pharmaceutical Co.	89	55	34	13	68	21 less
Hiroshima Division of Govt Railways	294	247	47	43	290	4 less

MANUFACTURING
AND INDUSTRY
FILE 12

BASIC: Ltr, Hqs Yamaguchi Mil Govt Team, AFO 317. Subj. "Exemption of
Reparations Equipment," 2 Mar 48.

CMER 386.3 (D-No) ^{5th}
~~Ind~~ Ind

Headquarters, Chugoku Military Government Region, AFO 317, Kure, Honshu,
16 April 1948

TO: Commanding Officer, Yamaguchi Military Government Team, AFO 317

1. Forwarded for your information.
2. Request that the Takeda Pharmaceutical Industries Ltd be
informed of the Contents of Paragraph, of 3rd Indorsement.

BY ORDER OF COLONEL SNYDER:

1 Incl:
n/s

JERRY W. TOM
1st Lt., USAF
Adjutant

45-4
enc II

Handwritten signature

BASIC: Ltr. Hq Yamaguchi Mil Govt Team, APO 317, subj, "Exemption of
Reparations Equipment," 2 Mar 48.

AG 387.6(2 Mar 48)REP

3d Ind

GENERAL HEADQUARTERS, SUPREME COMMANDER FOR THE ALLIED POWERS, APO 500

5 APR 48

TO: Commanding General, Eighth Army, APO 343

Permission is granted to temporarily use the requested chimney until such time as the open hearth furnace is allocated. Since this is a part of the equipment, there is no authority to release it from reparations.

BY COMMAND OF GENERAL MacARTHUR:

1 Incl
n/c

J. F. BRADSHAW
Major, AGD
Asst Adj Gen

AG 386.3 (MG-Em)

4th Ind

10 APR 1948

Headquarters Eighth Army, APO 343

TO: Commanding Officer, Chugoku Military Government Region
APO 317

Attention is invited to the 3rd indorsement.

BY COMMAND OF LIEUTENANT GENERAL EICHELBERGER:

1 Incl:
n/c

R. SCHAFER
Lt. Col., AGD
Asst. Adjutant General.

Handwritten initials

COPY

FCW/hh

Reparation file
HEADQUARTERS
YAMAGUCHI MILITARY GOVERNMENT TEAM
YAMAGUCHI, HONSHU, JAPAN
APO 317

2 March 1948

Serial No. 321-B

SUBJECT: Exemption of Reparations Equipment

THRU: Commanding Officer, Chugoku Military Govern-
ment Region, APO 317TO : Commanding General
Eighth Army
APO 343

1. Attached herewith application from Takeda Pharmaceutical Industries Ltd. for temporary use of a chimney located in Hikari Naval Arsenal, which is a reparations plant.
2. Takeda Pharmaceutical Industries Ltd. have permission to use portion of the land and buildings of Hikari Naval Arsenal, and at present are constructing a new factory for the manufacture of sulphathiazal.
3. The chimney required has not been inventoried for reparations, but has been marked as part of an integrated facility (open hearth melting furnace), and the approximate weight is 40 tons.
4. Due to the shortage of both cement and steel plates, it is almost impossible for this firm to build a new chimney, and the chimney at Hikari Naval Arsenal is only one in the area suitable for this factory.
5. In view of the above circumstances and the fact that sulphathiazal is an important drug required

44

in Japan, it is strongly recommended that this chimney be exempted from reparations.

/s/ Alfred P. Robertson
/t/ ALFRED P. ROBERTSON
Major, Infantry
SMGO

1 Incl:
As per 1

CMGR 386.3 (D-No) 1st Ind

Headquarters, Chugoku Military Government Region, APO 317,
Kure, Honshu, 4 March 1948

TO: Commanding General, Eighth Army, APO 343

Forwarded, recommending approval in view of statements made in paragraph 4 and 5 of basic letter.

1 Incl:
n/c

RUSSELL C. SNYDER
Colonel, FA
Commanding

57

C O P Y

Hikari, Jan 31, 1948

To: Yamaguchi Military Government Team
 From: Hikari Plant, Takeda Pharmaceutical Industries, Ltd.
 Re: Petition for the temporary use of a part of integrated facility

We beg to petition your authority to kindly permit us the temporary use of a part of integrated facility located at Ex-Hikari Naval Arsenal as per the particulars undermentioned:

: Integrated facility :	:
: No: :	: 45-4-701 :
: Name and particulars:	: Steel Chimney, 50 meters in
:	: length, 2.3 meters in aver-
:	: age diameter :
: Use for :	: For Sulzol (sulfathiazol)
:	: plant located at No.G area
:	: of Hikari Plant of Takeda
:	: Pharmaceutical Industries,
:	: Ltd., Hikari City :

Hikari Plant,
 Takeda Pharmaceutical Industries Ltd.

/s/ T. Nakamura
 /t/ T. Nakamura
 (Manager)

/s/ Ichiro Tsukamoto
 /t/ Ichiro Tsukamoto
 Chief of Yamaguchi Finance Bureau

57

C O P Y

Hikari, Jan. 31, 1948.

To: Yamaguchi Military Government Team
From: Hikari Plant, Takeda Pharmaceutical Industries, Ltd.
Re: Petition for the temporary use of a part of integrated facility

We beg to petition your authority to kindly permit us the temporary use of a part of integrated facility located at Ex-Hikari Naval Arsenal as per the particulars undermentioned:

:Integrated facility	:	:
:No:	:	45-4-7CI
:Name and particulars	:	Steel Chimny, 50 meters in
:	:	length, 2.3 meters in aver-
:	:	age diameter
:Use for	:	For Sulzol(sulfathiazol)
:	:	plant located at No.G area
:	:	of Hikari Plant of Takeda
:	:	Pharmaceutical Industries,
:	:	Ltd., Hikari City

Hikari Plant,
Takeda Pharmaceutical Industries Ltd.

P. Nakamura
T. Nakamura

plant located at No. 6 Area
of Hikari Plant of Takeda
Pharmaceutical Industries,
Ltd., Hikari City

Hikari Plant,
Takeda Pharmaceutical Industries Ltd.

T. Nakamura
T. Nakamura
(Manager)

Ichiro Tsukamoto
(ICHIRO TSUKAMOTO)
Chief of Yamaguchi Finance Bureau

Additional remarks referring to the chimney applied for temporary use

1. Location: At the Steel Shop in Ex-Hikari Naval Arsenal
2. Size & type Iron chimney, 2,060 mm. in dia. at the top, 50 meters in height
Approximate weight: 40 tons without fire brick.
3. Boilers to be connected with this chimney:
 - a. Type "Kewany" type, heating surface 183 m² and 140 m² each.
 - b. Quantity of coal 600 kgs/hour and 450 kgs/hour each.
4. 1 more boiler will be added to the above in future.
5. Capacity of chimney suitable for the 3 boilers above mentioned:
1,600 mm. in dia. and 50 meters in height
6. As the quality of coal available nowadays is inferior (4,000 to 3,500 calory), size of the chimney must be bigger than that of Item No.5.
7. Due to the reasons above mentioned, the size of this chimney is quite suitable for our use.

The reasons we want this chimney: Sulzol (sulfathiazole) is authorized by GHQPH and Welfare Ministry of Japanese Government as one of the most important medicines in Japan at present, and to meet with this requirement we are doing our best to speed up and complete the construction of the plant up to the end of April at least. Should we be forced to build the necessary chimney newly, ~~XXXXXX~~ we must wait another 4 months to have the new chimney. Supposed we build the new chimney with cement, it is almost impossible to buy the cement necessary for the construction of chimney, and this is quite same in the case of iron chimney.

Hikari Plant,
Takeda Pharmaceutical Industries Ltd.
Hikari City.

J. Nakamura
T. Nakamura
(Manager)



BASIC: Ltr, Hq Yamaguchi Mil Govt Team, APO 317, subject: Temporary Loan of Reparations Machinery, dated 17 May 1947

AG 387.6 (17 May 47) EIS/IN 3rd Ind

GENERAL HEADQUARTERS, SUPREME COMMANDER FOR THE ALLIED POWERS, APO 500, 4 November 1947

TO: Commanding General, Eighth Army, APO 343

1. The application of the Fuji Transporting and Conveying Machinery Corporation for temporary use of seventy-seven (77) machines from Hikari Naval Arsenal is not favorably considered.

2. Statistics reveal that non-reparations plants are not making full use of facilities in the manufacture of critical items. Until such facilities are utilized 100 per cent, reparations machinery cannot be released even on a temporary basis.

3. The use of arsenal equipment for other than critical occupational requirements should be discouraged.

BY COMMAND OF GENERAL MACARTHUR:

Handwritten: 45-4
F-4

1 Incl
n/c

A. J. REHE
Major, AGD
Asst Adj Gen

AG 004 (MG-En)

4th Ind

Headquarters Eighth Army, APO 343

20 NOV 1947

TO: Commanding Officer, Chugoku Military Government Region, APO 317

Attention is invited to the 3rd indorsement.

BY COMMAND OF MAJOR GENERAL RYDER:

1 Incl:
n/c

R. SCHAFER
Lt. Col., AGD
Asst. Adjutant General

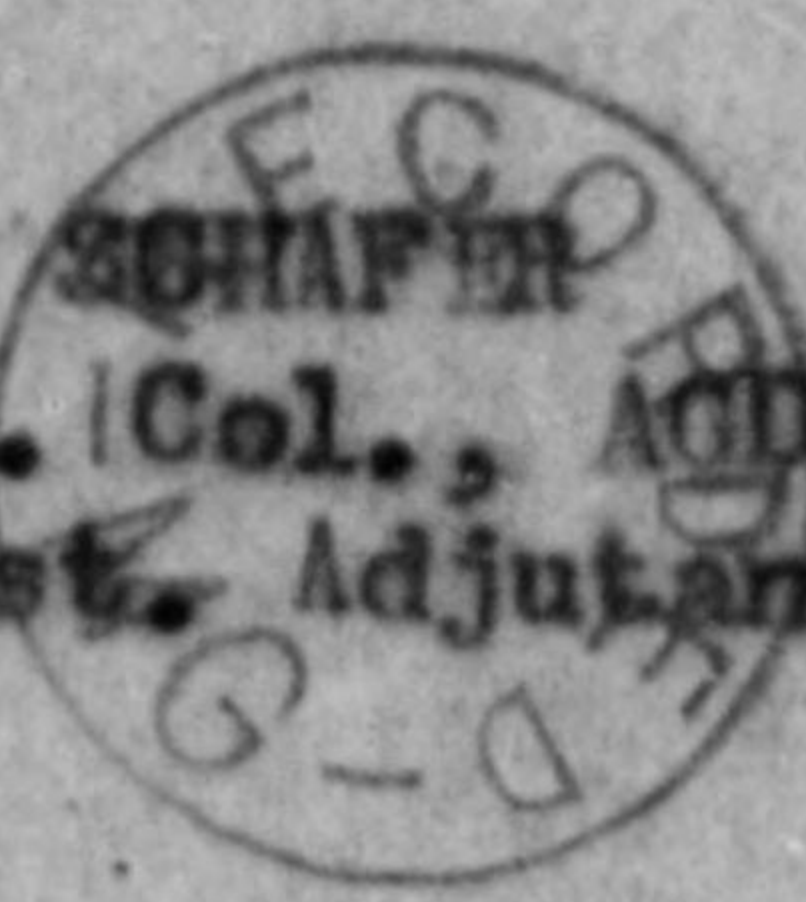

~~16~~ (16)

5496

BASIC: Ltr. Hq. Yamaguchi Mil Govt Team, APO 317, dtd 26 May 1947, Serial No. 671-B Subject: Request for Temporary Loan of Reparations Equipment to Takeda Pharmaceutical Company, Ltd.

1st Ind

D/STE/jya

Headquarters, Chugoku Military Government Region, APQ 317, Kure, Honshu,
14 June 1947

TO: Commanding General, Eighth Army, APO 343

1. Recommend approval.
2. A qualified representative of this headquarters has inspected subject plant and concurs in the recommendations in basic letter.

2 Incls
n/c

RUSSELL C. SNYDER
Colonel, F.A.
Commanding

45-4
200-4

15

BASIC: Ltr, Yamaguchi Mil Govt Team, APO 317, subject: "Loan of Reparations Machinery" dated 31 Jan 1947

2nd Ind

D/ETE/hm

CHUGOKU MILITARY GOVERNMENT REGION, APO 317, Kure, Honshu, 12 March 1947

TO: Commanding Officer, Yamaguchi Military Government Team, APO 317

1. Returned for specific and substantial comments wherein this machinery will be directly used in the manufacture of material stipulated in basic communication.
2. Your attention is directed to the correct channels for Military correspondence emanating from your organization. Correspondence to higher echelones will be channeled thru this headquarters unless otherwise stipulated.

BY ORDER OF COLONEL SNYDER:

ELZA B. NANCE
Major, Inf.
Adjutant

Encl: N/C

45-4
H

12

004 - Yamaguchi

Ltr, Yamaguchi Mil Govt Team, APO 317, subj: "Loan of
Reparations Machinery", dated 31 Jan 1947.

AG 386.3 (MG-Ea)

1st Ind

5 MAR 1947

Headquarters Eighth Army, APO 343

TO: Commanding Officer, Chugoku Military Government
Region, APO 317

1. Returned for recommendation.
2. The utilization of standard type machine tools in the
manufacture of serums, vaccines, toxoids, etc., does not appear
to be justified in the application as submitted.

BY COMMAND OF LIEUTENANT GENERAL RICHELBERGER:

2 Incls:
n/c

R. SCHAFER
Lt. Col., AGD
Asst. Adjutant General



~~10~~

9

2826

C O P Y

ko

LIST OF THE NECESSARY MACHINES AND APPARATUS

Code Number	Name of Machine	Characteristic
45-4-1786	Lathe	4 ft.
" - 1582	"	4 ft.
" - 217	"	5 ft.
" - 685	"	8 ft.
" - 210	"	8 ft.
" - 772	"	8 ft.
" - 778	"	12 ft.
" - 192	Universal Milling Machine	Type 3.
" - 455	"	"
" - 692	Vertical Milling Machine	Type 2.
" - 443	Table Horizontal Milling Machine	Table 500x150 m/m
" - 444	Table Vertical Milling Machine	"
" - 197	Slotting Machine	Stroke 215 m/m
" - 276	Shaping Machine	Stroke 400 m/m
" - 1410	Planing Machine	7.5 HP.
" - 351	Radial Drilling Machine	Arm 1200 m/m
" - 722	Table Drilling Machine	1 HP.
" - 697	"	1 "
" - 274	Drilling Machine	2 "
" - 345	Boring Machine	Main Shaft dia. 90 m/m.
" - 795	Universal Tool & Cutter Grinder	Swing 210 m/m.
" - 472	Tool and Cutter Grinder.	3 HP.
" - 718	"	1 HP.
" - 90	" "	1 HP.

C O P Y (3)

Incl # -1-

9

Code Number	Name of Machine	Characteristic
45-4- 410	Hack Sawing Machine	Cutting dia. 150 m/m.
" - 792	Cutting off Grinder	"
" - 352	Pneumatic Hammer	
" - 398	Hand Press	
" - 357	Centrifugal Fun	7.5 HP. 43 M3/min.
" -3293	Air Compressor	15 HP. 100 lb./in2
" -1111	Blue Printing Machine	
" -1915	Wood Band Sawing Machine	7.5 HP.
" -3033	Wood Band Planer	Table 460x2200 m/m.
" -3036	Wood Planing Machine	Table 670x1100 m/m.
" -3031	"	Table 750x330 m/m.
" -3285	Centrifugal Water Pump.	7.5 HP. 4" dia.
" -3283	"	"
" - 362	"	"
" - 360	"	"
" - 361	"	7.5 HP. 6" dia.
" - 407	"	"
" - 404	"	10 HP. 6" dia.
" - 413	"	30 HP. 8" dia.
" -3164	"	10 HP. 6" dia.
" -3280	"	30 HP. 6" dia.
" -3290	"	40 HP. 7" dia.

9
C O P Y

Code Number	Name of Machine	Characteristic
45-4-3291	Centrifugal Water Pump	15 HP. 6" dia.
" - 358	"	15 HP. 6" dia.
" - 359	"	2.5" dia.
" - 634	Motor	5 HP.
" - 646	"	5 HP.
" - 647	"	7.5 HP.
" - 649	"	7.5 HP.
" - 657	"	7.5 HP.
" - 640	"	10 HP.
" - 641	"	10 HP.
" - 650	"	10 HP.
" - 616	"	8.7 KW.
" - 653	"	15 HP.
" - 662	"	15 HP.
" -3470	Single phase Transformer	200 K.V.H.
" -3469	"	200 "
" -3471	"	200 "
" -3678	"	150 "
" -3679	"	150 "
" -3666	"	50 "
" -3467	"	50 "
" -3468	"	50 "
" -3463	"	50 "
" -3464	"	50 "
" -3465	"	50 "
" -3680	"	75 "
" -3681	"	75 "
" -3682	"	75 "
" -3683	"	50 "

9
C O P Y

Code Number	Name of Machine	Characteristic
45-4-3684	Single Phase Transformer	50 K.V.H.
" -3685	"	50 K.V.H.
" - 590	Dynamo for Direct Current	300 K.W.
" - 591	"	300 "

C O P Y

List of Products

Experi- menting;	{	Alum-precipitated diphtheria toxoid (some produced).....	2,000	litres per month	
		Alum-precipitated Staphylococci toxoid.....	1,000	" "	" "
Planned	{	Various toxoids.....	1,000	" "	" "
		Anti-diphtheria serum.....	150	" "	" "
		Various sera.....	50	" "	" "
		Various vaccines.....	200	" "	" "
		Injections (bacteriotherapeutic).....	420,000	ampoules	" "
		Sodium chloride.....	60	Tons	" "
	{	Tablets (various).....	30,000,000	pes.	" "
Actual- ly produced	{	Typhus vaccine.....	250	liters per month	

9

copy

INCL: # 2

Ltr, Hq Yamaguchi Mil Govt Team, Yamaguchi, Honshu, Serial No. 84-B, subj: "Loan of Reparations Machine to Occupational Forces", dtd 8 Feb 47.

AG 004 (MG-Em)

1st Ind

18 FEB 1947

Headquarters Eighth Army, APO 343

TO: Commanding Officer, Chugoku Military Government Region, APO 317

1. The temporary release, under custody and control, to the British Commonwealth Occupation Forces, of one Radial Drilling Machine, is authorized.
2. The British Commonwealth Occupation Forces will be made responsible for the proper care and maintenance of this equipment. No conversion or modification of this machine will be permitted.
3. Proper notation will be made on the inventory forms to show the temporary release of this reparations equipment from the Teikoku Seiki K.K., 2307 Imazu, Iwakuni-shi, Yamaguchi-ken, to the British Commonwealth Occupation Forces.

BY COMMAND OF LIEUTENANT GENERAL EICHELBERGER:

R. SCHAFER
Lt. Col., AGO
Asst. Adjutant General

1 Incl:
n/c

2nd Ind

D/JRF/ltn

CHUGOKU MILITARY GOVERNMENT REGION, APO 317, Kure, Honshu, 25 Feb 47

TO: Commanding Officer, Yamaguchi Military Government Team, APO 317

1. For necessary action.

BY ORDER OF COLONEL SNYDER:

ELZA B. NANCE
Major, Inf.
Adjutant

1 Incl: n/c

8

2064

File

HEADQUARTERS EIGHTH ARMY
United States Army
Office of the Commanding General
APO 343

Em

Yam. Reg.

AG 004 (MG)

18 FEB 1947

SUBJECT: Return of Inventory Sheets for Correction

TO : CO, Yamaguchi . . . Military Government Team

1. Transmitted herewith are inventory sheets, to be corrected as indicated and returned directly to ESS/IN, General Headquarters, Supreme Commander for the Allied Powers, for the following plants:

- 45-02
- 45-03
- 45-04
- 45-05
- 45-06
- 45-06 (A)
- 45-07

Info copy Chugoku Reg.

BY COMMAND OF LIEUTENANT GENERAL EICHELBERGER:

R. SCHAFER
Lt. Col., AGD
Asst. Adjutant General

Info to: I Corps
IX Corps
Shikoku Reg.
Chugoku Reg.
Tokyo-Kanagawa MG Dist.

1 Incl: 1084 inv. sheets

7

BASIC: Ltr, Headquarters Eighth Army, United States Army, Office of the
Commanding General APO 343, AG 386.3 (MG-Em), dated 30 Jan 47,
subj: Marking of Principal Units of Equipment of Steam-Electric
Power Generating Plants listed for Reparations.

1st Ind

D/JRF/bm

CHUGOKU MILITARY GOVERNMENT REGION, APO 317, Kure, Honshu, 4 Feb 47

TO: Commanding Officer Shimane Military Government Team APO 317
✓ Commanding Officer Yamaguchi Military Government Team APO 317

1. Forwarded for necessary action.
2. Your attention directed to paragraph 4.

BY ORDER OF COLONEL SNYDER:

1 Incl w/d
1 Incl Marking list appropriate Plant.

ELZA B. NANCE
Major, Inf.
Adjutant

~~H~~

6

HEADQUARTERS EIGHTH ARMY
 United States Army
 Office of the Commanding General
 APO 343

AG 386.3 (MG-Em)

30 JAN 1947

SUBJECT: Marking of Principal Units of Equipment of
 Steam-Electric Power Generating Plants listed
 for Reparations.

TO : Commanding Officer
 Chugoku Military Government Region
 APO 317

1. References are the following:

a. Memorandum for the Imperial Japanese Government
 from General Headquarters, Supreme Commander for the Allied Powers,
 File AG 387.6 (13 Aug 46) ESS/IN, (SCAPIN-1131), dated 13 August
 1946, subject, "Reparations Selection of Steam-Electric Power
 Generating Plants."

b. Memorandum for the Imperial Japanese Government
 from General Headquarters, Supreme Commander for the Allied Powers,
 File AG 387.6 (3 Feb 47) ESS/IN, (SCAPIN-1489), dated 3 February
 1947, subject, "Marking of Principal Units of Equipment of Steam-
 Electric Generating Plants Selected to be Removed for Interim
 Reparations."

2. Attached are lists of markings for each plant within your
 area of command, listing the equipment to be marked and giving
 the identifying mark or letter in each case.

3. Units of equipment will be marked in a clearly visible
 place, using such a size letter and color of paint as may be easily
 read. Only the equipment indicated for each installation will be
 marked.

4. When the instructions contained herein have been completed,
 it is requested that the Commanding General, Eighth Army (Attention
 Military Government Section) be promptly advised.

BY COMMAND OF LIEUTENANT GENERAL EICHELBERGER:

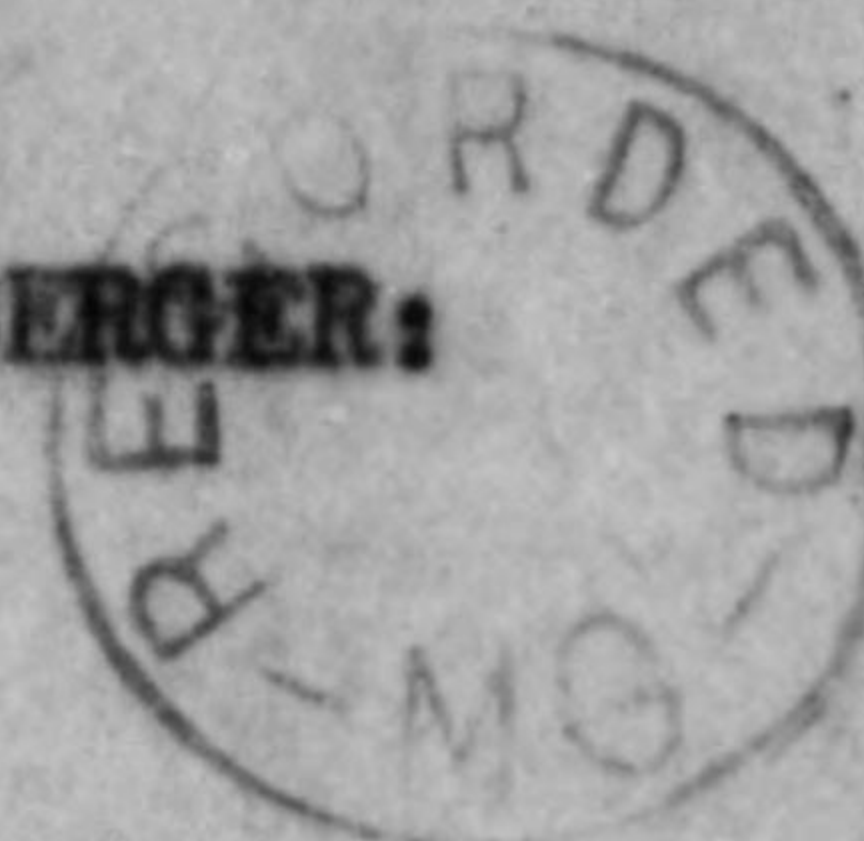

R. SCHAFER
 Lt. Col., AGD
 Asst. Adjutant General

6
 Incl:
 Marking list for
 Matsue Plant
 ✓ Ube-Nishi Plant

980

C O P Y

OUTLINE OF MAIN UNITS OF EQUIPMENT
TO BE MARKED AT UBE-NISHI STEAM ELECTRIC STATION

1. Steam Turbines

Identifying Mark	Description of Equipment			
S.T. 1	10,000	KW	G.E.	1921
S.T. 2	10,000	"	G.E.	1924

2. Generators

Identifying Mark	Description of Equipment			
Gen. 1	12,500	KVA	G.E.	1921
Gen. 2	12,500	KVA	E.E.	1924

3. Boilers

Identifying Mark	Description of Equipment			
Bo. 1	8.6	MT/Hr	B&W	1921
Bo. 2	8.6	"	"	1921
Bo. 3	8.6	"	"	1921
Bo. 4	8.6	"	"	1921
Bo. 5	8.6	"	"	1921
Bo. 6	8.6	"	"	1926
Bo. 7	8.6	"	"	1926
Bo. 8	8.6	"	"	1926
Bo. 9	8.6	"	"	1930
Bo. 10	8.6	"	"	1930

4. Coal Handling Equipment

Identifying Mark	Description of Equipment			
C.H. 1	Unloading Jib crane, 85 MT/Hr			
C.H. 2	" " " " 80 "			
C.H. 3	Main horizontal conveyor, 40 MT/Hr, 75 M long			
C.H. 4	Vertical bucket conveyor 40 " 23 M long			
C.H. 5	Conveyor, 40 MT/Hr, 34 M long			
C.H. 6	Inclined conveyor, 40 MT/Hr, 15 M long			

5. Stoker Equipment

Identifying Mark	Description of Equipment			
S. 1	Chain grate stoker			

⑥

COPY

OUTLINE OF MAIN UNITS OF EQUIPMENT
 TO BE MARKED AT UBE-NISHI STEAM ELECTRIC STATION
 (Continued)

5. Stoker Equipment (Continued)

Identifying Mark	Description of Equipment
S. 2	Chain Grate stoker
S. 3	" " "
S. 4	" " "
S. 5	" " "
S. 6	" " "
S. 7	" " "
S. 8	" " "
S. 9	" " "
S. 10	" " "

6. Switch Yard

Identifying Mark	Description of Equipment
S.Y. 1	11 KV
S.Y. 2	11 "
S.Y. 3	250 KVA
S.Y. 4	250 "
S.Y. 5	250 "
S.Y. 6	250 "
S.Y. 7	250 "
S.Y. 8	250 "
S.Y. 9	250 "
S.Y. 10	250 "
S.Y. 11	250 "
S.Y. 12	250 "
S.Y. 13	250 "
S.Y. 14	250 "
S.Y. 15	250 "

7. Switchboard Room

Identifying Mark	Description of Equipment
S.B. 1	Panel
S.B. 2	"
S.B. 3	"
S.B. 4	"
S.B. 5	"
S.B. 6	"

6

COPY

OUTLINE OF MAIN UNITS OF EQUIPMENT
TO BE MARKED AT UBE-NISHI STEAM-ELECTRIC STATION
(Continued)

7. Switchboard Room (continued)

Identifying Mark	Description of Equipment
S.B. 7	Panel
S.B. 8	"
S.B. 9	"
S.B. 10	"
S.B. 11	"
S.B. 12	"
S.B. 13	"
S.B. 14	"
S.B. 15	"
S.B. 16	"
S.B. 17	"
S.B. 18	"
S.B. 19	"
S.B. 20	"
S.B. 21	"
S.B. 22	"
S.B. 23	"
S.B. 24	"
S.B. 25	"
S.B. 26	"
S.B. 27	"
S.B. 28	"
S.B. 29	"
S.B. 30	"
S.B. 31	"
S.B. 32	"

8. Auxiliary Equipment

Identifying Mark	Description of Equipment
Aux ₁	300 HP exciter
Aux ₂	250 " "
Aux ₃	200 " feed water pump
Aux ₄	110 " condenser circulating water pump
Aux ₅	110 " " " " "
Aux ₆	100 " induced fan
Aux ₇	100 " " "
Aux ₈	65 " forced draft fan

6

COPY

OUTLINE OF MAIN UNITS OF EQUIPMENT
 TO BE MARKED AT UBE-NISHI STEAM-ELECTRIC STATION
 (Continued)

8. Auxiliary Equipment (Continued)

Identifying Mark	Description of Equipment
Aux. 9	65 HP forced draft fan
Aux. 10	65 " " " "
Aux. 11	65 " " " "
Aux. 12	11 Kv/3.45 KV, 500 KVA
Aux. 13	11 " " 500 "
Aux. 14	11 " " 500 "
Aux. 15	15 KV, 1,000 Amp
Aux. 16	15 " 800 "
Aux. 17	15 " 800 "
Aux. 18	15 " 400 "
Aux. 19	11.5" 1,200 "
Aux. 20	4.5" 400 "
Aux. 21	4.5" 400 "
Aux. 22	4.5" 400 "
Aux. 23	4.5" 400 "
Aux. 24	4.5" 400 "
Aux. 25	4.5" 400 "
Aux. 26	4.5" 200 "
Aux. 27	4.5" 200 "
Aux. 28	4.5" 200 "
Aux. 29	4.5" 200 "
Aux. 30	3.5" 200 "
Aux. 31	3.5" 200 "
Aux. 32	3.45" 200 "
Aux. 33	3.45" 200 "
Aux. 34	3.3" 30 "
Aux. 35	3.3" 30 "
Aux. 36	15" 800 "
Aux. 37	15" 800 "
Aux. 38	15" 800 "
Aux. 39	15" 800 "
Aux. 40	15" 800 "
Aux. 41	15" 800 "
Aux. 42	15" 800 "
Aux. 43	15" 800 "
Aux. 44	15" 800 "
Aux. 45	15" 800 "
Aux. 46	15" 800 "

⑥

C O P YOUTLINE OF MAIN UNITS OF EQUIPMENT
TO BE MARKED AT UBE-NISHI STEAM-ELECTRIC STATION
(Continued)

8. Auxiliary Equipment (Continued)

Identifying Mark	Description of Equipment
Aux. 47	15 KV, 800 Amp
Aux. 48	15 " 800 "
Aux. 49	15 " 800 "
Aux. 50	15 " 800 "
Aux. 51	15 " 800 "
Aux. 52	15 " 800 "
Aux. 53	15 " 800 "
Aux. 54	15 " 800 "
Aux. 55	15 " 300 "
Aux. 56	15 " 300 "
Aux. 57	15 " 300 "
Aux. 58	15 " 300 "
Aux. 59	15 " 300 "
Aux. 60	15 " 300 "
Aux. 61	15 " 300 "
Aux. 62	15 " 300 "
Aux. 63	15 " 300 "
Aux. 64	15 " 300 "

⑥

Ltr. Hq Yamaguchi Mil Govt Team, (Yamaguchi, Honshu, Japan)
 APO 317, subj: "Loan of Reparations Equipment to Home Ministry
 Agency", dated 24 January 1947

AG 004.04(ME-Em)

1st Ind

3 FEB 1947

Headquarters Eighth Army, APO 343

TO: Commanding Officer, Chugoku Military Government Region,
 APO 317.

1. The temporary use of the foundry and a 3-ton electric
 furnace located at Hikari Arsenal to the Committee for the
 Disposal of Destroyed Implements of War, is authorized.

2. No machinery is to be moved from its present location
 and the Committee for the Disposal of Destroyed Implements of
 War, will be made responsible for the proper care and maintenance
 of the equipment used.

3. Should information additional to that contained in
 the basic communication indicate that a different action is
 desirable, appropriate recommendations will be made to this
 headquarters prior to action authorized

BY COMMAND OF LIEUTENANT GENERAL EICHELBERGER:

R. SCHAFER
 Lt. Col. AGD
 Asst. Adjutant General.



45-4
 2nd II

5

5

9)

1275

Ltr, Yamaguchi Mil Govt Team, APO 317, dtd 17 Jan 1947, Serial No. 764-D, subject: "Loans of Reparations Machinery."

AG 004.04 (MG-Em)

2nd Ind

29 FEB 1947

Headquarters Eighth Army, APO 343

TO: Commanding Officer, Chugoku Military Government Region, APO 317

1. The petition of the Asahi Salt Manufacturing Company, Hikari City, Yamaguchi Prefecture, for the temporary use of reparations machinery, within the confines of the ex-Hikari Naval Arsenal, is approved.
2. The Asahi Salt Manufacturing Company will be responsible for the proper care and maintenance of the machines. (Reference: sixty-two (62) machines shown on list prepared by Asahi Salt Manufacturing Company).
3. Proper notation will be shown on the inventory list of the ex-Hikari Naval Arsenal to indicate the location of this reparations property.

BY COMMAND OF LIEUTENANT GENERAL MICHELBERGER:

1 Incl:
n/c

R. SCHAFER
Lt. Col., AGD
Asst. Adjutant General



45-4
acc II

(4)

1217

FTJ/ko

HEADQUARTERS
YAMAGUCHI MILITARY GOVERNMENT TEAM
YAMAGUCHI, HONSHU, JAPAN
APO 317

Yamaguchi, Honshu
17 January 1947

Serial No. 764-D

SUBJECT : Loans of Reparations Machinery

THRU : Commanding Officer, Chugoku Military Government
Region, APO 317, Kure, Honshu.

TO : Commanding General, Eighth Army, APO 343.

Attention: Reparations Branch, Economics Division.

1. Attached as Inclosure No. 1 is petition from Asahi Salt Manufacturing Company, now operating by special permission on the grounds of the Hikari Naval Arsenal (a reparations installation), requesting the temporary loan of sixty-two (62) pieces of small, movable reparations equipment, consisting mainly of pumps, motors, and transformers.

2. These items, if loaned to this company, would remain within the confines of Hikari Arsenal.

3. The company is attempting to locate similar equipment through civilian channels, and any borrowed reparations equipment would be returned to the Arsenal as soon as replacements were secured from civilian sources.

4. If this loan is authorized, the company expects to be in production by mid-February. In view of the current shortage of salt, approval of this petition is recommended.

5

ALFRED P. ROBERTSON
Major, Infantry
SMGO

Incl:
Incl #1,
Petition/Asahi Salt
Mfg Co.

4

1215

Yamaguchi Reconversion file

HEADQUARTERS
SEVENTY-SIXTH MILITARY GOVERNMENT
HEADQUARTERS AND HEADQUARTERS COMPANY
APO 24 (Kure, Honshu)

WLH/ln

29 May 1946

SUBJECT: Reconversion of the Hikari Naval Arsenal

TO : 76th M.G. Hq & Hq Co, Yamaguchi Detachment

1. Please note enclosures requesting use of Hikari Naval Arsenal by the Ministry of Transportation. It is our understanding that applications have been submitted by other firms for the use of these facilities.
2. Please review this matter and submit your recommendations to this office with full report on negotiations carried on to date.

FOR THE COMMANDING OFFICER:

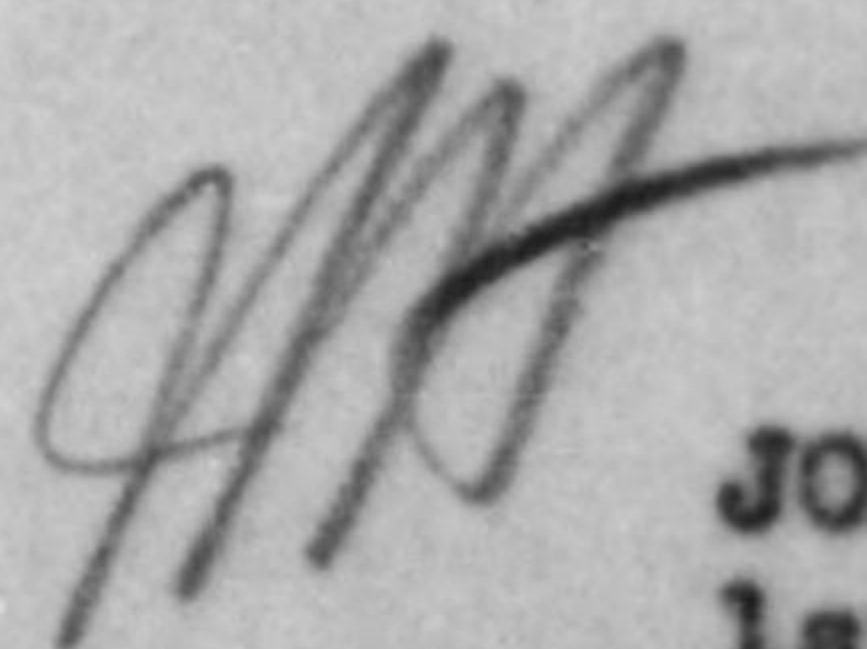

JOHN D. MONTGOMERY
1st Lt, TC
Adjutant

Encl:

1. Application of Ministry of Transportation (2)
2. Request from Central Liaison Office (2)

Handwritten initials
45-4
WC II

47

2

Hq 76th MG Co.

SMCC

Ex C

Adj

2nd Ind.

Yamaguchi Detachment, 76th Military Government Company. APO 317
25 June 1946

TO: Headquarters, 76th Mil Govt Hq & Hq Co, APO 317, Kure

It has been agreed to divide the Hikari Naval Arsenal into three sections. One section is now in use by the Takeda Pharmaceutical Company. A second section has been applied for by the city of Hikari as use as a dock area, and a third section has been applied for by the Hiroshima Division of the Government Railroad.

FOR THE COMMANDING OFFICER:

G. E. Byers
G E BYERS
1st Lt, FA
Mil Govt Officer

1946
JUN
26

77th MG Co.
 SNAGO
 X Ex O
 M
 Scopia

KURE LIAISON OFFICE

KL No. 227

27 May 1946



SUBJECT: Request for Temporary Utilization of Hikari Naval
 Arsenal up to the Time of Removal for Reparations
 TO : 76th Military Government Company.

The Kure Liaison Office presents its compliments to
 the 76th Military Government Company and has the honour,
 to transmit herewith a letter, subject as above, from the
 Central Liaison Office, Tokio.

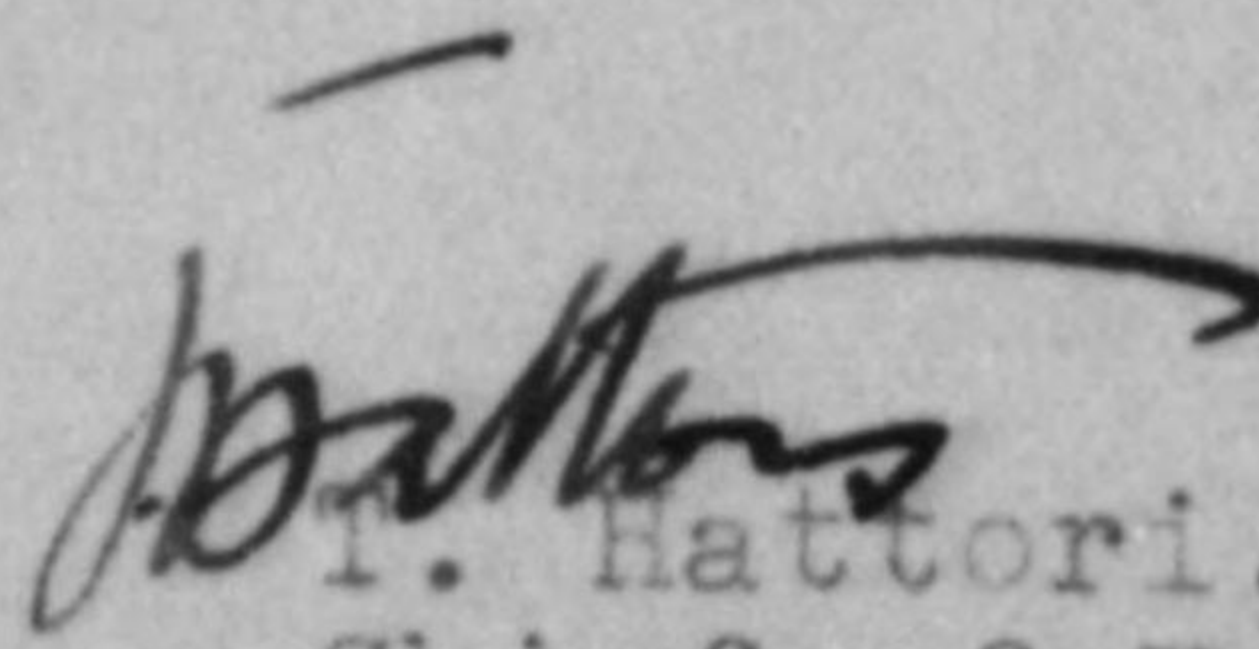
 I. Hattori,
 Chief of Kure Liaison Office.

Inclosure - 1 letter.

IMPERIAL JAPANESE GOVERNMENT
CENTRAL LIAISON OFFICE

TO : HEADQUARTERS, 76th MILITARY GOVERNMENT.
FROM : Central Liaison Office, Tokyo.
SUBJECT: Request for Temporary Utilization of Hikari Naval Arsenal up to the Time of Removal for Reparations.

C.L.O. No.113(ECI-F)

22 May 1946

1. The Japanese Government submits hereby a request for temporary utilization of the Hikari Naval Arsenal. The reasons for the request are stated below.
2. The overwork and the damages inflicted by air-raids during the war have reduced the rolling stock to a state of extreme deterioration, and the capacity for repairs, originally insufficient, was made all the more inadequate on account of the war damages, so that the railway reconstruction plan is now facing a serious obstacle.
3. The traffic on the San-yo line showed a marked increase since the opening of the Kanmon Tunnel, with the corresponding increase in the number of cars employed. While it is expected that the railway transportation of Kyushu coal will be continued in the future, there has been no reinforcement of repair capacity to cope with the expected increase of works to be done. As, from the geographical point of view, the new establishment of a repair plant is urgently required in the vicinity of Hikari, it is proposed to convert and utilize the said Arsenal.
4. The subject plant, whose custody, control and protective maintenance was directed by SCAP Memorandum AG 004(20 Jan 46) ESS/GD, fulfils the necessary conditions for the purpose intended, as stated below:
 - a. The location of the Arsenal between the two Engineering Plants of the Government Railways at Hiroshima and Kokura, offers a favorable condition, both geographically and otherwise.
 - b. The buildings have sufficient height and solidity and are suited for repair works of rolling stock.
 - c. The Arsenal has railway sidings, thereby offering facilities to manoruvering the rolling stock.

As there is no civilian plant answering the requirements as above, this Arsenal has been selected for conversion purposes.

47

5. The application in detail of the Ministry of Transportation in subject matter is herewith forwarded and your Headquarters is requested to be good enough to take up the matter and give favorable consideration to this application.

FOR THE PRESIDENT:

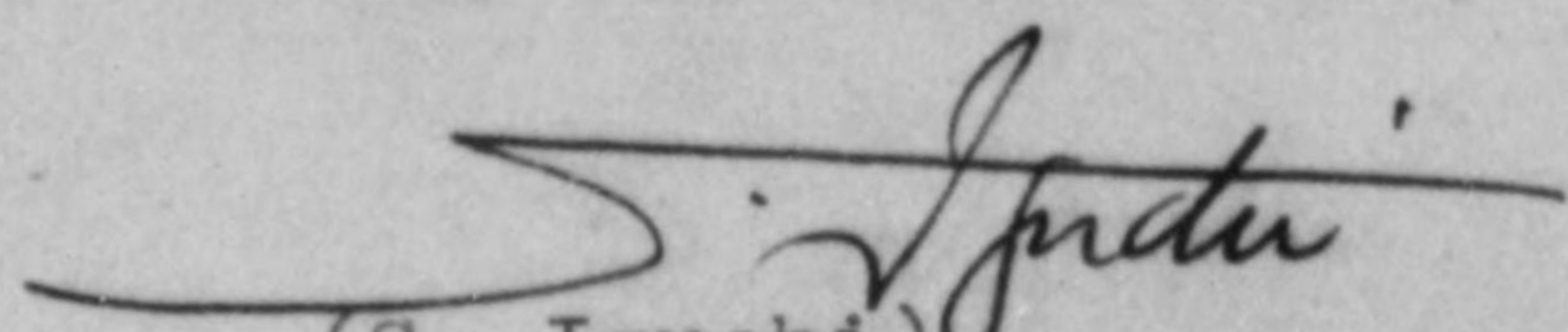
(S. Iguchi)
Director of General Affairs,
Central Liaison Office.

Enclosure: An application of Ministry of Transportation.

Copy to : Eighth U.S. Army.

47

APPLICATION FOR CONVERSION OF

and

REPORT ON INDUSTRIAL FACILITIES

TO : ~~Headquarters of the U.S. Eighth Army.~~
 THROUGH : Central Liaison Office, Tokyo
 FROM : General Railway Bureau, Ministry of
 Transportation
 DATE :

CONVERSION PROGRAM

Name and Address of Applicant

Name: General Railway Bureau, Ministry of Transportation

Address: Marunouchi, Kojimachiku, Tokyo

1. Name of factory: Hikari Navy Arsenal
2. Location: Oaza Shimada, Hikari City, Yamaguchi Prefecture
3. History
 - a. Date of Construction: 1 October, 1940
 - b. Date of first operation: Unknown
4. Description
 - a. Principal products
 1. wartime: Internal combustion engine, gun barrel, torpedo, steel foundry, bullets, shells and bombs.
 2. at present: Not in operation
 3. planned for 1946-47: Rolling stock repair
 - b. Capacity
 1. wartime:

Internal combustion engine:	No. 42-4,	No. 51-30	per month
Gun barrel :	80		per month
Torpedo :	90		"
Steel foundry:	5,000 tons		"
Bullets :	10,000		"

417

Shells : 10,000 per month

Bombs : 200 "

2. at present: Not in operation but maintaining the machinery, equipment etc. in their best condition

3. 1946-47 (with unrestricted access to materials)

General repair of locomotive : 200 per year

" " automobile : 300 "

" " freight car : 700 "

Sectional repair of locomotive: 420 "

Manufacture of loading machine: 6,000 tons (Quantity of material raw) per year

c. Number of employees

1. wartime: 25,000

2. at present: 70

3. 1946-47 (at maximum capacity): 5,000

5. Machineries and equipments on the plant

<u>Description</u>	<u>Quantity</u>	<u>Remarks</u>
Machinery	3,505	Under investigation

6. Present stocks of raw materials, supplies, and unfinished goods

<u>Description</u>	<u>Quantity</u> (at Jan. 1946)	<u>Condition</u>
Steel products	about 11,700 tons	
Steel alloys	" 6,160 "	
Wires, Leads, Zinc and Tins "	660 "	

7. Present stocks of fuel

None

8. Machineries and equipments needed for maximum production

1946-47

<u>Descriptions</u>	<u>Quantity</u>
Lathe	638
Planing machine	13

47

Shaping machine	81
Slotting machine	52
Drilling machine	103
Boring machine	74
Milling machine	169
Gear cutting machine	35
Grinding machine	91
Sawing machine	6
Other machines tool	3
Air hammer	10
Steam hammer	9
Drop hammer	5
Shearing & Punching machine	8
Press	17
Others	200
Total	1,504

9. Raw materials and supplies needed (monthly)

a. For Present Capacity

None

b. For maximum

<u>Description</u>	<u>Quantity</u>
Steel	about 500 tons
Special steel	" 15 "
Pig iron	" 250 "
Non-ferous alloys	" 20 "
Lumber	" 80 cub. meters of logs

10. Fuel needed (monthly) (do not include percent stocks)

47

<u>Description</u>	<u>Quantity</u>
Coal	about 1,000 tons
Coke	" 600 "

11. Personnel required (do not include locally available)

None

12. Prices (give current selling prices in Yen of principal products)

<u>Description</u>	<u>Unit</u>	<u>Price</u>
Repair of automobile	1 car	Y. 4,500
" locomotive	"	" 50,000
" freight car	"	" 2,000

13. Outline sketch of plant

Shown in the accompanying chart

None

14. Remarks

Since the opening of the underground tunnel between Shimonoseki and Moji to traffic, the volume of goods carried on the Sanyo Line has rapidly swollen with the resultant increase in the number of cars operated in the San-yo districts. As, however, the capacity of repairing the rolling-stock is not commensurate thereto, confusion has occurred in transportation. It is expected that a fairly large quantity of Kyushu coal will continue to be carried by rail in the future, and, in order to remove the existing bottleneck in transportation, increased rolling-stock repairing capacity is essential. Such being the case, it is planned to convert the arsenal under notice for use for the repair of the rolling-stock, having regard to the local distribution of repairing establishments.

Note: Because of the lack of a locomotive repairing plant in the districts concerned (west of Hiroshima) the repair of locomotives has

47

hitherto been made by the Kokura Workshop of the
Moji Railway Division.

15. Certification by applicant

I certify that the information contained herein is
true to the best of my knowledge and belief



Signed: E. Sato *E. Sato*

Title: Director,
General Railway Bureau
Ministry of Transportation

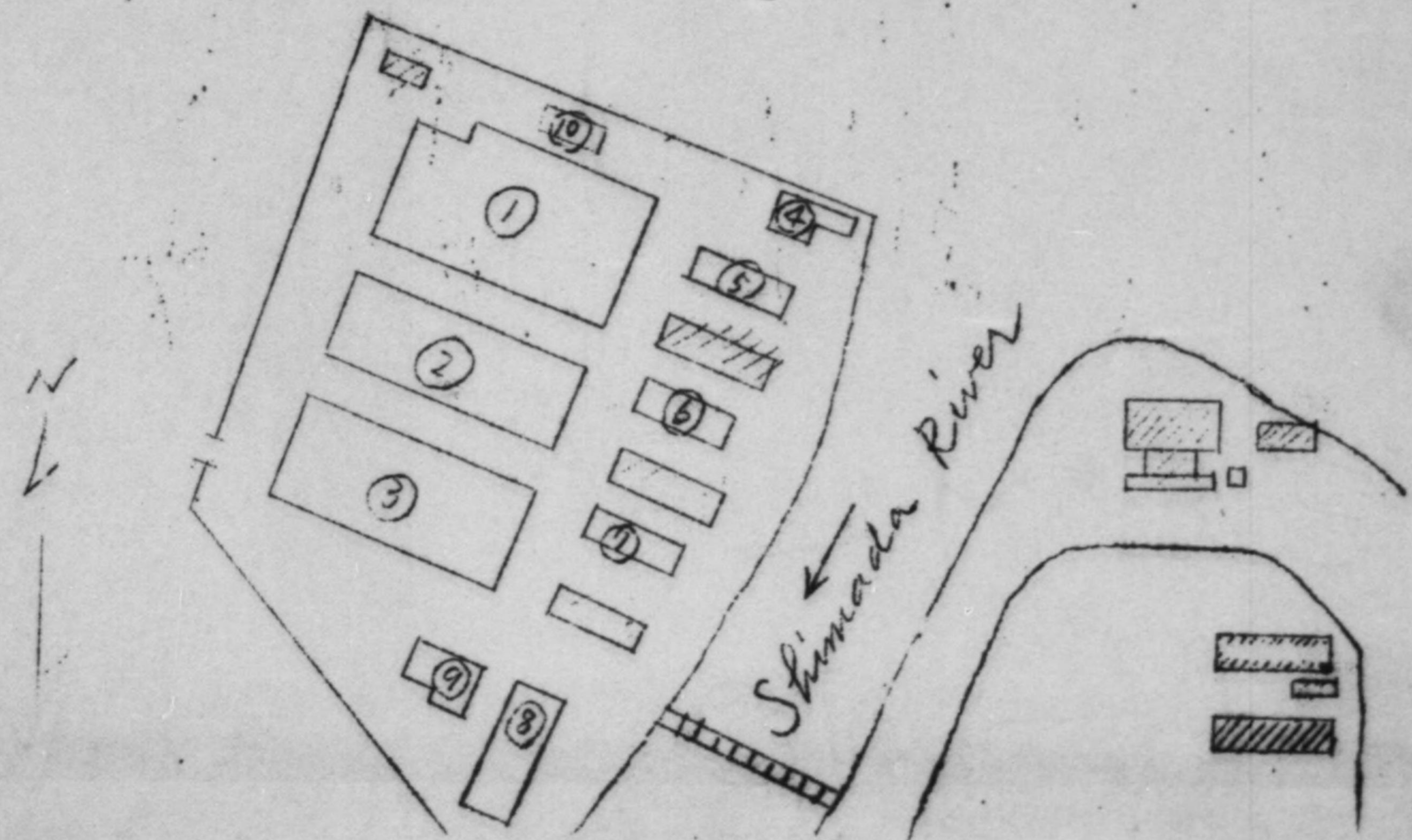
47



Plan of Itikari Navy Arsenal
scale 1/5000

Note:  Damaged building (Skeleton only)
 Building burnt

No	Name of shop after conversion	Name of shop before conversion
1	Loading & freight car shop	Machine shop
2	Automobile shop	Welding shop
3	Foundry shop	Foundry shop
4	Forging shop	Forging shop
5	Dining room	Skining shop
6	Ware house	Ware house

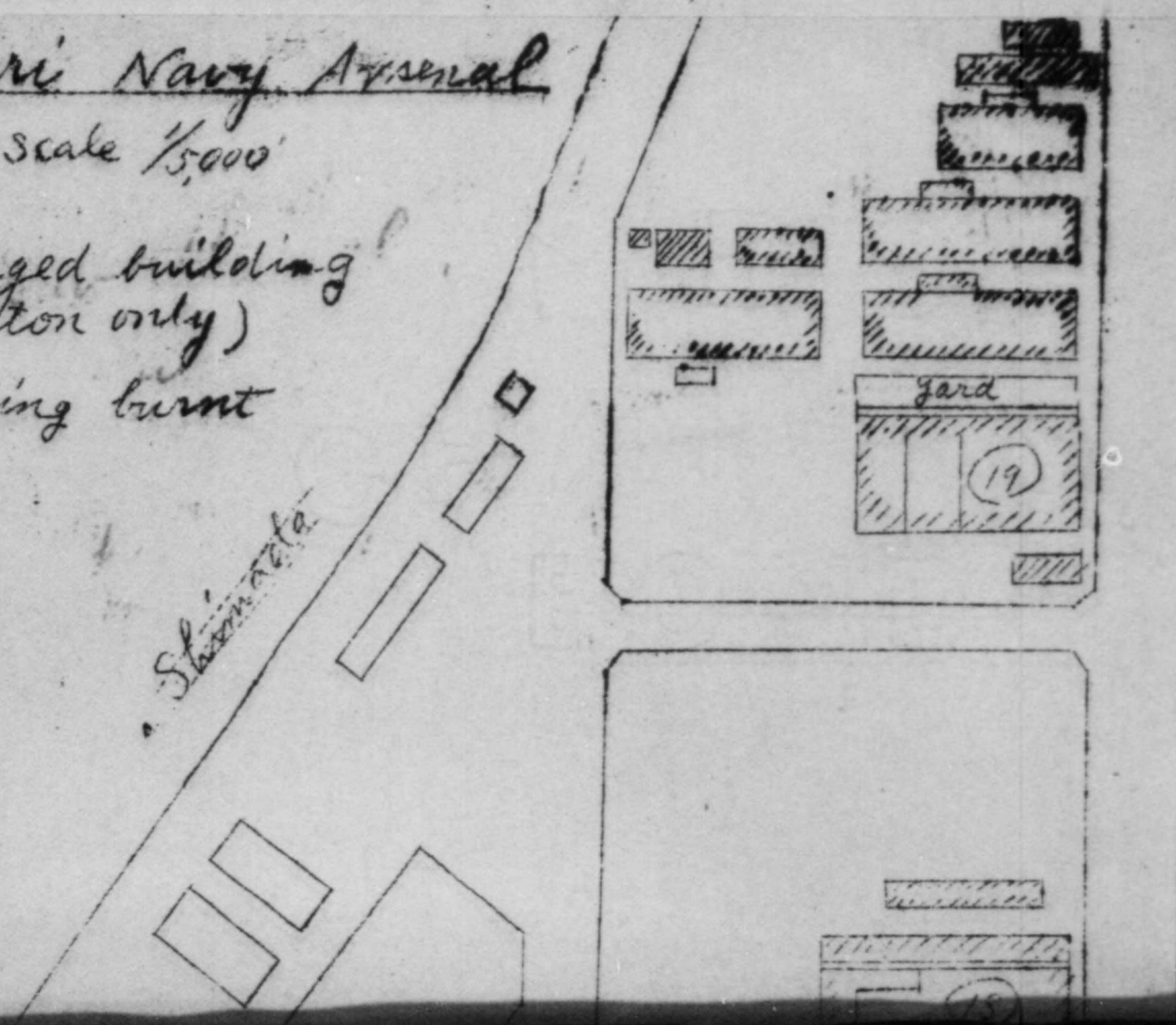

1	car shop	Machine shop
2	automobile shop	Welding shop
3	Foundry shop	Foundry shop
4	Forging shop	Forging shop
5	Leaving room	skinning shop
6	Ware house	Ware house
7	Ware house	Ware house
8	Pattern shop	Pattern shop
9	Foundry shop	Foundry shop
10	Tool shop	Tool shop
11	Electric & machine shop	Cannon shop
12	Foundry shop	Foundry shop
13	Foundry & Boiler shop	Foundry shop
14	Forging shop	Forging shop
15	Boiler room	Boiler room
16	Forging shop	Forging shop
17	Gas producer	gas producer
18	Steel shop	Steel shop
19	Electric steel shop	Electric steel shop

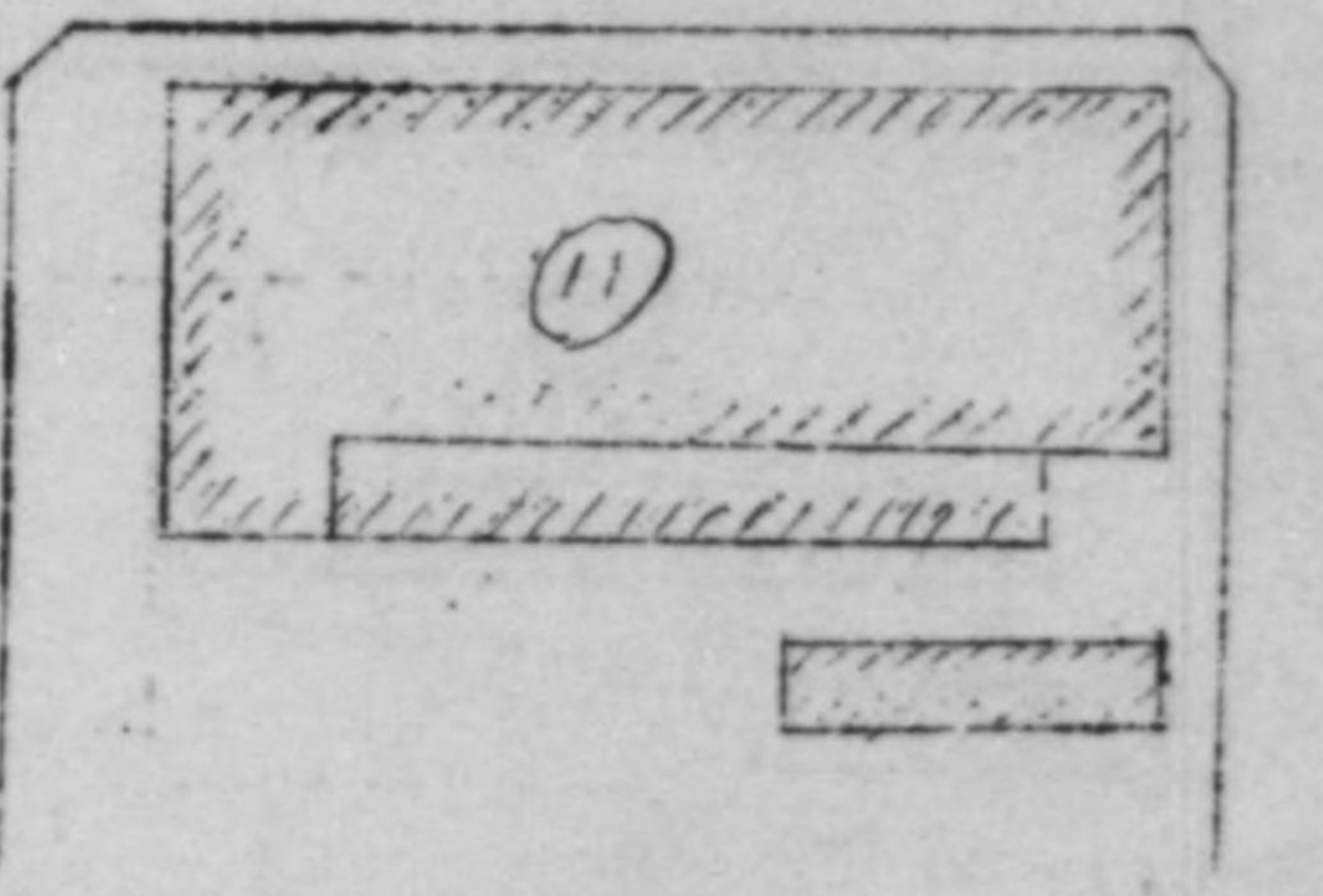
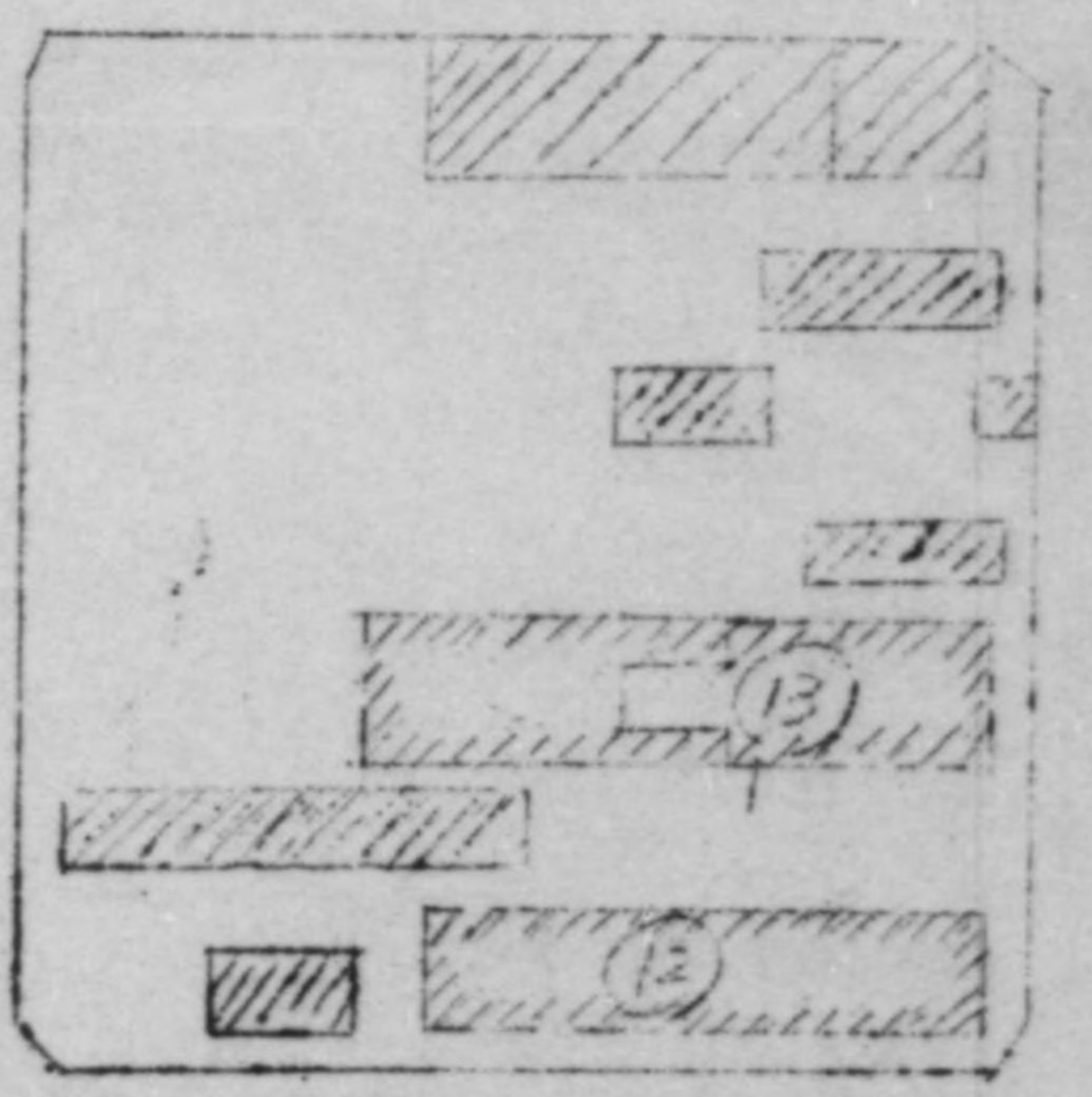
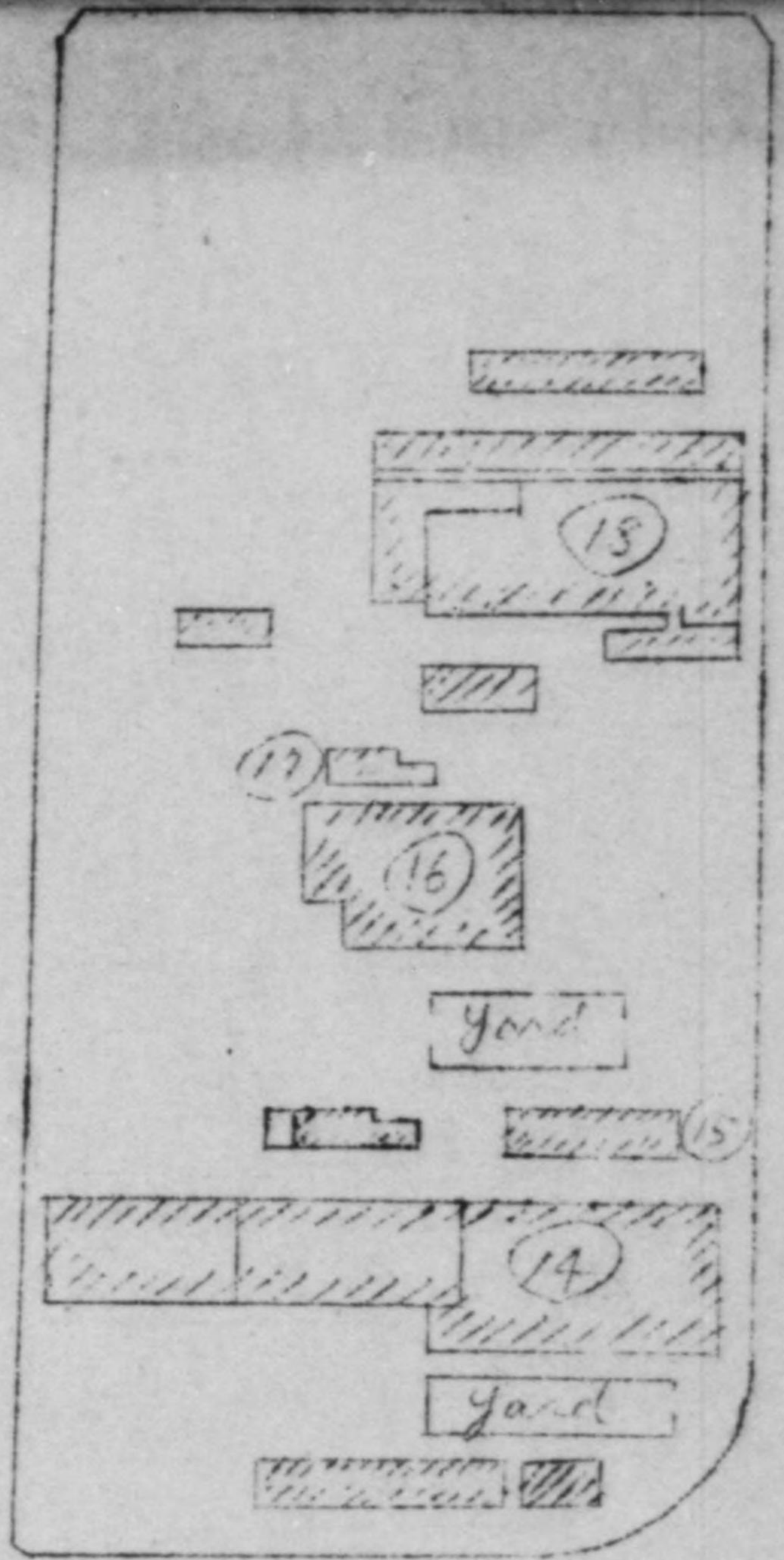

CHUGOKU
YAMAGUCHI FINANCE BUREAU

SYM/th

KFL No. O-164

31 October 1950

To : Chugoku Civil Affairs Region,
Attn. Economic Section

Subject: Shells dug out at Shirayuri Boarding House,
Hikari City, Yamaguchi Prefecture

In connection with an inquiry of Mr. Keisal of your office the undersigned just received an answer from the Chief of Hikari Branch, Chugoku Finance Bureau stating as below.

Shizuso Yamana
SHIZUSO YAMANAKA
Chief of Liaison Section,
Chugoku Finance Bureau

STATEMENT (Translation)

1. Mr. Susumu Otaki and ten others living in the Shirayuri Boarding House of former Hikari Naval Arsenal, Yamaguchi Prefecture dug shells out of the wooden water tank of 1.5 meter in diameter and 2.0 meters in depth which is placed in the same compound for fire-extinguishing purpose.

2. The dug out items are unloaded shells of 12.7 cm anti-aircraft guns. The shells were found in a pressed shape.

3. Those who dug out the shells reported to the Hikari Police Station who is presently taking the custody of the shells as buried property. They will be sold on bidding after the release.

Date: 14 October 1950

Stamped:

Chief of Hikari Branch,
Chugoku Finance Bureau

MANUFACTURING
AND INDUSTRY
FILE 45-2

II

3/10-1724

APPLICATION FOR MOVEMENT AND AUTHORIZED USE OF
DESIGNATED REPARATION MACHINERY AND EQUIPMENT

September 7, 1950

To : Ministry of Finance

From: Akira Tawarada
President
Ube Kosan Co. Ltd.
1976-1 Kogushi, Ube City, Yamaguchi Prefecture

1. Name (Code No.) and location of the plant which intends to use designated reparation machinery and equipment.

Ube Iron Works, Ube Kosan Co. Ltd. (non-designated plant)
1978-19 Kogushi, Ube City, Yamaguchi Prefecture

2. Name (Code No.) and location of the plant where designated reparation machinery and equipment to be used actually exist.

Hikari Naval Arsenal (Code No. 45-4)
Hikari City, Yamaguchi Prefecture

3. List of designated reparation machinery and equipment to be moved and used

Annex No.1

4. Necessity for movement and use of machinery and equipment

(A) Purpose

Main purpose of machineries applied for are explained by one of the annexes (Annex No.2-A No.2-B)

(B) Necessity for movement and use

Ube Iron Works is manufacturing machineries and equipments essential to reconstruction of Japan's economy.

The machine tools of the plant (about 150 sets) have been operating over 30 years and they are the largest barrier in carrying out the production plan and rationalization of production because approximately 40% of the facilities are superannuated and inefficient.

We tried to find highly precise and strong machine tools

MANUFACTURING
AND INDUSTRY
FILE 45-4

Sec II

Submitted to F. Ministry
18 Sept 50

so as to replace them. But we couldn't find any at private designated reparation works.

At present it is very difficult to get them in haste from domestic market, and this is also the conclusion of the opinion of the authorities concerned.

But by renting the machineries applied for, we can replace the superannuated and inefficient machineries, increase production efficiency, raise quality of products and lower the cost, and thus we can remove the barriers for rationalization of the production, plan to make better products in future, make up production organization for foreign exports and special demand orders. Recent average monthly production with present facilities with 700 employees is 32,000,000 Yen; and if we can obtain the machineries applied for, we can increase production of the main products about 15%.

We would like to make clear the comparison between the actual monthly production (average of the recent three months) and expected one by executing the new plan after getting reparation machineries by the attached paper ~~(No. 3)~~ (Annex No. 3)

We have a plan to install these applied machineries at Ube Iron Works as shown in the plan attached to this application.

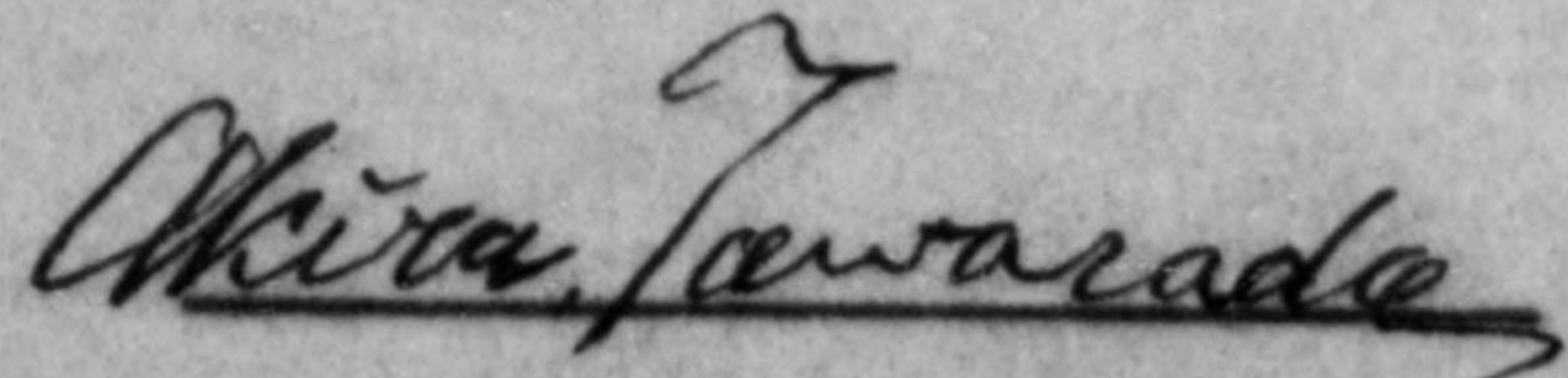

Akira Tawarada
President
Ube Kosan Co., Ltd.

Attached documents

1. List of facilities for application (Annex No. 1)
2. Purpose (Annex No. 2-A No. 2-B)

Attached documents (continued)

3. Comparison of actual production and production plan (Annex No. 3)
4. Letter of assent
5. Plan of Ube Iron Works

ANNEX NO. 1

LIST OF FACILITIES FOR APPLICATION

Code No.: 45-4
 Name of Plant: Hikari Naval Arsenal
 Address of Plant: Hikari City, Yamaguchi Prefecture

Inventory No.	Name of Machine	Brief Specification	Quantity	Remarks	Page of Worksheet
45-4-236	D-45 18' lathe	swing: 929mm; center to center: 3,000mm.	1	20 HP direct motor drive	156
45-4-317 ✓	5' radial drilling machine	sectional dimension of column: 400mm; max. distance from column surface to center of shaft: 1,500mm.	1	5 HP, 2 HP direct motor drive	110
45-4-456 ✓	#3 horizontal milling machine	size of table: 1,300x400mm.	1	10 HP direct motor drive	36
45-4-488 ✓	8' turning lathe	dia. of table: 2,500mm; max. turning length: 1,360mm	1	20 KW direct motor drive	689
45-4-1,390	#4 vertical milling machine	size of table: s. 400x500mm.	1	15 HP direct motor drive	456
45-4-1,566 1-661	10' lathe	swing: 500mm; center to center: 1,500mm.	2	7.5 HP direct motor drive	286 341
45-4-2,222 1-561	#3,500 grinding machine	swing: 400mm; grinding length: 1,200mm.	1	2 HP direct motor drive	256
45-4-3,099 ✓	D-35 40' lathe	swing: 720mm.	1	15 HP direct motor drive	554
45-4-3,100 ✓	D-45 40' lathe	swing: 920mm.	1	20 HP direct motor drive	553
45-4-3,132	5' radial drilling machine	sectional dimension of column: 400mm; max. distance from column surface to center of shaft: 1,500mm.	1	5 HP, 2 HP direct motor drive	526
45-4-3,168	6' sheet rectifier	width of roller: 6'; max. thickness of sheet to be rectified: 10mm.	1	weight: 3 tons	767 670

(continued)

ANNEX NO. 1 (continued)

Inventory No.	Name of Machine	Brief Specification	Quantity	Remarks	Page of Worksheet
45-4-3,315	1,500mm. dia. turning lathe	max. cutting dia.: 1,500x 900mm. (height)	1	10 HP direct motor drive	520
45-4-2,219	870mm. dia. turning lathe	max. cutting dia.: 900x600mm. (height)	1	7.5 HP direct motor drive	417