

## Historic, archived document

Do not assume content reflects current scientific knowledge, policies, or practices.



1  
A984M  
2 of 3

DC BRANCH

# MILKHOUSE, 16' x 22'

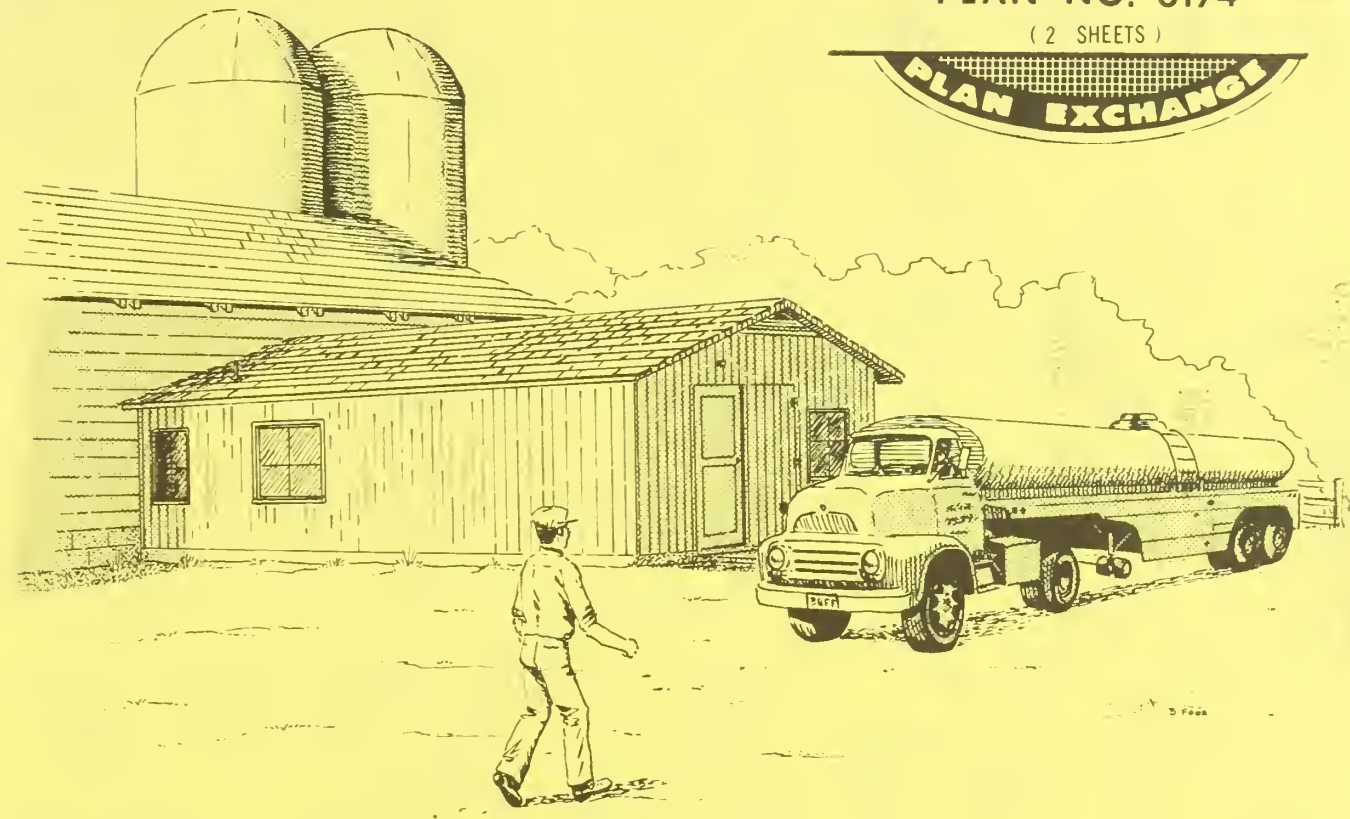

To supplement "Guidelines for Bulk Tank Milkrooms" prepared for the Northeast Dairy Practices Council, a plan for a small milkhouse was developed by an Extension Agricultural Engineer at Cornell University, Ithaca, N.Y. The plan combines several developments for improved operation, sanitation and energy conservation for dairy producers and can be utilized adjacent to either a milking parlor or milking barn.

The functional arrangement was developed to include a separate utility room, straight-through personnel traffic, plumbing and storage primarily along one wall, minimal toilet and lavatory, and utilization of compressor heat. Sizes of available commercial bulk milk tanks were checked to provide space for an 800-gallon bulk milk tank.

Structurally, 2- by 6-inch studs 2 feet on centers are fastened to a sill which is anchored in a 6-inch continuous concrete footing.

The milkhouse is well insulated with 4 inches of blanket insulation and vapor barrier in the walls and 6 inches of fill insulation and vapor barrier in the ceiling.

The roof of the building is supported with a simple king post rafter frame supporting a solid roof deck. A 6-inch

reinforced concrete floor provides a stable uniform base for different sizes of bulk milk tanks.

Conveniences include doors and louvers so that heat from refrigeration units can be directed into the milkroom during the winter and directed outside during warm weather. Other conveniences include wash vats, hand sink, record storage, and hose rack.

The working drawings include a perspective, floor plan, cross section, gable end framing, wiring and drainage layout, diagram of compressor air flow and details of louver door.

Check with the local public health and building code authorities on sanitation provisions before starting construction.

*Complete working drawings may be obtained from the extension agricultural engineer at your State university. There may be a small charge to cover cost of printing.*

*If you do not know the location of your State university, send your request to Agricultural Engineer, Extension Service, U.S. Department of Agriculture, Washington, D.C. 20250. He will forward your request to the correct university.*

ORDER PLAN NO. 6174, MILKHOUSE, 16' X 22'.

Issued September 1976

Washington, D.C.

UNITED STATES DEPARTMENT OF AGRICULTURE

Miscellaneous Publication No. 1333

For sale by the Superintendent of Documents, U.S. Government Printing Office, Washington, D.C. 20402

Price 35 cents; 25% discount allowed on orders of 100 or more to one address

Stock No. 001-000-03575-4

There is a minimum charge of \$1.00 for each mail order

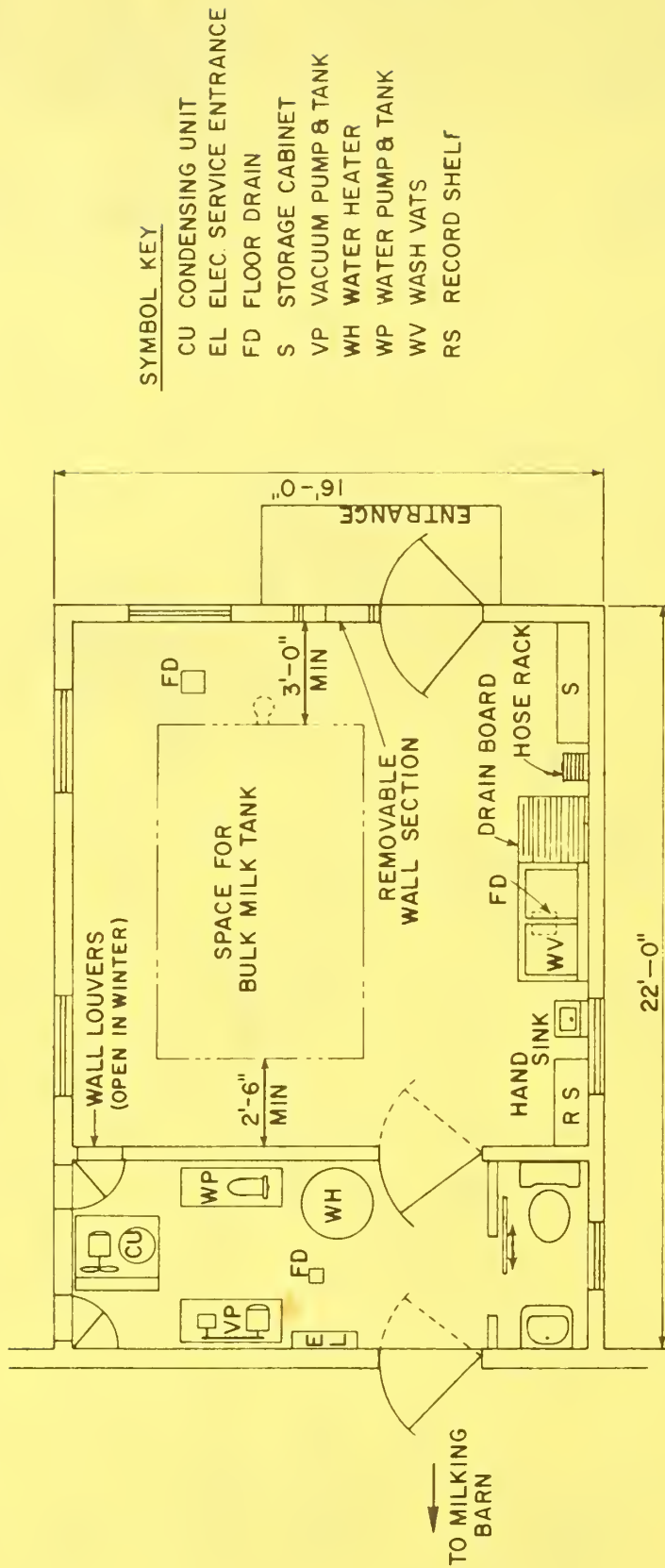

SYMBOL KEY

- CU CONDENSING UNIT
- EL ELEC. SERVICE ENTRANCE
- FD FLOOR DRAIN
- S STORAGE CABINET
- VP VACUUM PUMP & TANK
- WH WATER HEATER
- WP WATER PUMP & TANK
- WV WASH VATS
- RS RECORD SHELF

FLOOR PLAN



