

ALTERATIONS
SUBJECT
CORRECTED TO DATE
1/13/31

PLATE # 7

- ADDITIONALS
- 1. 1/13/31
- 2. 1/13/31
- 3. 1/13/31
- 4. 1/13/31
- 5. 1/13/31
- 6. 1/13/31
- 7. 1/13/31
- 8. 1/13/31
- 9. 1/13/31
- 10. 1/13/31
- 11. 1/13/31
- 12. 1/13/31
- 13. 1/13/31
- 14. 1/13/31
- 15. 1/13/31
- 16. 1/13/31
- 17. 1/13/31
- 18. 1/13/31
- 19. 1/13/31
- 20. 1/13/31
- 21. 1/13/31
- 22. 1/13/31
- 23. 1/13/31
- 24. 1/13/31
- 25. 1/13/31
- 26. 1/13/31
- 27. 1/13/31
- 28. 1/13/31
- 29. 1/13/31
- 30. 1/13/31
- 31. 1/13/31
- 32. 1/13/31
- 33. 1/13/31
- 34. 1/13/31
- 35. 1/13/31
- 36. 1/13/31
- 37. 1/13/31
- 38. 1/13/31
- 39. 1/13/31
- 40. 1/13/31
- 41. 1/13/31
- 42. 1/13/31
- 43. 1/13/31
- 44. 1/13/31
- 45. 1/13/31
- 46. 1/13/31
- 47. 1/13/31
- 48. 1/13/31
- 49. 1/13/31
- 50. 1/13/31
- 51. 1/13/31
- 52. 1/13/31
- 53. 1/13/31
- 54. 1/13/31
- 55. 1/13/31
- 56. 1/13/31
- 57. 1/13/31
- 58. 1/13/31
- 59. 1/13/31
- 60. 1/13/31
- 61. 1/13/31
- 62. 1/13/31
- 63. 1/13/31
- 64. 1/13/31
- 65. 1/13/31
- 66. 1/13/31
- 67. 1/13/31
- 68. 1/13/31
- 69. 1/13/31
- 70. 1/13/31
- 71. 1/13/31
- 72. 1/13/31
- 73. 1/13/31
- 74. 1/13/31
- 75. 1/13/31
- 76. 1/13/31
- 77. 1/13/31
- 78. 1/13/31
- 79. 1/13/31
- 80. 1/13/31
- 81. 1/13/31
- 82. 1/13/31
- 83. 1/13/31
- 84. 1/13/31
- 85. 1/13/31
- 86. 1/13/31
- 87. 1/13/31
- 88. 1/13/31
- 89. 1/13/31
- 90. 1/13/31
- 91. 1/13/31
- 92. 1/13/31
- 93. 1/13/31
- 94. 1/13/31
- 95. 1/13/31
- 96. 1/13/31
- 97. 1/13/31
- 98. 1/13/31
- 99. 1/13/31
- 100. 1/13/31

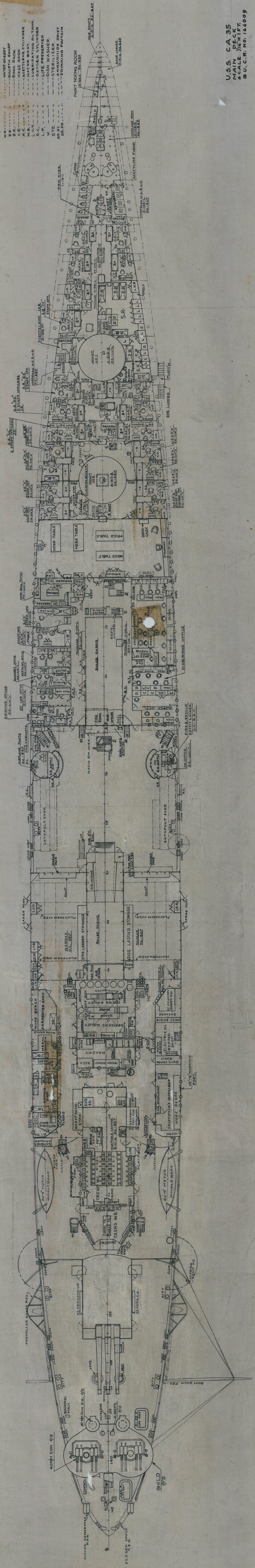

U.S.S. CA 35
MAIN DECK
B.U.C.R. NO. 16609

PLATE # 5

- ADDITIONALS
- 1. 1/13/31
- 2. 1/13/31
- 3. 1/13/31
- 4. 1/13/31
- 5. 1/13/31
- 6. 1/13/31
- 7. 1/13/31
- 8. 1/13/31
- 9. 1/13/31
- 10. 1/13/31
- 11. 1/13/31
- 12. 1/13/31
- 13. 1/13/31
- 14. 1/13/31
- 15. 1/13/31
- 16. 1/13/31
- 17. 1/13/31
- 18. 1/13/31
- 19. 1/13/31
- 20. 1/13/31
- 21. 1/13/31
- 22. 1/13/31
- 23. 1/13/31
- 24. 1/13/31
- 25. 1/13/31
- 26. 1/13/31
- 27. 1/13/31
- 28. 1/13/31
- 29. 1/13/31
- 30. 1/13/31
- 31. 1/13/31
- 32. 1/13/31
- 33. 1/13/31
- 34. 1/13/31
- 35. 1/13/31
- 36. 1/13/31
- 37. 1/13/31
- 38. 1/13/31
- 39. 1/13/31
- 40. 1/13/31
- 41. 1/13/31
- 42. 1/13/31
- 43. 1/13/31
- 44. 1/13/31
- 45. 1/13/31
- 46. 1/13/31
- 47. 1/13/31
- 48. 1/13/31
- 49. 1/13/31
- 50. 1/13/31
- 51. 1/13/31
- 52. 1/13/31
- 53. 1/13/31
- 54. 1/13/31
- 55. 1/13/31
- 56. 1/13/31
- 57. 1/13/31
- 58. 1/13/31
- 59. 1/13/31
- 60. 1/13/31
- 61. 1/13/31
- 62. 1/13/31
- 63. 1/13/31
- 64. 1/13/31
- 65. 1/13/31
- 66. 1/13/31
- 67. 1/13/31
- 68. 1/13/31
- 69. 1/13/31
- 70. 1/13/31
- 71. 1/13/31
- 72. 1/13/31
- 73. 1/13/31
- 74. 1/13/31
- 75. 1/13/31
- 76. 1/13/31
- 77. 1/13/31
- 78. 1/13/31
- 79. 1/13/31
- 80. 1/13/31
- 81. 1/13/31
- 82. 1/13/31
- 83. 1/13/31
- 84. 1/13/31
- 85. 1/13/31
- 86. 1/13/31
- 87. 1/13/31
- 88. 1/13/31
- 89. 1/13/31
- 90. 1/13/31
- 91. 1/13/31
- 92. 1/13/31
- 93. 1/13/31
- 94. 1/13/31
- 95. 1/13/31
- 96. 1/13/31
- 97. 1/13/31
- 98. 1/13/31
- 99. 1/13/31
- 100. 1/13/31

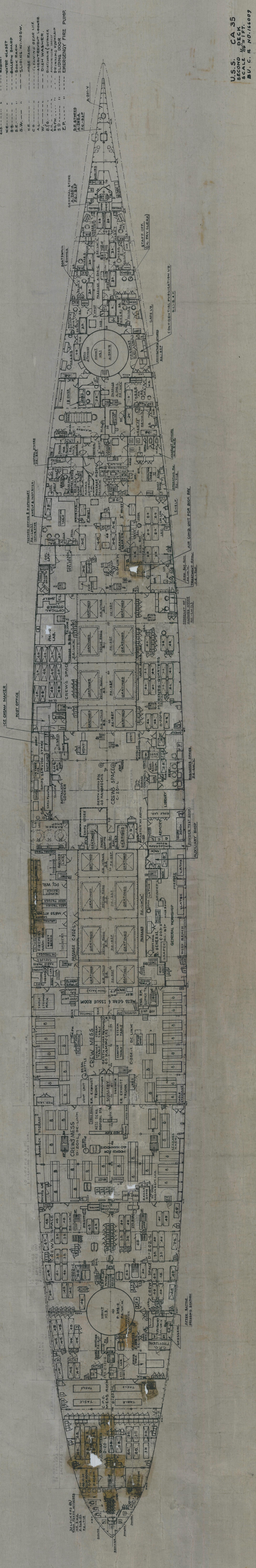

U.S.S. CA 35
MAIN DECK
B.U.C.R. NO. 16609

PLATE # 1

- ADDITIONALS
- 1. 1/13/31
- 2. 1/13/31
- 3. 1/13/31
- 4. 1/13/31
- 5. 1/13/31
- 6. 1/13/31
- 7. 1/13/31
- 8. 1/13/31
- 9. 1/13/31
- 10. 1/13/31
- 11. 1/13/31
- 12. 1/13/31
- 13. 1/13/31
- 14. 1/13/31
- 15. 1/13/31
- 16. 1/13/31
- 17. 1/13/31
- 18. 1/13/31
- 19. 1/13/31
- 20. 1/13/31
- 21. 1/13/31
- 22. 1/13/31
- 23. 1/13/31
- 24. 1/13/31
- 25. 1/13/31
- 26. 1/13/31
- 27. 1/13/31
- 28. 1/13/31
- 29. 1/13/31
- 30. 1/13/31
- 31. 1/13/31
- 32. 1/13/31
- 33. 1/13/31
- 34. 1/13/31
- 35. 1/13/31
- 36. 1/13/31
- 37. 1/13/31
- 38. 1/13/31
- 39. 1/13/31
- 40. 1/13/31
- 41. 1/13/31
- 42. 1/13/31
- 43. 1/13/31
- 44. 1/13/31
- 45. 1/13/31
- 46. 1/13/31
- 47. 1/13/31
- 48. 1/13/31
- 49. 1/13/31
- 50. 1/13/31
- 51. 1/13/31
- 52. 1/13/31
- 53. 1/13/31
- 54. 1/13/31
- 55. 1/13/31
- 56. 1/13/31
- 57. 1/13/31
- 58. 1/13/31
- 59. 1/13/31
- 60. 1/13/31
- 61. 1/13/31
- 62. 1/13/31
- 63. 1/13/31
- 64. 1/13/31
- 65. 1/13/31
- 66. 1/13/31
- 67. 1/13/31
- 68. 1/13/31
- 69. 1/13/31
- 70. 1/13/31
- 71. 1/13/31
- 72. 1/13/31
- 73. 1/13/31
- 74. 1/13/31
- 75. 1/13/31
- 76. 1/13/31
- 77. 1/13/31
- 78. 1/13/31
- 79. 1/13/31
- 80. 1/13/31
- 81. 1/13/31
- 82. 1/13/31
- 83. 1/13/31
- 84. 1/13/31
- 85. 1/13/31
- 86. 1/13/31
- 87. 1/13/31
- 88. 1/13/31
- 89. 1/13/31
- 90. 1/13/31
- 91. 1/13/31
- 92. 1/13/31
- 93. 1/13/31
- 94. 1/13/31
- 95. 1/13/31
- 96. 1/13/31
- 97. 1/13/31
- 98. 1/13/31
- 99. 1/13/31
- 100. 1/13/31

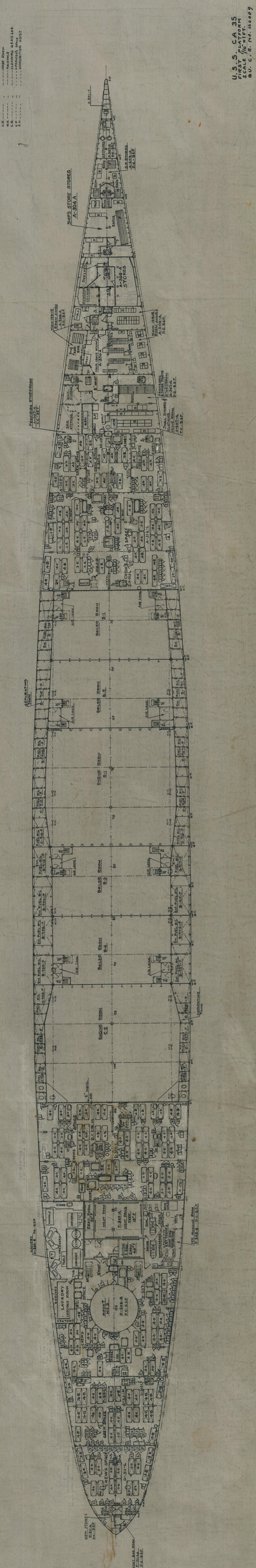

U.S.S. CA 35
MAIN DECK
B.U.C.R. NO. 16609

SUPT. CONSTRUCTORS STAMP

B.U.C.R. STAMP

CA 35
FINISHED PLAN
BOOKLET OF GENERAL PLANS
MAIN DECK, 2ND DECK & 1ST PLATFORM SHEET "B"
SCALE 1/8" = 1'-0"
SUPERINTENDING CONSTRUCTOR
UNITED STATES NAVY
NEW YORK SHIPBUILDING CO. CAMDEN, N.J.
FINISHED PLAN TAKEN FROM WORK
EXAMINED AND FOUND CORRECT.
APPROVED
E. J. Tenney

U.S. SHIPBUILDING CO.
7/21/31
E. J. Tenney

SUPT. CONSTRUCTORS

U.S. SHIPBUILDING CO.
BU. C. & R. No 16609
HULL DEPARTMENT
NEW YORK SHIPBUILDING COMPANY
CAMDEN NEW JERSEY U.S.A.
SCALE 1/8" = 1'-0"
CHECK BY GRN. DATE 5/1/31
FRANK BY G.H.
SUPERVISOR
BOOKLET OF GENERAL PLANS
MAIN DECK, 2ND DECK & 1ST PLATFORM SHEET "B"
DR. NO. 399-200-B
J.H. Tenney