

24
Dedicated to the City of Charleston
17th March 1851

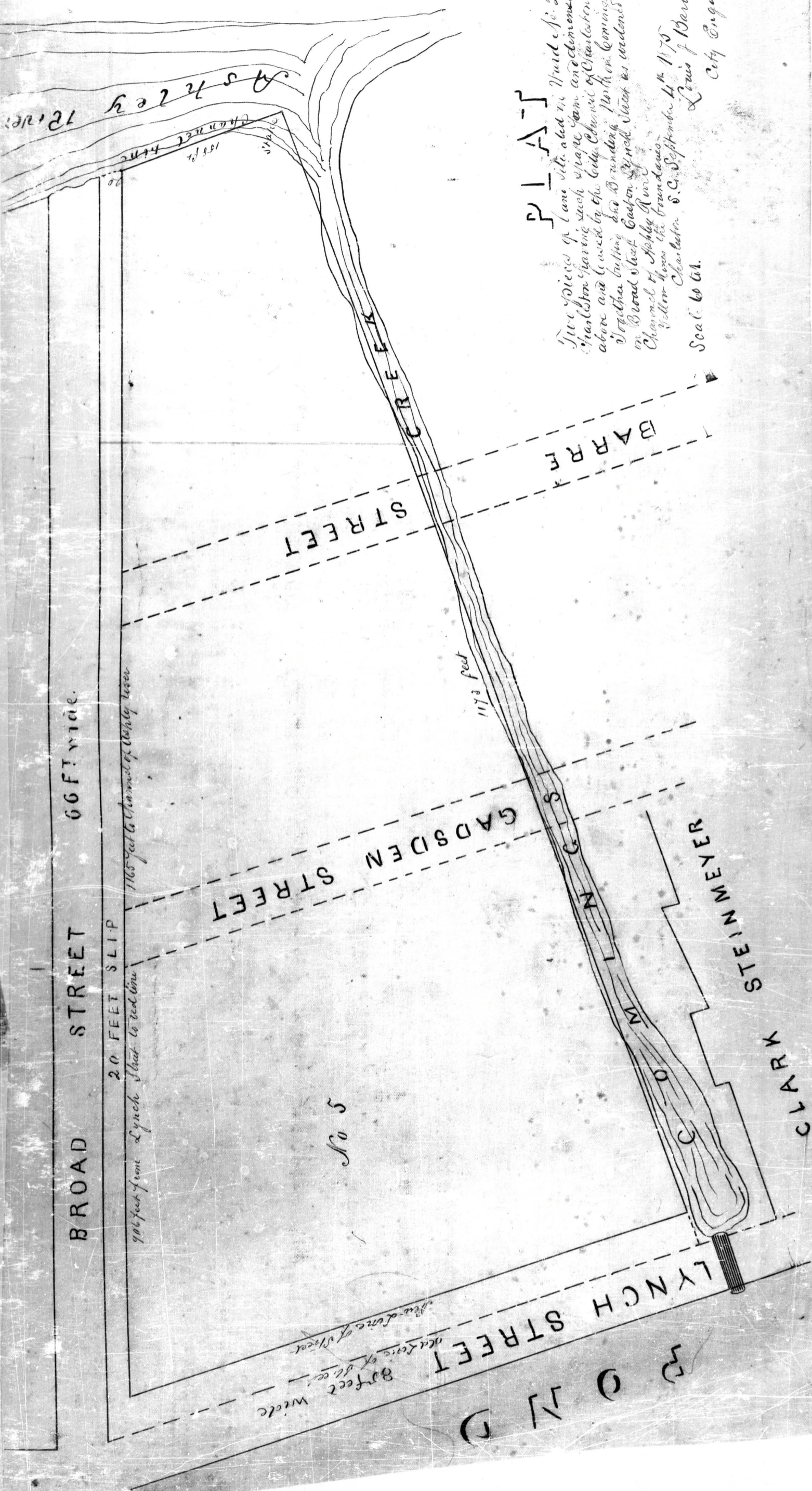

PLANS

Five pieces of land situated in Ward No. 2 City of Charleston having such shape, size and dimensions as shown above and located by the City Council of Charleston to be used for the building and bounding of a new bridge over Broad Street, Charleston, S.C. as indicated and shown in the plan of the Ashley River Channel, dated September 4th 1850.

Louis J. Barber
City Engineer

Scale 60 ft.