

- A Dwelling house three stories of wood, with cellar, has a bed or conductor
- B Kitchen and Ash Room one story of wood
- C Currier's house with loft one story of wood
- D Stable one story with both of wood
- E Offices of one story of wood
- F a Mill of water and pump
- G garden

Scale 20 feet for an Inch

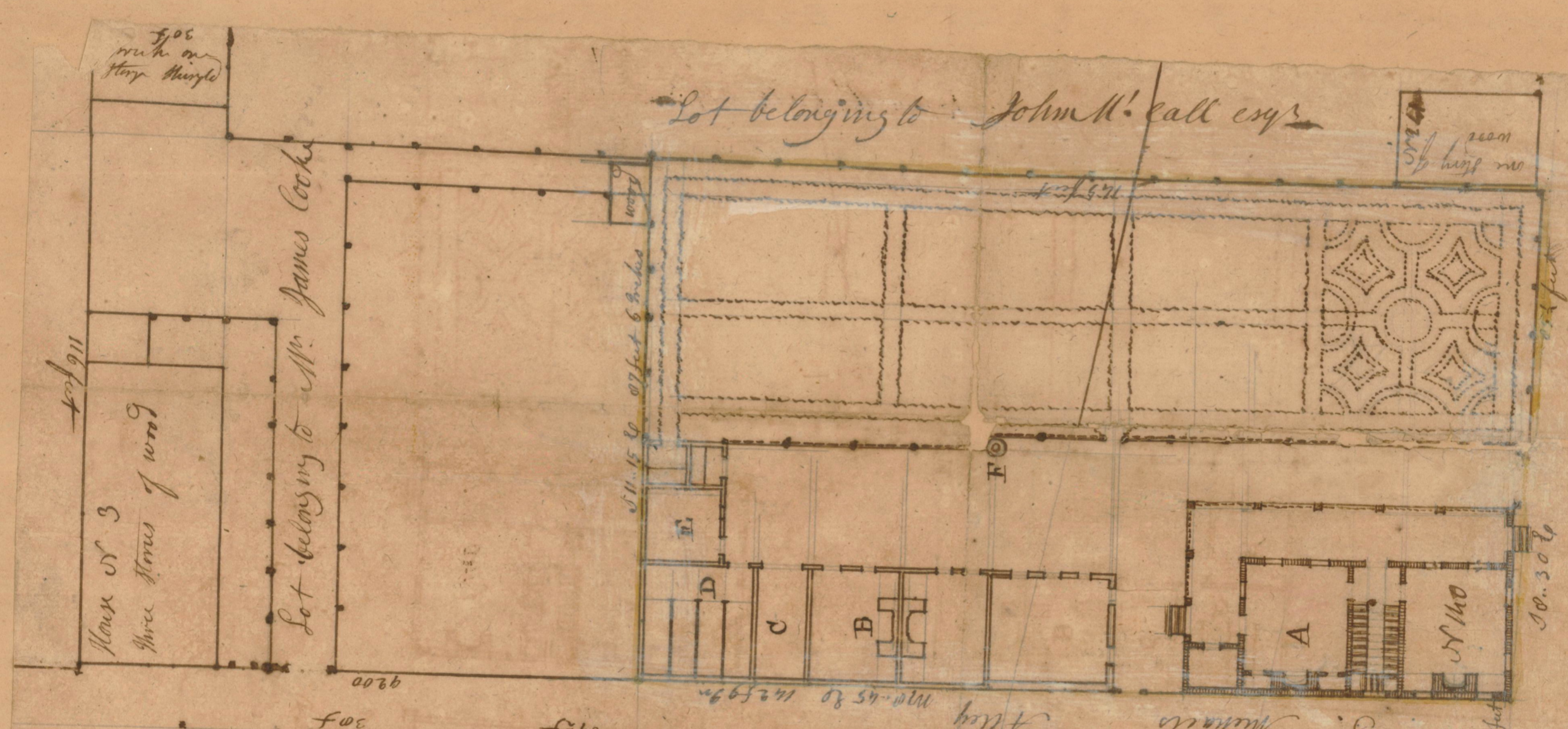

St. Nicholas Church  
 798 1/2 feet across  
 100 feet  
 1367  
 the above is a description of the Church yard and

St. Nicholas Church yard  
 brick wall  
 130 feet  
 209 feet  
 130 feet  
 double  
 Public Pump  
 A Plan of House and Lot of 2.10  
 on Market Street in Ward of C. at the  
 City of Charles to and State of South Carolina  
 belonging to the Elderly hall Bay 244  
 being descended by the trading of M. C. M. G.  
 from a survey taken in August 1709