

INVOICE

July 27, 1948

Before Kamiida Plant

Purchasing Section,
Business Dept.

Switch board

50A 3300V

3P Cycle 60 ~

1. @ 60,000.-

Y 60,000.-

INVOICE

July 23, 1948

Before Kamiida Plant

Purchasing Section,
Business Dept.

Switch board

50A 3300V

3P Cycle 60 ~

1. @ 60,000.- ¥ 60,000.- ✓

INVOICE

July 23, 1948

Before Kamiida Plant

Purchasing Section,
Business Dept.

Switch board

30A 3300V

3P Cycle 60 ~

1. @ 60,000.- ¥ 60,000.-

INVOICE

July 23, 1948

Before Kamiida Plant

Purchasing Section,
Business Dept.

Switch board

30A 3300V

3P Cycle 60 ~

1. @ 60,000.-

Y 60,000.- ✓

INVOICE

July 23, 1948

Before Kamiida Plant

Purchasing Section,
Business Dept.

Switch board

30A 3300V

3P Cycle 60 ~

1. @ 60,000.-

¥ 60,000.-

INVOICE

June 23, 1948

Before Kamiida Plant

Purchasing Section,
Business Dept.

Single phase transformer

Capacity 20 KVA

Cycle 60 ~

Osaka Hanatsuki K. K.

1. @ 12,000.- ¥ 12,000.- ✓

INVOICE

July 1, 1948

Before Kamiida Plant

Purchasing Section,
Business Dept.

Air compressor

2 HP

Meiji Seisakusho

1. @ ¥ 18,000.- ¥ 18,000.- V

INVOICE

July 1, 1948

Before Kamiida Plant

Purchasing Section,
Business Dept.

Gear testing machine

Max. gear dia. 360 m/m

1. @ 10,000.- ¥ 10,000.- ✓

INVOICE

July 1, 1948

Before Kamiida Plant

Purchasing Section,
Business Dept.

Wood scraper

4" x 12"

1. @ ¥ 17,000.- ¥ 17,000.-

HEADQUARTERS
AICHI MILITARY GOVERNMENT TEAM
APO 710 (Nagoya, Honshu)

RLM/hk

30 August 1948

SUBJECT: Confirmation of EX Items of Equipment

THRU: The Aichi Prefectural Liaison Office

TO: Okuma Development Co., Ltd.
Kamidada Plant (OL-33)
27 Nisshin, Tsuji-machi
Kita-ku, Nagoya

This headquarters hereby confirms the Exempt status of the four (4) items of equipment on attached list. These items of equipment are located at the Kamidada plant, Code No. OL-33.

FOR THE COMMANDING OFFICER:

FRANK L. BOCK
Major INF
Adjutant

1 Incl:
List of EX machinery

HEADQUARTERS
AICHI MILITARY GOVERNMENT TEAM
APO 710 (Nagoya, Honshu)

RLM/hk

27 August 1948

SUBJECT: Confirmation of EX Items of Equipment

THRU: The Aichi Prefectural Liaison Office

TO: Okuma Development Co., Ltd.
Kamidada Kojo (01-83)
500 Nishitenjinmae, Kamidada-machi
Kita-ku, Nagoya-shi

This headquarters hereby confirms the Exempt status of the eight (8) items of equipment on attached list. These items of equipment are located at the Kamidada plant, Code No. 01-83.

FOR THE COMMANDING OFFICER:

FRANK L. BOCK
Major INF
Adjutant1 Incl:
List of EX machinery

OKUMA DEVELOPMENT CO., LTD.

27 Nisshin, Tsuji-machi,
Kita-ku, Nagoya.

June 7, 1948.

Subject: Marking of EX Machinery and Equipment
Thru : Reparations Section of Economical Dept., Aichi Pref.
To : Aichi Military Government Team

We herewith submit to your office this report
concerning the above-mentioned subject.

Confirmed 27 Aug 48
Aichi Mil. Govt
RHM

Karoku Muroka
Karoku Muroka
President

List of items of Equipment in authorized EK

Name of Plant: Okuma Development Co., Ltd. --Ozone Plant

a Inventory Code No.	b Type of item	c Operation dimension serial and or Model number	d Name of Maker	e Name of Seller	f Date of purchase or other trans- action by which item was acquired	g Date of delivery into plant
1B3 - 3	Hand press	Pressing Capacity 100 Kg	Washino	Washino	May 18, 1948	May 17, 1948
1A5 - 32	Portable grinder (Flexible)	1. Standard diameter & width of grinding wheel 150 ϕ x 19 2. Motor drive	Kokusen Flex K. K.	Nagata	Oct. 31, 1948	Nov. 15, 1947
1A5 - 33	Portable grinder	"	"	"	"	"
1A5 - 34	Portable grinder	"	"	"	"	"
1A9 - 21	Hack saw	1. Length of blade 360			Documents were burnt down	

775013

		Wheel 150 ϕ x 19	Flex K. K. Nagata		Oct. 31, 1948 Nov. 15, 1947	
		2. Motor drive				
145 - 33	Portable grinder	"	"	"	"	"
145 - 34	Portable grinder	"	"	"	"	"
149 - 21	Hack saw	1. Length of blade 360 2. Max. size of work 230 ϕ 3. Stroke 150 4. Motor drive	Home made	Hori Tekko	Documents were burnt down by bombing. unknown	Feb. 10, 1948
8 - 2	Belt hammer	Capacity un-known	Okuma Kokura plant	Kokura transferred	"	April 24, 1948
1 - 1	Moulding machine	1. Work table size 450 x 550 2. Pressure of air 3.5 - 5 Kg/cm ² 3. Work Capacity 200 Model AJS	Matsubuchi Manufacturing Co.	Matsubushi	Oct. 9, 1946	May 20, 1948
- 36	Tool grinder (Double wheel)	Standard diameter & width of grinding wheel 200 ϕ x 19	Riken	Head office	Documents were burnt down by bombing. Unknown	June 1, 1948

The items listed on this page have been investigated and confirmed as EX items of equipment by Aichi Mil. Govt. *Confirmed 27 Aug. 47*
Aichi Mil. Govt. RHM
RJM 1st Lt Inf

ORDER No. 3-84

May 18, 1948

Before Washino Seiki Shoji

Okuma Kogyo E.K.

Please send us the following goods.

<u>Description</u>	<u>Quantity</u>	<u>Unit</u>	<u>Total</u>
Washino Eccentric press Hand	1	¥ 4,300	¥ 4,300

Confirmed
Aichi Mil. Govt.
RJM

INVOICE

May 17, 1948

Before Ozone Plant

Purchasing Section,
Business Dept.

No. 102

The following goods you ordered have been forwarded.

<u>Mfg. No.</u>	<u>No.</u>	<u>Description</u>	<u>Quantity</u>	<u>Unit</u>	<u>Total</u>
		Hand press	1	¥4,300. -	¥4,300. -

Confirmed
Recd. Mil. Govt.
2/2/48

775013

INVOICE

Nov. 18, 1947.

Before Ozone Plant

Purchasing Section,
Business Dept.

No. 57

The following goods you ordered have been forwarded.

<u>Manufacturing No.</u>	<u>No.</u>	<u>Description</u>	<u>Quantity</u>	<u>Unit</u>	<u>Total</u>
		Portable grinders	3	¥5,780.	¥17,340.

Confirmed
Aichi Mil. Govt.
RJM

ORDER No. 925

Oct. 31, 1947

Before Nagata Shoten

Okuma Kogyo K. K.

Please send us the following goods.

<u>Description</u>	<u>Quantity</u>	<u>Unit</u>	<u>Total</u>
Kokusan BH type Grinder	4	¥ 5,780.-	¥23,120.-

Confessed
Aichi Mil. Govt.
W.M.

INVOICE

10 February 1948

Before Okuma Kogyo K. K.

Hori Tekko Sho

13, Nanyodori-3-chome,
Minami-ku, Nagoya

Tel: 6-2122

<u>Order No.</u>	<u>Item</u>	<u>Quantity</u>	<u>Unit</u>	<u>Total</u>
8	Hack saw (Second-hand & repaired)	1	¥16,000.	¥16,000.

The above goods you ordered have been forwarded.

Confirmed
Aichi Mil. Govt.
RJM

775013

No. 385 A Kekura 8 B 327

I N V O I C E

April 24, 1948

Before Ozone Plant

Purchasing Section,
Business Dept.

The following goods you ordered have been forwarded.

<u>Description</u>	<u>Quantity</u>	<u>Unit</u>	<u>Total</u>
Okuma-type Belt hammer	1		¥22,500.

April 24, 1948

Received by Ando

Confirmed
Aichi Mil. Dept.
RJM

I N V O I C E

20 May 1948

Before Ozone Plant

Purchasing Section,
Business Dept.

No. 110

The following goods you ordered have been forwarded.

<u>Mfg. No.</u>	<u>No.</u>	<u>Description</u>	<u>Quantity</u>	<u>Unit</u>	<u>Total</u>
		Matsubuchi moulding machine	1	¥7,200	¥7,200

Confirmed
Aichi, G. I.
E. C. M.

775013

ORDER No. 113

Oct. 9, 1946

Before Matsubuchi K.K.

Okuma Kogyo K.K.

Please send us the following machines.

<u>No.</u>	<u>Description</u>	<u>Quantity</u>	<u>Unit</u>	<u>Total</u>
	Moulding machine	3	¥7,200.-	¥21,600.-

*Continued
from Mil. Govt.
RJM*

INVOICE

June 1, 1948

Before Ozone Plant

Purchasing Section,
Business Dept.

No. 109

The following goods you ordered have been forwarded.

<u>Manufacturing</u> <u>No.</u>	<u>No.</u>	<u>Description</u>	<u>Quantity</u>	<u>Unit</u>	<u>Total</u>
		Tool grinder (Double wheel)	1	¥3,000.	¥3,000.

*Confirmed
Aichi Mil. Govt
RJM*

HEADQUARTERS
AICHI MILITARY GOVERNMENT TEAM
APO 710 (Nagoya, Honshu)

RLM/hk

10 August 1948

SUBJECT: Confirmation of Items of Equipment in
Authorized Use

THRU: The Aichi Prefectural Liaison Office

TO: Gama Development Co. Ltd.
Kamida Plant (GI-83)
500 Nishitenjinno, Kamida-chochi
Kita-ku, Nagoya

This headquarters hereby confirms the continued authorized use of the two hundred (200) items of equipment on attached list. These items of equipment are located at the Kamida Plant (GI-83).

FOR THE COMMANDING OFFICER:

FRANK L. BOCK
Major INF
Adjutant

1 Incl:
Items of Equipment in authorized use

200 items
AU

OKUMA DEVELOPMENT CO., LTD.
KAMIIDA PLANT

List of Items of Equipments in Authorized Use

Inventory Number	Type of Item	Operating dimension serial and/or model	Purpose for which item is being used	Number and date of permit under which item of equipment is operating
1 01 - 83 IAI - 4 ✓	Horizontal Boring mach. Table type	Dia. of Boring Bar 70m/m Table dim. 1000 x 800m/m Union S - 70	Mach. fittings	MG 308 Dec. 18, 1945
2 01 - 83 IAI - 6 ✓	"	Dia. of Boring Bar 63.5m/m Table dim. 910 x 560 m/m Okuma HB No. 1	"	"
3 01 - 83 IAI - 7 ✓	"	"	"	"
4 01 - 83 IA3 - 2 ✓	Upright drilling mach. single	Dia. of spindle 33m/m Drilling cap. cast iron 25 m/m Okuma DU 20"	"	"
5 01 - 83 IA3 - 8 ✓	Radial drilling mach.	Dia. of spindle 45m/m-100m/m Drilling cap. cast iron 45 m/m Arm length 1080m/m Cincinnati Bickford 1080	"	"
6 01 - 83 IA3 - 25 ✓	"	Dia. of spindle 50-80m/m Drill. cap. Cast iron 50 m/m Arm length 1000 Okuma DA No. 1	"	"
01 - 83	Gear Shaper	Max. dia of work 600m/m	"	"

DECLASSIFIED E.O. 12065 SECTION 3-402/NNDG NO. 775013

4	01 - 83 IA3 - 2 ✓	Upright drilling mach. single	Dia. of spindle 35m/m Drilling cap. cast iron 25 m/m Okuma DU 20"	"
5	01 - 83 IA3 - 8 ✓	Radial drilling mach.	Dia. of spindle 45m/m-100m/m Drilling cap. cast iron 45 m/m Arm length 1080m/m Cincinnati Bickford 1080	"
6	01 - 83 IA3 - 25 ✓	"	Dia. of spindle 50-80m/m Drill. cap. Cast iron 50 m/m Arm length 1000 Okuma DA No. 1	"
7	01 - 83 IA4 - 2 ✓	Gear Shaper spur and Helical External only	Max. dia of work 600m/m Max. width of work 100m/m Parkinson No. 16	"
8	01 - 83 IA4 - 4 ✓	Gear Hobbing	Max. dia of work 500m/m max. width of work 150m/m Pfauder R. S. 500	"
9	01 - 83 IA4 - 5 ✓	"	Max. dia of work 600 width 150 Kashifuji	"
10	01 - 83 IA5 - 1 ✓	Tool grinder	Standard dia and width of grind wheel 365 ϕ x 50m/m Okuma GT 14"	"
11	01 - 83 IA5 - 6 ✓	Internal and facing grinding	Max. dia and depth 250 x 200 Fortuna SIP	"
12	01 - 83 IA5 - 8 ✓	Universal tool grinding	Max. dia and length of hole 203 ϕ x 610m/m Okuma GM	"
13	01 - 83 IA5 - 9 ✓	"	"	"
14	01 - 83 IA5 - 10 ✓	Internal and facing grinding	max. dia. and depth hole 150 x 200 m/m Reinecker TPS - 1	"

Confirmed
Aichi Mil. Govt.
RJM

DECLASSIFIED E.O. 12065 SECTION 3-402/NNDG NO. 775013

775013

Inventory Number	Type of Item	Operating dimension serial and/or model	Purpose for which item is being used	Number and date of permit under which item of equipment is operating
15 01 - 83 1A5 - 11 ✓	Internal	Max. dia. and depth of hole 100 x 130 m/m Wotan RJ 30	Machine fittings	MG 308 Dec. 18, 1945
16 01 - 83 1A5 - 15 ✓	Surface grinding Rotary table	Chuck surface dia 300 mm Churchill HBY 12	"	"
17 01 - 83 1A5 - 16 ✓	Surface grinding Recipro type	Max. trav. of head 3000 mm Billeter TH 110	"	"
18 01 - 83 1A5 - 18 ✓	Cylindrical grinding (Universal)	Max. dia. and length of work 300 x 1000mm Landis 0	"	"
19 01 - 83 1A5 - 20 ✓	Cylindrical grinding (Plain)	Max. dia and length of work 180 x 760 mm Cincinnati, Hydraulic	"	"
20 01 - 83 1A5 - 21 ✓	Cylindrical grinding (Universal)	Max. dia. and length of work 350 x 1830 mm Landis 0	"	"
21 01 - 83 1A5 - 25 ✓	Tool grinder	Standard dia and width of grinding wheel 450 ϕ x 64 mm Okuma GT 20"	"	"
22 01 - 83 1A5 - 26 ✓	Surface grinding (Recipro table)	Table traverse 1000 x 400 x 420 Thompson	"	"
23 01 - 83 1A6 - 14 ✓	Turret lathe saddle type	Round bar cap. 100mm Boehringer RH 23	"	"
24 01 - 83	Engine lathe	Swing x bet. cent. dia.		

		(Plain)	Cincinnati, Hydraulic		
20	01 - 83 1A5 - 21 ✓	Cylindrical grinding (Universal)	Max. dia. and length of work 350 x 1830 mm Landis G	"	"
21	01 - 83 1A5 - 25 ✓	Tool grinder	Standard dia and width of grinding wheel 450 φ x 64 mm Okuma GT 20"	"	"
22	01 - 83 1A5 - 26 ✓	Surface grinding (Recipro table)	Table traverse 1000 x 400 x 420 Thompson	"	"
23	01 - 83 1A6 - 14 ✓	Turret lathe saddle type	Round bar cap. 100mm Boehringer RH 23	"	"
24	01 - 83 1A6 - 74 ✓	Engine lathe standard	Swing x bet. cent. dia. 432 x 1230 mm Okuma OG	"	"
25	01 - 83 1A6 - 75 ✓	"	"	"	"
26	01 - 83 1A6 - 76 ✓	"	"	"	"
27	01 - 83 1A6 - 77 ✓	"	"	"	"
28	01 - 83 1A6 - 78 ✓	"	"	"	"
29	01 - 83 1A6 - 79 ✓	"	Swing x bet. cent. dia. 355 x 810 mm Pratt & Whitney G	"	"
30	01 - 83 1A6 - 80 ✓	"	Swing x bet. cent. dia. 362 x 755 mm Okuma UEG-	"	"

Confirmed
Aichi Mil. Govt.
RJM

775013

Inventory Number	Type of Item	Operating dimension Serial and/or model	Purpose for which item is being used	Number and date of permit under which item of equipment is operating
31 01 - 83 1A6 -81 ✓	Engine standard	Swing x between center dist. 362 x 755mm Okuma UEG	Machine fittings	MG 308 Dec. 18, 1945
32 01 - 83 1A6 -82 ✓	"	"	"	"
33 01 - 83 1A6 -83 ✓	"	"	"	"
34 01 - 83 1A6 -84 ✓	"	"	"	"
35 01 - 83 1A6 -85 ✓	"	"	"	"
36 01 - 83 1A6 -86 ✓	"	"	"	"
37 01 - 83 1A6-109 ✓	"	"	"	"
38 01 - 83 1A6-122 ✓	Turret Lathe Ram type	Round bar cap 38 mm Waner & Swasey No. 3	"	"
39 01 - 83 1A6-123 ✓	Turret Lathe Saddle type	Round bar cap. 62 mm Waner & Swasey No. 1A	"	"
01 - 83 1A6-114	Engine lathe Standard	Swing & bet. cent. dist. 622 x 1750 mm Okuma OEG	"	"
01 - 83 1A6-115	"	"	"	"
01 - 83	"	"	"	"

775013

37	01 - 83 1A6-109					
38	01 - 83 1A6-122	Turret Lathe Ram type	Round bar cap 38 mm Waher & Swasey No. 3	"	"	"
39	01 - 83 1A6-123	Turret Lathe Saddle type	Round bar cap. 62 mm Waher & Swasey No. 1A	"	"	"
	01 - 83 1A6-114	Engine lathe Standard	Swing & bet. cent. dist. 622 x 1750 mm Okuma OEG	"	"	"
	01 - 83 1A6-115	"	"	"	"	"
	01 - 83 1A6-116	"	Swing & bet. cent. dia. 630 x 2000 mm Okuma IE	"	"	"
40	01 - 83 1A7 - 7	Horizontal universal milling Knee type	Table traverse 710 x 250 x 450 Van Norman 22 type 2	"	"	"
41	01 - 83 1A7 - 8	Horizontal universal milling	Table trav. 710 x 254 x 457 Okuma ML No. 2	"	"	"
42	01 - 83 1A7 - 9	Horizontal plain milling	Table traverse 710 x 250 x 450 Gasdenki No. 2	"	"	"
43	01 - 83 1A7 - 10	"	"	"	"	"
44	01 - 83 1A7 - 11	Horizontal Uni- versal milling	Table traverse 710 x 254 x 457 Okuma ML No. 2	"	"	"
45	01 - 83 1A7 - 12	"	700 x 250 x 450 Ibwe FU-5NS No. 2	"	"	"

Confirmed
Aichi Mil. Govt.
RAM

Inventory Number	Type of Item	Operating dimension Serial and/or model	Purpose for which item is being used	Number and date of permit under which item of equipment is operating
46 01 - 83 1A7 - 13 ✓	Thread milling	Pratt & whitney 6m x 120	Machine fittings	MG 308 Dec. 18, 1945
47 01 - 83 1A7 - 14 ✓	"	J.E. Reinecker GP-0	"	"
48 01 - 83 1A7 - 15 ✓	Vertical milling Knee type	Table traverse 710 x 300 x 360 mm Cincinnati M	"	"
49 01 - 83 1A7 - 16 ✓	Vertical milling	Table traverse 710 x 300 x 360 mm Gardenki No. 2	"	"
50 01 - 83 1A7 - 19 ✓	Vertical milling Bed type	Table traverse 755 x 780 mm Okuma MK No. 3	"	"
51 01 - 83 1A8 - 1 ✓	Planer	Max. planing capacity 1285 x 1230 x 3170mm Kitakami	"	"
52 01 - 83 1A8 - 2 ✓	"	Max. planing capacity 775 x 2450 x 775 Okuma PS	"	"
53 01 - 83 1A8 - 3 ✓	"	"	"	"
54 01 - 83 1A8 - 6 ✓	"	Max. planing capacity 940 x 925 x 3680 mm Komatsu	"	"
55 01 - 83 1A8 - 7 ✓	"	Max. planing capacity 925 x 925 x 3660 mm Okuma PS	"	"

51	01 - 83 1A8 - 1 ✓	Planer	Max. planing capacity 1285 x 1230 x 3170mm Kitakami	"	"
52	01 - 83 1A8 - 2 ✓	"	Max. planing capacity 775 x 2450 x 775 Okuma PS	"	"
53	01 - 83 1A8 - 3 ✓	"	"	"	"
54	01 - 83 1A8 - 6 ✓	"	Max. planing capacity 940 x 925 x 3680 mm Komatsu	"	"
55	01 - 83 1A8 - 7 ✓	"	Max. planing capacity 925 x 925 x 3660 mm Okuma PS	"	"
56	01 - 83 1A8 - 8 ✓	"	Max. planing capacity 1080 x 1080 x 3660 Okuma PS	"	"
57	01 - 83 1A9 - 1 ✓	Centering machine	Double spindle Drilling cap. 25mm Okuma A	"	"
58	01 - 83 1A9 - 5 ✓	Hack Saw	Max. size of work 200 x 230mm Okuma 16"	"	"
59	01 - 83 1A9 - 6 ✓	"	"	"	"
60	01 - 83 1A9 - 11 ✓	Vertical shaper	Max. stroke of ram 300 mm Dia. of table 610 mm Prett & whitney B-12"	"	"
61	01 - 83 1A9 - 14 ✓	Shaper	Max. stroke of Ram 610 mm Okuma SS-24"	"	"
62	01 - 83 1A9 - 15 ✓	"	"	"	"

Confirmed
Aichi Mil. Govt.
" RJM

DECLASSIFIED E.O. 12065 SECTION 3-402/NNDG NO. 775013

775013

Inventory Number	Type of Item	Operating dimension Serial and/or model	Purpose for which item is being used	Number and date of permit under which item of equipment is operating
63 01 - 83 1A9 - 16 ✓	Shaper	Max. stroke of ram 510 mm Okuma SS-20"	Machine fittings	MG 308 Dec. 18, 1945
64 01 - 83 1A9 - 18 ✓	"	"	"	"
65 01 - 83 1A9 - 22 ✓	"	Max. stroke of ram 405 mm Okuma SS-16"	"	"
66 01 - 83 IIB1-1 ✓	Transformer	30 KVA Osaka	Supply of current	MG 308 Dec. 18, 1945
67 01 - 83 IIB1 - 2 ✓	"	50 KVA Osaka	"	"
68 01 - 83 IIB1 - 3 ✓	"	"	"	"
69 01 - 83 IIB1 - 4 ✓	"	"	"	"
70 01 - 83 IIB1 - 5 ✓	"	30 KVA Osaka	"	"
71 01 - 83 IIB1 - 6 ✓	"	50 KVA	"	"
72 01 - 83 IIB1 - 7 ✓	"	"	"	"
73 01 - 83 IIB1 - 8 ✓	"	"	"	"
74 01 - 83 IIB1 - 9 ✓	"	10 KVA Osaka	"	"

68	01 - 83 IIB1 - 3	"	"	"	"
69	01 - 83 IIB1 - 4	"	"	"	"
70	01 - 83 IIB1 - 5	"	30 KVA Osaka	"	"
71	01 - 83 IIB1 - 6	"	50 KVA	"	"
72	01 - 83 IIB1 - 7	"	"	"	"
73	01 - 83 IIB1 - 8	"	"	"	"
74	01 - 83 IIB1 - 9	"	10 KVA Osaka	"	"
75	01 - 83 IIB1 - 10	"	20 KVA Osaka	"	"
76	01 - 83 IIB1 - 11	"	50 KVA Osaka	"	"
77	01 - 83 IIB1 - 12	"	"	"	"
78	01 - 83 IIB1 - 13	"	"	"	"
79	01 - 83 IIB1 - 14	"	"	"	"
80	01 - 83 IIB1 - 15	"	30 KVA	"	"
81	01 - 83 IIB1 - 16	"	"	"	"
82	01 - 83 IIB1 - 17	"	50 KVA	"	"
83	01 - 83 IIB2 - 1	Switch board	100A Indoor	"	"

Confirmed
Aichi Mil. Govt.
RJM

775013

Inventory Number	Type of Item	Operating dimension serial and/or model	Purpose for which item is being used	Number and date of permit under which item of equipment is operating
84 01 - 83 IIIC2 - 20 ✓	Crane	3 ton	Machine fitting	MG 308 Dec. 18, 1945
85 01 - 83 IIIC2 - 23 ✓	"	5 ton	"	"
86 01 - 83 IIIC2 - 31 ✓	"	"	"	"
87 01 - 83 IIIC2 - 35 ✓	"	"	"	"
88 01 - 83 IIIC2 - 17 ✓	"	3 ton	"	"
89 01 - 83 IIIC2 - 11 ✓	"	5 ton	"	"
90 01 - 83 IIIC2 - 3 ✓	"	"	"	"
91 01 - 83 IIIC2 - 25 ✓	Crane	1 ton	"	"
92 01 - 83 IIIC2 - 26 ✓	"	"	"	"
93 01 - 83 IIIC2 - 27 ✓	"	"	"	"
94 01 - 83 IIIC2 - 30 ✓	"	"	"	"
95 01 - 83 IIIC2 - 32 ✓	"	"	"	"
96 01 - 83 IIIC2 - 33 ✓	"	"	"	"

775013

90	01 - 83 IIIC2 - 3 ✓	"	"	"	"	"
91	01 - 83 IIIC2 - 25 ✓	Crane	1 ton	"	"	"
92	01 - 83 IIIC2 - 26 ✓	"	"	"	"	"
93	01 - 83 IIIC2 - 27 ✓	"	"	"	"	"
94	01 - 83 IIIC2 - 30 ✓	"	"	"	"	"
95	01 - 83 IIIC2 - 32 ✓	"	"	"	"	"
96	01 - 83 IIIC2 - 33 ✓	"	"	"	"	"
97	01 - 83 IIIC2 - 36 ✓	"	"	"	"	"
98	01 - 83 IIIC2 - 37 ✓	"	"	"	"	"
99	01 - 83 IIIC2 - 38 ✓	"	"	"	"	"
100	01 - 83 IIIC2 - 39 ✓	"	"	"	"	"
101	01 - 83 IIIC2 - 4 ✓	Jib Crane	"	"	"	"
102	01 - 83 IIIC2 - 5 ✓	"	"	"	"	"
103	01 - 83 IIIC2 - 6 ✓	"	"	"	"	"
104	01 - 83 IIIC2 - 8 ✓	"	"	"	"	"
105	01 - 83 IIIC2 - 9 ✓	"	"	"	"	"

Confirmed
Alchi Mil. Govt.
RJM

Inventory Number	Type of Item	Operating dimension Serial and/or model	Purpose for which item is being used	Number and date of permit under which item of equipment is operating
106 01 - 83 IIIC2 - 10 ✓	Jib Crane	1 ton	Machine fitting	MG 308 Dec. 18, 1945
107 01 - 83 IIIC2 - 14 ✓	"	"	"	"
108 01 - 83 IIIC2 - 15 ✓	"	"	"	"
109 01 - 83 IIIC2 - 16 ✓	"	"	"	"
110 01 - 83 IIIC2 - 18 ✓	"	"	"	"
111 01 - 83 IIIC2 - 19 ✓	"	"	"	"
112 01 - 83 IIIC2 - 21 ✓	"	"	"	"
113 01 - 83 IIIC2 - 22 ✓	"	"	"	"
114 01 - 83 IIIC2 - 34 ✓	"	"	"	"

111 01 - 83
IIIC2 - 19 ✓

112 01 - 83
IIIC2 - 21 ✓

113 01 - 83
IIIC2 - 22 ✓

114 01 - 83
IIIC2 - 34 ✓

" " " "
" " " "
" " " "
" " " "

Confirmed
Aichi Mil. Govt.
RJM

775013

List of Items of Equipment in Authorized Use

Kanida Plant

Inventory Number	Type of Item	Operating dimensions serial and/or model	Purpose for which item is being used	Number and date of permit under which item of equipment is operating
115 01-83 1A1-1 ✓	Oil Groover	Table feed 203 mm	Machine fittings	MG 308 Dec. 18, 1945
116 01-83 1A3-10 ✓	Upright Drill	Drilling capacity cast iron 22mm	do	do
117 01-83 1A3-24 ✓	do	do	do	do
118 01-83 1A5-2 ✓	Special tool and cutter grinding	Grinding wheel 356 x 50	do	do
119 01-83 1A5-5 ✓	do	do	do	do
120 01-83 1A5-7 ✓	Universal tool and cutter grinding	Dia. of work 203 Between center 610	do	do
121 01-83 1A5-13 ✓	External grinding	Dia. of work 300mm Between center 1000mm	do	do
122 01-83 1A5-17 ✓	do	Dia. of work 400mm Between center 1600mm	do	do
123 01-83 1A6-1 ✓	Lathe Engine Standard	Swing 362mm Between center 755	do	do
124 01-83 1A6-2 ✓	do	do	do	do
125 01-83 1A6-3 ✓	do	do	do	do

120	01-83 1A5-7 ✓	Universal tool and cutter grinding	Dia. of work 203 Between center 610	do	do
121	01-83 1A5-13 ✓	External grinding	Dia. of work 300mm Between center 1000mm	do	do
122	01-83 1A5-17 ✓	do	Dia. of work 400mm Between center 1600mm	do	do
123	01-83 1A6-1 ✓	Lathe Engine Standard	Swing 362mm Between center 755	do	do
124	01-83 1A6-2 ✓	do	do	do	do
125	01-83 1A6-3 ✓	do	do	do	do
126	01-83 1A6-4 ✓	do	do	do	do
127	01-83 1A6-5 ✓	do	do	do	do
128	01-83 1A6-6 ✓	do	do	do	do
129	01-83 1A6-7 ✓	do	do	do	do
130	01-83 1A6-8 ✓	do	do	do	do
131	01-83 1A6-9 ✓	do	do	do	do
132	01-83 1A6-10 ✓	do	do	do	do

Confirmed
Aichi Mil. Govt.
RJM

775013

Inventory Number	Type of Item	Operating dimensions serial and/or model	Purpose for which item is being used	Number and date of permit under which item of equipment is operating
133 01-83 1A6-11 ✓	Lathe Engine Standard	Swing 630 mm Between center 2,000 mm	Machine fitting	MG 308 Dec. 18, 1945
134 01-83 1A6-12 ✓	do	do	do	do
135 01-83 1A6-15 ✓	Lathe Engine Standard	Swing 432 Between center 1,230 mm	do	do
136 01-83 1A6-16 ✓	do	do	do	do
137 01-83 1A6-17 ✓	do	do	do	do
138 01-83 1A6-18 ✓	do	do	do	do
139 01-83 1A6-19 ✓	do	do	do	do
140 01-83 1A6-110 ✓	Lathe Engine Standard	Swing 320	do	do
141 01-83 1A6-112 ✓	do	Swing 622 Between center 1750 mm	do	do
142 01-83 1A6-124 ✓	Turret Lathe Ram type	Bar dia. 25 mm	do	do
143 01-83 1A7-1 ✓	Horizontal Milling	Table travel 710x150x370 mm	do	do
144 01-83 1A7-2 ✓	do	do	do	do
145 01-83 1A7-3 ✓	Horizontal Milling	Table travel 460x117x295	do	do
146 01-83 1A7-17 ✓	Vertical Milling	Table travel 710x300x360 mm		

140	01-83 1A6-110	Lathe Engine Standard	Swing 320	do	do
141	01-83 1A6-112	do	Swing 622 Between center 1750 mm	do	do
142	01-83 1A6-124	Turret Lathe Ram type	Bar dia. 25 mm	do	do
143	01-83 1A7-1	Horizontal Milling	Table travel 710x150x370 mm	do	do
144	01-83 1A7-2	do	do	do	do
145	01-83 1A7-3	Horizontal Milling	Table travel 460x117x295	do	do
146	01-83 1A7-17	Vertical Milling	Table travel 710x300x360mm	do	do
147	01-83 1A8-9	Planer	Table size 890 x 4060 mm	do	do
148	01-83 1A8-10	"	Table size 1120 x 4000mm	do	do
149	01-83 1A8-11	"	Table size 2200 x 6500mm	do	do
150	01-83 1A9-2	Honning and Lepping	Drilling capacity 25 mm	do	do
151	01-83 1A9-4	Hack-saw	Max. dia. of work 200 x 230 mm	do	do
152	01-83 1A9-10	Slotter	Max. stroke 266 mm	do	do
153	01-83 1A9-13	Shaper	Max. stroke 610 mm	do	do
154	01-83 1A9-19	do	Max. stroke 405 mm	do	do
155	01-83 1A9-20	do	do	do	do
156	01-83 1A9-21	do	do	do	do

Confirmed
Aichi Mil. Govt.
RAM

Non Inventory Number	Type of Item	Operating dimension Serial and/or model	Purpose for which item is being used	Number and date of permit under which item of equipment is operating
----------------------	--------------	---	--------------------------------------	--

157	01 - 83 ✓ IIIB2 - 2	Centrifugal pump	3 HP	Machine fittings	MG 308 Dec. 18, 1945
-----	------------------------	------------------	------	------------------	----------------------------

The 157 reparations items of equipment listed on these 10 pages and the 4 B miscellaneous reparations items of equipment listed on page 11 have been reviewed and approved by Aichi Mil. Govt. for authorized use. Items of equipment other than those listed are not authorized for use.

Confirmed
Aichi Mil. Govt.
RJM

RJM
1st Lt. Inf

I have seen
Med. Look for authorized use. See
equipment other than those listed are not
authorized for use.

RJM let H by

Okuma Kogyo Kabushiki Kaisha,
Kamidada Plant

List of Items of Equipment in Authorized Use

No.	Non-Inventory No.	Type of Item	Operating dimensions, serial and/or model	Purpose for which item is being used	No. and date of permit under which item of equipment is operating
158	01-83-12 ✓	Surface Plate	660 x 550 x 110mm	Machine fittings	MG No.308 Dec. 13, 1946
159	01-83-13 ✓	"	"	"	"
160	01-83-14 ✓	"	860 x 720 x 140mm	"	"
161	01-83-15 ✓	"	"	"	"
162	01-83-16 ✓	"	"	"	"
163	01-83-18 ✓	"	"	"	"
164	01-83-19 ✓	"	"	"	"
165	01-83-20 ✓	"	660 x 560 x 110mm	"	"
166	01-83-27 ✓	"	560 x 410 x 65mm	"	"
167	01-83-28 ✓	"	"	"	"
168	01-83-29 ✓	"	"	"	"
169	01-83-30 ✓	"	760 x 350 x 75mm	"	"
170	01-83-39 ✓	"	550 x 265 x 70mm	"	"
171	01-83-57 ✓	"	3650x1500 x 200mm	"	"
172	01-83-58 ✓	"	"	"	"
173	01-83-59 ✓	"	2460x1240 x 250mm	"	"
174	01-83-74 ✓	Vise	130 mm	"	"
175	01-83-83 ✓	"	"	"	"
176	01-83-86 ✓	"	"	"	"
177	01-83-97 ✓	"	"	"	"
178	01-83-100 ✓	"	"	"	"
179	01-83-108 ✓	"	"	"	"
180	01-83-110 ✓	"	"	"	"
181	01-83-145 ✓	"	"	"	"
182	01-83-148 ✓	"	"	"	"
183	01-83-155 ✓	"	"	"	"

File

OKUMA DEVELOPMENT CO., LTD.
27 Niashin, Tsuji-machi, Kita-ku,
Nagoya

June 16, 1948

Subject: Application for Permission to Erect New Transformer
Substation in our Kamiida Plant

Thru : Aichi Prefectural Governor

To : Aichi Military Government Team

We are glad to apply for permission to erect, as shown in
the accompanying blueprint, New Transformer Substation on the
south-west corner of our Kamiida Plant for the following reasons.

Reasons for making application:

The former Transformer Substation in the plant had been
burnt down by bombing. And now, by an impromptu power-trans-
mission cable, the electric current is supplied to us to maintain
the reparations machinery & equipments, and to work in permitted
items. We think such condition is apt to entail serious dangers,
so we wish to have a well equipped Transformer Substation.

*OK
Without
Aichi M.G.
Per comms M. George
25 June 48*

Okuma Development Co., Ltd.
Kamiida Plant

Tsunichi Yokoyama
Tsunichi Yokoyama
Plant Manager

変電室一般図

GENERAL VIEW OF TRANSFORMER STATION



18.00

PLAIN VIEW

敷地境界線

Boundary Line

床コンクリート
1/3メートル厚
地盤面に引上

Concrete floor with
mortar, about 1/3
meter high from G.L.

12.00

18.00

18.00

0.00 0.00

12.00

図
NO
1
2
3
4
5
6
7
8

NO	建築物別名	面積	用途	費用
1	工場	300.00	9 便所	6.60
2	工場	300.00	10 衛生室	8.00
3	工場	300.00	11 便所	6.60
4	工場	300.00	12 便所	6.60
5	工場	300.00		
6	工場	300.00		
7	工場	300.00	噴霧	2007.80
8	工場	120.00	A 変電室	9.00
敷地		2902.02 m ²	(878014)	

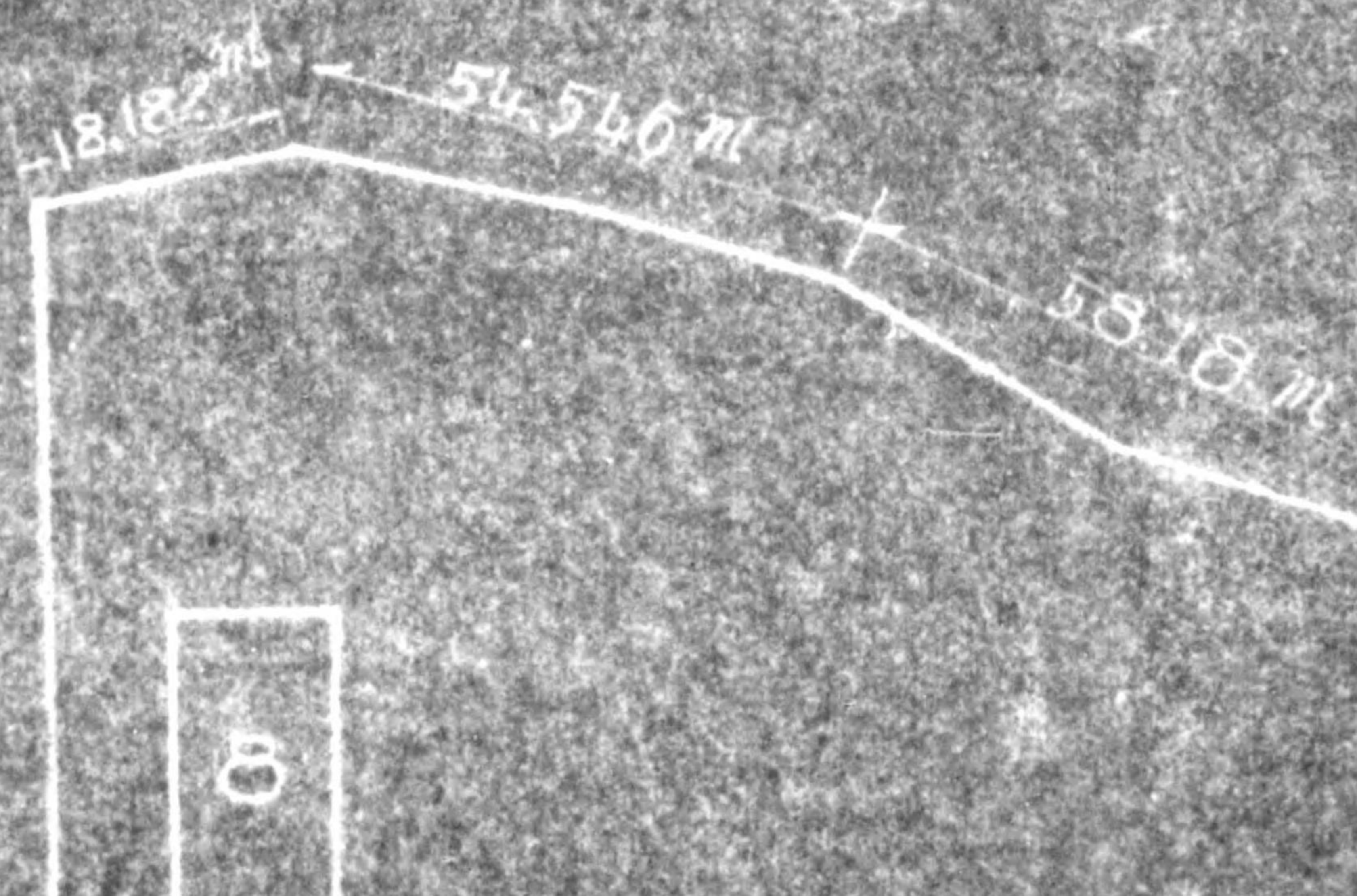
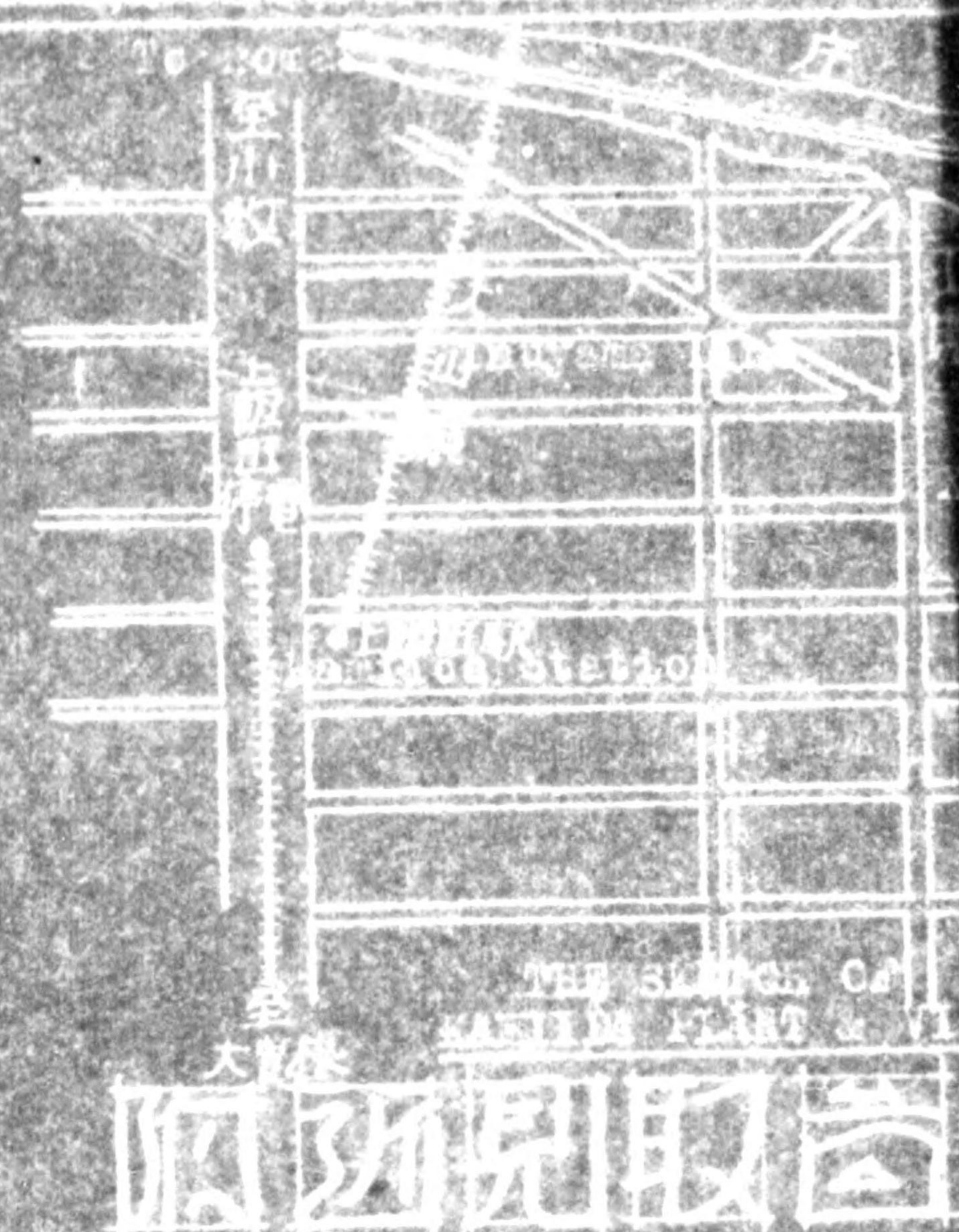
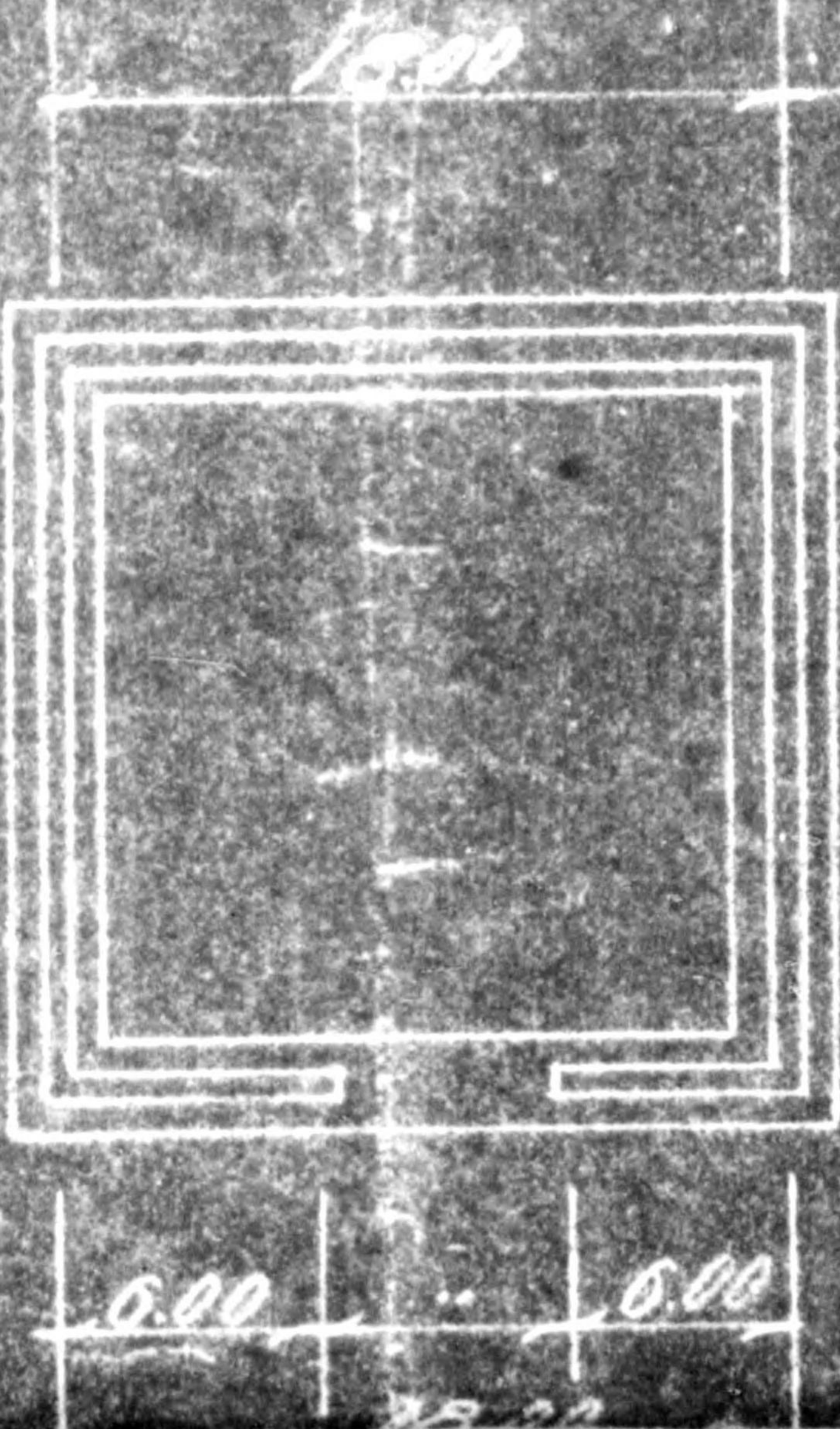

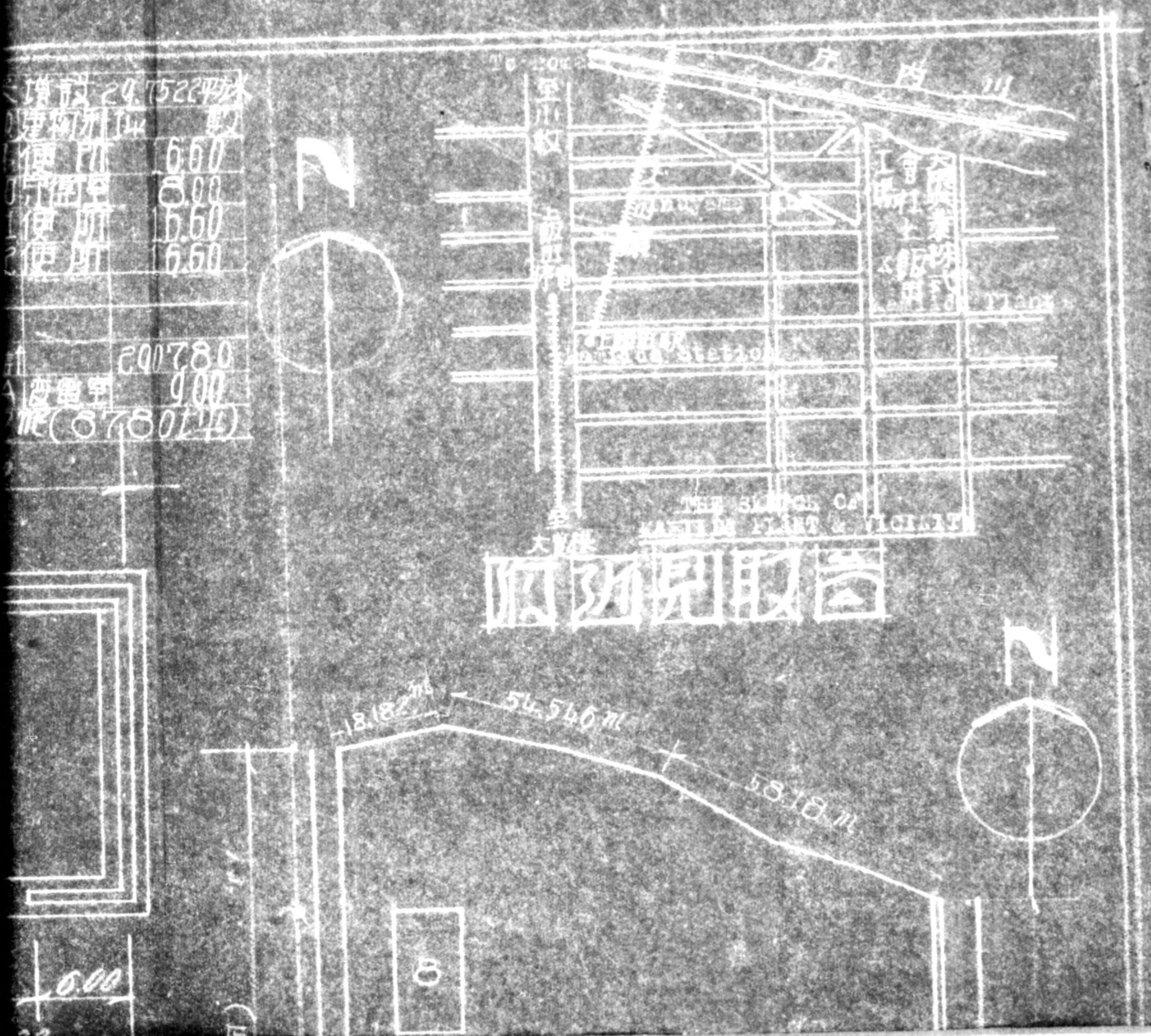



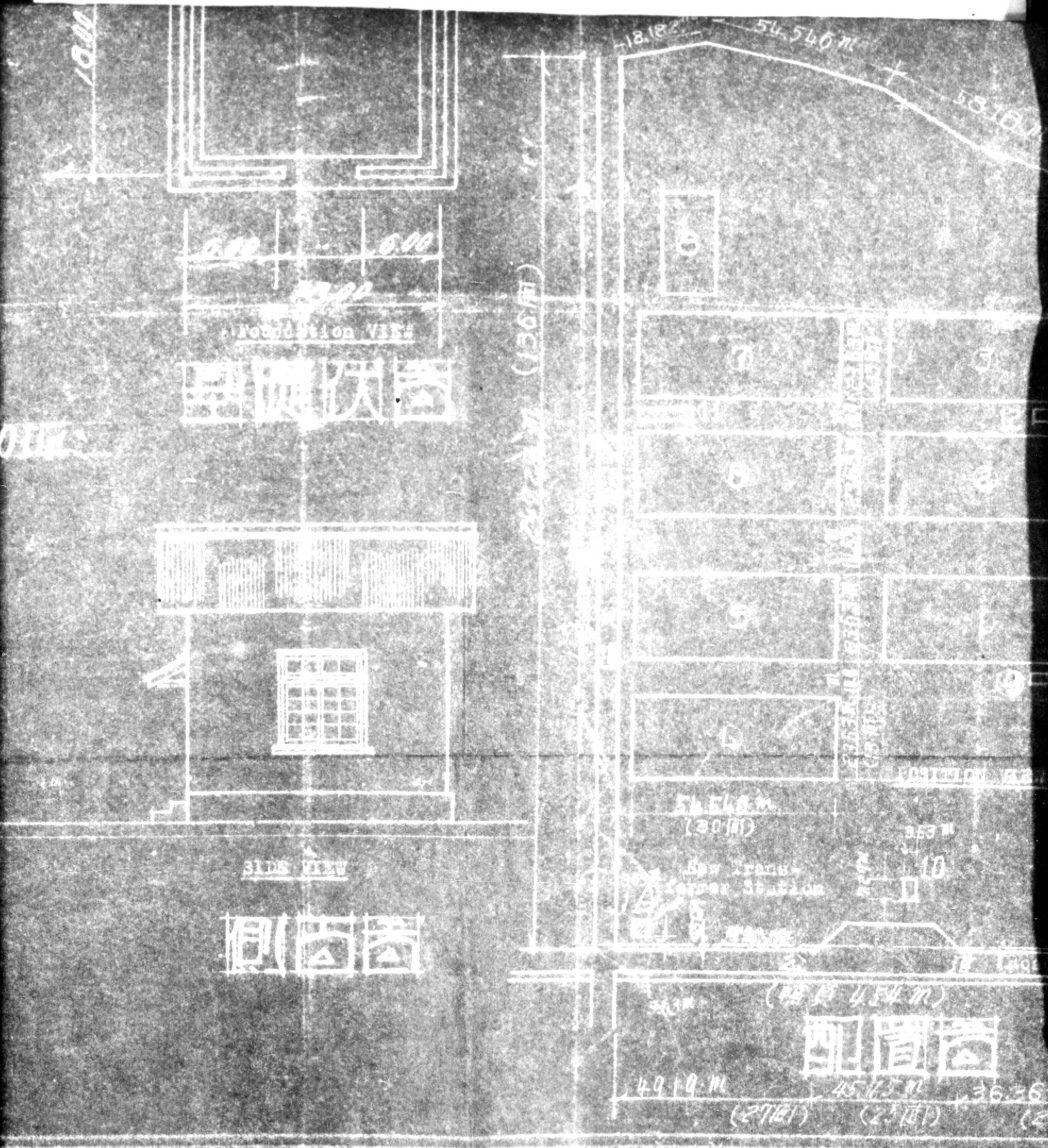

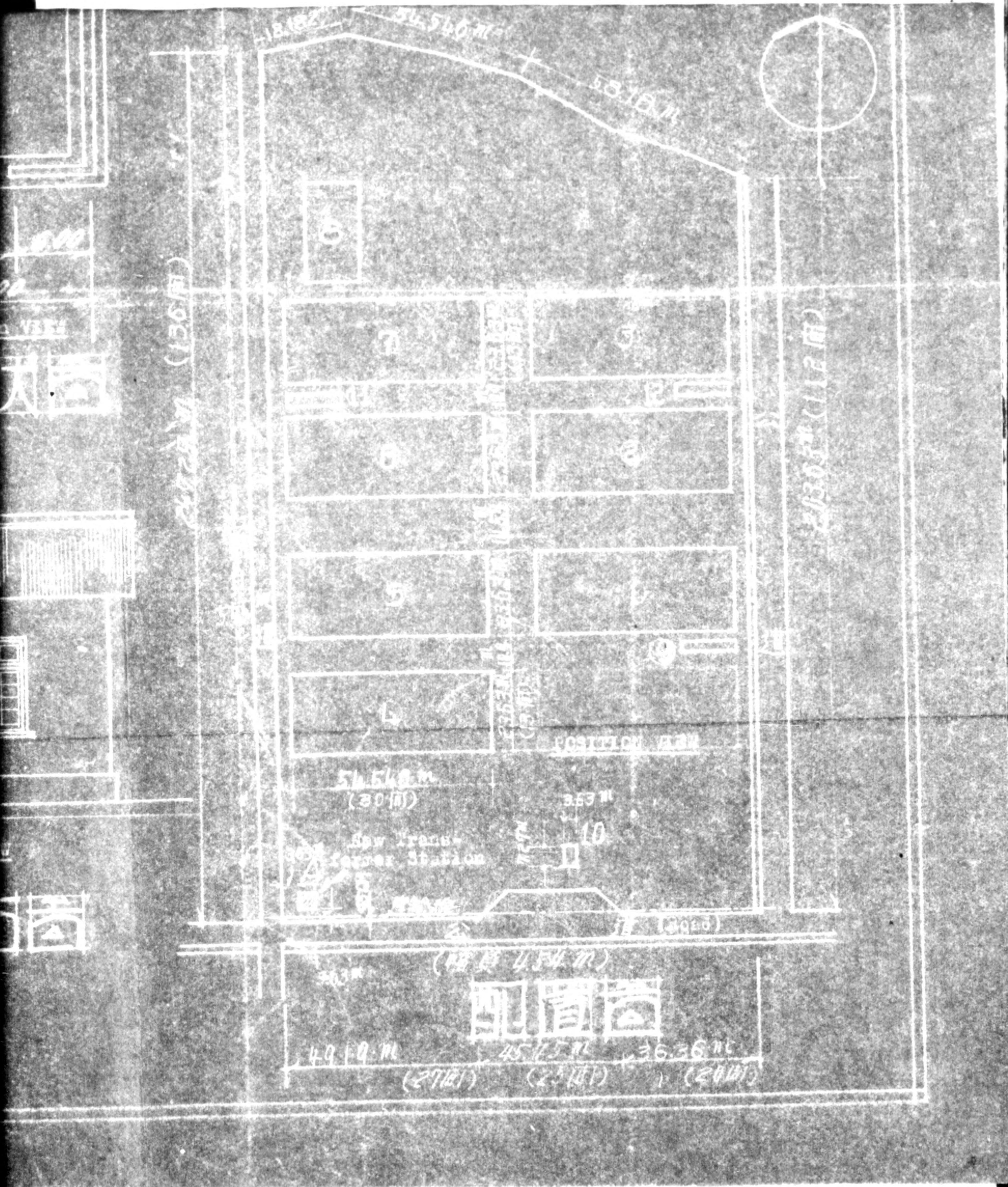

Annex No. 3

Report of Production

may '47

1. Name of Plant:

Okuma Development Co., Ltd. — Kamida Factory

2. Address:

500 Nishi-tenjinmae, Kamida-cho, Kita-ku,
Nagoya

3. Items permitted to produce:

- a) Looms.
- b) Netting machines.
- c) Machine fittings.

4. Items produced in May.

Nothing.

Annex No. 3

Report of Production

1. Name of Plant:

Okuma Development Co., Ltd. — Kamiide Factory

2. Address:

500 Nishi-tenjinmachi, Kamiide-cho, Kita-ku,
Nagoya

3. Items permitted to produce:

- a) Looms.
- b) Netting machines.
- c) Machine fittings.

4. Items produced in April.

Nothing.

775013

A

EVALUATION LIST OF
 PLANTS MANUFACTURING MACHINE TOOLS
 Okuma Development Co., Ltd.
 Kamiida Plant.

<u>A. Machine Tools</u>	No. of Machines	Price at 1939.
1. Boring Machines	7	¥ 90,540.
2. Boreing Machines		
3. Drilling Machines	27	58,942.
4. Gear Cutting Machines	6	85,062.
5. Grinding Machines	29	309,107.
6. Lathes	126	446,370.
7. Milling Machines	23	256,094.
8. Planers	11	235,298.
9. Shapers and Slotters	13	69,646.
10. Saw	5	4,955.
11. Miscellaneous	7	19,384.
 <u>B. Other Metal Working Machines</u>		
1. Punching and Shearing Machines	1	1,420.
2. Sheet Forming Presses		
3. Forging Presses		
4. Steam Hammers		
5. Pneumatic Hammers		
6. Mechanical Hammers		
7. Miscellaneous		
 <u>C. Miscellaneous Equipment</u>		
1. Foundry		
a. Electric Cupolas		
b. Other Cupolas		
2. Heat Treating Equipment		
a. Electric Furnaces	6	50,139.
b. Boilers		
c. Other Furnaces	5	11,718.
3. Auxiliaries		
a. Compressor		
b. Cranes	42	125,585.
c. Hoist		

1. Punching and Shearing Machines		1,420.
2. Sheet Forming Presses		
3. Forging Presses		
4. Steam Hammers		
5. Pneumatic Hammers		
6. Mechanical Hammers		
7. Miscellaneous		
C. Miscellaneous Equipment		
1. Foundry		
a. Electric Cupolas		
b. Other Cupolas		
2. Heat Treating Equipment		
a. Electric Furnaces	6	50,139.
b. Boilers		
c. Other Furnaces	5	11,718.
3. Auxiliaries		
a. Compressor		
b. Cranes	42	125,585.
c. Hoist		
d. Miscellaneous		
4. Power Supply		
a. Motors	5	2,261.
b. Trans Formers	17	8,756
c. Switch Board	1	2,064.
D. Other Removable Equipment		
1. Pumps Blowers		
2. Testing Machines	2	4,049.
E. Non-Removable Equipment (Machine Setting Cost)		201,319.
F. Buildings		912,811
G. Land		212,959.
H. Special Value Estimated To Whole Plant		466,272.
I. Value Of Plant As A Whole		3,574,751.

NOTE

- E. A-Machine Tools are 5% of evaluated prices B.C. & D. (exclusive of testing machine) are 20%
 But 1-Bed grinder and 1-Large planer are 50 percent of evaluated prices.
- F. Inclusive of Building and attached equipment.
- G. Inclusive of Land and attached equipment.
- H. 15 % is added to total evaluated prices on the following conditions.
1. Arrangements of Machines and equipments are reasonable.
 2. Shop Buildings and their arrangement are good.
 3. Machines and equipments are in good repair.
 4. Transportation of their productions is convenient.

Corrected Inventory Form

**INVENTORY FORM FOR MACHINE TOOL AND
BALL AND ROLLER BEARING PLANTS**

DATE 12 May 1947

Name of Company Okuma Kogyo K.K.

Related SCAPIN # 1133

Name of Plant Kamida Plant

Code # 01-83

ADDRESS 500 Nishi Tenjin-mae, Kamida-cho, Kita-ku, Nagoya

Number Talled

1. METAL WORKING MACHINES

246

A. MACHINE TOOLS

243

- 1. Boring machines 7
- 2. Broaching machines 0
- 3. Drilling machines 37
- 4. Gear cutting and finishing machines 5
- 5. Grinding machines 26
- 6. Lathes 124
- 7. Milling machines 21
- 8. Planers 11
- 9. Miscellaneous machine tools 22

B. SECONDARY METAL FORMING AND SHAPING MACHINES AND EQUIPMENT

1

- 1. Bending machines 0
- 2. Hydraulic presses 0
- 3. Manual presses 0
- 4. Mechanical presses 1

775013

INVENTORY FORM FOR MACHINE TOOL AND BALL AND ROLLER BEARING PLANTS

DATE 12 May 1947

Name of Company Okuma Kogyo K.K. Related SCAPIN # 1133

Name of Plant Kanida Plant Code # 01-83

ADDRESS 500 Nishi Tenjin-mae, Kanida-cho, Kita-ku, Nagoya

Number Tallied

B. SECONDARY METAL FORMING & SHARING MACHINES & EQUIPMENT (cont'd)

- 5. Shearing and punching machines 0
- 6. Forging machinery 0
- 7. Wire forming machines 0
- 8. Miscellaneous 0
- 9. Other metal working machinery and equipment 0

C. MISCELLANEOUS METAL WORKING EQUIPMENT

- 1. Welding machines, all types 0
- 2. Testing and measuring machines, all types 2
- 3. Miscellaneous physical property testing 0
- 4. Heat treating equipment 0
- 5. Portable metal working machines 0

11. ELECTRICAL MACHINERY AND APPARATUS

A. ELECTRICAL ROTATING EQUIPMENT

- 1. Generators 0
- 2. Motors (5 HP and over) 0

775013

INVENTORY FORM FOR MACHINE TOOL AND BALL AND ROLLER BEARING PLANTS

DATE 12 May 1947

Name of Company Okuma Kogyo K.K. Related SCAPIN # 1133

Name of Plant Kamidada Plant Code # 01-83

ADDRESS 500 Nishi-tenjin-mae, Kamidada-cho, Kita-ku, Nagoya

Number Tallied

A. <u>ELECTRICAL ROTATING EQUIPMENT (cont'd)</u>		
3. Motor Generators	<u>0</u>	
4. Frequency changers	<u>0</u>	
5. Converters and inverters	<u>0</u>	
6. Generator Sets (Direct coupled to prime mover)	<u>0</u>	
B. <u>PRIMARY ELECTRIC POWER TRANSMISSION AND DISTRIBUTION EQUIPMENT</u>		<u>18</u>
1. Transformers	<u>17</u>	
2. Switch	<u>1</u>	
111. <u>GENERAL PURPOSE INDUSTRIAL MACHINERY AND EQUIPMENT</u>		<u>43</u>
A. <u>ENGINES AND TURBINES</u>		<u>0</u>
1. Steam Engines	<u>0</u>	
2. Steam Turbines	<u>0</u>	
3. Internal Combustion Engines	<u>0</u>	
B. <u>COMPRESSORS AND PUMPS</u>		<u>1</u>
1. Compressors and Dry Vacuum Pumps	<u>0</u>	
2. Pumps	<u>1</u>	
C. <u>MISCELLANEOUS MACHINERY AND EQUIPMENT</u>		<u>42</u>
1. Power Boilers	<u>0</u>	
2. Cranes	<u>42</u>	

HEADQUARTERS
AICHI MILITARY GOVERNMENT TEAM
APO 710 U. S. ARMY

EFJ/ek

22 May 1947

SUBJECT: Release of Land and Buildings from
Reparations Custody

THRU : The Japanese Liaison Office, Nagoya

TO : Toyo Somo Kogyo Kabushiki Kaisha
4 Yakushi, Tsuji-machi, Kita-ku, Nagoya

1. You are hereby notified that the land and buildings of the Kamida Factory of Okuma Development Co. which are not required for custody and control of reparations equipment is released to the Home Ministry for return to the rightful owner.

FOR THE COMMANDING OFFICER:

ROBERT W. HUTCHINSON
Capt CIP
Adjutant

*Release voided 2 May 49
R F Jordan*

HEADQUARTERS
AICHI MILITARY GOVERNMENT TEAM
APO 710 U. S. ARMY

EFJ/ek

22 May 1947

SUBJECT: Release of Land and Buildings from
Reparations Custody

TO : The Japanese Liaison Office, Nagoya

1. You are hereby notified that the land and buildings of the Kamiida Factory of Okuma Development Co. which are not required for custody and control of reparations equipment is released to the Home Ministry for return to the rightful owner.

FOR THE COMMANDING OFFICER:

ROBERT W. HUTCHINSON
Capt GMP
Adjutant

Release voided 7 March 49
E F Jonard

HEADQUARTERS
AICHI MILITARY GOVERNMENT TEAM
APO 710 U. S. ARMY

5 May 1947

SUBJECT: Release of Land and Buildings from Reparations
Custody

TO : Commanding Officer, Tokai-Hokuriku
Military Government Region, APO 710

1. Transmitted herewith in quintuplicate is an application from the Toyo Somo Kogyo K.K. for the release of land and buildings of the OD-5 (01-83) Kamiida plant of Okuma Development Co., Ltd.

2. The areas to be released will be separated from the areas containing reparations machinery by a fence, maintaining the strict custody of the plant.

3. Inasmuch as the proper custody and maintenance of the reparations machinery will not be affected and inasmuch as this area is not a military installation or an object of procurement this headquarters recommends approval of this application.

FOR THE COMMANDING OFFICER:

1 Incl:
1 Application
(5 copies)

Robert W. Hutcheson
ROBERT W. HUTCHESON
Capt CMP
Adjutant

417
APG 82

775013

BASIC: Ltr, Hq Aichi Mil Govt Team, subj: "Release of Land and Buildings from Reparations Custody", dtd 5 May 47

1st Ind

GNM/ss

Hq Tokai-Hokuriku Mil Govt Region, APO 710, 6 May 47

TO: CG, I Corps, APO 301
(ATTN: Mil Govt Section)

Recommend that the land and buildings, of this machine tools plant, not required for custody and control of machines on reparation be released to the Home Ministry for return to it's rightful owner.

FOR THE COMMANDING OFFICER:

Frank M. Wilkins

FRANK M. WILKINS
Maj FA
Adjutant

B-116
HQ. I CORPS
AG. 602

1 Incl:
n/c
lcc w/d

45929

417

BASIC: Ltr, Hq Aichi Mil Govt Team, subj: "Release of Land and Buildings from Reparations Custody", dtd 5 May 1947.

AG 602 - BA

2nd Ind

EHN/ay

Hq I Corps, APO 301, 9 MAY 1947

TO: CG, Eighth Army, API 343

3514

1. Under authority of paragraph 2d, section III, Operational Directive No. 5/5, Headquarters Eighth Army, dated 24 September 1946, this headquarters is authorized to release to the Japanese Home Ministry, all land and buildings of aircraft plants, privately-owned munitions plants, and military arsenals, which are not required for custody and control of reparations equipment. This authority does not extend to machine tool plants which have been selected for reparations removal.

2. The Okuma Development Company, is requesting release of land and buildings of the Kamiida Plant (01-83, Machine Tool) which are not required for custody and maintenance of equipment subject to reparations. The area is segregated from the portion of the plant in which reparations equipment is stored. It is recommended that the inclosed application be given favorable consideration.

FOR THE COMMANDING GENERAL:

H. B. Taylor
H. B. TAYLOR
MAJOR, A.S.D.
ASST. ADJ. GEN.

1 Incl:
1 copy w/d

775013

g

Ltr. Hq Aichi Mil Govt Team, subj: "Release of Land and Buildings from Reparations Custody", dated 5 May 47.

AG 602 (MG-Em)

3rd Ind

14 MAY 1947

Headquarters Eighth Army, APO 343

TO: Commanding General, I Corps, APO 301

The release of the lands and buildings of the Kamiida Plant (01-83) of the Okuma Development Company, not required for custody and maintenance of reparation machines, to the Japanese Home Ministry, to be returned to rightful owner is approved.

BY COMMAND OF LIEUTENANT GENERAL EICHELBERGER:

8

1 Incl:
1 copy w/d

R. Schaffer
R. SCHAFER
Lt. Col., AGC
Asst. Adjutant General.

B-119
HQ. I CORPS
AG 602

AG 602 - BA

4th Ind

EHN/jyn

Hq I Corps, APO 301, 16 MAY 1947

TO: CO, Tokai-Hokuriku Mil Govt Region, APO 710

Your attention is directed to 3rd indorsement.

BY COMMAND OF MAJOR GENERAL WOODRUFF:

1 Incl:
n/c

H.B. Taylor
H. B. TAYLOR
MAJOR, A.B.D.
ASST. ADJ. GEN.

46943

1250

BASIC: Ltr, Hq Aichi Mil Govt Team, subj: "Release of Land
and Buildings from Reparations Custody", dated 5 May 47

5th Ind

GNM/ss

Hq Tokai-Hokuriku Mil Govt Region, APO 710, 19 May 47

TO: CO, Aichi Mil Govt Team, APO 710

Your attention is directed to the 3rd indorsement.

BY ORDER OF COLONEL BURNELL:

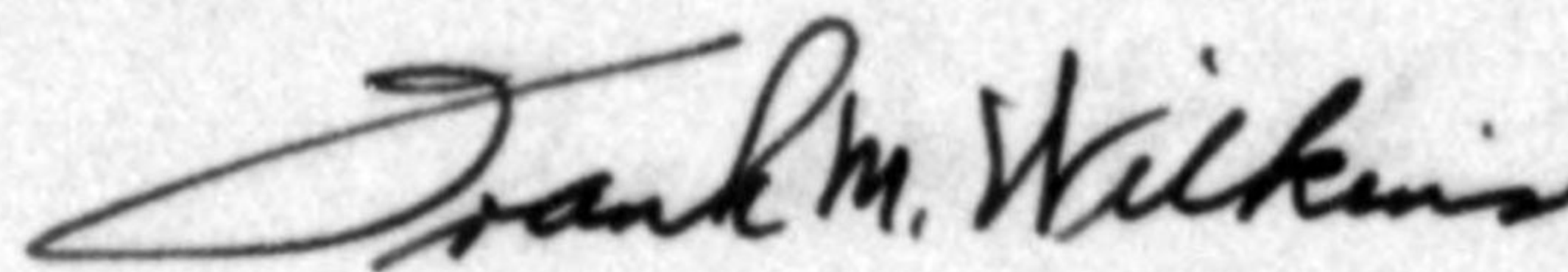

FRANK M. WILKINS
Maj FA
Adjutant

1 Incl:
n/c

08591

MAY 20 1947

1250

TOYO SOMO KOGYO KABUSHIKI KAISHA

4 Yakushi, Tsuji-machi,
Kita-ku, Nagoya.

April 21, 1947

To : Aichi Military Government Team

Through: Aichi Prefectural Government
Japanese Liaison Office, Nagoya

Subject: Petition for permission to employ part of the Okuma
Development Co., Ltd. -- Kamiida Factory as our
netting workshop.

We had chiefly made knotless fishing nets which had many points more excellent and stronger than ordinary knotted fishing ones, but unfortunately our shops were all burnt down by bombing.

Now we are operating 4 netting machines and their accessory machines in barracks. Mass production of fishing nets, however, is seriously discussed and demanded in the public in connection with the present food problems, so we want to rebuild shops and cater for the needs of men. But under the existing condition it is very difficult for us to build a new shop because of the shortage of materials.

- A. The Okuma Development Co., Ltd. -- Kamiida Factory is situated in close proximity to our company and they have unemployed land and buildings. So far as netting work is concerned, comparatively large and perfect warehouses are necessary for it, when buildings of the Kamiida are very suitable for it.
- B. The Okuma not only produces the fishing net making machines which we employ to-day, but also has close relations with us.

Therefore we wish to employ part of the Kamiida as our netting workshops for the above two reasons.

We appreciate it very much if you would be kind enough to examine the attached documents thoroughly and to release part of the land and buildings of the Kamiida from reparations custody through your special consideration.

Though the Okuma Development Co., Ltd. -- Kamiida Factory is now put under reparations custody, the area we want to employ is only the north-west part of it as the annexed blue-print shows.

del 3

- A. We will use none of reparations machinery at all in our netting work and consequently there are none of them in the area.
- B. Strict walls will be made hereafter between the two areas and then communication will be cut off.
- C. Netting work is not dangerous.

We are convinced that on these grounds netting work will have no influence upon the reparations machinery and equipment.

Yeichi Okuma

Yeichi Okuma
President
Toyo Somo Kogyo K.K.

Incl: Blue-print
Outline of Toyo Somo Kogyo K.K.
Outline of Okuma Development Co., Ltd. — Kamiida Factory

OKUMA KOGYO KABUSHIKI KAISHA
OKUMA DEVELOPMENT CO., LTD.

27 Nishin, Teuji-machi,
Kita-ku, Nagoya

21st April 1947

OFFICIAL ENDORSEMENT

We have no objection to loan part of the Kamiida
factory and make the Toyo Somo Kogyo Kabushiki Kaisha
employ it as their netting workshop.

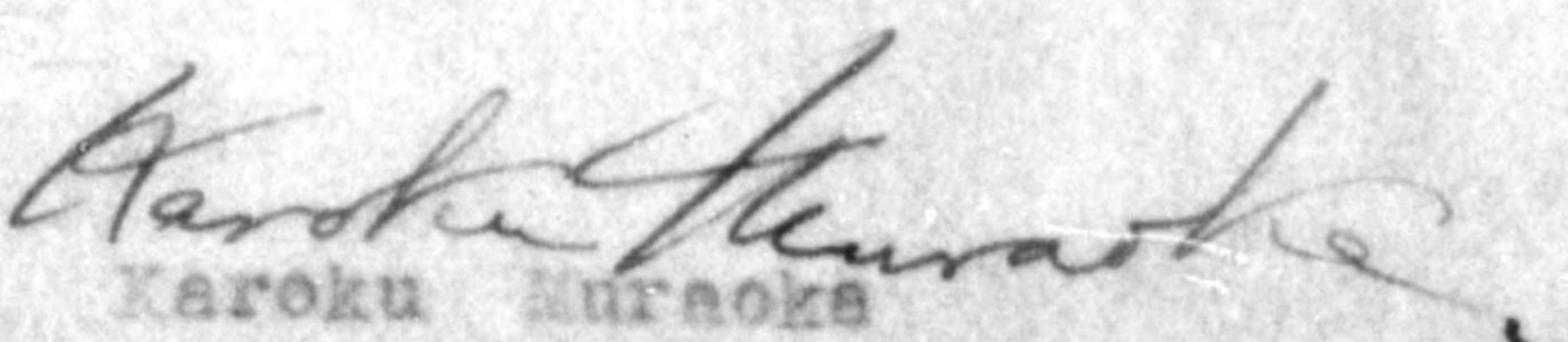
Karoku Murakami
President
Okuma Development Co., Ltd.

大隈興業株式会社 上飯田工場
OKUMA KOGYO K.K. KAMIIDA FACTORY

附近ノ景
Map of Vicinity

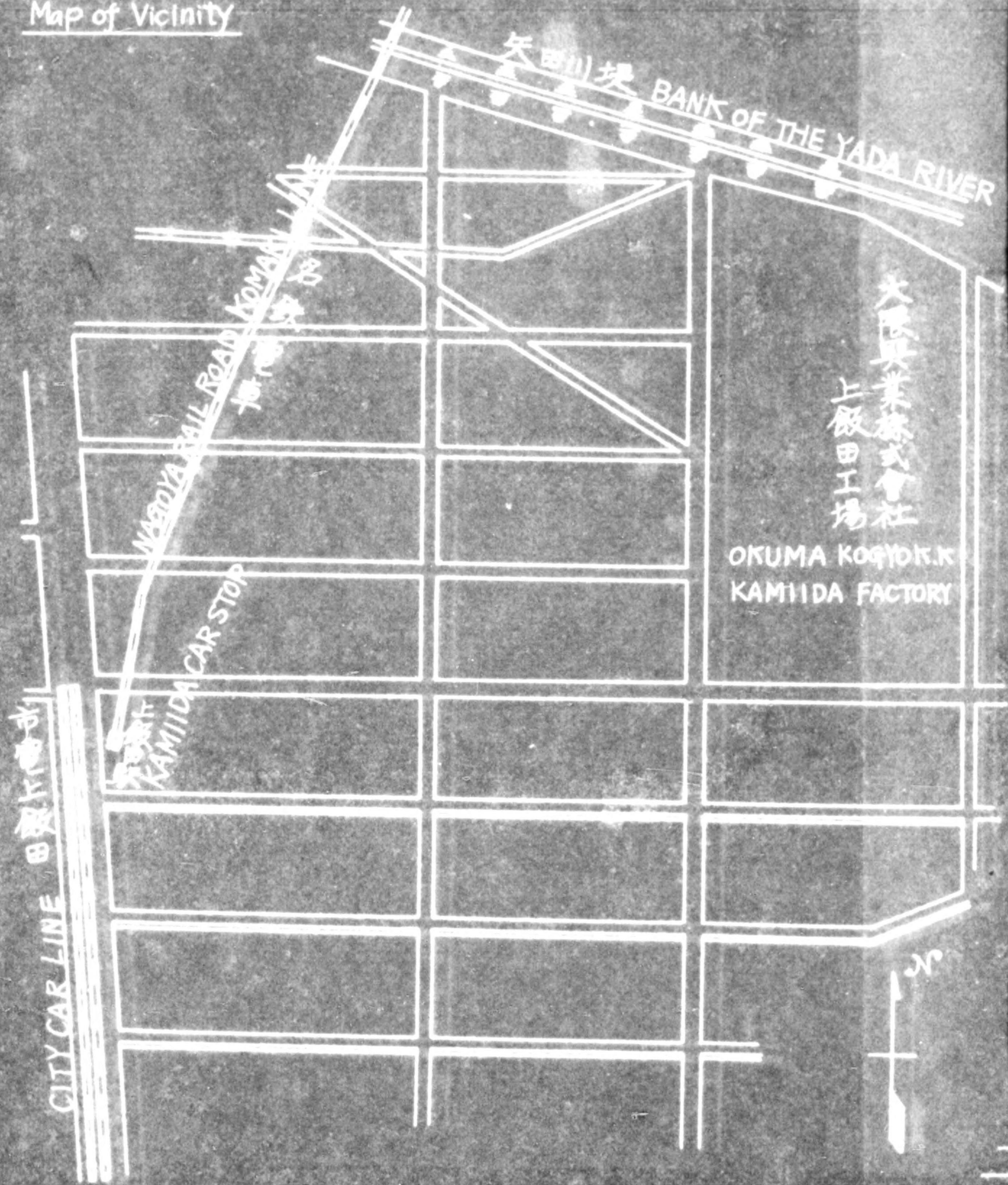

會社上飯田工場
K. KAMIIDA FACTORY

工場ノ畵

鎖線ヨリ北西部ヲ製網場ニ
使用シ南東部ヲ保全工場トシテ
保持ス

Map of Plant

The north-west of the dotted line is for the netting shops and the south-east for the custody.

BANK OF THE YADA RIVER

大隈興業株式會社
上飯田工場

OKUMA KOGYOK.K
KAMIIDA FACTORY

焼入工場
TEMPERING SHOP

8th SHOP
第八工場

4th SHOP
第四工場

7th SHOP
第七工場

3rd SHOP
第三工場

6th SHOP
第六工場

2nd SHOP
第二工場

5th SHOP
第五工場

1st SHOP
第一工場

BICYCLE YARD
自転車置場

FRONT GATE

N

Serial No. of Report

REPORT ON INDUSTRIAL FACILITIES

TO: Aichi Military Government Team

THROUGH: Jap. Liaison Office Nagoya

Toyo Somo Kogyo Kabushiki Kaisha
4 Yakushi, Tsuji-machi, Kita-ku, Nagoya
 (Name & Address of Reporting Unit)

20 April, 1947
 (Date)

1. Name of Facility: Romaji : Toyo Somo Kogyo Kabushiki Kaisha
 English: Toyo Net Making Co., Ltd.
2. Location: 4 Yakushi, Tsuji-machi, Kita-ku, Nagoya
3. Name of President: Yeichi Okuma
4. History
 - a. Date of construction : 21 February, 1936
 - b. Date of first operation: Ditto
 - c. 1936-1941 Production (Annual value in Yen; quantities of principal products by units or weight)

Knotless Net

Year	Quantity		
1936	308,900 feet	92,700 lbs.	P. P.
1937	483,000	144,900	We did only operations and Prices of products are uncertain.
1938	573,800	172,100	
1939	790,000	237,000	
1940	726,500	217,700	
1941	955,600	286,700	

- d. Present capitalization in Yen: ¥300,000 (paid-up capital)
- e. Changes made in Capital structure since 1935

Year	Nominal Capital	Paid-up Capital	Debt
1936	200,000	200,000	0
1937	"	"	0
1938	"	"	0
1939	"	"	0
1940	"	"	0
1941	"	"	0
1942	400,000	300,000	0
1943	"	"	0
1944	"	"	0
1945	"	"	0
1946	"	"	0
1947	4,000,000	4,000,000	0.... (in application)

- f. Name and address of parent company: Nothing
- g. Number of shares outstanding: 8,000 (Value of each share ¥ 50)
- h. Number of stockholders (Give name of those owning 10% or more of total)
 - Number of stockholders: 12
 - Name of those owning 10% or more:

Nippon Gyomo Sengu Kabushiki Kaisha	28.7%
Okuma Kogyo Kabushiki Kaisha	27.5%
Yeichi Okuma	17.0%
Estutaro Fujino	12.5%
- i. Funds received from Government (bounties, subsidies, etc.)
 Nothing

- 2 - (Report on Industrial Facilities)

5. General Description

a. Principal Products

1. Wartime : Knotless Fishing Net.
2. At Present: Knotless Fishing Net.
3. Planned for 1947-1948: Knotless Fishing Net, Kaerumata Fishing Net, Mojiriami Fishing Net, Rope & twist and Fittings of Net.

b. Capacity (annually)

1. Wartime : Knotless Fishing Net
900,000 feet
2. At present: Knotless Fishing Net
450,000 feet
3. 1947-1948 (With unrestricted access to materials)

<u>Description</u>	<u>Quantity</u>
Knotless Net	1,440,000 feet
Kaerumata Net	2,500,000 "
Mojiriami Net	1,800,000 "
Rope & twist	150,000 lbs.
Fittings of net	Some

6. Machinery & Equipment in Plant

<u>Description</u>	<u>Capacity</u>	<u>Maker</u>	<u>Number</u>
Knotless Netting Machines	480 feet/day	Okuma Development	10
Weft Winding Machines		"	4
Twisting Machines		"	2
Doubling Machines		"	2

7. Present stocks of Raw Materials and Supplies

Cotton 16,666 lbs.

8. Present Stocks of Finished Goods

Knotless Fishing Net 2,500 lbs.

9. Present Stocks of Fuel

Nothing

- 3 - (Report on Industrial Facilities)

10. Machinery & Equipment needed for maximum production 1947-1948

<u>Description</u>	<u>Quantity</u>
Mojiriemi Netting Machines	10
Kaerumata Netting Machines	16
Twisting Machines	39

11. Raw materials & Supplies needed for 1947-1948 (annually)

a. For present capacity (5b2)

Cotton 160,000 lbs.

b. For Maximum (5b3)

Cotton 845,000 lbs.

12. Fuel needed for 1947-1948

We do not need especially.

13. Additional personnel needed (Not locally available)

<u>Special Skills</u>	<u>Number</u>
Workmen	115
Engineers	3

14. Prices (Give current selling prices in Yen of principal products)

<u>Description</u>	<u>Unit</u>	<u>Price</u>
Knotless Net	500 feet	¥1,570 (piece work wages)
Kaerumata Net	"	¥ 350 (")
Mojiriemi Net	"	¥ 300 (")

15. Remarks (Include here any factors hampering production not already mentioned and any recommendations you consider necessary)

16. Certification by reporter

I certify that the information contained herein is true to the best of my knowledge and belief. I am authorized to sign for the above company.

Signed Yeiichi Okuma

Title President

Outline of Okuma Kogyo K.K. + Kamiida Factory

Name : Okuma Kogyo Kabushiki Kaisha
 Address: 27 Nisshin, Tsuji-machi,
 Kita-ku, Nagoya.
 Date : 21 April 1947.

1. Name of Facility: Romaji : Okuma Kogyo K.K. - Kamiida Kojo
 English: Okuma Development Co., Ltd. --
 Kamiida Factory
2. Location : 500 Nishitenjinmae, Kamiida-cho, Kita-ku, Nagoya
3. Name of President or Manager: President: Karoku Mureoka

4. History:

- A. Date of construction : 29 March 1939
 B. Date of first operation: 29 March 1939
 C. 1935-1941 Production (Annual value in Yen; quantities of
 principal products by units.)

Years	Total output		Output of machine tools	
	No. of products	Annual amount	No. of products	Annual amount
1939	110	371,775	110	371,775
1940	372	1,873,485	370	1,873,389
1941	291	2,785,501	289	2,780,601

D. Present capitalization:

¥21,520,000 (Contains the unpaid and borrowed.)

E. Changes made in capital structure since 1935: On another page.

F. Name and address of parent company: None

G. Number of shares: 410,000 (Face value: ¥50,00)

H. Total number of stockholders & main holders (Owing 10% or more
 of total)

Number: 1,327

Name : Senji Kinyu Kinko

I. Fund received from Government:

Bounty for manufacture: ¥25,000 in 1940

J. Outline sketch of Plant: On the separate sheet.

5. General description:

A. Principal Products:

1. Wartime : Grinding Machines
 2. At present: Nothing.
 3. Planned for 1946-47: Nothing.

B. Capacity:

1. Wartime : Grinding machines 360 ¥9,000,000 (Annually)
 2. At present: Nothing.
 3. Planned for 1946-47: Nothing.

C. Number of Employees:

1. Wartime : 1,323 (April, 1944)
 At present: 15 Especially some 40 workers for custody.
 1946-47 : Uncertain.

6. Machinery & Equipment in Plant:

Machinery : 256

Equipment : 46

7. Present stock of Raw materials, Supplies and Unfinished Goods:

Nothing.

8. Present stocks of Finished Goods : Nothing.

9. Present stocks of Fuel : Nothing.

10. Machinery and Equipment needed for maximum production 1946-47:

Nothing.

11. Raw materials & Supplies needed (1946-47 Total):

A. For Present : Nothing.

B. For Maximum : Nothing.

12. Fuel needed (for 2 years 1946-47): Nothing.

13. Personnel needed:

for custody of reparations machinery

Engineers 2

Workers 5

Guards 11

14. Prices (Current selling prices): None.

15. Remarks:

This factory was added to the reparations list of Machine Tool Industry in August, 1946 and so the operation is now ceased and under custody.

16. Certification by applicant.

I certify that the information contained herein is true to the best of my knowledge and belief. I am authorized to sign for the above company.

Signed

Karoku Furukawa

Title

President

Changes made in capital structure since 1935

<u>Year</u>	<u>Nominal Capital</u>	<u>Paid-up Capital</u>	<u>Debt</u>
1935	2,000,000	1,250,000	297,725
1936	2,000,000	1,250,000	330,446
1937	4,000,000 (increased)	2,500,000	1,181,174
1938	10,000,000 (")	6,000,000	1,672,538
1939	10,000,000	10,000,000	1,406,670
1940	10,000,000	10,000,000	3,572,730
1941	20,000,000 (increased)	12,500,000	500,000
1942	20,500,000 (")	15,250,000	1,500,000
1943	20,500,000	15,250,000	-----
1944	20,500,000	15,250,000	6,000,000
1945	20,500,000	15,250,000	8,300,000
1946	20,500,000	15,250,000	8,270,000



Annex No. 3

Report of Production

Feb.

1. Name of plant:

Okuma Development Co., Ltd., Kamiida Factory

2. Address:

500, Nishi-tenjinmae, Kamiida-cho,

Kita-ku, Nagoya

3. Items permitted to produce:

a) Looms.

b) Netting machines

c) Machine fittings

4. Items produced in March.

Nothing.

HEADQUARTERS
AICHI MILITARY GOVERNMENT TRAM
APO 710 U. S. ARMY

EFJ/ek

5 May 1947

SUBJECT: Release of Land and Buildings from Reparations
Custody

TO : Commanding Officer, Tokai-Hokuriku
Military Government Region, APO 710

1. Transmitted herewith in quintuplicate is an application from the Toyo Seme Kagyo K.K. for the release of land and buildings of the OD-5 (01-83) Kamiida plant of Okuma Development Co., Ltd.

2. The areas to be released will be separated from the areas containing reparations machinery by a fence, maintaining the strict custody of the plant.

3. Inasmuch as the proper custody and maintenance of the reparations machinery will not be affected and inasmuch as this area is not a military installation or an object of procurement this headquarters recommends approval of this application.

FOR THE COMMANDING OFFICER:

1 Incl:
1 Application
(5 copies)

ROBERT W. HUTCHESON
Capt CMP
Adjutant

OKUMA SOMO KOGYO KABUSHIKI KAISHA

4 Yakushi, Tenji-machi,
Kita-ku, Nagoya.

April 21, 1947

To : Aichi Military Government Team

Through: Aichi Prefectural Government
Japanese Liaison Office, Nagoya

Subject: Petition for permission to employ part of the Okuma
Development Co., Ltd. --- Kamiida Factory as our
netting workshop.

We had chiefly made knotless fishing nets which had many points more excellent and stronger than ordinary knotted fishing ones, but unfortunately our shops were all burnt down by bombing.

Now we are operating 4 netting machines and their accessory machines in barracks. Mass production of fishing nets, however, is seriously discussed and demanded in the public in connection with the present food problems, so we want to rebuild shops and cater for the needs of men. But under the existing condition it is very difficult for us to build a new shop because of the shortage of materials.

- A. The Okuma Development Co., Ltd. --- Kamiida Factory is situated in close proximity to our company and they have unemployed land and buildings. So far as netting work is concerned, comparatively large and perfect warehouses are necessary for it, when buildings of the Kamiida are very suitable for it.
- B. The Okuma not only produces the fishing net making machines which we employ to-day, but also has close relations with us.

Therefore we wish to employ part of the Kamiida as our netting workshops for the above two reasons.

We appreciate it very much if you would be kind enough to examine the attached documents thoroughly and to release part of the land and buildings of the Kamiida from reparations custody through your special consideration.

Though the Okuma Development Co., Ltd. --- Kamiida Factory is now put under reparations custody, the area we want to employ is only the north-west part of it as the annexed blue-print shows.

- A. We will use none of reparations machinery at all in our netting work and consequently there are none of them in the area.
- B. Strict walls will be made hereafter between the two areas and then communication will be cut off.
- C. Netting work is not dangerous.

We are convinced that on these grounds netting work will have no influence upon the reparations machinery and equipment.

Yeichi Okuma

Yeichi Okuma
President
Toyo Somo Kogyo K.K.

Incl: Blue-print
Outline of Toyo Somo Kogyo K.K.
Outline of Okuma Development Co., Ltd. — Kamiida Factory

OKUMA KOGYO KABUSHIKI KAISHA
OKUMA DEVELOPMENT CO., LTD.

27 Nisshin, Tsuji-machi,
Kita-ku, Nagoya

21st April 1947

OFFICIAL ENDORSEMENT

We have no objection to loan part of the Kamiida
Factory and make the Toyo Somo Kogyo Kabushiki Kaisha
employ it as their netting workshop.

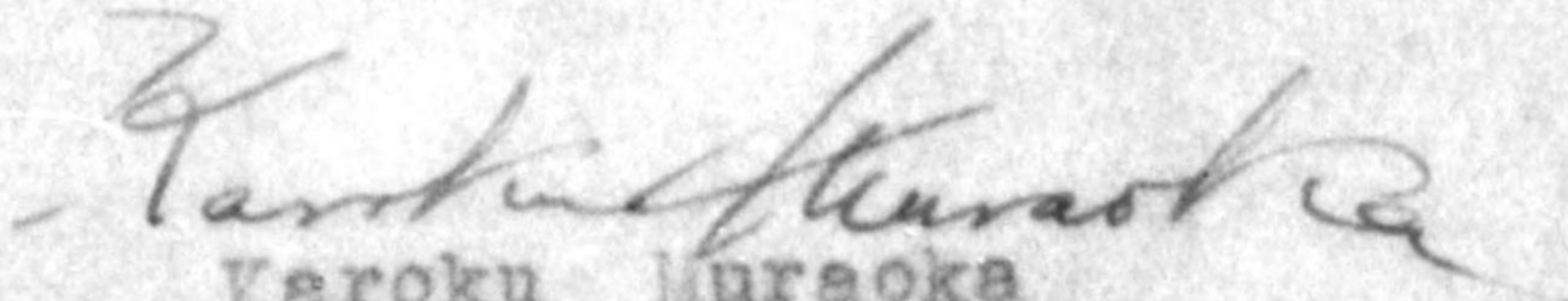
Karoku Muraoka
President
Okuma Development Co., Ltd.

Sketch of Kamida Factory

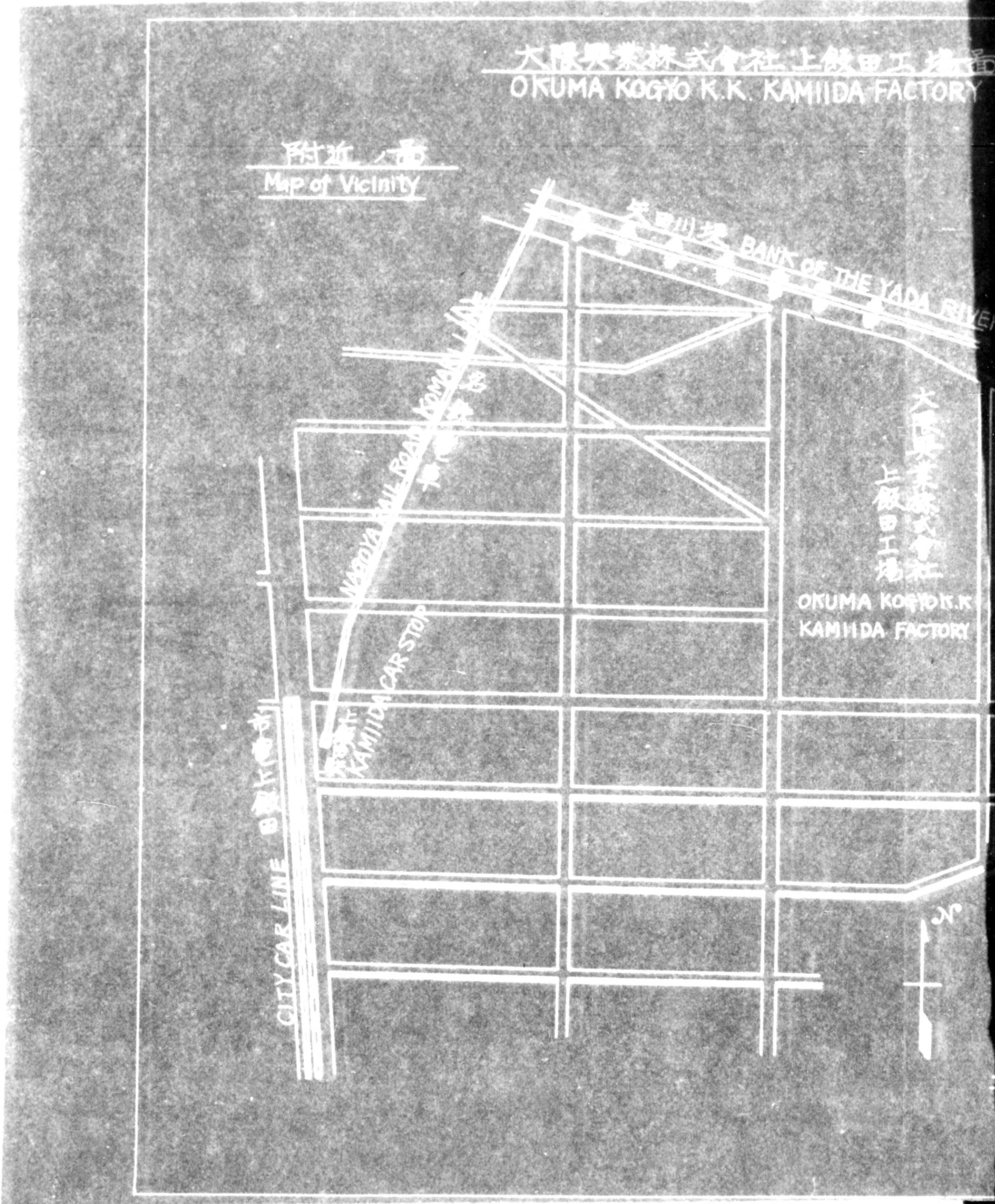

社上飯田工場市
KAMIIDA FACTORY

工場ノ面

鎖線の北西部、製網場=
使用シ南東部、保全工場トシ
保持ス

Map of plant

The north-west of the dotted line is for the netting shops and the south-east for the custody.

BANK OF THE YADA RIVER

大隈興業株式会社
上飯田工場

OKUMA KOGYO K.K.
KAMIIDA FACTORY

焼入工場
TEMPERING SHOP

8th SHOP
第八工場

4th SHOP
第四工場

WC
7th SHOP
第七工場

WC
3rd SHOP
第三工場

6th SHOP
第六工場

2nd SHOP
第二工場

5th SHOP
第五工場

WC
1st SHOP
第一工場

BICYCLE YARD
自転車置場

FRONT GATE



- 1 -

Serial No. of Report

REPORT ON INDUSTRIAL FACILITIES

TO: Aichi Military Government TeamTHROUGH: Jap. Liaison Office NagoyaToyo Somo Kogyo Kabushiki Kaisha
4 Yakushi, Tsuji-machi, Kita-ku, Nagoya

(Name & Address of Reporting Unit)

20 April, 1947

(Date)

1. Name of Facility: Romaji : Toyo Somo Kogyo Kabushiki Kaisha
English: Toyo Net Making Co., Ltd.
2. Location: 4 Yakushi, Tsuji-machi, Kita-ku, Nagoya
3. Name of President: Yeichi Okuma
4. History
 - a. Date of construction : 21 February, 1936
 - b. Date of first operation: Ditto
 - c. 1936-1941 Production (Annual value in Yen; quantities of principal products by units or weight)

Knotless Net

<u>Year</u>	<u>Quantity</u>		
1936	308,900 feet	92,700 lbs.	P.P.
1937	483,000	144,900	
1938	573,800	172,100	We did only operations
1939	790,000	237,000	and Prices of products
1940	726,500	217,700	are uncertain.
1941	955,600	286,700	

- d. Present capitalization in Yen: ¥300,000 (paid-up capital)
- e. Changes made in Capital structure since 1935

<u>Year</u>	<u>Nominal Capital</u>	<u>Paid-up Capital</u>	<u>Debt</u>
1936	200,000	200,000	0
1937	"	"	0
1938	"	"	0
1939	"	"	0
1940	"	"	0
1941	"	"	0
1942	400,000	300,000	0
1943	"	"	0
1944	"	"	0
1945	"	"	0
1946	"	"	0
1947	4,000,000	4,000,000	0.... (in application)

- f. Name and address of parent company: Nothing
- g. Number of shares outstanding: 8,000 (Value of each share ¥50)
- h. Number of stockholders (Give name of those owing 10% or more of total)
 - Number of stockholders: 12
 - Name of those owing 10% or more:

Nippon Gyomo Sengyo Kabushiki Kaisha	28.7%
Okuma Kogyo Kabushiki Kaisha	27.5%
Yeichi Okuma	17.0%
Katsutaro Fujino	12.5%

- i. Bonds received from Government (bounties, subsidies, etc.)
Nothing

- 2 - (Report on Industrial Facilities)

5. General Description

a. Principal Products

1. Wartime : Knotless Fishing Net.
2. At Present: Knotless Fishing Net.
3. Planned for 1947-1948: Knotless Fishing Net, Kaerumata Fishing Net, Mojiriemi Fishing Net, Rope & twist and Fittings of Net.

b. Capacity (annually)

1. Wartime : Knotless Fishing Net
900,000 feet
2. At Present: Knotless Fishing Net
450,000 feet
3. 1947-1948 (With unrestricted access to materials)

<u>Description</u>	<u>Quantity</u>
Knotless Net	1,440,000 feet
Kaerumata Net	2,500,000 "
Mojiriemi Net	1,800,000 "
Rope & twist	150,000 lbs.
Fittings of net	Some

6. Machinery & Equipment in Plant

<u>Description</u>	<u>Capacity</u>	<u>Maker</u>	<u>Number</u>
Knotless Netting Machines	480 feet/day	Okuma Development	10
Reel Winding Machines		"	4
Twisting Machines		"	2
Doubling Machines		"	2

7. Present stocks of raw materials and Supplies

Cotton 16,666 lbs.

8. Present Stocks of Finished Goods

Knotless Fishing Net 2,500 lbs.

9. Present Stocks of Fuel

Nothing

- 3 - (Report on Industrial Facilities)

10. Machinery & Equipment needed for maximum production 1947-1948

<u>Description</u>	<u>Quantity</u>
Mojiriami Netting Machines	10
Kaerumata Netting Machines	15
Twisting Machines	39

11. Raw materials & Supplies needed for 1947-1948 (annually)

a. For present capacity (5b2)

Cotton 160,000 lbs.

b. For Maximum (5b3)

Cotton 845,000 lbs.

12. Fuel needed for 1947-1948

We do not need especially.

13. Additional personnel needed (Not locally available)

<u>Special Skills</u>	<u>Number</u>
Workmen	115
Engineers	3

14. Prices (Give current selling prices in Yen of principal products)

<u>Description</u>	<u>Unit</u>	<u>Price</u>
Knotless Net	500 feet	¥1,570 (piece work wages)
Kaerumata Net	"	¥ 350 (")
Mojiriami Net	"	¥ 300 (")

15. Remarks (Include here any factors hampering production not already mentioned and any recommendations you consider necessary)

16. Certification by reporter

I certify that the information contained herein is true to the best of my knowledge and belief. I am authorized to sign for the above company.

Signed Yeiichi Okuma
 Title President

Outline of Okuma Kogyo K.K. - Kamiida Factory

Name : Okuma Kogyo Kabushiki Kaisha
 Address: 27 Hisshin, Tsuji-machi,
 Kita-ku, Nagoya.
 Date : 21 April 1947.

1. Name of Facility: Romaji : Okuma Kogyo K.K. - Kamiida Kojo
 English: Okuma Development Co., Ltd. ---
 Kamiida Factory
2. Location : 500 Nishitenjinmae, Kamiida-cho, Kita-ku, Nagoya
3. Name of President or Manager: President: Karoku Mureoka
4. History:
 - A. Date of construction: 29 March 1939
 - B. Date of first operation: 29 March 1939
 - C. 1935-1941 Production (Annual value in Yen; quantities of principal products by units.)

Years	Total output		Output of machine tools	
	No. of products	Annual amount	No. of products	Annual amount
1939	110	371,775	110	371,775
1940	372	1,873,485	370	1,873,389
1941	291	2,785,501	289	2,780,601

- D. Present capitalization : ¥21,520,000 (Contains the unpaid and borrowed.)
- E. Changes made in capital structure since 1935: On another page.
- F. Name and address of parent company: None
- G. Number of shares: 410,000 (Face value: ¥50.00)
- H. Total number of stockholders & main holders (Own 10% or more of total)
 - Number: 1,327
 - Name : Senji Kinyu Kinko
- I. Fund received from Government: Bounty for manufacture: ¥25,000 in 1940
- J. Outline sketch of Plant: On the separate sheet.

5. General description:

- A. Principal Products:
 1. Wartime : Grinding machines
 2. At present: Nothing.
 3. Planned for 1946-47: Nothing.
- B. Capacity:
 1. Wartime : Grinding machines 360 ¥9,000,000 (Annually)
 2. At present: Nothing.
 3. Planned for 1946-47: Nothing.
- C. Number of Employees:
 1. Wartime : 1,323 (April, 1944)
 2. At present: 15 Especially some 40 workers for custody.
 3. 1946-47 : Uncertain.

6. Machinery & Equipment in Plant:

Machinery : 256

Equipment : 46

7. Present stock of Raw materials, Supplies and Unfinished Goods:

Nothing.

8. Present stocks of Finished Goods : Nothing.

9. Present stocks of Fuel : Nothing.

10. Machinery and Equipment needed for maximum production 1946-47:

Nothing.

11. Raw materials & Supplies needed (1946-47 Total):

A. For Present : Nothing.

B. For Maximum : Nothing.

12. Fuel needed (For 2 years 1946-47): Nothing.

13. Personnel needed:

For custody of reparations machinery

Engineers 2

Workers 5

Guards 11

14. Prices (Current selling prices): None.

15. Remarks:

This factory was added to the reparations list of Machine Tool Industry in August, 1946 and so the operation is now ceased and under custody.

16. Certification by applicant.

I certify that the information contained herein is true to the best of my knowledge and belief. I am authorized to sign for the above company.

Signed

Kaoku Kurakawa

Title

President

Changes made in capital structure since 1935

<u>Year</u>	<u>Nominal Capital</u>	<u>Paid-up Capital</u>	<u>Debt</u>
1935	2,000,000	1,250,000	297,725
1936	2,000,000	1,250,000	330,446
1937	4,000,000 (increased)	2,500,000	1,181,174
1938	10,000,000 (")	6,000,000	1,672,538
1939	10,000,000	10,000,000	1,406,670
1940	10,000,000	10,000,000	3,572,730
1941	20,000,000 (increased)	12,500,000	500,000
1942	20,500,000 (")	15,250,000	1,500,000
1943	20,500,000	15,250,000	-----
1944	20,500,000	15,250,000	6,000,000
1945	20,500,000	15,250,000	8,300,000
1946	20,500,000	15,250,000	8,270,000

A

No. 27, Hisshin, Tsuji-machi,
Kita-ku, Nagoya.

24 February, 1947

Nichi Military Government Team

Gentlemen:

We are glad to send you the list of "Testing
and Measuring Instruments and Machines".

Yours truly,

Okuma Development Co., Ltd.

Karoku Muraoka
Karoku Muraoka

President

YS/CY

<u>Plant</u>	<u>Description</u>	<u>Maker</u>	<u>Number</u>	<u>Remarks</u>
Kamiida Plant	Hardness tester (Rockwell type)	Uncertain	1	Impaired
"	" (Brinell type)	"	1	
			<u>Total</u>	<u>2</u>
Ozone Plant	Hardness tester (Rockwell type)	Uncertain	1	Impaired
			<u>Total</u>	<u>1</u>
			<u>The grand total</u>	<u>3</u>

chita Plant) Nothing ~~nine~~
 Nunoike Plant

OKUMA DEVELOPMENT CO., Ltd
 Kōjō Plant

EVALUATION LIST OF
 PLANTS MANUFACTURING MACHINE TOOLS

A. Machine Tools	No of Machines	Price in 1939 ¥
1. Boring Machines	7	90,540.
2. Broching Machines		
3. Drilling Machines	27	58,942.
4. Gear Cutting Machines	6	85,062.
5. Grinding Machines	29	309,107.
6. Lathes	126	446,370.
7. Milling Machines	23	256,094.
8. Planers	11	235,298.
9. Shapers and Slotters	13	69,646.
10. Saw	5	4,955.
11. Miscellaneous	7	19,384.
B. Other Metal Working Machines		
1. Punching & Shearing Machines		
2. Sheat Forming Presses	1	1,420.
3. Forging Presses		
4. Steam Hammers		
5. Pneumatic Hammers		
6. Mechanical Hammers		
7. Miscellaneous		
C. Miscellaneous Equipment		
1. Foundry		
a. Electric Cupolas		
b. Other Cupolas		
2. Heat Treating Equipment		
a. Electric Furnaces	6	50,139.
b. Boilers		
c. Other Furnaces	5	11,718.
d. Drying ovens		
3. Auxiliaries		
a. Compresspr		
b. Cranes	42	125,585.
c. Hoist		
d. Miscellaneous (Hoisting Unit)		
4. Power Supply		
a. Motors	5	3,261.
b. Transformers	17	8,756.
c. Switch Boards	1	2,064.
d. Other Electric Apparatus		
D. Other Removable Equipment		
1. Pumps Blowers		
2. Testing Machines	2	4,049.
3. Foundry Equipment		
a. Sand-Blast		961,215.
b. Tumbler		918,211.
4. Separaters		

Omega Development Co.
Kamada Plant

Evaluation List of Plants Manufacturing Machine Tools (cont'd)

E. <u>Non-Removable Equipment (Machine Setting Cost)</u>	201,319.
F. <u>Building</u>	912,811.
G. <u>Land</u>	212,959.
H. <u>Special Value Estimated to Whole Plant</u>	466,272.
I. <u>Value of Plant as a Whole</u>	3,574,751.

NOTE:

E.A. Machine Tools are 5% of evaluated prices B.C. & D. (exclusive of testing machine) are 20%.

F. Inclusive of Building and attached equipment.

F. Inclusive of Land and Attached equipment.

H. 15% is added to total evaluated prices on the following conditions:

1. Arrangements of Machines and equipments are reasonable.
2. Shop buildings and their arrangement are good.
3. Machines and equipments are in good repair.
4. Transportation of their productions is convenient.

775013

h

INVENTORY FORM FOR MACHINE TOOL AND BALL AND ROLLER BEARING PLANTS

DATE 20 Feb 1947

Name of Company Okuma Kogyo KK

Related SCAPIN # 1133

Name of Plant Kamida Plant

Code # 01-83

ADDRESS #500 Nishitenjin-mae, Kamida-cho, Kita-ku, Nagoya

Number Talled

1. METAL WORKING MACHINES

240

A. MACHINE TOOLS

239

- 1. Boring machines 7
- 2. Broaching machines 0
- 3. Drilling machines 27
- 4. Gear cutting and finishing machines 5
- 5. Grinding machines 25
- 6. Lathes 124
- 7. Milling machines 21
- 8. Planers 8
- 9. Miscellaneous machine tools 22

B. SECONDARY METAL FORMING AND SHAPING MACHINES AND EQUIPMENT

1

- 1. Bending machines 0
- 2. Hydraulic presses 0
- 3. Manual presses 0
- 4. Mechanical presses 1

775013

INVENTORY FORM FOR MACHINE TOOL AND
BALL AND ROLLER BEARING PLANTS

DATE 20 Feb 1947

Name of Company Okuma Kogyo KK Related SCAPIN # 1133

Name of Plant Kamida Plant Code # 01-83

ADDRESS #500 Nishitenjin-mae, Kamida-cho, Kita-ku, Nagoya

Number Talled

B. SECONDARY METAL FORMING & SHARING MACHINES & EQUIPMENT (cont'd)

- 5. Shearing and punching machines 0
- 6. Forging machinery 0
- 7. Wire forming machines 0
- 8. Miscellaneous 0
- 9. Other metal working machinery and equipment 0

C. MISCELLANEOUS METAL WORKING EQUIPMENT

- 1. Welding machines, all types 0
- 2. Testing and measuring machines, all types 0
- 3. Miscellaneous physical property testing 0
- 4. Heat treating equipment 0
- 5. Portable metal working machines 0

11. ELECTRICAL MACHINERY AND APPARATUS

24

A. ELECTRICAL ROTATING EQUIPMENT

6

- 1. Generators 0
- 2. Motors (5 HP and over) 6

775013

INVENTORY FORM FOR MACHINE TOOL AND BALL AND ROLLER BEARING PLANTS

20 Feb 1947

DATE 1153

Name of Company Okuma Kogyo KK

Related SCAPIN # 01-83

Name of Plant Kanlida Plant

Code #

ADDRESS No. 500 Nishitenjin-mae, Kanlida-cho, Kita-ku, Nagoya

Number Tallied

A.	<u>ELECTRICAL ROTATING EQUIPMENT (cont'd)</u>		
	3. Motor Generators	<u>0</u>	
	4. Frequency changers	<u>0</u>	
	5. Converters and inverters	<u>0</u>	
	6. Generator Sets (Direct coupled to prime mover)	<u>0</u>	
B.	<u>PRIMARY ELECTRIC POWER TRANSMISSION AND DISTRIBUTION EQUIPMENT</u>		<u>18</u>
	1. Transformers	<u>17</u>	
	2. Switch	<u>1</u>	
111.	<u>GENERAL PURPOSE INDUSTRIAL MACHINERY AND EQUIPMENT</u>		<u>43</u>
A.	<u>ENGINES AND TURBINES</u>		<u>0</u>
	1. Steam Engines	<u>0</u>	
	2. Steam Turbines	<u>0</u>	
	3. Internal Combustion Engines	<u>0</u>	
B.	<u>COMPRESSORS AND PUMPS</u>		<u>1</u>
	1. Compressors and Dry Vacuum Pumps	<u>0</u>	
	2. Pumps	<u>1</u>	
C.	<u>MISCELLANEOUS MACHINERY AND EQUIPMENT</u>		<u>42</u>
	1. Power Boilers	<u>0</u>	
	2. Cranes	<u>42</u>	

775013

List of Machinery & Equipment

Name of Plant: Kamiida Plant *Mar. '47*

Address: 500, Nishitenjinmae, Kamiida-cho, Kite-ku, Nagoya.

<u>Name</u>	<u>Type</u>	<u>Capacity</u>	<u>Maker</u>	<u>No.</u>	<u>Owner</u>
Planer	PS	42"x42"x10'	Okuma	1	Okuma
"		98"x98"x21'	Kubota	1	"
"		48"x48"x12'	Rockford	1	"
"	PS	42"x42"x12'	Okuma	1	"
"	"	36"x36"x12'	"	1	"
"	"	"	Komatsu	1	"
"		50"x30"x 8'	Matsushita	1	"
"		48"x48"x12'	Kitekemi	1	"
"		48"x48"x10'	"	1	"
"	PS	30"x30"x 8'	Okuma	2	"
Tool grinder	GAG2	200 x 600	"	2	"
"	"	203x610	"	1	"
"		100 x 350	Fajima	1	"
"	SH-B		Churchil	1	Mitsubishi-Juko
"	AS-3		Schmaltz	1	"
Shaper	SS 16"	405 x 535	Okuma	4	Okuma

"		50"x30"x 8'	Mitsubishi	1	"
"		48"x48"x12'	Kitekemi	1	"
"		48"x48"x10'	"	1	"
"	PS	30"x30"x 8'	Okuma	2	"
Tool grinder	GAG2	200 x 600	"	2	"
"	"	203x610	"	1	"
"		100 x 350	Tajima	1	"
"	SH-B		Churchil	1	Mitsubishi-Juko
"	AS-3		Schmaltz	1	"
Shaper	SS 16"	405 x 535	Okuma	4	Okuma
"	SS 20"	510 x 610	"	3	"
"	SS 24"	610 x 760	"	3	"
Plain milling machine	MR	1575x165x184	"	1	"
"	No. 2	710x250x450	Gasuden	2	"
"	MS No. 0	460x117x295	Okuma	2	"
"	MP No. 2	710x150x370	"	2	"
Horizontal drilling & Boring machine	HB-1	63.5 m/m	"	3	"
"		"	Kanno	2	"
"	S-70	70 m/m	Union	1	"
"	HS-2	89 m/m	Okuma	1	"
Lathe	OG	432 x 1230	"	10	"
"		14" x 3'	Pratt	1	"