

GHQ/SCAP Records (RG 331, National Archives and Records Service)

Description of contents

- (1) Box no. 2921
- (2) Folder title/number: (11)
Toko Precision Machinery Mfg. Co. - Oyodo, Senrioka,
Mikuni Factories
- (3) Date: Mar. 1946 - Nov. 1946
- (4) Subject:
- | Classification | Type of record |
|----------------|----------------|
| 9230, 9621 | c |
- (5) Item description and comment:
i) Osaka
ii) Includes Contents List
- (6) Reproduction: Yes No
- (7) Film no. _____ Sheet no. _____

(Compiled by *National Diet Library*)

Index

Incoming Correspondences

No.	Date	Subject	Remarks
406	22 Oct 46	Monthly production report for Sep.	
1051	29 Nov 46	" Oct	

MONTHLY PRODUCTION REPORT
(During October)

Date 1st, Nov. 1946

To: Osaka Military Government Team
Thru: Osaka Prefectural Government

Description

1. Name Toko Precision Machinery Manufacturing Co., Ltd.
Mikuni Factory.

2. Location 10 Horikami-doori 1 choome Higashi-yodogawa-ku,
Osaka City.

3. Permitted date and number
107 OK 102 8, April, 1946

4. Permitted articles and capacity
Casting parts of Water-meter 30,000 kg.
Casting parts of Electric heater 6,000 kg.

5. Production

Articles	Pieces	Weight	Price
Casting parts of Water-meter	1325	481 kg.	¥5887.69

6. Remarks

OSAKA M.G
RES-COM-IND
FILE 1051

Signed H. Tanaka
Title Managing Director

MONTHLY PRODUCTION REPORT
(During October)

Date 1st, Nov. 1946

To: Osaka Military Government Team

Thru: Osaka Prefectural Government

Description

1. Name Toko Precision Machinery Manufacturing Co., Ltd.,
Senrioka Factory.

2. Location 105 Tsuboi, Mashita-mura, Mishima-gun, Osaka-fu.

3. Permitted number and date
107 OK 102 8, April, 1946

4. Permitted articles and capacity

Watthour-meter	60,000
Special electric meter	2,400
Electric heater	30,000

5. Production

Articles	Pieces	Weight	Price
Watthour-meter	2561		¥307,320.00
Special electric meter	170		¥ 32,300.00
Transformer	115		¥ 43,700.00

6. Remarks

Signed
Title

H. Tanaka
Managing Director

OSAKA M.G
RES-COM-IND
FILE 1052

MONTHLY PRODUCTION REPORT
(During October)

Date 1st, Nov. 1946

To: Osaka Military Government Team
Thru: Osaka Prefectural Government

Description

- 1. Name Toko Precision Machinery Manufacturing Co., Ltd.,
Oyodo Factory.
- 2. Location 44 Dainin-nishi 1 choome Oyodo-ku, Osaka City.
- 3. Permitted number and date
107 OK 102 8, April, 1946
- 4. Permitted articles and capacity
Water-meter

5. Production

Articles	Pieces	Weight	Price
Water-meter			
100 m/m	20		¥59,600.00
75 m/m	18		¥44,600.00
50 m/m	20		¥34,600.00

6. Remarks

Signed I. Tanaka
Title Managing Director

OSAKA M.G
RES-COM-IND
FILE 1053

MONTHLY PRODUCTION REPORT

(During September)

Date 1st, Oct., 1946

To: Osaka Military Government Team

Thru: Osaka Prefectural Government

Description

1. Name Toyo Precision Machinery Manufacturing Co., Ltd.,
Oyodo Factory.

2. Location 44 Dainin-nishi 1 chome Oyodo-ku, Osaka City.

3. Permitted number and date
107 OR 102 6 April, 1946.

4. Permitted articles and capacity
Water-meter 25000

5. Production

Articles	Pieces	Weight	Price
Water-meter			
100 m ³ /h	15		¥44,700.00
75 m ³ /h	30		¥74,100.00
13 m ³ /h	39		¥ 4,485.00

6. Remarks

Signed I. Tanaka
Title Managing Director

MONTHLY PRODUCTION REPORT

(During September)

Date 1st, Oct., 1946

To: Osaka Military Government Team
Thru: Osaka Prefectural Government

Description

1. Name Toko Precision Machinery Manufacturing Co., Ltd.,
Mikuni Factory.

2. Location 10 Horikami-doori 1 choome Higashi-yodogawa-ku,
Osaka City.

3. Permitted date and number
107 OK 102 8, April, 1946.

4. Permitted articles and capacity
Casting parts of Water-meter 30,000 kg.
Casting parts of Electric heater 6,000 kg.

5. Production

Articles	Pieces	Weight	Price
Casting parts of Water-meter	1133	929.785 kg.	} ¥5,296.00
Casting parts of Transformer	252	142.120 ")	

6. Remarks

Signed H. Taniaka
Title Managing Director

MONTHLY PRODUCTION REPORT

(During September)

Date 1st. Oct., 1946

To: Osaka Military Government Team

Thru: Osaka Prefectural Government

Description

1. Name Tozo Precision Machinery Manufacturing Co., Ltd.,
Senrioka Factory.

2. Location 105 Tsuboi, Hashita-ura, Minima-gun, Osaka-fu.

3. Permitted number and date
107 OK 102 8, April, 1946

4. Permitted articles and capacity
Watt-hour-meter 60,000
Special electric meter 2,400
Electric heater 30,000

5. Production

Articles	Pieces	Weight	Price
Watt-hour-meter	2226		¥267,120.00
Special electric meter	182		¥ 46,760.00
Transformer	192		¥ 76,800.00

6. Remarks

Signed H. Tanaka
Title Managing Director

HEADQUARTERS
94TH HQ & HQ DET MIL GOVT GP
APO 660 (Osaka, Japan)

File: 107 ok - 102

8 Apr 46

SUBJECT: **APPLICATION FOR OPERATION**

TO : ~~Toke Precision Machinery Manufacturing Co. Ltd., Gyodo Factory.~~
(Name and Address of Firm)

Senrioka Factory, and Mikuni Factory.

1. a. In accord with paragraph 3, b, Directive Number Three (3) from the Supreme Commander to the Imperial Japanese Government, dated 22 Sep 45, the Toke Precision Machinery Manufacturing Co. Ltd.
(Name of Firm)

is permitted to immediately start production of Gyodo Factory - Water Meters;
(Name of Items)
Senrioka Factory - Watt hour meters, Special Electric Meters, Electric Meters;
Mikuni Factory - Casting parts of Water Meters, Casting Parts of Electric
Heaters.

b. Maximum production currently authorized is Water Meters -
25,000 pcs; Watt hour meters - 60,000 pcs, Special Electric Meters - 2,400 pcs,
Electric Meters - 30,000 pcs; Casting parts of Water Meters - 30,000 kg,
Casting parts of Electric Heaters - 6,000 kg. (during 1946)

2. The acquisition of material, parts and sub-assemblies as well as the disposition of finished products, and the establishment of sales prices will be in accord with the regulations of the Imperial Japanese Government.

3. Until otherwise directed by this headquarters, a monthly report in English of each item, by name, type and quantity produced by each factory, sub-contractor subsidiary within this factory's control will be delivered to this office by the fifteenth (15) day of the following month.

4. It is understood that this permit for reconversion is issued subject to any and all directives affecting reconversion, ultimate disposition or otherwise, which have been issued or may hereafter be issued by the Supreme Commander for the Allied Powers or by this headquarters.

By order of Lieutenant Colonel ATWOOD:

Ben Locke

BEN LOCKE
Maj, AC
Res & Ind O

Info Copy to:

SCAP (Attn: ESS)	(1)
SCAP (Attn: G-2)	(1)
CG Eighth Army (Attn: Mil Govt)	(1)
CG I Corps (Attn: Mil Govt)	(1)
<u>Osaka</u> Liaison Office	(1)
Governor of Prefecture concerned	(1)

Incl. # 2

216
B

Serial No, of report

Application for operation of
and
report on industrial facilities

To: _____
Thur: _____
Name and address of reporting unit.

23, March, 1946th
Date

- 1. Name of facility
Toko precision machinery manufacturing Co, LTD, Senrioka factory.
(Toko seiki kabushiki kaisha Senrioka kojo.)
- 2. Location
Located at No 105, tsuboi, mashita mura, mishima gun, osaka fu.
- 3. Name of president or manager
President Minoru Fukuda.
- 4. History

- a. Date of construction
15, March, 1914th (3th year of Taisho)
- b. Date of first operation
20, February, 1941th (16th year of showa)
- c. 1935 - 1941 production (annual value in year; quantities of principal products by units or weights)
1941th (16th year of showa)

Description	value	quantity
watt hour meter	¥ 648000.	36000. piece
special electric meter	¥ 3000.	100. "
parts of aircrafts	¥ 350000.	

- d. Present capitalization in yen.
¥ 1400000.
- e. Changes made in capital structure since 1935th.
1935th (10th year of showa) ¥ 800000.
1940th (15th year of showa) ¥ 1400000.
- f. Name of ~~address~~ and address of parent company.
Kanto current distribution CO, LTD.
Located at No 1, tamuracho Ichome, shiba ku, Tokyo to.
- g. Number of shares outstanding
28000 shares (* ¥ 50.)
- h. Number of stockholders (give names of those owning 10% or more of total.)
The number of stockholder; Eleven.
(Toko electric CO, LTD. 9215 shares)
(Toden Bond and Securities CO, LTD. 13385 shares)
(Shinagawa electric machinery CO, LTD. 4500 shares)

- i. Funds received from government (Bounties, Subsidies, etc,)
Non.
- j. On reverse side give outline sketch of plant layout with approximate dimensions.

千里工場
Senrioka factory

敷地寸法圖
Outline sketch of plant

單位 = 米
Unit = meter

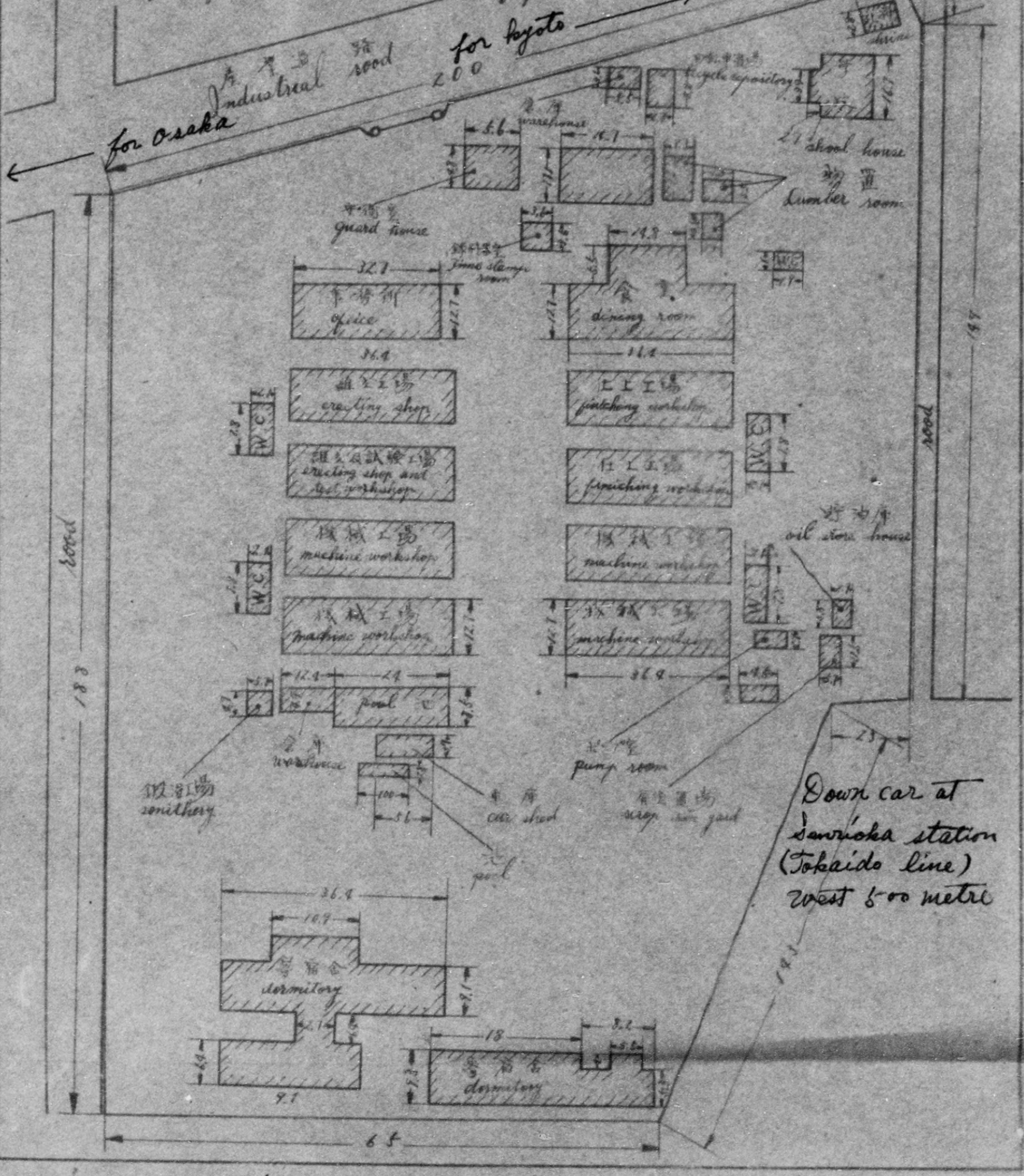

Down car at
Senrioka station
(Tokaido line)
west 500 metre

5. Description

a. Principal products

I. Wartime

Watt hour meter
Parts of aircrafts (gear box)

2. At present

Watt hour meter
Special electric meter
Electric heater

3. Planned for 1946 - 1947

1946th Watt hour meter
Special electric meter
Electric heater
1947th Watt hour meter
Special electric meter
Electric heater

III.

b. Capacity

I. Wartime

Watt hour meter 41352 piece
Parts of aircrafts (gear box) 12000 piece

2. At present

Watt hour meter 30000 piece
Special electric meter 2400 piece
Electric heater 24000 piece

3, 1946 - 1947 (with unrestricted access to materials)

	1946 th	1947th
Watt hour meter	60000 piece	72000 piece
Special electric meter	2400 piece	4800 piece
Electric meter	30000 piece	48000 piece

c. Number of employees

I. Wartime

880 people

2. at present

190 people

3. 1946 - 1947 (at maximum capacity)

590 people

6. Machinery & Equipment in plant

Description	Type	Measure	Quantity	Condition
Lathe	american	7' - 0"	1	goods
"	"	6' - 0"	15	"
"	"	5' - 0"	20	"
"	"	4' - 5"	1	"
"	"	4' - 0"	2	"
"	English	7' - 0"	1	"
"	"	6' - 0"	10	"
"	"	5' - 0"	4	"
"	"	4' - 0"	3	"
"	"	3' - 0"	2	"

"	Automatic	main spindle	1	goods
"	"	dia, 7m m	1	"
"	"	dia, 9m m	1	in repair
"	turret	dia, 9m m	1	goods
"	"	2' - 0"	8	"
"	bench	400m m	10	"
"	"	360m m	1	"
"	"	3' - 0"	4	"
"	"	2' - 0"	3	"
"	"	0' - 8"	1	"
"	screw cutting		1	"
Drilling machine	bench	10mmx300mm	7	"
"	"	"	2	in repair
"	4 spindle	10mm X 320mm	2	"
"	"	"	2	goods
"	2 spindle	10mm X 380mm	3	"
"	vertical	16"	1	"
"	"	20"	1	"
"	"	15mm x 500mm	2	"
"	"	21"	1	"
"	High speed		1	"
"	Jig boller	no, 0	1	"
Grinder	universal	6' - 0"	1	"
"	surface	5' - 8"	1	"
"	miscellaneous	14"	3	"
"	"	"	1	in repair
"	"	12"	1	goods
"	"	6"	3	"
"	"	100mm x 150mm	1	"
"	"	"	4	"
"	"	"	1	in repair
"	paper file		1	goods
"	Buff		1	"
Slotter		4"	2	"
"		8"	1	"
Milling machine	universal	no 2,	5	"
"	vertical	no 2,	1	"
"	"	no 1 1/2,	2	"
"	plane	no 2,	3	"
"	"	no 1,	3	"
"	"	no 0,	2	"
"	Duckle		4	"
"	"	310mm x 910mm	1	"
Shaper	ign	12"	1	"
"		16"	1	"
"		20"	1	"
"		24"	1	"

Press	Power	30 ton	I	goods
"	"	18 ton	I	"
"	"	15 ton	2	in repair
"	"	11 ton	2	goods
"	"	8 ton	I	in repair
"	Friction	15 ton	I	goods
"	"	6 ton	I	"
"	Hand	75 kg	6	"
Hob "	Hand screw		2	"
Hobbing machine	Automatic	10"	2	"
"	"	50 mm	2	"
"	"	"	I	in repair
"	"	"	I	impossible repair
"	"	40 mm	2	goods
"	"	12 mm	2	"
"	"	"	2	in repair
"	"	10 mm	2	goods
"	"	fellows No,	I	"
"	"	P, D, 80 mm	I	"
"	"	P, D, 500 mm	I	"
"	"	P, D, 100mm	I	"
Winding machine	Automatic		5	"
"	"		6	in repair
"	Hand		4	goods
Tapping machine		12" X 10"	5	"
"		"	I	in repair
"		under 1/4"	I	goods
"		10 k, w,	3	"
Welder	Electric		3	"
Drying apparatus	Gas		2	"
Exha "	Electric		2	"
Exhauster	Belt	4"	2	"
"	"	"	4	in repair
"	"	"	3	goods
Heat treatment furnace	Gas		I	"
Forging furnace	Coke		2	"
Sawing machine	Bow		I	"
File sawing machine	Automatic		2	"
Corking machine			I	"
Shearing maching			I	in repair
Roller	Belt	3" X 12"	2	goods
Head cutter			2	"
Blower			I	in repair
Sand blast			I	goods
Air compressor	Vertical		4	in repair
"	"		I	goods
Image machine			I	"
Magnetizer			I	"
Water feed plant	Suction			

Electric testing apparatus 14 goods
 Electric receiving plant. 3phase 3wire 60cycle 1
 130 k, w, " " " " " "

Transforming plant. Transformer
 Single phase 50 cycle 150 k, v, A, 3 " " " " " "
 " " 30 k, v, A, 1 " " " " " "
 " " 50 k, v, A, 3 " " " " " "

7. Present stocks of raw materials, supplies and unfinished goods.
 (1, February, 1946th. Stocks)

<u>Description</u>	<u>Quantity</u>	<u>Condition</u>
	7763 kg	goods
Brass bar	700 kg	"
Brass plate	600 kg	"
Phosphor bronze plate	1583 kg	"
Copper wire	185 kg	"
Copper bar	1708 kg	"
Copper plate	117 kg	"
Copper pipe	10225 kg	"
Cotton covering copper wire	3748 kg	"
Enamel copper wire	346 kg	"
Iron bar	3336 kg	"
Iron plate	1500 kg	"
Pig iron	11712 kg	"
Silicon steel plate	4361 kg	"
Polished steel plate	2374 kg	"
Duralmin bar	42 kg	"
Duralmin plate	507 kg	"
Aluminium plate	387 kg	"
Piano wire	850 kg	"
Tin	300 kg	"
Lead	36100 kg	"
Magnetic steel	408 kg	"
High speed steel bar	3438 kg	"
Special steel bar	946 kg	"
Special steel plate	3965 kg	"
Mild steel bar	127 litre	"
Insulated oil	1147 litre	"
Cutting oil	44 litres	"
Spindle oil	315 litre	"
Turbine oil	100 litre	"
Volatile oil	1325 kg	"
Bakelite oil plate	1000 litre	"
Rust stop paint	14 80 litre	"
Enamel	2018 litre	"
Varnish	245 litre	"
Lacquer		

8. Present stocks of finished goods.

<u>Description</u>	<u>Quantity</u>	<u>Condition</u>
Watt hour meter	13800 piece	goods
Special electric meter	150 piece	"
Electric heater	650 piece	"

9. Present stocks of fuel.

<u>Description</u>	<u>Quantity</u>
Coal refuse	5800 kg
Fire wood	11500 kg
Charcoal	900 kg

10. Machinery & Equipment needed for maximum production 1946 - 47.

<u>Description</u>	<u>Type</u>	<u>Measure</u>	<u>Quantity</u>
Lathe	american	8' - 0"	1
"	"	6' - 0"	15
"	"	5' - 0"	20
"	"	4' - 5"	1
"	"	4' - 0"	2
"	English	7' - 0"	1
"	"	6' - 0"	10
"	"	5' - 0"	4
"	"	4' - 0"	3
"	"	3' - 0"	2
"	Automatic	Main spindle diameter 7mm	2
"	"	" 9mm	1
"	Turret	"	1
"	"	2' - 0"	8
"	Bench	400 mm	10
"	"	360 mm	1
"	"	3' - 0"	4
"	"	2' - 0"	6
"	"	0' - 8"	3
"	Screw cutting	"	1
Drilling machine	Bench	10 mm x 300 mm	9
"	4 spindle	10 mm x 320 mm	6
"	2 spindle	10 mm x 380 mm	3
"	Vertical	16"	1
"	"	20"	1
"	"	15 mm x 500 mm	2
"	"	21"	1
"	High speed	"	1
"	Jig boller	No 0,	1

Grinder	Universal	6' - 0"	1
"	Surface	5' - 0"	2
"	Miscellaneous	14"	4
"	"	12"	1
"	"	6"	3
"	"	100 mm x 150 mm	1
"	"	"	7
"	Paper file	"	1
"	Buff	"	1
Slotter	"	4"	2
"	"	8"	1
Milling machine	Universal	No 2,	5
"	Vertical	No 2,	1
"	"	No 1 1/2,	2
"	Plane	No 2,	3
"	"	No 1,	3
"	"	No 0,	2
"	Dukle	"	4
"	"	310mm x 910mm	1
Shaper	"	12"	1
"	"	16"	1
"	"	20"	1
"	"	24"	1
Press	Power	30 ton	1
"	"	18 ton	1
"	"	15 ton	2
"	"	11 ton	2
"	"	8 ton	1
"	Friction	15 ton	1
"	"	6 ton	1
"	Hand	75 kg	6
"	Hand screw	"	2
Hopping machine	Automatic	10"	2
"	"	50 mm	7
"	"	40 mm	2
"	"	12 mm	4
"	"	10 mm	2
"	"	fellows	1
"	"	P,D, 80 mm	1
"	"	P,D, 500 mm	1
"	"	P,D, 100 mm	1
Winding machine	Automatic	"	11
"	Hand	"	4
Tapping maching	"	12" x 10"	6
"	"	1/4" Under	1
Welder	Electric	10 k,w,	4
Drying apparatus	Gas	"	3
"	Electric	"	2

Exhauster	Belt	4"	5
"	"	"	1
Heat treatment furnace	Gas		3
Forging furnace	Coke		1
Sawing machine	Bow		2
File sawing machine	automatic		1
Corking machine			3
Shearing machine			1
Roller	Belt		1
Head cutter			2
Blower			2
Sand blast			1
Air compressor	Vertical		5
Image machine			1
Magnetizer			1
Water feed plant	Suction		1
Electric testing apparatus			15
Electric receiving plant	3 phase 3 wire 60 cycle		
	130 k, w,		1
Transforming plant	Transformer		
	single phase 60 cycle 150 k,v,A,		3
	" 30 k,v,A,		1
	" 50 k,v,A,		3

II, Raw materials & supplies needed (monthly)
 a, for present capacity (5b 2 above)

<u>Description</u>	<u>Quantity</u>
Brass bar	1109 kg
Brass plate	30 kg
Copper plate	463 kg
Iron plate	2770 kg
Iron bar	710 kg
Iron wire	675 kg
Silicon steel plate	1229 kg
Polished steel plate	1388 kg
Steel wire	3 kg
Enamel copper wire	138 kg
Cotton covering copper wire	13 kg
Phosphor bronze plate	6 kg
Pig iron	500 kg
Tin	11 kg
Lead	40 kg
Aluminium plate	161 kg
Aluminium cast	1300 kg
Antimony	12 kg
Coke	1250 kg
Heat treatment oil	25 litre
Paint	80 litre
Insulation varnish	36 litre

Bakelite plate	50 kg
Braid	4 kg
Fiber	8 kg
Presspahn sheet	15 kg
Lino tape	10 kg
Micanite sheet	20 kg
Cotton	10 kg
Nichrome wire	50 kg
Glass plate	200 piece
Glass cover	2500 piece
Magnetic steel	750 kg
High speed steel bar	25 kg
Mild steel bar	115 kg
Special steel bar	107 kg
Special steel plate	47 kg

b, for maximum (5b 3 above)

<u>Description</u>	<u>Quantity</u>
Brass bar	2104 kg
Brass plate	30 kg
Copper plate	925 kg
Iron plate	6165 kg
Iron bar	888 kg
Iron wire	1350 kg
Silicon steel plate	2454 kg
Polished steel plate	2638 kg
Steel wire	3 kg
Enamel copper wire	275 kg
Cotton covering copper wire	25 kg
Phosphor bronze plate	6 kg
Pig iron	300 kg
Tin	16 kg
Lead	50 kg
Aluminium plate	303 kg
Aluminium cast	1625 kg
Antimony	12 kg
Coke	2500 kg
Heat treatment oil	50 litre
Faint	156 litre
Insulation varnish	68 litre
Bakelite plate	60 kg
Braid	4 kg
Fiber	10 kg
Presspahn sheet	30 kg
lino tape	20 kg
Lino tape	20 kg
Micanite sheet	40 kg
Cotton	20 kg
Nichrome wire	63 kg

Glass plate	200 piece
Glass cover	5000 piece
Magnetic steel	1300 kg
High speed steel bar	25 kg
Mild steel bar	192 kg
Special steel bar	178 kg
Special steel plate	79 kg

12, Fuel needed (monthly) (Donot include present stocks)

<u>Description</u>	<u>Quantity</u>
Coal	10 ton
Coke	2 ton
Fire wood	15 ton
Charcoal	1,6 ton
Gasoline	50 gallon
Gas	7000 cubic meter
Alcohol	120 litres

13, Additional personnel needed (Not locally available)

<u>Special skills</u>	<u>Number</u>
Non,	Non,

14, Prices (Give current selling prices in yen of principal products)

<u>Description</u>	<u>Unit</u>	<u>Price</u>
Watt hour meter (Single phase	40000 piece	¥ 150.
(Three phase	20000 piece	¥ 315.
Special electric meter	2400 piece	¥ 240.
Electric herter	30.00 piece	¥ 79.

15, Remarks (Include here any factors hampering production not already mentioned and any recommendations you consider necessary)

Non,

16, Certification by applicant

I certify that the information contained herein is true to the best of my knowledge and belief.

Signed Junichi Kurihara

Title Factory Manager

17, Action by occupation forces.

The factory described in this application has been inspected and the following action :

a, Ordered to remain closed	Yes _____	No _____
b, Ordered to cease operation immediately	Yes _____	No _____
c, Authorized to produce at the following rate :		

<u>Items to be manufactured</u>	<u>Monthly quantity</u>
---------------------------------	-------------------------

Signature of authorizing officer

Designation of authorizing unit