

West Point Mill

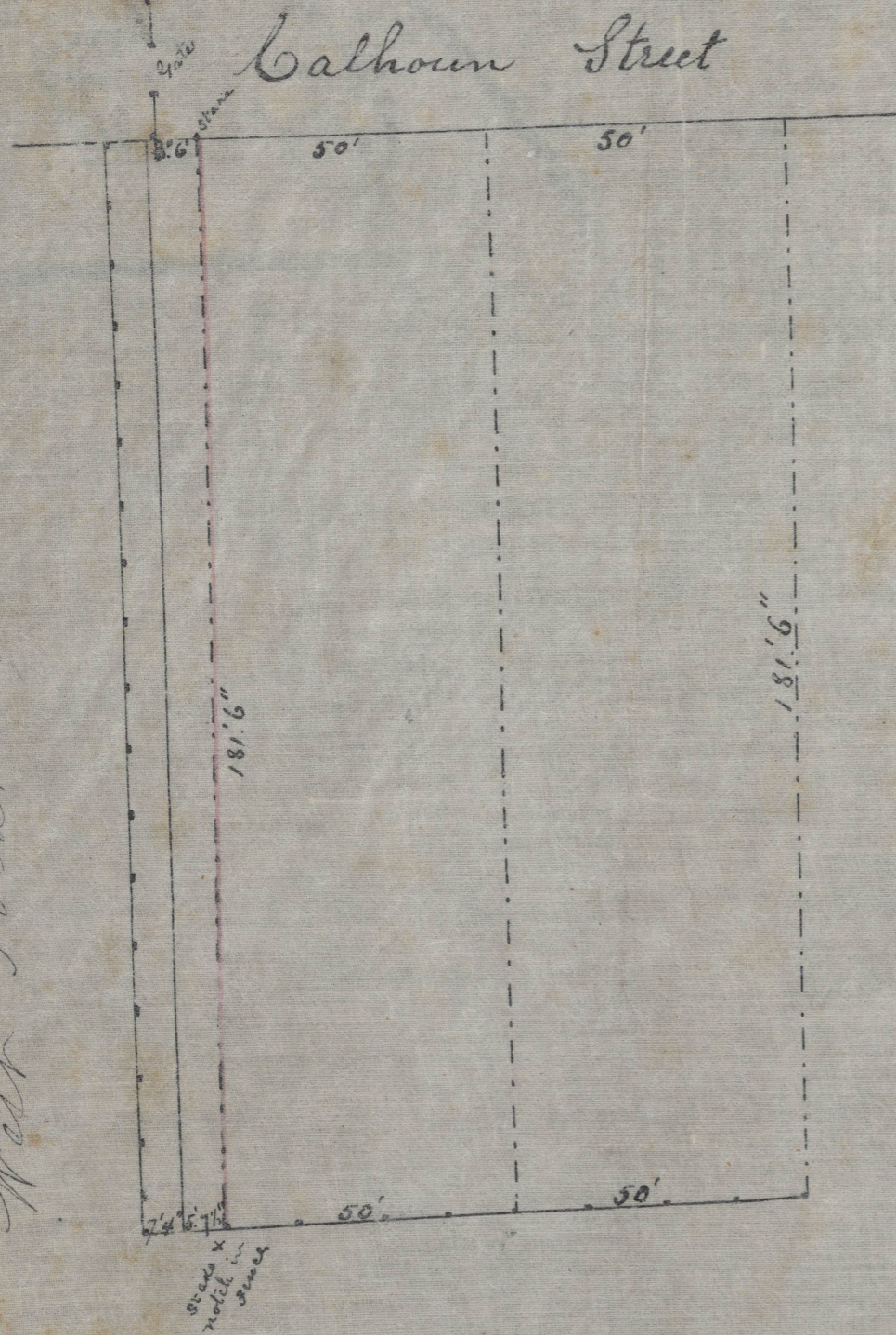

Plat of
 the dividing line between the
 West Point Mill property and
 lots recently purchased by Mr.
 E. L. Halley from A. G. McGrath Esq
 Surveyed August 1889.

Timons & Huger
 Surveyors.

The red line shows the true line
 the fence being a fence pass on the
 Mill property.

Scale 30ft per inch