

W<sup>m</sup> Cunningham  
 W<sup>m</sup> Melix Long  
 1854 6

King Street  
 41 Feet

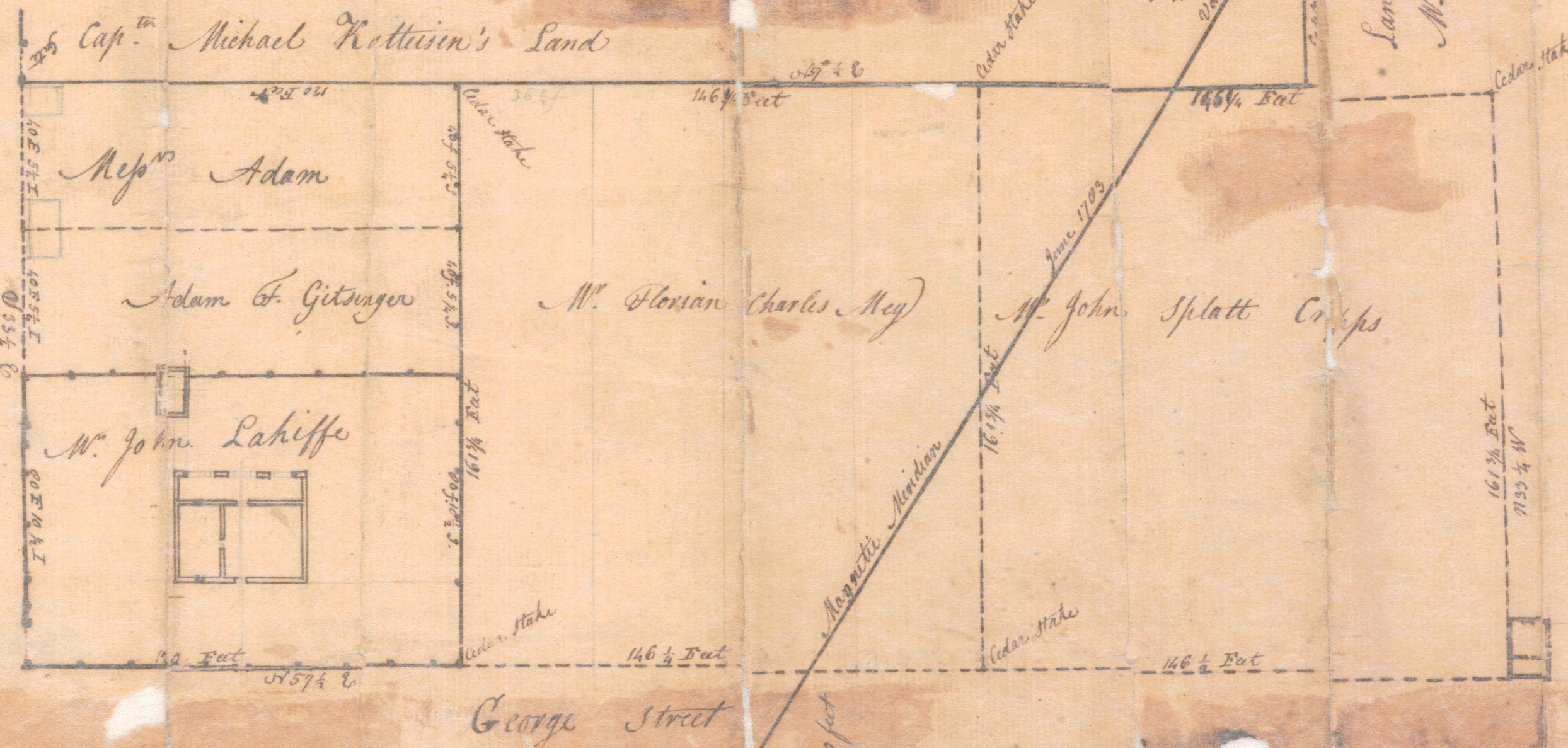

Lands belonging to W<sup>m</sup> David Guorod

Lands belonging to the Estate of  
 M<sup>r</sup> Pifer. — dead

At the Request of W<sup>m</sup> Florian Charles Mey I have made a survey & returned and filed the Boundaries of a Lot of  
 Lands in the Borough on the North side of George Street in St Philip's Parish, Merchant and State of Virginia.  
 The same being part of land purchased by the said W<sup>m</sup> F. C. Mey jointly with Mr John Splatt and Mrs Anne  
 Having met Make and Marks as represented in the above Plan 23. The Blue line comprehending  
 as by Agreement between  
 and the said that part now being to said Mr Mey —  
 Surveyed June 22. 1709  
 By J. P. Sawyer