

GHQ/SCAP Records (RG 331, National Archives and Records Service)

Description of contents

(1) Box no. 2894

(2) Folder title/number: (9)
Osaka Shipbuilding Co.

(3) Date: **Apr. 1946 - Feb. 1950**

(4) Subject:

Classification	Type of record
9230, 9622	z

(5) Item description and comment:

- i) Osaka**
- ii) Includes Contents Lists (Divided)**

(6) Reproduction: Yes No

(7) Film no.

Sheet no.

(Compiled by *National Diet Library*)

~~DATE~~

DATE

SUBJECT

10 Mar 47

Inventory Made By General Contractor's Association of Japan

18 Apr 47

Inventory Form.

Name: OSAKA SHIPYARD

Code No. 32-128

Date 1 July 49

SECTION I
INVENTORY DATA

470

1. Total items originally inventoried:

2. Originally inventoried items not available for allocation:

a. EX items

(1) Originally inventoried EX 2

(2) Subsequently deleted from EX classification 2

(3) Total (line a(1) less line d(2)) _____

b. Subsequently released from custody _____

(1) Woodworking* _____

(2) Others* _____

c. Destroyed SP* _____

d. Subsequent losses from fire, theft, etc* _____

e. Released from dispersed location* _____

f. Shipped to TID* _____

g. Removed under PD* _____

h. _____

i. _____

3. Total deduction from original inventory _____

4. Item missed from original inventory-subsequently picked up 170

5. Adjusted original inventory total (line 1 less line 3, plus line 4) 660

6. Subsequent additions to inventory _____

a. Returned PD'd items* _____

b. Added on evaluation _____

c. _____

d. _____

7. Inventory total 660

8. "U" items _____

9. Total items available for allocation (line 7 less line 8) 660

SECTION II
MISCELLANEOUS

1. Non-inventoried items shipped to TID _____

2. Items inventoried under other plant code number: (Not included in line 9, SEC I)

3. Authorized transformer capacity _____ KW

4. EX items subsequent to original inventory _____

* See reverse side

INVENTORY FORM FOR SHIPYARD

DATE 1 July, 1949

Name of Company Osaka Shipbuilding Co., Ltd. Related SCAPIN No. _____

Name of Yard Osaka Works Code No. 32-128

Address of Yard No. 1, 2-chome, Minamifukuzaki-cho, Minato-ku, Osaka.

Number Marked

I. METAL WORKING MACHINES

329

A. SECONDARY METAL FORMING AND SHIPING MACHINES AND EQUIPMENT

32

- | | |
|--|---------------|
| 1. Bending Machines | <u>1</u> |
| 2. Hydraulic pressed | <u>2</u> |
| 3. Manual presses | <u> </u> |
| 4. Mechanical presses | <u> </u> |
| 5. Shearing and punching machines | <u>7</u> |
| 6. Forging machinery | <u> </u> |
| 7. Wire forming machines | <u> </u> |
| 8. Miscellaneous | <u>2</u> |
| 9. Other metal working machinery and equipment | <u>9</u> |

B. PORTABLE METAL WORKING MACHINES AND TOOLS (POWER DRIVEN)

191

- | | |
|------------------------------|---------------|
| 1. Portable grinders | <u>2</u> |
| 2. Abrasive cutting machines | <u> </u> |
| 3. Portable drills | <u>26</u> |
| 4. Hammers | <u>51</u> |
| 5. Nibblers | <u> </u> |

INVENTORY FORM FOR SHIPYARD

Date 1 July, 1949

Name of Company Osaka Shipbuilding Co., Ltd. Related SCAPIN No. _____

Name of Yard Osaka Works Code No. 32-128

Address of Yard No. 1, 2-chome, Minamifukuzaki-cho, Minato-ku, Osaka.

Number Marked

B. PORTABLE METAL WORKING MACHINES
AND TOOLS (POWER DRIVEN) CONT'D

6. Shears	_____
7. Riveters	<u>69</u>
8. Miscellaneous	<u>47</u>

C. MACHINE TOOLS

70

1. Boring machines	<u>3</u>
2. Broaching machines	_____
3. Drilling machines	<u>10</u>
4. Gear cutting and finishing machines	_____
5. Grinding machines	<u>3</u>
6. Lathes	<u>38</u>
7. Milling Machines	<u>4</u>
8. Planers	<u>4</u>
9. Miscellaneous machine tools	<u>8</u>

D. MISCELLANEOUS METAL WORKING EQUIPMENT

46

1. Welding machines, all types	<u>36</u>
2. Testing and measuring machines, all types	_____

INVENTORY FORM FOR SHIPYARD

DATE 1 July, 1949.

Name of Company Osaka Shipbuilding Co., Ltd. related SCAPIN No. _____

Name of Yard Osaka Works Code No. 32-128

Address of Yard No. 1, 2-chome, Minamifukuzaki-cho, Minato-ku, Osaka.

Number Marked

D. MISCELLANEOUS METAL WORKING EQUIPMENT (CONT'D)

3. Miscellaneous physical property testing 4

4. Other equipments 6

II. TRANSPORTATION AND HOISTING EQUIPMENT 50

A. TRANSPORTATION EQUIPMENT 9

1. Locomotives (RR type) _____

2. Freight cars (RR type) _____

3. Barges and lighters 1

4. Boats 1

5. Industrial locomotives _____

6. Industrial cars 7

B. HOISTING EQUIPMENT 41

1. Cranes, floating _____

2. Cranes, jib _____

3. Cranes, overhead locomotives 25

4. Cranes, overhead 26

5. Derricks _____

6. Hoists 5

INVENTORY FORM FOR SHIPYARDS

DATE 1 July, 1948.

Name of Company Osaka Shipbuilding Co., Ltd. related SCAPIN No.

Name of Yard Osaka Works Code No. 32-128

Address of Yard No. 1, 2-chome, Minamifukuzaki-cho, Minato-ku, Osaka.

Number Marked

B. HOISTING EQUIPMENT (CONT'D)

1. Towers travelling _____

3. Winches _____

10

62

III. ELECTRICAL MACHINERY AND APPARATUS

A. ELECTRICAL ROTATING EQUIPMENT

41

1. Generators _____

2. Motors (5 HP and over) _____

35

3. Motor generators _____

4. Frequency changers _____

5. Converters and inverters _____

6. Motors less than 5 HP _____

6

B. PRIMARY ELECTRIC POWER TRANSMISSION AND DISTRIBUTION EQUIPMENT

21

1. Transformers _____

11

2. Switches _____

10

IV. GENERAL PURPOSE INDUSTRIAL MACHINERY AND EQUIPMENT

15

A. ENGINES, TURBINES AND BOILERS

1. Steam engines _____

2. Steam turbines _____

INVENTORY FORM FOR SHIPYARDS

DATE 1 July, 1949.

Name of Company Osaka Shipbuilding Co., Ltd. Related SCAPIN No. _____

Name of Yard Osaka Works Code No. 32-128

Address of Yard No. 1, 2-chome, Minamifukuzaki-cho, Minato-ku, Osaka.

Number Marked

A. ENGINES, TURBINES AND BOILERS (CONT'D)

3. Boilers, Power _____

4. Internal combustion engines _____

B. COMPRESSORS AND PUMPS 16

1. Compressors and dry vacuum pumps _____ 6

2. Pumps _____ 9

V. WOODWORKING MACHINERY 27

A. EQUIPMENT 27

1. Saws _____ 9

2. Surfacing machines _____ 4

3. Lathes _____ 3

4. Jointers, matchers and molders _____ 1

5. Mortise and tenon machines _____

6. Kilns _____

7. Other wood treating equipment _____

8. Veneer and plywood machines _____

9. Miscellaneous _____ 10

INVENTORY FORM FOR SHIPYARDS

DATE 1 July, 1949

Name of Company Osaka Shipbuilding Co., Ltd. Related SCAPIN No. _____

Name of Yard Osaka Yards Code No. 32-128

Address of Yard No.1, 2-chome, Minamifukuzaki-cho, Minato-ku, Osaka.

Number Marked

VII. BLACKSMITH SHOP 177

A. EQUIPMENT 177

1. Items of equipment 177

VIII. DOCKS _____

A. DRY DOCKS _____

1. Floating _____

VIII. MISCELLANEOUS 49

A. _____

1. Items of miscellaneous _____

B. 49

1. Items of miscellaneous 49

No. 1

EQUIPMENT OF THE LEAD CHAMBER ACID PLANT
TO BE LISTED FROM INVENTORY SHEET

TEIKOH KAKO I.T.

<u>NO.</u>	<u>INVENTORY NO.</u>	<u>NAME</u>	<u>SIZE AND CAPACITY</u>
1	IA1-4	Roaster	8.9m x 9.8m, 9 stairs, 25 ton/day
	IA1-4	Driving mechanism	Gear ratio:1/4,500
	IA1-4	Motor	7.5 HP 3 phases induction. Volt:220. Cycle:60
2	IA5-37	Air fan	Displacement of air:200 m ³ /min.
	IA5-37	Motor	10HP, 3 phases induction. Volt:220, Cycle:60
3	IA5-38	Air fan	Displacement of air:200 m ³ /min.
	IA5-38	Motor	10HP, 3 phases induction. Volt:220, Cycle:60
4	IA5-39	Elevator	Height:13m. 3 ton/hour
5	IA5-40	ditto	ditto
	IA5-41	Motor	5 HP, 3 phases induction. Volt:220, Cycle:60
6	IA5-42	Hot cottrell	5.3m x 9.5m x 8.3m Brick work
	IA5-43	Voltage regulator	2.5 KVA, 220V/173.5V
	IA5-44	Rectifier	Dia:700mm
	IA5-45	Motor	Synchronous 1KW, 4 Pole.
	IA5-46	Transformer	10 K.V.A. 6,800/293.5V
	IA5-47	Switch board	
7	IA5-48	Ammonia oxidizer	96 kg/day NH ₃

No. 2		INVENTORY	
NO.	NO.	NAME	SIZE AND CAPACITY
8	IA5-49	Amoma oxidizer	96 kg/day NH ₃
9		Glover tower	Lead & brick work, 3m x 3m x 11m
10		1st lead chamber	12.5m x 25.8m x 12m
11		2nd lead chamber	7m x 13m x 12m
12		3rd lead chamber	7.6m x 11.6m x 12m
13	IA5-50	Air fan	Lead work
	IA5-50	Motor	3 HP, 3 phases, 220V, Cycle:60
14		Gay-Lussac tower	lead work, 3m x 3m x 12m
15	IA5-51	Air fan	lead work
	IA5-51	Motor	3 HP, 3 phases, 220V, 60 Cycle
16		Gay-Lussac tower	Lead work, 3m x 3m x 12m
17	IA5-52	Plunger pump	Displacement of acid:5,400--6,000L/hour
18	IA5-53	ditto	ditto
19	IA5-54	ditto	ditto
20	IA5-55	ditto	ditto
	IA5-56	Motor	15 HP, 3 phases, 220 V, 60 cycle
	IA5-59	Turbin pump	Dia:45mm, Head:90m, Displacement of water:1.5m ³ /min.
	IA5-61	Pump	Centrifugal, Dia:150mm, Head:18m
	IA5-61	Motor	10 HP, 3 phases, 220V, 60 cycle
	IA5-62	Pump	Dia:95mm, Head:12m, Displacement of water:0.6m ³ /min.

No. 3

<u>NO.</u>	<u>INVENTORY NO.</u>	<u>NAME</u>	<u>SIZE AND CAPACITY</u>
	IA5-52	Motor	5 HP, 3 phases, 220V, 60 cycle
25		Cooler	1.5m x 2m
26		Tank	Lead and brick work
27		ditto	ditto
29	IA5-57	Pump	Dia:65mm, Head:24m. Displacement of acid:366 L/min.
	IA5-57	Motor	10Hp, 3 phases, 220 V, 60 cycle
30	IA5-58	Pump	Dia:65mm, Head:24m. Displacement of acid:366 L/min.
	IA5-58	Motor	10HP, 3 phases, 220V, 60 cycle
	IA5-60	Turbin pump	Dia:45mm, Head:90m. Displacement of water:1.5m ³ /min.
	IA5-60	Motor	5 HP. 3 phases, 220 V, 60 cycle.

HEADQUARTERS
US ARMY MILITARY GOVERNMENT TEAM
AFC 560

hnn/uh

10 March 1947

SUBJECT: Inventory Made by General Contractor's
Association of Japan.

THROUGH: Osaka Liaison Office

TO: Osaka Zosen-sho Co. Ltd.
(Code No. 32-128)

1. During the month of January the General Contractor's Association of Japan made an inventory of your plant. This inventory listed "Stockpiled and Installed Material and Supplies" which may eventually be removed.

2. Before a final decision is reached, this headquarters requests a list of all those inventoried items which you have any objection to removal, or which are necessary for the maintenance and custody of reparations machinery. Next to each item should be a short explanation outlining the reason for retaining.

3. It is requested that you submit your list in four copies by the 25th of March 1947.

FOR THE COMMANDING OFFICER:

Edward L. Merrill
EDWARD L. MERRILL
Major, T.A.
Adjutant

INVENTORY FORM FOR SHIPYARDS

Date 18 April, 1947.

Name of company Osaka Shipbuilding Co. Related SCAPIN # _____

Name of Yard Main Plant. Code # 188.

Address of Yard No. 1, 2-chome, Minamifukuzaki-cho, Minato-ku, Osaka.

Number Marked

I. METAL WORKING MACHINES

207

A. SECONDARY METAL FORMING AND DRIVING MACHINES AND EQUIPMENT

22

- | | |
|--|----------|
| 1. Bending machines | <u>1</u> |
| 2. Hydraulic presses | <u>3</u> |
| 3. Manual presses | _____ |
| 4. Mechanical presses | _____ |
| 5. Shearing and punching machines | <u>7</u> |
| 6. Forging machinery | _____ |
| 7. Wire forming machines | _____ |
| 8. Miscellaneous | <u>2</u> |
| 9. Other metal working machinery and equipment | <u>9</u> |

B. PORTABLE METAL WORKING MACHINES AND TOOLS (POWER DRIVEN)

79

- | | |
|------------------------------|-----------|
| 1. Portable grinders | _____ |
| 2. Abrasive cutting machines | _____ |
| 3. Portable drills | <u>6</u> |
| 4. Hammers | <u>11</u> |
| 5. Nibblers | _____ |

INVENTORY FORM FOR SHIPYARDS

Date 18 April, 1947.

Name of Company Osaka Shipbuilding Co. Related SCAFIN # _____

Name of yard Main Plant. Code # 128

Address of Yard No. 1, 2-chome, Minamufukuzaki-cho, Minato-ku, Osaka.

Number Marked

B. PORTABLE METAL WORKING MACHINES AND TOOLS (POWER DRIVEN) CONT'D

6. Shears	_____
7. Riveters	<u>62</u>
8. Miscellaneous	_____

C. MACHINE TOOLS 68

1. Boring machines	<u>3</u>
2. Broaching machines	_____
3. Drilling machines	<u>8</u>
4. Gear cutting and finishing machines	_____
5. Grinding machines	<u>3</u>
6. Lathes	<u>38</u>
7. Milling machines	<u>4</u>
8. Planers	<u>4</u>
9. Miscellaneous machine tools	<u>8</u>

D. MISCELLANEOUS METAL WORKING EQUIPMENT 38

1. Welding machines, all types	<u>38</u>
2. Testing and measuring machines, all types	_____

INVENTORY FORM FOR SHIPYARDS

Date 18 April, 1947.

Name of Company Osaka Shipbuilding Co. Related JOAFIN # _____

Name of Yard Main Plant Code # 128

Address of Yard No. 1, 2-chome, Minamifukuzaki-cho, Minato-ku, Osaka.

Number marked

D. MISCELLANEOUS METAL WORKING EQUIPMENT (CONT'D)

3. Miscellaneous physical
property testing _____

4. Other equipment _____

II. TRANSPORTATION AND HOISTING EQUIPMENT

50

A. TRANSPORTATION EQUIPMENT

9

1. Locomotives (RR type) _____

2. Freight cars (RR type) _____

3. Barges and lighters 1

4. Boats 1

5. Industrial locomotives _____

6. Industrial cars 7

B. HOISTING EQUIPMENT

41

1. Cranes, floating _____

2. Cranes, jib _____

3. Cranes, locomotives _____

4. Cranes, overhead 26

5. Derricks _____

6. Hoists 5

INVENTORY FORM FOR SHIPYARDS

Date 18 April, 1947.

Name of Company Osaka Shipbuilding Co. Related NAFIN # _____

Name of Yard Main Plant. Code # 128.

Address of Yard No.1, 2-chome, Minamifukuzaki-chom Minato-ku, Osaka.

Number Marked

B. HOISTING EQUIPMENT (CONTINUED)

7. Towers, travelling _____

8. Winches 10

III. ELECTRICAL MACHINERY AND APPARATUS 17

A. ELECTRICAL ROTATING ELEMENTS 4

1. Generators _____

2. Motors (5 HP and over) 4

3. Motor generators _____

4. Frequency changers _____

5. Converters and inverters _____

6. *Motors less than 5 HP* _____

B. PRIMARY ELECTRIC POWER TRANSMISSION AND DISTRIBUTION EQUIPMENT 13

1. Transformers 10

2. Switches 3

IV. GENERAL PURPOSE INDUSTRIAL MACHINERY AND EQUIPMENT 6

A. ENGINES, TURBINES AND BOILERS _____

1. Steam engines _____

2. Steam turbines _____

(11)

INVENTORY FORM FOR SHIPYARDS

Date 18 April, 1947.

Name of Company Osaka Shipbuilding Co. Related SC.FIN # _____

Name of Yard Main Plant. Code # 128.

Address of Yard No.1, 2-chome, Minamifukuzaki-chon Minato-ku, Osaka.

Number Marked

A. ENGINES, TURBINES AND BOILERS (CONT'D)

3. Boilers, power _____

4. Internal combustion engines _____

B. COMPRESSORS AND PUMPS 6

1. Compressors and dry vacuum pumps 3

2. Pumps 3

V. WOODWORKING MACHINERY 18

A. EQUIPMENT 18

1. Saws 5

2. Surfacing machines 2

3. Lathes 1

4. Jointers, matchers and molders 1

5. Mortise and tenon machines _____

6. Kilns _____

7. Other wood treating equipment _____

8. Veneer and plywood machines _____

9. Miscellaneous 9

CL

INVENTORY FORM FOR SHIPYARDS

Date 18 April, 1947.

Name of Company Osaka Shipbuilding Co. Related SCAFIN # _____

Name of Yard Main Plant. Code # 128.

Address of Yard No.1, 2-chome, Minamifukuzaki-cho, Minato-ku, Osaka.

Number Marked

VI. <u>BLACKSMITH SHOP</u>	<u>172</u>
A. <u>EQUIPMENT</u>	<u>172</u>
1. Items of equipment	<u>172</u>
VII. <u>DOCKS</u>	_____
A. <u>DRY DOCKS</u>	_____
1. Floating	_____

VIII. MISCELLANEOUS

Total 470. OK

I - 2

DATE	SUBJECT
------	---------

	Plant Layout Osaka Shipyard Fukai Detached Works
--	---

I B

PLAN LAY OUT.

The Osaka Shipyards Co. Ltd.
(The Osaka Zosen sho. Fukae Kōjyū
K.K.)

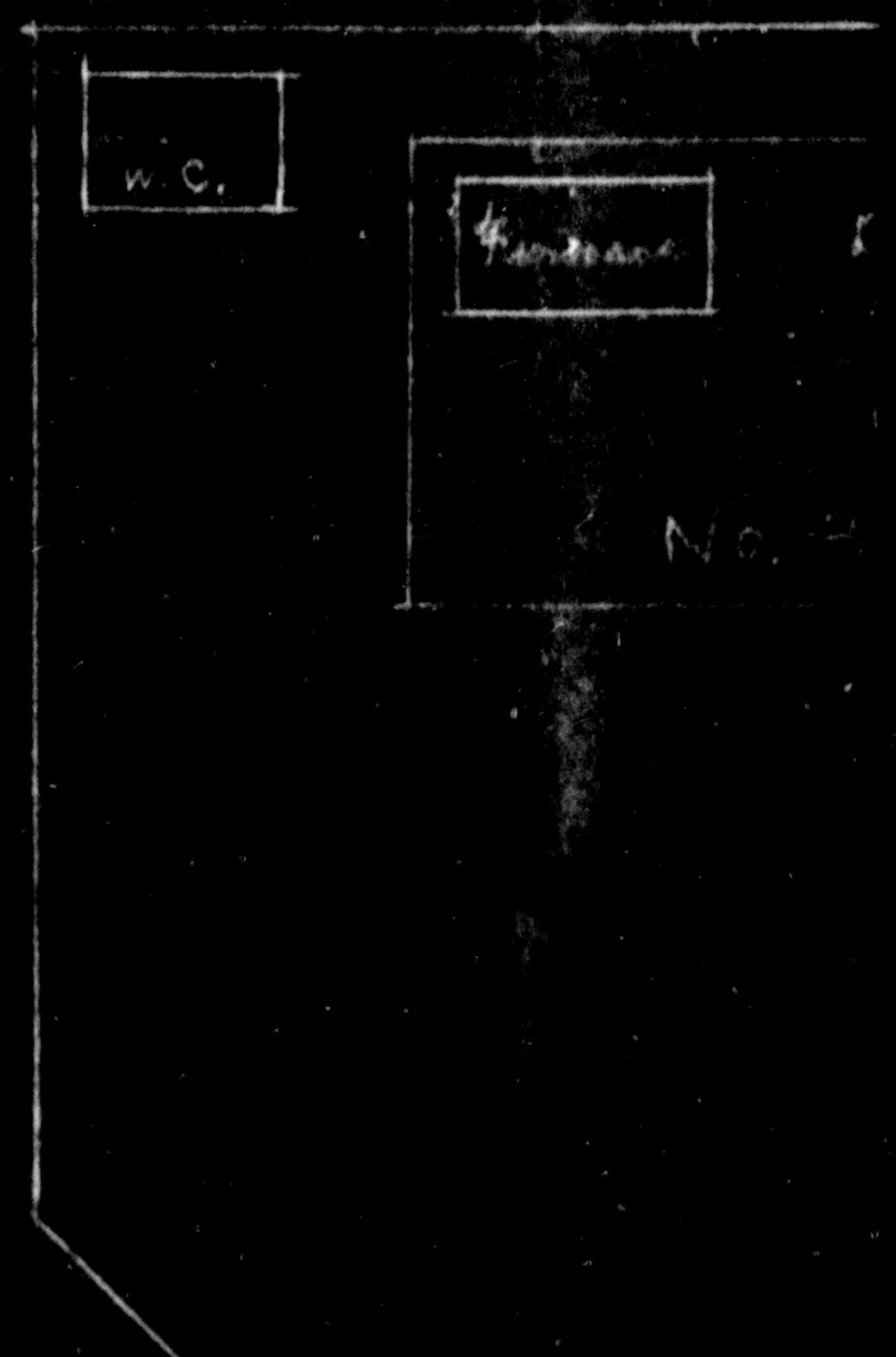
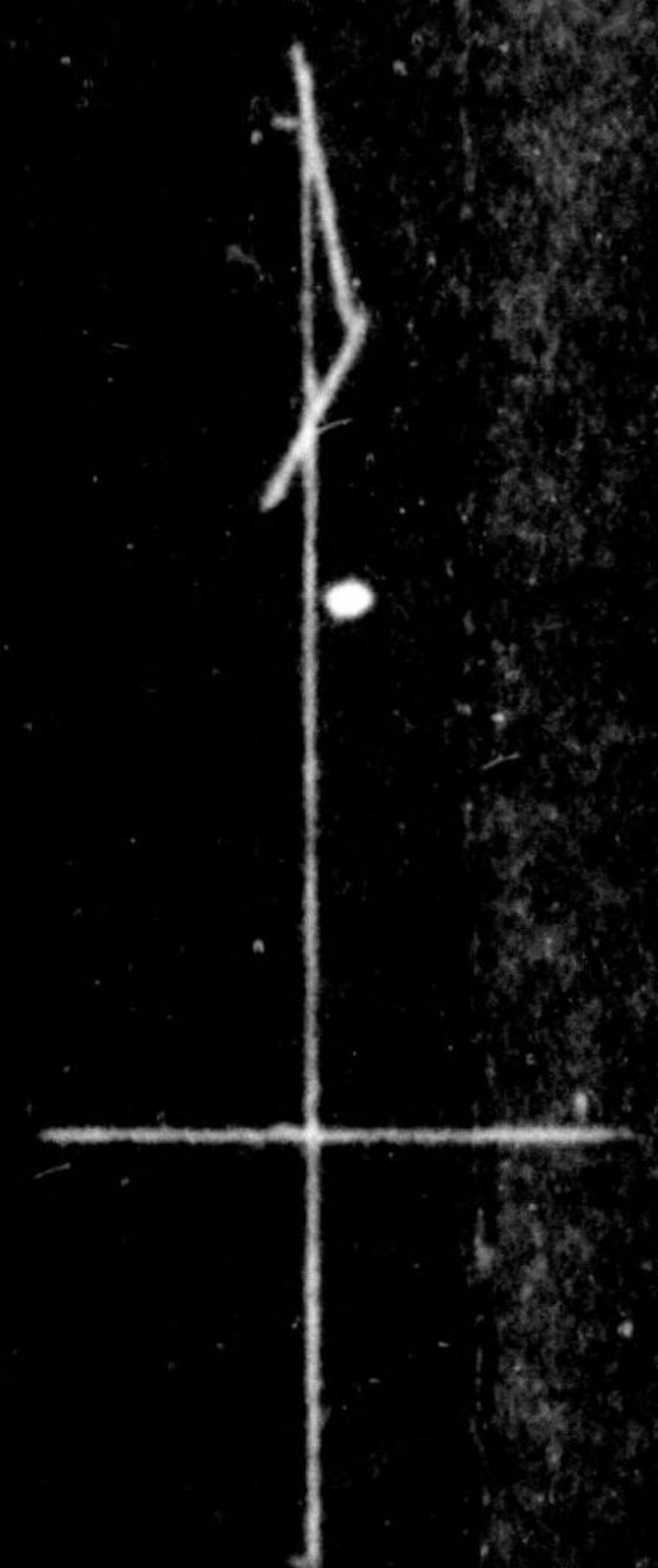

LAY OUT.

Shipyard Co. Ltd. Fukae Detached Works
(osen sho. Fukae Kōjyō.)

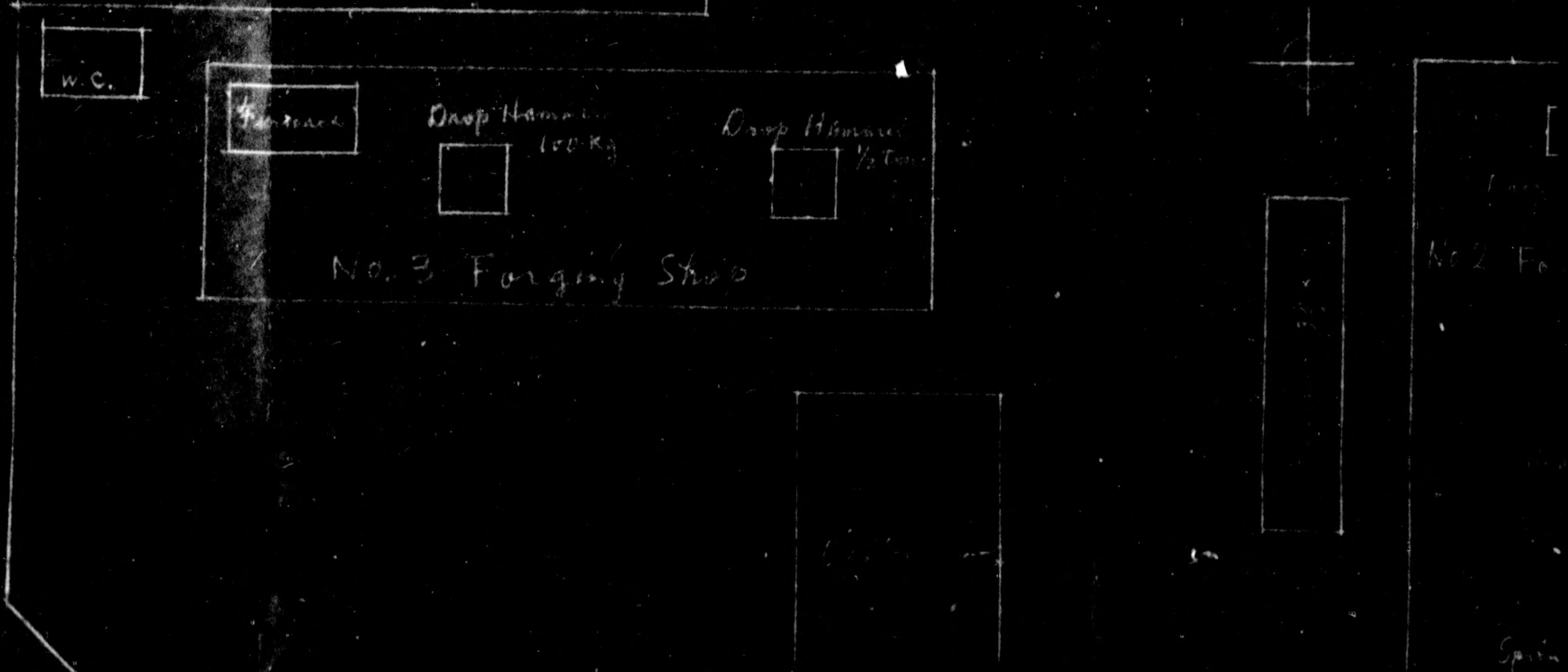
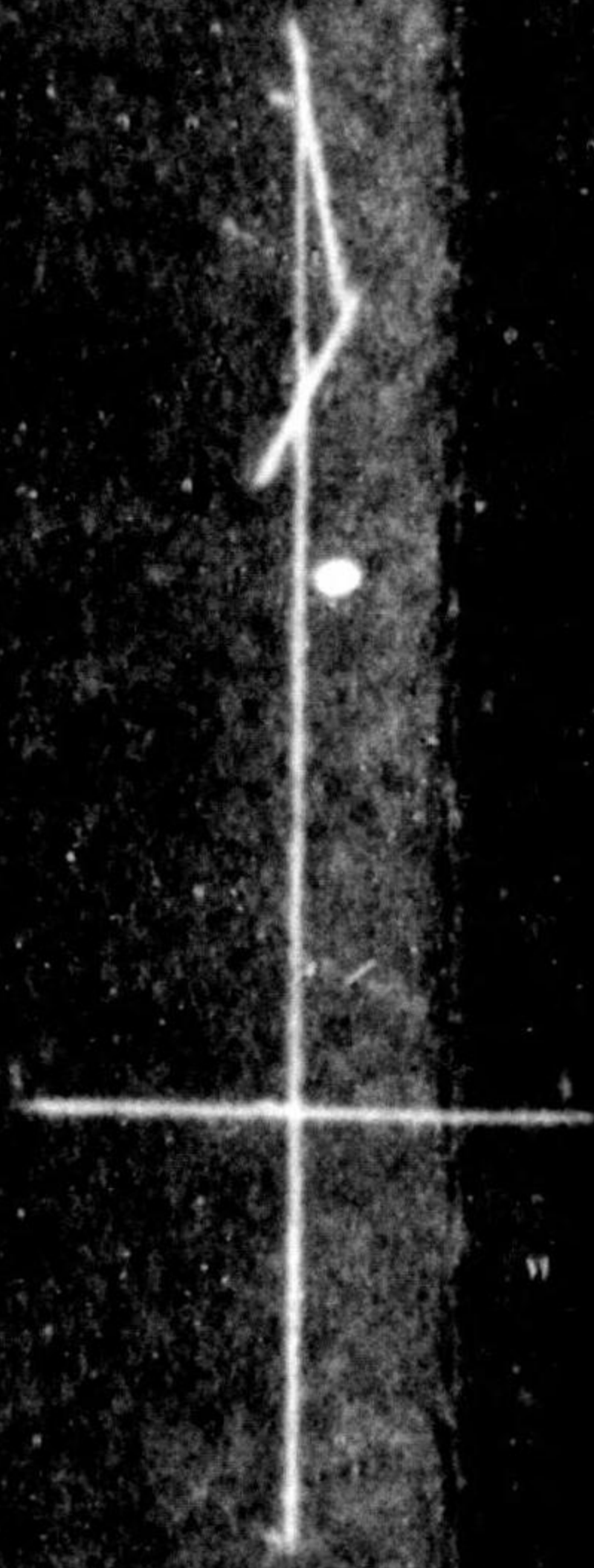

Hammer

Steam Hammer
1 1/2 Ton

No. 1
Forging
Shop

Hammer

Steam Hammer
1 1/2 Ton

3 Ton

5 Ton

5 Ton

w.c.

Finance

Doc

No. 2

C.1

Fireplace

Drop Hammer
100 kg

Drop Hammer
1/2 ton



No: 3 Forging Shop

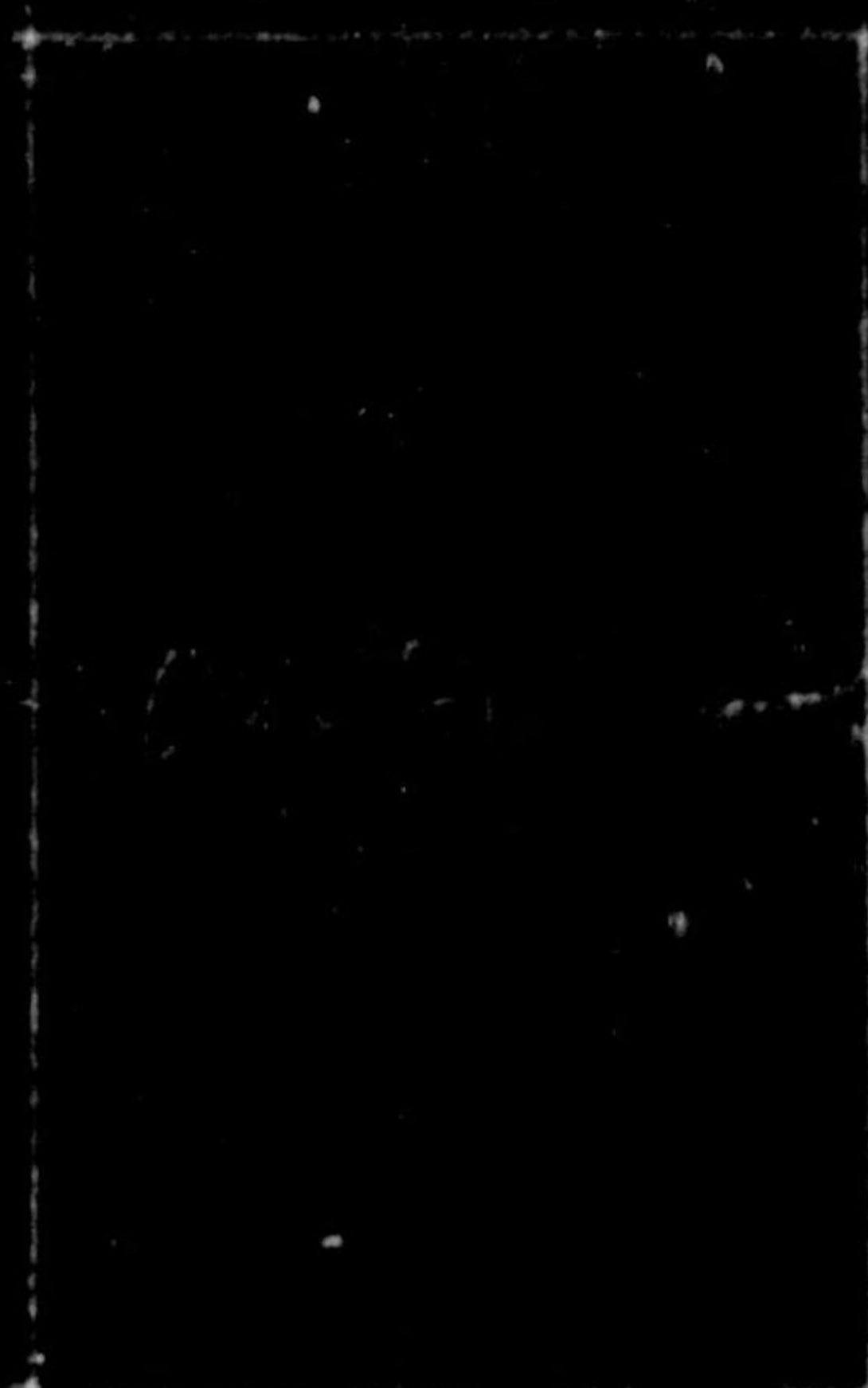

Drop Hammer
1/2 ton

No: 2 Forging Shop

5/8"



Drop Hammer
100 kg



Drop Hammer
100 kg

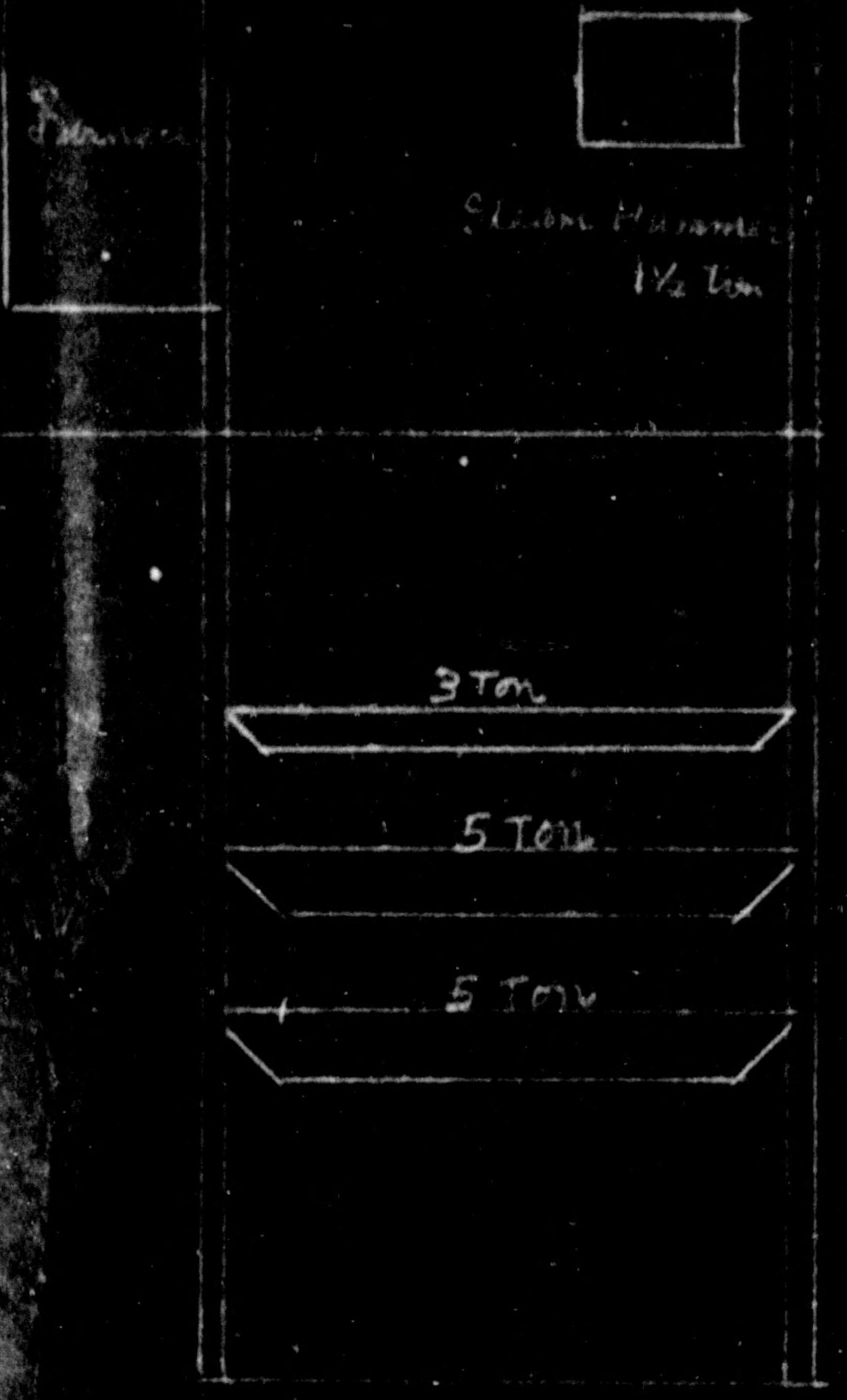
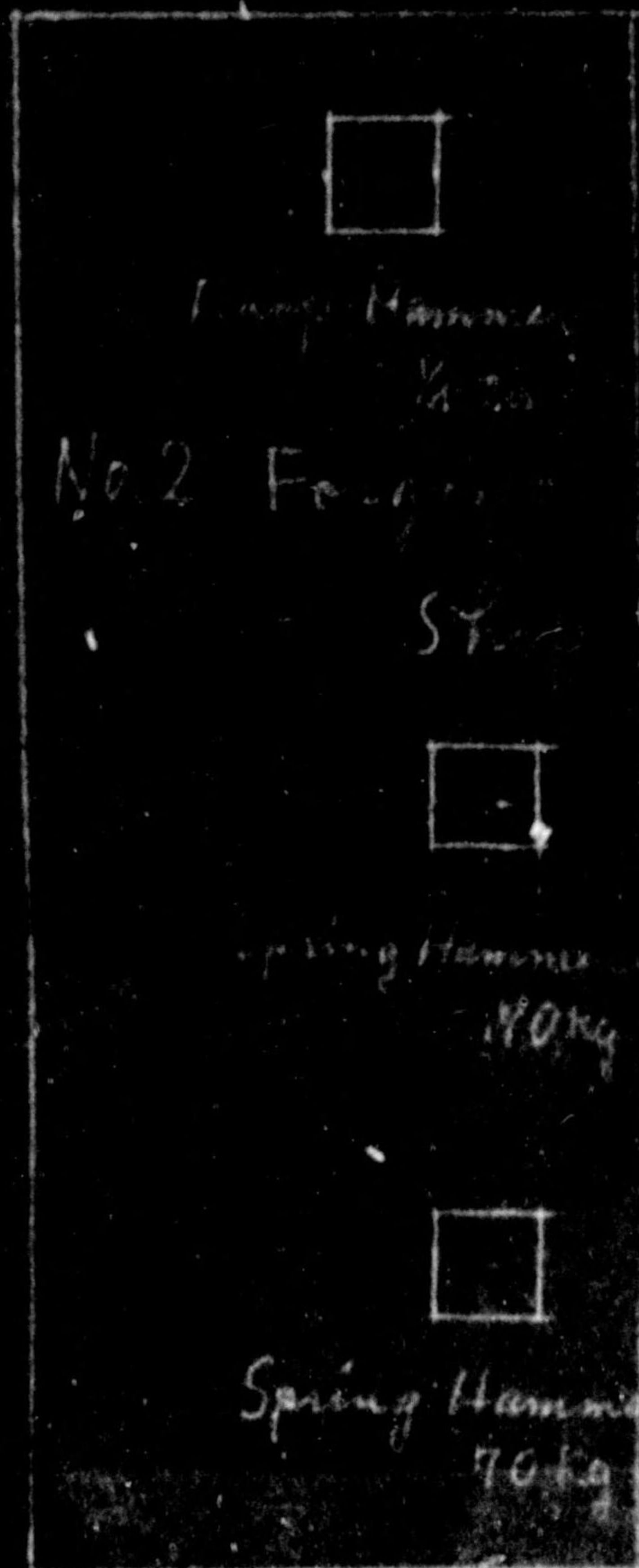

DATE	SUBJECT
26 Nov 48	Maintenance of Reparations Equipment

10

HEADQUARTERS
OSAKA MILITARY GOVERNMENT TEAM
APO 25

HCK/jwf/y1

26 November 1948

MEMORANDUM FOR: Osaka Prefectural Government
THROUGH: Osaka Liaison Office
SUBJECT: Maintenance of Reparations Equipment

1. Inspection made at the Osaka Shipbuilding Company on 20 November 1948 by this headquarters reveals the following deficiencies:

- a. Machines have surface rust.
- b. Roof needs repairing.
- c. Some machines are in one foot of water.

2. It is directed that this plant be inspected immediately by the prefectural government and a report submitted to this headquarters within two (2) days of receipt of this letter stating what action has been taken to correct above deficiencies.

MALCOLM E. CRAIG
Colonel, Infantry
Commanding

OSAKA M.G.
RE-3-COM-IND
FILE 0-2061

OSAKA LIAISON & COORDINATION OFFICE
Prefectural Building
OSAKA

*File
mg*

TS/ts

OLCO No. 614 RP

2 December, 1948

TO : Commanding Officer,
Osaka Military Government Team

SUBJECT: Maintenance of Reparations Equipments at
Osaka Shipbuilding Company

1. Reference: Memorandum, Headquarters, Osaka Military Government, 26 November, 1948, subject as above.
2. For your inspection.
3. Although the reference memorandum was addressed to Osaka Prefectural Government, the matter was referred to Kinki Maritime Bureau, as shipbuilding industry is under direct supervision of National Government and local governments have nothing to do with it.

S. Shima
S. Shima
Director

Incl: Letter from Kinki Maritime Bureau,
dated 30 November 1948.

OSAKA M.G
RES-COM-IND
FILE 1-4289

KINKI MARITIME BUREAU

Tel (53) 0083-0084

MINISTRY OF TRANSPORTATION

Osaka

30 November, 1948

TO : Osaka Military Government Team
THROUGH : Osaka Liaison and Coordination Office
SUBJECT : Integral maintenance of repairment Equipments of
Osaka Shipbuilding Company

1. Reference is made to your letter of November 26, 1948, with subject "Maintenance of repairment Equipment".

2. In regard to the items a., b. and c. indicated in paragraph 1 of the above reference, we wish to clarify the situations as follows:

a. Surface rust of the machines:- In spite of maintenance being carried on by several mechanics, number of which has been computed according to the base of calculation of the Transportation Ministry, we have to consider that it is hard to expect the perfect maintenance due to defectiveness of the roof and inundation in the plant as indicated in b. and c. of the above letter.

Since first general maintenance overhaul performed in April, 1947, this kind of overhaul has been repeated at every six months and a survey of smaller scale, once a month. However, it is not sufficient to prevent rust on the machines with such precautions as above-mentioned during rainy season and the period of flood tide; it may be added that it is much at to gather rust specially by the sea wind.

By the above reasons, it happens sometime to become rustily the machines although we urge and co-operate with the shipbuilding company to keep them in perfect conditions.

In connection with the rust in question, we wish to mention that it will be removed by November 30 after general survey.

b. Defectiveness of the roof:- The roof of the machine shop was completely repaired at the opportunity of the first overhaul using one ton of galvanizing steel plates supplied by us, but due to its age and war damage in general, the roof is being destroyed a part after another and from the view point of expenses, the company concerns itself about the repair which will be very heavy burden on it. Therefore, up to the present, pieces of tared wastes have been applied for checking the leakage or old scrap iron plates have been used for patch as for temporizing measures.

KINKI MARITIME BUREAU

Tel (53) 0083-0084

MINISTRY OF TRANSPORTATION

Ozaka

- 2 -

Nowadays as it has passed a certain period since the repair at the time of first general survey, such provisional measures as above are not of use in any way.

The quick damage of the roof are principally due to the fact that firstly the dockyard is situated on the beach consequently it is specially affected by the natural atmosphere such as rain and wind, and secondly, owing to variation of the foundation of the building caused by subsidence of the dockyard compound, the roof is affected by strong vibration each time when the overhead crane is used.

Since being in the case, as for the counter-measure, there is no alternative but to re-roof. To do so, it is confident that for several years such trouble like this case will not recur.

The renewal of the roof is estimated at ¥1,457,500.-, but it is not possible for the dockyard to reimburse such amount of money and it is not reasonable to request reimbursement of the expenses to the dockyard that is no inconvenience for the work even under the present condition.

c. Inundation in the compound:- The company had once projected to erect a bank of about 40 cm in height around the machinery shop in order to prevent from the inundation in the rain season and of flood tide for the period from summer to autumn because the ground of the dockyard is low level as a whole and tends to sink year after year.

In spite of this effort, the flood could not be prevented as the water welled out inside of the compound. In case of flood, the water is pumped out but while the river water level is higher than the dockyard compound, the complete pumping out cannot be expected owing to effusion from the ground. Therefore, as for counter-measure, it will be the only way to carry out the reclamation of about three feet thick all over the compound, for which approximately ¥. 3,830,000.- will be required.

To realize this plan, we cannot see our way clear but to request your consideration.

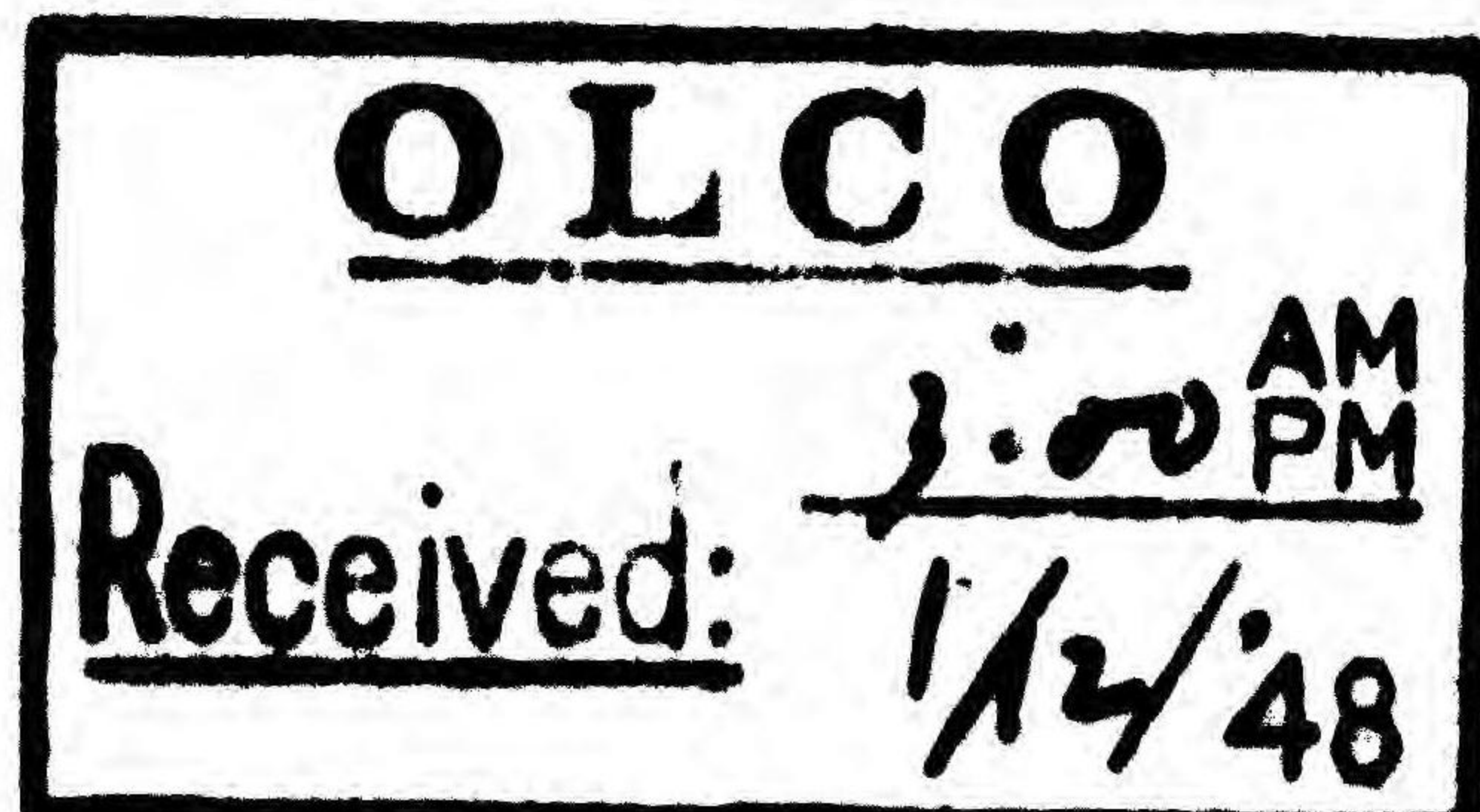

S. Nagai

SANETUKI NAGAI
Director
Kinki Maritime Bureau

TK/yy

Copy

TS/ts

OICG No. 614 RP

2 December, 1948

TO : Commanding Officer,
Osaka Military Government Team

SUBJECT: Integral Maintenance of Reparation Equipments
of Osaka Shipbuilding Company

For your inspection.

S. Shima
Director

Incl: the letter from Kinki Maritime Bureau,
dated 30 November 1948.

Tel (53) 0083-0084

KINKI MARITIME BUREAU

MINISTRY OF TRANSPORTATION

Owaka

30 November, 1948

TO : Osaka Military Government Team
THROUGH : Osaka Liaison and Coordination Office
BY : Internal instructions of repair shop equipments of
said shipbuilding company

1. Reference is made to your letter of November 26, 1948, with
subject "Condition of repair shop equipments".

2. In regard to the items a., b. and c. indicated in paragraph
1. of your letter, the following situations are
observed:

a. In spite of main-
tenance of the machinery, number of
of the repair shop, it is considered that it
is not to expect the perfect condition to be defective-
ness of the roof and inundation in the parts as indicated
in b. and c. of the above letter.

Since first general maintenance overhaul was carried in
April, 1947, a kind of overhaul has been repeated at
every six months and a survey of surplus scale, once a month.
However, it is not sufficient to prevent rust on the machines
with such precautions as above-mentioned during rainy season
and the period of flood tide; it may be added that it is
much at to gather rust specially by the sea wind.

By the above reasons, it happens sometime to become
rusty the machines although we urge and co-operate with
the shipbuilding company to keep them in perfect condition.

In connection with the rust in question, we wish to
mention that it will be removed by November 30 after general
survey.

b. Defectiveness of the roof:- The roof of the machine
shop was completely repaired at the opportunity of the
first overhaul using one ton of galvanized steel plates
supplied by us, but due to its age and war damage in general,
the roof is being destroyed a part after another and from
the view point of expenses, the company concerns itself
about the repair which will be very heavy burden on it.
Therefore, up to the present, pieces of tarred wastes have been
applied for checking the leakage or old scrap iron plates
have been used for patch as for temporizing measures.

KINKI MARITIME BUREAU

Tel (53) 0083-0084

MINISTRY OF TRANSPORTATION

Osaka

- 2 -

Nowadays as it has passed a certain period since the repair at the time of first general survey, such provisional measures as above are not of use in any way.

The quick damage of the roof are principally due to the fact that firstly the dockyard is situated on the beach consequently, it is specially affected by the natural atmosphere such as rain and wind, and secondly, owing to variation of the foundation of the building caused by subsidence of the dockyard compound, the roof is affected by strong vibration each time when the overhead crane is used.

As a counter-measure, there is no alternative but to re-roof. However, it is confident that if several counter-measures are taken, the same will not occur.

The renewal of the roof is estimated at ¥1,457,000.-, but it is not possible to carry out the repairs unless amount of money and it is not possible to request reimbursement of the expenses to the Government. It is no inconvenience for the Government even under the best condition.

c. Inundation in the compound:- The company had once projected to erect a bank of about 40 cm in height around the machinery shop in order to prevent from the inundation in the rain season and of flood tide for the period from summer to autumn because the ground of the dockyard is low level as a whole and tends to sink year after year.

In spite of this effort, the flood could not be prevented as the water leaked out inside of the compound. In case of flood, the water is pumped out but while the river water level is higher than the dockyard compound, the complete pumping out cannot be expected owing to effusion from the ground. Therefore, as for counter-measure, it will be the only way to carry out the reclamation of about three feet thick all over the compound, for which approximately ¥. 3,830,000.- will be required.

To realize this plan, we cannot see our way clear but to request your consideration.

S. Nagai

SHUNSUKE NAGAI
Director
Kinki Maritime Bureau

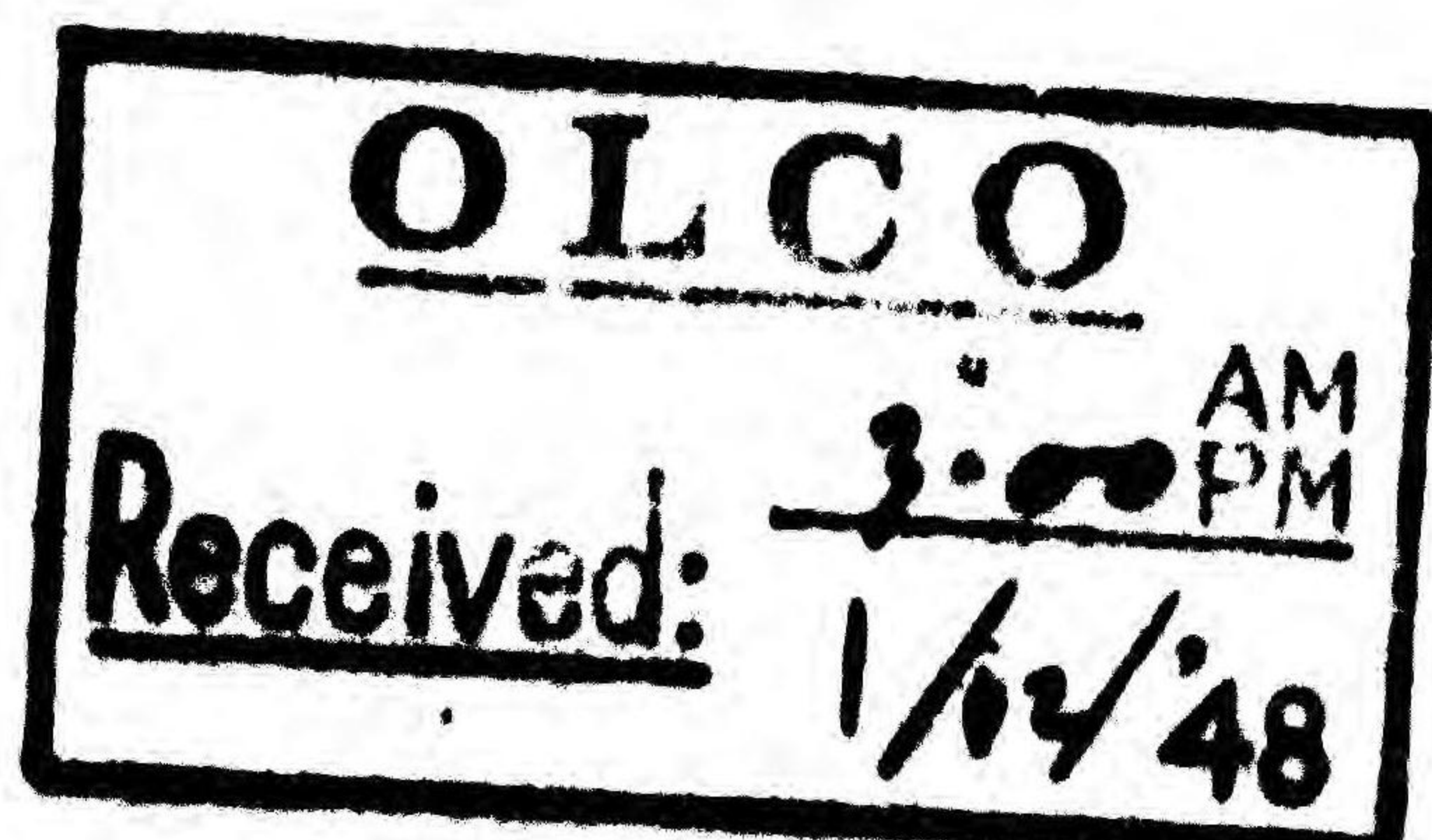

TK/YY

1-9

DATE	SUBJECT
------	---------

I D

DATE	SUBJECT

I B

DATE

SUBJECT

DATE	SUBJECT
5 Apr 46	Application for Operation of and Report on Industrial Facilities
5 Apr 46	Additional Description to Application for Operation of and Report on Industrial Facilities
27 Apr 46	Permit for Reconversion of the Osaka Shipyard
21 May 46	Permit for Operation
	Permit for Reconversion from War Production and for Resumption of Production of Essential Civilian Commodities
12 Jul 47	Authorization for the Temporary Use of Machinery
25 Aug 48	Use of Machine
20 Nov 48	Application for Permission to Continue Operations Designated Reparations
10 Feb 50	Use of Reparations Installation

HEADQUARTERS
KINKI CIVIL AFFAIRS REGION
APO 25 (Osaka, Honshu)

71-Id 1

32-128

II RAS/sy

10 February 1950

SUBJECT: Use of Reparations Installation

THRU: Kinki Liaison and Coordination Office

TO : Kinki Maritime Bureau

1. Use of Bldg. No. 18 at the Osaka Shipyard Company, 32-128, as a pilot plant for the production of vegetable oil extracting equipment, as requested by the inclosed application from your office, is approved.

2. Use of additional items of reparations equipment in connection with the pilot plant is not permitted unless specifically authorized by GHQ - SCAP.

3. Non-reparations equipment installed will be clearly indentified to indicate exempt status.

FOR THE CHIEF:

1 Incl:
As above

STERLIN C. MOORE
Major Inf
Deputy Chief

6 Feb '50

Subject: Application for Permit to
Use Reparatons Installation

1. Osaka Shipbuilding K.K. intends to manufacture vegetable oil extracting equipment. In order to market this new type of equipment, a demonstration unit is required. It is planned to utilize the welding shop at this plant for installation of a pilot plant.
2. Inspection was made on 6 Feb. There are two (2) cranes (II B4-15, 16) in the welding shop. No other inventoried items are currently stored in this shop.
3. Installation of pilot plant will not affect reparatons maintenance of this integrated facility.
4. Recommend approval ~~on basis~~ with understanding that newly installed items be identified by "EX".

W.H.M.

KINKI MARITIME BUREAU
MINISTRY OF TRANSPORTATION

Osaka, January 24, 1950.

TO : Kinki Civil Affairs Region
THRU : Kinki Division and Coordination Office
SUBJECT : Application for Permission of Temporary
Use of Repairs Installation

1. Osaka Shipbuilding Co., Ltd. designated to repairs under the jurisdiction of this office has submitted a petition, as per enclosed herewith, in order to transmit his request to you in connection with the above permission.

2. The applicant wishes to obtain permission to install a model plant in the compound of its factory with the object of demonstrating the ability of the oil extraction machine which is manufactured in the factory.

3. We shall be obliged if you give special consideration to the desire of the said company on the condition that the installation will not impede the integrity of maintenance of repairs.

For the Director

Kaneyoshi Akiyama

KANEYOSHI AKIYAMA
Manager, Ship Division,
Kinki Maritime Bureau

Incl: 1 Co's letter of
application
1 Blue print

TK/VJ

OSAKA SHIPBUILDING CO., LTD.
O S A K A W O R K S .

12 Jan., 1950.

FROM: Osaka Shipbuilding Co., Ltd., Osaka Works.
 No. 1, 2-chome, Minami-fukuzaki-cho, Minato-ku, Osaka.

THROUGH: Kinki Maritime Bureau.

TO: Kinki Civil Affairs Region.

SUBJECT: Petition for using Welding Shop for installation of
 Oil Extraction apparatus.

We have succeeded in planning new oil extraction apparatus, and intend to sell it in large quantities. To sell such new apparatus is by no means easy, because buyers do not understand easily the superiority of the apparatus by word of mouth only.

We, therefore, want to install "Model Plant" in our factory, so as to make buyers easily understand the superiority, by seeing the plant as it is.

For the place to install the plant, we want to use the welding shop and its ground (see blue print attached), because the above shop and ground will not hinder us from shipbuilding.

So we sincerely ask you for your special consideration to approve of our petition to use the said shop and ground for installing the "Model Plant".

Signature: *Kazuki Yamamoto*

KAZUKI YAMAMOTO
Managing Director.

40 Wa
ts
33 Store house
tubo 2
34 Store house
tubo 9
37 Watch man box
tubo 7



N

PLAN THE OSAK (THE K.K.

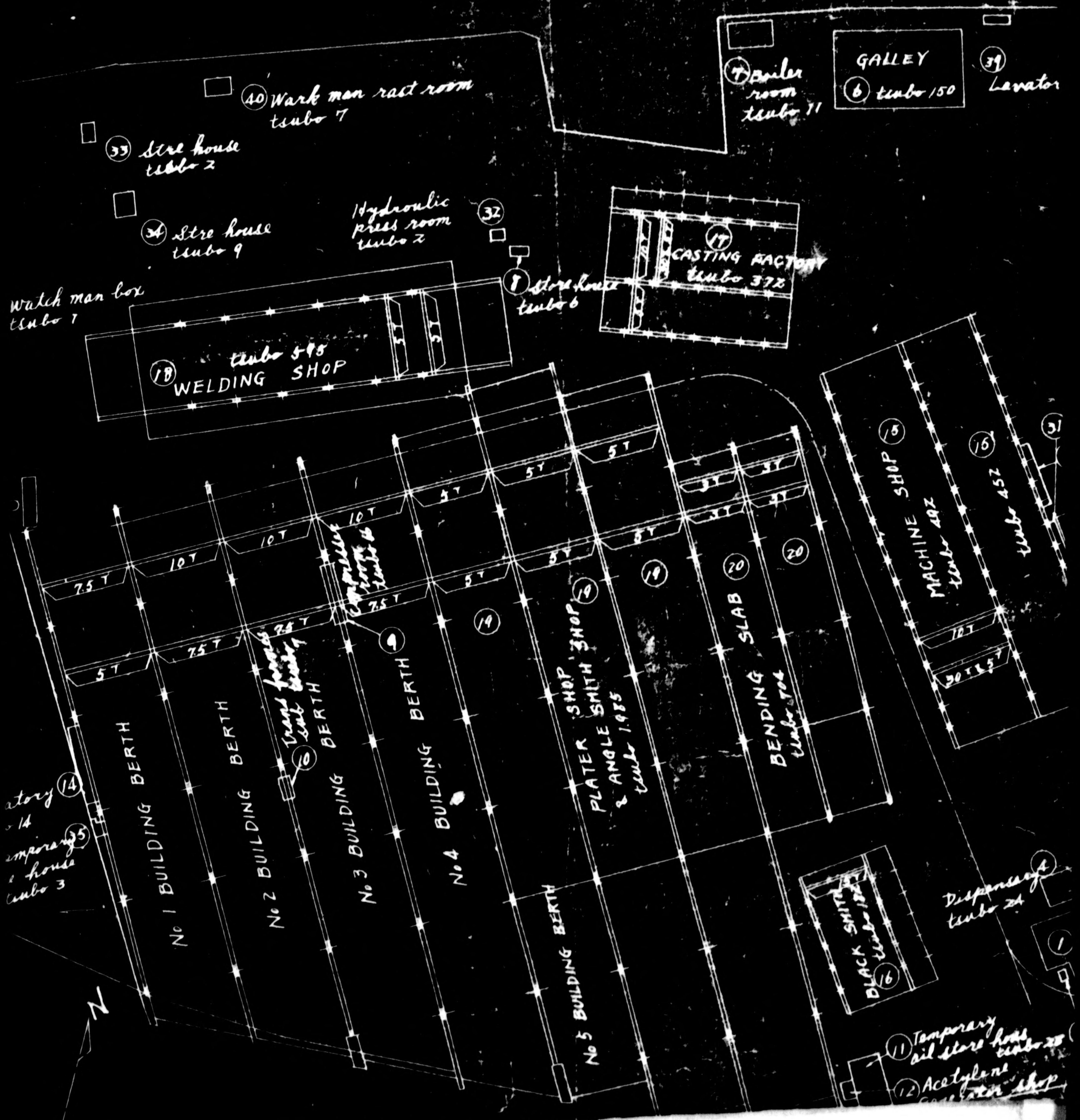

PLANT LAY OUT

THE OSAKA SHIPYARDS LTD OSAKA WORKS
 (THE K.K. OSAKA ZOSEN-SHO OSAKA KOJYO)

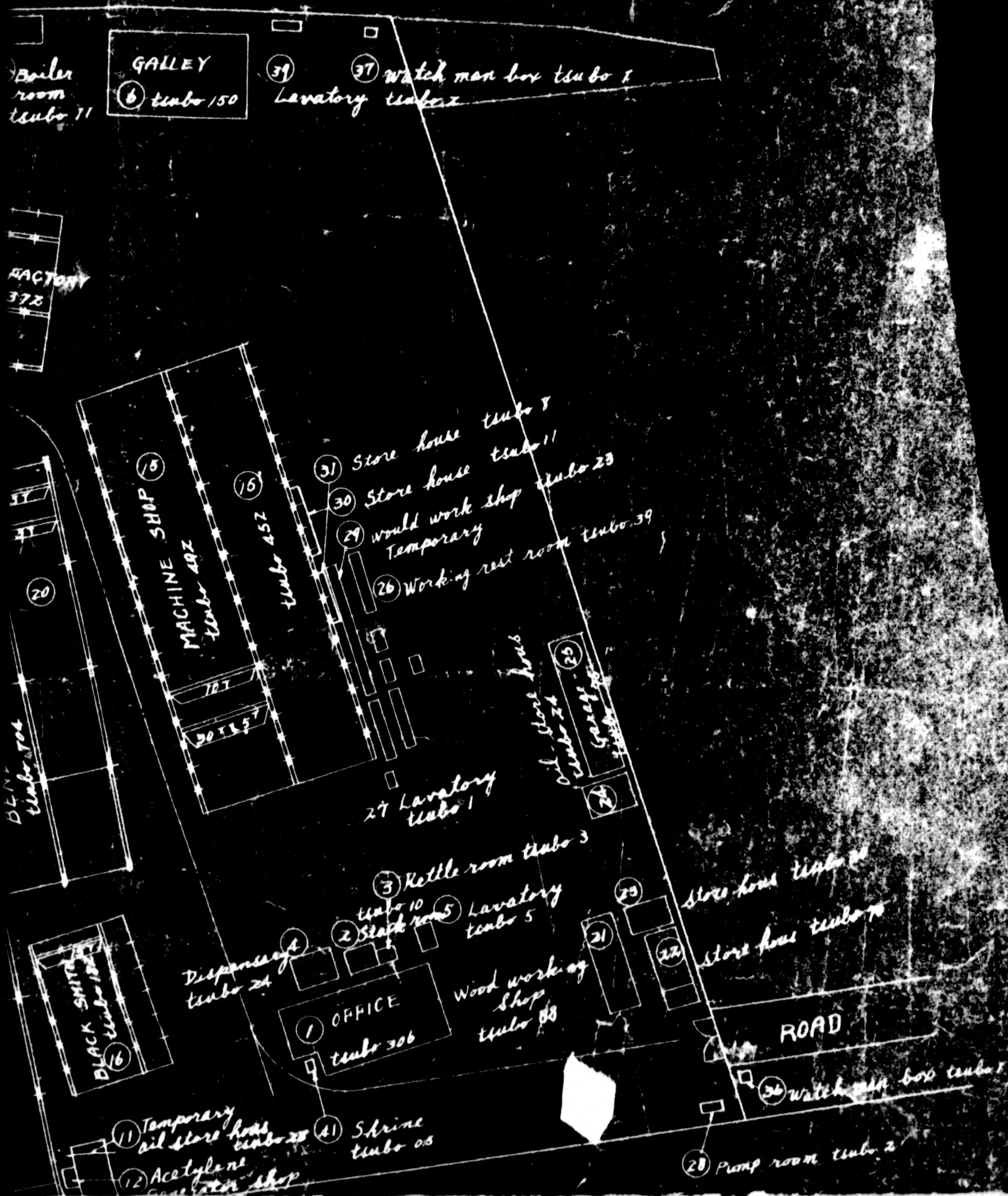



Lavatory (14)
tubo 14
Temporary (15)
store house
tubo 3

No 1 BUILDING BERTH

No 2 BUILDING BERTH

Inns for
sub berth
(S) BERTH

N

SIRINASHI - F

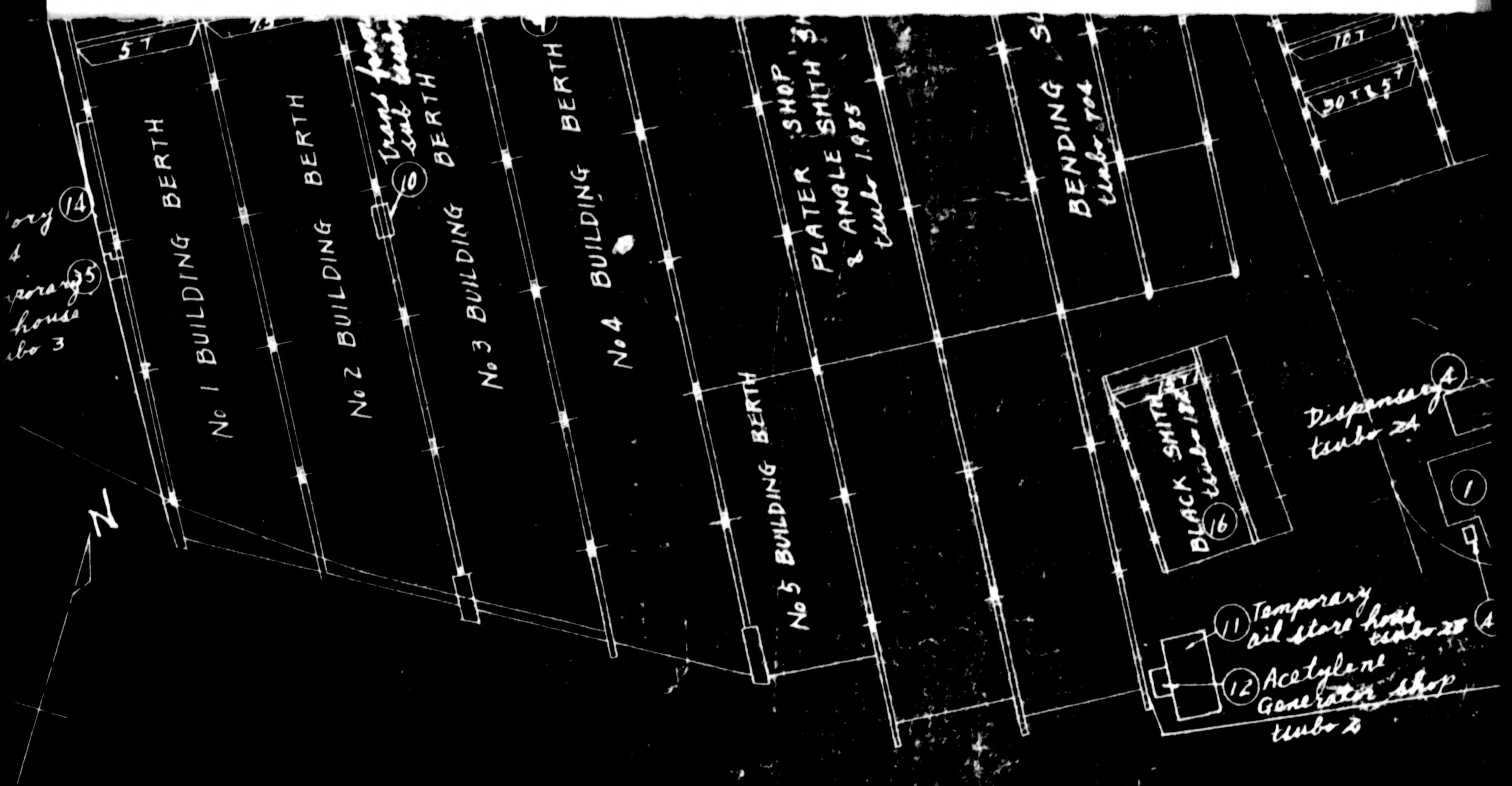

SIRINASHI - RIVER



APPLICATION FOR PERMISSION TO CONDUCT

OPERATIONS OF DESIGNATED CORPORATION IN AMERICA

Transportation Minister of Japanese Government.

Osaka Osensho (The Osaka Shipbuilding Co., Ltd.)
1-2-chome Inarifukuzaki-cho Inato-ku Osaka.
November 1940

1. Name of client Osaka Osensho (The Osaka Shipbuilding Co., Ltd.)

2. Location of client 1-2-chome Inarifukuzaki-cho
Inato-ku Osaka.

3. Name of products planned

- a) Shipbuilding & repairing
- b) Chemical plants & equipments
- c) Cast iron & gun-metal
- d) Plaster & girders
- e) Machinery
- f) Marine engines & auxiliary equipments
- g) Cars
- h) Engineering & constructing
- i) Wooden goods

4. Experience of the production planned

Items	Term experienced
a) Shipbuilding & repairing	13 years
b) Chemical plants & equipments	1
c) Cast iron & gun-metal	8
d) Plaster & girders	12
e) Machinery	10
f) Marine engines & auxiliary equipments	9
g) Cars	None
h) Engineering & constructing	8 years
i) Wooden goods	3

5 1939 - 1945 Production

Items	1939	1940	1941	1942	1943	1944	1945
a) Shipbuilding				3,329	13,137	5,682	
Shiprepairing	4,347	4,853	4,534		52	10,345	41
b) Chemical plants						one	none
Equipments							
c) Cast iron & gun-metal	one	one				13	4
d) Plater & Girders					19	one	none
e) Machinery						13	
f) Marine engines & auxiliary equipments	50	7	11	14			
g) Engineering & Constructing	one	2	20	40	11	73	

6. Scale of production planned by months for period on this application

F/Year	a) Shipbuilding	Shiprepairing	b) Chemical plants & equipments	c) Cast iron & gun-metal	d) Plater & Girders	e) Machinery	f) Marine engines & auxiliary equipments	g) Cars	h) Engineering & Constructing	i) Wooden goods
	10,000	4,000					2,000	13	500	2,400 cu. ft.

7. Period of desired permission

Full reparation removal.

8. Plan and Location to continue the production after reparation removal

Now, we are constructing 2 type cargo vessel which we are allowed to build by 2nd Shipbuilding Plan of SCAP, and yet 4th type cargo vessel construction will be allowed in the near future.

In coming year, we want to construct 3 or 4 type vessel. Specially, we have a firm confidence to be able to build best ship with our Contry Cranes at the possible lowest price.

All of us, employer and employees, are in high spirits to reconstruct our Japan and are eager to be released from reparation nomination.

It is very sorry to have no plan with us to tell you.

18. Details of proposed changes in physical facilities

None.

19. Anticipated expense for conversion or reconversion

None.

20. Name or location to which products are to be delivered.

For domestic, export and education forces.

Signed

Kagaki Minami

KAGAKI MINAMI

Title

Managing Director.

Equipments & Machinery

Building (ertnes' entry (ranes)

	1st Berta	2nd B.	3rd B.	4th B.	5th B.
Length	120 m	120 m	120 m	120 m	60 m
Width	16 m	16 m	16 m	16 m	16 m
Crane Number	2	2	2	2	2
Crane Capacity	7.5 T	7.5 T	7.5 T	7.5 T	5 T
Crane Lift Capacity	21.5 m	21.5 m	21.5 m	21.5 m	11.5 m
Crane Extension Capacity	100 m	115 m	120 m	135 m	60 m

Machinery

Inv.No.	Name	Quantity
I-A-1	Bending Machines	1 set
2	Hydraulic Presses	3 sets
3	Shearing & Punching Machines	7 sets
4	Miscellaneous	2 sets
5	Other Metal Working Machinery & Equipments	9 sets
I-C-1	Boring Machines	3 sets
3	Drilling Machines	2 sets
5	Grinding Machines	3 sets
6	Lathes	38 sets
7	Milling Machines	4 sets
8	Planers	4 sets
9	Miscellaneous Machine Tools	8 sets
I-D-1	Welding Machines, all types	38 sets
II-B-4	Cranes, overhead	26 sets
6	Hoist	5 sets
8	Winch	10 sets
IV-B-1	Compressors	3 sets
2	Pump	3 sets
V-A-1	Saw	5 sets
2	Surfacing Machines	2 sets
3	Lathes	1 set
4	Jointers, Matchers & Molders	1 set
9	Miscellaneous	9 sets

Copy of Permission Document

HEADQUARTERS 100th MG
No. 311 Kyoto, Honshu

100th MG

ref: 100 - 345

AG 344 - 10

3 May 1946

SUBJECT: Permit for reconversion from war-production and for
resumption of production of essential civilian commodities.

TO: OSAKA DENKYO K. K. OSAKA RIYARDS CO., LTD.
(Name and address of firm)

1 Minami-Fukuzaki-cho, 3-cho-me, Minato-ku, OSAKA

1. a. In accord with paragraph 3, b, Directive Number Three (3)
from the Supreme Commander to the Imperial Japanese Government, dated
22 September 1945, the OSAKA DENKYO K. K. OSAKA RIYARDS CO., LTD.
(Name of firm)

is permitted to immediately start production of a. rub coats
(Name of items)

b. lighter c. cast iron & gun-metal d. machines e. platers &
girders f. wood-working machines g. wooden goods h. salt i. flour
milling machines (NO ITEMS FOLLOW)

b. Maximum production currently authorized is per month

a. 1 b. 10 c. 300 f. 300 f. 50 g. 1200 cu.ft. h. 10
plants i. 10

2. The acquisition of materials, parts and sub-assemblies as
well as the disposition of finished products, and the establishment
of sales prices will be in accord with the regulations of the Imperial
Japanese Government.

3. Until otherwise directed by this headquarters, a monthly
report in English of each item, by name, type and quantity produced
by each factory, sub-contractor subsidiary within this factory's
control will be delivered to this office by the fifteenth (15) day
of the following month.

4. It is understood that this permit for reconversion is issued
subject to any and all directives affecting reconversion, ultimate
disposition or otherwise, which have been issued or may hereafter be
issued by the Supreme Commander for the Allied Powers or by this
headquarters.

BY COMMAND OF MAJOR GENERAL WOODRUFF:

(Signed)

H. B. TAYLOR
Major. AGD.
Asst. Adj Gen.

Info copy to:

SCAF (Attn: G-3) (1) (w/incl)
SCAF (Attn: G-2) (1) (w/incl)
CG Eighth Army (1) (w/incl)
(Attn: Mil Govt)
CG 94th MG Hq Group (1)
Kyoto Liaison Office (1)
Governor of Prefecture concerned (1)
Co. 109th MG Company (1)

HEADQUARTERS
OF THE MILITARY GOVERNMENT TEAM
APO 25

MMH/cjn/mh

25 August 1948

SUBJECT: Use of Machines

TO: Osaka Liaison Office

1. Reference letter, Kinki Maritime Bureau, subjects "Application for Full operation of Osaka Shipyard," dtd 23 June 1948.

2. The Osaka Military Government Team has never placed any restriction on the amount of reparations machinery and equipment which can be used in a reparations shipyard.

1 inclt
petition (1)

MALCOLM E. CRAIG
Colonel, Infantry
Commanding

OSAKA M.G
RES-COM-IND
FILE 0-797

KINKI MARITIME BUREAU

23rd June, 1948

TO : Osaka Military Government Team
THROUGH : Osaka Liaison And Coordination Office
SUBJECT : Application For Full Operation Of Osaka Shipyard

1. Approval was granted by G.H.Q. to construct 28 steel ships as the letter attached herewith. In accordance with the authorization, the Osaka Zosen K.K. (Osaka Shipyard) launched into construction of D type vessel on June 21, 1948.

2. After the termination of the war the company didn't see much brisk activity in construction of vessels, and as a result of it, resting rate of the plant showed as high as 90%. But recently their enthusiasm for construction of ships has gradually increased and has just succeeded in acquiring authorization to build D type vessel in spite of various difficulties.

File
3. As completion of the construction within the due terms of 6 months is deemed to need by any means full operation of the machines which have been hitherto been rested, we hereby beg your consideration and approval be given to this application.

For reference:

<u>Term</u>	<u>Resting Rate</u>	<u>Operation Rate</u>
Till October, 1947	90%	10%
" March, 1948	80%	20%
" May, 1948	40%	60%
At Present	0%	100%

4. Having 5 slips furnished with so many gantry cranes, the company takes a pride in its excellent shipbuilding facilities. So it is hoped that, once full operation of the machines is realized, the shipyard will make not a little contribution to the shipbuilding and shipping circles of post-war Japan. For this reason, your favourable consideration regarding reparation problem of this company will be much appreciated.

Saneyuki Nagai
SANEYUKI NAGAI
Director
Kinki Maritime Bureau

THE OSAKA SHIPBUILDING CO., LTD.
O S A K A W O R K S.

22 June 1948

FROM: Osaka Shipbuilding Co., Ltd.
THROUGH: Osaka Maritime Bureau.
TO: Osaka Military Government Team.
SUBJECT: Report of Laying the Keel and of Change of Resting
Machine Operation Rate.

We beg to report you that our application for permission to construct D type vessel has been accepted, as the attached copy, and are very glad to inform you that we laid the keel already on the 21st this month.

As the construction must complete within six months, we are intending to use resting machines. Consequently, the operation rate of our equipments and machines will be fully used.

Signature: Keiichi Nishiki

KEIICHI NISHIKI
Managing Director.

GENERAL HEADQUARTERS
SUPREME COMMANDER FOR THE ALLIED POWERS

AS 501 3 June 48/253/IN (SCAPIN 5682-A)

8 June 1948

MEMORANDUM FOR: JAPANESE GOVERNMENT

SUBJECT: Application for permission to Construct Steel
Cargo Vessels

1. Reference is C.I.C.C. letter No. 1221 (28) dated 10
April 1948, subject same as above.

2. Approval is granted to construct twenty-eight (28)
steel vessels as specified on the attached inclosure.

FOR THE SUPREME COMMANDER:

1 Incle (in dup)
List of steel vessels

A. J. Rehe
for R. M. LEVY
Colonel, AGD
Adjutant General

Received: 10 June 3.00 p.m.
Shukan : 2P
Copy : Chokan M of FA
Jicho
L. S. S. Bucho
1 0

LIST OF STEEL VESSELS (except Others)

Type 2,000 G.T.

NAME OF SHIPYARD

Osaka Zosen

OWNER

Meritaogyo.

GROSS TONNAGE

1,980

DEAD WT TONNAGE

2,800

ENGINE & SPEED

1100 HP Recipro
12 Kts

TIME REQUIRED FOR
COMPLETION IN MONTHS

6

NO. OF VESSELS

1

HEADQUARTERS
OSAKA MILITARY GOVERNMENT TEAM
APO 660

CJM/kn

11 July 1947

SUBJECT: Authorization for the Temporary Use of Machinery
Osaka Shipbuilding Co., Code No. 32-128

TO: Osaka Liaison Office

1. Reference to letter, Osaka Liaison Office, subj: Applications for Permission of Bringing Machines into the Reparations Plants, dated 8 July 1947.
2. Authorization is granted to utilize at the Osaka Shipbuilding Co. Ltd., the following machines on a temporary basis.
 - a. Hydraulic Press, capacity 400 tons, 2 sets
 - b. Accumulator, 6' dia. X 12' high, 1 set
 - c. Pump, 6,000 pounds, quaternity, 1 set
3. It is directed that you inform this headquarters when the above machines are no longer required.

FOR THE COMMANDING OFFICER:

1 Incl:
Petition

EDWARD B. MILLETT
Major, F. A.
Adjutant

OSAKA M.G
RES-COM-IND
FILE 36/



TS/ts

8 July 1947

SUBJECT: Applications for Permission of Bringing
Machines into the Reparations Plants.

TO : Headquarters, Osaka Military Government Team
(ATTN: Maj. Harmon)

This office hereby begs to forward to
your Headquarters for your kind consideration the
attached applications presented by Kinki Maritime
Transportation Bureau, dated 1 July 1947, subject
as above, about the following companies.

Sanoyasu Dockyard Co. Ltd.

Osaka Shipbuilding Co. Ltd.

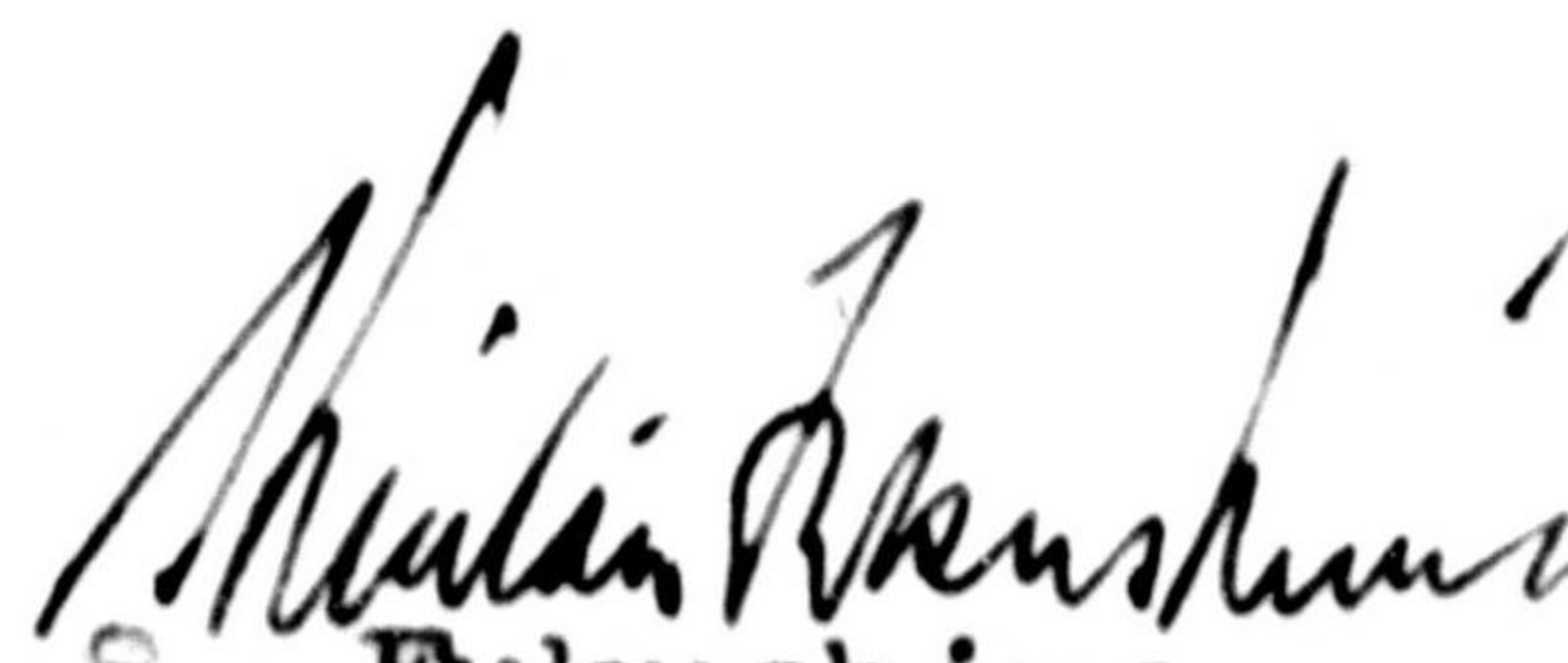
S. Fukushima,
Director-General,
Osaka Liaison Office.

Incls: above applications.

OSAKA M.G
RES-COM-IND
FILE 1786

~~COPY~~
Original

KINKI MARITIME BUREAU

1 July 1947

SUBJECT : Subsidiary petition for permission of bringing machines into the reparations plant compound.

THROUGH : Osaka Liaison Office.

TO : Osaka Military Government Team.

1. Enclosed please find the applications for permission of bringing a few machines into their reparations plants temporarily, which has been filed by the Osaka Shipbuilding Co., Ltd. and the Sanoyasu Dockyard Ltd..

2. In the case of the Sanoyasu Dockyard Ltd., these machines are to be utilized for getting satisfactory result of repairing marine engines, and in the case of the Osaka Shipbuilding Co., to be utilized for remaking war-damaged steel plates of oil tank.

3. The above mentioned works will greatly contribute to the shipbuilding circle.

4. It is requested that approval be given to these respects.

Saneyuki Nagai
SANUYUKI NAGAI
Director
Kinki Maritime Bureau

APPLICATION FOR PERMISSION OF
UTILIZATION OF MACHINES FOR A SHORT PERIOD

To : Osaka Military Government Team

Through: Osaka Liaison Office

K. K. SANoyASU DOKKU
(Sanoyasu Dockyard, Ltd.)
335, Kitakagaya-machi, Nishinari-ku,
O S A K A

June 13, 1947

We beg herewith to apply for your permission of utilization of following machines for a short period.

1. Specific Description of Machines:

<u>Item</u>	<u>Size & Type</u>	<u>Quantity</u>
Lathe	36' - 0"	1 set
Pin Lathe		1 "
Planer	16'-0" Open Type	1 "
Boring Machine		1 "

2. Purchased from:

Name: K. K. Kobe Hatsudoki Seizosho

Address: 10, Susano-dori 8-chome, Hyogo-ku, Kobe

- Reason:
3. To repair the engine of ship in our dock we are unable to secure a satisfactory result by the present plant equipment, so we wish to get satisfactory repair as well as to shorten the repair hours by utilizing of the above machines for a short period.

4. Location:

At No. 1 Machine Shop, Sanoyasu Dockyard, Ltd.

Y. Sanogawatani
YASUTARO SANOGAWATANI
President
Sanoyasu Dockyard, Ltd.

1785

Osaka, June, 1947.

Osaka Shipbuilding Co., Ltd.
1-3-1, 3-chome, Minatogawa-cho, Minato-ku, Osaka-city.

Osaka Military Government Camp No. 10.

Osaka Maritime Bureau.

Petition for permission of bringing machines into our compound.
In order to levelling air-raid steel plates by borrow machines
from other iron works and bring them into our factory.

We get order of remaking the air-raid steel plates all tanks settled
at the Maruzen Sekiya Co., Ltd., Minotsu, Higashinari-cho, from the
Seigai Seiko-sho, 10-1-1, 5-chome, Imazumi, Higashi-ku, Osaka-city.

As our own hydraulic presses have only 15 ton capacity each and it
takes much expense to repair them to their original state, we should like
to borrow the below mentioned suitable machines from the Mukai-Gumi (The
Manager: Morizo Mukai), 3-chome, Tezukayama-nishi, Sumiyoshi-ku, Osaka-
city, and use them after settling in our Bendine lab during this works
finished.

Please give us your special consideration to bring these machines
in our compound.

Amount of air-raid steel plates. abt. 1,500 tons.

Date of finished: October 1947.

Description of machines:

Hydraulic press, Capacity 400 ton	- - - - -	2 sets
Accumulator, 6' dia. x 12' high	- - - - -	1 set
Pump, 6,000 lbs., quaternity	- - - - -	1 set

Signature. K. Minami
KAGARI MINAMI
(Managing Director)

Ref: IG - 948

AG OOL - 3A

SUBJECT: Permit for Reconversion from War Production and for Resumption of Production of Essential Civilian Commodities.

TO: OSAKA ZOSENSHO K.K. (Osaka Shipyards Co., Ltd.)
(Name and Address of Firm)

1 Minami-Fukuzakicho, 2-chome, Minato-ku, Osaka.

1. a. In accord with paragraph 3, b, Directive Number Three (3) from the Supreme Commander to the Imperial Japanese Government, dated 22 September 1945, the Osaka Zosenso, Kabushiki Kaisha
(Name of Firm)

is permitted to immediately start production of a. Tug Boats
(Name of Items)

b. Lighter c. Cast Iron & gun-metal d. Machines e. Plates & girders

f. Wood-working machines g. Wooden goods. h. Salt i. Flour milling machines (NOTHING FOLLOWS)

b. Maximum production currently authorized is (per month)

a. 1 b. 10 c. 600 T d. 360 T e. 1200 T f. 50 g. 1200 cu.ft. h. 10 plants i. 10

2. The acquisition of material, parts and sub-assemblies as well as the disposition of finished products, and the establishment of sales prices will be in accord with the regulations of the Imperial Japanese Government.

3. Until otherwise directed by this headquarters, a monthly report in English of each item, by name, type and quantity produced by each factory, sub-contractor subsidiary within this factory's control will be delivered to this office by the fifteenth (15) day of the following month.

4. It is understood that this permit for reconversion is issued subject to any and all directives affecting reconversion, ultimate disposition or otherwise, which have been issued or may hereafter be issued by the Supreme Commander for the Allied Powers or by this headquarters.

BY COMMAND OF MAJOR GENERAL WOODRUFF:

Info copy to:
SCAP (Attn: ESS) (1) (w/incl)
SCAP (Attn: 3-2) (1) (w/incl)
CG Eighth Army (1) (w/incl)
(Attn: Mil Govt)
CO 94th MG Hq Group (1)
Kyoto Liaison Office (1)
Governor of Prefecture concerned (1)
✓ CO 109th MG Company (1)

3 JUN 1945

HEADQUARTERS I CORPS
APO 301 (Kyoto, Honshu)

EHN/ks

Annex No. 1

Permit No. IG-348

1. This permit authorizes you to construct ships under 100 gross tons only. In the following instances you will submit applications to the Supreme Commander for the Allied Powers through the Central Liaison Committee:

- a. Construction of new ships over 100 tons.
- b. Continuation of construction of partially completed merchant ships or demilitarized vessels.

2. Construction of trawlers of 270 gross tons and reconstruction of Navy Life Saving Boats come within the intent of paragraph 1a above. You will act accordingly with the above mentioned instructions.

HEADQUARTERS
109TH MIL GOVT HQ & HQ CO
APO 660

J. L.

HHH/rc

21 May 1946

SUBJECT: Permit for Operation (Osaka Zosen-sho K. K.)
THRU : Osaka Liaison Office
TO : Osaka Zosen-sho K. K. (Osaka Shipyards Co., Ltd.)
1 Minami-fukuzaki-cho, 2-chome,
Minato-ku, Osaka

1. Attached herewith permit No. IG-348 which allows you to manufacture certain specified items in specific quantities.

2. In order to obtain permission to construct new ships of over 100 gross tons or continue construction of partially completed, demilitarized ships, you will apply through the Japanese Central Liaison Committee to the Supreme Commander for the Allied Powers.

3. You will further make a monthly report of your production to this headquarters.

4. Any violation of or deviations from the terms of this permit will be considered sufficient cause for cancellation.

BY ORDER OF LT COLONEL TWAY:

ROBERT R RICH, JR
Captain, TC
Adjutant

1 Incl.
Permit for Operation.

HEADQUARTERS
109TH MIL GOVT HQ & HQ CO
APO 660

27 April 1946

SUBJECT: Permit for Reconversion of the Osaka Shipyards, Ltd.,
(K.K. Osaka Zosen-Sho).

TO : Commanding Officer
94th Hq & Hq Det Mil Govt Gp
APO 660 (Osaka, Japan)

1. Life Saving Boats shown in Pars 5a, 3, 7, were built for Japanese Navy Fleet Administration and are 50 and 75 percent complete. Permission is requested by the company to complete for use as cargo ships.

2. Reference to Pars 5a, 3, 10, subject: Trawlers. These crafts are for fishing purposes.

3. Request temporary permit be granted for manufacture of items exclusive of boats in excess of 100 tons and application forwarded to higher headquarters for action relative to these items.

FOR THE COMMANDING OFFICER:



HERBERT H HARMON
Major, TC
Resources and
Industry Officer

1 Incl.
4 copies of application.

BASIC: Ltr, Hq 109th Mil Govt Hq & Hq Co, APO 660, dated 27 Apr 46
Subj: "Permit for Reconversion of the Osaka Shipyards, Ltd.,
(K.K. Osaka Zosen-Sho)."

1st Ind

Hq, 94th Hq & Hq Det Mil Govt Gp, APO 660 (Osaka, Japan) 30 Apr 46

TO: CG, I Corps, APO 301

Reference subject matter. Information forwarded to higher
authorities for approval.

For the Commanding Officer:

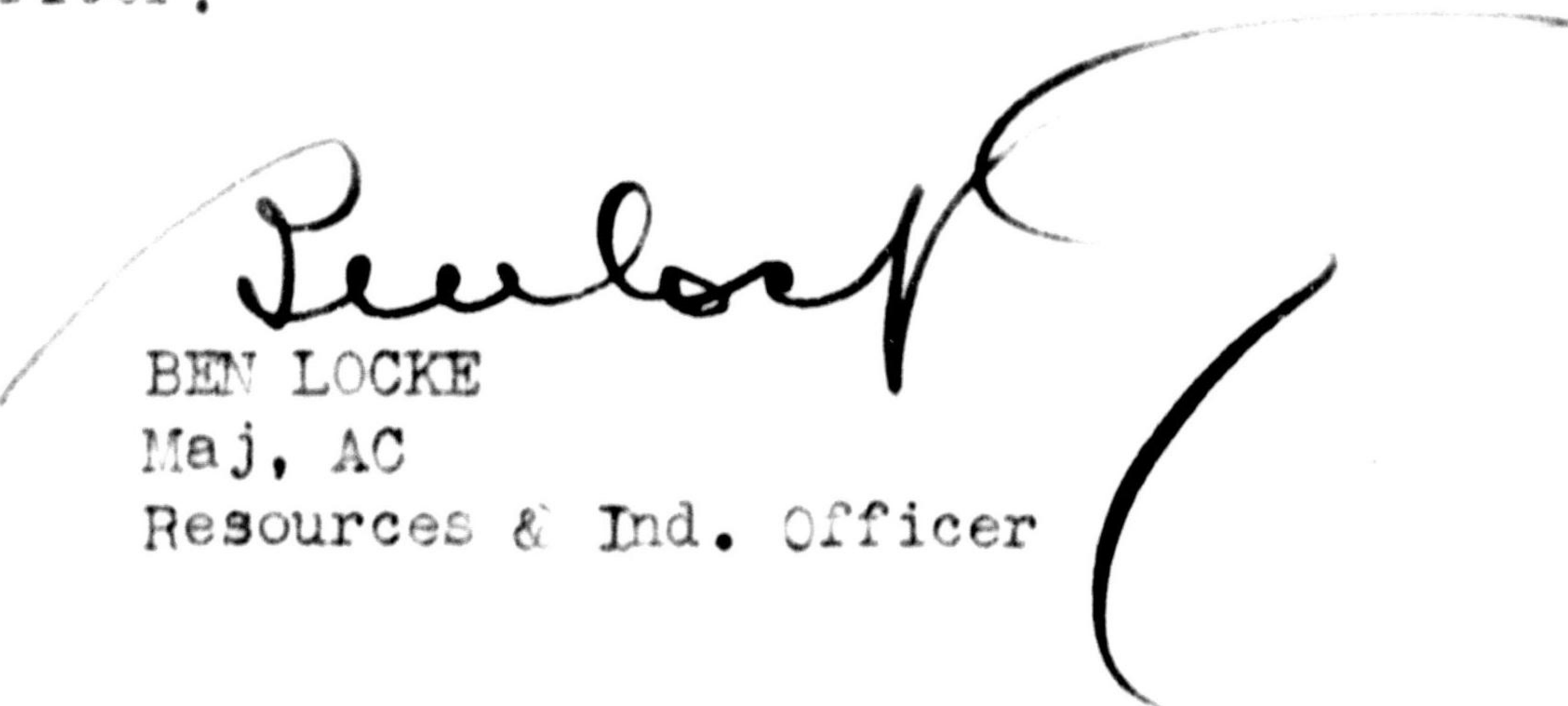
BEN LOCKE
Maj, AC
Resources & Ind. Officer

Incl:
n/c

513092

BASIC: Ltr, Hq 109th Mil Govt Co, Subj: "Permit for Reconversion of the Osaka Shipyards, Ltd., (K.K. Osaka Zosen-sho)", dtd 27 Apr 46.

AG 004 - BA

2nd Ind

EHN/ks

Hq I Corps, APO 301, 13 MAY 1946

TO: CO, 94th Mil Govt Gp, APO 660.

1. Reference is made to Operational Directive No. 18, Headquarters Eighth Army, 12 February 1946.

2. Request of subject company for permission to reconvert navy life saving boats, and the construction of trawlers of 270 gross tons mentioned in paragraph 5a, 3, 10 of application, cannot be approved. A reconversion permit authorizing productions of items other than the two above mentioned was issued by this headquarters under date of 8 May 1946, two copies and original of which are appended hereto. The original permit is to be forwarded to the subject company.

3. You are directed to inform the Osaka Zosen-Sho, that in order to construct new ships over 100 gross tons, or to continue construction of partially completed demilitarized snips, they will apply through the Japanese Central Liaison Committee, to the Supreme Commander for the Allied Powers.

BY COMMAND OF MAJOR GENERAL WOODRUFF:

H B Taylor

H. B. TAYLOR

Major AGD

Asst. Adj. Gen.

1 Incl:

1. w/d

Added

2. Permit (trip)

BASIC: Ltr, Hq 109th Mil Govt Hq & Hq Co, APO 660, dated 27 Apr 46
Subj: "Permit for Reconversion of the Osaka Shipyards, Ltd.,
(K. K. Osaka Zosen-sho)".

3d Ind

Hq, 94th Hq & Hq Det Mil Govt Gp, APO 660 (Osaka, Japan) 17 May 46

TO: CO, 109th Mil Govt Hq & Hq Co, APO 660 (Osaka)

Forwarded for your compliance with 2nd Indorsement.

By order of Lieutenant Colonel ATWOOD:

BEN LOCKE
Maj, AC
Resources & Ind. Officer

Incl:
Permit IG 348

20 MAY 1946

80
1400

ADDITIONAL DESCRIPTION TO
APPLICATION FOR OPERATION OF AND REPORT ON
INDUSTRIAL FACILITIES

(Sent in on the 5th of April 1945)

----- o ----- o ----- o ----- o ----- o -----

Name of Facility: The Osaka Shipyards, Ltd. (The Osaka Zosen-sho)

Location: No.1, 2-chome, Minamifukuzaki-cho, Minato-ku, Osaka.

----- o ----- o ----- o ----- o ----- o -----

<u>Item 6.</u>	Crane	Main 30 T., Auxl. 5 T.	- -	2	Perfect
		10 T.	- - - - -	3	"
		5 T.	- - - - -	9	"
	Acetylene Gas-Producer				
		Capacity: 0.83 m ³	- - -	1	"
		0.58 m ³	- - -	2	"
	<u>Naval Articles in Custody</u>				
	Edge Planing Machine		- - - - -	1	"
		2 mm x 6,000 mm			
	Straightning Roller		- - - - -	1	"
		12 mm x 6,000 mm			
	Punching & Shearing Machine		- - -	1	"
		Punching: 12 mm x 25 mm dia.			
		Shearing: 12 mm x 6,000 mm			
	Angle Cutting Machine		- - - - -	1	"
		12 mm x 100 mm x 100 mm			
	Bevelling Machine		- - - - -	1	"
		15 mm x 125 mm x 125 mm			
<u>Item 7.</u>	Reciprocating Engine (Capacity: 1,400 I.H.P.)				
		Percentage of Completion			
		80%	- -	1	Unfinished
		30%	- -	1	"
	White Metal		- - - - -	3,000 kg	Perfect
<u>Item 8.</u>	Tag-Boat (Osaka Mary)		- - - - -	1	Flooding
		(About 8 Gross Ton)			
	Turbing		- - - - -	4	"
		Capacity: 2,000 S.H.P.			

Item 8. Government Supply Goods

(Ct'd)	Water Tube Boiler - - - - -	13	Perfect (Flooding)
	Capacity: Heating Surface	159.5 m ²	
	Steam Pressure	20 kg/cm ²	
	Fuel Oil Pump - - - - -	6	" "
	Capacity: 100 x 180 x 75 mm		
	Fan Engine (Turbine) - - - - -	18	" "
	Capacity: Exhaust Steam	9 M ³ /Sec.	
	Feed Water Heater - - - - -	7	" "
	Capacity: Unknown.		
	Water Pump (Ware type) - - - - -	5	" "
	Capacity: 250 x 300 x 180 mm		
	Air Pump (Ware type) - - - - -	3	" "
	Capacity: 140 x 200 x 250 mm		
	Ejector (for Turbine) - - - - -	7	" "
	Capacity: Unkown.		
	Oil Survice Pump (Ware type) - -	16	" "
	Capacity: Steam Cylinder	140 mm dia.	
	Oil Cylinder	175 mm "	
	Stroke	350 mm	

- 2 - (Report on Industrial Facilities)

<u>Year</u>	<u>Annual Value in Yen</u>	<u>Principal Products</u>	<u>Quantities</u>
1940	¥ 4,700,000.	650 G.T. type Semi-Diesel Cargo Ship	1
		1,900 G.T. type Cargo Ship	2
1941	¥ 6,000,000.	1,900 G.T. Cargo Ship	1
		1,300 G.T. Cargo Ship	2
		200 G.T. Cargo Ship	1

d. Present capitalization in Yen ¥ 11,000,000. (full paid)

e. Changes made in capital structure since 1935

- Established on April 25, 1936 with the capital of ¥ 500,000.
- Capital increased to ¥ 5,000,000 on August 23, 1938 and the first call of one-fourth (¥ 1,250,000) paid.
- Second one-fourth call of new shares (¥ 2,250,000.) paid in the latter half of the fiscal year 1940.
- Last one-half call of new shares (¥ 2,250,000) paid in the first half of the fiscal year 1941, which resulted in the total amount having been fully-paid.
- 1st September, 1942 amalgamated "The Tokyo Steel Works, Ltd." having the capital of ¥ 6,000,000 of which ¥ 3,750,000 only had been paid and as the result the capital was increased to ¥ 11,000,000.
- Outstanding shares of ¥ 2,250,000 only were paid on June 1, 1944; thus, the capital was completely paid in full.

f. Name and address of parent company None.

g. Number of ^{shares} ~~shares~~ outstanding. 220,000 (face-value ¥ 50.)

h. Number of stockholders (Give names of those owning 10% or more of total) *See annex # 1-4 H attached*
2,033 (None hold share amounting to 10% or more of the capital)

i. Funds received from Government (Bounties, subsidies, etc.)

<u>Loan</u>	Senji Kinyu-Kinko <i>see annex # 1-4 J attached</i>	
	(The War Financial Depository)	¥ 7,050,000.
<u>Advanced Money</u>	The Naval Department	¥ 3,147,978.
	Gangyo Setsubi Eidan	
	(The Industrial Equipment Association)	¥ 221,875.

- 3 - (Report on Industrial Facilities)

j. One reverse-side give-outline sketch of plant layout with approximate dimensions.

Attached

5. Description

a. Principal Products

1. Wartime Cargo-ship, Life-saving-boat, CB-Boat.
2. At Present 42" Circular Sawing Machine.

3. Planned for 1946-1947.

- 1) Cast Iron & Gun-metal
- 2) Machine for mining, transportation & engineering.
- 3) Wood Working Machine
- 4) Wooden Goods
- 5) Self-manufacture Plant
- 6) Plate & ~~Garment~~ Work *Girders*
- 7) Reconstruction of Life-saving Boat (2-ship - 300 G.Tons.)

	<u>Beginn to rebuild</u>	<u>Launched</u>	<u>Finished</u>
	May/46	Aug/46	Nov/46
	Jul/46	Oct/46	Jan/47
8) Tag-Boat	<u>Keel laid</u>	<u>Launched</u>	<u>Finished</u>
	Nov/46	Feb/47	Apr/47
	Dec/46	Mar/47	May/47
9) Lighter (10-ship)			
10) Trawler (270 G.T.)	<u>No. of -hip</u>	<u>Keel laid</u>	<u>Launched</u>
	61	Jul/46	Nov/46
	62	Aug/46	Dec/46
	63	Sep/46	Jan/47
	64	Oct/46	Feb/47
	65	Nov/46	Mar/47
	66	Jan/47	Apr/47
	67	Feb/47	May/47
	68	Mar/47	Jun/47
	69	Apr/47	Jul/47
	70	May/47	Aug/47
	71	Jun/47	Sep/47
	72	Jul/47	Oct/47
	73	Aug/47	Nov/47
	74	Sep/47	Dec/47
	75	Oct/47	Jan/48
	76	Nov/47	Feb/48
	77	Dec/47	Mar/48
	78	Jan/48	Apr/48
	79	Feb/48	May/48
	80	Mar/48	Jun/48

- 4 - (Report on ~~Alia~~ Industrial Facilities)

b. Capacity

Navy - War Dept.

1. Wartime	"B-Boat	22.	
2. At Present	Circular Towing Machine Trawler (270 G.T.)		50 Sets 1-ship
3. 1946-47 (With unre-stricted access to material-)			
		<u>1946</u>	<u>1947</u>
Trawler (270 G.T.)	- - - -	0	16
Recon-struction of			
Life-saving Boat	- - -	1	1
Tag-Boat	- - - - -	1	1
Lighter	- - - - -	0	10
Cast Iron & Gun-metal	- -	400 T.	600 T.
Machine- for mining, tran- portation & engineering	- - -	240 T.	360 T.
Plate & Gwilder Work	- - -	800 T.	1,200 T.
Wood Working Machine	- - -	50	0
Wooden Good-	- - - - -	480 koku	720 koku
Wood Working	- - - - -	8,000 koku	12,000 koku
Salt-manufacture Plant	- -	10	0
Flour-mill Machine	- - -	10	10

c. Number of Employees

1. Wartime	Labour	4,203	Other	210
2. At Present	"	104	"	16
3. 1946-47 (At maximum capacity)				
		<u>1946</u>	<u>1947</u>	
	Labour	1,230	1,980	
	Other	60	90	

* 6. Machinery & Equipment in Plant

See appendix #1 for types

Description	Quantity	Condition
Building Berth (100m. x 20m.)	4	Perfect
" " (50m. x 10m.)	1	"
Gantry Crane		
Building Berth No.1 (7.5 * 5 T.)	2	"
" " No.2 (10 * 7.5 T.)	2	"
" " No.3 (" ")	2	"
" " No.3 (" ")	2	"
* Crane 5 T. to 30 T.	14	"
Smith Hearth (15x2.5x2m.)	1	"
Surface Plate	154	"
Transformer 1,000 KVA	3	"
300 "	3	"
150 "	3	"
300 "	2	burnt down
200 "	3	" "

See appendix #1 for types

- 5 - (Report on Industrial Facilities)

Description	Quantity	Condition
Transformer 100 KVA - - -	2	Burnt down
" 50 " - - -	1	" "
Air Compressor 200 HP - - -	2	Under repair
" 150 HP - -	4	Burnt down
" 150 HP - -	2	Under repair
" 100 HP - -	2	Burnt down
" 75 HP - -	1	" "
" 75 HP - -	1	Under repair
Electric Welder (10 Kw) -	20	Perfect
" " " " -	19	Burnt down
Smelting Furnace for Pig Iron and its equipment - - (1 each of 5, 3, & 1 T. capacity)	3	Perfect
Smelting Furnace for Gun-Metal (250 kg capacity)	1	"
Punching Machine 10 HP	1	"
Punching & Shearing Machine	4	"
Plate Shearing Machine 1000 mm	1	"
Hydraulic Press & Pump 150 T.	1	"
" " " " 150 T.	1	Unfinished
Edge Planing Machine 20'-0"	1	Perfect
Plate Straightening Roller 7'-0"	1	"
Bending Roller 12'-0"	1	"
Beam Bender 20 HP	1	"
Lathe 4' - - - - -	1	"
" 6' - - - - -	11	"
" 8' - - - - -	14	"
" 12' - - - - -	1	"
" 16' - - - - -	1	"
" 22' - - - - -	1	"
" 28' - - - - -	2	"
" 30' - - - - -	2	"
Turret Lathe 6' - - - - -	1	"
Face Lathe 8' - - - - -	1	"
Open Side Planer 12' - - - - -	1	"
Planing Machine 12' - - - - -	1	"
" " 8' - - - - -	1	"
Shaping Machine 16" - - - - -	1	"
" " 24" - - - - -	2	"
Slotting Machine 32" - - - - -	1	"
Milling Machine No. 2 - - - - -	2	"
" " No. 0 - - - - -	1	"
Drilling Machine 18" - - - - -	3	"
Radial Drilling Machine 6' - - - - -	3	"
" " " 4' - - - - -	1	"
Horizontal Boring Machine 2-1/2" - - - - -	1	"
" " " 4" - - - - -	1	"
Double Head Grinder - - - - -	1	"
Tool Grinder - - - - -	1	"
Band Sawing Machine 42" - - - - -	1	"

- 6 - (Report on Industrial Facilities)

<u>Description</u>	<u>Quantity</u>	<u>Condition</u>
Circular Sawing Machine 42"	1	Perfect
Wood Drilling Machine - - -	1	"
Hand Planing Machine 12" - -	1	"
Naval Article in Custody		
Edge Planing Machine - - -	1	"
Straightening Roller - - - -	1	"
Punching & Shearing Machine -	1	"
Angle Cutting Machine - - -	1	"
Bevelling Machine - - - -	1	"
<i>Jaira Detached Works Article in Custody; Fair Compressor</i> 200 H.P. x 2		"
Sugitani's Article in Custody		
Eccentric Press - - - - -	1	"
Drop Hammer - - - - -	1	"
Anvil for above (375 kg) -	1	"
Furnace - - - - -	4	"
Vice - - - - -	2	"
Blower - - - - -	2	"
Grinder - - - - -	1	"
Motor 5 HP - - - - -	2	"
Anvil - - - - -	2	"

* 7. Present stocks of Raw Materials, Supplies and Unfinished Goods.

<u>Description</u>	<u>Quantity</u>	<u>Condition</u>
Pig Iron - - - - -	60 T.	Perfect
Mild Steel - - - - -	967 T.	"
High Speed Steel - - - - -	538 T. <i>Wyd.</i>	"
Carbon Steel - - - - -	2.8 T.	"
Special Steel - - - - -	6 T.	"
Spring Steel - - - - -	0.8 T.	"
Electric Copper - - - - -	3 T.	"
<i>tubes</i> Brass tubes - - - - -	50 T.	"
Zinc - - - - -	1.7 T.	"
Lead - - - - -	2.3 T.	"
Tin - - - - -	4.5 T.	"
Nail - - - - -	1.2 T.	"
Machine Oil - - - - -	18 l	"
Wood - - - - -	566 M ³	"
Life-saving Boat		
(Displacement Ton 300) -	1	Hull 75%
<i>white metal</i> " " " -	1	" 45%

* 8. Present stocks of Finished Goods.
Government Supply Goods

<u>Description</u>	<u>Quantity</u>	<u>Condition</u>
Semi-diesel Boat (10 x 2.6 x 1.38 m)	4	Breakage & Flooding
<i>lost track</i> Wooden-Boat (8 x 2.5 x 0.8 m) <i>(lost)</i>	1	" " "
Water Tube Boiler - - - - -	13	Flooding
Anchor (1 ton) - - - - -	12	"

- 7 - (Report on Industrial Facilities)

	<u>Description</u>	<u>Quantity</u>	<u>Condition</u>
<i>Lengths</i> <i>H.P.</i> <i>Capacity</i>	Chain	40	Flooding
	Fuel Oil Pump	6	"
	Fan Engine (Turbin)	18	"
	Feed Water Heater	7	"
	Water Pump	5	"
	Air Pump	3	"
	Ejector (for turbine)	7	"
	Oil Service Pump	16	"

9. Present stocks of Fuel

<u>Description</u>	<u>Quantity</u>
Coal	30 T.
Coke	43 T.
Diesel Oil	1,500 l

10. Machinery & Equipment needed for maximum production 1946-47.

All machinery described in 8 item (our machinery & Naval Article in Custody) are necessary.

Except them we demand machinery as follows:

<u>Description</u>	<u>Quantity</u>
Crane 5 ton	4
Electric Welder (10 Kw - 15 Kw)	20
oxy-arc Welder (15 Kw)	1
Gas Welder No.100 - No.1,000	15
Gas Cutter No.1 - No.3	15
Electric Drill 3mm - 22mm	40
Lathe 4'-0"	5
Radial Drilling Machine 6'	2
Gear Hobbing Machine 1,000 mm	1
Bevel Gear Planer 300 mm	1
Hack-sawing Machine 18"	3
Double Head Grinder 8" - 12"	5
Band sawing Machine 60"	1
" " " 44"	2
" " " 42"	2
" " " 30"	1
" " " 26"	1
Wood Planer 34"	1
" " 18"	1
" " 14"	1
" " 12"	1
" " 10"	1
Wood Lathe 6'-0"	2
Wood Drilling Machine 20"	1
Other Wood Machinery	8

- 8 - (Report on Industrial Facilities)

11. Raw Material & Supplies needed (monthly)

a. For Present Capacity (5b2 above)

Description	Quantity
Steel	38 T.
Cast steel	1 T.
Pig Iron	8.5 T.
Copper	1.3 T.
Tin	0.2 T.
Lead	0.2 T.
Zinc	0.2 T.
Wood	27 koku.

b. For Maximum (5b3 above)

	1946	1947
Steel	368 T.	510 T.
Cast steel	6.3 T.	11 T.
Pig Iron	105 T.	130 T.
Copper	5 T.	18 T.
Tin	0.7 T.	1.5 T.
Lead	0.9 T.	2 T.
Zinc	1.3 T.	5 T.
Wood	1,210 koku.	1,330 koku.

12. Fuel needed (Monthly) (Do not include present stock)

Description	Quantity	
	1946	1947
Coal	110 T.	153 T.
Coke	79 T.	113 T.
Diesel Oil	500 l	50 l

13. Additional Personnel needed (Not locally available)
None.

14. Prices (Give current selling price in Yen of Principal products)

Description	Unit	Price
42" Circular sawing Machine	1 set	¥18,000.--

NB - The selling price of other products are remained unsettled.

15. Remarks (Include here any factors hampering production not already mentioned and any recommendations you consider necessary)

- 1) The food condition is becoming worse, accordingly the labourers have a tendency of lacking their steady will for work.
- 2) We are pressed for operating funds as a banking organ is now limiting a loan.
- 3) To scheme a plan of production is under the difficult circumstance, because we can not easily anticipate in getting raw material on hand or not.

- 4) About things which have been kept in our factory by order of navy, we are now applying for sale to the government, as they are absolutely necessary for our future plan of ship-building.
- 5) Our factory was greatly destroyed by air-raid on the 1st June last year and moreover in September was flooded with water by the major tide till one and half meter high. Therefore it takes much time and expense to repair on a large-scale all machinery and equipment which had been into sea-water for few days.
- 6) The ground of our factory is not firm, and subsides lower and lower a little every year. At the time of the major tide season it sometimes happened that we could not continue our operation by flood.

16. Certification by applicant

I certify that the information contained herein is ^{true} to the best of my knowledge and belief.

Signed P.P. Kageki Minami
Title President Manager

17. Action by Occupation Force

The factory described in this application has been inspected and the following action:

- a. Ordered to remain closed Yes No
- b. Ordered to cease operation immediately Yes No
- c. Authorized to produce at the following rate:

<u>Item to be manufactured</u>	<u>Monthly Quantity</u>

Signature of Authorizing Officer

Designation of Authorizing Unit

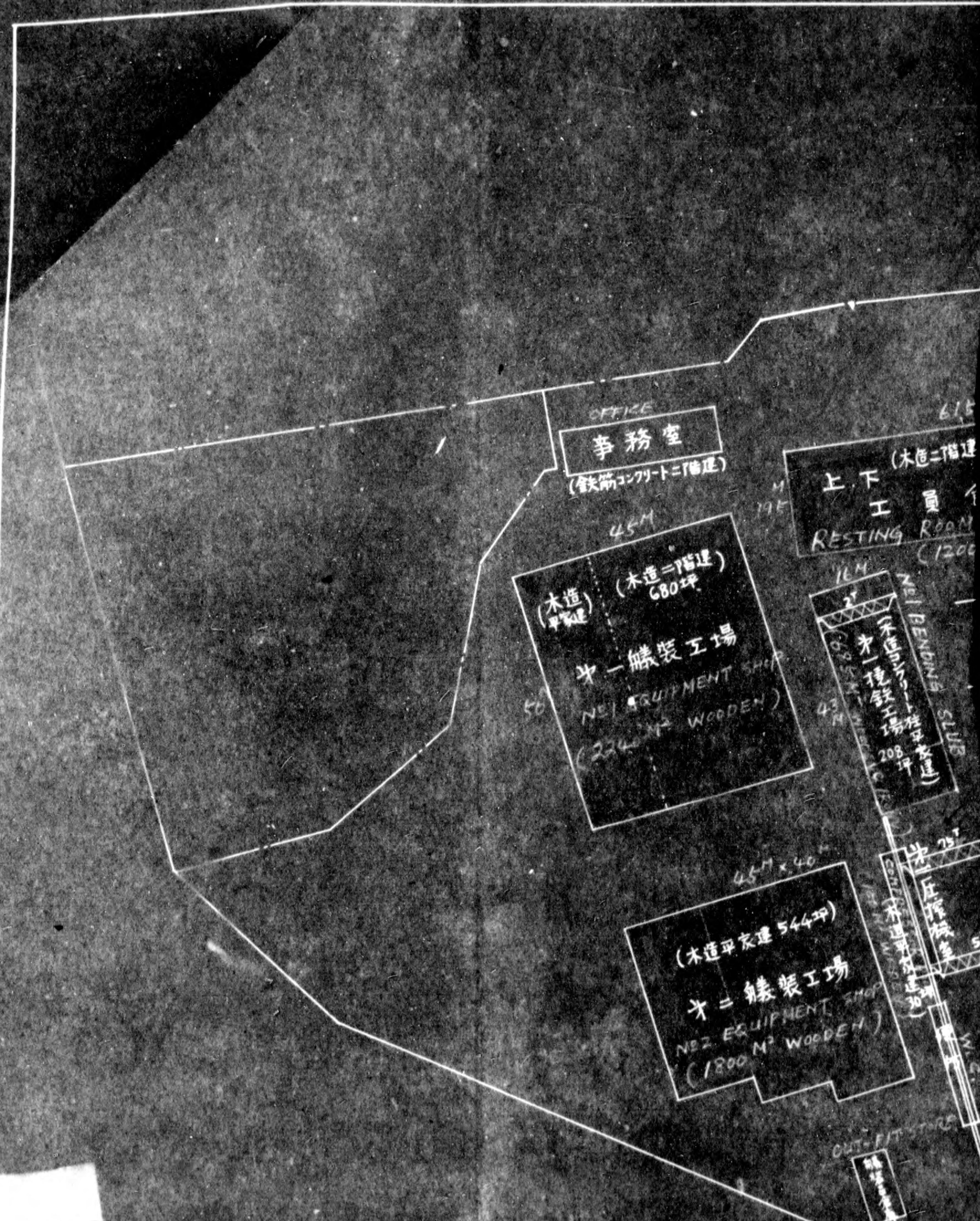

OFFICE
事務室
(鉄筋コンクリート二階建)
45M

61.5
上下工員 RESTING ROOM
(木造二階建)
(1200)

50
木造 (木造二階建) 680坪
木造 (木造二階建) 234坪 WOODEN
NE1 EQUIPMENT SHOP

16M
木造 (木造二階建) 208坪
NE1 BENDING SLIP

45M x 40M
木造 (木造二階建) 544坪
NE2 EQUIPMENT SHOP
(1800 M² WOODEN)

25M
木造 (木造二階建)
NE2 BENDING SLIP

OUT-FIT STORE





PLANT
 上 現園工場
 下 水二倉庫
 (木造=1階建 154.7坪)

浴室
 木造平家建 47坪
 BATH

米野原庫
 (木造平家建 144坪)
 炊事場
 (WOODEN)

(鉄骨平家建 374坪)
 鋳物工場
 CASTING FACTORY
 (IRONY 1230M²)

木型庫
 66M²
 WOODEN
 20坪
 PATTERN SHOP
 木型工場
 150M²
 WOODEN
 48坪

(木造=1階建 96坪)
 上才田倉庫
 下才田倉庫
 (木造=階建 90坪)
 上下倉庫
 政長倉庫
 (28坪)

水一造板工場
 (鉄骨平家建)
 (3150M² IRONY)
 956坪

木造スレート
 中二階 90.32坪
 WOODEN
 雨天作業場
 56坪
 木工場
 木造二階 103.5坪

薄板工場 672坪
 厚板工場 658坪
 條材工場 655坪
 水二造板工場
 (木造上層鉄骨平家建 700坪)

水二造板工場
 (木造上層鉄骨平家建 700坪)
 LAVATORY
 700坪

1344坪
 (鉄骨平家建)
 船台
 船台
 船台

水五倉庫
 (木造平家建 1512坪)
 煉炭工場
 32.5坪
 水造三階 28坪
 水造二階 32坪
 水造一階 24坪
 水造一階 15坪
 事務所 43坪

鋼板工場 379坪
 條材工場 393坪

水三造板工場
 (木造上層鉄骨平家建 181坪)
 水三倉庫
 (木造上層鉄骨平家建 100坪)

事務所
 倉庫
 事務室
 (木造=1階建) 153坪
 (505M² WOODEN)

船台
 船台
 船台
 事務所
 倉庫
 事務室
 (木造=1階建) 153坪
 (505M² WOODEN)

株式会社
大阪造船所工場配置図

縮尺 壹千分之壹

SCALE 1/1000

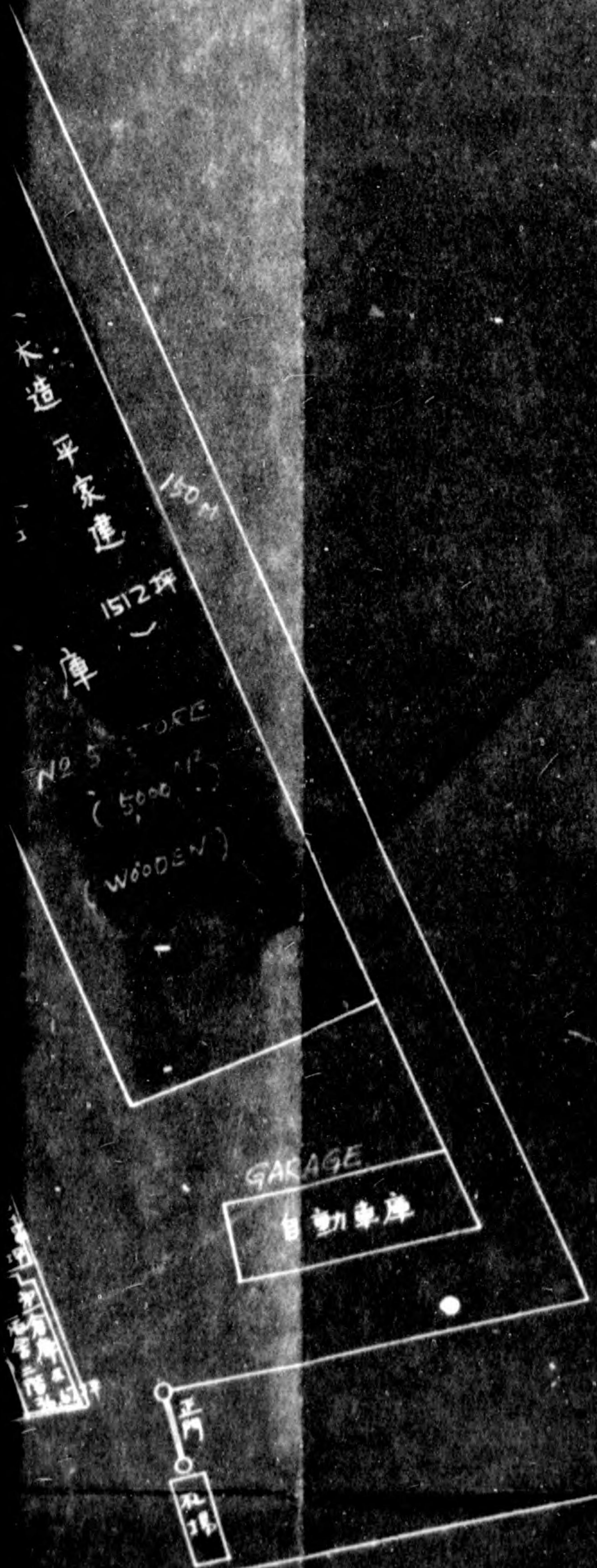
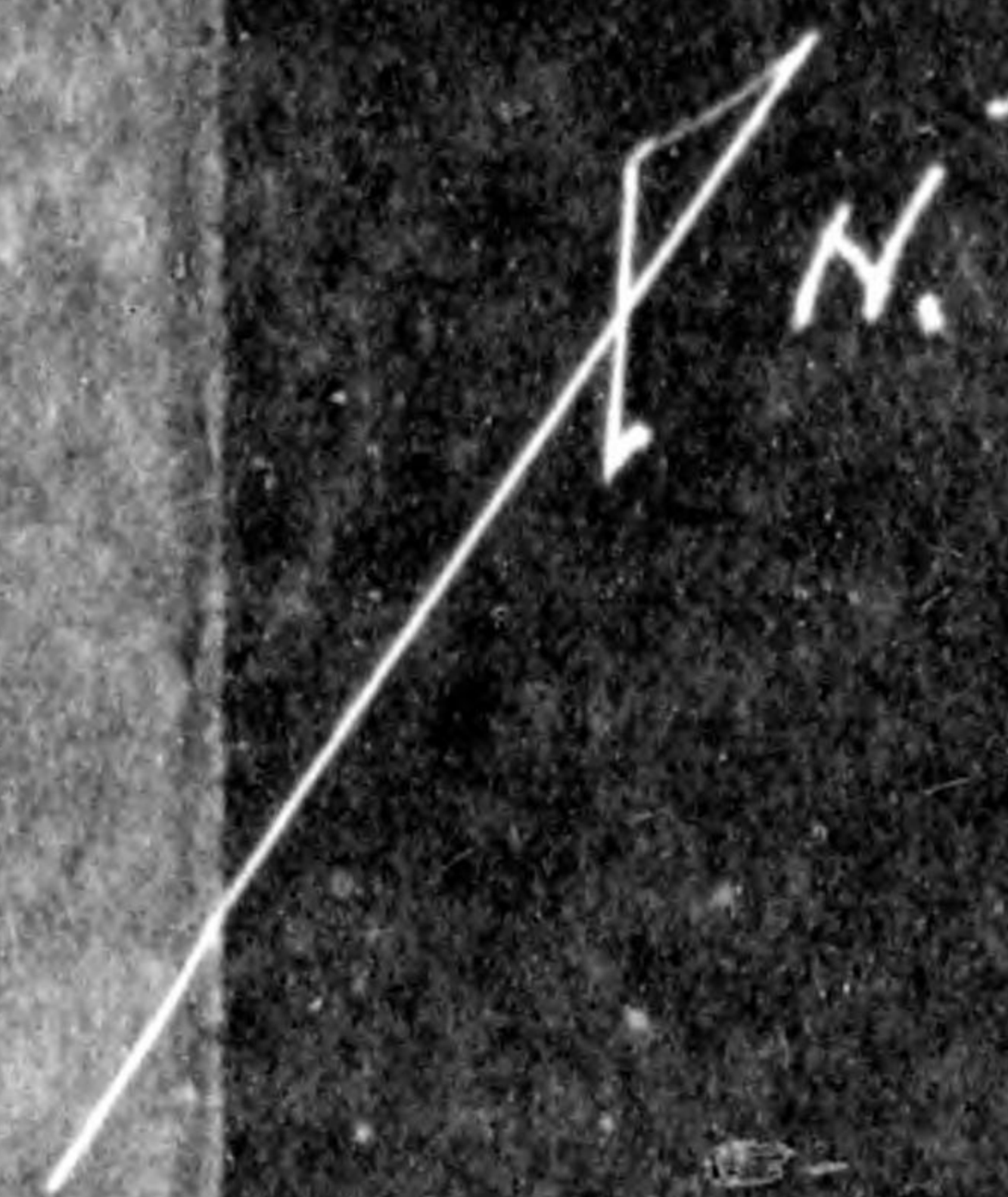

45 x 40
(木造平家建 544坪)

才 = 鑲裝工場

NE2 EQUIPMENT SHOP
(1800 M² WOODEN)

OUT-FIT

OUT-FIT

着色箇所は焼失を示す

BURNT DOWN

(木造平家建 544坪)
*二 鑲装工場
NE2 EQUIPMENT SHOP
(1800 M² WOODEN)

正作棟
木造平家建 30坪

*一 号
NE1 BUILDING 204x100M
船台

*二 号
NE2 BUILDING 204x100M
船台

*三 号
NE3 BUILDING 204x100M
船台

*四 号
NE4 BUILDING 204x100M
船台

薄板工場
672坪

厚板工場
658坪

條材工場
655坪

PLATE SHOP
(IRON)

*五 号
NE5 BUILDING 204x100M
船台

鋼板工場
379坪

條材工場
379坪

燒失指示
DOWN



GARAGE

自動車庫

SCALE 1/1000

正門

北端

10 尺

7
10

Drawing by K. Kubo
Jan. 27, 1946

SECTION III

III

DATE

SUBJECT

III

SECTION IV

IV - A

DATE

SUBJECT

IV A

R-3

DATE

SUBJECT

IV B

IV - 3
DATE SUBJECT

SECTION V

V.

DATE

SUBJECT

28 Feb 49 Shipyard Inspection

20 Apr 49 SCAPIN 1219 Compliance Inspection

DATE	SUBJECT
8 Dec 46	SCAPIN 1219 Compliance Inspection
9 Dec 46	Reparations Plant 01-1/2 Inspection Report
12 Dec 46	01-1/2 Inspection Report
14 Apr 47	Osaka Shipbuilding
19 Apr 47	SCAPIN 1219 Compliance Inspection
24 Apr 47	"
13 Jun 47	"
11 Aug 47	"
25 Nov 47	"
26 Nov 47	Inadequate Maintenance of Reparations Machinery
7 Jan 48	SCAPIN 1219 Compliance Inspection
18 Mar 48	"
20 Apr 48	Monthly Report of SCAPIN 1219 Inspections Made by Maritime Bureau Inspectors
23 Apr 48	SCAPIN 1219 Compliance Inspection
20 May 48	Monthly Report of SCAPIN 1219 Inspections made by Maritime Bureau Inspectors
19 Jun 48	Monthly Report of SCAPIN 1219 Inspections Made by Maritime Bureau Inspectors
15 Jul 48	SCAPIN 1219 Compliance Inspection
15 Jul 48	Inadequate Maintenance of Reparations Machinery
20 Jul 48	Monthly Report of SCAPIN 1219 Inspection Made by Maritime Bureau Inspectors
27 Sept 48	SCAPIN 1219 Compliance Inspection
12 Oct 48	"
20 Nov 48	"
23 Dec 48	"
22 Jan 49	"
5 Feb 49	"

SCAP 1219 COMPLIANCE CHECK

1. Plant Name: Osaka Shipyard Co.
2. Location: 1-2-chome, Minami-Fukuzaki-machi, Minato-ku, Osaka-shi
3. Plant Code Number: 32-128
4. Date of Inspection: 20 April 1949
5. Total Number of Machines: 468
6. Number of Machines in Operation: 98
7. Number of Machines not in operation: 370
8. Storage Condition: Fair
9. General Condition of Machines: Fair plus.
10. Instructions and Orders:
 - (1) Clean immediately those machines
 - (2) Clean, change gears and ~~put in rack.~~
 - (3) Paint code numbers on 2 overhead cranes.
 - (4) Cross out numbers on machines released by this headquarters.
Put tags on released machines for identification.
 - (5) Clean out oil wells of planer.
11. Remarks:

This plant has a reconversion permit. No violation was noted. Arm bands and identification buttons are in use. Electric wiring is checked each month by plant electrician. This plant was last checked on 10 Mar 40. All previous instructions have been complied with. A great improvement has been made at this plant since last inspection. The level of ground is being raised to prevent water from flooding reparation machines. Roof will be repaired as soon as material is available.

Date of Follow Up Inspection: 20 Apr. 49

J. E. M. Bailey

SHIPYARD INSPECTION

1. Name of Shipyard Osaka Zosen K.K.

2. Date of Inspection 28 Feb. 49

3. Address 2-1 Minamifukuzaki-cho Minato-Ku.

4. Number and Type of Ships being constructed.

A. Steel Cargo Vessel 676 (G.T.) - Repair.

B. _____

C. _____

D. _____

E. _____

5. SCAPIN No. authorizing (A) _____

(B) _____ (C) _____

(D) _____ (E) _____

6. Remarks: _____

A. will be completed 28 Feb 1949.

The Co has plans for new construction of (1) 2000 G.T. steel cargo vessel, and conversion of two crusher boats and two steel semi-passenger boats.

SC. PI. 1219 COMPLIANCE INSPECTION

file

1. Plant Name: Osaka Zosen K.K.
2. Location: 2-1 Minamifukuzaki-cho, Minato-Ku
3. Plant Code Number: 32-129
4. Date of Inspection: 28 Feb 49
5. Total Number of Machines: 468
6. Number of Machines in Operation: 281
7. Number of Machines not in operation: 187
8. Storage Condition: fair
9. General Condition of Machines: fair
10. Instructions and Orders:

Remove rust + repair roofs.

11. Remarks:

*a part of this company was flooded by high tide two weeks ago and some of the machine became rusty.
Fire fighting equipment is adequate*

Date of Follow Up Inspection: _____

By: J. Kanehira