

COMPREHENSIVE PLAN OF NARBERTH STATION IMPROVEMENTS

TO BE FORMALLY DISCUSSED AND ACTED UPON AT THE NEXT REGULAR MEETING OF THE NARBERTH COUNCIL, MONDAY EVENING, SEPTEMBER 10, IN THE COUNCIL CHAMBER IN ELM HALL

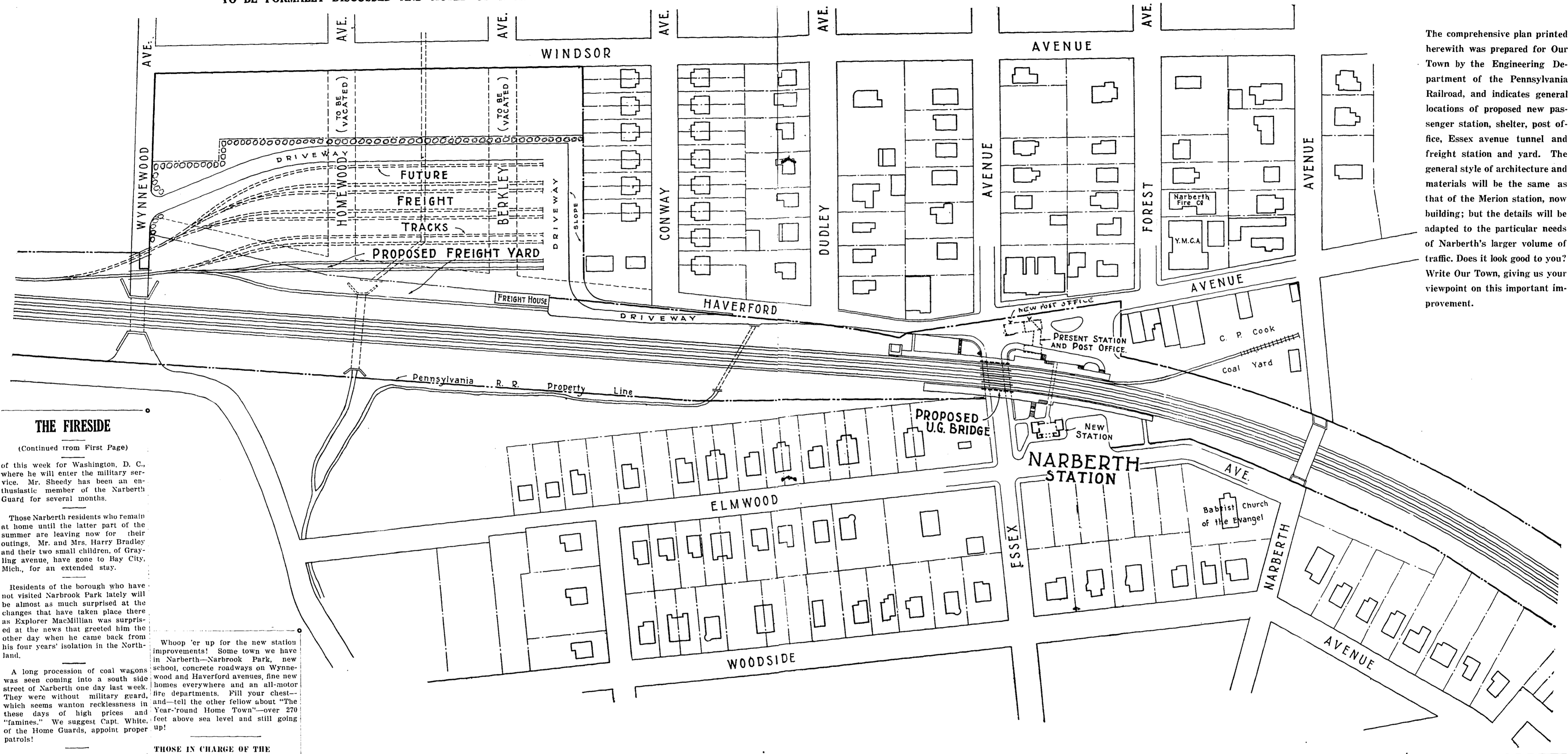

The comprehensive plan printed herewith was prepared for Our Town by the Engineering Department of the Pennsylvania Railroad, and indicates general locations of proposed new passenger station, shelter, post office, Essex avenue tunnel and freight station and yard. The general style of architecture and materials will be the same as that of the Merion station, now building; but the details will be adapted to the particular needs of Narberth's larger volume of traffic. Does it look good to you? Write Our Town, giving us your viewpoint on this important improvement.

THE FIRESIDE

(Continued from First Page)

of this week for Washington, D. C., where he will enter the military service. Mr. Sheedy has been an enthusiastic member of the Narberth Guard for several months.

Those Narberth residents who remain at home until the latter part of the summer are leaving now for their outings. Mr. and Mrs. Harry Bradley and their two small children, of Grayling avenue, have gone to Bay City, Mich., for an extended stay.

Residents of the borough who have not visited Narbrook Park lately will be almost as much surprised at the changes that have taken place there as Explorer MacMillan was surprised at the news that greeted him the other day when he came back from his four years' isolation in the Northland.

A long procession of coal wagons was seen coming into a south side street of Narberth one day last week. They were without military guard, which seems wanton recklessness in these days of high prices and "famines." We suggest Capt. White, of the Home Guards, appoint proper patrols!

THOSE IN CHARGE OF THE RED CROSS WORK ROOMS

Monday morning—Mrs. W. A. Cole.
Monday afternoon—Mrs. R. C. Hoffman.
Tuesday morning—Mrs. Trista B. du Marais.
Tuesday afternoon—King's Daughters, Mrs. C. T. Farley.
Wednesday morning—Community Club, Mrs. C. P. Fowler.
Wednesday afternoon—Needlework Guild and Thimble Club.
Thursday morning—Mrs. F. W. Stites.
Thursday afternoon—Mrs. Denman.
Friday morning—Mrs. Robert H. Brown.
Friday afternoon—Mrs. Carroll Downes.
You are cordially invited to be present at any or all of these days

There are still many residents of Narberth who have either never seen, or never noticed, the mammoth and magnificent oak tree at the northeast corner of Narberth and Chestnut avenues. It's all right to go across the continent to see the big trees of California, but before you go be sure you've seen our own "Sequoia Park."

Mr. and Mrs. W. H. Pugh, Jr. and Mr. and Mrs. Walter I. Dohard motored to Washington last Friday to visit Mr. Pugh's brother, Mr. Edmund W. Pugh, recently appointed from Los Angeles as a member of the local staff of the U. S. Food Administration, under Director Hoover. He accompanied the party on their return trip for a brief visit in Narberth.

The local political kettle has begun to boil and dame rumor has it that some peculiar combinations are to be served to those who go to the primaries to select from the party menus. It is also suggested that there may be independent candidates enter the field after the primaries. There are to be five vacancies in the local council this year.

UNCLAIMED LETTERS AT NARBERTH POSTOFFICE

Mr. Thomas Conlon
Mrs. Louisa Dreesen
Miss Mary A. Harvey
Mrs. A. S. Rhoads.
Edward S. Haws, Postmaster.

HOT WEATHER Does Not Affect INTEREST

It works just as hard for you at 98 degrees as at 65 degrees

SET INTEREST at work for you by depositing your surplus funds with us.

WE INVITE small deposits as well as larger ones.

The Merion Title & Trust Co.
NARBERTH OFFICE, ARCADE BUILDING

OPEN FROM 8 A. M., TO 4 P. M.

SATURDAYS 8 A. M. TO NOON. FRIDAY EVENINGS 7 UNTIL 9 O'CLOCK

Telephones.
1267
1268

HOWARD'S

The Brightest Spot in Narberth
A drug store in the most modern sense of the term

24TH SERIES OF
Narberth Building & Loan Association

WILL OPEN
Thursday Evening, Sept. 6th, 1917
7.30 to 9 P. M.

AT ELM HALL, NARBERTH, PA.

You are cordially invited to take shares and become a member.
J. HOWARD WILSON, President
THOMAS C. TROTTER, Jr., Secretary
WILLIAM E. GODFREY, Treasurer

RED CROSS
On September 28 and 29, there will be a Main Line Bazaar to be held at the Polo Grounds at Bryn Mawr, for the benefit of the Red Cross. Each Unit is to be represented, and all donations, particularly fancy

Of course, we deliver — any place — any time.

articles, are to be brought to the work room of the Narberth Red Cross Unit, any day but Saturday.

All information pertaining to this bazaar may be obtained at the work room in the Y. M. C. A. Building.
Tags of admission to the tennis tournament will be on sale at the Red Cross Work Room.

Mrs. Rezo Brooks' class has been doing wonderful work since the Red Cross Unit started in Narberth. They are working three days a week under her instruction, and will continue to do so through the winter.

Any one wishing to knit sweaters, helmets, socks, or scarfs may obtain the yarn free from Mrs. Perry Redifer, Essex and Windsor avenues.

SCHOOL NOTES

(Continued from First Page)

M. Louise BoyntonEnglish
Anna L. SwartzScience
Elementary Department
Nellie M. WetherillFirst grade
Anna Cooper Second grade
Margaret Duncan Third grade
Rosa K. Sample Third grade
Adah C. ClaytonFourth grade
Ella H. SnivelyFourth grade
Combined Fourth and Fifth grades
Maud GuthrieFifth grade
Olive C. Wright Sixth grade
Special Departments
Anna E. Fryer Domestic Science and Arts
A. V. Emmett Physical Culture
I. June Cross Music and Art
Mrs. A. R. Justice Lunch Room
Frieda R. Schuebel Secretary

Pupils who have been regularly tutored during the summer and who desire to pass off conditions will report on Tuesday, September 4, at 1 o'clock for examination, bringing with them certificates signed by tutor specifying definitely the work done.

I AM AT THE SERVICE OF THE PUBLIC OF NARBERTH

Automobiles to hire at all hours of day and night.
SABIE CENSORE, Phone 1289 or 625
NARBERTH, PA.

CLEAN—SAFE—WHOLESOME

OUR PRODUCTS ARE GUARANTEED UNDER BACTERIOLOGICAL CONTROL

Pasteurized Milk
Brynclwyn Certified Milk (Pediatric Society)
Special "Guernsey" Milk (Roberts & Sharpless' Dairies)
Cream Butter Milk
Table and Whipping Cream

WEST PHILA. OVERBROOK MERION WYNNFIELD BALA-CYNWYD NARBERTH ARDMORE WYNNWOOD

SCOTT-POWELL DAIRIES

45th and Parrish Sts.

