

GHQ/SCAP Records (RG 331, National Archives and Records Service)

Description of contents

- (1) Box no. 2864
- (2) Folder title/number: (13)
Nippon Seiko - Fukui Plant

(3) Date: Jan. 1950

(4) Subject:

Classification	Type of record
9230, 9621	c

(5) Item description and comment:
Fukui

(6) Reproduction: Yes No

(7) Film no.

Sheet no.

(Compiled by *National Diet Library*)

File

30 Jan. 1950

To: Chief of Tokai Hokuriku Civil Affairs Region Economic Sections

Through: Fukui Prefectural Governor

From: Nippon Seiko Kabushiki Kaisha, Fukui Plant.
Higashi Moto-machi, Takefu-shi, Fukui-ken.

Subject: Application for Release of Part of Designated Items for Reparations

Sir:

Application is hereby submitted for the release of the following property designated for reparations:

1. Property for which release is sought:

Land and Buildings of Nippon Seiko Kabushiki Kaisha
Fukui Plant:

Land: 2,208.29 tsubo

Buildings: 13 tsubo

Total floor space: 1,385.91 tsubo

2. Reasons why this application for the release of above property is submitted:

Permission for the transfer of the reparations equipment of the Nippon Seiko Fukui Plant was obtained under date of Nov. 17, 1949, as per attached AG 386.3 TLO No. 4851. As said equipment will be transferred to the Nippon Seiko Osaka Plant at 363, 2-chome, Higashi-Osaki, Shinagawa-ku, Tokyo-to, which is also a reparations plant, and finished to transfer, the Nippon Seiko wishes to return the land and buildings of the Fukui Plant to the party from which it is leased.

- 2 -

In view of these reasons the Nippon Seiko hopes that favorable consideration will be given to this application.

Signature Shigeru Kosugi
Shigeru Kosugi

Custodian,
Nippon Seiko K.K. Fukui Plant

APPROVED
E. F. Jourd by H. Yamanechi
E. F. Jourd DAC
Economics Div. THCAR
Date 1 Mar. '50

Check

HEADQUARTERS
TOKYO CIVIL AFFAIRS TEAM
APO 500

LI/ek

AG-E 386.3

17 Nov. 1949

MEMORANDUM FOR: Tokyo Metropolitan Government

THRU: Tokyo Liaison Office

SUBJECT: Transfer of Equipment

1. Reference is made to inclosed memorandum, TLO No.4851, subject: "Application for Permission to Remove Machinery and Equipment Designated for Reparations", 14 October 1949.
2. Cited request for permission to transfer equipment, listed and described in inclosure 1, from Nippon Seiko, Fukui Plant to Nippon Seiko Osaki Plant, is approved.
3. The entire cost of subject transfer will be borne by the applicant.
4. This approval will not be construed as authorizing priority in obtaining incidental materials, supplies, labor or transportation facilities.
5. The Japanese Government will make necessary corrections on pertinent records and advise General Headquarters, Supreme Commander for the Allied Powers of completion of transfer.

FOR THE CHIEF:

1 Incl:
TLO No.4851

CYLYDE C. DUNCAN
WOJG USA
Adjutant

Below Stairs

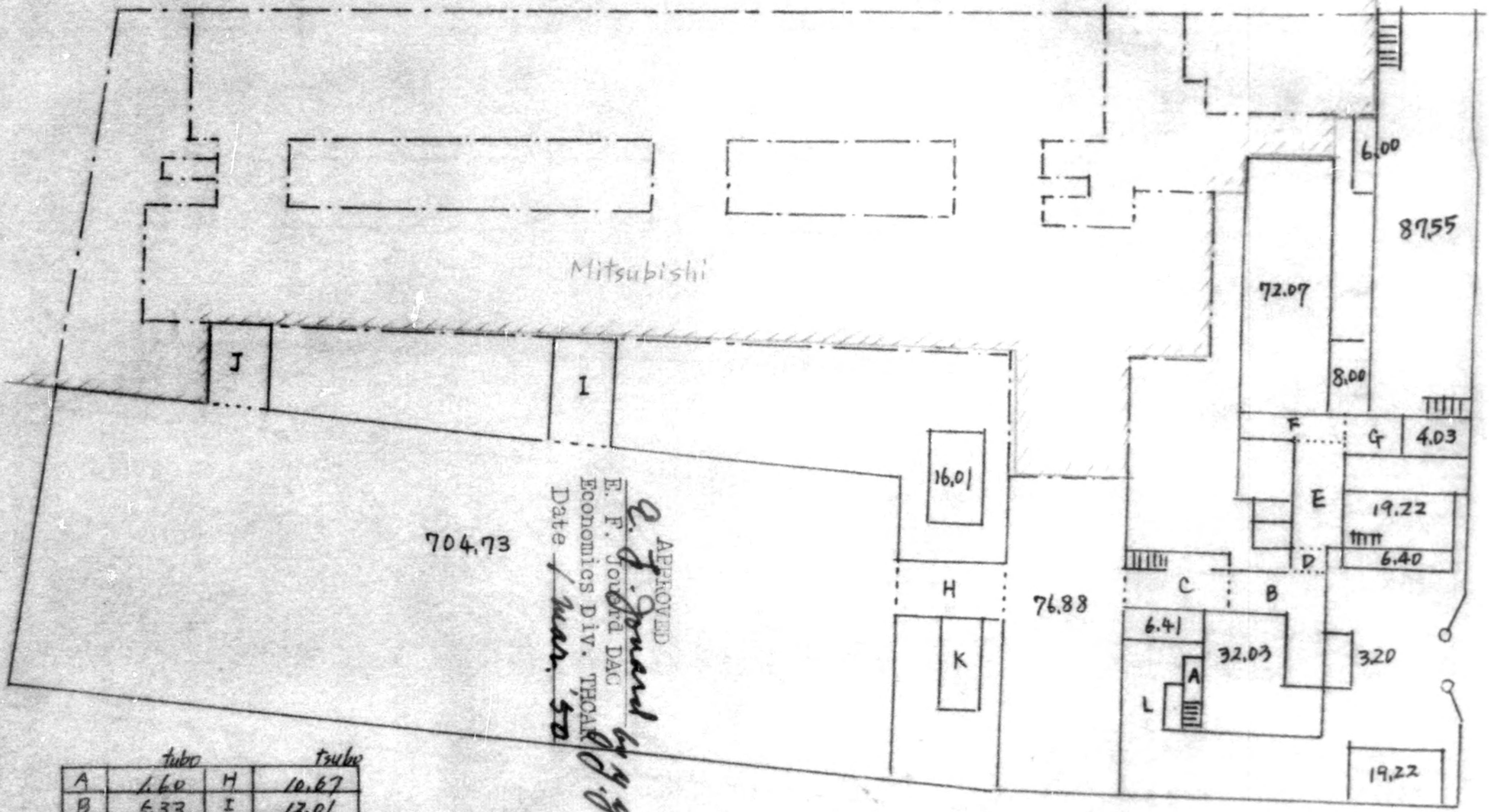

APPROVED
A. J. Howard
 E. F. Howard DAC
 Economics Div. THOAK
 Date / *Mar. 50*

	<i>tube</i>		<i>tube</i>
A	1.60	H	10.67
B	5.33	I	12.01
C	8.55	J	6.40
D	1.06	K	8.54
E	9.61	L	1.45
F	5.33		
G	6.65		

Upstairs

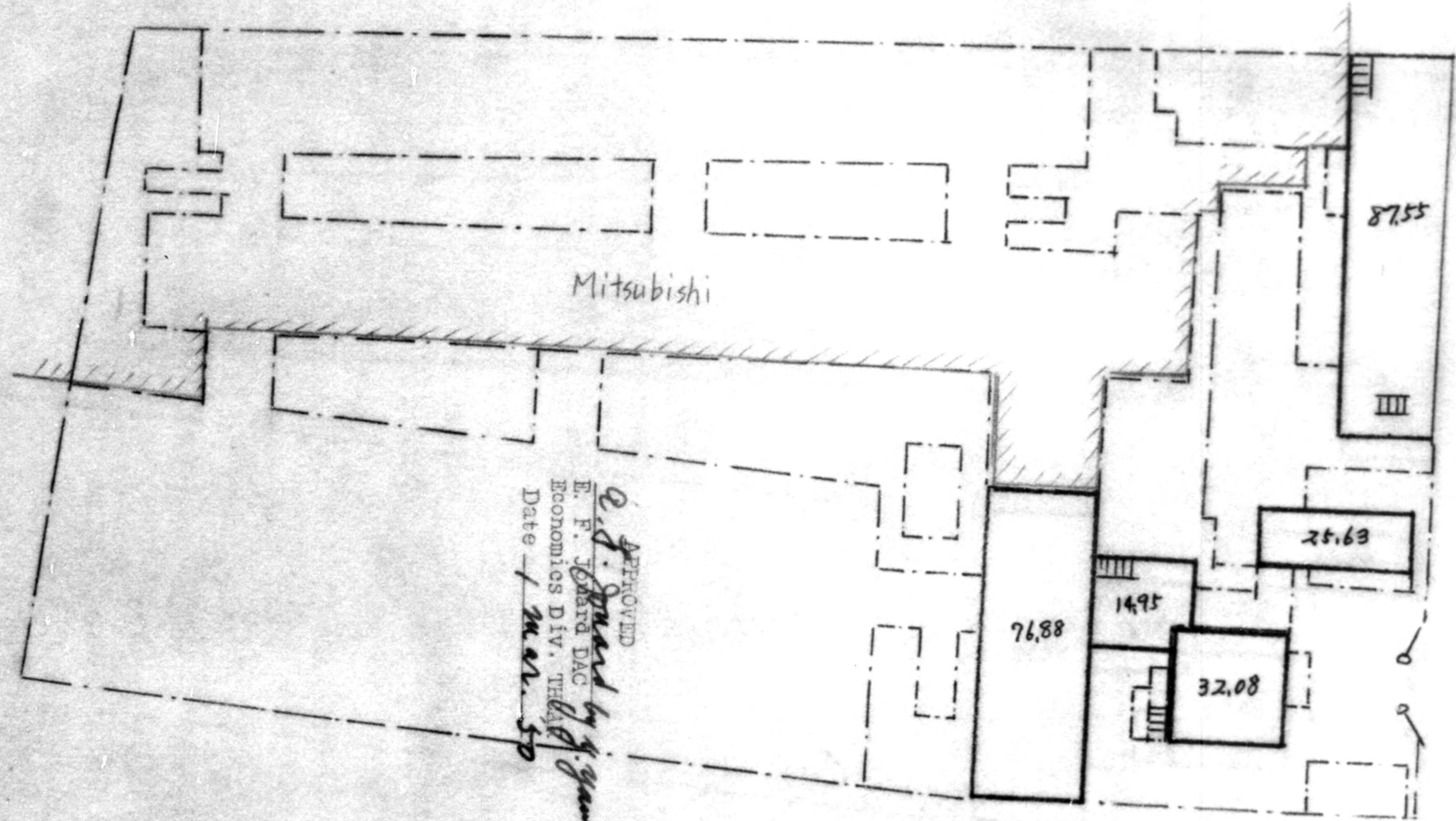

APPROVED
E. F. J. [Signature]
 E. F. J. [Signature] DAC
 Economics Div., THAA
 Date 1 Mar 50

File

COPY

December 14, 1949

TO: Tokyo Civil Affairs Team

Through: Liaison Dept., Tokyo Metropolitan Government

From: Nippon Seiko Kabushiki Kaisha,
No.1, 4-chome, Shiba-Tamachi, Minato-ku, Tokyo-to

Subject: Application for Permission to Remove Machinery and
Equipment Designated for Reparations

Sirs:

Application is hereby submitted for permission to remove machinery and equipment designated for reparations. Particulars relevant to this application are given hereunder.

1. Name of Applicant:

Nippon Seiko Kabushiki Kaisha.

President and Managing Director: Hiroki Imazato

2. Types, Capacity and Number of Machines, Implements and Other Equipment to Be Removed:

As specified in the list attached hereto.

3. Address of Place Where Above Machines, Implements and Other Equipment to Be Removed:

Nippon Seiko K.K. Fukui Plant

Higashimoto-machi, Takeu-shi, Fukui-ken.

4. Address of Place Where Above Machines, Implements and Other Equipment Are to Be Removed:

Nippon Seiko K.K. Osaki Plant

No.363, 2-chome, Higashi-Osaki, Shinagawa-ku, Tokyo.

5. State of Supervision of Place Where Above Machines, Implements and Other Equipment Are to Be Removed:

The above machines, implements and other equipment

APPROVED
E. F. J. Jourd'heuil
E. F. Jourd'heuil DAC
Economics Div. THCAR
Date 14 Dec '49
VO 14. 8th Army

are to be removed to the Osaki Plant of the Company which has been designated for reparations. Part of the said plant will be blocked off and the above machines, implements and other equipment will be stored together there

- 2 -

and kept in condition and under constant supervision by the plant staff in accordance with the regulations pertaining to the supervision of reparations plants. The custodian of the said plant will be made responsible for the supervision of the above machines, implements and other equipment.

6. Reasons for the Removal of Above Machines, Implements and Other Equipment:

The Fukui Plant, where the above machines, implements and other equipment are at present stored, is a former factory of the Yamasen Spinning Co. which was leased for a period of five years by the Company in May 1944 to be operated with machinery and equipment evacuated from other plants of the Nippon Seiko during the war. Before the said plant could begin full operations, however, it was designated for reparations and has remained idle to this day.

The Company is applying for permission for the removal of its machines, implements and other equipment designated for reparations for the following reasons:

(a) The contract for the lease of the above plant, signed in May 1944, expired in May this year and the Company has been asked by its owners, the Yamasen Spinning Co., to return the plant. The Yamasen Spinning Co. plans to operate the factory for the production of textile goods for export.

(b) Supervision of the Fukui Plant, situated in an out-of-the-way locality far removed from the Company's head office requires a considerable sum of money. By

- 0 -

putting its reparations machinery and equipment in the Company's Osaka Plant, which is also a reparations plant, together with the Company's other reparations machinery and equipment, the Company will be able to reduce the personnel and other expenditures required for the supervision of its reparations machinery and equipment.

(c) The buildings of the Fukui Plant housing the above reparations machines, implements and other equipment are old and require annual expenditures for protecting the machines and equipment from the heavy snows common to this district during winter.

The following figures show the subsidy received from the government for the supervision of said reparations machines and equipment at the Fukui Plant and the amount that must be borne each month by the Company:

Monthly Subsidy from the Government: 52,000 yen

Monthly Expenditure for Supervision of
Reparations Machinery and Equipment: 85,000 yen

Monthly Expenditure Borne by the Company: 33,000 yen

In addition to the aforementioned expenditures, the Company during winter has to bear an additional expenditure of about 150,000 yen for removing snow from the buildings and the factory compound.

Removal of the said machines, implements and other equipment from the Fukui Plant will require an expenditure of about 300,000 yen. But this will be more than offset by the monthly, saving in expenditures resulting from the storage of the Company's entire reparations machinery and equipment in one plant. From the standpoint

- 4 -

of supervision also the Company believes that this will prove most effective.

In view of the reasons given above we hope that this application will be given favorable consideration.

Yours truly,

Nippon Seiko K.K.

IMAZATO Hiroki

President and Director

List of Machineries and Equipments to be removed

Nippon Seiko K.K.

Name of Machine	Type	Manufacturer	Quantity	Capacity	Dimension	Weight		Code No.
						Per Machine kg	Total kg	
Bench Lathe		Kojima Seisakujo	5	Swing 60mm	110x30x30mm	250	1,250	IA 6 1 to 5
Chucking Lathe	BOCHI	Nippon Jukogyo K.K.	10	Swing 70mm	137x55x113	500	5,000	IA 6 6 to 15
Turret Lathe	TKM 19	Kiryu Kikai K.K.	18	Swing 70mm	120x85x105	600	10,800	IA 6 16 to 33
"	Type S	Tamagawa Tekkojo	6	Swing 110mm	151x64x100	800	4,800	IA 6 38 to 43
Lathe	4'	unknown	3	Swing 80mm	135x90x110	650	1,950	IA 6 34 to 36
"	War Type	Riken Jukogyo K.K.	1	Swing 90mm	120x70x100	600	600	IA 6 37
Radius Grinder	RWG 12	Asahi Kikai K.K.	7	Max. Work Dia. 200mm	90x90x115	800	5,600	IA 5 1 to 10
"	"	Tamagawa Tekkojo	3	"	"	"	2,400	IA 5
"	V 45	Van Norman Co.	2	Max. Work Dia. 200mm	120x140x125	1,800	3,600	IA 5 26, 27
"	RWG 31	Omori Kikai K.K. Tamagawa Tekkojo Ishiwata Seisakujo Shinagawa Seiki K.K.	1 4 1 1	Max. Work Dia. 100mm	100x92x125	1,000	7,000	IA 5 11 to 17
"	RWG 100	Ishiwata Seisakujo	1	"	180x120x148	900	900	IA 5 18
"	NSK 120	Nippon Kogyo K.K.	3	Max. Work Dia. 30mm	96x75x150	1,000	3,000	IA 5 19 to 21
"	RWG 170	Ishiwata Seisakujo	1	Max. Work Dia. 170mm	126x85x115	1,300	1,300	IA 5 22
"	V 41A	Van Norman Co.	3	Max. Work Dia. 90mm	180x122x160	1,500	4,500	IA 5 23 to 25
Cylindrical Grinder	IC-1	Toho Seiki K.K.	1	Max. Work Dia. 25mm	78x123x140	1,500	1,500	IA 5 28
Centerless Grinder	NF 16	Nihon Kenma Kosakujo	1	Max. Work Dia. 40mm	190x125x160	2,800	2,800	IA 5 29
"	IMV	Tidkoping Co.	1	Max. Work Dia. 500mm	110x250x145	5,000	5,000	IA 5 30

Name of Machine	Type	Manufacturer	Quantity	Capacity	Dimension	Weight		Code No.
						per machine	Total	
Surface Grinder	B 16	Blanchard Co.	1	Max. Work Dia. 500mm	mm 118x180x230	7,000 kg	7,000 kg	IA 5 31
Vertical Milling Machine	No. 2 %	Tateyama Jukogyo	1	Table Dia. 1308x305	181x125x170	2,000	2,000	IA 7 1
Marking Machine	Type C	Sanshin Kikai K.K. Okubo Kikai K.K. Ishiwata Seisakujo	1 1 2	Stroke 1 to 5mm	85x80x130	900	3,600	IA 9 1 to 3
Washing Machine		Hokushin Denki K.K.	1		300x165x150	800	800	IA 9 4
Oiling Machine		"	1		273x110x140	700	700	IA 9 5
Total			81					

DECLASSIFIED E.O. 12065 SECTION 3-402/NNDG NO. 775013