

GHQ/SCAP Records (RG 331, National Archives and Records Service)

Description of contents

- (1) Box no. **2865**
- (2) Folder title/number: **(10)**
Mitsubishi Jukogyo - Komi Plant

(3) Date: **Feb. 1947 - Apr. 1951**

(4) Subject:

Classification	Type of record
9230, 9621	Z

(5) Item description and comment:
Nagoya

(6) Reproduction: Yes No

(7) Film no. _____ Sheet no. _____

(Compiled by *National Diet Library*)

GENERAL HEADQUARTERS
 SUPREME COMMANDER FOR THE ALLIED POWERS
 Economic and Scientific Section
 APO 500

387.6(25 Apr 51)ESS/IND

MWH/WT/ao
25 April 1951

MEMORANDUM FOR: Reparations Agency, Tokyo

SUBJECT: Application for Movement and Authorized
Use of Items Listed for Reparations

<u>Present Location</u>	<u>No. of Items</u>	<u>To Be Transferred To</u>
Mitsubishi Heavy Industries, Ltd.		Mitsubishi Denki K.K. Itami Seisakujo No. 80, Aza-Nakano Minami-Shinazu Amagasaki City Hyogo Pref.
No. 3 Works (23-03)	5	
No. 5 Works (01-26a)	7	
Chita Plant of No. 5 Works (01-26c)	1	
Koud Plant (01-89)	3	
Mitsubishi Jukogyo K.K.		
Dai-Roku (No. 6) Kojo (37-01)	1	
No. 10 Works (01-27a)	2	
No. 12 Works (01-30)	6	
No. 18 Works (06-01)	1	
No. 22 Works (01-28)	6	
	<hr/>	
Total	32	

2 Incls

1. Item author for mvmt & use. (dup)
2. R.A.R. No. 695 (MS)
27 Mar 51. (dup)

MAURICE M. CLASS
 Chief, Industry Division

GENERAL HEADQUARTERS
 SUPREME COMMANDER FOR THE ALLIED POWERS
 Economic and Scientific Section
 APO 500

MWH/WI/yt
 27 March 1951

387.6(27 March 51) ESS/IND

MEMORANDUM FOR: Reparations Agency, Tokyo

SUBJECT: Application for Movement and Authorized Use of
 Items Listed for Reparations

<u>Present Location</u>	<u>No. of Items</u>	<u>To Be Transferred</u>
Central Japan Heavy Industries, Ltd., Nagoya Engineering Works, Komi Plant (01-89)	8 ✓	Central Japan Heavy Industries, Ltd., Nagoya Engineering Works, Iwatsuka Plant (01-27a)
Mitsubishi Heavy Industries, Ltd., Nagoya Liquidation Office		
a. Daiko Branch (01-25a)	5	
b. Fukui Branch (06-01)	1	
c. Biwajima Plant (01-25i)	1	
	<hr/>	
TOTAL	15	

2 Incls

1. Items author for mvmt & use. (dup)
2. R.A.R. No. 289 (MS)
12 Feb 51 (dup)

MAURICE M. GLASS
 Chief, Industry Division

Economic Guard

GENERAL HEADQUARTERS
 SUPREME COMMANDER FOR THE ALLIED POWERS
 Economic and Scientific Section
 APO 500

TOKAI-HOKURIKU INFORMATION
 JAN - 2 1951
 O.D. 11
AK

3876(18 Dec 50)ESS/IND

WT/MWH/RAS/yy
 18 December 1950

MEMORANDUM FOR: Reparations Agency, Tokyo

SUBJECT: Application for Movement and Authorized Use
 of Items Listed for Reparations

1. Reference is attached R.A.R. No. 1318 (MS), 12 October 1950, subject: Application for Intercompany Movement and Authorized Use of Reparations Equipment of Komi Plant (Code No. 01-89) of Nagoya Engineering Works, Central Japan Heavy Industries, Ltd. Filed by Daiko Plant (Code No. 01-25a) of Same Works.

2. The application requesting permission for the transfer and authorized use of the 10 items of reparations machinery and equipment listed in reference 1, above, is approved as indicated below:

Central Japan Heavy Industries, Ltd. Nagoya
 Engineering Works Inter-plant Transfer

<u>Present Location</u>	<u>No. of Items</u>	<u>To Be Transferred To</u>
Komi Plant (01-89)	10	Daiko Plant (01-25a)

3. This permit is issued subject to any and all directives affecting reparations plants which have been issued or may hereafter be issued by the Supreme Commander for the Allied Powers. Reports will be rendered as required by current directives and instructions.

FOR THE CHIEF, ECONOMIC AND SCIENTIFIC SECTION:

1 Incl
 as indicated.
 (dup)

MAURICE M. CLASS
 Chief, Industry Division

Cys furnished:
 CA Sec (dup)
 CPC

MEMO FOR RECORD:

The above ltr is self-explanatory.

Mr. R.A. Steele:
 26-7842

M. M. C.

To : General Headquarters, Supreme Commander for the Allied Powers.

From : Reparations Agency, Tokyo.

Subject: Application for Intercompany Movement and Authorized Use of Reparations Equipment of Komi Plant (Code No. 01-89) of Nagoya Engineering Works, Central Japan Heavy Industries, Ltd. Filed by Daiko Plant (Code No. 01-25a) of Same Works.

R.A.R. No. 1318 (MS)

12 October 1950.

1. The Reparations Agency hereby submits to your Headquarters an application for intercompany movement and authorized use of 10 sets of reparations equipment now in "authorized use" ^{and to} at Komi Plant (Code No. 01-89) of the Nagoya Engineering Works, Central Japan Heavy Industries, Ltd. filed by the Daiko Plant (Code No. 01-25a) of the same works, together with an application of the Ministry of International Trade and Industry, as enclosed herewith.
2. As the Komi Plant of the Nagoya Engineering Works, Central Japan H.I. Ltd. has been decided to be closed, the machinery and equipment now in use therein should be dispersed into other plants of the same works to continue the production thereby. So it is desired that the above-mentioned 10 sets of reparations equipment be moved to the Daiko Plant as soon as possible.
3. This application has been investigated and has been coordinated with other interested government agencies.
4. It is requested that your most favorable consideration be given to this application at the earliest practicable date.

(Y. Katsuno)
Director, Reparations Division,
Reparations Agency.

Incls:

- a) ~~Application of the Ministry of International Trade & Industry.~~
- b) Application of the subject plant.

Incl 1

List of Designated Reparation Machinery and Equipment Desired to Use

Applicant: Central Japan Heavy Industries Ltd.,
Nagoya Engr Works, Daiko Plant
(Evaluated Plant)

<u>Name of machine</u>	<u>Name of mfg. Co.</u>	<u>Type & dimension</u>	<u>Inventory number</u>	<u>Operation or idle</u>	<u>No. of item</u>	<u>Class</u>	<u>Old inventory or additional</u>	<u>Section of Evaluation sheet</u>	<u>Page of Evaluation sheet</u>
the-Engine	Okuma Tekko	10"-0	01-89-185	T. U Operation	1		Old inventory	A.U.	11 of 61
Lathe-Turret	Pittler Germany	Saddle type Bed L 50cm.	" 247	"	1		"	"	25 of 61
Lathe-Turret	Pittler Germany	Bed L 785 cm.	" 251	"	1		"	"	25 of 61
Milling machine	Cincinnati U.S.A.	Knee Horizontal	" 199	"	1		"	"	15 of 61
" "	Hitachi	Knee Universal	" 201	"	1		"	"	15 of 61
Drilling m/e	Dainippon Koki	Radial	" 225	"	1		"	"	15 of 61
Boring m/e	Heald Co. U.S.A.	Horizontal precision	" 84	A.U	1		"	"	2 of 61
grinder	Landis U.S.A.	External Universal	" 86	T. U	1		"	"	13 of 61
Gear Cutter	Gleason	Straight Bevel	" 183	A. U	1		"	"	3 of 61
Slotter	Pratt & Whitney	Vertical	" 191	T. U	1		"	"	12 of 61
					<u>Total</u>				<u>10</u>

GENERAL HEADQUARTERS
 SUPREME COMMANDER FOR THE ALLIED POWERS
 Economic and Scientific Section
 APO 500

387.6(19 Dec 50)ESS/IND

WT/MWH/RAS/yy
19 December 1950

MEMORANDUM FOR: Reparations Agency, Tokyo

SUBJECT: Application for Movement and Authorized Use
of Items Listed for Reparations

<u>Present Location</u>	<u>No. of Items</u>	<u>To Be Transferred To</u>
Kawasaki Sangyo K.K. Takatsuki Plant (32-06)	7	Shinko Rayon Co., Ltd. Rokujo Factory 1260, Rokujo, Gifu City, Gifu Prefecture
Mitsubishi Heavy Indus- try Co., Ltd.		
a. Daiko Plant No. 4 Seisakujo (01-25a)	2	"
b. Biwajima Plant (01-30)	3	"
c. Oe Plant (01-26a)	1	"
d. Komi Plant (01-89)	1	"
e. Iwatsuka Plant (01-27a)	1	"
f. Koromo Plant (01-28)	1	"
	<hr/>	
Total	16	

FOR THE CHIEF, ECONOMIC AND SCIENTIFIC SECTION:

MAURICE M. CLASS
 Chief, Industry Division

- COPY -

FOKAI-HOKURIKU *Econ*

INFORMATION:

GENERAL HEADQUARTERS
 SUPREME COMMANDER FOR THE ALLIED POWERS
 Economic and Scientific Section
 APO 500

O.D. 11
DZU
 APR 27 1950

WT/ABO/MNH/RAS/bd
 18 April 1950

387.6(18 Apr 50)ESS/IND

MEMORANDUM FOR: Reparations Agency, Tokyo

SUBJECT: Application for Movement and Authorized Use of Items Listed for Reparations

1. Reference is attached R.A.R. No. 257 (MS), 29 March 1950, subject: Application for Movement and Authorized Use of Reparations Equipment of Katsura Plant (Code No. 22-09), Kyoto Engineering Works of Mitsubishi Heavy Industries Co., Ltd. Filed by Komi Engineering Works (Code No. 01-89) of the Same Company.

2. The application requesting permission for the transfer and authorized use of one (1) item of reparations equipment listed in reference 1, above, is approved as indicated below:

<u>Present Location</u>	<u>No. of Items</u>	<u>To Be Transferred To</u>
Mitsubishi Heavy Industries, Ltd. (Aircraft Liquidation Office) Katsura Plant (22-9)	(22-9-1343)	Central Japan Heavy-Industries, Ltd. Komi Engineering Works (01-89)

3. This permit is issued subject to any and all directives affecting reparations plants which have been issued or may hereafter be issued by the Supreme Commander for the Allied Powers. Reports will be rendered as required by current directives and instructions.

FOR THE CHIEF, ECONOMIC AND SCIENTIFIC SECTION:

1 Incl
 as indicated

MAURICE M. CLASS
 Chief, Industry Division

Cys furnished:
 CA Sec (dup)
 CPC

MEMO FOR RECORD:

The above ltr is self-explanatory.

Mr. R. A. Steele
 26-6552

M. M. C.

- COPY -

TO : General Headquarters, Supreme Commander for the Allied Powers.

From : Reparations Agency, Tokyo

Subject: Application for Movement and Authorized Use of Reparations Equipment of Katsura Plant (Code No. 22-09), Kyoto Engineering Works of Mitsubishi Heavy Industries Co., Ltd. Filed by Komi Engineering Works (Code No. 01-89) of the Same Company.

R.A.R. No. 257 (MS)

29 March 1950

1. The Reparations Agency hereby submits to your Headquarters an application for movement and authorized use of 1 set of reparations equipment now lying idle in the Katsura Plant (Code No. 22-09) and machines under; (Code No. 22-10 located therein), Kyoto Engineering Works of the Mitsubishi Heavy Industries Co., Ltd. filed by the Komi Engineering Works (Code No. 01-89) of the same company, together with an application of the Ministry of International Trade and Industry as enclosed herewith.
2. This application has been investigated and has been coordinated with other interested government agencies.
3. It is requested that your most favorable consideration be given to this application at the earliest practicable date.

(Y. Katsuno)
Director, Reparations Division
Reparations Agency.

Incls:

1. Application of the Ministry of International Trade & Industry.
2. Application of the subject plant.

- COPY -

Details of Reparation Machines

(S) No.

To be transferred

KOMI ENGINEERING WORKS (Code No. 01-89)

No.280, 1-chome, 9-banchi, Minato-ku,
Nagoya City

West Japan Heavy - Industries, Ltd.

- COPY -

- COPY -

Details of Reparation Machinesto be transferred.

Komi Engineering Works

Name of Machine	Maker	Type & Capacity	Inventory No.	Use or non-use	No.
Fatigue tester (Torsion type)	Akashi Mfg., Works	Shenk Model 4 Kg/m.	22-9 1343	Non-use	1

- COPY -

COPY

D

GENERAL HEADQUARTERS
 SUPREME COMMANDER FOR THE ALLIED POWERS
 Economic and Scientific Section
 APO 500

WT/ABC/LNH/RAS/st
 21 March 1950

387.6(21 Mar 50)ESS/IND

MEMORANDUM FOR: Reparations Agency, Tokyo

SUBJECT: Application for Movement and Authorized Use
 of Items Listed for Reparations

1. Reference is attached R.A.R. No. 46 (MS), 3 February 1950, subject: Application of Komi Engineering Works, Mitsubishi Heavy-Industries, Ltd. (01-89) for movement and Authorized use of Reparations Facilities Lying Idle in Its Sister Plants.

2. The application requesting permission for the interplant transfer and authorized use of the ten (10) items of reparations machinery and equipment listed in reference 1, above, is approved as indicated below:

Central Japan Heavy-Industries, Ltd., Interplant
 Transfer

<u>Present Location</u>	<u>No. of Items</u>	<u>To Be Transferred To</u>
Oye plant No. 5 Works (01-26)	2	Komi Engineering Works 1-1 (01-89) Removed 3-1 check 7 Oct. '50
Daiko Plant No. 4 Works (01-25)	3	"
Riwajima Plant No. 12 Works (01-30)	5	"
Total		10

3. This permit is issued subject to any and all directives affecting reparations plants which have been issued or may hereafter be issued by the Supreme Commander for the Allied Powers. Reports will be rendered as required by current directives and instructions.

COPY

GENERAL HEADQUARTERS
 SUPREME COMMANDER FOR THE ALLIED POWERS
 Economic and Scientific Section
 APO 500

WT/ABO/MWH/RAS/bd
 21 March 1950

387.6(21 Mar50)ESS/IND

MEMORANDUM FOR: Reparations Agency, Tokyo

SUBJECT : Application for Movement and Authorized Use
 of Items Listed for Reparations

1. Reference is attached R.A.R. No. 46 (MS), 3 February 1950, subject: Application of Komi Engineering Works, Mitsubishi Heavy-Industries, Ltd. (01-89) for movement and Authorized use of Reparations Facilities Lying Idle in Its Sister Plants.

2. The application requesting permission for the interplant transfer and authorized use of the ten (10) items of reparations machinery and equipment listed in reference 1, above, is approved as indicated below:

Central Japan Heavy-Industries, Ltd., Interplant Transfer

<u>Present Location</u>	<u>No. of Items</u>	<u>To Be Transferred To</u>
Oye Plant No. 5 Works (01-26)	2 { 1-1 3-1	Komi Engineering Works (01-89) <i>Removed 7 Oct. '50</i> <i>check</i>
Daiko Plant No. 4 Works (01-25)	3	} <i>未完了</i>
Biwajima Plant No. 12 Works (01-30)	5	
Total	10	

3. This permit is issued subject to any and all directives affecting reparations plants which have been issued or may hereafter be issued by the Supreme Commander for the Allied Powers. Reports will be rendered as required by current directives and instructions.

775013

7th Guard.

TOKAI-HOKURIKU

INFORMATION:

O.D. *"*

[Signature]
JUN 16 1950

GENERAL HEADQUARTERS
SUPREME COMMANDER FOR THE ALLIED POWERS
Economic and Scientific Section
APO 500

WT/ABO/MWH/RAS/bd
10 June 1950

387.6(10 Jun 50)ESS/IND

MEMORANDUM FOR: Reparations Agency, Tokyo

SUBJECT: Application for Movement and Authorized Use of Items Listed for Reparations

1. Reference is attached R.A.R. No. 409 (MS), 1 May 1950, subject: Application for Movement and Authorized Use of Reparations Equipment of Tokyo Engineering Works (Code No. 39-108), Mitsubishi Heavy Industries, Ltd., Filed by Komi (No. 3) Works (Code No. 01-89), Central Japan Heavy Industries, Ltd. (Mitsubishi H.I. Ltd.)

2. The application requesting permission for the transfer and authorized use of the five (5) items of reparations equipment listed in reference 1, above, is approved as indicated below:

<u>Present Location</u>	<u>No. of Items</u>	<u>To Be Transferred To</u>
East Japan Heavy Industries, Ltd. Tokyo Engineering Works (39-108)	5 <i>1st class</i>	Central Japan Heavy-Industries, Ltd. Nagoya Engineering Works Komi Plant (01-89)

3. This permit is issued subject to any and all directives affecting reparations plants which have been issued or may hereafter be issued by the Supreme Commander for the Allied Powers. Reports will be rendered as required by current directives and instructions.

FOR THE CHIEF, ECONOMIC AND SCIENTIFIC SECTION:

Removed 20 Oct. '50

check

1 Incl
as indicated

Cys furnished:
CA Sec (dup)
CPC

MEMO FOR RECORD:

The above ltr is self-explanatory.
Mr. R. A. Steele, 26-6552

M. M. C.

E22
12
MORRICE H. CLASS
Chief, Industry Division
[Circular Stamp]

CA-SEC

TOKAI-HOKURIKU

To : General Headquarters, Supreme Commander for the Allied Powers.

From : Reparations Agency, Tokyo.

Subject: Application for Movement and Authorized Use of Reparations Equipment of Tokyo Engineering Works (Code No. 39-108), Mitsubishi Heavy Industries, Ltd. Filed by Komi (No. 3) Works (Code No. 01-89), Central Japan Heavy Industries, Ltd. (Mitsubishi H.I.Ltd.).

R.A.R. No. 409 (MS)

1 May 1950.

1. The Reparations Agency hereby submits to your Headquarters an application for movement and authorized use of 5 sets of reparations equipment now lying idle in the Tokyo Engineering Works (Code No. 39-108) of the Mitsubishi Heavy Industries, Ltd. filed by the Komi (the former No. 3) Works (Code No. 01-89) of the Central Japan Heavy Industries, Ltd. (one of the succeeding companies of Mitsubishi Heavy Industries, Ltd.), together with an application of the Ministry of International Trade and Industry, as enclosed herewith.
2. This application has been investigated and has been coordinated with other interested government agencies.
3. It is requested that your most favorable consideration be given to this application at the earliest practicable date.

(Y. Katsuno)
Director, Reparations Division,
Reparations Agency.

Incls:

- a) ~~Application of the Ministry of International Trade & Industry.~~
- b) Application of the subject plant.

Incl 1

List of Reparations Items

(1) Present location of Reparations machines.

Name of Plant: Tokyo Engineering Works,
Mitsubishi Heavy-Industries, Ltd.
Address of Plant: 321, Shimomaru-ko-machi, Ohteku, Tokyo-to.
Plant Code No.: 39-108-

(2) Applicant.

Name of Plant: Komi Plant,
Nagoya Engr. Work,
Central Japan Heavy-Industries, Ltd.
Address of Plant: No. 280 1-chome, 9 Bancho,
Minato-ku, Nagoya-City.

Komi Plant

Code No.	Name of m/c	Maker	Size & Type	Quantity	Remarks
39-108- 2376	Welding m/c A.C	Mitsuba Seisakusho	9 KW	1	Non Use
2387	"	"	"	1	"
666	Motor Generator	Chuo Seisakusho	15V 500A	1	"
667	"	"	"	1	"
700	"	"	"	1	"
			Total	<u>5</u>	

Monthly Purchasing Plan of 1950 White Potatoes

Prefecture	July			August			September			Total		
	For its own	Destined for other	Total	For its own	Destined for other	Total	For its own	Destined for other	Total	For its own	Destined for other	Total
	prefecture	prefecture		prefecture	prefecture		prefecture	prefecture		prefecture	prefecture	
Aomori			514	949	1,463	771	1,326	2,097	1,285	2,275	3,560	
Iwate			508	315	823	762	385	1,147	1,270	700	1,970	
Miyagi	381	181	562	762	885	1,647	762	329	1,091	1,395	3,300	
Akita	276		276	552		552	322		322	1,150	1,150	
Yamagata	289	123	412	578	629	1,207	578	223	801	1,445	2,420	
Fukushima	461	527	988	922	2,056	2,978	922	912	1,834	2,305	3,495	
Ibaraki	748	1,504	2,252	748	982	1,730	374	584	958	1,870	3,070	
Tochigi	710	716	1,426	710	397	1,107	355	252	607	1,775	1,365	
Gunma	754	419	1,173	754	553	1,307	377	303	680	1,685	1,275	
Saitama	998	1,752	2,750	998	777	1,775	499	756	1,255	2,495	3,285	
Chiba	1,018		1,018	1,018		1,018	284		284	2,320	2,320	
Tokyo	875		875	625		625				1,500	1,500	
Kanagawa	1,166		1,166	834		834				2,000	2,000	
Niigata	1,076	803	1,879	1,076	257	1,333	538	538	2,690	1,060	3,750	
Toyama	514	580	1,094	514	315	829	257	257	1,285	895	2,180	
Ishikawa	464	528	992	464	292	756	232	232	1,160	820	1,980	
Fukui	364	256	620	364	74	438	182	182	910	330	1,240	
Yamanashi	172		172	368		368			540		540	
Nagano	756	220	976	756		756	378	378	1,890	220	2,110	
Gifu	702		702	638		638			1,340		1,340	
Shizuoka	1,266		1,266	473		473			1,740		1,740	
Aichi	2,138		2,138	992		992			3,130		3,130	
Mie	688		688	412		412			1,100		1,100	
Shiga	265	163	428	265	27	292			530	190	720	
Kyoto	595		595	255		255			850		850	
Osaka	700		700	300		300			1,000		1,000	
Hyogo	889		889	381		381			1,270		1,270	

775013

(Cont'd)

Monthly Purchasing Plan of 1950 White Potatoes												:in 1,000 km		
Prefec- ture	July			August			September							
	For its:	Destined :	Total:	For its:	Destined :	Total:	For its:	Destined :	Total:	For its:	Destined :	Total:		
	own	for other:		own	for other:		own	for other:		own	for other:			
	prefec- ture	prefec- ture		prefec- ture	prefec- ture		prefec- ture	prefec- ture		prefec- ture	prefec- ture			
Nara	291	230	521	291	38	329				582	268	850		
Wakayama	268		268	272		272				540		540		
Tottori	266	295	561	200	49	249				466	344	810		
Shimane	306	124	430	230	20	250				536	144	680		
Okayama	696	269	965	522	133	655				1,218	402	1,620		
Hiroshima	1,078		1,078	902		902				1,980		1,980		
Yamaguchi	872		872	278		278				1,150		1,150		
Tokushima	378	205	583	132	185	317				510	390	900		
Kagawa	240		240							240		240		
Ehime	662		662	238		238				900		900		
Kochi	70		70							70		70		
Fukuoka	2,510		2,510	330		330				2,840		2,840		
Saga	448		448	352		352				700		700		
Nagasaki	420		420							420		420		
Kumamoto	460		460							460		460		
Oita	390		390							390		390		
Miyazaki	430		430	180		180				610		610		
Kagoshima	498		498	352		352				850		850		
Total	28,548	8,895	37,443	20,961	8,933	29,894	7,593	5,070	12,663	57,102	22,898	80,000		

Note: The government will start to purchase white potato not later than 10th July 1950.

GENERAL HEADQUARTERS
 SUPREME COMMANDER FOR THE ALLIED POWERS WT/ABO/MWH/RAS/jtt
 Economic and Scientific Section
 APO 500

387.6(18 Feb 50)ESS/IND

18 February 1950

MEMORANDUM FOR: Reparations Agency, Tokyo

SUBJECT: Application for Authorized Use of Items
 Listed for Reparations.

1. Reference is attached R.A.R. No. 119 (MS), 15 Dec 1949, subject: Application for Authorized Use of Equipment in Reparations Plants Located in Aichi Prefecture, which forwards en bloc, the applications of twenty (20) plants requesting authorized use of items currently in temporary operation.

2. The application for the authorized use of the equipment set forth in reference 1, above, is approved as indicated below:

<u>Company Name</u>	<u>Number of Items</u>
a. Aichi Kigyo Co., Ltd. Eitoku Pl (01-62)	3
b. Kobayashi Seisakusho Momonoki Kojyo (01-24)	4
c. Komi Engineering Works of Mitsubishi Heavy-Industries Ltd. (01-89)	4 - check
d. Mitsubishi Heavy Industries Ltd., Ryowa Engineering Works, Daiko Pl. (01-25)	29
e. Mitsubishi Heavy Industries Ltd., Ryowa Engineering Works, Oye Pl. (01-26)	36
f. Mitsubishi Heavy Industries Ltd., Nagoya Engineering Works (01-27A)	153
g. Kowa Spinning Co., Ltd. Chiryu Pl. (01-31)	13
h. Nisshin Boseki K.K. Wiai Kojyo (01-331)	18

Memo, GHQ, SCAP to Reparations Agency, Tokyo, 387.6(18 Feb 50)ESS/IND,
 subj: Application for Authorized Use of Items Listed for Reparations,
 18 Feb 50.

<u>Company Name</u>	<u>Number of Items</u>
i. Shin-Fuso Metal Industries Ltd., Copper Works (01-45)	19
j. Owari Tokai Co., Ltd. Seto Pl. (01-43)	12
k. Toyoda Automatic Loom Works Ltd., Sako Works (01-49)	1
l. Toyota Motor Co., Ltd. Kariya North Pl. (01-46)	105
m. Aichi Kogyo K.K. Kariya Factory (01-51)	41
n. Yajima Kogyo Co., Ltd. Main Plant (01-53)	8
o. Mitaka Bussan K.K. Inazawa Pl. (01-72)	33
p. Okuma Kogyo K.K. Kariida Pl. (01-83)	138
q. Asahi Okuma Industrial Co., Ltd. (01-69)	3
r. Aichi Koki Co., Ltd. Nagoya Pl. (01-77)	70
s. Fuji Industrial Co., Ltd. Handa Pl. (01-35)	50
t. Kawasaki Kokuki Kogyo K.K. Ichinomiya Pl. (01-23) (To be Used at Soto Kogyo K.K.)	8
TOTAL	778 Items

3. This permit is issued subject to any and all directives affecting reparations plants which have been issued or may hereafter be issued by the Supreme Commander for the Allied Powers. Reports will be rendered

Memo, GHQ, SCAP to Reparations Agency, Tokyo, 387.6(18 Feb 50)ESS/IND,
subj: Application for Authorized Use of Items Listed for Reparations,
18 Feb 50.

as required by current directives and instructions.

FOR THE CHIEF, ECONOMIC AND SCIENTIFIC SECTION:

Copies furnished:
CA Sec (dup)
CPC

MAURICE M. CLASS
Chief, Industry Division

MEMO FOR RECORD:

The above ltr is self-explanatory.

Mr. R. A. Steele:
26-6552

COPY

Komi Engineering Works,
Mitsubishi Heavy-Industries, Ltd.

Nov. , 1949.

To : Mr. Heitaro Inagaki,
Minister of International Trade & Industry.

Subject : Application for "Utilization" of reparation machines.

From : Komi Engineering Works of the Mitsubishi Heavy-Industries,
Ltd.

Applicant :

Name: Senichi Satoh, General Manager of the Komi Engineering Works, Mitsubishi Heavy-Industries, Ltd.

Address: No. 280, 1-chome, 9-bancho, Minato-ku, Nagoya City.

1. Name (Code No.) and address of the plant wherein the reparation machines & equipments which are located at present:

a) Name of the plant:

Komi Engineering Works of the Mitsubishi Heavy-Industries, Ltd. (Code Number 01 - 89)

b) Address: No. 280, 1-chome, 9-bancho, Minato-ku Nagoya City.

2. Outline of the reparation machines to be utilized:

The Machines which wanted to be utilized has been granted for "Temporary Use" from 19 Oct. 1949 to 18 Jan. 1950 by Aichi Civil Affairs Team. For details of these machines (34) please refer to the attached list.

3. Outline of the plant which submits this application:

a) Present production circumstances:

Permitted production items	Maximum Production (Monthly)	Remarks
Rice-hullers	800	
Power agricultural machines & implements (Mowers, Tractors)) 250	Production of these items (X) is now suspended
Internal combustion engines (light oil engines)) 400	
Electric refrigerators	150	
Scales	2,500	
X Tools	3,600	
X Parts for spinning & weaving machines) 50	
X Electric stoves	120	
X Repair of vehicles	By order	

b) Reparation machines:

Name of machines	Number of machines in operation			Number of Machines in non-operation	Total Number
	A.U.	T.O.	E.X.		
Machine Tools	238	29	20	1	288
Industrial machines	145	2	3	10	160
Electric Machines	32	3	42	4	81
Others	6	0	3	0	9
Total	421	34	68	15	538

c) Number of employees & workers:

Workers	818
Employees	232
Total	1,050

Remarks: At the end of Oct. 1949.

4. Reasons necessitating utilization of machines:

- (1) Komi Plant had been operated at 11. Shitamori, Shinchi, Yawatacho, Chita-gun Aichi-ken, with the conversion permit. Movement of the reparation machinery to Nagoya Plant, (280, 1-chome, 9-bancho, Minato-ku, Nagoya) has been authorized by Aichi Civil Affairs Team on Dec. 27, 1948. and the transference completed.
- (2) And, for the following reasons, we have been granted to use thirty-four (34) machines by Aichi C.A.T.:
- To rearrange the machinery and equipment.
 - To Change the production processes.
 - To increase the production up to the authorized amount.

Under these circumstances, we want to utilize these machines continuously. So it will be much appreciated if your kind consideration is given on this application.

5. There is no alteration of permitted production items and its number by utilizing these machines.

 Senichi Satoh
 General Manager of the
 Komi Engineering Works,
 Mitsubishi Heavy-Industries, Ltd.

List of the Machines wanted to be used

Inventory Number	Item	Type & Capacity	Manufactured	Purpose for which item is being used
01 - 89 -	1 Drilling machine	MDH 180 m/m	Mitsubishi Denki	1. Parts of Electric refrigerators 2. Holing screw 3. Reduction of labor cost
	4 Honing machine	No. 6	Yamaguchi Seiki	1. Parts of agricultural engines 2. Working Shaft 3. Superior quality
	5 Abrasive Cutting	150 m/m	Nippon Setsudanki	1. Parts of Electric refrigerators 2. Cutting of materials 3. Redction of labor cost
	7 Lathe	No. 3	Sankyo Kikai	1. Parts of rice-hullers 2. Working shaft gear 3. Superior quality
	8 Lathe	No. 3	Sankyo Kikai	1. Parts of refrigerators 2. Finishing piston & pin-shaft 3. Superior quality
	10 Lathe	4" x 0"	Kanno Tekko	1. parts of refrigerators 2. Finishing piston & pin-shaft 3. Reduction of labor cost
	13 Turret Lathe	HA - 50	Tokyo Kikai	1. Parts of agricultural engines 2. Working inner part of cylinder and sleeve 3. Superior quality

13	Turret Lathe	HA - 50	Tokyo Kikai	<ol style="list-style-type: none"> 1. Parts of agricultural engines 2. Working inner part of cylinder and sleeve 3. Superior quality
15	Lathe	4' x 10"	Kanno Tekko	<ol style="list-style-type: none"> 1. Parts of Rice-hullers 2. Working of shaft 3. Superior quality
16	Lathe	4' x 10"	Kanno Tekko	<ol style="list-style-type: none"> 1. Parts of Rice-hullers 2. Working of shaft 3. Superior quality
17	Lathe	No. 3 1/2	Shinagawa Seiki	<ol style="list-style-type: none"> 1. Parts of Rice-Hullers 2. Working of shaft 3. Superior quality
19	Milling machine	No. 3	Ikegai Tekko	<ol style="list-style-type: none"> 1. Parts of agricultural engines 2. Finishing inner part of cylinder 3. Superior quality
21	Lathe	400 x 500 m/m	Mitsubishi Kosaku	<ol style="list-style-type: none"> 1. Parts of Rice-hullers 2. Working of gear 3. Superior quality
23	Grinding machine	No. 13	Dainihon Kosaku	<ol style="list-style-type: none"> 1. Part of agricultural engines 2. Grinding crank shaft 3. Superior quality
60	Lathe	6' x 0"	Okaya Koki	<ol style="list-style-type: none"> 1. Parts of Rice-hullers 2. Working of gear 3. Superior quality
68	Shaper	24"	Kojima Tekkosho	<ol style="list-style-type: none"> 1. Parts of agricultural engines 2. Working of base 3. Reduction of labor cost

DECLASSIFIED E.O. 12065 SECTION 3-402/NNDG NO. 775013

Inventory Number	Item	Type & Capacity	Manufactured	Purpose for which item is being used
01 - 89 - 75	Rotary Slitting Shears	10 x 1000 m/m	Yamakawa Presse	1. Parts of rice-hullers 2. Cutting 3. Reduction of labor cost
77	Sawing machine-precision	6' x 6"	Hinomoto Seisaku	1. Parts of rice-huller 2. Cutting materials 3. Reduction of labor cost
80	Turret Lathes	900 m/m	Shinagawa Seiki	1. Parts of rice-hullers 2. Working Gear-box 3. Superior quality
84	Boring machine	No. 47 A	Heald	1. Parts of agricultural engines 2. Finishing crank-pin 3. Superior quality
87	Shaper	ND	Kojima Seisaku	1. Parts of rice-hullers 2. Working gear-box 3. Reduction of labor cost
90	Shaper	16"	Nishikawa Seisaku	1. Parts of rice-hullers 2. Working gear-box 3. Reduction of labor cost
92	welding machine	MH-W 18 KVA	Mitsuba Kosaku	1. Parts of refrigerators 2. Welding box 3. Superior quality
93	welding machine	16 KVA	Shibaura Denki	1. Parts of refrigerators 2. Welding box 3. Superior quality

93	Welding machine	16 KVA	Shibaura Denki	<ol style="list-style-type: none"> 1. Parts of refrigerators 2. Welding box 3. Superior quality
144	Grinding machine	BBF 2 HP	Mizuno Kikai	<ol style="list-style-type: none"> 1. Parts of refrigerators 2. Finishing box 3. Superior quality
145	Grinding machine	YHM 2 HP	Mizuno Kikai	<ol style="list-style-type: none"> 1. Parts of refrigerators 2. Finishing box 3. Superior quality
151	Furnace	8 KVA	Ohino Seisaku	<ol style="list-style-type: none"> 1. Parts of mowers 2. Welding & annealing 3. Superior quality
156	Welding machine	12,5 KVA	Osaka Henatsu	<ol style="list-style-type: none"> 1. Parts of mowers 2. Welding & annealing 3. Reduction of labor cost
183	Gear Cutting machine	12"	Gleason	<ol style="list-style-type: none"> 1. Parts of mowers 2. Gear cutting 3. Reduction of labor cost
186	Grinding machine	T-81 300 m/m	Toyo Kogyo	<ol style="list-style-type: none"> 1. Parts of agricultural engines 2. Grinding cylinder 3. Superior quality
190	Lathe	1500 x 1500 m/m	Osaka Juko	<ol style="list-style-type: none"> 1. Parts of refrigerators. 2. Working flywheel 3. Reduction of labor cost
216	Centering machine	No. 13	Okuma Tenko	<ol style="list-style-type: none"> 1. Parts of rice-hullers 2. Centering 3. Reduction of labor cost
254	Grinding machine	No. 72 A	Heald	<ol style="list-style-type: none"> 1. Parts of refrigerators 2. Grinding inner part of crank. 3. Superior quality

DECLASSIFIED E.O. 12065 SECTION 3-402/NNDG NO. 775013

Inventory Number	Item	Type & Capacity	Manufactured	Purpose for which item is being used
01 - 89 - 292	Grinding machine	TUG - 300	Tsugami Seisaku	Parts of rice-hullers Grinding shaft Superior quality
305	Honing machine	GHB - 630	Osaka Kiko	Parts of agricultural engine Working shaft Superior quality
	Total		34	

Remarks : Purpose (1) Name of parts to make by utilizing the machine.
(2) Working portion of machine parts.
(3) Efficiency to products.

CENTRAL JAPAN HEAVY INDUSTRIES LTD,
NAGOYA ENGINEERING WORKS

No. 2, OCHIDORI, MINATOKU, NAGOYA, JAPAN

27 December 1950

SUBJECT: Report on Rescission of Authorized Use Equipment
TO: The Ministry of International Trade and Industry.
FROM: Nagoya Engineering Works
Central Japan Heavy-Industries, Ltd.
(Former No.3 Works, Mitsubishi Heavy-Industries, Ltd.)

1. **Plant Name and Location (Code Number)**

a) **Name of Plant**

Nagoya Engrg Works, Komi Plant
Central Japan Heavy-Industries, Ltd.
(Former No.3 Works, Mitsubishi Heavy-Industries, Ltd.)

b) **Location**

No.280, 1-Chome, 9-Bancho, Minato-ku, Nagoya.

c) **Code Number 01-89**

2. **User:** Komi Plant, Nagoya Engrg Works,
Central Japan Heavy-Industries, Ltd.

3. **Reason of Rescission:**

Owing to the change of using machine
due to the change of production process.

4. **Total number of Rescinded Equipment:**

2 sets (Detail as per attached sheet)

5. **Name of Reporter**

Joji Hattori
for Joji Hattori
General Manager
Nagoya Engrg Works
Central Japan Heavy-Industries, Ltd.

Attached sheet

List of Rescinded Equipment

<u>Inventory No.</u>	<u>Name of Equipment</u>	<u>Remarks</u>
01-89-84	Boring machine	(Page of Eval. Sheets) 2 of 61 sheets
" 183	Gear - Cutter	3 of 61 "

Total 2 sets

4/dec

CENTRAL JAPAN HEAVY INDUSTRIES, LTD.
 NAGOYA ENGINEERING WORKS
No. 2 OYECHO MINATOKU, NAGOYA, JAPAN,

25 November 1950

SUBJECT: Report on Rescission of Authorized Use Equipment.

TO: The Ministry of International Trade and Industry.

FROM: Nagoya Engineering Works
Central Japan Heavy-Industries, Ltd.
No. 2, Oye-cho, Minato-ku, Nagoya.

1. Plant Name and Location (Code Number)

a) Name of Plant

Nagoya Engrg Works, Komi Plant
Central Japan Heavy-Industries, Ltd.
(Former No. 3 Works, Mitsubishi Heavy-Industries, Ltd.)

b) Location

No. 280, 1-Chome, 9-Bancho, Minato-ku, Nagoya.

c) Code Number 01-89

2. **User:** Nagoya Engrg Works, Komi Plant,
Central Japan Heavy-Industries, Ltd.

3. **Reason of Rescission:**

Owing to the change of using machine due
to the change of production process.

4. **Total Number of Rescinded Equipment**

182 machines (as per attached list)

5. **Name of Reporter:**

Joji Hattori

Joji Hattori
General Manager
Nagoya Engrg Works
Central Japan Heavy-Industries, Ltd.

List of Rescinded Equipment

<u>Inventory No.</u>	<u>Name of Equipment</u>	<u>Remark</u>
01-89- 1	Drilling Machine, Vertical	1
" 3	" " "	1
" 4	" " "	1
" 6	Lapping machine, Cylindrical	1
" 7	Sawing Machine, Hack.	1
" 8	Lathe- Engine.	1
" 10	" " "	1
" 11	" " "	1
" 13	Lathe-Turret (Saddle type)	1
" 15	Lathe-Engine.	1
" 16	" " "	1
" 17	" " "	1
" 19	Milling Machine-Knee, Vertical.	1
" 22	Milling Machine, Bed type.	1
" 23	Grinder Tool and Cutter (Universal)	1
" 27	Transformer-Indoor type	1
" 30	Switch, Gear-Indoor type.	1
" 32	Slotter- Vertical.	1
" 33	Drilling Machine-Vertical.	1
" 35	Drilling Machine-Radial.	1
" 36	Grinder-Tool & Cutter (Universal)	1
" 37	Milling Machine-Die Sinker-Vertical.	1
" 39	Milling Machine-Universal.	1
" 40	Milling Machine-Universal.	1
" 41	Milling Machine-Knee-Vertical	1
" 42	" " " "	1
" 43	" " " "	1
" 44	" " " "	1
" 45	" " " Universal	1
" 47	Grinder-Tool & Cutter-Stand	1
" 49	Lathe-Engine	1
" 50	" " "	1
" 51	" " "	1
" 52	Lathe-Turret (Ram type)	1
" 53	Shaper-Horizontal	1
" 59	Lathe-Engine	1
" 60	Lathe-Engine	1
" 61	" " "	1
" 63	" " "	1
" 64	" " "	1
" 65	Shaper-Horizontal	1
" 67	Lathe-Engine	1
" 68	Shaper-Horizontal	1
" 69	Compressor-Air	1
" 70	Lathe-Engine	1
" 71	Milling Machine, Horizontal.	1
" 72	Lathe-Engine	1
" 73	" " "	1
" 75	Shearing Machine-Rotary-Slitting	1
" 79	Drilling Machine, Radial	1
" 83	Shaper-Horizontal	1
" 87	Shaper-Horizontal	1
" 88	Lathe-Engine	1
" 89	" " "	1
" 90	Shaper-Horizontal	1
" 91	Drilling Machine-Vertical	1
" 104	Mechanical Press-Friction	1
" 107	Grinder-Tool and Cutter	1

Sub-Total 58

List of Rescinded Equipment

<u>Inventory Number.</u>	<u>Name of Equipment.</u>	<u>Remark</u>
01-89-108	Grinder-Tool and Cutter.	1
" 113	Compressor-Air	1
" 114	" "	1
" 116	Mechanical Press 1 Point Vertical	1
" 117	Mechanical Press-Inclinable	1
" 118	" " "	1
" 119	" " "	1
" 120	Mechanical Press-Friction	1
" 122	Grinder-Bench (Stand)	1
" 127	Bending Machine-Plate-Non Auto	1
" 128	Shrinking Machine.	1
" 130	" " "	1
" 132	Shearing Machine - Rotary	1
" 135	" " - S enar	1
" 137	Drilling Machine-Bench-Vertical	1
" 140	Grinder-Bench type-Double Head	1
" 142	Drilling Machine-Bench-Vertical	1
" 143	Drilling Machine-Bench	1
" 145	Grinder-Bench (Stand)	1
" 151	Furnace-Heating-Elect (Resist)	1
" 160	Welding Machine-Elect. flash Bat.	1
" 167	Transformers-Indoor type	1
" 168	" " "	1
" 169	Switch Gear-Indoor type	1
" 179	Sawing Machine-Hack	1
" 186	Grinder-Internal	1
" 188	Grinder-Tool and Cutter (Special)	1
" 190	Lathe-Engine	1
" 195	Milling Machine-Knee-Vertical	1
" 196	Milling Machine-Vertical	1
" 216	Centering Machine	1
" 226	Drilling Machine-Bench-Vertical	1
" 258	Milling Machine-Knee type-Vertical	1
" 259	" " "	1
" 260	Milling Machine-Vertical-Horizontal	1
" 261	Milling Machine-Knee type, Horizontal	1
" 263	" " "	1
" 275	" " Thread	1
" 278	Switch Gear-Indoor type	1
" 279	" " "	1
" 280	" " "	1
" 281	Grinder-Tool & Cutter (Stand)	1
" 284	Lathe-Engine-Gap	1
" 285	Grinder-Tool and Cutter	1
" 286	Milling Machine-Vertical	1
" 287	Milling Machine-Knee-Horizontal	1
" 288	Drilling Machine-Bench	1
" 289	Drilling Machine-Vertical	1
" 290	Lathe-Engine-Gap	1
" 292	Grinder-Universal	1
" 293	Shaper-Horizontal	1
" 294	Lathe-Engine	1
" 295	" " "	1
" 296	" " "	1
" 298	Drilling Machine-Bench-Vertical	1
" 299	" " " "	1
" 300	" " " "	1
" 301	" " " "	1
" 302	Grinder, Tool and Cutter.	1
" 304	Compressor-Air	1
	Sub-total	60

List of Rescinded Equipment

<u>Inventory Number.</u>	<u>Name of Equipment</u>	<u>Remark</u>
01-89-316	Manual Press-Bench	1
" 318	" " Floor	1
" 321	" " Bench	1
" 323	Switch Gear-Indoor type	1
" 328	Blower-impeller	1
" 330	Manual Press-Bench	1
" 331	" " "	1
" 333	Bending Machine-Pipe-Non Auto	1
" 335	Manual Shear-Square-Bench	1
" 336	" " "	1
" 339	Acetylene Gas Generator-Torch	1
" 340	" " "	1
" 341	" " "	1
" 351	Portable Drill-Elect.	1
" 352	" " "	1
" 353	" " "	1
" 354	" " "	1
" 355	" " "	1
" 356	" " "	1
" 357	" " "	1
" 358	" " "	1
" 359	" " "	1
" 366	" " "	1
" 367	" " "	1
" 368	" " "	1
" 369	" " "	1
" 370	" " "	1
" 371	" " "	1
" 377	" " "	1
" 378	" " "	1
" 379	" " "	1
" 380	" " "	1
" 381	" " "	1
" 382	" " "	1
" 383	" " "	1
" 384	" " "	1
" 385	" " "	1
" 386	" " "	1
" 416	Manual Shear-Square-Bench	1
" 417	Manual Press-Bench, Excentric Press	1
" 418	Manual Press-Floor Press.	1
" 419	Manual PresseBench Pressa.	1
" 420	Grooving Machine	1
" 421	Furnace-Heating-Elect. (Resist)	1
" 425	Manual Press-Bench Pressa.	1
" 426	" " Arbor Press.	1
" 430	Acetylene-Gas Generator, Torch	1
" 465	Pump	1
" 470	Furnace Heating	1
" 471	Blower	1
" 474	"	1
" 476	Stoker 80 Kg/hr witch blower	1
" 478	Blower	1
" 479	"	1
" 481	"	1
" 484	"	1
" 485	Furnace-Heating Coal	1
" 487	Blower	1
" 488	Oil tank welded	1
" 489	" " "	1
" 491	Fire Car- (Non Auto)	1
	Sub-total	61

List of Rescinded Equipment

Page 4 of 4 pages,

<u>Inventory Number.</u>	<u>Name of Equipment</u>	<u>Remark</u>
01-89-492	Fire-Car (Auto)	1
" 496	Switch Board-Telephone	1
" 499	Motor - 3 HP	1

Subtotal 3

Grand Total 182

CENTRAL JAPAN HEAVY INDUSTRIES, LTD.
NAGOYA ENGINEERING WORKS
No. 2 OYE-CHO, MINATO-KU, NAGOYA, JAPAN.

27 December 1950

SUBJECT: Report on Rescission of Authorized Use Equipment

TO: The Ministry of International Trade and Industry.

FROM: Nagoya Engineering Works,
Central Japan Heavy-Industries, Ltd.
No. 2, Oye-cho, Minato-ku, Nagoya.

1. Plant Name and Location (Code Number)
 - a) Name of Plant
Nagoya Engrg Works, Komi Plant
Central Japan Heavy-Industries, Ltd.
(Former No. 3 Works, Mitsubishi Heavy-Industries, Ltd.)
 - b) Location
No. 280, 1-chome, 9-Bancho, Minato-ku, Nagoya.
 - c) Code Number 01-89
2. **User:** Komi Plant, Nagoya Engrg Works,
Central Japan Heavy-Industries, Ltd.
3. **Reason of Rescission:**
Owing to the change of using machine due
to the change of production process.
4. **Total number of Rescinded Equipment:**
3 machines (As per attached list)
5. **Name of Reporter.**

Joji Okada

for Joji Hattori
General Manager
Nagoya Engrg Works
Central Japan Heavy-Industries, Ltd.

Attached sheet

List of Rescinded Equipment

<u>Inventory No.</u>	<u>Name of Equipment</u>	<u>Remarks</u>
01-89-21	Lathe-Engine	1 of 61 sheets
" -77	Sawing	2 of 61 sheets
" -254	Grinder	3 of 61 sheets
	Total	3 sets

NAGOYA ENGINEERING WORKS
CENTRAL JAPAN HEAVY INDUSTRIES, LTD
(NAKA NIPPON JUKOGYO KABUSHIKI KAISHA)
NO. 2, OYE-CHO, MINATO-KU, NAGOYA, JAPAN.

TOKYO OFFICE
NO. 1, NISHI 8-CHOME,
GINZA, CHUO-KU,
TOKYO, JAPAN.

CABLE ADDRESS
"ENGR NAGOYA"

CODE USED
BENTLEY'S
2ND EDITION

Nagoya, 5 September 1950

SUBJECT: Report on Additional "EX" Equipment

TO : Hq. Tokai-Hokuriku Civil Affairs Region
(Attn: Chief, Economic Section)

We request to move the listed equipment which are now located in the non-custody area in our Komi Plant to the custody area in the Oye Plant and use them as "EX" machines.

The Oye Plant is now mainly making bus bodies and other sheet metal products and the said machines are necessary for reinforcing the short capacity of the existing equipment.

Joji Hattori

for **Joji Hattori**
General Manager
Nagoya Engr Works

APPROVED

E. F. Jourd
E. F. Jourd DAC
Economics Div. THCAR

Date *26 Sept. '50*

by Y. Yamamoto

List of "EX." Machinery Desired to Move

(Oye Plant)

<u>Inventory No.</u>	<u>Name of Machine</u>	<u>Specification</u>	<u>Name of Maker</u>	<u>Remarks</u>
01-26a-1740EX	Switch board	3300 V	Hitachi	These equipment are now existed in the non-custodian area of our Kemi Plant
" 1741EX	"	3300 V	"	
" 1742EX	"	3300 V	"	
" 1743EX	"	3300 V	"	
" 1744EX	Transformer	200 KVA	Mitsubishi Denki	"
" 1745EX	"	200 KVA	"	"
" 1746EX	"	20 KVA	Hitachi	"
" 1747EX	"	20 KVA	"	"
" 1748EX	Grinder, Universal	400	Okuma	"
" 1749EX	Drilling machine, Radial		Karatsu	"
" 1750EX	Drilling machine, Bench	12 m/m	Washino	"
" 1751EX	Lathe-engine	8'	Ikegai	"
" 1752EX	Rotary shear	2x760	Nippon Press	"
" 1753EX	Power Press	20 tons	Ezaki	"
" 1754EX	Drilling machine, Bench	10 tons	Toho Booki	"
" 1755EX	Welding machine, spot.	II type	Dengensha	"
" 1756EX	"	I type	"	"
" 1757EX	"	"	"	"
" 1758EX	Welding machine, Electric Arc	29KVA	Morioka	"
" 1759EX	Grinder, double head	10"	Mizuho	"
" 1760EX	Tenoner		Unknown	"
" 1761EX	Switch board	3300 V	Takashima Seisaku	"
" 1762EX	"	3300 V	"	"
" 1763EX	"	100 V	"	"
" 1764EX	"	100 V	"	"

APPROVED

E. F. Jouard DAC
Economics Div.
Date _____

<u>Inventory No.</u>	<u>Name of Machine</u>	<u>Specification</u>	<u>Name of Maker</u>	<u>Remarks</u>
01-26a-1765EX	Switch board	100 V	Takashima Seisaku	These equipment are now existed in the non-custodian area of our Komi Plant
" 1766EX	"	"	"	
" 1767EX	"	"	"	
" 1768EX	Transformer	50 KVA	Osaka-Henatsu	
" 1769EX	"	"	"	"
" 1770EX	"	"	"	"
" 1771EX	"	100 KVA	Mitsubishi Denki	"
" 1772EX	"	"	"	"
" 1773EX	Generator		Unknown	
" 1774EX	Welding machine, spot	I type	Dengensha	"
" 1775EX	Wood works, sawing machine, band	30"	Washino	"
" 1776EX	Planer, hand	16"	Antluce	"
" 1777EX	Mechanical press friction	50 tons	Yamakawa Press	"
" 1778EX	Blower & fan		Rikagaku Kogyo K.K.	"
" 1779EX	"	"	"	"
" 1780EX	"	"	"	"

Total 42 sets

Number of last installed "EX" machine 68 sets
 " " applied "EX" machine 42 sets
 " " present non-inventrical "EX" machine 110 sets

APPROVED
E. F. Jourd
 E. F. Jourd DAC
 Economics Div. T-1248
 Date 26 Sept. '50

CENTRAL JAPAN HEAVY INDUSTRIES, LTD.
 **NAGOYA ENGINEERING WORKS**
 No. 2 OYE-CHO MINATOKU, NAGOYA, JAPAN.

2 September 1950

SUBJECT: Application for Permission to Move "EX" Machinery.

TO : Hq. Tokai-Hokuriku Civil Affairs Region
 (Attn: Chief, Economic Section)

Permission to move the "EX" machinery as per attached list from the Komi plant to the Oye plant is hereby requested.

Present address of machines

Komi plant, Code No.01-89
 280, 1-chome, 9-bancho, Minato-ku, Nagoya

Address to where machines are to be moved

Oye plant, Code No.01-26a
 10, Oye-cho, Minato-ku, Nagoya

The said machinery are necessary in the Oye plant for bus body construction work. The machinery requiring movement have been confirmed by your office as "EX" machines.

Joji Hattori

Joji Hattori
 General Manager
 Nagoya Engr Works

APPROVED
E. F. Jourd
 E. F. Jourd DAC
 Economics Div. THCAR
 Date 26 Sept. 50

by Y. Yamamoto

List of "EX" Equipment Desired to Move

Present Location: Komi Plant

<u>Inventory No.</u>	<u>Name of Machine</u>	<u>Specification</u>	<u>Name of Maker</u>
01-89-310EX	Grinder, centerless	320x180	Karatsu
" 503 "	Chain block	1 ton	Okaya
" 504 "	" -"	1 "	" -"
" 539 "	Surface plate	-	-
" 513 "	Electric motor	3 HP	Hitachi
" 514 "	" -"	" -"	" -"
" 515 "	" -"	" -"	" -"
" 516 "	" -"	2 HP	" -"
" 431 "	Welding machine, spot	400 KVA	Dengensha

Total 9 sets

Oye Plant
 Number of last installed "EX" machine ----- 59
 " " applied "EX" machine ----- 9
 " " present non-inventrical "EX" machine ----- 68

Komi Plant
 Number of present non-inventrical "EX" machine ----- 51

APPROVED
E. F. Jovan
 E. F. Jovan, DAC
 Economics Div. THCAR
 Date 20 Sept. '50

CENTRAL JAPAN HEAVY INDUSTRIES LTD.
 NAGOYA ENGINEERING WORKS
 No. 2 OYECHO MINATOKU, NAGOYA, JAPAN,

2 September 1950

SUBJECT: Application for Permission to Move "EX" Machinery.

TO : Hq. Tokai-Hokuriku Civil Affairs Region
 (Attn: Chief, Economic Section)

Permission to move the "EX" machinery as per attached list from the Komi plant to the Daiko plant is hereby requested.

Present address of machines

Komi plant, Code No.01-89
 280, 1-chome 9-bancho, Minato-ku, Nagoya

Address to where machines are to be moved

Daiko plant, Code No.01-25a
 998, Okinaka, Daiko-cho, Higashi-ku,
 Nagoya

The said machinery are necessary in the Daiko plant for the increased production of Diesel Engine. The machinery requiring movement have been confirmed by your office as "EX" machine.

Joji Hattori

Joji Hattori
 General Manager
 Nagoya Engr Works

APPROVED
A. F. Jourd
 E. F. Jourd DAC
 Economics Div. THCAR

Date *26 Sept '50*

by Y. Yamamoto

List of "EX" Machinery Desired to Move

Present location: Komi plant

<u>Inventory No.</u>	<u>Name of Machine</u>	<u>Specification</u>	<u>Name of maker</u>
01- 29 -308EX	Grinder, universal	270 x 2100	Landis
" 306 ³¹¹ EX	Hoist	1 ton	Mitsubishi Denki
<u>Total</u>		<u>2 sets</u>	

Daiko plant

Number of last installed "EX" machine ----- 206
 " " applied "EX" machine ----- 2
 " " present non-inventrical "EX" machine-- 208

Komi plant

Number of present non-inventrical "EX" machine-- 49

APPROVED
 E. F. Jouard DAC
 Economics Div. THCAR
 Date 26 Sept. '50

CENTRAL JAPAN HEAVY INDUSTRIES, LTD.
 NAGOYA ENGINEERING WORKS
 No. 2 OYECHO MINATOKU, NAGOYA, JAPAN,

2 September 1950

SUBJECT: Application for Permission to Move "EX"
 Machinery

TO : Hq. Tokai-Hokuriku Civil Affairs Region
 (Attn: Chief, Economic Section)

Permission to move the "EX" machinery as per
 attached list from the Komi Plant to the Iwatsuka Plant
 is hereby requested.

Present address of machines

Komi Plant, Code No.01-89
 280, 1-Chome 9-Bancho, Minato-ku, Nagoya

Address to where machines are to be moved

Iwatsuka Plant, Code No.01-27a
 1, Miya-higashi, Iwatsuka-cho, Nakamura-ku,
 Nagoya

The said machinery are necessary in the Iwatsuka
 Plant for the increased production of fiber machines. The
 machinery requiring movement have been confirmed by your
 office as "EX" machine.

Joji Hattori

Joji Hattori
 General Manager
 Nagoya Engr Works

APPROVED
E. F. Jouard
 E. F. Jouard, DAC
 Economics Div. THCAD
 Date *26 Sept. '50*
by J. Yamamoto

List of "EX" Machinery Desired to Move

Present location: Komi Plant

<u>Inventory No.</u>	<u>Name of Machine</u>	<u>Specification</u>	<u>Name of Maker</u>
01-89-533EX	Electric motor	1/2 HP	Shibaura
" 536 "	" -" -	1/4 HP	Mitsubishi
" 469 "	Hardness tester	Brinnel	Tokyo Kikai
" 307 "	Hoist	1 ton	Mitsubishi
" 309 "	Grinder, surface	60x150	Heald
" 306 ³⁰⁶ "	Hoist	1 ton	Mitsubishi
" 511 "	Vaccum pump		Mitsubishi
" 517 "	Electric motor	1 HP	Meidensha
" 518 "	" -" -	1/2 "	Mitsubishi
" 529 "	" -" -	1/2 "	Shibaura
" 530 "	" -" -	1 "	Mitsubishi
" 532 "	" -" -	1 "	" -"
" 534 "	" -" -	1 "	Matsushita
" 537 "	" -" -	1 "	Shibaura
Total		14 sets	

Iwatsuka Plant

Number of last installed "EX" machines ----- ¹²⁵~~126~~
 " " applied "EX" machines ----- 14
 " " present non-inventrical "EX" machines - ~~6~~
139

Komi Plant

Number of present non-inventrical "EX" machines- 35

APPROVED

E. F. Jourd' BAC
 Economics Div.

Date 26 Sept. '50

file

MITSUBISHI HEAVY INDUSTRIES, CO., LTD.
KOMI PLANT

25, March,

SUBJECT: Application for Release of EX Machines in
Komi Plant

TO: Hq. Tokai-Hokuriku Civil Affairs Region

FROM: Mitsubishi Heavy-Industries, Ltd.
(Former 3 Works)

1. Release of EX machines in Komi plant is hereby requested.
Item : Full details as per attached sheet.
2 sets
2. Komi plant has been in operation manufacturing agricultural machinery but recently we decided to close the plant and hereby request the release of EX Machines located in the Plant as we wish to move them to non reparations plants.

Y. Morikawa.

Y. Morikawa
Custodian of Komi PlantAPPROVED
*E. F. Jourd*E. F. Jourd DAC
Economics Div. IECARDate *26 mar. '57**by Y. Yawamori*

List of Machine to Release

<u>EX No.</u>	<u>Name of Machine</u>
01-89-312	Grinding machine
313	"
319	"
324	Bevel gear cutter
415	Grinding machine
432	Transformer
498	Grinding machine
500	Blower
501	Blower
502	Grinding machine
505	Motor
506	"
510	"
512	"
519	"
523	"
524	"
525	"
526	Fan Motor
527	"
528	"
531	Motor
535	"
538	"
Total	<u>24 Sets</u>

Mitsubishi

NAGOYA ENGINEERING WORKS
CENTRAL JAPAN HEAVY INDUSTRIES, LTD
2, Oye-cho, Minato-ku
Nagoya Japan

August 1950

SUBJECT: Application for Movement and Authorized Use of
Designated Reparation Machinery and Equipment.

TO : Ministry of International Trade and Industry.

FROM : Shinzo Fujii,
President, Central Japan Heavy Industries, Ltd.
No.1, 7-chome, Wadamiya-dori, Hyogo-ku, Kobe-shi.

Name and Address of the Representative for the Above

Joji Hattori,
General Manager,
Nagoya Engineering Works,
Central Japan Heavy Industries, Ltd.
2, Oye-cho, Minato-ku, Nagoya.

Name and Address of Tokyo Representative:

Takashi Ochiai
General Affairs Section, Tokyo Office,
Central Japan Heavy Industries, Ltd.,
No.1 Nishi 8-chome, Ginza, Chuo-ku, Tokyo.
Telephone: (57) 6361, 9019.

1. Name, (Code Number, Category) and location of the plant which intends to use designated reparation machinery and equipment.

Nagoya Engineering Works, Daiko Plant,
Central Japan Heavy Industries, Ltd.,
(Former Mitsubishi Heavy Industries, Ltd.,
Ryowa Engr Works, No.4 Works).

Location: No.998, Okinaka, Daiko-cho, Higashi-ku, Nagoya.

Code No. 01-25a

Category: Aircraft

2. Name, (Code Number, Category) and location of the plant where designated reparation machinery and equipment to be used actually exists.

Nagoya Engineering Works, Komi Plant,
Central Japan Heavy Industries, Ltd.,
(Former Mitsubishi Heavy Industries, Ltd.,
Komi Engineering Works, No.3 Works).

Location: No.280, 1-chome, 9-bancho,
Minato-ku, Nagoya

Code No. 01-89

Category: Aircraft

3. List of designated reparation machinery and equipment to be moved and used.

Machine Tools 10 sets.
(Details as per attached list).

4. Necessity for Movement and use of Machinery and Equipment.

The Nagoya Engineering Works consists of 5 works--Oye, Daiko, Iwatsuka, Komi, and Tsu plants. As these constituent plants are located sporadically at remoted places we were confronted with many obstructions and inconveniences.

We decided, therefore, to close the Komi plant and merge it with the other plants in Nagoya area for the purpose of economy and rationalizing operation.

The Daiko Plant is now producing diesel engines which are now commanding high-reputation in quality throughout the nation. Moreover the export of these engines to Pakistan and Philippines is increasing monthly.

The equipment at our Daiko plant is insufficient to meet this increasing demand and we are therefore requesting permission to move the 10 machines (as per attached list) from the Komi plant to Daiko plant.

Shiro Iguchi

for
Joji Hattori
General Manager
Nagoya Engr Works

List of Designated Reparation Machinery and Equipment Desired to Use

Applicant: Central Japan Heavy Industries, Ltd.,
Nagoya Engr Works, Daiko Plant
(Evaluated Plant)

<u>Name of machine</u>	<u>Name of mfg. Co.</u>	<u>Type & dimension</u>	<u>Inventory number</u>	<u>Operation or idle</u>	<u>No. of item</u>	<u>Class</u>	<u>Old inventory or additional</u>	<u>Section of Evaluation sheet</u>	<u>Page of Evaluation sheet</u>
Lathe-Engine	Okuma Tekko	10"-0	01-89-185	Operation	1		Old inventory	A.U.	11 of 61
Lathe-Turret	Pittler Germany	Saddle type Bed L 50cm.	" 247	"	1		"	"	25 of 61
Lathe-Turret	Pittler Germany	Bed L 785 cm.	" 251	"	1		"	"	25 of 61
Milling machine	Cincinnati U.S.A.	Knee Horizontal	" 199	"	1		"	"	15 of 61
" "	Hitachi	Knee Universal	" 201	"	1		"	"	15 of 61
Drilling m/c	Dainippon Koki	Radial	" 225	"	1		"	"	15 of 61
Boring m/c	Heald Co. U.S.A.	Horizontal precision	" 84	"	1		"	"	2 of 61
Grinder	Landis U.S.A.	External Universal	" 86	"	1		"	"	13 of 61
Gear Cutter	Gleason	Straight Bevel	" 183	"	1		"	"	3 of 61
Slotter	Pratt & Whitney	Vertical	" 191	"	1		"	"	12 of 61
					<u>Total</u>	<u>10</u>			

DECLASSIFIED E.O. 12065 SECTION 3-402/NNDC NO. 775013

Attached sheet No.2

<u>Name of Machine.</u>	<u>Quantity.</u>	<u>Reason of Necessity.</u>
All these equipment are necessary for reinforcing insufficient capacity of large type lathe.		
Lathe-Engine	1	This is to be used for the rough shaping of crank shaft of diesel engine.
Lathe-Turret.	2	This is to be used for re-process work of pintive valve for diesel engine.
Drilling Machine-Radial	1	This is to be used for boring various holes on crank case and cylinder for diesel engine.
Boring Machine-Fine.	1	This is to be used for boring holes on cam shaft and crank shaft after crank case is assembled.
Grinder-Universal	1	This is to be used for grinding journal and crank shaft of diesel engine.
Bevel Gear & Generator.	1	This is to be used for making reversible gear of diesel engine
Slotter.	1	This is to be used for reprocess work on arm of crank shaft.
Milling Machine-Horizontal	2	This is to be used for reprocess work of Large type parts of diesel engine.

Total	<u>10</u>	

Supplementary Data

1. Present Production (Monthly)

<u>Products</u>	<u>Quantity</u>
Diesel Engine (5.5-25 HP)	150

2. Employee (As of July 1950)

<u>Clerk & Engineer</u>	<u>Worker</u>	<u>Total</u>
152	461	613

3. Machinery & Equipment in Use (As of July 1950)

<u>Machinery & Equipment</u>	<u>Quantity</u>
Machine Tool	426
Industrial Machine	18
Electric Machine	81
Power Generating Machine	20
Others	<u>131</u>
Total	<u>676</u>

COPY

NAGOYA ENGINEERING WORKS
CENTRAL JAPAN HEAVY INDUSTRIES, LTD
2, Oye-cho, Minato-ku
Nagoya Japan

1 March 1950

SUBJECT: Application for Permission to Move and Operate
Reparation Machinery.

TO: Mr. I. Ikeda,
Minister of International Trade & Industry.

FROM: Central Japan Heavy Industries, Ltd.
Nagoya Engineering Works
2, Oye-cho, Minato-ku, Nagoya.

1. Name and address of plant to which machinery is to be moved:

Komi plant (Code No. 01-89)
Nagoya Engineering Works
Central Japan Heavy Industries, Ltd.
No. 280, 1-chome, 9-Bancho,
Minato-ku, Nagoya.
(Former No. 3 Works, Mitsubishi Heavy Industries, Ltd.)

2. Name and address of plant from which machinery is to be moved:

East Japan Heavy Industries, Ltd.
Tokyo Engineering Works
No. 321, Shimomaruko-cho,
Ota-ku, Tokyo.
(Former Mitsubishi Heavy Industries, Ltd.,
Tokyo Engineering Works). Code No. 39-108.

3. Machinery desired to be moved:

Name of machine	Manufacturer	Type	Inventory No.	Use or none use	Quantity	Class
Welding machine (A.C. Arc)	Mitsuba Seisakusho.	9 KW	39-108-2376	none use	1	1
"	"	"	39-108-2387	"	1	1
Motor Generator	Chuo Seisakusho	15 V 500A	39-108-666	"	1	1
"	"	"	39-108-667	"	1	1
"	"	"	39-108-700	"	1	1
Total					5	

Remarks: Present location of the above machines:

East Japan Heavy Industries, Ltd.
Tokyo Engineering Works.

4. Actual state of plant to which machines are to be moved

- (a) Present major products
(Full particulars as per attached list No.1)

Rice huller
Agricultural kerosine engine
Refrigerator

- (b) Details of designated facilities & employees
(Full particulars as per attached list No.2 & 3)

The additional use of these machine will in no way affect the number of employees.

- (c) Producing experience and technique so far and its future plan.

Since obtaining reconversion permit to civil industry in May, 1946, we have been exerting our utmost in producing various machines such as agricultural machines and refrigerators which are essential in industrial revival of Japan and are also exporting same.

Major products scheduled for production

	Monthly production
Rice hulling machine	600
Refrigerator	100
Agricultural kerosine engine	200
Other agricultural machines	some

5. Reasons necessitating movement:

With the increased demand for agricultural machines but owing to the unbalanced and insufficiency of equipment, our Komi plant is faced with the situation of having to subcontract part of work which is causing a bottleneck especially in the production of the export rice hulling machines. It is therefore ~~below~~ anxiously requested to move and use the machines listed below.

<u>Name of machine</u>	<u>Code No.</u>	<u>Reasons for requiring machines</u>
Welding machine (A.C. Arc)	39-108-2376	(These machines are in urgent need to bill the insufficiency of (welding the export rice hulling machines, as the production is only 20 per month with the existing equipment.
"	"-2387	
Motor generator	39-108-666	(The electric generator for the plating shop is not enough, therefore (the plating capacity is low and (we are faced with the situation of (having to unavoidably subcontract (this work
"	39-108-667	
"	39-108-700	

Tokuo Hattori

for Joji Hattori
General Manager
Nagoya Engr Works

Attached list No.1

Actual state of plant to which machines are to be moved.

<u>Items permitted to produce</u>	<u>Name of authorities.</u>	<u>Date of permission.</u>	<u>Monthly production in January 1950</u>
Rice hulling machine	G.H.Q.	24 Nov 48	176
Agricultural kerosine engine	"	7 Mar 49	175
Hand tractor	"	7 Mar 49	20
Refrigerator	Hq. I Corps.	21 Jun 46	100

Attached list No.2

Details of designated facilities

<u>Name of machine</u>	<u>Total number</u>	<u>in Use</u>			<u>Non use</u>
		<u>AU</u>	<u>TO</u>	<u>RK</u>	
Machine tool	288	238	29	20	1
Industrial machine	160	120	2	3	35
Electric machine	81	32	3	42	4
Other machines	9	6	0	3	0
Total	538	396	34	68	40

Attached list No.3

Details of employee

<u>Employees</u>	<u>Worker</u>	<u>Clerk</u>	<u>Technician</u>	<u>Others</u>	<u>Total</u>
(As of Jan 50)	737	65	110	11	923

Remarks: No change in the number of employees due to the additional use of machines.

The number of the "others" column shows that of hospital & infirmaries (doctors & nurses)

HEADQUARTERS I CORPS
APO 301 (Kyoto, Honshu)

GLS/fsn

Ref: IG - 357

AG 004 - ba

MAY 21 1946

SUBJECT: Permit for Reconversion from war Production and for
Resumption of Production of Essential Civilian Commodities

TO: Mitsubishi Jukogyo K.K., Komi Plant (Branch of No. 3 Plant
(Name and Address Firm)
Shitamori, Shinchi, Yawata-cho, Chita-gun, Aichi-ken.

1. a. In accord with paragraph 3, b, Directive Number Three(3)
from the Supreme Commander to the Imperial Japanese Government,
dated 22 September 1945, the Mitsubishi Jukogyo K.K., Komi Plant.

(Name of Item)

is permitted to immediately start production of a. Electric Refri-
gerators (Name of Items)

b. Rice-hull separator. c. Parts for spinning & weaving machines.
d. Spring Weight (NOTHING FOLLOWS)

b. Maximum production currently authorized is (monthly)

a. 150 b. 30 c. 50 d. 500

2. The acquisition of material, Parts and sub-assemblies as well as the disposition of finished products, and the establishment of sales prices will be in accord with the regulations of the Imperial Japanese Government.

3. Until otherwise directed by this headquarters a monthly report in English of each item, by name, type and quantity produced by each factory, sub-contractor subsidiary within this factory's control will be delivered to this office by the fifteenth (15) day of the following month.

4. It is understood that this permit for reconversion is issued subject to any all directives affecting reconversion, ultimate disposition or otherwise, which have been issued or may hereafter be issued by the Supreme Commander for the Allied Powers or by this headquarters.

BY COMMAND OF MAJOR GENERAL WOODRUFF:

Info copy to:

SCAP (Attn: ESS) (1) (w/incl)

SCAP (Attn: C-2) (1) (w/incl)

CG Eighth Army (1) (w/incl)

(Attn: Mil Govt)

CG 94th MG Hq Group (1)

Kyoto Liaison Office (1)

Governor of Prefecture concerned(1)

CG 30th MG Company

1 Incl:

Annex 1.

HEADQUARTERS I CORPS
APO 301 (Kyoto, Honshu)

OIS/fsn

Ref: IG - 357 (Revised)

AG 004 - BA

June 21 1946

SUBJECT: Permit for Reconversion from War Production and for
Resumption of Production of Essential Civilian Commodities.

TO: Mitsubishi Jukogyo K.K., Komi Plant (Branch of No. 3 Plant)
(Name and Address of Firm)
Shitamori, Shinohi, Yawata-cho, Chita-gun, Aichi-ken.

1. a. In accord with paragraph 3, b. Directive Number Three(3)
from the Supreme Commander to the Imperial Japanese Government,
dated 22 September 1945. the Mitsubishi Jukogyo K.K., Komi Plant is
(Name and Firm)
permitted to immediately start production of a. Electric Refrigerators
(Name of Items)
b. Rice-hulling machines. c. Spring Weight. d. Tools (saws, drills &
wrenches) e. Electric Stoves f. Repair of Vehicles. (NOTHING FOLLOWS)

b. Maximum production currently authorized is (monthly)
a. 100 b. 20 c. 500 d. 3,600 e. 120 f. by order.

2. The acquisition of materials, parts and sub-assemblies as well
as the disposition of finished products, and the establishment of
sales prices will be in accord with the regulations of the Imperial
Japanese Government.

3. Until otherwise directed by this headquarters, a monthly
report in English of each item, by name, type and quantity produced
by each factory, sub-contractor subsidiary within this factory's
control will be delivered to this office by the fifteenth (15) day of
the following month.

4. It is understood that this permit for reconversion is issued
subject to any and all directives affecting reconversion, ultimate
disposition or otherwise, which have been issued or may hereafter be
issued by the Supreme Commander for the Allied Powers or by this
headquarters.

BY COMMAND OF MAJOR GENERAL WOODRUFF:

O. H. SCHMIDT
MAJOR, AGD
ASST. ADJ. GEN.

Info copy to:
SGAP (Attn: ESS) (1) (w/incl)
SGAP (Attn: C-2) (1) (w/incl)
CG Eighth Army (1) (w/incl)
(Attn: Mil Govt)
CG 30th MG Hq Company (1)
Kyoto Liaison Office (1)
Governor of Prefecture concerned (1)

1 Incl:
Annex 1.

GENERAL HEADQUARTERS
 SUPREME COMMANDER FOR THE ALLIED POWERS
 Economic and Scientific Section

24, November 1948
 Date

SUBJECT: Reconversion Permit for Reparations Plant
 TO: Mitsubishi Heavy-Ind., Co., Ltd. Komi Plant
 No. 11 Shitamori, Shinchi, Yawata-cho, Chita-gun,
 Aichi Prefecture.

1. In accordance with Memorandum from the Supreme Commander for the Allied Powers to the Japanese Government, dated 22 November 1946 (SCAPIN-1355), the Mitsubishi Heavy Ind., Co., Ltd. is permitted to produce at their Komi Factory located at Shinchi, Yawata-cho the following additional items:

<u>Item</u>	<u>Maximum Quantity</u>
<u>Rice Hulling Machine</u>	<u>800 Per month</u>
<u>Scale</u>	<u>2,500 Per month</u>
<u>XXXXXXXXXXXXXXXXXXXX</u>	<u>XXXXXXXXXXXXXXX</u>

2. The temporary use of the following additional reparations

None None

3. A program will be immediately initiated to substitute non-reparations machined, for reparations machinery in temporary use.

4. The acquisition of material, parts and sub-assemblies as well as the disposition of finished products and the establishment of sales prices will be in accordance with the regulations of the Japanese Government.

5. This permit is issued subject to any and all directives affecting reparations plants which have been issued or may hereafter be issued by the Supreme Commander for the Allied Powers. Reports will be rendered as required by current directives and instructions.

FOR THE CHIEF, ECONOMIC AND SCIENTIFIC SECTION:

W. S. VAUGHAN
 Chief, Industry Division

775013

GENERAL HEADQUARTERS
SUPREME COMMANDER FOR THE ALLIED POWERS
Economic and Scientific Section

7 March 1949
Late

SUBJECT: Reconversion Permit for Reparations Plant

TO : Mitsubishi Jukogyo K.K., Komi Plant
= 11 Shitemori, Shinohi, Yawata-cho, Chita-gun, Aichi Pref.

1. In accordance with Memorandum from the Supreme Commander for the Allied Powers to the Japanese Government, dated 22 November 1946 (SCAPIN-1355), the Mitsubishi Jukogyo K.K. is permitted to produce at their following additional items:

<u>Item</u>	<u>Maximum quantity</u>
<u>Power Agricultural Mach. Implement</u>	<u>250 sets per month</u>
<u>Internal Combustion Engine</u>	<u>400 " " "</u>
<u>XXXXXXXXXXXXXXXXXXXXXXXXXXXX</u>	<u>XXXXXXXXXXXXXXXXXXXX</u>

2. The temporary use of the following additional reparations machinery is authorized:

<u>NONE</u>	<u>NONE</u>
-------------	-------------

3. A program will be immediately initiated to substitute non-reparations machinery for reparations machinery in temporary use.

4. The acquisition of material, parts and sub-assemblies as well as the disposition of finished products and the establishment of sales prices will be in accordance with the regulations of the Japanese Government.

5. This permit is issued subject to any all directives affecting reparations plants which have been issued or may hereafter be issued by the Supreme Commander for the Allied Powers. Reports will be rendered as required by current directives and instructions.

FOR THE CHIEF ECONOMIC AND SCIENTIFIC SECTION:

W. S. VAUGHAN
Chief, Industry Division

TOKYO ENGINEERING WORKS
EAST JAPAN HEAVY INDUSTRIES, LTD
32, Shimomaruke-Cho, Ohta-Ku, Tokyo, Japan.

(Plant Code No. 39-108)

Date: 1 March 1950

TO: General Manager
Komi Plant, Nagoya Engr Works
Central Japan Heavy Industries, Ltd.
280, 1-Chome, 9-Bancho, Minato-Ku, Nagoya.

SUBJECT: Recognition for the Transfer of
the Reparations Property.

We hereby recognize the transfer of the reparations
property to your plant (total number 5 as per inclosed
list)

E. Tatsumi
General Manager
Tokyo Engr Works
East Japan Heavy Industries, Ltd.

Inclosed List

<u>Name of machine.</u>	<u>Manufacturer.</u>	<u>Type.</u>	<u>Inventory number.</u>	<u>Use of non use.</u>	<u>Quantity.</u>	<u>Class.</u>
Welding machine (A.C. Arc)	Mitsuba Seisakusho	9 KW	39-108-2376	non use	1	1
"	"	"	39-108-2387	"	1	1
Motor Generator	Chuo Seisakusho	15V 500A	39-108-666	"	1	1
"	"	"	39-108-667	"	1	1
"	"	"	39-108-700	"	1	1
					<u>5</u>	
			Total			

File

NAGOYA ENGINEERING WORKS
 CENTRAL JAPAN HEAVY IND. LTD.
 2 Oye-cho Minato-ku
 Nagoya

Date 23 Feb 1950

SUBJECT: Report on Additional "EX" Equipment

TO : Headquarters Tokai-Hokuriku
 Civil Affairs Region

Attaching herewith list of machine we beg to report to you that our Komi Plant which is now manufacturing Rice Huller and other Agricutural machines has arranged to buy the listed machine from another plant and will carry them into the Komi Plant, because the production of the said machines has recently been increased and the existed machines being insufficient, the said plant is forced to fill the shortage of machines.

1. Description of machine.

As per attached list.

2. Name and address of seller.

The Tokyo Finance Section Mito Branch, Mito City,
 Ibaragi Pref.

3. Name and Address of plant which is to use machine.

Central Japan Heavy Industries, Ltd.

Nagoya Engineering Works.

Komi Plant

9 Bancho, Minato-ku, Nagoya.

(Former No.3 Works, Code No.01-89)

Joji Hattori

JOJI HATTORI
 General Manager
 Nagoya Engr. Works
 Central Japan Heavy Ind., Ltd.

Remark:	No. of last installed EX machine	68 Sets	✓
	No. of applied EX machine	5 "	✓
	No. of present non-inventorical EX machine	73 "	✓

<u>Code No.</u>	<u>Name of machine</u>	<u>Maker</u>
01-39-553EX	Lathe engine	Shinagawa
01-39-554EX	"	"
01-39-555EX	"	Mitsubishi Kosaku
01-39-556EX	<i>Lathe turret</i>	Toyo-Seikan
01-39-557EX	"	"
Total		5 Sets

//////////////////LAST ITEM////////////////////

*Confirmed by H. Kato
 Adm. Prefectural Officer
 Date; 7th March 50*

APPROVED
E. F. Jourd by *J. Yamamoto*
 E. F. Jourd DAC
 Economics Div. THCAR
 Date 10 Mar. 50

check

*file
new*

Mitsubishi Heavy-Industries, Ltd.
Komi Engineering Works,
280, 1-chome, 9-bancho, Minato-ku,
Nagoya.

Oct. 17, 1949.

TO : Commanding Officer, Tokai-Hokuriku Civil Affairs Team.

THRU : Reparation Section, Aichi Prefectural Government.

SUBJECT : Application for extension of the period of
" Temporary Use ".

1. The application for " Temporary Use " dated on July 15 1949 (A copy is attached herewith) has been granted for 3 months from 19 July to 18 Oct. 1949. Nevertheless, Those machines we wanted to be used continuously to increase Production efficiency.
2. This applicatin for permission to extend the authorized period is hereby submitted. If your favorable Consideration is given on this matter, It is much appreciated.

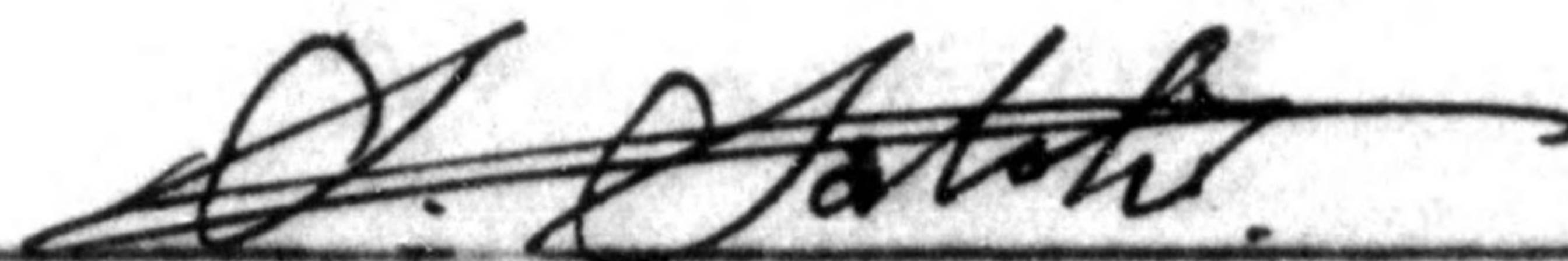

SENICHI SATOH
Custodian,
General Manager.

APPROVED

E. F. JOUARD, DAC
Engineer Section Chief
Aichi Mil Gov't Team

*Temporary use for 3 months
From 19 Oct to 18 Jan. 1950*

Mitsubishi Heavy-Industries, Ltd.,
Komi Engineering Works.
280, 1-chome, 9-bancho, Minato-ku,
Nagoya.

July 15, 1949.

TO : Commanding Officer, Aichi Military Government Team.

THRU : Reparation Section of Aichi Prefectural Government.

SUBJECT : Application for " Temporarily use ".

1. Komi Plant had been operated at 11 Shitamori, Shinchi, Yawata-cho, Chita-gun, Aichi with the conversion Permit.
2. Movement of the reparations machinery to Nagoya Plant, 280, 1-chome, 9-bancho, Minato-ku, Nagoya, has been authorized by your headquarters on December 27, 1948. and the transference is completed.
3. For the following reasons, thirty-four (34) machines (please refer to the attached list) are wanted to be used for production to increase production efficiency:
 - a) To rearrange the machinery and equipment.
 - b) To change the production processes.
 - c) To increase the production up to the authorized amount.
4. Under these circumstances, This application is hereby submitted. It will be much appreciated if your kind consideration is given on this matter.

APPROVED
E. F. JOUARD, DAC
Engineer Section Chief
Aichi Mil Gov't Team

SENICHI SATOH
Custodian,
General Manager

Temporary use for 3 months
From 19 July to 18 Oct. 1949

List of the Machines wanted to be Used

Inventory No.	Item	Manufactured	Number
01 - 89 - 1 ✓	Drilling machines	Mitsubishi Denki	1
4 ✓	Honing machines	Yamaguchi Seiki	1
5 ✓	Abrasive Cutting machines	Nippon Setsudanki	1
7 ✓	Lathe	Sakyo Kikai	1
8 ✓	"	"	1
10 ✓	"	Kanno Tekko	1
13 ✓	Turret Lathe	Tokyo Kikai	1
15 ✓	Lathe	Kanno Tekko	1
16 ✓	"	"	1
17 ✓	"	Shinagawa Seiki	1
19 ✓	Milling machines	Ikegai Tekko	1
21 ✓	Lathe	Mitsubishi Kosaku	1
23 ✓	Grinding machines	Dainihon Kosaku	1
60 ✓	Lathe	Okaya Koki	1
68 ✓	Shaper	Kojima Tekkosho	1
75 ✓	Rotary Slitting Shears	Yamakawa Press	1
77 ✓	Sawing machine-precision	Hinomoto Seisaku	1
80 ✓	Turret Lathe	Shinagawa Seiki	1
84 ✓	Boring machines	Heald	1
87 ✓	Shaper	Kojima Seisaku	1
90 ✓	"	Nishikawa Seisaku	1
92 ✓	Welding machines	Mitsuba Kosaku	1
93 ✓	"	Shibaura Denki	1
144 ✓	Grinding machines	Mizuho Kikai	1
145 ✓	"	"	1
151 ✓	Furnace	Chino Seisaku	1

APPROVED

26
E. F. JOUARD, DAC
Engineer Section Chief
Aichi Mil Gov't Team

Inventory No.	Item	Manufactured	Number
01-89-156 ✓	Welding machine	Osaka Henatsu	1
183 ✓	Gear Cutting machine	Gleason	1
186 ✓	Grinding machine	Toyo kogyo	1
190 ✓	Lathe	Osaka Juko	1
216 ✓	Centering machine	Okuma Tekko	1
254 ✓	Grinding machine	Heald	1
292 ✓	"	Tsugami Seisaku	1
305 ✓	Honing machine	Osaka Kiko	1

Total

34

APPROVED

E. F. JOUARD, DAC
Engineer Section Chief
Aichi Mil Gov't Team

File
now

Mitsubishi Heavy-Industries, Ltd.
Komi Engineering Works
280, 1-chome, 9-bancho, Minato-ku,
Nagoya

July 15, 1949.

TO : Commanding Officer, Aichi Military Government Team.
THRU : Reparation Section of Aichi Prefectural Government.
SUBJECT : Application for " Temporarily use "

1. Komi Plant had been operated at 11 Shitamori, Shinchi, Yawata-cho, Chita-gun, Aichi with the conversion Permit.
2. Movement of the reparations machinery to Nagoya Plant, 280, 1-chome, 9-bancho, Minato-ku, Nagoya, has been authorized by your headquarters on December 27, 1948. and the transference is completed.
3. For the following reasons, thirty-four (34) machines (please refer to the attached list) are wanted to be used for production to increase production efficiency:
 - a) To rearrange the machinery and equipment.
 - b) To change the production processes.
 - c) To increase the production up to the authorized amount.
4. Under these circumstances, This application is hereby submitted. It will be much appreciated if your kind consideration is given on this matter.

APPROVED

E. F. JOUARD, DAC
Engineer Section Chief
Aichi Mil Gov't Team

Temporary use for 3 months
From 19 July to 18 Oct. 1949

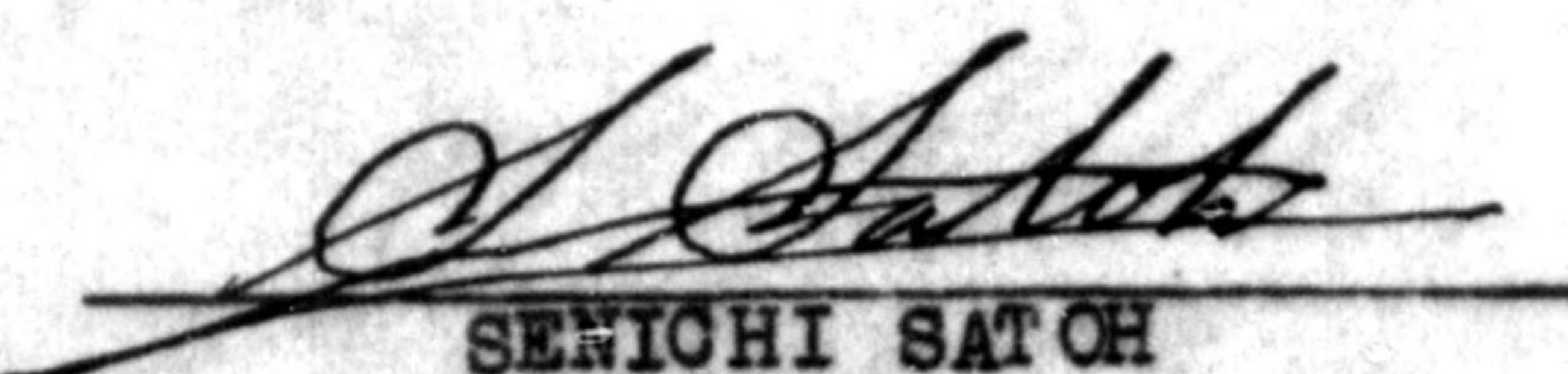
SEIICHI SATOH
Custodian,
General Manager

List of the Machines wanted to be used

Inventory No.	Item	Manufactured	Number
01-89- 1	Drilling machine	Mitsubishi Denki	1
4	Honing machine	Yamaguchi Seiki	1
5	Abrasive Cutting machine	Nippon Setsudanki	1
7	Lathe	Sankyo Kikai	1
8	"	"	1
10	"	Kanno Tekko	1
13	Turret Lathe	Tokyo Kikai	1
15	Lathe	Kanno Tekko	1
16	"	"	1
17	"	Shinagawa Seiki	1
19	Milling machine	Ikegai Tekko	1
21	Lathe	Mitsubishi Kosaku	1
23	Grinding machine	Dainohon Kosaku	1
60	Lathe	Okaya koki	1
68	Shaper	Kojima Tekkosho	1
75	Rotary Slitting Shears	Yamakawa Press	1
77	Sawing machine-precision	Hinomoto Seisaku	1
80	Turret Lathe	Shinagawa Seiki	1
84	Boring machine-	Heald	1
87	Shaper	Kojima Seisaku	1
90	"	Nishikawa Seisaku	1
92	Welding machine	Mitsuba Kosaku	1
93	"	Shibaura Denki	1
145	Grinding machine	Mizuho Kikai	1
144	"	"	1

APPROVED

E. F. JOUARD, DAC
 Engineer Section Chief
 ichi Mil Gov't Team

Inventory No.	Item	Manufactured	Number
01-89- 151	Furnace	Chino Seisaku	1
156	Welding machine	Osaka Henatsu	1
183	Gear Cutting machine	Gleason	1
186	Grinding machine	Toyo Kogyo	1
190	Lathe	Osaka Juko	1
216	Centering machine	Okuma Tekko	1
254	Grinding machine	Heald	1
292	"	Tsugami Seisaku	1
305	Honing machine	Osaka Kiko	1

Total**34**

APPROVED

E. F. JOUARD, DAC
Engineer Section Chief
Nichi Mil Gov't Team

COPY

Komi Engineering Works,
Mitsubishi Heavy-Industries, Ltd.

Dec. 8. 1949.

To : Commanding Officer, Tokai-Hokuriku Civil Affairs Region.
Thru : Tokai-Hokuriku Liaison Office.
From : Komi Engineering Works, Mitsubishi Heavy-Industries, Ltd.
Subject : Application for cancellation of "Authorized Use".

Applicant:

Name : Senichi Satoh, Custodian and General Manager of
Komi Engineering Works, Mitsubishi Heavy-Industries,
Ltd.

Address : No. 280, 1-chome, 9-bancho, Minato-ku, Nagoya City.

1. Name (Code No.) and address of the reparation facilities.

a) Name : Komi Engineering Works of the Mitsubishi Heavy-
Industries, Ltd. (Code No. 01 - 89)

b) Address: No. 280, 1-chome, 9-bancho, Minato-ku, Nagoya City.

2. Details of the reparations facilities to be canceled "Authorized Use".

Please refer to the attached list.

3. Reasons for cancellation of "Authorized Use".

a) Komi Plant had been operated at 11, Shitamori, Shishi, Yawata-cho, Chita-gun, Aichi Pref., with the conversion permit. And movement of the reparation facilities to Nagoya Plant, No. 280, 1-chome, 9-bancho, Minato-ku, Nagoya City, has been authorized by your headquarters on December 27, 1948, and the transference is completed.

b) The main products of our plant are rice-hullers, agricultural engines, electric refrigerators and scales, being continuously produced after the transference of reparations facilities.

c) But since April 1949, shortage of working fund and materials due to the economic deflation has been prevailing, and consequently we have not been able to install the forging machines and boilers.

- d) Under these circumstances, the machines listed on the attached sheet can not be used for the time being, and this application is hereby submitted. It will be much appreciated if your kind consideration is given on this matter.

- Attached Sheet -

1. List of reparation machines to be canceled "Authorized Use".
2. Rough map showing arrangement of building of Komi Plant.



Senichi Satoh.
Custodian and General Manager
of Komi Engineering Works,
Mitsubishi Heavy-Industries, Ltd.

List of reparation machines to be canceled "Authorized Use"

Inventory No. (or Evaluation Number)	Item	Type & Capacity	Manufactured
01 - 89 - 95	Electric Furnace	60 KVA	Okutani
97	" "	"	"
98	" "	"	"
99	steam Hammer	1 ton	Muta-Chuko
100	Friction Press	150 ton	Osaka Bankin
101	Air Hammer	1/4 ton	Osaka Kikai
106	Steam Hammer	"	Muta-Chuko
109	" "	1/2 ton	Erie
110	Friction Press	100 ton	Osaka Bankin
112	" "	200 ton	Yamakawa Press
152	Electric metal- heat furnace	41,6 KVA	Dengensha
325	Sand Blast	M.P. 50 Kg/cm	Takikawa Tekko
326	" "	" "	"
327	" "	" "	"
329	Sand Tank	1,2x0,8x5,0 m	"
422	Boiler	Pressure 7,7Kg/cm	Mitsubishi Juko
423	"		"
472	Furnace		"
473	"		"
475	Forging Furnace		Hinomoto
477	Furnace		"
480	"		"
482	"		Mitsubishi Juko
483	"		"
486	"		"
APPROVED			
Total			25 ✓

E. F. Jouard DAC
Economics Div. THCAR
Date 15 Dec. '49

DECLASSIFIED E.O. 12065 SECTION 3-402/UNCLAS. 775013

FLOOR PLAN OF MITSUBISHI HEAVY-INDUSTRY LTD.
KOBE ENGINEERING WORKS

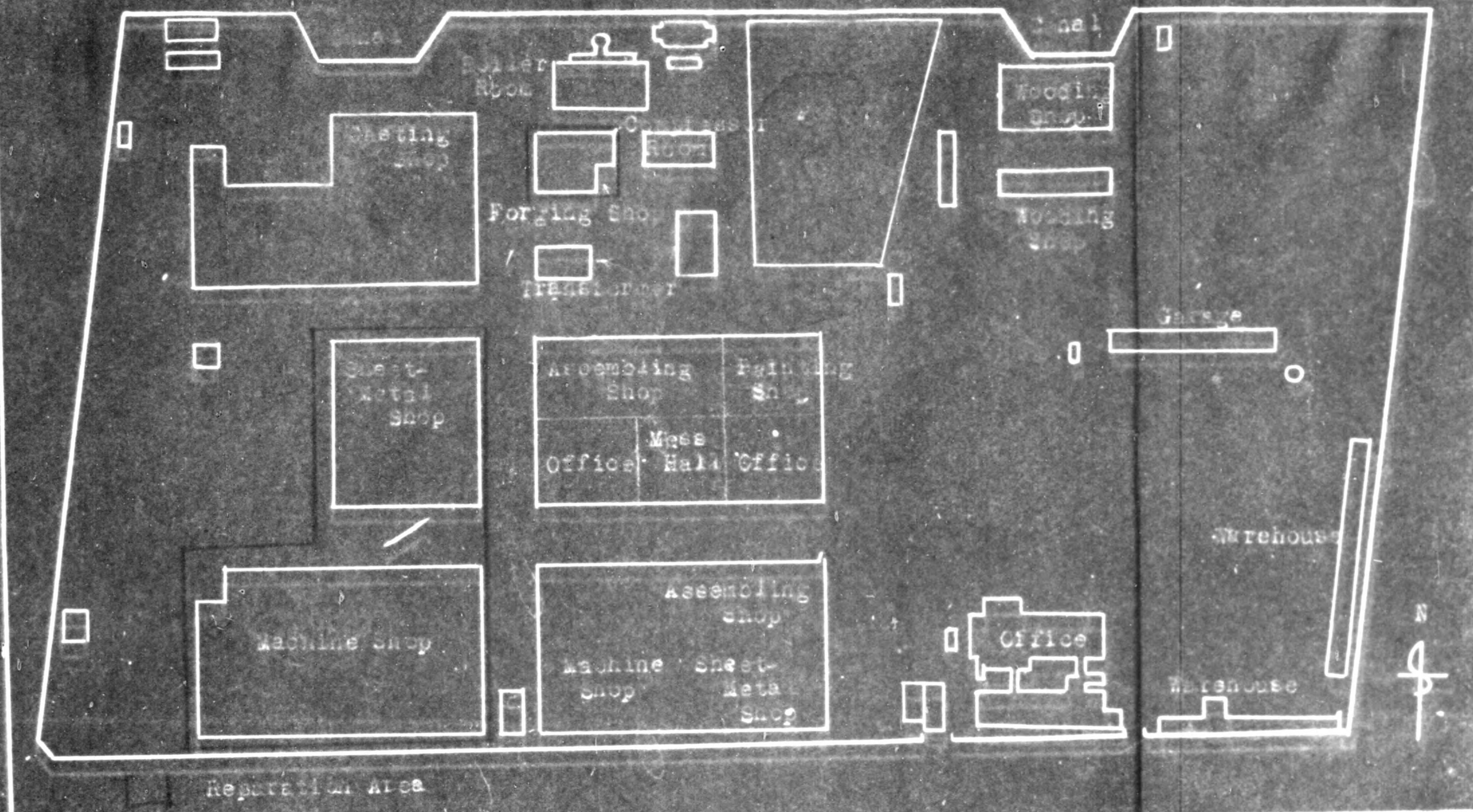

File
Check

**Komi Engineering Works,
Mitsubishi Heavy-Industries, Ltd.**

Nov. 19, 1949.

To: Mr. Heitaro Inagaki
Minister of International Trade & Industry.

Subject: Application for Permission to remove reparation
Machines.

From: Komi Engineering Works of the Mitsubishi Heavy-
Industries, Ltd.

Applicant :

Name : Senichi Sato, General Manager of the Komi Engi-
neering Works, Mitsubishi Heavy-Industries, Ltd.

Address : No. 280, 1-chome, 9-Bancho, Minato-ku, Nagoya City

1. Name (Code No.) and address of the plant to which reparation
machines will be removed and utilization thereof:

a) Name of the Plant:

Komi Engineering Works of the Mitsubishi Heavy-Industries,
Ltd. (Code Number 01 - 89)

b) Address:

No. 280, 1-Chome, 9-Bancho, Minato-ku, Nagoya City

2. Name (Code No.) and address of the Plants wherein the reparation
machines which are to be removed are located at present:

Name of the Plants where the machines are located	Code No	Address	Remarks
No. 5 Works (Oye Plant) of the Mitsubishi Heavy-Industries, Ltd.	01-26	No. 10, Oye-machi, Minato-ku, Nagoya City	} These pla- nts all belong to the same Company
No. 4 Works (Daiko Plant) of the Mitsubishi Heavy-Industries, Ltd.	01-25	Daiko-cho, Higashi-ku, Nagoya City	

Name of the Plants where the machines are located	Code No.	Address	Remarks
No. 12 Works (Biwajima Plant) of the Mitsubishi Heavy-Industries, Ltd.	01-30	Oaza Shimotai, Nishi Biwajima-cho, Nishikasugai-gun, Aichi Pref.	These plants all belong to the same Company

3. Outline of the reparation machines to be removed and utilized:

Name of the Plants where the machines are located	Total number of machines & equipments which belong to the said Plant	Number of reparation machines to be removed and utilized			Remarks
		Available	Non-operation	Total Grand Total	
No. 5 Works of the Mitsubishi Heavy-Industries, Ltd.	2,464	0	2	2	For details, please refer to the Attached Sheet No. 1.
No. 4 Works of the Mitsubishi Heavy-Industries, Ltd.	2,544	0	3	3	
No. 12 Works of the Mitsubishi Heavy-Industries, Ltd.	1,811	0	5	5	

4. Outline of the plant which submits this application:
 (1) Present production circumstances:

Name of Products	Production in Sept. 1949		Remarks
	Number	Amount in ¥ 1,000.00	
Rice hullers	774	24,520	For details of reconversion permit, please refer to the Attached Sheet No. 2
Agricultural engines	150	4,050	
Electric refrigerators	88	3,788	
Electric freezers	11	1,100	
Platform scales	100	430	
Beam balances	1314	1,183	
Repairs & others	-	576	
Total		35,647	

2) Outline of the reparation machines and number of employees and workers:

a) Number of employees and workers:

	Workers	Employees	Total	Remarks
Present number of employees and Workers	819	231	1,050	(at the end of) (September 1949)
Increase or decrease in number under the said plan	0	0	0	No increase in number of employees and workers is necessary, as transfer will be carried out in the Plant
Total	819	231	1,050	

b) Reparation Machines:

Name of Machines	Total Number	Number of machines in operation			Number of machines in Non-operation
		A.U.	T.O.	E.X.	
Machine tools	288	238	29	20	1
Industrial machines	160	145	2	3	10
Electric machines	81	32	3	42	4
Others	9	6	0	3	0
	538	421	34	68	15

3) Production results in the past, and future production schedule:

a) Production results in the past:

Year	Name of Products	Production Amount in Y 1,000.00	Remarks
1944	Tools, moulds, forgings	208	Commenced (in April 1944) We have secured reconversion permit several times since January 1946.
1945	" "	671	
1946	Rice-hullers, refrigerators etc.	15,814	
1947	" "	72,864	
1948	" "	185,221	
1949	" "	228,618	

Note: 1. We commenced export of rice-hullers in October 1948.
 2. Production for 1949 is the total from January to September, 1949.

b) Future Production schedule:

Month & Year	Production Items	Production Amount in ₹ 1,000.00	Average Per a month
January-March 1950	Rice-hullers Agricultural engines	84,005	28,002
April-June 1950	Electric refrigerators Hand tractors etc.	79,595	26,532

5. Reasons necessitating such removal:

a) Reasons necessitating installation of electric welding machines:

Orders from overseas for Rice-hullers, which are main product of the Plant, are increasing month. The rice-hullers for domestic use were made of wood, but these export are converted to iron plate and metals. Under these circumstances, it is absolutely necessary to assemble the main body of the rice-hullers by electric welding.

These products, as a result become more robust and the efficiency of the processing operation is increased through utilization of electric welding. Future, a reduction of operation hours will curtail the manufacturing cost.

This applies particularly in the manufacture of iron-plated air conduction sleeves for agricultural engine and of evaporators and coolers for electric refrigerators.

b) Reasons necessitating installation of grinders and lapping machines:

We are now compelled to carry out processing operation by hand in fitting the valve plate for electric refrigerators, in grinding heat-treated gears for export rice-hullers and hand tractors, and processing cam shafts for agricultural engines, as we have no grinding and lapping machines for these purpose.

However, the efficiency is very poor, and the finish is very rough, which have a bad influence on the performance. Under these circumstances, we would like to instal first class foreign made grinders so that we may increase production and develop further the efficiency.

c) Reasons necessitating installation of drilling machine and boring machines:

We are now manufacturing 1/4 - 5 H.P. electric refrigerators, and are furthermore designing large type 10 H.P. refrigerators so as to meet very wide demand and to extend the market.

We need drilling and boring machines of first grade efficiency so as to process the large type crank cases of these refrigerators.

However, we cannot possibly get such machines in the general market. Therefore we would like to install high grade foreign made machines as referred to in the attached sheet No. 1.

- d) Reasons necessitating installation of gear cutting machine and hobbing machines:

We are obliged to procure gears for our rice-hullers and agricultural engines from outside makers, as we possess inadequate capacity and facilities. However the gears manufactured by outside makers lack precision and are very noisy in operation and give bad performance. Under these circumstances, we would like to install the said machines so that we may manufacture gears ourselves and further develop in our products.

6. Other relevant facts:

- a) The machines to be removed are all located in the same city in which the Plant is situated (please refer to the attached map), therefore the removal expense of the machines is rather small. These machines are not being operated, and the people who have them in custody in each Plant have agreed to our proposal to remove them.
- b) The building of the Plant to which the machines are to be removed had once authorized to accommodate the machines located in Yahata-machi, Chita-gun, Aichi Prefecture under approval of the Aichi Military Government Team on Dec. 27, 1948, therefore there need be no anxiety regarding custody and maintenance of the said reparation machines in the future.

e) Attached Document -

1. Certificate regarding approval of transfer and the transportation of machines to be removed.3
2. Copy of the Reconversion permit4 (Not annexed)
3. Rough map showing arrangement of buildings of the Plant1
4. Rough map showing location and relation between the Plants in which the machines to be removed are now located, and the Plant to which they will be removed.1

Senichi Sato,
General Manager of the
Komi Engineering Works,
Mitsubishi Heavy-Industries, Ltd.

Attached Sheet No. 1

Details of reparation machines to be removed and utilized:

1. The machines located in Oye Plant (Code No. 01 - 26)

Name of Machine	Maker	Type & Measure	Inventory No.	In operation or non-operation	No.	Class
Electric Spot Welding Machine	Mitsubishi Electric Mfg. Co., Ltd.	P20000A 160KVA	1294	Non-operation	1	1
Electric Seam Welding Machine	"	P30000A 400KVA	1310	"	1	3
Total					2	

2. The machines located in Daiko Plant (Code No 01- 25)

Name of Machine	Meker	Type & Measure	Inventory No.	In operation or non-operation	No.	Class
Horizontal Boring Machine	Lewis	No. 0.8" A-899 A - 899		Non-operation	1	1
Super Gear Shaper	Fellows	No. 61 890x127	D - 51	"	1	1
Super Gear Shaper	Mong	ss 1/2 600x130	D - 32	"	1	1
Total					3	

3. The machines located in Biwajima Plant (Code No. 01 - 30)

Name of Machine	Meker	Type & Measure	Inventory No.	In operation or non-operation	No.	Class
Radial Drilling machine	Carlton	CA - 3 300x1000	⁰¹⁻¹ 66	non-operation	1	1
" "	Asquith	280x 600	67	"	1	1
Cam grinding machine	Mitsubishi Heavy-Industries, Ltd.		⁰¹⁻³⁰ 1023	"	1	1
Single shaft Horizontal hobbing machine	Kashifuji Iron Works, Ltd.	14 Max. processing	776	"	1	1
Vertical lapping machine	Shinagawa precision Machine Works	MMS - 23	1209	"	1	2
Total					5	

Attached Sheet No. 2

Details of Production Items permitted by G.H.Q.

Permitted production items	Name of Military Government Team which granted permission	Date of permission	Remarks
Rice - hullers	Headquarters 1 Corps	May 21, 1946	Alteration permitted No
"	" "	June 21, 1946	" "
"	G.H.Q. S.C.A.P.	Nov. 24 1948	
Power agricultural machine & implements (Mowers, tractors)	G.H.Q. S.C.A.P.	March 7, 1949	
Internal combustion engines (light oil engines)	" "	March 7, 1949	
Electric refrigerators	Headquarters 1 Corps	May 21, 1946	Alteration permitted
"	" "	June 21, 1946	Number
Spring Weight	Headquarters 1 Corps	May 21, 1946	" "
"	" "	June 21, 1946	" "
"	G.H.Q. S.C.A.P.	Nov. 24, 1949	
* Tools	Headquarters 1 Corps	June 21, 1946	
* Repair of vehicles	" "	" " "	
* Parts for spinning & weaving machines	" "	" " "	
* Electric stoves	" "	" " "	

Remarks Production of these items (*) is now suspended.

COPY

Mitsubishi Heavy Industries, Ltd.
Aircraft Liquidation & Conversion Office.
No. 5, 3-chome, Sakae-machi, Naka-ku, Nagoya-shi.

Date: 7, Oct. 1949.

To: Komi Engineering Works
Mitsubishi Heavy Industries, Ltd.

Subject: Recognition of Transfer of Reparation machine.

Dear Sir :

We, hereby recognize the transfer of the under mentioned machines from Mitsubishi Aircraft Liquidation & Conversion Office to Mitsubishi Komi Engineering Works.

1. From: 10, Oye-cho, Minato-ku, Nagoya-shi.
Oye Branch, (01-26).
Aircraft Liquidation & Conversion Office,
Mitsubishi Heavy Industries, Ltd.
2. To : 280-1 chome, kyuban-cho, Minato-ku, Nagoya-shi.
Komi Engineering Works, (01-89).
Mitsubishi Heavy Industries, Ltd.

3. Particulars of machines to be transferred:

Name	Maker	Type & Dimension	Inventory No.	Operation or None Operating	Q'ty	Remarks
Spot Welder	Mitsubishi Denki	P20.000A 160 KVA	01-26 a-1294	None Operating	1	
Seam Spot Welder	"	P30.000A 400 KVA	-1310	"	1	
Total					<u>2</u>	

BY _____

E. Hiramatsu
Responsible man of plant
designated for reparations
(Gen. Manager of the Office)

COPY

Mitsubishi Heavy Industries, Ltd.,
Aircraft Liquidation & Conversion Office.
No. 5, 3-chome, Sakae-machi, Naka-ku, Nagoya-shi.

Date: 7, Oct. 1949.

To: Komi Engineering Works
Mitsubishi Heavy-Industries, Ltd.

Subject: Recognition of Transfer of Reparation
Machine.

Dear Sir:

We, hereby recognize the transfer of the under mentioned machines from Mitsubishi Aircraft Liquidation & Conversion Office to Mitsubishi Komi Engineering Works.

1. From: 998, Okinka, Daiko-cho, Higashi-ku, Nagoya-shi.
Daiko Branch, (01-25).
Aircraft Liquidation & Conversion Office,
Mitsubishi Heavy Industries, Ltd.
2. To : 280-1 chome, Kyuban-cho, Minato-ku, Nagoya-shi,
Komi Engineering Works, (01-89).
Mitsubishi Heavy Industries, Ltd.

3. Particulars of machines to be transferred:

<u>Name</u>	<u>Maker</u>	<u>Type & Dimension</u>	<u>Inventory No.</u>	<u>Operation or None Operation</u>	<u>Q'ty</u>	<u>Remarks</u>
Boring machine -Horizontal Lewis		No.0.8"	01-25 a-899	None Operating	1	
Gear Shaper Fellows		No.61	d-51	"	1	
Gear Grinder	Maag	890x127 Ss1/2 600x130	d-32	"	1	
Total					<u>3</u>	

By _____

E.Hiram tsu
Responsible man of plant
designated for reparations
(Gen. Manager of the Office)

Mitsubishi Heavy Industries, Ltd.
Aircraft Liquidation & Conversion Office.
No. 5, 3-chome, Sakae-machi, Naka-ku, Nagoya-shi.

COPY

Date: 7, Oct. 1949.

To: Komi Engineering Works
Mitsubishi Heavy Industries, Ltd.

Subject: Recognition of Transfer of Reparation machine.

Dear Sir:

We, hereby recognize the transfer of the under mentioned machines from Mitsubishi Aircraft Liquidation & Conversion Office to Mitsubishi Komi Engineering Works.

1. From: Oaza-Shimodai, Nishibiwajima-cho, Nishikasugai-gun,
Aichi-Pref. Biwajima Branch (01-30).
Aircraft Liquidation & Conversion Office.,
Mitsubishi Heavy Industries, Ltd.

2. To : 280-1 chome, Kyuban-cho, Mnato-ku, Nagoya-shi.
Komi Engineering Works, (01-89)
Mitsubishi Heavy Industries, Ltd.

3. Particulars of machines to be transferred:

<u>Name</u>	<u>Maker</u>	<u>Type & Demension</u>	<u>Inventory No.</u>	<u>Operation or None Operating</u>	<u>Q'ty</u>	<u>Remarks</u>
Drilling machine	Carlton	OA 300x1000	01- 1 -66	None Operating	1	
Radial	Asquith	280x600	-67	"	1	
Cam	Mitsubishi		01-30	"	1	
Grinder	Juko		-1023	"	1	
Gear Hobber		14" Maximum	-776	"	1	
Single Sppindle	Kashifuji Tekko	dia 300 m/m				
Vetical Lapping	Shinagawa Seiki	MNS02B	-1209	"	1	
<u>Total</u>					<u>5</u>	

By _____
E. Hiramatsu
Responsible man of plant
designated for reparations
(Gen. Manager of the Office)

775013

數地 2058坪869
建坪 5864坪1

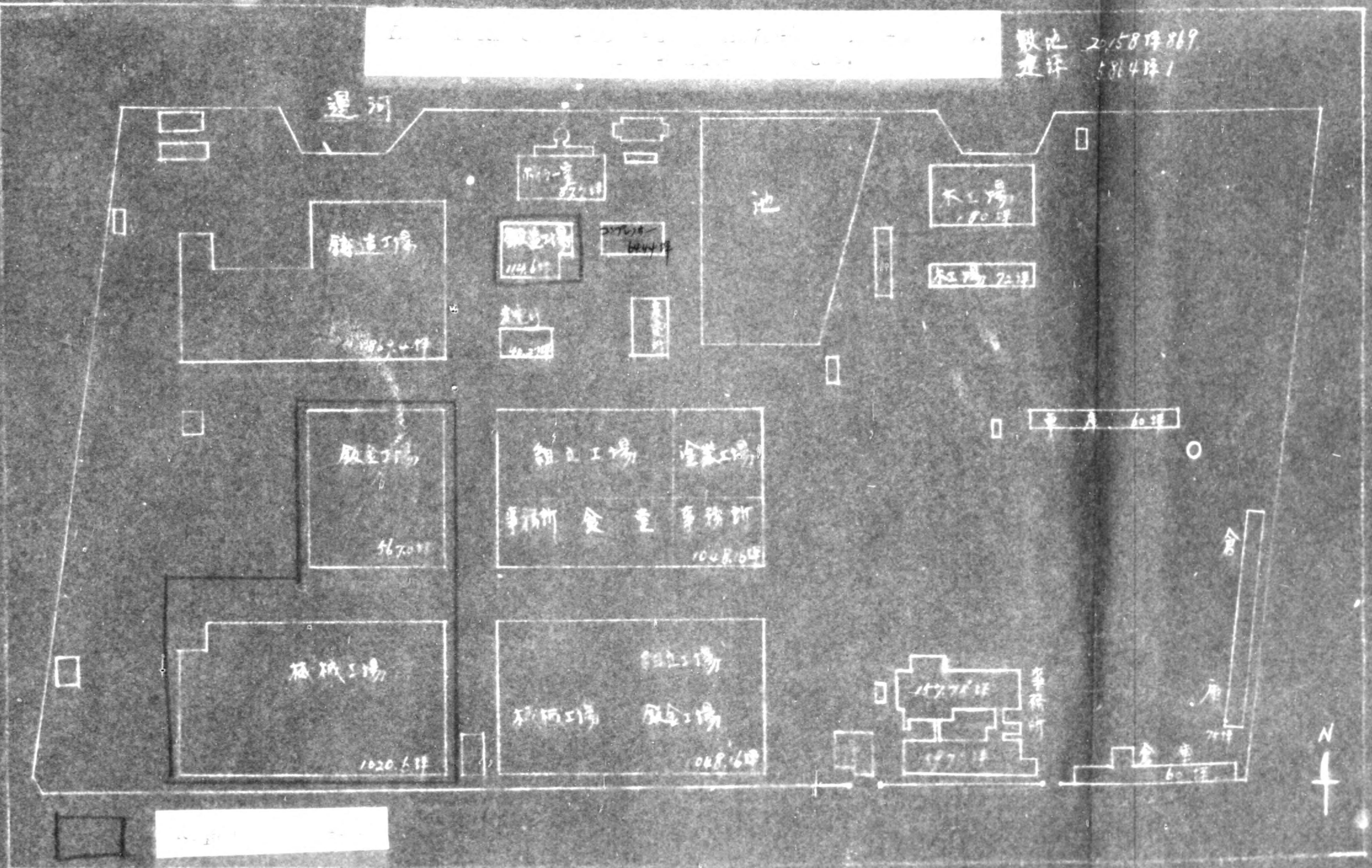

運河

池

鑄造工場

下... 57.11

鑄造工場 114.6

2576.18 644.18

木工場 180坪

木工場 72坪

車路 40坪

鍛造工場

567.0

組立工場

塗裝工場

事務所 食堂 事務所

1028.6

砥石工場

1020.6

組立工場

砥石工場

鍛造工場

1048.6

1577.12

1577.12

事務所

倉

庫

77坪

倉庫 60坪

N

775013

S M

File

EXCISE

SGT. MAJ

COMPANY

ECONOMICS

LEGAL & GOVT

Handwritten notes and signatures

GENERAL HEADQUARTERS
SUPREME COMMANDER FOR THE ALLIED POWERS
Economic and Scientific Section

7 March 1949
Date

C I

C E

PUBLIC WELFARE

TO:

PUBLIC HEALTH

Aichi

Military Government Team

SUBJECT: Reconversion Permit for Reparations Plant

1. Inclosed is an Operating Permit for Mitsubishi Jukogyo K.K.
Name of Company

Komi Plant #11 Shitamori, Shinchi, Yawata-cho, Chita-gun, Aichi
Plant Name Address

2. This permit will be granted the company unless the company is not fully complying with current directives effecting operation of the Reparations Plants.

3. If the permit is not given the Supreme Commander will be notified immediately of the reasons for the withholding of the permit and recommendations as to continued operation of the plant. An information copy will be sent direct to the Supreme Commander (Attn: ESS/IN) and action copies forwarded through command channels.

FOR THE CHIEF, ECONOMIC AND SCIENTIFIC SECTION:

Handwritten signature of W. S. Vaughan

W. S. VAUGHAN
Chief, Industry Division

MAR 12 1949
250 83

GENERAL HEADQUARTERS
SUPREME COMMANDER FOR THE ALLIED POWERS
Economic and Scientific Section

25 February 1949

Date

SUBJECT: Reconversion Permit for Reparations Plant

Mitsubishi Jukogyo K.K., Komi Plant

TO: #11 Shitazori, Shinchi, Yawata-cho, Chita-gun, Aichi Pref.

1. In accordance with Memorandum from the Supreme Commander for the Allied Powers to the Japanese Government, dated 22 November 1946 (SCAPIN-1355), the Mitsubishi Jukogyo K.K. is permitted to produce at their ~~Komi~~ Yawata-cho Factory located at Yawata-cho the following additional items:

Item	Maximum Quantity
<u>Power Agricultural Mach. Implement</u>	<u>250 sets per month</u>
<u>Internal Combustion Engine</u>	<u>400 " " "</u>
<u>XXXXXXXXXXXXXXXXXXXX</u>	<u>XXXXXXXXXXXXXXXXXXXX</u>
_____	_____
_____	_____

2. The temporary use of the following additional reparations machinery is authorized:

<u>None</u>	<u>None</u>
_____	_____
_____	_____
_____	_____

3. A program will be immediately initiated to substitute non-reparations machinery for reparations machinery in temporary use.

4. The acquisition of material, parts and sub-assemblies as well as the disposition of finished products and the establishment of sales prices will be in accordance with the regulations of the Japanese Government.

5. This permit is issued subject to any and all directives affecting reparations plants which have been issued or may hereafter be issued by the Supreme Commander for the Allied Powers. Reports will be rendered as required by current directives and instructions.

FOR THE CHIEF, ECONOMIC AND SCIENTIFIC SECTION:

W. S. VAUGHAN
Chief, Industry Division

775013

File

TO: The commander of Aichi Military Government Team
 THROUGH: Aichi Prefectural Liaison Office
 FROM: Mitsubishi Jukogyo K.K., Komi Plant.

List of Items of Equipment in Inventoried EX

Inventory Number	Type of Item	Operating dimension Serial and/or model Number	Name of maker	Name of Seller	Date of Purchase or other transaction by which item was acquired	Date of delivery into Plant	Classification of class
01 - 89 -306 EX	Hoist-Electric	Lifting capacity- 1 ton Height of Lift-6 m model-HO type Serial No. 12062 Individual Motor Driven	Mitsubishi Denki, Japan	Mitsubishi Denki	August 7, 1946.	August 20, 1946.	1
01 - 89 -307 EX	Hoist-Electric	Lifting capacity- 1 ton Height of Lift-6 m model-HO type Serial No. 12057 Individual Motor Driven	Mitsubishi Denki, Japan	Mitsubishi Denki	August 7, 1946.	August 20, 1946.	1
01 - 89 -311 EX	Hoist-Electric	Lifting capacity- 1 ton Height of Lift-6 m model-HO type Serial No. 12061 Individual Motor Driven	Mitsubishi Denki, Japan	Mitsubishi Denki	August 7, 1946.	August 20, 1946.	1

		Serial No. 12057 Individual Motor Driven					
01 - 89 -311 EX	Hoist-Electric	Lifting capacity- 1 ton Height of Lift-6 m model-HO type Serial No. 12061 Individual Motor Driven	Mitsubishi Denki, Japan	Mitsubishi Denki	August 7, 1946. ✓	August 20, 1946.	1
01 - 89 -308 EX	Grinder- Universal	Swing - 32 cm Center to Center- 100 cm Wheel Dia - 35 m/m Hydraulic System model - C type Serial No. 1865 Individual Motor Driven	Landis, U.S.A.	Borrowed from Nishiyama Seisakusho	Dec. 1, 1945. ✓	Dec. 20, 1945.	1
01 - 89 -309 EX	Grinder- Surface (Rotary type)	Swing - 6 cm Wheel Dia - 300 m/m Wheel Stroke - 6 x 15 cm model No. 22 Serial No. 8063 Individual Motor Driven	Heald, U.S.A.	Borrowed from Nishiyama Seisakusho	Dec. 1, 1945. ✓	Dec. 20, 1945.	1
01 - 89 -310 EX	Grinder- Centerless	Swing - 18 cm Wheel - 2 Dia of wheel - 50 m/m, 32 m/m Wheel Stroke- 8 cm Individual Motor Driven	Karatsu Tekko, Japan	Borrowed from Nishiyama Seisakusho	Dec. 1, 1945. ✓	Dec. 20, 1945.	1

Confirmed by J. Ishida Aichi prefectural officer
date 18 Feb 1949
Gatal. 6

APPROVED
SGT THOMAS J. BENEDICT
Repair Section
Aichi Mil Gov't Team

(附屬書類一通)
古調第一八號

愛知縣賠償課 御中

昭和二十四年一月十八日

三菱重工業株式會社古見機噐製作所
所長 佐藤 仙一 伏請

登録工機噐設備に係る件

拜啓嚴寒の砌り愈々御隆盛の趣御慶ひ申上げます、陳者去る十三日附
賠第九號を以て御申越ありました首題登録工機噐設備確認申請の件
別紙の通り御送付申上げますから宜敷御取計ひ下され度御願申上げま
す 敬具

Lease Contract

December 1, 1945.

Nishiyama Seisakusho (refer to A below) shall make a contract regarding to the machines owned by A with Komi Kojo, Mitsubishi Jukogyo K.K. (refer to B below).

The condition of the contract are as following:

- Article (1) A shall rent the machines stated below to B and B shall use the subject machines for production.
- Article (2) The valid period of the contract shall be five years beginning December 20, 1945 ending December 19, 1950. When either A or B does not notify until three months before the expiration, the contract shall be renewed by one year hence after.
- Article (3) The rental fee shall be two yen per machine and shall be paid to A on the last day of every December.
- Article (4) Either A or B can cancel the contract with six months notice even in the period stated in the Article (2) above.
- Article (5) Insurance fee, tax of other levy shall be paid by B.
- Article (6) A may claim for compensation to B when whole or a part of the subject articles is damaged by negligence of B or his employee.
- Article (7) At the expiration or cancellation of this contract, B shall have to put the subject machines as they are at the beginning of the contract.
- Article (8) A and B shall negotiate items not stated in this contract or any doubt arisen henceafter.

To verify this contract, two copies of this contract shall be held by A and the other shall be held by B.

A. Saka-machi, Shinkawa-cho, Nishikasugai-gun, Aichi-ken.

Nishiyama Seisakusho

Stamp

B. Shitamori, Shinchi, Yawata-cho, Chita-gun, Aichi-ken.

Mitsubishi Jukogyo K.K. Komi Kojo,

Manager, Kunii Takeo

Stamp

Leased Articles

Item	Maker	Quantity
Universal Grinder	Landis (U.S.A.)	1
Surface Grinder	Heald (U.S.A.)	1
Centerless Grinder	Karatsu Tekko (Japan)	1



機 械 賃 借 契 約 書

西山製作所 (以下甲ト稱ス) ハ三菱重工業株式會社古見工場(以下乙ト稱ス)トノ間ニ甲所有ノ機械ニ付契約スルコト左ノ如シ

第 壹 條 甲ハ其ノ所有ニ係ル末尾記載ノ機械ヲ乙ニ賃貸シ乙ハ之ヲ借受ケ使用スルモノトス

第 貳 條 本賃借期間ハ昭和貳拾年拾貳月貳拾日ヨリ昭和貳拾五年拾貳月拾九日ニ至ル五ケ年間トス

右期間滿了參ケ月前迄ニ甲乙就レヨリモ特別ノ意思表示無キ場合ハ以後毎年壹ケ年宛更新スルモノトス

第 參 條 本賃借料ハ壹ケ月機械一臺ニ付金貳圓也トシ毎年十二月末日ニ其分ノ甲ニ支拂フモノトス

第 四 條 甲及乙ハ貳條ノ期間中ト雖モ六ケ月前ノ豫告ヲ以テ契約スルコトヲ得ルモノトス