

PLAN OF THE POWER STATION  
OF THE  
RHEINISCH-WESTFÄLISCHE POWER CO. AT ESSEN

Marked 4 on Air Map No. 4.

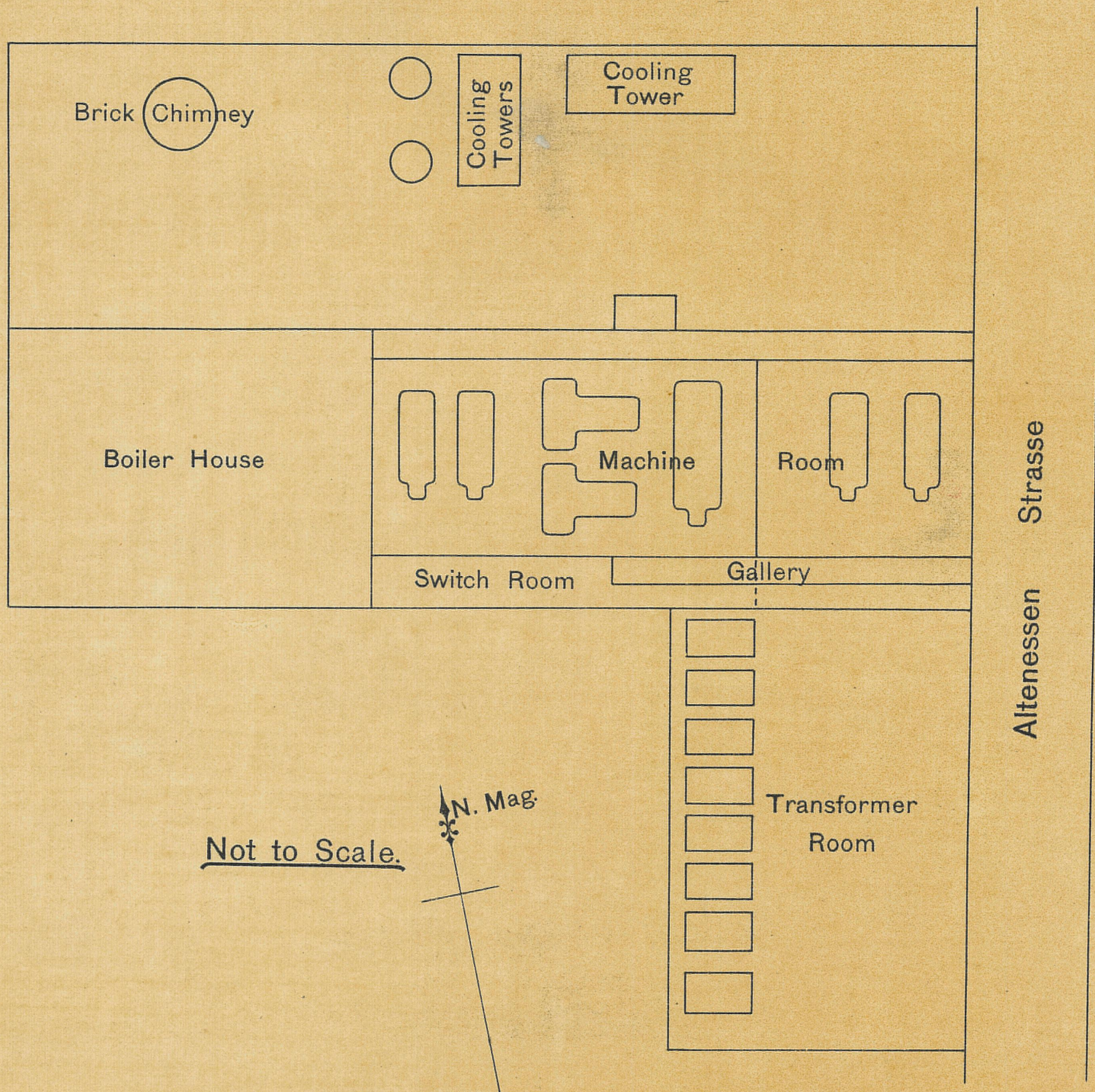

Immediately to the West of the power station is the Victoria Colliery (not shown on Air Map No. 4). There should be little difficulty in identifying this station, as in addition to the Pit Heads of the Victoria Colliery there are high chimneys and cooling towers.