

Inventory

Mark	Name of Equipment	Size	Maker	No.
B3- 7	Lathe	520X2400	Hibi	1
B3- 8	"	560X2400		1
B3-12	Cam Milling M/C	500X1400	Toyoseikan	1
B3-13	"	400X1000	"	1
B3-14	Vertical Drilling M/C		Kawashima	1
B3-17	Vertical Milling M/C #2	260X1050	Kyoto	1
B3-18	Bench Drilling M/C		Nakatsu	1
B3-19	Lathe	360X1800	Okuma	1
B3-20	"	320X1500		1
B3-21	"	500X1800		1
B3-22	"	350X1800	Okuma	1
B3-23	"	500X1800		1
B3-24	"	480X1800	Nishihashi	1
B3-26	"	480X1800		1
B3-27	"	540X300	Nishibayashi	1
B3-28	Vertical Drilling M/C	120X520	Onishi	1
B3-30	Plain Milling M/C	280X1300	Kageyama	2
B3-31	Vertical Drilling M/C	180X500		1
B3-32	Tool Grinding M/C	180		1
B3-33	Slotting M/C	360	Shibayama	1
B3-34	Shaping M/C	650	Mizutani	1
B3-35	"	400	Hayashi	1
B3-36	"	400		1
B3-37	"	500	Rokaroku	1
B4- 4	Plain Milling M/C #2	280X1130	Kageyama	1
B4-57	" #1	220X1000		1
B4-10	Lathe	640X3600	Maeda	1
B4-11	"	700X3600	Maeda	1
B4-12	"	350X2400	Toyoseikan	1
B4-15	"	520X1800	Karaiishi	1
B4-16	"	500X1500	Izumi	1
B4-19	"	300X1500	Honma	1
B4-20	Shaping M/C	400		1
B4-23	Tool Grinding	180		1
B4-25	Lathe	560X2400		1
B4-26	"	420X1800		1
B4-27	"	520X1800	Haga	1
B4-28	"	400X1500		1
B5- 5	"	460X1800	Kawashima	2
B5-6	"	620X2400		1
B5- 7	"	480X1800	Hameda	1
B5- 8	"	450X3000	American	1
B5-11	Vertical Drilling M/C	280X440		1
B5-12	Slotting M/C	300	Yokoyama	1
B5-14	Vertical Drilling M/C	320X750X500	Mitsubishi	1

Mark	Name of Equipment	Size	Maker	No.
B5-16	Vertical Milling M/C #2	260X660	Becker	1
B5-17	Lathe	360X1500		1
B5-20	Bench Drilling M/C		Hakatsu	1
B6-5	Lathe	440X2400	Tesseiko	1
B6-6	"	280X1200		1
B6-8	Vertical Milling M/C #2	320X1160		2
B6-9	Lathe	500X4500	Mitsubishi	1
B6-10	Shaping M/C	400	Smith & Mills	1
B6-12	Lathe	540X3600	Tanaka	1
B6-13	"	800X3600	Wakayama	1
B6-14	"	480X2400		1
B6-15	"	420X1800	Hokuroka	1
B6-16	"	480X1800	Akioka	2
B6-17	Plain Milling M/C #0	180X770		1
B6-18	Slotting M/C	200		1
B6-20	Shaping M/C	400		1
B6-22	Vertical Drilling M/C	200X570		1
B7-1	Hack Saw	150		2
B7-4	Radial Drilling M/C	300X1000	Dainippon Koki	1
B7-5	Vertical Milling M/C	300X1000	Osakakiko	1
B7-6	Shaping M/C	400		1
B7-7	Plain Milling M/C #0	160X770	Wurai	1
B7-8	Slotting M/C	250		1
B7-9	Hobbing M/C	500	Kashifuji	1
B7-10	"	630	Ogata	1
B7-13	Turret Lathe	380X2400	Toyoseikan	2
B7-14	Radial Drilling M/C	30X800		3
B7-16	Bench Drilling M/C		Hakatsu	1
B7-18	Shaping M/C	400	Sekae	1
B7-20	Vertical Multiple Spindle Drilling M/C 250X300X1000		Natcs	1
B7-21	Tool Grinding M/C	60X390		1
B7-22	Gear Hobbing M/C	250	Hansi	1
B7-24	Plain Milling M/C	200X820	Brown & Sharp	1
B1-13	Shaping M/C	600	Okumura	2
B3-9	Hack Saw	150	Rokuroku	1
B3-29	Vertical Milling M/C	250X840	Yoneda	1
B6-11	Lathe	620X2400		1

Address of the factories to which the machinery is to be transferred.

Aomori Factory
No. 125 Nowaki Ura-machi Aomori.

Shimizu Factory
1-chome Hinode-machi Shimizu.

Osaka Fukushima Factory
No. 30 Kusabiraki-cho Fukushima-ku Osaka.

Tobata Factory
No. 32 Tobatabiraki Tobata. — 30

Shimonoseki Factory
Hikoshima Shimonoseki — 15

TOYO SEIKAN KK
HIROSHIMA KOJO 11-15
Section V.

DATE	SUBJECT	ISSUING HEADQUARTERS & INDORSEMENTS
No Date	Reparations Check Sheet Munitions.	Toyo Seikan K.K.-Basic
31 Mar. 1949	Report on Inspection (11-15)	HMGT - Basic
7 Apr. 1949	Report on Inspection (11-15)	HMGT - Basic
22 June 1949	Report on Inspection (11-15)	HMGT - Basic
9 Aug. 1949	Report on Inspection (11-15)	HCAT - Basic
17 Aug. 1949	Report on Inspection (11-15)	HCAT - Basic
6 Dec. 1949	Inspection of Reparations Plants in Hiroshima Prefecture.	CCAR - Basic
20 Jan. 1950	Report on Inspection (11-15)	CCAR - Basic
20 Jan. 1950	Report on Inspection (11-15)	CCAR - Basic
10 Aug. 1950	Inspection of Toyo Seikan Company, Code No. 11-15	CCAR - Basic
8 Jan. 51	Inspection of Toyo Seikan K.K. (Mun 11-15)	CCAR - Basic

Section V. Inspection Reports.

Y

HEADQUARTERS
CHUGOKU CIVIL AFFAIRS REGION
ECONOMICS SECTION

D/WFA/ftk

CCAR 319.1

8 January 1951

SUBJECT: Report of Field Trip, Hiroshima City, Hiroshima Prefecture,
5 January 1951.

TO : Chief
Economics Section

PREPARED BY: W. F. Armstrong, Distribution and Industry Division.

1. REFERENCE:

O. D. 11.

2. PURPOSE:

Inspection of Toyo Seikan K.K., (Mun. 11-15).

3. BACKGROUND:

Routine.

4. DISCUSSION:

There are three dispersal areas which are not listed in our records. The status of reparations items bearing code number 11-15 is as follows:

<u>Code No.</u>	<u>Name of Co.</u>	<u>No. of items</u>	<u>Remarks</u>
* 11-15	Toyo Seikan K.K. Hiroshima Kojo	112	
* 11-15	Toyo Kikai K.K.	31	
11-15	Ohara Kogyo K.K.	12	Documental proof on hand
* 11-15-108 -111 -112 -114	Shirko Gode K.K.	4	

<u>Code No.</u>	<u>Name of Co.</u>	<u>No. of Items</u>	<u>Remarks</u>
11-15- 1 - 23 - 66	Toyo Seikan K.K. Shimizu Kojo	3	No documental proof on hand.
11-15- 8 - 46 - 54 - 67 -173 -217	Toyo Seikan K.K. Tokyo Kojo	6	No documental proof on hand.

NOTE: * Listed in our record.

The dead storage building is being used for storing wooden boxes without approval, thus causing a fire hazard to reparation machinery housed in the building.

5. CONCLUSIONS:

Maintenance of machinery both in A.U. and dead storage was found to be fair with no evidence of recent maintenance on dead storage equipment.

6. RECOMMENDATIONS:

The company officials were requested to submit copies of authorization for two dispersal areas for which no documental proof was present at time of inspection and that wooden boxes in the dead storage building be removed immediatly in view of the fire hazard.

W. F. ARMSTRONG
Distribution & Industry Division

FIELD TRIP REPORTR. P. LORD

10 August 1950

1. Purpose:

Inspection of Toyo Seikan Company, Code No. 11-15.

2. Background:

Surveillance in accordance with O.D. 11, 10 April 1950.

3. Discussion:

Reparations equipment in use at this location totals forty-seven (47) machines none of which are in use to the Toyo Seikan Company. This equipment is in use to three non-reparation companies - Shinko Gode (4 machines), Toyo Kikai (31 machines), Ohara Industry Co. (12 machines). Machinery in use to Shinko Gode and Toyo Kikai is still marked temporary operation since no approval has yet been received for their application requesting authorized use of these items. Machinery being used by Ohara Industry Co. is in authorized use approved by ESS/SCAP. (copy of this approval is in our file).

One of the warehouses at this location, housing reparations, equipment, which recently collapsed due to heavy rains has now been rebuilt and machinery therein is being cleaned and new preservatives applied.

4. Conclusion:

Equipment inspected and found in satisfactory condition with exception of several items in use by Toyo Kikai.

5. Recommendations:

- a. Improve maintenance on machinery mentioned above.
- b. Check with Hiroshima Bureau of ITI to see what action has been taken on Toyo Kikai and Shinko Gode application for authorized use of temporary use equipment.

R. P. LORD
Distribution & Industry Division

D/RPL/fk

MANUFACTURING
AND INDUSTRY
FILE 11-15 Sec II

11-15

IV

REPORT ON INSPECTIONCHUGOKU CIVIL AFFAIRS REGION
ECONOMIC SECTION

DATE: 20 January 1950

Mr. STRADLEY AND N. NISHIDA

INSTALLATION INSPECTED: SHINKO GODO KIKI SEISAKUSHO (CODE NO. 11-15)

LOCATION: NAKANO-MURA, AKI-GUN, HIROSHIMA PREFECTURE

INSPECTION COVERED THE FOLLOWING: Custody and maintenance of reparation machinery.

REMARKS:-

The reparation machines stored in this plant are which have been dispersed from TOYO SEIKAN CO. HIROSHIMA PLANT.

1. No. of Reparation machines: 4 (cl.II., "T.O.")

Each machine in T.O. was dusty generally, especially change gears of six-Lathe machine (code No. 11-15-108) was in poor condition and found some cogs of gear wheel were broken. Instruction was given to clean all of items and to replace the broken gear wheel with a complete one and a representative of C.C.A.R. Economics Section will call at this plant next month to see that this work is done. Application for "A.U." of 4 items in "T.O." was submitted to G.H.Q. through Japanese channel on 28 Dec 1949.

2. No. of gates: 1

No. of guards: 1 (and Mr. KOMORI, chief of this plant lives in this factory with his family)

3. Fire service arrangements:

Water tank - 1 (15^t capacity)

Fire extinguisher - 1 Bucket - 5

4. Employees: 6

Average age - 24.8 years Average wages - ¥ 7.500

% of attendance - 100 (NOV & DEC 1949)

5. Custody and maintenance of reparation machinery was in fair condition.

Appx:

President)
Custodian): MASAMI KOMORI
Technician)

B/S

11-15
Dec 1949

REPORT ON INSPECTIONCHUGOKU CIVIL AFFAIRS REGION
ECONOMICS SECTION

DATE: 20 January 1950

MR. STRADLEY AND N. NISHIDA

INSTALLATION INSPECTED: TOYO SEIKAN K.K., HIROSHIMA PLANT, AND
TOYO KIKAI K.K., HIROSHIMA PLANT. (Code No. 11-15)

LOCATION: 501 NISHITERRAMA-CHO, HIROSHIMA CITY

INSPECTION COVERED THE FOLLOWING: Custody and maintenance of Reparation
Machinery.

REMARKS: - (TOYO SEIKAN K.K., HIROSHIMA PLANT)

1. No. of Reparation machines: 159 (cl. I-0, cl. II-108, cl. III-51)

T.O. -35 D.S. - 124

31 items - lent to TOYO KIKAI K.K.

4 items - lent to SHINKO GODO KIKI SEISAKUSHO } out of 35 items
in T. O.

124 items in D.S. were well preserved and in excellent condition.

2. No. of gates : 1
-
- No. of guards: 4 (Shift of 24 hrs each half of 4)

3. Fire service arrangements:

Water tank - 5 (2^t - 3, 1^t - 2) Hand pump - 2

Hydrant - 1 Fire extinguisher - 8

Sand box - 10 Bucket - some

4. Employers: 16 (including 2 females)

Average age - 38 years Average wages - ¥ 10.930

% of attendance - 97.0 (NOV. 1949), 98.0 (DEC. 1949)

5. Custody and maintenance of Reparation machinery was very satisfactory.

Appx:

President : FUSAO KOBAYASHI

Chief of HIROSHIMA PLANT)
and Custodian) : YUJI NISHIDA

Technician : SHIN-ICHI IZUTA

11-15
Mc I

R D

(TŌYŌ KIKAI K.K., HIROSHIMA)

Located in the area of TŌYŌ SEIKAN K.K., HIROSHIMA PLANT

1. No. of Reparation machines : 31 (cl.II-25, cl.III-6, "T.O.")
Loaned from TŌYŌ SEIKAN K.K.,
HIROSHIMA PLANT.
2. Guards and Fire service arrangements of this plant are depending upon TŌYŌ SEIKAN K.K., HIROSHIMA PLANT's.
3. Employees: 45
4. Custody and maintenance of reparation machinery was in good condition.

Appx:

Application for "A.U." of 31 items in "T.O." was submitted to G.H.Q. through Japanese channel on 27 Dec 1949.

11-15
F-15

BSS

Inspection
Report

Sec. V

SUBJECT: Inspection of Reparations Plants in Hiroshima Prefecture
6-7-9-12-13-14 December 1949

The Saka Electric Power Plant of Nippon Hassoden was visited on 6 December. This plant was not inventoried as it is not included on list in SCAPIN 1489, dated 27 January 1947. Plant seems to be run in an orderly and efficient manner.

Toyo Kogyo Kabushiki, 11-28. Plant inspected on 6 December. 176 machines in authorized use were checked and found to be well maintained. Entire plant was in excellent condition. This company now manufacturing three-wheel motorcycle trucks. Production is 800 monthly with ready market. Some export orders for India were being filled at time of inspection. Company officials displayed cooperative attitude throughout inspection.

Japan Steel Works, 11-14. Inspected on 709 December. 360 machines listed on Inventory Data Sheet as being in authorized use after evaluation are only temporary use items. None of these items were located on first day of inspection "because person in charge of these items was absent." Authorized use machinery was inspected and found in poor condition. Rust appeared on several machines in addition to most machinery being poorly marked. Two machines 11-5(71)-17 and 11-14-421 were found in use although there was no authority on record for their temporary or authorized use. Explanation was given that machines were needed so therefor they were placed in use. Motor 11-14-2825 was attached to authorized use machine 11-14-146. The motor originally attached to this machine was said to be under repair. Motor finally located lying on dirt floor, no effort made to repair. Two unidentifiable motors attached to 11-14-1766U. Motor formerly attached to this machine were located lying in corner of warehouse. No explanation given.

On 9 December plant officials were "prepared" to show me the 360 items added on evaluation and listed on their Inventory Data Sheet by code numbers which I had in my possession for checking purposes. Machines shown me (approximately 50) evidently had code numbers painted on after my first visit as paint was still wet on them. The "man in charge" was never seen and all items seen were located in warehouses previously visited on 7 December. Compressor marked 11-14-3044 found to be 11-14-3024. Motor attached to 11-14-1309U had code number 11-14-2739 marked on. Motor was covered on front with machine oil. After wiping off the oil, code number 11-14-1309 appeared very prominently. Checking serial number of machine showed code number to be 11-14-1309. This was another effort on their part to cover up for items which they did not locate or properly code. Dead storage equipment also found in poor condition. Warehouses where machinery is stored are in need of repairs. Overall impression of plant is bad. Custodian is guilty of negligence and cover up tactics.

Shinko Godo inspected on 12 December. Four (4) machines are in temporary use here. The machines were dispersed from Toyo Seikan. All are in good condition. Code numbers are: 11-15-108, 111, 113, 114.

Toyo Seikan 11-15, inspected on 12 December. Dead storage area contains 124 machines. 31 machines from this location are in temporary use at Toyo Kikai by permission of HMGT letter dtd 6 December 1948. These 31 machines inspected and no discrepancies noted. All dead storage equipment is in excellent condition.

Asahi Sangyo 11-10, 11-5(73). Inspected on 12 December. 94 items were listed as being in authorized use. This figure should be 84 as ten machines listed as AU are in error. Machine numbers 11-5(73)-50, 11-5(73)-41 temporary use and 11-10-100, 11-10-113, 11-10-109, 11-10-116, 11-10-134, 11-10-137 authorized use were found in poor shape. 11-10-192U part of jib crane is lying outside building. Custodian says this cannot be used and should be scrapped. Motor marked "EX" found to be 11-10-138 authorized use machine. Marking of machinery is very poor as is maintenance. Custodian very sorry plant appeared in such condition.

Shinko Gomu 11-5(91) inspected on 13 December. Nine (9) machines are in authorized use by letter of HMGT. Five (5) machines are in temporary use. Application was sent to HMGT in February 1948 asking authorized use of temporary use machinery. No answer was received. Machinery inspected and found in good condition.

Kurashiki Cotton Spinning Works 11-2. Dead storage area inspected on 13 December. 272 machines checked and found to be well stored and maintained in four warehouses.

Hagoromo Works 11-12. Inspected on 14 December. Dead storage area containing 78 machines. All machinery checked and found in good condition.

Hiroshima Machine Tool Works 11-17
Mitsubishi Heavy Industries

Inspected on 14 December. All machinery in use and storage inspected and found in excellent condition. Stored machinery is well housed.

ROBERT P. LORD, DAC
Economics Section
CCAR

REPORT ON INSPECTION

HIROSHIMA CIVIL AFFAIRS TEAM

DATE: 17 August 1949SECTION MAKING INSPECTION: Economics DATE OF INSPECTION: 12 August 1949OFFICER OR E.M. MAKING INSPECTION: W.O. Sowder, N. NishidaINSTALLATIONS INSPECTED: Toyoseikan K. K., Hiroshima Plant(Code No. 11-15)LOCATION: 501, Nishitema-cho, Hiroshima City (B - 14)TIME SPENT IN INSPECTION: 2 hoursINSPECTION COVERED THE FOLLOWING: Custody and maintenance of reparation machinery.

REMARKS:

1. No. of reparation machines:

Total No. - 159 (Cl.II - 108, Cl.III - 51)T.O. - 35 D.S. - 124

2. Date of the latest overhaul and adjustment of reparation machinery:

End of March 1949.

3. No. of gates: 1. No. of guards: 4 (Shift of 24 hours each half)

4. Fire service arrangements:

Water tank - 5 (2t - 3, 1t - 2)Hand pump - 2 Hydrant - 1Fire extinguisher - 8 Sand boxes - 10Buckets - Some

5. Employees:

Total - 16 (12 August, 1949)Workers engaged in maintenance of Reparations Machinery: 5

6. Custody and maintenance of machinery was very satisfactory.

(Appx):- (1) % of attendance;

98.0% (April 1949)97.0% (May 1949)

99.0% (June 1949)

100% (July 1949)

(2) a. Average age of employees: 38.0 years

Oldest " " " : 61 years

Youngest " " " : 21 years

b. Average wages of employees: ¥ 10,930

Maximum " " " : ¥ 16,500

Minimum " " " : ¥ 5,900

(3) President: FUSAO KOBAYASHI

Custodian: YUJI NISHIDE

Technician: SHINICHI IZUTA

REPORT ON INSPECTION

HIROSHIMA CIVIL AFFAIRS TEAM

DATE: 9 August 1949SECTION MAKING INSPECTION: Economics DATE OF INSPECTION: 6 August 1949OFFICER OR E.M. MAKING INSPECTION: WO Soudar, N. NishidaINSTALLATIONS INSPECTED: Shinke Gode Kiki Seisakusho (Code No. 11-15)LOCATION: Nakano-mura, Aki-gun, Hiroshima Prefecture (B-15)TIME SPENT IN INSPECTION: 1 1/2 hoursINSPECTION COVERED THE FOLLOWING: Custody and maintenance of Reparation MachineryREMARKS: The reparation machines stored in this plant are which have been dispersed from Toyo Seikan K.K., Hiroshima City.1. No. of Reparation Machines:4 (G1 II and T.O.)2. Date of the latest overhaul and adjustment of Reparation Machinery:End of January 19493. No. of gates: 1No. of guards: 1 (Mr. Konori, Chief of this plant, lives in this Plant with his family)4. Fire service arrangements:Water tank - 1 (15t)Fire extinguisher - 1Buckets - 55. Employees: 6 (males only)Average age : 24.8 yearsOldest age : 38 yearsYoungest age : 17 years

00 00

Average wages	:	¥7,500
Maximum wages	:	¥8,500
Minimum wages	:	¥5,000

6. % of attendance:

100% (April, May, June, and July 1949)

7. Custody and maintenance of Reparation Machinery was in good condition.

(APPX):

President)	
Custodian)	Masami Komori
Technician)	

REPORT ON INSPECTION

HIROSHIMA MILITARY GOVERNMENT TEAM

DATE: 2 JUNE 1949SECTION MAKING INSPECTION: Econ. DATE OF INSPECTION: 27 MAY 1949OFFICER OR E.M. MAKING INSPECTION: Capt. Sugges, N. NishidaINSTALLATIONS INSPECTED: Tōyō Seikan K. K. Hiroshima Plant.
(code No. 11-15)LOCATION: 501, Nishi Tenma-Chō, Hiroshima (B-14)TIME SPENT IN INSPECTION: 1½ hoursINSPECTION COVERED THE FOLLOWING: Custody and Maintenance
of Reparation Machinery

REMARKS: 1. No. of Reparation Machines:

Total No. 159 (Cl II 108, Cl III 51)T.O. 35 D.S. 124.2. Date of the latest overhaul and adjustment
of Reparation Machinery: End of Mar. 493. No. of gates: 1No. of guards: 4 (Shift of 24 hours each half)

4. Fire service arrangements:

Hand Pump - 2Hydrant - 1Fire extinguisher - 8Water tank - 5 (2^T-3, 1^T-2)Sand box - some

5. Employees:

Total - 16 (27 MAY 49)Workers engaged in maintenance of (cont'd)

REPORT ON INSPECTION

HIROSHIMA MILITARY GOVERNMENT TEAM

DATE: _____

SECTION MAKING INSPECTION: _____

DATE OF INSPECTION: _____

OFFICER OR E.M. MAKING INSPECTION: _____

INSTALLATIONS INSPECTED: _____

LOCATION: _____

TIME SPENT IN INSPECTION: _____

INSPECTION COVERED THE FOLLOWING: _____

(Cont'd)

REMARKS:

*Reparation Machinery - 5**% of attendance - 98.0% (Apr. 49)**b. Custody and Maintenance of Reparation machinery was in excellent condition.**(Appx)**President: FUSAO KOBAYASHI**Custodian: YUJI NISHIDE**Technician: SHINICHI IZUTA.*

REPORT ON INSPECTION

HIROSHIMA MILITARY GOVERNMENT TEAM

DATE: 7 Apr. 1949SECTION MAKING INSPECTION: Econ. DATE OF INSPECTION: 1 Apr. 1949OFFICER OR E.M. MAKING INSPECTION: Capt. Dugger, N. NishidaINSTALLATIONS INSPECTED: Shinko Godo Kiki SeisakushoLOCATION: Nakano-Mura, Aki-Gun, Hiroshima Pref.TIME SPENT IN INSPECTION: 1 1/2 hoursINSPECTION COVERED THE FOLLOWING: Custody & Maintenance
of Reparation MachineryREMARKS: The Reparation Machines stored in this
plant were which have been dispersed from
Toyō Seikan Co. - Hiroshima City.1. Code No.: 11-15

No. of Reparation Machines:

4 (cl. 4) T.O. 42. Custody, Maintenance & Marking of R.M.
was in good condition.

(Appx)

(1) Date of the latest overhaul & adjustment:

30 Jan. 1949(2) Employees: Total 8 (male)(3) % of attendance: 100%(4) No. of guards: 1

(5) Fire Service arrangements:

Water tank (15^T)-1, Fire extinguisher-1, Buckets-5.

REPORT ON INSPECTION

HIROSHIMA MILITARY GOVERNMENT TEAM

DATE: 31 Mar. 1949SECTION MAKING INSPECTION: Econ.DATE OF INSPECTION: 29 Mar. 1949

OFFICER OR E.M. MAKING INSPECTION:

Capt. Duggan, N. Nishida

INSTALLATIONS INSPECTED:

Toyo Seikan Co. Hiroshima Plant,
(11-15)

LOCATION:

501 Nishitenma-cho, Hiroshima. B-14

TIME SPENT IN INSPECTION:

2 hours

INSPECTION COVERED THE FOLLOWING:

Custody & Maintenanceof Reparation Machinery

REMARKS:

1. Total number of machines:159 (Ch. II 108, d. II 51)T.O. 35 D.S. 1242. Custody, Maintenance and Marking
of Reparation Machinery was in
excellent condition.(Appx.)(1) Date of the latest overhaul & adjustment:
End of March 1949(2) Workers engaged in maintenance of R.M.:
5 (~~Females~~) (Males)

V

COPY

Reparations Check Sheet

~~REPAIRS~~ Munitions

(Cross out one)

Nishi Tenna-machi

1. Name Toyo Seikan K.K. Code # 11-15

2. Prefecture: Hiroshima Year Built 1924

3. Reparation Status

(a) Listed by Scapin No. 1134 13 Aug 1947

(b) Deleted by Section No. _____

(c) Rec. for Deletion HAGT 7-220, 28 Jan 1947

(d) Rec. for Addition _____
(Not yet listed)

4. Products

	Items	Percent
(a) Prewar	Canning Machines Can Making Machines	100 %
(b) During War	Can Making Machines Canning Machines Torpedo Parts	till 1944 100 %
(c) Post War	None	

5. Year War Production Began: 1944

6. Is Plant Now in Operation? No - some wood work being done.

7. Size of Company:

	<u>No. Machines</u>	<u>No. of Employees</u>
(a) Prewar	120	400
(b) During War	263	1400
(c) Post War	228	18

8. Condition of Plant 90 % Per Cent Damaged.

9. Remarks:

In the case of this factory such intensive damage was done that rehabilitation has been impossible with the present financial condition.

Prior to the conversion to War production Can Making Machines and a Canning Machine was made along the lines of the America Can Company patent and appeared to be of high quality.

Although the Hiroshima Factory is a complete loss and the main office has abandoned it, Twenty five machines were dispersed, prior to listing for reparations to the Tobata Factory, Fukuoka Prefecture where Canning Machines is being continued. Deletion of these 25 tools is recommended.

Signed:

James R. Francisco
J. R. FRANCISCO

Capt., Inf.

This is No _____ of _____

Commerce & Industry Officer
reviews to be submitted.

HEADQUARTERS
CHUGOKU CIVIL AFFAIRS REGION
APO 182

CCAR 386.3 (D-Lo)

15 August 1950

MEMORANDUM FOR: Hiroshima Prefectural Government

THROUGH: Chugoku Liaison and Coordination Office

SUBJECT: Repair of Building at Reparations Plant 11-15

1. Reference is letter Hiroshima Prefectural Office, Serial No. Hiro-Shin-Ki 50, subject: "Repair to the Building at Reparations Plant", 9 August 1950.
2. No objection is interposed to repairs of warehouse as outlined in referenced letter.
3. Expenses involved in this repair will be borne by the Toyo Seikan Company and will not be charged to any reparations account.

C. N. BAILEY
Colonel, Inf
Chief

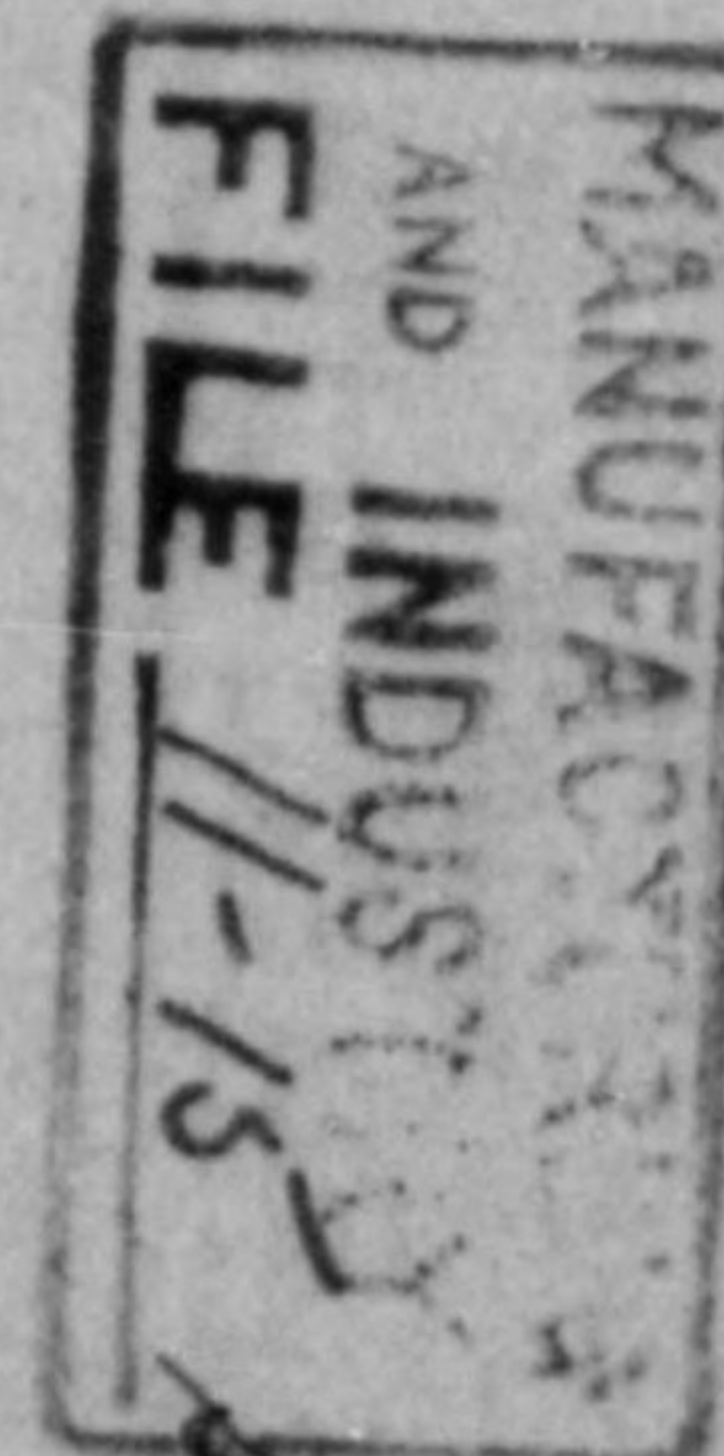

C O P Y

Hiroshima Prefectural Office

Serial No. : Hiro-Shin-Ki 50

Hiroshima City
9 August 1950

SUBJECT: Repair to the Building of Reparation
Plant

TO : Chief
Chugoku Civil Affairs Region

Toyo Seikan K.K. Hiroshima Factory (11-15) located at Nishi Temma-cho, Hiroshima-shi has built a one-storied warehouse of 100 tsubo of floor space consisting of cement-tile roof and wood in April 1947 with the money granted by the Government in order to store reparation machinery. But the floor space of 80 tsubo of the warehouse has become unserviceable for storage of the reparation articles (87 machines and 33 other goods) stored in the warehouse as the roof fell down and most of the side walls were destroyed about 3.10 a.m. July 1 when it was raining.

You are cordially requested to be kind enough to acknowledge the following matters:

1. There is no other place available.
2. It is duly necessary that this building should be repaired in order to carry out satisfactory preservation and custody with the minimum expenditure.
3. A special approval will be granted for disbursing the repairing expenses to this building from the National Treasury.

FOR THE PREFECTURAL GOVERNOR:

/s/ Tetsuo Wakuda
TETSUO WAKUDA
Vice-Governor

C O P Y

KURE LIAISON OFFICE

KL No. 514

22 July 46

SUBJECT: Transmitting the following report and applications.

TO : Hiroshima Military Government Team.

I have the honour to transmit herewith the following report and 4 applications from the Chief of Kure Branch of the Hiroshima Financial Bureau.

1. Report of delayance of Machinery removal.
2. Return of admittance certificate and request of postponement of term.
3. Disassembling of the temporary wooden building belonging to former Kure Navy Yard and the use of tin plate available.
4. Removal and maintenance of evacuated machinery belonging to former 11th Naval Air Arsenal located at Toyo Seikan Co.
5. Removal and maintenance of evacuated machinery belonging to former 11th Naval Air Arsenal located at Ohara Girls' Middle School.

Your favourable consideration on this matter will be greatly appreciated.

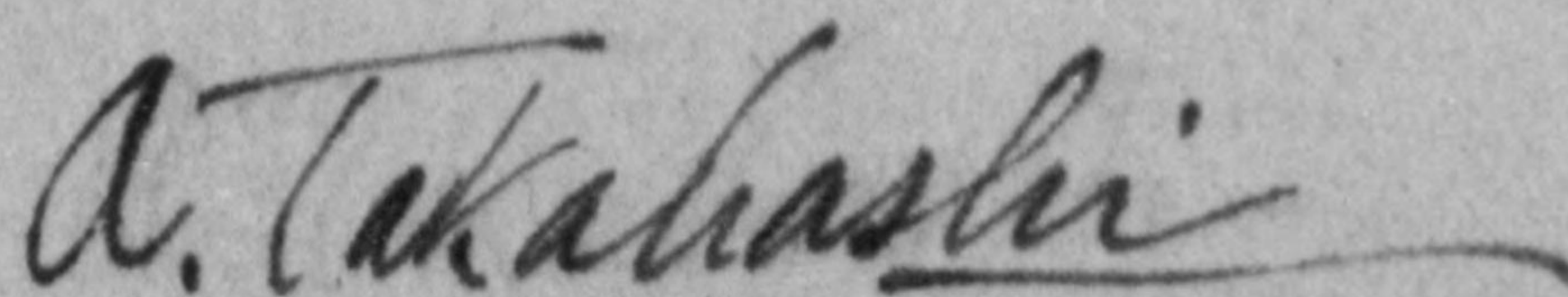

A. Takahashi,
Deputy Chief,
Kure Liaison Office.

Inclosure: 5.

MU/sn

784

HIROSHIMA FINANCIAL BUREAU

17 July 1946

To : HQ 76th Military Government
Subject : Report of delayance of machinery
removal

Dear sir :

May we report you the following.

The underwritten removal of machinery which was approved through petition, File K.L.No. 187, dated 17 May 46, are obliged to postpone approximately on 20 July owing to the break out of cholera in the town to be transferred and sentenced out-of-bound.

Present place of evacuation
Takahashi boy's middle school
Nariha girl's middle school
(both in Okayama Prefecture)

Place to be transferred
Shigemasa Seisakusho, Kanbe-machi, Fukayasu-
gun, Hiroshima Pref.

Materials to be transferred
100 machines and tools

The above, for your information.

Yours truly

S. Kashiwabara
Saburo Kashiwabara
Chief of Kure Branch,
Hiroshima Financial Bureau

HIROSHIMA FINANCIAL BUREAU

17 July 1946

From : Hiroshima Financial Bureau
 To : 76th Military Government
 Through : Kure Liaison Office
 Subject : Disassembling the temporary wooden buildings belonging to former Kure Navy Yard and the use of tin plates available

Dear Sir :

May we ask your favour to please approve the following petition.

Roofs of shops located in Mizuno area were heavily damaged by bombing and a part of machineries in these shops are exposed to rains, necessitating the repair of roofs and side walls to prevent the rusting of these machinery by using the tin plates.

In accordance to your instruction, to repair the roofs of these shops by the last of July, urgent collection of tin plates is desired.

But as at present is quite impossible to collect the new plates from the civilian sources, we should like to disassemble the temporary buildings located on the upward of the upper road (now empty, in no use, c.f. enclosed map) and to use tin plates available for the above purpose.

For your reference, location of buildings and quantity of tin plates available are as follows.

No. of building	Quantity			Total
	roof	side wall	on the ground	
A	50	12	13	75
B	18	2		20
C	60	7		67
D		8		8
E		31		31
F	14			14

-- I --

No. of building	Quantity			Total
	roof	side wall	on the ground	
G.	9			9
H.	606	415		1,021

Grand total 1245 plates

Kind consideration on your part will be greatly appreciated.

Yours truly

S. Kashiwabara

Saburo Kashiwabara
Chief of Kure Branch
Hiroshima Financial Bureau

Enclosure : one map

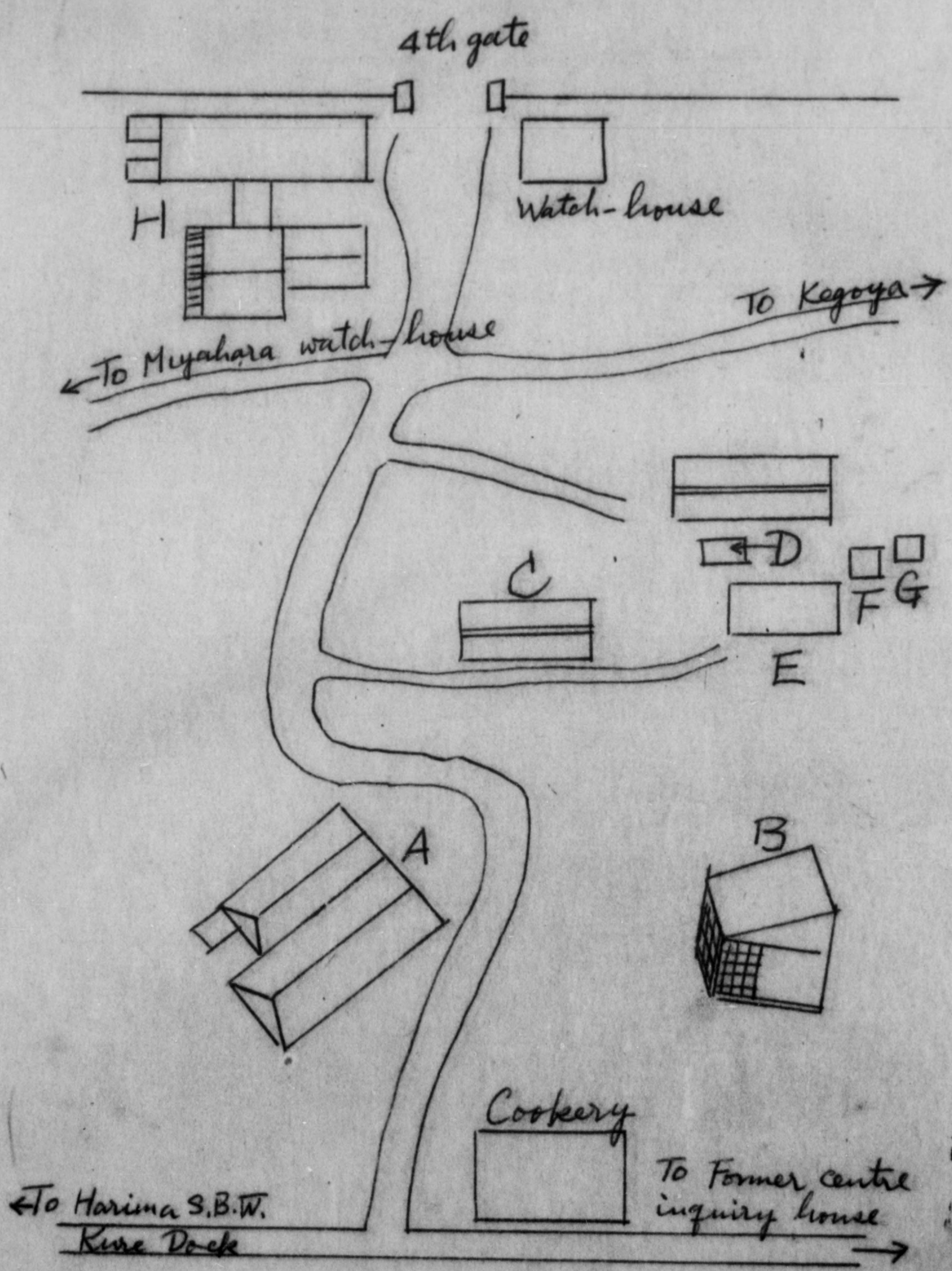

HIROSHIMA FINANCIAL BUREAU

17 July 1946

To : DEE Section, HQ BCOF
Subject : Return of admittance certificate
and request of postponment of
term

Dear Sir :

Enclosed please find the 4 admittance certificate to Kirikushi Cave, Etajima, owing to the termination of term.

Concerning the admittance certificate of Mr. Taoda the term was corrected by BCOF to be effective until 31 July.

But as these certificate are by all means indispensable for the protective maintenance and investigation of machinery in these area in near future, we should be much obliged if you would approve the postponment of term until the last of August this year.

Kind consideration on your part will be greatly appreciated.

Yours truly

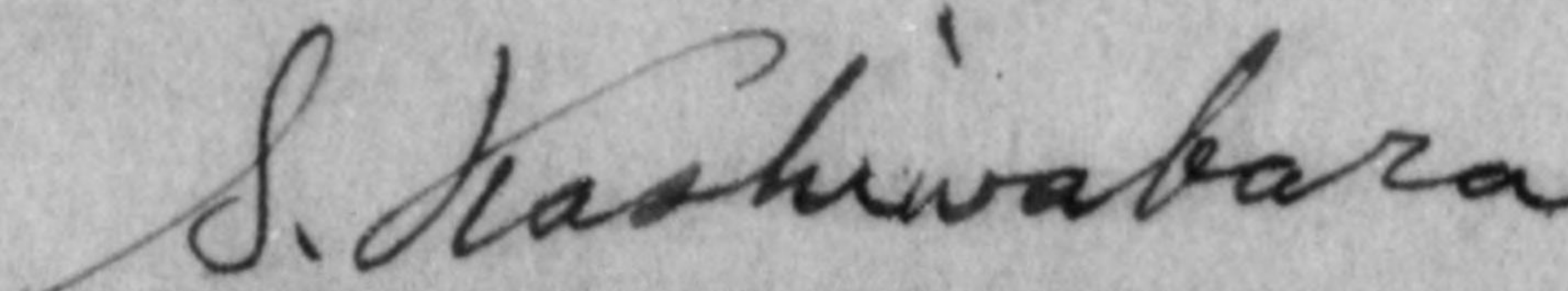

Saburo Kashiwabara
Chief of Kure Branch,
Hiroshima Financial Bureau

Enclosure : Certificate of Mr. Yamashita, Kaya,
Hayashi, Shoda

BRITISH COMMONWEALTH OCCUPATION FORCE

Form D2

PERMIT NO. DEE..282....

1-2

RANK.....NAME..K. Yamashita & Working Party
representing. Kure Branch Hiroshima Financial Bureau.....(Unit)

is authorised to enter the following premises.....

.....Installations at KIRIGUSHI *containing machinery only*

for the purpose of:

- (a) ^{*in the area*} Inspection & Removal of Machinery
- (b) ~~Removing equipment and stores as indicated on attached inventory Form D1.~~

This permit is valid until 10 Jul 46 and must be returned to D.E. Sec, HQ BCOF, upon expiry.

Signed. *[Signature]*

Date... 11 Jun 46



[Handwritten notes and symbols on the right margin]

FROM : HIROSHIMA FINANCIAL BUREAU
TO : HEADQUARTER OF 76TH, MILITARY GOVERNMENT
VIA : KURE LIAISON OFFICE

SUBJECT: REMOVAL AND MAINTENANCE OF EVACUATED MACHINERIES BELONGED TO FORMER KURE NAVY ARSENAL.

We request your approval of the following petition

1. Present place of evacuation
Toyoseikan Comp. Kohicho Hiroshima-city
2. Place to be transferred
328 Schome Osucho Hiroshima-city
Chugokuhaiden Comp.
3. Materials to be transferred
Machine 34 and parts
refer attached paper
4. Responsible custodian
Chugokuhaiden Comp. Chief of Osu worka
Takeshi Miyajuki
5. Reason for transfer
According to 20th of January 1946, AG004 directives concerning the maintenance of former Army and Navy Machineries, we practiced maintenance one time but the present location of the above machineries is unfit because some machineries are exposed to rain and the superindence is difficult, hence we desire its urgent removal.

S. Hashiwabara
Chief of kure Branch
Hiroshima Financial Bureau

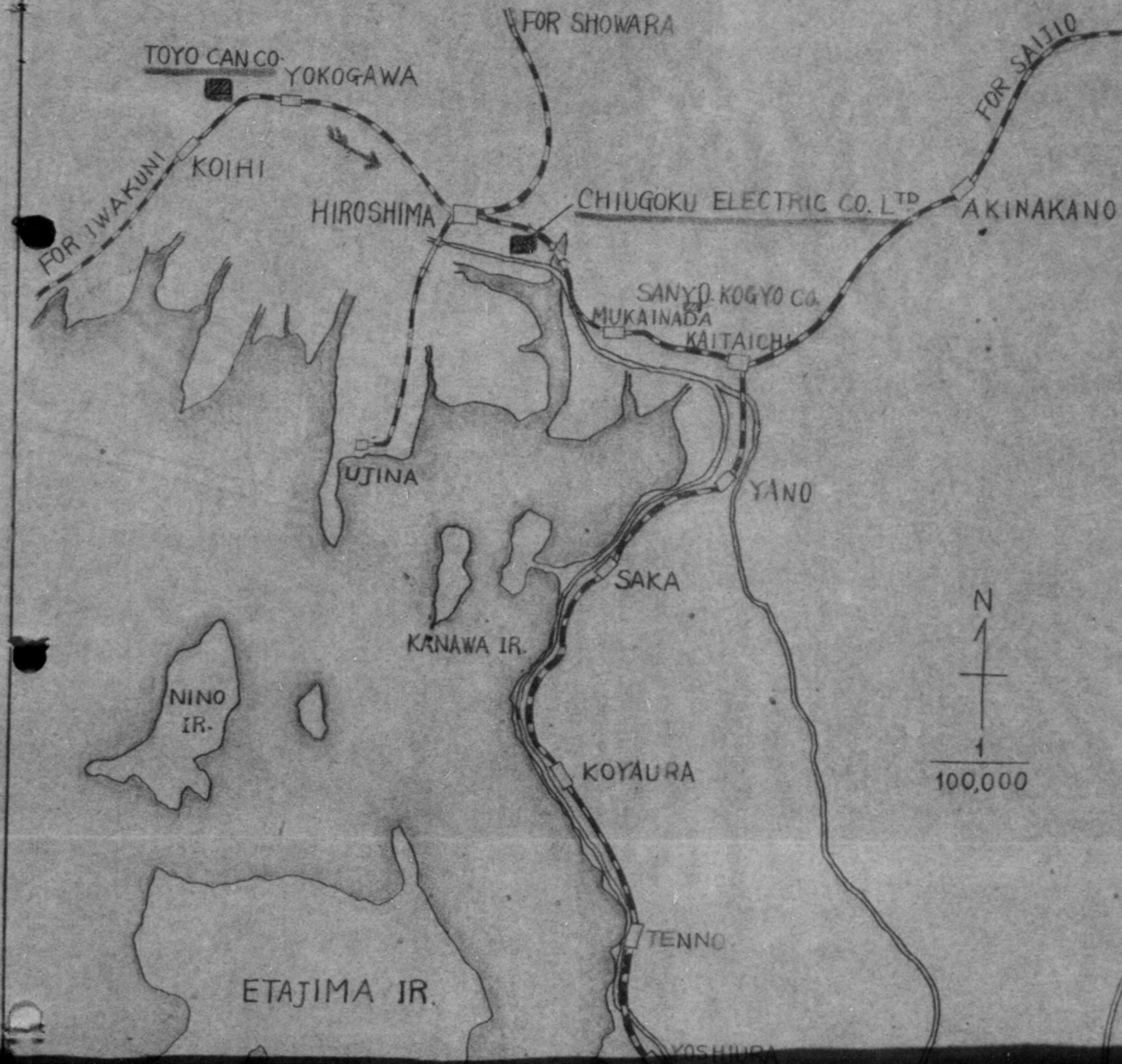

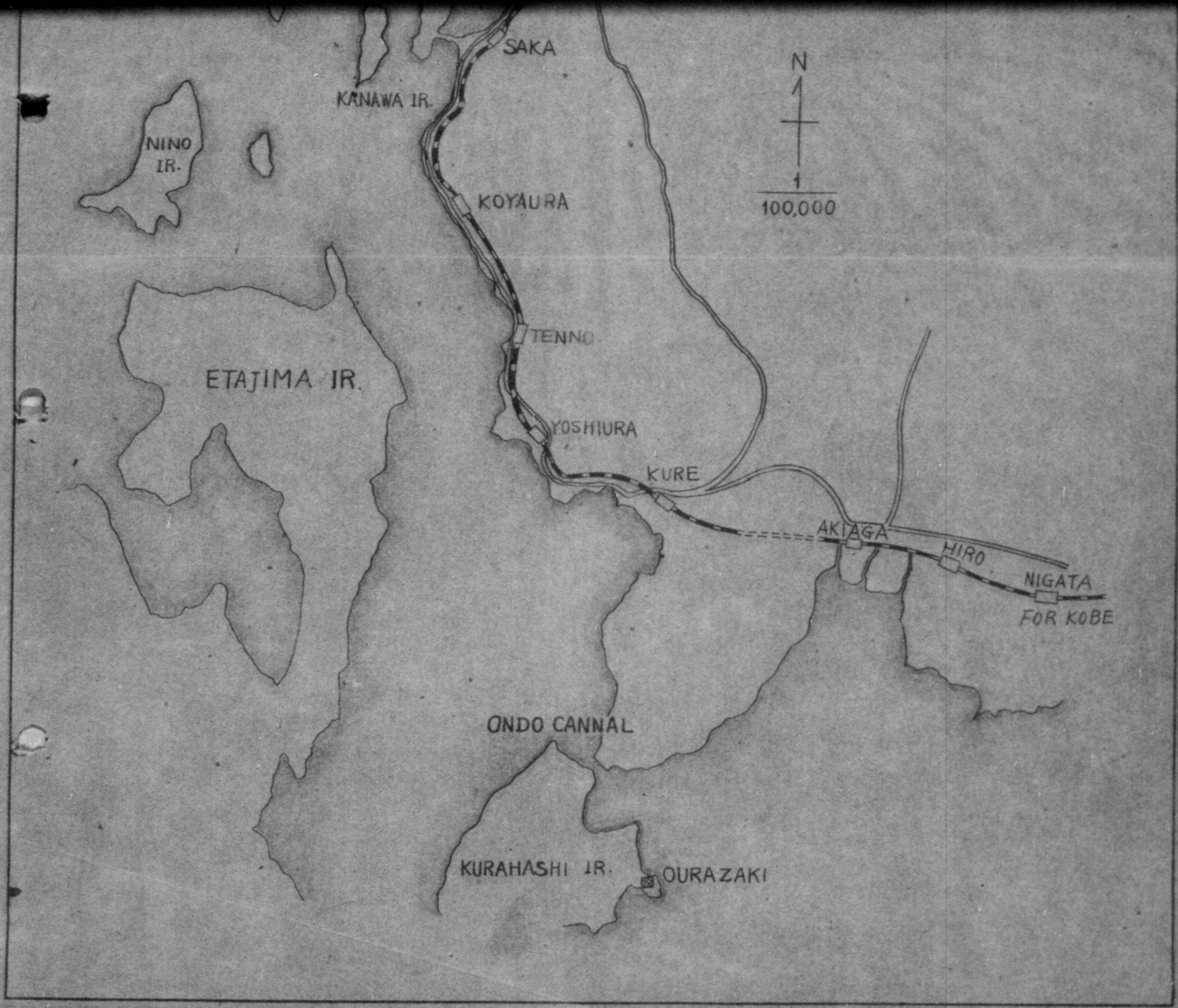

(機 器 類 別)

List of machines

DESCRIPTION	QUANTITY	REMARKS
Lathe	18	
Milling machine	8	
Shaper	4	
Slotter	1	
Drilling machine	2	
Sawing machine	1	
Total	34	

機 車

HIROSHIMA FINANCIAL BUREAU

17 July 1946

From : Hiroshima Financial Bureau
To : HQ 76th Military Government
Via : Kure Liaison Office
Subject : Removal and Maintenance of evacuated
machinery belonging to former 11th
naval air arsenal

Dear Sir :

May we ask your favour to please approve the following petition

1. Present place of evacuation
Ohara Girls middle School
Ohara Ogaki-cho, Saiki-gun, Hiroshima-ken
2. Place to be transferred
Nomi-kojo, Toyo-boseki Co.
Okimi Ogaki-cho, Saiki-gun, Hiroshima-ken
(above refer attached paper)
3. Materials to be transferred
12 machines and parts
(refer attached paper)
4. Responsible custodian
Sanji Nonaka , Representative of Toyo Boseki-
Company
5. Reason for transfer
Present location is the Girl's middle School
and no custodian for the protective maintenance
of above machinery and moreover the place is
unfit for the safe keeping, necessitating the
urgent removal to the suitable place.

Anticipating your kind consideration for the above,
I am

Yours truly

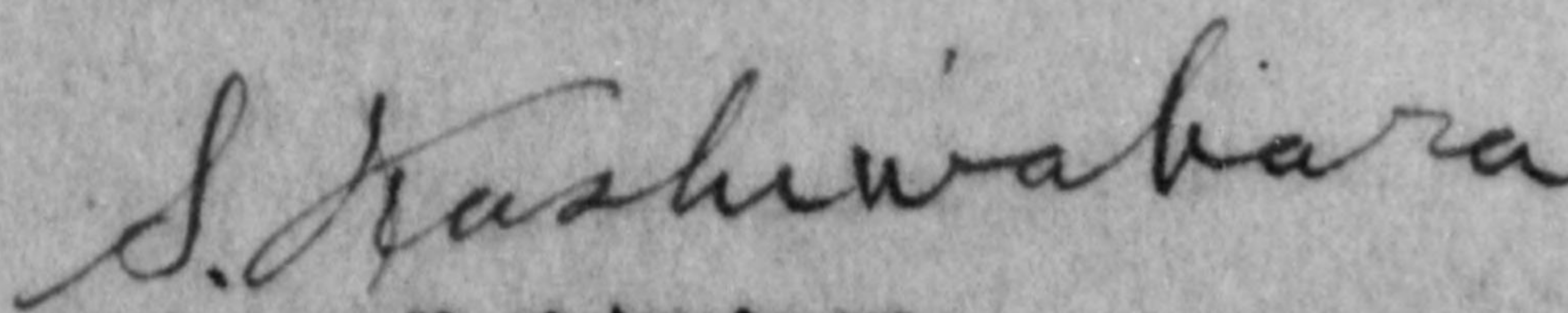

Saburo Kashiwabara
Chief of Kure Branch,
Hiroshima Financial Bureau

Maps of Okara Girls middle school
and Nomi-kojo, Toyo-baweki Camp.

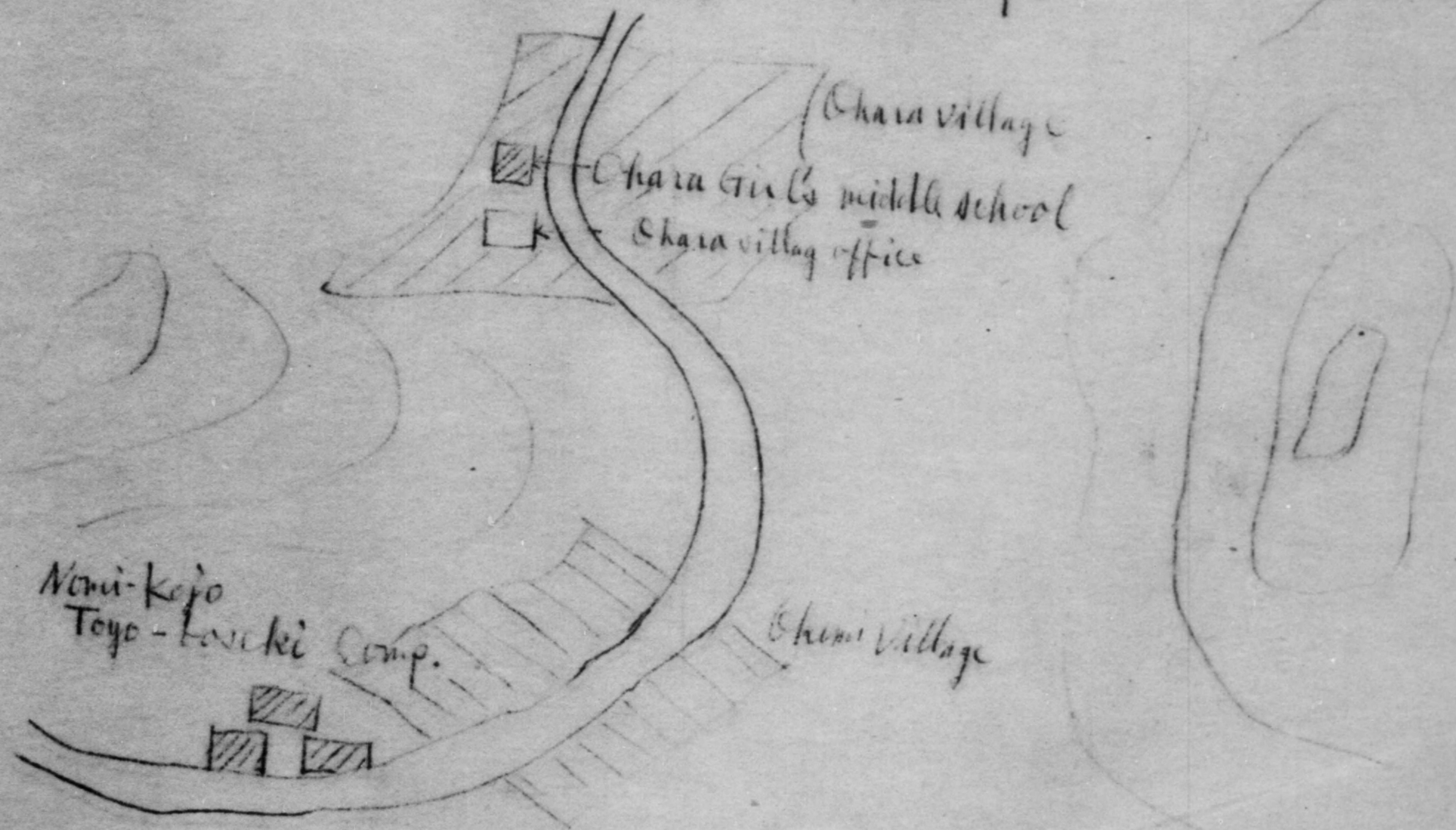

(英 國 海 軍)

List of machine

DESCRIPTION	Quantity	Remarks.
Small lathe	10	and parts
Small milling machine	1	"
tool grinder	1	"
total	12	and parts

海 軍