

集合母型の特徴

集合母型の製作に當つては入金に鉛字の文字面を研ぎ、彫刀を入れ、之を粗字として精緻な原鋳を作製し之に依り複製しますから、字の歪や深さの不同は絕對にありません。厚味は三・五ミリメートル以上の無垢の銅板ですから普通の銅箔的母型と其の比を異にしてゐます。然かも之に銅板と見出盤を張りつけた堅牢無比なものであります。鉛字保存及取扱は至つて容易で任意の文字が鑄込めますのみならず字母の取價は單母型の半値以下になります。

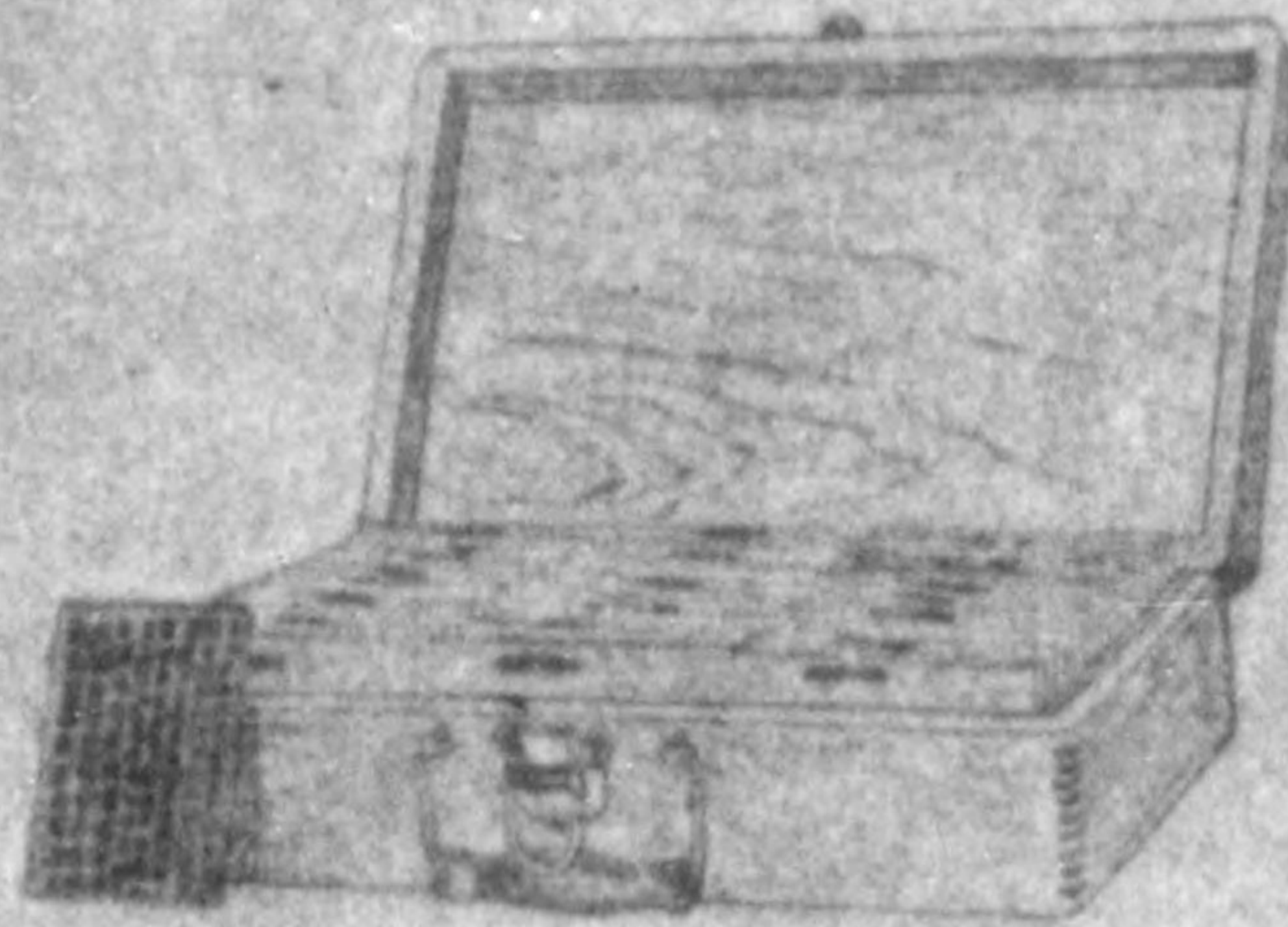

集合母型及母型枠

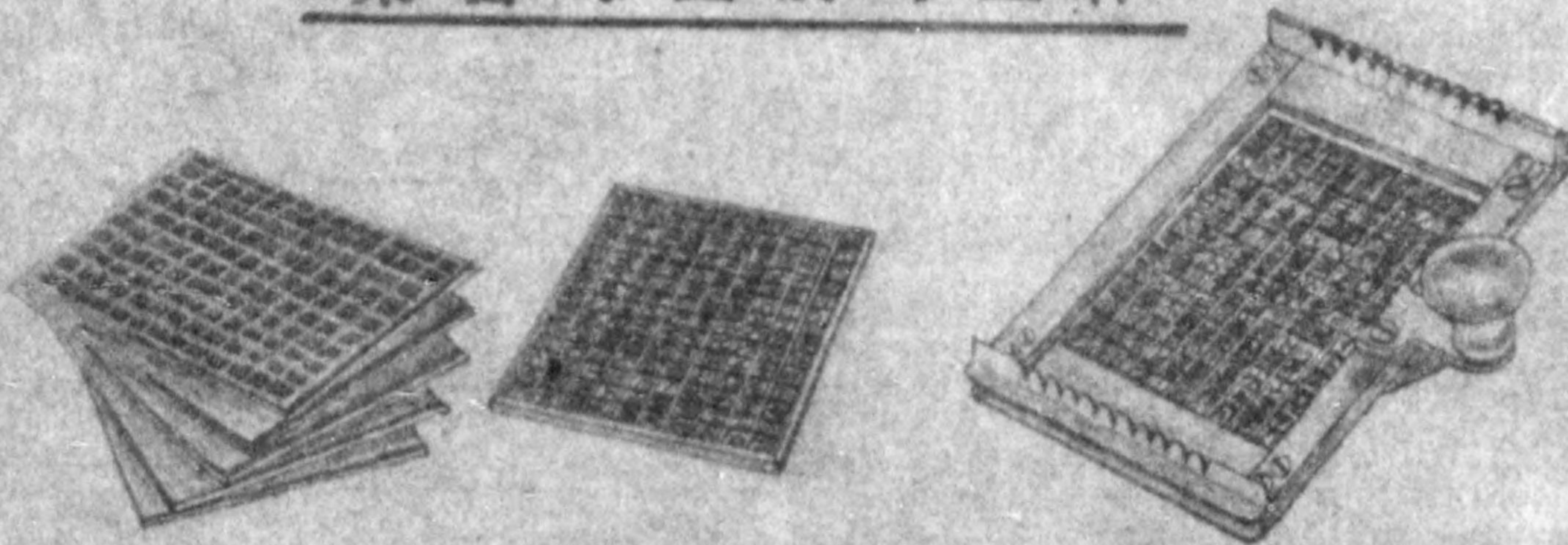

集合母型收容字数表

組	種	種別	編纂枚数	外字数枚数	照字物数枚数	大外字数枚数	合計数	一枚の総字数	字母總数	母型の深さ
四	種	築地體	12				12	176	2,112	45
五	種	築地體	12	11	2	10	35	247	8,567	45
六	種	築地體	12	11	2		25	247	6,175	36
12	P	築地體	12				12	204	2,448	45
9	P	築地體	12	11	2		25	247	6,175	36
8	P	築地體	12	11	2		25	247	6,175	36
7	P	築地體	12	11	2		25	247	6,175	30
6	P	築地體	12	10			22	247	5,434	25
9	Pルビ付	築地體	12	16			30	288	8,640	36
8	Pルビ付	築地體	12	12			24	325	7,800	36
7	Pルビ付	築地體	12	16			28	276	7,728	30
9.5	P	築地體	12				12	216	2,592	45
四	種	秀英體	12	20			32	176	6,632	45
五	種	秀英體	12	11	2	10	35	247	8,567	45
六	種	秀英體	12	11	2		25	247	6,175	36
12	P	秀英體	12	16			28	204	5,712	45
9	P	秀英體	12	11	2	10	35	247	8,567	36
新 9	P	秀英體	12	12			24	247	5,928	36
8	P	秀英體	12	12	2		26	247	6,422	36
7.5	P	秀英體	12	11	2	8	33	247	8,047	36
9	Pルビ付	秀英體	16	1.5			31	247	7,657	36
8	Pルビ付	秀英體	16				16	247	3,952	36
7.5	Pルビ付	秀英體	12	12			24	325	7,800	36
四	種	ゴシック	12	8			20	176	3,520	45
五	種	ゴシック	12	3			15	247	3,705	45
六	種	ゴシック	12	3			15	247	3,705	36
12	P	ゴシック	18				18	204	3,672	45
9	P	ゴシック	12	3			15	247	3,705	36
五	種	タイフ	12	11	2	10	35	247	8,645	45
六	種	タイフ	28				28	225	6,300	36
七	種	タイフ	17				17	225	3,825	20
9	P	タイフ	28				28	225	6,300	36
8.7	P	タイフ	25				25	225	5,625	30
6.7	Pルビ付	タイフ	35				35	225	7,875	30
4.5	P	タイフ	2				2	225	450	20
六	種	ゴシック	12	3			15	247	3,705	36
6.7	P	ゴシック	17				17	225	3,825	30

文字鑄型

大きさの異なる各ポイント及明朝各號の活字鑄造の際は此の文字鑄型を取換へればよいのです。取付は全く機械的に設計してありますから調整試験鑄込等に苦しい事は絶対にありません。

一個の文字鑄型で丸字ルビ一付約物等の鑄込が容易に出来ます。

込物鑄型

取付及使用方法は全く文字鑄型の場合と同じであります。一ヶの込物鑄型はスペース四分より二分迄、クワダ全角より倍物まで鑄造自在であります。文字鑄型と同様水冷装置は完備致して居ります。

單母型装置

弊社製高級單母型又はトムソン單母型等の細く上り下り、寄り引きの正確なものは圖の細く鋼製チャックに挿入し、其の儘使用すれば絶対に寄り引きのない活字が鑄造出来ます。

一般の單母型を使用する場合は微細に行ひ得る矯正装置に依り正しい活字が得られます。

集合母型装置

特許集合母型の場合は單母型装置の代りに本装置を使用するのであります。上り下り、寄り引きは特殊ラック機構に依り自動的に調整出来る様になつて居ります且取付は二本の螺子で締めつけるだけで結構であります。

文字鑄型

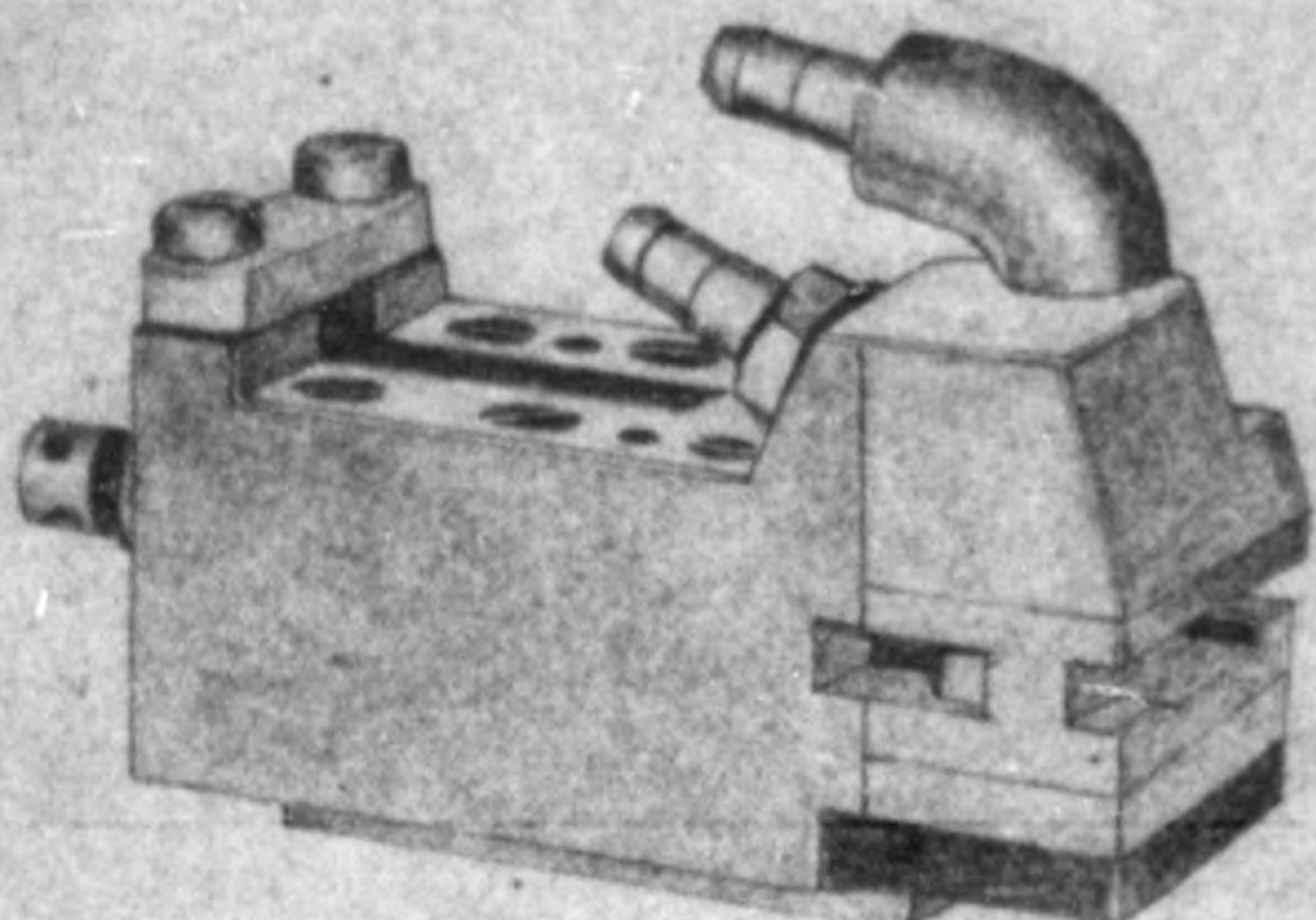

込物鑄型

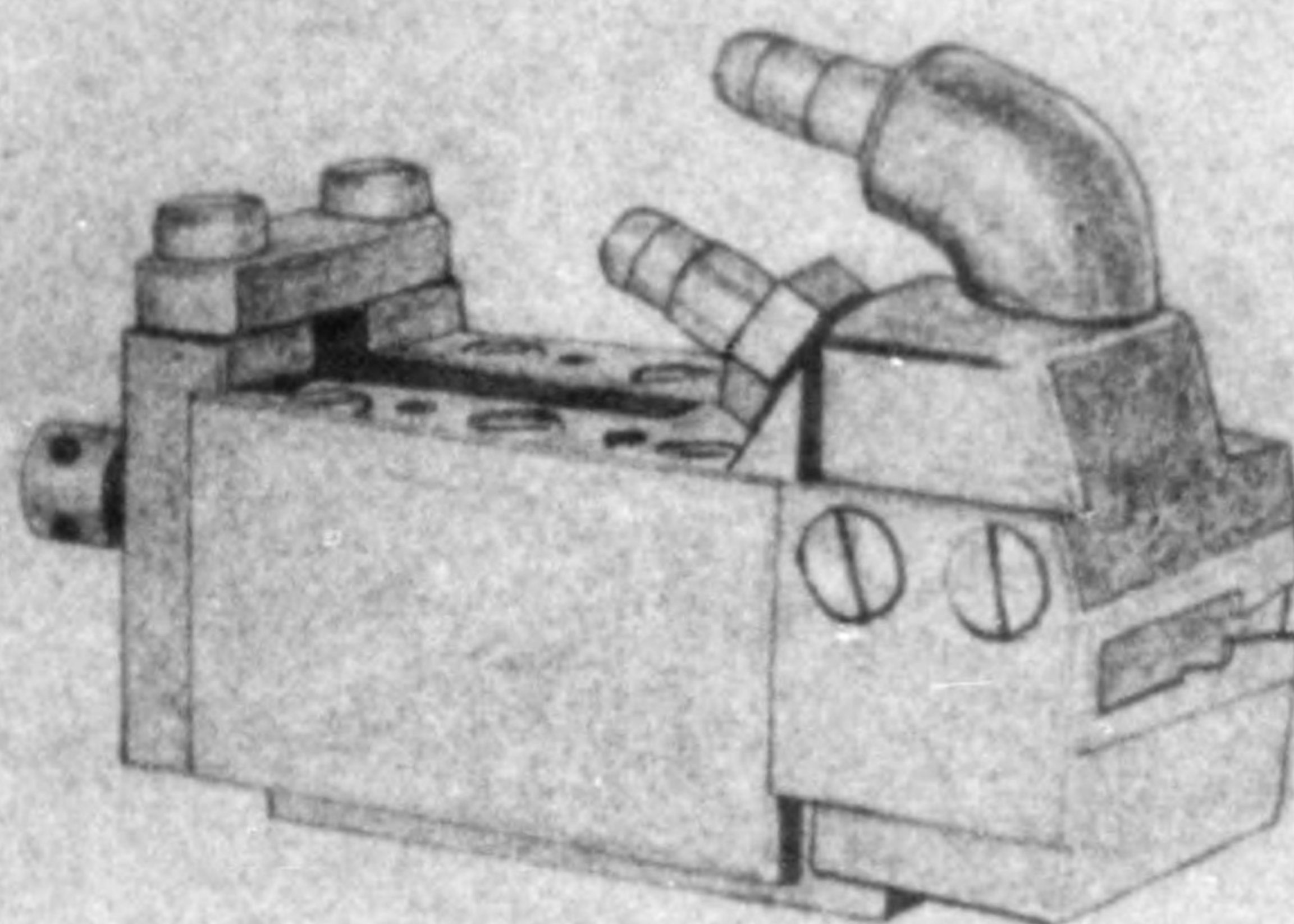

單母型裝置

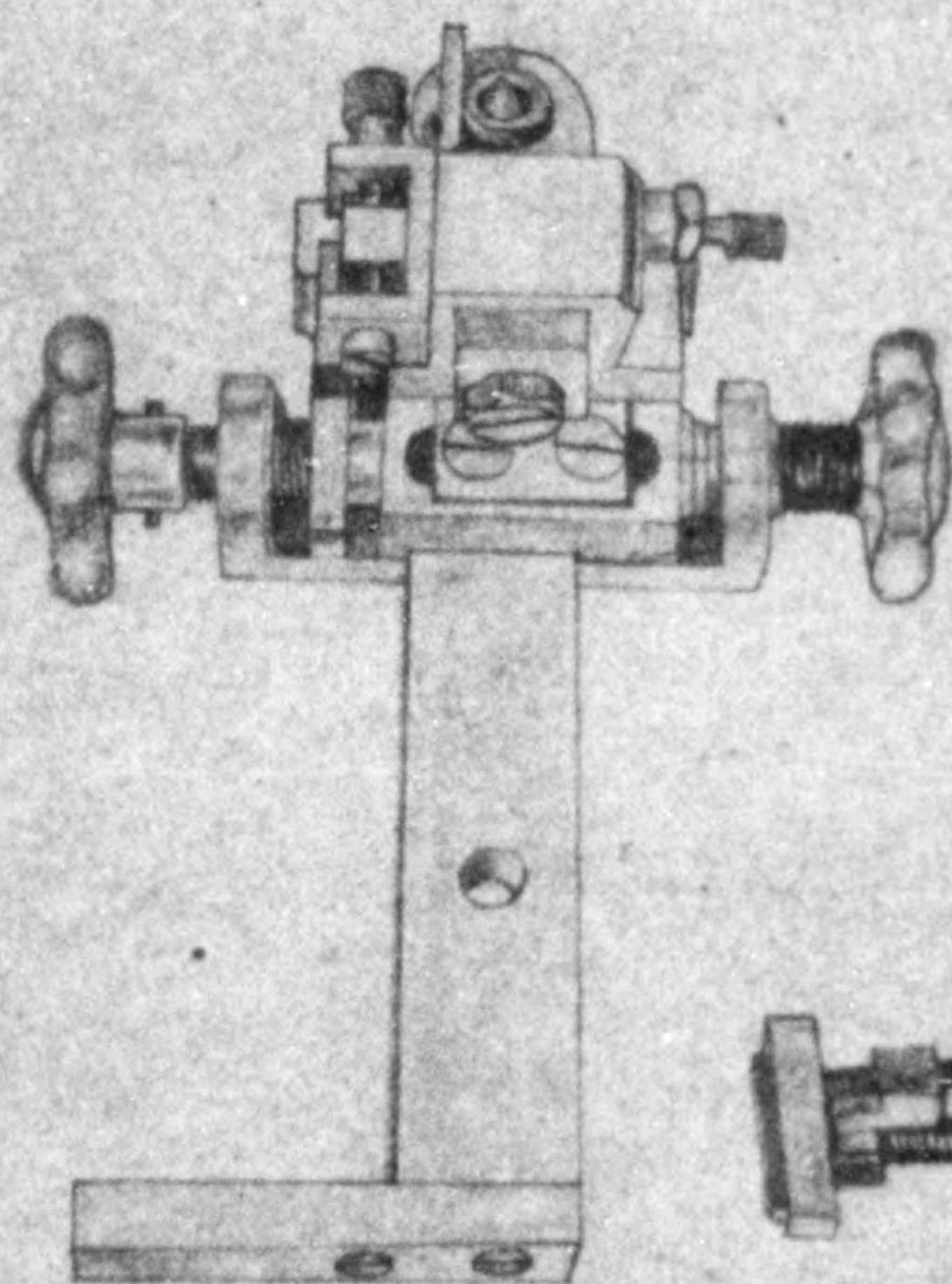

集合母型裝置

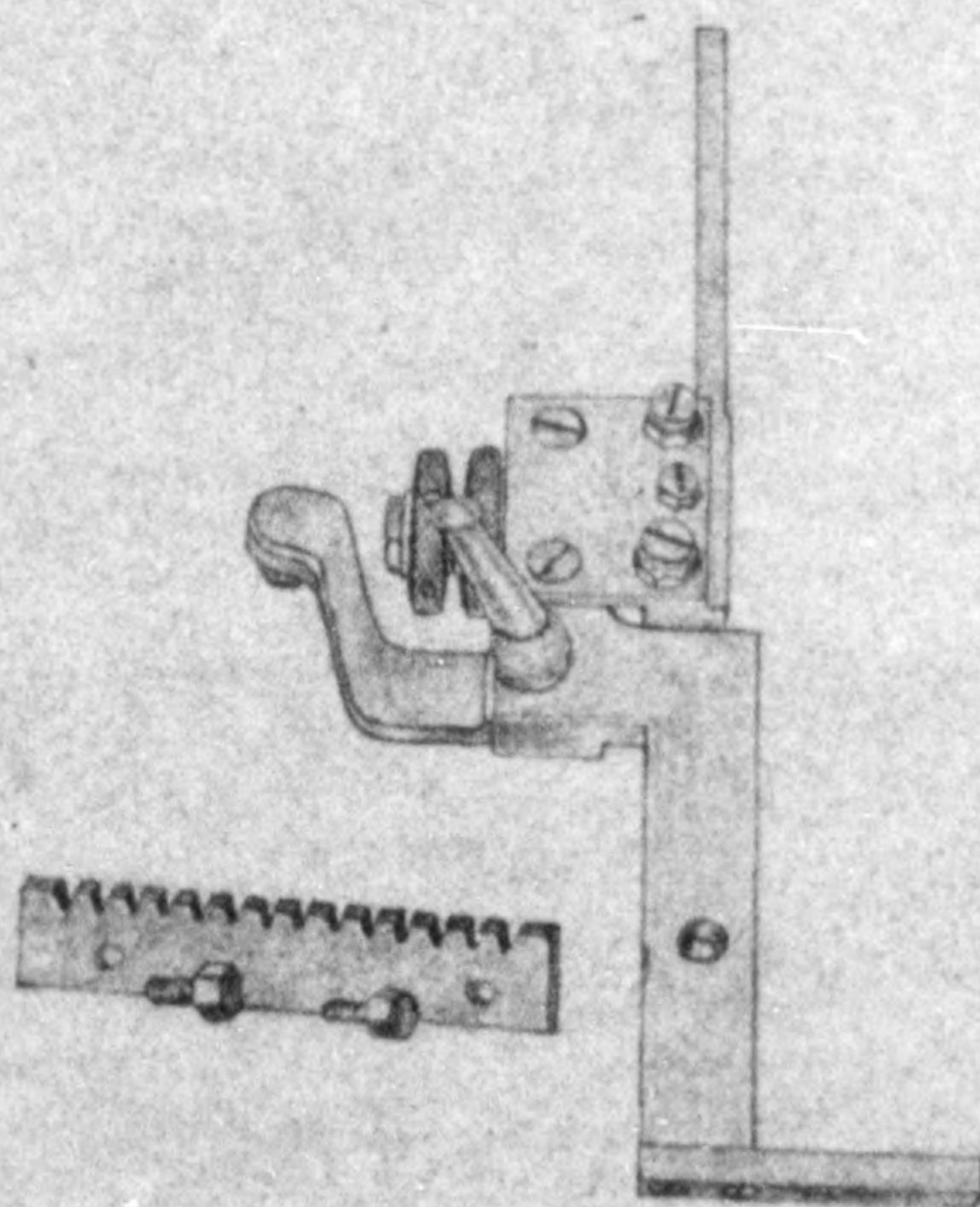

萬能鑄造機の据付方

1 場所の選定

瓦斯及び水道栓に成る可く近い所が便利で。

動力は普通電燈線を利用しますから電燈工事の成る可く完備した場所を御選び下さい。

造活字の運搬上又鑄場に近い所が便利で。

機械全體に間接光線が入れば理想的ですが若し一方より採光する場合は機械の正面より採光する様に据付けるのが能率的であります。

2 面積

機械のベースは二尺に二尺五寸ですから鑄造工が、注油クリーニング等の作業に差支ない程度の餘地を機械の周圍に残し其他又撰箱及地金置場等共約一坪の面積で足ります。

3 据付方

機械の振動及其れに依つて生ずる騒音等を除く爲めコンクリート又は木材蓋（五寸角物）にて機械ベースを床に固定するのが理想的です。

御註文要項

萬能鑄造機の御註文には是非次の諸項を御指定願ひます

- 1 鑄型は何ポイント又は何號用の文字又は込物鑄型と御指定下さい
- 2 貴所で御使用活字の規格に合はす爲に見本活字を一種類五六本位御送り下さい。
- 3 貴所御持合せの單母型を御使用になる場合は見本單母型を一種類三本位御送り下さい。
- 4 地金溶解は普通瓦斯を使用する設計になつて居りますが特にガソリン又は電力の使用を希望の場合はその旨を御通知賜度尙電力の場合に限り下記事項御通知下さい。
 - (イ) 直流の場合の電壓（ボルト）
 - (ロ) 交流の場合の電壓（ボルト）及周波數（サイクル）
 三相又は單相の別
- 5 電動機（モーター）は前項電力使用の場合と同事項につき御知らせ下さい。
- 6 集合母型を御使用の場合は本社標準盤以外の特殊配列集合母型の御註文にも關じます。

京都工作機械株式會社

本社工場

京都市下京區吉野院落台町一〇三

電話下 ☉	{	988
		1577
		4410

九條工場

京都市下京區西九條大圓町六〇

電話下 ☉	{	2160
		5492

66

No. 1

KYOTO KOSAKU KIKAI KABUSHIKI KAISHA

103, Ochiai-cho, Kisshoin, Shimokyo-ku, Kyoto-city

Sept. , 1947

To: Major H.C. Sheffield,
Commanding Officer of Kyoto M.G.T.

SUBJECT: Installing new machines in a reparation plant.

We beg to report you that we are going to install non-reparation machines in Juzo Plant as follows, moving them from Kujo Plant of our company.

We are now manufacturing type-casters under your recon-version permit and it is necessary for us to have the following machines.

Details of the machines

1. Bench drilling machine (individual motor $\frac{1}{4}$ H.P.)
 Manufacturer's name : **Kyokuto Kozai K.K.**
 Country manufactured in : Japan
 Condition : Possible to use
 Type : B.D.
 Capacity : 10 m/m
 Weight : 60 kgs
 Length : 650 m/m
 Width : 300m/m
 Height : 800 m/m
2. Bench drilling machine (individual motor $\frac{1}{4}$ H.P.)
 Manufacturer's name : Unknown
 Country manufactured in : Japan
 Condition : Possible to use
 Type : G.K.S.
 Capacity : 15 m/m
 Weight : 80 kgs
 Length : 650 m/m
 Width : 350 m/m
 Height : 1000 m/m
3. Bench drilling machine (individual motor I H.P.)
 Manufacturer's name : unknown
 Country manufactured in : Japan
 Condition : Possible to use
 Type : Unknown

~~48~~ #7

Capacity : 10 m/m
Weight : 100 kgs
Length : 500 m/m
Width : 700 m/m
Height : 700 m/m

4. Cutting tool grinder (individual motor $\frac{1}{4}$ H.P.)
Manufacturer's name : Unknown
Country manufactured in : Japan
Condition : Possible to use
Type : Unknown
Capacity : 1000 R.P.M.
Diameter of the grinding-stone
120 m/m
Weight : 25 kgs
Length : 250 m/m
Width : 350 m/m
Height : 300 m/m

Managing Director

J. Enmei

*File
glc*

JPN2-6280

44

KIKAI
KYOTO KOSAKU KABUSHIKI KAISHA
103 Ochiaicho, Kisshoin, Shimokyo-ku
Kyoto-City

July 25, 1947

TO : The Commander of 8th Army.
SUBJECT: Petition for release of P.D. for
Galvanized Sheet iron.

Procurement Demand for 100 sheets of galvanized sheet iron in our factory has been issued by Headquarters, 8th Army.

The above sheet iron is absolutely necessary for repair of many leaks in the roofs of our factory in which the reparation machines are stored. As galvanized sheet iron is very difficult to obtain in the market at present, we cannot repair the leaks, if the above item is taken away. At the same time we feel much difficulty in keeping the reparation machines very well.

We shall be very glad, if you'll take the above into your kind consideration and favour us with release of P.D.

Managing Director

J. Ummei

P.S.

The above materials will be safely kept at our works until we get further instruction from 8th Army.

J. U.

*6.

Min file

41

HEADQUARTERS I CORPS
APO 301 (Kyoto, Honshu)

EHN/af

AG 333 - BA

19 JUL 1947

SUBJECT: Inspection Report

TO : Commanding Officer
Kyoto Military Government Team
APO 713

1. Following extract from a report made by a field representative of SCAP is forwarded for your information and necessary corrective action:

"2. a. Kyoto Kosaku (Jujo Plant) - Kyoto-Ken - Code No. 22-44

This plant is listed in the catalog as number 25 and all data given therein is correct, except that pertaining to present state of maintenance and amount of serviceable equipment. Maintenance at present is not too good, machinery being dirty and too little lubrication present. The following catalog inaccuracies were noted and should be corrected to read: Boring machines - 3; Drilling machines - 23; Gear cutting and finishing machines - 6; Grinding machines - 21; Lathes - 59; Milling machines - 30; Planers - 7; Transformers - 8.

"b. Shimazu Seisakusho KK (Terada Plant) - Kyoto Prefecture - Code No. 22-53

The above plant, located approximately 7 miles from Kyoto, is listed in the catalog as number 68. This plant did not produce any machine tools, as it was still in the process of assembly when the war ended. Machines belonging to this plant are comparatively new and of good quality, but at present are extremely dirty and according to information obtained at the plant, have not had any maintenance in the last 8 months. The present plans of the prefecture, and with approval of Military Government, are to use the buildings and surrounding factory area as a repatriation center. The two center sections of the main building are composed of structural steel in excellent condition, with two traveling cranes running the length of the building. This center section including supporting members for cranes will be of unquestionable value to a claimant nation. At present approximately half (55 machines) of the equipment formerly at this plant (Terada) has been moved to the Sango plant of Shimazu Seisakusho about 7 miles away and scattered throughout this installation, making their location difficult for inspections by R & R delegations. The above mentioned equipment, as is the remaining equipment

54239

5

Ltr, Hq I Corps, subj: "Inspection Report", dtd 19 JUL 1947 cont'd.

at the Terada plant, is well below the accepted standards of maintenance. Equipment belonging to Terada is as follows: Boring - 5; Drilling - 7; Gear cutting and finishing - 10; Grinding - 9; Lathes - 53; Milling - 7; Planers - 1; Miscellaneous machine tools - 8; and Cranes - 2."

BY COMMAND OF MAJOR GENERAL WOODRUFF:

H. B. Taylor
H. B. TAYLOR
MAJOR, A.S.D.
ASST. ADJ. GEN.

Mix
Misc
File

~~4/4~~

- TRANSLATION -

13

May

1947

FROM; Osaka Financial Bureau, Former Maizuru Naval Arsenal Administration Dept.

TO : Kyoto Mil. Gov't. Team, Maizuru Detachment

Subject: Give notice to Toyama Financial Bureau for revise of these 2 Inventory Sheets

1. These 2 Inventory Sheets had been made by Toyama Financial Bureau and submitted to Toyama MGT.
2. These Inventory Sheet's Number was informed to Toyama Financial Bureau from this Office by the inquiry of Toyama F.B. And this matter was granted by KMGT at this time.
3. Therefore these sheets should be revised by Toyama F.B. and these location of machines are not able to know by this Office.
I ask you to send these sheets to Toyama F.B.

Capt Commons.

The finance ministry has asked in this letter that these sheets be processed through Toyama Finance Bureau, could you send these out to them via Toyama Mil Gov.

Lt Stallo

舞廠監第六號ノ四四

昭和二十二年五月十三日

京都軍政部舞鶴分遣隊 御中

大阪財務局舞鶴海軍工廠監理部



登録票移牒の件

首題の件左記の通りにつき可然御取計ひ下さい

記

- (一) 本登録票は富山管財支所が調製し富山軍政部へ提出したものである
- (二) 登録番號は富山軍政部が元工廠の親工場番號を買ふやう富山管財支所に指示され同支所より當部へ照會があつたので京都軍政部へ申請して²²1²⁴(1)親番號を通知したものである
- (三) 本件は富山軍政部へ移牒し再調査されるのを適當と思料する

(終)

*File
Inventory
of machinery
44, 53*

KYOTO MILITARY GOVERNMENT TEAM
APO 713 (Kyoto, Honshu)

ELC/ys

14 April 1947

SUBJECT: Inventory for Machine-Tool, Ball and Roller Bearing
Plants

TO : Commanding General, HQ Eighth Army, APO 345
(Yokohama, Honshu)

1. Compliance to Ltr, HQ I Corps, subj: "Same as above", dtd
10 Feb. 47, inventories for the following plants are submitted:

- a. Kyoto Koseku Kikai K.K., Jujo Kojo
- b. Shimazu Seisakusho, Terada Kojo

2. Request that previously submitted sheets of Kyoto Koseku
Kikai be deleted from your files.

FOR THE COMMANDING OFFICER:

THOMAS R HARBIN
1st Lt., Inf.
Adjutant

2 Incl:
As mentioned above.

H

INVENTORY FORM FOR MACHINE TOOL AND
BALL AND ROLLER BEARING PLANTSDATE 10, March, 1947.Name of Company Japan Related SCAPIN # 1133Name of Plant Kyōto Kōsakukikai K.K. Code # 44Address of Plant 103, Ochiai-chō, Kisshōin, Shimokvō-ku, Kyōto.Number Talled1. METAL WORKING MACHINESA. MACHINE TOOLS186

1. Boring machines	<u>3</u>	<u>177</u>
2. Broaching machines	<u>0</u>	
3. Drilling machines	<u>23</u>	
4. Gear cutting and finishing machines	<u>6</u>	
5. Grinding machines	<u>21</u>	
6. Lathes	<u>59</u>	
7. Milling machines	<u>30</u>	
8. Planers	<u>7</u>	
9. Miscellaneous machine tools	<u>28</u>	

B. SECONDARY METAL FORMING AND SHAPING MACHINES AND EQUIPMENT

1. Bending machines	<u>0</u>	<u>2</u>
2. Hydraulic presses	<u>0</u>	
3. Manual presses	<u>0</u>	
4. Mechanical presses	<u>0</u>	

INVENTORY FORM FOR MACHINE TOOL AND
BALL AND ROLLER BEARING PLANTSDATE 10, March, 1947.Name of Company Japan Related SCFIN # 1133Name of Plant Kyōto Kōsakukikai K.K. Code # 44Address of Plant 103, Ochiai-chō, Kisshōin, Simokyō-ku, Kyōto.

Number Tallied

B. SECONDARY METAL FORMING AND SHAPING MACHINES AND EQUIPMENT (cont'd)

5. Shearing and punching machines	<u>0</u>
6. Forging machinery	<u>2</u>
7. Wire forming machines	<u>0</u>
8. Miscellaneous	<u>0</u>
9. Other metal working machinery and equipment	<u>0</u>

C. MISCELLANEOUS METAL WORKING EQUIPMENT

1. Welding machines, all types	<u>1</u>
2. Testing and measuring machines, all types	<u>0</u>
3. Miscellaneous physical property testing	<u>0</u>
4. Heat treating equipment	<u>6</u>
5. Portable metal working machines	<u>0</u>

II. ELECTRIC L. MACHINERY AND APPARATUS18A. ELECTRIC L. ROTATING EQUIPMENT6

1. Generators	<u>0</u>
2. Motors (5 HP and over)	<u>6</u>

INVENTORY FORM FOR MACHINE TOOL AND
BALL AND ROLLER BEARING PLANTSDATE 10, March, 1947.Name of Company Japan Related SCLPIN # 1133Name of Plant Kyōto Kōsakukikai K.K. Code # 44Address of Plant 103, Ochiai-chō, Kisshōin, Shimokyō-ku, Kyōto.Number TalledA. ELECTRICAL ROTATING EQUIPMENT (cont'd)

3. Motor Generators	<u>0</u>
4. Frequency changers	<u>0</u>
5. Converters and inverters	<u>0</u>
6. Generator sets (Direct coupled to prime mover)	<u>0</u>

B. PRIMARY ELECTRIC POWER TRANSMISSION AND DISTRIBUTION EQUIPMENT

1. Transformers	<u>8</u>
2. Switch	<u>4</u>

12III. GENERAL PURPOSE INDUSTRIAL MACHINERY AND EQUIPMENT1A. ENGINES AND TURBINES

1. Steam Engines	<u>0</u>
2. Steam Turbines	<u>0</u>
3. Internal Combustion Engines	<u>0</u>

0B. COMPRESSORS AND PUMPS

1. Compressors and Dry Vacuum Pumps	<u>0</u>
2. Pumps	<u>1</u>

1C. MISCELLANEOUS MACHINERY AND EQUIPMENT

1. Power Boilers	<u>0</u>
2. Cranes	<u>0</u>

0

INVENTORY FORM FOR MACHINE TOOL AND
BALL AND ROLLER BEARING PLANTS

DATE 5 MAR. 1947

Name of Company KABUSHIKAISSHA SHIMADZU S ELSAKUSHO Related SCAFIN # 1499

Name of Plant TERADA KOJO Code # 53

Address of Plant 51, OAZA TERADA KOAZA HAYASHINOKUCHI, TERADA-MURA, KUZE-GUN, KYOTO-FU

Number Talled

1. METAL WORKING MACHINES

A. MACHINE TOOLS

100

- | | | |
|--|-----------|------------|
| 1. Boring machines | <u>5</u> | <u>100</u> |
| 2. Broaching machines | <u>0</u> | |
| 3. Drilling machines | <u>7</u> | |
| 4. Gear cutting and finishing machines | <u>10</u> | |
| 5. Grinding machines | <u>9</u> | |
| 6. Lathes | <u>53</u> | |
| 7. Milling machines | <u>7</u> | |
| 8. Planers | <u>1</u> | |
| 9. Miscellaneous machine tools | <u>8</u> | |

B. SECONDARY METAL FORMING AND SHAPING MACHINES AND EQUIPMENT

- | | | |
|-----------------------|----------|----------|
| 1. Bending machines | <u>0</u> | <u>0</u> |
| 2. Hydraulic presses | <u>0</u> | |
| 3. Manual presses | <u>0</u> | |
| 4. Mechanical presses | <u>0</u> | |

INVENTORY FORM FOR MACHINE TOOL AND
BALL AND ROLLER BEARING PLANTS

DATE 5 MAR. 1947

Name of Company KABUSHIKIKAISHA SHIMADZU SEISAKUSHO Related SCAPIN # 1499

Name of Plant TERADA KOJO Code # 53

Address of Plant 51 OAZA TERADA KOZA HAYASHINOKUCHI, TERADA-MURA, KUZE-GUN, KYOTO-FU

Number Tallied

B. SECONDARY METAL FORMING AND SHAPING MACHINES AND EQUIPMENT (cont'd)

- 5. Shearing and punching machines 0
- 6. Forging machinery 0
- 7. Wire forming machines 0
- 8. Miscellaneous 0
- 9. Other metal working machinery and equipment 0

C. MISCELLANEOUS METAL WORKING EQUIPMENT

- 1. Welding machines, all types 0
- 2. Testing and measuring machines, all types 0
- 3. Miscellaneous physical property testing 0
- 4. Heat treating equipment 0
- 5. Portable metal working machines 0

II. ELECTRIC L MACHINERY AND APPARATUS

A. ELECTRIC L ROTATING EQUIPMENT

- 1. Generators 0
- 2. Motors (5 HP and over) 0

775013

INVENTORY FORM FOR MACHINE TOOL AND BALL AND ROLLER BEARING PLANTS

DATE 5 MAR. 1947

Name of Company KABUSHIKI KAISHA SHIMADZU SEISAKUSHO Related S.S. PIN # 1499

Name of Plant TERADA KOJO Code # 53

Address of Plant 5, OAZA TERADA KOAZA HAYASHI NOKUCHI, TERADA MURA, KURE-GUN, KYOTO-FU

Number Talled

A. ELECTRICAL ROTATING EQUIPMENT (cont'd)

- 3. Motor Generators 0
- 4. Frequency changers 0
- 5. Converters and inverters 0
- 6. Generator sets (Direct coupled to prime mover) 0

B. PRIMARY ELECTRIC POWER TRANSMISSION AND DISTRIBUTION EQUIPMENT 0

- 1. Transformers 0
- 2. Switch 0

III. GENERAL PURPOSE INDUSTRIAL MACHINERY AND EQUIPMENT 2

A. ENGINES AND TURBINES 0 0

- 1. Steam Engines 0
- 2. Steam Turbines 0
- 3. Internal Combustion Engines 0

B. COMPRESSORS AND PUMPS 0

- 1. Compressors and Dry Vacuum Pumps 0
- 2. Pumps 0

C. MISCELLANEOUS LIGHTING AND EQUIPMENT 2

- 1. Power Boilers 0
- 2. Cranes 2

4-4-53
HEADQUARTERS I CORPS
APO 301 (Kyoto, Honshu)

EHN/jyn

AG 004(Rep) - BA

11 APR 1947

SUBJECT: Completion of Machine Tool and Precision Bearing
Plant Inventories

TO : Commanding Officer, Kyoto Military Government
Team, APO 713

1. Reference: letter, Headquarters I Corps, AG 004(Rep)-
BA, subject: "Inventory Instructions for Machine Tool and
Ball and Roller Bearing Plants," dated 10 February 1947.
Inventories of the following machine tool plants have not
been received:

- a. Kyoto Kosaku Kikai KK (22-44)
- b. Shimazu Seisakusho KK, Terada Kojo (22-53)

2. Information is desired as to the expected completion
date of inventory of subject plants.

BY COMMAND OF MAJOR GENERAL WOODRUFF:

H. B. TAYLOR
MAJOR, A.S.D.
ASST. ADJ. GEN.

*Inventory
of
machines 44/57*

BASIC: Ltr, Hq I Corps, subj: "Completion of Machine Tool and Precision Bearing Plant Inventories," dtd 11 Apr. 1947.

1st Ind

ELC/ys

Hq Kyoto Military Government Team, APO 718 (Kyoto, Honshu) 17 April 1947

TO: Commanding General, Hq I Corps, APO 301
Attn: Mil Govt, Res & Ind Section

Inventories referred to in basic communication were completed and forwarded from this office on 14 April 47.

FOR THE COMMANDING OFFICER:

THOMAS R HARBIN
1st Lt., Inf.
Adjutant

File
EM

(146)

Kyōto Machine Tool Manufacturing
Co, Ltd, Jūjyō Plant.
103, Ochiai-chō, Kisshōin,
Shimokyō-ku Kyōto City.

- I. Chief Products of War
Parts of aircraft
2. Chief Products of Present
 - A. Japanese and Chinese Typewriter
 - B. English Typewriter
 - C. Type Caster
 - D. Printing Machine
 - E. Tramcar Parts
 - F. Small Marine Engines
3. Number of Inventory Sheet ----- 207
4. A class ----- 50%
B class ----- 42%
C class ----- 8%
5. Number of Employees ----- 125

Junsaku Emmei
Director & President
Kyōto Machine Tool Mfg, Co, Ltd.

J. Emmei

The Report of The Permitted Reconversion
from War Production and Resumption of
Production of Essential Civil Commodities.

Date: 31 December, 1946.

To: The Commanding General, I Corps Headquarters, Kyōto.

From: J. Emmei,
The President of Managers,
The Kyōto Machine Tool Manufacturing Co., Ltd.,
103 Ochiai-cho, Kisshōin, Shimokyō-ku, Kyōto.

Name of Firm: Head (Jūjū) Plant & Kujō Plant,
The Kyōto Machine Tool Manufacturing Co., Ltd.
(Kyōto Kōsaku Kikai Kabushiki Kaisha,
Honsha (Jūjū) Kōjō & Kujō Kōjō.)

京都工作機械株式會社 本社(十條)工場・九條工場

No. of Permit: MG 52.

1. The Name & Type of Products.

<u>Name of Products</u>	<u>Type</u>
A. Japanese & Chinese Typewriter.	Universal Type, Type No.30.
B. English Typewriter.	
C. Type Caster.	Universal Type, Tompson Type.
D. Printing Machine.	Two Revolution Cylinder Press with Automatic Feeder. Size - Octavo.
E. Tramear Parts.	
F. Small Marine Engine.	25 Horse Power, Burning Combustible Engine, 10 HP Diesel Engine.

2. The Quantity of Products in Each Factory (Monthly).

The Name of Products	Quantity or Price		Notes
	Juho Plant	Kujo Plant	
Japanese & Chinese Typewriter	Typewriter Parts 1,500 (¥30,000.00)	None	Under work. 95%.
English Typewriter	None	None	Under planning
Type Caster	Repair 5 (¥75,000.00) Newly made 2 (¥100,000.00)	Repair 2 (¥30,000.00) Newly made 2 (¥100,000.00)	
Printing Machine	None	Parts, under work.	Under work.
Tramcar Parts	Bolts 300 & others. Total price (¥50,000.00)	Bolts 300 & others. Total price (¥50,000.00)	
Small Marine Engine	None	Parts (¥60,000.00)	Under work.

3. The Quantity of Products in the Subsidiary Factory
(Monthly).

None.

4. The Quantity of Products in the Sub-Contractor Factories (Monthly).

<u>Name of Factories</u>		<u>Quantity or Price</u>	<u>Notes</u>
Amanogawa Seisakusho	Japanese typewriter Almighty type	Typewriter parts 10,000	Under work, 95%
Ōtori Kikō K.K.	"	Typewriter parts 10,000	Under work treating iron plates 100%.
Taiyō Sangyō K.K.	Tramcar parts	None	Under work
Asahi Zōki K.K.	"	None	Under work
Noguchi Tekkōsho	"	None	Under work

The Report of The Permitted Reconversion
from War Production and Resumption of
Production of Essential Civil Commodities.

Date: 22 30 November, 1946.

To: The Commanding General, I Corps Headquarters, Kyōto.

From: J. Emmei,
The President of Managers.
The Kyōto Machine Tool Manufacturing Co., Ltd.
103, Ochiaichō, Kisshōin, Shimokyō-ku, Kyōto.

Name of Firm: Head (Jūjō) Plant & Kujō Plant,
The Kyōto Machine Tool Manufacturing Co., Ltd.
(Kyōto Kōsaku Kikai Kabushiki Kaisha,
Honsha (Jūjō) Kōjō & Kujō Kōjō.)

京都I作機株式会社 本社(十條)工場・九條工場

No. of Permit: MG 52.

1. The Name and Type of Products.

<u>Name of Products</u>	<u>Type</u>
A. Japanese & Chinese Typewriter.	Universal Type. Type No. 30.
B. English Typewriter.	
C. Type Caster.	Universal Type. Tompson Type.
D. Printing Machine.	Two Revolution Cylinder Press with Automatic Feeder. Size - Octavo.
E. Tractor Parts.	
F. Small Marine Engine.	25 Horse Power, Burning Combustible Engine, 10 HP Diesel Engine.

2. The Quantity of Products in Each Factory X (Monthly).

The Name of Products	Quantity or Price		Notes
	Jūjō Plant	Kujō Plant	
Japanese & Chinese Typewriter	Typewriter Parts 1,500 (¥30,000.00)	None.	Under work, 95%.
English Typewriter	None.	None.	Under planning.
Type Caster	Repair 5 (¥75,000.00) Newly designed parts, under work 60%.	Repair 2 (¥30,000.00) Newly designed parts, under work 55%.	
Printing Machine	None.	Repair 1 (¥100,000.00)	Under work.
Tramcar Parts	Bolts 500 Amateur shafts 10 sets & Others. (¥30,000.00 Total)	Bolts 200 Amateur shafts 30 & Others. (¥50,000.00 Total)	
Small Marine Engine	None.	Parts (¥5,000.00)	Under work.

3. The Quantity of Products in the Subsidiary Factory (Monthly).

None.

4. The Quantity of Products in the Sub-Contractor Factories.
(Monthly)

<u>Name of Factories</u>	<u>Quantity or Price</u>	<u>Notes</u>
Amanogawa Seisakusho	Japanese Typewriter Almighty Type. Typewriter parts 10,000	Under work, 95%.
Ōtori Kikō Kabushiki Kaisha	Japanese Typewriter Almighty Type. Typewriter parts 10,000	Under work treating iron plates 100%.
Taiyō Sangyō Kabushiki Kaisha	Tramcar parts	None Under work.
Asahi Zōki K.K.	Tramcar parts	None Under work.
Noguchi Tekkōsho	Tramcar parts	Amateur shafts 10 (¥7,600.00) Under work.

The Report ^{of} The Permitted Reconversion
From War Production and Resumption of
Production of Essential Civil Commodities.

Date: 31 October, 1946.

To: The Commanding General, I Corps Headquarters, Kyōto.

From: J. Emmel, The President of Managers.
The Kyōto Machine Tool Manufacturing Co., Ltd.
103, Ochiaichō, Kisshōin, Shimokyō-ku, Kyōto.

Name of Firm: Jūjō Plant & Kujō Plant,
The Kyōto Machine Tool Manufacturing Co., Ltd.
(Kyōto Kōsaku Kikai Kabushiki Kaisha,
Jūjō Kōjō & Kujō Kōjō.)

京都工作機械株式会社 本社（十條工場 九條工場）

No. of Permit: MG 52.

1. The Name and Type of Products.

<u>Name of Products</u>	<u>Type</u>
A. Japanese & Chinese Typewriter.	Universal Type. Type No. 30.
B. English Typewriter	
C. Type Caster	Universal Type. Tomson Type.
D. Printing Machine	Two Revolution Cylinder Press with Automatic Feeder, Size - Octavo.
E. Tractor Parts	
F. Small Marine Engine	25 Horse Power, Burning Combustible Engine, 10 HP Diesel Engine.

2. The Quantity of Products in Each Factory (Monthly)

The Name of Products	Quantity or Price		Notes
	Jūjō Plant	Kūjō Plant	
Japanese & Chinese Typewriter	Typewriter Parts 1,000 (¥20,000.00)	None.	Under work, 95%.
English Typewriter	None.	None.	Under planning.
Type Caster	Repair 7 (¥105,500.00) Newly designed parts, under work 40%.	Newly designed parts, under work, 30%.	
Printing Machine	None.	Repair 1 (¥100,000.00)	Under work.
Tramcar Parts	Bolts 300 Gear cases 8 sets Others (¥25,000.00 Total)	Bolts 300 Amateur shafts 30 Others (¥50,000.00 Total)	
Small Marine Engine	Parts (¥5,000.00)	Parts 500 (¥50,000.00)	Under work.

3. The Quantity of Products in the Subsidiary Factory (Monthly)

None.

4. The Quantity of Products in the Sub-Contractor Factories.
(Monthly)

<u>Name of Factories</u>		<u>Quantity or Price</u>	<u>Notes</u>
Amanogawa Seisakusho	Japanese Typewriter Almighty Type.	Typewriter parts 7,000	Under work, 93%.
Ōtori Kikō Kabushiki Kaisha	Japanese Typewriter Almighty Type.	Typewriter parts 5,000	Under work treating iron plates 98%.
Taiyō Sangyō Kabushiki Kaisha	Tramcar parts	None	Under work
Asahi Zōki K.K.	Tramcar parts	None	Under work
Noguchi Tekkōsho	Tramcar parts	Amatuer shafts 10 (¥7,600.00)	Under work.

The Report of the Permit for Reconversion
from War Production and for Resumption of
Production of Essential Civilian Commodities.

Date: 30 Sept. 1946.

To: The Commanding General, I Corps Headquarters, Kyoto.

From: J. Emmei, The President of Managers,
The Kyoto Machine Tool Manufacturing Co., Ltd.
103, Ochiaichō, Kisshōin, Shimokyō-ku, Kyoto.

Name of Firm: The Kyoto Machine Tool Manufacturing Co., Ltd.
Jūjō Plant & Kūjō Plant.
(Kyōto Kōsaku Kikai Kabushiki Kaisha,
Jūjō Kōjō & Kūjō Kōjō.)
京都工作機械株式会社 本社(十條)工場・九條工場

No. of Permit: MG 52.

1. The Name and Type of Products.

<u>Name of Products</u>	<u>Type</u>
A. Japanese & Chinese Typewriter	Universal Type Type No. 30.
B. English Typewriter	
C. Type Caster	Universal Type Tomson Type.
D. Printing Machine	Two Revolution Cylinder Press with Automatic Feeder Size of Press, Octavo.
E. Tramcar Parts	
F. Small Marine Engine	25 Horse Power Burning Combustible Engine 10 HP Diesel Engine.

2. The Quantity of Products in Each Factory (monthly)

<u>The Name of Products</u>	<u>Quantity or Price</u>		<u>Note</u>
	<u>Jūjū Plant</u>	<u>Kujū Plant</u>	
Japanese & Chinese Typewriter	Typewriter Parts 1,000 (¥20,000.)	None	Under work 95%
English Typewriter	None	None	Under Planning
Type Caster	Repair 9 (¥135,000.) Newly designed parts under work, 20%	Under work 20% (Parts)	Parts for newly designed machine are under work in both plants.
Printing Machine	None	None	Under Repair.
Tramcar Parts	Bolts 400 Others ¥25,000. (Total)	Bolts 500 Amateur shafts 10 & others ¥35,000. (Total)	Under work.
Small Marine Engine	Parts 15 (¥1,000.)	Parts 900 (¥60,000.) (total)	Under work.

3. The Quantity of Products in the Subsidiary Factory (Monthly)

None.

4. The Quantity of Products In the Sub-Contractor Factories.
(Monthly)

<u>Name of Factories</u>		<u>Quantity or Price</u>	<u>Note</u>
Amanogawa Seisakusho	Japanese Typewriter Universal type	Typewriter parts 6,000	Under work 90%
Ōtori Kikō Kabushiki Kaisha	Japanese Typewriter Universal type	Typewriter Parts 5,000	Under work treating iron plates 90%
Taiyō Sangyō Kabushiki Kaisha	Tramcar Parts	None	Under work
Asahi Zōki Kabushiki Kaisha	Tramcar Parts	None	Under work
Noguchi Tekkō-sho	Tramcar Parts	Amateur Shafts 10 (¥7,600.)	Under work

The Report of the Permit for Reconversion
from War Production and for Resumption of
Production of Essential Civilian Commodities.

Date: 31 Aug. 1946

To: The Commanding General I Corps Headquarters, Kyoto.

103, Oshiai-cho, Kisshoin, Shimokyo-ku, Kyoto.
Kyoto Machine Tool Manufacturing Co. Ltd.
President of Managers: J. Emmei.



Name of Firm: Kyoto Machine Tool Manufacturing Co. Ltd.

Head Plant & Kujō Plant.

Kyoto Kogaku Kikai Kabushiki Kaisha.

Honsha Kojō & Kujō Kojō.

京都工作機株式会社 本廠工場九條工場

本社

Number of Permit: MG 52

1. The Name and Type of Products.

Name of Products	Type
A. Japanese & Chinese Typewriter	Universal Type Thirty Type
B. English Typewriter	
C. Type Caster	Universal Type Tomson Type
D. Printing Machine	Two Revolution Cylinder Press with Automatic Feeder Size of Press, Octavo.
E. Tramsar Parts	
F. Small Marine Engine	25 Horse Power Burning Combustible Engine 10 HP Diesel Engine.

2. The Quantity of Products in each Factory (monthly)

The Name of Products	Quantity or Price		Note
	Head Plant	Kaje Plant	
Japanese & Chinese Typewriter			To working-up Progress Degree 99 percent
English Typewriter			To Planning
Type Caster	Repair 9 ¥135,000.00		To Repairing
Printing Machine			To Planning with new Products
Tramcar Parts	(a) Bolts 500 Others ¥30,500.00 (total)	(a) Bolts 800 Others ¥75,000.00	To working-up
Small Marine Engine			

3. The Quantity of Products of the Subsidiary Factory (monthly)

None.

4. The Quantity of Products of the Sub-contractor Factory (monthly)

Name of Factory	Quantity or Price	Note	
Amanogawa Seisakusho	(a) Japanese Typewriter (Universal Type) (b) Tramcar Parts	(a) Typewriter Parts 6,000 (b) Belts 300 Armature Shafts 20 30000 ¥13,000.00 (total)	To working-up (90 percent)
Ōtori Kikō Kabushiki Kaisha	Japanese Typewriter (Universal Type)	Japanese Typewriter Parts (Universal Type) 5,000	To working-up of steel headed (95 %)
Taiyō Sangyō Kabushiki Kaisha	Tramcar Parts		To working-up
Asahi Zōki Kabushiki Kaisha	Tramcar Parts		To working-up
Noguchi Tekkō-sho	Tramcar Parts	Bolt-nuts 300 ¥5,000.00 (total)	To working-up

The report of the permit for reconversion
from war production and for resumption of
production of Essential Civilian Commodities.

Date: 31 July. 1946

To: The Commanding General I Corps Headquarters Kyoto,

103, Kisshoin Ochiai-cho Shimokyo-ku Kyoto.
Kyoto machine Tool manufacturing Co. Ltd,
president Of manager, J, Humei.

Name Of Firm: Kyoto machine Tool manufacturing Co. Ltd.
Head Plant & kujiyo plant.
Kyoto Kosakukikai kabushikikaisha
Honsha kujiyo & kujiyo kujiyo.
京都工作機械株式会社 本社工場 九條工場

Number Of permit: MG 52

1. The Name and Type Of products,

Name Of products	Type
A. Japanese and chinese Typewriter	Universal type Thirty type
B. English Typewriter	
C. Type caster	Universal type Tomson type
D. printing machine	Two Revolution Cylinder Press with Automatic Feeder Size Of press Full kiku
E. Tramcar parts	
F. Small maring engines	25 Force power Burning Combustible engine 10 HP Diesel engine

2. The quantity Of products in each factory (monthly)

The name Of products	quantity Or price		Note
	Head plant	Kujyo plant	
Japanese and Chinese Typewriters			To working-up progressdegree (99 percent)
English Typewriters			To planing
Type caster	Repair 6 ¥87,600.00		To Repairing
printing machine			To planning with New product
Tramcar parts	(a) Bolts 500 else ¥30,500.00 (total)	(a) Bolts 900 else ¥71,000.00 (total)	To working-up
Small maring engines			

3. The quantity Of products Of the sub sidiary Factory(monthly)

None

4. The quantity Of products Of The sub-contractor Factory
(monthly)

Name Of Factory	Quantity Or Price		Note
Manogawa Seisakusho	(a) Japanese Typewriters (Universal type)	(a) Typewriter-parts 6.000	To working-up (90 percent)
Otori kiko kabushiki kaisha	Japanese Typewriters (Universal type)	Japanese Typewriter parts (Universal type) 5.000	To working-up Of steel boadeds (pp percent)
Taiyo Sangyo kabushiki kaisha	Tramcar parts	Gear-Case 10 else 39,150.00 (total)	
Asahi zok kabushiki kaisha	Tramcar parts		To working-up
Noguchi Tekkosho	Tramcar parts		

The report Of the permit for reconversion
from war production and for resumption Of
production Of Essential Civilian Commodities.

Date' 30 June. 1946

To: The Commanding General I Corps Headquarters kyoto,

103, kisshoin Ochiai-cho Shimokyo-ku kyoto,
kyoto machine Tool manufacturing Co. Ltd,
president Of manager, J, Emmei.

Name Of Firm: Kyoto machine Tool manufacturing Co. Ltd.
Head plant & kujyo plant.
kyoto kosakukikai kabushikikaisha
Honsbu koijo & kujyo koijo.
京都工作機械株式会社 本社工場, 九條工場

Number Of permit: MG 52

1. The Name and Type Of products,

Name Of products	Type
A. Japanese and chinese Typewriter	Universal type Thirty type
B. English Typewriter	
C. Type caster	Universal type Tomson type
D. printing machine	Two Revolution Cylinder press with Automatic Feeder Size Of press Full kiku
E. Tramcar parts	
F. Small maring engines	25 Force power Burning Combustible engine 10 HP Diesel engine

2. The quantity Of products in each factory (monthly)

The name Of products	quantity Or price		Note
	Nead plant	kujyo plant	
Japanese and Chinese Typawriters			To working-up progress degree (98 percent) (universal type)
English Typewriters			To planing
Type caster	Repair 6 ¥87,600.00		To Repairing and To planning with New product (wood molding to producting)
printing machine			To planning with New product
Tramcar parts	(a) Armature shaft 50 (b) Bolts 300 else ¥41,300.00 (total)	(a) Armature shaft 10 (b) Bolts 500 else ¥12,000.00 (total)	To working-up
Small maring engines			(1) To planning (10 HP Deisel engines) (2) To Commeneing product 45 percent (15 Force power Burning Combustible engine)

3. The quantity Of products Of the sub sidiary Factory (monthly)

None

4. The quantity Of products Of the sub-contractor^Factory
(monthly)

Name Of Factory	quantity Or price		Note
Amanogawa Seisakusho	(a) Japanese Typewriters (Universal type)	(a) Typewriter-parts 6.000	To working-up (90 ^{or} percent)
Otori kiko kabushiki kaisha	Japanese Typewriters (Universal type)	Japanese Typewriter parts (Universal type) 5.000	To working Of steel boadeds (98) Percent
Tsuyo Sangyo kabushiki kaisha	Tramcar parts	Gear-Case 29 else ¥39,150.00 (total)	To working-up (60 percent)
Asahi zoki kabushiki kaisha	Tramcar parts		To working-up
Noguchi Tekkosho	Tramcar parts		To working-up

OC 23 1946

Capt Conn
F. J. Lee

ISHIKAWA
MILITARY GOVERNMENT TEAM
APO 713

18 October 1946

SUBJECT: Kyoto Kosaku Kikai K.K.

TO : Commanding Officer
Kyoto Mil Govt Team
APO 713, (Kyoto, Honshu)

1. Letter, this headquarters, subject as above, dated 17 October 1946 is forwarded for your information.
2. Inventoring of the machine belonging to subject company and located in Ishikawa-ken will be effected if and when you so desire.

FOR THE COMMANDING OFFICER:

Virgil L. Cordell
VIRGIL L. CORDELL
Captain, AC
Industry Officer

1 Incl.
As indicated

ISHIKAWA
MILITARY GOVERNMENT TEAM
APO 713

17 October 1946

SUBJECT: Kyoto Kosaku Kikai KK

TO : Commerce and Industry Section
Ishikawa Prefectural Government
Kanazawa-shi, Ishikawa-ken

THRU : Liaison Office

1. Attention is drawn to SCAPIN 1133, Memorandum to the Imperial Japanese Government, dated 13 August 1946.

2. Therein the Kyoto Kosaku Kikai KK is designated as a reparations plant. It is requested that your office inform the representative of subject company as to the procedure and requirements outlined in paragraph 3, letter, this Headquarters, subject: "Reparation Plant", dated 16 October 1946.

3. During September this year seventy-eight (78) pieces of machinery belonging to subject company, and located at No. 50, Tsurugi-machi, Ishikawa-gun, Ishikawa-ken, were inspected and found to be poorly housed and in a deteriorating condition. You are further instructed to see that the machinery is reconditioned, and that in future it is properly preserved and safely stored.

BY ORDER MAJOR, BRIDGFORD:

VIRGIL L. CORDELL
Captain, AC
Industry Officer

79
44KYOTO MILITARY GOVERNMENT TEAM
APO 713 (Kyoto, Honshu)

ELC/ys

17 March 1947

SUBJECT: Inventory of Kyoto Machine Tool Co.

TO : Commanding General, Hq I Corps, APO 301
Attn: Mil Govt, Res & Ind Section

1. The tools and equipment of Kyoto Kosaku Kikai (Kyoto Machine Tool Co), plant 22-44, were prematurely inventoried under the initial inventory instructions. This inventory, consisting of 187 sheets, was forwarded to SCAP on 18 Nov. 1946.

2. In view of the fact that this plant is now being re-inventoried under instructions in letter from your Hq., Subject, Inventory Instructions for Machine Tool and Ball and Roller Bearing Plants, dated 10 Feb. 1947, it is requested that the original inventory sheets submitted by this office be withdrawn.

FOR THE COMMANDING OFFICER:

Kincl

HQ. I CORPS

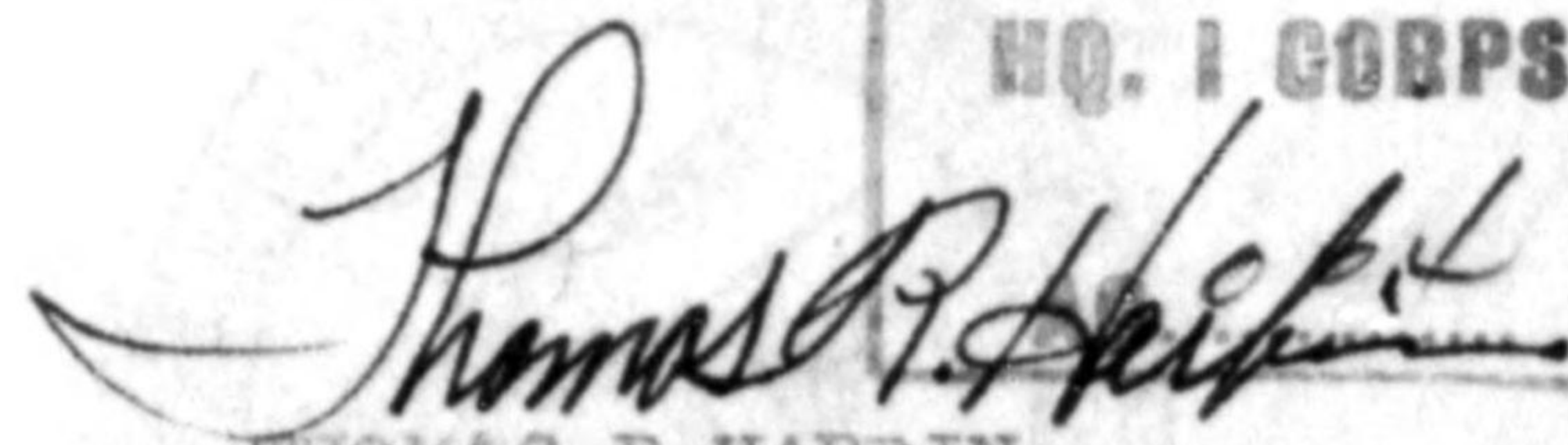
THOMAS R HARBIN
1st Lt., Inf.
Adjutant

3

38479

6568
BASIC: Ltr, Kyoto Mil Govt Team, subj: "Inventory of Kyoto Machine Tool Co.", dtd 17 Mar 47

AG 004 - BA

1st Ind

EHN/ckw

Hq I Corps, APO 301, 25 MAR 1947

TO: CG, Eighth Army, APO 343

1. The Kyoto Military Government Team erroneously inventoried the equipment of the Kyoto Kosaku Kikai KK (22-44 Mach T1) in accordance with instructions for inventory of aircraft and privately owned munitions plants. The inventory sheets (187) were forwarded directly to SCAP under date of 18 November 1946.

2. In accordance with instructions contained in letter, Headquarters Eighth Army, AG 004 (MG-Em), subject: "Inventory Instructions for Machine Tool and Ball and Roller Bearing Plants," dated 5 February 1947, the Kyoto Kosaku Kikai KK is being reinventoried on the prescribed inventory form. These inventory forms will be forwarded to your headquarters immediately upon completion of inventory. It is requested that the 187 inventory sheets referred to in paragraph 1, above, be withdrawn.

FOR THE COMMANDING GENERAL:

A. Seipel
A. SEIPEL
Lt. Col., AGD
Asst. Adj. Gen.

775013

Ltr, Kyoto Mil Govt Team, subj: "Inventory of Kyoto Machine Tool Co
dtd 17 Mar 47.

GHQ, SCAP
APR 2 1947
AGO RECORDS

AG 004 (MG-Em)

2nd Ind

1 APR 1947

Headquarters Eighth Army, APO 343

TO: Supreme Commander for the Allied Powers, APO 500
(Attention: Executive for Reparations)

It is recommended that the inventory sheets of Jujo plant of
Kyoto Kosaku 22-44 be withdrawn and the notification of withdrawal
be furnished this headquarters.

FOR THE COMMANDING GENERAL:

8

[Handwritten Signature]
R. SCHAFER
Lt. Col., AGD
Asst. Adjutant General.

55R

mg

BASIC: Ltr, Kyoto Mil Govt Team, Subj: *Inventory of Kyoto Machine Tool Co.*, dtd 17 Mar 47.

AG 387.6(17 March 47)ExRep 3d Ind

15-47

GENERAL HEADQUARTERS, SUPREME COMMANDER FOR THE ALLIED POWERS,
APO 500, 25 April 1947.

TO: Commanding General, Eighth Army, APO 343

In accordance with request in 2d indorsement, inventory sheets of the Jujo plant of Kyoto Kosaku (Code No. 22-44) have been withdrawn.

BY COMMAND OF GENERAL MacARTHUR:

W.F. Schmidt
W.F. SCHMIDT
Captain, AGD
Asst Adj Gen

Ltr, Kyoto Mil Govt Team, Subj: "Inventory of Kyoto Machine Tool Co. ", dtd 17 Mar 47.

AG 004 (MG-Em) 4th Ind

Headquarters Eighth Army, APO 343

28 APR 1947

TO: Commanding General, I Corps, APO 301

Attention is invited to the 3rd indorsement.

8

BY COMMAND OF LIEUTENANT GENERAL EICHEBERGER:

R. Schawer
R. SCHAWER
Lt. Col., A.S.D.
Asst. Adjutant General

B-MC
HQ. I CORPS
AG 004

AG 004 - BA

5th Ind

EHN/ts

Hq I Corps, APO 301, 5 MAY 1947

TO: CO, Kyoto Mil Govt Team, APO 713

Your attention is directed to 4th indorsement.

BY COMMAND OF MAJOR GENERAL WOODRUFF:

H.B. Taylor
H. B. TAYLOR
MAJOR, A.S.D.
ASST. ADJ. GEN.

8 8

22-44

KYOTO MILITARY GOVERNMENT TEAM
APO 713 (Kyoto, Honshu)

14 Feb. 1947

SUBJECT: Permission for Kyoto Kosaku Kikai K.K., Jujo Plant to Move
Reparations Machines From Ishikawa Prefecture

TO : Commanding General, Hq I Corps, APO 301 (Kyoto, Honshu)
Attn: Mil Govt, Res & Ind Section

1. Transmitted herewith is three (3) copies of the permission granted to Kyoto Kosaku Kikai K.A., Jujo Plant to move reparations machines dispersed at Ishikawa Prefecture.
2. These machines carry this prefecture's code number (22-44A) and it is felt that this movement will allow better control and maintenance.
3. Forwarded in compliance with par. 5b, OI #3 Hq I Corps, dtd 15 Feb. 1946.

FOR THE COMMANDING OFFICER:

ENOS L. COMMONS JR
Capt., Ord.
Res & Ind Officer

Incl:

Permission for movement of machinery (3cc)

KYOTO MILITARY GOVERNMENT TEAM
APO 713 (Kyoto, Honshu)

13 Feb. 1947

SUBJECT: Permission for Kyoto Kosaku Kikai K.K., Jujo Plant
to Move Reparations Machine

TO : Commanding Officer, Ishikawa Military Government Team
APO 713
Attn: Res & Ind Officer

1. Transmitted herewith is one (1) copy of the permission granted to Kyoto Kosaku Kikai K.K., Jujo Plant to move reparations machinery dispersed at Ishikawa Prefecture.

2. Forwarded in compliance with par 5b, O.I. #3, Hq I Corps, dtd 15 Feb. 1946.

FOR THE COMMANDING OFFICER:

ENOS L. COMMONS JR
Capt., Ord.
Res & Ind Officer

KYOTO MILITARY GOVERNMENT TEAM
APO 713 (Kyoto, Honshu)

14 Feb. 1947

SUBJECT: Movement of Machinery From Ishikawa Prefecture

TO : Kyoto Koseku Kikai K.K., Jujo Plant

THRU : Kyoto Liaison Office

You are authorized to move to your Jujo Plant twenty (20) reparations machine-tools as listed in attached list from your Yamagami Plant located at tsu-50, Tsuruki-machi, Ishikawa Prefecture with the understanding that adequate care will be given by test working and repairing and that the movement will not be for production purposes.

FOR THE COMMANDING OFFICER:

ENOS L. COMMONS JR
Capt., Ord.
Res & Ind Officer

Incl:
List of machine-tools to be moved (lcc)

APPLICATION FOR PERMISSION TO REMOVE MACHINES

To Kyoto Military Government,

Date:

1947

Address and Name of Applicant:

Junsaku Emmel.
 President of managers,
 The Kyōto Kōsaku Kikai Kabushiki Kaisha,
 (The Kyōto Machine Tool Manufacturing Co., Ltd.)
 103 Ochiai-chō, Kisshōin, Shimokyō-ku, Kyōto.

1. The Minute Description of Machine & Equipment:
As per annexed paper.

2. The Reason of Removal:

20 of machine tools which have been removed to Ishikawa Prefecture with the intention to use them at the Yamagami Plant of our factory, were listed as objects of indemnity and are now in the warehouse at tsu-50, Tsuruki-machi, Ishikawa Prefecture. But as the equipment of the warehouse is so incomplete that there are difficulties in charging them. So we wish to remove them to the Jujo Plant of our factory in Kyoto, where we can easily charge them in satisfactory condition with machines enlisted as objects of indemnity in that plant.

3. Use of Machines after Removal:

To keep them in the possible complete condition by test working and repairing.

4. Present Location of Machines:

Yamagami warehouse, tsu-50, Tsuruki-machi, Ishikawa-gun, Ishikawa Prefecture.

Place where Machines removed to:

Jūjō Plant, The Kyōto Machine Tool Manufacturing Co., Ltd.
 103 Ochiai-chō, Kisshōin, Shimokyō-ku, Kyōto.

Signed:

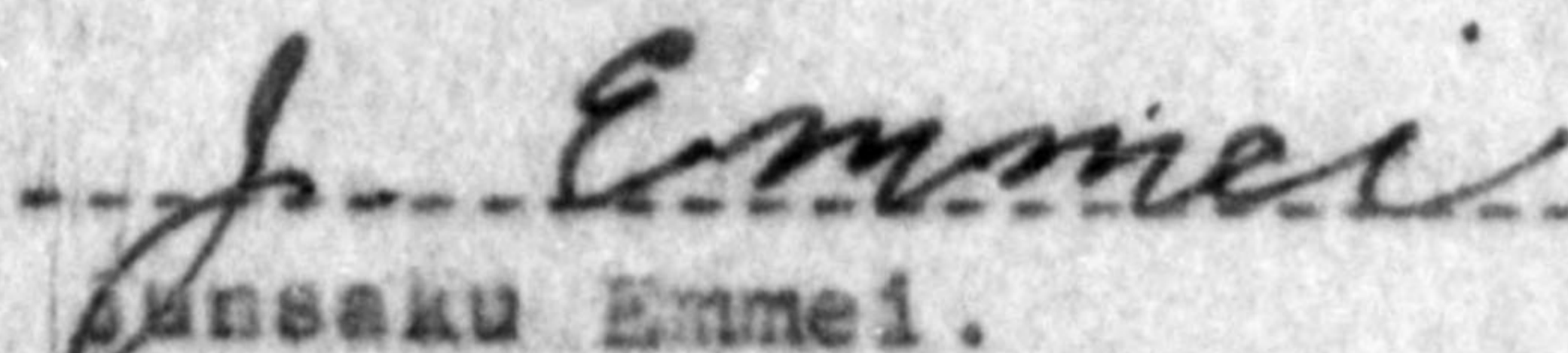

Junsaku Emmel.
 President of Managers,
 The Kyōto Machine Tool Manufacturing Co., Ltd.

MINUTE DESCRIPTION OF MACHINES AND EQUIPMENT.

<u>Name of machines</u>	<u>Number</u>	<u>Type</u>	<u>Dimensions</u>	<u>Use</u>	<u>Manufacturer</u>
Vertical milling machine	5	Motor driven DC.	No.1	Japanese, Chinese & English typewriter,	Kyōto Kōsaku Kikai Kabushiki Kaisha,
Upright drilling machine	5	"	14 mm.	Type caster,	Genko.
"	1	"	25 mm.	Tramcar parts	Daiiei Seiki K.K.
"	3	Belt Driven motor driven DC.	Under & 18 mm.	and Small marine engine.	Unknown.
Tool & cutter grinding machine	1	Motor driven DC.	240 mm.	for all machine are use	Unknown.
Cylindrical grinding machine	2	"	280 mm. & 350 mm.		Kyōto Kōsaku Kikai K.K. & Unknown.
Internal grinding machine	1	"	440 mm.		Ōtsuke Seiki K.K.
Shaping machine	2	"	300 mm. & 470 mm.		Otani Kikai Seisakusho, & Nakagawa Kikai K.K.
Total	20				

APPLICATION FOR PERMISSION TO REMOVE MACHINES.

To Kyōto Military Government Team.

Date:

1947.

Address and name of
Applicant:

Junsaku Enmei.
President of Managers.
The Kyōto Kōsaku Kikai Kabushiki Kaisha.
(The Kyōto Machine Tool Manufacturing Co., Ltd.)
103, Ochiai-chō, Kisshōin, Shimokyō-ku, Kyōto.

1. Minute Description of Machines & Equipment:

2. Reason of Removal:

Our factory is engaging in the manufacturing of the followings; (some of them repairing only)

- 1) Japanese & Chinese typewriters.
- 2) English typewriters.
- 3) Type casters.
- 4) Tramcar parts.
- 5) Small marine engines.

And the machines in question are needed to perform the work, so we apply for the removal of them to Kujo Plant.

3. Use of Machines after Removal:

For the manufacturing & Repairing of the articles stated in article No. 2.

4. Present Location of Machines:

Yamagami warehouse,
Tsu-50, Tsuruki-machi, Ishikawa-gun, Ishikawa Prefecture.

5. Place where Machines removed to:

Kujō Plant,
The Kyōto Machine Tool Manufacturing Co., Ltd.
60, Okuni-chō, Nishi-kujō, Shimokyō-ku, Kyōto.

Signed:

J. Enmei
Junsaku Enmei.
President of Managers,
The Kyōto Machine Tool Mfg.
Co., Ltd.

MINUTE DESCRIPTION OF MACHINES AND EQUIPMENT.

<u>Name of machine</u>	<u>Number</u>	<u>Type</u>	<u>Dimensions</u>	<u>Use</u>	<u>Manufacturer</u>
Lath	19	Motor driven DC.	4 ft.		Yoshida Tekkōsho & others.
"	5	"	45 ft.	Japanese, Chinese & English typewriter,	Hokuriku Kikai K.K.
"	2	"	6 ft.	Type caster,	Tōyō Jūkōgyō K.K.
"	3	Belt driven.	12 ft.	Tramcar parts, & Small marine engine,	Asahi (1) Unknown (2)
Vertical milling machine	5	Motor driven DC.	No. 1		Kyōto Kōseku Kikai K.K.
Radial drilling machine	3	"	5 ft.	All machine are use,	Minoura Jūkōgyō (2) Unknown (1)
Bench drilling machine.	1	"	10 mm.		Unknown.
Gear Shaper.	2	"	Fujita No.7-A		Fujita Tekkōsho(1) Cincinnati Co. (1)
Gear chamfering machine.	1	"	10 inch.		Tsutsuni Seisakusho
Bevel gear generator.	1	Gresson type, Motor driven, DC.	8 in.		Gresson Iron Works.
Cylindrical grinding machine.	1	Motor driven, DC.	Swing 300 mm.		Unknown.
Tool & cutter Grinding machine.	1	"	240 mm.		Unknown.
Slotter	2	"	6 inch.		Fukui tekkocho (1) Shibayama " (1)

MINUTE DESCRIPTION OF MACHINES AND EQUIPMENT (Contend.)

<u>Name of machine</u>	<u>Number</u>	<u>Type</u>	<u>Dimensions</u>	<u>Use</u>	<u>Manufacturer</u>
Sawing machine.	1	Motor driven, DC.	16 inch.		Rokuroku Shōten.
Shaping machine	1	"	22 inch.	Japanese Chinese & English typewriter	Mitsubishi Kōsaku Kikai K.K.
Horizontal boring machines.	2	"	3 inch.	Type cester,	Genno Kikai Seisekusho (1) Shibayama Tekkosho (1)
Compressor	1	Belt driven	10x6 inch.	Tramcar parts and small marine engine	Sallian, with air tank (1) (3x5 ft.)
Double housing planer.	2	Motor driven, DC.	8x10 ft.	all machine are use	Iwahashi Seisekusho, & Matsumoto Chūzō K.K.
Total	56				

KYOTO MILITARY GOVERNMENT TEAM
APO 713 (Kyoto, Honshu)

14 Feb. 1947

SUBJECT: Permission for Kyoto Kosaku Kikai E.K., Jujo Plant
to Move Reparatons Machine

TO : Commanding Officer, Ishikawa Mil Govt Team, APO 713
Attn: Res & Ind Officer

For your information.

FOR THE COMMANDING OFFICER:

ENOS L COMMONS JR
Capt., Ord.
Res & Ind Officer

Incl:
Permission for movement of machinery (lcc).

44

FACTORY INFORMATION

1. Name of Company
 - A. Present Name: Kyoto Kosaku Kikai Kabushiki Kaisha
 - B. Former Name : Kyoto Kosaku Kikai Kabushiki Kaisha
2. Name of Plant
 - A. Present Name: Jujo Plant
 - B. Former Name : Jujo Plant
3. Location of Company and Plant
 - A. Location of Company: 103, Ochiai-cho, Kisshoin, Shimokyo-ku, Kyoto City.
 - B. Location of Plant : 103, Ochiai-cho, Kisshoin, Shimokyo-ku, Kyoto City.
4. Representatives of Company and Plant
 - A. Rep. of Company: Managing Director...Junsaku Enmei
 - B. Rep. of Plant : Director, Chief Engineer...Nobuyuki Nakamura
5. Date Incorporated and Commenced Operation of Company and Plant
 - A. Date-Incorporated-Company: Nov. 1928
 - B. Date Commenced Operation-Plant: Nov. 1943
6. History of Plant
 - a. Nov. 1943...Purchased Kisshoin Plant of Daido Senko K.K. from the latter company and commenced production of machine tools, naming the plant as Jujo.
 - b. Mar. 1944...Transferred the head office to this Jujo Plant.
 - c. Nov. 1945...With permission of 6th Army (MG52.Nov.23, 1945), converted to manufacturing type-casting machines, parts of tramcars, and Japanese typewriters.
 - d. Aug. 1946...This Jujo Plant was designated as reparations plant.

|

7. Area and Floor Space of Plant

- A. Area: 6,822.5 tsubo
 B. Floor Space: 2,672.18 tsubo

8. Yearly Production from 1934 to 1936

Not commenced operation plant.

9. Yearly Production from 1937 to 1945

Year	K.O.V.-type Vertical Milling Machine	Miscellaneous
1943	0	0
1944	6	¥62,225.00
1945	71	¥644,175.00

10. Past-war Production

A. Date and Authorities Permitted to reconvert to produce civilian commodities

Nov. 23, 1945

GEORGE D. SEARS
 Colonel: Infantry

Military Government Officer

B. Items and Quantity produced after grant of permission (List all)

Month	Description of Items produced	Quantity	Amount	Remarks
Dec. 1945	None.	0	0	
Jan. 1946	ditto.	0	0	
Feb. 1946	Typewriter parts		¥319,548.	
Mar. 1946	Type casting machine	1		
	Parts of Tramcar		¥ 55,845.	
Apr. 1946	Typecasting M. Tramcar parts	1	¥ 56,216.	
May. 1946	Tramcar parts.		¥ 33,650.	
	Typewriter parts		¥3,580.	
June 1946	Typecasting M. Tramcar parts	1	¥ 13,760.	
	Typewriter parts		¥ 41,800.	
July 1946	Typecasting M. Tramcar parts	3	¥ 40,000.	
	Typewriter parts		¥ 37,974.	

Month	Description of Items produced	Quantity	Amount	Remarks
Aug. 1946	Typcasting M.	2		
	Tramcar parts		¥31,319.	
	Typewriter parts		¥205,846.	
Sept 1946	Typcasting M.	2		
	Tramcar parts		¥18,051.	
	Typewriter parts		¥175,280.	
Oct. 1946	Typcasting M.	2		
	Tramcar parts		¥5,000.	
	Typewriter parts		¥141,118.	
Nov. 1946	Typcasting M.	1		
	Tramcar parts		¥56,026.	
	Typewriter parts		¥93,391.	
Dec. 1946	Typcasting M.	1		
	Tramcar parts		0	
	Typewriter parts		¥219,306.	
Jan. 1946	Typcasting M.	2		
	Tramcar parts	0	0	
	Typewriter parts		¥53,754.	
Feb. 1947	Typcasting M.	3		
	Typewriter parts		¥48,599.	
Mar. 1947	Typcasting M.	3		
	Typewriter parts		¥117,733.	
Apr. 1947	Typewriter parts		¥65,426.	
May 1947	Typewriter parts		¥98,177.	
June 1947	Typewriter parts		¥43,798.	
July 1947	Typcasting M.	2		
	Tramcar parts		¥20,000.	
	Typewriter parts		¥120,528.	
Aug. 1947	Typcasting M.	2		
	Tramcar parts		¥100,104.	
	Typewriter parts		¥138,123.	
Sept 1947	Typcasting M.	7	¥910,000.	
	Tramcar parts		0	
	Typewriter parts		0	
Oct. 1947	Typcasting M.	6	¥780,000.	
	Tramcar parts		0	
	Typewriter parts		0	

C. Production Object in the Future (Monthly)

Items produced	Quantity	Remarks
Type Casting Machine	7 machines	Of which, 2 machines for export.

D. Attach copies of Procurement Demands

None

11. Outline of Reparations Machinery and Equipment

A. Total Number of Machines and Equipment Inventoried:
205

B. Classification of Machinery & Equipment:

	<u>Amount</u>
Class I	112
Class II	87
Class III	6

C. Number of Machines and Equipment.

Number Inventories and Number Necessary for
 Continuing Civilian Production

DESCRIPTION	NUMBER	NECESSARY NO.	REMARKS
Machine Tools	177	163	No. now in operation 90
Secondary Machine Tools	2	2	2
Miscellaneous Machine Tools	7	6	5
Electric Machines	6	6	5
Electric Equipment	12	8	8
Pump	1	1	1
TOTAL	205	186	111

D. Attach Complete List of Machinery and Equip.

CLASSIFICATION NAME OF MACHINE	TOTAL	REQUIRES	CODE NO	NO OF MACH
	OF REQ NO	OF REQ NO	OF REQ NO	OPER AT PRESENT
Machine Boring Machines Tools	3	3	IA1-1,2,3	1

CLASSIFI- CATION	NAME OF MACHINE	TOTAL REQUIRES	CODE NO OF REQ.	NO OF MACH OPER AT PRESENT	
Machine Tools	Drilling Machines	23	20	IA3-1,2,3,4,5, 6,7,8,9,10,11, 12,13,14,15,17, 20,21,22,23	12
ditto	Gear Cutt- ing and Finishing Machines	6	4	IA4-1,2,3,6	2
ditto	Grinding Machines	21	21	IA5-1,2,3,4,5,6,7, 8,9,10,11,12,13, 14,15,16,17,18,19, 20,21	10
ditto	Lathes	59	56	IA5-1,2,3,4,5,6, 7,8,9,10,11,12,13, 14,15,16,17,18,19, 20,21,22,23,24,25, 26,27,28,29,30,31, 32,33,34,35,36,37, 38,39,40,41,42,43, 44,46,47,50,51,52, 53,54,55,56,57,58, 59	28
ditto	Milling Machines	30	30	IA-7-1,2,3,4,5,6,7, 8,9,10,11,12,13, 14,15,16,17,18,19, 20,21,22,23,24,25, 26,27,28,29,30	11
ditto	Planers	7	4	IA8-3,4,5,6	2
ditto	Shapers	8	8	IA9-1,2,3,4,5,6, 27,28	8
ditto	Slotters	5	2	IA9-7,10	4

CLASSIFI- CATION	NAME OF MACHINE	TOTAL	REQUIRES	CODE NO OF REQ.	NO OF MACH OPER AT PRESENT
Machine Tools	Sawing Machines	5	5	IA9-12,13, 14,15,16	2
ditto	High-speed Cutting M.	1	1	IA9-17	1
ditto	Bits Grinder	9	9	IA9-18,19,20, 21,22,23,24, 25,26	9
Secondary Machines	Air Hammers	1	1	IB6-1	1
ditto	Mechanical Hammer	1	1	IB6-2	1
Finishing Equip.	Welding Machine	1	1	IC1-1	1
ditto	Heat Treat- ing Equip.	6	5	IC4-1,2,3,4,5,6	4
Electric Machines	Motors	6	6	2A2-1,2,3,4,5,6	5
ditto	Trans- formers	8	7	2B1-2,3,4,5,6,7, 8	7
Electric Equip.	Switch Gear	4	1	2B2-2	1
Miscella- neous	Heat Treat- ing Furnace	6	5	IC4-1,2,3,4,5,6	4

CLASSIFI- CATION	NAME OF MACHINE	TOTAL REQUIRES	CODE NO OF REQ.	NO OF MACH OPER AT PRESENT
---------------------	--------------------	----------------	--------------------	----------------------------------

Miscellaneous	Centrifugal Pump	1	1	III ^{B1} A -1	1
---------------	---------------------	---	---	-----------------------------------	---

12. General Conditions concerning maintenance of Reparatons Machinery and Equipment

- A. Machines of Class I & II un-operated.....88
- B. Machines of Class III un-operated.....6
- C. Operating Machines.....111
- D. Machines dispersed and lent.....0
- E. Protecting measure.....0

13. Purchasers of Products

- A. Export.....93%
- B. Markets in Japan.....7%
- C. Occupation Forces.....0

14. Condition of Operation

- A. No. of Employees
Administrative-Technical-Laborers-Others-Total
 - Male.....136
 - Female.....13
-
- TOTAL 149

B. Condition of Production

Ever since our plant was granted permission by GHQ, SCAP for reconversion into peace-time industry, we have been endeavoring for production of the Type Casting Machine, thereby to contribute to the printing industry in post-war Japan.

The manufacturers of this machine in our country are comparatively small in number and most of their plants and machines were destroyed by air-raids during the war years, and therefore, the amount of production has been greatly reduced.

It is fortunate, however, that our plant is equipped with sufficient machines and facilities for higher production. With the skilled laborers transferred from the Nippon Typewriter K. K. (who is holding a patent right for this machine) we are making a steady progress for the recovery of our industry, showing a gradual increase in production. At present, we can manufacture 10 units per month within the capacity of machines and equipment now under operation. We are expecting to produce much more by improving technics.

Although we are confronted with a difficult situation under the current electric shortage, we are making our utmost effort to maintain the present productivity with our industrious workers. When the present power crisis is tided over, we shall increase the production by increasing the number of the workers.

As for the materials required for our production, we are making constant study for utilizing everything available and securing the necessary amount in spite of the acute shortage of the national resources. Therefore, of all the Type Casting Machines now being manufactured in our country, more than one half, or 58 % (as of September, of this year) are turned over from our plant. In case, therefore, our machines and equipment are to be removed as the reparations items, we fear that the production amount of the Casting Machines will be reduced to a negligible level. (The above-mentioned level can be maintained by keeping the machines and equipment at the present operation rate.)

Under these circumstances, it is requested that you will kindly take into consideration the present position of our plant in the Type Casting manufacturing industry of our country and grant us special favor for our plant to be removed from the reparations program, as we earnestly desire to make contribution to the national industrial rehabilitation and especially to the development of the printing industry of our country.

Factory Information
Kyoto Koraku Kikai
Supplementary #14 (A)

Administrative (Directors).....4

No. of Employees KIND	NUMBER		Total
	Male	Female	
Office workers	10	5	15
Engineers	10	-	10
<u>Factory workers</u>			
Lathe	30	-	30
Milling	19	5	24
Shaping	6	-	6
Planing	2	-	2
Boring	1	-	1
Grinding	4	-	4
Drilling	3	-	3
Gear Cutting	1	-	1
Slotting	1	-	1
Marking	2	-	2
Forging	2	-	2
Finishing	33	-	33
Welding	1	-	1
Electric	1	-	1
Testing	2	-	2
Cutting	2	-	2
Odd Job	-	3	3
Guard	6	-	6
GRAND TOTAL	136	13	149

APPLICATION FOR PERMISSION TO MOVE MACHINERY

Fuji Industrial Corp. Handa Plant
 Gechohama 1, Okkawa, Handa-shi, Aichi-ken
 20 Oct. 1946

Kyoto Military Government Team
 Kyoto, Henshu

- 1. Name: Fuji Industrial Corp. Handa Plant
- 2. Location: Gechohama 1, Okkawa, Handa-shi, Aichi-ken
- 3. Location of Machines: 103 Ochiai-machi, Kissehin, Shimokyo-ku
 Kyoto-shi, (Kyoto Kosakuki K.K.)
- 4. Moving Place: Gechohama 1, Okkawa, Handa-shi, Aichi-ken
 (Fuji Industrial Corp. Handa Plant)
- 5. Purpose of Movement: To clean and store the machines pending
 final disposition under the war
 reparation program.
- 6. Machines:

Name of Machine	Maker	Number	Code Number
Miscellaneous Metal Working Equipment-Heat Treating Furnace Electric	Tekyo Denkiro K.K.	1	01-35-1968

Fuji Industrial Corp. Handa Plant

Manager Shinobu Mitake
 SHINOBU MITAKE

I hereby certify that the above listed machines
 belong to the Handa Plant of the Fuji Industrial Corp.

Kyoto Kosaku Kikai K.K.

Authorized Rep. J. Enmei

KYOTO-FU-CHO

Nov. 21, 1946.

TO : The Commanding Officer,
Kyoto M.G. Team.

SUBJECT: Recommendation on application for
permission to move a reparation
machine.

Fuji Industrial Corp. Handa Plant is applying for your permission, as per the application attached hereto. The plant wants to move the electric furnace, which has been lent to Kyoto Kosaku-Kikai K.K. since during the war, to its own plant in Handa-city for the purpose of maintaining it with more attention. So please give your kind permission to the plant.

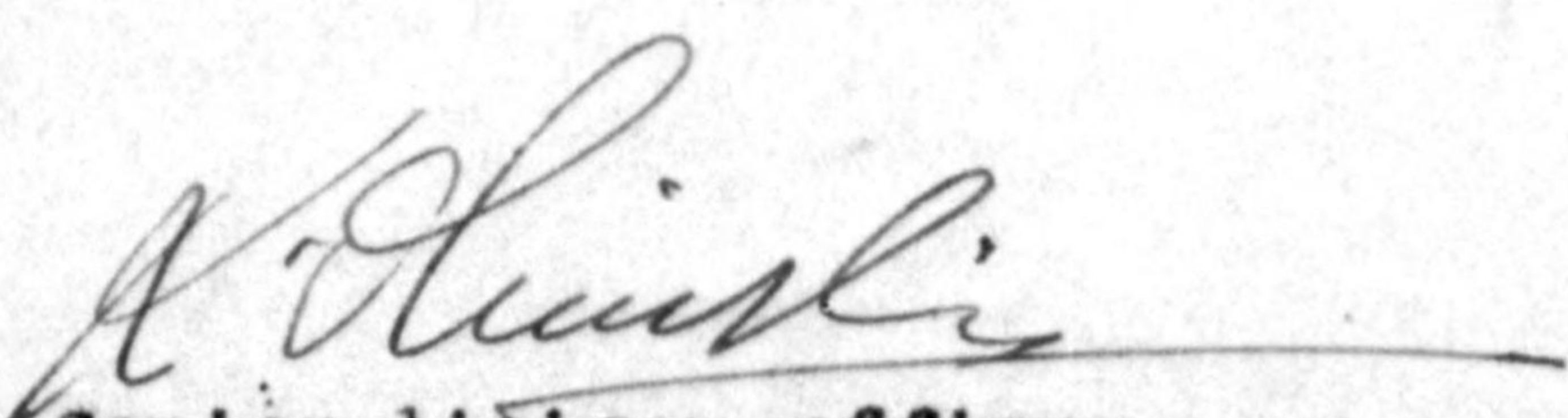
Senior liaison officer
Kyoto Liaison Office.

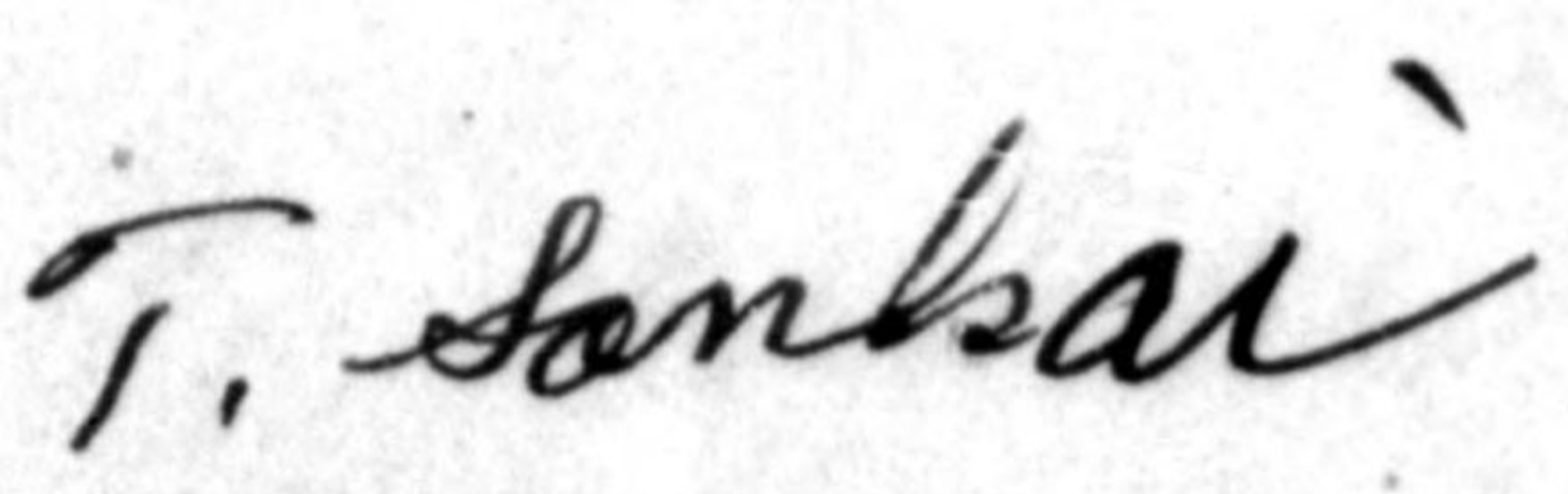
Chief of the Section
of Reparation Affairs.

44
KYOTO MILITARY GOVERNMENT TEAM
APO 713 (Kyoto, Honshu)

19 Nov. 1946

SUBJECT: Inventory of Dispersed Reparations Machinery

TO : Commanding Officer, Ishikawa Mil Govt Team, APO 713

1. In compliance with OD-5/4, Hq Eighth Army, dtd 22 Aug 46, Instructions for the Inventory of Reparations Plants*, Section III B(c), inclosed herewith are inventory sheets of dispersed machinery located in your prefecture at #50 Tsurugi-machi, Ishikawa-gun belonging to Kyoto Kosaku Kikai K.K., Jujo Plant. (listed as plant code #44, Kyoto Pref.)
2. Request the inclosed inventory sheets be spot-checked in accordance with reparations directives.
3. Due to the fact that the remaining fifty-six (56) machines belongs to the Jujo Plant of the same company, spot-checking is unnecessary.
4. Upon completion of this work, please forward the inventory sheets to this office for submission through the proper channels.

FOR THE COMMANDING OFFICER:

ENOS L. COMMONS JR
Capt., Ord.
Res & Ind Officer

Incl:

Original inventory sheets (20 sheets)
Duplicate " " (20 sheets)

44
KYOTO MILITARY GOVERNMENT TEAM
APO 713 (Kyoto, Honshu)

19 Nov. 1946

SUBJECT: Inventory of Dispersed Reparations Machinery

TO : Commanding Officer, Ishikawa Mil Govt Team, APO 713

1. In compliance with OD-5/4, Hq Eighth Army, dtd 22 Aug 46, Instructions for the Inventory of Reparations Plants*, Section III B(c), inclosed herewith are inventory sheets of dispersed machinery located in your prefecture at #50 Tsurugi-machi, Ishikawa-gun belonging to Kyoto Kosaku Kikai K.K., Jujo Plant. (listed as plant code #44, Kyoto Pref.)
2. Request the inclosed inventory sheets be spot-checked in accordance with reparations directives.
3. Due to the fact that the remaining fifty-six (56) machines belongs to the Jujo Plant of the same company, spot-checking is unnecessary.
4. Upon completion of this work, please forward the inventory sheets to this office for submission through the proper channels.

FOR THE COMMANDING OFFICER:

ENDS L. COMMONS JR
Capt., Ord.
Res & Ind Officer

Incl:

Original inventory sheets (20 sheets)
Duplicate " " (20 sheets)

44

KYOTO MILITARY GOVERNMENT TEAM
APO 713 (Kyoto, Honshu)

18 Nov. 1946

SUBJECT: Inventory of Dispersed Reparations Machinery

TO : Commanding Officer, Ishikawa Mil Govt Team, APO

1. In compliance with OD-5/4, Hq Eighth Army, dtd 22 Aug 46, "Instructions for the Inventory of Reparations Plants", Section III B(c) inclosed herewith are inventory sheets of dispersed machinery located in your prefecture at #50 Tsurugi-machi, Ishikawa-gun belonging to Kyoto Kosaku Kikai K.K., Jujo Plant (listed as plant code #44, Kyoto Prefecture)
2. Request the inclosed inventory sheets be spot-checked in accordance with reparations directives.
3. Upon completion of this work, please forward the inventory sheets to this office for submission through the proper channels.

FOR THE COMMANDING OFFICER:

ENOS L. COMMONS JR
Capt., Ord.
Res & Ind OfficerIncl:
As stated above

Fact no 161

Kyoto Fu

20 Dec '41 LAC

Specification Of The Plant

Location 103, Kishshoin Ochiaicho, Shimokyoku, Kyoto.

Name: (Plant Number) No. 161 The Kyoto Machine-Tool M.F.G. Co., Ltd. Jujyo Plant



1. Machinery:

1. Lathe	46
2. Turret-Lathe	8
3. Milling Machine	28
4. Drilling Machine	13
5. Planing Machine	7
6. Boring Machine	3
7. Shaping Machine	6
8. Slotting Machine	6
9. Grinding Machine	19
10. Gear-Raping Machine	1
11. Gear-Shaping Machine	10
12. High-Speed Cutting Machine	1
13. Metal-Sawing Machine	4
	152

2. Principal Materials On Hand :

1. Cast-Iron	1.5 ton
2. Special-Steel	9.5
3. Light-Metal	2.5

3. Productions In Stock :

1. Bench-Lathe	8
----------------	---

2. Bench-Milling

3

3. 1½ Vertical-Milling

2

7

I have received the above factory and
inventory for the Home Ministry on
this date 20 Dec 45.

Humeji Kobayashi.

THE KYOTO

R O A D

2

3

4

5

6

7

13

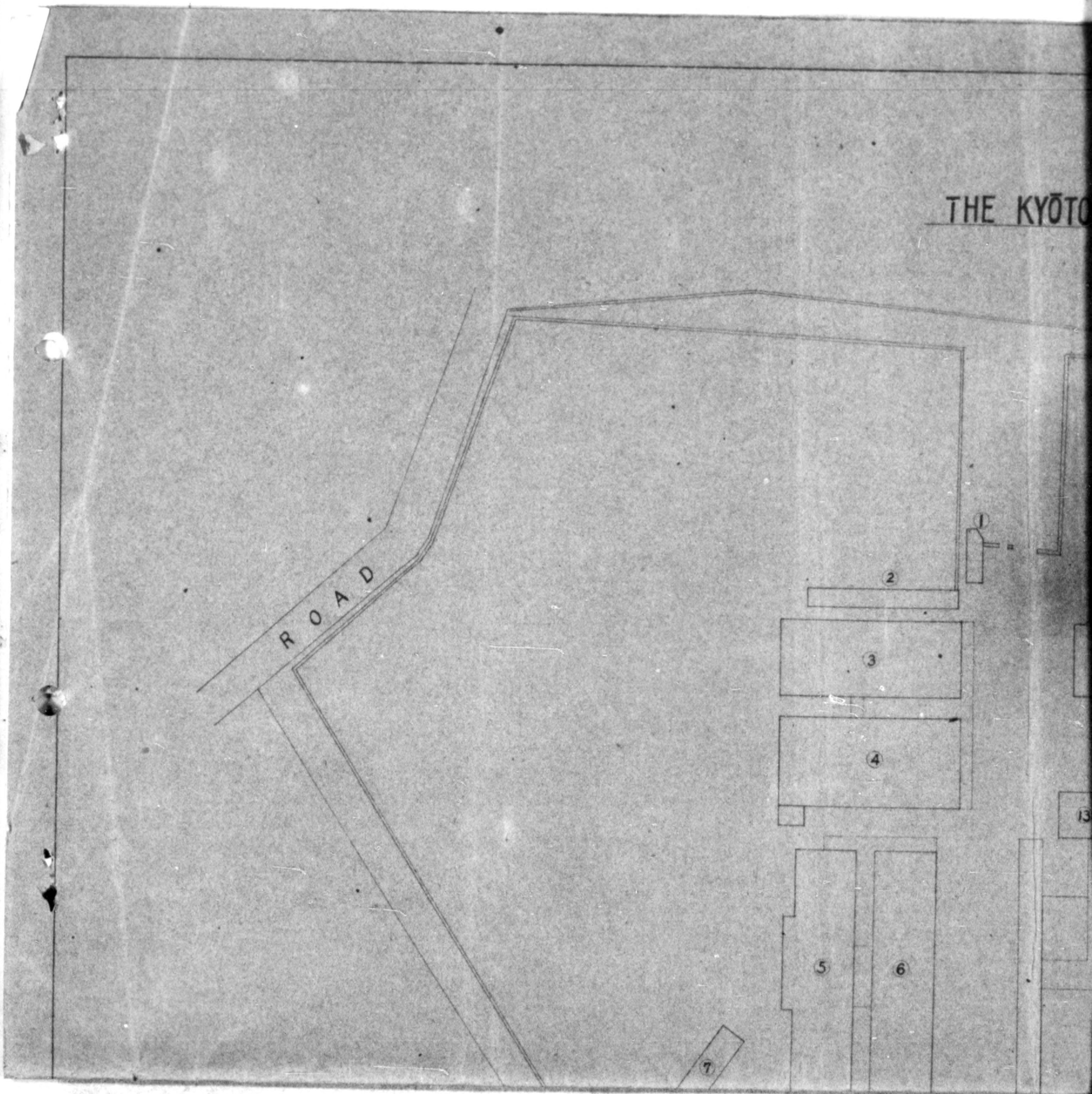

THE KYŌTO MACHINE-TOOL MANUFACTURING CO. LTD. ZYŪZYŌ MANUFACTORY G

NO. 103, KISSHŌIN OCHIAICHŌ, SIMOKYŌKU, KYŌTO

Z Y Ū Z Y ō ST.

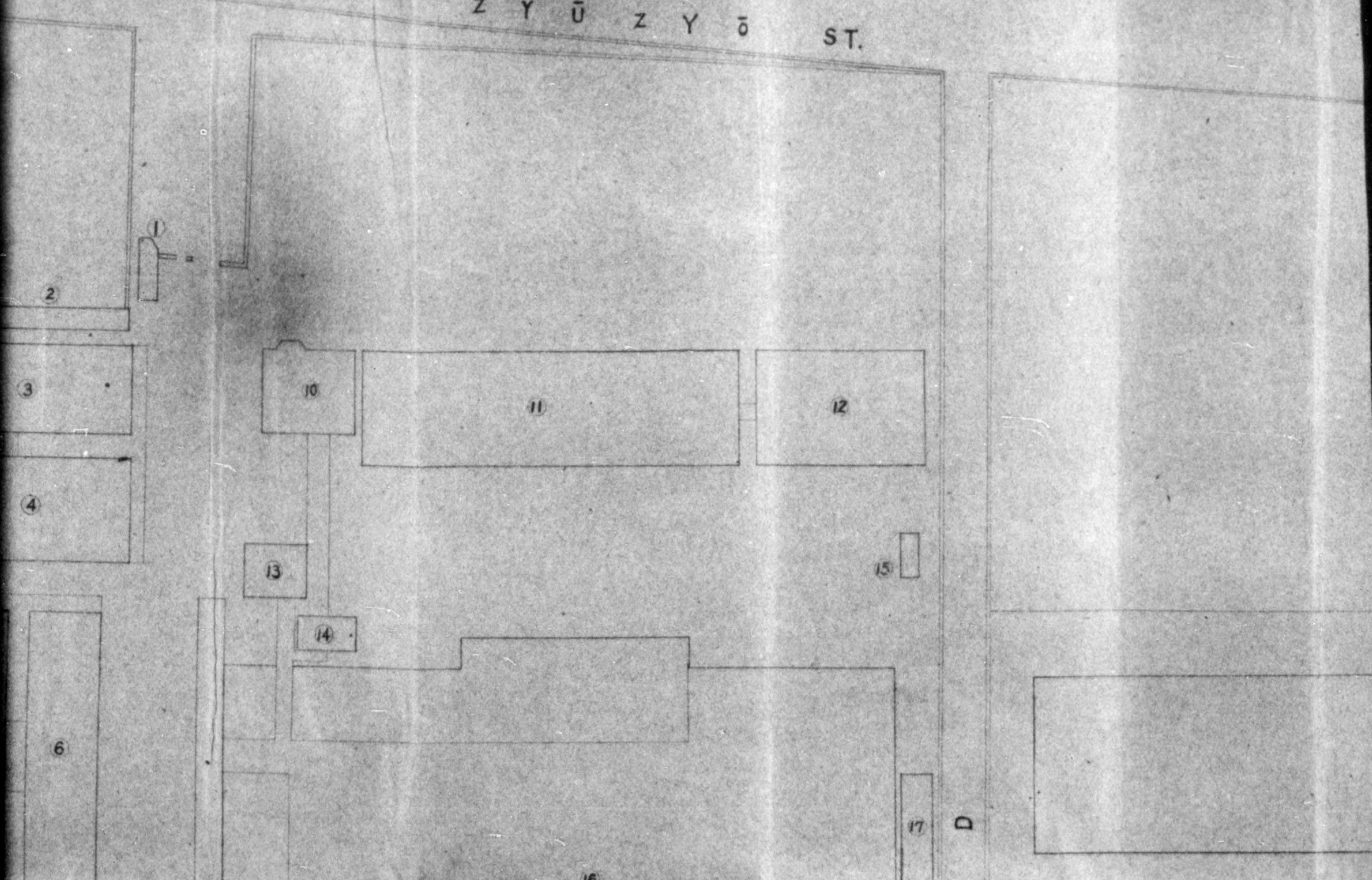

775013

5 MANUFACTORY GROUND-PLAN 1:600

CHŌ, SIMOKYŌKU, KYŌTO

775013

STORY GROUND-PLAN 1:600
KYOTO

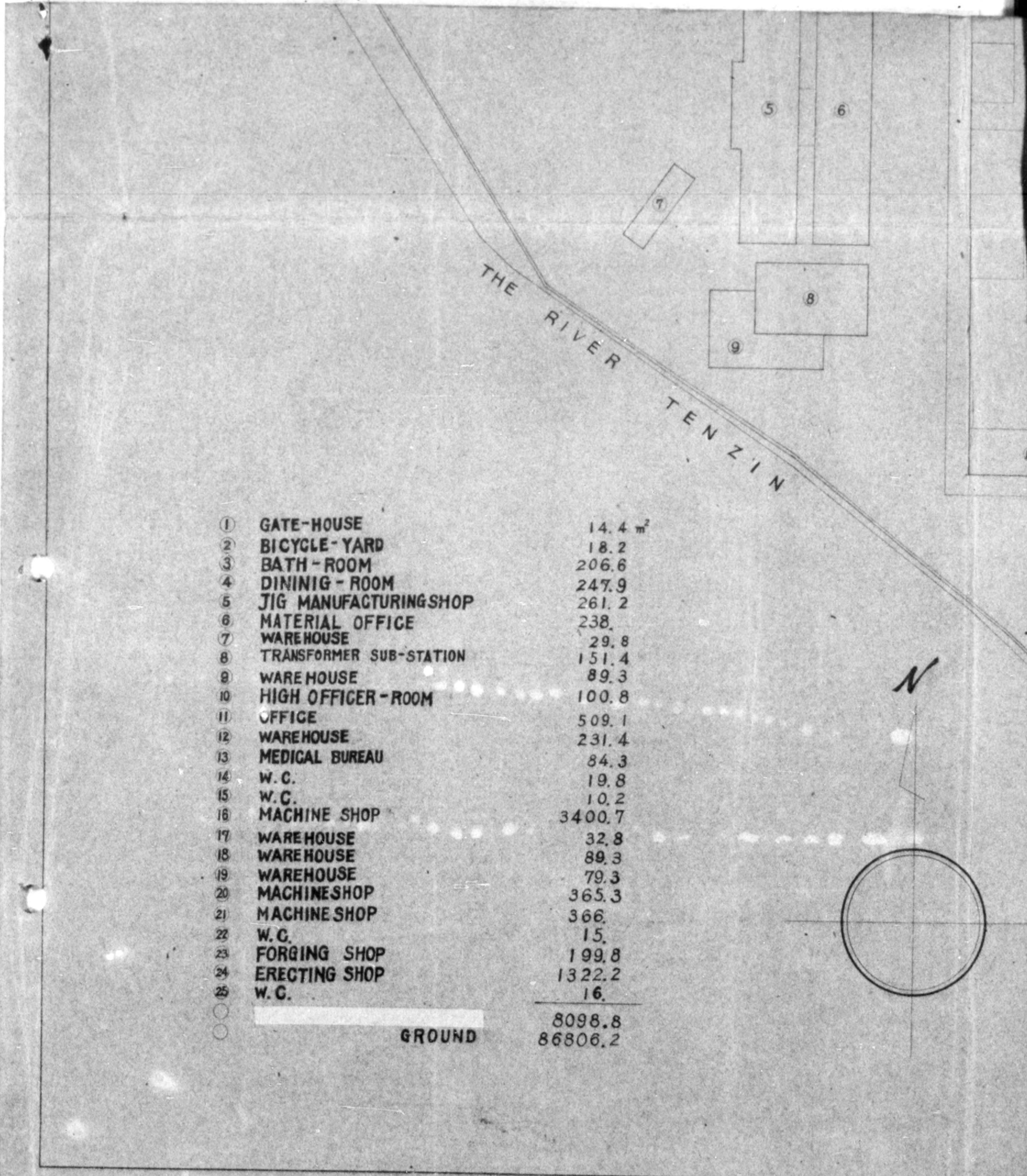

①	GATE-HOUSE	14.4 m ²
②	BICYCLE-YARD	18.2
③	BATH-ROOM	206.6
④	DINING-ROOM	247.9
⑤	JIG MANUFACTURING SHOP	261.2
⑥	MATERIAL OFFICE	238.
⑦	WAREHOUSE	29.8
⑧	TRANSFORMER SUB-STATION	151.4
⑨	WAREHOUSE	89.3
⑩	HIGH OFFICER-ROOM	100.8
⑪	OFFICE	509.1
⑫	WAREHOUSE	231.4
⑬	MEDICAL BUREAU	84.3
⑭	W.C.	19.8
⑮	W.C.	10.2
⑯	MACHINE SHOP	3400.7
⑰	WAREHOUSE	32.8
⑱	WAREHOUSE	89.3
⑲	WAREHOUSE	79.3
⑳	MACHINE SHOP	365.3
㉑	MACHINE SHOP	366.
㉒	W.C.	15.
㉓	FORGING SHOP	199.8
㉔	ERECTING SHOP	1322.2
㉕	W.C.	16.
○		8098.8
○	GROUND	86806.2

N

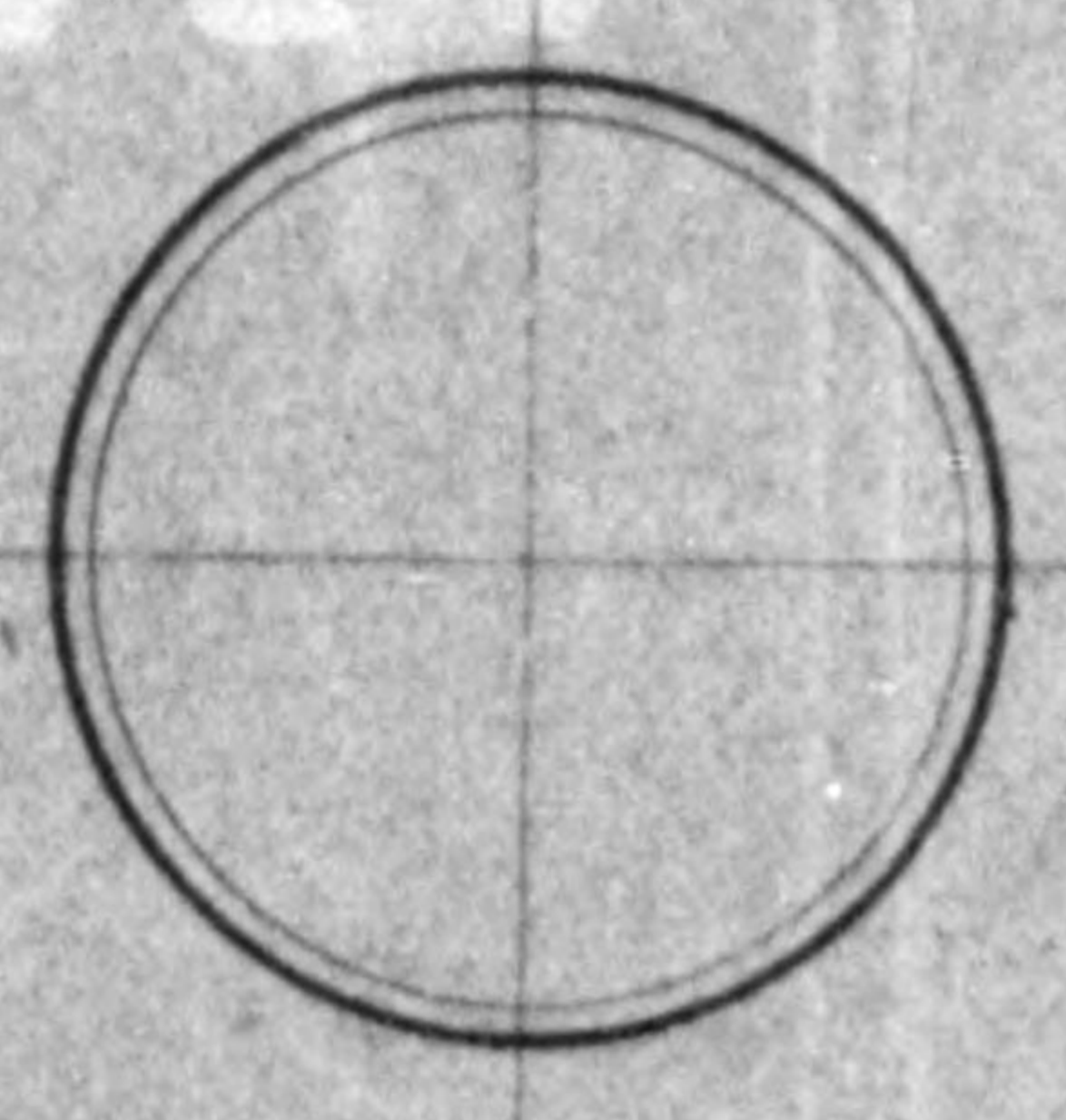

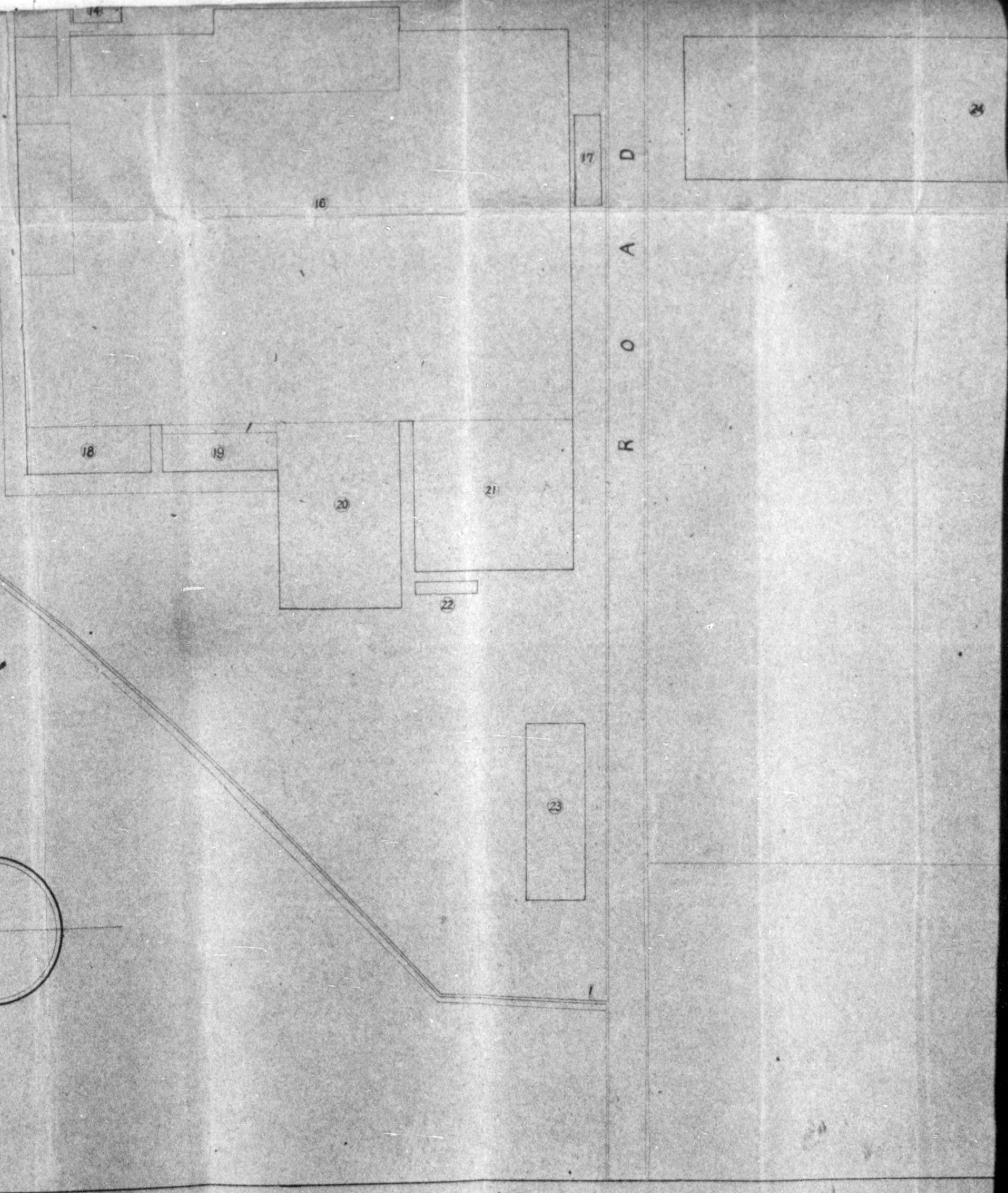

775013

24

25

775013

General Equipment
of
MILAZU
Steam Power Plant

Kinki (Osaka) Branch
Nippon Yusen K. K.

775013

Miyazu Steam Power Plant			Location: Miyazu Town.
Authorized Out Put 15,000 K.W.		Kyoto Prefec	
Site & Building	Area of Site. (m ²)		cl. 4
	Construction of Main Building.		rainf
Boiler	Area of Main Building. (m ²)		2.16
	Order.		No. 1
	Maker.		Hita
	Type.		Yellow
	Date Officially registered.		Nov.
	Steam Pressure. (Kg/cm ²)		3.
	Steam Temperature. (°C)		41.
	Boiler Capacity. Mex. Continuous. (t/h) Economical.		2
Super heater	Calorie per Kg coal. (design)		500
	Heating Surface. (m ²)		73.
Furnace	Super heating surface. (m ²).		2.
	Structure.		Ball
	Volume. (m ³)		14
Economiser	Heating Surface of Belly well. (m ²)		1.
	Maker & Type.		Hita
	Heating Surface. (m ²) & Number.		200
Air Pre-heater	Feed water	In let.	12
	Temp. °C.	Out let.	17
	Maker & Type.		Hita
Fan	Heating Surface (m ²)		500
	Number.		11
	Temperature of Air rise. (°C)		11
Fan	Forced Fan	Quantity (m ³ /m.m.) & Head (m.m.Aq.)	1,200
		Motor capacity (HP) & No. of pole.	120
		Number.	1
Fan	2ndry Fan	Quantity (m ³ /m.m.) & Head (m.m.Aq.)	2,100
		Motor capacity (HP) & No. of pole.	160
		Number.	4
Combustion Equipment	Induced Fan	Quantity (m ³ /m.m.) & Head (m.m.Aq.)	2,100
		Motor capacity (HP) & No. of pole.	160
		Number.	4
Stoker	Type.		Travel
	Breadth. (m.m.)		2.4
	Length. (m.m.)		6.
	Rate of combustion (Kg/m ² h)		2
		Number.	2

Plant - 1 -	
Location: Miyazu Town, Yosho districts Kyoto Prefecture.	
Building (m ²)	21,946 reinforced concrete 2,162
Model	No. 1 - 4 Hitachi Yellow Nov. 1936
Capacity (kg/h)	32 415
Continuous	27
Vertical	21.5
Sign	5,500 731
Area (m ²)	240
Well (m ²)	Hayley wall 140 15
Number	Hitachi tablar type 380 x 4
Capacity	120 176
Material	Hitachi plate type. 600 4
(OC)	116
Head (m.m.Aq.)	1,200 x 240
HP & Role	120/6 4
Head (m.m.Aq.)	
HP & Role	
Head (m.m.Aq.)	2,100 x 190
HP & Role	160/6 4
Traveling grate	2,400 6,000 137 2 x 4

Steam Power Plant			
Combustion Equipment	Pulv. Mill.	Type Capacity (t/h) Motor capacity (HP) Number	
	Exhauster	Quantity (m ³ /m.m.) & Head (m.m. Ac.) Motor capacity (HP) Number	
	Burner	Type Capacity (t/h) & Number	
	Automatic combustion equipment		None
	Dust Collector	Type Number	Coal
	Coal Dryer	Capacity (t/h) Number	120
Coal Handling Equipment	Coal Bunker Capacity (t) & No.		
	Pulv. Coal Bunker Capacity (t) & No.		
	Area of coal yard (m ²)		
	Capacity of coal storage (t)		11,000
Capacity of ship mooring (t)		3,000	
Capacity of train luggage (t/nc. of waggons)		3,200	
Ash Handling Equipment	dreg-chain conveyer--horizontal conveyer (3t/h x 4.) (1st/h x 1)		
Steam Turbine	Other.	No. 1	
	Maker.	A.E.G.	
	Type.	Impu.	
	Date officially Registered.	Dec. 1901	
	Out put K.W. (Gen. Terminal)	10,000	
	Steam Pressure (kg/cm ²)	4	
Steam Temperature. (°C)	360		
R. P. M.			
Expansion Stops.	High Press. Side Low Press. Side		
Number of steam Extraction.			
Condenser.	Degree of vacuum. (m.m.Hg.)		7
	Cooling water temp. (°C)		
	Cooling surface (m ²)		1,000
	Kind of cooling water		See

nt

m.m.
Ac.)

s)

l conveyer -- inclined conveyer -- Ash Cer.
t/n x 1) (15 /n x 1)

Siemens
Centrifugal type
4
120
4

11,000 grab bucket fixed, 40
3,000 belt conveyer 40 -- bridge transformer, 40 -- 6501 yard.
3,700 belt conveyer 40
belt conveyer 40 -- bunker.

No. 1 - 2
A.E.C.
Impulse
Dec. 1936
10,000
30
400
3,500
6
2
720
18
1,050
See water

Steam Power Plant

Air Pump.	Type Number		
Circulating Water Pump	Capacity (m ³ /h) & Head (m Aq.) Motor capacity (HP) & No. of pole Number		
Condensate Water Pump	Capacity (m ³ /h) & Head (m Aq.) Motor capacity (HP) & No. of pole Number		
Feed Water Pump	Maker & Type Capacity (m ³ /h) & Head (Kg/cm ²) Prime-mover capacity (HP) & No. of pole Number		
Hot & Clearing Equipment	Deaerator Capacity (t/h) & Number.		
	Evaporator Capacity (t/h) & Number. Feed water Heater Outlet Temp. (°C) Number		
Generator & Condenser	Order		
	Maker		
	Capacity (K.V.A.)		
	Capacity as condenser (K.V.A.)		
	Power factor ()		
	Voltage (V)		
R. P. M.			
Neutral ground Resistance ()			
Starting Motor for condenser ()			
Sealing method			
Exhauster	Order		
	Driving Motor		
	Capacity (K.V.A.) Voltage (V)		
Transformer	Bank order		
	Maker		
	Date officially registered		
	Capacity (K.V.A.)	Primary (K.V.) Secondary (K.V.) Tertiary (K.V.)	
Connection & Voltage (K.V.)	Primary Secondary Tertiary		

- 3 -

	Steam ejector		
	2		
	100 x 10		
	86/8		
	4		
	100 x 46		
	47/4		
	2		
	Hitech. Machine	Hitech. turbine	
	60 x 40	80 x 40	
	220/4	Steam 1/2	
	2	1	
	60 x 2		
	1/2		
	125		
	4		
	No. 1, 2.		
	A. B. G.		
	12,500		
	12,500		
	80		
	11,000		
	3,600		
	58.6		
	670 (10 min)		
	Osaka Naval Dock.		
	No. 1, 2.		
	Nov. 1, 2, 3		
	No. 140		
	280		
	No. 1, 2.	Houma machine	
	Hitech	Hitech	
	Nov. 1935	Nov. 1935	
	12,500	1,250	
	12,500	1,250	
	10.5	11.0 - 9.6	
	345 - 285	3.45	

Steam Power Plant

- 4 -

Trans- former	Phase & Type Volume of Insulating Oil (l/one) Cooling method Number	S S
Supplying Water	Kind & Capacity of Water source (t/h) Capacity of water tank (m ³) Capacity & No. of softner (t/h)	A
Remarks	Power Static Condenser	C

775013

- 4 -

/one)	3-phase core type 18,450 Self-cooling 2	3-phase core type 18,450 Self-cooling 2
3) t/)	Water well 5 x 1 600 x 2 4lb x 1	
	5,000 K.V.A. x 12,000 V x 2 bank	

(22-48-Pow. Gen.)

OUT-LINE OF MAIN UNITS OF EQUIPMENT
TO BE WORKED AT VIYAZU STEAM-ELECTRIC STATION

1. Steam Turbines
Identifying Mark

Description of Equipment

S.T.	1	20,000 KW. A. E. G. 1935
"	2	" " "

2. Generators
Identifying Mark

Description of Equipment

Gen.	1	12,500 KVA A. E. G. 1935
"	2	" " "

3. Boilers
Identifying Mark

Description of Equipment

BO.	1	21.5 MT/Hr. H. 1935
"	2	" " "
"	3	" " "
"	4	" " "
"		

4. Coal Handling Equipment
Identifying Mark

Description of Equipment

C.H.	1	Cantilever crane short horizontal conveyer 12 M. long
"	2	Inclined conveyer 73 M long
"	3	Horizontal conveyer 46 M. long
"	4	Inclined conveyer 13 M. long
"	5	Horizontal conveyer 50 M. long

5. Stoker Equipment
Identifying Mark

Description of Equipment

S.	1	Chain grate stoker
"	2	" " "

S.	3	Chain grate stoker
"	4.	" " "
"	5	" " "
"	6	" " "
"	7	" " "
"	8	" " "

6. Outdoor Switch Yard
Identifying Mark

Identifying Mark	Description of Equipment
S.Y. 1	34.5 28.5 KV/ 10.5 KV 12,500 KVA
" 2	" " " " "
" 3	44 KV 800 Amp.
" 4	" "
" 5	" "
" 6	" "
" 7	" "
" 8	" "
" 9	" "
" 10	" "
" 11	" "
" 12	" "

7. Indoor Switch Room
Identifying Mark

Identifying Mark	Description of Equipment
S.R. 1	25 KV 1,000 Amp.
" 2	" "
" 3	22 KV 1,500 Amp.
" 4	" "
" 5	" 400 Amp.
" 6	" "
" 7	" 200 Amp.
" 8	" "

8. Switch board Room
Identifying Mark

Description of Equipment

S.B.	Identifying Mark	Description of Equipment
1		Panel
2		"
3		"
4		"
5		"
6		"
7		"
8		"
9		"

9. APPLICABLE EQUIPMENT
IDENTIFYING MARK

Description of Equipment

Eq.	Identifying Mark	Description of Equipment
1		220 HP Feed Water Pump
2		220 " " " "
3		180 " Induced draft fan
4		180 " " " "
5		180 " " " "
6		180 " " " "
7		120 " Forced draft fan
8		120 " " " "
9		120 " " " "
10		120 " " " "
11		86 " Condenser Circulating Water Pump
12		86 " " " " " "
13		86 " " " " " "
14		86 " " " " " "
15		11 9.5 KV/3.45 KV 1,250 KVA
16		11 9.5 " " " "

46

Miyazu steam - Electric station

Factory Information

1. Name of Company
 - A. Present Name
Japan Electric Generation & Transmission Co. Ltd.
 - B. Former Name
Kyoto Electric Co. Ltd.
2. Name of Plant
 - A. Present Name
Miyazu Steam Electric Station
 - B. Former Name
Miyazu 2nd Steam Electric Station
3. Location of Company & Plant
 - A. Location of Company
No. 11, 1 chōme, Koishikawa-chō, Koishikawa-ku, Tokyo-to.
 - B. Location of Plant
Shishizaki, Miyazu town, Yosa district, Kyoto Prefecture.
4. Representatives of Company & Plant
 - A. Representative of Company
Eichi Ōnishi
 - B. Representative of Plant
Kuniaki Kaneko

A. Location of Company

No. 11, 1 chōme, Koishikawa-chō, Koishikawa-ku, Tokyo-to.

B. Location of Plant

Shishizaki, Miyazu town, Yosa district, Kyoto Prefecture.

4. Representatives of Company & Plant

A. Representative of Company

Eichi Ōnishi

B. Representative of Plant

Kuniaki Kaneko

5. Date Incorporated & Commenced Operation of Company & Plant

A. Date Incorporated Company

April, 1939.

B. Date Commenced Operation Plant

December, 1936.

6. History of Plant

(1) July, 15th, 1935. Approved to new-construct.

(2) December, 27th, 1935. Approved to commence construction.

(3) December, 13th, 1936. Approved to provisional use.

Common Output 10,000 K.W. Supply output 3,000 K.W.

Total Output 13,000 K.W.

(4) February, 10th, 1937. Approved to formal use.

Common Output 10,000 K.W.

(5) September, 22nd, 1937. Approved to provisional use.

(6). November, 20th, 1937. Approved to formal use.

Description.

(1) January, 30th, 1937.

According to the repair of damage of No.2 Generator, output was limited to 10000^{K.W.} at the occasion of approved to formal use, February, 10th.

(2) September, 21st, 1937.

According to the finishing of repair & formal test operation, output was recovered to 13,000^{K.W.} under date of 22nd.

(3) March, 21st, 1944.

2 Static Condensers (11^{KV.} 5000^{K.V.A.}) were additionally constructed.

7. Area & Floor Space of Plant.

A. Area 45,458 m²

B. Floor Space Mainbuilding 2165 m² others 1814 m²

8. Yearly Production from 1934 to 1936.

1934 — 0
1935 — 0
1936 — 780250 K.W.H.

9. Yearly Production from 1937 to 1945.

1937 — 6,596,270 K.W.H.
1938 — 3,938,300 "
1939 — 1,541,250 "