

Land of H. A. Middleton

South Bay Street 50 ft  
750 ft

Post 320 589 15 E 540

Post 320 210

Wharf

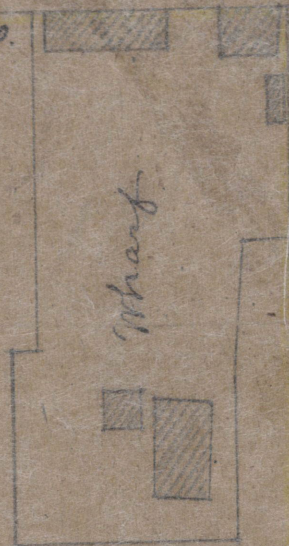

800 ft

J. S. Bailey

Ashley

River

Edge of channel by Taylor 1771 by Purcell 1799

State of South Carolina }  
Charleston District }

Pursuant to a Warrant from Thomas S. Jones  
Deputy Surveyor General for Charleston District dated <sup>14<sup>th</sup></sup> August 1848 and to me  
directed, I have admeasured and laid out unto William Bird Esq. A Tract  
of Land consisting of high shoal and low water lots containing in the  
whole fourteen acres & eight tenths of an acre a portion of which is supposed  
to be vacant. Situate in the Parish of St. Michael, Charleston District.  
Having such form marks and boundaries as the above  
plat represents, Certified this Nineteenth day of August A.D. 1848

Scale 100 ft per inch

Signed  
Robt R Payne

Copied January 8<sup>th</sup> 1856 from a paper  
(well drawn) among R. R. Paynes papers by  
John W. Michel

Land formerly of Charles Sumner  
116 30 E 615 ft