

MI  
4  
034  
1903  
M996.





7935

## Bentley Historical Library

The University of Michigan • Ann Arbor

Rebound through the generosity

of

Marguerite N. Lambert







PLAT BOOK  
OF

OGEMAW

COUNTY  
MICHIGAN.

Drawn from Actual Surveys and the County Records.  
by

P.A. & J.W. MYERS,  
SURVEYORS AND DRAUGHTSMEN.

PUBLISHED BY  
THE CONSOLIDATED PUBLISHING CO.

610 Boston Block.  
MINNEAPOLIS, MINN.  
1903

Engraved by  
BALLIET & VOLK,  
27 So. 6<sup>th</sup> St. Phila.



6-7-49 iVF

### TOWNSHIPS

	PAGE		PAGE
<i>lacking</i> Cumming . . . . .	20	Hill . . . . .	21
✓ Churchill . . . . .	14	Knacking . . . . .	19 <i>lacking</i>
✓ Edwards . . . . .	8	Rose . . . . .	25 <i>lacking</i>
Foster . . . . .	18 23	Logan . . . . .	15 <i>lacking</i>
✓ Goodar . . . . .	24	✓ Richland . . . . .	10 11
✓ Horton . . . . .	9	✓ West Branch . . . . .	12 13

### CITIES AND TOWNS

	PAGE		PAGE
Beaver . . . . .	23	✓ Rose City . . . . .	22
Lupton . . . . .	16 17	South Branch . . . . .	16 <i>lacking</i>
Ogemaw Springs . . . . .	16	Selkirk . . . . .	28 <i>lacking</i>
Prescott . . . . .	28	West Branch . . . . .	26 27 <i>lacking</i>

### MISCELLANEOUS

	PAGE		PAGE
✓ Ogemaw County Outline . . . . .	6 7	Farmers' Directory . . . . .	37 38 39
Michigan State Map . . . . .	30 31	Table of Contents . . . . .	3
Government Surveys . . . . .	4	Title Page . . . . .	1
Patron's Directory . . . . .	33 34 35 36	Explanations . . . . .	8



# TABLE OF CONTENTS

## OGEMAW COUNTY, MICHIGAN

### TOWNSHIPS

	PAGE		PAGE
Cumming . . . . .	20	Hill . . . . .	21
Churchill . . . . .	14	Klacking . . . . .	19
Edwards . . . . .	8	Rose . . . . .	25
Foster . . . . .	18 23	Logan . . . . .	15
Goodar . . . . .	24	Richland . . . . .	10 11
Horton . . . . .	9	West Branch . . . . .	12 13

### CITIES AND TOWNS

	PAGE		PAGE
Beaver . . . . .	28	Rose City . . . . .	22
Lupton . . . . .	16 17	South Branch . . . . .	16
Ogemaw Springs . . . . .	16	Selkirk . . . . .	28
Prescott . . . . .	28	West Branch . . . . .	26 27

### MISCELLANEOUS

	PAGE		PAGE
Ogemaw County Outline . . . . .	6 7	Farmers' Directory . . . . .	37 38 39
Michigan State Map . . . . .	30 31	Table of Contents . . . . .	3
Government Surveys . . . . .	4	Title Page . . . . .	1
Patron's Directory . . . . .	33 34 35 36	Explanations . . . . .	8



# GOVERNMENT SURVEYS

FROM INSTRUCTIONS BY J. A. WILLIAMSON, COMMISSIONER.

## HISTORICAL.

The rectangular system of surveying Government lands, termed the Land System of the United States, was adopted by an act of Congress passed May 20, 1785. The ordinance provided for townships six miles square, containing thirty-six sections of one mile square. The region embraced by the surveys under this law forms a part of the present State of Ohio, and is usually styled "Old Seven Ranges." The townships, six miles square, were laid out in ranges, extending northward from the Ohio River, the townships being numbered from south to north, and the ranges from east to west. In these initial surveys only the exterior lines of the townships were surveyed and mile corners were established on the township lines, but the plats were marked by subdivisions into sections of one mile square. The sections were numbered from one to thirty-six, commencing with number one in the southeast corner of the township, and running from south to north in each tier to number thirty-six in the northwest corner of the township. These first public surveys were made under the direction of the Geographer of the United States.

The act of Congress approved May 18, 1796, provided for the appointment of a surveyor-general, and directed the survey of the lands northwest of the Ohio River and above the mouth of the Kentucky River, "in which the titles of the Indian tribes have been extinguished." Under this law one-half of the township surveyed were subdivided into sections "by running through the same, each way, parallel lines at the end of every two miles, and by making a corner on each of said lines at the end of every mile," and it further provided that "the sections shall be numbered, respectively, beginning with the number one in the northeast section, and proceeding west and east alternately, through the township, with progressive numbers till the thirty-sixth be completed." This method of numbering the sections is still in use.

The act of Congress, approved February 11, 1805, directs the subdivision of the public lands into quarter sections, and provides that all the corners marked in the public surveys shall be established as the proper corners of sections or subdivisions of sections which they were intended to designate, and that corners of half and quarter sections not marked shall be placed as nearly as possible "equidistant from those two corners which stand on the same line."

The act of Congress, approved April 25, 1812, provided "That there shall be established in the Department of the Treasury an office to be denominated the General Land Office, the chief officer of which shall be called the Commissioner of the General Land Office, whose duty it shall be, under the direction of the head of the department, to superintend, execute, and perform all such acts and things touching or respecting the public lands of the United States and other lands patented or granted by the United States, as have heretofore been directed by law to be done or performed in the office of the Secretary of State, of the Secretary and Register of the Treasury, and of the Secretary of War, or which shall hereafter by law be assigned to the said office."

The act of Congress approved July 4, 1836, provided for the reorganization of the General Land Office, and that the executive duties of said office "shall be subject to the supervision and control of the commissioner of the General Land Office under the direction of the President of the United States." The repealing clause is, "That such provisions of the act of the twenty-fifth of April, in the year one thousand eight hundred and twelve, entitled 'An act for the establishment of a General Land Office in the Department of the Treasury,' and of all acts amendatory thereof as are inconsistent with the provisions of this act, be, and the same are hereby, repealed."

From the wording of this act it would appear that the control of the General Land Office was removed from the Treasury Department, and that the Commissioner reported directly to the President, but as a matter of fact, the Secretary of the Treasury still had supervisory control, for the act of Congress, approved March 3, 1849, by which the Department of the Interior was established, provided "That the Secretary of the Interior shall perform all the duties in relation to the General Land Office, of supervision and appeal, now discharged by the Secretary of the Treasury." By this act the General Land Office was transferred to the Department of the Interior, where it still remains.

## RECTANGULAR SYSTEMS.

The public lands of the United States are ordinarily surveyed into rectangular tracts bounded by lines conforming to the cardinal points. The principal lines are designated as meridian, base, township, range, and section lines, and the bodies of land thus formed are known as townships, sections, and lots. The first recorded use of the terms "township" and "section," as applied to the public lands of the United States, is in an ordinance reported to Congress April 26, 1785.

## SURVEYING.

Initial points from which the lines of the public surveys are to be extended must be established whenever necessary under such special instructions as may be prescribed in each case by the Commissioner of the General Land Office. The locus of such initial points must be selected with great care and due consideration for their prominence and easy identification, and must be established astronomically. The initial point having been established, the lines of the public survey are to be extended therefrom as follows:—

## PRINCIPAL MERIDIAN AND BASE LINES

are extended north and south and east and west from the initial point by the use of solar instruments or transits, as may be directed by the Surveyor General. In order to check errors in measurement, two sets of chainmen, operating independently of each other, must

be employed, and the proper corners established. Principal meridians are designated by number or name, as the Fourth and Fifth principal meridians in Illinois, Wisconsin, Minnesota, Iowa, Missouri, and eastern Dakota, or the "Black Hills" meridian in western Dakota, and the Salt Lake meridian in Utah.

## STANDARDS AND AUXILIARIES.

Standard parallels, which are also called correction lines, and auxiliary or guide meridians, are run from time to time, and are designated by number, and as north, south, east, or west, as the case may be, from their respective base lines and principal meridians; parallels and auxiliaries are now run at intervals of twenty-four miles, dividing the country into tracts of twenty-four miles square, or sixteen townships.

## TOWNSHIPS AND RANGES.

Township lines are run east and west parallel with and six miles from the base line and from each other, and the spaces between these lines are known as townships north or south, and designated by numbers according to their numerical distance from the base line. Range lines are run north and south on a true meridian, six miles from and parallel, as near as may be, with the principal meridian, and the spaces between them are known as ranges, and are described as east or west of the principal meridian, and consecutively numbered from that line. The bodies of land six miles square, formed by the intersection of the township and range lines, are called

## CONGRESSIONAL TOWNSHIPS.

and contain, as near as may be, 23,040 acres. Congressional townships are described and located as being north or south of the base line and east or west of the Principal Meridian from which that particular survey is made. Thus township one north, range three west of the Fifth principal meridian, would be the first township north of the base line and in the third range west from the principal meridian. The law requires that the lines of the public surveys shall be governed by the true meridian, and that the townships shall be six miles square, two things involving, in connection, a mathematical impossibility, for, strictly to conform to the meridian, necessarily throws the township out of square, by reason of the convergency of the meridians, and hence, by adhering to the true meridian, results the necessity of departing from the strict requirements of law, as respects the precise area of townships and the subdivisional parts thereof, the townships assuming something of a trapezoidal form, which inequality develops itself more and more as such, the higher the latitude of the surveys.

Congressional townships are subdivided into thirty-six tracts, called

## SECTIONS.

each containing as near as may be 640 acres. The thirty-six sections into which a township is subdivided are numbered, commencing with number one at the northeast angle of the township, and proceeding west to number six, and thence proceeding east to number twelve, and so on, alternately, until they number thirty-six in the southeast angle. In all cases of surveys of fractional townships, the sections should bear the same number as they would if the township was full. In all cases where the exterior lines of the townships, thus subdivided into sections or half sections, shall exceed, or shall not extend six miles, the excess or deficiency shall be specially noted, and added to or deducted from the western or northern ranges of sections or half sections in such township, according as the error may be in running the lines from east to west, or from south to north; the sections and half sections bounded on the northern and western lines of such townships shall be sold as containing only the quantity expressed in the returns and plats respectively, and all others as containing the complete legal quantity.

Sections are divided into quarters by straight lines run from the established quarter section corners—United States surveys—to the opposite corresponding corners, and the point of intersection of the lines so run will be the corner common to the several quarter sections, or, in other words, the legal centre of the section; these quarter sections are designated as northeast quarter, northwest, southwest, or southeast, according to their location with regard to their common corner.

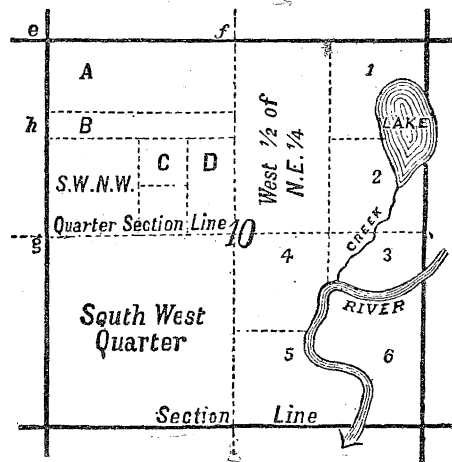

In the subdivision of quarter sections, the quarter quarter corners are to be placed at points equidistant between the section and quarter section corners and between the quarter corners and the common centre of the section, except on the last half mile of the lines closing on the north or west boundaries of a township, where they should be placed at twenty chains, proportionate measurement, to the north or west of the quarter section corner.

Fractional sections and those containing meandered rivers and lakes are also divided into 40 acre lots, as near as may be, these fractional lots are numbered from one upwards in each section. By an examination of the accompanying diagram and of the maps on the other pages of this work, the careful student will be enabled to describe or locate any piece of land. Numbers 1, 2-6 are the numbers of the meandered lots. A is the north sixty acres of the north half of the northwest quarter; B, south twenty acres north half northwest quarter; C, northwest quarter of the southeast of the northwest quarter; D, east one-half southeast northwest; e is the section corner, f north quarter corner, g west quarter corner, h quarter quarter corner.

Proceeding down stream, the bank on the left hand is termed the "left bank" and that on the right hand the "right bank." These terms are to be universally used to distinguish the two banks of a river or stream.

## MARKING LINES.

All lines on which are to be established the legal corner boundaries are to be marked after this method, viz: Those trees which may intercept your line must have two chops or notches cut on each side of them without any other marks whatever. These are called "sight trees" or "line trees." A sufficient number of other trees standing within fifty links of the line, on either side of it, are to be blazed on two sides diagonally, or quartering towards the line, in order to render the line conspicuous and readily to be traced, the blazes to be opposite each other, coinciding in direction with the line where the trees stand very near it and to approach nearer each other the farther the line passes from the blazed trees. Due care must ever be taken to have the lines so well marked as to be readily followed, and to cut the blazes deep enough to have recognizable scars as long as the tree shall stand. Where trees two inches or more in diameter are found, the required blazes must not be omitted. Bushes on or near the line should be bent at right angles therewith, and receive a blow of the axe at about the usual height of blazes from the ground sufficient to leave them in a bent position, but not to prevent their growth.

## CORNERS.

The following are the different points for perpetuating corners, viz: For township boundaries, at intervals of every six miles. For section boundaries, at intervals of every mile, or eighty chains. For quarter section boundaries, at intervals of every half mile, or forty chains; exceptions, however, occur, as has already been explained. Meander corners are established at all those points where the lines of the public surveys intersect the banks of such rivers, bayous, lakes, or islands as are by law directed to be meandered. Corners may be marked by a cross (x) marked at exact corner point on a rock in place, or by marks on a tree growing at the corner. Corners are also marked by stones, posts, burnt stakes, charcoal, mounds of stone and earth, and pits. Witness corners or bearing trees are also established to assist in identifying the true corner. Township corners common to four townships, and section corners common to four sections, are to be set diagonally in the earth, with angles in the direction of the lines. All other corners are to be set square, with sides facing the direction of the lines. Stones and posts at township corners are marked with six notches on the edges, stones and posts at section corners are marked on the south and east edges with as many notches as the corner is distant in miles from the south and east township lines.

## RE-ESTABLISHMENT OF LOST CORNERS.

The original corners, where they can be found, must stand as the true corners they were intended to represent, even though not exactly where strict professional care might have placed them in the first instance.

Missing corners should be re-established in the identical localities they originally occupied. When the point cannot be determined by the existing landmarks in the field, resort must be had to the field notes of the original survey. The law provides that the lengths of the lines, as stated in the field notes shall be considered as the true lengths thereof, and the distances between corners set down in the field notes constitute proper data from which to determine the true locality of a missing corner; hence the rule that all such should be restored at distances proportionate to the original measurements between existing original corners. That is, if the measurement between two existing corners differs from that state in the field notes, the excess or deficiency should be distributed proportionately among the intervening section lines between the said existing corners standing in their original places. Missing corners on standard township and range lines should be restored by proportionate measurement between the nearest existing original corners on those lines. Missing section corners in the interior of townships should be re-established at proportionate distances between the nearest existing original corners north and south of the missing corners.

As has been observed, no existing original corner can be disturbed, and it will be plain that any excess or deficiency in measurements between existing corners cannot in any degree affect the distances beyond said existing corners, but must be added or subtracted proportionately to or from the intervals embraced between the corners which are still standing.







OUTLINE MAP OF  
**OGEMAW CO.**  
 MICHIGAN.

Scale 480 rods to 1 inch.

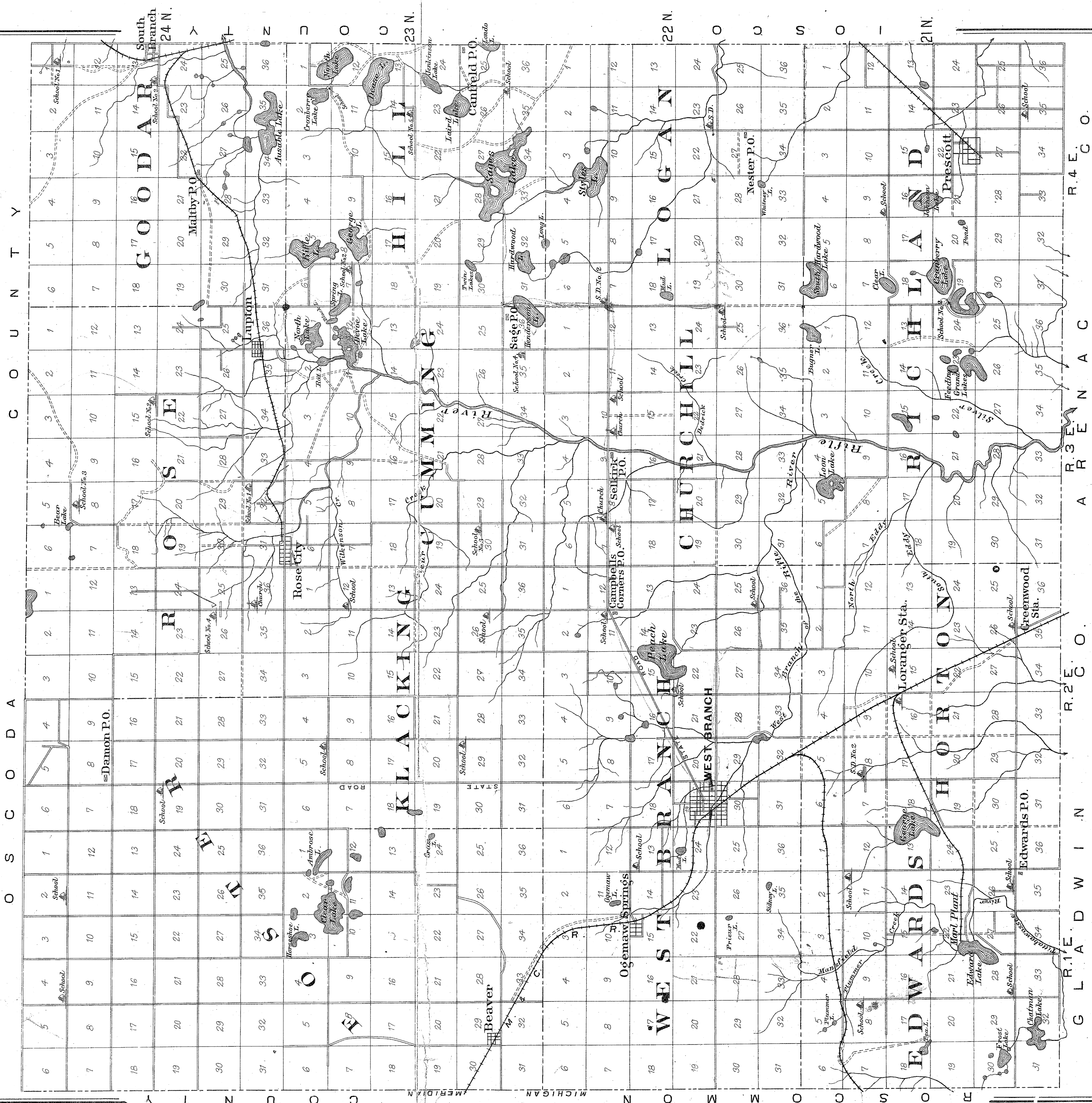

Copyright, 1900, by Ogemaw Co. This map is published by Ogemaw Co. at the General Land Office, Washington, D.C.





EXPLANATION.

- Section Line.....
- Farm or Lot Line.....
- Wagon Road.....
- Railroad.....
- Creeks & Springs.....
- Houses.....
- Churches.....
- School Houses.....
- Adjacent Lands owned by same party connected by a hook thus.....
- Post Office.....
- County Bridge.....
- Coal, Lead or Zinc Mine.....

# PLAT OF EDWARDS

Township 21 North, Range 1 East.  
of the Michigan Meridian.

Scale: 2 inches to the Mile.

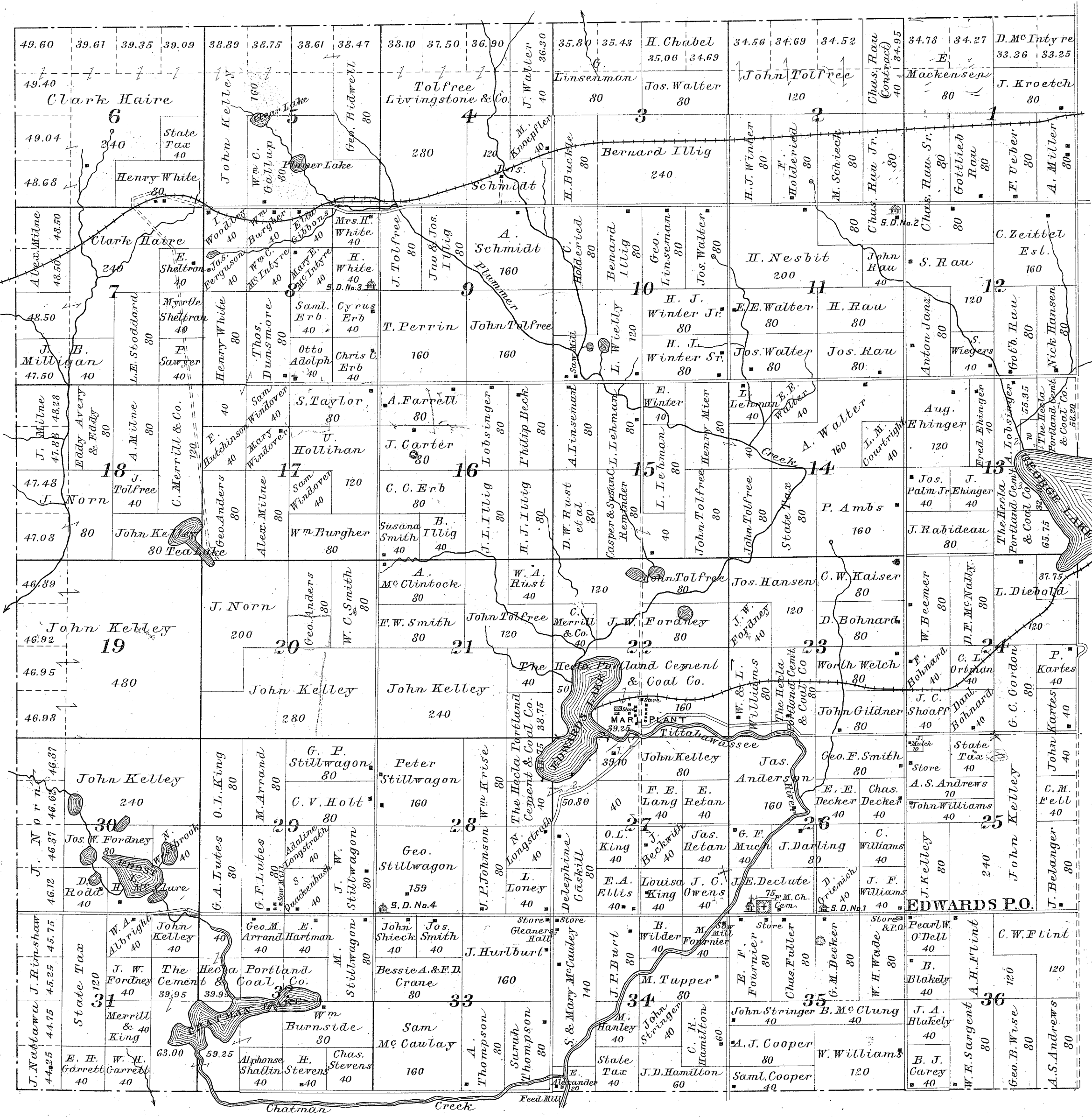

# PLAT OF HORTON

Township 21 North, Range 2 East.  
of the Michigan Meridian.

Scale: 2 inches to the Mile.

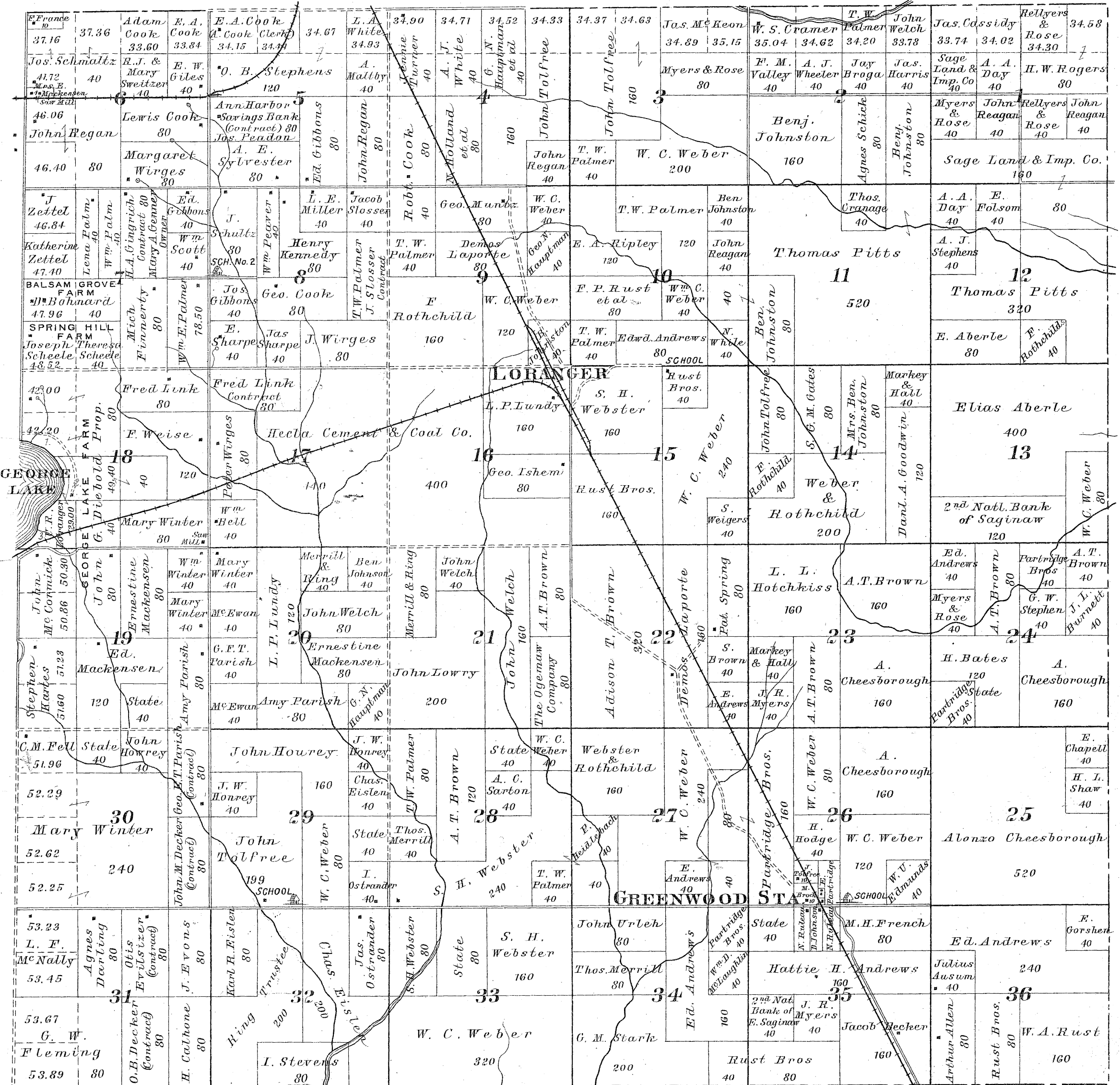



# PLAT OF RICHLAND

Township 21 North, Range 3 East.  
of the Michigan Meridian.

Scale: 2 inches to the Mile.

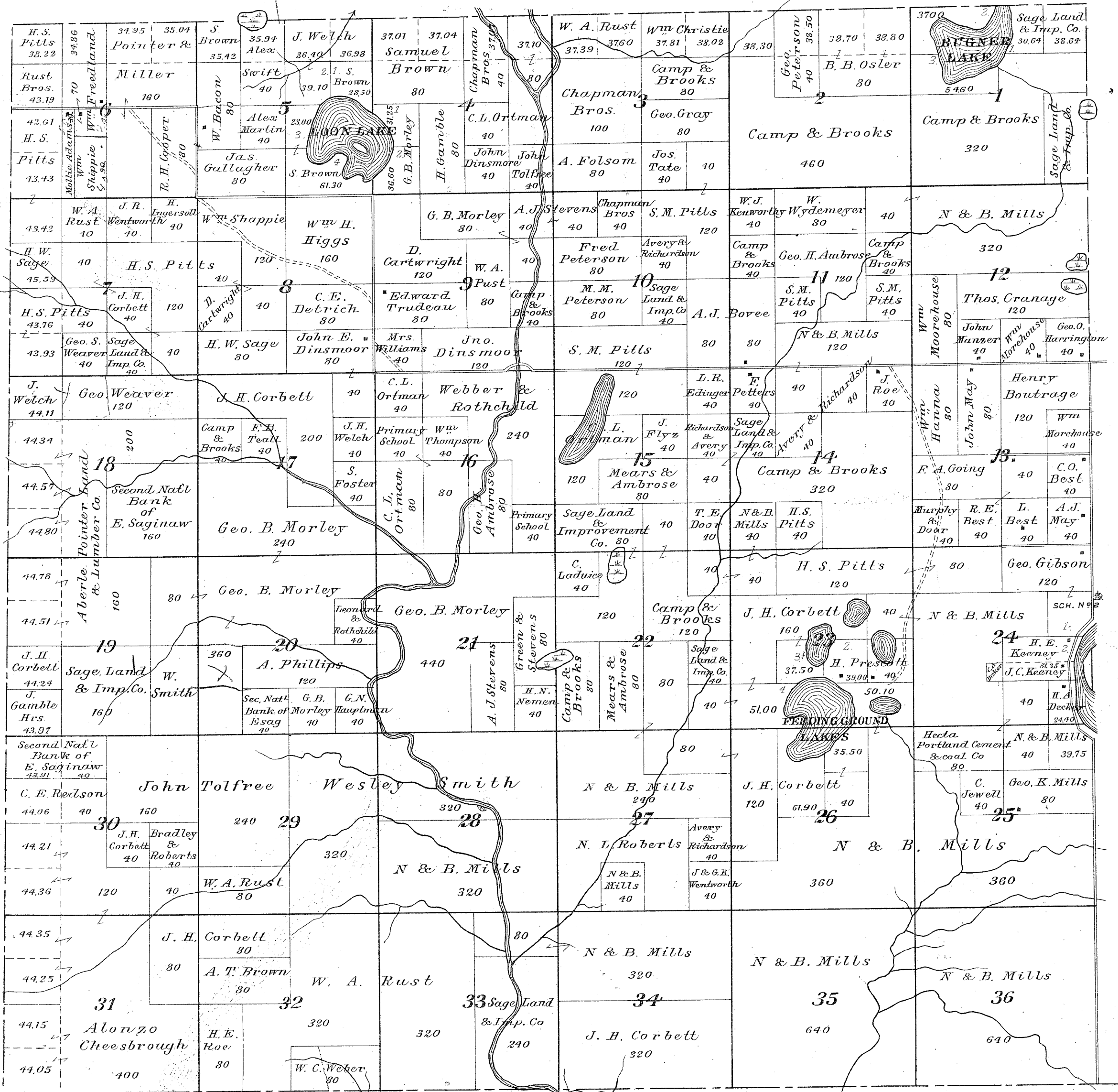

# PLAT OF RICHLAND

Township 21 North, Range 4 East.  
of the Michigan Meridian.

Scale: 2 inches to the Mile.

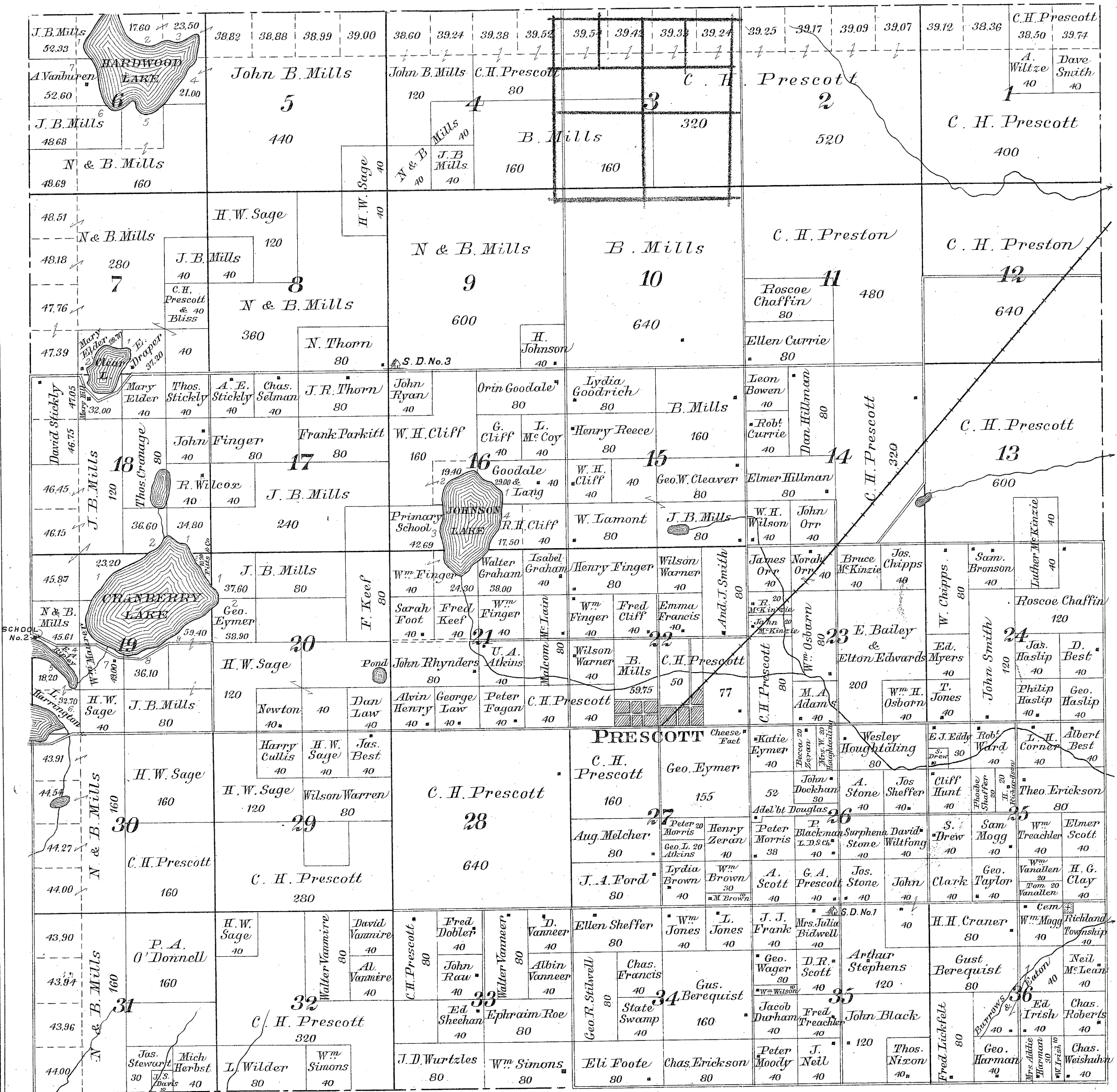



# PLAT OF WEST BRANCH

Township 22 North, Range 1 East.  
of the Michigan Meridian.

Scale: 2 inches to the Mile.

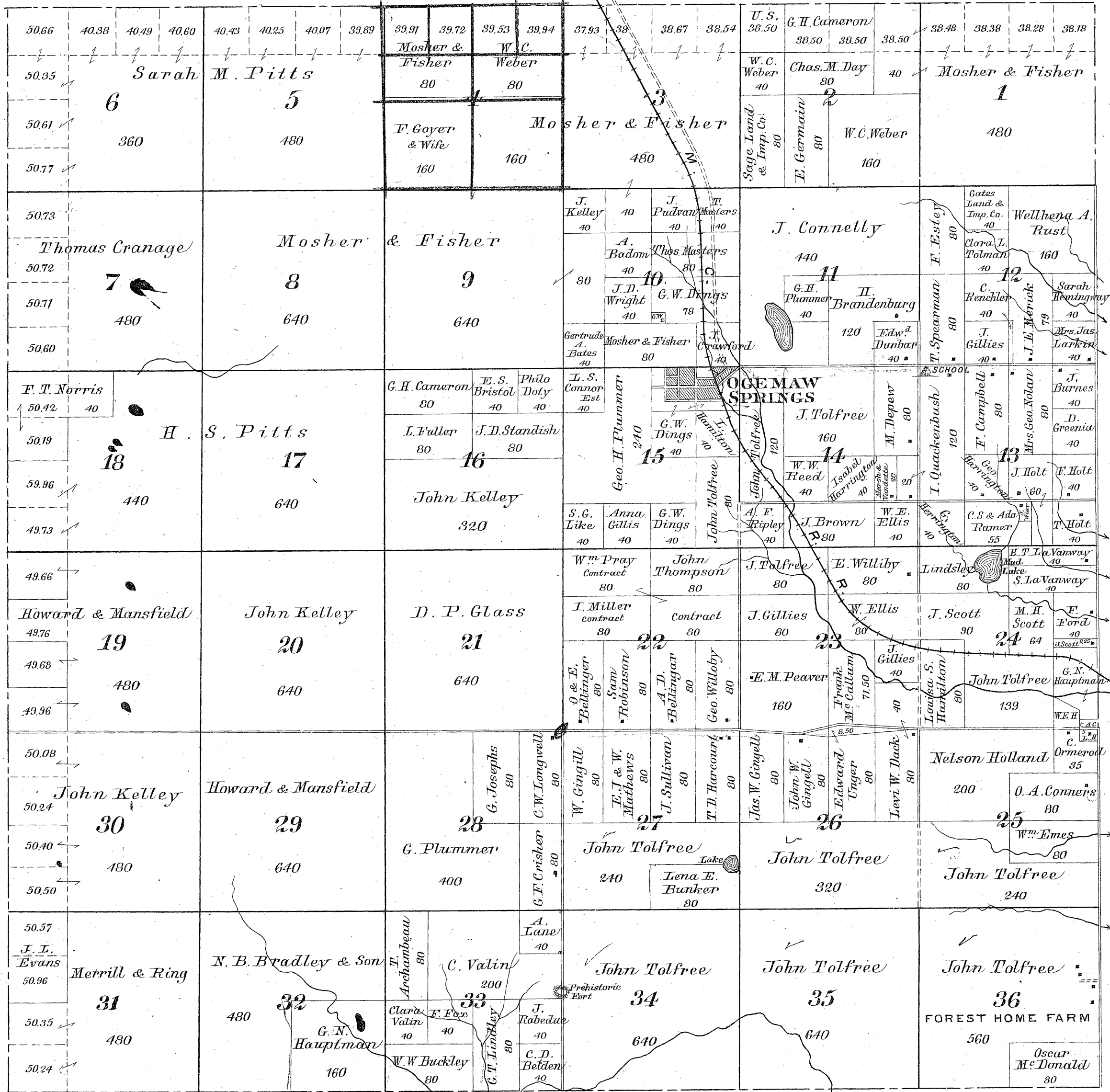

# PLAT OF WEST BRANCH

Township 22 North, Range 2 East.  
of the Michigan Meridian.

Scale: 2 inches to the Mile.

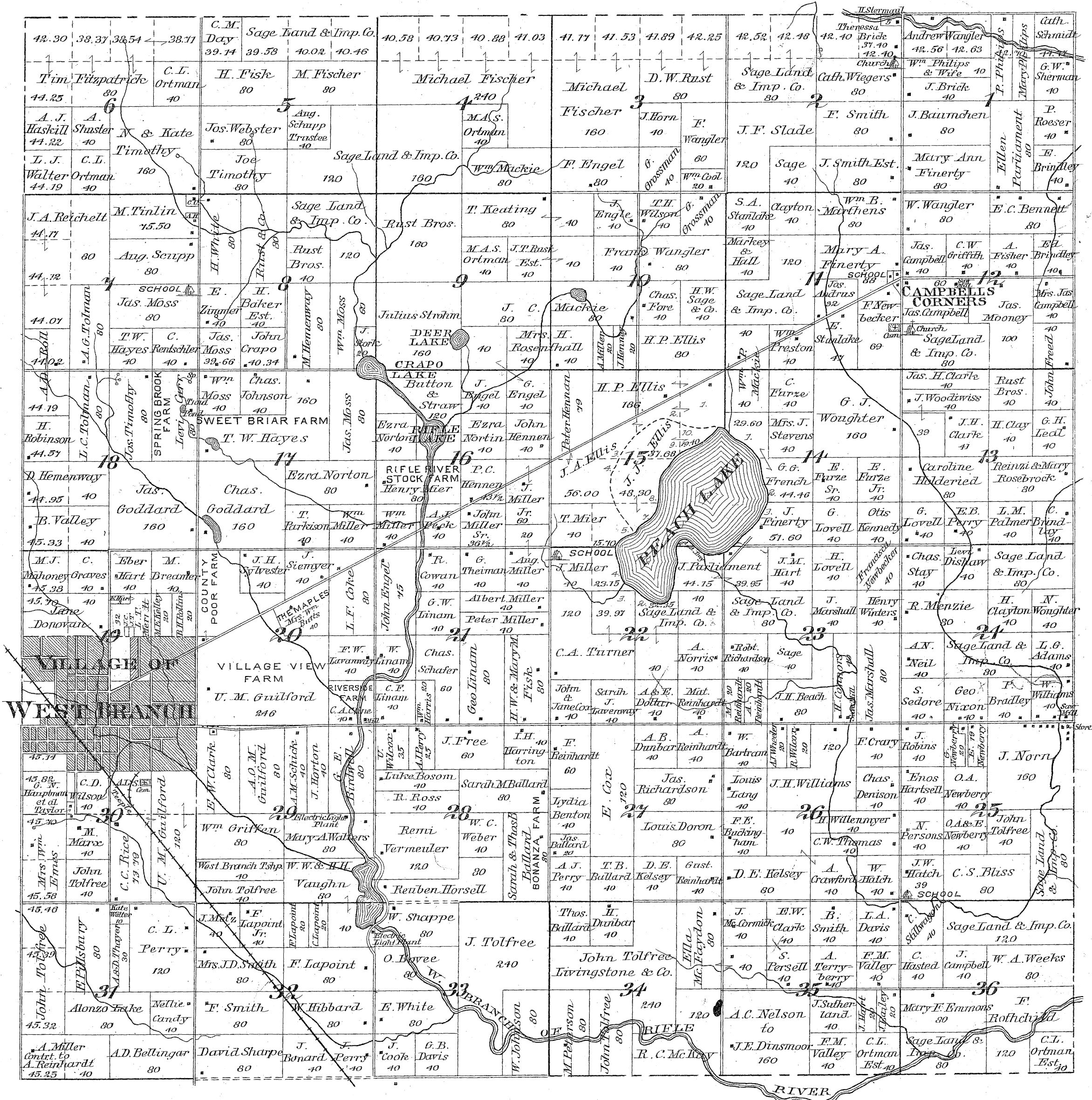





Missing  
page



Missing  
page

Missing  
page



Missing  
page

Missing  
page



Missing  
page

# PLAT OF HILL

Township 23 North, Range 4 East.  
of the Michigan Meridian.

Scale: 2 inches to the Mile.

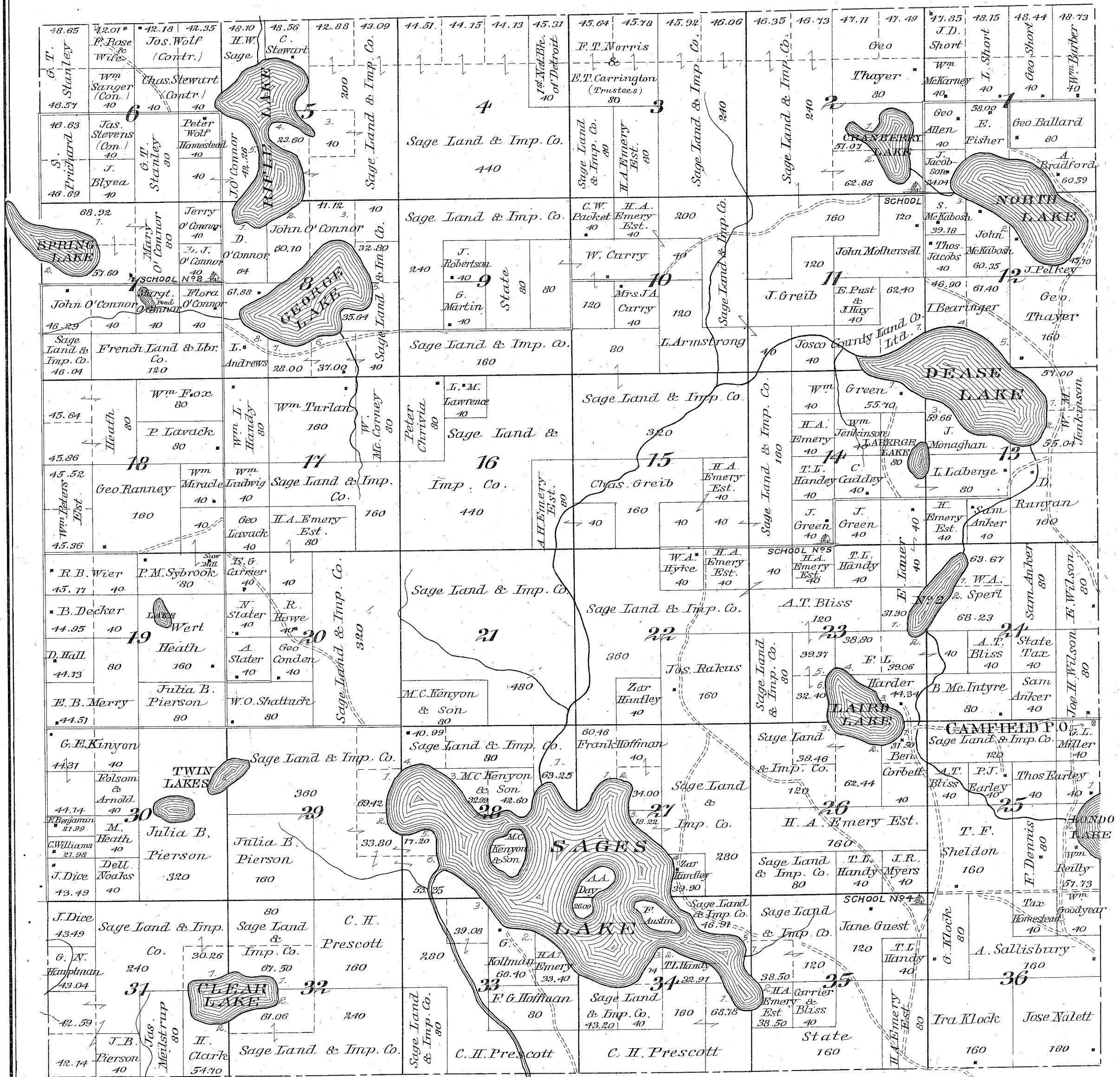





# PLAN OF FOSTER

Township 24 North, Range 1 & 2 East.  
of the Michigan Meridian.  
Scale: 2 inches to the Mile.

40.84 Pheips & Hydrabaugh 40.89 40.82	39.87 J. E. Potts 40.82	39.87 J. C. Watson 80	40.01 Ellis 80	40.15 J. W. Billings 80	40.29 J. H. Durn 39.82	40.26 Jos. Roddin 40.29 40.32 40.35	40.40 Chas. A. Darnalee 80	40.47 Gov. Balknap 40.47 40.52	40.17 A. B. Eliot 80	40.04 Richard Dimock 80	40.26 Mc Cormick 40.33 40.60	40.72 Wm Bentley 80	41.04 Pefer Cook 80	41.20 J. W. Woodrow 130	41.83 M. Hawley 40	42.02 M. E. Stauffer 40	
40.50 Nellie Hathwell 40.64	40.80 Geo. Renwick 160	40.80 John Frey Doolittle 160	40.80 W. Hunt 160	40.80 Nichols & Shepard 160	40.80 H. W. Diamond 160	40.80 W. Hunt 160	40.80 W. M. Rabiden 160	40.80 G. O. Smith 80	40.80 A. J. F. Cox 160	40.80 Geo. Beacham 160	40.80 William M. Cormick 160	40.80 Geo. Beacham 160	40.80 Frank Fisdale & Harman 160	40.80 J. W. Woodrow 130	40.80 M. E. Stauffer 40	42.02 M. E. Stauffer 40	
40.50 J. L. & S. R. R. Co. 40.27	40.80 W. E. Kennedy 160	40.80 Jas. C. Donnelly 160	40.80 W. E. Kennedy 160	40.80 T. Ballock 160	40.80 M. W. Durham 160	40.80 W. E. Kennedy 160	40.80 L. T. Hotge 160	40.80 U. S. 40	40.80 A. J. Warner 160	40.80 J. W. Potts 160	40.80 J. W. Potts 160	40.80 J. W. Potts 160	40.80 A. J. Warner 160	40.80 J. W. Potts 160	40.80 A. J. Warner 160	40.80 A. J. Warner 160	
40.50 J. C. Larson 40.07 39.82	40.80 U. S. 240	40.80 J. L. & S. R. R. Co. 170	40.80 J. L. & S. R. R. Co. 170	40.80 W. M. Hubble 160	40.80 H. W. Fiske 160	40.80 W. M. Hubble 160	40.80 J. F. Durham 160	40.80 H. M. Hoar 160	40.80 S. Wash 80	40.80 S. Wash 80	40.80 S. Wash 80	40.80 S. Wash 80	40.80 S. Wash 80	40.80 S. Wash 80	40.80 S. Wash 80	40.80 S. Wash 80	40.80 S. Wash 80
40.84 W. M. Keeler 160	40.80 C. M. Hobson 80	40.80 H. W. Sage Est 80	40.80 W. M. Keeler 160	40.80 W. M. Lewis 160	40.80 W. M. Lewis 160	40.80 W. M. Lewis 160	40.80 W. M. Lewis 160	40.80 W. M. Lewis 160	40.80 W. M. Lewis 160	40.80 W. M. Lewis 160	40.80 W. M. Lewis 160	40.80 W. M. Lewis 160	40.80 W. M. Lewis 160	40.80 W. M. Lewis 160	40.80 W. M. Lewis 160	40.80 W. M. Lewis 160	40.80 W. M. Lewis 160
42.07 J. & K. Wentworth 42.22	42.22 H. J. Cutting 80	42.22 U. S. 80	42.22 H. J. Cutting 80	42.22 H. J. Cutting 80	42.22 H. J. Cutting 80	42.22 H. J. Cutting 80	42.22 H. J. Cutting 80	42.22 H. J. Cutting 80	42.22 H. J. Cutting 80	42.22 H. J. Cutting 80	42.22 H. J. Cutting 80	42.22 H. J. Cutting 80	42.22 H. J. Cutting 80	42.22 H. J. Cutting 80	42.22 H. J. Cutting 80	42.22 H. J. Cutting 80	42.22 H. J. Cutting 80
42.69 J. L. & S. R. R. Co. 42.78	42.69 R. G. Hart 320	42.69 J. L. & S. R. R. Co. 480	42.69 R. G. Hart 320	42.69 R. G. Hart 320	42.69 R. G. Hart 320	42.69 R. G. Hart 320	42.69 R. G. Hart 320	42.69 R. G. Hart 320	42.69 R. G. Hart 320	42.69 R. G. Hart 320	42.69 R. G. Hart 320	42.69 R. G. Hart 320	42.69 R. G. Hart 320	42.69 R. G. Hart 320	42.69 R. G. Hart 320	42.69 R. G. Hart 320	42.69 R. G. Hart 320
43.07 J. L. & S. R. R. Co. 43.26	43.07 H. J. Cutting 320	43.07 H. J. Cutting 320	43.07 H. J. Cutting 320	43.07 H. J. Cutting 320	43.07 H. J. Cutting 320	43.07 H. J. Cutting 320	43.07 H. J. Cutting 320	43.07 H. J. Cutting 320	43.07 H. J. Cutting 320	43.07 H. J. Cutting 320	43.07 H. J. Cutting 320	43.07 H. J. Cutting 320	43.07 H. J. Cutting 320	43.07 H. J. Cutting 320	43.07 H. J. Cutting 320	43.07 H. J. Cutting 320	43.07 H. J. Cutting 320

# PLAT OF GOODAR

Township 24 North, Range 4 East.  
of the Michigan Meridian.

Scale: 2 inches to the Mile.

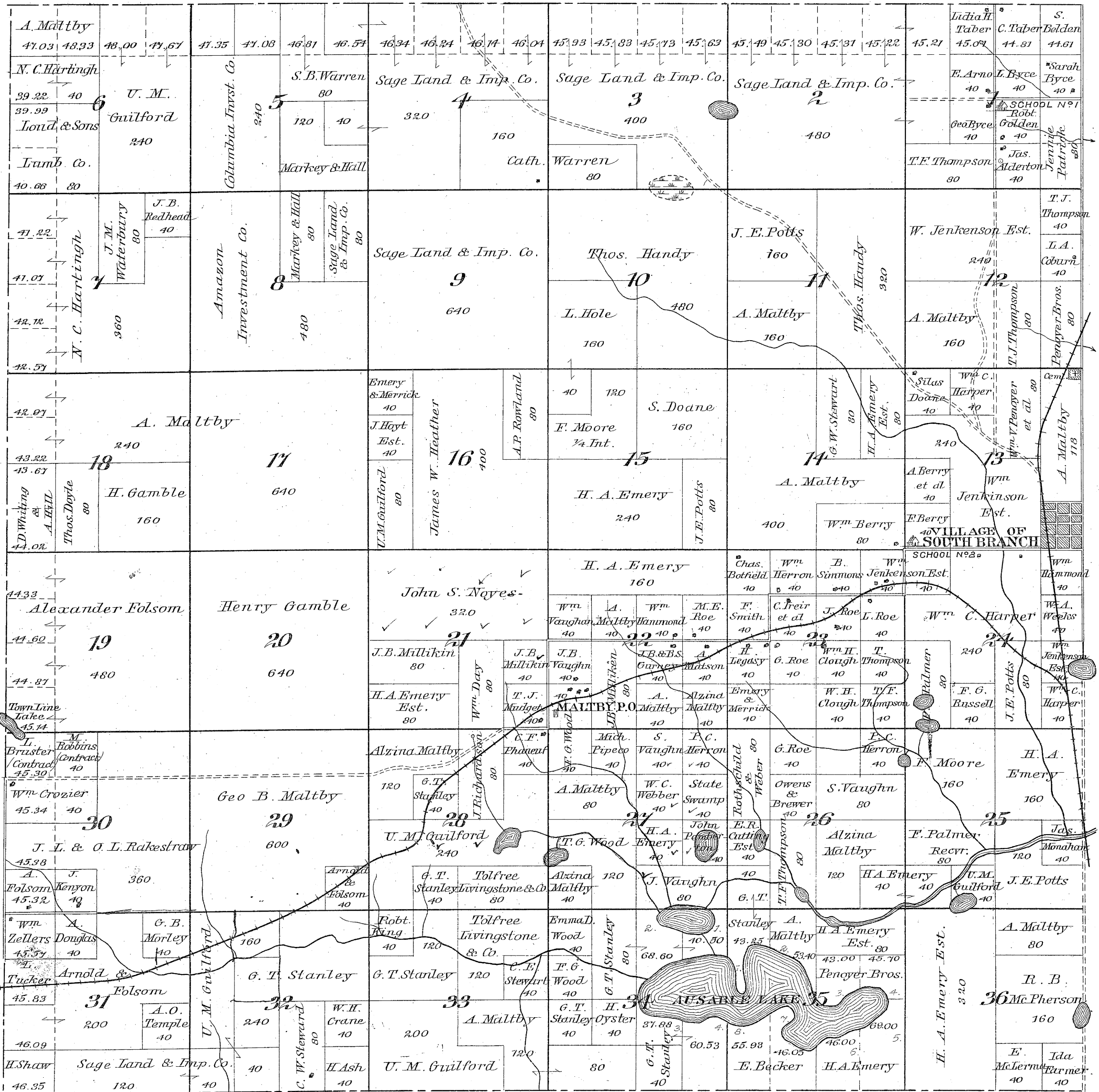



Missing  
page

Missing  
page

Missing  
page



Missing  
page

Missing  
page

Missing  
page



Missing  
page

Missing  
page

# Patron's Directory of Ogemaw County, Michigan.

## CUMMING

NAME	BUSINESS	POSTOFFICE	SEC.
Ammond, Jerry . . .	Farming . . .	Rose City	31
Brown, John H. . .	Farmer and Proprietor of Stage Line to West Branch . . .	Sage	26
Cumming, A. L., Jr. . .	Farmer . . .	Rose City	6
Corwin, J. B. . .	Farmer and Timber Jobber . . .	Sage	36
Camp, Robert . . .	Farmer . . .	Selkirk	35
Craft, George, Sr. . .	Farmer . . .	Rose City	20
Craft, Henry . . .	Farmer . . .	Rose City	19
Knight, John . . .	Farmer . . .	Sage	25
Morrison, Frank . . .	Farmer and Supervisor . . .	Rose City	29
Pettit, Norman . . .	Farming . . .	Sage	36
Roll, Peter . . .	Farming . . .	Rose City	30
Rose, Willard . . .	Farmer and Lumber Manufacturer . . .	Rose City	7
Smith, L. F. . .	Farmer and Blacksmith . . .	Rose City	9
Scheistel, Albert . . .	Farmer, Stone Mason, Bricklayer and Plasterer . . .	Rose City	19
Schick, Joseph . . .	Farmer . . .	Rose City	29

## CHURCHILL

Armon, Wm. H. . .	Farming . . .	Selkirk	8
Bedtelyon, John . . .	Farming . . .	Selkirk	20
Bedtelyon, Jay . . .	Farming . . .	Selkirk	20
Carscallen Bros. . .	Dealers in General Merchandise. Butter and Eggs a specialty . . .	Selkirk	9
Carey, W. T. . .	Farming . . .	Selkirk	16
Cummings, Iru P. . .	Farming . . .	Selkirk	8
Dillenbeck, C. H. . .	Farming . . .	Selkirk	6
Dodds, R. A. . .	Farming . . .	Selkirk	25
Ford, Lizzie . . .	Farming . . .	Selkirk	8
Grenica, Almira . . .	Farming . . .	Selkirk	12
Hamlin, Frank A. . .	Dealer in Groceries, Tinware and Notions. Flour, Feed, etc. . .	Selkirk	9
Hodgins, Wm. . .	Farming . . .	Selkirk	2
Jones, Luther . . .	Farming . . .	Selkirk	12
Kuhn, Valentine . . .	General Farming. Proprietor of Maple Shade Farm . . .	Selkirk	17
Merry, Marvin . . .	Farming . . .	Selkirk	7
Nye, James . . .	Farming. Proprietor Spring Brook Farm . . .	Selkirk	8
Norris, W. B. . .	Farming . . .	Selkirk	25
Parliament, John W. . .	Farming . . .	Campbell's Corners	5
Parliament, James . . .	Farming . . .	Campbell's Corners	6
Perkins, P. . .	Farming . . .	Selkirk	3
Peter Bros. . .	Geo. Peters, Gilbert Peters. Manufacturers of Lumber and Shingles . . .	Selkirk	9
Quigley, John N. . .	Farming . . .	Selkirk	10
Selman, Norman . . .	Farming . . .	Prescott	24
Selman, Henry A. . .	Farming . . .	Prescott	24
Sims, Catherine . . .	Farming . . .	Selkirk	3
Struble, G. E. . .	Farming . . .	Selkirk	21
Teepie, A. G. . .	Farming . . .	Selkirk	9
Winslow, W. G. . .	Farming . . .	Selkirk	11

## EDWARDS

Anders, George . . .	Farming . . .	West Branch	8
Anderson, James . . .	Farming . . .	Edwards	26
Burgher, Wm. M. . .	Farming . . .	West Branch	8
Bellanger, John . . .	Farming . . .	Alger	25
Darling, John L. . .	Farming . . .	Alger	26
Decker, C. A. . .	Farming . . .	Edwards	26
Declute, John E. . .	Farming . . .	Alger	26
Erb, Cyrus . . .	Farming . . .	West Branch	8
Force, Charles . . .	Farming . . .	West Branch	12
Ferguson, James . . .	Farming . . .	West Branch	8
Gallup, Wm. C. . .	Farming . . .	West Branch	5
Holt, Charles A. . .	Farming . . .	Alger	29
Hurlburt, John . . .	Farming . . .	Alger	33
Hartman, Elmer . . .	Farmer and Carpenter . . .	Alger	32
Lehman, Lawrence . . .	Farmer . . .	West Branch	15
Lutes, Geo. A. . .	Farmer and Lumber Manufacturer . . .	Alger	29
Lobsinger, Jos. F. . .	Farmer . . .	West Branch	16
Linsenman, Alphonse . . .	Farmer . . .	West Branch	15
McCaulley, Sam. . .	Farmer . . .	Alger	34
McClintock, A. . .	Farmer . . .	West Branch	21
McIntyre, W. C. . .	Farmer . . .	West Branch	8
Reminder, Casper, Jr. . .	Farmer . . .	West Branch	15
Reminder, Casper, Sr. . .	Farmer . . .	West Branch	15
Rau, Gottlub . . .	Farmer . . .	West Branch	12
Rau, Stephen . . .	Farmer . . .	West Branch	12

## EDWARDS—Continued

NAME	BUSINESS	POSTOFFICE	SEC.
Schmitt, Joseph . . .	Farmer . . .	West Branch	4
Smith, Geo. F. . .	Farmer . . .	Edwards	26
Stillwagon, John W. . .	Farmer . . .	Alger	29
Stillwagon, Peter . . .	Farming . . .	Alger	28
Stillwagon, George . . .	Farming . . .	Alger	28
Taylor, Stewart . . .	Farming . . .	West Branch	17
Fuller, Charles . . .	Farming . . .	Alger	35
Tupper, Mason . . .	Farming . . .	Alger	34
Winter, H. J. . .	Mr. Winter was born in Aghan, Germany, June 24th, 1827; came to America in 1845 and located at Cleveland, O. Was married to Catherine Fransiske Wies, October 10th, 1850. Mrs. Winter was born in Baden, Germany, February 9th, 1824, and came to America in 1845. They moved to Mercer Co., O., in 1859 and from there to Ontario, Canada, in 1867. Moved to Michigan in 1884, and settled on the farm he now owns; he was among the earliest settlers of the township. Moved into the house in which he now resides January, 17th, 1885. They are the parents of 9 children: 7 of whom survive; 3 sons and 4 daughters; all married and living in this township. . . .	West Branch	10
Windover, Samuel . . .	Farmer . . .	West Branch	17
Williams, John . . .	Farmer . . .	Edwards	25

## FOSTER

Aikman, R. C. . .	Lumberman . . .	Beaver Lake	30
Smith, Geo. R. . .	Farming . . .	West Branch	23
Hickey, Oliver J. . .	Farming . . .	Damon	17
Thornton, Wm. W. . .	Hotel Keeper . . .	Damon	17

## GOODAR

Botfield, Charles . . .	Farming . . .	South Branch	23
Doone, Silas . . .	Landlooker and Farmer . . .	South Branch	13
Ewing, L. C. . .	Farming . . .	South Branch	Vil.
Golden, Robert . . .	Farming . . .	South Branch	1
Hammond, Wm. . .	Farming . . .	Maltby	22
Harper, Wm. C. . .	Farming and Lumbering . . .	South Branch	Vil.
Herron, Will . . .	Farming . . .	South Branch	23
Ireir, Chris. . .	Farming . . .	South Branch	23
Legacy, Henry . . .	Dealer in Wines, Liquors and Cigars . . .	South Branch	Vil.
Matson, Andrew . . .	Farming . . .	Maltby	22
Martindale, J. H. . .	Dealer in Wines Liquors, Cigars and Lumbering . . .	South Branch	Vil.
Martindale, Mrs. A. . .	Postmistress and dealer in Groceries . . .	South Branch	Vil.
Patrick, Jennie . . .	Farming . . .	South Branch	1
Phaneuf, C. F. . .	Farming . . .	Maltby	28
Roe, M. E. . .	Farming . . .	South Branch	22
Warren, S. B. . .	Farming . . .	South Branch	4

## HILL

Chrivia, Peter . . .	Farming and Lumbering . . .	Lupton	16
Chrivia, Lenie . . .	Farming and Lumbering . . .	Lupton	16
Dimmick, Albert . . .	Lumber Manufacturer . . .	Lupton	18
Heath, Wirt . . .	Farming . . .	Sage	19
Huntley, Zor . . .	Farming . . .	Canfield	27
Kinyon, G. E. . .	Farming . . .	Sage	30
Klock, Ira . . .	Farming . . .	Canfield	36
Lavack, Peter . . .	Farming . . .	Lupton	18
Lawrence, T. M. . .	Farming . . .	Lupton	16
Mothersell, John . . .	Farming . . .	Elllake	10
Miller, Geo. L. . .	Farming . . .	Canfield	25
McIntyre, Benny . . .	Farming . . .	Canfield	24
Merry, E. B. . .	Farming . . .	Sage	19
Robertson, John . . .	Farming . . .	Lupton	9
Shattuck, W. O. . .	Farming . . .	Sage	20
Slater, Arthur . . .	Farming . . .	Lupton	20
Wilson, J. H. . .	Farming . . .	Canfield	24



**HORTON**

NAME	BUSINESS	POSTOFFICE	SEC.
Bohnard, Donates	Farming	West Branch	7
Becker, Jacob	Farming	Alger	35
Cook, Robert	Farming	West Branch	4
Cook, Adam	Farming	West Branch	5
Cook, George	Farming	West Branch	8
Decker, John M.	Farming	Alger	31
Diebold, John G.	Farming and Breeder of Full Blood and Grade Short Horn Durham Cattle; dealer in Bees, Honey and Wax	West Branch	18
Gibson, Robert	Section Foreman	Edwards	17
Kennedy, Henry	Farming	West Branch	8
Kartes, Stephen	Farming	West Branch	19
LePort, James	Farming	West Branch	22
Lundy, L. P.	Farming	West Branch	16
Link, Fred	Farming	West Branch	18
Muntz, George	Farming	West Branch	9
McCormick, John	Farming	West Branch	19
Mackensen, Edward	Farming	West Branch	6
Parish, Geo. E. T.	Farming	Alger	19
Pearer, Wm.	Farming	West Branch	8
Peden, Joseph	Farming	West Branch	5
Regan, John	Farming	West Branch	6
Stephens, O. B.	Farming	West Branch	5
Scott, Asa	Farming	Edwards	7
Sylvester, A. E.	Farming. Breeder of Full Blood Dorset Sheep. Rams and Ewes for sale	West Branch	5
Scheele, Joseph	Farming	West Branch	7
Winter, Wm.	Farming, Threshing and Lumber Manufacturing	West Branch	19
Zettel, Jacob	Farming	West Branch	7

**KLACKING**

Blouch, B. F.	Farming	Rose City	9
Clees, M. M.	Farming	Rose City	1
Crabtree, J. H.	Farming	Rose City	29
Crowder, M. J.	Farming	Rose City	26
Goff, G. G.	Farming	West Branch	29
Hodge, Hiram	Farmer and Justice of the Peace	Rose City	1
McDonald, O. H.	Farming	Rose City	2
Morgan, William	Farming	Rose City	24
McCool, Mrs. Alex.	Farming	Rose City	1
Meadows, F. G.	Farming	Rose City	12
Spering, Gust.	Farming	Rose City	12
Peters, Chas.	Farming	Rose City	14
Reetz, Christopher	Farming	Rose City	35
Reed, James	Farming	Rose City	16
Steuernol, Henry	Farming	Campbell's Corners	25
Schmitt, George	Farming	Campbell's Corners	36
Thornton, Charles	Farming	Rose City	15
Watson, W. A.	Farming	Rose City	1

**LOGAN**

Cameron, Angus	Farming	Nester	20
Jewell, Geo.	Farming	Selkirk	17
McKenney, J. B.	Farming	Nester	28
McDonald, John	Farming	Selkirk	17
Miller, P.	Farming	Nester	20
Miller, J.	Farming	Nester	20
McDonald, John R.	Farming	Nester	26
Prevost, Michael	Farming	Nester	27
Purdee, Chester	Farmer and Saw Filer	Selkirk	8
Rose, Delbert	Farmer, Township Clerk and Postmaster.	Nester	27
Schwartz, Wm.	Farming	Nester	14
Thomas, Geo. S.	Farming	Nester	27

**LUPTON (Village of)**

NAME	BUSINESS
Hole, L.	Dealer in General Merchandise, Cedar Posts and Farm Produce.
Hamilton, James H.	Dealer in Hardware, Farm Machinery and Agricultural Implements, Wagons, Buggies, Paints, Oils, Crockery, Notions and Millinery.
Rakestraw & Son	Joshua R. and Orin L. Dealers in Dry Goods, Boots and Shoes, Groceries and Hardware, Hats, Caps and Clothing, Perfumery, Toilet and Fancy Articles, Wall Paper, Books, Stationery, Notions, etc.
Reid, Alex.	Contractor and Jobber.
Stanley, G. T.	Dealer in Real Estate and Forest Products. Shingles, poles, ties and posts.
Snook, Fred	Dealer in Groceries, Provisions, Posts, Ties and Horse Blankets.

**ROSE CITY (Village of)**

Bell, Frank G.	Hardware, Sporting Goods and Crockery.
Barber, Mrs. Phoebe J.	Proprietor of Restaurant and Boarding House.
Cumming, A. L.	Justice of the Peace, Conveyancing and Collections a specialty. Notary Public with Seal.

**ROSE CITY (Village of)—Continued**

NAME	BUSINESS
Crippen, Jennie	Bakery, Bread, Cakes, Cookies, Doughnuts and all kinds of Baker's Goods at reasonable prices.
Ferguson, Frank	Dealer in Bazaar Goods.
Ingleright, L. R.	Physician and Surgeon.
Karcher, H. S.	Principal of Rose City High School and Dealer in Real Estate.
Landsberg, Max	General Merchandise, Dry Goods and Groceries. Buyer and Seller of everything for cash.
Morton, P. B.	Liveryman. 10 cent Feed Barn in connection.
McLaren, W. J.	General Blacksmith, Horseshoer and Woodworker.
McFadyen, Hugh	Dealer in General Merchandise and Agricultural Implements.
Perkins, W. J.	Barber and Proprietor of Bowling Alley and Pool Rooms. Lunch Counter in connection. Cigars, tobacco, etc. for sale.
Rose City Bank	John Bell, president; John P. Niggeman, vice-president. Money to loan on chattel security or good endorsed notes. Interest allowed on deposits of one dollar and upwards. Drafts drawn available in any part of the United States or Canada. Business and individual accounts received on favorable terms. All business strictly confidential. Special attention given to collections. Wm. J. Bell, cashier.
Ritter, R. O.	Dealer in Wines, Liquors and Cigars.
Rose, A. S.	Gentleman of Leisure.
Straw, Geo. F.	Blacksmithing and General Repairing.
Tulloch, Wm. H.	Dealer in Furniture and Harness. Undertaking. All kinds of road vehicles.
Zailer, Conrad	Proprietor of Rose City Grist Mill. Custom work a specialty

**ROSE TOWNSHIP**

NAME	BUSINESS	POSTOFFICE	SEC.
Arthur, F. B.	Farmer and Stock Raiser. Breeder of thoroughbred Victoria Hogs	Rose City	32
Arnold, Edward O.	Farmer and Carpenter	Rose City	36
Brooks, H. F.	Farming	Rose City	19
Borden, Hiram	Retired. Mr. Borden was born in Sullivan County, N. Y., January 18th, 1840; was married to Hannah Kimball, April 13th, 1859. Mr. Borden responded to his country's call during the War of the Rebellion and enlisted August 16th, 1862, in Company H., 143rd Regiment, N. Y. Vol. Inf., and was mustered out June 28th, 1865, in New York City. He moved to Rose Township, Mich., July 12th, 1877. Mr. and Mrs. Borden are the parents of six children: three sons and three daughters; all of whom are living.	Rose City	24
Cosand, Linton E.	Clerk for Rakestraw & Son	Lupton	32
Campbell, Robert A.	Farming	Rose City	24
Campbell, George	Farming	Rose City	36
Dobson, J. K.	Farmer. Mr. Dobson was born August 26th, 1846, in Mahoning Co., Ohio. Enlisted February 1865 in Company A., 197th Regiment, O. V. Inf., and was discharged in August of the same year. He was married to Mary A. Oyster in April 1869, came to Michigan and located where he now lives, in July 1879; his family joined him in February, 1882. Mr. and Mrs. Dobson are the parents of eight children; six of whom are living; three sons and three daughters.	Lupton	26
Dobson, A. E.	Farming	Lupton	26
Goodridge, Richard E. W.	Bookkeeper for Mr. G. T. Stanley	Lupton	26
Greenway, John	Farming	Lupton	26
Gifford, Robt. H.	Farming	Rose City	25
Hammond, Charles	Farming	Rose City	26
Lewis Bros. D. S. and M. E. Lewis	Farming	Rose City	36
Lindley, I. C.	Farming	Lupton	22
Lupton, I. R.	Farming	Lupton	26
Lupton, Martin	Farming and Poultry Raising, Bee Husbandry and Bee Supplies	Lupton	25
Moore, Ralph	Farming	Rose City	36
Miller Lumber Co.	Manufacturers of Lumber and Shingles	Rose City	33
McCoombes, Wm. W.	Farming	Rose City	13
Miles, J. E.	Farming	Lupton	25
Neal, D. A.	Farmer and Supervisor	Rose City	25
Rowe, J. E.	Farming	Lupton	24
Rose, S. B.	Farming	Rose City	25
Sheppard, James	Farming	Rose City	30
Stevens, Luella B.	Farming	Rose City	26
Stevens, Elmer	Farming and Threshing	Rose City	26
Stark, J. F.	Farming	Lupton	25
Thompson, Annie E.	School Teacher	Rose City	26
Talbot, W. H.	Farming. Born in Huron Co., Ontario, August 6th, 1837, came from there to Michigan in 1876, and located the land where he now lives in the fall of 1877. He was married January 14th, 1874 to Elizabeth Watson. They are the parents of five living children; four daughters and one son	Rose City	33

**ROSE TOWNSHIP—Continued**

NAME	BUSINESS	POSTOFFICE	SEC.
Thompson, D. C.	Farming	Rose City	25
Thielecke, Henry, Jr.	Farming	Lupton	22
Thornton, Fred	Farming	Rose City	36
Wellington, Wm. F.	Farming	Rose City	24
White, E. B.	Carpenter	Rose City	36

**RICHLAND**

Adams, Milton	Farmer	Prescott	23
Blackman, P.	Farmer	Prescott	26
Chaffin, Roscoe	Farmer	Prescott	24
Cliff, Wm. H.	Farmer	Prescott	15
Craner, H. H.	Farmer	Prescott	36
Douglas, Adelbert	Farmer	Prescott	26
Doble, Fred	Farmer	Prescott	32
Dockham, John	Liveryman. Good rigs, reasonable rates,	Prescott	Vil.
Erickson, Theo	Farmer	Prescott	25
Goodrich, Luther	Farmer	Prescott	15
Harman, George	Farmer	Prescott	36
Karr, Adney	Farmer	Prescott	1
Mills, Barney	Farmer. Dealer in general merchandise and real estate.	Prescott	Vil.
Maurer, Wm.	Farmer	Prescott	19
May, John	Farmer	Prescott	13
Mills, Geo. K.	Farmer	Prescott	25
McLean, M.	Farmer	Prescott	21
Roe, Jonathan	Farmer	Prescott	14
Smith, Myrtle	School Teacher	Prescott	22
Trudeau, Edward	Farmer	Prescott	14
Wager, George	Farmer	Prescott	35

**WEST BRANCH (Village of)**

Allen, Jay	Newspaper reporter and solicitor, job work, advertising. Clubbing rates with the leading Michigan papers. Representing the "Ogemaw Republican."
Commercial Bank	Thos. W. Ballentine, Cashier.
Babcock, A. R.	Editor and proprietor of "The Herald Times," official paper for Ogemaw County. Rates one dollar per year.
Blakely, C. J.	The Star Livery. Good turnouts. Charges reasonable. Houghton Avenue, West of railroad.
Blumenthal, B.	Proprietor of The Big Brick Store. Dry goods, clothing, boots and shoes, ladies' and gent's furnishing goods, etc.
Brock, A. N.	Dry goods, notions and wall paper. American Express Agent.
Benjamin, D. W.	Sheriff of Ogemaw County and dealer in timber and timber lands.
Burgess, John W.	My tailor. Repairing and cleaning on short notice. Fine work neatly done to order.
Cullen, M. J.	Dealer in shoes and rubber goods. Largest and most complete line of shoes in Ogemaw County.
Clark, E. W.	Justice of the Peace.
Cline, C. A.	Postmaster of West Branch.
Donovan & Huckle	Editors and proprietors of the "Ogemaw County Republican." Rate one dollar per year.
Dusenbery, C. M.	Furniture dealer and funeral director.
Estey, Frank	Dealer in groceries and provisions, flour, feed, hay, grain, etc.
French, G. G.	Fire insurance. Supervisor of West Branch Township.
Guilford, U. M.	Farmer and dealer in real estate.
Guthausen, Rev. G.	Pastor of St. Joseph's Catholic Church.
Goodell, E. J.	County Surveyor.
Harris, E. M.	Prosecuting Attorney.
Horton, Jos. E.	?
Jones, Isaac H.	County Clerk.
Jones, Frank	Proprietor of The New Exchange Hotel, one block South of Main Street. Rates one dollar to one dollar and a quarter per day.
McKay, R. C.	Cashier of Ogemaw County Bank.
McCannon & Wood	Livery and feed stables.
McGowan, E. H.	Hardware, stoves, ranges and agricultural implements.
Merrill, H. G.	Dealer in gent's furnishing goods.
Morrison, E. V.	Manufacturer of and dealer in all kinds of harness, robes, blankets, fur robes and fur coats.
McKay, Alex.	Dealer in agricultural implements. Agent for "McCormick" machines, "Farmers' Favorite Drill," "Page's Woven Wire Fence." Cash paid for cedar ties and poles.
McPhee, Angus	Proprietor of the West Branch Hotel.
Norton, Theo	Proprietor of the Norton House. Rate one dollar and fifty cents per day.
Nauman, C. L.	Physician and surgeon.
"Ogemaw Republican"	Donovan and Huckle, publishers. Subscription price one dollar per year.
Phelps & Whitman	R. C. Phelps and M. Whitman, proprietors of bowling alley and billiard hall. Candies, cigars and soft drinks.
Ross, James B.	Attorney.
Rifle River Electric Lighting Co.	We construct and equip telephone systems, hydraulic and steam power.
Slingerlend, B. F.	Groceries and general merchandise. Farm produce bought and sold.
Smith, Frank S.	Dealer in and manufacturer of heavy and buggy harness, wagons, buggies, sleighs, farm machinery and stock food.

**WEST BRANCH (Village of)—Continued**

NAME	BUSINESS
Schick, A. M.	Brewers and bottlers of Select and Export Lager Beer. Bottlers of carbonated beverages. Strict purity assured in every class of goods.
Smith, Frank	County Treasurer.
Shrigley, A. L.	An Apiarist
Tolfree, John	Dealer in land, drugs and general merchandise.
Teall, Frank	Merchant tailor. Satisfaction guaranteed.
"The Herald Times."	A. R. Babcock, proprietor.
Turner, W. R.	Dealer in real estate and timber lands.
Woughter, E. H.	Dealer in furniture, carpets and house furnishings. Undertaker and dealer in marble and granite monuments. All work guaranteed to be first class.
Witter, W. H.	Physician and surgeon.
Weeks, W. A.	Register of Deeds.

**WEST BRANCH TOWNSHIP**

BUSINESS	POSTOFFICE	SEC.
Adams, L. G.	Farming	West Branch 24
Brindley, Edward	Farming	Campbell's Corners 1
Brick, Joseph	Farming	Campbell's Corners 2
Bennett, Chas. E.	Farming	Campbell's Corners 12
Butts, Mrs. Wm.	Farming	West Branch 20
Buckingham, Fred	Farming	West Branch 26
Bastram, Wm.	Farming	West Branch 26
Ballard, Thos.	Proprietor of Bonanza Farm; Breeder of Duroc Jersey Swine and High Grade Oxford Down Sheep	West Branch 28
Bonsom, Luke	Farming	West Branch 28
Baltzell, Peter	Farming	West Branch 31
Campbell, F.	Farming	West Branch 13
Carr, Levi	Farming	West Branch 18
Campbell, James	Farming	Campbell's Corners 12
Coke, L. F.	Farming	West Branch 20
Crary, Frank	Farming	West Branch 26
Crawford, Albert	Farming	West Branch 22
Cramer, W. S.	Farming	West Branch 2
Cox, John	Farming	West Branch 22
Cline, C. A., Jr.	Manager of Farmers' Manufacturing Company. Window and Door Frames, Screen Doors and Windows, Bee Hives, Bushel Crates, Milk Safes and Cupboards. All kinds of planing mill work, scroll sawing and wood turning.	West Branch 20
Dings, George W.	Farming	West Branch 15
Dishaw, Levi	Farming	West Branch 24
Denison, Chas.	Farming	West Branch 26
Denler, Fred	Farming	West Branch 25
Densmoor, J. E.	Farming	West Branch 35
Doron, Louis	Farming	West Branch 21
Dack, L. W.	Farming	West Branch 36
Gillies, John	Farming	West Branch 12
Harrington, Geo. H.	Farming	West Branch 13
Hemenway, M.	Farming	West Branch 8
Hacht, John F.	Farming	Campbell's Corners 2
Hart, John M.	Farming	West Branch 23
Hacht, Chas. C.	Dealer in General Merchandise and Postmaster	Campbell's Corners 11
Hatch, Wm.	Farming	West Branch 26
Hatch, John	Farming	West Branch 25
Hartsell, Enos	Farming	West Branch 22
Harrington, Isaac H.	Farming	West Branch 28
Harris, Wm.	Farming	West Branch 21
Horsell, Robert	Farming	West Branch 28
Keating, Thos.	Farming	West Branch 9
Kelsey, D. E.	Farming	West Branch 26
Lapoint, Fred	Farming	West Branch 32
Lang, Louis	Farming	West Branch 26
Linam, Wm.	Farming	West Branch 21
Linam, Charles	Farming	West Branch 21
Miller, Isaac	Farming	West Branch 12
Miller, Henry	Farming	West Branch 12
Marx, M.	Farming	West Branch 31
Mahoney, M. J.	Farmer and Carpenter	West Branch 19
Moss, James	Farming	West Branch 8
Mooney, James	Farming	Campbell's Corners 12
Mier, Henry	Farming	West Branch 16
Menzie, Robert	Farmer and dealer in Real Estate	West Branch 24
Newberry, O. A.	Farming	West Branch 25
Pray, Wm.	Farming	West Branch 14
Parliament, Elon	Farming	Campbell's Corners 1
Preston, Wm.	Farming	West Branch 11
Persell, S.	Farming	West Branch 35
Perry, Albert J.	Farming	West Branch 28
Roll, A. D.	Farming	West Branch 7
Roeser, Jacob	Carpenter, Contractor and Builder	Campbell's Corners 1
Reinhardt, Gust.	Farming	West Branch 27
Reinhardt, Mathew	Farming	West Branch 22
Reinhardt, Andrew	Farming	West Branch 27
Reinhardt, Fred	Farming	West Branch 27
Rice, C. C.	Farming	West Branch 31
Sherman, George	Farmer and dealer in Real Estate	Campbell's Corners 1

WEST BRANCH TOWNSHIP—Continued				WEST BRANCH TOWNSHIP—Continued			
NAME	BUSINESS	POSTOFFICE	SEC.	NAME	BUSINESS	POSTOFFICE	SEC.
Smith, Fred . . . .	Farming . . . . .	Campbell's Corners	2	Walters, B. . . . .	Farming . . . . .	West Branch	28
Smith, Henry . . . .	Farming . . . . .	Campbell's Corners	2	Zimmer, Edd . . . .	Farming . . . . .	West Branch	8
Siemyer, John . . . .	Farming . . . . .	West Branch	20				
Smith, Benjamin . . . .	Farming . . . . .	West Branch	35				
Stillwagon, C. . . .	Farming . . . . .	West Branch	36				
Schaefer, Chas. A. . . .	Farming . . . . .	West Branch	21				
Timothy, Jos. . . . .	Farming . . . . .	West Branch	6				
Turner, Chas. A. . . .	Farming . . . . .	West Branch	22				
Valley, Benj. . . . .	Farming . . . . .	West Branch	18				
Vermeuler, Remi . . . .	Farming . . . . .	West Branch	28				
Wangler, Frank . . . .	Farming . . . . .	West Branch	10				
Wiess, Mike . . . . .	Farming . . . . .	West Branch	11				
Woodiwiss, John . . . .	Farming . . . . .	Campbell's Corners	13				
Winters, Henry . . . .	Farmer and Agent for the Chatham Fanning Mill . . . . .	West Branch	23				
Winterlee, G. A. . . .	Farming . . . . .	West Branch	34				
Wheeler, A. J. . . . .	Farming . . . . .	West Branch	26				
Wilcox, Ulysses . . . .	Farming . . . . .	West Branch	28				

MISCELLANEOUS			
BUSINESS	POSTOFFICE		
Auditor General . . . . .	Lansing, Mich.		
Anker, Sam . . . . .	Proprietor of Hotel Holland . . . . .	East Tawas, Mich.	
Brown and Farley . . . .	George F. Brown } Attorneys . . . . .	Flint, Mich.	
	John H. Farley }		
Carson, Ealy & Co. . . .	Bankers . . . . .	East Tawas, Mich.	
DeCamp, C. C. & A. . . .	Real Estate and Law. Tax Titles a specialty . . . . .	Lansing, Mich.	
Evans, R. E. . . . .	With the Ottawa Hardware Co. . . . .	East Tawas, Mich.	
Fraser, Wm. A. . . . .	Agent for the Southern Colorado Land Co. . . . .	Lansing, Mich.	
Prescott & Sons . . . .	Lumber Manufacturers. Lands for sale . . . . .	Tawas City, Mich.	
Willison, L. G. . . . .	Real Estate Loans and Insurance . . . . .	Flint Mich.	

**WILL Z. SEARLE**  
(LITTLE WILL)

**O. L. SEARLE**

# SEARLE OPTICAL COMPANY

## MANUFACTURING OPTICIANS

331 LAKE STREET,  PETOSKEY, MICHIGAN

Why delay three days or a week waiting for lenses? We give special attention to Prescription Lenses. Orders filled same day received.

LITTLE WILL, Optician and Jeweler



FINE REPAIRING OUR SPECIALTY

MAIL ORDERS PROMPTLY ATTENDED TO

# FARMER'S DIRECTORY

EXCEPTING THOSE IN PATRONS' DIRECTORY

## CUMMING

NAME	POSTOFFICE	SEC.
Allen, R. J.	Rose City	8
Adzitt, E.	Selkirk	35
Bailer, C.	Rose City	6
Bailey, Levi	Rose City	7
Benjamin, D. W.	Rose City	18
Beck, A. B.	Rose City	19
Beck, M.	Rose City	29
Beck, B.	Rose City	31
Benjamin, E.	Campbell's Corners	32
Cleveland, O. A.	Lupton	12
Craft, Wm.	Rose City	29
Cromwell, J. A.	Sage	35
Deford, John	Rose City	5
Delany, Wm.	Rose City	19
Dantzler I. W.	Rose City	29
Everett, A.	Rose City	19
Everett, J.	Rose City	30
Freeman, Alex.	Rose City	6
Fritz, Jos	Rose City	32
Graber, A.	Rose City	9
Graber, J.	Rose City	9
Green, Alex.	Rose City	19
Green, E.	Rose City	29
Green, J.	Rose City	31
Graybill, R.	Rose City	31
Green, Michael, Sr.	Rose City	31
Green, Michael, Jr.	Rose City	31
Hawley, Charles	Rose City	4
Hoover, A.	Rose City	30
Hamacher, H.	Campbell's Corners	31
Houck, J. H.	Sage	35
Linton, H.	Rose City	7
Lobsinger, Jacob	Rose City	29
Little, A.	Rose City	32
Lehman, J. B.	Rose City	32
Lovewell, F.	Sage	24
McCann, J.	Rose City	26
McNeill, Jos	Sage	26
Monahan, James	Rose City	6
Montgomery, J.	Rose City	18
Mattison, Rory	Rose City	18
Mowbray, E. B. R.	Rose City	17
Nichols, H. W.	Rose City	6
Pross, J.	Rose City	5
Parker, G. E.	Rose City	6
Post, Walter	Rose City	5
Pawley, N.	Campbell's Corners	31
Peters, Charles	Campbell's Corners	32
Power, Emma	Selkirk	35
Roll, J.	Rose City	19
Schick, Alex.	Rose City	29
Schmitt, Rudolph	Rose City	29
Waterman, Fred	Rose City	4
Windelborn, C.	Rose City	30
Winter, Leo.	Rose City	30
Withey, A. E.	Sage	35
Walker, E.	Sage	25

## CHURCHILL

Blancher, Mrs. M. A.	Campbell's Corners	7
Bell, R. M.	Lupton	1
Benjamin, H.	Selkirk	9
Bemis, H. W.	Selkirk	11
Benjamin, W.	Selkirk	17
Burt, E. M.	Selkirk	18
Brown, James R.	Selkirk	18
Bennett, Wm.	Selkirk	18
Benjamin, P.	Campbell's Corners	30
Cross, I.	Selkirk	16
Cooper, F.	Campbell's Corners	6
Cumming, E. E.	Selkirk	8
Cottle, Wm. J.	Campbell's Corners	17
Connor, I.	Campbell's Corners	19
Dilenbeck, C.	Campbell's Corners	6
Dayton, Edward	Campbell's Corners	7
Fox, Aug.	Campbell's Corners	19
Fisher, Jacob	Campbell's Corners	20
Greniea, Chas.	Selkirk	12
Goodhand, John	Selkirk	1
Griffin, Geo.	Selkirk	8

## CHURCHILL—Continued

NAME	POSTOFFICE	SEC.
Gonyea, C. M.	Selkirk	9
Grzeszak, L.	Selkirk	10
Griffith, Wm.	Selkirk	11
Griffith, Judson	Selkirk	11
Goodwin, Wm.	Selkirk	12
Hiltz, S.	Lupton	1
Hiltz, J.	Lupton	1
Hodgins, John	Selkirk	2
Hodgins, Jesse	Selkirk	2
Hills, E.	Selkirk	14
Jones, A. D.	Selkirk	14
Jones, John	Selkirk	24
Kuhn, Martin	Selkirk	17
Launau, Geo.	Selkirk	19
McCrimmon, Dan	Campbell's Corners	5
McKinnon, J.	Selkirk	9
McCallum, S. H.	Selkirk	1
McCasin, H. A.	Selkirk	21
Oggar, John	Selkirk	15
Perkins, Glen	Selkirk	2
Page, Frank	Selkirk	2
Parliament, Jos	Selkirk	8
Perkins, D.	Selkirk	16
Quigley, Wm.	Selkirk	15
Rawden, J.	Campbell's Corners	5
Reeve, Mrs. J.	Selkirk	9
Stoner, Jos.	Selkirk	9
Stephens, Mrs. G.	Campbell's Corners	7
Short, Joseph	Campbell's Corners	10
Smith, W. W.	Lupton	1
Sims, Thos.	Selkirk	3
Shyne, Geo.	Campbell's Corners	7
Sherman, Thos.	Selkirk	9
Short, Prosper	Selkirk	9
Sheppard, Wm. B.	Selkirk	17
Schroeder, John	Selkirk	19
Tinning, John	Campbell's Corners	7
Teepie, Hiland	Selkirk	2
Turner, C. B.	Campbell's Corners	6
Thompson, Jos.	Campbell's Corners	8
Thompson, J. H.	Campbell's Corners	17
Teepie, Jared	Selkirk	10
Teepie, Henry	Selkirk	11
Thompson, John	Campbell's Corners	18
Tranzow, Mrs. F.	Campbell's Corners	20
Vanwormer, Aug.	Selkirk	12
Webster, Jes	Campbell's Corners	5
Weeks, W. F.	Campbell's Corners	6
Wangler, Wm.	Campbell's Corners	6
Walker, G. E.	Selkirk	12
Withey, Frank	Selkirk	13
Withey, Charles	Selkirk	12
Weeks, S. J.	Selkirk	6

## EDWARDS

Adolph, Otto	West Branch	8
Amb, P.	West Branch	14
Arrand, G. M.	Alger	32
Alexander, E.	Alger	34
Beck, Philip	West Branch	16
Beemer, W.	Edwards	24
Bohnard, F.	Edwards	24
Bohnard, Daniel	Edwards	24
Burnside, Wm.	Alger	32
Blakely, J. B.	Edwards	36
Carter, J.	West Branch	16
Cooper, Sam.	Edwards	35
Cooper, A. J.	Edwards	35
Carey, B. J.	Edwards	36
Diebold, L.	West Branch	24
Decker, G. M.	Edwards	35
Erb, Chris C.	West Branch	8
Ehinger, Aug.	West Branch	13
Ehinger, Fred	West Branch	13
Fournier, E. F.	Alger	35
Flint, A. H.	Edwards	36
Gildner, John	Edwards	23
Holderied, Frank	West Branch	2
Hansen, Nicholas	West Branch	12
Hamilton, C. R.	Edwards	34
Illig, Bernard	West Branch	10

## EDWARDS—Continued

NAME	POSTOFFICE	SEC.
Janz, Anton	West Branch	12
Johnson, J. P.	Alger	28
Knoepler, M.	West Branch	4
Kroetch, J.	West Branch	1
Kartes, John	West Branch	24
Kartes, P.	West Branch	24
Kaiser, C. W.	Edwards	23
Lobsinger, A.	West Branch	13
Lutes, G. F.	Alger	29
Loney, L.	Alger	28
Miller, A.	West Branch	1
Much, G. F.	Alger	26
Quackenbush, S.	Alger	29
Rau, Gottlieb	West Branch	1
Rau, Chas., Sr.	West Branch	12
Rau, Chas., Jr.	West Branch	12
Rau, Joseph	West Branch	11
Rabideau, J.	West Branch	13
Schmitt, A.	West Branch	9
Stillwagon, M.	Alger	32
Stevens, H.	Alger	32
Stillwagon, G. P.	Alger	29
Sheick, John	Alger	33
Smith, Jos.	Alger	33
Smith, Geo. F.	Alger	26
Stringer, John	Edwards	35
Thompson, A.	Alger	33
Thompson, Sarah	Alger	33
Ueber, F.	West Branch	1
White, Henry	West Branch	6
Woodley, Mrs. J.	West Branch	8
Walter, E. E.	West Branch	11
Walter, A.	West Branch	14
Winter, H. J., Jr.	West Branch	10
Willey, L.	West Branch	10
Walter, Joseph	West Branch	10
Welch, Worth	Edwards	23
Williams, Wm.	Edwards	23
Williams, L.	Edwards	23
Williams, J. F.	Edwards	26
Williams, W.	Edwards	35

## FOSTER

Brown, R. T.	Beaver Lake	28
Eagan, Pat	West Branch	12
Foote, A.	Beaver Lake	6
Straner, T.	West Branch	14

## GOODAR

Aeno, E.	South Branch	1
Alderton, James	South Branch	1
Berry, Wm	South Branch	14
Berry, F.	South Branch	13
Byce, Sarah	South Branch	1
Byce, George	South Branch	1
Coburn, L. A.	South Branch	12
Clough, Wm. H.	South Branch	23
Crozier, Wm	South Branch	30
Kinyon, J.	Lupton	30
Mudget, T. J.	Maltby	21
Roe, L.	South Branch	23
Roe, J.	South Branch	23
Simons, B.	South Branch	23
Steward, C. W.	Lupton	32
Taber, Lydia	South Branch	1
Vaughan, J. B.	Maltby	22
Wood, T. G.	Maltby	22

## HORTON

Andrews, John	West Branch	19
Ausum, Jule	Alger	26
Brock, M.	Alger	26
Cook, Lewis	West Branch	6
Decker, O. B.	Alger	29
Evans, John	Alger	31
Evilsizer, Otis	Alger	31
France, Frank	West Branch	6
Finnerty, Michael	West Branch	7
Fell, C. M.	Edwards	30



**HORTON—Continued**

NAME	POSTOFFICE	SEC.
Gibson, Robert	Edwards	17
Griffin, John	Alger	26
Griffin, Robert	Alger	26
Griffin, James	Alger	35
Giles, E. W.	West Branch	6
Genner, Mary A.	West Branch	7
Gibson, Edward	West Branch	7
Gingrich, H. A.	West Branch	7
Ishem, George	West Branch	16
Johnson, David	Alger	35
Mackensen, Mrs. E.	West Branch	6
Miller, L. E.	West Branch	8
Ostrander, I.	Alger	29
Peadon, Joseph	West Branch	5
Palmer, A. L.	West Branch	19
Palm, Wm.	West Branch	7
Palmer, Wm. E.	West Branch	7
Parish, Amy	Alger	19
Stephens, O. B.	West Branch	5
Selmer, John	Alger	35
Schmaltz, Jos.	West Branch	6
Scott, Wm.	West Branch	7
Schlosser, Jacob	West Branch	7
Sharpe, James	West Branch	8
Schultz, John	West Branch	8
Spring, Patrick	West Branch	22
Wirges, Jacob	West Branch	6
Wirges, Peter	West Branch	17
Weise, Fred	West Branch	18

**HILL**

Allen, George	Ellake	1
Barber, Wm.	Ellake	1
Ballard, George	Ellake	1
Bradford, A.	Ellake	1
Curry, M. A.	Lupton	10
Caddey, C.	Canfield	14
Corbett, Ben	Canfield	26
Dennes, F.	Canfield	25
Earley, P. J.	Canfield	25
Earley, Thos.	Canfield	25
Fisher, E.	Ellake	1
Green, Wm.	Canfield	13
Green, J.	Canfield	14
Guest, Jane	Canfield	
Hyke, W. A.	Canfield	22
Harder, F. L.	Canfield	23
Jacobson, J.	Ellake	1
Jacobs, Thos.	Ellake	12
Klock, G.	Canfield	36
Labarge, L.	Ellake	13
Lower, E.	Canfield	23
McKarney, Wm.	Ellake	1
McKobosh, S.	Ellake	12
McKobosh, J.	Ellake	12
Nalett, Jos.	Canfield	36
Runyan, D.	Ellake	13
Rabus, Jos.	Canfield	22
Reiley, Wm.	Canfield	25
Short, Geo.	Ellake	1
Short, L.	Ellake	1
Short, J. D.	Ellake	1
Sheldon, T. F.	Canfield	25
Sellesburg, A.	Canfield	36
Thayer, Geo.	Ellake	12
Wilson, E.	Canfield	24

**KLACKING**

Badtruff, I.	Rose City	1
Brown, A.	West Branch	30
Bosham, I.	West Branch	20
Bosham, R.	West Branch	20
Bartels, Chas.	Rose City	15
Belknap, O.	Rose City	11
Bohley, H.	Rose City	13
Belknap, C.	Rose City	24
Coffey, C.	Rose City	1
Chase, Wm. H.	West Branch	29
Cummings, L.	Rose City	12
Carr, Jay	Rose City	12
Cooper, Wm. J.	Rose City	35
Duncan, Nancy	West Branch	28
Densmore, D. D.	Campbell's Corners	25
Densmore, N.	Campbell's Corners	25
Detzler, John	Campbell's Corners	25
Densmore, N. A.	Campbell's Corners	25
Detzler, D.	Campbell's Corners	25
Earley, Jos.	Campbell's Corners	36
Fritz, John	Campbell's Corners	36
Griffith, Rose	Rose City	1
Goff, G.	West Branch	21
Gamble, H.	Rose City	12

**KLACKING—Continued**

NAME	POSTOFFICE	SEC.
Gussman, Wm.	Rose City	13
Groff, A.	Campbell's Corners	36
Green, F. M.	Rose City	23
Green, J. A.	Campbell's Corners	24
Geroy, Wm. H.	Campbell's Corners	26
Harvey, D.	Rose City	5
Hodge, P. B.	Rose City	1
Hutchison, E.	Rose City	11
Haman, J.	Rose City	13
Kruger Aug.	West Branch	22
Krug, Carl	Rose City	11
Klacking John	Campbell's Corners	36
Lahman, Lewis	Campbell's Corners	25
Mier, Mich.	Campbell's Corners	36
Mier, Con	Campbell's Corners	36
Mier, Wm.	Campbell's Corners	36
Mardan, Mary	Campbell's Corners	24
Morgan, W.	Campbell's Corners	24
Martin W. B.	Campbell's Corners	24
Newbicker, J.	Campbell's Corners	36
Ost, Wm.	Rose City	13
Philips, F.	West Branch	28
Philips, H. A.	West Branch	22
Peters, Fred	Rose City	10
Rosavere, J.	West Branch	30
Rosavere, Wm.	West Branch	29
Reetz, Gus	Campbell's Corners	35
Reetz, Wm.	Campbell's Corners	36
Remer, R.	Rose City	13
Reetz, Wm.	Rose City	36
Schroeder, A.	Rose City	1
Snook, M.	Rose City	1
Schrebmier, F.	Rose City	9
Smith, J. B.	Rose City	9
Schmitt, Catherine	Campbell's Corners	36
Spencer, C.	Rose City	24
Schneider, Jos.	Campbell's Corners	23
Schuck, M.	Campbell's Corners	25
Thompson, M.	Rose City	2
Tileger, J.	Campbell's Corners	23
Talbot, Leon	Campbell's Corners	20
Van Brocklin	Rose City	6
Vananburg, A.	Campbell's Corners	25

**LOGAN**

Atherton	Selkirk	19
Beach, D. A.	Prescott	32
Brown, D. W.	Nester	25
Bronson, Wm.	Nester	23
Clark, J.	Prescott	32
Canfield, J.	Selkirk	8
Collins, Eugene	Nester	30
Chapman, S.	Nester	26
Ecker, Henry	Prescott	33
Ford, James	Nester	27
Gardner	Selkirk	7
Gordon, W. H.	Nester	23
Green, W. H.	Nester	26
Harris, H.	Prescott	32
Huff, D.	Selkirk	19
Huff, Elizabeth	Selkirk	19
Hinchley, M.	Nester	21
Jones, P. W.	Prescott	32
Jones, Alonzo	Prescott	28
Jones, M.	Prescott	28
Jones, Sarah	Nester	30
Jersey, C.	Nester	23
Lamb, Dell	Nester	27
Maddison, J.	Prescott	32
Murray, D.	Selkirk	6
Mang, Jos.	Selkirk	8
Near, John	Nester	22
Prevost, M.	Nester	
Rose, O. A.	Nester	27
Schegdel, Chas.	Selkirk	7
Soule, Ed.	Nester	19
Sullivan, D.	Nester	25
Tester, Wm.	Prescott	32
Whiteside, Geo.	Selkirk	35
Withier, Chas.	Selkirk	7

**ROSE**

Abbott, J. A.	Rose City	5
Abbott, C.	Rose City	5
Abbott, L.	Rose City	8
Abbott, R. S.	Rose City	7
Arntz, M.	Rose City	20
Arntz, John	Rose City	20
Alvord, C.	Rose City	36
Atherton, C.	Rose City	32
Arthur, B. F.	Rose City	32
Barber, O. N.	Rose City	8

**ROSE—Continued**

NAME	POSTOFFICE	SEC.
Barber, C.	Rose City	5
Boardman, F. D.	Rose City	24
Butterly, B.	Rose City	24
Brooks, Clara	Rose City	25
Bruff, A.	Rose City	35
Barber, L. G.	Rose City	31
Cole, M.	Rose City	7
Campbell, B. T.	Rose City	13
Campbell, H. J.	Rose City	13
Coreson, Jerry	Rose City	13
Cheney, W.	Rose City	23
Cheney, J. D.	Rose City	36
Cook, A. S.	Rose City	31
Doud, C. E.	Rose City	24
Demmock, Mrs. R. C.	Rose City	30
Fayett, G. W.	Rose City	32
Griffith, S.	Rose City	13
Goslin, Wm.	Rose City	25
Holland, A.	Rose City	8
Hampton, Geo.	Rose City	24
Healy, W.	Rose City	32
Ingram, James	Rose City	33
Jacobs, And.	Rose City	35
Kohn, S.	Rose City	35
Locey, Mrs. N.	Rose City	18
Lockwood, L.	Rose City	32
McVay, N.	Rose City	4
Mathews, Jas.	Rose City	8
Mills, L. L.	Rose City	26
Montgomery, S. J.	Rose City	30
Rice, N. A.	Rose City	23
Rice, H. T.	Rose City	23
Rose, A.	Rose City	25
Sammons, D.	Rose City	30
Scott, L. D.	Rose City	30
Slater, E.	Rose City	35
Thompson, John	Rose City	25
Woolcott, James	Rose City	32

**RICHLAND**

Adams, Mollie	Selkirk	6
Bronson, Sam	Prescott	24
Best, D.	Prescott	24
Best, Robert	Prescott	25
Brown, M.	Prescott	27
Brown, Wm.	Prescott	27
Brown, Lydia	Prescott	27
Berequist, Gust	Prescott	34
Bidwell, Mrs. Julia	Prescott	35
Black, John	Selkirk	36
Bacon, W.	Selkirk	5
Bovee, A. J.	Prescott	11
Best, C. O.	Prescott	13
Best, L.	Prescott	13
Best, R. E.	Prescott	13
Currie, Gilbert	Prescott	11
Cliff, Fred	Prescott	22
Cleaver, Geo. W.	Prescott	15
Currie, Robert	Prescott	14
Chippis, W.	Prescott	24
Corner, L. H.	Prescott	25
Clark, John	Prescott	35
Drew, S.	Prescott	25
Eddy, E. J.	Prescott	25
Finger, H.	Prescott	22
Finger, John	Prescott	18
Finger, Wm.	Prescott	22
Ford, J. A.	Prescott	27
Fagan, Peter	Prescott	21
Foot, Eli	Prescott	34
Goodale, Luther	Prescott	15
Graham, Walter	Prescott	16
Graham, Isabelle	Prescott	16
Going, F. A.	Prescott	13
Gibson, Geo.	Prescott	24
Hillman, Dan	Prescott	14
Hillman, Elmer	Prescott	14
Haslip, Philip	Prescott	24
Haslip, James	Prescott	24
Haslip, George	Prescott	24
Hunt, Cliff	Prescott	25
Houghtaling, Wesley	Prescott	26
Henry, Alvin	Prescott	21
Harman, Mrs. Addie	Prescott	36
Harrington, Geo. D.	Prescott	12
Irish, Edward	Prescott	36
Irish, W.	Prescott	36
Johnson, H.	Prescott	9
Jones, T.	Prescott	24
Jones, L.	Prescott	34
Jones, Wm.	Prescott	34
Keeney, J. C.	Prescott	24
Keeney, H. E.	Prescott	24

**RICHLAND—Continued**

NAME	POSTOFFICE	SEC.
Law, Geo . . . . .	Prescott	21
Lickfelt, Fred . . . . .	Prescott	36
Mogg, Sam . . . . .	Prescott	25
Mogg, Wm . . . . .	Prescott	36
Morris, Peter . . . . .	Prescott	26
Melcher, Aug . . . . .	Prescott	27
Moody, Peter . . . . .	Prescott	35
McLean, Neil . . . . .	Prescott	36
Manzer, John . . . . .	Prescott	12
McGee, Frank . . . . .	Prescott	23
Newton— . . . . .	Prescott	20
Nixon, Thos . . . . .	Prescott	35
Peters, F . . . . .	Prescott	14
Reece, Henry . . . . .	Prescott	15
Richardson, H . . . . .	Prescott	25
Rau, John . . . . .	Prescott	35
Roberts, Chas . . . . .	Prescott	36
Stickly, David . . . . .	Prescott	18
Stickly, A. E. . . . .	Prescott	17
Smith, John . . . . .	Prescott	24
Sheffer, Jos . . . . .	Prescott	26
Stone, A . . . . .	Prescott	62
Sheehan, Edward . . . . .	Prescott	35
Sheffer, Ellen . . . . .	Prescott	34
Simons, Wm . . . . .	Prescott	33
Stephens, Arthur . . . . .	Prescott	36
Stanley, John . . . . .		
Thorn, N . . . . .	Prescott	8
Thorn, J. R . . . . .	Prescott	17
Treachler, Wm . . . . .	Prescott	25
Treachler, Fred . . . . .	Prescott	35
Taylor, George . . . . .	Prescott	25
Vanallen, Thos . . . . .	Prescott	25
Vanallen, D . . . . .	Prescott	35
Wilcox, R . . . . .	Prescott	18
Ward, Robert . . . . .	Prescott	25
Whitfong, David . . . . .	Prescott	26
Wilson, Wm . . . . .	Prescott	35
Weishuhn, Chas . . . . .	Prescott	36

**WEST BRANCH**

Andrews, John . . . . .	Campbell's Corners	11
Bailey, J. . . . .	West Branch	35
Ballard, James . . . . .	West Branch	27
Bradley, P . . . . .	West Branch	24
Beach, J. H. . . . .	West Branch	23
Baumchen, J . . . . .	Campbell's Corners	1
Brick, Theresa . . . . .	Campbell's Corners	2
Bohn, Jas . . . . .	West Branch	13
Breamer, M . . . . .	West Branch	19
Brandenburg, H. . . . .	West Branch	11
Baltzell, P . . . . .	West Branch	31
Bellingar, A. D . . . . .	West Branch	31
Bellingar, O . . . . .	West Branch	22
Belden, C. D . . . . .	West Branch	33

**WEST BRANCH—Continued**

NAME	POSTOFFICE	SEC.
Cook, J . . . . .	West Branch	33
Cool, Wm . . . . .	West Branch	3
Clark, J. H. . . . .	Campbell's Corners	13
Cowan, R . . . . .	West Branch	21
Crapo, J . . . . .	West Branch	8
Crawford, J . . . . .	West Branch	15
Candy, Geo . . . . .	West Branch	31
Connors, O. A . . . . .	West Branch	25
Crisher, C . . . . .	West Branch	28
Duncan, James . . . . .	West Branch	17
Davis, T . . . . .	West Branch	7
Donovan, J. M . . . . .	West Branch	19
Depew, M . . . . .	West Branch	14
Emmons, J . . . . .	West Branch	36
Emery, B . . . . .	West Branch	25
Engle, F . . . . .	West Branch	3
Engle, J . . . . .	West Branch	21
Ellis, W. E . . . . .	West Branch	14
Fisk, W. H . . . . .	West Branch	21
Finerty, John . . . . .	Campbell's Corners	1
Fisher, A . . . . .	Campbell's Corners	12
Freed, J . . . . .	Campbell's Corners	12
Furze, E . . . . .	Campbell's Corners	14
Ford, F . . . . .	West Branch	24
Grossman, G . . . . .	West Branch	10
Goddard, Jas . . . . .	West Branch	18
Goddard, C . . . . .	West Branch	17
Gingell, John . . . . .	West Branch	26
Horton, J . . . . .	West Branch	29
Hibbard, N . . . . .	West Branch	32
Hicks, Geo . . . . .	West Branch	25
Hack, John . . . . .	Campbell's Corners	2
Holdried, Mrs. C . . . . .	Campbell's Corners	13
Hermen, J . . . . .	West Branch	16
Hermen, P. C . . . . .	West Branch	16
Haskell, A . . . . .	West Branch	7
Hemenway, H . . . . .	West Branch	12
Hemenway, D . . . . .	West Branch	18
Hayes, T. W. . . . .	West Branch	17
Hart, E . . . . .	West Branch	19
Hart, T . . . . .	West Branch	13
Holt, J . . . . .	West Branch	13
Holt, F . . . . .	West Branch	13
Harcourt, T. D . . . . .	West Branch	22
Linam, Geo. W. . . . .	West Branch	21
Largent, John . . . . .	West Branch	25
Lehl, G. H. . . . .	West Branch	13
Lovell, G . . . . .	West Branch	13
Lavanway, F. W. . . . .	West Branch	20
Longwell, C. W. . . . .	West Branch	28
Merritt, J . . . . .	West Branch	25
Mackie, J. C . . . . .	West Branch	10
Mackie, Wm. P. . . . .	Campbell's Corners	11
Miller, Wm. . . . .	West Branch	16
Miller, J. Sr. . . . .	West Branch	16
Miller, J. Jr. . . . .	West Branch	16
Miller, A . . . . .	West Branch	21

**WEST BRANCH—Continued**

NAME	POSTOFFICE	SEC.
Miller, P . . . . .	West Branch	21
Miller, Peter A. . . . .	West Branch	12
Moss, Wm. . . . .	West Branch	17
Merrill, Wm. . . . .	West Branch	19
Masters, T. . . . .	West Branch	15
McGee, W. . . . .	West Branch	31
McDonald, . . . . .	West Branch	26
Norris, A . . . . .	West Branch	22
Newberry, G. . . . .	West Branch	25
Newberry, E. . . . .	West Branch	25
Nixon, Geo. . . . .	West Branch	24
Neubecker, F. . . . .	Campbell's Corners	11
Neil, A. N. . . . .	West Branch	24
Ormerod, C. . . . .	West Branch	25
Persons, N. . . . .	West Branch	25
Peterson, M. . . . .	West Branch	33
Perry, J. . . . .	West Branch	32
Phillips, P. . . . .	Campbell's Corners	1
Peck, Mrs. A. J. . . . .	West Branch	16
Pray, W. . . . .	West Branch	14
Parkinson, T. . . . .	West Branch	19
Pearer, E. M. . . . .	West Branch	23
Quackenbush, Lee . . . . .	West Branch	13
Richardson, Robt. . . . .	West Branch	23
Richardson, James . . . . .	West Branch	27
Roeser, P. . . . .	Campbell's Corners	1
Rosenthal, Mrs. H. . . . .	West Branch	10
Reutscheler, C. . . . .	West Branch	7
Robison, H. . . . .	West Branch	18
Rabedeau, J. . . . .	West Branch	33
Sutherland, J. . . . .	West Branch	35
Scott, A. . . . .	West Branch	25
Shephard, R. . . . .	Campbell's Corners	12
Stanlake, E. . . . .	West Branch	24
Stay, Chas. . . . .	West Branch	24
Scott, S. . . . .	West Branch	24
Smith, John . . . . .	West Branch	32
Sharpe, D. . . . .	West Branch	32
Terryberry, A. . . . .	West Branch	35
Theiman, G. . . . .	West Branch	21
Tinlin, M. . . . .	West Branch	7
Timothy, N. . . . .	West Branch	6
Tolman, Mrs. L. C. . . . .	West Branch	18
Valley, F. M. . . . .	West Branch	35
Walsh, W. . . . .	West Branch	28
Wilcox, R. . . . .	West Branch	26
White, E. . . . .	West Branch	33
Williams, J. H. . . . .	West Branch	26
Williams, W. . . . .	West Branch	24
Wangler, A. . . . .	Campbell's Corners	1
Wilson, T. H. . . . .	West Branch	10
Woughter, J. . . . .	Campbell's Corners	14
White, C. . . . .	West Branch	7
Webster, James . . . . .	West Branch	5
White, H. . . . .	West Branch	8
Williby, F. . . . .	West Branch	23
Wilder, N. . . . .	West Branch	32









OGEMAW COUNTY 1903

RECEIVED: Binding of 3/4 leather with cloth sides, battered. Pages of atlas are dirty and some are frayed around the edges. Pages are wire-stitched through the side. Pages 15-20 and 25-32 are missing.

TREATMENT: Picked to pieces. Washed. Dried. Deacidified. Erased pencil marks throughout. Laminated. Guarded large folded map. Added endsheets. Stubbed for thickness. Bound in standard atlas binding.

MATERIALS: Water. Wei T'o deacidification solution. Ehlermann's LAL 215 PVA adhesive. Gane Bros. HKOC PVA adhesive. Swift's 50-212 glue. Wei T'o deacidification solution. PROMATCO heavy duty endsheet paper, reinforcing paper, nylon laminating tissue. Ademco unsupported texicryl. Davey "Red Label" binder's board. University Products 2-ply acid-free 100% rag conservation mounting board. Pyroxylin-impregnated cotton library buckram. 23K gold. Aluminum screw-type binder posts.

Ann Flowers  
December 2, 1983



