

GENERAL HEADQUARTERS
SUPREME COMMANDER FOR THE ALLIED POWERS
APO 500

23 June 1950

AG 561(23 Jun 50)ESS/IND
SCAPIN 2103

MEMORANDUM FOR: JAPANESE GOVERNMENT

SUBJECT: Revision of Scope of Activities in Former Japanese
Naval Shipyards

1. The following memoranda for the Japanese Government from General Headquarters, Supreme Commander for the Allied Powers, are rescinded:

a. AG 388.3(5 Dec 45)GD, SCAPIN 393, 5 December 1945, subject: Use of Maizuru and Ominato Navy Yards for repair of Japanese merchant shipping and vessels engaged in minesweeping.

b. AG 561(15 Dec 45)GD, SCAPIN 451, 15 December 1945, subject: Reactivation of facilities at Kure Navy Yard.

c. AG 601(16 Feb 46)GD, SCAPIN 741, 16 February 1946, subject: Reactivation of Facilities at Sasebo Navy Yard.

2. Effective this date the Japanese Government will limit the operations of former naval shipyards to those cited hereafter:

a. Sasebo and Maizuru ex-naval shipyards:

(1) Voyage and emergency repairs to Japanese ships which can be accomplished within 30 working days per vessel of which a maximum of 15 days is allowable in the dry-dock.

(2) Scrapping operations.

(3) Emergency repairs to foreign flag merchant vessels.

(4) Repairs to Occupation ships.

b. Kure and Ominato ex-naval shipyards.

(1) Completion of ship repairs now in the yards.

(2) Completion of other work now in process. This work must be completed prior to 31 December 1950.

AG 561(23 Jun 50)ESS/IND
SCAPIN 2103

c. Prior approval of the Supreme Commander for the Allied Powers will be required for any other operations in the listed yards other than those referenced above.

3. On 1 January 1951, Kure and Ominato will cease shipbuilding activities and machinery and equipment not required for other authorized activities will be placed in storage.

4. The Japanese Government will submit a monthly report to the Supreme Commander for the Allied Powers for each of the above listed yards showing the following:

- a. New ship repair work entering the yard during the month.
- b. Ship work completed during the month.
- c. Other work completed during the month.
- d. Man days worked during the month.

5. Direct communication between the Economic and Scientific Section, General Headquarters, Supreme Commander for the Allied Powers and the Ministry of Transportation regarding matters within the scope of this memorandum is authorized.

FOR THE SUPREME COMMANDER:

K B Bush

K. B. BUSH,
Brigadier General, USA,
Adjutant General.

KYUSHU CIVIL AFFAIRS REGION
GHQ SCAP
Fukuoka, Kyushu, Japan

EWU/ams

APO 24 Unit 5
21 June 1950

E 387.6

SUBJECT: Release of Former Japanese Military Installation

TO : Chief, Civil Affairs Section
GHQ SCAP
APO 500
ATTN: Major Freeman

1. References:

- a. Letter E 387.6, this headquarters, subject: "Status of Buildings at the Sasebo Naval Arsenal", dated 14 April 1950.
- b. Operational Directive 11, Civil Affairs Section, General Headquarters, Supreme Commander for the Allied Powers, subject: "Industry", dated 10 April 1950.

2. Attached is a copy of the letter submitted by this headquarters to the Regional Post Engineers, releasing all buildings not required for custody of reparations at the Sasebo Naval Arsenal.

FOR THE CHIEF:

1 Incl:
1. Ltr, Regional Post
Engineer w/Incl.

ELLSWORTH R. MOSMAN
Chief, Economics Section

KYUSHU CIVIL AFFAIRS REGION
CHIEF SCAP
Fukuoka, Kyushu, Japan

EWB/mms

APO 24 Unit 5
21 June 1950

E 387.6

SUBJECT: Release of Former Military Installation

TO : Commanding Officer, 34th Infantry Regiment, APO 24 Unit 3
ATTN: Regional Post Engineer

1. Reference is made to the following:

a. Operational Directive 11, Civil Affairs Section, General Headquarters, Supreme Commander for the Allied Powers, subject: "Industry", dated 10 April 1950.

b. Letter E 387.6, this headquarters, subject: "Recall of Former Japanese Naval Installations", dated 1 April 1950.

2. In compliance with reference 1b above, the entire Sasebo Naval Arsenal was recalled under custody of reparations. This action was necessary because previous releases included all buildings containing reparations.

3. Physical inspection reveals that only those buildings outlined in red on the attached map are required for custody and control of reparations. All buildings listed on the attached application are not required for custody of reparations, therefore, they may be released to the Ministry of Finance by the Regional Post Engineer under existing directives for the disposition of enemy surrendered property.

FOR THE CHIEF:

2 Incls:
1. Application
2. Map of Area

ELLSWORTH R. BOSMAN
Chief, Economics Section

Incl 13

KITAKYUSHU FINANCE DEPOT FUKUOKA,
KYUSHU, JAPAN.

3 June 1950.

FROM : CHIEF OF KITA-KYUSHU FINANCE BUREAU.
THRU : Chief of Kyushu Civil Affairs Region
TO : Sasebo Post Engineer
SUBJECT: Application for Release of Former Japanese Military and
naval installations.

We here by submit you the application for release as
above, including other attached sheets, and will be glad to get
your permission.

Incl 1. Buildings of Sasebo Naval Arsenal.

Signed

S. Kawato

Chief of Kita-Kyushu
Finance Bureau, Fukuoka, Japan.

del 85

Application for release of former Military installations

1. Location of the property in terms of Map Number, Map scale and Military grid coordinates and the chome-cho-ku address, if known.

Name of Former Military installations.
Sasebo Naval Arsenal

Location
Sasebo-shi, Nagasaki-ken.

Sheet
Coordinates
Former Owner
Navy

2. Acreage		Estimated value
	(15,887.9 tsubo)	803,600.00,
Building.....	564,020,45 sq/ ft.	¥ 2,232,993.03
		¥ 3,036,593.03

3. Number ^{and} of type of Building

	Build.	Ridge
Wooden one-storied	150	150
Wooden two- "	"	20
Brick one- "	"	21
Brick two- "	"	2
Iron one- "	"	14
Iron Two- "	"	1
Iron Concreted One "	"	11
Iron Concreted two "	"	3
Stone one "	"	2
Stone two "	"	1
Iron-wooden one- "	"	2
Total		227

Equipments		
Stoned	slip-way	I (No.1)
Concreted	"	I (No.2)
Concreted	"	I (No.3)
<u>Storage for gasoline</u>		<u>I (Build. No. 103)</u>
Total		4

4. General Description of the whole installations.

These buildings were formerly factories, warehouses and other attached house of Sasebo Naval Arsenal and in largely part, not to be accumulated reparation machineries, but several houses containing these machineries, will be applied on other terms. They are not complete, but the larger part of Buildings, used by Sasebo shipping industry Co., and nishi Kyushu Soko Co., No. improvement almost are made.

5. Proposed use.

Will be used as facilities for peace-time industries of ware-house

6. Recommendations.

No.	Name of Bldg.	Contr.	Quantity	Ageage (tsubo)	Remarks.
✓ 1	Warehouse	Wooden 1 stored	1	25.5	
✓ 1-1	No.8 Guard House	"	1	16.0	
✓ 1-2	No.8 Guard toilet	"	1	4.0	
2	Ware House.	"	1	189.0	Dismantled
3	No.5 "	"	1	184.0	
3-2	Ware-house	Stoned 1 stored	1	9.0	
4	"	Wooden "	1	20.0	
5	"	"	1	196.0	
6	"	"	1	140.0	
7	Plant	"	1	12.0	
8	"	"	1	48.0	
8-1	Toilet	"	1	1.0	
8-2	"	"	1	8.0	
9	Office	"	1	128.0	
9-1	Warehouse	"	1	33.4	Dismantled
10	Storage	" 2 storied	1	182.0	
11	Garage	"	1	208.0	
11-1	Wood Dring yard	" 1 "	1	16.0	Dismantled
13	Bath house	" " "	1	75.0	
13-1	Motor-Car Repair shop	"	1	10.0	
13-2	Plant	"	1	24.0	
13-3	Temporary Office	" 2 "	1	28.0	
13-4	Toilet	" 1 "	1	1.7	
13-5	Bath House	" " "	1	32.0	
14	Warehouse	" " "	1	65.0	
14-1	Charcoal-storage	" " "	1	18.0	Dismantled
14-2	Storage	" " "	1	24.0	
14-3	Plant	Iron 1 storied	1	70.0	
14-4	Ware house	" " "	1	35.0	
14-5	Toilet	Wooden "	1	1.5	
14-6	Ware-house	Iron 1 storied	1	70.0	
14-7	Storage	" " "	1	30.0	
14-8	Plant	" " "	3	317.0	
14-9	Laundry house	Wooden "	1	60.0	
16	Toilet	" " "	1	5.4	
16-1	Coal storage	" " "	1	20.0	
16-2	Charcoal shop	Iron 1 storied	1	25.0	
18	Temporary warehouse	Wooden "	1	90.0	Dismantled
19	Ware-house	" 2 "	1	288.0	
20	Plant	" 1 "	1	153.0	
21	No.3 Dock Office	" " "	1	80.0	
22	Toilet	Iron Cocreted storied.	1 1	6.5	
23	"	" " "	1	20.8	

No.	Name of Bldg.	Dontr.	Quantity	Acreage (tsubo)	Remarks
24	No.3 Kichen house	Iron cocreted storied	1 1	40.3	
24-3	Toilet	Wooden 1 storied	1 1	22.8	Dismantled
27	Ware-house	" " "	1 1	182.0	
27-1	& Toilet	" " "	2 2	8.6	
28	No.15 guard house & Toilet	" " "	1 1	252.8	Dismantled
28-1	Ware-house	" " "	2 2	5.5	
28-2	No.9 Guard house & Toilet	Bricked 1 storied	1 1	24.5	
28-2	Oil-storage	Iron concreted 2	1 1	96.0	
28-3	"	storied			
28-4	Ware-house	Wooden 1 storied	1 1	90.0	Dismantled
28-5	Plant	Iron concreted 1 storied	1 1	56.0	
28-6	Toilet	Wooden 1 storied	1 1	9.0	Dismantled
29	Ware-house	" 1 "	1 1	158.0	
32	Temporary ware house	" 2 "	1 1	180.8	
32-1	Ware-house	" 1 "	1 1	120.0	
50	Motorcar repair shop.	" " "	1 1	137.3	PARTLY 2 STORIED
51	Garage	" " "	1 1	3.0	Dismantled
52	Ware-house	" " "	1 1	16.0	
53	"	" " "	1 1	15.0	
56	"	" " "	1 1	15.0	Dismantled
57	Chacoal storage	" " "	1 1	187.5	
58	Ware-house	" 2 "	1 1	205.6	
59	"	" 1 "	1 1	31.5	
60	Repair shop	" " "	1 1	40.0	
60-1	Plant	" " "	1 1	90.0	
62	Locomotive repair shop	" " "	1 1	90.0	Dismantled
63	Ware house	" " "	1 1	13.2	
67-1	Toilet	" " "	1 1	1.0	
73	Machine plant	Iron " "	1 1	90.0	
73-1	Toilet	Iron concreted 1 storied	1 1	64.0	
74	No.2 PAINT storage	" " "	1 1	25.0	
74-1	Toilet	" " "	1 1	10.0	
75	No.2 dock office	Wooden 1 storied	1 1	160.0	
76	Plant	Iron concreted 1 storied	1 1	5.9	
76-1	Toilet	Wooden 1 storied	1 1	3.0	Dismantled
76-2	No.14 guard house & Toilet	" " "	1 1	2.5	
79-1	No.2 fire station	" " "	1 1	14.5	
79-2	Toilet	" " "	1 1	0.5	
79-3	Office	" " "	1 1	10.5	
79-4	Amaishi Guard house	" " "	1 1	5.5	

No.	Name of bldg.	Construction	quantity.	Acreage (tsubo)	Remarks
79-5	Toilet	Wooden 1 storied	1	20.0	
80	No.7 dock office	" " "	1	48.0	
80-1	No.4 Garage	" 2 "	1	300.5	
84	Bath house	" 1 "	1	25.0	
85	Ware house	" " "	1	144.0	Dismantled
85-1	No.6 Guard house	" " "	1	4.0	
86	Toilet	" " "	1	105.0	
88	Ware-house	" 2 "	1	459.5	
89	Garage	" 1 "	1	60.0	
92	Rivet storage	" " "	1	57.99	
97-1	Toilet	" " "	1	12.13	
97-2	"	" " "	1	15.0	
97-3	"	" " "	1	13.24	
97-4	Ware house	" " "	1	44.98	
97-5	Slip way toilet	" " "	1	2.72	
97-6	"	" " "	1	6.12	
97-7	"	" " "	1	11.0	
100	Office	Stoned 2 "	1	302.76	
100-1	Toilet	Wooden 1 "	1	3.75	
101-1	"	" " "	1	12.0	
101-2	Plant	" " "	1	12.0	
101-3	Ware-house	Bricked " "	1	9.1	
102-2	Office	Wooden " "	1	40.0	Dismantled
102-3	No.5 guard house	" " "	1	15.19	
102-4	Toilet	" " "	1	2.5	
105	Ware-house	Bricked " "	1	21.81	
107-1	Toilet	Wooden " "	1	20.0	
107-2	"	" " "	1	7.99	
107-3	Storage	" 2 "	1	27.22	Dismantled
109-3	Toilet	" 1 "	1	8.93	
109-4	"	" " "	1	3.03	
110-1	"	" " "	1	15.48	
110-2	No.4 Guard house	" " "	1	4.0	
111	Plant	" " "	1	250.0	Dismantled, PARTLY 2 storied
112	No.1 paint storage	Bricked " "	1	22.32	
113	Toilet	Wooden " "	1	44.9	
115	Ware-house	Iron concketed 1 storied	1	82.25	
116	"	Bricked 2 storied	1	38.48	
117	Office	Wooden 1 "	1	197.12	
117-1	Toilet	" " "	1	9.94	
118-1	"	" " "	1	8.47	
119-1	No.3 guard house	" 2 "	1	6.60	
119-2	Office	" " "	1	12.48	
119-3	Ware-house	" " "	1	48.0	

No.	Name of Building.	Construction	Quantity	Acreage (tsubo)	Remarks
119-4	Guard House	Wooden 1 storied	1	1.5	
121-2	Toilet	" " "	1	10.1	
122	Plant	Iron wood 1 storied	1	190.11	
122-1	Bath-house	Iron 1 "	1	12.48	
122-3	Toilet	Wooden 1 "	1	16.32	
125	Office	" " "	1	20.49	
127	Wood Storage	" " "	1	96.0	
129-1	Ware-house	" " "	1	12.0	
130	"	" " "	1	240.0	
132	"	" " "	1	102.0	
132-1	Toilet	" " "	1	20.0	
132-2	Ware-house	" 2 "	1	306.0	
135	"	" " "	1	378.0	
134	"	" " "	1	210.0	
134-1	No.10 Guard house & toilet	" 1 "	2	3.0	
134-2	Toilet	" " "	1	3.6	PARTLY
135	Toilet &	" 2 "	1	36.75	1 storied
136	Office	Bricked 2 "	1	608.2	
137-1	Oxygen house	" 1 "	1	42.0	PARTLY
137-2	Carbide house	" 1 "	1	34.74	2storied
137-3	Toilet	Wooden 1 "	1	4.0	
140-1	Toilet	" " "	1	4.0	
142-1	"	" " "	1	13.75	
143-1	Plant	" " "	1	57.40	
143-2	Toilet	" " "	1	18.15	
143-3	"	" " "	1	22.0	
146-1	Ware-house	Bricked " "	1	82.49	
146-2	Toilet	Wooden " "	1	13.8	
146-3	Ware-house	Iron " "	1	20.0	
149	"	Bricked 1 "	1	134.49	
150	"	" 1 "	1	93.02	
151	"	" " "	1	133.451	
152	"	" " "	1	218.49	
154	Office	Iron concreted 2 storied	1	643.64	
154-4	Ware-house	Bricked 1 storied	1	24.0	
154-2	No. 1 guard house	Wooden " "	1	10.0	
155-1	Welding plant	Iron " "	1	24.42	
155-2	Toilet	Wooden " "	1	12.69	
155-3	"	" " "	1	12.0	
156-2	"	" " "	1	12.5	
156-3	"	" " "	1	5.0	Dismantled
156-4	No.2 Guard house	" " "	1	5.0	
156-5	Toilet	" " "	1	0.5	
156-6	Ware-house	Bricked " "	1	2.0	
156-7	"	Wooden 2 "	1	182.37	
157-1	Toilet	" 1 "	1	11.25	
157-2	"	" " "	1	18.75	
157-3	Warehouse	Iron " "	1	120.0	
157-4	Mess-house	Wooden " "	1	39.79	
157-5	Toilet	" " "	1	7.0	

No.	Name of Bldg.	Construction	Quantity	Acreege (tsubo)	Remarks
167	Ware-house	Stoned 1 storied	1	495.0	PARTLY 2 storied
168	"	" " "	1	495.0	"
168-2	"	Bricked " "	1	38.0	
168-3	"	Wooden " "	1	87.5	
168-4	"	Bricked " "	1	12.5	
168-5	Toilet	Wooden " "	1	11.0	
168-6	Ware-house	Iron concreted 1 storied	1	2.5	
168-7	"	Bricked " "	1	38.0	
169	"	" " "	1	214.5	
170	"	" " "	1	214.5	
171-1	"	Wooden " "	1	60.0	
171-2	"	" " "	1	55.0	Dismantled
171-3	"	" " "	1	50.0	"
171-4	"	" " "	1	12.0	"
172-2	"	" " "	1	8.0	
172-5	Toilet	" " "	1	12.0	
176	Plant	" 2 " "	1	208.0	Dismantled
176-1	Toilet	" 1 " "	1	10.0	"
176-2	Warehouse	" 2 " "	1	120.0	
176-3	Toilet	" 1 " "	1	6.0	
176-4	Ware-house	" " "	1	4.5	
176-5	Ware-house	" " "	1	18.0	
176-5	Guard house	" " "	1	10.0	
176-8	Toilet	" " "	1	10.0	
177	Plant	Iron concreted 2 storied	1	261.11	
178	Auditorium	Iron & Wooden 1 storied	1	174.0	
178-1	Toilet	Wooden 1 storied	1	12.0	
180-1	"	" " "	1	25.98	
180-2	"	" " "	1	13.07	
180-3	Office custom	Bricked " "	1	35.0	
181	Ware-house	Wooden " "	1	132.47	
182-1	Toilet	" " "	1	3.0	
185-1	Ware-house	" " "	1	75.07	
185-2	Toilet	" " "	1	10.09	
185-3	Plant	Iron-concreted 1 storied	1	6.55	
188-1	Toilet	Wooden " "	1	10.02	
189-2	Ware-house	Iron " "	1	139.19	
189-1	Toilet	Wooden " "	1	8.75	
189-2	"	" " "	1	18.7	
189-3	"	" " "	1	20.9	
192-1	Bath house	" " "	1	20.89	
193	Battery plant	Iron 2 storied	1	140.29	
193-1	Plant	" 1 " "	1	77.97	
197-1	Toilet	Wooden 1 storied	1	18.0	
197-2	Ware-house	" " "	1	56.87	
200-1	"	Bricked " "	1	41.0	
201	"	Wooden 2 " "	1	238.0	
201-1	"	" 1 " "	1	10.0	
201-2	"	" " "	1	2.0	Dismantled

<u>No.</u>	<u>Name of Bldg.</u>	<u>Construction</u>	<u>Quantity</u>	<u>Acreage (tsubo)</u>	<u>Remarks</u>
201-3	Boiler house	Wooden 21 storied	1	5.0	
201-4	Plant	" " "	1	21.0	Dismantled
201-5	Ware-house	" " "	1	12.0	"
201-6	"	Bricked " "	1	28.0	Underground

Map attached

Cable Address
"SOKO SASEBO"

Telephone:
433 SASEBO



LANDING & SHIPPING AGENTS
STEVEDORES, CUSTOMS
BROKERS,
WHARFINGERS AND
WAREHOUSEMEN

NISHI KYUSHU WAREHOUSE CO., LTD
TATEGAMI AREA, EX-NAVAL ARSENAL
SASEBO JAPAN

Sasebo, May 24. 1950.

To : Col. Burgheim, Commdr. of Kyushu Civil Affairs Region,
Fukuoka.
From : Nishi Kyushu Warehouse Co., Ltd.

Subject: Approval for Repairing & Temporary Use of Building
No. 168, Petition for.

Dear Sir,

We would be glad to express our heartfelt thanks for your kind approval for the temporary use of building No. 145 (partly) 167, 169 and 170 (building next to No. 169, newly numbered) for the storage of importing wheats.

The ship, changing her original schedule, is expected to enter in this port in end of May and we are fixing our warehouses and discharging machines and tools, however sorry to say, the space of warehouses, being capable of fumigation, are not enough for this quantities.

Under the circumstances, we again ask you for your special consideration for the temporary use of building No. 168, situated next to building No. 167 and in close proximity to ship's berth but the same have been heavily damaged on its walls, doors and roofs, requiring repairs of about yen 500,000.

Your generous approval for this matter will much oblige us,

Yours faithfully,

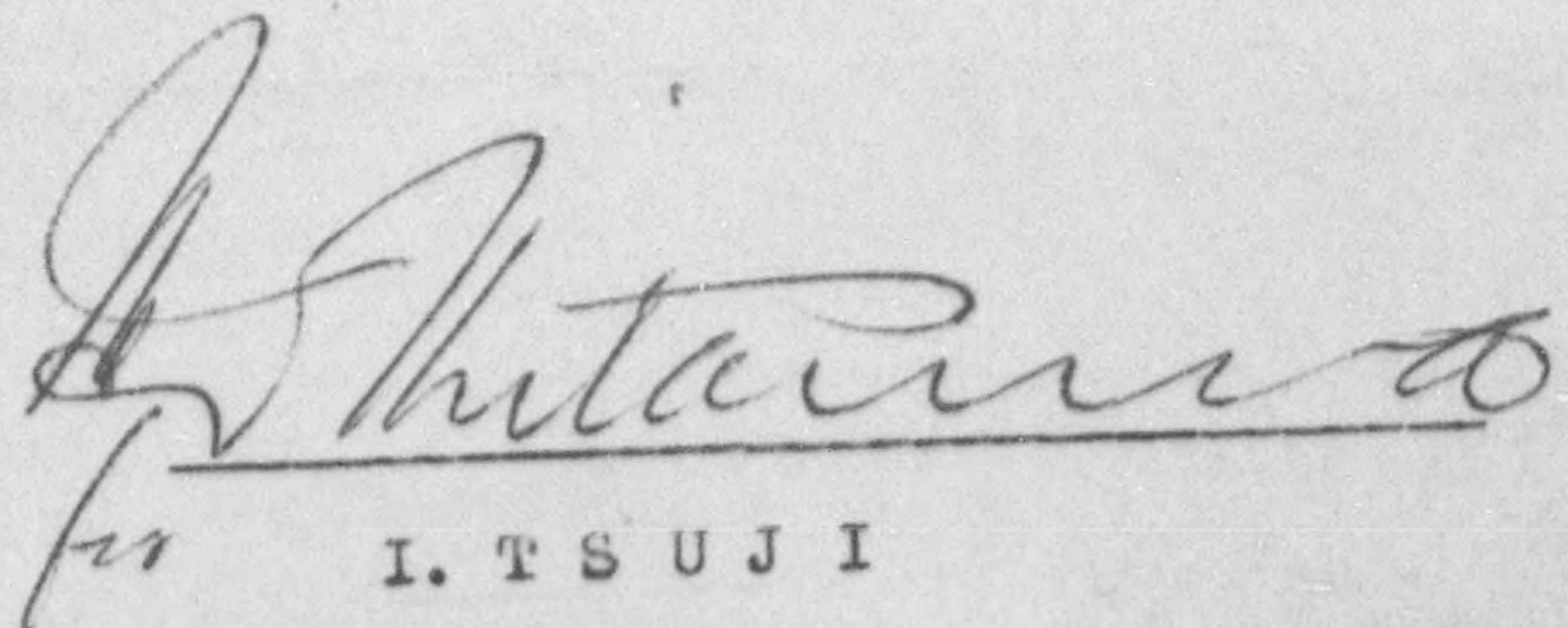
I. T S U J I

President, Nishi Kyushu Warehouse Co.

Cable Address
"SOKO SASEBO"

Telephone:
433 SASEBO



LANDING & SHIPPING AGENTS
STEVEDORES, CUSTOMS
BROKERS,
WHARFINGERS AND
WAREHOUSEMEN

NISHI KYUSHU WAREHOUSE CO., LTD
TATEGAMI AREA, EX-NAVAL ARSENAL.
SASEBO, JAPAN

Sasebo, May 24. 1950.

To ; Col. Burgheim, Commdr. of Kyushu Civil Affairs Region,
Fukuoka.
From , Nishi Kyushu Warehouse Co. Ltd.
Subject; Approval for Repairing & Temporary Use of Building
No. 168, Petition for.

Dear Sir,

We would be glad to express our heartfelt thanks for your kind approval for the temporary use of building No. 145 (partly) 167, 169 and 170 (building next to No. 169, newly numbered) for the storage of importing wheats.

The ship, changing her original schedule, is expected to enter in this port in end of May and we are fixing our warehouses and discharging machines and tools, however sorry to say, the space of warehouses, being capable fumigation, are not enough for this quantities.

Under the circumstances, we again ask you for your special consideration for the temporary use of building No. 168 situated next to building No. 167 and in close proximity to ship's berth but the same have been heavily damaged on its walls, doors and roofs, requiring repairs of about yen 500,000.

Your generous approval for this matter will much oblige us,

Yours faithfully,

I. TSUJI

President, Nishi Kyushu Warehouse Co.

FROM : Fukuoka Finance Office, Fukuoka, Kyushu.
TO : Headquarters, Kyushu Civil Affairs Region
SUBJECT : Report on the robbery of Ex-Sasebo Naval Arsenal.

Date : May 6 1950.

We submit to your headquarters a report on the stolen accessories of crane on the sea, according to the letter from the chief, Sasebo Custody Office on april 11, 1950.

The specifications are as listed below.

1. Name of plant : Ex-Sasebo Naval Arsenal
2. Location stolen: Ithori-ura, Port Sasebo, Ebisu Bay
3. Date stolen : from march 5 to march 15 1950.
4. Stolen Item : accessories of 350 tons crane on the sea (crane Inv. No. 25-3-11,000)

Name of Item	Unit	Quantity	Weight(Kg)	Cost estimate
Wire(covered with lead)	dia 40mm	about 26 Meters	28	¥ 2,100.-
"	" 25mm	about 112 meters	98	¥ 7,350.-
Electric wire	" 6mm	about 40 meter	10	¥ 750.-
Switch, accessories of switch board	Piece	10		¥ 500.-
Magnet coil	"	7		¥ 3,500.-
Resistance coil	"	10		¥ 1,000.-
TOTAL				¥ 15,200.-

5. Date discovered : Mar, 16, 1950

6. Soon after the above items were stolen by thieves, the chief of Sasebo Custody Office informed this affair to Sasebo City Police Station. Afterwards, three items (two wires with lead and electric wire) in the above items were discovered by policemen at the selling shop of the used articles in the Sasebo City and taken back to the Sasebo Custody Office.

The members of Sasebo city police Station and Sasebo Custody Office, Fukuoka Finance Office, are looking for the other items.

We will urge, from now on, guards to push the watch service for the prevention of robbery.

Signature :

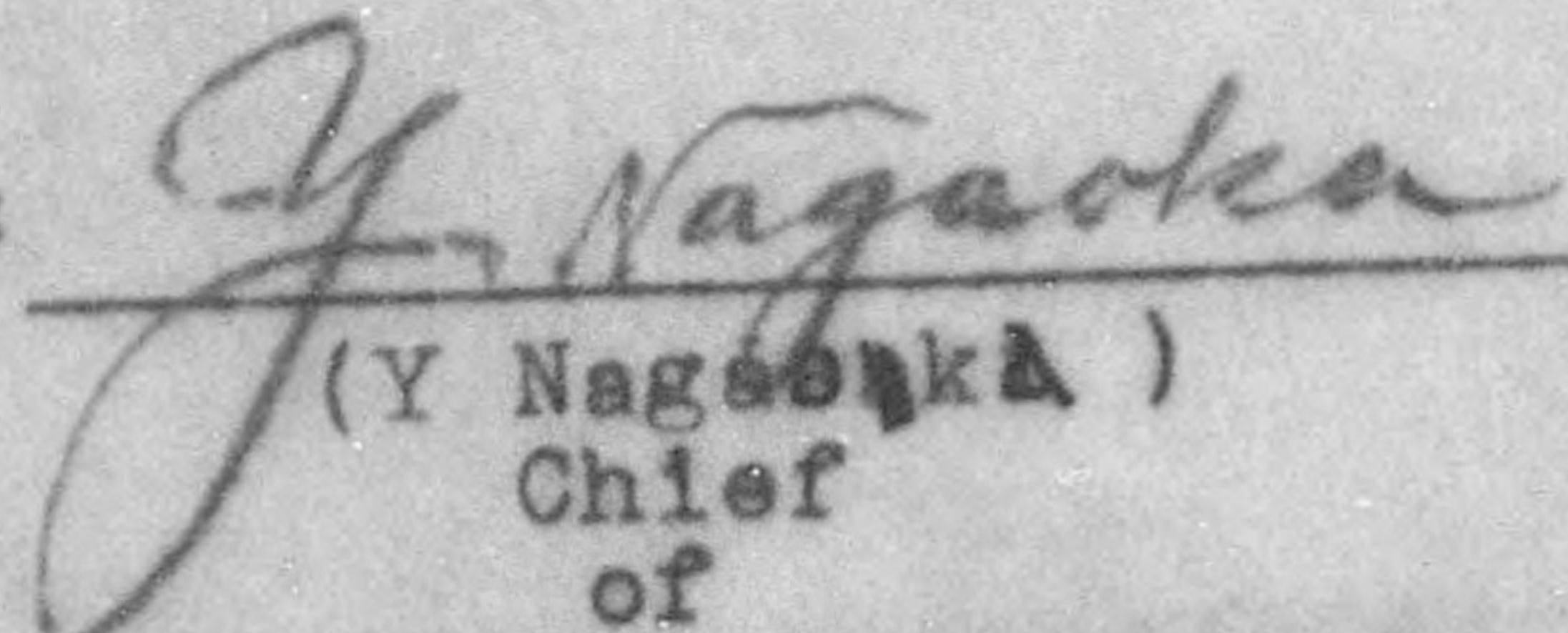

(Y Nagasaki)
Chief
of

Reparations Section,
Fukuoka Finance Office.

File
27-03

TO : HEADQUARTERS, KYUSHU CIVIL AFFAIRS REGION
FROM : Kyushu Liaison and Coordination Office
SUBJECT : Recall of Former Japanese Naval Installation

KLCO NO. 540

1 June 1950

1. Reference, letter 387.6, Kyushu Civil Affairs Region, subject: "Recall of Former Japanese Naval Installations, dated 1 April 1950.

2. This office hereby submits to your office two copies of OGA Form No. 1 which were being kept by the Kita Kyushu Finance Bureau and Nagasaki Prefectural Government (original copy) respectively, in compliance with paragraph 4, of reference above.

FOR THE DIRECTOR:



(Y. NISHI)

Liaison Officer
of
Kyushu Liaison & Coordination Office

TO : HEADQUARTERS, KYUSHU CIVIL AFFAIRS REGION
FROM : Kyushu Liaison and Coordination Office
SUBJECT : Recall of Former Japanese Naval Installation

KLCO NO. 540

1 June 1950

1. Reference, letter 387.6, Kyushu Civil Affairs Region, subject: "Recall of Former Japanese Naval Installations, dated 1 April 1950.

2. This office hereby submits to your office two copies of OGA Form No. 1 which were being kept by the Kita Kyushu Finance Bureau and Nagasaki Prefectural Government (original copy) respectively, in compliance with paragraph 4, of reference above.

FOR THE DIRECTOR:

(Y. NISHI)

Liaison Officer
of
Kyushu Liaison & Coordination Office

RELEASE OF FORMER JAPANESE MILITARY AND NAVAL
INSTALLATIONS

Page 1 of 2 Pages

RECEIVED FROM: Sgt. Charles E. Hollison, 1st Lt., 24th Inf. Cav. Group, Nagasaki
OFFICER ORGANIZATION LOCATION PREFECTURE

DATE RECEIVED 5 March 1948 (PARTIAL) (FINAL) RELEASE
(delete one)

ESTIMATED VALUE IN YEN OBTAINED
FROM MINISTRY OF FINANCE BUREAU
OF STATE PROPERTY

LOCATION INSTALLATIONS

(1278 1113)
Sasebo Naval Arsenal
Sasebo City

Total Acreage: - 14,079.19 Sq. Ft
266 Installations as below:

- 132- Wooden 1-storied
- 20- Wooden 2-storied
- 6- Iron Framed 2-storied
- 28- Iron framed 1-storied
- 1- Bricked 1-storied (part of 2-storied)
- 21- Bricked 1-storied
- 1- Concrete 1-storied (part of 2-storied)
- 3- Bricked 2-storied
- 8- Concrete 2-storied
- 1- Iron Framed 1-storied (part of wooden 2-storied)
- 1- Iron frame, 1-storied (" " 2-storied)
- 1- Iron frame, 2-storied (part of wooden 2-storied)
- 6- Iron Framed 1-storied (part of 2 storied)
- 17- Concrete 1-storied
- 2- Bricked & wooden 1-storied
- 3- Iron frame & wooden 1-storied

Improvement valuation
in dollars 0

- continued on next page -

DROPPED FROM
PROPERTY RECORDS OF 24th Infantry BY Charles E. Hollison, Capt. 5 March 48
ORGANIZATION OFFICER RANK DATE

REMARKS:

CERTIFIED CORRECT EXCEPT AS NOTED INITIALED

BY [Signature] Nagasaki Mil. Gov. Sec. 11 Mar 1948
RELEASING OFFICER ORGANIZATION DATE

BY [Signature] Nagasaki 11 Mar 48
JAPANESE REPRESENTATIVE AGENCY DATE

OGA FORM 1 as amended

Inclo #1 to OD 28/14 for 1947
Hqs 8th Army 27 February 1947

RELEASE OF FORMER JAPANESE MILITARY AND NAVAL
INSTALLATIONS

Page 2 of 2 Pages

RECEIVED FROM: Edward H. Millison, 1st Lt, 20th Infantry, 8th Army, Nagasaki

DATE RECEIVED 5 March 1948 (PARTIAL) (FINAL) RELEASE
(one)

ESTIMATED VALUE TO BE OBTAINED
FROM MINISTRY OF FINANCE BUREAU
OF STATE PROPERTY

LOCATION	INSTALLATIONS	ESTIMATED VALUE TO BE OBTAINED FROM MINISTRY OF FINANCE BUREAU OF STATE PROPERTY
Sasebo Naval Arsenal Sasebo City (Continued)	1- Storage for gasoline, concrete. 1- Stone Building 1- Concrete & Wooden 1-storied 1- Concrete Water Tank 2- Wooden 1-storied (part of 2-storied) 1- wooden 1-storied (3 bldgs connected) 1- Iron Frame, 1-storied (part of wooden-storied & wooden 2-storied) 1- Concrete, 2-storied (part of 3-storied) 1- Concrete 2-storied (part of 1-storied)	
Sasebo Naval Arsenal Sasebo City	Six (6) Bldgs Three (3) City	
Sasebo Naval Arsenal Sasebo City	Acres: - 9,443,856 Sq. Ft LAND - One	Improvement valuation in dollars <u>0</u>
Sasebo Naval Arsenal Sasebo City	Acres: - 304.99 Sq. Ft LAND - One	

DROPPED FROM PROPERTY RECORDS OF 34th Engineer BY 1st Lt. E. H. MILLISON, Capt. 5 March 48

REMARKS:

CERTIFIED CORRECT EXCEPT AS NOTED INITIALED

BY [Signature] Nagasaki Military Liaison 11 Mar 1948
RELEASING OFFICER ORGANIZATION DATE

BY [Signature] Nagasaki 11 Mar 1948
JAPANESE REPRESENTATIVE AGENCY DATE

OGA FORM 1, as amended

Incl 1 to OD 28/14 for 1945
Hqs 8th Army 27 February 1947

RELEASE OF FORMER MILITARY AND NAVAL INSTALLATIONS

Page 1 of 2 pages

RECEIVED FROM: Howard E. Rollison, 1st Lt. 34th Inf. Camp Mower, Nagasaki
 NAME OF OFFICER ORGANIZATION LOCATION PREF.

DATE RECEIVED: 5 March 1948

FINAL RELEASE

ESTIMATED VALUE IN YEN OBTAINED FROM MINISTRY OF FINANCE BUREAU OF STATE PROPERTY

LOCATION	INSTALLATIONS
(1278_1113) Sasebo Naval Arsenal Sasebo City	Total Acreage:- 14,079.19 Sq.ft. 268 Installations as below: 132- Wooden 1-storied 20- Wooden 2-storied 6- Iron Framed 2-storied 38- Iron Framed 1-storied 1- Brick 1-storied (partly 2-storied) 21- Brick 1-storied 1- Concrete 1-storied (partly 3-storied) 3- Brick 2-storied 5- Concrete 2-storied 1- Iron framed 1-storied (part of wooden 2-storied) 1- Iron framed 1-storied (partly 2-storied) 1- Iron framed 2-storied (part of wooden 2-storied) 6- Iron framed 1-storied (part of 2-storied) 17- Concrete 1-storied 2- Brick & wooden 1-storied 3- Iron frame & wooden 1-storied

- continued on next page -

DROPPED FROM PROPERTY RECORDS OF 34th Inf. BY Charles R. Miller, Capt., 5 March 48
 ORGANIZATION ACCOUNTABLE OFFICER RANK DATE

REMARKS:

CERTIFIED CORRECT EXCEPT AS NOTED AND INITIALLED:

BY JOE C. GOLDSBY Nagasaki Mil Gov't Team 11 March 1948
 RELEASING OFFICER ORGANIZATION DATE

BY H. KITAMURA Nagasaki 11 March 1948
 JAPANESE REPRESENTATIVE AGENCY DATE

RELEASE OF FORMER JAPANESE MILITARY AND NAVAL
INSTALLATIONS

Page 2 of 2 pages

RECEIVED FROM: Howard E. Rollison, 1st Lt., 34th Inf. Camp Mower, Nagasaki
 NAME OF OFFICER ORGANIZATION LOCATION PREFECTURE
 DATE RECEIVED: 5 March 1948 FINAL RELEASE

ESTIMATED VALUE IN YEN OBTAINED
FROM MINISTRY OF FINANCE BUREAU
OF STATE PROPERTY

LOCATION	INSTALLATIONS	ESTIMATED VALUE IN YEN OBTAINED FROM MINISTRY OF FINANCE BUREAU OF STATE PROPERTY
Sasebo Naval Arsenal, Sasebo City (Continued)	1- Storage for gasoline - concrete made 1- Stone building 1- Concrete and wooden 1-storied 1- Concrete Water Tank 2- Wooden 1-storied (part of 2-storied) 1- Wooden 1-storied (3 bldgs connected) 1- Iron frame 1-storied (part of wooden 1-storied and wooden 2-storied)	
Sasebo Naval Arsenal, Sasebo City.	Six (6) Docks Three (3) Slip	
Sasebo Naval Arsenal, Sasebo City	Acreage:- 9,443.556 sq.ft. LAND - One	
Sasebo Naval Arsenal, Sasebo City	Acreage:- 904.99 sq.ft. LAND - One	

DROPPED FROM
PROPERTY RECORDS OF 34th Inf. BY Charles R. Miller, Capt., 5 March 48
 ORGANIZATION ACCOUNTABLE OFFICER RANK DATE

REMARKS:

CERTIFIED CORRECT EXCEPT AS NOTED AND INITIALLED:

BY JOE C. GOLDSBY Nagasaki Mil Gov't Team 11 March 1948
 RELEASING OFFICER ORGANIZATION DATE

BY H. KITAMURA Nagasaki 11 March 1948
 JAPANESE REPRESENTATIVE AGENCY DATE

Economus

4893 KYUSHU

CIVIL PROPERTY CUSTODIAN
APO 500

INFORMATION:

O.D. 11 JUN - 8. 1950
HF/CHR/MS
JUN 1950

387.6 (7 JUN 1950) GPC/AD

MEMORANDUM FOR: Reparations Division, Reparations Agency, Japanese Government, Tokyo, Japan

SUBJECT: Release of Reparations Equipment

1. Reference is made to letter from Reparations Agency, Reparations Division, BAR No. 458 (MS), 16 May 1950, with inclosure thereto.
2. The request contained in reference 1 above for the release of Pneumatic Hammer, Piston Valve Type, as melt down scrap, is approved.
3. It is directed that a report be rendered to Civil Property Custodian, General Headquarters, Supreme Commander for the Allied Powers within ninety (90) days from the date of this memorandum showing the disposition of the equipment released.

Economus

E. C. MILLER, Jr.
Colonel, Infantry
Deputy Custodian

DISTR:
ESS
CAS
CHS (2)

CAS

Kyushu 20 11 000 2-102

Incl 1

KYUSHU

REPARATIONS AGENCY
REPARATIONS DIVISION

TO : GENERAL HEADQUARTERS, SUPREME COMMANDER FOR THE
ALLIED POWERS.

FROM : Reparations Agency, Tokyo.

SUBJECT: Application for Release of Reparations Equipment as
Scrap.

RAR No. 458 (MS)

16 May 1950

1. The Reparations Agency hereby submits to your Headquarters an application for release of a reparations item which has neither been inventoried nor been evaluated by reason of having no value other than as scrap, filed by Kumamoto Financial Office as enclosed herewith.

2. This application had been transmitted to the Kumamoto Civil Affairs Team, but, as it was returned after the issuance of OD No. 51 in September 1949, it is requested now that the formal permission of release as scrap be given by you Headquarters at the earliest practicable date.

(Y. Katsuno)
Director, Reparations Division,
Reparations Agency.

Incl: Application of the
Kumamoto Financial Office.

Kumamoto Financial Office

HI/sg

To : General Headquarters, Supreme Commander For The Allied Powers, Economic & Scientific Section.

Thru : Ministry of Finance.

Subject; Application for Release of Scrap Value Item belonging to Ex-Sasebo Naval Arsenal.

Km. F.B. No. 52

Jan. 9, 1950

1. Description of Items:

Location	Name of Item	Capacity	Est. Wt. (Tonnage)
Kawashiri-machi, Kumamoto City. (Kumamoto Prefectural Industry laboratory)	1/8 ton Pneumatic Hammer, Piston Valve type.	Max. stroke: 15 $\frac{1}{2}$ " HP of motor: 10	4

2. Item indicated on Paragraph 1, above had been moved from Sasebo Naval Arsenal to above Location before the End of the War. But owing to the calamity of the War, this machine had been burnt down and not inventoried by reason of Scrap Value. Since then it has been stored in that condition. Therefore I request that Authorization for Release will be granted by your kind consideration.

Tamio Morita

Director, Kumamoto Financial
Office.

KYUSHU CIVIL AFFAIRS REGION
HQ SCAP
Fukuoka, Kyushu, Japan

MTW/lms

APO 24 Unit 5
16 June 1950

E 387.6

SUBJECT: Resetting of Authorized Use Trackage

THROUGH: Kyushu Liaison and Coordination Office, Fukuoka, Kyushu

TO : Nishi Kyushu Warehouse Company,
Sasebo-shi, Nagasaki Ken

1. This headquarters has no objection to the re-locating of the trackage three (3) meters as described on the attached application, providing that the following is observed.

a. Cost will be paid for by the Nishi Nippon Warehouse Company.

b. That this project will in no way interfere with movement of occupational equipment.

c. That the work could be completed before the JOSCO Oil Spar project is completed.

FOR THE CHIEF:

1 Incl:
Application

WILSWORTH R. MOSMAN
Chief, Economics Section

Cable Address
"SOKO SASEBO"
Telephone:
433 SASEBO



LANDING & SHIPPING AGENTS
STEVEDORES, CUSTOMS
BROKERS,
WHARFINGERS AND
WAREHOUSEMEN

NISHI KYUSHU WAREHOUSE CO., LTD
TATEGAMI AREA, EX-NAVAL ARSENAL
SASEBO JAPAN

Sasebo, 15th June, 1950

To : Col. Burgheim, Commdr. of Kyushu
Civil Affairs Region, Fukuoka.

From : Nishi Kyushu Warehouse Co., Ltd.

Subject: Approval for cutting bomb pressure shelters,
petition for.

Dear Sir,

Please be informed that we are applying to get approval for reviving the ex naval railroad tracks to carry out smooth transportation of goods to and from our warehouses located thereby as per drawing attached, which requires to remove 3 tracks for allowing big government locomotives (before ex naval small locomotives only utilized) but the shifting met dead-locks due to electric power lines underground for ex naval arsenal area.

Under the circumstances, engineers advised that they cannot help but to plane away portions of two concrete shelters against bomb pressure, attached to building which is now occupied by S.S.K. for telephone exchange equipment: cutting about 2-4 M. height, 63 m.m. depth, and 3-4 cub. M. width, of portions facing to the tracks.

In this connection, your kind approval for cutting the same at our expence will greatly oblige us.

Yours faithfully,

Incl 1
Michael W. Wolniak
MICHAEL W. WOLNIAK
AUTHORIZED TO CERTIFY ALL
REPARATIONS DOCUMENTS FOR
KYUSHU CIVIL AFFAIRS REGION

I. Tsuji
for I. TSUJI
President,
Nishi Kyushu Warehouse Co., Ltd.

立神

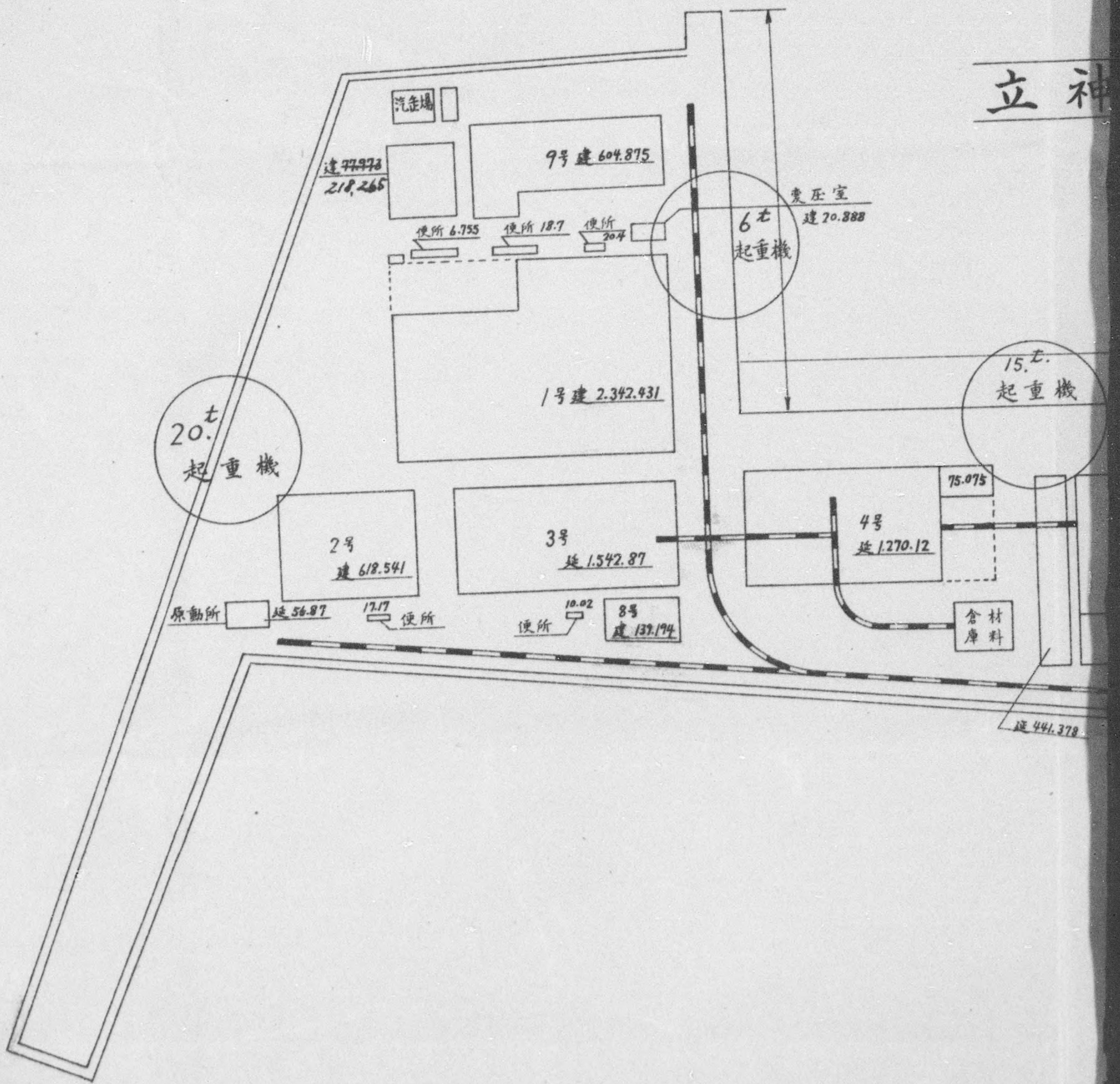

copy

立神繫船池

1
2000.

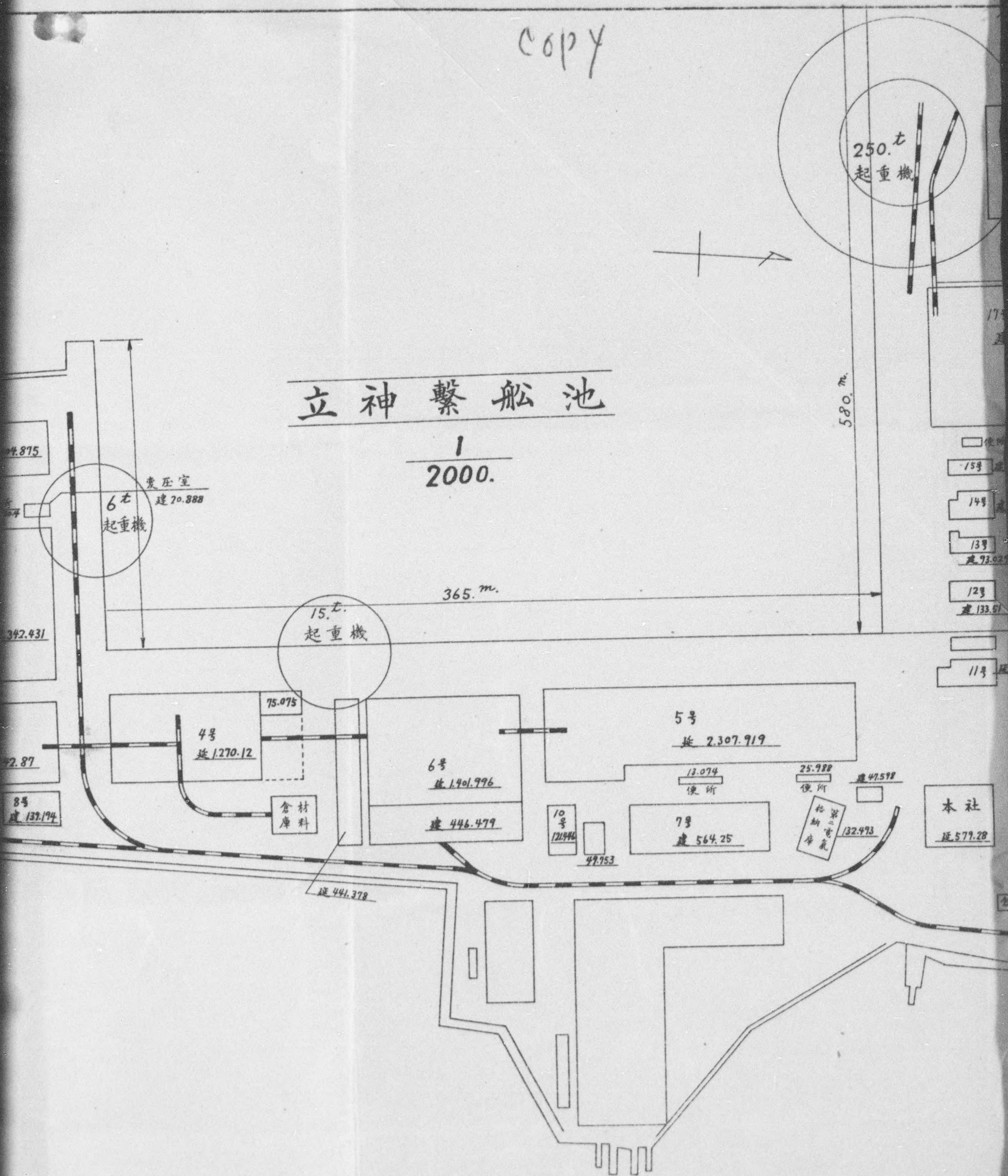

250. 七
起重機

580. m.

17号
建 1,195.46

便所

15号 建 22.491

14号 建 149.857

13号

建 93.029

16号

建 134.491

12号

建 133.51

11号 建 218.492

5号
建 2,307.919

13.074

便所

25.988

便所

建 47.518

松葉
第二
倉庫

132.493

本社

建 579.28

SSK

倉庫

運輸係
事務所

TEL
Ex-
change

WIDTH 40 m.
HEIGHT 4 m.
DEPTH 63 m.m.

WIDTH 40 m.
HEIGHT 2 m.
DEPTH 63 m.m.

20

21

22

Sent file

KYUSHU CIVIL AFFAIRS REGION
GHQ SCAP
Fukuoka, Kyushu, Japan

MWW/mms

APO 24 Unit 5
26 May 1950

E 387.6

SUBJECT: Authorized Use of Reparations Equipment

TO : Commanding Officer, Eleventh Engineer Construction Battalion,
Fukuoka Detachment, Construction Section, APO 929
ATTN: Mr. Rahmes

1. Reference is made to telephone conversation with Mr. Rahmes, Eleventh Engineer Construction Battalion, Fukuoka Detachment, requesting a copy of letter, authorizing use of reparations equipment.

2. Transmitted herewith as Inclosure #1, a copy of approval received from higher headquarters.

FOR THE CHIEF:

1 Incl:
As indicated

ELLSWORTH R. MOSMAN
Chief, Economics Section

C O P Y

HEADQUARTERS
11TH ENGINEER COMBAT BATTALION
CONSTRUCTION SECTION

ENG/ys
12 April 1950

SUBJECT: Release of Reparations Material

TO : Commanding General
Eighth Army
APO 343

ATTN: The Engineer

1. It is requested that reparations railway materials described below be released to enable this unit to complete construction of rail siding for JOSCO located at Sasebo, Kyushu, Japan.

	<u>Reparation Code</u>	<u>Description</u>	<u>Class</u>	<u>Length of Track</u>
a.	27-3-5062	30 Kg M	2	2,900 Meters
b.	27-3-5115	30 Kg M	2	1,120 "
c.	27-3-5114	30 Kg M	1	80 "

2. The construction was authorized by GHQ, FEC directive JAP 302 and Eighth Army Procurement Demand Number JPNC-146 and further indentified by Eighth Army Construction Directive Number LE-I-9-35.

3. The track is at present in place but is not being used and is necessary for a right of way into the JOSCO Oil Terminal. A delay in scheduled progress has resulted due to slow processing for release of these rails and the target date for completion of this project cannot be met unless early release is effected.

4. Recommend that the officer in charge of the Civil Affairs Region at Fukuoka be given verbal authority to effect release pending formal processing of the necessary papers.

FOR THE COMMANDING OFFICER:

s/t/ J. H. COSPER
Lt. Col, CE
Chief, Const Sec.

C O P Y

HEADQUARTERS
11TH ENGINEER COMBAT BATTALION
CONSTRUCTION SECTION

ENG/ys
12 April 1950

SUBJECT: Release of Reparations Material

TO : Commanding General
Eighth Army
APO 343

ATTN: The Engineer

1. It is requested that reparations railway materials described below be released to enable this unit to complete construction of rail siding for JOSCO located at Sasebo, Kyushu, Japan.

	<u>Reparation Code</u>	<u>Description</u>	<u>Class</u>	<u>Length of Track</u>
a.	27-3-5062	30 Kg M	2	2,900 Meters
b.	27-3-5115	30 Kg M	2	1,120 "
c.	27-3-5114	30 Kg M	1	80 "

2. The construction was authorized by GHQ, FEC directive JAP 302 and Eighth Army Procurement Demand Number JPNC-146 and further indentified by Eighth Army Construction Directive Number LE-I-9-35.

3. The track is at present in place but is not being used and is necessary for a right of way into the JOSCO Oil Terminal. A delay in scheduled progress has resulted due to slow processing for release of these rails and the target date for completion of this project cannot be met unless early release is effected.

4. Recommend that the officer in charge of the Civil Affairs Region at Fukuoka be given verbal authority to effect release pending formal processing of the necessary papers.

FOR THE COMMANDING OFFICER:

s/t/ J. H. COSPER
Lt. Col, CE
Chief, Const Sec.

C O P Y

AGLDC 386.3 (12 Apr 50) 1st Ind
SUBJECT: Release of Reparations Material

HEADQUARTERS EIGHTH ARMY, APO 343

Apr 19 1950

TO: Supreme Commander for the Allied Powers, APO 500
ATTN: G-4 Section

It is recommended that the railway materials described in the basic communication be approved for authorized use.

FOR THE COMMANDING GENERAL:

/s/ Dewitt M. Miles
Dewitt M. MILES
Captain AGD
Asst. Adj General

AG 387.6 (12 Apr 50) CPC/AD

2d Ind

ECM/EF/CHR/1w

GENERAL HEADQUARTERS, SUPREME COMMANDER FOR THE ALLIED POWERS,
APO 500

TO: Commanding General, Eighth Army, APO 343

The authorized use of items of reparations equipment requested in basic communication, is approved.

BY COMMAND OF GENERAL McARTHUR:

DISTR:
ESS
CAS

C. D. CONLEY
Major AGD
Asst Adj Gen

MEMO FOR RECORD:

1. Self explanatory.
2. Concurrence: G-4 (C/N No. 1, 22 Apr 50).
Engr
3. Completes action on CPC Line No. 52708.

E. C. M. Jr. _____ 26-5636

C O P Y

AGLDC 386.3 (12 Apr 50)
SUBJECT: Release of Reparations Material

3rd Ind

ERD/sk

HEADQUARTERS EIGHTH ARMY, APO 343 16 May 1950

THRU: Commanding General, 24th Infantry Division, APO 24

TO: Commanding Officer, 34th Infantry, APO 24 Unit 5

1. Attention is invited to preceding indorsement.
2. Equipment authorized will be accounted for on Account Number SA-702-PE in accordance with Eighth Army Circular 77, 18 October 1949, a copy of this correspondence will be filed with property accountable records as authority for this equipment.
3. Reference basic letter the rails as listed were requested and installed by 11th Engineer Combat Battalion.
4. It is desired that requests for release, transfer or other disposition of reparations equipment on authorized use be approved by this headquarters prior to movement.

BY COMMAND OF LIEUTENANT GENERAL WALKER:

Copy furnished:
Chief Fukuoka CAFF Region

DEWITT M. MILES
Captain AGD
Asst. Adj General

Gen
587.6 SNA

4009
KYUSHU
INFORMATION:
1st Ind O.D.

AGLDC 385.3 (12 Apr 50)
SUBJECT: Release of Reparations Material
HEADQUARTERS EIGHTH ARMY, APO 343

Apr 19 1950 MAY 9 1950

TO: Supreme Commander for the Allied Powers, APO 500
ATTN: C-4 Section

It is recommended that the railway materials described in the basic communication be approved for authorized use.

FOR THE COMMANDING GENERAL:

/s/ Dewitt M. Miles
DEWITT M. MILES
Captain AGD
Asst. Adj General

AG 387.6(12 Apr 50)CFC/AD

2d Ind

ECM/EF/CHR/lw

CAS

GENERAL HEADQUARTERS, SUPREME COMMANDER FOR THE ALLIED POWERS, APO 500
5 MAY 50

TO: Commanding General, Eighth Army, APO 343

The authorized use of items of reparations equipment requested in basic communication, is approved.

BY COMMAND OF GENERAL MACARTHUR:

MAILED 0830 MAY 6 '50 AG. - GHO.

ran/

DISTR:
ESS
CAS

C. D. CONLEY
Major, AGD
Asst Adj Gen

MEMO FOR RECORD:

1. Self explanatory.
2. Concurrence: C-4 (C/N No. 1, 22 Apr 50).
Engr
3. Completes action on CFC Line No. 52708.

K.C.M.Jr. _____ 26-5636

HEADQUARTERS
11TH ENGINEER COMBAT BATTALION
CONSTRUCTION SECTION
APO 25-6

ENG/ys
12 April 1950

SUBJECT: Release of Reparations Material

TO : Commanding General
Eighth Army
APO 343

ATTN: The Engineer

1. It is requested that reparations railway materials described below be released to enable this unit to complete construction of a rail siding for JGSCO located at Sasebo, Kyushu, Japan.

	<u>Reparation Code</u>	<u>Description</u>	<u>Class</u>	<u>Length of Track</u>
a.	27-3-5062	30 Kg M	2	2,900 Meters
b.	27-3-5115	30 Kg M	2	1,120 "
c.	27-3-5114	30 Kg M	1	80 "

2. The construction was authorized by GHQ, FEC directive JAP 302 and Eighth Army Procurement Demand Number JFNC-146 and further identified by Eighth Army Construction Directive Number LE-I-9-35.

3. The track is at present in place but is not being used and is necessary for a right of way into the JGSCO Oil Terminal. A delay in scheduled progress has resulted due to slow processing for release of these rails and the target date for completion of this project cannot be met unless early release is effected.

4. Recommend that the officer in charge of the Civil Affairs Region at Fukuoka be given verbal authority to effect release pending formal processing of the necessary papers.

FOR THE COMMANDING OFFICER:

s/t/ J.H. COSPER
Lt. Col, CE
Chief, Const Sec.

COPY

AGLDC 386.3 (12 Apr 50) 3rd Ind
SUBJECT: Release of Reparations Material

ERD/sk

HEADQUARTERS EIGHTH ARMY, APO 343 16 May 1950

THRU: Commanding General, 24th Infantry Division, APO 24

TO: Commanding Officer, 34th Infantry, APO 24 Unit 5

1. Attention is invited to preceding indorsement.
2. Equipment authorized will be accounted for on Account Number 8A-702-PE in accordance with Eighth Army Circular 77, 18 October 1949, a copy of this correspondence will be filed with property accountable records as authority for this equipment.
3. Reference basic letter the rails as listed were requested and installed by 11th Engineer Combat Battalion.
4. It is desired that requests for release, transfer or other disposition of reparations equipment on authorized use be approved by this headquarters prior to movement.

BY COMMAND OF LIEUTENANT GENERAL WALKER:

Copy furnished:
Chief Fukuoka Caff Region

DEWITT M. MILES
Captain AGD
Asst. Adj General

REPORT OF NEW DISCOVERED MACHINES, BELONGED
TO SASEBO NAVAL ARSENAL (27-3)

TO : Headquarters, Kyushu Civil Affairs Region.

FROM : Fukuoka Finance Office

Date: April, 26, 1950.

We hereby submit to your headquarters a report of new discovered machines belonged to Sasebo Naval Arsenal(27-3)

The specifications of machines is as follows.

1. New discovered machines.

Inv. No.	Name of Machine	Maker	Year-made	Class	Status of Machine
27-3-13872	Electric motor EFO-K type. 150 HP 220V.38A 60 cy. Est. 160Kg. LO. 6mxW0.55mxH0.55m 3HH 1,150 RPM.	Hidachi	1938	2	
13873	Electric motor 1K-AB type 5HP 3.7KW 200-220V 15A-135A 50-60 cy. 1410-1700 RPM. 60 Kg Est. L W H 0.46mx0.30mx0.30m	Shibaure Electric	1935 Est.	3	Bad insulation
13874	Electric motor ORR 75/7+4 type 7.5HP 5.6KW 200/220V 215/105A 50-60cy. 1440/1740 RPM 3 PH 100Kg Est. L W H 0.53mx0.40mx0.35m	Fuji Electric	1935 Est.	3	Bad insulation
13875	Electric motor type unknown. 3 HP 60Kg est. L W H 0.45mx0.35mx0.35m	Meiden- sha	1935 Est.	3	Bad insulation
13876	Electric motor 3HP 60kg est. L W H 0.45mx0.35mx0.35m	Meiden- sha	1935 Est.	3	Bad insulation

Inv.No.	Name of Machine	Maker	Year-made	Class	Status of Machine
27-3-13877	Electric motor FR-S type 30 HP 220V 78A 60 cy 865 RPM 3PH 400Kg est. L W H 1.2mx0.65x0.72m	Meiden-sha	1935 est.	3	Bad insulation.
13878	Electric motor waterproof type 20KW 220V 7.5A 60 cy 590 RPM 3 PH 526 Kg. L W H 1mx0.75mx0.83m	Mike Seisakusho, Mitsui Coal Mining Co., Ltd.	Mar.1944	3	Bad insulation.
13879	Electric motor Continuing MS type 100HP 3300V 16A 60 cy 1,170 RPM 3PH 600Kg est. L W H 1.48mx0.75mx0.87m	Mitsubishi Electric.	Dec.1932	3	Bad insulation.
13880	Electric motor US 451-CA type 30HP 220V 71A 60cy 1,165 RPM 3PH 400Kg est L W H 0.76mx0.63mx0.69m	Toyo Electric	Jan.1937	3	Bad insulation.
13881	Electric motor IM type 40 HP 220V 104A 60cy 865 RPM 3PH 500Kg est L W H 1.2mx1m x0.92m	Shibaurs Electric	1935 est.	3	Bad insulation.
13882	Electric motor TIK-ABK type 50HP 3.7KW 220V 122A 60 cy 865 RPM 3PH 500Kg est L W H 0.84x1mx1m	Shibaurs Electric	Mar.1941	3	Bad insulation.
13883	Electric motor B type 5HP 220V 14.2A 60cy 865 RPM 3PH 100 Kg est. L W H 0.59mx0.59mx0.61m	Chuo Electric	May.1938	3	Bad insulation.

Inv.No.	Name of Machine	Maker	Year-made	Class	Status of Machine
27-3-13884	Electric motor B type 5HP 220V 14.2A 60cy 865 RPM 3PH 100kg est. L W H 0.64mx0.45mx0.49m	Chuo Electirc	May 1938	3	Bad insulation
13885	Transformer Type unknown. 50 KVA 300Kg est. L W H 0.8mx0.62mx1m	Osaka Transformer	1932 est.	3	Bad insulation
13886	Transformer 50 KVA 30Kg est L W H 0.8mx0.62mx1m	Osaka Transformer	1932 est.	3	Bad insulation
13887	Transformer 50 KVA 300Kg est. D W H 0.8mx0.62mx1m	Osaka Transformer	1932 est.	3	Bad insulation
13888	Transformer 30 KVA est. 200KG est. L W H 0.75mx0.50mx0.85m	Unknown	1932 est.	3	Bad insulation
None	Transformer 50KVA 300Kg est L W H 0.8mx0.62mx1m	Osaka Transformer	1932 est.	Scrap	A part of body-damaged Inside parts-corroded.
None	Transformer 20 KVA 183 kg est. L W H 0.68mx0.44mx0.8m	Osaka Transformer	1932 est.	Scrap	Cover-missing Inside parts-corroded.
None	Shaft-(8) dia 70mmx3.05m..1 dia 70mmx3.16m..1 dia 70mmx2.8 m..1 dia 50mmx1.48m..1 dia 65mmx2.87m..1 dia 65mmx2.64m..1 dia 65mmx2.94m..1 dia 90mmx3.15m..1 Total 8 pieces 600Kg est. L W H 3.5mx2mx2m	Unknown	1930 est.	Scrap	Bearing, pulley-missing. Outside parts-corroded

Inv.No.	Name of Machine	Maker	Year-made	Class	Status of Machine
SC-724	Pulley.....(6) dia 1.24xW15 450Kg est. L W H 1.3mx1.1mx1.3m	Unknown	1930 est.	Scrap	incomplete pulley
Total	21 Machines				6,199 Kg est.
	Machine	17	Machines		4,666 Kg est.
	Scrap	4	Machines		1,533 Kg est.

2. Disposition of Machines above.

The machines above, discovered newly, are in dead storage at the warehouse of Sasebo Food-stuffs Industry Co., Ltd, (Sasebo Shokuryo Sangyo K.K.) miura-machi, Sasebo-shi, Nagasaki-ken. Therefore, we immediately intend to carry them to the warehouse of Sasebo Naval Arsenal, to practise their maintenance, to afix the number on the 17 machines except 4 machines to be scrapped down and to additionally describe them on the evaluation work sheet.

Y. Nagaoka
 Yoshimatsu, NAGAOKA.
 Chief of Reparation Section.
 Fukuoka Finance Office.

KYUSHU CIVIL AFFAIRS REGION
GHQ SCAP
Fukuoka, Kyushu, Japan

E/MWW/msw

387.6

APC 24 Unit 5
14 April 1950

SUBJECT: Status of Buildings at the Sasebo Naval Arsenal

TO: Chief, Civil Affairs Section
GHQ SCAP
APO 500
ATTN: Major Freeman

1. Reference: Telephone conversation between Economics Section, Kyushu Civil Affairs Region, and Major Freeman of your headquarters, 4 April 1950, pertaining to the release of all buildings in the Sasebo Naval Arsenal.
2. A release dated 11 March 1948 issued by Nagasaki Military Government Team on all land and buildings at the Sasebo Naval Arsenal has been cancelled. These land areas and buildings include installations still required for custody of reparations and therefore their release was in error.
3. A copy of the letter written by this headquarters to the Finance Bureau, Japanese Government, cancelling the final release is submitted herewith for your information.

1 Incl:
As indicated

J. H. BURGHIM
Colonel QMC
Chief

KYUSHU CIVIL AFFAIRS REGION
GHQ SCAP
Fukuoka, Kyushu, Japan

E/MWW/mms

AFO 24 Unit 5

1 April 1950

387.6

SUBJECT: Recall of Former Japanese Naval Installations

THROUGH: Kyushu Liaison and Coordination Office, Fukuoka, Kyushu

TO : Fukuoka Finance Bureau, Fukuoka, Kyushu

1. References:

a. Letter, Nagasaki Military Government Team, subject: "Application for Release of Disposition Property", dated 23 October 1947.

b. Letter, Headquarters 34th Infantry, APO 24-3, subject: "Release of Enemy Property", dated 2 February 1948.

c. Fourth Indorsement to Headquarters 34th Infantry, APO 24-3, subject: "Release of Enemy Property", dated 2 February 1948.

2. Lands and buildings as shown on attached AGO Form #1, in the Sasebo Naval Arsenal were released erroneously. The final release includes lands and buildings required for custody and control of reparations. Therefore, this headquarters cancels the final release as shown on the attached AGO Form #1.

3. However, it is understood that some of the buildings have been dismantled and others are not required for control and custody of reparations. Therefore, these buildings could be released.

4. In cases which come under Paragraph 3 above, the Finance Bureau will submit individual application to this headquarters and upon investigation, confirmation in writing will be given. Application along with confirmation letters will then be processed through the Regional Post Engineer for final release.

5. All copies of the AGO Form #1 pertaining to the above correspondence will be submitted to this office.

FOR THE CHIEF:

1 Incl:
AGO Form #1

ELSWORTH R. MOSMAN
Chief, Economics Section

RELEASE OF FORMER JAPANESE MILITARY AND NAVAL
INSTALLATIONS

Page 1 of 2 Pages

RECEIVED FROM: Howard E. Hollison, 1st Lt., 24th Inf. Corp Nowar, Nagasaki
 NAME OF OFFICER ORGANIZATION LOCATION PREFECTURE

DATE RECEIVED 5 March 1948 (~~PARTIAL~~) (FINAL) RELEASE
 (Delete one)

LOCATION	INSTALLATIONS	ESTIMATED VALUE IN YEN OBTAINED FROM MINISTRY OF FINANCE BUREAU OF STATE PROPERTY
(1278 1113) Sasebo Naval Arsenal	Total Acreage:- 14,079.19 sq.Ft 268 Installations is below: 138- Wooden 1-storied 20- Wooden 2-storied 6- Iron Framed 2-storied 38- Iron framed 1-storied 1- Bricked 1-storied (part of 2-storied) 21- Bricked 1-storied 1- Concreted 1-storied (part of 3-storied) 2- Bricked 2-storied 5- Concrete 2-storied 1- Iron Framed 1-storied (part of wooden 2-storied) 1- Iron frame, 1-storied (part of 2 -storied) 1- Iron frame, 2-storied (part of wooden 3-storied) 6- Iron Framed 1-storied (part of 2 storied) 17- Concrete 1-storied 2- Bricked & wooden 1-storied 3- Iron frame & wooden 1-storied	Improvement valuation in Dollars <u>0</u>

continued on next page

DROPPED FROM
PROPERTY RECORDS OF 34th Infantry BY Charles R. Miller Capt. 5 March 48
 ORGANIZATION ACCOUNTABLE OFFICER RANK DATE

REMARKS:

CERTIFIED CORRECT EXCEPT AS NOTED INITIALED

BY Joe C. Goldaby Nagasaki Mil Govt Team 11 Mar. 1948
 RELEASING OFFICER ORGANIZATION DATE

BY H. Kitamura Nagasaki 11 Mar. 1948
 JAPANESE REPRESENTATIVE AGENCY DATE

OGA FORM 1 as amended

Incl #1 to OD 28/14 for 1945
 HQs 8th Army 27 February 1947

RELEASE OF FORMER JAPANESE MILITARY AND NAVAL
INSTALLATIONS

Page 2 of 2 Pages

RECEIVED FROM: Howard E. Rollison, 1st Lt., 34th Infantry, Corp Hq., Nagasaki
NAME OF OFFICER ORGANIZATION LOCATION PREFECTURE

DATE RECEIVED 5 March 1948 (PARTIAL) (FINAL) RELEASE
(delete one)

LOCATION	INSTALLATIONS	ESTIMATED VALUE IN YEN OBTAINED FROM MINISTRY OF FINANCE BUREAU OF STATE PROPERTY
Sasebo Naval Arsenal	1- Storage for gasoline, concreted. 1- Stone Building 1- Concreted & wooden 1-storied 1- Concrete Water Tank 2- Wooden 1-storied (part of 2-storied) 1- Wooden 1-storied (3 bldgs connected) 1- Iron Frame, 1-storied (part of wooden 1-storied & wooden 2-storied) 1- Concrete, 2-storied (part of 3-storied) 1- Concrete 2-storied (part of 1-storied)	
Sasebo Naval Arsenal	six(6) Docks	
Sasebo City	three(3) Ship	
Sasebo Naval Arsenal	Acreage:- 9,443,556 Sq.Ft	
Sasebo City	Land - one	Improvement valuation in Dollars <u>0</u>
Sasebo Naval Arsenal	Acreage:- 304.99 Sq.Ft	
Sasebo City	Land - one	

DROPPED FROM
PROPERTY RECORDS OF 34th Infantry BY Charles R. Millar, Capt. 5 March 48
ORGANIZATION ACCOUNTABLE OFFICER RANK DATE

REMARKS:

CERTIFIED CORRECT EXCEPT AS NOTED INITIALED

BY Joe C. Goldsby Nagasaki Mil Govt Team 11 Mar. 1948
RELEASING OFFICER ORGANIZATION DATE

BY H. Kitamura Nagasaki 11 Mar. 1948
JAPANESE REPRESENTATIVE AGENCY DATE

OGA FORM 1 as amended

Incl 1 to OD 28/14 for 1945
Hqs 8th Army 27 February 1947

KYUSHU CIVIL AFFAIRS REGION
CHQ SCAP
Fukuoka, Kyushu, Japan

E/INTV/mms

AFO 24 Unit 5
7 April 1950

387.6

SUBJECT: Temporary Use of Building by Nishi Kyushu Warehouse
Company, Limited.

THROUGH: Kyushu Liaison and Coordination Office, Fukuoka, Kyushu

TO : Fukuoka Finance Bureau, Fukuoka, Kyushu
ATTN: #2 Section

1. Attached application for temporary use of building next to #169 at the Sasebo Naval Arsenal is approved.
2. Buildings Nos. 169, 167 and building next to 169 (un-numbered) may be released, for they are not required for custody and control of reparations. Applications for the release of these three (3) buildings may be processed through the Regional Post Engineer for final release.

FOR THE CHIEF:

1 Incl:
As indicated

WELLSWORTH R. MOSMAN
Chief, Economics Section

Cable Address
"SOKO SASEBO"

Telephone:
433 SASEBO



LANDING & SHIPPING AGENTS
STEVEDORES, CUSTOMS
BROKERS,
WHARFINGERS AND
WAREHOUSEMEN

NISHI KYUSHU WAREHOUSE CO., LTD
TATEGAMI-AREA, EX-NAVAL ARSENAL.
SASEBO, JAPAN

Sasebo, Mar. 25 1950

To : Col. Burgheim, Commander of
Civil Affairs Div., Fukuoka.

From : Nishi Kyushu Warehouse Co., Ltd.

Subject : Repairing & Temporary use
of Building, Petition for.

Dear Sir: We would firstly express our heartfelt thanks for your kind approval for temporary use of warehouses No. 145 (partly) 167 & 169 for importing wheat.

We again ask you for your special consideration for temporary use of building situated next to No. 169, no number fixed, for the same purpose.

The building in question were naturally decayed, broken heavily, being roofless and outer walls only, requiring perfect repair (as per photo attached).

As you are well aware, we are aiming to get the store located in the vicinity of the ship's berth which is absolutely necessary to lessen the cost of port charges and thus lighten the price of goods.

From this viewpoint, your generous approval for repairing and temporary use of above-mentioned building for this purpose will greatly oblige us.

Thanking you again for your kind sanction.

Yours faithfully,

Michael W. Wolniak

MICHAEL W. WOLNIAK
AUTHORIZED TO CERTIFY ALL
REPARATIONS DOCUMENTS FOR
KYUSHU CIVIL AFFAIRS REGION

I. Tsuboi

I. Tsuboi
President, Nishi Kyushu
Warehouse Co., Ltd.

Incl 1 to KCAR letter, file 387.6, dtd 7 Apr 50, subj: "Temporary Use of Building by Nishi Kyushu Warehouse Company, Limited."

KYUSHU CIVIL AFFAIRS REGION
GHQ SCAP
Fukuoka, Kyushu, Japan

E/MW/mms

AFPO 24 Unit 5
30 March 1950

387.6

SUBJECT: Disapproval of Expenditures for Repair of Building
at Sasebo Naval Arsenal

THROUGH: Kyushu Liaison and Coordination Office, Fukuoka, Kyushu

TO : Chief, Kumamoto Finance Bureau, Kumamoto, Kyushu

1. Recent inspection of building #159 showed no necessity for immediate repairs. In fact, this headquarters had selected this building in the past for storage of United Kingdom and Chinese packages awaiting shipment, because of the excellent condition of the building.

2. Therefore, the application listed in Inclosure one(1) is disapproved.

FOR THE CHIEF:

1 Incl:
Application

ELSWORTH R. MOSMAN
Chief, Economics Section

APPLICATION FOR MAINTENANCE WORK

Date. 28 March 1950

Project No.

Plant No. 27 - 3

Plant Name : Sasebo Naval Arsenal.

Plant Address : Tategami Sasebo-shi, Nagasaki-ken.

Description of work.

a. Present status of Bldg. No ¹⁵⁹~~195~~ (as shown in the other sheets)

1. Construction of Bldg.....Brick frame

2. Roof to be repaired
^{95 tsubo}
~~550 square meters~~ (50% on the roof)

3. Window to be repaired
~~88.9 square meters.~~
^{28 tsubo}

b. Materials to be requested

1. Boarding for window

^{28 tsubo}
~~88.9 square meters~~

2. Boarding for roof

^{95 tsubo}
~~550 sq. meters.~~

3. Tile for roof

ditto.

4. Cryptomeria bark

168 tsubo

Cost estimate.

Materials cost	¥ 175,935.00
Labor cost	¥ 44,855.00
Service Expense	¥ 28,216.00
Miscellaneous Expense	¥ 37,302.89
Total	¥ 286,308.89

Checked by Chief of Reparation Section Fukuoka Finance Office

Date : 28 March 1950.

Approved by Kyushu Civil Affairs Region.

Incl 1 to KCAR letter, file 387.6, dtd 30 Mar 50, subj:
"Disapproval of Expenditures for Repair of Building
at Sasebo Naval Arsenal."

Michael W. Wolniak

MICHAEL W. WOLNIAK
AUTHORIZED TO CERTIFY ALL
REPARATIONS DOCUMENTS FOR
KYUSHU CIVIL AFFAIRS REGION

KYUSHU CIVIL AFFAIRS REGION
HQ SCAP
Fukuoka, Kyushu, Japan

E/MSW/mms

AFO 24 Unit 5
30 March 1950

387.6

SUBJECT: Disapproval of Expenditures for Building a Wall
Around Reparations Equipment

THROUGH: Kyushu Liaison and Coordination Office, Fukuoka, Kyushu

TO : Chief, Kumamoto Finance Bureau, Kumamoto, Kyushu

1. The application, as listed in Inclosure #1, is disapproved for the following reasons:

a. The responsibility for segregation of reparations equipment in storage from that part of a building being used by a private plant falls upon the using agency.

b. The reparations machinery in buildings Nos. 95 and 97 are being damaged from the dust created by the company using part of the said buildings.

c. Therefore, if the dead storage equipment is not protected, either by constant maintenance or by building a wall separating the dead storage equipment from that which is in use, the Sasebo Shipbuilding Company will have to find two(2) other buildings to operate in.

FOR THE CHIEF:

1 Incl:
Application

ELSWORTH R. MOSMAN
Chief, Economics Section

APPLICATION FOR MAINTENANCE WORK

Date. 28 March 1950

Project No.

Plant No. 27-3

Plant Name : Sasebo Naval Arsenal.

Plant address : Tategami Sasebo Shi Nagasaki Ken

Description of work.

a. New board fence, length 790 ft. height 12 ft. , indicated in attached map will be constructed.

b. Wall pillar will be steadily bound to the channel type steel of constructed pillar with bolt or band steel bar.

c. Entrance with key, height 6 ft. width 6ft. will be newly constructed

d. The place, indicated in the attached map, will be dug depth 100 mm & paved with concrete.

e. Railway trucks will be kept in the condition capable of use.

f. All materials will be borne by contractor.

g. All materials which are inspected by supervisor will be used.

Cost estimate.

Finance Office ¥ 467,196.40

Checked by

Chief of Reperation Section Fukuoka Finance Office

J. Nagasaki

Date : 28 March 1950.

Approved by Kyushu Civil Affairs Region.

Incl 1 to KCAR letter, file 387.6, dtd 30 Mar 50, subj:
"Disapproval of Expenditures for Building a Wall
Around Reparations Equipment."

Michael W. Wolniak

MICHAEL W. WOLNIAK
AUTHORIZED TO CERTIFY ALL
REPARATIONS DOCUMENTS FOR
KYUSHU CIVIL AFFAIRS REGION

KYUSHU CIVIL AFFAIRS REGION
GHQ SCAP
Fukuoka, Kyushu, Japan

ERM/hh

APO 24 Unit 5
21 March 1950

SUBJECT: Temporary Use of Arsenal Buildings

THROUGH: Chief, Kyushu Coordinating and Liaison Office,
Fukuoka, Japan

TO: Mayor, Sasebo City

1. This headquarters has no objections for the temporary use of buildings #145, #167 and #169 at the Sasebo naval arsenal, by the Kyushu Warehousing Company for the storage and processing of Argentine wheat.

2. The reparations equipment in building #145 will be segregated from the wheat by a wooden wall. The overhead traveling crane remaining in the portion of the building being used for storage of wheat may be placed in "temporary use", by the Kyushu Warehousing Company until such time that the buildings are no longer needed for processing of wheat.

FOR THE CHIEF

1 Inclosure
Letter Mayor,
Sasebo City

E. R. MOSMAN
Chief, Economics Section

Sasebo, Mar. 16, 1950

To ; Colonel Burgheim, Comdr of
Civil Affairs Team, Fukuoka.

From; Mayor, Sasebo City.

Subject ; Exclusion of Warehouses,
Petition for.

Dear Sir,

We beg to ask your special consideration regarding the above caption.

We are informed that you are planning to store the reparation goods scattered nearby, in godowns located in ex-naval arsenal and war supply's stores quarter and Nishi Kyushu Warehouses Co.'s whses No. 17, 20, 21, as per print attached, are likely to be designated for this purpose.

As you are aware, recently imports to this port are remarkably declining, and from last February there is no entrance of foreign flags, causing stevedores, longshoremen as well as warehousing serious distress.

Therefore, we made continuous contact with Government, especially last February Mayor of city, President of Chamber of Commerce and Industry, Chief of Sasebo Port Developing Committee together with parties concerned petitioned for ship entrance and happily succeeded to get one ship loaded with 10,000 tons wheat in bulk from Argentine in early April.

We, thereat, instructed Nishi Kyushu Warehouse Co. to arrange and finish perfect repairing of the warehouses under their management, No. 145 for temporary landing and sacking, No. 167 and 169 for storing and fumigation and they completed same just few days ago.

If our arrangement be upsetted, the expected ship may change her destination, which should be vital blow to us citizen.

Under the circumstances, your kind and favourable reconsideration to release the said warehouses from your designation will greatly oblige us.

Thanking you in advance,

Yours faithfully,

*Incl 1 To Kyushu Civil Affairs
Letter 387. Dated 21 March 1950*
MICHAEL W. WOLNIAK

AUTHORIZED TO CERTIFY ALL
REPARATIONS DOCUMENTS FOR
KYUSHU CIVIL AFFAIRS REGION

J. H. ...
for Mayor, Sasebo City.

Designated warehouse			
WHSE No.	Space(Tsubo)	Remark	
Tategami No. 20	200	Ex. Sound Operation Shop.	Repair finished for stowage fumigation of importing wheat. 3000 T. "-"
" No. 21	400	Ex. Amm. Atore under management of chief Engineer	
" No. 17	565	Outfitting shop	Repaired & fixed bulkhead for temporary landing, assarting & sacking
<hr/>			
Total	1,165		

Substitute Warehouse			
WHSE No.	Space(Tsubo)	Remark	
West gate No. 2	199.6	broken 40 %	Necessary to repair rain pipe, windows etc.
" No. 3	183.92	"	"
" No. 1	60.5	"	Necessary to repair heavy doors, windows etc.
" No. 5	199.6	broken 70 %	"
" No. 6	146.74	"	"
" No.10	63	"	"
" No. 30	221.11	Drainage bad	necessary to repair perfectly
No.2 Drydock No. 18	160	broken 70 %	Necessary to repair heavy doors, windows etc.
<hr/>			
Total	1,235.47		

LIST OF EQUIPMENT DESIGNATED FOR RETENTION

*To Be Cancelled
at Sasebo 27-03*

Name of Arsenal : Kawatana Naval Arsenal

Address : Momozu Kawatana-machi, Higashisonogi-gun, Nagasaki-ken.

Code No. : 27 - 1

Date 10 Feb. 1950

Page 1 of 4 Page

1. Equipment falling under the category of par 2a of the memorandum.

Inv. No.	Name of Machine
27 - 1 - 12079	Bench Vice Width of Jaw 100mm
12080	Bench vice Width of Jaw 100mm
12081	Bench Vice Width of Jaw 100mm
12082	Bench Vice Width of Jaw 100mm
12083	Bench Vice Width of Jaw 100mm
12084	Bench Vice Width of Jaw 100mm
12085	Bench vice Width of Jaw 100mm
12086	Bench vice Width of Jaw 100mm
12087	Bench vice Width of Jaw 100mm
12088	Bench vice Width of Jaw 100mm
12089	Bench vice Width of Jaw 100mm
12090	Bench vice Width of Jaw 100mm
12091	Bench vice Width of Jaw 100mm
12092	Bench vice Width of Jaw 100mm
12093	Bench vice Width of Jaw 100mm
12094	Bench vice Width of Jaw 100mm
12095	Bench vice Width of Jaw 100mm
12096	Bench vice Width of Jaw 100mm
12097	Bench vice Width of Jaw 100mm
12098	Bench vice Width of Jaw 100mm
12099	Bench vice Width of Jaw 100mm
12100	Bench vice Width of Jaw 100mm
12101	Bench vice Width of Jaw 100mm
12102	Bench vice Width of Jaw 100mm

Inv. No.	Name of Machine		
27 - 1 - 12103	Bench vice	Width of Jaw	100mm
12104	Bench vice	Width of Jaw	100mm
12105	Bench vice	Width of Jaw	100mm
Non evaluation			
(Y 1)	Flat belt	width 150mm	L 98000mm W 150mm H 7mm
(Y 2)	Round files	Size length 100mm- 200mm	100mm-50pcs 150mm-70pcs 200mm-1000 pcs.

LIST OF EQUIPMENT DESIGNATED FOR RETENTION

Name of Arsenal : Koyotane Naval Arsenal
 Address : Momozu Koyotane-machi, Higashisonogi-gun, Nagasaki-ken.
 Code No. : 27 - 1 Date 13 Feb 1950
 Page 3 of 4 Page

2. Equipment falling under the category of par 2b of the memorandum.

Inv. No.	Name of Machine
27 - 1 - 1618	Potable air grinder wheel dia 100mm
1619	Potable air grinder wheel dia 100mm
1620	Potable air grinder wheel dia 100mm
1621	Potable air grinder wheel dia 100mm
1622	Potable air grinder wheel dia 100mm
1772	Transformer 50 K.V. A.
1773	Transformer 50 K.V. A.
1776	Transformer 50 K.V. A.
1777	Transformer 50 K.V. A.
1778	Transformer 20 K.V. A.
1779	Transformer 20 K.V. A.
2078	Motor 15 HP
2521	Oil switch 3300V 800A
2526	Oil switch 3P 500V 60A
2527	Oil switch 3P 500V 60A
2552	Oil switch 3300V 100A
2553	Oil switch 3300V 100A
2659	Potable electric grinder 110V 1/4HP wheel dia 127mm
2660	Potable electric grinder 110V 1/4HP wheel dia 127mm
2663	Potable electric grinder 110V 1/4HP wheel dia 127mm

Inv. No.	Name of Machine
27 - 1 - 2664	Potable electric grinder 110V $\frac{1}{4}$ HP wheel dia 127mm
2665	Potable electric grinder 110V $\frac{1}{4}$ HP wheel dia 127mm
2666	Potable electric grinder 110V $\frac{1}{4}$ HP wheel dia 127mm
2667	Potable electric grinder 110V $\frac{1}{4}$ HP wheel dia 127mm
11908	Oil switch 3P 3300V 60A
11909	Oil switch 3P 3300V 60A
11912	Transformer 20 K.V.A.
11914	Oil switch 3P 3500V 300V
11915	Oil switch 3P 3500V 300A
11916	Oil switch 3P 3500V 300A
11919	Transformer 5 K.V.A.
11924	Transformer 30 K.V.A.
11925	Transformer 20 K.V.A.
11927	Oil switch 3P 3300V 60A
11928	Oil switch 3P 3300V 200A
11931	Motor 80 KW
11946	Motor 40 HP
(11948)	Transformer 20 K.V.A.
(12109)	Transformer 20 K.V.A.
(12238)	Motor 300 HP

LIST OF EQUIPMENT DESIGNATED FOR RETENTION

Name of Arsenal : 21st Naval Air Depot Omura Branch.

Address : Matsunami-cho, Omura-shi, Nagasaki-ken.

Code No. : 27 - 04

Date 13 Feb. 1950

Page 1 of 13 Page

1. Equipment falling under the category of par 2a of the memorandum

Inv. No.	Name of Machine
27 - 4 - 386	Grinding machine
414	Turret lathe with motor
5740	Pneumatic hammer
5741	Pneumatic hammer
5742	Pneumatic hammer
5743	Pneumatic hammer
5744	Pneumatic hammer
5745	Pneumatic hammer
5746	Pneumatic hammer
5747	Pneumatic hammer
5748	Pneumatic hammer
5749	Pneumatic hammer
5750	Pneumatic hammer
5751	Pneumatic hammer
5752	Pneumatic hammer
5753	Pneumatic hammer
5754	Pneumatic hammer
5755	Pneumatic hammer
5756	Pneumatic hammer
5757	Pneumatic hammer
5758	Pneumatic hammer
5759	Pneumatic hammer
5760	Pneumatic hammer

Inv. No.	Name of Machine
27 - 4 - 5761	Pneumatic hammer
5762	Pneumatic hammer
5763	Pneumatic hammer
5764	Pneumatic hammer
5765	Pneumatic hammer
5766	Pneumatic hammer
5767	Pneumatic hammer
5768	Pneumatic hammer
5769	Pneumatic hammer
5770	Pneumatic hammer
5771	Pneumatic hammer
5772	Pneumatic hammer
5773	Pneumatic hammer
5774	Pneumatic hammer
5775	Pneumatic hammer
5776	Pneumatic hammer
5777	Pneumatic hammer
5779	Pneumatic hammer
5780	Pneumatic hammer
5781	Pneumatic hammer
5782	Pneumatic hammer
5783	Pneumatic hammer
5784	Pneumatic hammer
5785	Pneumatic hammer
5786	Pneumatic hammer
5787	Pneumatic hammer
5788	Pneumatic hammer
5789	Pneumatic hammer
5778	Pneumatic hammer

Inv. No.	Name of Machine
27 - 4 - 5700	Pneumatic hammer
5791	Pneumatic hammer
5792	Pneumatic hammer
5793	Pneumatic hammer
5794	Pneumatic hammer
5795	Pneumatic hammer
5796	Pneumatic hammer
5797	Pneumatic hammer
5798	Pneumatic hammer
5799	Pneumatic hammer

The following is non evaluation.

<u>Inv. No.</u>	<u>Name of Machine</u>
(9044)	Integrating meter 220V 50A 100kwh/REV
(9334)	Wood planner Size 1.65m x1.45mx1.10m.

LIST OF EQUIPMENT DESIGNATED FOR RETENTION

Name of Arsenal : 21st Naval Air Depot Omura Branch

Address : Matsunemicho Omura-shi, Nagasaki-ken.

Code No. : 27 - 4

Date 13 Feb. 1950

Page 4 of 18 Page

2. Equipment falling under the category of per 2b of the memorandum.

Inv. No.	Name of Machine
27 - 4 - 618	Motor 5 HP
619	Motor 30 HP
873	Potable drill 135 pcs.
2288	Transformer 200V.V.A.
2467	Motor 10 HP
2499	Motor 10 HP
2686	Transformer 30 V.V.A.
5432	Potable drill
5568	Potable drill
5569	Potable drill
5570	Potable drill
5571	Potable drill
5572	Potable drill
5573	Potable drill
5574	Potable drill
5575	Potable drill
5576	Potable drill
5577	Potable drill
5578	Potable drill
5579	Potable drill
5580	Potable drill
5581	Potable drill
5582	Potable drill
5583	Potable drill
5584	Potable drill
5585	Potable drill
5586	Potable drill
5587	Potable drill

Inv. No.	Name of Machine
27 - 4 - 5588	Potable drill
5589	Potable drill
5590	Potable drill
5591	Potable drill
5592	Potable drill
5593	Potable drill
5594	Potable drill
5595	Potable drill
5596	Potable drill
5597	Potable drill
5598	Potable drill
5599	Potable drill
5600	Potable drill
5601	Potable drill
5602	Potable drill
5603	Potable drill
5604	Potable drill
5605	Potable drill
5606	Potable drill
5607	Potable drill
5608	Potable drill
5609	Potable drill
5610	Potable drill
5611	Potable drill
5612	Potable drill
5613	Potable drill
5614	Potable drill
5615	Potable drill
5616	Potable drill
5617	Potable drill
5618	Potable drill
5619	Potable drill
5620	Potable drill
5621	Potable drill

Inv. No.	Name of Machine
27 - 4 - 5588	Potable drill
5589	Potable drill
5590	Potable drill
5591	Potable drill
5592	Potable drill
5593	Potable drill
5594	Potable drill
5595	Potable drill
5596	Potable drill
5597	Potable drill
5598	Potable drill
5599	Potable drill
5600	Potable drill
5601	Potable drill
5602	Potable drill
5603	Potable drill
5604	Potable drill
5605	Potable drill
5606	Potable drill
5607	Potable drill
5608	Potable drill
5609	Potable drill
5610	Potable drill
5611	Potable drill
5612	Potable drill
5613	Potable drill
5614	Potable drill
5615	Potable drill
5616	Potable drill
5617	Potable drill
5618	Potable drill
5619	Potable drill
5620	Potable drill
5621	Potable drill

Inv. No.	Name of Machine
27 - 4 - 5622	Potable drill
5623	Potable drill
5624	Potable drill
5625	Potable drill
5626	Potable drill
5627	Potable drill
5628	Potable drill
5629	Potable drill
5630	Potable drill
5631	Potable drill
5632	Potable drill
5633	Potable drill
5634	Potable drill
5635	Potable drill
5636	Potable drill
5637	Potable drill
5638	Potable drill
5639	Potable drill
5640	Potable drill
5641	Potable drill
5642	Potable drill
5643	Potable drill
5644	Potable drill
5645	Potable drill
5646	Potable drill
5647	Potable drill
5648	Potable drill
5649	Potable drill
5650	Potable drill
5651	Potable drill
5652	Potable drill
5653	Potable drill
5654	Potable drill

Inv. No.	Name of Machine
27 - 4 - 7962	Transformer 20 K.V. A.
7969	Transformer 20 K.V. A.
7970	Transformer 20 K.V. A.
7971	Transformer 20 K.V. A.
7972	Transformer 10 K.V. A.
8148	Transformer 15 K.V. A.
8149	Regulst transformer 42.3K.V. A.
8344	Pole oil switch 3P 3500V 100A
8345	Pole oil switch 3P 3500V 100A
8346	Pole oil switch 3P 3500V 100A
8347	Pole oil switch 3P 3500V 100A
8348	Pole oil switch 3P 3500V 100A
8349	Pole oil switch 3P 3500V 100A
8350	Pole oil switch 3P 3500V 100A
3851	Pole oil switch 3P 3500V 100A
8352	Pole oil switch 3P 3500V 100A
8354	Pole oil switch 3P 3500V 100A
8360	Pole oil switch 3P 3500V 100A
8441	Automatic oil switch 3P 3500V 60A
8442	Automatic oil switch 3P 3500V 60A
8443	Automatic oil switch 3P 3500V 60A
8444	Automatic oil switch 3P 3500V 60A
8503	Pole oil switch P3. 3500V 100A
8504	Pole oil switch P3. 3500V 100A
8505	Pole oil switch P3. 3500V 100A
8506	Pole oil switch P3. 3500V 100A
8507	Pole oil switch P3. 3500V 100A
8508	Pole oil switch P3. 3500V 100A
8509	Pole oil switch 3P 3500V 100A
8510	Pole oil switch 3P. 3500V 100A
8511	Pole oil switch 3P. 3500V 100A
8512	Pole oil switch 3P. 3500V 100A

Inv. No.	Name of Machine
27 - 4 - 8513	Pole oil switch 3P. 3500V 1000
8633	Oil circuit breaker 3P 3450V 200A
8634	Oil circuit breaker 3P 3450V 400A
8635	Oil circuit breaker 3P 3450V 400A
8636	Oil circuit breaker 3P 3500V 400A
8639	Oil circuit breaker 3P 3500V 400A
8640	Oil circuit breaker 3P 3500V 400A
8641	Oil circuit breaker 3P 3500V 400A
8642	Oil circuit breaker 3P 3500V 400A
8643	Oil circuit breaker 3P 3500V 400A
8645	Oil circuit breaker 3P 3500V 400A
8646	Oil circuit breaker 3P 3500V 400A
8647	Oil circuit breaker 3P 3500V 400A
8649	Oil circuit breaker 3P 6900V 400A
8650	Oil circuit breaker 3P 3450V 200A
8651	Oil circuit breaker 3P 3450V 200A
8652	Oil circuit breaker 3P 3450V 300A
8653	Oil circuit breaker 3P 3450V 300A
8655	Oil circuit breaker 3P 3450V 300A
8656	Oil circuit breaker 3P 3450V 300A
8659	Oil circuit breaker 3P 3500V 100A
8661	Oil circuit breaker 3P 11000V 1000A
8662	Oil circuit breaker 3P 350V 15A
8663	Oil circuit breaker 3P 350V 15A
8664	Oil circuit breaker 3P 350V 15A
8666	Oil circuit breaker 3P 3500V 200A
8667	Oil circuit breaker 3P 6900V 300A
8674	Over load oil circuit breaker 350V 300A
8678	Over load oil circuit breaker 3500V 100A
8679	Over load oil circuit breaker 3500V 100A
8682	Over load oil circuit breaker 3500V 50A
8684	Over load oil circuit breaker 3500V 50A

Inv. No.	Name of Machine
27 - 4 - 8686	Over load oil circuit breaker 3500V 30 A
8691	Over load oil circuit breaker 3300V 150A
8695	Over load oil circuit breaker 3450V 100A
8697	Over load oil circuit breaker 3500V 100A
8702	Over load oil circuit breaker 3500V 300A
8703	Over load oil circuit breaker 3500V 300A
8705	Over load oil circuit breaker 3500V 100A
8706	Over load oil circuit breaker 3500V 100A
8710	Over load oil circuit breaker 3500V 60 A
8713	Over load oil circuit breaker 3500V 200A
8715	Over load circuit breaker 3500V 100A

The following is non evaluation

Inv. No.	Name of Machine
27 - 4 - (9055)	Transformer out door self cooled 5 K.V.A. Ph. 1 cy 60.
(9057)	Oil circuit breaker Ph 3 3300V 150A
(9058)	Transformer out door self cooled 10K.V.A. Ph 1 cy 60
(9059)	Transformer out door self cooled 10K.V.A. Ph 1 cy. 60
(9060)	Transformer out door self cooled 10 K.V.A. Ph 1 cy. 60.
(9061)	Transformer out door self cooled 10 K.V.A. Ph. 1 cy 60.
(9062)	Transformer out door self cooled 10 K.V.A. Ph 1 cy. 60.
(9063)	Transformer out door self cooled 5 K.V.A. Ph. 1 cy 60
(9064)	Transformer out door self cooled 5K V.V.A. Ph. 1 cy.60
(9065)	Transformer out door self cooled 10K.V.A. Ph. 1 cy.60

Inv. No.	Name of Machine
27 - 4 - (9125)	Potable grinder 3Ph. 60 cy. 200 A 3000 to 3600 R.P.M. Dia & thk of wheel 7 inch x 1 inch
(9175)	Oil circuit breaker Ph 3 3300V 150 A
(9176)	Oil circuit breaker Ph.3 3300V 150 A
(9177)	Oil circuit breaker Ph.3 3300V 150 A
(9178)	Oil circuit breaker Ph.3 3300V 150 A
(9188)	Oil circuit breaker Ph.3 3300V 150 A
(9191)	Oil circuit breaker Ph.3 3500V 100 A
(9192)	Oil circuit breaker Ph.3 3500V 100 A
(9193)	Oil circuit breaker Ph.3 3300V 60 A
(9215)	Oil circuit breaker Ph.3 3300V 60 A
(9218)	Oil circuit breaker Ph. 3 3450V 100 A
(9220)	Oil circuit breaker Ph. 3 3300V 60 A
(9221)	Oil circuit breaker Ph. 3 3300V 60 A
(9222)	Oil circuit breaker Ph. 3 3300V 100 A
(9223)	Transformer out door self cooled 1 ph. 60 cy. 10 K.V.A.
(9224)	Oil circuit breaker Ph. 3 3300V 60 A
(9225)	Oil circuit breaker Ph. 3 3300V 60 A
(9226)	Oil circuit breaker Ph. 3 3300V 100 A
(9227)	Oil circuit breaker Ph.3 3300V 150 A
(9228)	Oil circuit breaker Ph.3 3300V 150 A
(9230)	Pole oil switch Ph.3 3300V 100 A
(9232)	Pole oil switch Ph.3 3300V 100 A
(9233)	Pole oil switch Ph. 3 3300V 150 A
(9234)	Pole oil switch Ph.3 3300V 60 A
(9235)	Pole oil switch Ph.3 3300V 150 A
(9236)	Pole oil switch Ph.3 3300V 150 A
(9237)	Pole oil switch Ph.3 3300V 150 A
(9238)	Pole oil switch Ph.3 3300V 60 A
(9239)	Pole oil switch Ph.3 3500V 100 A
(9240)	Pole oil switch Ph.3 3500V 300 A
(9241)	Pole oil switch Ph.3 3500V 200 A
(9250)	Pole oil switch 3P. 3300V 60 A

Inv. No.	Name of Machine
27 - 4 - (9242)	Pole oil switch Ph.3 3450V 200A
(9243)	Pole oil switch Ph.3 3450V 200A
(9244)	Pole oil switch Ph.3 3300V 150A
(9245)	Pole oil switch Ph.3 3300V 150A
(9246)	Pole oil switch Ph.3 3450V 200A
(9247)	Pole oil switch 3Ph. 3450V 200A
(9248)	Pole oil switch 3Ph. 3300V 30A
(9251)	Pole oil switch 3Ph. 3300V 150A
(9298)	Pole oil switch 3Ph. 3300V 60A
(9302)	Pole oil switch 3Ph. 3500V 200A
(9312)	Pole oil switch 3Ph. 6900V 600A
(9314)	Pole oil switch 3Ph. 6900V 600A
(9318)	Pole oil switch 3Ph. 3500V 50A
(9347)	Pole oil switch 3Ph. 3300V 60A
(9349)	Pole oil switch 3Ph. 3500V 100A
(9386)	Motor 15 HP 3Ph. 1450 R.P.M.
(9391)	Pole oil switch 3Ph. 3500V 200A
(9393)	Pole oil switch 3Ph. 3300V 150A
(9449)	Pole oil switch 3Ph. 69000V 400A
(9450)	Pole oil switch 3Ph. 69000V 400A
(9456)	Pole oil switch 3Ph. 3300V 100A
(9459)	Potable grinder 1 Ph. 100V 60 cy 3000R.P.M. $\frac{1}{2}$ HP Dia & thk of wheel 7 inch x 1 inch
(9460)	Potable grinder 1 Ph. 100V 60 cy 3000R.P.M. $\frac{1}{2}$ HP Dia & thk of wheel 7 inch x 1 inch
Item No.	
(671)	Grinding wheels 84 pcs. Dia 115mm hole 51mm thk 52mm Grain 80 Hardness LKQ
(672)	Grinding wheels 42 pcs. Dia 115mm hole 51mm thk 52mm Grain 80 Hardness K
(673)	Grinding wheels 13 pcs. Dia 115mm hole 51mm thk 32mm Grain 60 Hardness K

Inv. No.	Name of Machine
----------	-----------------

Item No.

- | | |
|-------|--|
| (674) | Grinding wheels 75 pcs.
Die 53mm hole 8mm thk 38mm Grain 80 Hardness K |
| (675) | Hand tap.1 Set H.S.
Die 20mm Pitch 2.5mm |
| (677) | Dialgauge universal
Measuring Range 50-66mm Measuring unit 1/100mm |
| (678) | Dialgauge tester in gauge 2 pcs.
Measuring range 0-7mm Measuring unit 1/100mm |
| (679) | Micrometers out side 157 pcs.
Measuring Range 25-50mm |
| (680) | Micrometers out side 15 pcs.
Measuring Range 50-75mm 5 pcs.
Measuring Range 75-100mm 10 pcs. |
| (681) | Micrometers out side 11 pcs.
Measuring Range 125-150mm 5pcs.
100-125mm 6pcs. |
| (682) | Micrometer out side 28 pcs.
Measuring Range 150-175mm 12 pcs. 175-200mm 16 pcs. |
| (683) | Micrometers out side 15 pcs.
Measuring Range 200-225mm 9 pcs. 225-250mm 6pcs. |
| (684) | Micrometers out side 10 pcs.
Measuring Range 250-275mm |
| (685) | Micrometer out side
Measuring Range 425-450mm |
| (686) | Micrometer out side
Measuring Range 475-500mm |
| (687) | Micrometers Thread out side 3pcs.
Measuring Range 0-25mm 2 pcs. 50-75mm 1 pcs. |
| (690) | Calipers Inside 260pcs. L 160mm
Material steel |
| (691) | Calipers Inside 100 pcs.L 100mm
Material steel |
| (692) | Calipers Inside 150 pcs.L 200mm
Material steel. |

LIST OF EQUIPMENT DESIGNATED FOR RETENTION

Name of Arsenal : 21st Naval Air Depot Isahaya Branch.

Address : Koseicho Isahaya-shi, Nagasaki-keh.

Code No. : 27 - 4

Date 13 Feb. 1950

Page 13 of 18 Page

1. Equipment falling under the category of par 2a of the memorandum

Inv. No.

Name of Machine

non evaluation

Surface gauges 20 Pcs.

H 240mm - 460mm

L 220mm - 400mm

LIST OF EQUIPMENT DESIGNATED FOR RETENTION

Name of Arsenal : 21st Naval Air Depot Isehaya Branch

Address : Koseicho Isehaya-shi, Nagasaki-ken.

Code No. : 27 - 4

Date 13 Feb. 1950

Page 14 of 18 Page

2. Equipment falling under the category of per 2b of the memorandum

Inv. No.	Name of Machine
27 - 4 - 1161	Motor 5 HP
2412	Transformer 10 K.V. A.
2413	Transformer 50 K.V. A.
2414	Transformer 50 K.V. A.
2415	Transformer 50 K.V. A.
2422	Motor 5 HP
4851	Potable grinder
4852	Potable grinder
4853	Potable grinder
4854	Potable grinder
4856	Potable grinder
4857	Potable grinder
49464	Auto transformer 25.2 K.V. A.
4965	Auto Transformer 30 K.V. A.
4966	Auto Transformer 11.5 K.V. A.
4967	Auto Transformer 13.5 K.V. A.
4968	Auto Transformer 6.1 K.V. A.
4969	Auto Transformer 1.4 K.V. A.
4970	Auto Transformer 1.4 K.V. A.
4971	Auto Transformer 15 K.V. A.

LIST OF EQUIPMENT DESIGNATED FOR RETENTION.

Name of Arsenal : 21st Naval Air Depot Kashima Branch.

Address : Shiota-machi, Fujitsu-gun, Saga-ken.

Code No. : 27 - 4

Date 13 Feb. 1950

Page 15 of 17 Page

1. Equipment falling under the category of par 2e of the memorandum

Inv. No.	Name of Machine
27 - 4 - 1878	Turret lathe
1885	Slotting machine
1886	Shearing machine
1906	Milling machine

LIST OF EQUIPMENT DESIGNATED FOR RETENTION

Name of Arsenal : 21st Naval Air Depot Kashima Branch
 Address : Shiota-machi, Fujitsu-gun, Sago-ken.
 Code No. : 27 - 4

Date 13 Feb. 1950

Page 16 of 18 Page

2. Equipment falling under the category of per 2b of the memorandum.

Inv. No.	Name of Machine
27 - 4 - 2197	Transformer 500 K.V. A.
2430	Transformer 75 K.V. A.
2431	Transformer 75 K.V. A.
4625	Potable drill
4626	Potable Grinder
4751	Motor 10 HP
4752	Motor 10 HP
4778	Oil switch 3500V 60A
4779	Oil switch 3500V 60A
4780	Pole oil switch 3500V 100A
4781	Pole oil switch 3500V 100A
4782	Pole oil switch 3300V 30A
4783	Pole oil switch 3300V 30A
4784	Transformer 3.5 K.V. A.
4785	Transformer 3.5 K.V. A.
4789	Transformer 2 K.V. A.
4790	Transformer 2 K.V. A.
4791	Transformer 2 K.V. A.
4804	Oil switch 3300V 100A
4805	Oil circuit breaker 3300V 100A

Inv. No.	Name of Machine
27 - 4 - 4806	Oil circuit breaker 3300V 100A
4807	Oil circuit breaker 6900V 300A
4808	Oil circuit breaker 3450V 300A
4809	Oil circuit breaker 3450V 300A
Item No.	Grinding wheels 2 pcs. Dia 410mm thk 50mm Dia of hole 115mm
3 Page 459	Grinding wheels 5 pcs. Dia 500mm thk 65mm Dia of hole 190mm
4 Page 459	Micrometer Inside Measuring Range 35-60mm Measuring unit 1/100mm
21 Page 461	Gauge blocks 8 pcs. Size of Block (in m.m.) 125, 150, 175, 200, 250, 300, 400, 500.
37 Page 464	Gauge blocks 8 pcs. Size of block 1005 - 100mm Gauge tables 2 sets Size of gauge table L 410mm W 210mm H 50mm
Non evaluation (9343)	Transformer 10 K.V. A.
(9344)	Transformer 10 K.V. A.

LIST OF EQUIPMENT DESIGNATED FOR RETENTION

Name of Arsenal : 21st Naval Air Depot.

Address : Momozu Kawatane-machi, Higashisonogi-gun, Nagasaki-ken.

Code No. : 27 - 4

Page 18 of 18 Page

2. Equipment falling under the category of per 2b of the memorandum.

Inv. No.	Name of Machine	
27-4-2352	Transformer	150 K.V.A.
2353	"	"
2354	"	"
2356	"	"
2357	"	"
2358	"	"
2829	"	20 K.V.A.
2830	"	"
4610	Motor	5 HP