

COMPANY SITE	---	1291
BUILDING FLOOR SPACE	--	232
TOTAL NO. OF BUILDING	---	



Pool

Engine Testing Room

Hydrant

Well

E

Gasoline Tank

30 W.C.

17  
Painting  
Room

129106.98 sq.M.

SPACE -- 23248.59 sq.M.

DING --- 35



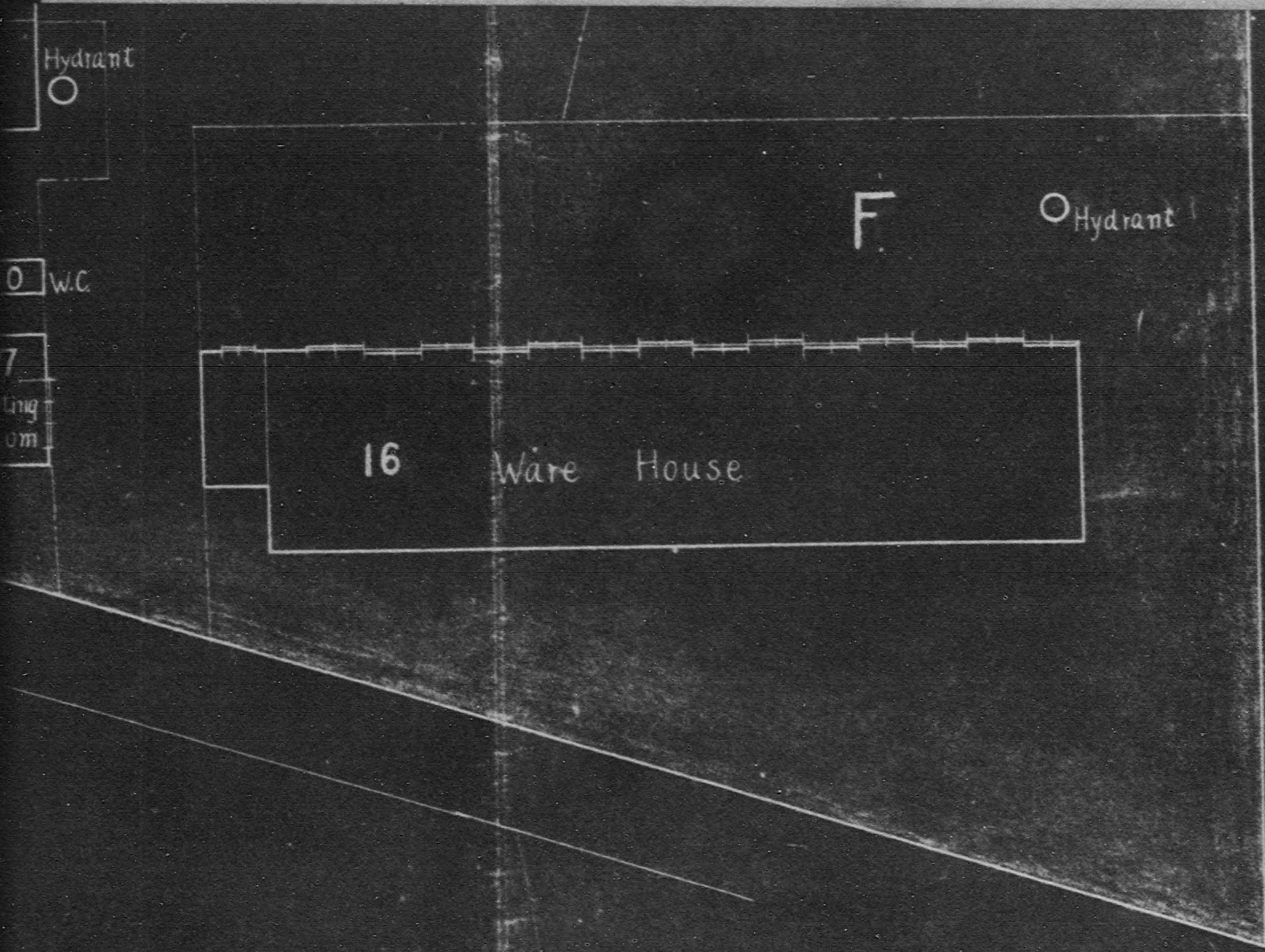

10	Ware Hou
11	Design Dep (2nd Stor) Ware Hou (1st Stor)
12	Ware Hou
13	Ware Hou
14	Ware Ho
15	Ware Ho
16	Ware Ho
17	Painting R
18	Kitchen
19	Garage
20	Carpentert
21	Material Y
22	Guard Ho
23	Gasoline Pu
24	Bicycle Parkin
25	W. C.
26	W. C.



10	Ware House	Tile Roofing	12.75 x 17.27	218.54		
11	Design Dept. (2nd Storied)	Wooden-Frame Slate Roofing	16.36 x 39.69	962.53	B	Money Safe
	Ware House (1st Storied)	(Two Storied House)				Pool
12	Ware House	Wooden-Frame Slate Roofing	16.36 x 38.78	634.69		Well
13	Ware House	Wooden-Frame Slate Roofing	9.09 x 18.18	165.28		Hydrant
14	Ware House	Wooden-Frame Shingle Roofing	5.45 x 27.27	148.66		Hydrant
15	Ware House	Wooden-Frame Shingle Roofing	5.45 x 27.27	148.66		Hydrant
16	Ware House	Wooden-Frame Slate Roofing	14.54 x 59.99	852.89	C	Hydrant
17	Painting Room	Wooden-Frame Slate Roofing	10.81 x 7.27	79.33		Hydrant
18	Kitchen	Wooden-Frame Slate Roofing	7.27 x 9.09	65.45	D	Pool
19	Garage	Wooden-Frame Slate Roofing	8.18 x 18.18	148.83		Hydrant
20	Carpenter House	Wooden-Frame Zinc Roofing	9.09 x 18.18	165.28		Gasoline Tank
21	Material Yard	Wooden-Frame Slate Roofing	3.64 x 56.36	204.92	E	Pool
22	Guard House	Wooden-Frame Slate Roofing	1.82 x 2.73	4.96		Well
23	Gasoline Pump	Wooden-Frame Shingle Roofing	1.82 x 2.73	4.96		Hydrant
24	Bicycle Parking Space	Wooden-Frame Slate Roofing	5.78 x 45.45	247.93	F	Hydrant
25	W. C.	Wooden-Frame Slate Roofing	2.73 x 3.64	11.90		
26	W. C.	Wooden-Frame Slate Roofing	2.73 x 4.55	14.87		



Safe			
ant			
ant			
ant			
ant			
ant			
ant			
line Tank			
ll			
rant			
rant			



## REPORT ON CUSTODIAL PERSONNEL AT REPARATIONS PLANT

20 July, 1950.

CODE NO. : 34 - 57  
PLANT NAME : Kageyama Kikai Seisakusho  
LOCATION : Oyaguchi, Urawa-shi, Saitama Pref.

## A. Total number of items mentioned, Machine Tools and Equipment.

Machine tools	89
Electric machines	15
General machines	8

B. Total point value of A, above. 6,053

C. Total floor space of the plant ( under custody ) 656 tsybo

## D. Nature and value of equipment.

Few machines are old and worn out.

## E. Number, disposition, construction and condition of buildings, housing reparations equipment.

6 wooden slate-roofed buildings.  
Condition is good.

## F. Size and characteristics of plant area, nature of protective inclosure.

Size of plant area 8,500 tsybo.  
Strong hedge.

## G. Existence of firms, institutions or installations adjacent to the plant which constitute a fire hazard.

None.

## H. Undesirable social condition.

## I. Number of guard posts and required number of relief guards.

One guard post and one relief guards

## J. Percentage of idle machinery.

55%.



Code No. 34-57

Plant Name: Kajeyama Kikai

Seisakusho.

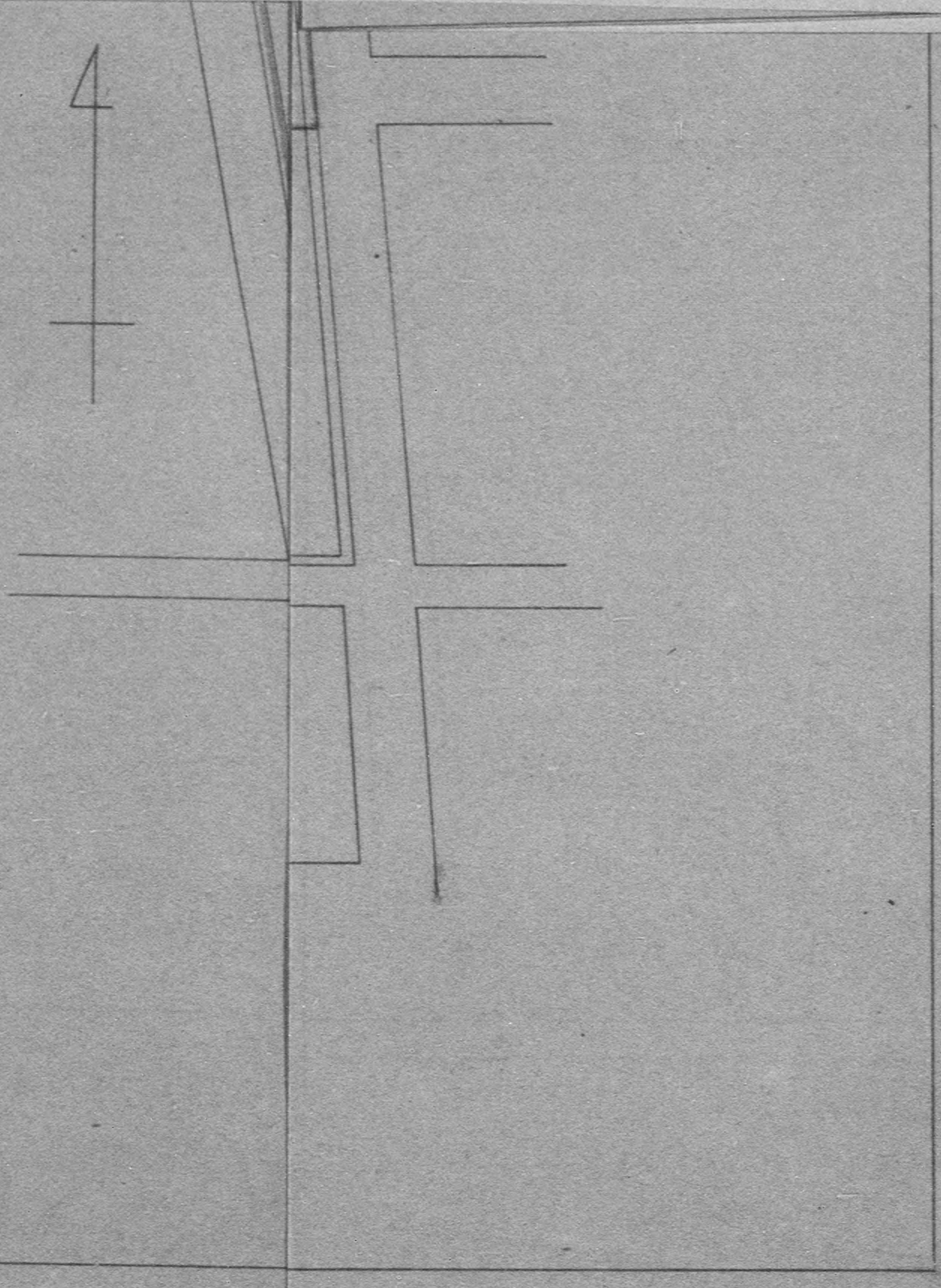



No 34~57

Plant: K.K. Kageyama  
Kikai Seisakusho  
Location: 243 Oyaguchi Urawa City  
Saitama Pref.

# PEACE SEWING MACHINE

(Kageyama Machine Tool)

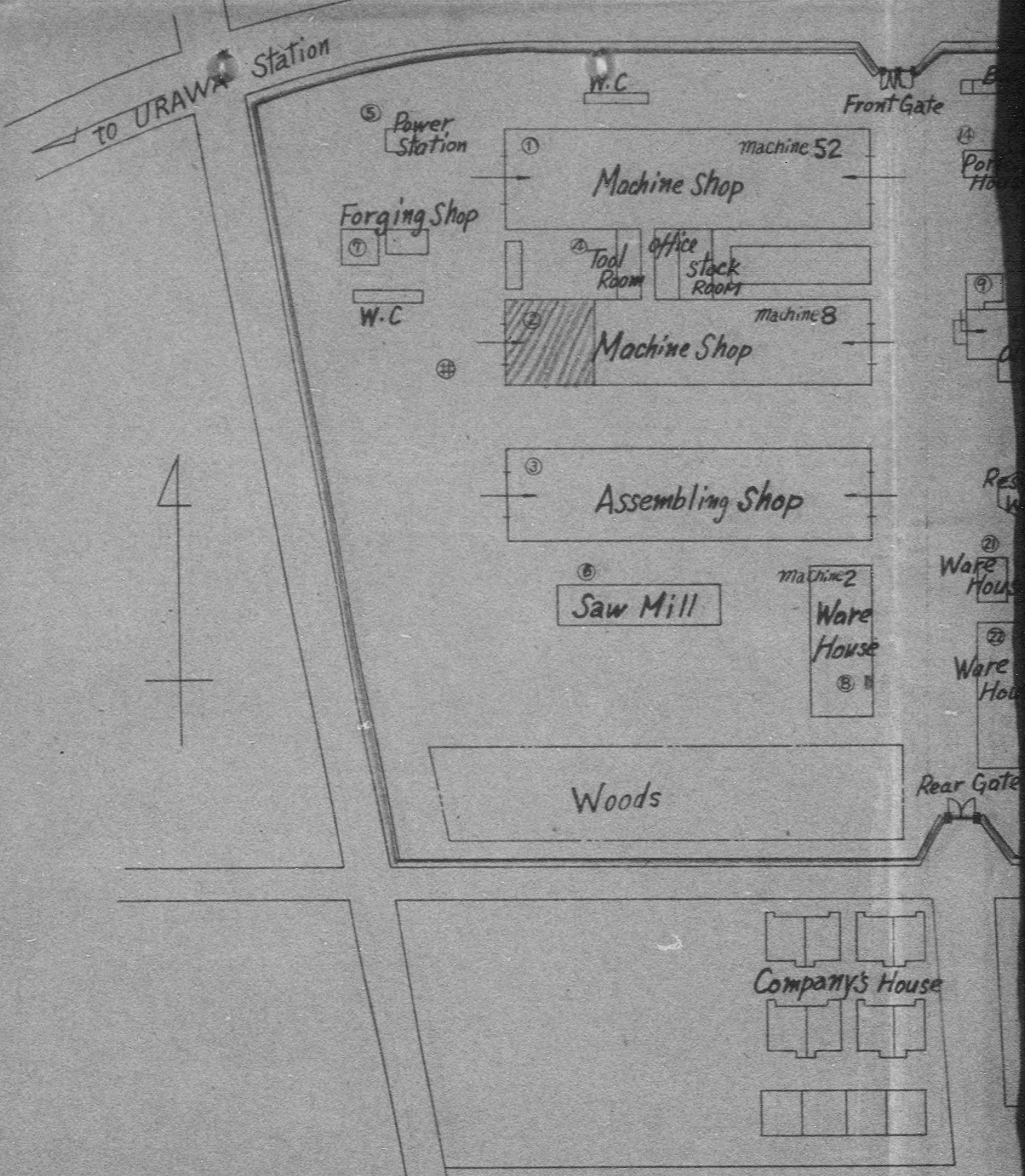



# GE SEWING MACHINE MFG. CO., LTD. (Kageyama Machine Tool Works Ltd.)

to KOSHIGAYA

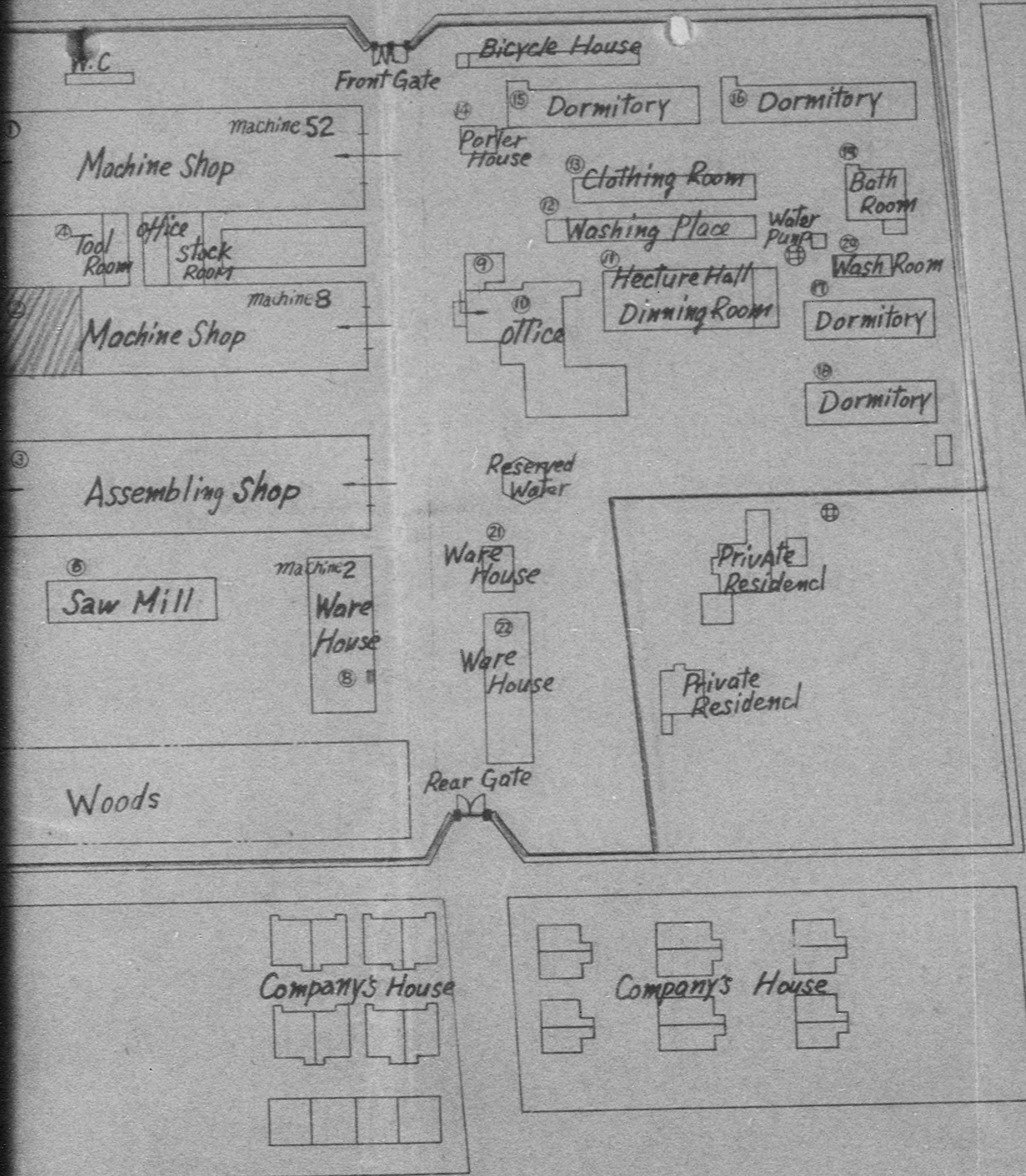



LTD.

)

25 th. Aug. 1946

to KOSHIGAYA

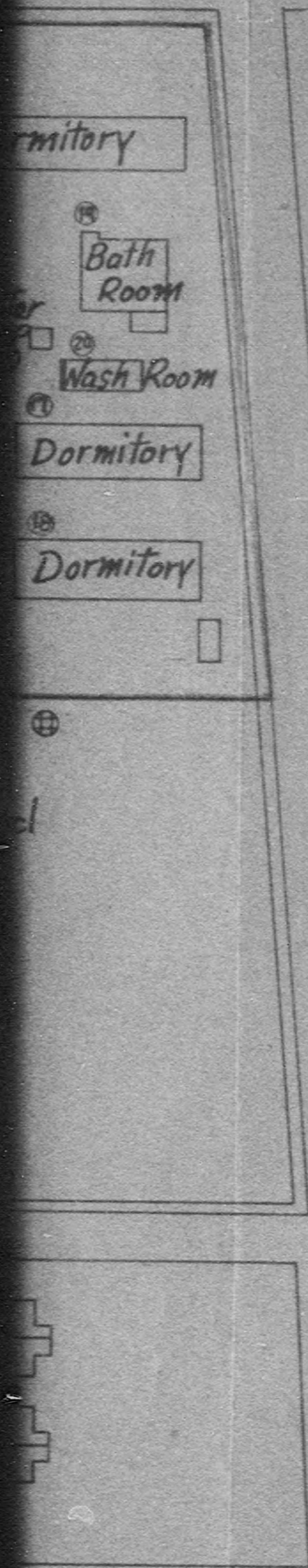



LTD.

25 th. Aug. 1946

to KOSHIGAYA

mitory

Bath Room

Wash Room

Dormitory

Dormitory

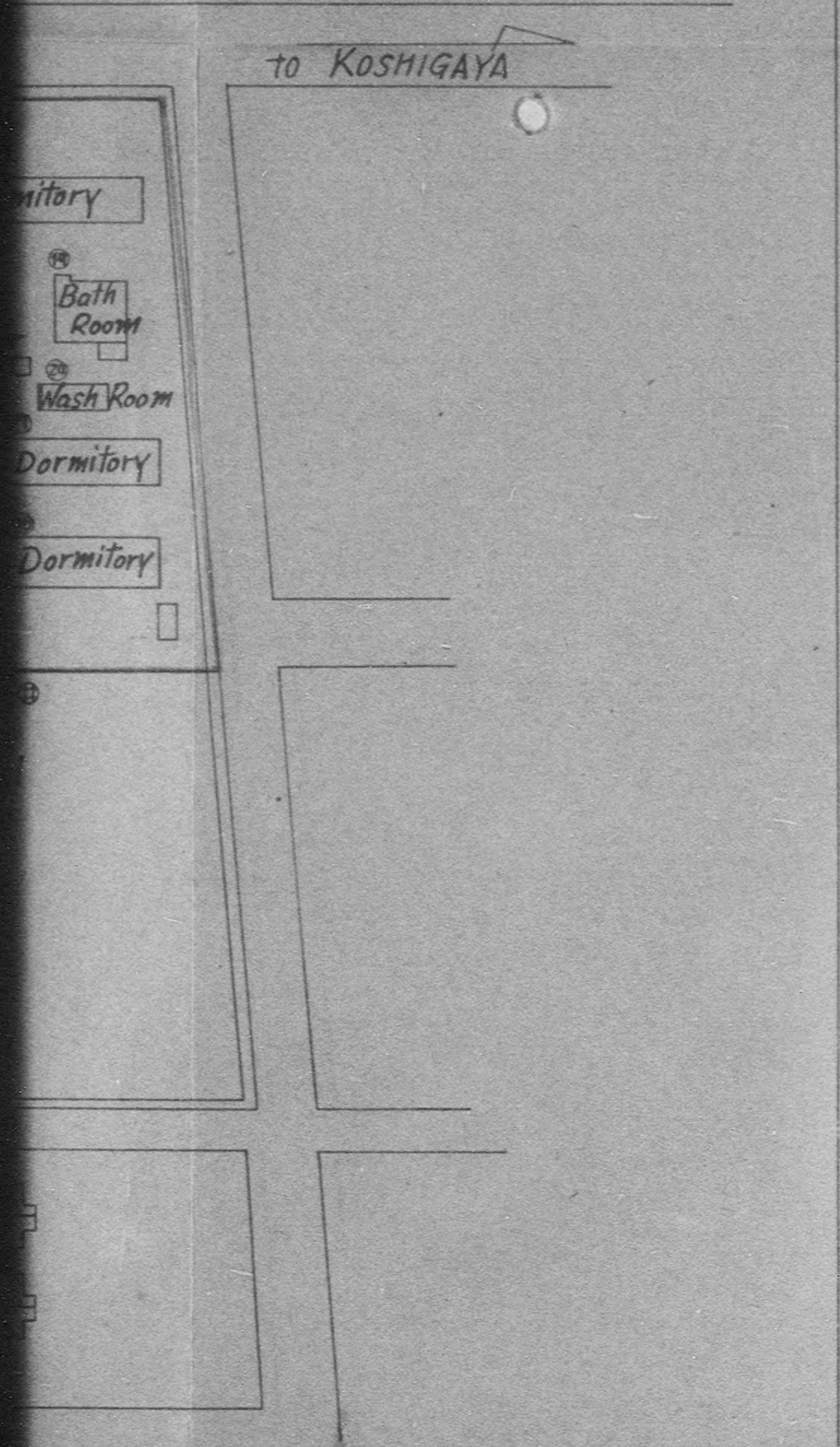



## REPORT ON CUSTODIAL PERSONNEL AT REPARATIONS PLANT.

20 July, 1950.

CORE NO. : 34 - 56  
 PLANT NAME : Chiba Seisakusho Honjo Plant.  
 LOCATION : Jonho-machi, Kodama-gun, Saitama Pref.

## A. Total number of items mentioned, Machine Tools and Equipment.

Machine Tools	193
Electric machines	17
General machines	5

B. Total point value of A, above. 13,710

C. Total floor space of the plant ( under custody ) 1,046 tsubo

## D. Nature and value of equipment.

About 10% machines are old and worn out.

## E. Number, disposition, construction and condition of buildings, housing reparations equipment.

8 wooden slate-roofed buildings.  
 Condition is good.

## F. Size and characteristics of plant area, nature of protective inclosure.

Size of plant area 2,500 tsubo.  
 Strong wooden inclosure.

## G. Existence of firms, institutions or installations adjacent to the plant which constitute a fire hazard.

None.

## H. Undesirable social condition.

## I. Number of guard posts and required number of relief guards.

One guard post, and three relief guards.

## J. Percentage of idle machinery.

67%.



Code No. 34-56

Plant Name; Chiba Sangio K.K.

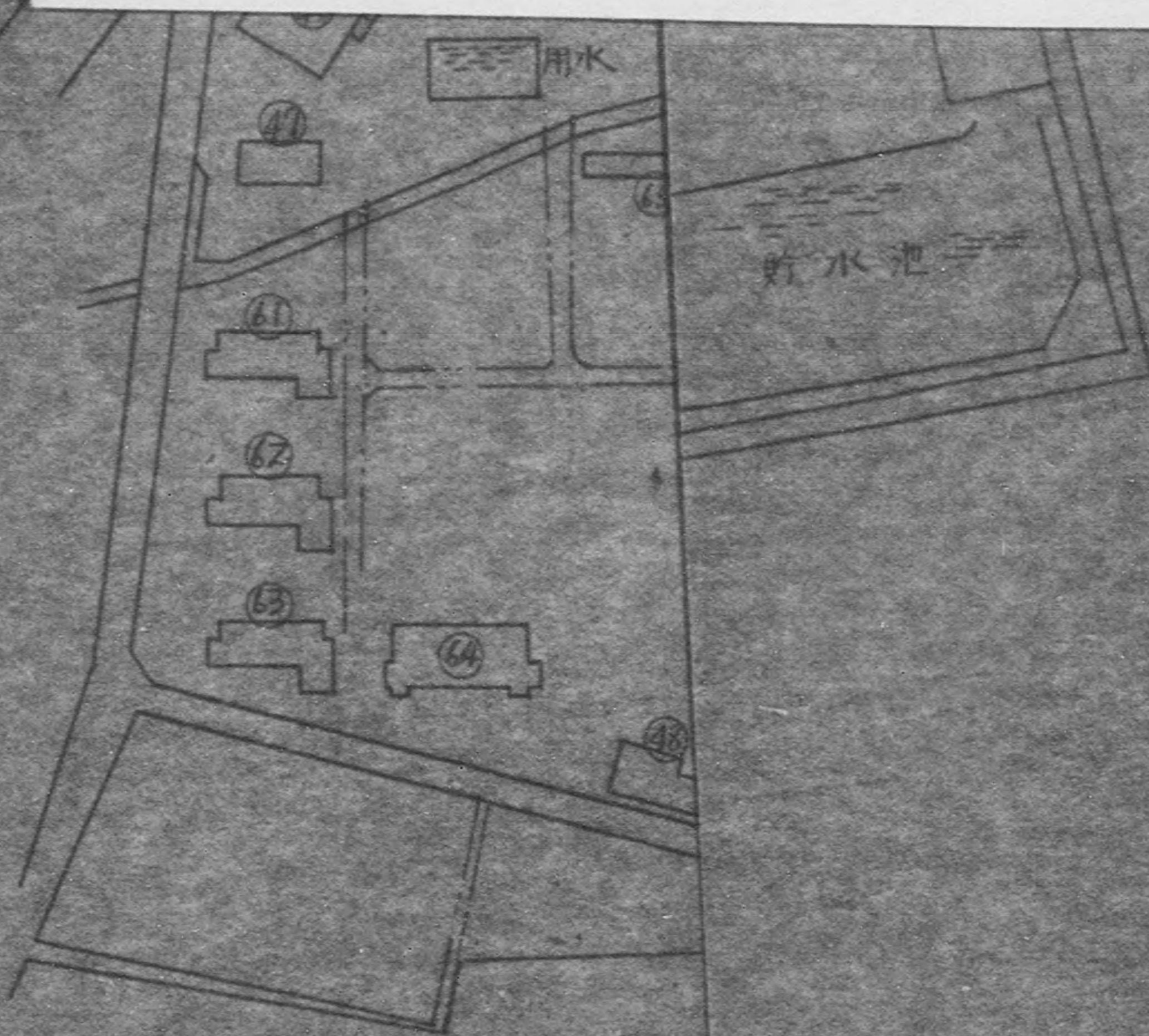

			1	千八
24.10.28	T. N.		1000	
千葉産業株式会社工場				
建物配置図				



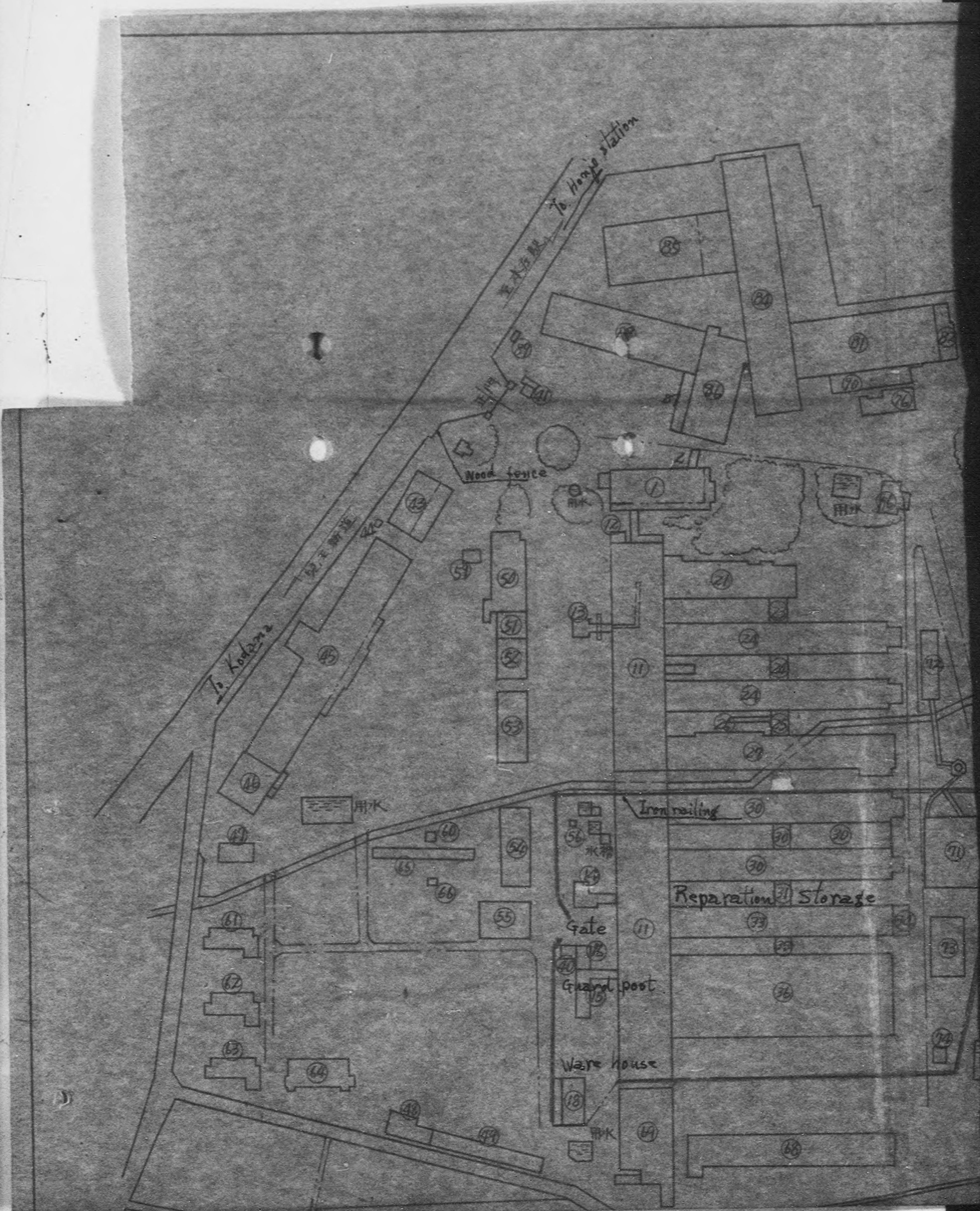



PLANT LAYOUT

Code No.: 34-56

Name of Plant.: Honjo Plant, Chiba Sangyo

Location.: No. 2713, Honjo-machi, Saitama





PLANT LAYOUT

.: 34-56

Plant.: Honjo Plant, Chiba Sangyom Inc.

Address: No. 2713, Honjo-machi, Saitama Prefecture









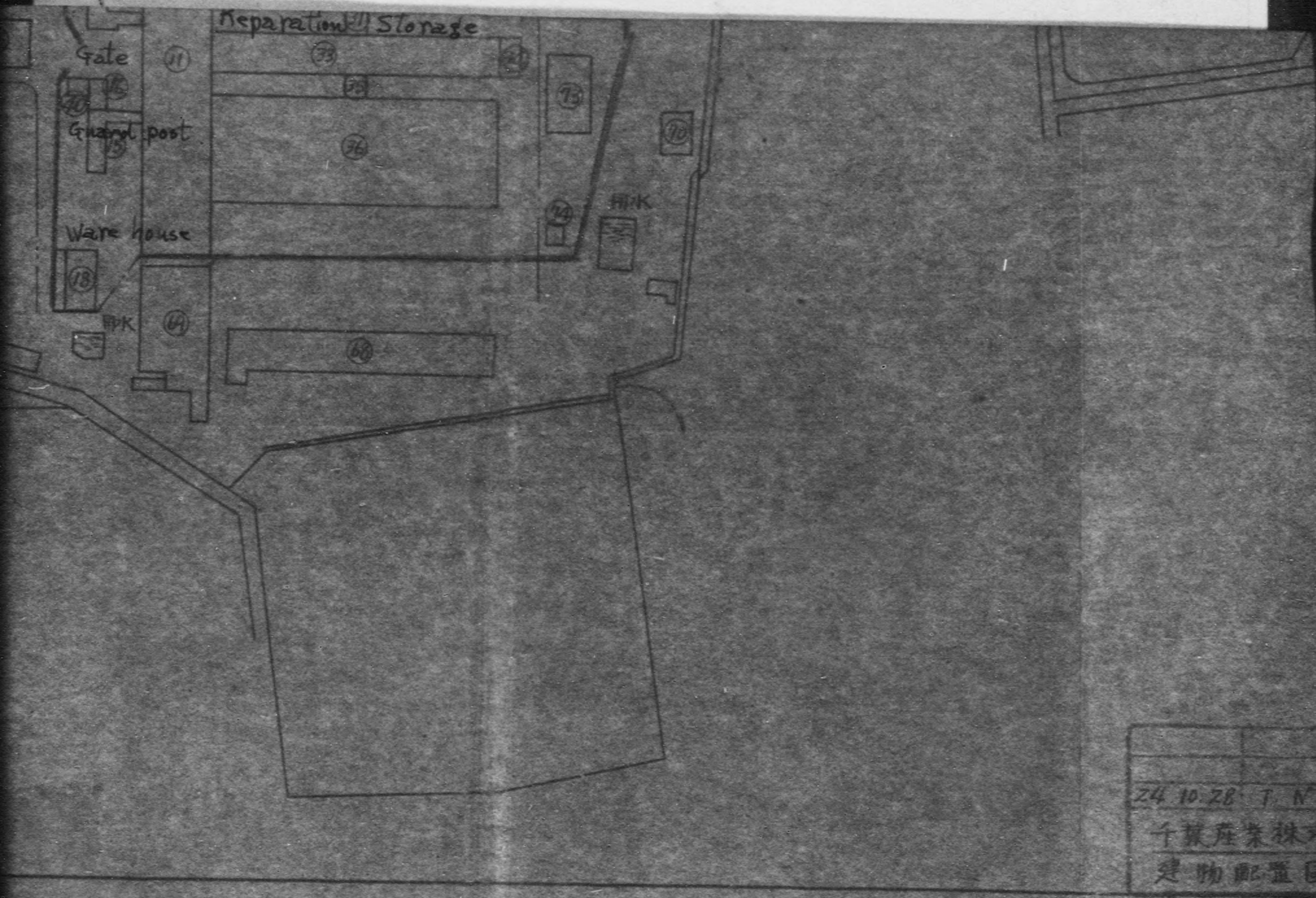

24 10-28 T N  
 千原産業株大  
 建物配置図



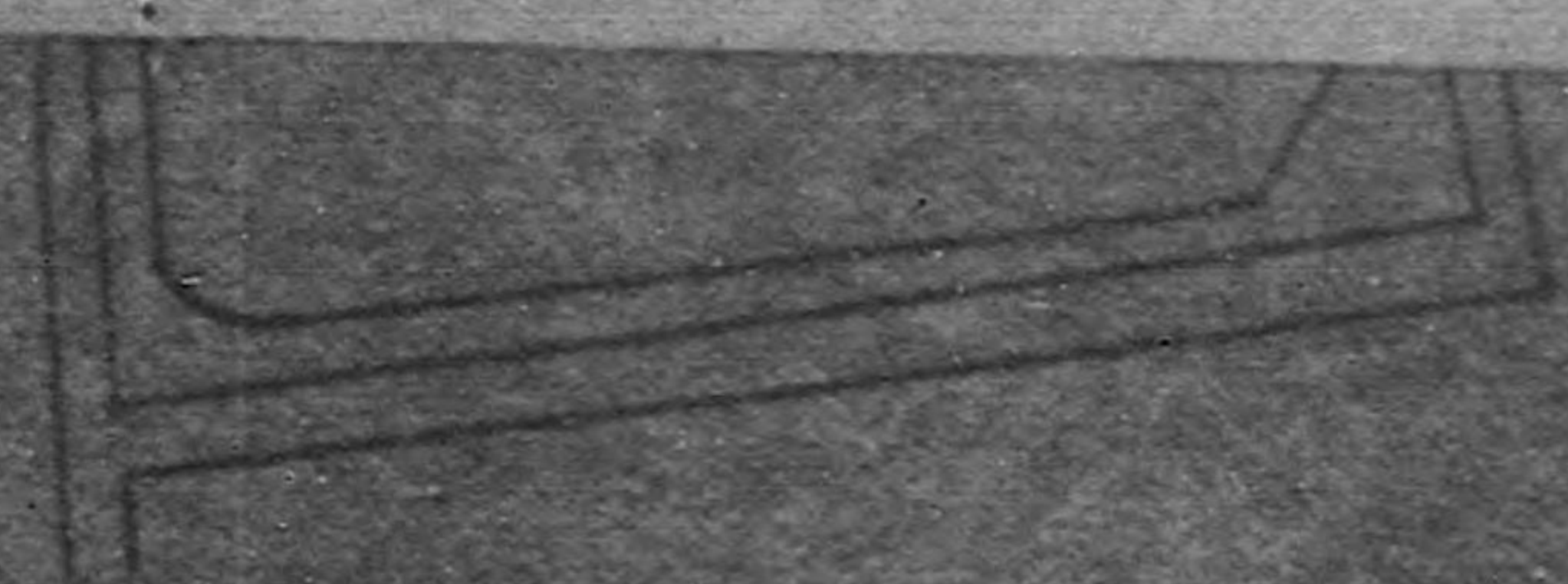

			1/1000	1/1000
24.10.28	T. N.			
千原産業株式会社木立場				
建物配置図				



## REPORT ON CUSTODIAL PERSONNEL AT REPARATIONS PLANT

20 July, 1950.

CODE NO. : 34 - 63  
PLANT NAME : Nihon Kiko K.K.  
LOCATION : Yono-machi, Kita-adachi-gun, Saitama Pref.

## A. Total number of items mentioned, Machine Tools and Equipment.

Machine Tools	121
Electric machines	28
General machines	10

- B. Total point value of A, above. 10,774
- C. Total floor space of the plant ( under custody ) 693 tsubo.
- D. Nature and value of equipment.

Many machines are old and worn out.

## E. Number, disposition, construction and condition of buildings, housing reparations equipment.

13 wooden slate and zinc roofed buildings.  
Condition is not good.

## F. Size and characteristics of plant area, nature of protective inclosure.

Size of plant area  
One side is concrete inclosure and other side is wooden inclosure.

## G. Existence of firms, institutions or installations adjacent to the plant which constitute a fire hazard.

None.

## H. Undesirable social condition.

## I. Number of guard posts and required number of relief guards.

One guard post and one relief guard.

## K. Percentage of idle machinery.

52%.



Code No. 84-63

Plant Name: Nihon KIKOKU K.K.

Wood fence

⑥

Foundry
Casting Shop
Blower 1
Compressor 1
Furnace 2
Furnace for drying of mould 1
Grinder 1

Concrete fence

Wood fence

Road

⑧

Stock House
-------------

20.5

10 部 11 月 12 日



Code No. 34-63

NIHON KIK

Location; 590 Hamiochiai  
Yono-machi Saitama  
Pref.

Situation of Buildings in

For Ōmiya

Concrete fence

Office  
Tool & Raw  
Stock

Pattern Shop

7

2

5

4

Wood fence

6

Foundry Casting Shop  
Blower 1  
Compressor 1  
Furnace 2  
Furnace for drying of mould 1  
Grinder 1

Assembly Shop

Face Lathe 1  
Press 2  
Grinder 1  
Shearing machine 1  
Pipe Bender 2  
Electric Furnace 3  
Crane 2  
Lathe 1  
Boring Machine 1  
  
Electric Welding 2  
Motor 1

19

Hack Saw 2

Machine Shop

Lathe	35
Fellow's Gear Shaper	3
Hobbing Machine	2
Gleason's Gear Shaper	1
Vertical Milling Machine	2
Plane Milling Machine	6
Hand Milling Machine	1
Universal Grinder	1
Plane Grinder	1
Surface Grinder	1
Tool Grinder	1
Horizontal Boring Machine	1
Radial Drill	2
Turret Lathe	1
Slotter	5
Planer	4
Shaper	2
Upright Drill	1
Grinder	5
Motor	2
Crane	2
Portable Drill	2

Road

8

Stock House

22

Toilet

Wood fence



# NIHON KIKŌ K.K

Location of Buildings in the compound

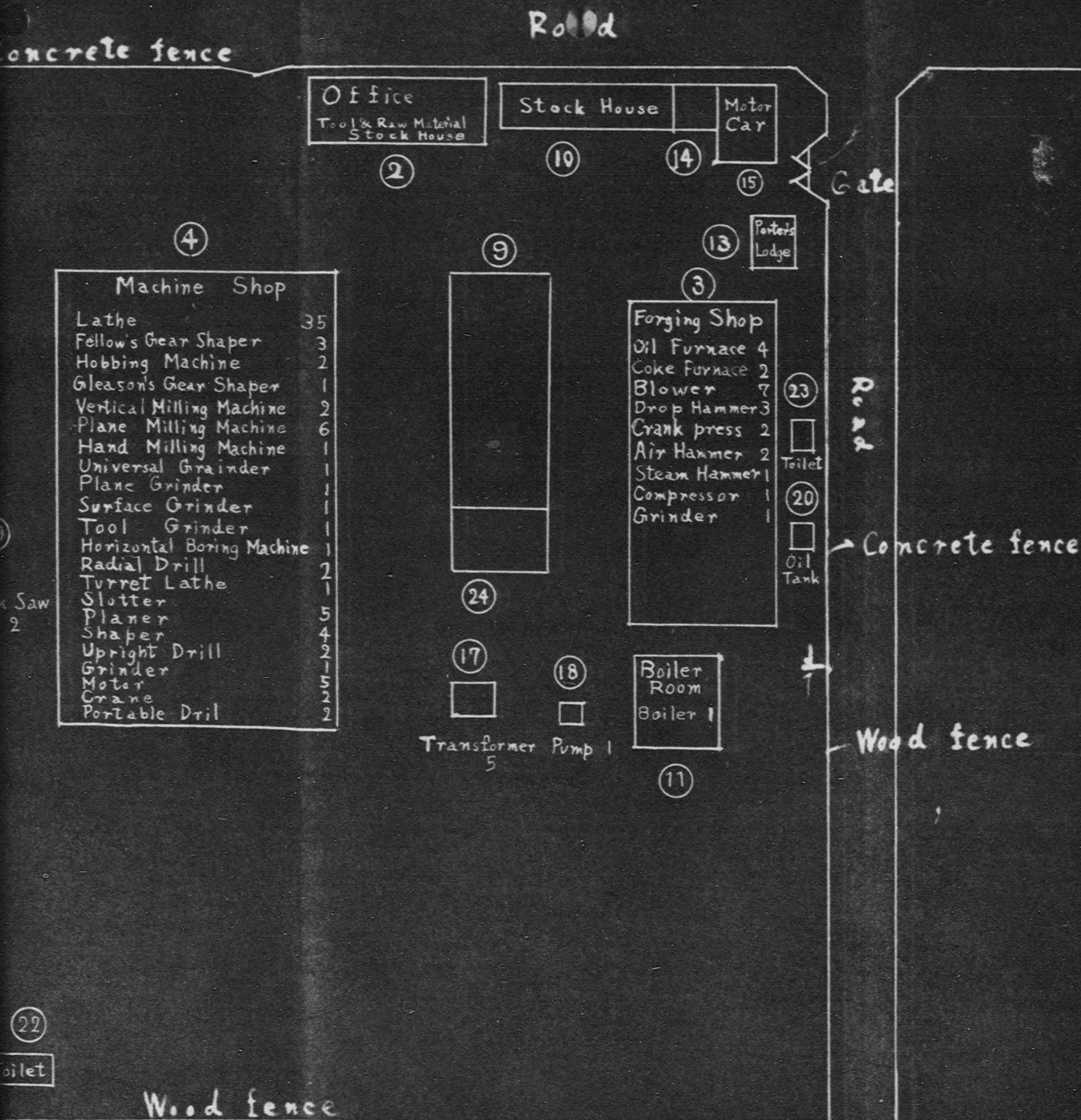





d

For Tokyo  
→

Motor Car

15 Gate

3 Peters Lodge

hop  
ce 4  
ce 2  
7  
mer 3  
s 2  
7 2  
mer 1  
1  
1

23  
Toilet  
20  
Oil Tank

Road

Concrete fence

Wood fence

20.3

10 21 12 13 14 15



## REPORT ON CUSTODIAL PERSONNEL AT REPARATIONS PLANT

20 July, 1950

CODE NO. : 34 - 64  
PLANT NAME : Omiya Plant of Nippon Kogaku Kogyo K.K.  
LOCATION : Kitabukuro, Omiya-shi, Saitama Pref.

## A. Total number of items mentioned, Machine tools and Equipment.

Machine tools 13  
Electric machines 25  
General machines 4

## B. Total point value of A, above. 618

## C. Total floor space of the plant ( under custody ) 164 tsubo.

## D. Nature and value of equipment.

About 30% machines are old and worn out.

## E. Number, disposition, construction and condition of buildings, housing reparations equipment.

2 concrete buildings.  
2 wooden slate-roofed buildings.  
Condition is good.

## F. Size and characteristics of plant area, nature of protective inclosure.

Size of plant area 278 tsubo.  
Weak bamboo inclosure.

## G. Existence of fires, institutions or installations adjacent to the plant which constitute a fire hazard.

None.

## H. Undesirable social condition.

## I. Number of guard posts and required number of relief guards.

One guard post and one relief guard.

## J. Percentage of idle machinery.

67%.



# Plant Layout

Code No. 34-64  
Name of plant; Omiya plant. Nippon Kogaku Kogyo K.K.  
Location; 13 Kitabukuro Omiya Saitama pref.

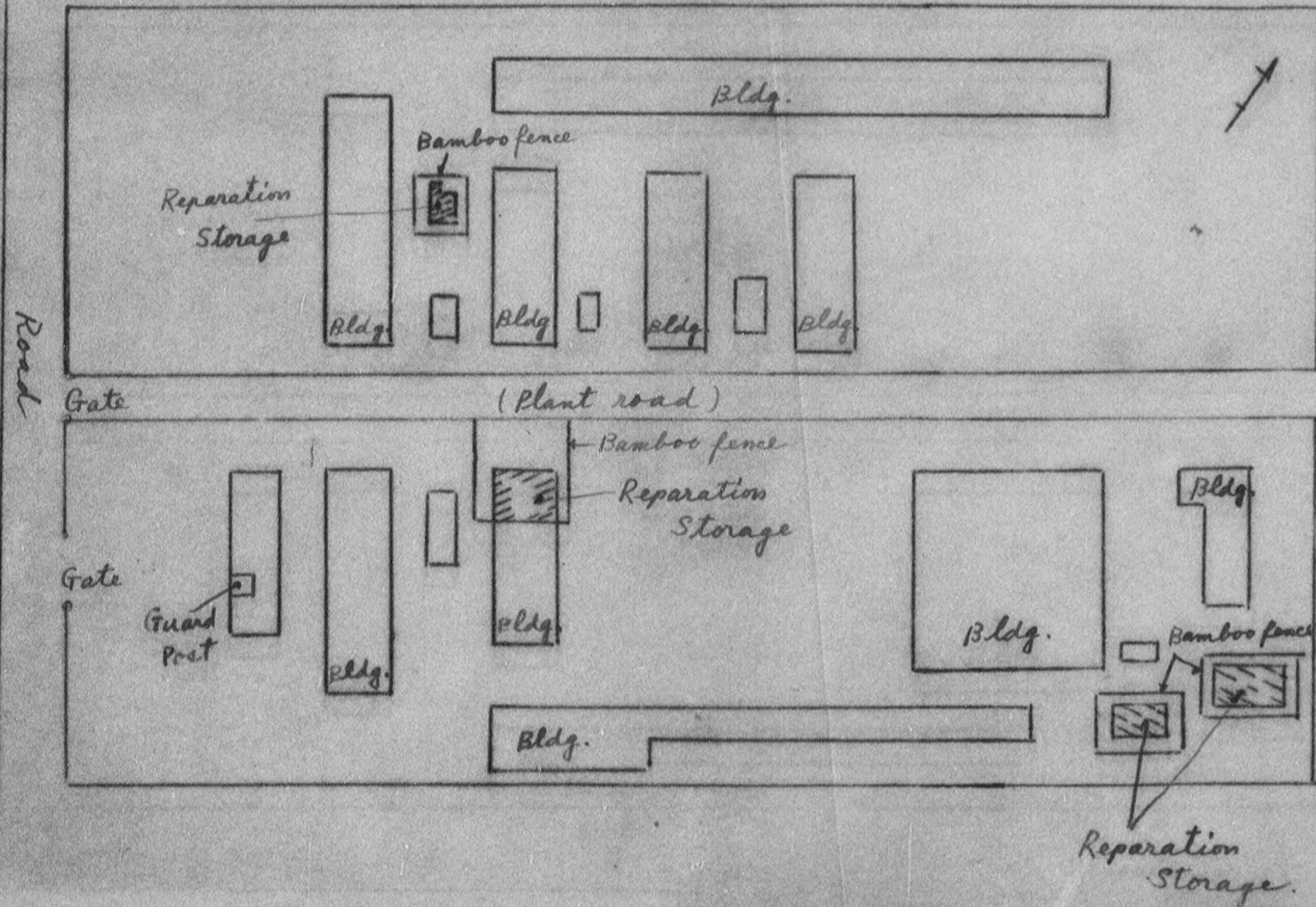



## REPORT ON CUSTODIAL PERSONNEL AT REPARATIONS PLANT

20 July, 1950.

CODE NO. : 34 - 65

PLANT NAME : Kawaguchi Plant, Nippon Kagaku.

LOCATION : Sakai-cho, Kawaguchi-shi, Saitama Pref.

## A. Total number of items mentioned, machine tools and equipment.

Machine tools	27
Electric machines	2
General machines	6

B. Total point value of A, above. 2,950

C. Total floor space of the plant ( under custody ) 180 tsubo.

## D. Nature and value of equipment.

Most equipment is old and worn out.

## E. Number, disposition, construction and condition of buildings, housing reparations equipment.

3 iron frames buildings. One wooden slate roofed building.

Condition of buildings is good.

## F. Size and characteristics of plant area, nature of protective inclosure.

Size of plant area 250 tsubo.

Strong zinc inclosure.

## G. Existence of firms, institutions or installations adjacent to the plant which constitute a fire hazard.

None.

## H. Undesirable social condition.

## I. Number of guard posts and required number of relief guards.

One guard post and one relief guard.

J. Percentage of ~~100%~~ machinery.

100%.



Plant layout

Code No. 34-65  
Name of plant; Kawaguchi plant, Nippon Kogaku Kogyo K.K.  
Location ; 22 1-chome Sakae-machi Kawaguchi Saitama pref.

Ware house

Gate

Wood

← Wood fence

Guard post

Reparation Storage