

775 013

GHQ/SCAP Records (RG 331, National Archives and Records Service)  
 Description of contents

- (1) Box no. 2905
- (2) Folder title/number: (11)  
 400.170: (Reconversion & Exemption) Kawasaki Aircraft -  
 Kobe Plant
- (3) Date: Feb. 1946 - Aug. 1949
- (4) Subject:

Classification	Type of record
9230, 9621	Z

- (5) Item description and comment:  
 1) Kobe  
 11) Includes Contents List
- (6) Reproduction:  Yes  No
- (7) Film no.

Sheet no.

(Compiled by National Diet Library)



775 013

I N D E X

( 400.17 )

	<u>Date</u>	<u>Subject</u>
1.	13 Apr 46	Application for Reconversion Permit Submitted by Kobe Casting and Forging Plant, Kawasaki Aircraft Industries Limited.
2.	20 Apr 46	Request for Additional Information Regarding Kawasaki Aircraft Company, Kobe Branch
3.	15 May 46	Permit for Reconversion from War Production and for Resumption of Production of Essential Civilian Commodities.

It is requested that necessary action be taken to ensure that the above information is disseminated to all concerned agencies and that the necessary steps be taken to ensure that the information is kept up to date.

Very truly yours,  
 [Signature]

Major General  
 [Signature]

100  
 [Signature]

100  
 [Signature]



775 013

HEADQUARTERS  
HYOGO MILITARY GOVERNMENT AREA  
(APO 317)

File No.	Date
SUBJECT: Expediting Procurement Receipts	
TO :	

1. In compliance with Operational Directive 33, Headquarters Eighth Army, dated 26 March 1946, procurement receipts (GSA Form 2) outstanding for more than 60 days, have not been received for the procurement demands listed on the attached inclosure.

2. It is requested that necessary action be taken to obtain receipts for all supplies, services and facilities received on procurement demands listed.

3. Any undue delay in delivery of supplies and facilities after a demand is issued should be reported to this office for appropriate action.

4. Cancellations should be forwarded this office on procurement demands requesting items or services not received and no longer needed.

5. It is further requested that a follow-up be made at regular intervals to insure prompt receipt of these procurement transactions.

RUSSELL G. ASHKOP  
Lt Col, C.A.C.  
Commanding

Incl:  
List of Procurement Demand Numbers

cc:  
CG, Eighth Army



775 013

HEADQUARTERS I CORPS  
APO 301 (Kyoto, Honshu)

GIS/rsm

note attached  
fileRef: IO - 355

AG 004 - BA

MAY 15 1946

SUBJECT: Permit for Reconversion from War Production and for Resumption of Production of Essential Civilian Commodities.

TO: Kawasaki Aircraft Industries Co., Ltd., Kobe Casting  
(Name and Address of Firm)  
and Forging Plant.  
1, 2-Chome, Wadayama-dori, Hyogo-ku, Kobe.1. a. In accord with paragraph 3, b, Directive Number Three (3) from the Supreme Commander to the Imperial Japanese Government, dated 22 September 1945, the Kobe Casting & Forging Plant  
(Name of Firm)is permitted to immediately start production of Parts for railway  
(Name of Items)  
equipment, automobile, bicycle, ship, farm implement, and  
household utensils. (a) Steel forgings. (b) Aluminum castings.  
(c) Cast iron. (d) Copper Alloys. (NOTHING FOLLOWS)b. Maximum production currently authorized is per annum(a) 330 T. (b) 120 T. (c) 370 T. (d) 160 T.

2. The acquisition of material, parts and sub-assemblies as well as the disposition of finished products, and the establishment of sales prices will be in accord with the regulations of the Imperial Japanese Government.

3. Until otherwise directed by this headquarters, a monthly report in English of each item, by name, type and quantity produced by each factory, sub-contractor subsidiary within this factory's control will be delivered to this office by the fifteenth (15) day of the following month.

4. It is understood that this permit for reconversion is issued subject to any and all directives affecting reconversion, ultimate disposition or otherwise, which have been issued or may hereafter be issued by the Supreme Commander for the Allied Powers or by this headquarters.

BY COMMAND OF MAJOR GENERAL WOODRUFF:

Info copy to:  
SCAP (Attn: ESS) (1) (w/incl)  
SCAP (Attn: G-2) (1) (w/incl)  
CG Eighth Army (1) (w/incl)  
(Attn: Mil Govt)  
LCO 94th MG Hq Group (1)  
Kyoto Liaison Office (1)  
Governor of Prefecture concerned (1)  
~~CG 30th MI Company~~  
~~CO 30th MI Co~~

1 Incl:

Annex 1. *Incl 1*



775 013

HEADQUARTERS I CORPS  
APO 301 (Kyoto, Honshu)

EHN/fa

Permit No: IG - 355

ANNEX 1.

Although your plant is listed as a plant restricted for reparations purposes, this permit is being issued, permitted interim operation. Permission to continue operation does NOT in any way constitute removal of your establishment from the list of plants subject to reparations purposes. It must be understood that this permit grants you authority to operate only until such time as your plant equipment may be removed for reparations use.



Hashiwagit was here 20th  
June 46 to received one of the  
Original copies of permit which  
belong to the office file.

JJ.



775 013

HEADQUARTERS I CORPS  
APO 301 (Kyoto, Honshu)

GLS/tr

20 APR 1946

<sup>004</sup>  
AG ~~300.5~~ - BA

SUBJECT: Request for Additional Information Regarding  
Kawasaki Aircraft Company, Kobe Branch

TO: Commanding Officer  
94th Military Government Group  
APO 660

1. Reference is made to your letter from 31st Military Government Company, dated 26 March 1946, subject: "Reports as Required by Operational Instructions No. 1, and 1st indorsement thereto from your headquarters, dated 29 March 1946.

2. Reports submitted by reference 1 above, regarding subject company, indicates that the establishment is currently in operation. Records at this headquarters do not indicate that this establishment is in possession of a reconversion permit.

3. It is desired that the 31st Military Government Company reply, through channels to this headquarters, at the earliest possible date, submitting a report which will cover the following points:

- a. Reasons for this plant being in operation without a reconversion permit.
- b. Definite recommendation for or against continued operation.
- c. If recommendation required by b, above is favorable, it will be accompanied by standard application for reconversion filed by the company as required by Operational Instructions No. 1, this headquarters, paragraph 5 b, (4)

BY COMMAND OF MAJOR GENERAL WOODRUFF:

*H. B. Taylor*  
H. B. TAYLOR  
Major, AGD.  
Asst. Adj. Gen.

CO, 94TH MIL GOVT GP

2

BA/1946

L4096



775 013

BASIC: Ltr, Hq I Corps, AG 004 - BA, dated 20 Apr 46, Subj: "Request for Additional Information Regarding Kawasaki Aircraft Company, Kobe, Branch".

1st Ind

Hq, 94th Hq & Hq Det Mil Govt Gp, APO 660 (Osaka, Japan) 24 Apr 46  
TO: CO, 31st Mil Govt Hq & Hq Co, APO 660 (Kobe)

It is requested that investigation be made immediately and a thorough report made in reference to the information desired in basic communication.

By Order of Lieutenant Colonel ATWOOD:

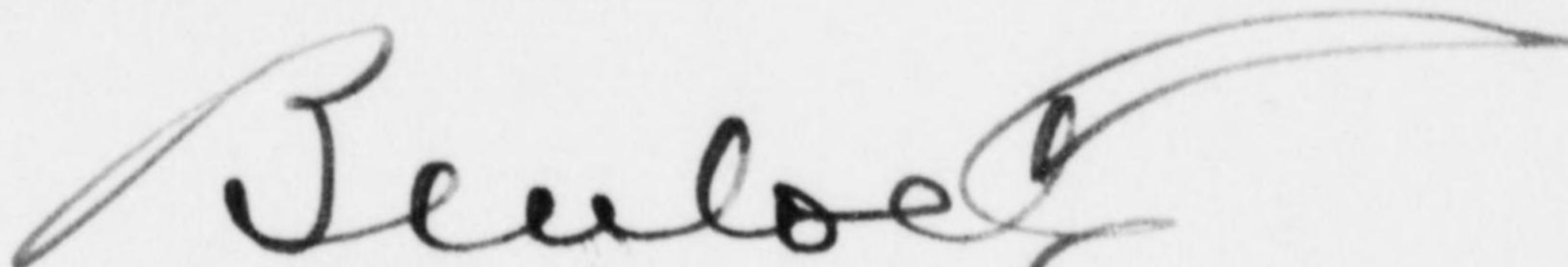

BEN LOCKE  
Maj, AC  
Resources & Ind. Officer

2nd Ind

ABH/di

Hq 31st Mil Gov't Hq & Hq Co, APO 660 (Kobe, Honshu) 2 May 46  
TO: CO, 94th Hq & Hq Det Mil Gov't Group, APO 660 (Osaka)

1. Subject company submitted application for reconversion on 16 Nov 1945 to Sixth Army through Hyogo-ken office and again on 19 Dec 1945 to this headquarters and submitted again on 22 Feb 1946. This application was sent forward after inspection by this headquarters (see basic letter, Hq I Corps, APO 301, File AG 004-BA, subj: "Application of Kobe Forging and Casting Plant of Kawasaki Aircraft Industrial Plant for permission to operate" and subsequent indorsements.) The company was informed by Colonel Ballard of Eighth Army Headquarters, formerly of Sixth Army Headquarters that they could operate pending action on their application for a permit.

2. Recommendation of this headquarters for continued operation of the plant and formal application were forwarded



775 013

BASIC: Ltr, Hq I Corps, AG 004 - BA, dated 20 Apr 46, Subj:  
"Request for Additional Information Regarding Kawa-  
saki Aircraft Company, Kobe Branch".

to your office with 2nd Indorsement of basic letter men-  
tioned above on 6 March 1946.

*Peter W. Scott*  
PETER W. SCOTT  
Lt Col, Infantry  
Commanding



HEADQUARTERS I CORPS  
APO 301 (Kyoto, Honshu)

GLS/br

AG 004 - BA

13 Apr 1946

SUBJECT: Application for Reconversion Permit Submitted by Kobe Casting and Forging Plant, Kawasaki Aircraft Industries Limited.

TO: Commanding General, Eighth Army, APO 343.

1. Reference is made to:

a. Letter from this headquarters to Headquarters Eighth Army, file AG 319.1-BA, subject same as above, dated 12 Jan 46, and indorsements and attachments thereto, appended as inclosure 1.

b. Letter from this headquarters to Headquarters 107th Military Government Company, file AG 004-BA, subject: "Application of Kobe Forging and Casting Plant of Kawasaki Aircraft Industrial Plant for Permission to Operate", dated 22 Feb 46, and indorsements thereto, appended as inclosure 2.

2. Subject plant is listed in inclosure 2 of Operational Directive 5.

3. Plant has not previously obtained a reconversion permit, but this failure was not the fault of the concern. Application for permit was filed by the company in Nov 45 with the Prefectural Government, and because of delay in the government office, the application was never received by any Military Government Unit.

4. Under basis of informal advice from Military Government Officers, the company proceeded with its reconversion plans.

5. In Jan 46, prior to the issuance of Operational Directive 5, the application of this company was forwarded to Eighth Army Headquarters without full information, requesting advice as to whether or not this company would come within the intent of the forthcoming directive. In this connection, your attention is invited to basic communication of inclosure 1 and 1st indorsement thereto, from your headquarters, which denied issuance of permit on the grounds that this plant was listed by Operational Directive 5, which was issued between the time

Incl 1



Ltr, Hq I Corps, AG 004-BA, subj: "Application for Reconversion Permit Submitted by Kobe Casting and Forging Plant, Kawasaki Aircraft Industries Limited", dtd 3 Apr 1946

of writing of basic communication of inclosure 1 and writing of your 1st indorsement.

6. Since that time, additional information has been received and investigation made of this plant. Partial results of investigation are found in 2nd indorsement to basic communication of inclosure 2 from the 31st Military Government Company to the 107th Military Government Company, dated 6 Mar 46.

7. It is recommended that, in view of the circumstances in this case, and the need for the product which the company will manufacture, your headquarters reconsider the matter and authorize the issuance of a reconversion permit with the understanding that the company will still be subject to reparations removals at such time as may be determined by appropriate allied authorities.

FOR THE COMMANDING GENERAL:

PAUL OED  
Colonel, AGD,  
Adjutant General

2 Incls:

1. Ltr, Hq I Corps to Hq Eighth Army, AG 319.1-BA, subj as above, dtd 12 Jan 46, and indorsements & attachments thereto.
2. Ltr, Hq I Corps to Hq 107th MG Co, AG 004-BA, subj: "Appl of Kobe Forging & Casting Plant of Kawasaki Aircraft Ind Plant for Permission to Operate", dtd 22 Feb 46, and indorsements thereto.



775 013

HEADQUARTERS I CORPS  
APO 301 (Kyoto, Honshu)

EHN/clw

20 MAY 1946

AG 004 - RA

SUBJECT: Application for Reconversion.

TO: Commanding Officer, 94th Military Government Group,  
APO 660.

1. Reference is made to letter this headquarters, AG 004-BA, subj: "Application for Reconversion Permit Submitted by Kobe Casting and Forging Plant, Kawasaki Aircraft Industries Co., Ltd.," dated 3 April 1946 and indorsements thereto, copies of which are attached hereto as inclosure 1. A reconversion permit was issued by this headquarters under date of 15 May 1946, two copies and original of which are inclosed hereto. The original permit is to be forwarded to subject company.

2. In accordance with paragraph 2 of 3rd indorsement of above reference, the continued operation of the subject plant will in no way be construed as a guarantee of release from the requirements of directives of the Supreme Commander for the Allied Powers, nor from reparations liability. The subject plant is permitted to continue operations only under restrictions and will be under obligation to preserve equipment and machinery for reparations use.

BY COMMAND OF MAJOR GENERAL WOODRUFF:

- 2 Incls:  
1. Application (trip)  
2. Permit (trip)

H.B. Taylor

H.B. TAYLOR  
MAJOR, AGD.  
ASST. ADJ. GEN.

BA4658



BASIC: Ltr, Hq I Corps, APO 301, file AG 004 - BA, dated 20 May 46  
Subj: "Application for Reconversion".

1st Ind

Hq, 94th Hq & Hq Det Mil Govt Gp, APO 660 (Osaka, Japan) 22 May 46

TO: CO, 31st Mil Govt Hq & Hq Co, APO 660 (Kobe)

Forwarded for distribution and compliance with basic communication.

By order of Lieutenant Colonel ATWOOD:

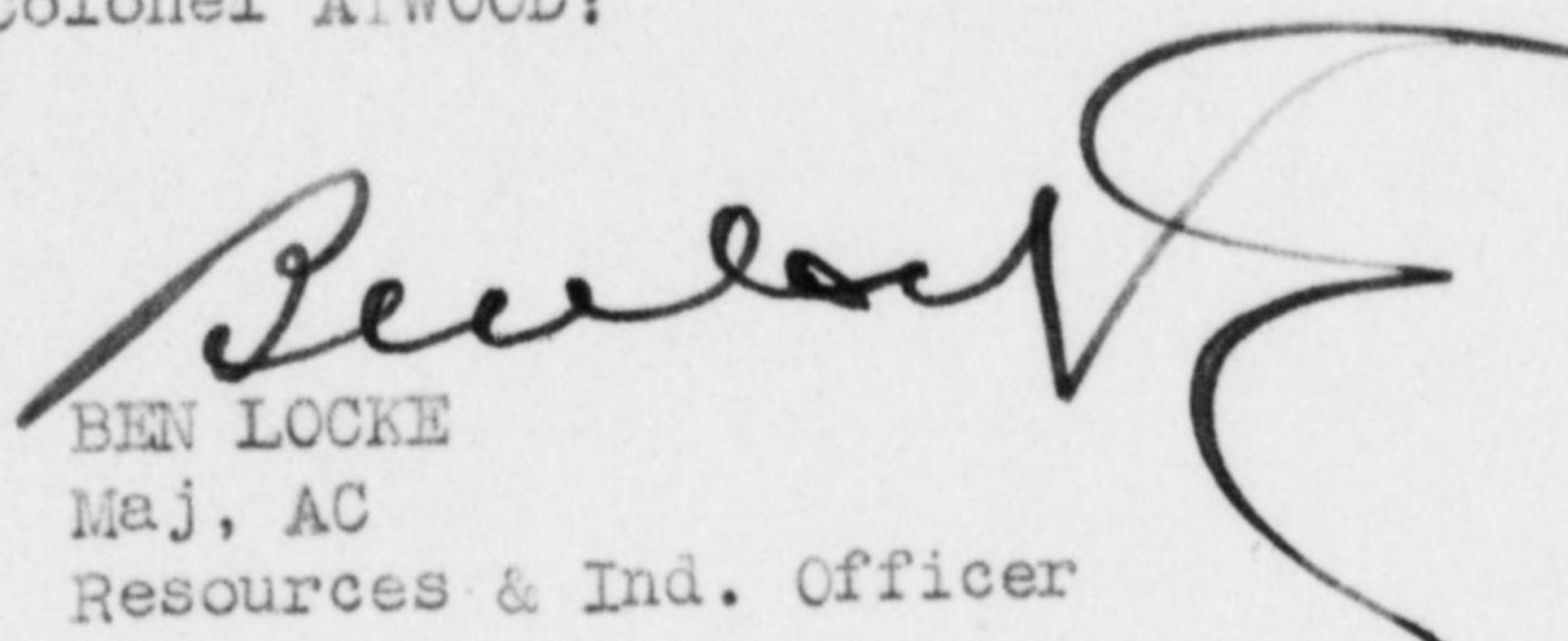
  
BEN LOCKE  
Maj, AC  
Resources & Ind. Officer

Incl:  
Permit IG-355 (dupl)

*Called in Mr. Matsui, Superintendent  
of plant and explained situation  
thoroughly on 29 May 1946.*

*awh/etg*



Ltr Hq I Corps AG 004 - RA, dated 13 April 46, Subj: "Application for Reconversion Permit Submitted by Kobe Casting and Forging Plant, Kawasaki Aircraft Industries Limited."

AG 004.04 (MG)

1st Ind.

19 Apr 1946

Headquarters Eighth Army, APO 343.

TO: Supreme Commander for the Allied Powers, APO 500.

1. Submitted in compliance with instructions contained in sub-paragraph 2i, letter your headquarters, file AG 004 (13 Jan 46)ESS/IN/GD, dated 13 January 1946, subject: "Preservation of Japanese Industrial Facilities."
2. The recommendation contained in paragraph 7 of the basic communication is approved by this headquarters.
3. The continued operation of this plant in the production of castings and forgings for railway equipment, automobiles, bicycles, ships, farm implements, and householdware is considered necessary for restoration of the minimum civilian economy of Japan.

FOR THE COMMANDING GENERAL:

2 Incls  
n/c

JAMES H. NASH  
1st. Lt., CAC  
Actg. Asst. Adjutant General.



775 013

BASIC: Ltr, Hq I Corps, AG 004-BA, dtd 12 Apr 46, Subj: "Application for Reconversion Permit Submitted by Kobe Casting and Forging Plant, Kawasaki Aircraft Industries Limited".

AG 095 (13 Apr 46) ESS/IN

2nd Ind.

GENERAL HEADQUARTERS, SUPREME COMMANDER FOR THE ALLIED POWERS, APO 500,  
4 May 1946

TO: Commanding General, Eighth Army, APO 343.

The recommendation contained in paragraph 7 of the basic communication is approved.

BY Command of General MacARTHUR:

J. W. MANN  
Lt Colonel, AGD  
Asst Adjutant General

2 Incls:  
n/c



775 013

Ltr Hq I Corps, AG 004 - BA, dated 13 Apr 46, Subj: "Application for Reconversion Permit Submitted by Kobe Casting and Forging Plant, Kawasaki Aircraft Industries Limited."

AG 004.04 (MG)

3rd Ind.

10 May 1946

Headquarters Eighth Army, APO 343.

TO: Commanding General, I Corps, APO 301.

1. Attention is invited to the 2nd indorsement.
2. The continued operation of the Kobe Casting and Forging Plant, Kawasaki Aircraft Industries Limited, is approved. However the plant will continue to be subject to custody and control as outlined in Operational Directive Number 5.

BY COMMAND OF LIEUTENANT GENERAL EICHELBERGER:

2 Incls  
n/c

JAMES H. NASH  
1st. Lt., CAC  
Actg. Asst. Adjutant General.



*file*  
 BASIC: Ltr, Hq I Corps, APO 301, file AG 004 - BA, Subject:  
 "Application of Kobe Forging and Casting Plant of Kawasaki  
 Aircraft Industrial Plant for Permission to Operate",  
 dtd 22 Feb 46.

2d Ind AVJ/hdk  
 31st Mil Govt Hq & Hq Co, APO 660 (Kobe, Honshu) 6 March 1946

TO: CO, 107th Mil Govt Hq & Hq Co, APO 660 (Osaka)

1. In compliance with paragraph 5 of basic communication,  
 the following information is submitted:

a. The plant inventory as submitted in Inclosure 3 is  
 quite accurate. No discrepancies were noted when inspection of  
 this plant was made.

b. The proposed product of this plant is deemed essen-  
 tial to the automobile industry of this area. They have a back-  
 log of orders from several automobile manufacturing companies,  
 which is appended as Inclosure 5.

c. The progress made by this company toward reconversion  
 consists only of cleaning up the debris and repairing of machinery  
 damaged by bombing.

d. The machinery in the plant is approximately 50% oper-  
 ative at the present time. Of the remaining 50%, 25% is repair-  
 able and the remainder is beyond repair.

2. Recommend that this plant be allowed to operate and man-  
 ufacture automobile parts, bicycle parts, electrical equipment  
 for locomotives, kettles, and small farming implements, with the  
 understanding that they may be stopped at any time.

4 Incls - n/c  
 1 Incl added  
 As indicated in Par.  
 1b above

PETER W. SCOTT  
 Lt Col, Infantry  
 Commanding



775 013

川崎重工業株式會社

APPLICATION FOR OPERATION OF  
AND  
REPORT ON INDUSTRIAL FACILITIES

To  
THRU:

x) Kobe Casting & Forging Plant, Kawasaki Aircraft Industries Co. Ltd  
No.1, 2-Chōme, Wadayama dori, Hyogo-ku, Kobe

19th Dec, 1945

1. Name of Facility: Kobe Casting and Forging Plant,  
Kawasaki Aircraft Industries, Co. Ltd.

2. Location: No.1, 2-chome, Wadayama dori, Hyogo-ku,  
Kobe.

3. Name of President or Manager:  
Masao Matsui (Superintendent)

4. History:

(a) Date of Construction Oct. 1942 (Motor Car Plant belonging  
to Kawasaki Rolling Stock  
Industries Co. Ltd. was  
converted)

(b) Date of first operation Dec. 1942

(c) 1935 - 1941 Production

Nil

(d) Present Capitalization in Yen

Yen 150,000,000 Paid-up amount (Kawasaki Aircraft  
Industries Co. Ltd.)

(e) Changes made in Capital structure since 1935

Nil

(f) Name and address of parent company

Kawasaki Heavy Industries, Ltd.  
No.38, Akashi-machi, Ikuta-ku, Kobe.

(g) Number of shares outstanding

Yen 150,000,000 (3,000,000 shares)

(h) Number of Stockholders

Kawasaki Heavy Industries, Ltd.

(i) Funds received from Government

Nil

x) Name in Japanese:  
Kobe Kinzoku Kojo of  
Kawasaki Kokuki Kabushiki  
Kaisha.



775 013

川崎重工業株式會社

5. Description

(a) Principal Products

- 1. Wartime Aluminium casting and steel forging for Aero-engine and aircraft frame.
- 2. At Present 1. Steel forging, cast iron, copper alloy and aluminium casting for parts of rolling stock, automobile and ship.  
2. Kitchen-utensils
- 3. Planned for 1946-47 Same as above

(b) Capacity

- 1. Wartime Steel forging Max. 370 tons per month  
Al. casting " 37 " " "
- 2. At present Steel forging 5 " "  
Casting (aluminium cast iron and copper alloy) 10 tons

		1946 (yearly)	1947 (Yearly)
3. 1946-47	Steel forging	830 tons	1,800 tons
	Al. Casting	64 "	220 "
	Cast Iron	370 "	720 "
	Copper Alloy	152 "	200 "
	Kitchen utensils	770,000 yen	84,000 yen

(c) Number of Employees

- 1. Wartime 2,314 persons (at the 15th Aug. 1945)
- 2. At Present 200 "
- 3. 1946-47 1946 ... 500 persons  
1947 ... 600 "

6. Machinery and Equipment in Plant

Description	Quantity	Condition	
		Good	Bad
Lathe	33	19	14
Milling Machine	13	8	5
Drilling Machine	4	3	1
Planing Machine	1	1	-
Shaping Machine	5	5	-
Slotting Machine	2	2	-
Miscellaneous	28	15	13
Total	86		



775 013

**CORRECTION**

THIS DOCUMENT  
HAS BEEN REPHOTOGRAPHED  
TO ASSURE LEGIBILITY



775 013

川崎重工業株式会社

APPLICATION FOR OPERATION OF  
AND  
REPORT ON INDUSTRIAL FACILITIES

To  
THRU:

x) Kobe Casting & Forging Plant, Kawasaki Aircraft Industries Co. Ltd  
No. 1, 2-Chome, Wadayama dori, Hyogo-ku, Kobe

19th Dec, 1945

1. Name of Facility: Kobe Casting and Forging Plant,  
Kawasaki Aircraft Industries, Co. Ltd.

2. Location: No. 1, 2-chome, Wadayama dori, Hyogo-ku,  
Kobe.

3. Name of President or Manager:  
Masao Matsui (Superintendent)

4. History:

(a) Date of Construction Oct. 1942 (Motor Car Plant belonging  
to Kawasaki Rolling Stock  
Industries Co. Ltd. was  
converted)

(b) Date of first operation Dec. 1942

(c) 1935 - 1941 Production

Nil

(d) Present Capitalization in Yen

Yen 150,000,000 Paid-up amount (Kawasaki Aircraft  
Industries Co. Ltd.)

(e) Changes made in Capital structure since 1935

Nil

(f) Name and address of parent company

Kawasaki Heavy Industries, Ltd.  
No. 38, Akashi-machi, Ikuta-ku, Kobe.

(g) Number of shares outstanding

Yen 150,000,000 (3,000,000 shares)

(h) Number of Stockholders

Kawasaki Heavy Industries, Ltd.

(i) Funds received from Government

Nil

x) Name in Japanese:  
Kobe Kinzoku Kojo of  
Kawasaki Kokuki Kabushiki  
Kaisha.



775 013

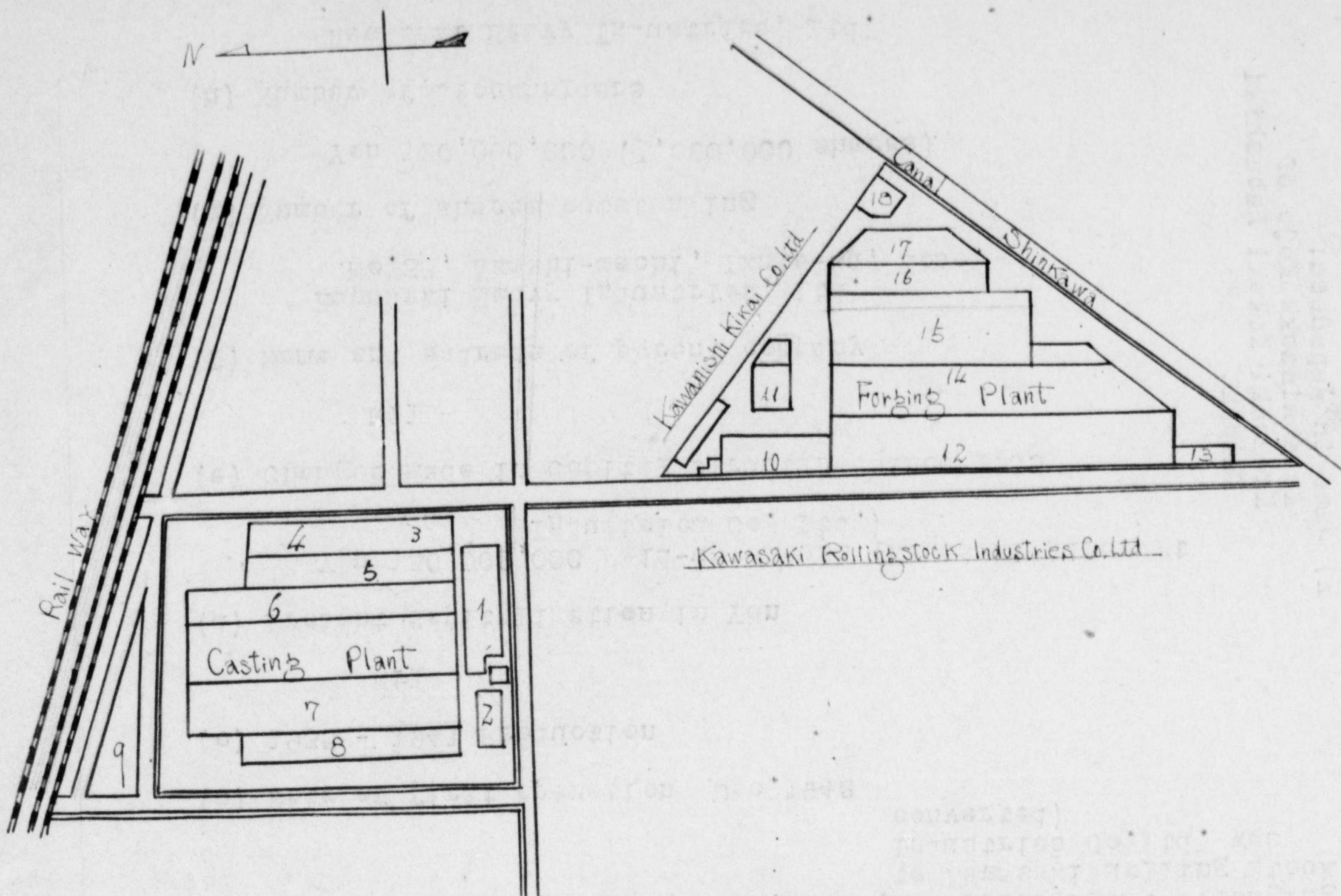

NO	Shop Name	NO	Shop Name
1	General Office	10	Ware House
2	Ware House	11	Boiler Room
3	Transformer Room	12	Forging Shop
4	Heat Treating Shop	13	Gas Producer
5	Finishing Shop	14	Heat Treating Shop
6	Core Setting Shop	15	Inspection Shop
7	Moulding Shop	16	Bar Shear Shop
8	Melting Shop	17	Machine Shop
9	Steel Storage	18	Compressor Room



775 013

川崎重工業株式會社

5. Description

(a) Principal Products

- 1. Wartime Aluminium casting and steel forging for Aero-engine and aircraft frame.
- 2. At Present 1. Steel forging, cast iron, copper alloy and aluminium casting for parts of rolling stock, automobile and ship.  
2. Kitchen-utensils
- 3. Planned for 1946-47 Same as above

(b) Capacity

- 1. Wartime Steel forging Max. 370 tons per month  
Al. casting " 37 " " "
- 2. At present Steel forging 5 "  
Casting (aluminium cast iron and copper alloy) 10 tons

		1946 (yearly)	1947 (Yearly)
3. 1946-47	Steel forging	830 tons	1,800 tons
	Al. Casting	64 "	220 "
	Cast Iron	370 "	720 "
	Copper Alloy	152 "	200 "
	Kitchen utensils	770,000 yen	84,000 yen

(c) Number of Employees

- 1. Wartime 2,314 persons (at the 15th Aug. 1945)
- 2. At Present 200 "
- 3. 1946-47 1946 ... 500 persons  
1947 ... 600 "

6. Machinery and Equipment in Plant

Description	Quantity	Condition	
		Good	Bad
Lathe	33	19	14
Milling Machine	13	8	5
Drilling Machine	4	3	1
Planing Machine	1	1	-
Shaping Machine	5	5	-
Slotting Machine	2	2	-
Miscellaneous	28	15	13
Total	86		



773 013

川崎重工業株式會社

- 3 -

<u>Description</u>	<u>Quantity</u>	<u>Condition</u>	
		<u>Good</u>	<u>Bad</u>
Hammer	26	21	5
Press	15	8	7
Air Compressor	12	9	3
Travelling Crane	4	3	1
Gas Producer	2	2	-
Moulding Machine	26	20	6
Melting Furnace	30	26	4
Heating Furnace	23	20	3
Heat Treating Furnace	15	12	3
Electric Furnace	9	5	4
Wood Machine	18	18	-
Steam Boiler	2	1	1
Miscellaneous	<u>354</u>	234	120
Total	538		

7. Present stocks of Raw Materials, Supplies and Unfinished Goods.

<u>Description</u>	<u>Quantity</u>	<u>Condition</u>
Special steel	1,500 tons	In stock
" "	177 "	Unfinished
Aluminium	50 "	In stock
" "	38 "	Unfinished
Copper	12 "	To be supplied from Futemi
Lead Bronze	50 "	In stock
Tin	15 "	To be supplied from Futemi
Pig Iron	30 "	In stock

8. Present stocks of Finished Goods.

<u>Description</u>	<u>Quantity</u>	<u>Condition</u>
Special steel	40 tons	
Aluminium	9 "	

9. Present stocks of Fuel

Nil



川崎重工業株式会社

- 4 -

## 10. Machinery &amp; Equipment needed for maximum production 1946-47.

<u>Description</u>	<u>Quantity</u>
Lathe	50 (28 at Futami Plant)
Milling Machine	20 (12 " " )
Drilling Machine	3
Planing Machine	1
Shaping Machine	8 (3 at Futami Plant)
Slotting Machine	4 (2 " " )
Miscellaneous	<u>35</u> (20 " " )
Total	<u>121</u>
Hammer	15
Press	15 (3 at Akashi)
Air Compressor	9
Travelling Crane	4
Gas Producer	2
Moulding Machine	15
Melting Furnace	20
Heating Furnace	15
Heat Treating Furnace	10
Electric Furnace	3
Wood Machine	18
Steam Boiler	2
Miscellaneous	<u>160</u> (30 at Futami and Akashi)
Total	<u>288</u>

## 11. Raw Materials and Supplies needed (monthly)

## (a) For Present Capacity

<u>Description</u>	<u>Quantity</u>
Steel	8 tons
Pig Iron	3 "
Aluminium	3 "
Copper	1.5 tons

## (b) For Maximum

<u>Description</u>	<u>Quantity</u>
Steel	250 tons
Pig Iron	40 "
Aluminium	25 "
Copper	15 "



川崎重工業株式會社

- 5 -

## 12. Fuel Needed

Coal	500 tons
Coke	100 "
Town Gas	150,000 cubic meters

## 13. Additional Personnel needed

<u>Special skills</u>	<u>Number</u>
Blacksmith	110 persons
Caster	90 "
Mechanician	100 "

## 14. Prices

<u>Description</u>	<u>Unit</u>	<u>Price</u>
Steel forging	per ten	Yen 7,000
Cast Iron	"	2,000
Copper Alloy	"	10,000
Aluminium Casting	"	12,000

15. Remarks (Include here any factors hampering production not already mentioned and any recommendations you consider necessary).

Nil.

## 16. Certification by applicant

I **certify** that the information contained herein is true to the best of my knowledge and belief.

*Masao. Matsui*  
Superintendent



川崎重工業株式會社

17. Action by Occupation Forces

The factory described in this application has been inspected and the following action:

- a. Ordered to remain closed ~~Yes~~ .... No ....
- b. Ordered to cease operations immediately. ~~Yes~~ .... No ....
- c. Authorized to produce at the following rate:

<u>Item to be manufactured</u>	<u>Monthly quantity</u>
--------------------------------	-------------------------



I N D E X

( 400.170 )

- |    | <u>Date</u> | <u>Subject</u>   |
|----|-------------|--|
| 1. | 18 Feb 46   | Application for Removal of Kobe Casting & Forging Plant, Kawasaki Aircraft Industries, Ltd., from List of Plants to be used for Reparatons |
| 2. | 9 Nov 46    | Application and Recommendation for the Removal of Kawasaki Kokuki Kabushiki Kaisha, Kobe Kojo, from Operational Directivr 5.               |
| 3. | 19 Nov 46   | Application and Recommendation for the Removal of Kawasaki Kokuki Kabushiki Kaisha, Kobe Kojo, from O.D. 5.                                |
| 4. | 18 Dec 46   | Application and Recommendation for the Removal of Kawasaki Kokuki Kabushiki Kaisha, Kobe Kojo, from Operational Directive No. 5.           |
| 5. |             | Overseas Consultants Report  |
| 6. | 26 Feb 48   | Reparations Release  |
| 7. | 31 Aug 49   | Temporary Operation of Reparatons Equipment  |



775 013

HEADQUARTERS  
 HYOGO MILITARY GOVERNMENT  
 APO 317

File No. \_\_\_\_\_ Date \_\_\_\_\_

SUBJECT: Expediting Procurement Receipts

TO :

1. In compliance with Operational Directive 33, Headquarters Eighth Army, dated 26 March 1946, procurement receipts (GMA Form 2) outstanding for more than 60 days, have not been received for the procurement demands listed on the attached inclosure.
2. It is requested that necessary action be taken to obtain receipts for all supplies, services and facilities received on procurement demands listed.
3. Any undue delay in delivery of supplies and facilities after a demand is issued should be reported to this office for appropriate action.
4. Cancellations should be forwarded this office on procurement demands requesting items or services not received and no longer needed.
5. It is further requested that a follow-up be made at regular intervals to insure prompt receipt of these procurement transactions.

RUSSELL G. ASHKOP  
 Lt Col, C.A.C.  
 Commanding

Incl:  
 List of Procurement Demand Numbers

cc:  
 CG, Eighth Army



775 013

FILE

HEADQUARTERS  
HYOGO CIVIL AFFAIRS TEAM  
APO 317

JHS/d1

400.170

31 August 1949

SUBJECT: Temporary Operation of Reparations Equipment

TO : Commanding General  
Eighth Army  
APO 343  
ATTN: Civil Affairs Section  
(thru channels)

## 1. References:

a. Paragraph 4f, Operational Directive 21, 1948, as supplemented by paragraph 4(2) Operational Directive 21/1, 1949.

b. Paragraph 4g, Operational Directive 21, 1948, as amended by paragraph 5, Operational Directive 21/1, 1949.

c. Attached application.

2. Acquisition of machine tools required in the manufacture of engines in attached application would involve a considerable period of time inasmuch as it would necessitate their manufacture. The procurement of such tools would constitute a tremendous expense, in all probability beyond the value of the export order in attached application.

3. In view of the above, it is the recommendation of this team that permission be granted Kawasaki Sharyo K.K., (Kawasaki Rolling Stock Manufacturing Co., Ltd.) to move the thirty-four (34) machines in question which are now owned by the Kawasaki Aircraft K.K., (a sister concern) and located in four (4) separate custody areas into their plant at Kobe for the purpose of manufacturing the gasoline engines as specified in attached application.

FOR THE CHIEF:

2 Incls:

1. Application - Kawasaki Rolling-Stock Mfg Co Ltd. (quad.)
2. Ltr, Gov of Hyogo Prefecture (quad.)

WALTER KIMBALL  
Major, Infantry  
Executive Officer



775 013

Ref. K.R.S.NO. 10 1949

## THE KAWASAKI ROLLING-STOCK MFG.CO.,LTD.

(THE KAWASAKI SHARYO K.K.)

6 1-CHOME, WADAYAMA-DORI, HYOGO-KU.

KOBE, JAPAN.

TEL. NOS. MINATOGAWA (5) 657-659

August 19, 1949.

TO : Col. G. K. Crockett  
 Commanding  
 Hyogo Civil Affairs Team  
 Attention : Manufacturing & Industry  
 Sect.

SUBJECT : Application for Transfer and Temporary  
 Use of Machinery Designated for  
 Reparations.

1. Under present state of affairs, the promotion of export should receive a top-priority for rehabilitation and stabilization of Japanese economy. The Kawasaki Rolling-Stock Mfg. Co., Ltd. has been making every effort to accomplish this end by finding, whenever possible, suitable outlets in foreign market for its products — rolling-stocks and accessories.
2. As shown by Purchase Order G-148 attached herewith (Annex No.1), we have received orders for seven sets of gasoline engines and their accessories from General American Transportation Corp., Purchasing Agents for Taiwan Sugar Corporation. These items are replacements for a portion of twenty four sets which we manufactured and supplied to Taiwan Railway during pre-war years.
3. For manufacture of this type of engine, a high degree of precision is required; however, most of the machine tools now available at our plant are either worn-out or inefficient due to the fact that better machines which we owned and operated were sold and moved to the Kawasaki Aircraft Mfg. Co., Ltd. by order of the Japanese Army in October 1942. These machines were subsequently designated for reparations when the Kawasaki Aircraft Mfg. Co., Ltd. was selected as a reparations plant. The negotiation for temporary use of these machines has been made with the Kawasaki Aircraft Mfg. Co., Ltd. and it is agreed that the latter company will accept proposal provided permission can be granted from Hyogo Civil Affairs Team.
4. In view of the importance of executing foreign orders such as this and particularly of performing high standard work which is required, it is earnestly requested that permission be granted to move and use temporarily the machine tools as located in Hyogo Prefecture and listed in Annex No. 2.

Managing Director

*Kaoru Okamura*  
 (Kaoru Okamura)

Kawasaki Rolling-Stock  
 Mfg. Co., Ltd.  
 Mfg. Co., Ltd.

Incl 1



775 013

Annex No. 1

Form T.C. I 500 Sets 3-49

K.R.S.No. 2

GENERAL AMERICAN TRANSPORTATION COOPERATION  
 Purchasing Agents for  
 TAIWAN SUGAR COOPERATION  
 Nishiginza-Rokuroku Building-Room 404-Tokyo Tel. 563046/47

PURCHASE ORDER G-148  
 SUPPLY FIRM The Kawasaki Rolling-Stock Mfg. Co., Ltd.

Address Tokyo

Please supply the following merchandise subject to the terms and conditions specified below.

QUANTITY	DESCRIPTION OF MATERIAL AND SPECIFICATION	UNIT PRICE	TOTAL PRICE
	Shipping Mark.		
TR-C-I-320	5 Gasoline Engine complete (Kawasaki K-P-170B) (J.G.R. GMF 17)		
	2 Gasoline Engine complete Kawasaki KW-127A (J.G.R. GMF 13)		
	Gasoline Engine parts as per attached statement (TR-C-3-TR-C-320)		

GRAND TOTAL F.O.B. 139,078.13

Place of Delivery F.O.B. Kobe  
 Time of Delivery 6-8 months after order  
 Terms of payment L/C on National City Bank of New York, Tokyo  
 Customs Duty (ESCROW Contract JI-40125)

Remarks  
 This purchase order is placed by General American Transportation Cooperation, not on its own behalf, but as Purchasing Agent for Taiwan Sugar Cooperation. No shipments are to be made against this order except after inspection by General American Transportation Cooperation and written approval thereof to ship. Render all bills in triplicate to Taiwan Sugar Cooperation. Certificates of Inspection must accompany bills.

Accepted By  
 (Supply firm) The Kawasaki Rolling-Stock Mfg. Co., Ltd.

(Signature) Toshio Hata  
 (Title) Director and Manager for Tokyo Office

Date June 30, 1949.

GENERAL AMERICAN TRANSPORTATION COOPERATION  
 BY H.H. Bernstein  
 Approved.  
 TAIWAN SUGAR COOPERATION  
 BY C. Chiao  
 Approved for shipment.  
 GENERAL AMERICAN TRANSPORTATION COOPERATION

Inspected by.

By \_\_\_\_\_  
 Date \_\_\_\_\_ 19\_\_

Please sign & return three copies within three days

ORIGINAL



K.R.S. No. 3

Annex No. 2

## List of machines

(1). Nishinomiya Kojo (11 Tsumon Takamatsu Nishinomiya  
Hyogo Pref.)

Inventory Serial No.	Name of machine	Class	Manufacturer
13-24-98	Boring machine Horizontal	1	Ikegai
13-24-97	Boring machine Drilling & milling	1	Kearns
13-24-27	Engine lathe	1	Hirao 6'
13-24-54	ditto	1	Hirao 5'
13-24-23	ditto	1	Daiko 10'
13-24-75	ditto	1	Toyo Kikai 6'
13-24-87	ditto	1	ditto
13-24-30	ditto	2	Hirao 6'
13-24-88	ditto	2	Toyo Kikai 8'
13-24-82	ditto	2	Wakayama 10'
13-24-16	Milling machine Vertical	1	Cincinnati No. 4
13-24-53	Slotter	2	Bern Hard 200 m/m
13-24-14	Milling machine Horizontal	1	Hidachi

Total 13 sets

(2). Akashi Hatsudoki Kojo (100, Otsubo Kanigasaka Akashi, Hyogo  
Pref.)

Inventory Serial No.	Name of machine	Class	Manufacturer
13-17- 4	Engine lathe, Crankpin lathe	2	Tokyo Gasudenki
13-17-202	Electric dynamometer 200 HP.	2	General Electric

Total 2 sets

(3). Akashi Kitai Kojo (100, Otsubo Kanigasaka Akashi,  
Hyogo Pref.)

Inventory Serial No.	Name of machine	Class	Manufacturer
13-16-203	Shearing machine	2	Ishihara Sangyo

Total 1 set



K.R.S. No. 4

## (4). Futami plant (Futami-cho, Kako-gun Hyogo Pref.)

Inventory Serial No.	Name of machine	Class	Manufacturer
13-18-372	Engine lathe	1	Hirao 8'
13-18-374	Engine lathe	1	Wakayama 8'
13-18-56	ditto	1	Hirao 8'
13-18-446	Turret lathe	2	Foster 50 m/m
13-18-302	Milling machine Vertical	2	Wanderer No. 4
13-18-1	ditto	1	Kerney Trecker EK
13-18-47	ditto	2	Hidachi No. 4
13-18-192	Slotter	2	Hirao 600 m/m
13-18-984	Shaper	2	Hirano 500 m/m
13-18-80	Shaper	2	Nakagawa 600 m/m
13-18-386	Engine lathe	1	Hirao 5'
13-18-665	Surface grinder	2	Heald
Total		12 sets	

## (5). Hokuban plant (Takino-cho, Kato-gun Hyogo Pref.)

Inventory Serial No.	Name of machine	Class	Manufacturer
13-20-405	Turret lathe	1	Herbert
13-20-10	Spline grinder	2	Hokushin Denki
13-20-444	Gear grinder	2	Niigata (Niles)
13-20-838	Internal grinder	1	Heald
13-20-125	Tool grinder	1	Barber-Colman
13-20-619	Gear shaper	1	Fellow
Total		6 sets	



775 013

K.R.S.No. 5

Consent  
on the temporary use of machine equipments

August , 1949

As for the temporary use of machine equipments stated on the application submitted as the attached sheets from Kawasaki Rolling-stock Mfg. Co., Ltd., our company will make no objection provided permission can be granted from General Headquarters.

*Masashi Isano*  
(Masashi Isano)

Chief Director

Kawasaki Sangyo K.K.

(Former, Kawasaki Kokuki  
Kogyo K. K. )



K.R.S. No. 6

## The list of these machine equipments

Code No.	Name of machine	Number of unit	Location
13-24-98	Boring machine Horizontal	1	Nishinomiya Kojo
13-24-97	Boring machine Drilling & milling	1	ditto
13-24-87	Engine lathe	1	ditto
13-24-54	ditto	1	ditto
13-24-23	ditto	1	ditto
13-24-75	ditto	1	ditto
13-24-87	ditto	1	ditto
13-24-30	ditto	1	ditto
13-24-88	ditto	1	ditto
13-24-82	ditto	1	ditto
13-24-16	Milling machine Vertical	1	ditto
13-24-53	Slotter	1	ditto
13-24-14	Milling machine Horizontal	1	ditto
13-17-4	Engine laths, Crankpin	1	Akashi Hatusdoki Kojo
13-17-202	Electric dynamometer 200 HP.	1	ditto
13-16-203	Shearing machine	1	Akashi Kitai Kojo
13-18-372	Engine lathe	1	Futami plant
13-18-374	ditto	1	ditto
13-18-56	ditto	1	ditto
13-18-446	Turret lathe	1	ditto
13-18-302	Milling machine Vertical	1	ditto
13-18-1	ditto	1	ditto
13-18-47	ditto	1	ditto
13-18-192	Slotter	1	ditto
13-18-984	Shaper	1	ditto
13-18-80	ditto	1	ditto
13-18-386	Engine lathe	1	ditto
13-18-665	Surface grinder	1	ditto
13-20-405	Turret lathe	1	Hokuban plant
13-20-10	Spline grinder	1	ditto
13-20-444	Gear grinder	1	ditto
13-20-838	Internal grinder	1	ditto
13-20-125	Tool grinder	1	ditto
13-20-619	Gear shaper	1	ditto

Total

34



775 013  
Ref. KRS NO. 10 1949

## THE KAWASAKI ROLLING-STOCK MFG.CO.,LTD.

( THE KAWASAKI SHARYO K.K. )

6 1-CHOME, WADAYAMA-DORI, HYOGO-KU.

KOBE, JAPAN.

TEL. NOS. MINATOGAWA (5) 657-659

August 19, 1949.

TO : Col. G. K. Crockett  
Commanding  
Hyogo Civil Affairs Team  
Attention : Manufacturing & Industry  
Sect.

SUBJECT : Application for Transfer and Temporary  
Use of Machinery Designated for  
Reparations.

1. Under present state of affairs, the promotion of export should receive a top-priority for rehabilitation and stabilization of Japanese economy. The Kawasaki Rolling-Stock Mfg. Co., Ltd. has been making every effort to accomplish this end by finding, whenever possible, suitable outlets in foreign market for its products -- rolling-stocks and accessories.
2. As shown by Purchase Order G-148 attached herewith (Annex No.1), we have received orders for seven sets of gasoline engines and their accessories from General American Transportation Corp., Purchasing Agents for Taiwan Sugar Corporation. These items are replacements for a portion of twenty four sets which we manufactured and supplied to Taiwan Railway during pre-war years.
3. For manufacture of this type of engine, a high degree of precision is required; however, most of the machine tools now available at our plant are either worn-out or inefficient due to the fact that better machines which we owned and operated were sold and moved to the Kawasaki Aircraft Mfg. Co., Ltd. by order of the Japanese Army in October 1942. These machines were subsequently designated for reparations when the Kawasaki Aircraft Mfg. Co., Ltd. was selected as a reparations plant. The negotiation for temporary use of these machines has been made with the Kawasaki Aircraft Mfg. Co., Ltd. and it is agreed that the latter company will accept proposal provided permission can be granted from Hyogo Civil Affairs Team.
4. In view of the importance of executing foreign orders such as this and particularly of performing high standard work which is required, it is earnestly requested that permission be granted to move and use temporarily the machine tools as located in Hyogo Prefecture and listed in Annex No. 2.

Managing Director

*Keoru Okamura*  
( Keoru Okamura )

Kawasaki Rolling-Stock  
Mfg. Co., Ltd.  
Mfg. Co., Ltd.



775 013

Annex No. 1

Form T.C. I 500 Sets 3-49

K.R.S.No. 2

GENERAL AMERICAN TRANSPORTATION COOPERATION  
 Purchasing Agents for  
 TAIWAN SUGAR COOPERATION  
 Nishiginza-Rokureku Building-Room 404-Tokyo Tel. 563646/47

PURCHASE ORDER G-148  
 SUPPLY FIRM The Kawasaki Rolling-Stock Mfg. Co., Ltd.

Address Tokyo

Please supply the following merchandise subject to the terms and conditions specified below.

QUANTITY	DESCRIPTION OF MATERIAL AND SPECIFICATION	UNIT PRICE	TOTAL PRICE
----------	---	------------	-------------

Shipping Mark.

TR-C-I-320 5 Gasoline Engine complete  
 (Kawasaki K-P-170B)  
 (J.G.R. GMF 17)

2 Gasoline Engine complete  
 Kawasaki KW-127A  
 (J.G.R. GMF 13)

Gasoline Engine parts as per attached  
 statement  
 (TR-C-3-TR-C-320)

GRAND TOTAL F.O.B. 139,078.13

Place of Delivery F.O.B. Kobe  
 Time of Delivery 6-8 months after order  
 Terms of payment L/C on National City Bank of New York, Tokyo  
 Customs Duty (ESCROW Contract JI-40125)

Remarks

This purchase order is placed by General American Transportation Cooperation, not on its own behalf, but as Purchasing Agent for Taiwan Sugar Cooperation. No shipments are to be made against this order except after inspection by General American Transportation Cooperation and written approval thereof to ship. Render all bills in triplicate to Taiwan Sugar Cooperation. Certificates of Inspection must accompany bills.

Accepted By  
 (Supply firm) The Kawasaki Rolling-Stock Mfg. Co., Ltd.

(Signature) Toshio Hata  
 (Title) Director and Manager  
 for Tokyo Office

Date June 30, 1949.

GENERAL AMERICAN TRANSPORTATION  
 COOPERATION  
 BY H.H. Bernstein  
 Approved.

TAIWAN SUGAR COOPERATION  
 BY C. Chiao  
 Approved for shipment.

GENERAL AMERICAN TRANSPORTATION  
 COOPERATION

Inspected by.

Please sign & return three copies within three days

ORIGINAL

By \_\_\_\_\_  
 Date \_\_\_\_\_ 19\_\_



775 013

Annex No. 2

K.R.S. No. 3

## List of machines

(1). Nishinomiya Kojo (11 Tsumon Takematsu Nishinomiya  
Hyogo Pref.)

Inventory Serial No.	Name of machine	Class	Manufacturer
13-24-98	Boring machine Horizontal	1	Ikegai
13-24-97	Boring machine		
	Drilling & milling		
13-24-27	Engine lathe	1	Kearns
13-24-54	ditto	1	Hirao 6'
13-24-23	ditto	1	Hirao 5'
13-24-75	ditto	1	Daiko 10'
13-24-87	ditto	1	Toyo Kikai 6'
13-24-30	ditto	1	ditto
13-24-88	ditto	2	Hirao 6'
13-24-82	ditto	2	Toyo Kikai 8'
13-24-16	Milling machine Vertical	2	Wakayama 10'
13-24-53	Slotter	1	Cincinnati No. 4
13-24-14	Milling machine Horizontal	2	Bern Hard 200 m/m
		1	Hidechi
Total	13 sets		

(2). Akashi Hatsudeki Kojo (100, Otsubo Kanigasaka Akashi, Hyogo  
Pref.)

Inventory Serial No.	Name of machine	Class	Manufacturer
13-17- 4	Engine lathe, Crankpin lathe	2	Tokyo Gasudenki
13-17-202	Electric dynamometer 200 HP.	2	General Electric
Total	2 sets		

(3). Akashi Kitai Kojo (100, Otsubo Kanigasaka Akashi,  
Hyogo Pref.)

Inventory Serial No.	Name of machine	Class	Manufacturer
13-16-203	Shearing machine	2	Ishihara Sangyo
Total	1 set		



K.R.S. No. 4

## (4). Futami plant (Futami-cho, Kake-gun Hyogo Pref.)

Inventory Serial No.	Name of machine	Class	Manufacturer
13-18-372	Engine lathe	1	Hirao 8'
13-18-374	Engine lathe	1	Wakayama 8'
13-18-56	ditto	1	Hirao 8'
13-18-446	Turret lathe	2	Foster 50 m/m
13-18-302	Milling machine Vertical	2	Wanderer No. 4
13-18-1	ditto	1	Kerney Trecker EK
13-18-47	ditto	2	Hidachi No. 4
13-18-192	Slotter	2	Hirao 600 m/m
13-18-984	Shaper	2	Hirano 500 m/m
13-18-80	Shaper	2	Nakagawa, 600 m/m
13-18-386	Engine lathe	1	Hirao 5'
13-18-665	Surface grinder	2	Heald
Total	12 sets		

## (5). Hokuban plant (Takino-cho, Kato-gun Hyogo Pref.)

Inventory Serial No.	Name of machine	Class	Manufacturer
13-20-405	Turret lathe	1	Herbert
13-20-10	Spline grinder	2	Hokushin Denki
13-20-444	Gear grinder	2	Niigata (Niles)
13-20-838	Internal grinder	1	Heald
13-20-125	Tool grinder	1	Farber-Colman
13-20-619	Gear shaper	1	Fellow
Total	6 sets		



775 013

K.R.S.No. 5

Consent  
on the temporary use of machine equipments

August , 1949

As for the temporary use of machine equipments stated on the application submitted as the attached sheets from Kawasaki Rolling-stock Mfg. Co., Ltd., our company will make no objection provided permission can be granted from General Headquarters.

*Masashi Isano*

(Masashi Isano)

Chief Director

Kawasaki Sangyo K.K.

(Former, Kawasaki Kokuki  
Kogyo K. K. )



K.R.S. No. 6

## The list of these machine equipments

Code No.	Name of machine	Number of unit	Location
13-24-98	Boring machine Horizontal	1	Nishinomiya Kojo
13-24-97	Boring machine Drilling & milling	1	ditto
13-24-87	Engine lathe	1	ditto
13-24-54	ditto	1	ditto
13-24-25	ditto	1	ditto
13-24-75	ditto	1	ditto
13-24-87	ditto	1	ditto
13-24-30	ditto	1	ditto
13-24-88	ditto	1	ditto
13-24-82	ditto	1	ditto
13-24-16	Milling machine Vertical	1	ditto
13-24-53	Slotter	1	ditto
13-24-14	Milling machine Horizontal	1	ditto
13-17-4	Engine lathe, Crankpin	1	Akashi Hatsudoki Kojo
13-17-202	Electric dynamometer 200 HP.	1	ditto
13-16-203	Shearing machine	1	Akashi Kitai Kojo
13-18-372	Engine lathe	1	Futami plant
13-18-374	ditto	1	ditto
13-18-56	ditto	1	ditto
13-18-446	Turret lathe	1	ditto
13-18-302	Milling machine Vertical	1	ditto
13-18-1	ditto	1	ditto
13-18-47	ditto	1	ditto
13-18-192	Slotter	1	ditto
13-18-984	Shaper	1	ditto
13-18-80	ditto	1	ditto
13-18-386	Engine lathe	1	ditto
13-18-665	Surface grinder	1	ditto
13-20-405	Turret lathe	1	Hokuban plant
13-20-10	Spline grinder	1	ditto
13-20-444	Gear grinder	1	ditto
13-20-838	Internal grinder	1	ditto
13-20-125	Tool grinder	1	ditto
13-20-619	Gear shaper	1	ditto
Total		34	



775 013

Ref. K 10. 10 1949

## THE KAWASAKI ROLLING-STOCK MFG.CO.,LTD.

(THE KAWASAKI SHARYO K.K.)

6 1-CHOME, WADAYAMA-DORI, HYOGO-KU.

KOBE, JAPAN.

TEL. NOS. MINATOGAWA (5) 657-659

August 19, 1949.

TO : Col. G. K. Crockett  
Commanding  
Hyogo Civil Affairs Team  
Attention : Manufacturing & Industry  
Sect.

SUBJECT : Application for Transfer and Temporary  
Use of Machinery Designated for  
Reparations.

1. Under present state of affairs, the promotion of export should receive a top-priority for rehabilitation and stabilization of Japanese economy. The Kawasaki Rolling-Stock Mfg. Co., Ltd. has been making every effort to accomplish this end by finding, whenever possible, suitable outlets in foreign market for its products — rolling-stocks and accessories.
2. As shown by Purchase Order G-148 attached herewith (Annex No.1), we have received orders for seven sets of gasoline engines and their accessories from General American Transportation Corp., Purchasing Agents for Taiwan Sugar Corporation. These items are replacements for a portion of twenty four sets which we manufactured and supplied to Taiwan Railway during pre-war years.
3. For manufacture of this type of engine, a high degree of precision is required; however, most of the machine tools now available at our plant are either worn-out or inefficient due to the fact that better machines which we owned and operated were sold and moved to the Kawasaki Aircraft Mfg. Co., Ltd. by order of the Japanese Army in October 1942. These machines were subsequently designated for reparations when the Kawasaki Aircraft Mfg. Co., Ltd. was selected as a reparations plant. The negotiation for temporary use of these machines has been made with the Kawasaki Aircraft Mfg. Co., Ltd. and it is agreed that the latter company will accept proposal provided permission can be granted from Hyogo Civil Affairs Team.
4. In view of the importance of executing foreign orders such as this and particularly of performing high standard work which is required, it is earnestly requested that permission be granted to move and use temporarily the machine tools as located in Hyogo Prefecture and listed in Annex No. 2.

Managing Director

*Kaoru Okamura*  
( Kaoru Okamura )

Kawasaki Rolling-Stock Mfg. Co., Ltd.



775 013

Annex No. 1

K.R.S. No. 2

Form T.C. I 500 Sets 3-49

GENERAL AMERICAN TRANSPORTATION COOPERATION  
 Purchasing Agents for  
 TAIWAN SUGAR COOPERATION  
 Nishiginza-Rokuroku Building-Room 404-Tokyo Tel. 563046/47

PURCHASE ORDER G-148  
 SUPPLY FIRM The Kawasaki Rolling-Stock Mfg. Co., Ltd.

Address Tokyo

Please supply the following merchandise subject to the terms and conditions specified below.

QUANTITY	DESCRIPTION OF MATERIAL AND SPECIFICATION	UNIT PRICE	TOTAL PRICE
	Shipping Mark.		
TR-C-1-320	5 Gasoline Engine complete (Kawasaki K-P-170B) (J. G. R. GMF 17)		
	2 Gasoline Engine complete Kawasaki KW-127A (J. G. R. GMF 13)		
	Gasoline Engine parts as per attached statement (TR-C-3-TR-C-320)		

GRAND TOTAL F.O.B. 139,078.13

Place of Delivery F.O.B. Kobe  
 Time of Delivery 6-8 months after order  
 Terms of payment L/C on National City Bank of New York, Tokyo  
 Customs Duty (ESCROW Contract JI-40125)

Remarks  
 This purchase order is placed by General American Transportation Cooperation, not on its own behalf, but as Purchasing Agent for Taiwan Sugar Cooperation. No shipments are to be made against this order except after inspection by General American Transportation Cooperation and written approval thereof to ship. Render all bills in triplicate to Taiwan Sugar Cooperation. Certificates of Inspection must accompany bills.

Accepted By  
 (Supply firm) The Kawasaki Rolling-Stock Mfg. Co., Ltd.

(Signature) Toshio Hata  
 (Title) Director and Manager  
 for Tokyo Office

Date June 30, 1949.

GENERAL AMERICAN TRANSPORTATION COOPERATION  
 By H.H. Bernstein  
 Approved.

TAIWAN SUGAR COOPERATION  
 By C. Chiao  
 Approved for shipment.

GENERAL AMERICAN TRANSPORTATION COOPERATION

Inspected by.

By \_\_\_\_\_  
 Date \_\_\_\_\_ 19\_\_

Please sign & return three copies within three days

ORIGINAL



K.R.S. No. 3

Annex No. 2

## List of machines

(1). Nishinomiya Kojo (11 Tsumon Takamatsu Nishinomiya  
Hyogo Pref.)

Inventory Serial No.	Name of machine	Class	Manufacturer
13-24-98	Boring machine Horizontal	1	Ikegai
13-24-97	Boring machine	1	Kearns
13-24-27	Drilling & milling Engine lathe	1	Hirao 6'
13-24-54	ditto	1	Hirao 5'
13-24-23	ditto	1	Daiko 10'
13-24-75	ditto	1	Toyo Kikai 6'
13-24-87	ditto	1	ditto
13-24-30	ditto	2	Hirao 6'
13-24-88	ditto	2	Toyo Kikai 8'
13-24-82	ditto	2	Wakayama 10'
13-24-16	Milling machine Vertical	1	Cincinnati No. 4
13-24-53	Slotter	2	Bern Hard 200 m/m
13-24-14	Milling machine Horizontal	1	Hidachi

Total 13 sets

(2). Akashi Hatsudoki Kojo (100, Otsubo Kanigasaka Akashi,  
Hyogo Pref.)

Inventory Serial No.	Name of machine	Class	Manufacturer
13-17- 4	Engine lathe, Crankpin lathe	2	Tokyo Gasudenki
13-17-202	Electric dynamometer 200 HP.	2	General Electric

Total 2 sets

(3). Akashi Kitai Kojo (100, Otsubo Kanigasaka Akashi,  
Hyogo Pref.)

Inventory Serial No.	Name of machine	Class	Manufacturer
13-16-203	Shearing machine	2	Ishihara Sangyo

Total 1 set



K.R.S. No. 4

## (4). Futami plant (Futami-cho, Kako-gun Hyogo Pref.)

Inventory Serial No.	Name of machine	Class	Manufacturer
13-18-372	Engine lathe	1	Hirao 8'
13-18-374	Engine lathe	1	Wakayama 8'
13-18-56	ditto	1	Hirao 8'
13-18-446	Turret lathe	2	Foster 50 m/m
13-18-302	Milling machine Vertical	2	Wanderer No. 4
13-18-1	ditto	1	Kerney Trecker 2K
13-18-47	ditto	2	Hidachi No. 4
13-18-192	Slotter	2	Hirao 600 m/m
13-18-984	Shaper	2	Hirano 500 m/m
13-18-80	Shaper	2	Nakagawa 600 m/m
13-18-386	Engine lathe	1	Hirao 5'
13-18-665	Surface grinder	2	Heald
Total		12 sets	

## (5). Hokuban plant (Takino-cho, Kato-gun Hyogo Pref.)

Inventory Serial No.	Name of machine	Class	Manufacturer
13-20-405	Turret lathe	1	Herbert
13-20-10	Spline grinder	2	Hokushin Denki
13-20-444	Gear grinder	2	Niigata (Niles)
13-20-838	Internal grinder	1	Heald
13-20-125	Tool grinder	1	Barber-Colmar
13-20-619	Gear shaper	1	Fellow
Total		6 sets	



K.R.S. No. 5

Consent  
on the temporary use of machine equipments

August 21, 1949.

As for the temporary use of machine equipments stated on the application submitted as the attached sheets from Kawasaki Rolling-Stock Mfg. Co., Ltd., our company will make no objection provided permission can be granted from General Headquarters.

Masashi Isano  
( Masashi Isano )

Chief Director

Kawasaki Sangyo K.K.

( Former, Kawasaki Kokuki  
Kogyo K. K. )



K.R.S. No. 6

## The list of these machine equipments

Code No.	Name of machine	Number of unit	Location
13-24-98	Boring machine Horizontal	1	Nishinomiya Kojo
13-24-97	Boring machine Drilling & milling	1	ditto
13-24-27	Engine lathe	1	ditto
13-24-54	ditto	1	ditto
13-24-23	ditto	1	ditto
13-24-75	ditto	1	ditto
13-24-87	ditto	1	ditto
13-24-30	ditto	1	ditto
13-24-88	ditto	1	ditto
13-24-82	ditto	1	ditto
13-24-16	Milling machine Vertical	1	ditto
13-24-53	Slotter	1	ditto
13-24-14	Milling machine Horizontal	1	ditto
13-17-4	Engine lathe, Crankpin	1	Akashi Hatsudoki Kojo
13-17-202	Electric dynamometer 200 HP.	1	ditto
13-16-203	Shearing machine	1	Akashi Kitai Kojo
13-18-372	Engine lathe	1	Futami plant
13-18-374	ditto	1	ditto
13-18-56	ditto	1	ditto
13-18-446	Turret lathe	1	ditto
13-18-302	Milling machine Vertical	1	ditto
13-18-1	ditto	1	ditto
13-18-47	ditto	1	ditto
13-18-192	Slotter	1	ditto
13-18-984	Shaper	1	ditto
13-18-80	ditto	1	ditto
13-18-386	Engine lathe	1	ditto
13-18-665	Surface grinder	1	ditto
13-20-405	Turret lathe	1	Hokuban plant
13-20-10	Spline grinder	1	ditto
13-20-444	Gear grinder	1	ditto
13-20-838	Internal grinder	1	ditto
13-20-125	Tool grinder	1	ditto
13-20-619	Gear shaper	1	ditto
Total		34	



## HYOGO PREFECTURAL GOVERNMENT

August 30, 1949

To : Col. Gilman K. Crockett,  
Chief, Hyogo Civil Affairs Team

Subject : Recommendation for Transfer and Temporary  
Operation of Reparations Equipments

Thru : Kobe Liaison & Co-ordination Office

Sir,

In connection with the application filed by the Kawasaki Sharyo K.K. ( Kawasaki Rolling-Stock Mfg. Co., Ltd. ) as per the papers attached hereto, we submit to you our recommendation as follows:

The Kawasaki Rolling Stock Mfg. Co. Ltd., applicant in question, as one of the leading companies, together with the Japan Rolling Stock Mfg. Co. Ltd., has been engaged in the manufacture of rolling stock ever since the pre-war days, and its manufactures has well been received in this country by both government and private railways, and also giving entire satisfaction to such consumers abroad as Formosa, Korea and the South Sea Island.

The said company has recently received an order for 7 units of gasoline engines destined for Formosa from General American Transportation Corporation, which is acting as agent for the Formosa Sugar Mfg. Co., Ltd. However, we wish to state here that the Company was forced in 1942 to transfer a large portion of its superior equipments to the Kawasaki Air Craft Mfg. Co., Ltd., through compulsory purchase by the Japanese Army, thence the Company has been experiencing serious difficulties to make a rational management of their business, because of poor efficiency of the remaining equipments. In addition to this, they are now quite perplexed to meet the immediate need of manufacturing the aforesaid engines which requires superior machine tools of high precision.

In the light of the current straitened situation in Japan, the promotion of foreign trade is of the utmost urgent necessity, if economic independence is to be set up. In this respect, we believe that the machine industry, such as the manufacture of rolling stock, is one of the most powerful and promising factors in attaining the foregoing objective, and to that end, every effort must be put forth by any means so as to achieve the full development of the industry.

However, the present situation is this, the choice tool machines, which had been employed in machine industry in pre-war days, were compulsorily transferred to munitions industry for pursuance of the Army's policy of those days, with the result to-day that those machines of poor efficiency left available are barely maintaining the production activities

Ince 2



- 2 -

in our country. This is not in the least a congruous with the rational management of business which is the need of the day, inasmuch as such a trend is liable to cause waste of materials and labor against the interest of the industry.

For straightening out and improving the aforesaid situation, it is most desirable that the allocation of production equipment which was carried out in an abnormal manner during the war will be restored to normal for the benefit of all factories concerned.

The machines under present application number 34 in total. All of them were formerly owned by the Kawasaki Rolling Stock Mfg. Co., Ltd., and are now under the custody of the Nishinomiya (13-24), Akashi Engine (13-16), Akashi Body (13-17), Hokuban (13-20), and Futami (13-18) plant, of the Kawasaki Aircraft Mfg. Co., Ltd., which is a designated company as reparations.

To purchase and install the machines of same type and capacity as those at present located in the above-mentioned plants is next to impossible for the applicant company, in view of their stringent financial conditions caused by the general economic situation prevailing at the present time. It may further be added that, even if their financial capacity grants the purchase of new machines mentioned above, it will take at least more than a year to get actually those machines in the hands of the company, thus making impossible for them to meet the aforesaid order in point of the term.

If the company is obliged to carry on the manufacture of rolling stock with the worn-out machines of poor efficiency left with them, instead of utilizing the above-mentioned machines, we are afraid that a serious tardiness will be caused in keeping up with the other nations in international economic competition. On the contrary, if, through your courtesy, permission is granted for the transfer and temporary operation of the said machines, it will greatly serve to vitalize their industry which is in a depressed condition, and we believe that it will go a long way toward the rehabilitation of production not only in this prefecture but also throughout the whole country of Japan.

In view of the fact that all of the items under the present application are designated as reparations, we are quite sure, if permission is granted, to exercise the closest surveillance over the custody and maintenance of these machines which will be carried out by the Kawasaki Rolling Stock Mfg. Co., Ltd. with full responsibility.

We should appreciate it highly, therefore, if you would kindly give your favorable consideration to the foregoing matter and approve of the application as filed by the Kawasaki Rolling Stock Mfg. Co., Ltd.

FOR THE GOVERNOR :

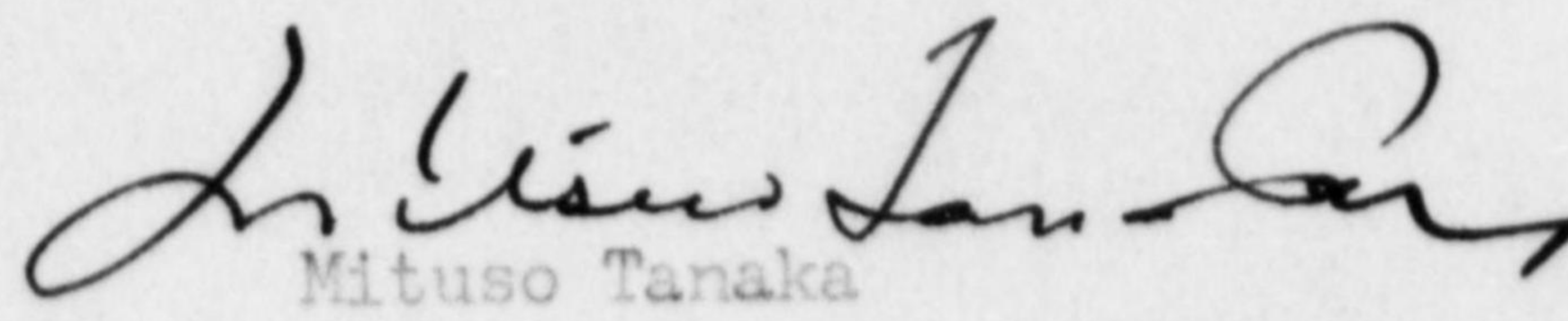
  
Mituso Tanaka  
Chief,  
Hyogo Liaison Office.



775 013

FILE

HYOGO MILITARY GOVERNMENT TEAM  
APO 317

400.170

NAT/ryf/to

26 February 1948

SUBJECT: Reparations Release  
TO : Kawasaki Kokuki K. K., Kobe Plant  
THRU : Hyogo Liaison Office

By authority of letter, Headquarters Eighth Army, AG 004.04 (MG-EM), subject: "Plant Not Meeting Criteria for Reparations Removal," dated 11 February 1948, this is to hereby inform you that your plant has been released from reparations custody and control.

FOR THE COMMANDING OFFICER:

LOUIS C. HUTTON  
Major, Cavalry  
Executive Officer

400.170 - # 22

6



775 013

1712

HEADQUARTERS EIGHTH ARMY  
UNITED STATES ARMY  
OFFICE OF THE COMMANDING GENERAL  
APO 343

A.G.004.04(MG-EM)

11 February 1948

SUBJECT: Plant Not Meeting Criteria for Reparations Removal

TO: Commanding General, I Corps, APO 301  
ATTN: Military Government Section

MB<sup>B</sup>

The Kawasaki Kokuki KK (Kobe Plant) (13-22), Hyogo Prefecture, does not meet the criteria for selection of plants for reparations removals. It is desired, therefore, that the local Japanese government agency in Hyogo Prefecture and the owner of the plant be simultaneously notified of its release from custody and control.

BY COMMAND OF LIEUTENANT GENERAL EICHELBERGER:

R. SCHAFER  
Lt Col, AGD  
Asst Adj General

AG 004 - BA

1st Ind

ABH/mss

Hq I Corps, APO 301,

TO: CO, Hyogo Mil Govt Team, APO 317

FEB 20 1948

Wal

BA 6056



775 013

Plant was originally established in 1931 as a forging plant. In 1942, machinery suitable for aircraft production was transferred to the Akashi Plant of same company, and the Kobe Plant concentrated production in the forging of aircraft parts. The same machinery was used in the production of civilian products were utilized, and no major conversion was necessary to place it on a program of foreign exchange.

**KAWASAKI AIRCRAFT IND., KOBE PLANT**  
**Hyogo Ken**

13 - 22  
 1931

Plant is currently in full operation manufacturing products mentioned in paragraph 4(e).  
 Removal of this plant will cause labor displacement and will jeopardize regional economy.

987  
 Not applicable  
 Yes  
 Not applicable

Forgings for autos, ships, 100%  
 locomotives, etc.  
 Forgings & Castings for airc. parts 100%  
 Aluminum radiators 50%; Forgings 100%  
 for autos, ships engine parts, etc. Castings for elec. motors  
 & cast iron parts 50%  
 1942  
 Yes

M. A. THOMPSON, JR.  
 Economic Section

908	1,800 (est.)
442	2,700
442	607
49%	



775 013

Plant was originally established in 1931 as a forging plant. In 1942, machinery suitable for aircraft production was transferred to the Akashi Plant of same company, and the Kobe Plant concentrated production to the forging of aircraft parts. The same equipment used for the forging of civilian products were utilized, and no major conversion was necessary to embark on a program of forging aircraft parts.

Plant is currently in full operation manufacturing products mentioned in paragraph 4(c).

Removal of this plant will cause labor displacement of major proportions and will jeopardize regional economy.

Yes

Not applicable

Forging for autos, ships, locomotives, etc.  
Forging & casting for auto parts

Aluminum radiators for foraging  
for autos, ships engine parts, etc. Castings for elec. motor & cast iron parts

Yes

N. A. THOMPSON, CAP 9  
Economic Section

1,800 (est.)

600,5

700 22

508

545

66

796



775 013

90

FILE  
*[Handwritten signature]*

HYOGO MILITARY GOVERNMENT TEAM  
APO 317

ABH/d1

18 December 1946

P-15

SUBJECT: Application and Recommendation for the Removal  
of Kawasaki Kokuki Kabushiki Kaisha, Kobe Kojo,  
from Operational Directive No. 5.

TO : Commanding Officer  
Kinki Military Government Region  
APO 301

1. Reference is made to letter, this headquar-  
ters, same subject, dated 9 November 1946.
2. Additional information on the same subject  
received from the Central Liaison Office, Tokyo, is  
submitted herewith for consideration.

PETER W. SCOTT  
Lt Col      Inf  
Commanding

1 Incl:  
As indicated above  
(5 copies)

4



#90  
IMPERIAL JAPANESE GOVERNMENT  
CENTRAL LIAISON OFFICE

TO : HEADQUARTERS, HYOGO MILITARY GOVERNMENT TEAM.  
FROM : Central Liaison Office, Tokyo.  
SUBJECT: Request for Removal of Kobe Kinzoku Plant of  
Kawasaki Sangyo K.K. from Reparations List.

C.L.O. No. 704(RSG-E)

16 December 1946

## 1. Reference:

a. SCAP Memorandum AG 004(11 Oct 46)ESS/IN (SCAPIN#1263),  
subject: "Revised List No. 2 Aircraft Factories, Military  
and Naval Arsenals and Reserch Laboratories."

b. C.L.O. Memorandum No. 589(RSG-E), addressed to the Head-  
quarters, Hyogo Military Government Team, dated 8 November  
1946, subject as above.

2. An application for removal of the Kobe Kinjoku Plant of the  
Kawasaki Sangyo K.K. from the Reparations List was submitted by  
reference b. Memorandum. However, as the explanation offered  
therein has been found insufficient, supplementary information  
is submitted herewith as per the attached papers.

3. The subject plant was engaged in the manufacture of automobile  
and its parts since the beginning of its operation in 1931.  
During the war after the end of 1942, it was compelled to convert  
to the manufacture of forged and cast parts of aircraft by order  
of military authorities. However, no major changes were made on  
its machinery and equipment, which were of aircraft. The plant  
thus remained to be a raw material plant. After the surrender,  
it has been totally reconverted to its proper line of industry.

4. Under these circumstance, it is requested that favorable  
consideration be given by your Headquarters for the removal of  
this plant from the Reparations List.

FOR THE PRESIDENT:

(K. Asakai)  
Director of General Affairs,  
Central Liaison Office.

Enclosure: An explanatory note on the subject  
plant, accompanied by a letter of  
the Ministry of Commerce and In-  
dustry.



775 013

TO : HEADQUARTERS, HYOGO MILITARY GOVERNMENT TEAM.  
FROM : Central Liaison Office, Tokyo.  
SUBJECT : Request for Removal of Kobe Kinzoku Plant of  
Kawasaki Sangyo K.K. from Reparations List.

C.L.O. No. 704(RSG-E)

16 December 1946

## 1. Reference:

a. SCAP Memorandum AG 004(11 Oct 46)ESS/IE (SCAPIN-1263), subject: "Revised List No. 2 Aircraft Factories, Military and Naval Arsenals and Research Laboratories."

b. C.L.O. Memorandum No. 589(RSG-E), addressed to the Headquarters, Hyogo Military Government Team, dated 8 November 1946, subject as above.

2. An application for removal of the Kobe Kinzoku Plant of the Kawasaki Sangyo K.K. from the Reparations List was submitted by reference b. Memorandum. However, as the explanation offered therein has been found insufficient, supplementary information is submitted herewith as per the attached papers.

3. The subject plant was engaged in the manufacture of automobile and its parts since the beginning of its operation in 1931. During the war, after the end of 1942, it was compelled to convert to the manufacture of forged and cast parts of aircraft by order of military authorities. However, no major changes were made on its machinery and equipment, which were operated for the production of only the forged and cast parts of aircraft. The plant has thus remained to be a raw material plant. After the surrender, it has been totally reconverted to its proper line of industry.

4. Under these circumstances, it is requested that favorable consideration be given by your Headquarters for the removal of this plant from the Reparations List.

FOR THE PRESIDENT:

(K. Asakai)  
Director of General Affairs,  
Central Liaison Office.

Enclosure: An explanatory note on the subject plant, accompanied by a letter of the Ministry of Commerce and Industry.



775 013

To : Headquarters Hyogo Military Government Team.  
 2. Full explanation of the machines, machinery and equipments of this plant is given in separate sheets.  
 From : Reparation Enforcement Bureau,  
 Ministry of Commerce and Industry.  
 This plant has been long operated, since its foundation in 1931 manufacturing of automobile and parts thereof at the place prescribed.  
 Subject : Re submitting the Additional Statement regarding Application for Exemption from Designation of Reparation Control to Kawasaki Kokuki Kogyo K. K., Kobe Kinzoku Kojo (Kobe Forging and Casting Plant, Kawasaki Aircraft Industrial Co., Ltd. - Present Name Kawasaki Industrial Co., Ltd.) as Aircraft Plant.

1. This is an Additional Statement giving a detailed explanation of the machines, machinery and equipment now installation of the Kawasaki Kokuki Kogyo K. K., Kobe Kinzoku Kojo (Kobe Forging and Casting Plant, Kawasaki Aircraft Industrial Co., Ltd. - Present Name, Kawasaki Industrial Co., Ltd.) which plant was designated and placed under the control, under the date of January 20, 1946, as the Aircraft Plant. Application for exemption from the above treatment has been already submitted to and duly filed.

*K. Tamaki*  
 Director of Reparation Enforcement  
 Bureau, Ministry of Commerce and  
 Industry.



2. Full explanation of the machines, machinery and equipments of this plant is given in separate sheets.

From these sheets, the followings are to be noted. This plant has been long operated, since its foundation in 1931, manufacturing of automobile and parts thereof, at the place prescribed.

In 1942, the operation was converted into manufacturing of the aircraft plants, with almost no modification in its machines, machinery and equipments.

The operation was solely in the range of forging and casting process of aircraft parts. No machine work nor finishing work was operated in this plant.

As the termination of the war, they are desirous of reconverting their operation to their original aim, e. i., the manufacturing of essential civil commodities such as automobiles, parts thereof and electric heaters, and sincerely crane for the permission from the list of aircraft, so that their machines, machinery and equipments may remain.

*K. Panak*  
Director of Reparation Enforcement  
Bureau, Ministry of Commerce and  
Industry.



## A. Name of Company and Plant.

## 1. Name of Company.

Kawasaki Kokuki Kogyo K.K.,

(Kawasaki Aircraft Industrial Co., Ltd. Present Name ...

Kawasaki Industrial Co., Ltd.)

## 2. Name of Plant.

Kobe Kinzoku Kojo.

(Kobe Forging and Casting Plant.)

## B. Location of Company and Plant.

## 1. Company.

100, Otsubo Kanigasaka, Akashi-City.

(Office moved to 1609 Chaemba-cho, Akashi City.)

## 2. Plant.

1, 2-chome, Wadayama-dori, Hyogo-ku, Kobe City.

## C. Year and month of Foundation and commencement of operation of plant.

## 1. Foundation of Company.

November, 1937.

## 2. First operation of plant.

March, 1931



D. Outline of Machines and Equipments.

I. Particulars of Machines and Equipments from 1931  
(First operation of plant) to 1937.

a) Machine Tools

Name of Machine	1931	1932	1933	1934	1935	1936	1937	Total
Lathe	8		1	3		3	1	16
Drilling Machine	3			1				4
Vertical Milling Machine	1			1				2
Shaper	1							1
Grinder	1							1
Circular Saw						2		2
Steel-Bar Cutting Machine						4		4
Band Saw	2							2
Horizontal Milling Machine						1		1
Total	16	0	1	5	0	10	1	33

b) Industrial Machine

Name of Machine	1931	1932	1933	1934	1935	1936	1937	Total
Hammer	3							3
Press	8							8
Air Compressor	3			1				4



775 013

Name of Machine	1931	1932	1933	1934	1935	1936	1937	Total
Double Head Grinder	14							14
Moulding Machine	6							6
Sand Mixer	6							6
Sand Mill	3							3
Portable Grinder	1				1			2
Wire-cutting Machine	1							1
Conveyed	1							1
Saw Sharpening Machine	1							1
Cupola	1							1
Upsetter	1							1
Total	49	0	0	1	1	0	0	51

c) Electric Machine

Name of Machine	1931	1932	1933	1934	1935	1936	1937	Total
Motor	2						2	4
Transformer	1			6				7
Electric Furnace	3							3
Oil Switch Case	3							3
Blower	15							15
Total	24	0	0	6	0	0	2	32



775 013

d) Wood Working Machine

Name of Machine	1931	1932	1933	1934	1935	1936	1937	Total
Lathe	3							3
Planer	1							1
Hand Planer	3							3
Band Saw	3							3
Circular Saw	3							3
Machine Saw	3							3
Drilling Machine	1							1
Saw Sharpening Machine	1							1
Planer	1							1
Total	19	0	0	0	0	0	0	19

e) Accurate Messuring Machine

Name of Machine	1931	1932	1933	1934	1935	1936	1937	Total
Brinel Hardness Testing Machine	3							3
Rockwell Hardness Mach.	1							1
Total	4	0	0	0	0	0	0	4

f) Transporting Machine

Name of Machine	1931	1932	1933	1934	1935	1936	1937	Total
Travelling Crane	2							2
Hoist	6							6
Total	8	0	0	0	0	0	0	8



775 013

Grand total : 147

Name of Machine	1938	1939	1940	1941	1942	1943	1944	1945	Total
Steel-Bar Cutting Mach.									2
Bar Shear									1
Circular Saw Grinder									1
Die Sinker				1					1
Band Saw									3
Back Saw									2
Slotter									2
Horizontal Milling Mach.	2		1			1			3
Cutter									3
<b>Total</b>	16	12	20	14	5	5	20	10	67

Numbers of machines existed in installation at the time of the war terminated : 359

Ratio against the machines now in installation :  $\frac{147}{359} = 41\%$

Remarks: The above machines in present installation are all operated, and have been run for manufacturing automobile and parts thereof.)

a) Machine - Tools.

Name of Machine	1938	1939	1940	1941	1942	1943	1944	1945	Total
Lathe Machine	4	3	5	3					15
Hammer Drilling Machine	1	1	4	2					8
Press		6							6
Vertical Milling Machine	4	3	2	1	3	14			11
Air Compressor									7
Double Head Grinder		1	4	3					1
Planer									20
Mouling Machine						20			20
Shaper	1	3	2						4
Boiler									2
Gas Producer									1
Grinder	1								1
Rotary Heat Treating Furnace									1
Circular Saw							1		1



775 013

Name of Machine	1938	1939	1940	1941	1942	1943	1944	1945	Total
Steel-Bar Cutting Mach.				2			1		2
Bar Shear			1					1	1
Circular Saw Grinder						2	5		3
Die Sinker				2	1	3			1
Band Saw	2					1	2		3
Hack Saw Collecting Apparatus			6	3				1	9
Slotter Circular Saw Sharpening M.			1		1				2
Horizontal Milling Mach.	2	1			1	1			3
Cutter Grinder			1	2			1		3
Total	16	12	20	14	24	0	6	5	320
									60
									0
									67

b) Industrial Machine

Name of Machine	1938	1939	1940	1941	1942	1943	1944	1945	Total
Hammer			9	13	1	3	2	15	226
Press Transformer		8	6						68
Air Compressor			1	6		3	4	6	812
Double Head Grinder				1	4	1	3		72
Mouling Machine				1	1	20			203
Boiler				2					2
Gas Producer		8	2	11	3	2	4	2	51
								21	0
									2
Rotary Heat Treating Furnace			1						1



775 013

Name of Machine	1938	1939	1940	1941	1942	1943	1944	1945	Total
Portable Grinder						1			1
Gas Mixer							1		1
Stoker						5			5
Sand Blast			2	3					5
Stoker						2			2
Dust Collecting Apparatus							1		1
Circular Saw Sharpening M.				1					1
Dry Furnace				1	1				2
Sand Dry Machine						1			1
Total	0	0	19	24	6	32	6	0	87

e) Electric Machine

Name of Machine	1938	1939	1940	1941	1942	1943	1944	1945	Total
Motor		2	3	1	3	2	15		26
Transformer	8								8
Electric Furnace			6				6		12
Blower			1	1					2
Electric Welding Machine			1	1	1				3
Total	8	2	11	3	4	2	21	0	51



775 013

d) Wood working machine

Name of machine	1938	1939	1940	1941	1942	1943	1944	1945	Total
Lathe				1					1
Band Saw						1			1
Total	0	0	0	1	0	1	0	0	2

e) Accurate Measuring Machine

Name of Machine	1938	1939	1940	1941	1942	1943	1944	1945	Total
Brinell Hardness Testing Machine						1			1
Xray Arrangement						1			1
Rockwell Hardness Testing Machine				1					1
Total	0	0	0	1	0	2	0	0	3

f) Transporting Machine

Name of Machine	1938	1939	1940	1941	1942	1943	1944	1945	Total
Crane				1	1				2
Total	0	0	0	1	1	0	0	0	2

Grand Total : 212

Numbers of machines existed in installation at the time of the War terminated: 359

Ratio against the machines now in installation:  $\frac{212}{359} = 59\%$



Remarks: This plant was converted, in 1942, during the war, into aircraft parts manufacturing plant by the order of the Army Authority. The operation was, however, within the range of forging and casting process of aircraft parts, no machine work nor finishing process was operated in this plant.

The Total Number of Machines at the time of conversion to aircraft part manufacturing was 290; the ratio against the number at the time of the war terminated being  $\frac{290}{359} = 80\%$



775 013

**E. Production after the war**

a) **Cooperative Survey of Monthly Production of this Monthly Production after Permit of Conversion into Civilian Industry granted.** (Permit was granted under the date of 15 May 1946).

Articles	Production Capacity of		Production Capacity of		Percentage	
	whole country	May	June	July	Aug.	Sept.
<b>Forging</b>						
Main Bolt		5079	2763			
Rear Axle shaft	1,000	1027	1108	150	1802	11043
Rear Yokes			2692	3023	5650	3692
Front Yoke		1313	1665	2979	4191	5005
Spidermarks:	Main article	2536	1014	5294	6219	3787
Drive Gear	Connecting Rod, Universal joint,	732	2921	3155	1797	
Side Gear	Kind of Gears, and	2773			4059	2466
Speed Gear	being completely finished in machine process.				661	
Other Gears						2580
Pitman Arms						2483
Drive Gear only						1397
Bicycle Parts		3448	834	6201	5985	
Others		554	1204			
<b>Castings</b>						
Total		27Ton	47Ton	37Ton	68Ton	65Ton
<b>Aluminium Castings</b>						
Articles Radiator		Square feet		Square feet		
(for Occupation)		May	June	July	Aug.	Sept.
Electric Reverb- eratory Stove		12200	273	719	520	594
Electric Rester		1855	195			233
Water Pump for motor car)		4	127	924	82	30
Others for Domestic Use	(Tons)	2.5	2	2.5	4	3.5

Remarks: Total Production Capacity of whole country  
Total (Tons) is difficult to estimate, 10.5 approximately 9.8  
figures are therefore given in the above

b) **Production Program for the Future**

	1946			1947			(Tons)
	Oct.	Nov.	Dec.	Jan.	Feb.	Mar.	
Forgings	102	128	150	150	150	150	
Aluminium Casting	15	15	15	15	15	15	"
Iron Casting	1	3	7	10	15	20	"
Copper Alloy							500 Pieces

- Note: 1) Forgings are mostly parts of Automobiles, ships and rolling stock engine.  
2) Aluminium Casting are mostly heating radiator and electric articles.  
3) Iron Castings are mostly parts of ships and rolling stock engines and rolling stock parts.



c) Comparative Survey of Monthly Production of this Plant against that of the whole country in main productions of this plant.

<u>Articles</u>	<u>Production Capacity of whole country</u>	<u>Production Capacity of this plant</u>	<u>Percentage</u>
Forgings			
Automobile Parts	1,000 Tons	150 Tons	15 %

Remarks: Main articles, wherein, are Rear Axle shaft, Connecting Rod, Universal Joint, and Various Kind of Gears, and some part of them are being completely finished in machine process.

<u>Articles</u>	<u>Production Capacity of whole country</u>	<u>Production Capacity of this Plant</u>	<u>Percentage</u>
Castings			
Aluminium Castings			
Heating Radiator (for Occupation Forces)	Square feet 20,000	Square feet 15,000	75 %
2 KW Reveratory Stove (for Occupation Forces)	1,000	650	65 %

Remarks: Total Production Capacity of whole country is difficult to estimate, only approximate figures are therefore given in the above table.



F. Reason for necessity of retention:

a) As stated above, this Plant has been operating, since 1921, the manufacturing of automobile and parts thereof. The Plant was compelled by the order of the military authority, to convert into the aircraft manufacturing industry. From the above, you will please note this Plant was not originally organized with the view of manufacturing aircraft parts.

Mention may be made that the Plant was reconverted, soon after the termination of the War, to its original operation of automobile manufacturing industry, which is the base of the rehabilitation of the Japanese Industry.

b) In 1942, when this Plant was converted into the aircraft manufacturing industry, most of the machines, machinery and equipments then existed installation were moved to the Kawasaki Kokuki Kogyo K.K. (Kawasaki Aircraft Industrial Co., Ltd.) Akashi Aircraft Engine Plant and Akashi Aircraft Body Plant. As for this Plant, no important alteration was made at all in its operation. Operation was continued as ever with the remaining machines and equipments in the range of forging and casting process. No finished goods were manufactured in machine process in this Plant.

c) On the termination of the War, the Plant was reconverted into its original operation of manufacturing automobiles and parts thereof. The Plant is now doing its operation of automobile manufacturing industry, with its long established experience and particular technique, supplying its products



to the Nissan Automobile K.K. and Toyota Automobile K.K. and other dealers of automobile parts. It is easily understood that no small amount of influence will be affected in this line, should the operation of this Plant be suspended by one reason or other.

d) This Plant enjoys at present a peculiar good position in Japan in line of Aluminum forging. There is no other Plant but this Plant which can supply a quantity of Aluminum alloy heating radiator and electric heater for Allied Forces, through the process of mass production.

Under these circumstances, it is sincerely hoped to retain the minimum machines, machinery and equipments necessary for realizing the essential civil commodity production, which is indispensable for rehabilitation of Japanese industry.



775 013

To : Headquarters Hyogo Military Government Team  
From : Adjusting Division,  
Ministry of Commerce and Industry  
Subject : Application for Exemption from Designation of  
Reparation Control to Kawasaki Kokuki Kogyo K.K.,  
Kobe Kinzoku Kojo (Kobe Forging and Casting Plant,  
Kawasaki Aircraft Industrial Co., Ltd. ---- Present  
Name Kawasaki Industrial Co., Ltd.) as aircraft plant.

1. In regard to this plant as designated for control as aircraft plant in the directive dated 20 January 1946, we have taken and are also taking actions to assure its satisfactory control and custody, in close connection with organs concerned civil and official.
2. However, this plant is desired to be exempted from the designation for control as well as to be the object of reparation in future after your review on the detailed explanation (annexed paper) due to the fact that this company, having the long history as a manufacturer of civilian goods, was not established for the purpose of aircrafts production though participated in aircrafts production occasionally during war, and all its facilities were intended to be restored to civilian production, its original mission, since the termination of war.

Director of Adjustment Division,  
Ministry of Commerce and Industry.



775 013

## A. Name of Company

Kawasaki Kokuki Kogyo K.K.  
 (Kawasaki Aircraft Industrial Co., Ltd. Present Name ...  
 Kawasaki Industrial Co., Ltd.)

## B. Name of Plant

Kobe Kinzoku Kojo  
 (Kobe Forging and Casting Plant)

## C. Location of Company and Plant

## a) Company:

100 Otsube Kanigasaka, Akashi-City  
 (Office moved to: 1609 Chaemba-cho, Akashi-City)

## b) Plant:

1 2-chome Wadayama-deri Hyogo-ku, Kobe-City

## D. Year and month of Foundation and Commencement of Company and Plant.

## a) Foundation of Company:

November, 1937

## b) Commencement of Plant:

March, 1931

## E. History of plant

1931 In Kawasaki Rolling Stock Co., Ltd. the plant was established as Automobile Department and was planned for mass production of automobiles.

1932 The plant's total production: 13 automobile trucks and 37 motor bus bodies.

1933-1939 The production during this period were automobile trucks, motor buses, civilian motor cars and 100 HP gasoline engines.

1940 The Automobile Department was promoted to an independent factory, taking the same rank as the Rolling Stock Factory of the Company. The plant moved to the present site with replenished machinery and equipment and commenced mass production of automobile trucks.



775 013

1941 Production of automobile trucks amounted to 1323.

1942 In October, the plant was converted into forging and casting factory for manufacturing aircrafts by order of the Military authority. At the same time it was taken over by Kawasaki Aircraft Industrial Company Ltd. so far as capital is concerned. The greater part of machines were taken over to Kawasaki Aircraft Industrial Co., Ltd. Akashi Plant.

1943 & Afterwards, Manufactured crude aircraft parts forged and or casted.

1945 The plant was bombed three times, in March, June and July and suffered big damages to buildings and equipment. Damages to, buildings 59% and to machinery and equipment 48%.

1946 In May, the plant received a permit from Allied Forces to resume production of civilian commodities.

F. Particulars of Products in 1934 - 1936 (In Kawasaki Rolling Stock Co.)

Articles	1934	1935	1936
Trucks		52	66
Buses	20	21	23
" (bodies only)	99	82	
Civilian cars		2	
100 HP gasoline engines	101	45	38
Special Pulling Cars		4	

G. Particulars of Products in 1937 - 1945

Articles	In Kawasaki Rolling Stock Co.						In Kawasaki Aircraft Ind. Co.			
	1937	1938	1939	1940	1941	1942	1943	1944	1945	
Trucks	175	346	340	1045	1325	1430				
Buses	6									
Civilian Cars	10	3								
100 HP gasoline engines	28	25	10							
100 HP Diesel	1			1						
60 HP "		1	1							
Aircraft Parts (forging) (Tons)							15	2006	3528	
" (casting) (Tons)								158	205	
									108	



775 013

Notes: Forging aircraft parts mainly consist of Con. Rod, Valve lock arm etc.  
 Casting aircraft parts mainly consist of Crank Case, Cylinder Block etc.

H. Production after the war.

a) Monthly Production after Permit of Conversion into Civilian Industry granted. (Permit has been granted under the date of 15 May 1946)

Forgings

Articles	May	June	July	Aug.	Sept.
Main Bolt	5079	2763			
Rear Axle Shaft	1027	1108	802	1110	1043
Rear Yoke		2592	3023	5650	3692
Front Yoke	1313	1665	2979	4191	5005
Spider	2536	1014	5294	6219	3787
Drive Gear		732	2921	3155	1797
Side Gear		2773		4059	2466
Speed Gear				661	
Other Gears					2580
Pitman Arm					2483
Drive Gear Only					1397
Bicycle Parts	3448	834	6201	5985	5450
Others	554	1204			
Total (Tons)	27	47	37	68	65

Casting

Articles	May	June	July	Aug.	Sept.
Electric Reverberatory Stove	122	273	719	520	594
Electric Mower	1856	195			833
Water Pump for Motor Car	4	127	924	82	30
Radiator					24
Others for Domestic Use (Tons)	2.8	2	2.3	4	3.5
Total (Tons)	7.8	6.8	10.5	9.5	9.8



## b) Production Programme in Future.

	1946 Sept.	Oct.	Nov.	Dec.	1947 Jan.	Feb.	Mar.	
Forgings	90	102	128	150	150	150	150	Tons
Aluminium Castings	15	15	15	15	15	15	15	"
Iron Castings		1	3	7	10	15	20	"
Copper Alloy							500	Pieces

## Notes:

- a) Forgings are mostly parts of automobiles, ships and rolling stock engines.
- b) Aluminium Castings are mostly heating radiators and electric articles.
- c) Iron castings are mostly parts of ships and rolling stock engines and rolling stock parts.



775 013

1. Outline of Equipment

(A) Particulars of machinery and equipment possessed by each shop.

a) Forging shop

Manufacturing: Forgings of automobile, rolling stock, bicycle etc.

Land area used for Buildings: 14,018 square meters

Total Floor Space: 16,681 " "  
(Damages by air raid 75%)

Construction: 4 one-storied and 1 two-storied buildings of steel-skelton, roofed with zinc plate.

Machinery and other equipment: The particulars:

1) Metal Cutting Machine

Machine	Number
Lathe	21
Drilling Machine	6
Vertical Milling Machine	12
Horizontal Milling Machine	4
Planer	1
Shaper	4
Slotter	2
Grinder	2
Circular Saw	3
Die Sinker	1



Machine	Number
Hack Saw	9
Metal Cutting Machine	6
Bar Shear	1
Cutting Grinder	3
Circular Saw Grinder	2
Total	79

## 2) Industrial Machine

Machine	Number
Hammer	25
Press	14
Air Compressor	6
Double Head Grinder	14
Boiler	2
Gas Producer	2
Rotary Heat Treating Furnace	1
Portable Grinder	1
Stoker	5
Sand Blast	5
Stoker	2
Saw Sharpening Machine	1
Upsetter	1
Total	79



775 013

3) Electric Machine

Machine	Number
Motor	8
Transformer	4
Electric Furnace	13
Blower	12
Electric Welding Machine	2
Total	39

4) Wood Machine

Machine	Number
Circular Sawing Machine	1
Total	1

5) Accurate Measuring Apparatus

Machine	Number
Brinell Hardness Testing M.	3
Total	3

6) Transporting Machine

Machine	Number
Travelling Crane	2
Hoist	3
Total	5

The Total Number of Forging Shop : 206



775 013

b) Casting Shop

Manufacturing : automobile and ships engine parts,  
electric articles, heating radiators etc.

Land area used for Buildings: 12,035 square meters

Total Floor Space: 16,711 " "  
(Damage by air raid 33%)

Construction: 5 one-storied and 1 two storied buildings  
of steel-skelton, roofed with zinc plates.

Machinery and other equipment : The Particulars :

1) Metal Cutting Machine

Machine	Number
Lathe	10
Drilling Machine	4
Vertical Milling Machine	1
Shaper	1
Band Saw	5
Total	21

2) Industrial Machine

Machine	Number
Air Compressor	5
Double Head Grinder	7
Moulding Machine	26
Sand Mixer	5



775 013

Machine	Number
Sand Mill	3
Portable Grinder	2
Wire Cutting Machine	1
Gas Mixer	1
Dust Collecting Plant	1
Conveyer	1
Saw Sharpening Machine	1
Dry Furnace	2
Sand Dry Machine	1
Cupola	1
Total	59

3) Electric Machine

Machine	Number
Motor	22
Transformer	11
Electric Furnace	2
Oil Switch Case	3
Blower	5
Electric Welding Machine	1
Total	44



775 013

4) Wood Working Machine

Machine	Number
Lathe	4
Planer	1
Hand Planer	3
Band Saw	4
Circular Saw	2
Machine Saw	3
Drilling Machine	1
Saw Sharpening Machine	1
Planer	1
Total	20

5) Accurate Measuring Apparatus

Machine	Number
Brinell Hardness Testing M.	1
X Ray	1
Rockwell Hardness Testing M.	2
Total	4

6) Transporting Machines

Machine	Number
Travelling Crane	2
Hoist	3
Total	5

Casting Shop Total 153



775 013

B. Particulars of machinery and equipment which are necessary or unnecessary for the production of civilian commodities. (percentage shows the ratio against total)

1) Metal Cutting Machine

Machine	Necessary	Unnecessary	Total
Lathe	22	9	31
Drilling Machine	9	3	12
Vertical Milling Machine	7	6	13
Planer	1	0	1
Shaper	5	0	5
Slotter	1	1	2
Grinder	0	2	2
Circular Saw	2	1	3
Metal Cutting Machine	6	0	6
Bar Shear	1	0	1
Cutting Grinder	5	0	5
Circular Saw Grinder	1	1	2
Die Sinker	0	1	1
Band Saw	1	4	5
Back Saw	2	7	9
Horizontal Milling Machine	3	1	4
<b>Total</b>	<b>64 (64%)</b>	<b>36 (36%)</b>	<b>100</b>



775 013

2) Industrial Machine

Machine	Necessary	Unnecessary	Total
Hammer	15	10	25
Press	12	2	14
Air Compressor	5	7	12
Double Head Grinder	19	2	21
Moulding Machine	2	24	26
Boiler	1	1	2
Gas Producer	2	0	2
Rotary Heat Treating F.	0	1	1
Sand Mixer	2	4	6
Sand Mill	1	2	3
Portable Grinder	3	0	3
Wire Cutting Machine	0	1	1
Gas Mixer	0	1	1
Stoker	0	5	5
Sand Blast	0	5	5
Stoker	2	0	2
Dust Collecting Plant	0	1	1
Conveyer	0	1	1
Circular Saw Sharpening M.	0	1	1
Saw Sharpening Machine	0	1	1
Gas Drying Furnace	0	2	2
Sand Drying Machine	0	1	1
Cupola	1	0	1
Upsetter	1	0	1
Total	66 (46%)	72 (52%)	138



3) Electric Machine

Machine	Necessary	Unnecessary	Total
Motor	11	19	30
Transformer	13	2	15
Electric Furnace	5	10	15
Oil Switch Case	0	3	3
Blower	9	8	17
Electric Welding Machine	3	0	3
Total	41 (49%)	42 (51%)	83

4) Wood Machine

Machine	Necessary	Unnecessary	Total
Lathe	4	0	4
Planer	1	0	1
Hand Planer	2	1	3
Band Sawing Machine	4	0	4
Circular Sawing Machine	1	2	3
Machine Saw	3	0	3
Drilling Machine	1	0	1
Saw Sharpening Machine	1	0	1
Planer	0	1	1
Total	17 (81%)	4 (19%)	21



775 013

5) Accurate Measuring Apparatus

Machine	Necessary	Unnecessary	Total
Brinell Hardness Testing M.	4	0	4
X Ray Arrangement	0	1	1
Rockwell Hardness Testing M.	0	2	2
Total	4 (57%)	3 (43%)	7

6) Transporting Machine

Machine	Necessary	Unnecessary	Total
Travelling Crane	4	0	4
Hoist	2	4	6
Total	6 (60%)	4 (40%)	10

The Total Number      198 (55%)      161 (45%)      359



775 013

J. Comparative Survey of Monthly Production of this plant against that of the whole contry in main products of this plant.

Articles	Production Capacity of whole country	Production Capacity of this plant	Percentage
<u>Forgings</u>			
Automobile Parts	1,000 tons	150 tons	15%
Remarks: Main articles, wherein, are Rear Axle Shaft, Connecting Rod, Universal Joint, and Various kind of gears, and some part of them are being completely finished by machinery. <i>machining.</i>			
<u>Castings</u>			
Aluminium Castings			
Heating Radiator (for Occupation Forces)	square foot 20,000	square foot 15,000	75%
2 KW Reverberatory Stove (for Occupation Forces)	1,000	650	65%
Remarks: Total production capacity of whole country is difficult to estimate, therefore only approximate figures are given in above table.			



K. Reason for petition for Exemption from Reparation List.

- a. This plant had engaged in automobile manufacturing from 1931, while in 1942 she was converted to an aircraft manufacturing plant by order of the Army Authority. Fundamentally, therefore, the plant is not the one which was established for aircraft manufacturing. After the end of war, she has turned to her original product of automobile parts which are being manufactured at present.
- b. In 1942 at the time of conversion to aircraft, the greater part of machinery and equipment then in their possession, were transferred to Akashi Aeroengine plant and of Akashi Frame Plant of Kawasaki Aircraft Industrial Co., Ltd. The conversion was made, therefore, with the remaining of machinery and equipment not making much alternation on their arrangement. Aircraft parts manufactured by this plant during the war time, were forgings and castings in crude status and no completely finished articles were manufactured.
- c. As this plant has long experience for automobile manufacturing she has special skill and equipment. At present she is supplying large quantity of crude materials to automobile manufacturers mostly such as Nissan Automobile Co. and Toyota Automobile Co. and other automobile parts manufacturer in Kansai District and, therefore, the discontinuance of such a supply may cause a disastrous effect on automobile manufacturing industry in this country.



## 建設假勘定豫算表 (附第二號表)

- d. Manufacturing skill of this plant of aluminium castings is also quite renowned. There is no factory in this country except this plant which can make mass production of electric heaters and radiators to be sent to the Occupation Forces.



775 013

FILE

HYOGO MILITARY GOVERNMENT TEAM  
APO 317

ABH/di

P-15

19 November 1946

SUBJECT: Application and Recommendation for the  
Removal of Kawasaki Kokuki Kabushiki Kaisha,  
Kobe Kojo, from O. D. 5.

TO : Commanding General  
I Corps  
APO 301

1. Reference is made to letter, this headquarters, same subject, dated 9 November 1946.
2. Additional information on the subject received from the Central Liaison Office is submitted herewith.

PETER W. SCOTT  
Lt Col Inf  
Commanding

- 3 Incls:
1. Letter of Recommendation from Central Liaison Office (5 copies)
  2. Letter of Recommendation - Commerce & Industry Ministry. (5 copies)
  3. Application of Kawasaki Kokuki K. K. (5 copies)



TO : HEADQUARTERS, HYOGO MILITARY GOVERNMENT TEAM.  
FROM : Central Liaison Office, Tokyo.  
SUBJECT: Request for Removal of Kobe Kinzoku Plant of  
Kawasaki Sangyo K.K. from Reparations List.

C.L.O. No. 589(RSG-E)

8 November 1946

1. Reference: SCAP Memorandum AG 004(11 Oct 46)ESS/IN  
(SCAPIN-1263), subject: "Revised List No.2 Aircraft Factories,  
Military and Naval Arsenal and Research Laboratories."

2. Herewith is submitted an application of the Ministry of  
Commerce and Industry on the subject matter.

3. As is stated in detail in the above application, the  
subject plant was established in March 1931 for the purpose  
of manufacturing automobiles and was not established as an  
aircraft plant. During the war, it was converted into a  
forging and casting factory for aircraft manufacture by order  
of military authorities but only manufactured forged and  
casted parts of aircraft, being operated as a raw material  
plant. After the surrender, it has been reconverted to the  
manufacture of forged and casted parts of automobiles along  
its proper line of industry.

4. Under these circumstances, it is requested that favorable  
consideration be given by your Headquarters for removal from  
the Reparations List of the minimum machinery required for  
civilian production in this plant.

FOR THE PRESIDENT:

(K. Asakai)  
Director of General Affairs,  
Central Liaison Office.

Enclosure: An application of the Ministry of  
Commerce and Industry, accompanied  
by an explanatory note on the sub-  
ject plant.



To : Headquarters Hyogo Military Government Team  
From : Adjusting Division,  
Ministry of Commerce and Industry  
Subject : Application for Exemption from Designation of  
Reparation Control to Kawasaki Kōkuki Kogyo K.K.,  
Kobe Kinzoku Kojo (Kobe Forging and Casting Plant,  
Kawasaki Aircraft Industrial Co., Ltd. --- Present  
Name Kawasaki Industrial Co., Ltd.) as aircraft plant.

1. In regard to this plant as designated for control as aircraft plant in the directive dated 20 January 1946, we have taken and are also taking actions to assure its satisfactory control and custody, in close connection with organs concerned civil and official.
2. However, this plant is desired to be exempted from the designation for control as well as to be the object of reparation in future after your review on the detailed explanation (annexed paper) due to the fact that this company, having the long history as a manufacturer of civilian goods, was not established for the purpose of aircrafts production though participated in aircrafts production occasionally during war, and all its facilities were intented to be restored to civilian production, its original mission, since the termination of war.

*T. Wada*  
Director of Adjustment Division,  
Ministry of Commerce and Industry.



## A. Name of Company

Kawasaki Kokuki Kogyo K.K.  
 (Kawasaki Aircraft Industrial Co., Ltd. Present Name ...  
 Kawasaki Industrial Co., Ltd.)

## B. Name of Plant

Kobe Kinzoku Kojo  
 (Kobe Forging and Casting Plant)

## C. Location of Company and Plant

## a.) Company:

100 Otsubo Kanigasaka, Akashi-City  
 (Office moved to: 1609 Chosamba-cho, Akashi-City)

## b.) Plant:

1 2-chome Wadayama-dori Hyogo-ku, Kobe-City

## D. Year and month of Foundation and Commencement of Company and Plant

## a.) Foundation of Company:

November, 1937

## b.) Commencement of Plant:

March, 1931

## E. History of plant

1931 In Kawasaki Rolling Stock Co., Ltd., the plant was established as Automobile Department and was planned for mass production of automobiles.

1932 The plant's total production; 13 automobile trucks and 37 motor bus bodies.

1933-1939 The production during this period were automobile trucks, motor buses, civilian motor cars and 100 HP gasoline engines.

1940 The Automobile Department was promoted to an independent factory, taking the same rank as the Rolling Stock Factory of the Company. The plant moved to the present site with replenished machinery and equipment and commenced mass production of automobile trucks.



775 013

1941 Production of automobile trucks amounted to 1323.

1942 In October, the plant was converted into forging and casting factory for manufacturing aircrafts by order of the Military Authority. At the same time it was taken over by Kawasaki Aircraft Industrial Company Ltd. so far as capital is concerned. The greater part of machines were taken over to Kawasaki Aircraft Industrial Co., Ltd. Akashi Plant.

1943 & afterwards, Manufactured crude aircraft parts forged and or casted.

1945 The plant was bombed three times, in March, June and July and suffered big damages to buildings and equipment. Damages to buildings 59% and to machinery and equipment 48%.

1946 In May, the plant received a permit from Allied Forces to resume production of civilian commodities.

F. Particulars of Products in 1934 - 1936 (In Kawasaki Rolling Stock Co.)

Articles	1934	1935	1936
Trucks		52	56
Buses	20	21	23
" (bodies only)	99	82	
Civilian cars		2	
100 HP gasoline engines	101	45	38
Special Pulling Cars		4	

G. Particulars of Products in 1937 - 1945

Articles	In Kawasaki Rolling Stock Co.						In Kawasaki air-craft Ind. Co.			
	1937	1938	1939	1940	1941	1942	1942	1943	1944	1945
Trucks	175	346	340	1045	1325	1430				
Buses	6									
Civilian Cars	10	3								
100 HP gasoline engines	28	25	10							
100 HP Diesel "	1			1						
60 HP " "		1	1							
Aircraft Parts (forging)	Tons)						15	2006	3528	919
" (casting)	Tons)						158	205	108	



Notes: Forging aircraft parts mainly consist of Con. Rod,  
Valve Lock Arm etc.

Casting aircraft parts mainly consist of Crank Case,  
Cylinder Block etc.

H. Production after the war.

a) Monthly Production after Permit of Conversion into  
Civilian Industry granted. (Permit has been granted  
under the date of 15 May 1946)

#### Forgings

Articles	May	June	July	Aug.	Sept.
Main Bolt	5079	2763			
Rear Axle Shaft	1027	1108	802	1110	1043
Rear Yoke		2692	3023	5650	3692
Front Yoke	1313	1665	2979	4191	5005
Spider	2536	1014	5294	6219	3737
Drive Gear		732	2921	3155	1797
Side Gear		2773		4059	2466
Speed Gear				661	
Other Gears					2580
Pitman Arm					2483
Drive Gear Only					1397
Bicycle Parts	3448	834	6201	5965	5450
Others	554	1204			
Total (Tons)	27	47	37	66	65

#### Casting

Articles	May	June	July	Aug.	Sept.
Electric Reverberatory Stove	122	273	719	520	594
Electric Roster	1856	195			233
Water Pump for Motor Car	4	127	924	82	30
Radiator					24
Others for Domestic Use (Tons)	2.5	2	2.3	4	3.5
Total (Tons)	7.8	6.8	10.5	9.5	9.8



775 013

b) Production Programme in Future.

	1946 Sept.	Oct.	Nov.	Dec.	1947 Jan.	Feb.	Mar.	
Forgings	90	102	128	150	150	150	150	Tons
Aluminium Castings	15	15	15	15	15	15	15	"
Iron Castings		1	3	7	10	15	20	"
Copper Alloy							500	Pieces

Notes:

- a) Forgings are mostly parts of automobiles, ships and rolling stock engines.
- b) Aluminium Castings are mostly heating radiators and electric articles.
- c) Iron castings are mostly parts of ships and rolling stock engines and rolling stock parts.



775 013

I. Outline of Equipment

(A) Particulars of machinery and equipment possessed by each shop.

a) Forging shop

Manufacturing: Forgings of automobile, rolling stock, bicycle parts etc.

Land area used for Buildings: 14,018 square meters

Total Floor Space: 16,681 " "  
(Damages by air raid 75%)

Construction: 4 one-storied and 1 two-storied buildings of steel-skeleton, roofed with zinc plate.

Machinery and other equipment: The Particulars:

1) Metal Cutting Machine

Machine	Number
Lathe	21
Drilling Machine	8
Vertical Milling Machine	12
Horizontal Milling Machine	4
Planer	1
Shaper	4
Slotter	2
Grinder	2
Circular saw	3
Die Sinker	1



Machine	Number
Hack Saw	9
Metal Cutting Machine	6
Bar Shear	1
Cutting Grinder	3
Circular Saw Grinder	2
Total	79

## 2) Industrial Machine

Machine	Number
Hammer	25
Press	14
Air Compressor	6
Double Head Grinder	14
Boiler	2
Gas Producer	2
Rotary Heat Treating Furnace	1
Portable Grinder	1
Stoker	5
Sand Blast	5
Stoker	2
Saw Sharpening Machine	1
Upsetter	1
Total	79



3) Electric Machine

Machine	Number
Motor	6
Transformer	4
Electric Furnace	13
Blower	12
Electric Welding Machine	2
Total	39

4) Wood Machine

Machine	Number
Circular Sawing Machine	1
Total	1

5) Accurate Measuring Apparatus

Machine	Number
Brinell Hardness Testing M.	3
Total	3

6) Transporting Machine

Machine	Number
Travelling Crane	2
Hoist	3
Total	5

The Total Number of Forging Shop : 206