

Plotted By: Sherwood, Adam January 24, 2023 04:15:35pm
 This document, together with the concepts and designs presented herein, is intended only for the specific purpose and client for which it was prepared. Please do not rely on this document without written authorization and adaptation by Kinney-Horn and Associates, Inc. and be without liability to Kinney-Horn and Associates, Inc.

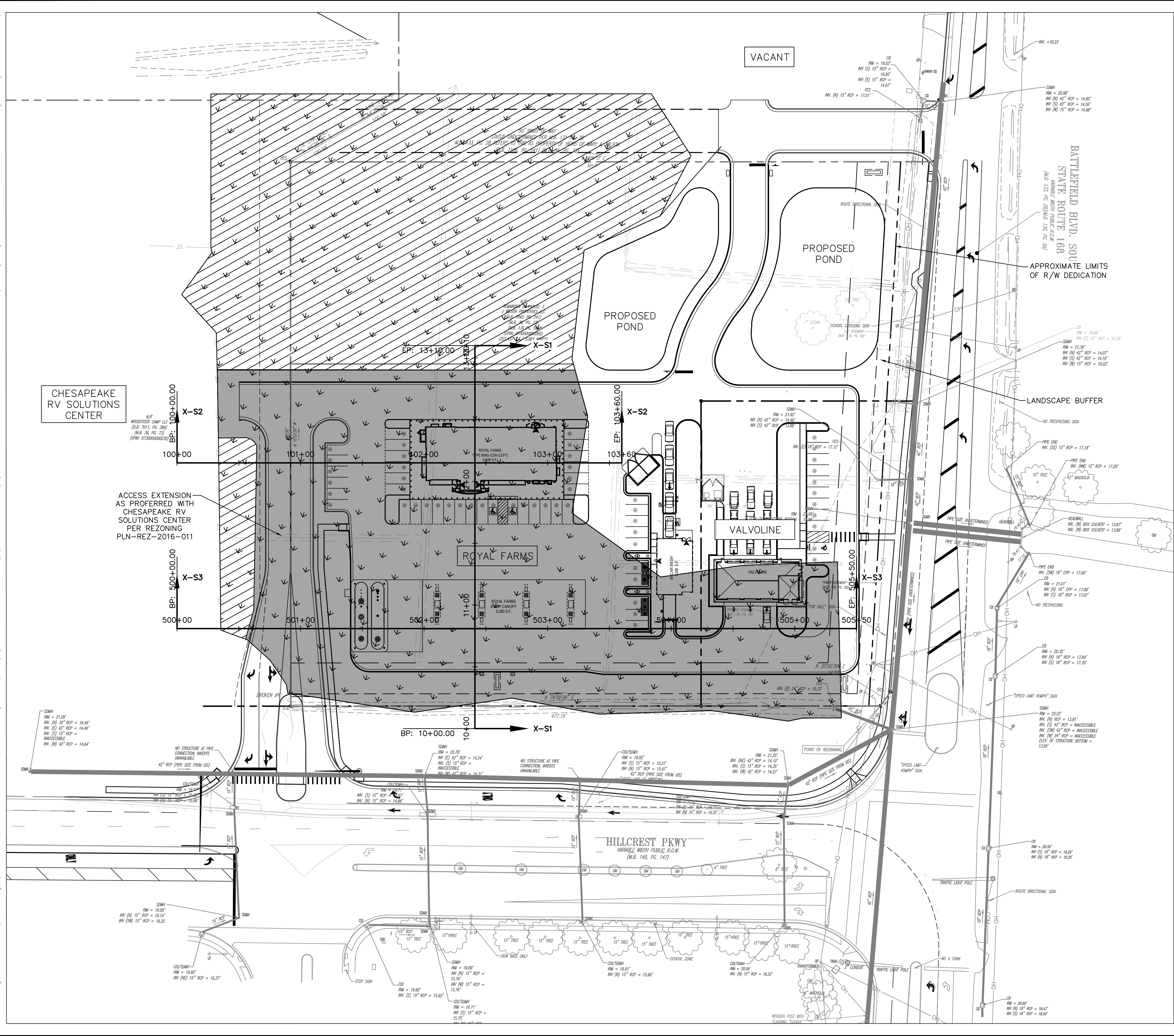

ENVIRONMENTAL IMPACT SUMMARY:

- DELINEATED PFO WETLANDS: 4.09 ACRES (SF)
- IMPACTED PFO WETLANDS: 2.25 ACRES (SF)
- AVOIDED PFO WETLANDS: 1.84 ACRES (SF)

LEGEND:

- DELINEATED PFO WETLANDS
- IMPACTED PFO WETLANDS
- AVOIDED PFO WETLANDS

FOR REVIEW ONLY

DATE	1/24/2023	SCALE	AS SHOWN	DRAWN BY	ATS	CHECKED BY	GHS
------	-----------	-------	----------	----------	-----	------------	-----

ENVIRONMENTAL X-SECTION EXHIBIT

**EDINBURGH RETAIL
1809 BATTLEFIELD BLVD**
CHESAPEAKE VIRGINIA

SHEET NUMBER
3

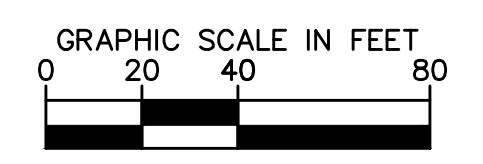
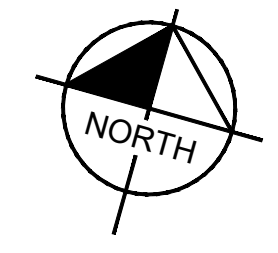

Plotted By: Sherwood, Adam January 24, 2023 04:15:35pm
 This document, together with the concepts and designs presented herein, is intended only for the specific purpose and client for which it was prepared. Reuse or improper reliance on this document without written authorization and approval by Kinney-Horn and Associates, Inc. shall be without liability to Kinney-Horn and Associates, Inc.

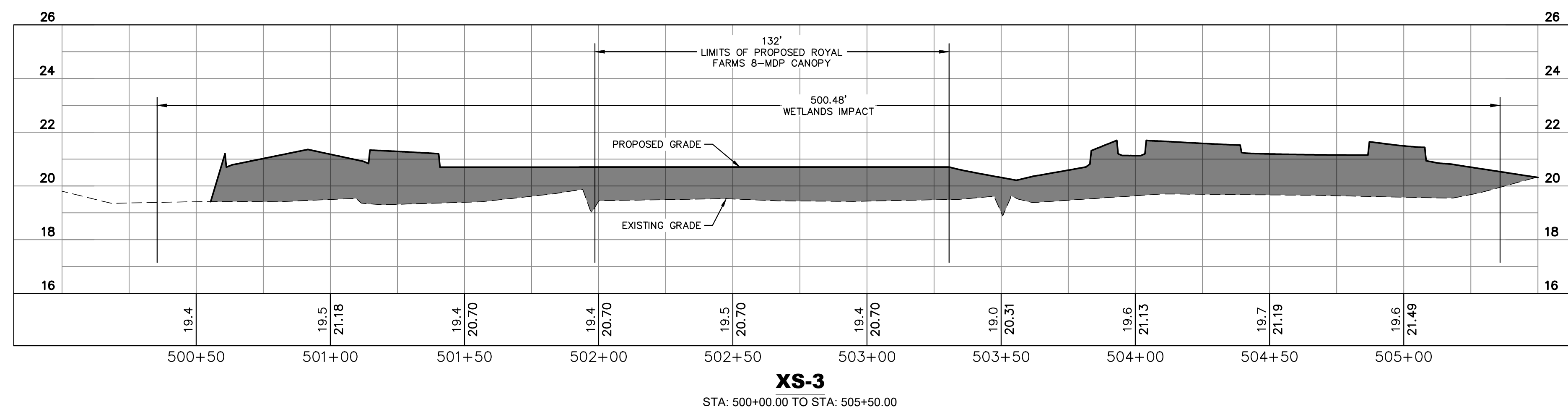
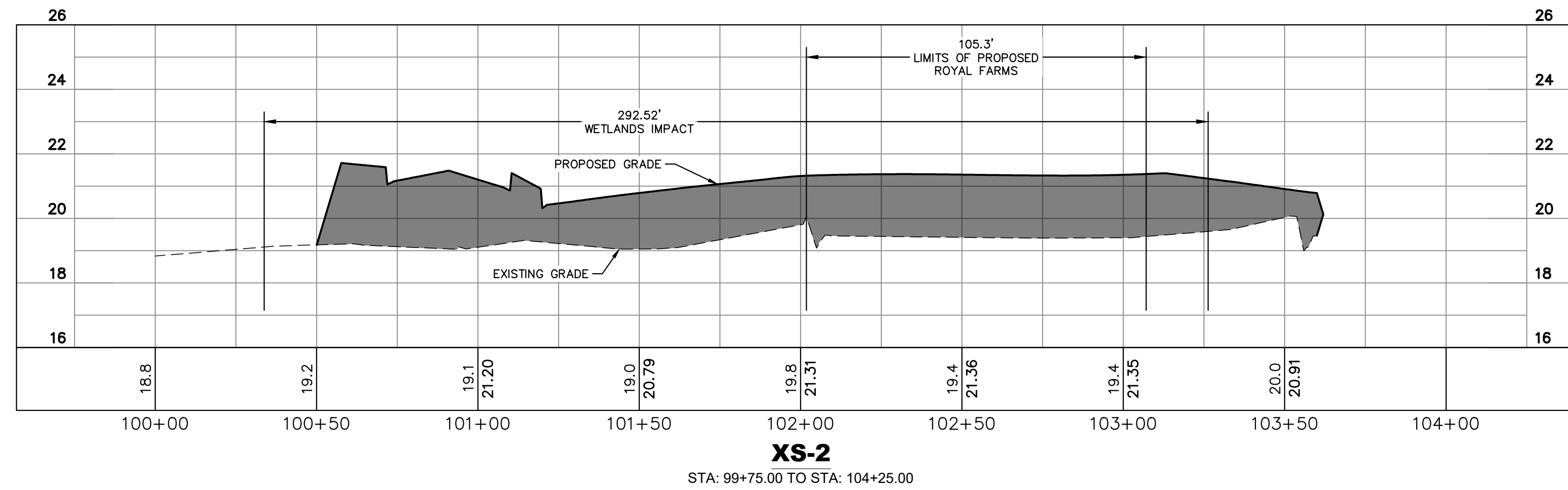
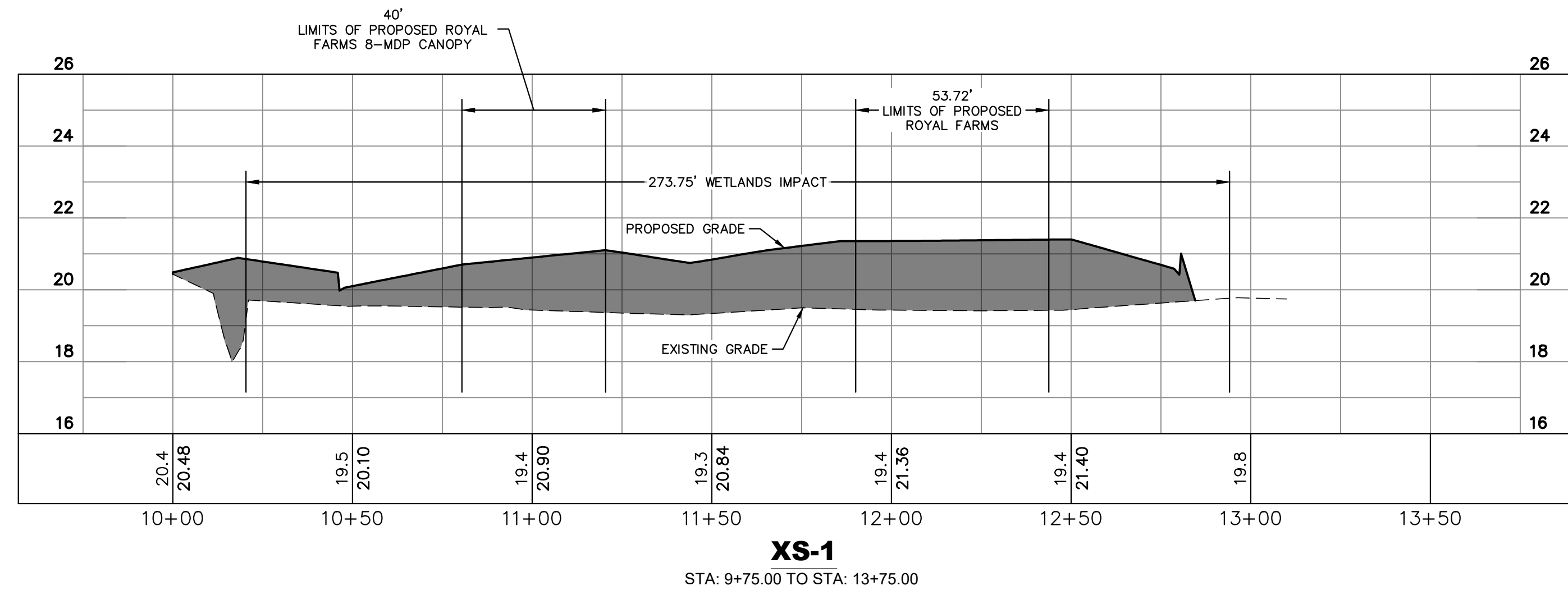

IMPACTED PFO WETLANDS

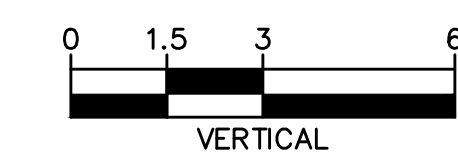
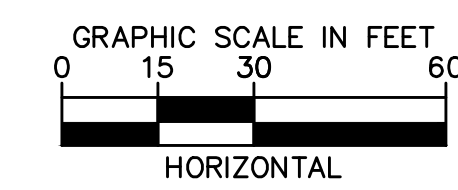

FOR REVIEW ONLY

DATE	12/02/2022
SCALE	AS SHOWN
DRAWN BY	ATS
CHECKED BY	GHS

ENVIRONMENTAL
X-SECTION
EXHIBIT

EDINBURGH RETAIL
1809 BATTLEFIELD BLVD

VIRGINIA

CHESAPEAKE

SHEET NUMBER

3B