

Crocker St

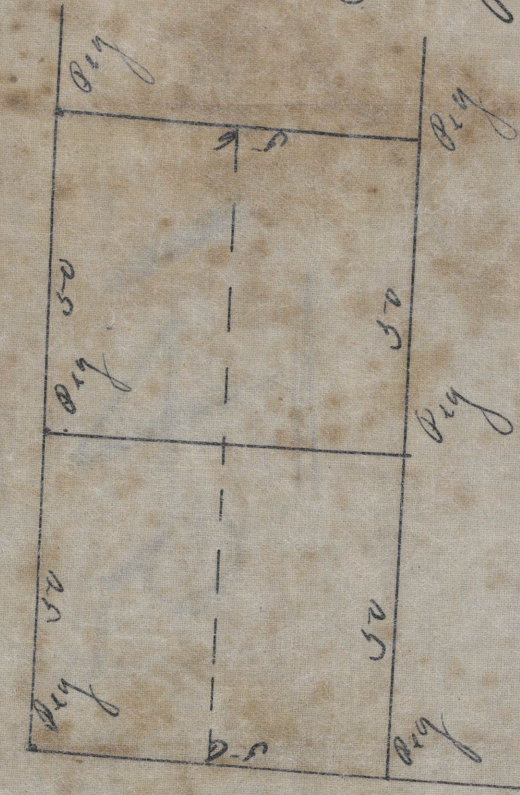

Sutter St

Plot of two lots at the
 N E Cor of Crocker and
 Sutter Sts. Belonging to
 E H Winster Esq. Being
 Nos 1 and 2 on a Plat
 of lands of Lamin Esq
 Surveyed and titled
 Aug 1864 Lewis Simons
 State 30 ft per each

Plot of lands of Lamin Esq
 recorded in Plot book C
 Page 33 R per C office -