

Dowle

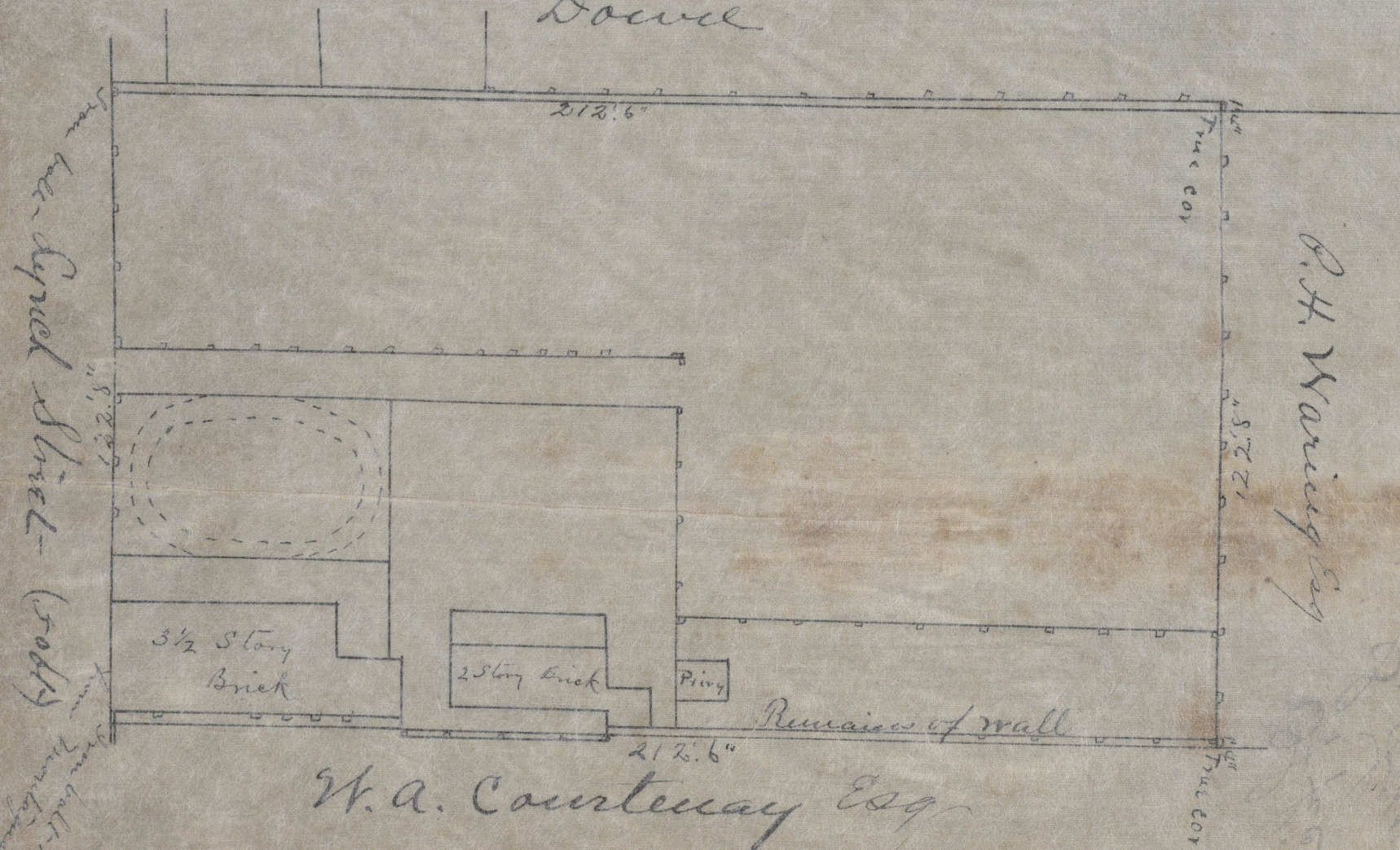

From the Lynch Street - (50ft)

O. H. Waring Esq

W. A. Courtenay Esq

Plat of a lot of land with buildings thereon, situate on the West side of Lynch Street - Belonging to Mrs Salena E. Magrath.

Surveyed by Lewis Simons

Charleston S.C. Mar '85

Scale 30 ft. = 1 in.