

— A P L A T —

OF THE SOUTH EAST CORNER OF
ASHLEY AVE. AND CANNON ST.
MADE FOR CHARLESTON IMPROVEMENT
COMPANY. SURVEYED JULY 26-1911, BY,

John M. Crady.

TRUE LINE ———
LINE OF OCCUPATION ———

SCALE 10' = 1"

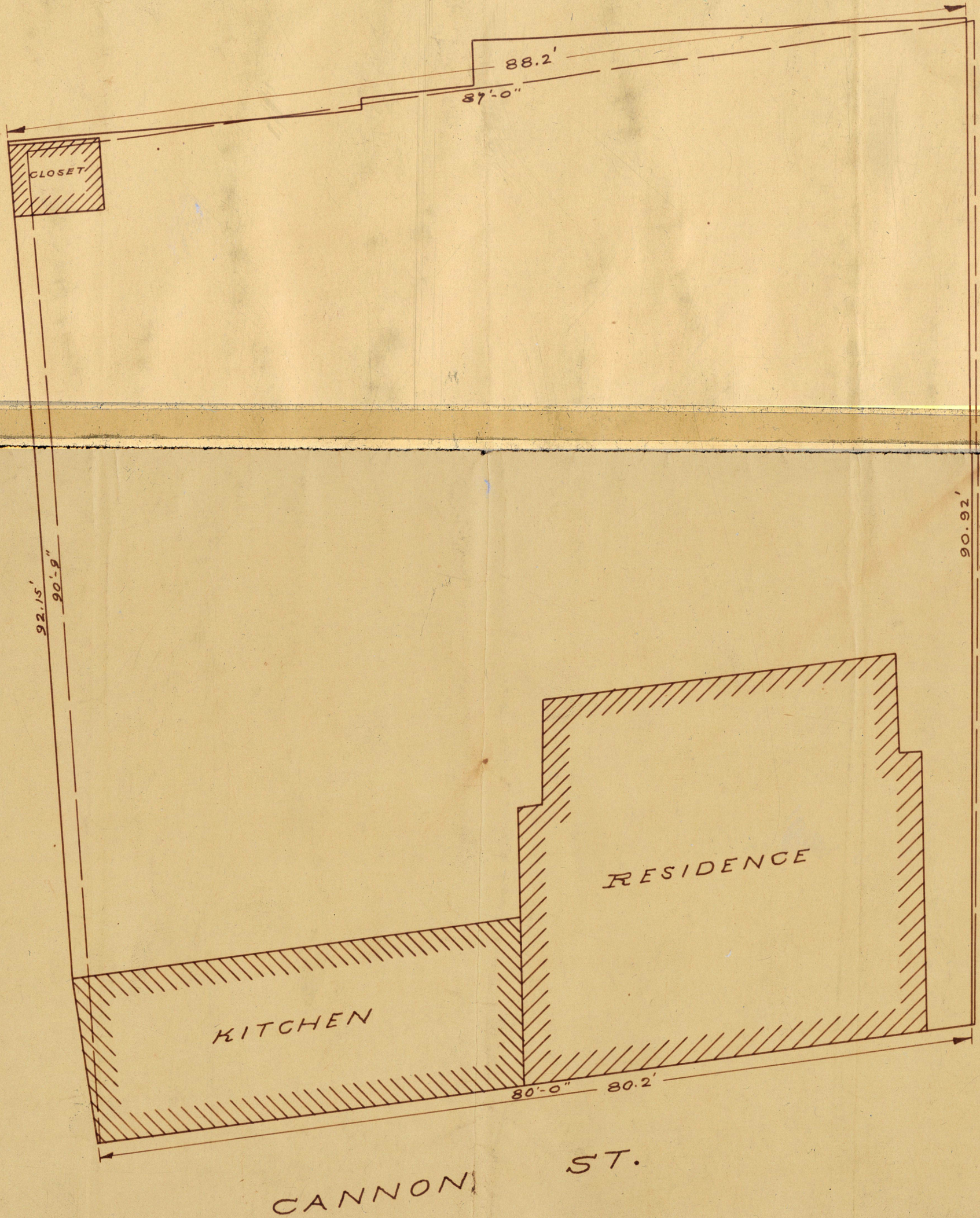

ASHLEY AVE.

CANNON ST.