

No. 6

Item	Name	Type	Manufacturer's Name	Size and Capacity (Single Unit)	No. of Units	Year Built	Condition		
51	Counter shaft		The Toyo Carry air Co., Ltd.		1		Usable	in use	make for- lime sulphur
52	Motor	Open type	The Shibaura electric machine Co., Ltd.	3 HP	1	1943	"	idle	
53	Holder for carbon-dioxide gas		The Sumitomo chemical industrial Co., Ltd.		1		"	"	
54	C.F. Condenser by brine cooling	Brine type	The Toyo carry air Co., Ltd.	450x2420	1		"	in use	for farmacy- sulfanilyl guanidine
55	Get condenser	Spiral type	The sate factory		1	1943	"	in use	for farmacy- sulfanilyl guanidine
56	Vacuum pump	Knosawa type S.V.Y type	The Knosawa Company Iron factory		1		Minor repair	idle	
57	Motor 10 HP	Double open type	The Shibaura electric industrial Co., Ltd.	10 HP	1		Usable	"	
58	Vacuum tank	Vertical Cylinder type	The Toyo carry air Co., Ltd.	300x1500	1		"	in use	for farmacy- sulfanilyl guanidine
59	Thermometer	Box type Electric resistance type	The Gokushin electric machine Co., Ltd.		1	1943	Completely damaged	in use	for farmacy- Saccharine
60	"	"	"		1	1943	"	idle	
61	"	"	"		1	1943	"	"	

No. 7							
Item	Name	Type	Manufacturer's Name	Size and Capacity (single unit)	No of Units	Year Built	Condition
62	Hoist	Mikuni type 3XT	The Mikuni Hoist factory		1		usable in use for pharmacy - sulfanilyl guanidine
63	Motor 5 HP	All enclosed type	The Yasukawa electric machine Co., Ltd.		1		" " "
64	Vacuum pump	Vertical two cylinder	The Nishikawa factory	4.4 inch	1	1943	" " For pharmacy - Carbonic guanidine
65	Motor 7.5 HP	Half enclosed type	The Fuji electric industrial Co., Ltd		1	1943	" " "
66	Test pump				1		" " For pharmacy - Acetanilid
67	Motor 1HP	Enclosed type	The Yasukawa electric machine Co., Ltd.		1	1943	" " "
68	Tank for balancing pressure	Box type	The Toyo carry air Co., Ltd.		1	1943	" idle
69	Ammonia compressor	Two cylinder	The Sanyo iron work's	15x15inch	1	1942	" "
70	Motor 250HP	synchronous motor	The Yasukawa electric machine Co., Ltd.	250 HP	1	1942	" "
71	Ammonia booster	three cylinder	The Sanyo iron work's	13x13inch	1	1942	" "
72	Motor 150HP	synchronous motor	The Yasukawa electric machine Co., Ltd.	15 HP	1	1943	" "

775013

No. 8

Item	Name	Type	Manufacturer's Name	Size and Capacity (single unit)	no. of Units	Year Built	Condition	
73	Ammonia booster	Three Cylinder	The Sanyo iron works	13x13 inch	1	1942	Minor Repair idle	
74	Motor 150 HP	Synchronous motor	The Yasukawa electric machine Co., Ltd.	150 HP	1	1942	usable idle	
75	Ammonia booster	Three Cylinder	The Sanyo iron works	13x13inch	1	1942	" "	
76	Motor 150 HP	Synchronous motor	The Yasukawa electric machine Co., Ltd.	150 HP	1	1942	Minor Repair idle	
77	Ammonia compressor	Three Cylinder	The Sanyo iron works	8x8inch	1	1942	usable	in use for pharmacy Belphenine sulfanilyl guanidise (S.G.)
78	Motor 50 HP	open type	The Yasukawa electric machine Co., Ltd.	50 HP	1	1942	"	idle
79	Oil separator	upstand type	The Toyo carry air Co., Ltd.		1	1943	"	"
80	"	"	"		1	1943	"	"
81	"	"	"		1	1943	"	"
82	"	"	"		1	1943	"	"
83	"	"	"		1	1943	"	"
84	Ammonia condenser	Vertical multi tube type		1007x4845	1	1943	"	"
85	"	"	"	610x6657	1	1943	"	in use for pharmacy- Belphenine S.G.

No. 9								
Item	Name	Type	Manufacturer's Name	Size and Capacity (Single Unit)	No. of Units	Year Built	Condition	
86	Liquid ammonia receiver	Floor type	The Toyo carry air Co., Ltd.	710x5500	1	1943	usable idle	
87	"	"	"	406x2426	1	1943	" in use For pharmacy-Belphenine S.G.	
88	Accumulator	Vertical cylinder type	"	762x1829	1	1943	" idle	
89	"	"	"	406x1220	1	1943	" in use For pharmacy-Belphenine S.G.	
90	Inter cooler	"	"	914x2438	1	1943	" idle	
91	Ammonia pre-cooler	"	"	610x1830	1	1943	" "	
92	Brine cooler	Floor type	"	660x2473	1	1943	" in use For pharmacy-Belphenine S.G.	
93	Brine pump	Edy type	The Sbars Co., Ltd.		1	1943	" idle	
94	Motor 7.5 HP	Open type	The Shisaura Co., Ltd.	7.5 HP	1	1943	" "	
95	Brine tank	Box type	The Toyo carry air Co., Ltd.	1067x4787	1	1943	minor repair	
96	Liquid ammonia receiver	Floor type	"	706x3667	1	1943	usable idle	
97	Liquid ammonia separator	Vertical suspension type	"	762x1824	1	1943	"	

No. 10

Item	Name	Type	Manufacturer's Name	Size and Capacity (Single unit)	No. of Units	Year Built	Condition
98	Purge drum		The Toyo carry air Co., Ltd.	304x562	1	1943	Usable idle
99	Brine Tank	Box type	The Toyo carry air Co., Ltd.	1829x1824 x1537	1	1943	" in use For pharmacy- Belphenine S.G.
100	Brine cooler	Floor type	"	1067x4767	1	1943	" idle
101	Ammonia condenser	vertical cylinder type	"	1067x4845	1	1943	" idle
102	Pump	Handy type	The Ebara Co., Ltd.		1	1943	Minor Repair idle
103	Motor 20HP	Enclosed type	The Meidensha Co., Ltd.	20 HP	1	1943	Usable "
104	Centrifuger		The Nippon centrifuger manufactory		1		Minor Repair idle
105	Motor 4 HP	Half enclosed type	The Kanto electric machine manufactory		1	1943	Usable "
106	Trolley block				1	1943	" "
107	"				1	1943	" "
108	Brine tank	vertical cylinder type	The Nippon carbide industrial Co., Ltd.		1	1943	Minor Repair "
109	Exiter	Continuous type	The yasukawa electric machine Co., Ltd.		1	1943	Usable "

No. 11

Item	Name	Type	Manufacturer's Name	Size and Capacity (Single Unit)	No. of Units	Year Built	Condition	
110	Motor 30HP	All enclosed type	The Yasukawa electric machine Co., Ltd.		1	1943	usable	idle
111	Motor	Continuous type	"		1	1943	"	"
112	Motor 30HP	All enclosed type	"		1	1943	minor repair	idle
113	Transformer	Three phase	The Fujinawa electric factory	300 K.V.A.	1	1942	usable	in use For pharmacy-Selpheline S.G.
114	"	Single phase	"	50 K.V.A.	1	1942	"	"
115	Switch board	Hightension Mitschi type	The Shitaura Co., Ltd.		1	1942	"	"
116	"	"	"		1	1942	"	"
117	Switch box		The Yasukawa electric machine Co., Ltd.		1	1943	"	idle
118	"		"		1	1943	"	"
119	"		"		1	1943	"	"
120	"		"		1	1943	"	"
121	"		"		1	1943	"	"
122	Mulsifier	tram type	The Kokusanseiko company Ltd.		1	1944	"	"
123	"	"	"		1	1944	"	"

Item	Name	Type	Manufacturer's Name	Size and Capacity (Single Unit)	No. of Units	Year Built	Condition	Notes
124	Motor 20 HP	All enclosed endured explosion type	The Shibaura electric industrial Co., Ltd.	20 HP	1	1944	usable idle	
125	Exhaust fan				1		Minor repair in use	make for-fertilizer
126	Motor 15HP	All enclosed type	The Fuji electric machine Co., Ltd.		1	1943	usable	
127	Trolley block		The Nippon chemical machine Co., Ltd.		1	1943	" "	for pharmacy-Acetanilid
128	Hydrogen gas blower		The Mikuni iron works	15inch 77.5m ³	1	1942	Minor Repair idle	
129	Motor 3HP	All enclosed type	"	3 HP	1	1942	usable in use	For pharmacy-sulfanilyl guanidine(S.C.)
130	Oil separator		The Nippon chemical machine industrial Co., Ltd.		1	1942	" in use	For pharmacy-S.C.
131	Safety valve for Hydrogen		The Nippon chemical machine industrial Co., Ltd.	50x90mm	1	1942	" idle	
132	Holder for chlorine	30 meter cubic	The Showa manufactory Co., Ltd.		1	1943	Minor Repair in use	synthesizing ruby
133	Blower made by processin	Diameter	The Nippon chemical machine industrial Co., Ltd.	80 mm	1	1943	usable in use	For pharmacy-S.C.

Item	Name	Type	Manufacturer's Name	Size and Capacity (Single Unit)	No. of Units	Year Built	Condition
134	Motor 1/2 HP	Open type	The Nippon chemical machine industrial Co., Ltd.	1/2 HP	1	1943	Usable in use for pharmacy-S.G.
135	Flow meter	For hydrogen	"	"	1	1942	Minor Repair idle
136	"	For chlorine	"	"	1	1942	Completely damaged idle
137	Silica tube		The Tokyo shibaura electric industrial Co., Ltd.		1	1943	Usable idle
138	Storage tank for catalyst	Acid proof type earthenware made	The Nippon chemical machine industrial Co., Ltd.	100 M ³	1	1942	Completely damaged in use for pharmacy-S.G.
139	"	"	"	100 M ³	1	1942	" " "
140	Acid proof centrifugal pump	Geared type	The Yashima ceramic industrial Co., Ltd.		1	1943	" idle
141	Acid proof motor 3/4 HP	All enclosed type	The Hitachi Co., Ltd.	3 HP	1	1943	Usable idle
142	Air compressor		The Nippon chemical machine industrial Co., Ltd.	1.1 feet 2/min	1	1943	" in use for pharmacy-Belphenine

NO. 14

Item	Name	Type	Manufacturer's Name	Size and Capacity (Single Unit)	No. of Units	Year Built	Condition
143	Motor 1/2 HP	Open type	The Tokyo Shibaura electric industrial Co., Ltd.	1/2 HP	1	1943	usable in use for pharmacy- Belphenine
144	Head tank for catalyst	Acid proof type earthen-ware made	The Nippon chemical machine industrial Co., Ltd.	100 m ³	1	1942	Completely damaged idle
145	Neutralizing tower for exhaust gas	"	"	"	1	1942	usable in use for pharmacy- S.G.
146	Silica tube		The Shibaura electric industrial Co., Ltd.		1	1943	" idle
147	Pump	Spiral type	The Nippon Co., Ltd.	175 mm	1	1943	" "
148	Motor 20 HP	Open type	The Meidensha Co., Ltd.	20 HP	1	1943	" "
149	Transformer		The Chuo factory	1000A. 130V 5 HP	1	1942	" in use for pharmacy- Alcohol
150	Transformer		The Chuo factory	1000A. 130V 5 HP	1	1942	" " "
151	Converter		"	"	1	1942	" " "
152	Motor 5HP		"	"	1	1942	" " "
153	Switch board		"	"	1	1942	" " "
154	Transformer		"	"	1	1942	" " "

Item	Name	Type	Manufacturer's Name	Size and Capacity (single unit)	No. of Units	Year Built	Condition		
155	Electrolysis vessels		The Sanshin Company	S.R.E.-3. 900A 24-26	1	1943	Usable	in use	for pharmacy-Alcohol
156	"		"	"	1	1943	"	"	"
157	"		"	"	1	1943	"	"	"
158	"		"	"	1	1943	"	"	"
159	"		"	"	1	1943	"	"	"
160	Tank for distilled water	wood box 1000kg	"		1	1943	"	idle	
161	Equipment to getting distilled water evaporator		"	150 kg/day	1	1943	"	"	
162	Equipment to getting distilled water condenser		"		1	1943	"	"	
163	Washer for Oxygen		"		1	1943	"	in use	for pharmacy-Alcohol
164	Washer for Hydrogen		"		1	1943	"	"	"
165	Hydrogen holder		"		1	1943	"	"	"
166	Alkali tank	100 cubic meter	The Nippon carbide industrial Co., Ltd.		1	1943	"	"	make for-fertilizer

Item	Name	Type	Manufacturer's Name	Size and Capacity (Single Unit)	No. of Units	Year Built	Condition	
167	Turbine pump		The Essegawa pump manufactory	1meter 2 inch 2HP	1	1942	usable	idle
168	Agitator	acid proof porcelain made of	The Nippon Insulator Co., Ltd.		1	1943	"	in use make for-rubber accelerator
169	Filter press				1	1942	"	idle
170	Centrifuger 24'	For Belt spiral type	The Osaka centri-fugal drier manufactory	24x12inch	1	1942	"	in use Pharmacy-acetanilid
171	Motor	oil enclosed type	The Yamanashi electric machine Co., Ltd.	7.5 HP	1	1941	"	"
172	Air tank	Vertical cylinder type made of iron	The Ando Iron works	1000x1500	1	1942	"	" Pharmacy-sulfanilyl guanidine
173	Boiler				1	1944	minor repair	idle
174	Filter press				1	1942	usable	"
175	Agitator	acid proof porcelain made of	The Nippon Insulator Co., Ltd.		1	1943	"	in use make for-rubber accelerator
176	"	"	"		1	1943	"	in use Pharmacy-sulfanilyl guanidine
177	Centrifuger 24'	For Belt spiral type	The Osaka centrifugal drier manufactory	24x12inch	1	1943	"	" make for-salt

DECLASSIFIED E.O. 12065 SECTION 3-402/NNDG NO. 775013

Item	Name	Type	Manufacturer's Name	Size and Capacity (Single Unit)	No. of Units	Year Built	Condition	
178	Turbine pump		The Hasegawa pump manufactory	Diameter 2 inch 2HP	1	1942	usable	idle
179	Motor 3HP	All enclosed type	The Yasukawa electric machine Co., Ltd.	3 HP	1	1943	"	in use make for-salt
180	Filter press				1	1942	"	idle
181	Agitator	acid proof porcelain made of	The Nippon Insulator Co., Ltd.		1	1943	"	in use Pharmacy-sulfanilyl guanidine
182	"	"	"		1	1943	"	"
183	"	"	"		1	1943	"	"
184	"	"	"		1	1943	minor repair	"
185	"	"	"		1	1943	"	"
186	Centrifugal pump		The Hara Co., Ltd.		1	1941	usable	in use Pharmacy-carbonic guanidine
187	Motor 3HP		The Shitaura electrical machine industrial Co., Ltd.		1	1941	"	"
188	Centrifugal 30'	For Belt	The Hika industrial company	30 inch	1	1941	"	Pharmacy-acetanilid
189	Motor 3HP	All enclosed type	The Yasukawa electric machine Co., Ltd.	3 HP	1	1943	"	"

COM	Name	Type	Manufacturer's Name	Size and Capacity (Single Unit)	No. of Units	Year Built	Condition		
190	Reducer	Direct communication type	The Aoki roll manufactory		1	1943	usable	in use	product for-natural rubber
191	Counter shaft		"		1		"	"	"
192	Motor 100HP	open type	The Mitsubishi Co., Ltd	100 HP	1	1943	"	"	"
193	Switch board		The Gora Company	Power switch board 100HP	1	1943	"	"	"
194	Wexing roll		The Aoki roll manufactory Co., Ltd.	Horizontal second floor type one Belt 8x10 inch	1	1943	"	"	"
195	Motor 5HP	open type	The Mitsubishi electric machine Co., Ltd.		1		"	"	"
196	Reducer	Direct communication	The Aoki roll manufactory	5 HP	1	1943	"	"	"
197	Press vulcanization	Vertical hydraulic type	"	16x16inch 100 lbs	1	1943	Completely damaged		
198	Exhaust fan		The Osaka blower Co., Ltd.		1		usable	in use	Pharmacy-sulphanil-lyl guanidine
199	Motor 10HP	Enclosed type	The Saji electric factory		1	1937	"	"	"
200	Feed tank	Cylinder type	The Nippon carbide industrial Co., Ltd.		1	1945	"	in use	Pharmacy-Bel henine Acetanilid S.G. Rubber

No. 19

Item	Name	Type	Manufacturer's Name	Size and Capacity (Single unit)	No. of Units	Year Built	Condition	
201	Washington pump				1	1945	Usable in use	parmaoy- Belphenine Acetaniled S.C. Rubber
202	"				1	1945	" "	"
203	Boiler		The Hokkai chemical electric industrial Co., Ltd.		1	1945	" "	"
204	"		"		1	1945	" "	"
205	Feed tank	Cylinder type	The Nippon carbide industrial Co., Ltd.		1	1945	" "	"
206	kettle		"		1	1945	" idle	
207	"		"		1	1945	" "	
208	Testing machine for tensile strength	shoppe type	The Shimazu Co., Ltd.		1	1943	" in use	make for-natural rubber
209	Testing machine for ageing	Gearred type	"		1	1943	Minor Repair in use	"
210	Motor 1/2HP	enclosed type	"	1/2 HP	1	1943	Usable	"
211	Cutter test piece		"		1	1943	" "	"
212	Thermostat by air	No. 125-5211 single phase	The Chino Co., Ltd.		1	1940	" "	parmaoy- Belphenine

no. 23

Item	Name	Type	Manufacturer's Name	Size and Capacity (Single Unit)	No. of Units	Year Built	Condition	
213		Seiko type No. 442	The Scientific Laboratory		1	1940	Usable	idle
214		Omega type No. 50	"		1	1942	"	in use Pharmacy-Acetanilid
215	Emulsifier (Hareru)	" type	The Zokusanseiko factory Co., Ltd.		1	1944	"	idle
216	Motor 2HP		The Mitsubishi electric machine Co., Ltd.		1	1944	"	in use Pharmacy-Nizenaphol
217	Vacuum pump	portable type made by iron add 4 leg's			1	1942	"	" laboratory
218	Motor 1/4HP	Half enclosed type	The Seikosha factory	1/4 HP	1	1942	"	" "

Item	Name	Type	Manufacturer's Name	Size and Capacity (Single Unit)	No. of Units	Year Built	Condition	
219-222	Tank for hot-water	Box type	The Onoda Cement Co., Ltd.	1000x1000x1000	1	1943	usable in use	Pharmacy-sulfanilyl guanidine
	"	"	"	"	1	1943	" "	Pharmacy-Acetanilid
224-226	Carrying pot for catalyst	Proof acid type porcelain made	The Yashima Ceramic Co., Ltd.		5	1943	Completely damaged idle	
229	Carrying pot for catalyst	Enamel lining made by iron	The Asahi Enamel Co., Ltd.		1	1943	Minor repair in use	Pharmacy-Acetanilid
230	"	"	"		1	1943	" "	Pharmacy-Belphenine
231-232	"	"	"		2	1943	" "	Pharmacy-sulfanilyl guanidine
	"	"	"		1	1943	" "	"
234-240	Polymerizing plant	Enamel lining cylinder type	The Toyo Carry Air Co., Ltd.	1200x1800	7	1943	" idle	
241-243	Tank for hot-water	Box type self tangent	The Nippon Carbide Industrial Co., Ltd.		3		usable idle	
244	Tank for drained water	Box type	The Nippon Carbide Industrial Co., Ltd.		1		" in use	Pharmacy-Belphenine

DECLASSIFIED E.O. 12065 SECTION 3-402/NNDG NO. 775013

Item	Name	Type	Manufacturer's Name	Size and Capacity (Single Unit)	No. of Units	Year Built	Condition
245	Receiver for Hydrochloride acid	Acid proof type porcelain 50m ³	The Nippon chemical machine industrial Co., Ltd.		1	1943	Usable idle
246	"	"	"		1	1943	Completely Damaged idle
247-319	Bombe for chlorin	Volume 50kg	"		73	1943	Usable idle
320	Alkali reservoir	Vertical cylinder type made of iron	The Ando iron work's		1	1942	" "
321	"	"	"	1000x1500	1	1942	" "
322	Tank of separated liquid	Made by iron 200 cubic meter	"		1	1942	" "
323	"	"	"		1	1942	Minor Repair "
324-327	Conical flange pot	Cylinder type 500 cubic meter	The Yashima ceramic Co., Ltd.		4	1942	usable in use Farmsoy-Acetanilid
328-329	Precipitator	Made by wood	The Chuo wood tank & pipe Co., Ltd.	1200x1200 x1600	2	1942	Completely Damaged idle

Item	Name	Type	Manufacturer's Name	Size and Capacity (Single Unit)	No of Units	Year Built	Condition		
330-332	Precipitator	Made by wood	The Chuo wood tank & pipe Co., Ltd.	1200x1200 x1600	3	1942	Minor Repair	idle	
333	"	"	"	"	1	1942	Completely Damaged	idle	
334-335	"	"	"	"	2	1942	Minor Repair	idle	
336-338	"	"	"	"	3	1942	Usable	idle	
339-349	Wooden trough	Round type	The Chuo wood tank & pipe Co., Ltd.	1200x1650	11	1942	"	in use	Pharmacy-Acetanilid
350-352	Tank of Alkali Solution	Made by iron	The Nippon carbide industrial Co., Ltd.	1350x1720 x910	3	1942	Usable	idle	
353	Acid proof pot (200L.)	Made by porcelain pot type	The Yashima Ceramic Co., Ltd.		1	1942	"	in use	Pharmacy-Belphenine
354	"	"	"		1	1942	"	"	Pharmacy-sulfanilyl guanidine
355-357	"	"	"		3	1942	Completely Damaged	in use	Pharmacy-Alcohol
358	"	"	"		1	1942	"	idle	
359	"	"	"		1	1942	Usable	in use	Pharmacy-Belphenine
360-363	Earthen ware kettle	2000 cubic meter	The Sansin Company		4	1942	"	"	Pharmacy-Belphenine Aspirin Acetanilid

No. 24

Item	Name	Type	Manufacturer(s) Name	Size and Capacity (Single Unit)	No. of year Units Built	Condition	
364-365	Carrying pot of catalyst	Made by iron on rubber rizing	The Ando iron work's		2 1945	Minor Repair	in use Pharmacy- Belphenine
366-368	"	"	"		3 1945	Usable	idle
369-372	"	"	"		5 1944	"	"
374-1373	Acid proof pot(27L)	27 liter Porcelain	The yashima ceramic Co., Ltd.		1000 1944	"	"
1374-1393	Lidact pot	"	"		20 1944	"	"
1394-1413	Acid proofpot (200L.)	200 Liter porcelain	The Kameoka store		20 1944	"	in use Pharmacy- Acetanilid Aspirin
1414	Acid proof pot(100L.)	100 Liter porcelain	The Kameoka store		1 1944	"	in use Pharmacy- Belphenine
1415-1417	"	"	"		3 1944	"	Acetanilid Aspirin
1418	"	"	"		1 1944	"	Pharmacy- Belphenine
1419-1433	"	"	"		15 1944	"	Acetanilid Aspirin
1434-1633	Earthen ware pot(27L.)	Made by earthenware 27 liter	The Takayama kozan chemical earthenware Co., Ltd.		200 1944	"	" Pharmacy- Acetanilid
1634-1635	Analysis table	Large type	The Kishida store		2 1942	"	Pharmacy- Belphenine

9. Certification.

Signature : _____ SEAL :
Keiji Asahina

Title : _____
Superintendent, Uozu Works.

Acetylene generating plant

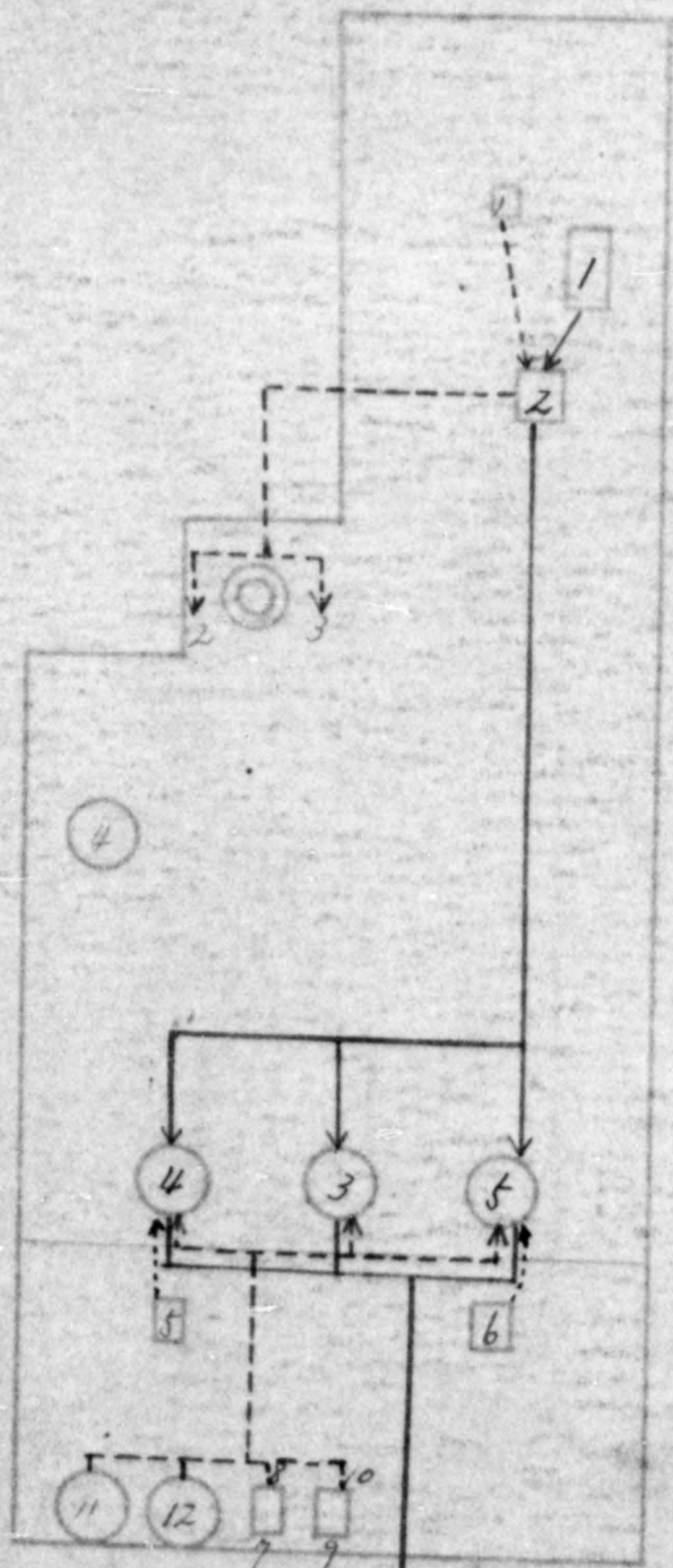

13, 14:
being used for packing plant

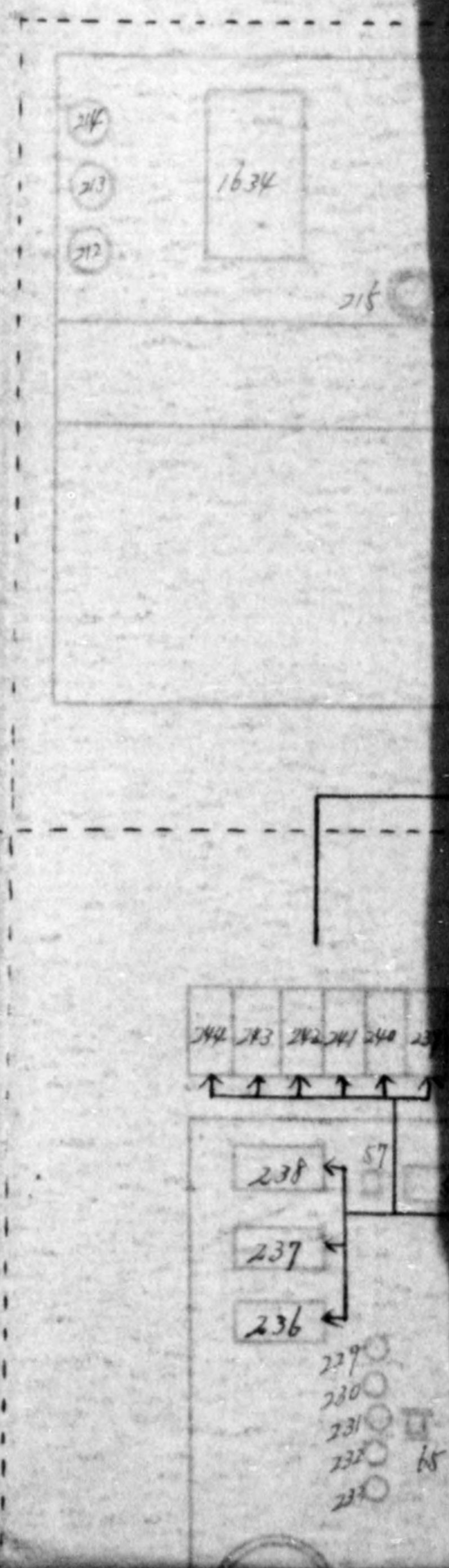

FLOW SHEET OF SYNTHETIC RUBBER PLANT

The Nippon Carbide Industrial Co., Ltd. Uozu Works

Synthesizing plant of Hydrochloric acid

Test room and office

Polymerizing plant

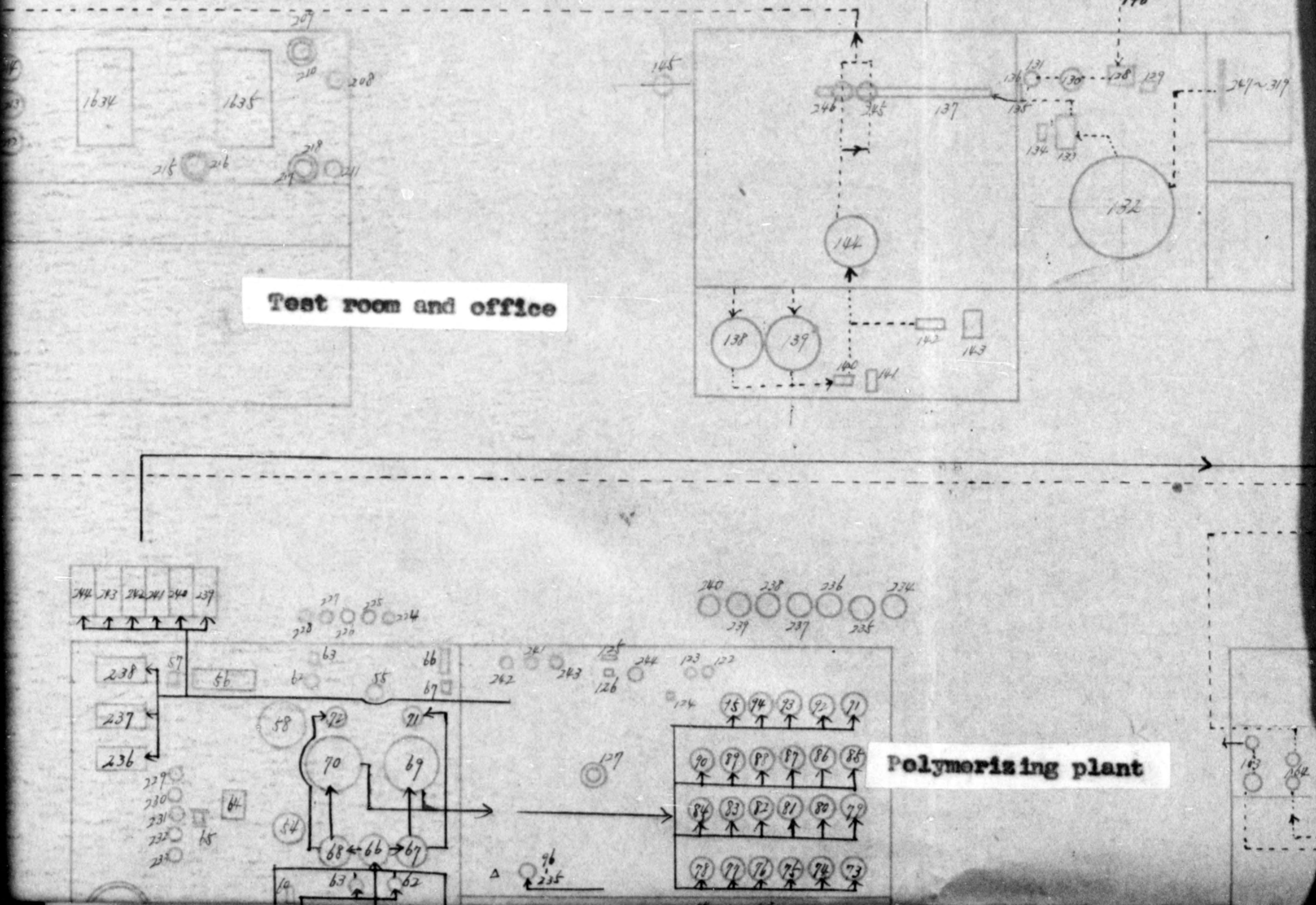

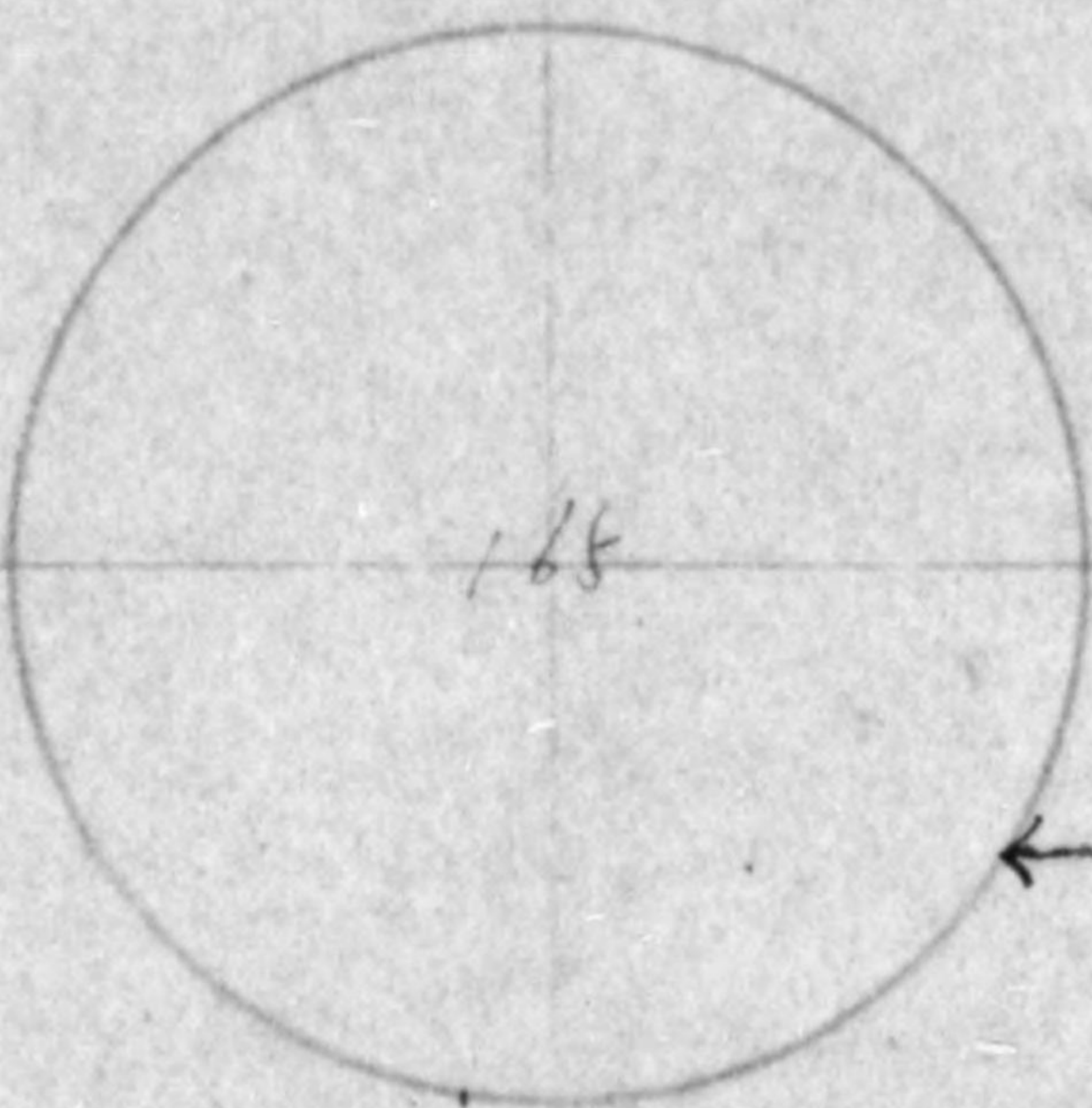

blue
red

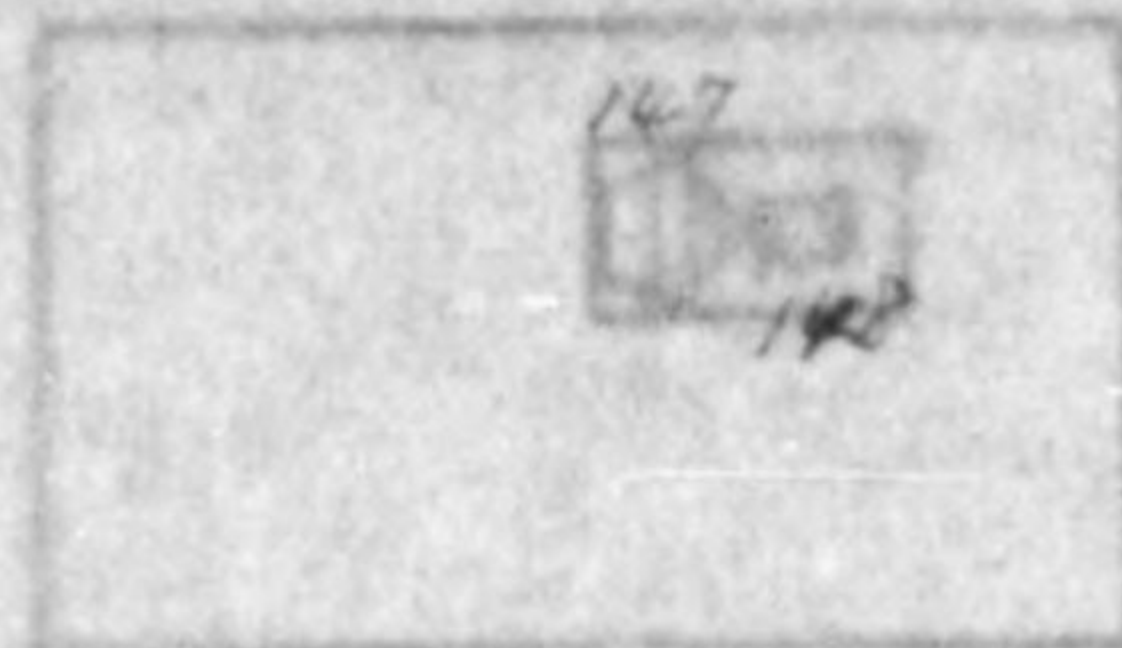
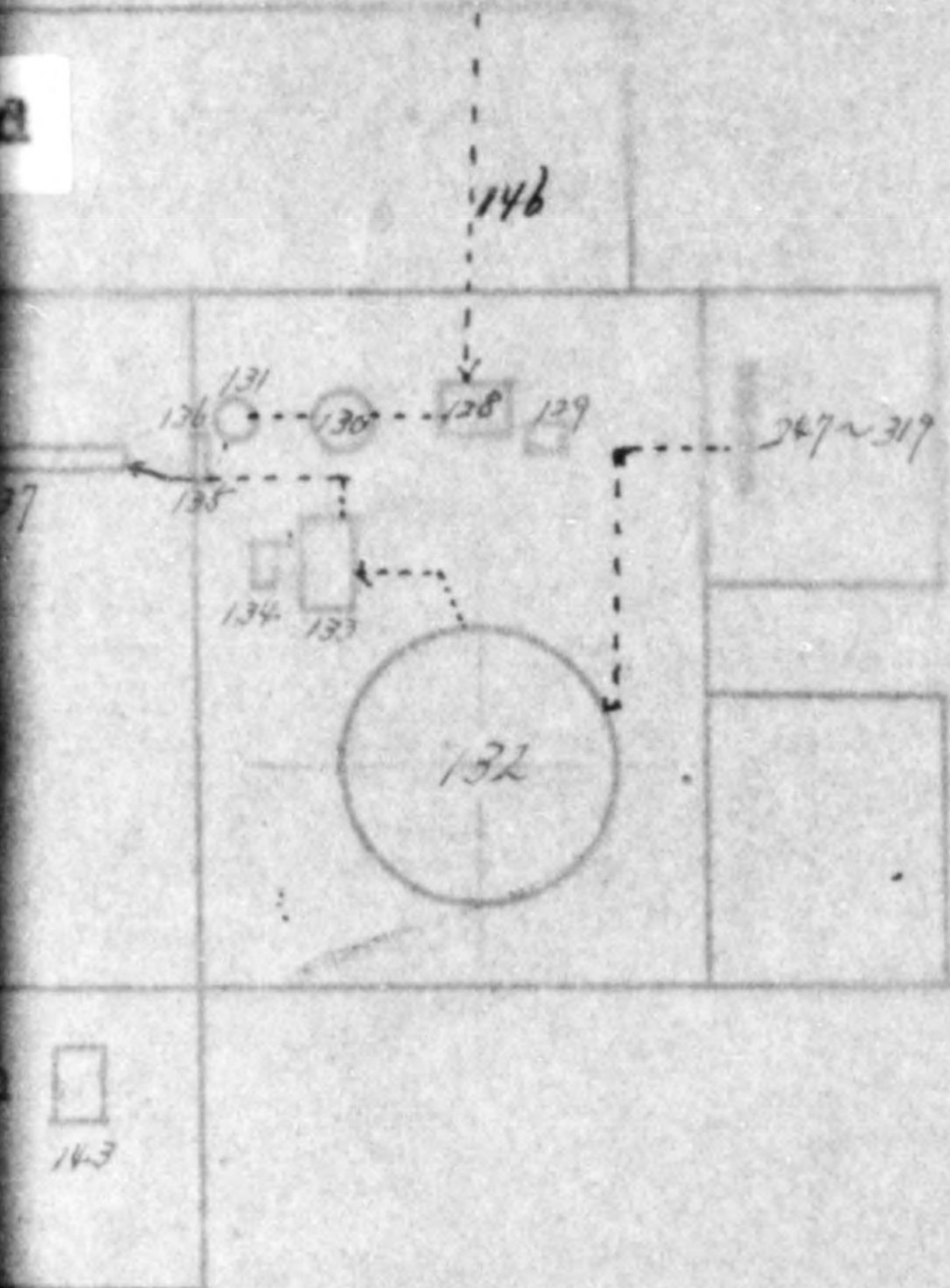

Pump room No. 2

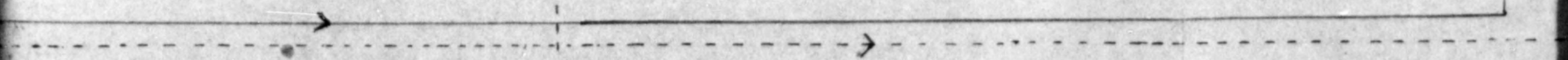
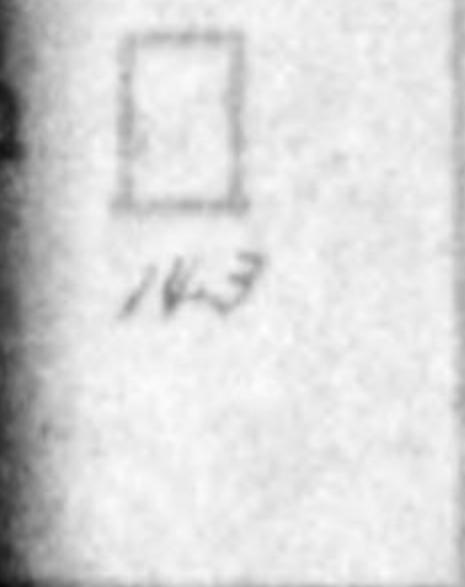
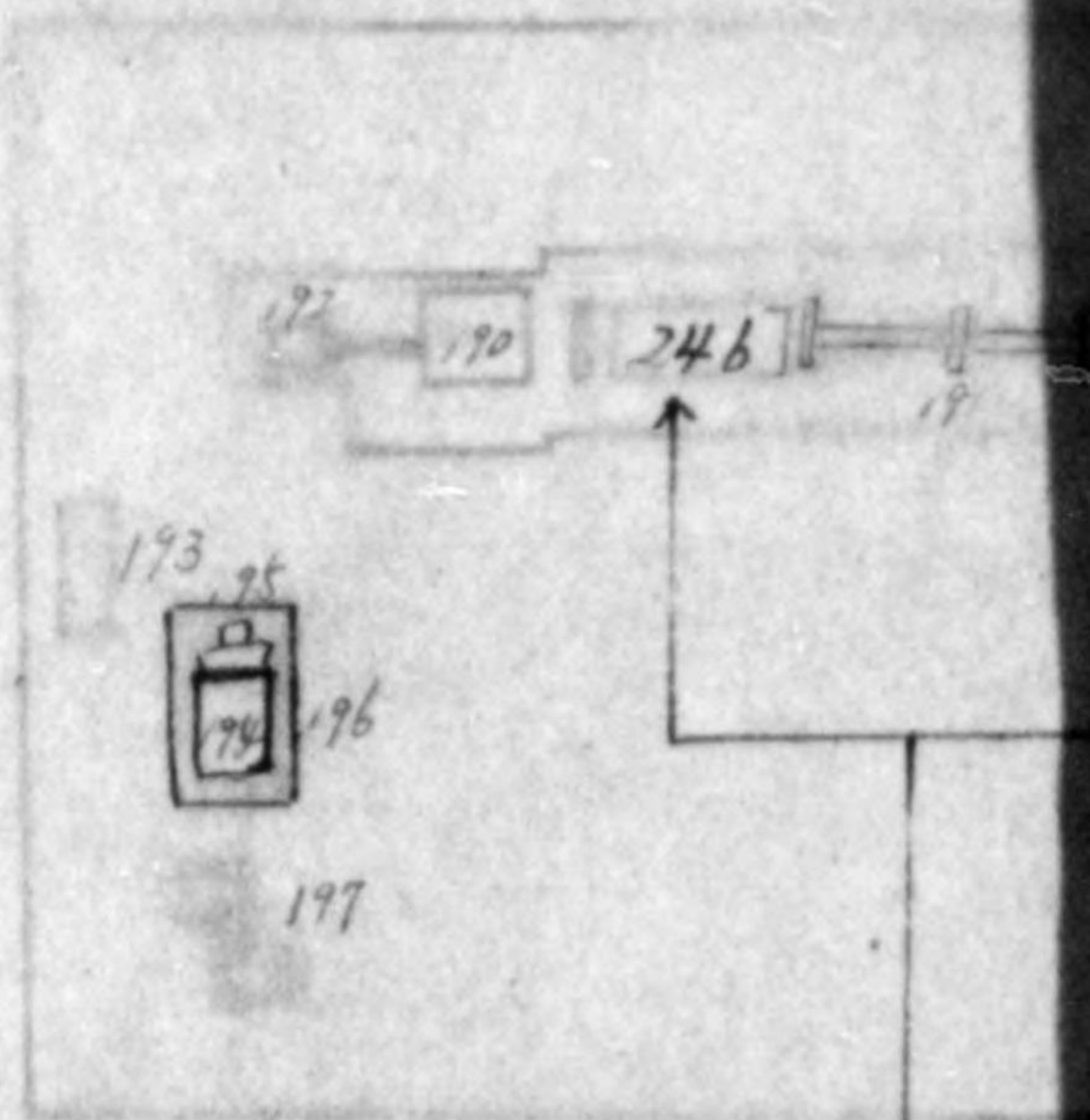

merizing plant

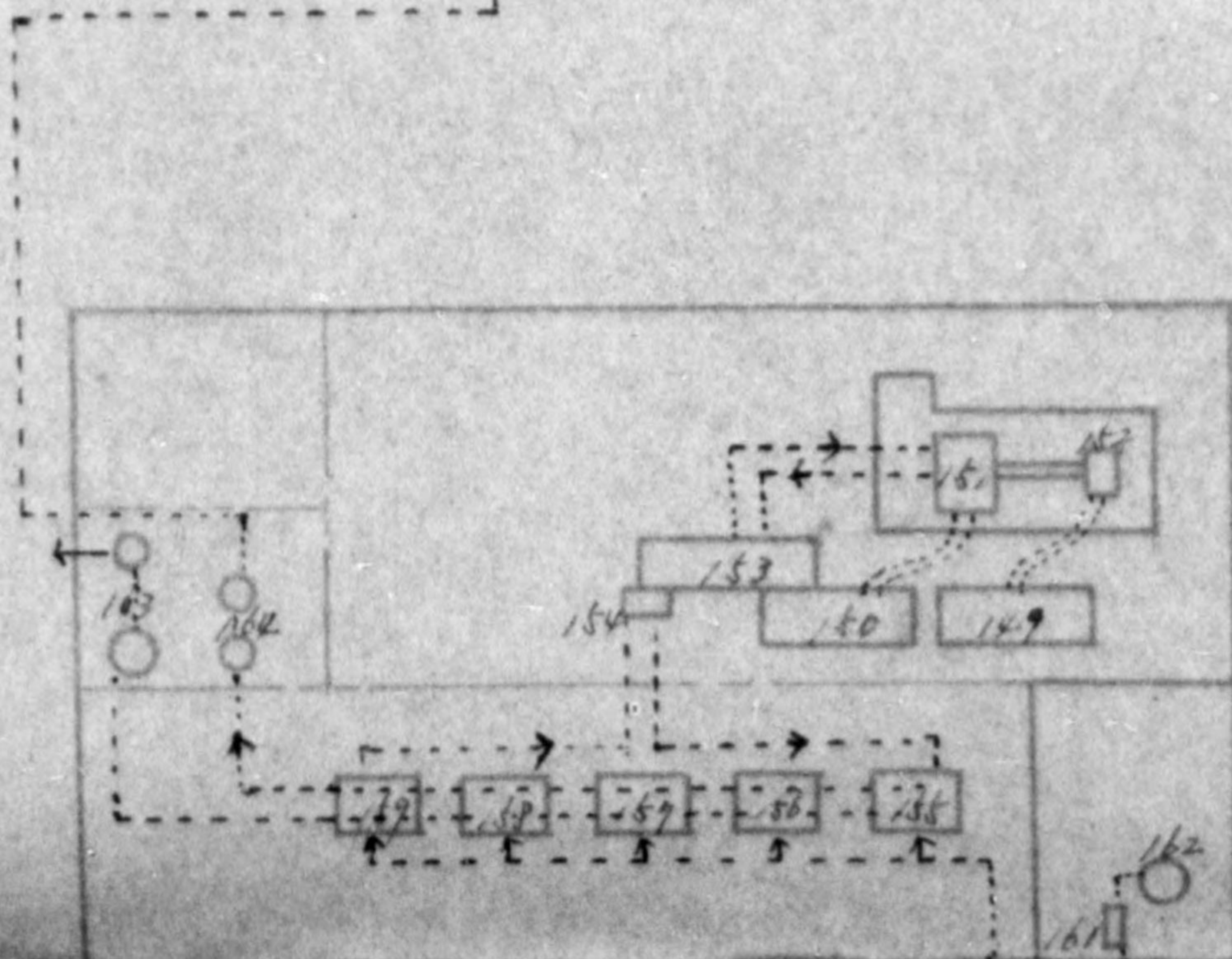

- 1434~1633
- 1414~1433
- 1374~1413
- 1374~1393
- 374~1373

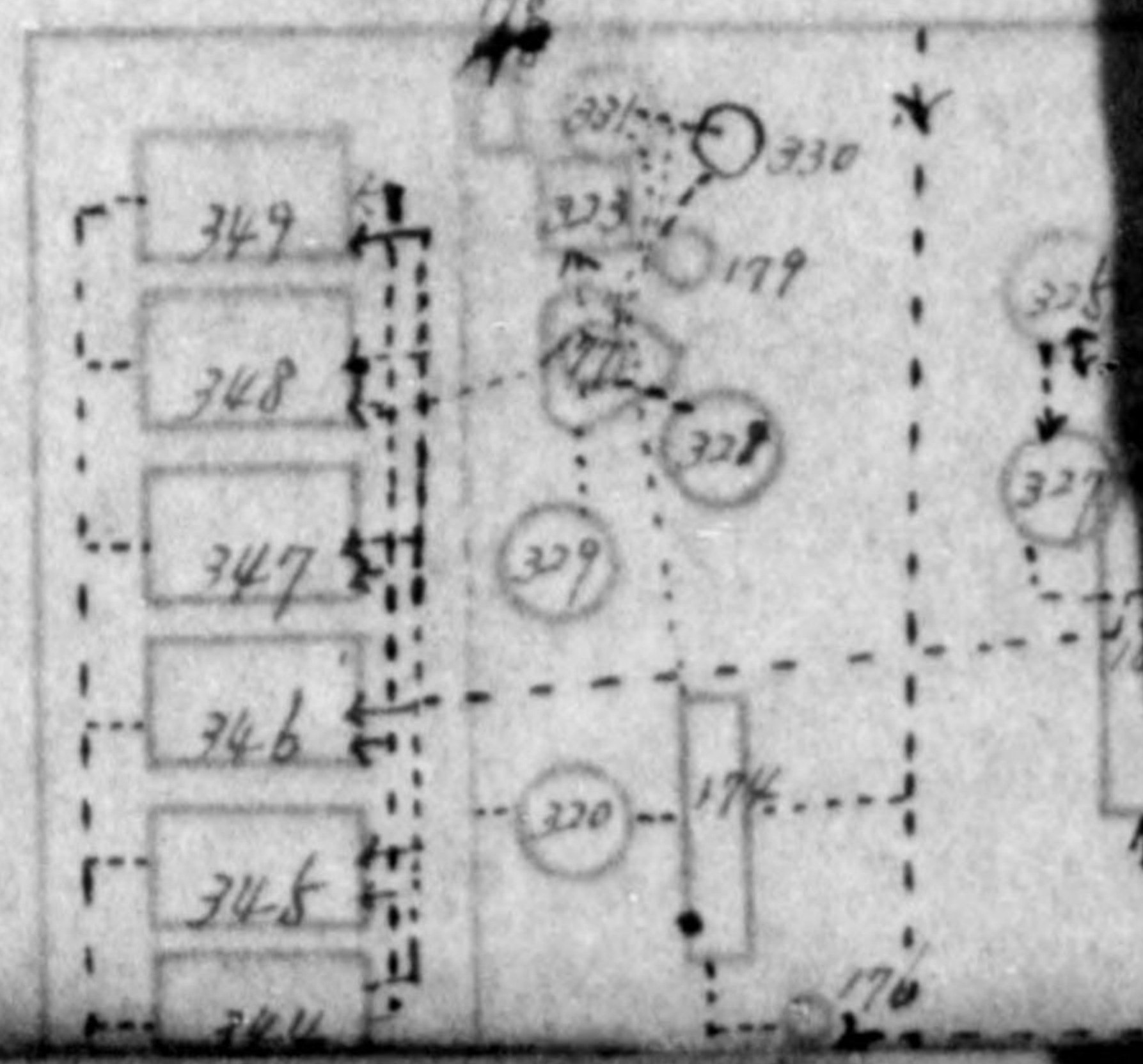

blue number : Process Equipment
 red number : Auxiliary Equipment

up room No. 2

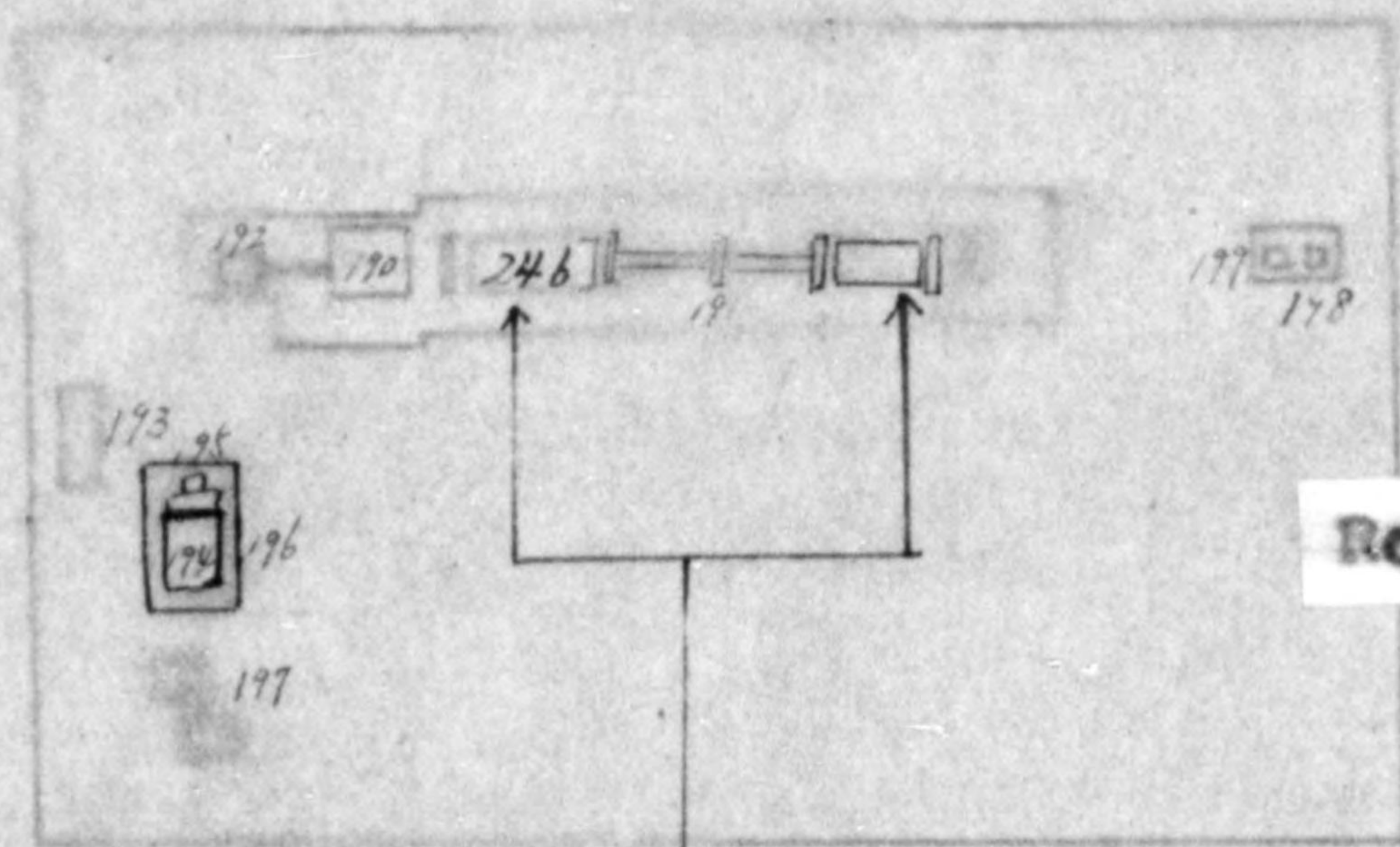

Rolling machine

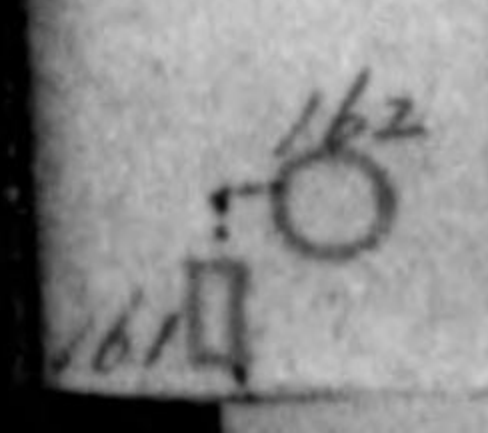
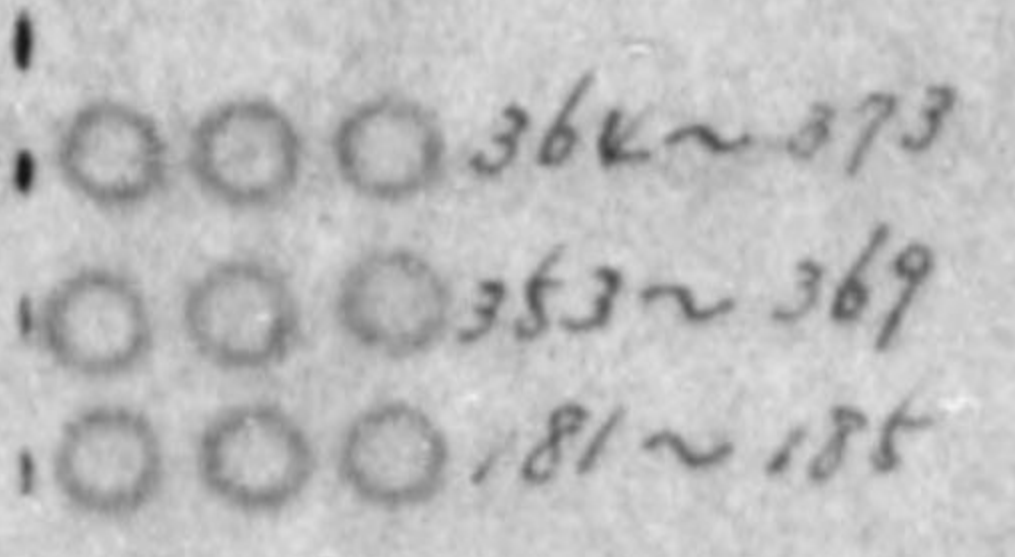
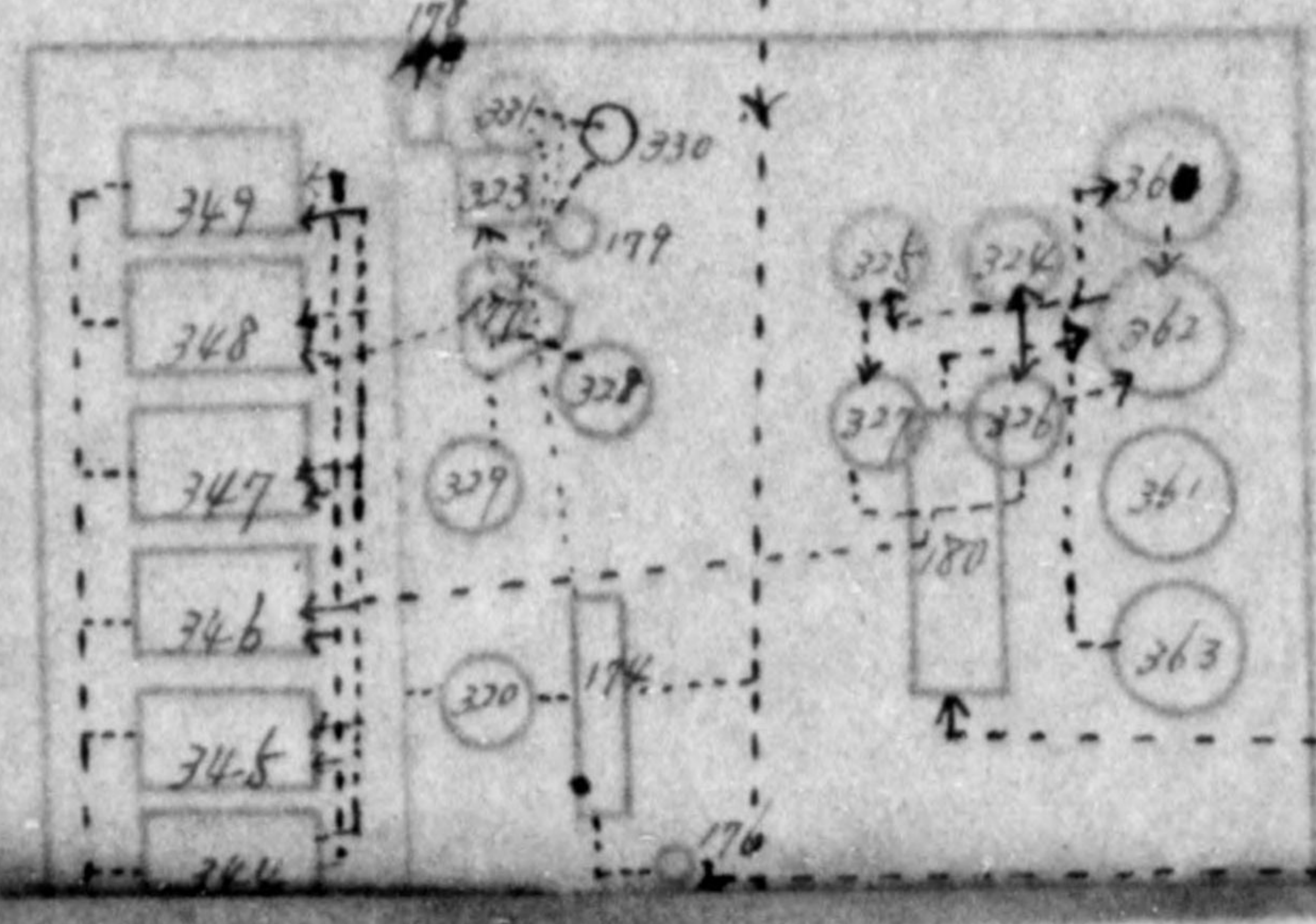
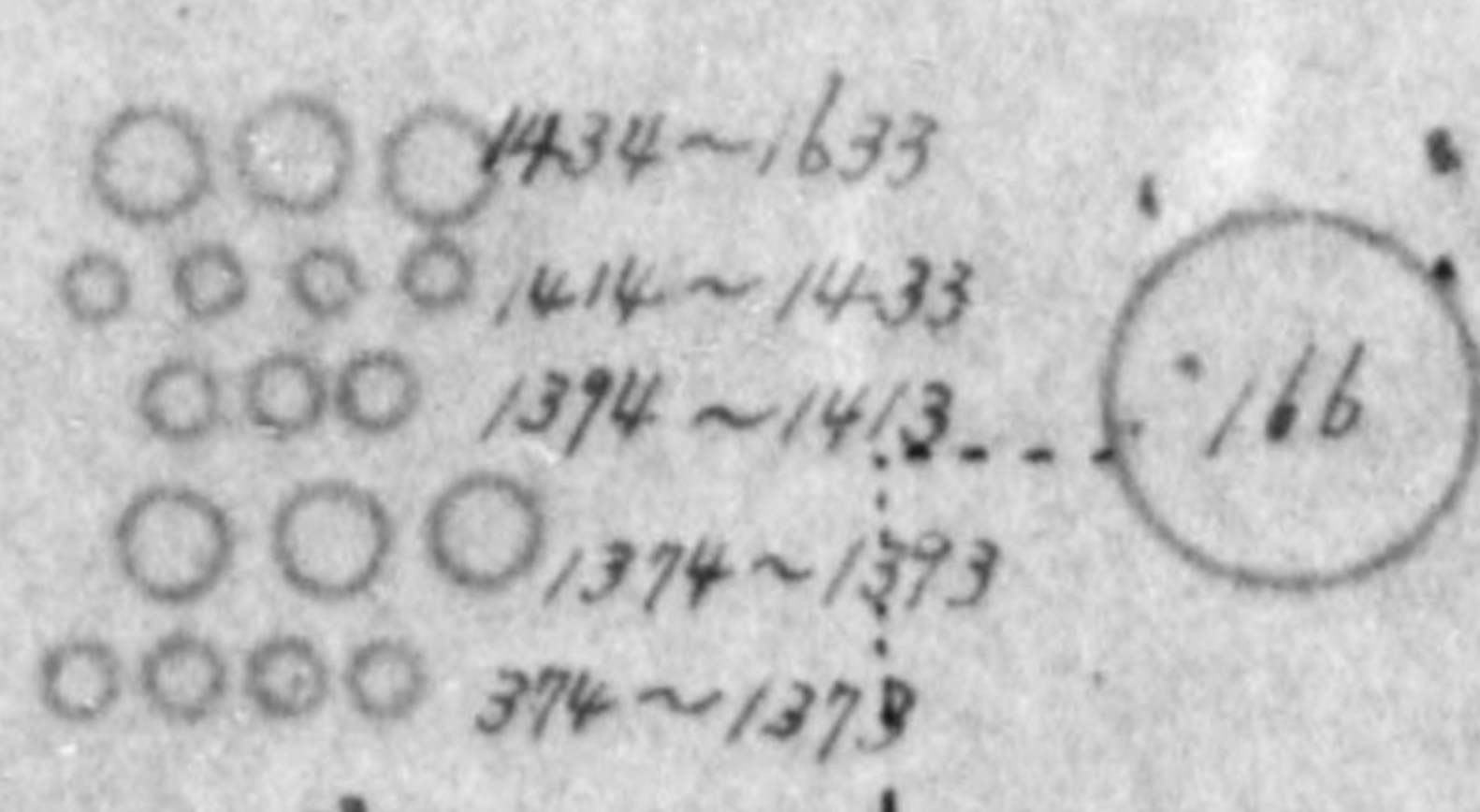

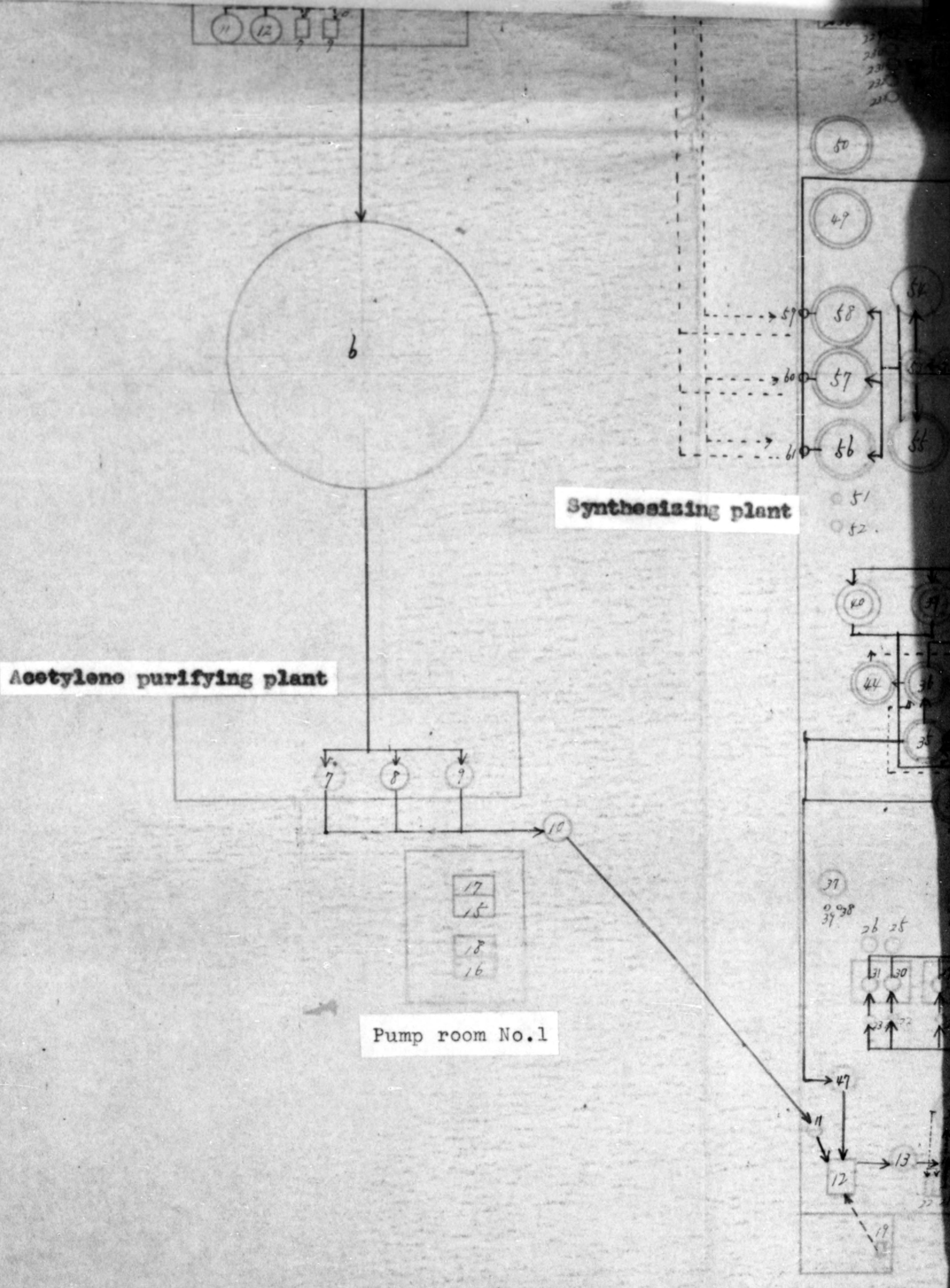

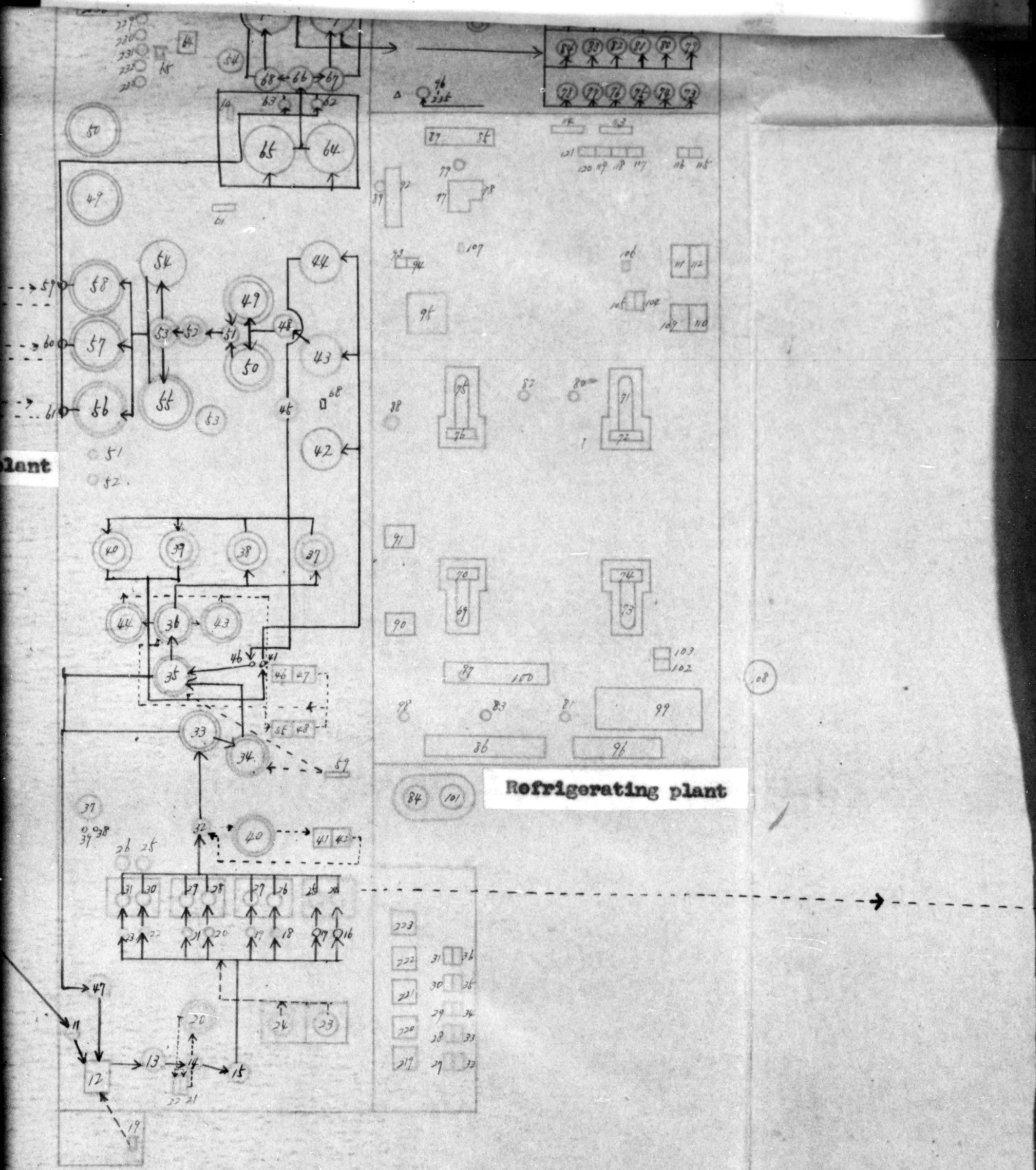

lant

Refrigerating plant

- 223
- 222 31 36
- 221 30 35
- 220 29 34
- 219 28 33
- 218 27 32

775013

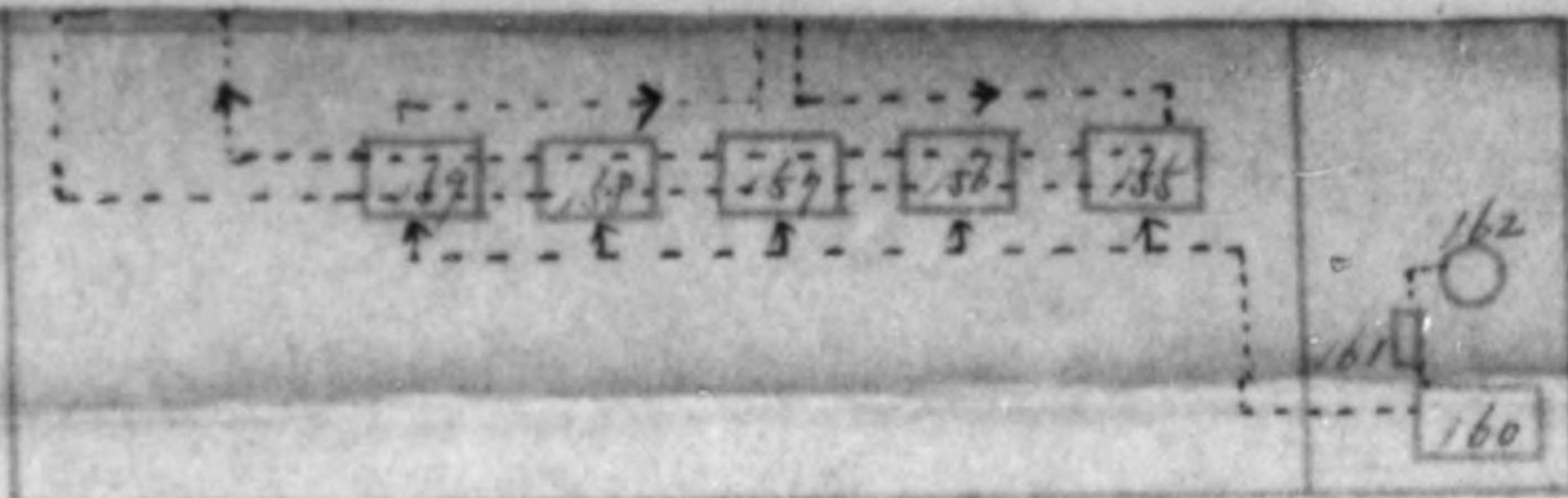

Electrolyzer of water

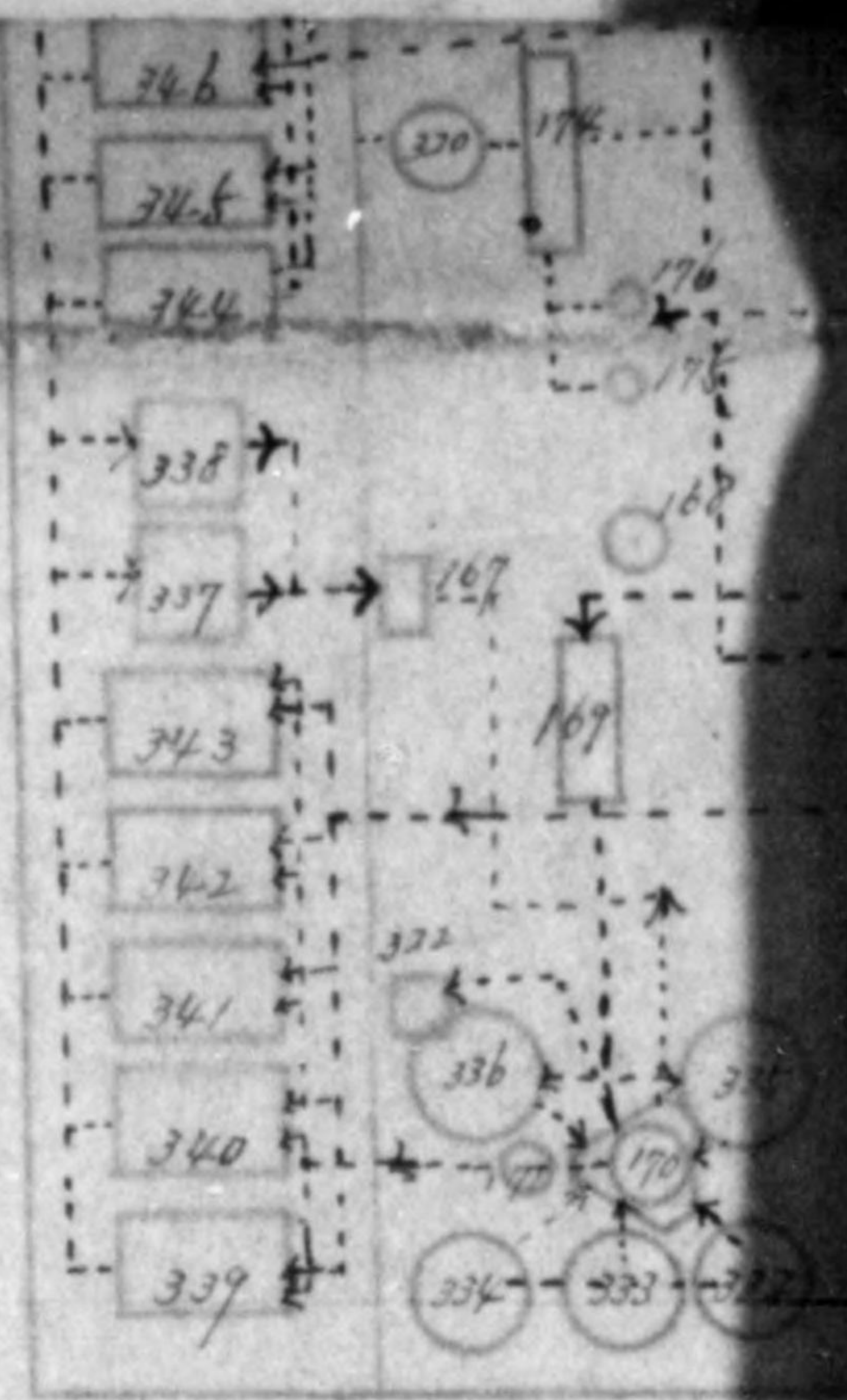

Regenerating plant

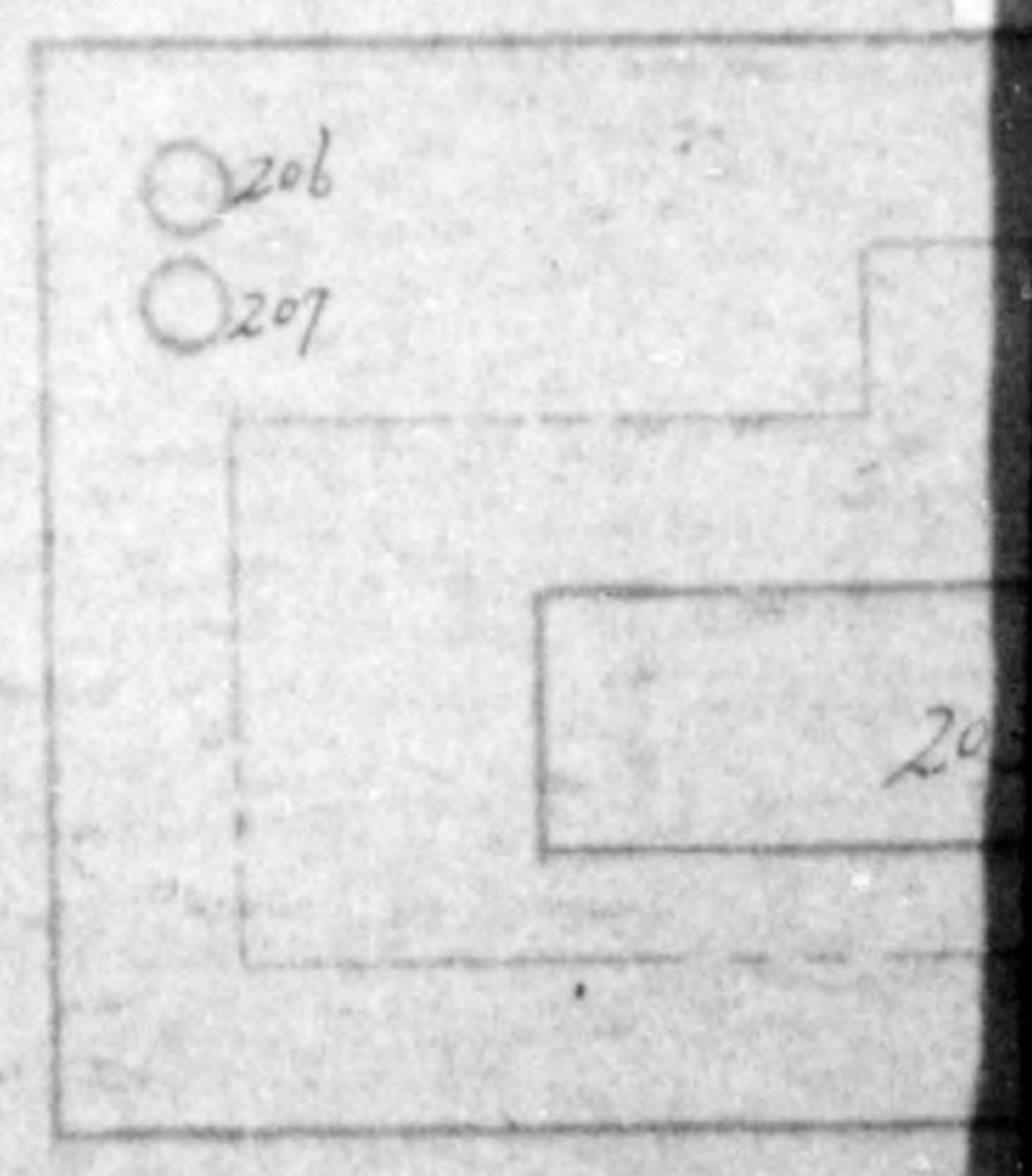
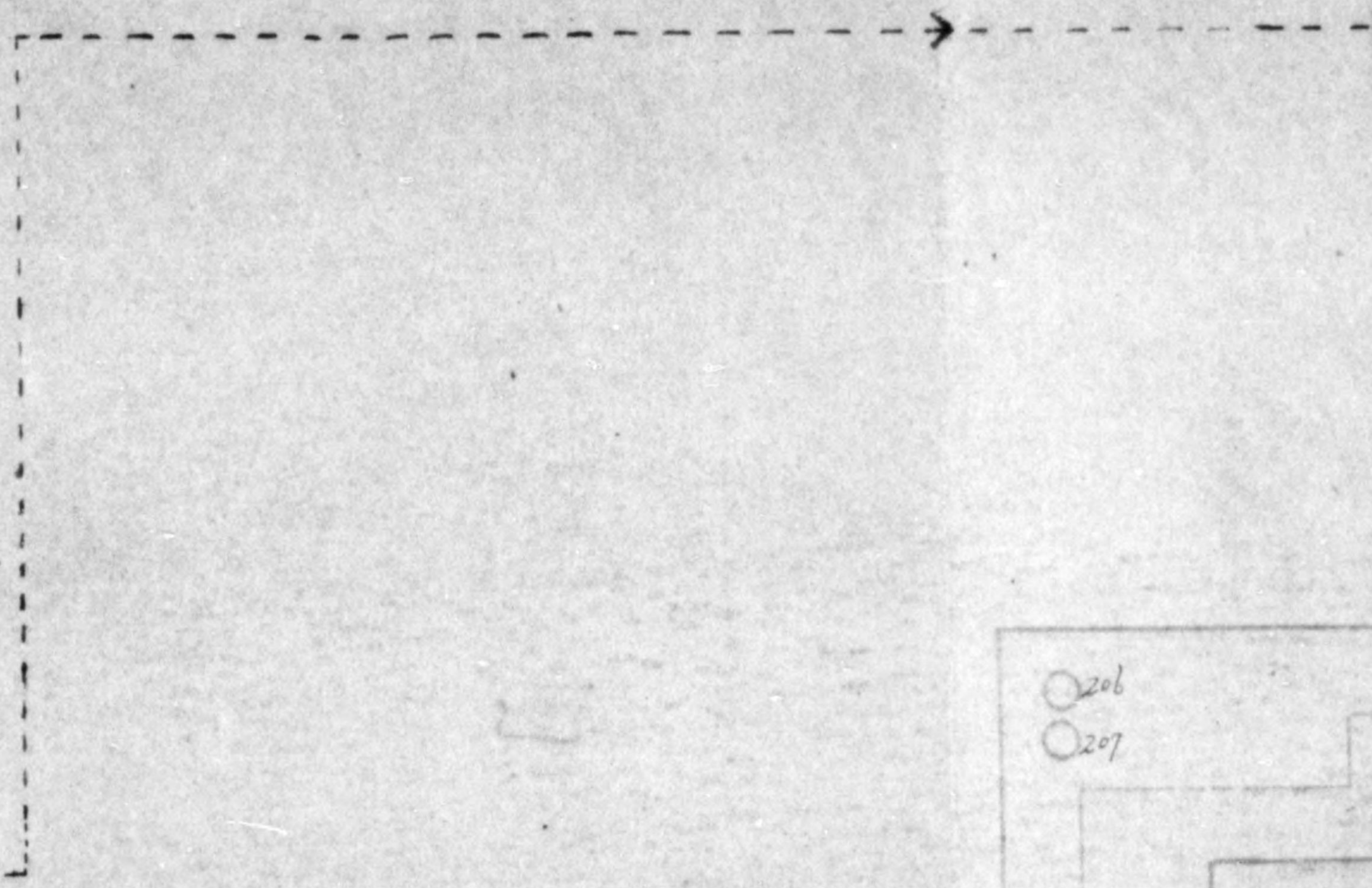

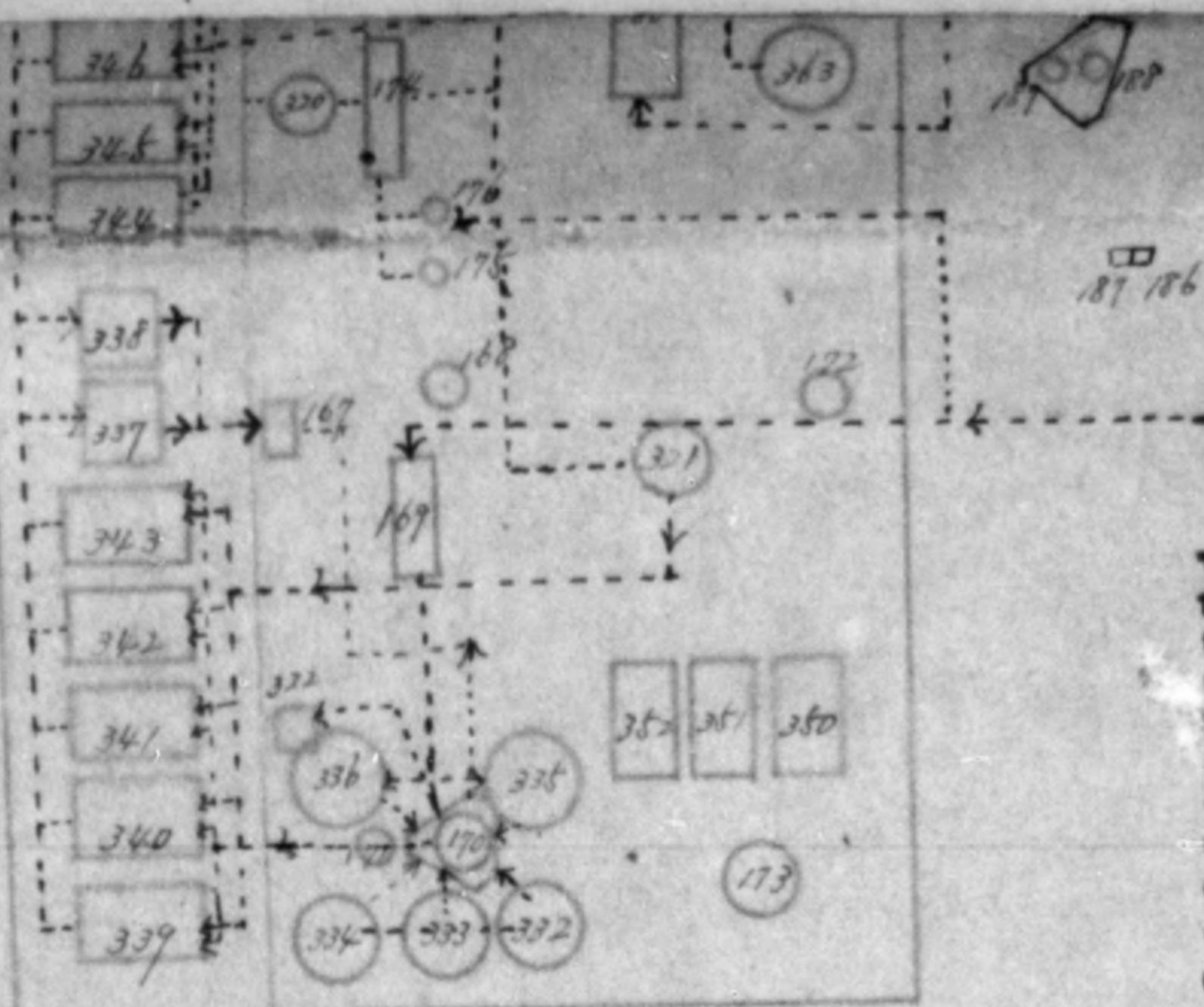

Regenerating plant of catalyst

Boiler room

