

AGBU
811

FOREST ATLAS

GENERAL CLASSIFICATION

Commercial Timber	
	Less than 2,000 B.F. per acre
	2,000 to 5,000 B.F. per acre
	5,000 to 10,000 B.F. per acre
	10,000 to 25,000 B.F. per acre
	25,000 to 50,000 B.F. per acre
	Woodland, cordwood, poles, etc.
	Chaparral or brush
	Sagebrush
	Grassland, parks, etc.
	Barren, above timberline, etc.
	Desert
	Burn, not restocking
	Burn, scattering trees
	Burn, forest cover established
	Windfall
	Bug-killed or diseased
	Old cutting, less than 1/4 of the merchantable timber removed
	Old cutting, 1/4 to 3/8 of the merchantable timber removed
	Old cutting, 3/8 to all of the merchantable timber removed
	Timber sales, less than 1/4 of the merchantable timber removed
	Timber sales, 1/4 to 3/8 of the merchantable timber removed
	Timber sales, 3/8 to all of the merchantable timber removed
	Cultivated
	Irrigated

TITLE

	Alienations
	Permanent alienations
	State lands, approved
	State lands, not approved
I	Indian allotments
L	Lieu selections
RP	Railway lands, patented
R	Railway lands, not patented
HP	Homesteads, patented
H	Homesteads, not patented
CE	Cash entry
T	Timber and stone
C	Coal entry
TE	Townsite entry
	Mineral lode claims, patented
	Mineral placer claims, patented
	Mineral mill site, patented
	Mineral classification

GRAZING MAP LEGEND

	Supervisor's headquarters
	Supervisor's division
	Ranger's division
	Grazing districts
	Open for all stock
	Open for cattle and horses only.
	Open for sheep and goats only
	Closed for all stock
	Lambing grounds
	Driveways for stock
	Corral

CONVENTIONAL SIGNS

	Block line
	Compartment line, sales
	Boundary line for all other classifications
	Grant line
	Telegraph line
	Telephone line
	Power line
	Pipe line
	Aqueduct
	Railroad
	Tramway
	Wire rope conveyor
	Wagon road
	Secondary or private road
	Pack trail
	Foot trail
	Fire line
	Fence
	Ditch
	Flume
	Slide
	Log driving route
	Rollway
	Skidway
	Bridge
	Ferry
	Ford
	Sowing
	Nursery
	Corral
	Supervisor's headquarters
	Ranger's headquarters
	House
	Railroad station
	Stage station
	Power station
	Hotel
	School
	Church
	Cemetery
	Telegraph office
	Telephone office
	Cabin
	Dairy
	Logging camp
	Sawmill, portable
	Sawmill, stationary
	Grist mill
	Grist and sawmill
	Apiary
	Mine location, unpatented

	Supervisor's headquarters
	Ranger's headquarters

	House
	Railroad station
	Stage station
	Power station
	Hotel
	School
	Church
	Cemetery
	Telegraph office
	Telephone office
	Cabin
	Dairy
	Logging camp
	Sawmill, portable
	Sawmill, stationary
	Grist mill
	Grist and sawmill
	Apiary
	Mine location, unpatented

U.S. Improvements made by the United States are marked U. S.

Proposed improvements are shown by the appropriate sign and are designated by "Proposed" on the margin of the maps

Abandoned improvements are shown by zeros 0 0 0 0 and designated on the margin of the maps

ALPHA-NUMERIC SYMBOLS FOR WESTERN COMMERCIAL TREE SPECIES

These will be used on maps, where limited space makes necessary, in the following manner:

D129 = *Pseudotsuga taxifolia*, average stand 29,000 B.M. per acre

Q612 = *Quercus agrifolia*, average stand 12 cords per acre

T67 = *Thuja plicata*, average stand 7 tele-poles per acre

P0	<i>Pinus murrayana</i>	Lodgepole Pine
1	<i>flexilis</i>	Limber Pine
2	<i>monticola</i>	Western White Pine
3	<i>lambertiana</i>	Sugar Pine
4	<i>ponderosa</i>	Yellow Pine
5	<i>coulteri</i>	Coulter Pine
6	<i>sabiniana</i>	Gray Pine
7	<i>jeffreyi</i>	Jeffrey Pine
8	<i>radiata</i>	Monterey Pine
9	<i>attenuata</i>	Knobcone Pine
B2	<i>strobiformis</i>	Mexican White Pine
5	<i>albicaulis</i>	White-bark Pine
6	<i>torreyana</i>	Torrey Pine
7	<i>edulis</i>	Pinon
9	<i>monophylla</i>	Single-leaf Pinon
A1	<i>Abies magnifica</i>	Magnificent Fir
2	<i>concolor</i>	White Fir
3	<i>shastensis</i>	Shasta Fir
4	<i>nobilis</i>	Noble Fir
5	<i>lasiocarpa</i>	Alpine Fir
6	<i>grandis</i>	Lowland Fir
7	<i>arizonica</i>	Arizona Cork Fir
8	<i>amabilis</i>	Lovely Fir
9	<i>venusta</i>	Bristle-cone Fir
S2	<i>Picea engelmanni</i>	Engelmann Spruce
3	<i>parryana</i>	Blue Spruce
5	<i>breweriana</i>	Weeping Spruce
6	<i>sitchensis</i>	Sitka Spruce
D1	<i>Pseudotsuga taxifolia</i>	Douglas Fir (Red)
5	<i>macrocarpa</i>	Bigcone Spruce
H5	<i>Tsuga mertensiana</i>	Black Hemlock
6	<i>heterophylla</i>	Western Hemlock
R1	<i>Sequoia sempervirens</i>	Redwood
5	<i>washingtoniana</i>	Bigtree
C5	<i>Chamaecyparis nootkatensis</i>	Yellow Cedar
6	<i>lawsoniana</i>	Port Orford Cedar
T6	<i>Thuja plicata</i>	Red Cedar
L5	<i>Larix lyallii</i>	Alpine Larch
7	<i>occidentalis</i>	Western Larch
O5	<i>Libocedrus decurrens</i>	Incense Cedar
K5	<i>Cupressus macnabiana</i>	Macnab Cypress
6	<i>macrocarpa</i>	Monterey Cypress
7	<i>arizonica</i>	Arizona Cypress
8	<i>goveniana</i>	Gowen Cypress
J1	<i>Juniperus utahensis</i>	Utah Juniper
2	<i>pachyphloea</i>	Alligator Juniper
4	<i>occidentalis</i>	Western Juniper
5	<i>sabinoides</i>	Mountain Juniper
7	<i>californica</i>	California Juniper
9	<i>monosperma</i>	One seed Juniper
Q0	<i>Quercus chrysolepis</i>	Canyon Live Oak
1	<i>californica</i>	California Black Oak
2	<i>lobata</i>	California White Oak
3	<i>douglasii</i>	Blue Oak
4	<i>garryana</i>	Pacific Post Oak
5	<i>wislizeni</i>	Highland Oak
6	<i>agrifolia</i>	California Live Oak
7	<i>gambelii</i>	Gambel Oak
8	<i>densiflora</i>	California Tanbark Oak
9	<i>engelmanni</i>	Engelmann Oak
M2	<i>Acer macrophyllum</i>	Oregon Maple
5	<i>glabrum</i>	Dwarf Maple
9	<i>negundo californicum</i>	California Boxelder
W0	<i>Populus trichocarpa</i>	Black Cottonwood
2	<i>fremontii</i>	Fremont Cottonwood
5	<i>tremuloides</i>	Aspen
7	<i>angustifolia</i>	Narrowleaf Cottonwood.
F1	<i>Fraxinus pennsylvanica</i>	Red Ash
6	<i>oregona</i>	Oregon Ash
8	<i>lancolata</i>	Green Ash
U1	<i>Prunus demissa</i>	Western Choke Cherry
Y7	<i>Platanus wrightii</i>	Arizona Sycamore
8	<i>racemosa</i>	California Sycamore
X0	<i>Salix lasiandra</i>	Western Black Willow
2	<i>sessilifolia</i>	Silverleaf Willow
9	<i>amygdaloides</i>	Almondleaf Willow

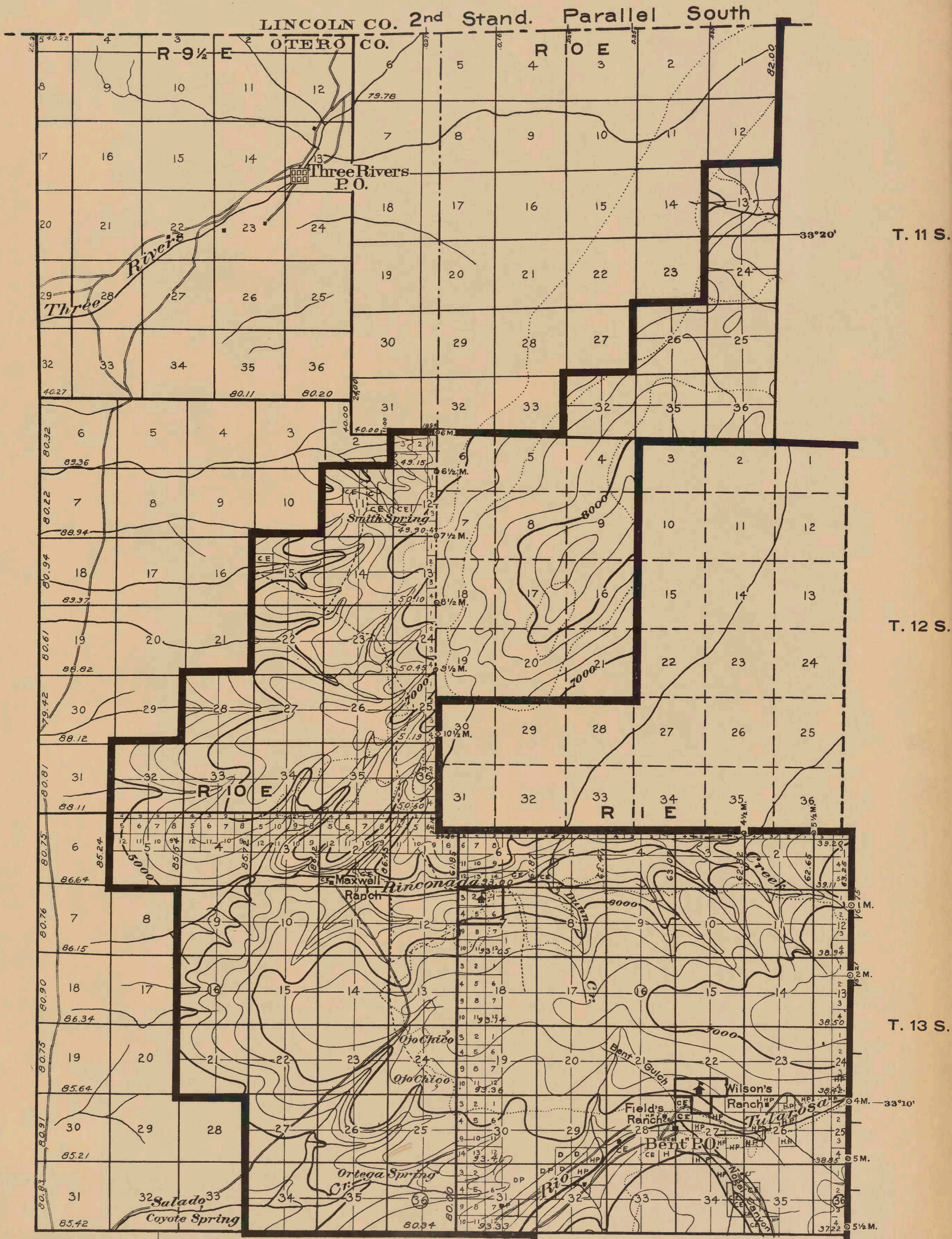

106°00'
 COMPILATION
 Topography from U. S. Geological Survey maps
 Land lines from General Land Office plats
 Classification by Forest Service

JAN., 1909
 ALAMO

R. 10 E.

R. 11 E.

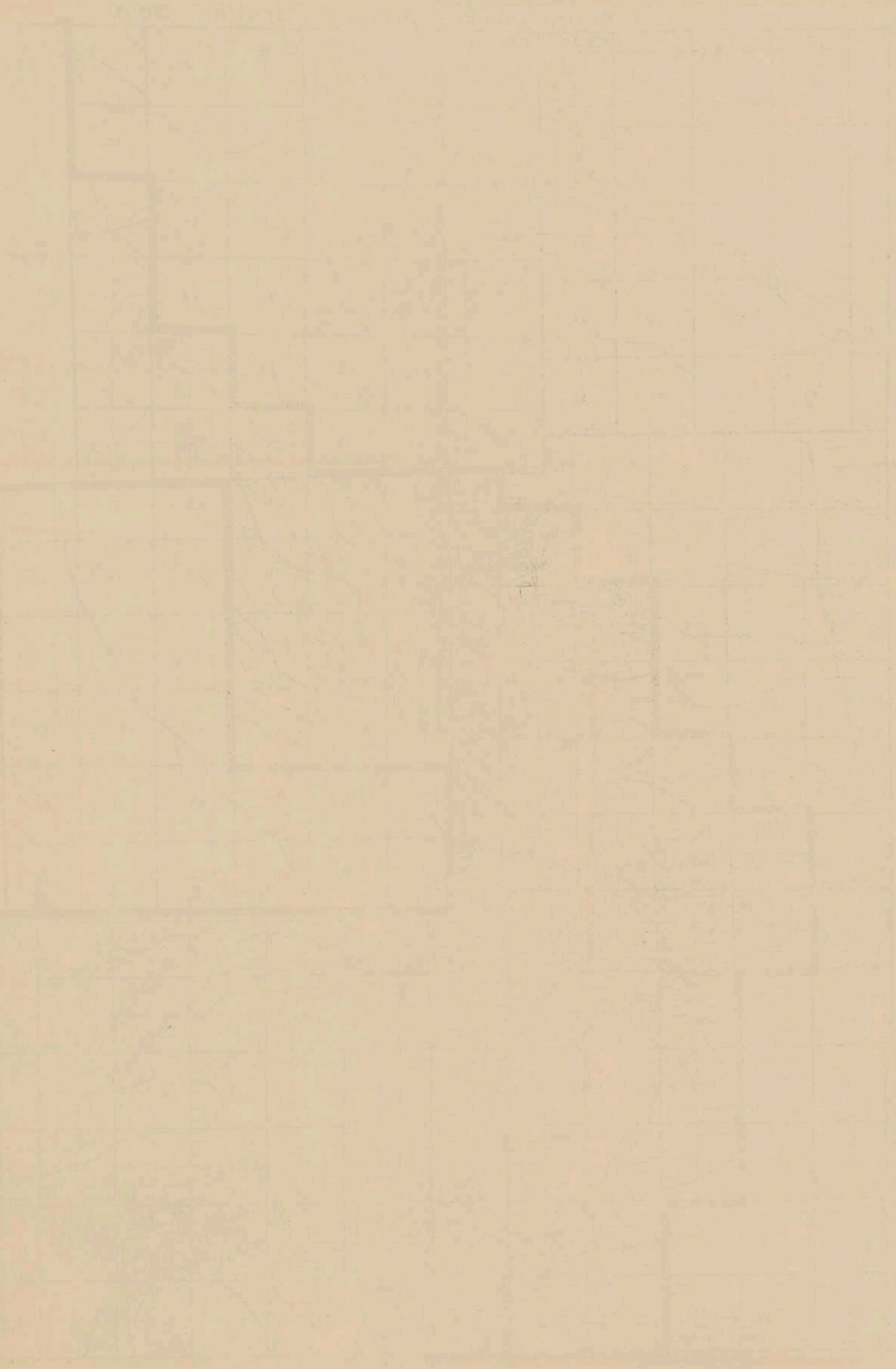

LINCOLN CO. 2nd Stand. Parallel South

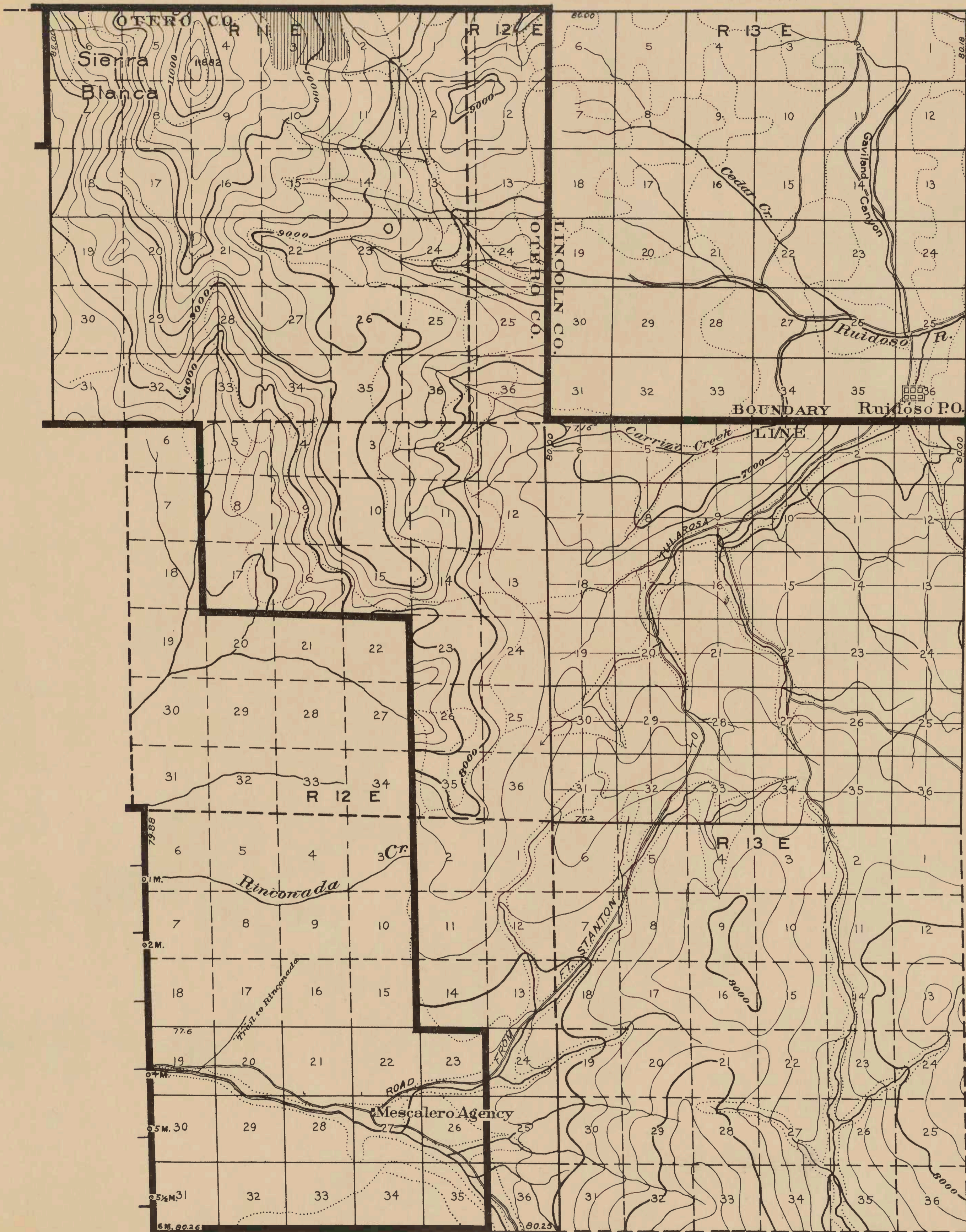

T. 11 S.
33°20'

T. 12 S.

33°10'
T. 13 S.

COMPILATION
 Topography from U. S. Geological Survey maps
 Land lines from General Land Office plats
 Classification by Forest Service

R. 12 E.

R. 13 E.

JAN. 1909
ALAMO

105°20'

Date	Description	Debit	Credit	Balance
1880				
Jan 1	Balance			
Jan 5	...			
Jan 10	...			
Jan 15	...			
Jan 20	...			
Jan 25	...			
Jan 30	...			
Feb 1	...			
Feb 5	...			
Feb 10	...			
Feb 15	...			
Feb 20	...			
Feb 25	...			
Feb 30	...			
Mar 1	...			
Mar 5	...			
Mar 10	...			
Mar 15	...			
Mar 20	...			
Mar 25	...			
Mar 30	...			
Apr 1	...			
Apr 5	...			
Apr 10	...			
Apr 15	...			
Apr 20	...			
Apr 25	...			
Apr 30	...			
May 1	...			
May 5	...			
May 10	...			
May 15	...			
May 20	...			
May 25	...			
May 30	...			
Jun 1	...			
Jun 5	...			
Jun 10	...			
Jun 15	...			
Jun 20	...			
Jun 25	...			
Jun 30	...			
Jul 1	...			
Jul 5	...			
Jul 10	...			
Jul 15	...			
Jul 20	...			
Jul 25	...			
Jul 30	...			
Aug 1	...			
Aug 5	...			
Aug 10	...			
Aug 15	...			
Aug 20	...			
Aug 25	...			
Aug 30	...			
Sep 1	...			
Sep 5	...			
Sep 10	...			
Sep 15	...			
Sep 20	...			
Sep 25	...			
Sep 30	...			
Oct 1	...			
Oct 5	...			
Oct 10	...			
Oct 15	...			
Oct 20	...			
Oct 25	...			
Oct 30	...			
Nov 1	...			
Nov 5	...			
Nov 10	...			
Nov 15	...			
Nov 20	...			
Nov 25	...			
Nov 30	...			
Dec 1	...			
Dec 5	...			
Dec 10	...			
Dec 15	...			
Dec 20	...			
Dec 25	...			
Dec 30	...			

2nd

Stand.

Parallel

South

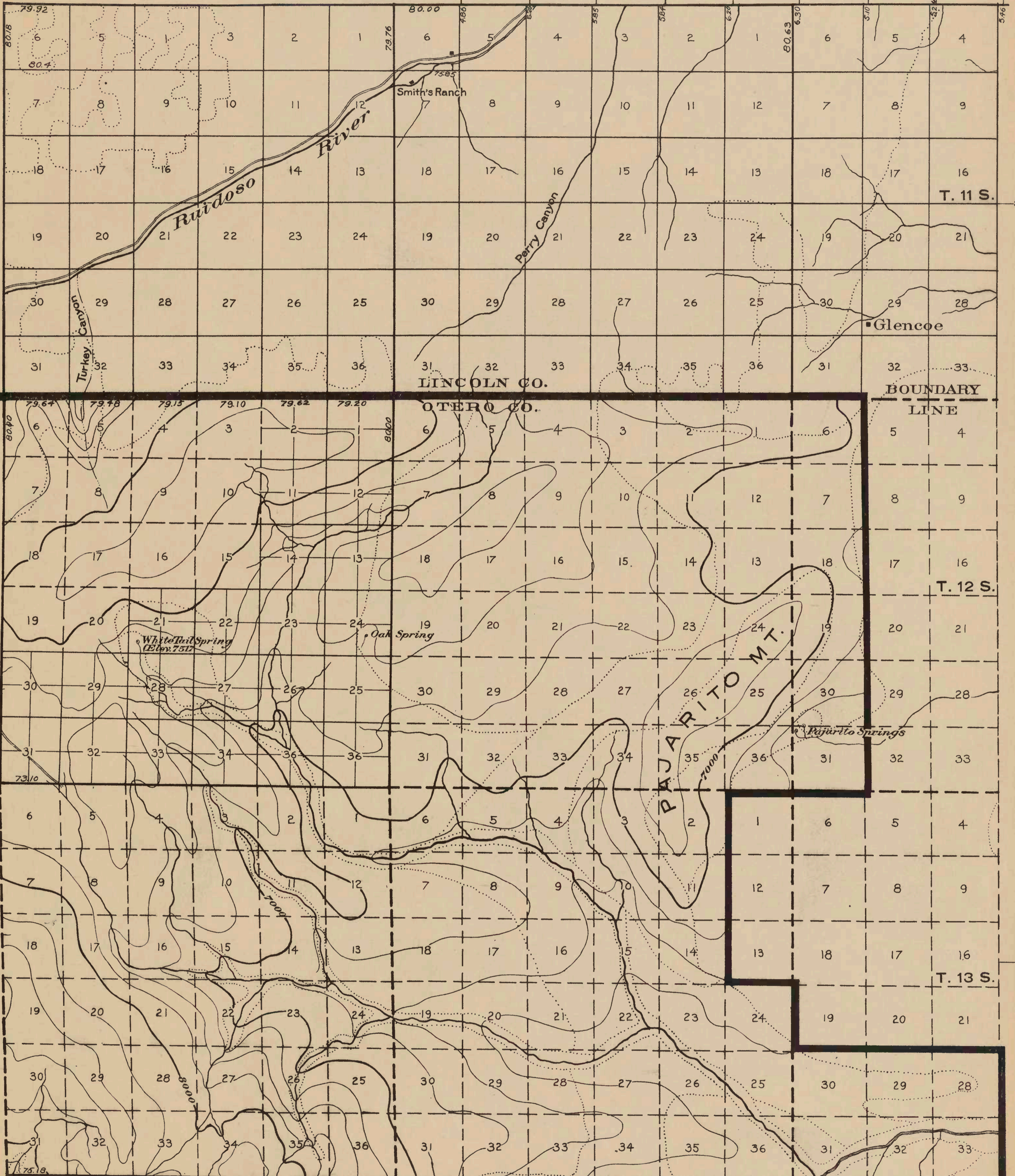

T. 11 S.

33°20'

LINCOLN CO.

OTERO CO.

BOUNDARY LINE

T. 12 S.

T. 13 S.

33°10'

105°30'

COMPILATION
 Topography from U. S. Geological Survey maps
 Land lines from General Land Office plats
 Classification by Forest Service

R. 14 E.

R. 15 E.

JAN. 1909
 ALAMO
 R. 16 E.



T. 14 S.

T. 15 S.

T. 16 S.

7992 7992 1375 7980 1460

COMPILATION
 Topography from U. S. Geological Survey maps
 Land lines from General Land Office plats
 Classification by Forest Service

105°40' JAN. 1909
 ALAMO

R. 11 E.

R. 12 E.

East
 Meridian
 Guide
 Aux.
 1 st.

R. 14 E.

R. 15 E.

T. 14 S.

T. 15 S.

33°00'

T. 16 S.

East
Meridian,
Guide
Aux.
1st.



COMPILATION
 Topography from U. S. Geological Survey maps
 Land lines from General Land Office plats
 Classification by Forest Service

R. 13 E.

105°30'

R. 14 E.

JAN. 1909
 ALAMO

R. 16 E.

R. 17 E.
LINCOLN CO.
CHAVES CO.

T. 14 S.

T. 15 S.

T. 16 S.

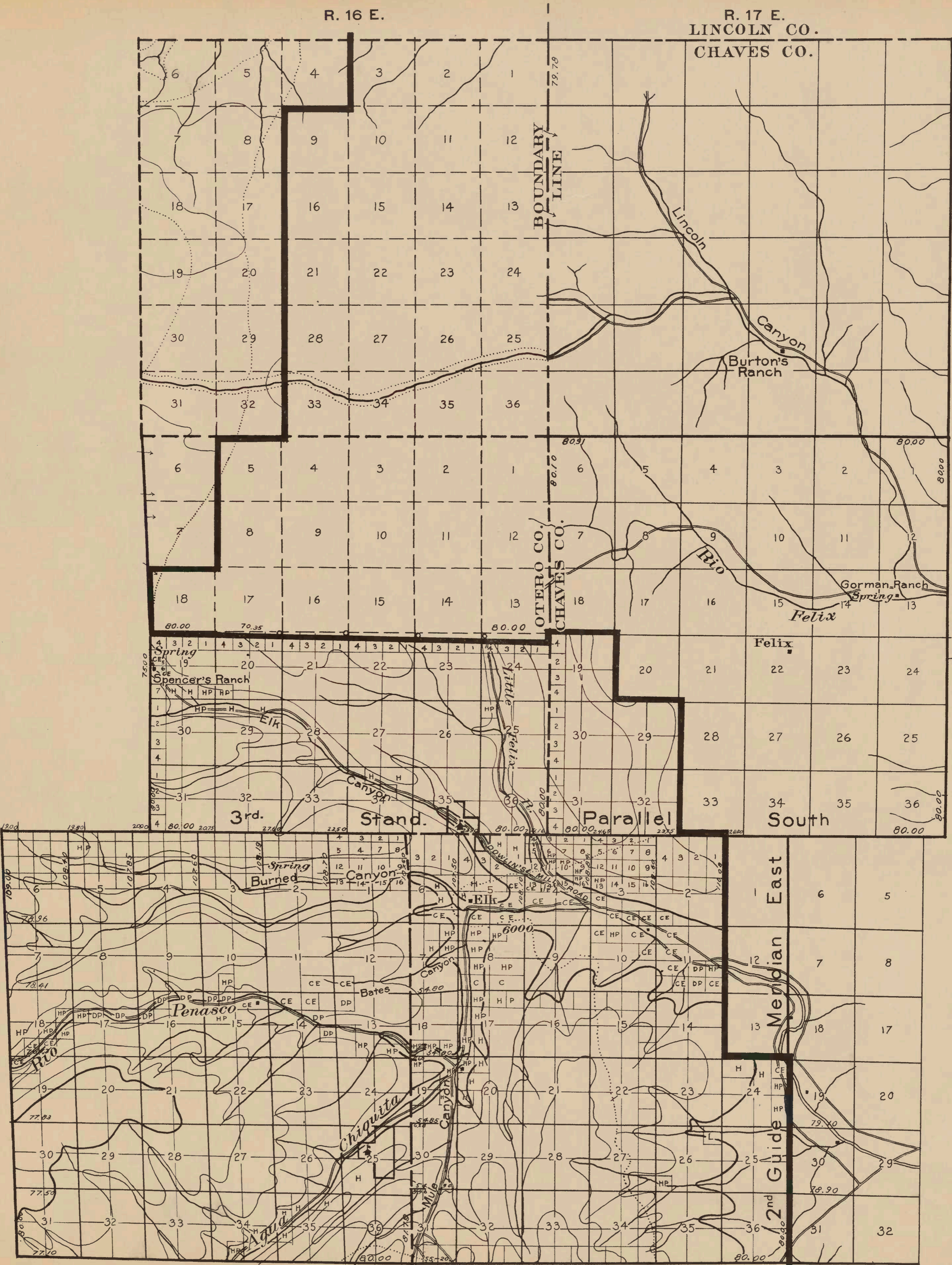

COMPILATION
 Topography from U. S. Geological Survey maps
 Land lines from General Land Office plats
 Classification by Forest Service

R. 15 E.

R. 16 E.

R. 17 E.

105° 20'

JAN., 1909

ALAMO

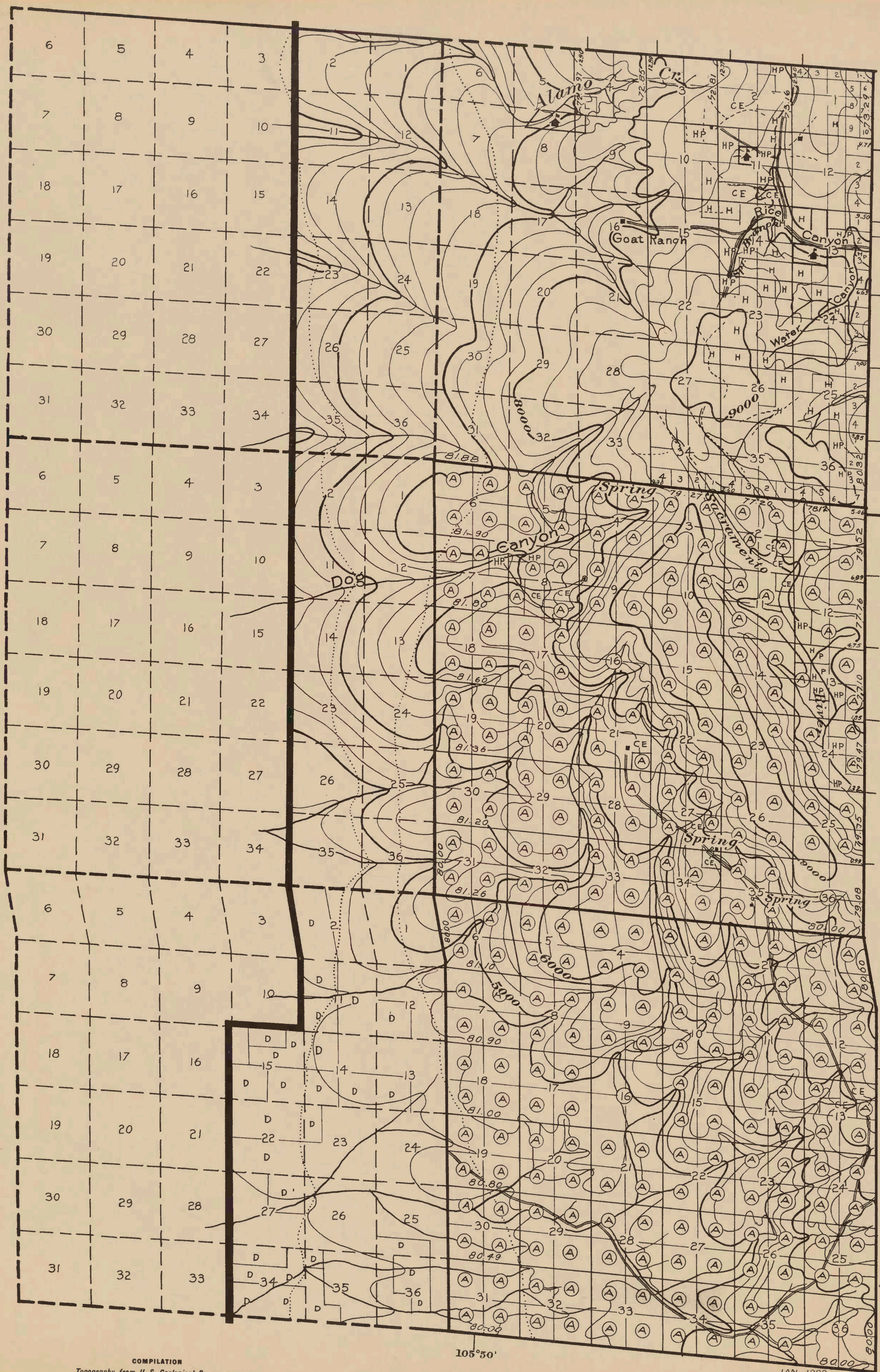

T. 17 S.

T. 18 S.

T. 19 S.

COMPILATION
 Topography from U. S. Geological Survey maps
 Land lines from General Land Office plats
 Classification by Forest Service

R. 10 E.

R. 11 E.

JAN. 1909
ALAMO

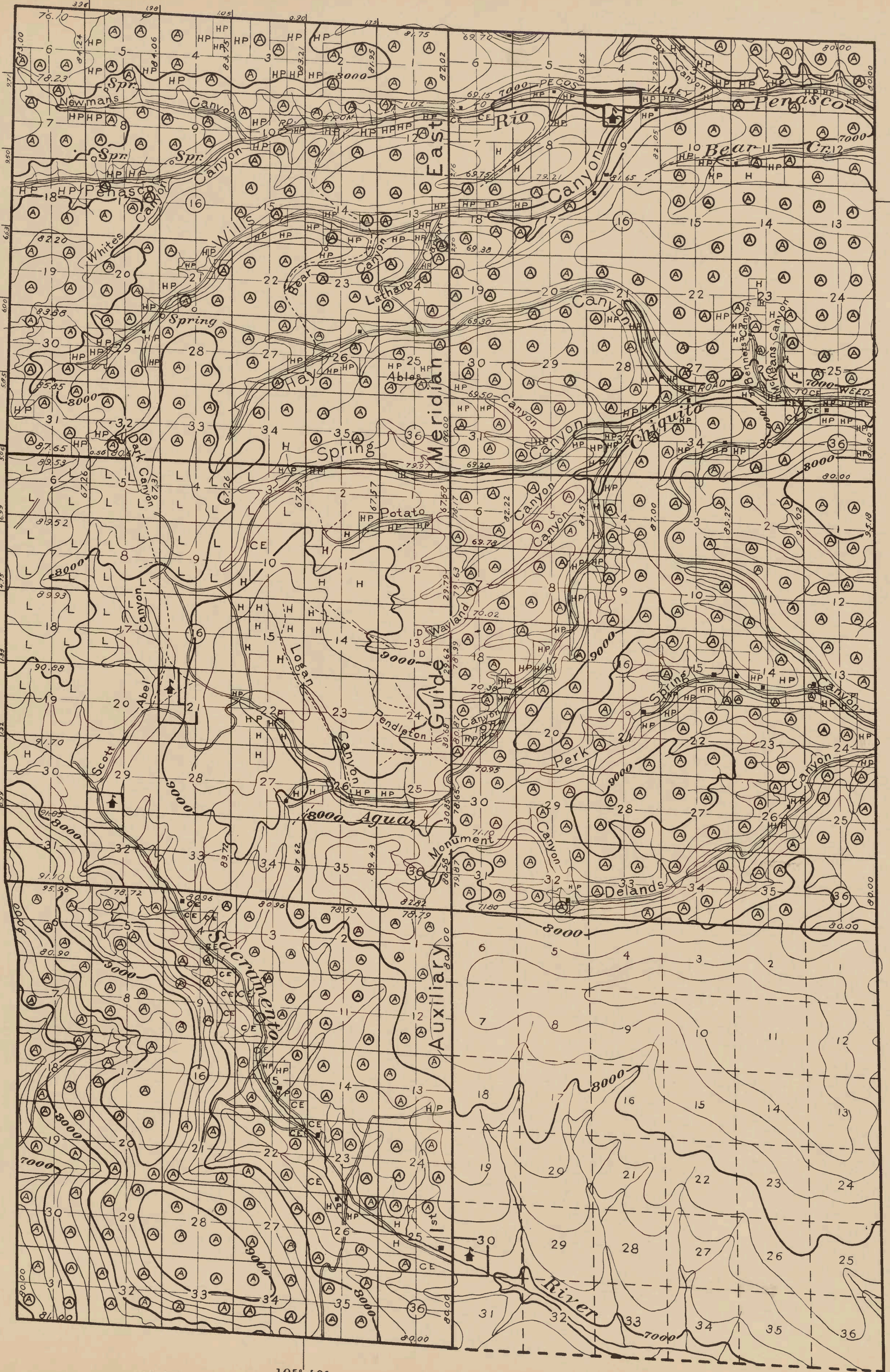

32° 50'

T. 17 S.

T. 18 S.

T. 19 S.

105° 40'

COMPILATION
 Topography from U. S. Geological Survey maps
 Land lines from General Land Office plats
 Classification by Forest Service

JAN. 1909

ALAMO

R. 12 E.

R. 13 E.

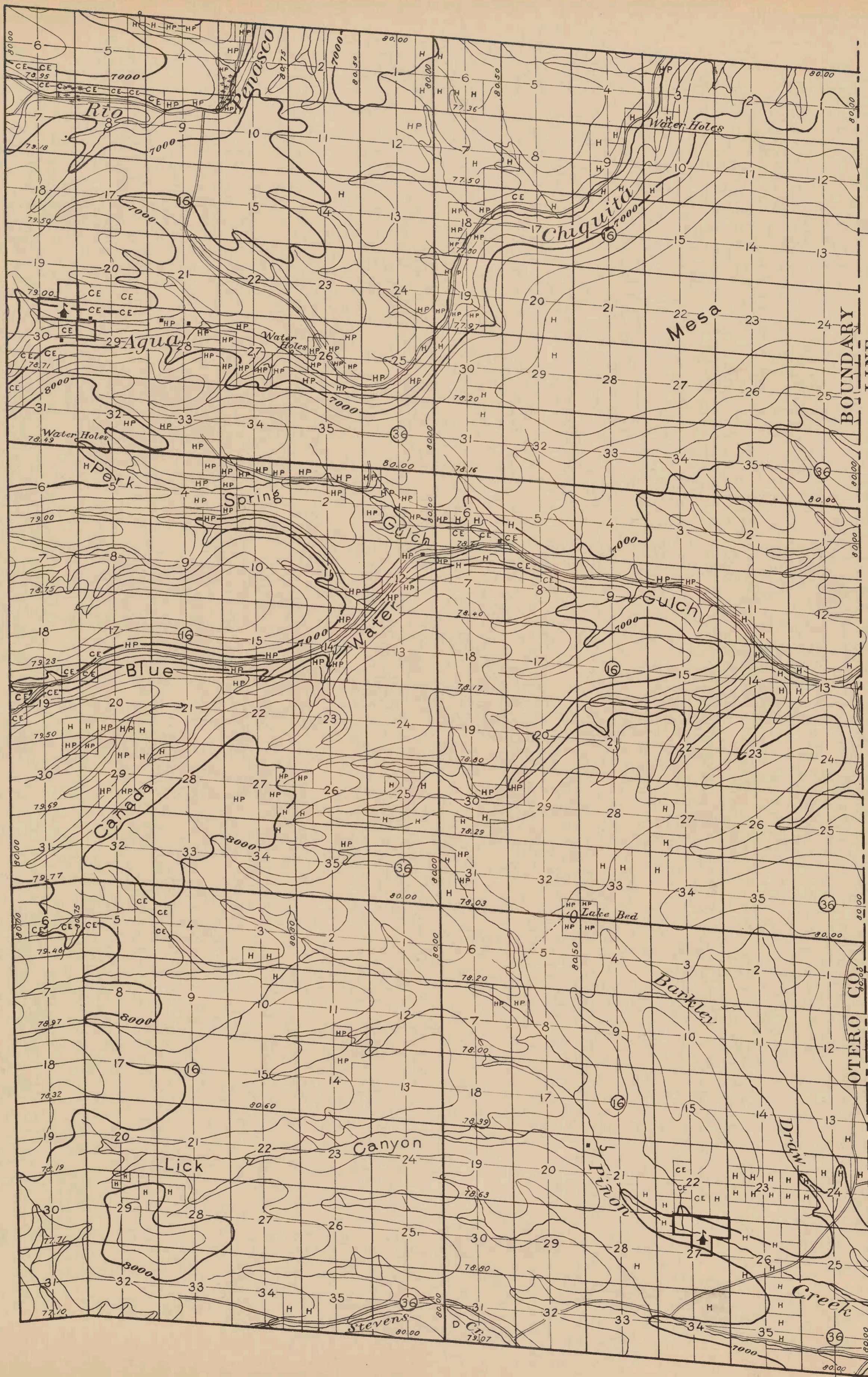

32° 50'
T. 17 S.

T. 18 S.

T. 19 S.

BOUNDARY LINE

OTERO CO.
CHAVES CO.

COMPILATION
 Topography from U. S. Geological Survey maps
 Land lines from General Land Office plats
 Classification by Forest Service

JAN. 1909
ALAMO
 105° 20'

R. 14 E.

R. 15 E.

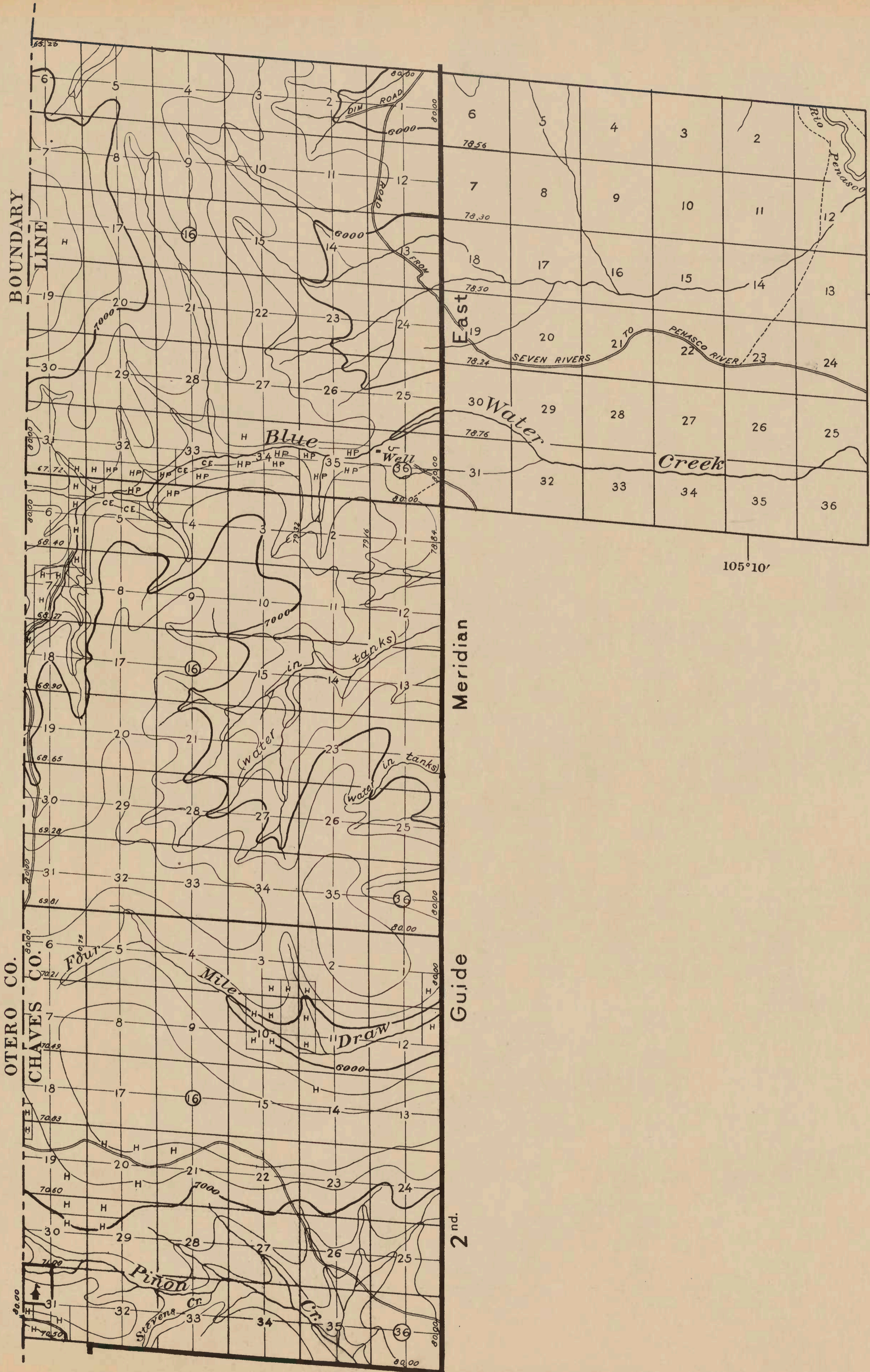

32° 50'
T. 17 S.

T. 18 S.

T. 19 S.

OTERO CO.
CHAVES CO.

Meridian
Guide

2nd.

COMPILATION
Topography from U. S. Geological Survey maps
Land lines from General Land Office plats
Classification by Forest Service

JAN., 1909
ALAMO

R. 16 E.

R. 17 E.

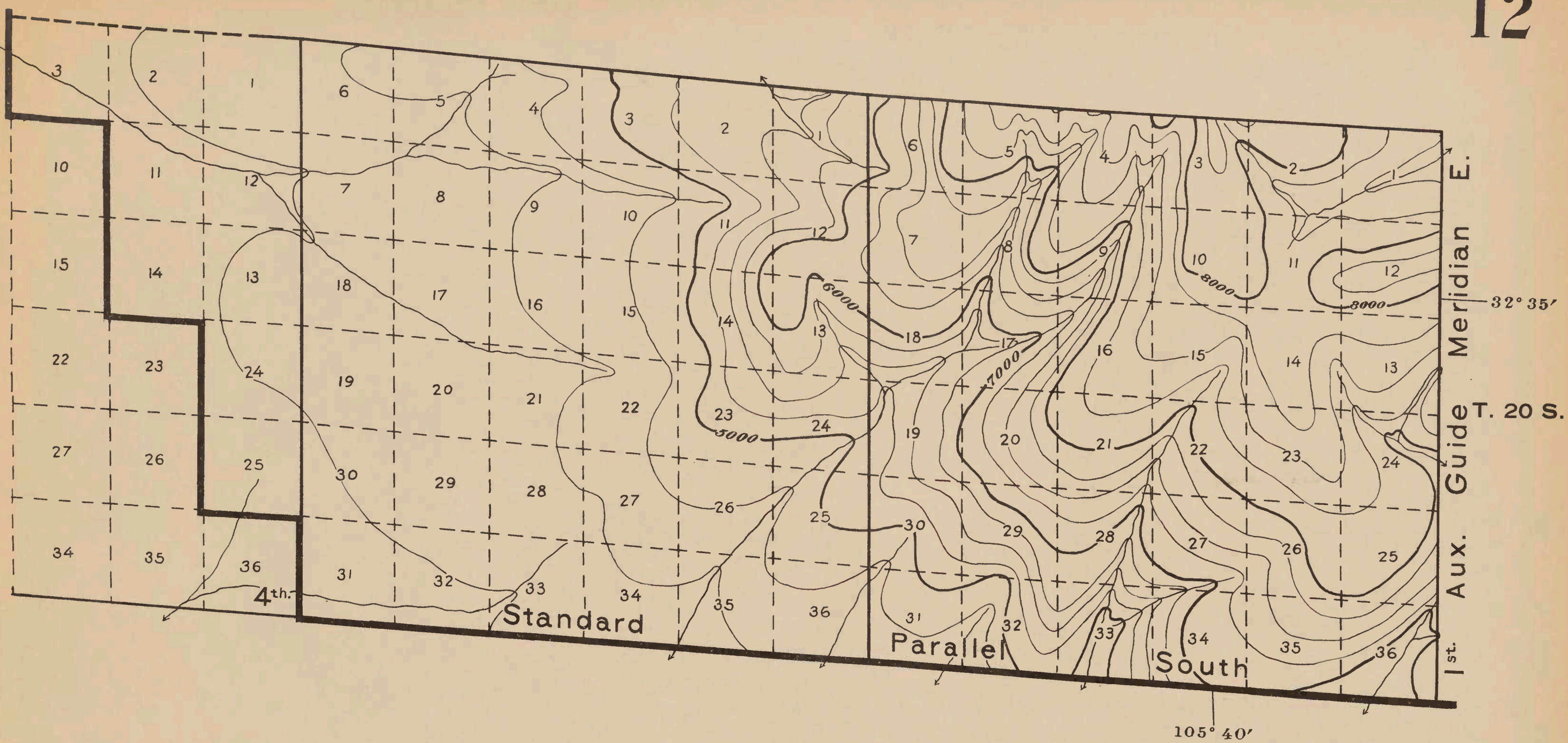

COMPILATION
 Topography from U. S. Geological Survey maps
 Land lines from General Land Office plats
 Classification by Forest Service

R. 10 E.

R. 11 E.

R. 12 E.

JAN., 1909
 ALAMO

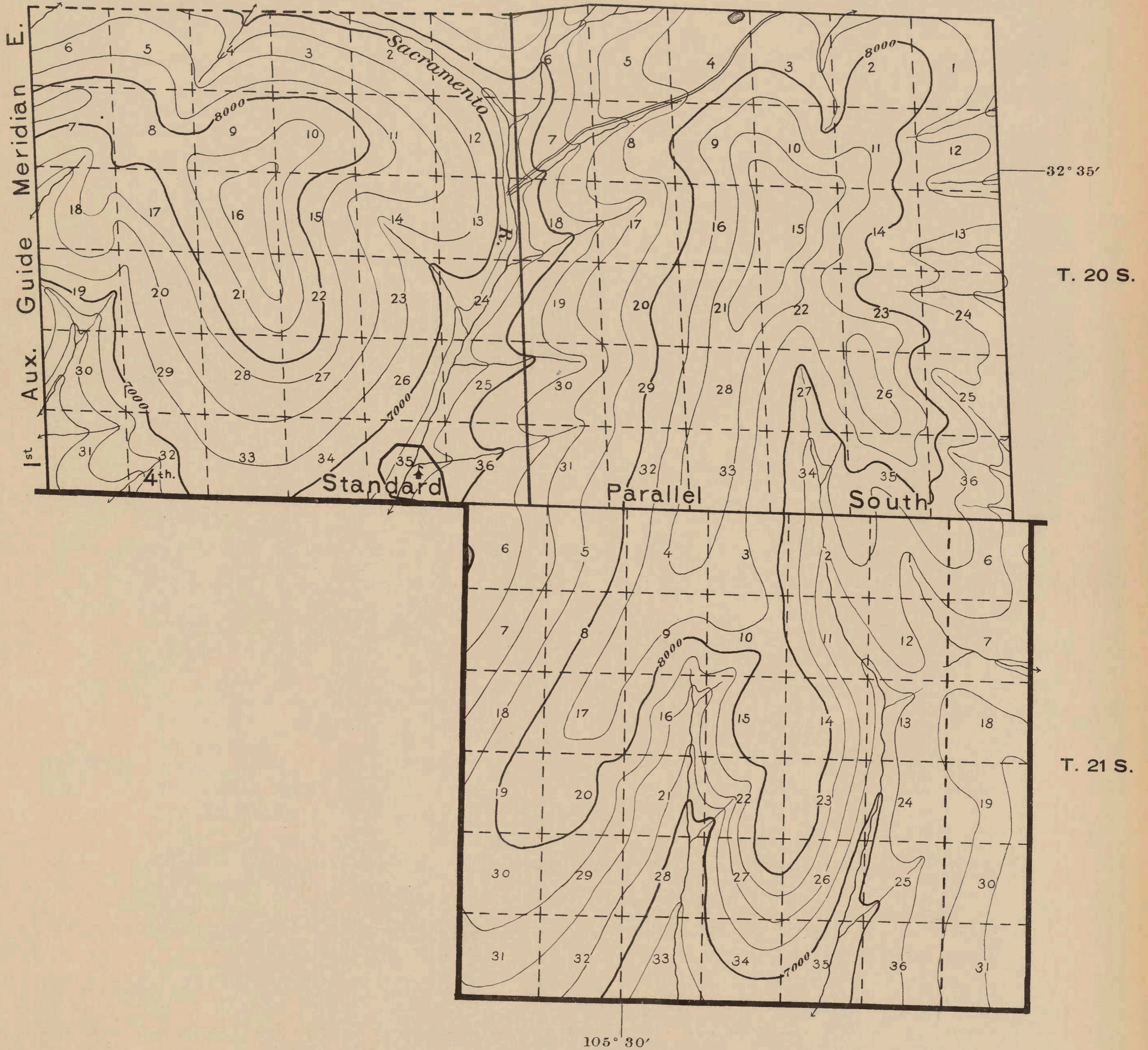

COMPILATION
 Topography from U. S. Geological Survey maps
 Land lines from General Land Office plats
 Classification by Forest Service

R. 13 E.

R. 14 E.

JAN. 1909
ALAMO

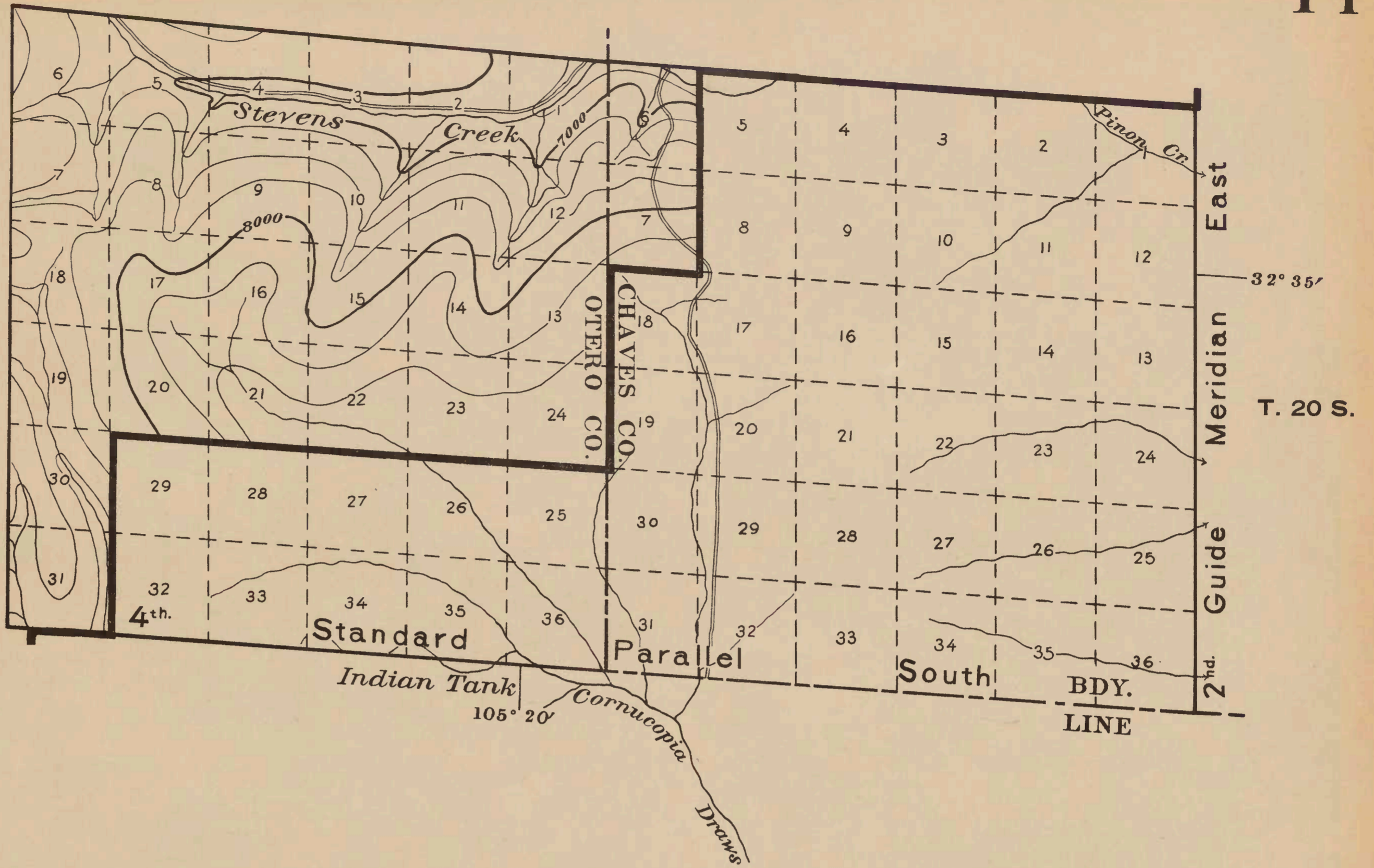

COMPILATION
 Topography from U. S. Geological Survey maps
 Land lines from General Land Office plats
 Classification by Forest Service

R. 15 E.

R. 16 E.

JAN. 1909
 ALAMO

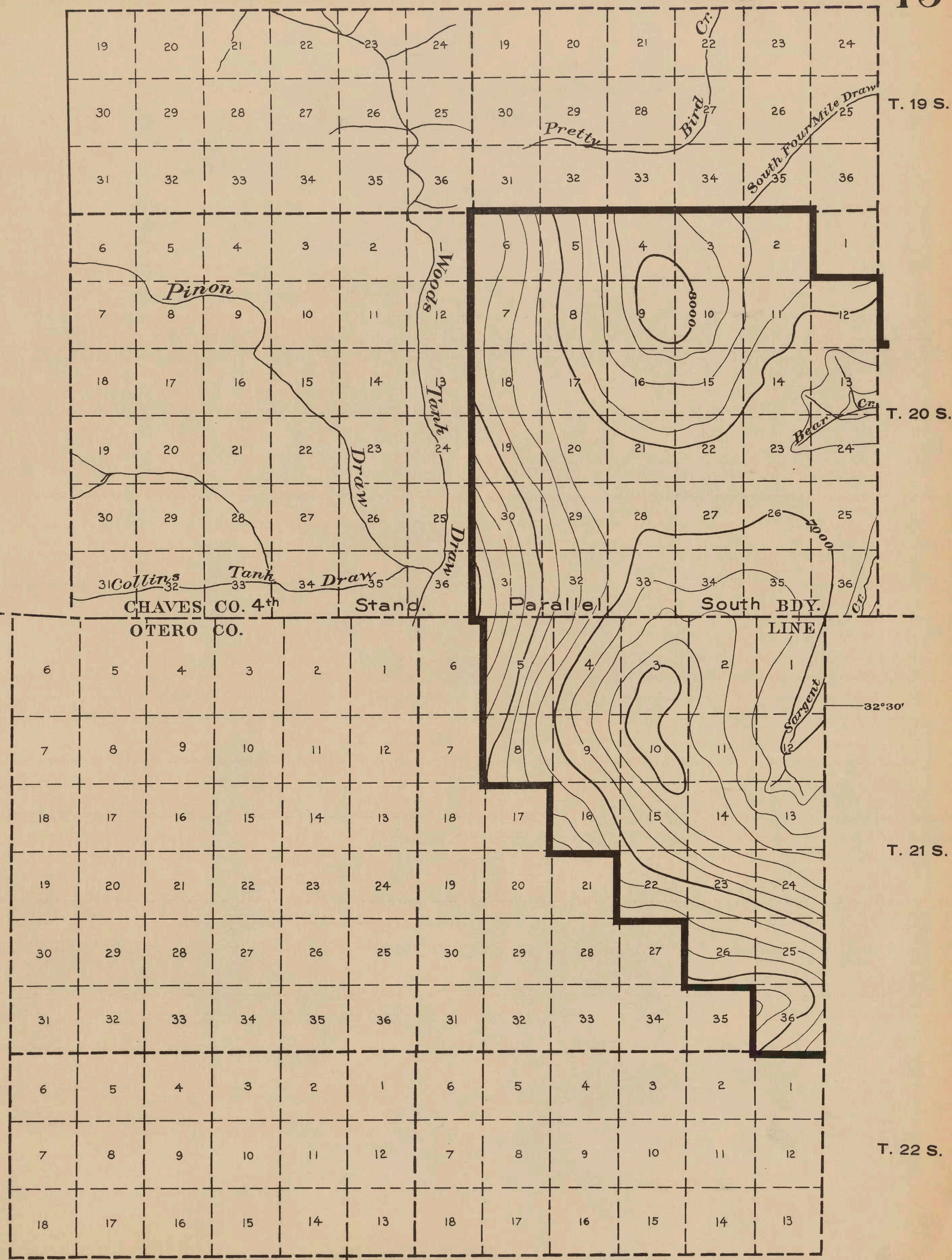

COMPILATION
 Topography from U. S. Geological Survey maps
 Land lines from General Land Office plats
 Classification by Forest Service

105° 10'

JAN., 1909
 ALAMO

R. 17 E.

R. 18 E.

T. 19 S.

T. 20 S.

T. 21 S.

T. 22 S.

32° 30'

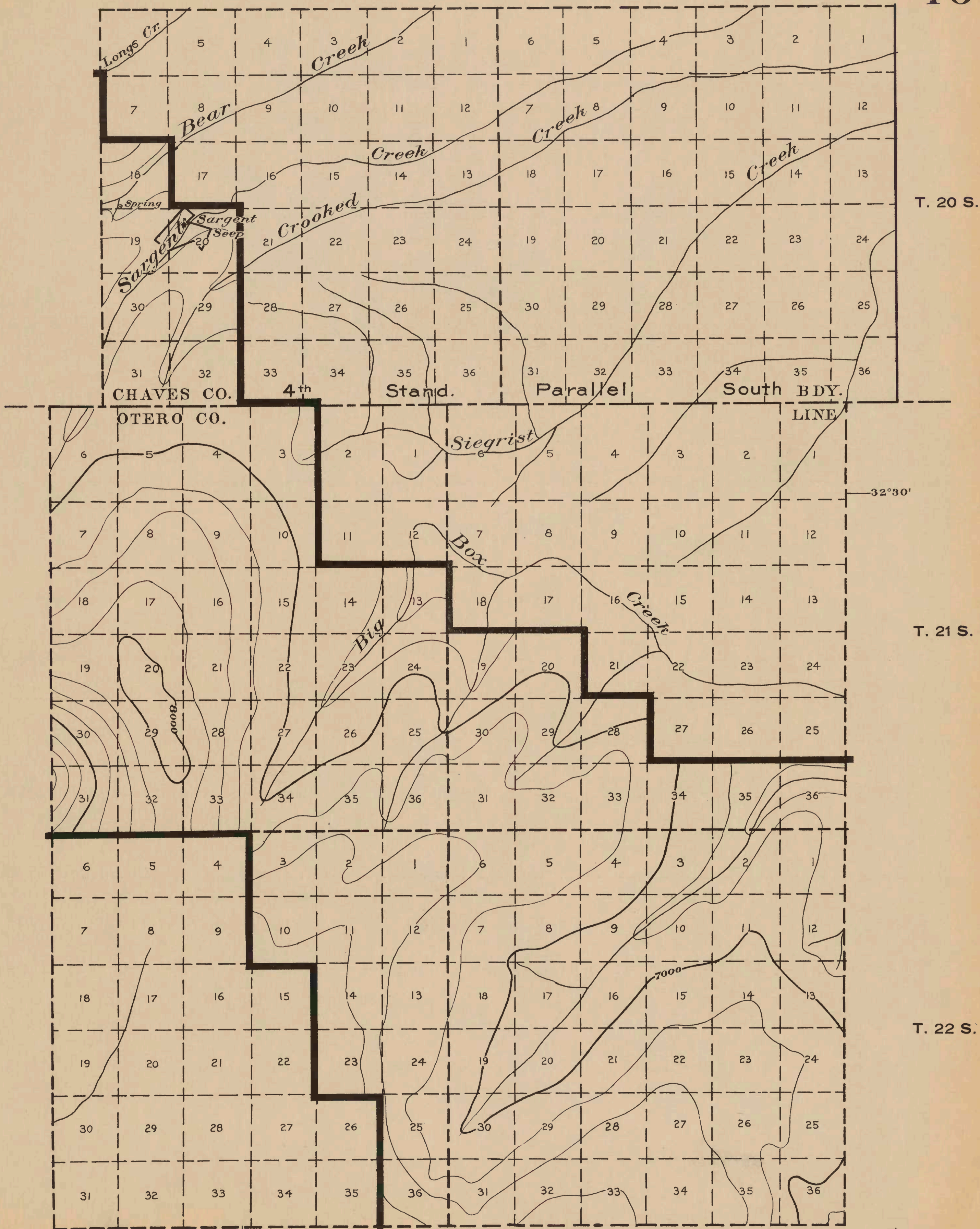

COMPILATION
 Topography from U. S. Geological Survey maps 105°00'
 Land lines from General Land Office plats
 Classification by Forest Service

JAN., 1909
 ALAMO 104°50'

R. 19 E.

R. 20 E.



CHAVES CO.

OTERO CO. 4th Stand. Parallel South

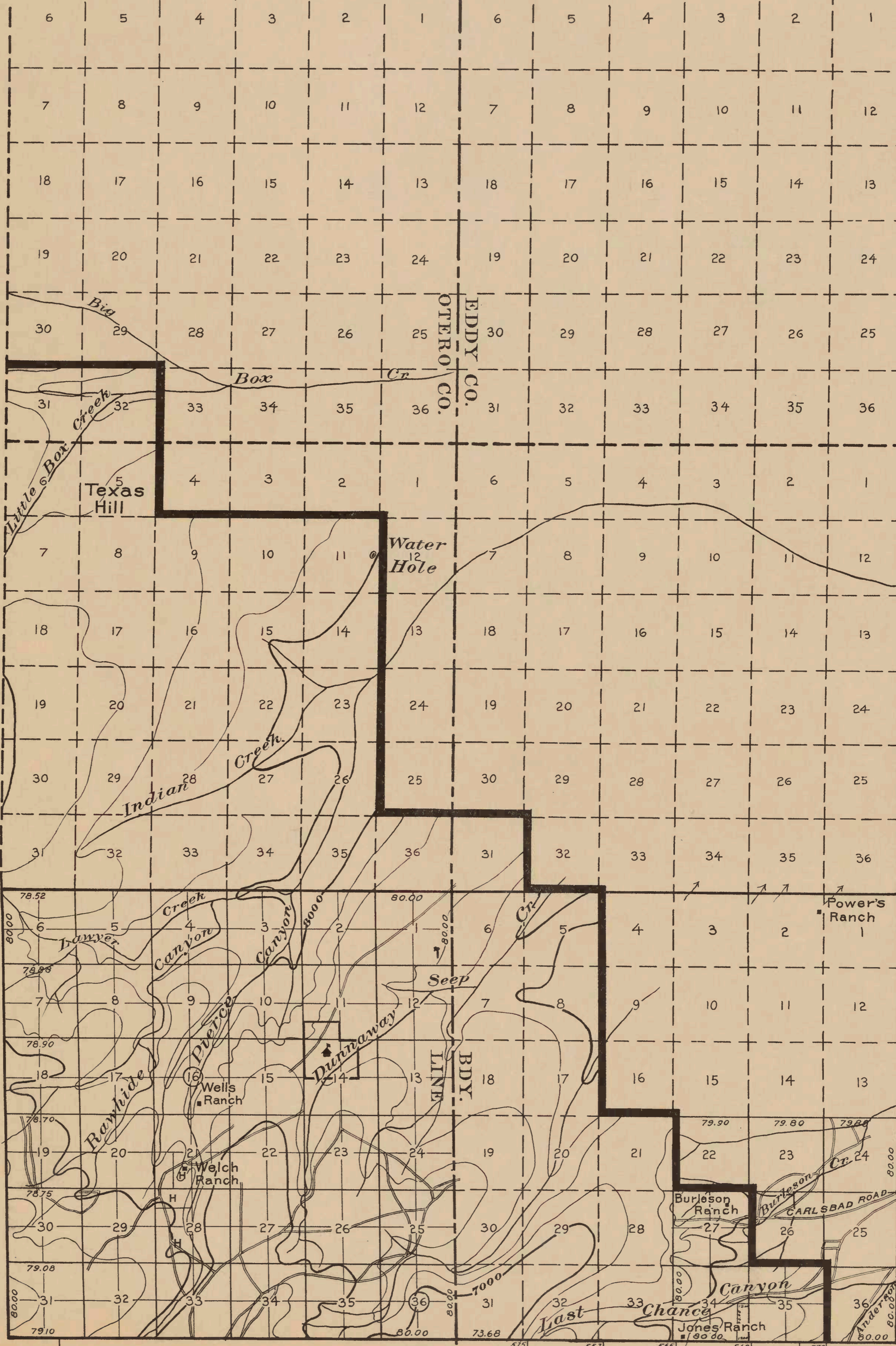

32°30'

T. 21 S.

T. 22 S.

32°20'

T. 23 S.

104°50' COMPILATION
 Topography from U. S. Geological Survey maps
 Land lines from General Land Office plats
 Classification by Forest Service

R. 21 E.

R. 22 E.

104°40' JAN. 1909
 ALAMO



T. 23 S.

T. 24 S.

T. 25 S.

COMPILATION
 Topography from U. S. Geological Survey maps
 Land lines from General Land Office plats
 Classification by Forest Service

R. 19 E.

R. 20 E.

JAN., 1909
 ALAMO

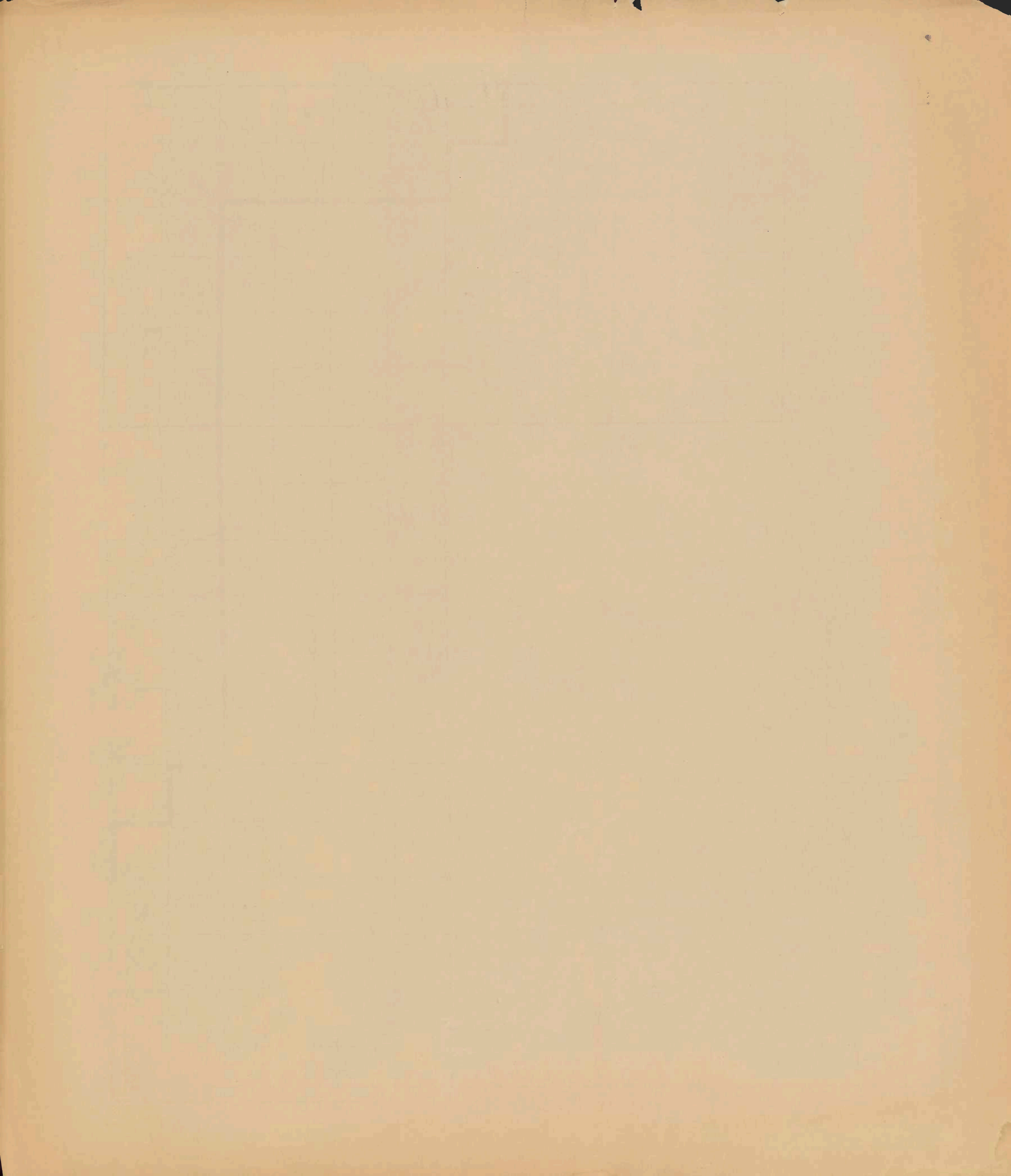

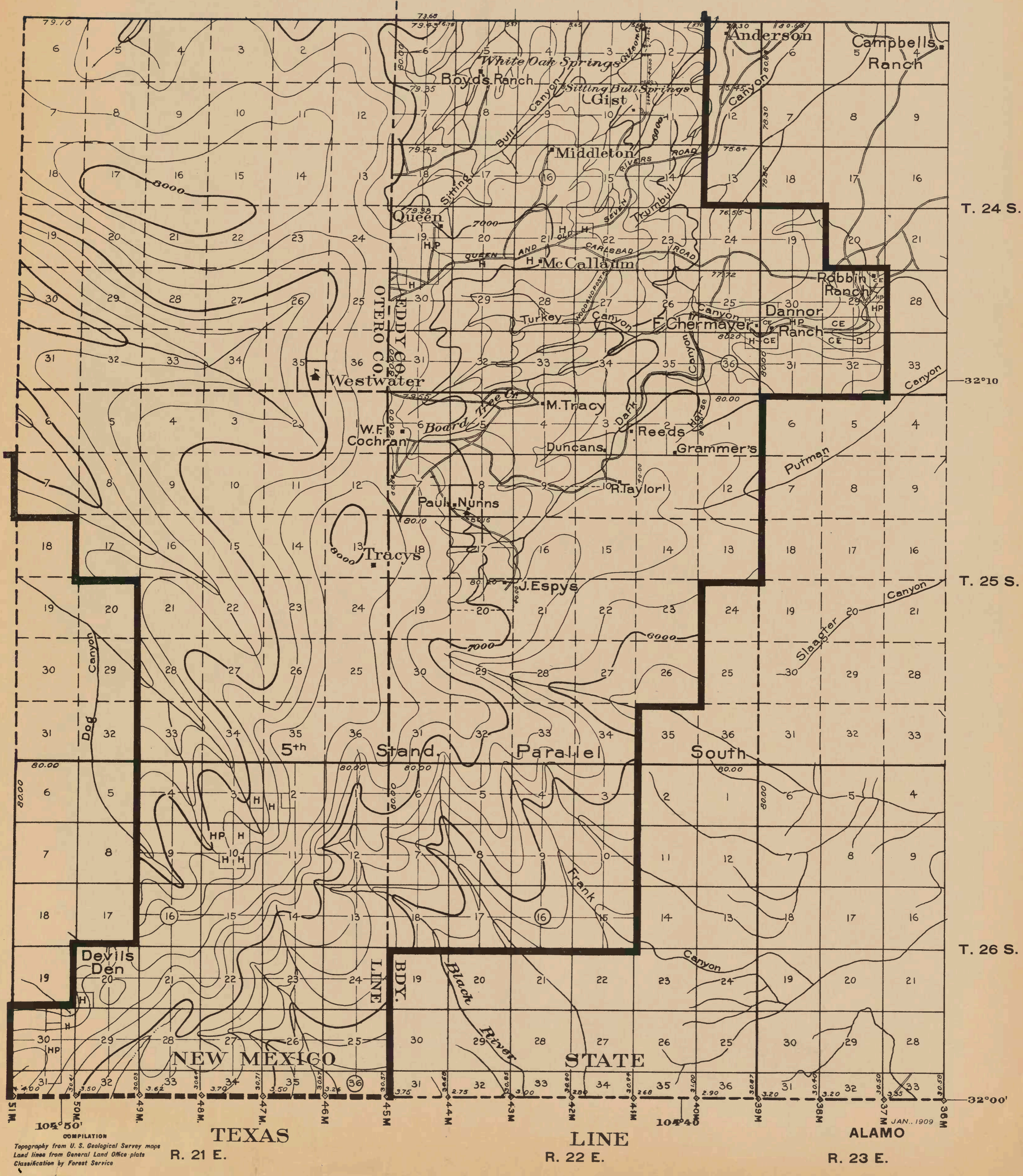

Topography from U. S. Geological Survey maps
 Land lines from General Land Office plats
 Classification by Forest Service

TEXAS
 R. 21 E. LINE R. 22 E. ALAMO R. 23 E.
 104° 50' 104° 40' 104° 30' 104° 20' 104° 10' 104° 00' 103° 50' 103° 40' 103° 30' 103° 20' 103° 10' 103° 00'

