

GHQ/SCAP Records (RG 331, National Archives and Records Service)

Description of contents

- (1) Box no. 2867
- (2) Folder title/number: (10)
Nagoya Military Arsenal - Kusu Factory
- (3) Date: Aug. 1946 - Apr. 1951

(4) Subject:

Classification	Type of record
9212, 9230	Z

- (5) Item description and comment:
Mie

- (6) Reproduction: Yes No

- (7) Film no. _____ Sheet no. _____

(Compiled by National Diet Library)

775013

Mr. Yamamoto - action

2

GENERAL HEADQUARTERS
SUPREME COMMANDER FOR THE ALLIED POWERS
Economic and Scientific Section
APO 500

MWH/WT/yt
16 April 1951

387.6(16 Apr 51)ESS/IND

MEMORANDUM FOR: Reparations Agency, Tokyo

SUBJECT: Application for Authorized Use of Items Listed for
Reparations

1. Reference is R.A.R. No. 1806 (MS), 14 December 1950, subject: Application for Authorized Use of Reparations Equipment of Former Arsenals Filed by Nineteen (19) Plants (Non-Reparations Plants).
2. The application requesting permission for the authorized use of the 367 items of reparations machinery and equipment listed in reference 1, above, is approved.
3. A rental fee shall be established for the authorized use of the equipment listed in reference 1, above, based upon current valuation and comparable to rental charges assessed by private interests for the use of similar equipment.
4. This permit is issued subject to any and all directives affecting reparations plants which have been issued or may hereafter be issued by the Supreme Commander for the Allied Powers. Reports will be rendered as required by current directives and instructions.

FOR THE CHIEF, ECONOMIC AND SCIENTIFIC SECTION:

1 Incl
R.A.R. No. 1806 (MS),
14 Dec 50. (dup)

MAURICE M. CLASS
Chief, Industry Division

Cys furnished:
CA Sec (dup)
CPU

MEMO FOR RECORD:

The above ltr is self-explanatory.

W. A. Thurman, 26-8485 M. M. C.

TOKAI-HOKURIKU INFORMATION
O.D. _____
W.A. THURMAN
CAS

ESS
APR 16 1951

8926

To : General Headquarters, Supreme Commander for the Allied Powers.

From : Reparations Agency, Tokyo.

Subject: Application for Authorized Use of Reparations Equipment of Former Arsenals Filed by Nineteen (19) Plants (Non-Reparations Plant)

R.A.R. No. 1806 (MS)

14 December 1950.

1. The Reparations Agency hereby submits to your Headquarters an application en bloc for authorized use of reparations equipment of the former Arsenals filed by the nineteen (19) plants as indicated below, together with applications of the Ministry of Finance and recommendations of the Ministry of International Trade and Industry, Transportation and Education as enclosed herewith.

<u>No.</u>	<u>Name of Arsenal</u>	<u>No. of Items</u>	<u>User Plant</u>	<u>Place of User</u>	<u>Remark</u>
1.	Wakkanai Fuel Oil Storage, Naval Fuel Depot (12-25)	6	K.K. Kokuyu Shokai	No. 39, 8 Chome, Ironai-cho, Otaru-shi, Hokkaido.	Oil storage
2.	Tsu Naval Arsenal (23-12)	6	Kikugawa Iron Works	No. 85, Ominato-cho, Ujiyamada-city, Mie Prefecture.	
3.	"	27	Mie Horo Kabushiki Kaisha	No. 1917, Eba Kuwana-city, Mie Prefecture.	
4.	Kusu Factory, Nagoya Military Arsenal (23-09)	38	Kusu Factory, Tea Wool Spinning & Weaving Co., Ltd.	In the compound of Arsenals.	
5.	Muroran Fuel Oil Storage, Naval Fuel Depot (12-25)	7	Hokkaido Tank Co., Ltd.	"	Oil Storage
6.	Kusu Factory, Nagoya Military Arsenal (23-09)	7	Tea Seiki K.K.	No. 50 Minami Kawa, Kusu-machi, Mie-gun Mie Prefecture.	

Incl 1

7.	Japanese Army Akatsuki Marine Troops (45)	2	Nippon Oil Co., Ltd.	No. 1409, Deshi- machi, Hikoshima, Shimonoseki-city, Yamaguchi Prefec- ture.
8.	Kusu Factory Nagoya Military Arsenal (23-09)	23	Shiohama Repair Shop, Kinki Nippon Railway Co., Ltd.	No. 880 Shiohama- cho, Yokkaichi, Mie Prefecture.
	Tsu Naval Arsenal (23-12)	6	"	"
9.	Tsu Naval Arsenal (23-12)	6	Matsuzaka Iron Works	No. 200, Kaibana Matsuzaka-city, Mie Prefecture.
10.	Kusu Factory, Nagoya Military Arsenal (23-09)	10	Tsu Engineering Works, Mitsu- bishi Heavy Industries, Ltd. (Code No. 23-03a)	No. 27, 4-chome, Kamihana-cho, Tsu City, Mie Prefec- ture.
	Muraka Naval Arsenal (23-10A)	4	"	"
	Tsu Naval Arsenal (23-12)	2	"	"
11.	Kokura Military Arsenal (07-13)	20	Miike Colliery, Mitsui Mining Co., Ltd.	No. 170, Harayama- machi, Omuta-shi, Fukuoka Prefecture.
	Hita Factory, Kokura Military Arsenal (30-03)	18	"	"
12.	Kasuga Factory, Kokura Military Arsenal (07-12)	6	K.K. Tataru Seisakusho	No. 6, Mitarai, Shime-machi, Kasuya-gun, Fukuoka Prefecture.
13.	Tsu Naval Arsenal (23-12)	4	Seishin Chuko Kabushiki Kaisha (Seishin Foundry Co., Ltd.)	No. 730, Otobe Tsu-city, Mie Prefecture

14.	Tsu Naval Arsenal (23-12)	11	Takahita Noki Kabushiki Kaisha (Takahita Farm Impliment Manufactory Co., Ltd.)	No. 1380, Kiya-cho, Oaza, Nabari- cho, Naga-gun, Mie Prefecture.
✓ 15.	Suzuke Naval Arsenal (23-10A)	3	Kyowa Seiyu K.K. (Kyowa Komori, Vegetable Oil Mfg. Co., Ltd)	No. 1580, Oaza Tsu-city Mie Prefecture
✓ 16.	Hakata Naval Air Corps (07-15)	27	Kyushu University	Hakozaki-machi Fukuoka-shi, Fukuoka Prefecture.
✓ 17.	Mirakata Factory, Mie Military Arsenal (32-31)	26 (99 pieces)	Osaka Jato Shiako K.K.	No. 14, Shimmachi- dori 1-chome, Nishi- ku, Osaka.
✓ 18.	Tateishi, Factory Kokura Military Arsenal (30-05)	14	Aso Coal Mining Co., Ltd.	No. 1900, Tateiwa, Iizuka-shi, Fukuoka Prefecture.
18.	Itochiyama Factory, Kokura Military Arsenal (30-04)	1	"	"
✓ 19.	Akatsuki Military Corps (07-57)	28	Moji Branch, Idemitsu Kosan Co., Ltd.	No. 250 3-chome, Nishihon-machi, Moji-shi, Fukuoka Prefecture.
Grand Total		293	items (364 pieces)	

2. These equipment applied herein have been used for production of the applicant plants with temporary permissions of local occupation authorities concerned and some of them have already been moved to users' plants on temporary base.

3. This application has been investigated and has been recommended by other interested government agencies after checking on essential needs of these equipment for applicants.

- 4 -

4. It is requested that your most favorable consideration be given to this application at the earliest practicable date.

(Y. Katsuno)
Director, Reparations Division,
Reparations Agency.

Incls:

1. Applications of the Ministry of Finance.
2. Recommendations of the Ministry of International Trade and Industry, and Transportation and Education.
3. Applications of the subject plants.

List of Facilities for Application

Code No. 12-25

Name of Plant : The Wakkanai Fuel Oil Storage,
Naval Munitions Department, Ominato.Address of Plant: ^{Fuel Depot} 6-chome, Kitahama-dori, Wakkanai City,
Soya-Gun, Hokkaido

1. Machinery

Inv. No.	Name of Machinery	Brief Specifications	Quantity	Remarks
1T	No. 2 and No. 3 3,000 ton Fuel Oil Tank	Cylinder type steel tank. Height 30.0128' Dia. 86.8034' 4 rings, riveted.	1	with pipe- line
2T	ditto	ditto	1	
1	Diesel Engine	"Ikegai" 50 HP Vertical type No. 7025	1	with accessary
2	Oil Pump	"Kawasaki" Worshington pump, 125 Kilolitre per hour.	1	with pipe- line
3	Service Oil Tank		2	
4	Water Pump	"Kawasaki" 3-stage Turbine pump 50 tons per hour	1	

Total 6 items (7 pieces)

List of Facilities for Application

Code No. 23-12
 Name of Plant. Tsu Naval Arsenal.
 Address of Plant. Komori, Tsu city, Mie Pref.

1. Machinery

Inv. No.	Name of Machine	Brief Specifications	Quantity	Remarks
23-12-2741	Moulding Machine	Pneumatic, flush size 370 x 500 mm	1	
" 395	Milling Machine	Bench, table feed 100 x 70 mm	1	
" 1107	Milling Machine	Vertical, table feed 850 x 250 x 400 mm	1	
" 565	Milling Machine	"	1	
" 497	Milling Machine	Vertical, table feed 1000 x 300 x 400 mm	1	
" 364	Lathe	Relieving, swing 480 mm bed length 1680 mm	1	
			Total 6	

Kikukawa Iron Works

Mie Goro Kabushiki Kaisha
Kuwana City, Mie

December 9, 1949

List of Facilities for Application

Code No. 23-12
Name of Plant. Tsu Naval Arsenal
Address of Plant. Komori, Tsu City, Mie-prefecture

1. Machinery

Inv.No.	Name of Machinery	Brief Specification	Quantity	Remarks
23-12-610	Shaper 600 m.m.	1. Vice & table handles missing 2. 1 Class	1	On 2 August 1949, authorized to use by Mie C.A.T.
23-12-522	Vertical Milling Machine	1. A type No.2 Mill-waukee 2. 1 Class	1	do
23-12-1257	Universal Milling Machine	1. Table stopper, Ring of Arbor missing 2. 1 Class	1	do
23-12-1277	Drilling Machine	1. 5 handles missing 2. 2 Class	1	do
23-12-1092	Lathe (12 feet)	1. Main chuck damaged Centre & Motor pully missing 2. 2 Class	1	do
23-12-147	Lathe (8 feet)	1. Motor pully broken 2. 2 Class.	1	do
23-12-641	Sletter	1 Class	1	do
23-12-954	Pneumatic Hammer	1. Many small parts missing & broken 2. 2 Class	1	do
23-12-1540	Transformer 100 KVA	1 Class	1	do
23-12-1541	Transformer 100 KVA	1 Class	1	do
23-12-1265	Electric Furnace	1. Ni-Cr resistance wire missing: Fire-proof brick, A-& V-meters broken 2. 3 Class	1	do

Inv.No.	Name of Machinery	Brief Specification	Quantity	Remarks
23-12-3076	Electric Distil- later	1 Class	1	On 2 August 1949, author- ized to use by Mic C.A.T.
23-12-893	Grinder	1 Class,	1	do
23-12-1226	Rockfal hardness Tester	1. Diamond cone & Steel ball penetrators missing - 2. 3 Class	1	do
23-12-2781	Circular table	1 Class	2	On 16 Septem- ber 1949, authorized to use by Mic C.A.T.
23-12-2793	Vice for Milling Machine	1 Class	2	do
23-12-2882	Vice	1 Class	2	do
23-12-2870	Straight edge	1 Class	2	do
			<u>Total</u>	<u>21</u>

- 2. Building None
- 3. Land None

List of Facilities for Application

Applicant : Tea Wool Spinning & Weaving Co . Ltd.
 Code No. : 23 - 09
 Name of Plant : Kusu Factory, Nagoya Military Arsenal.
 Address of Plant : 50, Minamikawa, Kusu-Cho, ^{Mie Gun,} Mie Prefecture.

1. Machinery

Inv.No.	Name of Machinery	Brief Specifications	Quantity	Remarks
1168	Boiler (Toyo Seikan)	Max. pressure 10 KG/cm ²	1	Boiler
1169	Boiler (Kisha Kaisha)	" "	1	Room
1170	Boiler (Toyo Seikan)	" "	1	
1171	Elevator	(Nakajima Mfg. Co.)	1) For Coal
1172	Vertical Conveyer	" "	1) Supply
1173	Steam Turbine Pump	(Mitsubishi Heavy Industry)	1) For Feed
1174	Electric Turbine Pump	(Nishijima Mfg. Co.)	1) Water
1175	Electric Turbine Pump	" "	1) Supply
1176	Boiler ^a Shaft	(Kisha Kaisha)	1	
1178	Blower	(Ebara Mfg. Co.)	1)
1179	Blower	" "	1) For
1180	Blower	" "	1) Boiler
1181	Blower	" "	1)
1182	Blower	" "	1)
1250	Centrifugal Pump	(Ebara Mfg. Co.)	1) For Drink
1251	Centrifugal Pump	" "	1) Water
1252	Turbine Pump	(Ebara Mfg. Co.)	1	
1253	Rotary Pump	(Ebara Mfg. Co.)	1	
1254	Vertical Pump	(Ebara Mfg. Co.)	1	
1155	Transformer	1,000 KVA (Hitachi)	1	
1156	Transformer	" "	1	Electric
1157	Transformer	" "	1	Power
1158	Transformer	" "	1	Receiving
1159	Transformer	10 KVA (Takaoka)	1	Station

Inv.No.	Name of Machinery	Brief Specifications	Quantity	Remarks
1160	Transformer	10 KVA (Takaoka)	1	
1161	Switch Gear	(Hitachi Seisakusho)	1	
1162	Switch Gear	" "	1	
1163	Switch Gear	" "	1	
1164	Switch Gear	" "	1	
1165	Switch Gear	" "	1	
1166	Switch Gear	" "	1	
1167	Switch Gear	" "	1	
1177	Motor	3 HP (Mitsubishi Electric)	1	
1081	Transformer	200 KVA	1	
1082	Transformer	"	1	Sub-
1083	Transformer	"	1	Station
1084	Transformer	"	1	
1087	Transformer	"	1	
Total			38	

List of Facilities for Application

Code No : 12 - 26
 Name of Plant: The Muroran Fuel Oil Storage
 Address of Plant: Aza Horomoe, Motowanishi-Machi, Muroran
 City, Hokkaido.

1. Machinery

Inv. No.	Name of Machinery	Brief Specification	Quantity	Remarks
12 - 26				
T1	Fuel Oil Tank (with pipe Line)	3,000 ton	1	
1	Winch (Hand)	Capacity 500 kg	1	
V1 V2 V3 V4 -	Valves (Rising Spindle type)	Size 203,152 & 76.	5	
Total			7	

List of Facilities for Application

Code No. 23-9

Name of Plant: Kusu Factory, Nagoya Army Arsenal *Facilities*

Address of Plant: Kusu-cho, Mie-gun, Mie Pref.

T.O. Approved Date: June 25, 1949

1. Machinery

Inv. No.	Name of Machinery	Brief Specification	Quantity	Remarks
23-9-1	Lathe	6ft	1	Approved June 25, 1949
2	Lathe	6ft	1	"
" 482	Lathe	8ft	1	"
" 1053	Drilling machine	swing 550mm	1	"
" 127	Shaper	stroke 710mm	1	"
" 1046	Electric welding machine	10KW	1	"
740	Hack Saw	1HP	1	"
			<u>Total</u>	7

Attached Sheet

List of Facilities for Application

Code No; 45

Name of Plant: Former Japanese Army "No. 2940 Akatsuki"
Marine Troops.Address of Plant: Hikoshima Depot (Oil Storage), Nippon Oil
Co., Ltd.1-1373, Deshimachi, Hikoshima, Shimonoseki
City, Yamaguchi Pref.

1. Machinery

Inv. No.	Name of Machinery	Brief Specification	Quantity	Remarks
45	Oil Tank	Iron Tank, Cylindrical, Vertical. (D) 6.06 M (H) 6.67 M	1	Capacity 250 KL For Gasoline.
45	Oil Tank	" "	1	" "
Total			2	

LIST OF MACHINES AND EQUIPMENTS APPLIED

Code No. 23-9

Name of Plant: Kusu Factory, former Nagoya ~~Army~~ ^{Military} Arsenal.

Address of Plant: Kusu-cho, Mie-gun, Mie Pref.

Place where these machines and implements are installed:
Shiohama Car Repair Shop, Kinki Nippon
Railway 880 Shiohama 9cho, Yokkaichi, Mie Pref.

1. Machinery:

Inv.No.	Name of Machine	Brief Specification	Qt.
23-9-863	Planer	10'	1
" 625	Shaper	24'	1
" 171	Vertical Miller	No.2	1
" 42	Horizontal Miller	No.2	1
" 874	Lathe	12'	1
" 386	Lathe	8'	1
" 388	Lathe	8'	1
" 788	Lathe	8'	1
" 511	Universal G rinder	Swing 255mm	1
" 992	Drilling Machine	Swing 48cm	1
" 862	slotter	300 mm	1
" 828	Hack Saw	275 mm	1
" 886	Pump		1
" 960	Pump	D. 55mm 0.25m	1
" 958	Pump	"	1
" 1045	Pump	"	1
" 959	Pump	"	1
" 1108	surface Plate	1.5m x 3m	1
" 745	Jib Crane	500 kg	1
" 747	Jib Crane	"	1
" 746	Jib Crane	"	1
" 748	Jib Crane	"	1
" 923	Air Compressor	3300V x 75kw	1
Total			23

LIST OF MACHINES AND EQUIPMENTS APPLIED:

Code No. 23-12

Name of Plant: Former Tsu Naval Arsenal

Address of Plant: Komori, Tsu City, Mie-Pref.

Place where these machines and equipments are installed.

Nabari Forge, Kinki Nippon Railway.

Hirao, Nabari-cho, Nagagan, Mie-Pref.

Inv.No.	Name of Machine	Brief Specification	Quantity	Remarks
23-12-600	Shaper	Stroke 40 cm	1	
" 611	Shaper	Stroke 60 cm	1	
" 149	Lathe	Swing 433 mm Bed Length 2508 mm	1	
830	Cutter Grinding Machine	1 HP	1	
" 1029	Hard Tester	Table 123mm x 360mm	1	
" 811	Grinding Machine	Double head type	1	
			Total	6

List of Facilities for Application

Code No. 23-12
 Name of plant Tsu Naval Arsenal
 Address of Plant Komori, Tsu city, vie pref.
 TO approved date Aug. 1, 1949

1. Machinery

Inv. No.	Name of Machinery	Brief Specifications	Quantity	remark
23-12-321	Lathe	Turret, swing 250 mm bed length 1200 mm	1	
" 493	Milling	Horizontal, 860 x 305 mm	1	
" 578	"	Thread, 150 x 60 mm	1	
" 2783	Universal Index		1	
" 2860	Die Head	Coventry	1	
			Total 5	

The attached sheets. No.1

List of Facilities for Application.

Code No.: 23-09

Name of Plant: Kusu Factory Nagoya Military Arsenal.

Address of Plant: Minamikawa, Kusu-cho, Mie-gun, Mie-ken.

1. Machinery.

Inv.No.	Name of Machinery	Brief Specification	Quantity	Remarks
23-09-34	Mechanical press 1-Point Vertical Knuckle Joint	Capacity 20 ton Working surface of table 500x325mm	1	Class 1
23-09-246	"	"	1	"
23-09-985	"	"	1	"
23-09-986	"	"	1	"
23-09-405	"	Capacity 100 ton Working surface of table 500x500mm	1	Class 2
23-09-498	"	"	1	"
23-09-869	"	"	1	"
23-09-689	"	Capacity 30 ton Working surface of table 535x325mm	1	"
23-09-975	Induction Motor	15-11 KW 200/220V 970/1170RPM	1	Class 1
23-09-977	"	"	1	"
Total			10	

List of Facilities for Application.

Code No: 23-10A

Name of Plant: Suzuka Naval Arsenal.

Address of Plant: Hirano-cho, Suzuka-shi, Mie-ken.

1. Machinery:

Inv.No.	Name of Machinery	Brief Specification	Quantity	Remarks
23-10-1794	Mechanical Press 1-Point Vertical Inclinable	Capacity 3 ⁰ ton Size of Ram 280x210x550mm	1	Class 2
23-10-927	Welding Machine	200KVA AC 200/220V	1	"
23-10-3536	Induction Motor	2 HP 200/220V 1420/1710 RPM	1	Class 1
23-10-2666	Induction Motor	7 1/2HP 200/220V 1450/1750 RPM	1	Class 1
Total			4	

List of Facilities for Application

Code No.: 23-12

Name of Plant: Tsu Naval Arsenal.

Address of Plant: Komori, Tsu-shi, Mie-ken.

1. Machinery.

Inv.No.	Name of Machinery	Brief Specification	Quantity	Remarks
23-12-960	Furnaces Heating Electric Resistance	Salt Bath 6,14 KW 65,6 KVA Maximum temperature 1350°C 24V 1 ϕ 60 cycle Size of Heating Chamber 300x300x300 mm	1	Class 1
23-12-1202	Generator Motor	5 KW 12 V, 614 Amp, 1440 RPM	1	"
Total			2	
<u>Grand Total</u>			<u>16</u>	

11

LIST OF FACILITIES FOR APPLICATION

CODE NO. : 07 - 13 DATE: 28, Feb. 1950.
 30 - 3

NAME OF PLANT : Kokura ^{Military} Arsenal.
 Hita ^{Factory} ~~Plant~~ Kokura ^{Military} Arsenal.

ADDRESS OF PLANT: Tamachi, Kokura-shi, Fukuoka-ken.
 Tajima-cho, Hita-shi, Oita-ken.

APPLICANT : Miike Colliery, Mitsui Mining Co., Ltd.
 170 Harayama-machi, Onuta-shi, Fukuoka-ken.

1. Machinery.

Inv. No.	Name of Machine	Brief Specification	Quantity	Remarks
07 - 13 - 7520	Rock Drill	Kinjo Drill Co.	1	Kokura Arsenal
7521	"	"	1	
7522	"	"	1	
7523	"	"	1	
7524	"	"	1	
7525	"	"	1	
7526	"	"	1	
7527	"	"	1	
7528	"	"	1	
7529	"	"	1	
7530	"	"	1	
7531	"	"	1	
7532	"	"	1	
7533	"	"	1	
7534	"	"	1	
7535	"	"	1	
7536	"	"	1	
7537	"	"	1	
7538	"	"	1	
7539	"	"	1	
TOTAL			20	

Inv. No.	Name of Machine	Brief Specification	Quantity	Remarks.
30 - 3 - 1074	Spot Welder	35 KW	1	Hita Plant,
1339	Centrifugal Pump	5 HP.	1	Kokura
1412	Induction Motor	20 HP	1	Army Arsenal.
1539	"	15 KW	1	
1688	"	20 HP	1	
2208	Centrifugal Pump		1	
2518	Induction motor	30 HP	1	
2547	"	20 KW	1	
2549	"	30 HP	1	
2566	Centrifugal pump	5 HP	1	
2573	Coil Winding machine		1	
2574	"		1	
2575	"		1	
2576	"		1	
4221	Electric Arc Welder	16 KW	1	
4265	Induction motor	20 HP	1	
4267	"	20 HP	1	
4416	"	150 HP	1	Include 100 HP Air Compressor
TOTAL			18	
GRAND TOTAL			38 sets	

2. Building.

None.

3. Land.

None.

LIST OF FACILITIES FOR APPLICATION

CODE NO. : 07 - 12
 NAME OF PLANT : Kasuga Factory, Kokura Military Arsenal.
 ADDRESS OF PLANT : Kasugabarū, Kasuga-mura, Chikushū-gun, Fukuoka-ken.
 NAME OF APPLICANT : G. Mitarai, Shime-machi, Kasuga-gun, Fukuoka-ken.
 K.K. Tetsu Seisakusho.

1. Machinery

Inv.No.	Name of Machine	Brief Specification	Quantity	Remarks
07-12-14	Mechanical press	I.M.D, Inclinalbe, Pressure 75 M.T. stroke 340mm, Size of Table 500x775mm, Motor: A.C. 10HP	1	
07-12-158	Mechanical press	I.M.D. StraightsSides, Pressure 50 M.T. Stroke 490mm Size of Table 500x500mm Motor: A.C.75HP	1	Motor Missing
07-12-190	Dilling machine	I.M.D. Radial Drill Cap in Steel 65mm Swing 2,360mm, Motor A.C. 5HP	1	
07-12-184	Air Hammer	I.M.D, Single Frame, Falling weight 250kgs, Max. Distance Anvil to Hammer 400mm, Motor: A.C. 30HP	1	Motor Missing
07-12-198	Air Hammer	I.M.D, Single Frame, Falling 125kgs, Max. Distance Anvil to Hammer 300mm, Motor: A.C. 15HP	1	
07-12-100	Slitter	I.M.D, Verticel. Length of stroke 350mm, Motor: A.C. 5HP	1	
Total			6	

List of Facilities for Application

Code No. 23-12
 Name of plant Tsu Naval Arsenal
 Address of plant Komori, Tsu city, Mie pref.
 T.O. Approved date 2 Feb. 1949

1. Machinery

Inv. No.	Name of Machinery	Brief Specifications	Qt.	Remarks
23-12-1060	Over head Traveling crane	Capacity: 2 tons	1	
" 813	Tool Grinder (double head)	1 HP	1	
" 1120	Tool Grinder (double head)	1 HP	1	
" 935	Portable Air Compressor	No. of cylinder-4 capacity 0.91m ³ /min. pressure 100 lb/3	1	
			Total 4	

List of Facilities for Application

Code No. 23-12
 Name of plant Tsu Naval Arsenal
 Address of plant Komori, Tsu city, Mie pref.
 T.O. approval date 16 Sept. 1949

1. Machinery

Inv. No.	Name of Machine	Brief Specification	Quantity	Remarks
23-12-1012	Shaper	Vertical	1	
" 582	Milling machine	for thread	1	
" 948	Press	two point vertical	1	
" 787	Surface Grinding machine		1	
" 652	Slotter		1	
" 646	Slotter		1	
" 672	Drilling machine	vertical	1	
" 1410	Flexible Sander		1	
" 2783	Index		1	
" 2862	Square Block	(middle, small)	2	
			Total 11	

List of Facilities for Application

Code No. 23-10A
 Name of Plant. Suzuka Naval Arsenal.
 Address of Plant. Shono-cho, Suzuka city, Mie Pref.
 T.O. Approved Date: January 29, 1949.
 1. Machinery

Inv. No.	Name of Machine	Brief Specification	Qt.	Remarks
23-10A- 512	Motor	10 Hp	1	Approved Jan.
2601	Motor	5 Hp	1	29, 1949
2994	Motor	1 Hp	1	"
			Total 3	"

LIST OF FACILITIES FOR APPLICATION

CODE No.: 07-15

NAME OF PLANT: Hakata Naval Air Corps.

ADDRESS OF PLANT: Saitozaki, Shikanoshimamura,
Yasuyagun, Fukuoka-ken.

Inv. No.	Name of Machine.	Brief Specification.	Quantity	Remarks
07-15-1	Bending Machine.	Max. Working Thickness 2mm Length 1,250mm	1	
07-15-2	Cutter Grinder.	Swing 250mm Center Distance 365mm	1	
07-15-5	Air Hammer.	Massay 1/8 ton	1	
07-15-6	Shearing Machine.	Max. Working Length 1,000mm Thickness 3mm	1	
07-15-7	Shaper.	Max. Stroke 910mm Horizontal Travel 610mm Vertical Travel 260mm	1	
07-15-8	Milling Machine.	Universal L. x C. x V. Table Travel. 711x254x457mm	1	
07-15-9	Electric Motor.	3ph. 200/220 V 5 HP 4pole 1,300 R.P.M.	1	
07-15-10	Motor Generator.	D.C. 12 Kw 60 V 200 Amp. 1,300 R.P.M.	1	
07-15-11	Air Compressor.	5 Kg/cm ² 4m ³ /min. 5 HP	1	
07-15-12	Electric Motor.	3ph. 200/220 V 15 HP 6pole 1140 R.P.M.	1	
07-15-13	Drying Furnace.	10 Kw 300°C Chamber volume 1000x1000x600mm	1	
07-15-240	Frame.	to be used for Scroll Saw Inv. No. 07-15-244	1	
07-15-241	Disc Sander.	Disc Dia 750mm 2 HP Table 370x800mm	1	
07-15-242	Grinder for wood Planer.	Max. Length 750mm Table Travel 140mm	1	
07-15-243	Brinnell Hardness Tester.	Max. Length 750mm Height of Head 300mm	1	
07-15-244	Scroll Saw.	Table 800x700mm Saw Stroke 100mm	1	
07-15-245	Trimming Machine.	Table 700x1,000mm Working Size 150x150mm	1	
07-15-246	Straightening Machine of Band Saw.	Roller dia 75mm 1/4 HP Height of Roller 160mm	1	
07-15-247	Band Saw.	Tilting table 800x1,000mm Dia and Width of wheel 200x70mm	1	
07-15-248	Saw filer.	Working Length 2,000mm Grinder wheel Dia 200mm Saw wheel Dia 500mm	1	
07-15-249	Wood Drilling Machine.	Tilting table 300x600mm Max. Drill dia 17/32" Spindle travel 220mm	1	
07-15-250	Electric Furnace.	Salt bath 220 V 46 kw Size of bath 300x350x1,200mm	1	
07-15-252	Electric Furnace.	Chamber volume 250x100x150mm 1400°C 7 PVA.	1	

Inv. No.	Name of Machine.	Brief Specification	Quantity	Remarks
07-15-253	Switch Board.	Panel 650x750mm marble 220 V 250 Amp.	1	
07-15-254	Switch Board.	Panel 650x750mm marble 220 V 250 Amp.	1	
07-15-255	Electric Motor.	3ph. 200/220 V 10 HP 4pole 1,800 R.P.M.	1	
07-15-256	Electric Motor.	3ph. 200/220 V 20 HP 6pole 1,200 R.P.M.	1	

Total.

27.

List of Facilities for Application

Code No. 32 - 31

Name of plant: The Hirakata ~~Plant~~, *Factory Oraka Military Arsenal*, ~~Oxygen Manufacturing Shop~~Address of plant: Kaida Area of Hirakata Arsenal
Hirakata City.

1. Machinery

Inv.No.	Name of machinery	Brief Specifications	Quantity	Remarks
6957	Air cleaner	3M ³ /min	1	
5509	Centrifugal pump	12 gal/min	1	
772	Air compressor	1M ³ /min	1	
6958	Motor		1	
6959	Switch board	220V 100A	1	
773	Gas reservoir	3M ³ /min	1	
6960	Air rectifying column	3M ³ /min	1	
770	Expansion machine	2M ³ /min	1	
6961	Centrifugal pump	15 gal/min	1	
6962	Oxygen gas tank	V 30 M ³	1	
771	Compressor	0.5M ³ /min	1	
6963	Motor	20 HP	1	
6964	Switch board	220V 100A	1	
6965	Oil separator	V 0.3M ³	1	
6966	Soda tank	V 1.2M ³	1	
6967	Recovering apparatus	V 0.6M ³	1	
6968	Thawing apparatus	V 0.4M ³	1	
5510	Centrifugal water pump	12 gal/min	1	
6970	Filling stand	12 Bombs	1	
6971	Water pump	7 gal/min	1	
6972	press manual		1	

775013

6973	spare parts	1
6974	piston ring	1
6975	stop valve	1
6976	pipe	1
	Oxygen Bottles	7
Total		9

2. Building

Area No.	Building No.	Name of building	Total Area	Construction	Remarks
Kaida	337	Oxygen producing shop	102 tsubo	One storied wooden house	

26 items (9 pieces)

3. Land

Area no.	Area (tsubo)	Remarks
Kaida	200	

18

LIST OF FACILITIES
FOR
APPLICATION

CODE NO. :
 30-5 (Tateishi ^{Factory} Branch)
 30-4 (Itoguchiyama Branch)
 NAME OF PLANT: ^{Factory}
 Tateishi Branch of Kokura Military Arsenal
 Itoguchiyama Branch of Kokura Military Arsenal
 ADDRESS OF PLANT: ^{Factory}
 Tateishi ^{Factory}
 Tateishi-cho, Hayami-gun, Oita-ken.
 Itoguchiyama ^{Factory}
 Itoguchi-mura, Usa-gun, Oita-ken.
 APPLICANT:
 1900 Tatsuta, Fukuoka-shi, Fukuoka-ken.
 Aso Coal Mining Company, Ltd.

1. Machinery

Inv. No.	Name of Machine	Brief Specification	Quantity	Remarks
30-5-37	Air Compressor	100 HP.	1	
30-5-38	Ditto	300 HP.	1	
30-5-39	Ditto	75 HP.	1	
30-5-40	Ditto	Ditto	1	
30-5-41	Ditto	Ditto	1	
30-5-616	Gear Cutting Machine		1	
30-5-109	Ditto		1	
30-5-984	Slotting Machine		1	
30-5-753	Turning lathe		1	
30-5-742	Front Lathe		1	
30-5-98	Grinding Machine		1	
30-5-760	Drilling Machine		1	
30-5-794	Ditto		1	
30-5-846	Ditto		1	
30-4-37	Blue Printing Machine		1	
Total			15-14	

2. Building:
None.

3. Land
None.

LIST OF FACILITIES FOR APPLICATION

CODE NO : (07-57)

NAME OF PLANT : Akatsuki, Military Corps

ADDRESS OF PLANT : Aohama, Shiranoe, Noji-Shi, Fukuoka-Ken

1. Machinery

Inv. No.	Name of Machine	Brief Specification	Quantity	Remarks
07-57-1T	Oil Storage	Above ground Vertical const Capacity 350K.L. Height 7.5M. Dia 7.2M.	1	
07-57-2T	"	"	1	
07-57-3T	"	"	1	
07-57-4T	"	Capacity 650K.L. Height 7.5M. Dia 10.4M.	1	
07-57-1	Motor	InductionCage 50HP 3 Phase 1750 R.P.M.	1	
07-57-2	Pump	Geer Dia 127M.M.	1	
07-57- ³ 16	5"Valve	Body Cast Steel face to face 269M.M.	14	
07-57- ¹⁷ 23	2"Valve	Body and Trim Brass face to face 122M.M.	7	
07-57-24	5"Pipe	350M.	1	
Total			28	

GENERAL HEADQUARTERS
SUPREME COMMANDER FOR THE ALLIED POWERS
Economic and Scientific Section
APO 500

WT/MWH/RAS/mcp
25 January 1951

387.6(25 Jan 51)ESS/IND

MEMORANDUM FOR: Reparations Agency, Tokyo

SUBJECT : Application for Movement and Authorized Use of Items
Listed for Reparations

<u>Present Location</u>	<u>No. of Items</u>	<u>To Be Transferred To</u>
1. Toyokawa Naval Arsenal		Toyota Motor Co., Ltd.
(01-60a)	16	8 Meyama, Shimoichiba,
(01-60b)	5	Koromo-cho, Nishikomo-
(01-60c)	5	gun, Aichi Prefecture
2. Tsu Naval Arsenal	3	"
(23-12)		
3. Nagoya Military Arsenal		"
a. Kusu Factory	4	
b. Torimatsu Factory	8	
c. Kasugai Branch	2	
(01-59b)		
d. Yanaizu Factory	6	
Total	49	

1 Incl
as indicated (dup)

MAURICE M. CLASS
Chief, Industry Division

775013

ECIN

*1. Johnston
2. Heston
3. Yamouchi*

8947

GENERAL HEADQUARTERS
SUPREME COMMANDER FOR THE ALLIED POWERS
Economic and Scientific Section
APO 500

MWH/WT/ao

387.6(19 Apr 51) ESS/IND

19 April 1951

MEMORANDUM FOR: Reparations Agency, Tokyo

SUBJECT: Application for Movement and Authorized Use of Items Listed for Reparations

1. Reference is R.A.R. No. 581 (MS), 17 March 1951
subject: Application for Movement and Authorized Use of Reparations Equipment of Kusu Factory, Nagoya Military Arsenal (Code No. 23-09) Filed by Matsuoka Industry Co., Ltd. (Non-reparations plant)

2. The application requesting permission for the transfer and authorized use of the nine (9) items of reparations machinery and equipment listed in reference 1, above, is approved as indicated in inclosure 1.

3. A rental fee shall be established for the authorized use of the equipment listed in reference 1, above, based upon current valuation and comparable to rental charges assessed by private interests for the use of similar equipment.

4. This permit is issued subject to any and all directives affecting reparations plants which have been issued or may hereafter be issued by the Supreme Commander for the Allied Powers. Reports will be rendered as required by current directives and instructions.

FOR THE CHIEF, ECONOMIC AND SCIENTIFIC SECTION:

- 2 Incls
- 1. Items author. for mvmt & use. (dup)
- 2. R.A.R. No. 581 (MS), 17 Mar 51 . (dup)

MAURICE M. CLASS
Chief, Industry Division

MEMO FOR RECORD:

The above ltr is self-explanatory.

Cys furnished:
CA Sec (dup)
CPC

W. A. Thurman, 26-8485

M. M. C.

OKAHI... INFORMATION

O.D. APR 27 1951

CAS

Items Authorized for Movement and Use

The application requesting permission for the transfer and authorized use of the following ~~nine~~ (9) items of reparations machinery and equipment is approved as listed below:

<u>Present Location</u>	<u>No. of Items</u>	<u>To Be Transferred To</u>
Nagoya Military Arsenal Kusu Factory (23-09)	9	Matsuoke Industry Co., Ltd. No. 1145 Yasunaga, Jyonan-mura, Kawan-gun, Mie Pref.

- nothing follows -

Incl 1

TO : GENERAL HEADQUARTERS, SUPREME COMMANDER FOR THE ALLIED POWERS.
FROM : Reparations Agency, Tokyo.
SUBJECT: Application for Movement and Authorized Use of Reparations
Equipment of Kusu Factory, Nagoya Military Arsenal
(Code No. 23-01) Filed by Matsushita Industry Co., Ltd.
(Non-reparations plant)

R.A.R. No. 581 (NS)

17 March 1951.

1. The Reparations Agency hereby submits to your Headquarters an application for movement and authorized use of 9 items of reparations equipment now lying idle in the Kusu Factory, Nagoya Military Arsenal (Code No. 23-09) filed by the Matsushita Industry Co., Ltd. (Non-reparations plant), together with an application of the Ministry of International Trade and Industry as enclosed herewith.
2. Movement and use of the reparations equipment applied herein have already been orally permitted as "temporary operation" by the High Military Government Team on 28 June, 1949. It is desired that they be permitted formally as "AU".
3. This application has been investigated and has been coordinated with other interested government agencies.
4. It is requested that your most favorable consideration be given to this application at the earliest practicable date.

(I. Katano)
Director, Reparations Division,
Reparations Agency.

Incls:

- a. Application of the Ministry of Finance.
- b. Recommendation of the Ministry of International Trade and Industry.
- c. Application of the subject company.

Incls

List of Facilities for Application

Code No. 23-19

Name of Plant. Kusu Factory, Nagoya ^{Military} Arsenal.

Address of Plant. Kusu-cho, Mie-gun, Mie Pref.

T.O. Approved Date: June 28, 1949

1 Machinery

Inv. No.	Name of Machine	Brief Specifications	qt.	Remarks
23-9-895	Lathe	Cap, swing 740mm bed length 4500mm	1	Approved June 28, 1949
402	Boring Machine	Horizontal Bar dia 65mm	1	"
1019	Drilling Machine	Swing 480mm	1	"
1020	Drilling Machine	"	1	"
821	Drilling Machine	Swing 850mm	1	"
720	Boring Machine	Jig Boring table size 494x715mm	1	"
351	Boring Machine	Precision table size 1650x510mm	1	"
383	Milling Machine	Vertical, 705x255x50mm	1	"
817	Milling Machine	Vertical 1200x380x400mm	1	"
			Total	9

GENERAL HEADQUARTERS
 SUPREME COMMANDER FOR THE ALLIED POWERS
 Economic and Scientific Section
 APO 500

MWH/WT/ao

387.6(19 Apr 51)ESS/IND

19 April 1951

MEMORANDUM FOR: Reparations Agency, Tokyo

SUBJECT: Application for Movement and Authorized
Use of Items Listed for Reparations

1. Reference is R.A.R. No. 581 (MS), 17 March 1951
 subject: Application for Movement and Authorized Use of Reparations
 Equipment of Kusu Factory, Nagoya Military Arsenal (Code No. 23-01)
 Filed by Matsuoka Industry Co., Ltd. (Non-reparations plant)

2. The application requesting permission for the transfer and authorized use of the nine (9) items of reparations machinery and equipment listed in reference 1, above, is approved as indicated in inclosure 1.

3. A rental fee shall be established for the authorized use of the equipment listed in reference 1, above, based upon current valuation and comparable to rental charges assessed by private interests for the use of similar equipment.

4. This permit is issued subject to any and all directives affecting reparations plants which have been issued or may hereafter be issued by the Supreme Commander for the Allied Powers. Reports will be rendered as required by current directives and instructions.

FOR THE CHIEF, ECONOMIC AND SCIENTIFIC SECTION:

2 Incls

1. Items author. for mvmt & use. (dup)
2. R.A.R. No. 581 (MS),
17 Mar 51 . (dup)

Cys furnished:
 CA Sec (dup)
 CPC

MAURICE M. CLASS
 Chief, Industry Division

MEMO FOR RECORD:

The above ltr is self-explanatory.

W. A. Thurman, 26-8485

M. M. C.

Items Authorized for Movement and Use

The application requesting permission for the transfer and authorized use of the following nine (9) items of reparations machinery and equipment is approved as listed below:

<u>Present Location</u>	<u>No. of Items</u>	<u>To Be Transferred To</u>
Nagoya Military Arsenal Kusu Factory (23-09)	9	Matsuoka Industry Co., Ltd. No. 1145 Yasunaga, Jyonan-mura, Kivana-gun, Mie Pref.

- nothing follows -

Incl 1

TO : GENERAL HEADQUARTERS, SUPREME COMMANDER FOR THE ALLIED POWERS.
 FROM : Reparations Agency, Tokyo.
 SUBJECT: Application for Movement and Authorized Use of Reparations
 Equipment of Kusu Factory, Nagoya Military Arsenal
 (Code No. 23-01) Filed by Matsushita Industry Co., Ltd.
 (Non-reparations plant)

R.A.R. No. 521 (MS)

17 March 1951.

1. The Reparations Agency hereby submits to your Headquarters an application for movement and authorized use of 9 items of reparations equipment now lying idle in the Kusu Factory, Nagoya Military Arsenal (Code No. 23-09) filed by the Matsushita Industry Co., Ltd. (Non-reparations plant), together with an application of the Ministry of International Trade and Industry as enclosed herewith.
2. Movement and use of the reparations equipment applied herein have already been orally permitted as "temporary operation" by the Mac Military Government Team on 26 June, 1949. It is desired that they be permitted formally as "AU".
3. This application has been investigated and has been coordinated with other interested government agencies.
4. It is requested that your most favorable consideration be given to this application at the earliest practicable date.

(T. Katsumo)
 Director, Reparations Division,
 Reparations Agency.

tion of the Ministry
 100.
 of the Ministry
 ational Trade and
 n of the subject

hick

List of Facilities for Application

Code No. 23-19

Name of Plant. Kusu Factory, Nagoya ^{Military} Arsenal.

Address of Plant. Kusu-cho, Mie-gun, Mie Pref.

T.O. Approved Date: June 28, 1949

1 Machinery

Inv. No.	Name of Machine	Brief Specifications	qt.	Remarks
23-9-895	Lathe	Cap, swing 740mm bed length 4500mm	1	Approved June 28, 1949
# 402	Boring Machine	Horizontal Bar dia 65mm	1	"
" 1019	Drilling Machine	Swing 480mm	1	"
" 1020	Drilling Machine	"	1	"
" 821	Drilling Machine	Swing 850mm	1	"
" 720	Boring Machine	Jig Boring table size 494x715mm	1	"
" 351	Boring Machine	Precision table size 1650x510mm	1	"
" 383	Milling Machine	Vertical, 705x255x50mm	1	"
" 617	Milling Machine	Vertical 1200x360x400mm	1	"
Total			9	

THE TOKAI FINANCE BUREAU

THE MINISTRY OF FINANCE

MINAMI SOTOBORI CHO

File No. TFB-L-²¹~~18~~ NAGOYA

March 9th, 1951.

Chief,
Tokai-Hokuriku Civil Affairs Region,
Nagoya, Honshu.

Dear Sir,

Application for Removal and
Consolidation of Reparations
Items in the Kusu Factory,
Nagoya Army Arsenal (Code No.
23-9) Mie Prefecture.

No.12 Building which is housing reparation items in the Kusu Factory, Nagoya Army Arsenal is one of the buildings borrowed from the Toa Wool Spinning & Weaving Company the roof of which has been damaged badly by the last storm.

In view of the fact that the above-mentioned building is desired to be used due to the recent expansion a storehouse by the Company, we should like to remove and consolidate all reparations items housed in the building into the compound of the 2nd Naval Fuel Depot (Code No. 23-13) Yokkaichi City, and also from the point of view of maintenance and custody.

Kindly give your approval to the above-mentioned subject.

Yours very respectfully,

APPROVED

E. F. Jomard
E. F. Jomard DAC
Economics Div. THCAR

Date *17 Mar. '51*by *M. Yamamoto*

T. Yoshihashi
T. Yoshihashi,
Director.

Description

Name of building & Plant		Quantity	Weight	Remarks
From No.12 Building, Kusu Plant.	To No.119 Building, 2nd Naval Ars.	216	ton 14,717	Tools only
"	"	184	163,551	Machinery

Nagoya Military Arsenal, Kusu Plant. (23)

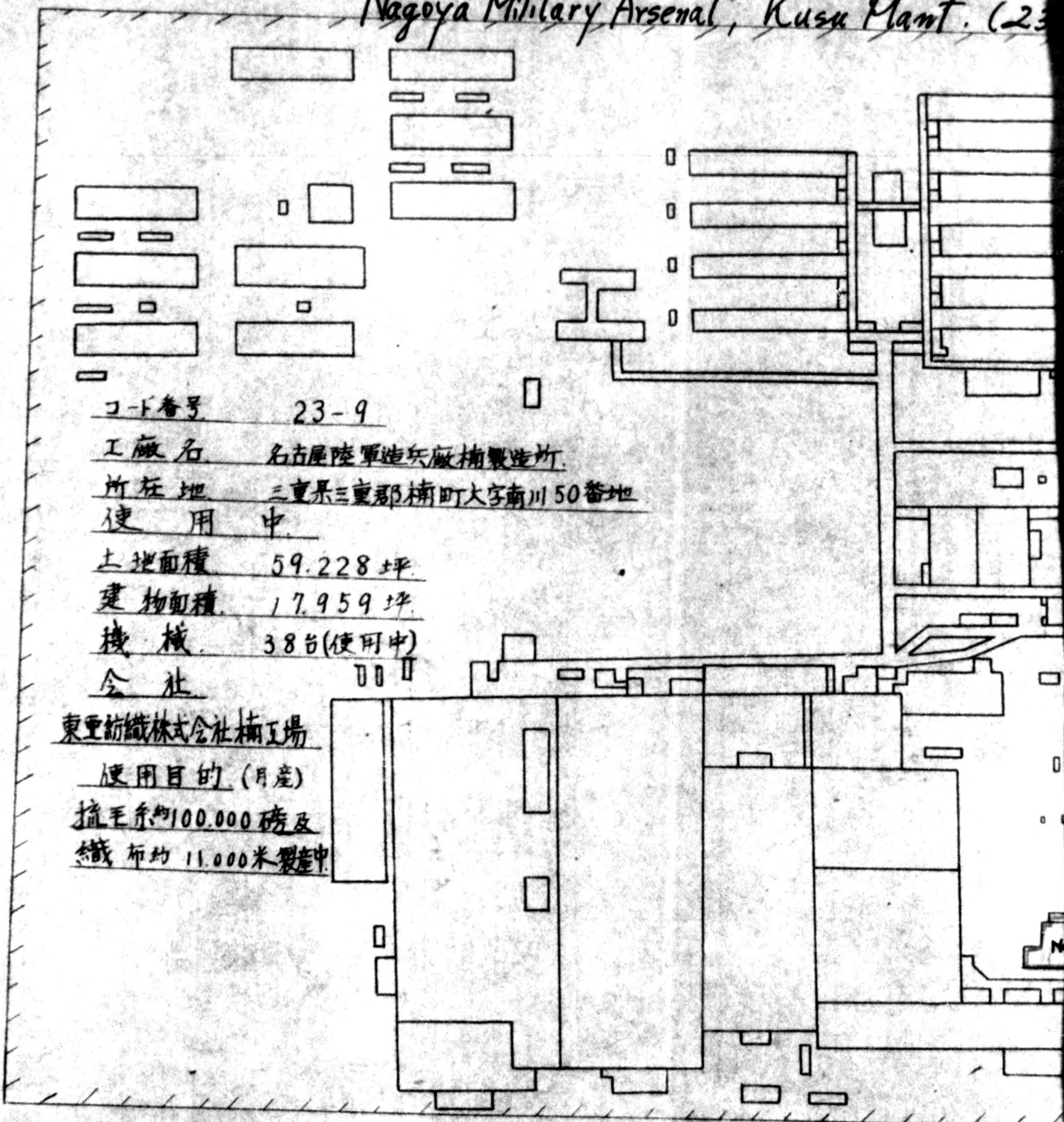

コト番号 23-9

工廠名 名古屋陸軍造兵廠楠製造所

所在地 三重県三重郡楠町大字南川50番地
使用中

土地面積 59.228坪

建物面積 17.959坪

機械 38台(使用中)

会社 〇〇〇

東亜紡織株式会社楠工場

使用目的 (月産)

梳毛糸約100,000磅及
織布約11,000米製産中

Military Arsenal, Kusu Plant. (23-9)

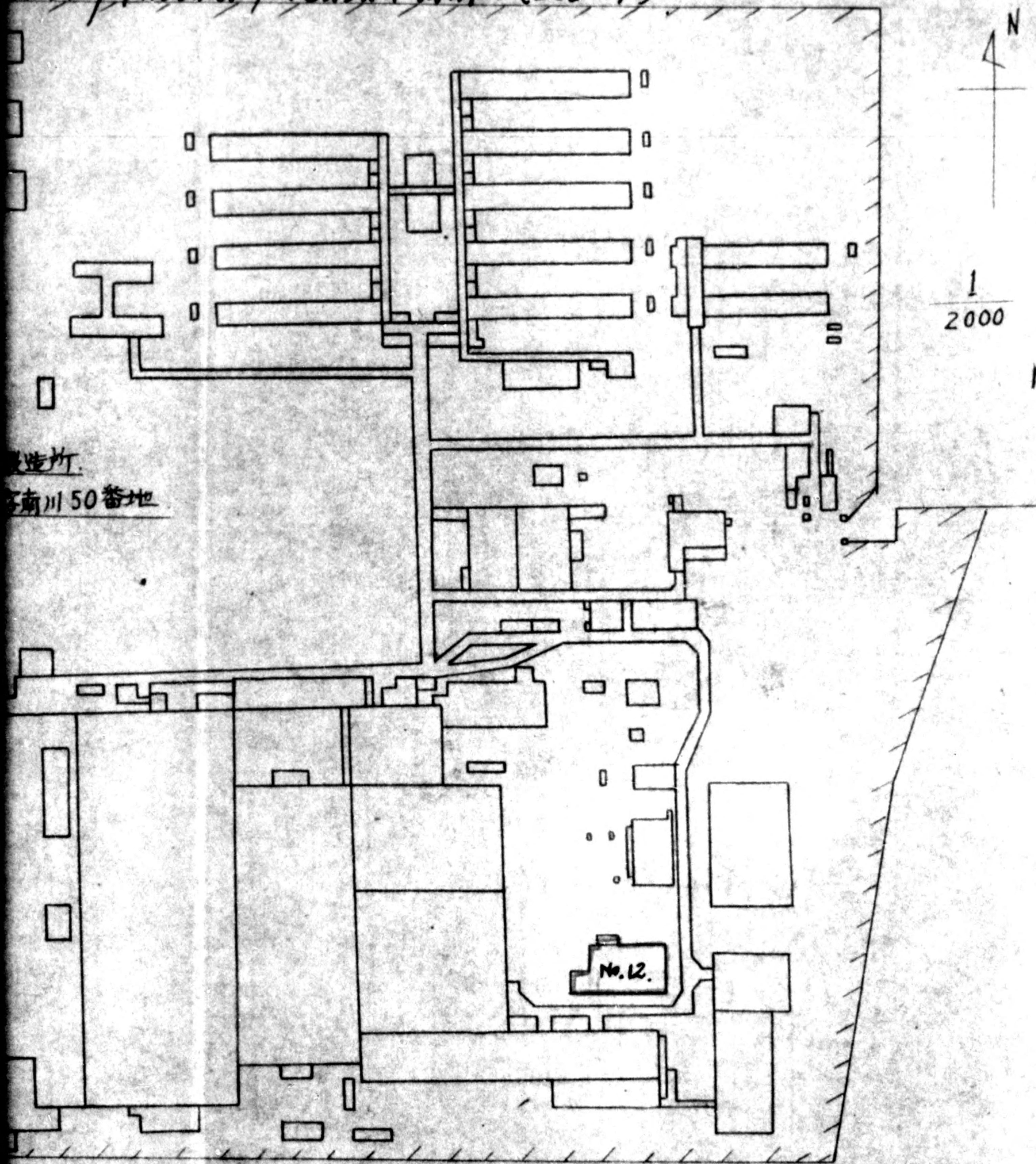

コード番号 23-13
工廠名 川第二海軍燃料廠
所在地 三重県四日市市(飯浜町有地)

敷地約60万坪(一区劃面積約

2nd Naval Fuel Depot (2

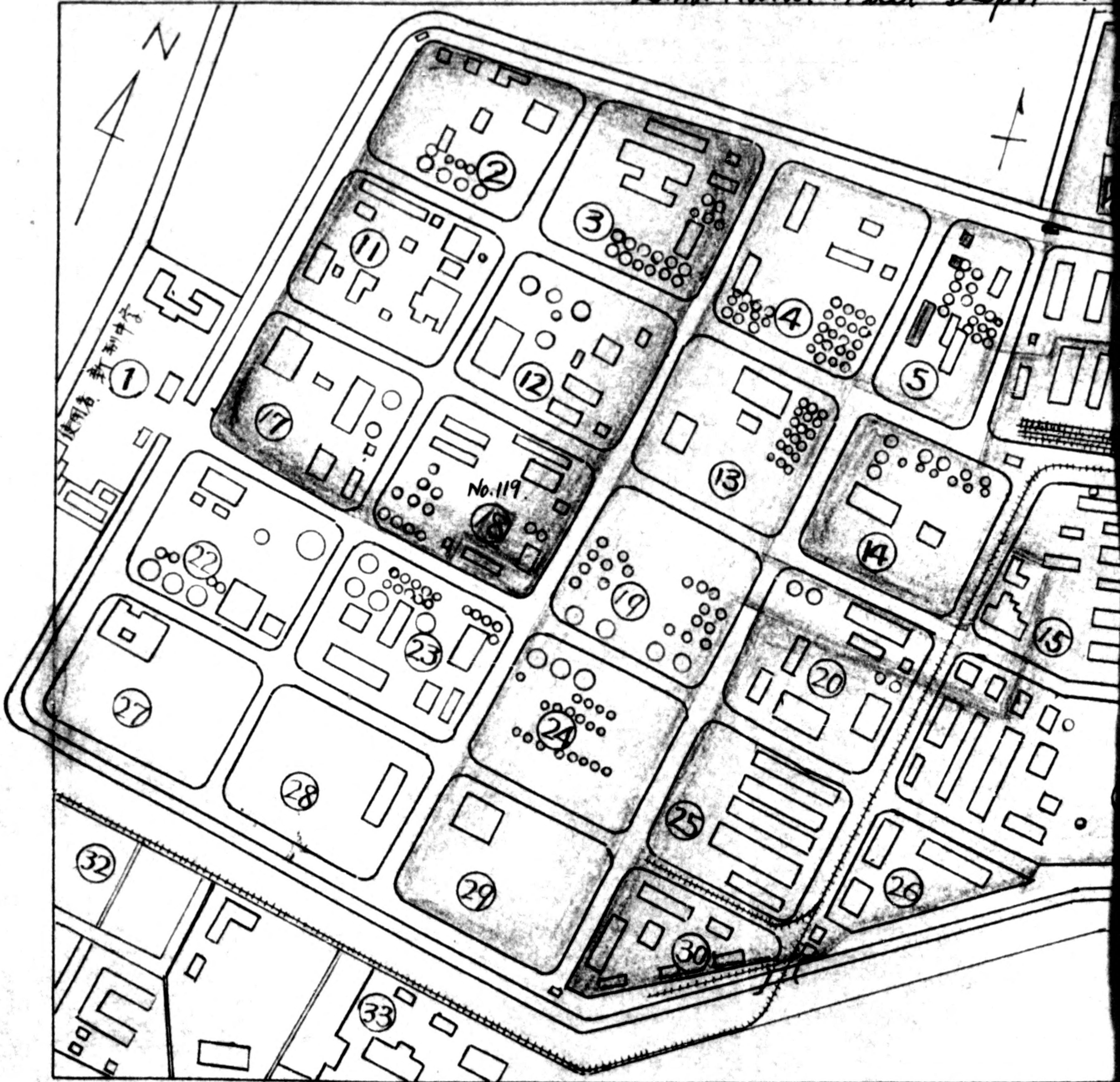

敷地約60万坪(一區劃面積約)

2nd Naval Fuel Depot (23-13)

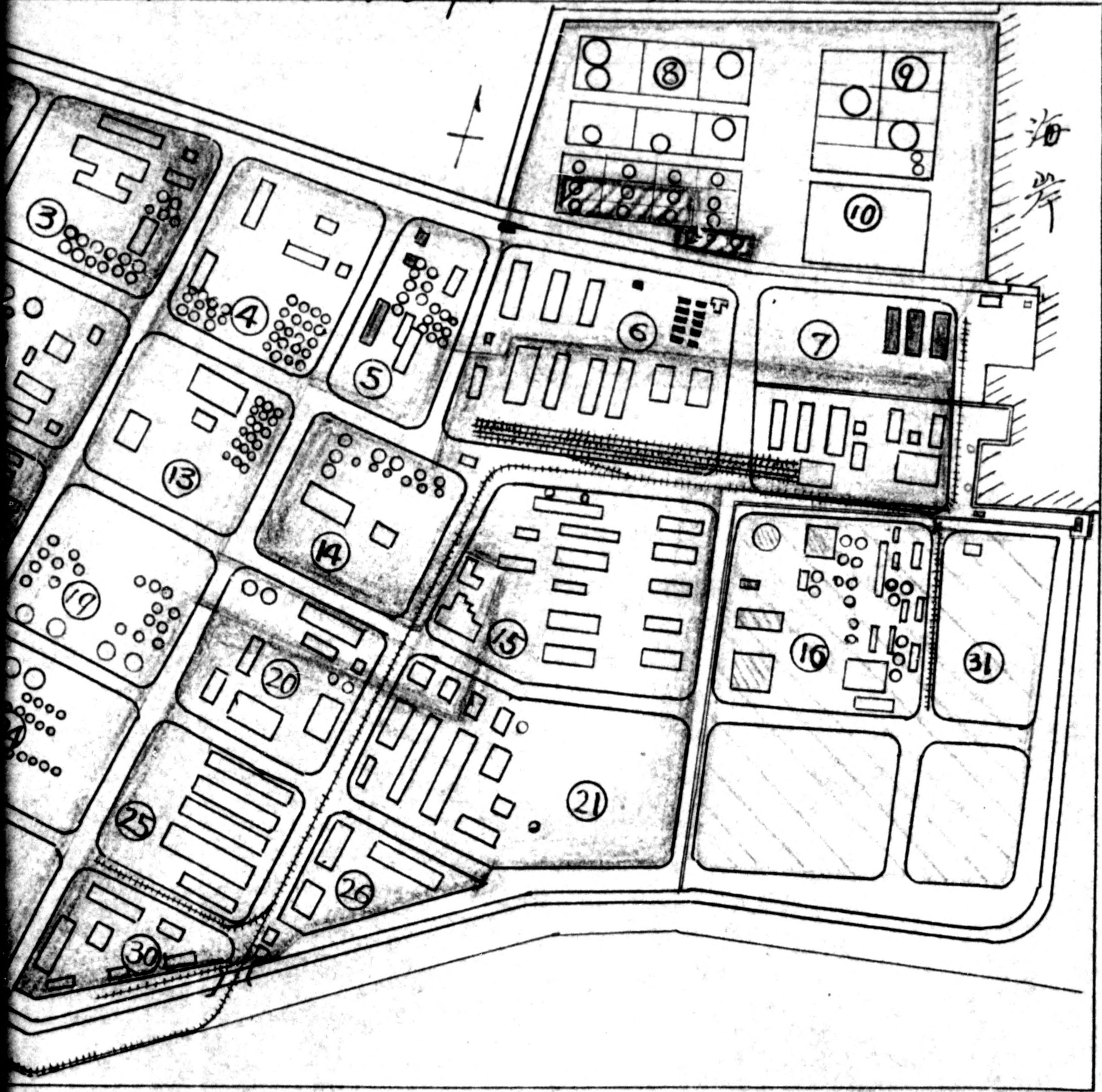

THE TOKAI FINANCE BUREAU

THE MINISTRY OF FINANCE

MINAMI SOTOBORI CHO

NAGOYA

January 18, 1951.

To : Tokai-Hokuriku Civil Affairs Region,
Nagoya.

From : Tokai Finance Bureau, Nagoya.

Subject: Application for Move of Reparations Machinerys
and Release of Building in Kusu Plant, Nagoya
Army Arsenal.

As regards the above-mentioned subject, we submit herewith this application in compliance with the Toa Wool Spinning & Weaving Company which is the owner of Land and Building, now in borrow by the Japanese Government, and that which they would have to use the 13th building.

The said building are now housing only four(4) units of Reparations machinerys be disposed as scrap, and also it is too much defects on the guard for isolation from the other building of Reparations machinerys housed.

In the occasion of the request to use the above building by the Toa Wool Spinning & Weaving Company, it is proposed that four (4) units of machinery housed in its building will be required to move to the 12th building which is the nearest place, and it is the proper measures, not only for the management of Reparations machinery, but also for conservation.

The expenses for move of machinery will be offered in responsibilities of the above-mentioned Company as the real owner, requested to use the building.

Specification for move of machineries is shown in a copy and plan annexed.

We wish you will be taken your special consideration for the above-mentioned subject.

T. Yoshihashi
.....
T. Yoshihashi,
Director.

APPROVED
E. F. Jouard
E. F. Jouard DAC
Economics Div. THCAR
Date *29 Jan. 57*

Specification for move of machineries

1. Number of machineries be moved

Machineries, be moved;	4 units
Total weight of machineries;	18 tons
Distance, be moved;	160 meters

2. Building, be required to move machineries;

No.13 building

Building, to be housed removable machineries;

No.12 building

3. Building, be released;

No.13 building

4. Expenses, be required;

Responsibilities of the
Tea Wool Spinning &
Weaving Company.

Kusu Plant, Nagoya Army Arsenal.

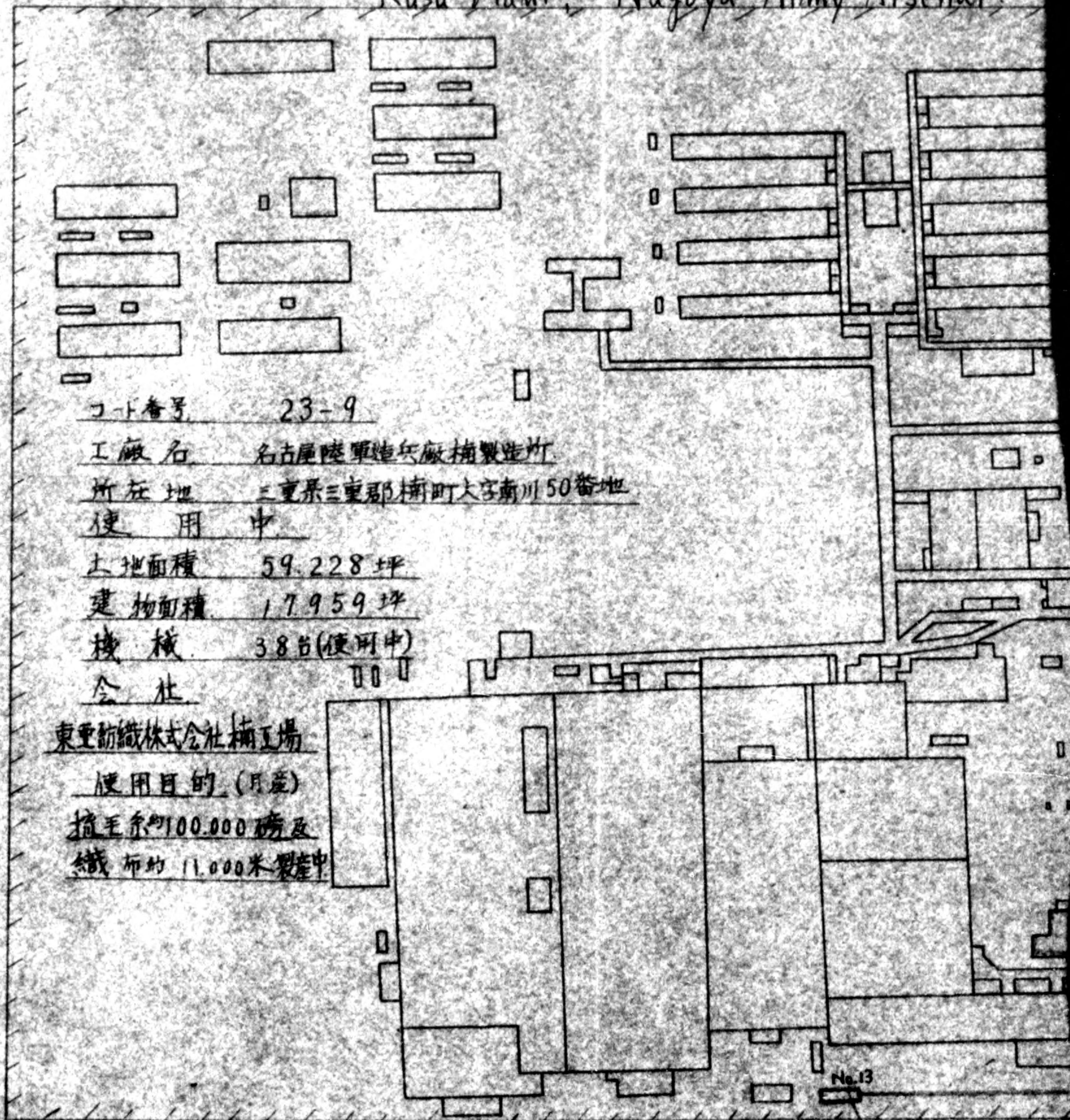

工厂番号 23-9

工厂名 名古屋陸軍造兵廠補製造所

所在地 三重県三重郡楠町大字南川50番地

使用中

土地面積 59,228坪

建物面積 17,959坪

機械 38台(使用中)

会社

東亜紡織株式会社補工場

使用目的 (月産)

梳毛糸約100,000磅及

織布約11,000米製中

No. 13

Scrap down 40

ant, Nagoya Army Arsenal.

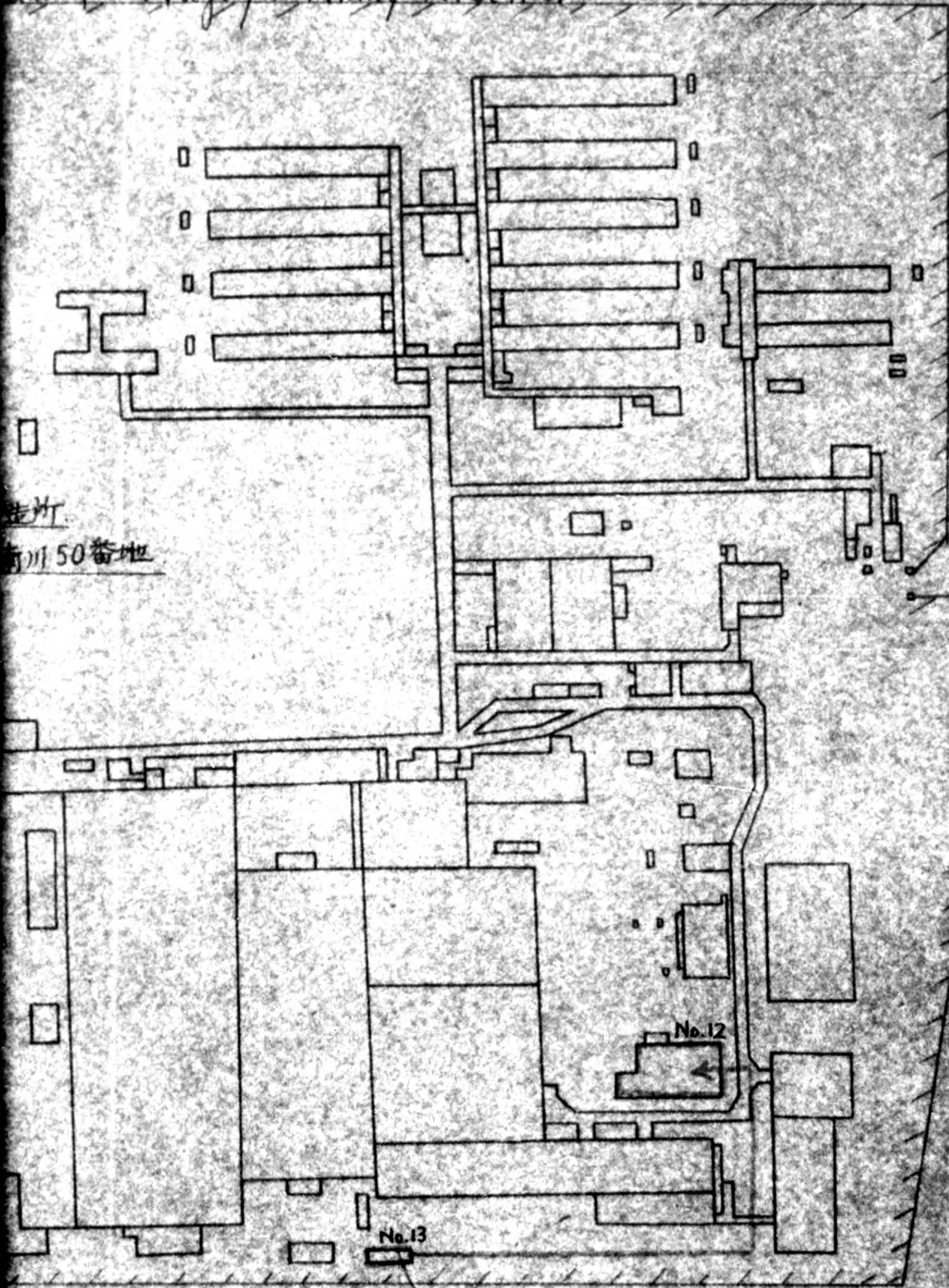

2000

新川 50 番地

E. F. Jourd
 E. F. Jourd DAC
 Economics Div. THCAR
 Date 29 Jan 54
 by Y. Yamamoto

scrapped down
gates only

THE TOKAI FINANCE BUREAU

THE MINISTRY OF FINANCE

MINAMI SOTOBORI CHO

NAGOYA

September 6, 1950.

Chief,
Tokai Hokuriku Civil Affairs Region,
Nagoya, Honshu.

Dear Sir,

Application for Release of a
Portion of Ground Designated
as Reparations Area.

The Former Kusu Plant of the Nagoya Army Arsenal at Kusu, Mie Prefecture has been converted into woollen textile mill by the Toa Woollen Textile Mfg. Company, Ltd., the owner of the Plant. The reparations items in the Plant have been centralized in an area and housed in the buildings as are indicated on the attached diagram.

The Company is now contemplating to build in tennis court area dormitory buildings and houses to accommodate its employees who increase in number due to the expansion of the Plant.

The Company is wishing to be permitted to use the area indicated by red lines on the map as play-ground and tennis court for the employee.

We have investigated on the spot the application and found there is no object to this application from the standpoint of custody and maintenance of the reparations items housed therein.

Will you please approve this application from the Toa Woollen Textile Mfg. Company?

APPROVED
E. F. Jourd
E. F. Jourd DAC
Economics Div. THCAF

Date *11 Dec. 50*

Yours very truly,

T. Yoshihashi
.....
T. Yoshihashi,
Director.

Kusu Plant, Nagoya Mil:

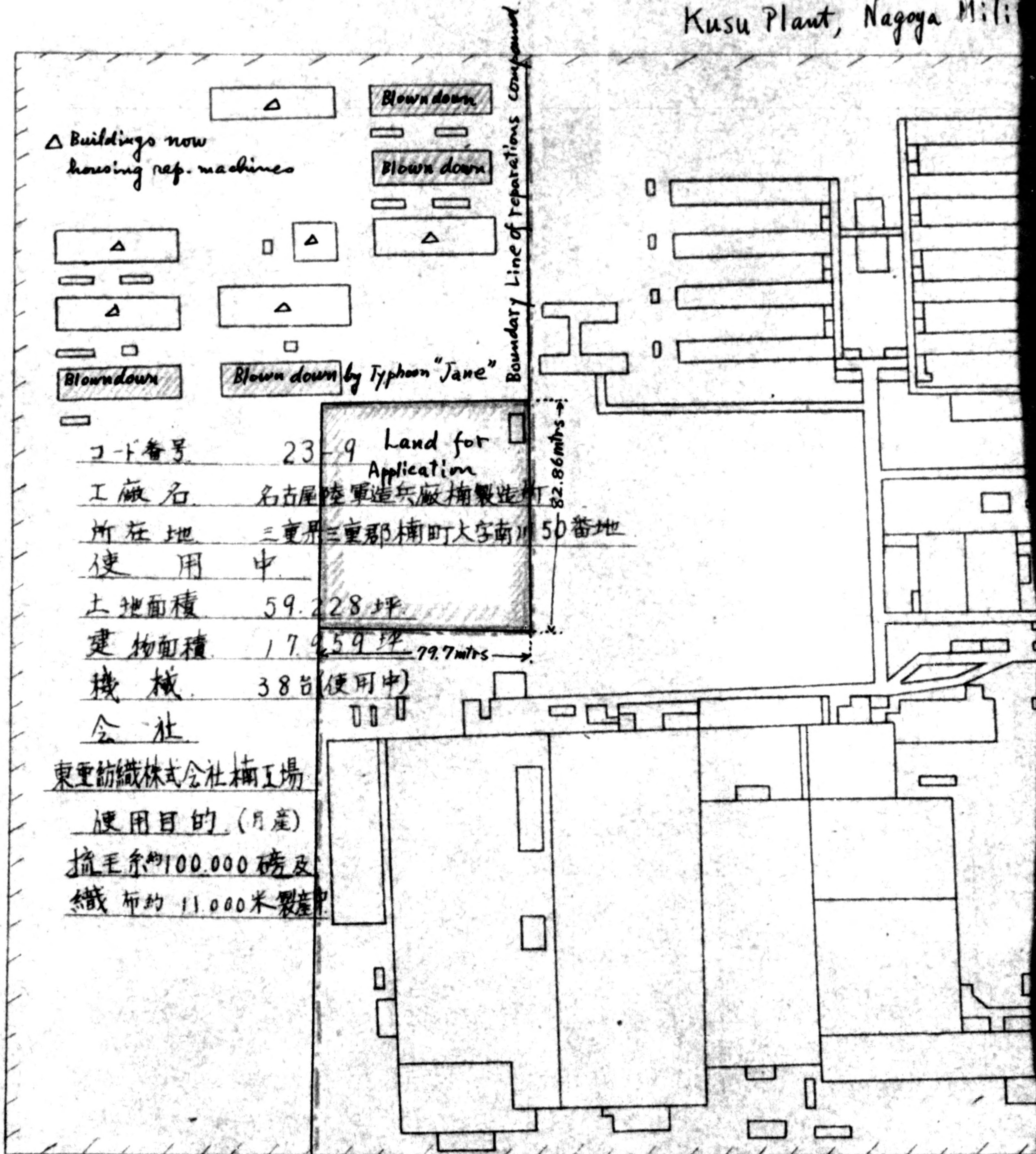

△ Buildings now housing rep. machines
 Blown down
 Blown down
 Blown down
 Blown down by Typhoon "Jane"
 Land for Application
 32.86mtrs
 50番地
 79.7mtrs
 23-9
 名古屋陸軍造兵廠補製造所
 三重県三重郡楠町大字南川
 使用中
 土地面積 59.228坪
 建物面積 17.959坪
 機械 38台(使用中)
 会社
 東重紡織株式会社楠工場
 使用目的(月産)
 梳毛糸約100,000磅及
 織布約11,000米製産

Kusu Plant, Nagoya Military Arsenal

Boundary Line of Repairs Compound

82.86mtrs
南川 50 番地



1
2000

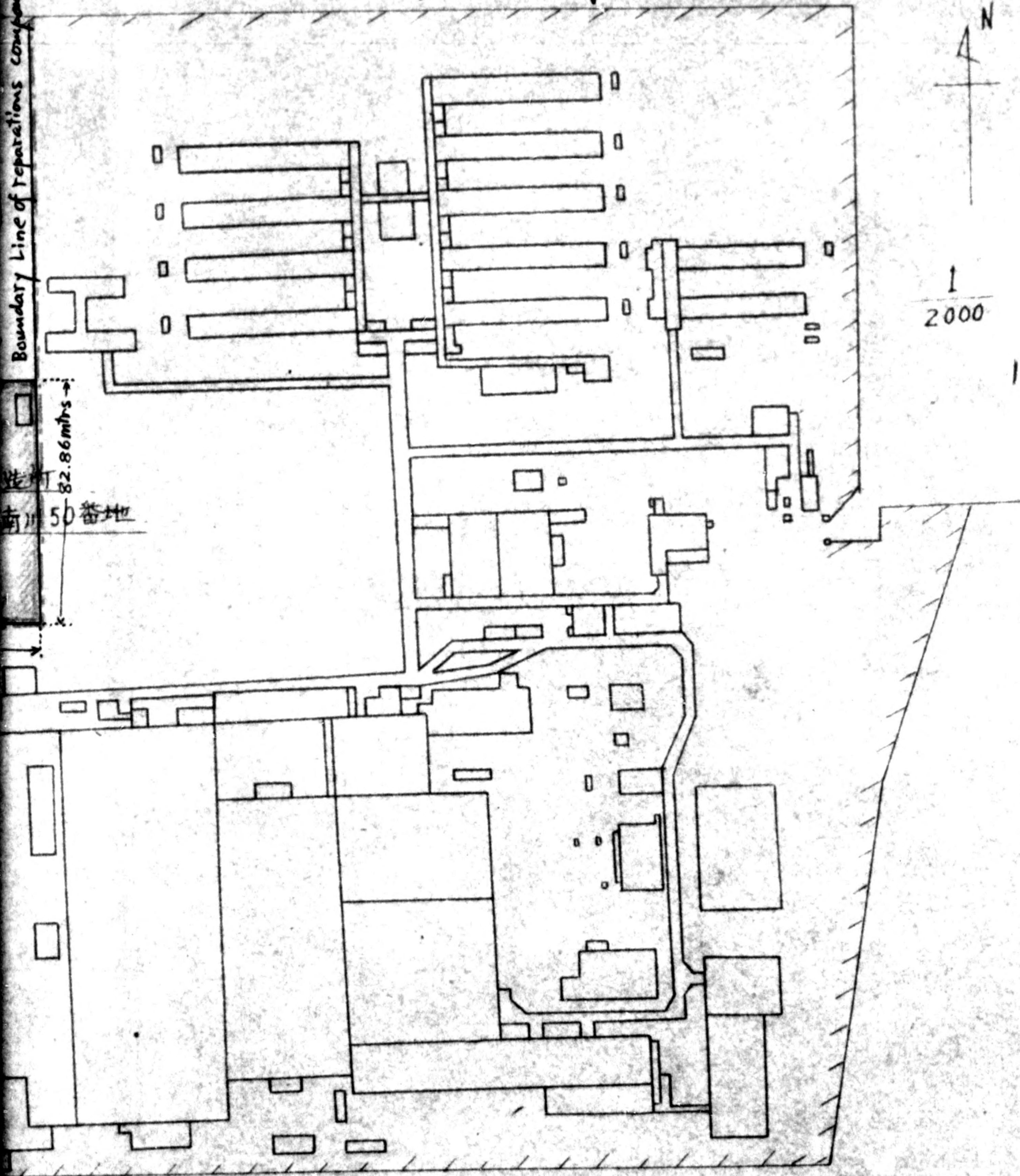

THE TOKAI FINANCE BUREAU

THE MINISTRY OF FINANCE

MINAMI SOTOBORI CHO

NAGOYA

October 19, 1950.

Chief,
Tokai Hokuriku Civil Affairs Region,
Nagoya, Honshu.

Dear Sir,

We hasten to make a report of 17 pieces of motors stolen from the Kusu Plant (Code No.23-9) as mentioned on the accompanying sheets. These motors are those the ones attached to the re-
parations machines.

We have found this fact on October 18th, and got in touch with the Kusu Town Police Station immediately. The Police is now searching out thieves and the items stolen, and we expect they would be found sometime soon.

We shall make reports to you in this connection later.

Yours very respectfully,

T. Yoshihashi

.....
T. Yoshihashi,
Director.

Enclosure: One List

LIST OF ITEMS STOLEN

Code No.	Inv. No.	Name of Machine	Capacity	Pieces	Remarks
23-9	574	Meter(Attached to Drilling)	2 HP	1	(No. of 6 Bldg.)
"	603	" (" Lathe)	1	1	"
"	721	" (" ")	1.3	1	(No. of 8 Bldg.)
"	730	" (" Drilling, Bench)	0.5	1	"
"	731	" (" ")	0.5	1	"
"	733	" (" Drilling)	2	1	"
"	734	" (" Grinder)	2	1	"
"	737	" (" ")	0.5	1	"
"	764	" (" Drilling)	1	1	"
"	766	" (" ")	1	1	"
"	1007	" (" Lathe)	2	1	(No. of 9 Bldg.)
"	1009	" (" ")	2	1	"
"	1039	" (" Grinder)	0.5	1	"
"	811	" (" ")	2	1	(No. of 11 Bldg.)
"	717	" (" ")	2	1	(No. of 7 Bldg.)
"	712	" (" Grinder, Cutter)	1	1	"
"	690	" (" Buffing)	0.5	1	"

TOTAL

17 Pieces

HEADQUARTERS
MIE MILITARY GOVERNMENT TEAM
APO 710

WLT/LC/ft

23 June 1949

SUBJECT: Authority for Removal of Released Exempt Equipment from Reparations Installations

THRU: Liaison Office, Mie Prefecture

TO: Plant Master, Kusu Factory, Nagoya Military Arsenal

1. References:

a. Letter, Headquarters Eighth Army ACMGFM 386.3, subject: "Authority for Released Exempt Equipment to be Moved from Reparations Installations", dated 14 December 1948.

b. Letter, Headquarters I Corps, AG-004-BA, subject: "Authority for Removal of Released Exempt Equipment from Reparations Installations", dated 21 December 1948.

2. The following three (3) equipment have been established as EX and are hereby released to the rightful owner for use, removal, or sale. These equipment will be marked "EX".

<u>Name of Equipment</u>	<u>Manufacturer</u>	<u>Capacity</u>	<u>Quantity</u>
Pulverized coal combustionner	Yokohama Kisha Seizo K.K.	5000 Kg/H	1
Enokido-shiki Stoker	Enokido Stoker K.K.	-	2

FOR THE COMMANDING OFFICER:

ROBERT E. BERGSTEN
Capt., CAC
Asst. Adjutant

cc: Chief, Tsu Local Division, Nagoya Finance Bureau
Plant Manager, Kusu Plant, Toa Spinning Co., Ltd.
Chief of Guards, Kusu Factory, Nagoya Military Arsenal (23-9)

Toa Boshoku k.k. Kusu Mill
Kusu-cho, Mie-gun, Mie-ken.

10 June 1949

SUBJECT: Application for carrying in machines. (23-9)
TO : Mie Military Government Team.
THRU : Tsu Local Division, Nagoya Finance Bureau.

We wish to your kind permission for carrying purchased machines into Kusu Factory, Nagoya Army Arsenal as shown the following.

Name	Qt.	Size	Serial No. or Remarks	Purchased Maker
Plaverized coal combusioner	1	500kg/H	No. Unknown, 1948	Yokohama Kisha Seizo Co., Ltd.
Enokido-shiki Stoker	2	7,	No. Unknown, 1949	Enokido Stoker Co.

S. Ukai
SUSUMU UKAI
Chief, Tsu Branch Office,
Nagoya Finance Division.

Yuji Tamura
YUJI TAMURA
Plant Master, Kusu Mill,
Toa Boshyoku k.k.
Kusu-cho, Mie-gun, Mie-ken.

K. Kubo
K. KUBO
Plant Master, Kusu Factory,
Nagoya Army Arsenal.

PACKING LIST

Plant Code Symbol: 23-9-4416-A Allocation Number: 6147-A
 Recipient Nation: China Package Number: 464-A
 Weight: 1.505 kgs Width: 3.8 feet
 Cubage: 140.4 cub. feet Height: 4.8 feet
 Length: crate Set No: _____
 Type of Package: _____ Position Code No: _____

Quantity	Item
1	<p data-bbox="638 1618 757 1655">Lathe</p> <p data-bbox="644 1884 827 1922"><u>Remarks:</u></p> <ul style="list-style-type: none"> <li data-bbox="693 1991 1379 2028">1. 8 change gears missing <li data-bbox="693 2066 1379 2104">2. Feed mechanism missing <li data-bbox="693 2141 1379 2179">3. 1 set spanner missing <li data-bbox="693 2217 1379 2254">4. Many small parts missing

Name of Packer

Hamaguchi Gumi

PACKING LIST

Plant Code Symbol: 23-9-4416-A Allocation Number: 6147-A
 Recipient Nation: China Package Number: 464-A
 Weight: 1.505 kgs Width: 3.8 feet
 Cubage: 140.4 cub. feet Height: 4.8 feet
 Length: crate Set No: _____
 Type of Package: _____ Position Code No: _____

Quantity	Item
1	<p data-bbox="632 1477 749 1514">Lathe</p> <p data-bbox="638 1740 823 1781"><u>Remarks:</u></p> <ul style="list-style-type: none"> <li data-bbox="691 1843 1379 1884">1. 8 change gears missing <li data-bbox="691 1919 1379 1960">2. Feed mechanism missing <li data-bbox="691 1994 1379 2035">3. 1 set spanner missing <li data-bbox="691 2069 1379 2110">4. Many small parts missing <p data-bbox="1135 2518 1592 2590" style="text-align: right;">Name of Packer Hamaguchi Gumi</p>

PACKING LIST

Plant Code Symbol: 23-9-4416-A Allocation Number: 6147-A
 Recipient Nation: China Package Number: 464-A
 Weight: 1.505 Kgs Width: 3.8 feet
 Cubage: 140.4 cub. feet Height: 4.8 feet
 Length: crate Set No: _____
 Type of Package: _____ Position Code No: _____

Quantity	Item
1	<p style="text-align: center;">Lathe</p> <p><u>Remarks:</u></p> <ul style="list-style-type: none"> 1. 8 change gears missing 2. Feed mechanism missing 3. 1 set spanner missing 4. Many small parts missing

Name of Packer

Hamaguchi Gumi

PROGRES REPORT OF POOLED ITEM

- 1. Report No: 2
- 2. Allocation No: 6147
- 3. Period Ending: 27th Dec. '48
- 4. Code symbol of plant being reported on: 23-9
- 5. Dismantling, disassembly, and packaging:
 - a. Allocation notice completion date: 31st Dec. '48
 - b. Present estimated completion date: 27th Dec. '48
 - c. Number of major items packaged during report period: 2
 - d. Total number of major items packaged to date: 2

e. Packages completed during report period:

Number	Gross Weight (metric tons)	Gross Volume (meas. tons)
2	1.9	4.7

f. Packages completed to date:

Number	Gross Weight (metric tons)	Gross Volume (meas. tons)
2	1.9	4.7

6. Remarks:

All Completed

K. Kubo

7. (Signature) Kazuyuki Kubo

8. (Title) Custodian of Kusu Plant

Incl: 23-9-4416-A
23-9-4416-B packing lists

PROGRES REPORT OF POOLED ITEM

1. Report No: 1
 2. Allocation No: None
 3. Period Ending: 15th Dec. 1948

4. Code symbol of plant being reported on: 23-9
 5. Dismantling, disassembly, and packaging:
 a. Allocation noitce completion date: 31st Dec. 1948
 b. Present estimated completion date: 25th Dec. 1948
 c. Number of major items packaged during report period 2
 d. Total number of major items packaged to date: 0

e. Packages completed during report period:

Number	Gross Weight (metric tons)	Gross Volume (meas. tons)

f. Packages completed to date:

Number	Gross Weight (metric tons)	Gross Volume (meas. tons)

6. Remarks:

Kazuyuki Kubo

7. (Signature)

KAZUYUKI KUBO

8. (Title)

Plant Master, Kusu Factory,
Nagoya Army Arsenal.

Incl: None packing lists None

APPLICATION FOR RELEASE OF DESTROYED
SPECIAL PURPOSE MACHINES MATERIAL.

8 Nov. 1948

1. Location of Materials:

Kusu Factory, Nagoya Army Arsenal. (23-9)

Kusu-cho, Mie-gun, Mie Pref.

2. Name of Material and quantity:

Name of Machine	Quantity	Description (tonnage)	Remarks
Gun Barrel Boring Machine	9	81.0	Destroyed by Occupied Forces at the time Occupied.
Cart/ridge Case lathe	14	11.2	"
Breaching Machine	3	3.5	"
Rifle Boring Machine	4	18.0	"
Cart/ridge Case Vertical Press	6	24.0	"
Cart/ridge Case Horizontal Press	6	11.0	"
Total	42	148.7	

3. Proposed use after released:

It is proposed that these material be distributed to popular supply, and be used as the material for production and restoration.

Osamu Aoki

OSAMU AOKI
Governor, Mie Prefecture.

Kiyomoto Otsuka

KIYOMOTO OTSUKA
Chief, Tsu Local Division,
Nagoya Finance Bureau.

INSTRUCTIONS FOR REPORTING PLAN FOR REMOVAL OF
CPC MACHINES

1. Plant or facility being reported on:

- a. Plant code symbol: 23 - 12
 b. Tsu Naval Arsenal
 c. Location: Komori Tsu-Shi Mie-Pref
 d. Industrial category: Arsenal

2. Shipping data:

a. Removable equipment (not including building) :

- (1) Total Number of packages: 41
 (2) Gross weight: 114 metric tons
 (3) Net weight: 95 " "
 (4) Gross volume: 108.594 measurement tons (40 cubic ft)
 (5) Size of largest item of equipment to be removed as a single unit:
 (a) Gross weight: 3 metric tons
 (b) Gross volume: 3.573 meas. tons
 (c) Length: 3.4 M
 (d) Width: 0.9 M
 (e) Height: 1.3 M

3. Time required:

- a. Dismantling, disassembly, and packaging of equipment:
 30 days: 1425 man-days,
 e. Gantt Charts: Inclosure 1.

(4) Transportation

a. Within Plant

Vehicle	Size metric tons	Number Required for equip	Days Require for equip
1. Trucks	4	1	5
(5) 2. Wagon	1.5	1	10

(5) Principal non-expendable items required for removal:

Item	Unit	Amount for equip.
a. Rope, wire	M	100
b. Rope, manila	M	100
c. Sluch	ea	2
d. Chain block	ea	3
e. Hand drill	ea	4
f. Balance	ea	2
g. Good working M/C	ea	3

(6) Principal expendable items required for removal:

Item	Unit	Amount for equip.
a. Lumber	Koku (3)	285
b. Nails	Kg ((9))	855
c. Bolts and nuts	Kg (15)	1420
d. Strapping, metal	Kg (1.1)	104
e. Grease, preservative	Kg (1.0)	95
f. Oil, preservative	L (0.4)	25
g. Solvent	L (1.3)	124
h. Gasoline:		
(X) For transportation within plant	L	50

Item	Unit	Amount For equip.
i. Oil, lubricating	L	13
j. Paint, preservative	kg (0.1)	9,5
k. Asphalt roofing	m ² (7)	670
l. Roofing felt	m ² (2)	190
m. Lag screw	kg (1)	95
n. Coal tar	kg (0.4)	38
o. Felt	m ² (0,3)	329
p. Oil, paper	m ² (4)	380
q. Paper waterproof	m ² (4)	380
r. Wire	kg (1)	95
s. Asphalt	kg (0.4)	38
t. Paint (Marking)	kg (0.5)	48

775013

7. Major items of equipment to be removed and "component breakdown":

C.P.C. No.	Name of Machine	No. Package	Net Weight Met. tons	Net Volume Mee. tons
C.P.C. - 5122	Lathe - Gap & Standard	1	2.6	2.61
5123	"	1	1.8	2.24
5124	"	1	1.8	2.24
5125	"	1	1.8	2.24
5126	"	1	1.82	2.24
5127	"	1	1.82	2.24
5128	"	1	2.5	2.61
5129	"	1	2.5	2.61
5130	"	1	1.8	2.24
5131	"	1	1.8	2.24
5132	"	1	1.8	2.24
5133	"	1	1.8	2.24
5134	"	1	1.8	2.24
5135	"	1	1.88	2.24
5136	"	1	2.6	2.61
5137	"	1	1.8	2.24
5138	"	1	3	3.57
5139	"	1	3	3.57

775013

C.P.C. No.	Name of Machine	No. of Package	Net Weight Met. tons	Net Volume Met. tons
C.P.C. - 5140	Lathe - Gap & Standard	1	3	3.57
5141	"	1	2.6	2.61
5142	"	1	3	3.57
5143	"	1	1.8	2.24
5144	"	1	1.5	2.07
5145	"	1	2.6	2.61
5146	"	1	2.5	2.61
5147	"	1	2.6	2.61
5148	"	1	2.6	2.61
5149	"	1	2.6	2.61
5150	"	1	2.6	2.61
5151	"	1	2.6	2.61
5152	"	1	3	2.88
5153	"	1	2.6	2.61
5154	"	1	1.8	2.24
5155	"	1	2.6	2.61
5156	Milling Machine - Knes Horizontal	1	1.5	2.42

C.P.C. No.	Name of Machine	No. of Package	Net Weight Met. tons	Net Volume Mea. tons
C.P.C.-5157	Lathe Gap & Standard	1	1.8	2.24
5158	"	1	3	3.57
5159	"	1	3	3.57
5160	"	1	3	3.57
5161	"	1	3	3.57
5162	"	1	1.8	2.24
Total			95	108.31

Chart of March

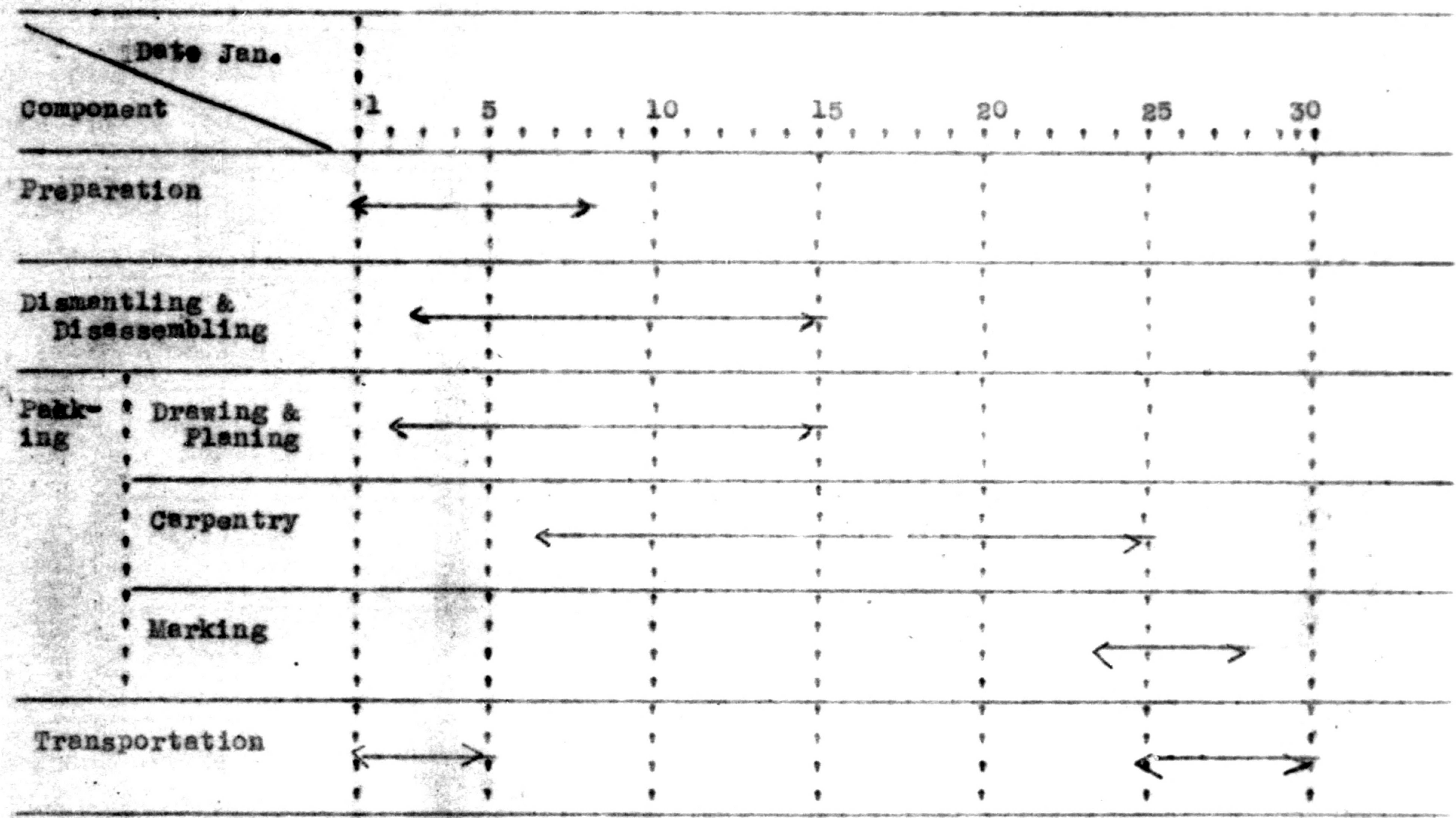

Plant Layout

Tsu Naval Arsenal

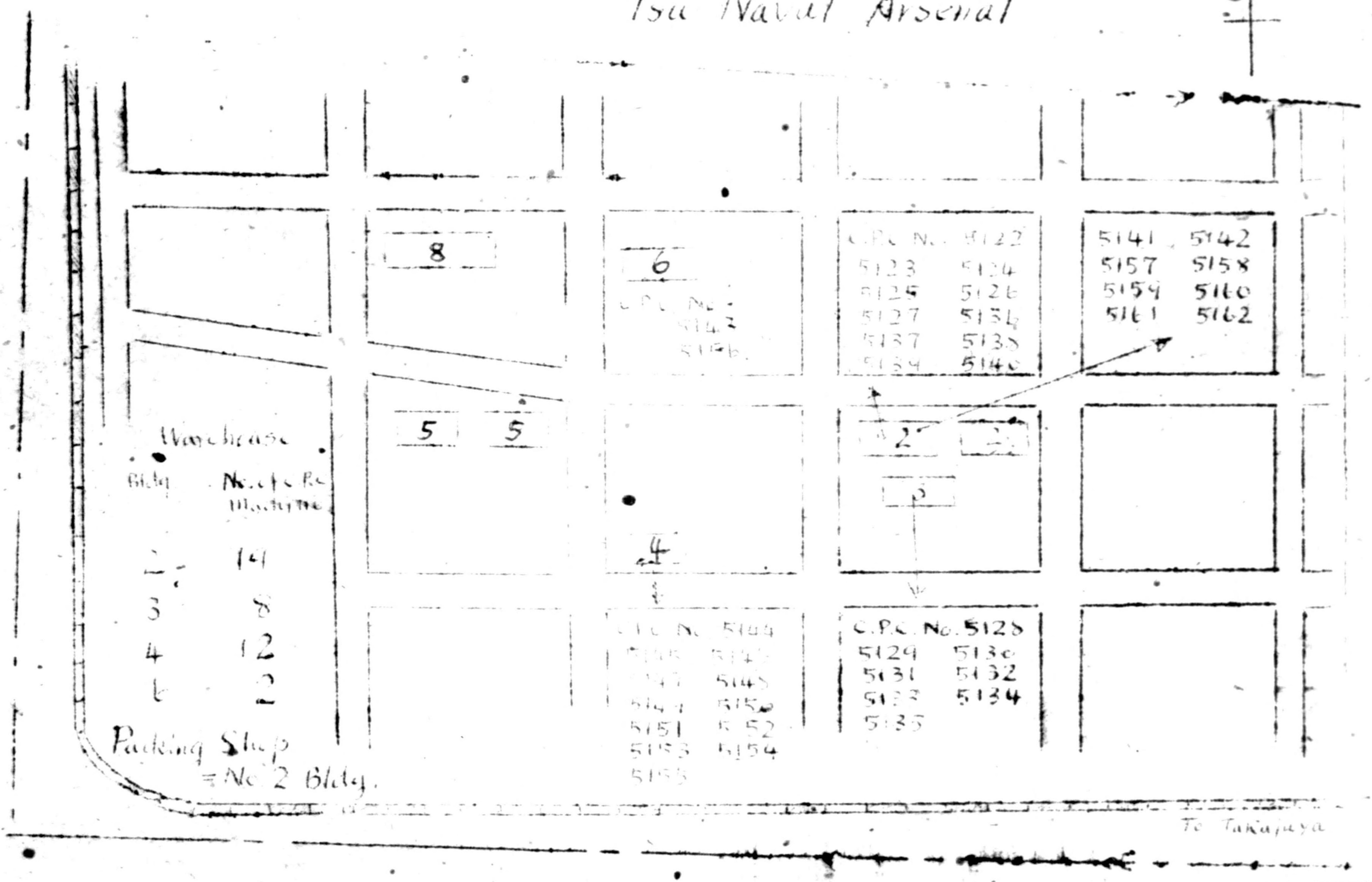

To Takayama

INSTRUCTIONS FOR REPORTING PLAN FOR REMOVAL OF
CPC MACHINES

1. Plant or facility being reported on:

- a. Plant code symbol: 23 - 10A
- b. Company name: Suzuka Naval Arsenal
- c. Plant Name:
- d. Location: Shono-cho, Suzuka-shi, Mie-Pref.
- e. Industrial category: Arsenal

2. Shipping data:

a. Removable equipment (not including building):

- (1) Total Number of packages: 237
- (2) Gross weight: 290 metric tons
- (3) Net weight: 210 " "
- (4) Gross volume: 380.7 measurement tons (40 cubic ft)
- (5) Size of largest item of equipment to be removed as a single unit:
- (a) Gross weight: 4.9 metric tons
- (b) Gross volume: 12.6 meas. tons
- (c) Length: 3.0 M
- (d) Width: 1.4 M
- (e) Height: 3.4 M

3. Time required:

a. Dismantling, disassembly, and packaging of equipment:

30 days: 3150 man-days.

c. Gantt Charts: Inclosure 1.

(4) Transportation

a. Within Plant

Vehicle	Size Metric tons	Number Required for equip.	Days Require for equip
1. Trucks	4	3	10
2. Wagons	1.5	2	10

(5) Principal non-expendable items required for removal:

Item	Unit	Amount for equip.
a. Rope, wire	M	200
b. Rope, manila	M	200
c. Winch	ea.	4
d. Chain block	ea.	12
e. Hand drill	ea.	12
f. Balance	ea.	4
g. Wood working M/C	ea.	6

(6) Principal expendable items required for removal:

Item	Unit	Amount for equip.
a. Lumber	koku (3)	630
b. Nails	kg (9)	1890
c. Bolts and nuts	kg (15)	3150
d. Strapping, metal	kg (1.1)	230
e. Grease, preservative	kg (1)	210
f. Oil, preservative	L (0.4)	60
g. Solvent	L (1.3)	273
h. Gasolines:		
(1) For transportation within plant	L	100

<u>Item</u>	<u>Unit</u>	<u>Amount</u> <u>for equip.</u>
i. Oil, lubricating	L	24
j. Paint, preservative	kg (0.1)	21
k. Asphalt roofing	m ² (7)	1470
l. Roofing felt	m ² (2)	420
m. Lag screw	kg (1)	210
n. Coal tar	kg (0.4)	84
o. Felt	m ² (0.3)	63
p. Oil, paper	sq. m.(4)	840
q. Paper water proof	sq. m.(4)	840
r. Wire	kg (1)	210
s. Point (marking)	kg (0.5)	105
t. Asphalt	kg(0.4)	84

7. Major Items of equipment to be removed and component breakdown:

G.P.C. No.	Name of Machine	No. Package	Net Weight Met. tons	Net Volume Mea. 'tons
4885	shaper	1	900	1.58
4886	Lathe	1	1,000	1,685
4887	"	1	1,000	1,526
4888	"	1	800	1,015
4889	"	1	1,000	1,078
4890	"	1	1,000	1,078
4891	"	1	1,000	1,481
4892	"	1	1,000	1,730
4893	"	1	1,000	1,980
4894	"	1	3,000	3,360
4895	"	1	500	0.635
4896	"	1	500	0.635
4897	"	1	500	0.635
4898	"	1	1,500	2.25
4899	"	1	1,500	2.570

G.P.C. No.	Name of Machine	No. Package	Net Weight Met. tons	Net Volume Mea. tons
4900	Lathe	1	1,200	2.005
4901	"	1	1,500	2.440
4902	"	1	1,500	2.480
4903	"	1	1,700	1.012
4904	"	1	700	1.012
4905	"	1	700	1.012
4906	"	1	700	1.012
4907	"	1	700	1.012
4908	"	1	700	1.012
4909	"	1	700	1.012
4910	"	1	700	1.012
4911	"	1	700	1.012
4912	"	1	700	1.012
4913	"	1	700	1.012
4914	"	1	700	1.012

C.P.C. No.	Name of Machine	No. Package	Net Weight Met. tons	Net Volume Mea. tons
4915	Shaper	1	1,000	1.032
4916	"	1	1,200	2.640
4917	"	1	1,200	1.190
4918	"	1	1,200	1.551
4919	Drilling Machine	1	500	0.547
4920	"	1	500	1.092
4921	Slotted	1	700	1.481
4922	Drilling Machine	1	1,000	0.926
4923	Lathe	1	1,000	1.438
4924	"	1	1,000	1.682
4925	"	1	1,000	1.110
4926	"	1	1,000	1.110
4927	"	1	1,000	1.110
4928	"	1	1,000	1.110

775013

G.P.O. No.	Name of Machine	No. Package	Net Weight Met. tons	Net Volume Mea. tons
4929	Lathe	1	1,000	1.605
4930	"	1	2,000	3.360
4931	"	1	2,000	3.360
4932	"	1	2,000	3.360
4933	"	1	700	1.015
4934	"	1	700	1.015
4935	Shaper	1	500	1.289
4936	Drilling Machine	1	500	0.839
4937	Lathe	1	400	1.015
4938	Shaper	1	600	1.242
4939	"	1	800	1.331
4940	"	1	800	1.481
4941	Lathe	1	1,000	1.405
4942	"	1	800	1.110
4943	"	1	800	1.481
4944	"	1	800	1.182

775013

C.P.O. No.	Name of Machine	No. Package	Net Weight Met. tons	Net Volume Mea. tons
4945	Lathe	1	800	1.110
4946	"	1	800	1.182
4947	"	1	800	1.015
4948	"	1	800	1.015
4949	"	1	1,000	1.590
4950	"	1	1,000	1.110
4951	Shaper	1	1,000	2.480
4952	Drilling Machine	1	1,400	0.925
4953	Shaper	1	400	1.331
4954	Lathe	1	1,000	2.170
4955	"	1	500	1.780
4956	"	1	1,000	2.285
4957	"	1	1,000	2.380
4958	Drilling Machine	1	300	0.850
4959	"	1	500	0.850

775013

S.S.C. No.	Name of Machine	No. Package	Net Weight Met. tons	Net Volume Mea. tons
4960	Lathe	1	700	1.870
4961	Drilling Machine	1	300	1.005
4962	Lathe	1	300	1.480
4963	"	1	500	1.551
4964	Shaper	1	1,000	1.361
4965	Drilling Machine	1	1,000	0.970
4966	Lathe	1	1,500	2.250
4967	"	1	3,000	3.360
4968	"	1	1,200	1.920
4969	"	1	1,200	1.375
4970	"	1	1,500	1.850
4971	"	1	1,500	2.170
4972	"	1	1,500	1.375
4973	"	1	1,200	1.480
4974	"	1	1,000	0.970

G.P.C. No.	Name of Machine	No. Package	Net Weight met. tons	Net Volume mea. tons
4975	Lathe	1	1,000	0.970
4976	"	1	1,200	1.920
4977	"	1	700	1.012
4978	Drilling Machine	1	1,000	1.120
4979	Lathe	1	1,200	1.375
4980	"	1	400	1.012
4981	"	1	1,000	0.954
4982	"	1	1,200	1.042
4983	"	1	1,200	1.935
4984	"	1	1,200	2.166
4985	"	1	1,000	0.972
4986	"	1	1,000	1.042
4987	"	1	1,000	1.042
4988	"	1	1,000	1.935
4989	"	1	1,000	1.556

S.P.C. No.	Name of Machine	No. Package	Net Weight Met. tons	Net Volume Mea. tons
4990	Lathe	1	1,000	1.042
4991	Drilling Machine	1	500	0.601
4992	Lathe	1	1,000	1.042
4993	"	1	1,500	2.386
4994	Milling Machine	1	700	1.935
4995	Lathe	1	700	1.564
4996	Drilling Machine	1	1,000	1.121
4997	Lathe	1	800	1.484
4998	"	1	800	1.484
4999	"	1	800	2.244
5000	Drilling Machine	1	400	0.928
5001	Shaper	1	1,000	1.732
5002	Milling Machine	1	500	2.242
5003	Milling Machine	1	500	2.142
5004	Lathe	1	800	2.485

G.P.C. No.	Name of Machine	No. Package	Net Weight Met. tons	Net Volume Mea. tons
5005	Milling Machine	1	1,000	3.599
5006	Radial Drilling Machine	1	3,500	6.181
5007	Milling Machine	1	800	2.242
5008	"	1	800	2.211
5009	"	1	500	2.068
5010	Lathe	1	1,600	1.484
5011	"	1	1,000	1.927
5012	"	1	700	1.930
5013	"	1	1,000	1.420
5014	Shaper	1	1,000	1.332
5015	Lathe	1	1,000	1.930
5016	"	1	1,000	1.605
5017	"	1	1,000	1.605
5018	"	1	1,000	1.404
5019	"	1	1,000	1.480
5020	"	1	300	1.480

775013

C.P.C. No	Name of Machine	No. Package	Net Weight Met. tons	Net Volume Mea. tons
5021	Lathe	1	200	1.48 0
5022	"	1	200	1.605
5023	Shaper	1	800	2.480
5024	Lathe	1	500	1.480
5025	"	1	800	1.480
5026	"	1	300	1.692
5027	"	1	800	1.480
5028	"	1	800	1.270
5029	"	1	1000	2.785
5030	"	1	"	1.528
5031	"	1	"	1.210
5032	Milling Machine	1	"	2.620
5033	Lathe	1	"	2.250
5034	"	1	"	2.785
5035	"	1	"	2.250
5036	"	1	"	2.250
5037	"	1	"	2.570

DECLASSIFIED E.O. 12065 SECTION 3-402/NNDG NO. 775013

C.P.C. No.	Name of Machine	No. Package	Net Waight Met. tons	Net Volume Mea. tons
5038	Milling Machine	1	700	2.240
5039	Lathe	1	1000	1.605
5040	"	1	"	1.404
5041	"	1	"	1.835
5042	"	1	"	1.480
5043	"	1	"	1.340
5044	"	1	"	1.555
5045	"	1	"	1.078
5046	"	1	"	1.078
5047	Milling Machine	1	"	4.908
5048	"	1	"	1.493
5049	Shaper	1	"	1.493
5050	"	1	"	1.290
5051	"	1	800	1.732
5052	Milling Machine	1	1000	1.935
5053	Shaper	1	1000	1.697
5054	Milling Machine	1	2000	3.610

C.P.C. No.	Name of Machine	No. Package	Net Weight Met. tons	Net Volume Mea. tons
5055	Milling Machine	1	1000	1.493
5056	Shaper	1	"	1.333
5057	Milling Machine	1	"	1.784
5058	Drilling Machine	1	500	1.007
5059	"	1	"	1.007
5060	"	1	"	0.928
5061	"	1	"	0.928
5062	"	1	"	1.175
5063	"	1	"	1.175
5064	"	1	800	1.060
5065	"	1	500	1.007
5066	"	1	300	1.060
5067	Shaper	1	700	1.007
5068	Drilling Machine	1	300	1.095
5069	"	1	500	1.007
5070	"	1	"	1.095
5071	"	1	"	1.060
5072	"	1	"	0.918

C.P.C. No	Name of Machine	No. Package	Net Weight Met. tons	Net Volume Mea, tons
5073	Lathe	1	1500	2.375
5074	Milling Machine	1	1000	2.308
5075	Lathe	1	"	2.375
5076	"	1	"	2.580
5077	"	1	800	1.564
5078	"	1	500	1.935
5079	Shaper	1	800	1.785
5080	Turret Lathe	1	800	2.758
5081	Lathe	1	1000	2.580
5082	"	1	"	2.580
5083	"	1	"	2.580
5084	Drilling Machine	1	500	0.885
5085	"	1	"	0.908
5086	"	1	"	1.686
5087	"	1	1000	2.580
5088	Shaper	1	500	1.766

775013

C.P.C. No.	Name of Machine	No. Package	Net Weight Met. tons	Net Volume Cea. tons
				2.859
5089	Lathe	1	1000	
5090	Shaper	1	800	1.590
5091	Lathe	1	"	1.318
5092	"	1	"	1.546
5093	"	1	"	1.590
5094	Milling Machine	1	"	1.476
5095	Lathe	1	1500	1.834
5096	"	1	1000	1.935
5097	Drilling Machine	1	"	0.594
5098	Turret Lathe	1	"	1.205
5099	Lathe	1	"	2.580
5100	"	1	"	2.580
5101	Milling Machine	1	"	2.184
5102	Drilling Machine	1	400	0.996
5103	Milling Machine	1	900	2.184
5104	Drilling Machine	1	500	2.649

C.P.C. No.	Name of Machine	No. Package	Net Weight Met, tons	Net Volume Mea. tons
5105	Drilling Machine	1	800	0.643
5106	"	1	300	0.856
5107	"	1	500	0.782
5108	"	1	500	0.883
5109	Lathe	1	1000	2.490
5110	"	1	800	2.490
5111	Drilling Machine	1	1000	1.455
5112	"	1	500	0.837
* 5113	"	1	400	0.600
5114	Lathe	1	200	1.080
5115	"	1	1000	2.785
5116	Shaper	1	5500	1.288
5117	Drilling Machine	1	"	0.845
5118	Shaper	1	1000	2.150
5119	Lathe	1	700	1.428
5120	Drilling Machine	1	300	0.748
5121	"	1	"	0.748

775013

775013

Chart of March

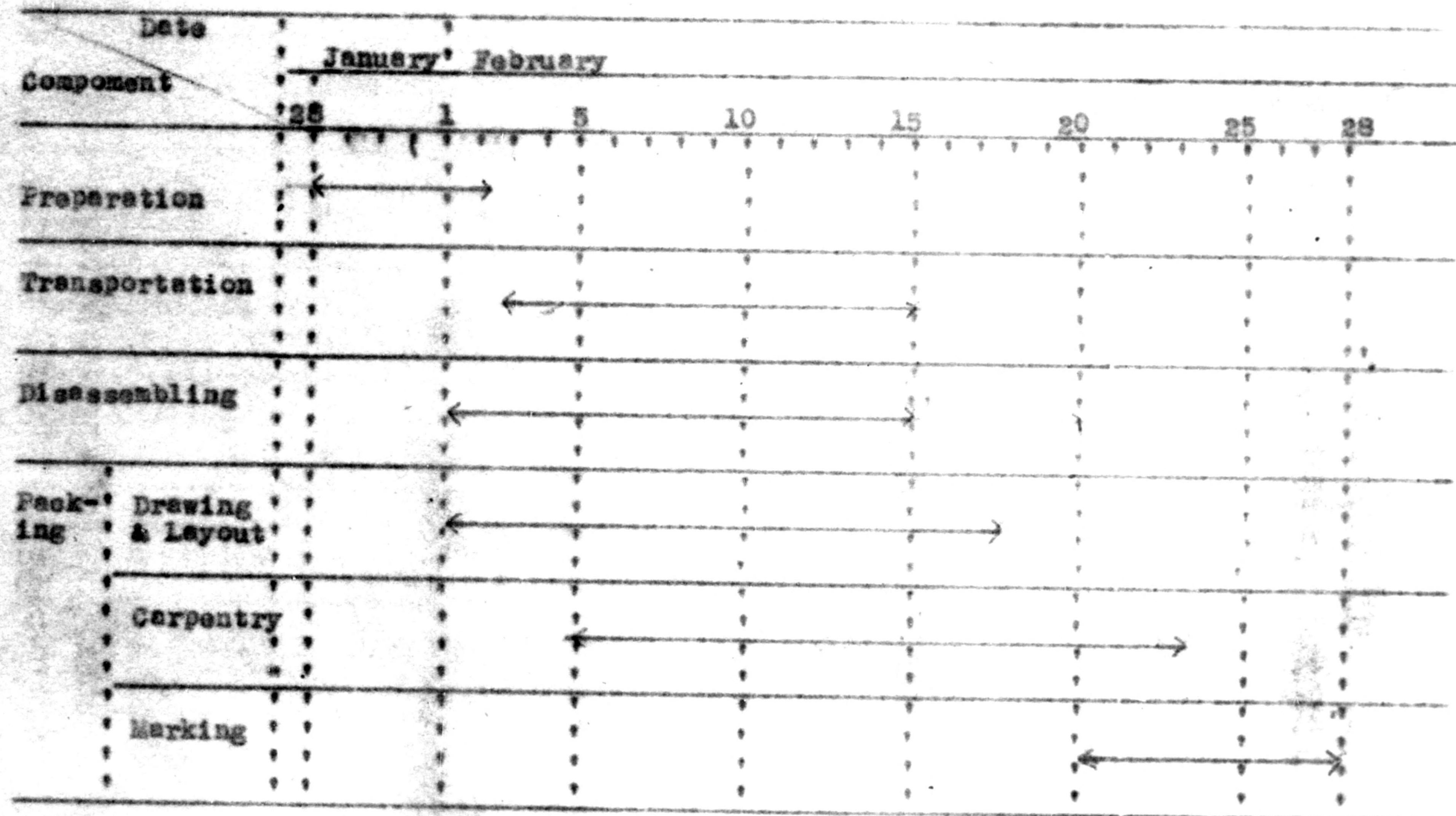

Plant Layout

Suzuka Naval Arsenal (23-10 A)

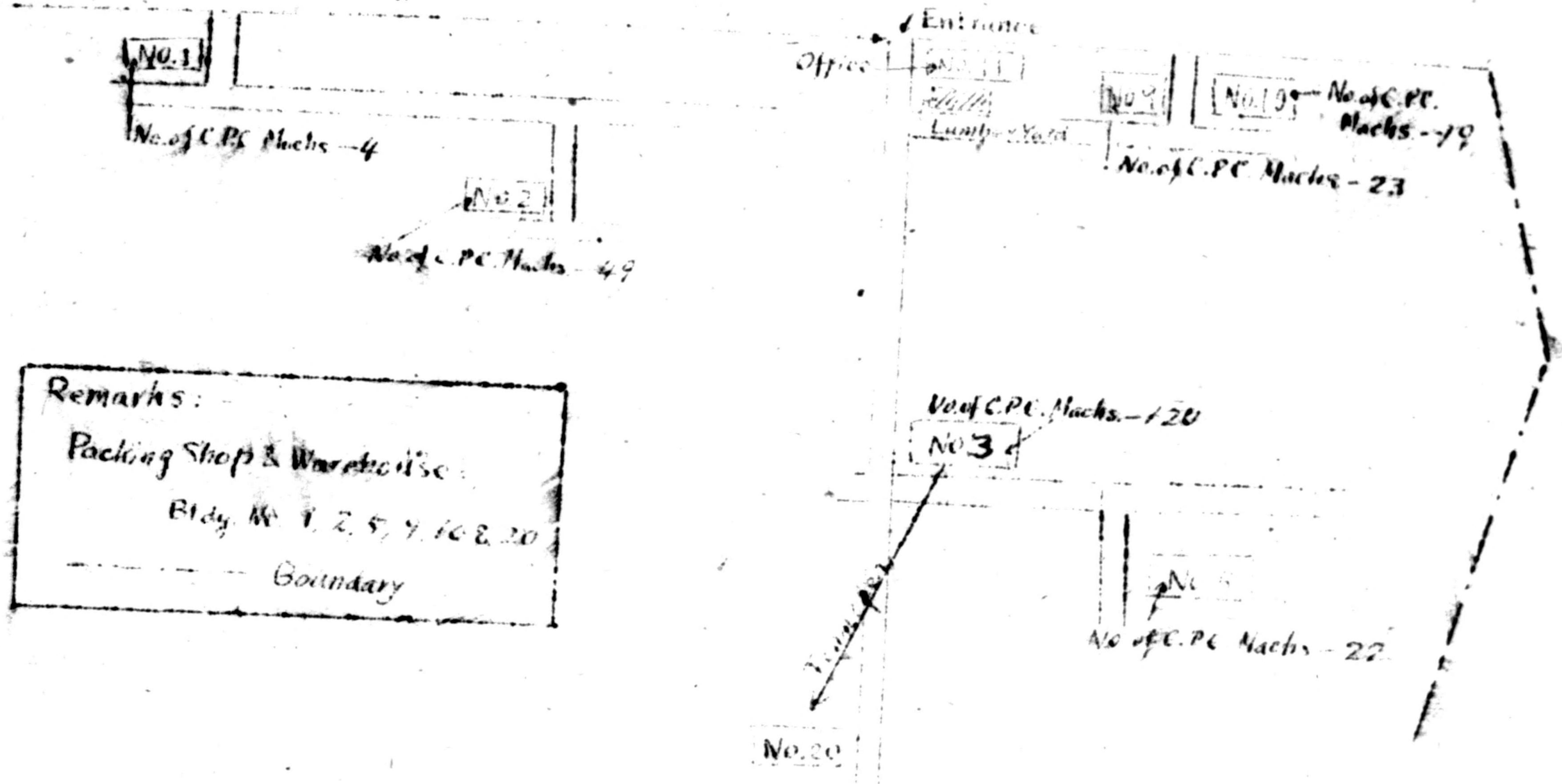

Remarks:
Packing Shop & Warehouse:
Bldg. No. 1, 2, 5, 7, 10 & 20

Boundary

775013

LIST OF C.P.C. MACHINES IN EACH REP. PLANT

<u>Building No. 1</u>	<u>Building No. 2</u>	<u>Building No. 3</u>
CPC-4885	CPC-4889	CPC-4917
CPC-4886	CPC-4890	CPC-4918
CPC-4887	CPC-4891	CPC-4919
CPC-4888	CPC-4892	CPC-4921
	CPC-4893	CPC-4922
	CPC-4894	CPC-4923
	CPC-4895	CPC-4924
	CPC-4896	CPC-4925
	CPC-4897	CPC-4926
	CPC-4898	CPC-4927
	CPC-4899	CPC-4928
	CPC-4900	CPC-4929
	CPC-4901	CPC-4930
	CPC-4902	CPC-4931
	CPC-4903	CPC-4932
	CPC-4904	CPC-4933
	CPC-4905	CPC-4934
	CPC-4906	CPC-4935
	CPC-4907	CPC-4936
	CPC-4908	CPC-4937
	CPC-4909	CPC-4938
	CPC-4910	
	CPC-4911	
	CPC-4912	
	CPC-4913	
	CPC-4914	
	CPC-4915	
	CPC-4916	
		CPC-4939
		CPC-4940
		CPC-4941
		CPC-4942
		CPC-4943
		CPC-4944
		CPC-4945
		CPC-4946
		CPC-4947
		CPC-4948
		CPC-4949
		CPC-4950
		CPC-4951
		CPC-4952
		CPC-4953
		CPC-4954
		CPC-4955
		CPC-4956
		CPC-4957
		CPC-4958
		CPC-4959
		CPC-4960
		CPC-4961
		CPC-4962
		CPC-4963
		CPC-4964
		CPC-4965
		CPC-4966
		CPC-4967
		CPC-4968
		CPC-4969
		CPC-4970
		CPC-4971
		CPC-4972
		CPC-4973
		CPC-4974
		CPC-4975
		CPC-4976
		CPC-4977
		CPC-4978
		CPC-4979
		CPC-4980
		CPC-4981
		CPC-4982
		CPC-4983
		CPC-4984
		CPC-4985
		CPC-4986
		CPC-4987
		CPC-4988
		CPC-4989
		CPC-4990
		CPC-4991
		CPC-4992
		CPC-4993
		CPC-4994
		CPC-4995
		CPC-4996
		CPC-4997
		CPC-4998
		CPC-4999
		CPC-5000
		CPC-5001
		CPC-5002
		CPC-5003
		CPC-5004
		CPC-5005
		CPC-5006
		CPC-5007
		CPC-5008
		CPC-5009
		CPC-5010
		CPC-5011
		CPC-5012
		CPC-5013
		CPC-5014
		CPC-5015
		CPC-5016
		CPC-5017
		CPC-5018
		CPC-5019
		CPC-5020
		CPC-5021
		CPC-5022
		CPC-5023
		CPC-5024
		CPC-5025
		CPC-5026
		CPC-5027
		CPC-5028
		CPC-5029
		CPC-5030
		CPC-5031
		CPC-5032
		CPC-5033
		CPC-5034
		CPC-5035
		CPC-5036
		CPC-5037
		CPC-5038
		CPC-5039
		CPC-5040
		CPC-5041
		CPC-5042
		CPC-5043
		CPC-5044
		CPC-5045
		CPC-5046
		CPC-5047
		CPC-5048
		CPC-5049
		CPC-5050
		CPC-5051
		CPC-5052
		CPC-5053
		CPC-5054
		CPC-5055
		CPC-5056
		CPC-5057
		CPC-5058
Total	4	49
		120

LIST OF C.P.C. MACHINES IN EACH REP. PLANT

Building No. 5

- CPC-5073
- CPC-5074
- CPC-5075
- CPC-5076
- CPC-5077
- CPC-5078
- CPC-5079
- CPC-5080
- CPC-5081
- CPC-5082
- CPC-5083
- CPC-5084
- CPC-5085
- CPC-5086
- CPC-5087
- CPC-5088
- CPC-5089
- CPC-5090
- CPC-5091
- CPC-5092
- CPC-5093
- CPC-5094

Total 22

Building No. 9

- CPC-5095
- CPC-5096
- CPC-5097
- CPC-5098
- CPC-5099
- CPC-5100
- CPC-5101
- CPC-5102
- CPC-5103
- CPC-5104
- CPC-5105
- CPC-5106
- CPC-5107
- CPC-5108
- CPC-5109
- CPC-5110
- CPC-5111
- CPC-5112
- CPC-5113
- CPC-5115
- CPC-5117
- CPC-5118
- CPC-5119

23

Building No. 10

- CPC-4920
- CPC-5114
- CPC-5116
- CPC-5120
- CPC-5121
- CPC-5059
- CPC-5060
- CPC-5061
- CPC-5062
- CPC-5063
- CPC-5064
- CPC-5065
- CPC-5066
- CPC-5067
- CPC-5068
- CPC-5069
- CPC-5070
- CPC-5071
- CPC-5072

19

TSU LOCAL DIVISION, NAGOYA FINANCE BUREAU.

25 April 1949

SUBJECT : Report for Supplementary evaluation of reparations
machine (23-9)

TO : Mie Military Government Team.

The listed machine in the attached sheet has been made supplementary evaluations as reparation machine, in accordance with instruction of General Headquarters, Supreme Commander Allied Powers.

These machine are now being used by Kusu Factory, Toa Spinning & Weaving Co.

KAZUYUKI KUBO
Plant Master, Kusu Factory,
Nagoya Army Arsenal.

The Attached List.

Supplementary Evaluation of reparations machine (23-9)

<u>Item No.</u>	<u>Bldg. No.</u>	<u>Inventory No.</u>	<u>Name-Type-Specifications Accessories & Spare parts</u>
16	15	1250-U	Pump-Centrifugal-Motor Driven.
17	15	1251-U	Pump-Centrifugal-Motor Driven.
18	15	1252-U	Pump-Turbin-Motor Driven.
19	15	1253-U	Pump-Rotary-Motor Driven.
20	15	1254-U	Pump-Vertical-Steam Driven.
	<u>Total</u>	5	

