

STORE ROOM

STORE ROOM

STORE ROOM

STORE ROOM

775013

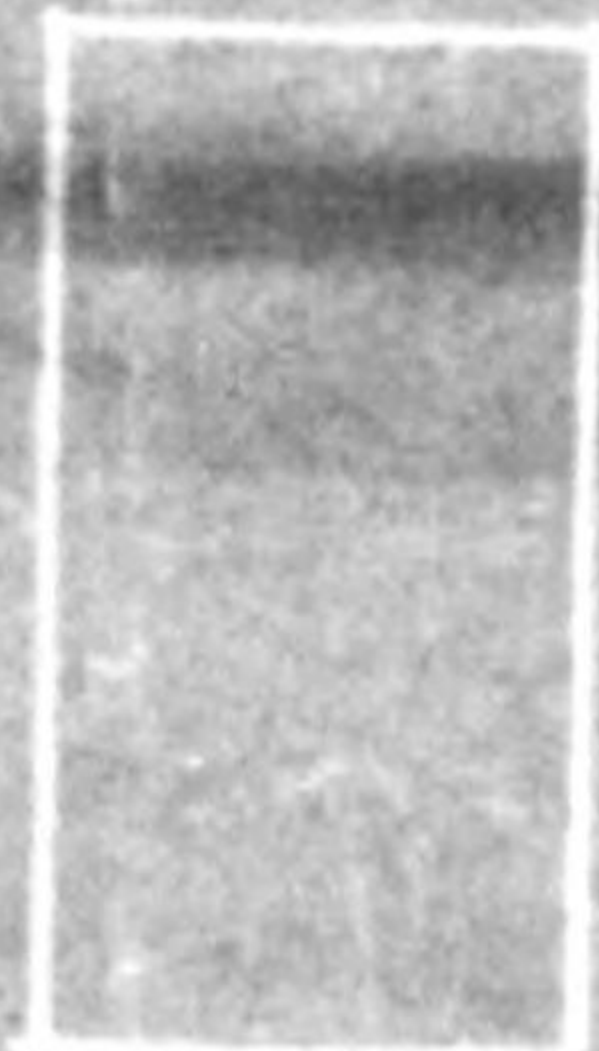
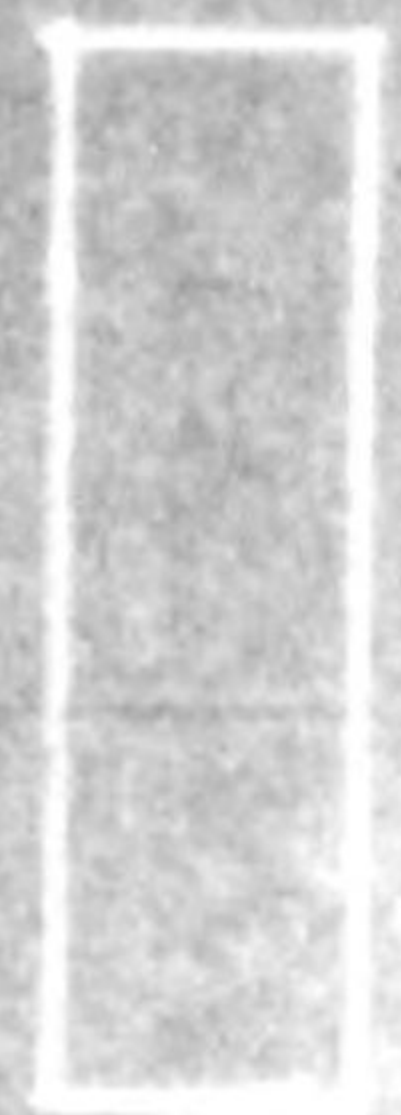

225



1

1

775013

STORE ROOM

NO. 7 MACH. SHOP

NO. 6 MACH. SHOP

NO. 5 MACH. SHOP

NO. 4 MACHINE SHOP

NO. 10 SHOP
HEAT TREATMENT SHOP

NO. 9 SHOP
FINISHING, INSPECTION, & DELIVERY SHOP

NO. 8 SHOP
FINISHING, INSPECTION, & DELIVERY SHOP

ELECT TRANSFORMER HOUSE

SCRAP STORE

STORE ROOM

STORE ROOM

STORE ROOM

STORE ROOM

775013

NO. 4
MACHINE
SHOP

NO. 3
MACHINE
SHOP
(ORDNANCE
MF78
SHOP)

ASSEMBLING
HALL

MAIN OFFICE

FUEL
STORE
ROOM

GARAGE

MAP OF
[Diagrammatic symbols]



STORE ROOM

STORE ROOM



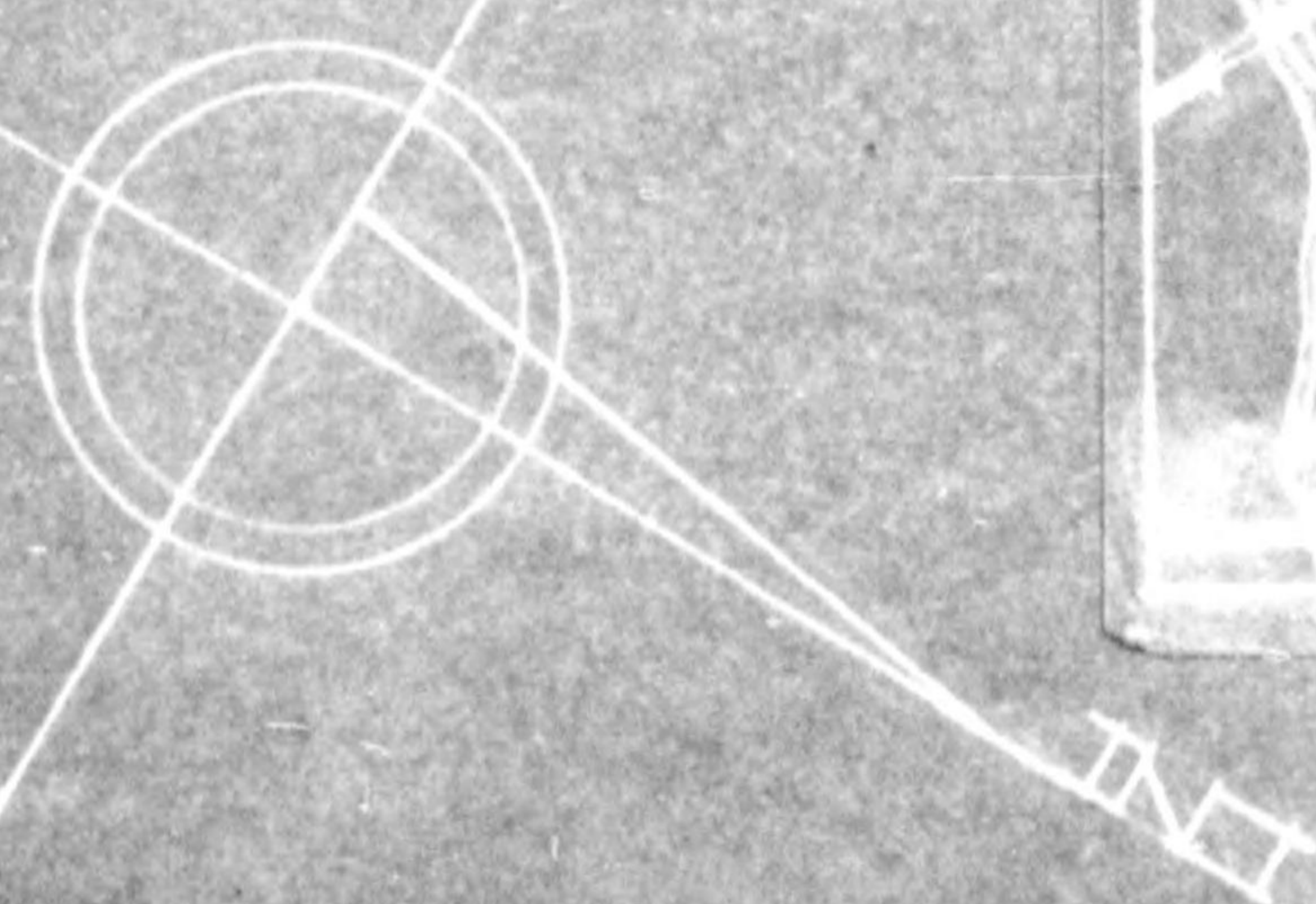

775013



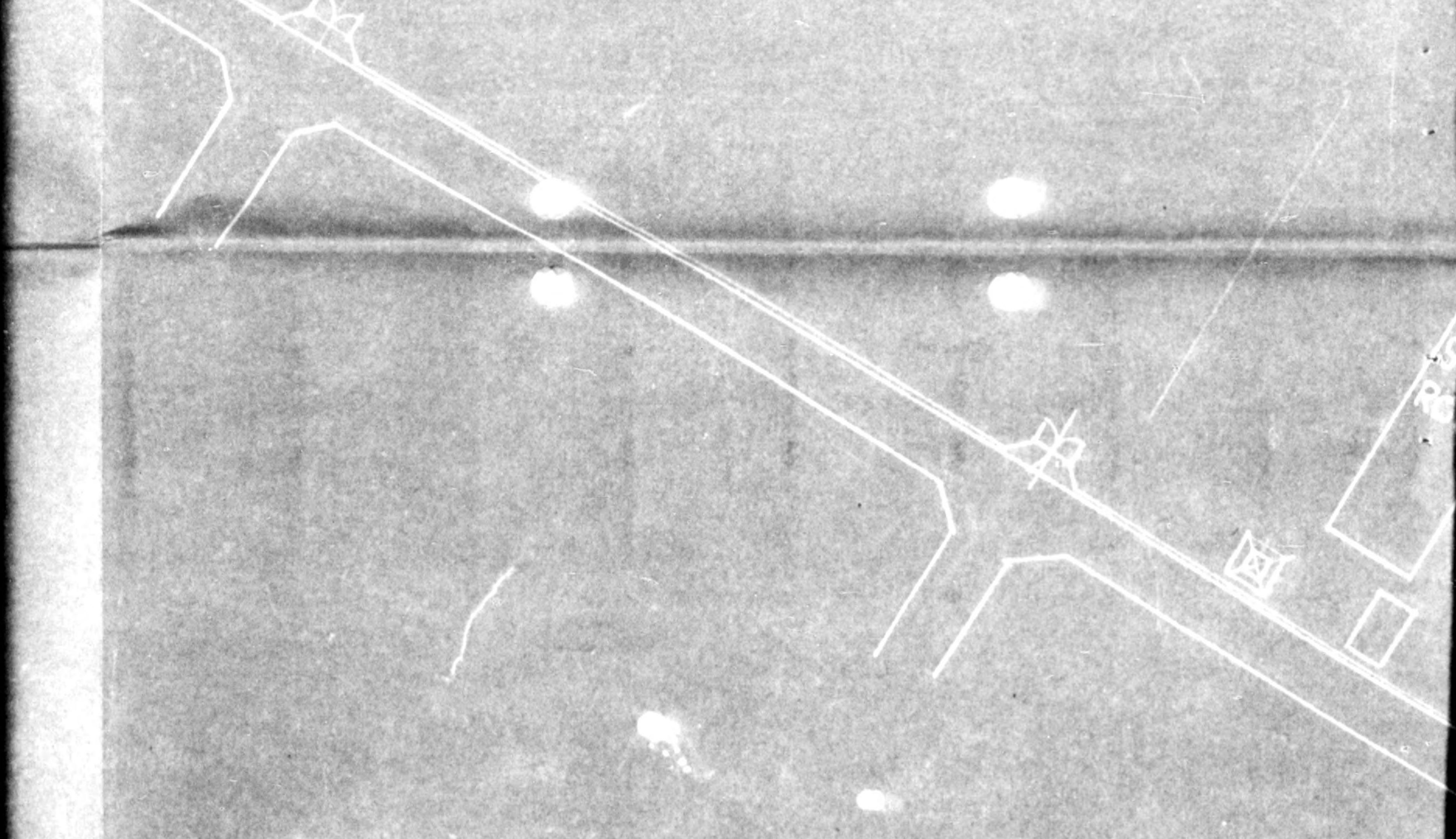
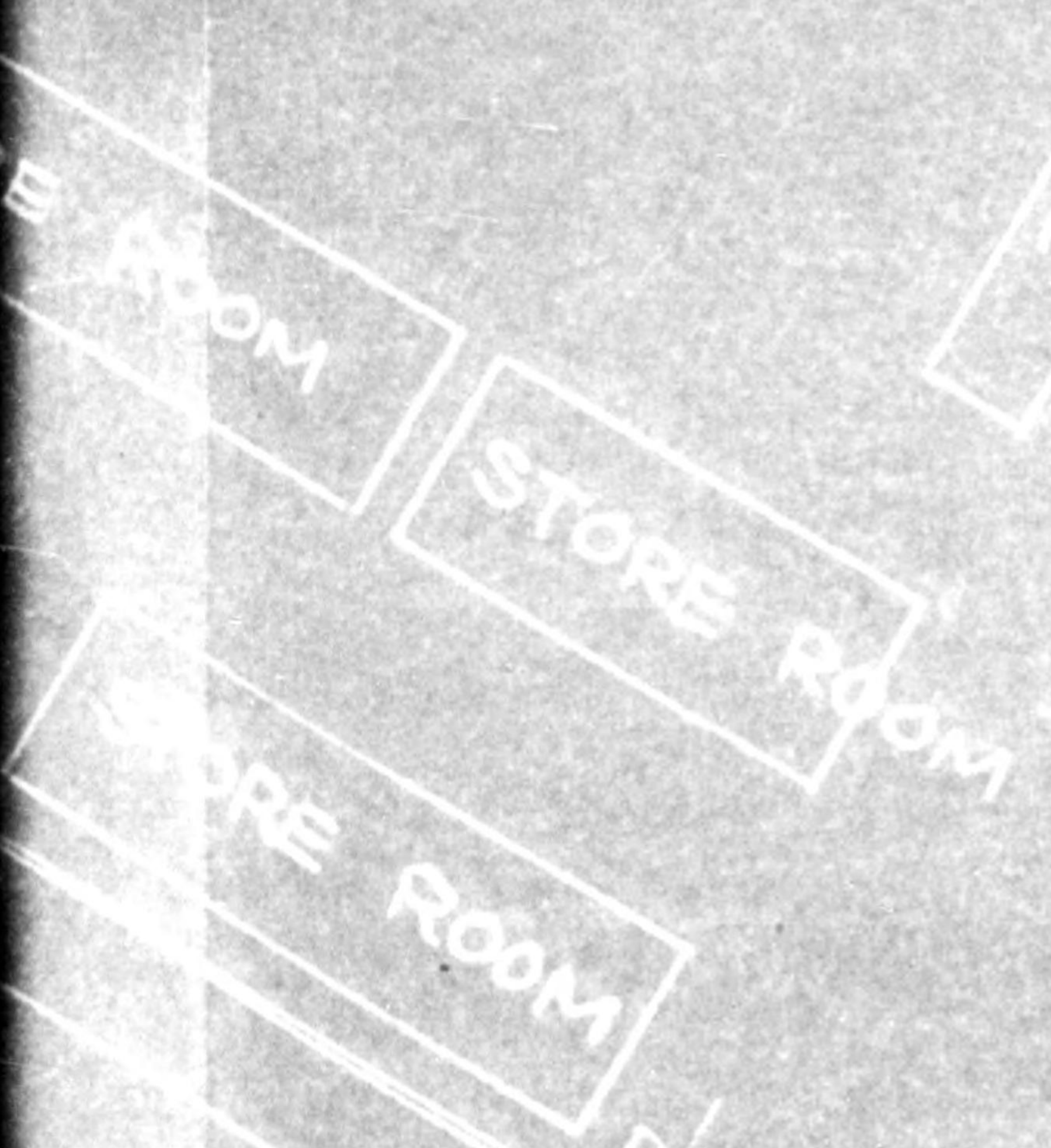

R.S.

775013



KYOTO
(KYOTO)

775013

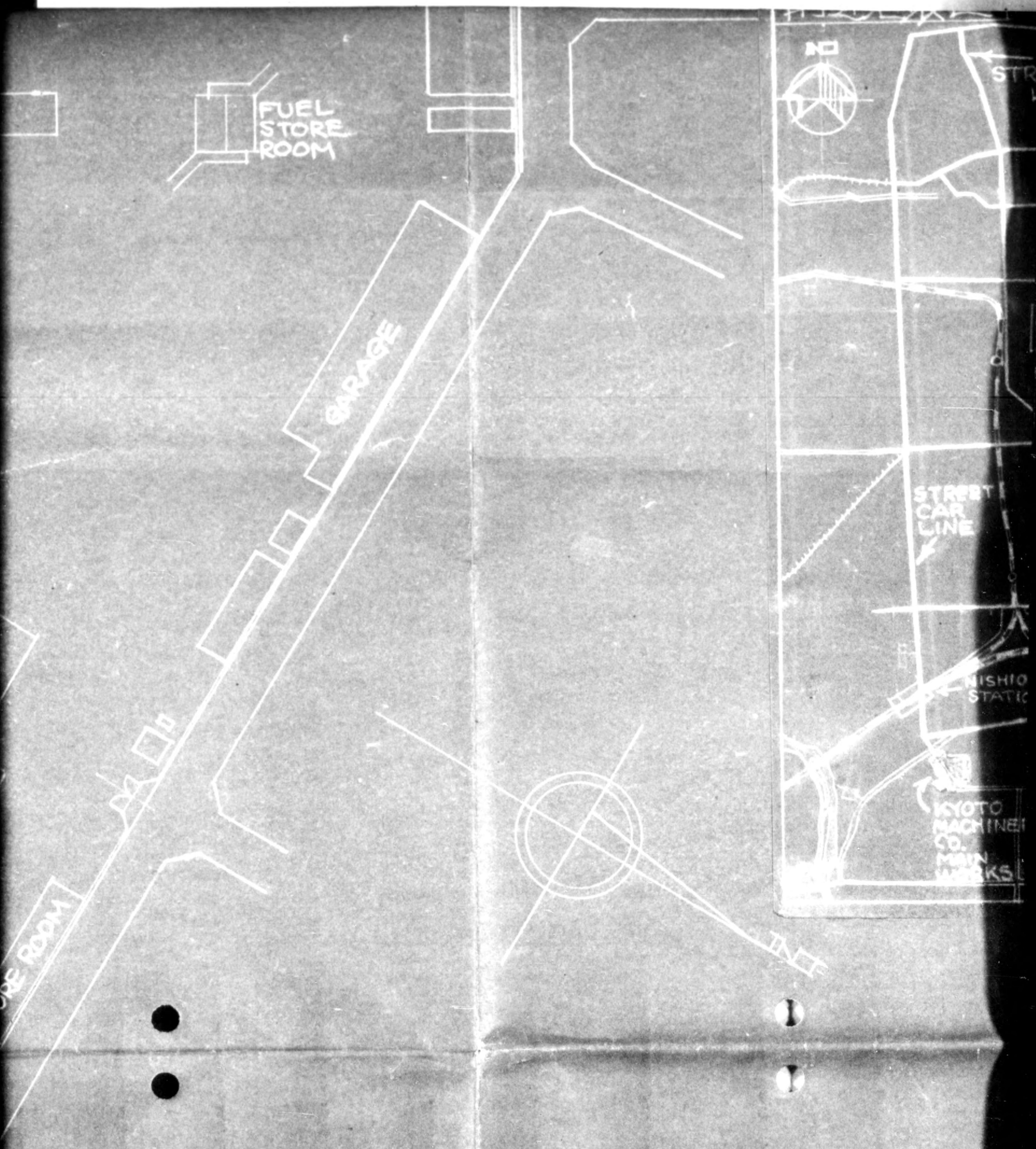

KYOTO KIKAI K. K.
(KYOTO MACHINERY CO., LTD),
KYOTO.

京都	務
名敷	北
種別	才
縮尺	
製圖	昭

775013

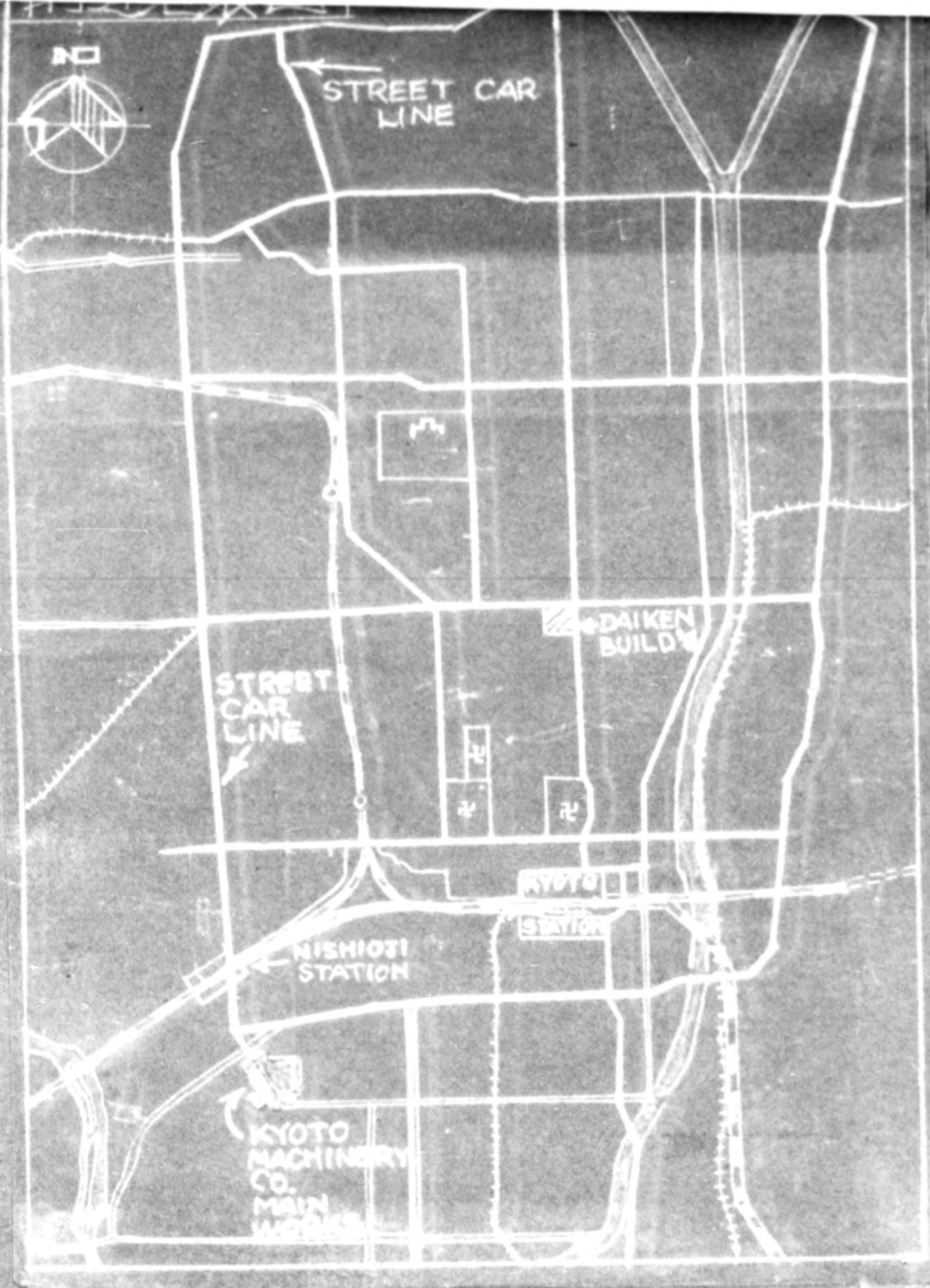

THE

KAI K. K.
MACHINERY CO., LTD),
KYOTO.

京都機械株式會社建設部			
名稱	敷地建物配置圖		單位
種別	本社		標
縮尺	1/600	單位	製圖
製圖	昭和21年9月3日第1	單位	寫

HEADQUARTERS COMPANY I CORPS
APO 301

17 August, 1946

SUBJECT: Confirmation of Procurement Demands

TO : CG I Corps APO 301
ATTN: Procurement, Military Government Section

1. Reference is made to attached procurement demands concerning the procurement of Real Estate and Equipment from Kyoto Kikai Co., which is necessary to conduct classes in welding and machine shop, Kyoto Central School.

2. The above mentioned property has been used by Kyoto Central School since 1 April 46. At that time the Kyoto Kikai Co. did not wish to lease or sell this property as they were in need of it at various times. Recently, they agreed to the contracts.

3. Request approval to procure any materials from the Kyoto Kikai Co., retroactive 1 April 46, necessary for proper maintenance and administration of classes in welding and machine shop.

DONALD G. MOORE
1st Lt.
Supply Officer

BASIC: Ltr, Hq Co I Corps, subj: "Confirmation of Procurement Demands"
dtd 17 August 46.

AG 601 - BA

1st Ind

EG/ta

Hq I Corps, APO 301, 30 Aug 1946

TO: Commanding General, Eighth Army, APO 343

1. Former request for same services was returned by Procurement Division Eighth Army Military Government Section in June 1946, for correction of forms and resubmission.
2. Recommend approval of request.

FOR THE COMMANDING GENERAL:

KARL W. MARKS
Lt Col, AGD
Asst Adj Gen

3 Incls:

- 1 - Procurement Demand
#KYTE-791
- 2 - Procurement Demand
#KYTE-634-A
- 3 - Inventory of Machinery.

BASIC: Ltr, Hq Co I Corps, Subj: Confirmation of Procurement Demands,
dtd 17 August 46.

AG 400.312 (MG)

2nd Ind

13 SEP 1946

Headquarters Eighth Army, APO 343

TO: Commanding General, I Corps, APO 301.

- Capt Commons
this par. is
for your
information
Kissan*
1. Procurement demands KYTE 791 and KYTE 634-A are approved.
 2. However, since the Kyoto Kikai Company is under custody and control for reparations, the equipment must be inventoried in accordance with instructions contained in Operational Directive 5/3, this headquarters, dated 24 June 1946. Appropriate notation must be made on the inventory sheets citing this indorsement as authority for use under custody and control.
 3. This indorsement will also be cited as authority for the confirming demand.

BY COMMAND OF LIEUTENANT GENERAL EICHELBERGER:

3 Incls:
n/cR SCHAFER
Lt. Col., AGD
Asst. Adj Gen

AG 600.1 - BA

3rd Ind

EQ/yt

Hq I Corps, APO 301, 18 SEP 1946

TO: CO, Kyoto Military Government Team, APO 713

K. W. M.

3 Incls:
n/c

38

BASIC: Application by Kyoto Kikai Kabushiki Kaisha, Katsuragawa, Hichijo, & Hanazono Factory. 50 Funadocho, Kisshoin, Shimogyoku, Kyoto, to produce new items.

1st Ind.

103rd Mil Govt Co., APO 713 (Kyoto, Honshu) 7 June 46

TO: Hq. I Corps, APO 301 (Kyoto, Honshu)
Attn: Mil Govt Section, Res. & Ind. Officer

1. Inspection and survey was made of the subject plant by a representative of this Hq. All information, found in the attached application for permission to produce new items, was found true to the best of this Hq. representatives knowledge.

2. The basic firm does not have any Government machinery. All machinery in the basic factory is owned by subject firm. Results of the inspection found the machinery in good condition.

3. This factory does not appear on either Operational Directive No. 5 or Operational Instruction No. 1. This factory was issued a permit by Sixth Army, 23 Nov. 45, MG 51, subject: Permit for Reconversion from War Production and for Resumption of Production of Essential Civilian Commodities. This permit listed the items that were authorized for production. This permit was canceled, by this Hq, and new one issued, 6 June 46, making an addition of gas generator units to the already authorized items.

4. The Liaison Office says that gas generator units finish over 96% of the transportation in Japan. They also state that, trucks that are vitally needed are lying idle because of lack of the requested item.

5. Compiling all information that this Hq. has, a permit was issued today, 6 June 46.

HAROLD C. SHEFFIELD
Major, QMC
SMGO

103RD MILITARY GOVERNMENT CO.
KYOTO OFFICE
APO 713 (Kyoto, Honshu)

File: MG 101

6 June 1946

SUBJECT: Application for Operation

TO : Kyoto Kikai Kabushiki Kaisha, Katsuragawa, Hichijo, & Hana-
(Name and Address of Firm)
zono Factory
50 Funadocho, Kisshoin, Shimogyoku, Kyoto.

1. a. In accord with paragraph 3, b, Directive Number Three (3) from the Supreme Commander to the Imperial Japanese Government, dated 23 Sep 45, the Kyoto Machinery Company, Ltd.
(Name of Firm)

(Kyoto Kikai Kabushiki Kaisha, Kyoto.)

is permitted to immediately start production of Automobile parts,
Repair of autos, Wood-working machine, Centri- (Name of Items)
fugal separators, Dyeing and finishing machines, Hand tools,
Prefabricated houses, Doors and Gas generator units.

b. Maximum production currently authorized is Auto parts
(18,000 pcs.) Repair of autos (30 cases) Wood-working machine (2.92 mach.) Centri-
fugal separators (10.83 mach.) Dyeing and finishing machines (12.50 mach.) Hand
tools (1,775 sets) Prefabricated houses (& doors) (11.3 houses) Gas Gen. Unit (120 u.)

2. The acquisition of material, parts and sub-assemblies as well as the disposition of finished products, and the establishment of sales prices will be in accord with the regulations of the Imperial Japanese Government.

3. Until otherwise directed by this headquarters, a monthly report in English of each item, by name, type and quantity produced by each factory, sub-contractor subsidiary within this factory's control will be delivered to the 103rd Mil Govt Office by the fifteenth (15) day of the following month.

4. It is understood that this permit for reconversion is issued subject to any and all directives affecting reconversion, ultimate disposition or otherwise, which have been issued or may hereafter be issued by the Supreme Commander for the Allied Powers or by this headquarters.

By order of Lieutenant Colonel HYLAND:

Harold C. Sheffield
HAROLD C. SHEFFIELD
Major, QMC
Res & Ind O

Info Copy to:

SCAP (Attn: E55) (1)
SCAP (Attn: G-2) (1)
CG Eighth Army (Attn: Mil Govt) (1)
CG I Corps (Attn: Mil Govt) (1)
Kyoto Liaison Office (1)
Governor of Kyoto Prefecture (1)
103rd Mil Govt Co. (2)

HEADQUARTERS SIXTH ARMY
 Military Government Section
 APO 442 (Kyoto, Honshu)

File: MG 51Date: 23 November 1945

SUBJECT: Permit for Reconversion from War Production and for Resumption
 of Production of Essential Civilian Commodities.

TO: : Kyoto Kikai Kabushiki Kaisha, Katsuragawa, Hichijo, & Hanazono Factory
 (Name & Address of Firm)

50 Funadocho, Kisshoin, Shimogyoku, Kyoto.

1. In accordance with the provisions of paragraphs 3 a and 3 b of Directive No. 3 from the Supreme Commander for the Allied Powers, dated 22 September 1945; Memorandum for the Imperial Japanese Government, Subject: Reconversion of War Production Plants to Peacetime Production, dated 28 October 1945; and under authority granted this Headquarters by CINCAFPAC radio ZAX 6197 dated 3 October 1945, you are authorized to commence operation of your plant, and to manufacture the essential civilian commodities listed in Annex No. 1 to this permit.

2. This permit grants authority only to operate. The acquisition of materials, parts, and sub-assemblies, as well as the disposition of finished products and establishment of sales prices, will be in accord with the regulations of the Imperial Japanese Government.

3. At the end of the first month of operation, and at the end of each three month period thereafter, until notified to the contrary by this Headquarters a report will be made to the Commanding General I Corps, Headquarters Osaka, Attention: Military Government Section. This report will be written in English and will list each item, by name, type, and quantity produced by each factory, subsidiary, or sub-contractor operating under the provisions of this permit. This report will be delivered to Corps Headquarters not later than fifteen (15) days after the conclusion of the period to which the report pertains.

1 Incl: Annex No. 1
 23 Nov 45

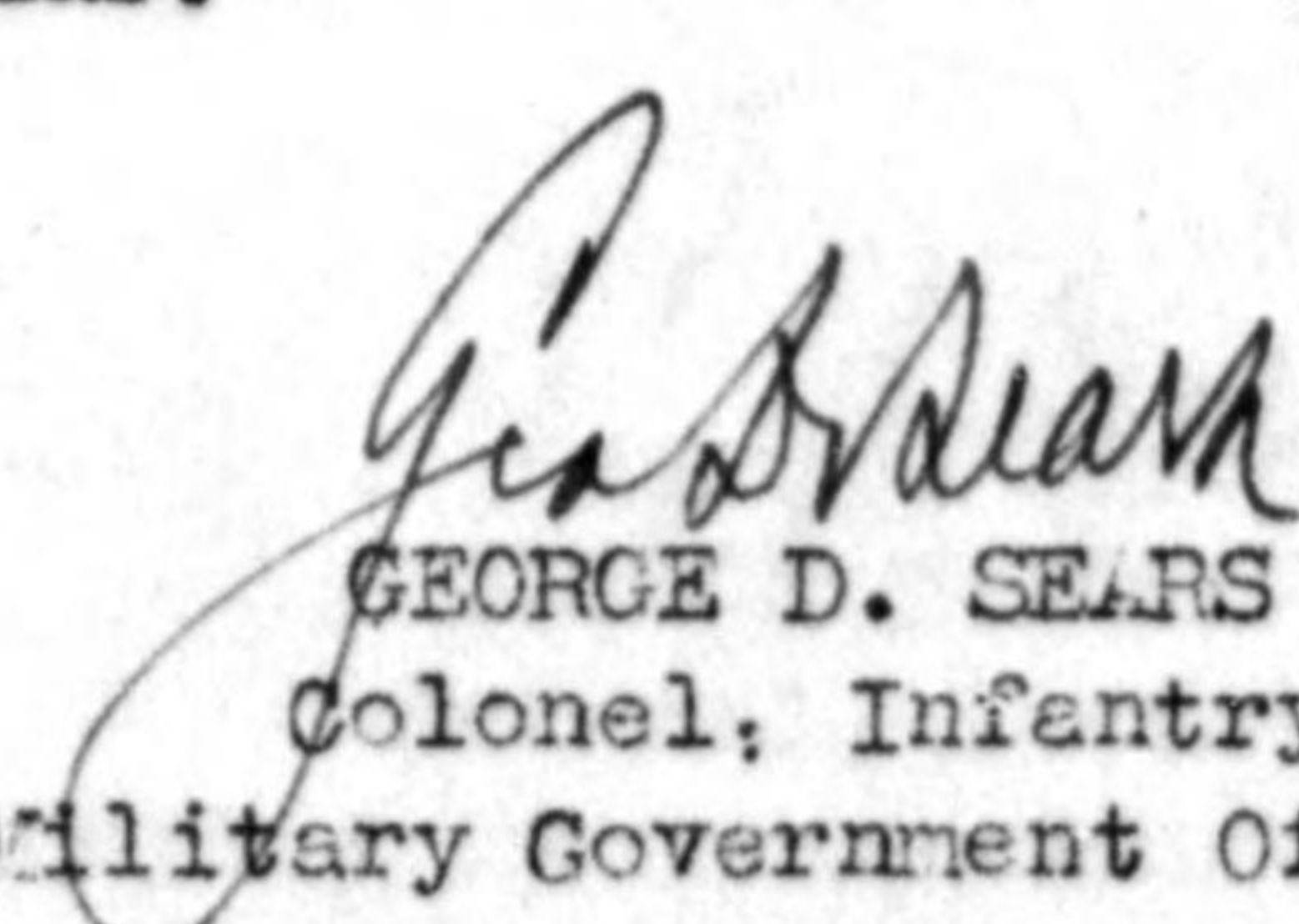
 GEORGE D. SEARS
 Colonel, Infantry
 Military Government Officer

Info Copies To:

GHQ, SCAP (Atten E. & S. Sec)
 CG I Corps, (Attn) MG Sec.
 Imperial Japanese Gov't
 (6th Army Jap. Liaison Office, Kyoto)

HEADQUARTERS SIXTH ARMY
Military Government Section
APO 442

23 November 1945

ANNEX NO. 1.

Permission is granted to Kyoto Kikai Kabushiki Kaisha, Katsuragawa, Hichijo, & Hanazono Factory 50 Funadocho, Kisshoin, Shimogyoku, Kyoto to produce the following items listed below:

- a. Automobile parts.
- b. Repair of automobiles.
- c. Wood-working machine.
- d. Centrifugal separators.
- e. Dyeing and finishing machines.
- f. Hand tools.
- g. Prefabricated houses.
- h. Doors.

- - - - -
(Nothing follows: - - - - -)

David S. Lockie
DAVID S. LOCKIE
1st Lt. F. D.

KYOTO KIKAI CO., LTD

50 Funado-cho, Kisshoin,
Shimogyo-ku, Kyoto.

38

Kyoto, April 23rd, 1946.

The Headquarters,
I Corps,
Kyoto.

Sir:-

In connection with our Application for Permission to manufacture Gas-Generator Units to produce Gas as Fuel for Engines, we beg to enclose herewith as follows:-

- 1) Application for Permission to Manufacture Gas-Generator Units.
- 2) Explanations for Wood-Gas Generator (Producer) Unit, for Engines of Automobiles, etc.
- 3) Drawing for Wood-Gas Generator Unit.
- 4) Production Output Schedule for 1946-1947.
- 5) Copy of your Permission, File No. 51, dated Nov. 23, 1945.
- 6) Copy of our Application for the Permission to the Essential Consumers' Commodities, dated Oct. 20, 1945.

Yours faithfully,

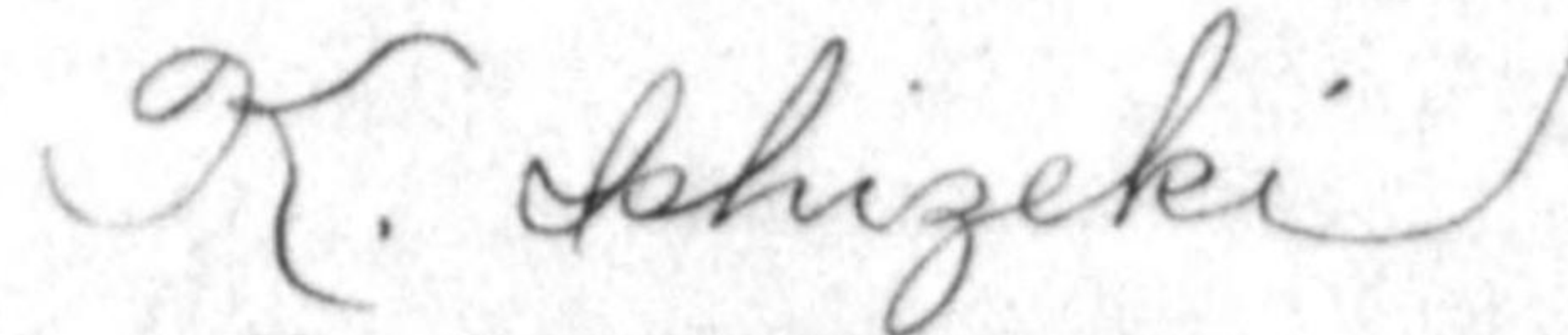
Kyoto Kikai Kabushiki Kaisha
Kyoto Machinery Co., Ltd.K. ISHIZEKI
Managing Director.

APPLICATION FOR PERMISSION
TO MANUFACTURE GAS-GENERATOR UNITS
TO PRODUCE GAS AS FUEL (MOTIVE POWER)
FOR ENGINES.

To: Headquarters, I Corps.

Thru: The Kyoto Prefectural Office.

From: Kyoto Kikai Kabushiki Kaisha

Kyoto Machinery Company, Limited

Address:

50 Funado-cho, Kisshoin,
Shimogyo-ku, Kyoto.

April 23 , 1946.

1. NAME OF FACILITY:

Kyoto Kikai Kabushiki Kaisha.

Kyoto Machinery Company, Limited.

2. LOCATION:

50 Funado-cho, Kissho-in, Shimogy-ku, Kyoto.

3. NAME OF OFFICERS:

President Tokutaro Nagase
Chief Managing Director Ko-ichi Nakaguchi
Managing Director Kensuke Ishizeki
Manager of The General Affairs
Department
Managing Director Kyo-oichi Anahara
Manager of The First Factory
Department
Managing Director Zennosuke Harada
Manager of The Second Factory
Department
Director Sho-ozo Nagase

4. CAPITAL:

5,000,000 Yen (Five-million Yen), fully paid in.

5. PERMIT FOR RECONVERSION FROM WAR PRODUCTION AND FOR
RESUMPTION OF PRODUCTION OF ESSENTIAL CIVILIAN COMMODITIES:

File: M C 51,

Date: 23 November, 1945.

Permission was granted to produce the following items:

- a) Automobile parts.
- b) Repair of Automobiles.
- c) Wood-working Machines.
- d) Centrifugal Separators.
- e) Dyeing and Finishing Machines.
- f) Hand Tools.
- g) Prefabricated Houses.
- h) Doors.

6. DESCRIPTION OF PRODUCTS INTENDED TO MANUFACTURE:

Gas Generator Units,

To produce Gas,
 From Wood, Charcoal, Coal and Coalite (semi-roasted coal),
 The Gas is for fuel, as motive power, for Automobile
 Engines, Small Gas Engines, Kerosine Engines and
 Gasoline Engines, for H. P. from about 5 to 100.

In order to give brief outline of Gas-
 Generator Unit, we enclosed herewith a statement,
 "Wood-Gas Generator (Productor) Unit", ^{and} a drawing
 for a Unit.

The constructions of Coal-, Coalite-,
 and Charcoal-Gas Generators are similar to that of
 Wood-Gas Generator Unit, except Generator Chamber.
 The Generator Chamber of Wood-Gas Unit, is more
 complicated than other type units,

7. NUMBER OF EMPLOYEES:

	<u>Aug. 15,</u> <u>1945.</u>	<u>Dec. 31,</u> <u>1945.</u>	<u>Mar. 15,</u> <u>1946.</u>
Total	2,333 : : : : : : : : :	962 : : : : : : : : :	1,039 : : : : : : : : :
Clrks	475	227	240
Labora	1,858 <u>2,333</u> : : : : : : : : :	735 <u>962</u> : : : : : : : : :	799 <u>1,039</u> : : : : : : : : :
Male	1,709	840	913
Female	624 <u>2,333</u> : : : : : : : : :	122 <u>962</u> : : : : : : : : :	126 <u>1,039</u> : : : : : : : : :
Clerks			
Male	277	168	176
Female	198	59	64
Labora			
Male	1,432	672	737
Female	426 <u>2,333</u> : : : : : : : : :	63 <u>962</u> : : : : : : : : :	62 <u>1,039</u> : : : : : : : : :
	Two- shifts a day.	One shift a day.	One shift a day.

Maximum Capacity: 1,250 persons in all.

8. STOCKS OF RAW MATERIALS:

	<u>Aug. 15, 1945.</u> in Metric Tons	<u>At present.</u> in Metric Tons
Ordinary Steel	645.	516.
Special Steel	1,192.	1,034.
Pig Iron	45.	120.
Copper & its Alloys	22.	39.
Aluminium & its Alloys	33.	35.

9. RAW MATERIALS NEEDED (MONTHLY):

	<u>Average</u> <u>Per Unit</u>	<u>120 Units</u> <u>Per Month</u>
Ordinary Steel		
Sheet	160 kilos.	19.20 Tons of 1000 kg.
Rod	6 "	0.72 "
Tube	145 "	17.40 "
Angle	12 "	1.44 "
Total	<u>323 kilos.</u>	<u>39.76 Tons of 1000 kg.</u>
	::::::::::	::::::::::
Cast Iron	110 kilos.	13.20 Tons of 1000 kg.
	::::::::::	::::::::::

10. QUANTITY BLANNED TO MANUFACTURE (MONTHLY):

Wood-Gas Generator Unit	50 units.
Charcoal-Gas Generator Unit	30 units.
Coalite-Gas Generator Unit	20 units.
Coal-Gas Generator Unit	20 units.
Total	<u>120 units.</u>
	::::::::::

For starting, we intend to make about 30 units per month, but to gradually increase the output to 120 units a month within four or five months' time.

11. PRICES:

Yen 4,500 to 5,500 per complete unit (for 20 H.P. Engine); price varies according to Type of Generator, to Type and Condition of Engine and Car, etc.

Yen 1,000 Charge for installation to Car, etc. Charge varies according to Type and Condition of Engine and Car, etc.

Yen 6,000 Average Price per Complete Generator Unit including installation charge.

The total monthly output is approximately:-

120 Units @ Yen 6,000 ----- Yen 720,000.00

12. P. S.GENERATORS:

The Gas Generators, as mentioned above, are one of most essential and important item for transportation, etc., under the present state in Japan, as we have already so many important enquiries from various sources.

OUR PRODUCTIONS:

We have been doing our best for producing eight items which you kindly permitted us. Our productions are increasing month after month, for instance:-

	<u>DAILY PRODUCTIONS</u> <u>Basing Yen Amount</u>	<u>MONTHLY PRODUCTIONS</u> <u>Basing Yen Amount</u>
Dec.	100 %	100 %
Jan.	108 %	88 %
Feb.	110 %	115 %
Mar.	172 %	165 %

OUR FACTORY:

Your Kyoto Central School is using part of our factory as Machine Shop and Welding Shop. Lt. Zasa, the Instructor of the School, will be able to give you necessary informations regarding to our factory if necessary.

13. CERTIFICATION BY APPLICANT:

I certify that the information contained herein is true to the best of my knowledge and belief.

Signed

K. Ishizeki

K. Ishizeki

Title

Managing Director
Kyoto Kikai Kabushiki Kaisha
(Kyoto Machinery Co., Ltd.)

Kyoto Kikai Kabushiki Kaisha, Kyoto.
Kyoto Machinery Company, Limited.

WOOD-GAS GENERATOR (PRODUCER) UNIT,
For Engines of Automobiles. Etc.

1. USES:

The Wood-Gas Generators are widely used in Japan as a part of attachments of Automobiles, supplying its Wood-Gas to the Engine as fuel.

The Wood-Gas Generator Units are also used as fuel supplier for Gas, Kerosine or Gasoline Engines (about 5 H. P. to 100 H. P.) of general industrial uses, building and construction works, agricultural uses, saw mills, gasoline cars on rail, etc. in districts where wood is easily obtainable, or where charcoal, coal or coalite (semi-roasted coal) is not easily obtainable.

2. FUEL:

Any dry wood which contains less tar or resin can be used as a gas source. Most suitable wood is of well dried, hard, heavy quality from flat-leaved trees. As the wood of needle-leaved trees generally contains fairly large amount of resin, it cannot be used for this type Wood-Gas Generator.

To feed the dried wood into Gas Generator Chamber, the wood is cut into small pieces having diameter 1 inch to 2 inches, and length 2 inches to 4 inches. In case the diameter of wood is larger than 2 inches, it is cut into halves or one-third. The reasons to cut the wood into small pieces are:-

- A) To enable to carburize all the wood pieces evenly and perfectly well.
- B) To enable to charge, in one shift, as much quantity of wood pieces as possible, with sufficient spaces between wood pieces so to let the gas pass through.
- C) To enable to fall all the carburized wood pieces gradually to the bottom of Generator Chamber (this is why the long wood cannot be charged into Generator Chamber).

3. CAPACITY:

It is very difficult to mention here exact capacity of this Generator Unit owing to a many factors existing, such as: quality of dried wood; type and conditions of Engine; weight of car; weight of load; plain or mountain road; seasons of the Year, etc.

We mention capacity here basing our experience: to make a round trip with our Truck (4 tons truck with 4 tons of goods fully loaded) to Osaka from Kyoto, there is about 60 miles in milage (round trip).

In case of Gasoline, it requires about 7 gallons. With Wood-Gas Generator Unit, about 375 lbs. of dried wood is required.

The first charge of dried wood to the Generator Chamber, for starting, is about 125 lbs.; then about five smaller charges are made on the way while the engine is running (but the running of car has to be stopped for charging the wood), before the truck returns to our factory in Kyoto.

Capacity according to our actual experience as mentioned above, is as follows:-

1 Gallon Gasoline, corresponds to about 54 lbs. dried wood.

1 mile required about 6.3 lbs. dried wood (in plain road).

4. BRIEF EXPLANATION OF OUR WOOD-GAS GENERATOR UNIT:

For starting, put a little amount of wood shavings into the bottom of Generator Chamber, then fill the Chamber with wood pieces. Do not put the top-cover on the Chamber yet. Light the bottom of Chamber with matches. After the shavings caught fire well, start the Fan to blow the air into the Chamber; smoke will rise from the top of Generator Chamber.

After a little while, no smoke will be seen rising from the top of Generator; then put the top-cover on the Chamber; take off the cap of air-inlet and start the Engine, at the sametime stop the Air Fan.

To blow the gas out from the Generator Chamber, no Gas or Air Blower or Compressor is required, as the suction by Engine sucks the necessary Gas from the Generator Chamber.

The wood at the bottom of Generator Chamber is roasted and produce Carbon-oxide Gas which will pass through the layer of red-heated wood-charcoal, and, with moisture in it, the gas will change to Carbon-monoxide which contains moisture, hydrogen, methane, etc.

Greater part of tar and water will run away through Tar Receiver which is attached about the middle of Generator Chamber.

The Gas from Gas-Generator Chamber will pass through - Dust Collector, First Purifier, Second Purifier, Gas Cooler (temperature of Gas when leaving the Generator Chamber is about 200 to 300° C., but by this Cooler, the temperature of Gas is lowered to about 50 to 100° C.), Third Purifier, then to the Engine.

5. FEATURES AND DEFECTS:

Comparing the Wood-Gas Car with Charcoal-Gas Car and Coal- or Coalite-Gas Car:-

- A) Wood-Gas Car requires no steam supply into Gas Generator Chamber and is simplest. All other type cars require steam supply into Generator.
- B) Wood-Gas Car can charge the dried wood into Generator Chamber without stopping the Engine, while other type cars have to stop their Engines for charging fuel.
- C) Due to the Wood-Gas containing no sulphur and coarse ashes, the life of Wood-Gas Engine will be longer than other type engines; that is less wearing and less repairing.
- D) Comparing with other type cars, Wood-Gas Car has advantages:-
 - a) More speed.
 - b) Steeper hill can be climbed.
 - c) Heavier goods can be loaded.
- E) Cleaning of Wood-Gas Generator and Unit is easier and simpler than other type Generators, except Charcoal Gas Generator.

Comparing with Gasoline Car, the Wood-Gas Car has the following defects:-

- A) Low speed.
- B) Cannot climb too steep hills.
- C) Requires about 30 minutes in Summer and 60 minutes in Winter for starting engine.

Kyoto, April 23, 1946.

The Commanding General,
Headquarters,
I Corps,
A P O 301.

Sir:-

Attention: Military Government Section,
Your File: M C 51,
Permit for Reconversion,
Dated 23 Nov., 1945.

Production Output Schedule for 1946-1947.

According to your instruction on April 12th, we beg
to enclose herewith a table showing "Production Output
Schedule, for 1946 - 1947" for eight items.

Yours faithfully,

Kyoto Kikai Kabushiki Kaisha
Kyoto Machinery Co., Ltd.

K. Ishizeki

K. ISHIZEKI
Managing Director.

KI

PRODUCTION OUTPUT SCHEDULE

FOR 1946 - 1947.

(A)	PROPOSAL 1946		PROPOSAL 1947	
	AVERAGE MONTHLY pcs.	PER YEAR pcs.	AVERAGE MONTHLY pcs.	PER YEAR pcs.
<u>Automobile Parts</u>				
<u>For Toyoda Cars:</u>				
Spindle Bolt	958	11,500	1,000	12,000
Spindle Bolt Locking Pin	896	10,750	1,000	12,000
Spindle Bolt Locking Pin Nut	883	10,600	1,000	12,000
Piston Pin	958	11,500	1,000	12,000
Piston Pin Bushing	817	9,800	1,000	12,000
Front Hub Bolt Set	1,133	13,600	1,500	18,000
Rear Hub Bolt Set	2,292	27,500	3,000	36,000
Universal Joint	242	2,900	300	3,600
Rear Shaft	213	2,550	300	3,600
Rear Spring Shackle Pin	925	11,100	1,000	12,000
Rear Spring Shackle Pin Nut	925	11,100	1,000	12,000
Rear Spring Shackle Pin Bushing	717	8,600	800	9,600
<u>For Nissan Cars:</u>				
Spring Bolt	958	11,500	1,000	12,000
Spring Bolt Locking Pin	896	10,750	1,000	12,000
Piston Pin	958	11,500	1,000	12,000
Rear Shaft	213	2,550	300	3,600
<u>Miscellaneous Parts</u>	3,326	39,916	1,800	21,600
TOTAL	17,310	207,716	18,000	216,000
	pcs.	pcs.	pcs.	pcs.
	::::::::::	::::::::::	::::::::::	::::::::::

(B)
Repair of Automobile

Repair of Automobiles

	1946		1947	
	AVERAGE MONTHLY	PER YEAR	AVERAGE MONTHLY	PER YEAR
Repair of Automobiles	39.5 cars	474 cars	45 cars	540 cars
Repair of part of Automobiles	28.5 cases	342 cases	30 cases	360 cases

(C)
Wood-working Machines

36 inch Circular Saw Machine

	1946		1947	
	AVERAGE MONTHLY	PER YEAR	AVERAGE MONTHLY	PER YEAR
36 inch Circular Saw Machine	6.25 mach.	75 mach.	2.92 mach.	35 mach.

(D)
Centrifugal Separators

No. 300 Machine
No. 500 Machine
No. 700 Machine

	1946		1947	
	AVERAGE MONTHLY	PER YEAR	AVERAGE MONTHLY	PER YEAR
No. 300 Machine	0.67	8	2.50	30
No. 500 Machine	6.25	75	6.67	80
No. 700 Machine	0.25	3	1.67	20
TOTAL	7.17 mach.	86 mach.	10.83 mach.	130 mach.

	1946		1947	
	AVERAGE MONTHLY	PER YEAR	AVERAGE MONTHLY	PER YEAR
(E)				
<u>Dyeing & Finishing Machines</u>				
Felt Calender	1.25 ² mach.	15 mach.	0.83 mach.	10 mach.
3-Bowl Mangle	0.08 mach.	1 mach.	0.83 mach.	10 mach.
16-Cylinder Drying Machine	0.33 mach.	4 mach.	0.83 mach.	10 mach.
30-ft. Stentering Machine	0.42 mach.	5 mach.	0.83 mach.	10 mach.
40-ft. Stentering Machine	0.08 mach.	1 mach.	----	----
Jigger	1.25 mach.	15 mach.	1.67 mach.	20 mach.
Yardage Counting <i>Folding</i> Machine	1.50 mach.	18 mach.	1.67 mach.	20 mach.
Clips for Stenter	1,392 pcs.	16,700 pcs.	833 pcs.	10,000 pcs.
Hydro Extractor	0.33 mach.	4 mach.	0.83 mach.	10 mach.
Roller Washing Machine	----	----	0.83 mach.	10 mach.
4-Burner Singeing Machine	----	----	0.83 mach.	10 mach.
Wince Beck	----	----	2.50 mach.	30 mach.
5-Tank Washing Machine	----	----	0.83 mach.	10 mach.
TOTAL	5.25 mach.	63 mach.	12.50 mach.	150 mach.
	1,392 pcs.	16,700 pcs.	833 pcs.	10,000 pcs.

	1946		1947	
	AVERAGE MONTHLY	PER YEAR	AVERAGE MONTHLY	PER YEAR
(F)				
<u>Hand Tools</u>				
Metal Hammer	84 pcs.	1,011 pcs.	----	----
Punch	42 pcs.	500 pcs.	----	----
Hand Vice	33 pcs.	395 pcs.	----	----
Metal Saw	42 pcs.	500 pcs.	----	----
Plier	583 pcs.	7,000 pcs.	833 pcs.	19,000 pcs.
Assortment of Box Wrenches	125 sets	1,500 sets	125 sets	1,500 sets
Box Wrenches Double Head	75 sets	900 sets	----	----
Connecting Rod Socket	149 pcs.	1,790 pcs.	----	----
Assortment of Box Wrenches	294 sets	3,529 sets	300 sets	3,600 sets
Box Wrench, Double Head	94 pcs.	1,128 pcs.	125 pcs.	1,500 pcs.
Assortment of 6 Wrenches Double Head	183 sets	2,200 sets	167 sets	2,000 sets
Box Wrench, Single Head	204 pcs.	2,450 pcs.	167 pcs.	2,000 pcs.
Assortment of 4 Wrenches Double Head	279 sets	3,350 sets	125 sets	1,500 sets
Assortment of Box Wrenches	108 sets	1,300 sets	125 sets	1,500 sets
Assortment of 3 Wrenches Box, Double Head	167 sets	2,000 sets	167 sets	2,000 sets
Assortment of 6 Wrenches Box, Double Head	133 sets	1,600 sets	167 sets	2,000 sets
6 inch Pinch	333 pcs.	4,000 pcs.	500 pcs.	6,000 pcs.

	1946		1947	
	AVERAGE MONTHLY	PER YEAR	AVERAGE MONTHLY	PER YEAR
(F)				
<u>Hand Tools</u>				
<u>(Continued)</u>				
Assortment of Various Tools, Portable	125 sets	1,500 sets	----	----
Monkey Wrench 8 in.	208 pcs.	2,500 pcs.	208 pcs.	2,500 pcs.
Miscellaneous Tools	93 pcs.	1,111 pcs.	----	----
<hr/>				
TOTAL	1,490 sets	17,879 sets	1,175 sets	14,100 sets

	1,865 pcs.	22,385 pcs.	1,833 pcs.	22,000 pcs.

(G)
Prefabricated Houses

(H)
Doors

Houses and Doors for Houses	9.8 houses	118 houses	11.3 houses	135 houses

HEADQUARTERS SIXTH ARMY
Military Government Section
APO 442 (Kyoto, Honshu)

File: MG 51Date: 23 November 1945

SUBJECT: Permit for Reconversion from War Production and for Resumption of Production of Essential Civilian Commodities.

TO: : Kyoto Kikai Kabushiki Kaisha, Katsuragawa, Hichijo, & Hanazono Factory
(Name & Address of Firm)

50 Funadocho, Kisshoin, Shimogyoku, Kyoto.

1. In accordance with the provisions of paragraphs 3 a and 3 b of Directive No. 3 from the Supreme Commander for the Allied Powers, dated 22 September 1945; Memorandum for the Imperial Japanese Government, Subject: Reconversion of War Production Plants to Peacetime Production, dated 28 October 1945; and under authority granted this Headquarters by CINCAFIAC radio ZAX 6197 dated 3 October 1945; you are authorized to commence operation of your plant, and to manufacture the essential civilian commodities listed in Annex No. 1 to this permit.

2. This permit grants authority only to operate. The acquisition of materials, parts, and sub-assemblies, as well as the disposition of finished products and establishment of sales prices, will be in accord with the regulations of the Imperial Japanese Government.

3. At the end of the first month of operation, and at the end of each three month period thereafter, until notified to the contrary by this Headquarters a report will be made to the Commanding General 1 Corps, Headquarters Osaka, Attention: Military Government Section. This report will be written in English and will list each item, by name, type, and quantity produced by each factory, subsidiary, or sub-contractor operating under the provisions of this permit. This report will be delivered to Corps Headquarters not later than fifteen (15) days after the conclusion of the period to which the report pertains.

1 Incl: Annex No. 1
23 Nov 45

GEORGE D. SEARS
Colonel. Infantry
Military Government Officer

Info Copies To:

GHQ, SCAP (Attn E. & S. Sec)
CG 1 Corps, (Attn) MG Sec.
Imperial Japanese Gov't
(6th Army Jap. Liaison Office, Kyoto)

HEADQUARTERS SIXTH ARMY
Military Government Section
APO 442

ANNEX NO. 1.

23 November 1945

Permission is granted to Kyoto Kikai Kabushiki Kaisha, Katsuragawa, Hichijo, & Hanazono Factory 50 Funadocho, Kisshoin, Shimogyoku, Kyoto to produce the following items listed below:

- a. Automobile parts.
- b. Repair of automobiles.
- c. Wood-working machine.
- d. Centrifugal seperators.
- e. Dyeing and finishing machines.
- f. Hand tools.
- g. Prefabricked houses.
- h. Doors.

(Nothing follows:

DAVID S. LOCKIE
1st Lt. F. D.

COPY

COPY

APPLICATION FOR THE PERMISSION
OF CONVERSION TO
THE ESSENTIAL CONSUMERS' COMMODITIES.

KYOTO KIKAI KABUSHIKI KAISHA
(Kyoto Machinery Company, Limited)

Oct. 20, 1945.

Managing Director.

APPLICATION FOR THE PERMISSION
OF CONVERSION TO
THE ESSENTIAL CONSUMERS' COMMODITIES

1. NAME:-

Kyoto Kikai Kabushiki Kaisha.
(Kyoto Machinery Company, Limited.)

2. CAPITAL:-

5,000,000 Yen (Five-million Yen) (Paid-up).

3. OWNERSHIP:-

The capital is divided into 100,000 shares; each share being 50 Yen paid-up. Total number of share-holders is 24. Large share-holders are as follows:-

Share-holders	Number of Shares	Ratio to Capital
Messrs. Nagase & Co., Ltd.	69,255	69.2%
Mr. Tokutaro Nagase	7,000	7.0%
Mr. Ko-ichi Nakaguchi	5,000	5.0%
Mr. Shozo Nagase	4,000	4.0%
Mr. Seizo Nagase	3,852	3.8%
Mr. Eikichi Uenoyama	3,075	3.1%
Mr. Komajiro Kusakabe	1,875	1.9%
Mr. Seijiro Okazaki	1,500	1.5%
Total 8 Share-holders	95,557	95.5%

4. RELATION TO THE GOVERNMENT:-

There is no relation to the Government for our Capital.

5. DATE OF FOUNDATION:-

Company: August 2nd, 1938.
Factory: August 2nd, 1938.

6. LOCATION:-Company:

50 Funadocho, Kisshoin, Shimogyoku, Kyoto.

Factory:

50 Funadocho, Kisshoin, Shimogyoku, Kyoto.

Branch Factories:Katsuragawa Factory8 Shimono-mukai-cho, Shinden, Kisshoin,
Shimogyoku, Kyoto.
(About a half mile west from our Company.)Hichi jo Factory43 Goshono-uchiho, Nishi-hichi jo,
Shimogyoku, Kyoto.
(Less than 1 mile north from our Company.)Hanazono Factory19 Yatsuguehicho, Hanazono, Ukyoku, Kyoto.
(About 2.5 miles north from our Company.)7. GENERAL DESCRIPTION OF MACHINERY AND PLANT:-Area of Sites:-

43,123 Tsubo (6 ft. sq.) or abt. 35.2 Acres

Area of Structures:

9,100 Tsubo or abt. 7.4 Acres

The about ^{ve} "Area of Structures" includes Area of
machine shops:

3,200 Tsubo or abt. 2.6 Acres

Machinery and Plant:Metal Working Machine:

Lathe	260
Drilling Machine	50
Boring Machine	1
Grinding Machine	31
Milling Machine	37
Gear Cutting Machine	6
Planer	3
Shaper	14
Metal Sawing Machine	3
Others	38

Industrial Machine:

Hammer	1 ton	1
	0.5 ton	2
	Others	3
Air Compressor		3
Others		7

Electric Machine:

Motor	43
Transformer	40
Electric Furnace, for Heat Treatment	11
Others	12

Wood Working Machine:

Band Saw-ing Machine	7
Circular Saw-ing Machine	9
Planer	5
Grinding Machine	2
Others	25

Testing Apparatus:

Microscopical Tester for Tools	1
Impact Tester	1
Hardness Tester	10
Others	3

Materials on Hand:

<u>Materials</u>	<u>Shape</u>	X (1) <u>Gunju</u>	X (2) <u>Minju</u>	<u>Total</u>
Ordinary Steel Products	Rod	133	120	253 Tons
	Sheet	75	207	282 Tons
	Tube	0	24	24 Tons
	Wire	21	46	67 Tons
	Rope	15	4	19 Tons
		<u>244</u>	<u>401</u>	<u>645</u> Tons
Special Steel Products	Rod	908	140	1,048 Tons
	Sheet	126	0	126 Tons
	Tube	16	0	16 Tons
	Wire	2	0	2 Tons
		<u>1,052</u>	<u>140</u>	<u>1,192</u> Tons
Copper Products	Rod	21	0	21 Tons
	Sheet	1	0	1 Ton
		<u>22</u>	<u>0</u>	<u>22</u> Tons
Aluminium Products	Rod	17	0	17 Tons
	Sheet	3	7	10 Tons
		<u>20</u>	<u>7</u>	<u>27</u> Tons
Aluminium Cast Products		<u>6</u>	<u>0</u>	<u>6</u> Tons
Zinc		<u>2</u>	<u>2</u>	<u>4</u> Tons

Note:

X(1) "Gunju" means
Our own materials in
making articles for the
Munitions Ministry.

X(2) "Minju" means
Our own materials in
making articles for the
civil use.

8. Number of EMPLOYEES:-

	1945.				
	<u>Aug. 15</u>	<u>Aug. 31</u>	<u>Sept. 15</u>	<u>Sept. 30</u>	<u>Oct. 15</u>
TOTAL NUMBER	<u>2,333</u>	<u>1,869</u>	<u>1,037</u>	<u>934</u>	<u> </u>
Clerks	475	466	328	251	
Laborers	<u>1,858</u>	<u>1,403</u>	<u>709</u>	<u>683</u>	<u> </u>
Total	<u>2,333</u>	<u>1,869</u>	<u>1,037</u>	<u>934</u>	<u> </u>
Male	1,709	1,404	846	779	
Female	<u>624</u>	<u>465</u>	<u>191</u>	<u>155</u>	<u> </u>
Total	<u>2,333</u>	<u>1,869</u>	<u>1,037</u>	<u>934</u>	<u> </u>
Clerks, Male	277	272	237	172	
Female	198	194	91	79	
Laborers, Male	1,432	1,132	609	607	
Female	<u>426</u>	<u>271</u>	<u>100</u>	<u>76</u>	<u> </u>
Total	<u>2,333</u>	<u>1,869</u>	<u>1,037</u>	<u>934</u>	<u> </u>

9. PRODUCTION BEFORE THE WAR:-

	<u>Adjusting Tools</u>	<u>Part of Bomb</u>	<u>Dyeing & Finishing Machinery</u>	<u>Centrifugal Separator</u>
	<u>,000 Yen</u>	<u>,000 Yen</u>	<u>,000Yen</u>	<u>,000 Yen</u>
From May, 1938 To Apr., 1939	---	---	410	---
From May, 1939 To Apr., 1940	418	71	145	---
From May, 1940 To Apr., 1941	913	200	165	---
From May, 1941 To Nov., 1941	2,461	---	60	53

NOTE:

Production of "Dyeing & Finishing Machinery" and "Centrifugal Separator" include the productions by:-

Kyoto Dye Machinery Works, Ltd.
(Kyoto Senki Seisakusho, Ltd.)

Kusakabe Engineering Works, Ltd.
(Kusakabe Kosakusho, Ltd.)

Ishigaki Iron-works.
(Ishigaki Tekkosho)

Whose complete equipments were purchased and taken up by our Company. These productions also include complete machines, parts, repairing of machines, revivification of machines.

10. PRODUCTION DURING THE WAR:-

	Adjusting Tools	Part of Bomb	Dyeing & Finishing Machinery	Centrifugal Separator
	<u>,000 Yen</u>	<u>,000 Yen</u>	<u>,000 Yen</u>	<u>,000 Yen</u>
From Dec., 1941 To Apr., 1942	2,462	---	---	53
From May, 1942 To Apr., 1943	8,969	470	---	241
From May, 1943 To Apr., 1944	9,082	383	---	315
From May, 1944 To Apr., 1945	14,687	2,260	---	276

NOTE:-

Production of "Centrifugal Separator" includes the production by Kusakabe Engineering Works, Ltd.; it also includes complete machines, parts, and repairings of machine.

11. FUTURE PLAN OF PRODUCTION:-**Articles and Monthly Turnover:**

(1) Parts of Automobile	300,000 Yen
(2) Repairing ^s of Automobile	50,000
(3) Wood Working Machines	50,000
(4) Centrifugal Separators	50,000
(5) Dyeing & Finishing Machinery	500,000
(6) Tools	50,000
(7) Ready-made Bungalows & Doors	300,000
Total, Monthly	<u>1,300,000</u> Yen

Chief Materials Required (Per Month):-

Steel & Special Steel	64 tons
Pig-iron	89 tons
Secondary Steel Products	5 tons
Copper	9 tons
Coal	61 tons
Coke	61 tons
Lubricating Oil	954 litres
or about	250 gallons
Timber	3,652 Koku
or about	36,000 cub. feet

Summary:-**(1) Parts of Automobile (Truck and Motor car):**

Some part of Automobile Parts can be made by our own engineers, workmen and equipments without reshuffling of men and machines. We have already several important and urgent inquiries for these parts.

(2) Repairings of Automobile (Truck and Motor Car)

In our Traffic Division, besides transportations of our goods by our trucks and other vehicles, we have special men and equipments for repairings of trucks and motor cars; we intend to utilize and enlarge this plant for repairing of Automobile to meet the urgent requirements from several sources.

(3) Wood Working Machines:

We have several urgent enquiries for these machines from lumber-mills, etc. These machines can be made by ourselves with our present men and equipments.

(4) Centrifugal Separators:

A part of our works is still equipped for making these machines; we have our own experienced men. Although we had a short intermission recently (since about the end of 1944) for making the same, we want to resume the production from about December or January next.

We are a qualified Member of "The Industrial Machine Control Association" (Sangyo Kikai To-osei Kai).

(5) Dyeing and Finishing Machinery:

We had a very long experience before the War for making these machines as our main and specialized line. After several years' intermission of making the same, we now desire to re-start the manufacturing. We still have our own mechanists, men and equipments. We have already several important enquiries in hand.

We are a qualified Member of "Japan Textile Machine Industry Control Association" (Nippon Sen-i Kiki Kogyo To-osei Kumiai).

(6) Tools:

Among the "Adjusting Tools" for the Munitions Ministry, partly they are special tools for air-engines, but partly they are ordinary tools for civil use, such as pinches, wrenches, screw-drivers, etc. We desire to continue to make the latter, that is only ordinary tools for civil use. Many enquiries in hand from railways, transportation, and electric-car companies, etc.

(7) Ready-made Bungalows and Doors:

Our Construction Division is equipped with lumber-mill. We have our own forests in northern part of Kyoto, about 12 miles from our Company; our own woodsmen cut the trees there; and our own trucks carry the woods to our lumber-mill.

This Division has also several professional people, such as designers, carpenters, tile-layers, electricians, plasterers, door-makers, glass-fitters, painters, etc. All our buildings, repairing of shops, small or large, wooden-fittings, simple furnitures, etc. were constructed or made by the hands of our Construction Division.

We desire to utilize all of our men and equipments of the Division and our woods in forests, in order to meet a part of urgent requirements of housing.

Summarising the above, with our present equipments and by least reshuffle of aged men, experienced for inexperienced, we desire to convert whole of our complete works to manufacture essential consumers' commodities.