

Part C-2  
to

Sept 14. 1945

Consolidation of underground

Name and Location	Tank Capacity	Ownership			Tank in Use		
		Govt	Private	Foreign	Current	Surplus	Other
Nagano Sekiyu- hanbai-kaisha (320 Nakagoshō-machi Nagano-city)	Barrel 1-330	-	1-330	-	1-330	-	1-
<b>Totals</b>	1-330	-	1-330	-	1-330	-	1-



Part C-2  
 tankage

Consolidation of underground by prefecture

Prefecture Way

Ownership	Prefecture	Tank in Use			Tank Not in Use			Total		
		Class	Size	Total	Class	Size	Total	Usable	Repairable	Unrepairable
		No cap	No cap	No cap	No cap	No cap	No cap	No cap	No cap	No cap
1-330	—	1-330	—	1-330	—	—	—	1-330	—	—
1-330	—	1-330	—	1-330	—	—	—	1-330	—	—



Proprietor Nagano-ken

Total					
Usable No cap	Repairable No cap	Unrepairable No cap	Total No cap	Remaining No cap	Net Repairable No cap
1-330	—	—	1-330	—	1-330
1-330	—	—	1-330	—	1-330



prefecture

Prefecture Nagano-ken

Tank Not in Use			Total					
Use	Empty	Total	Uncable	Repairable	Unrepairable	Total	Repairable	Unrepairable
No cap	No cap	No cap	No cap	No cap	No cap	No cap	No cap	No cap
—	—	—	1-330	—	—	1-330	—	1-330
—	—	—	1-330	—	—	1-330	—	1-330



A

## Report of Individual Tank

1 Identification: None

2 Owner: 6, Dec 1941 Nagano sekiryu  
hanbai kaisha  
15, Aug 1945 "  
Present "

3 Present User: Nagano sekiryu hanbai kaisha

4 Present Use: Gasoline

5 Type of construction: Underground horizontal  
riveted steel (not removed)

6 Capacity: 330 barrels diameter 9' 6"  
height 23' 8"

7 Present Condition: Serviceable

8 Accessories: Valves manhole plate are  
available



B

Report on individual installation

- 9 Name and location of Installation  
 Nagano-sekiyu hanbai Kaisha Nagano depot  
 330, Nakagecho Machi Nagano city
- 10 Total Numbers Usable 1  
 Repairable none  
 Irreparable none
- 11 Total Capacity Usable 330 barrels  
 Repairable none  
 Irreparable none
- 12 Total Tanks in use Clean Tank 1  
 Dirty Tank none
- 13 Total Tanks not in use None
- 14 Routes of Communications Railroad highway  
 facilities enter the  
 installation are serviceable  
 I.K.M. to Nagano Station
- 15 Waterway None
- 16 Primary functions Storage
- 17 Discharging and Loading facilities  
 By tankcar (pipeline) cargo
- 18 Capacity of operation in item 17  
 Pipe number 3 inch X 145 feet  
 2 1/2 X 138  
 Pump 2HP - 1
- 19 Serviceability 100%



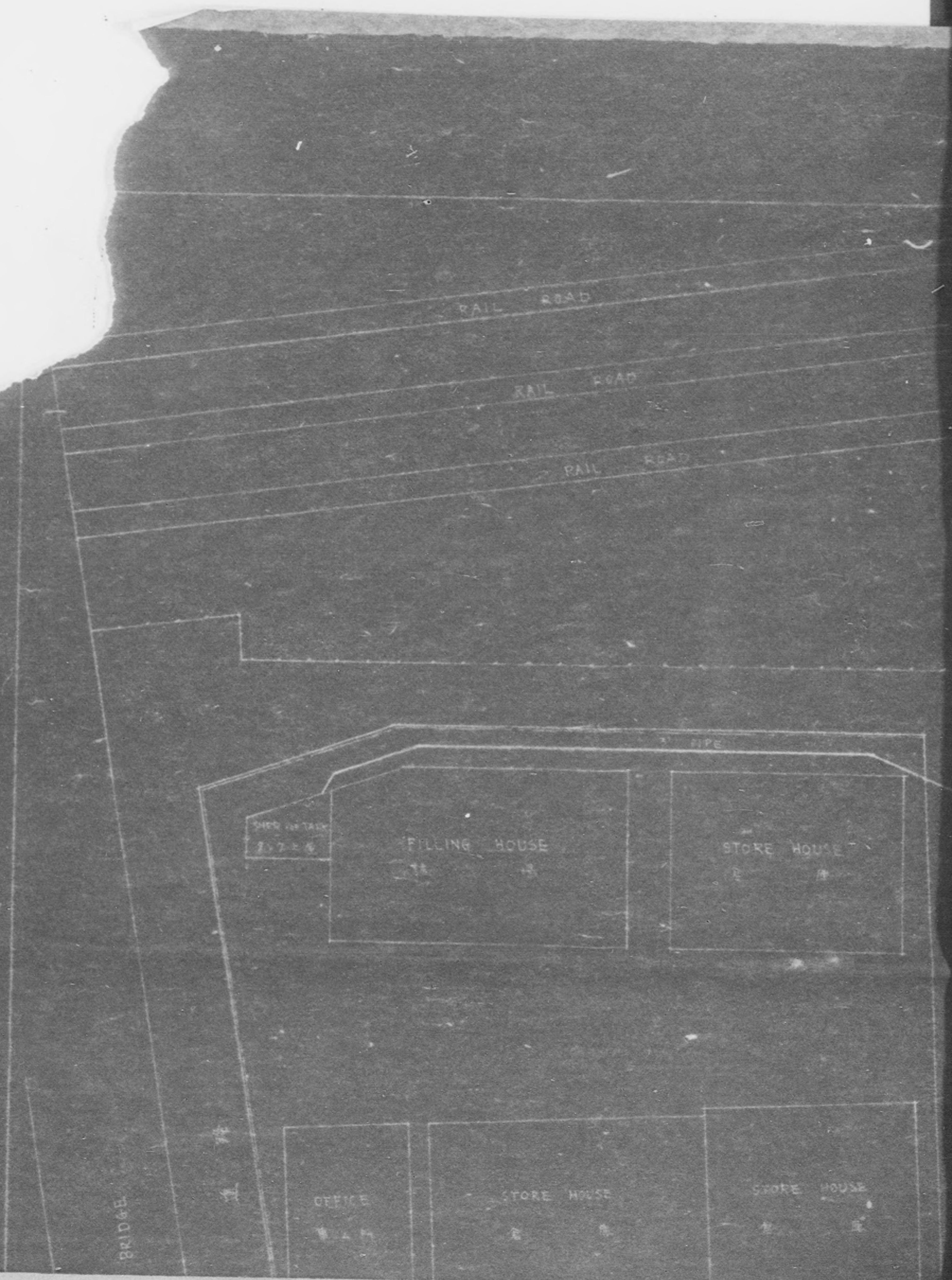



HAWARD STATION COMPOUND

ST. 15



WT 1000  
 H 1000  
 DIA 1000  
 DIA 1000  
 DIA 1000  
 DIA 1000  
 HORIZONTAL TYPE, POINTLESS  
 IRON TANK UNDER THE GROUND.  
 NOW IN USE.  
 DIA. 31-6/8  
 LENGTH 27-1/2



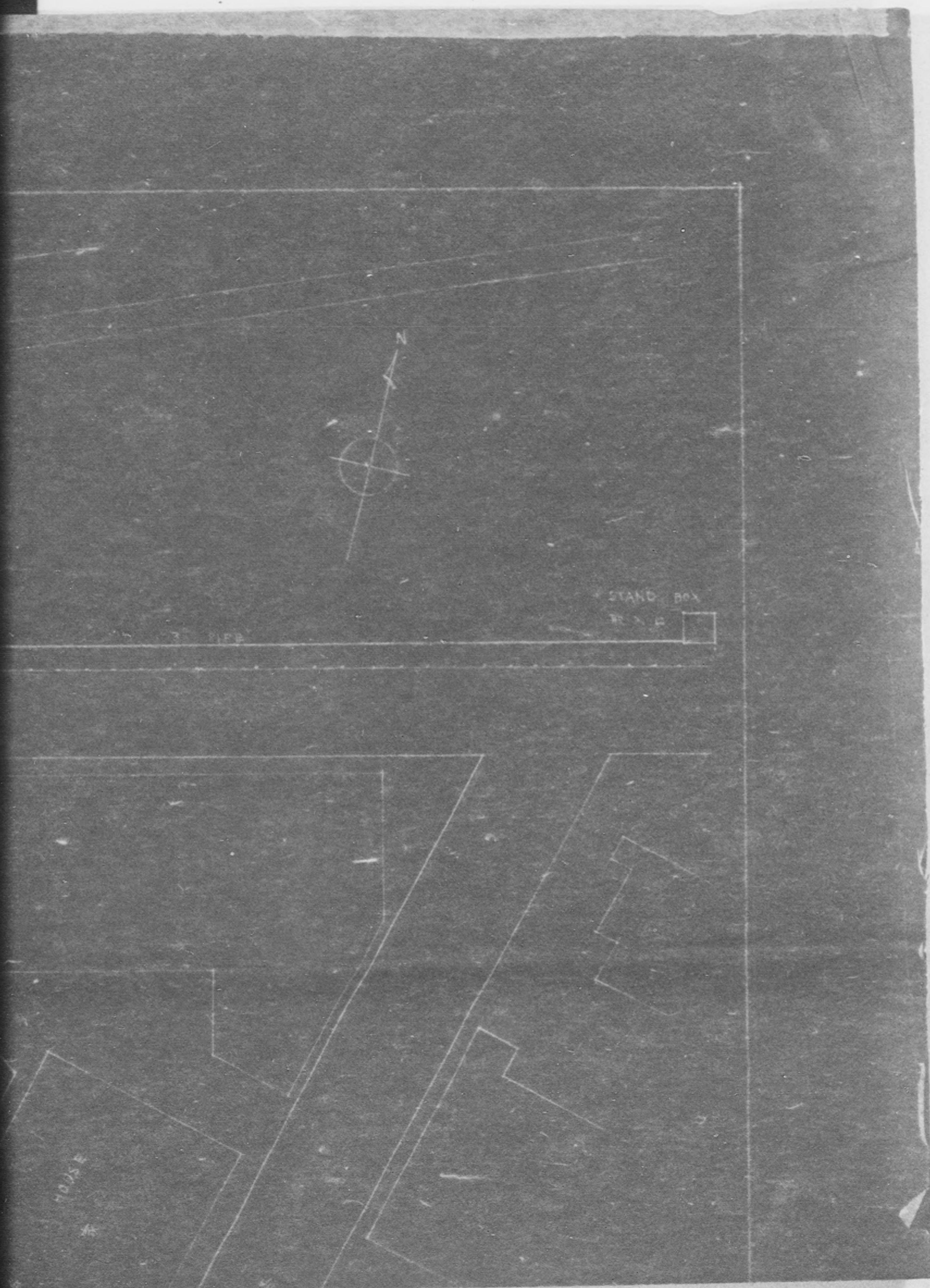



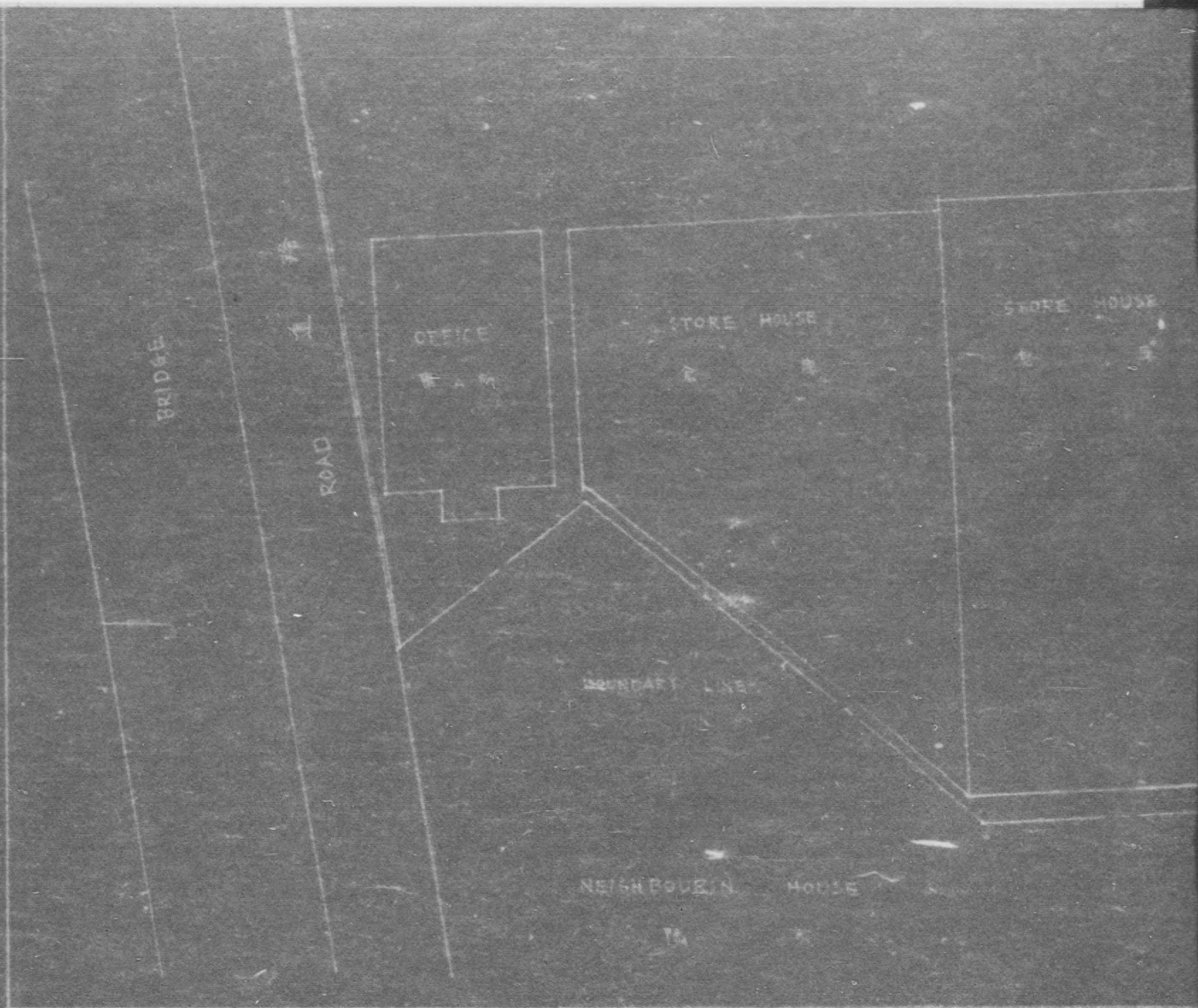



775013

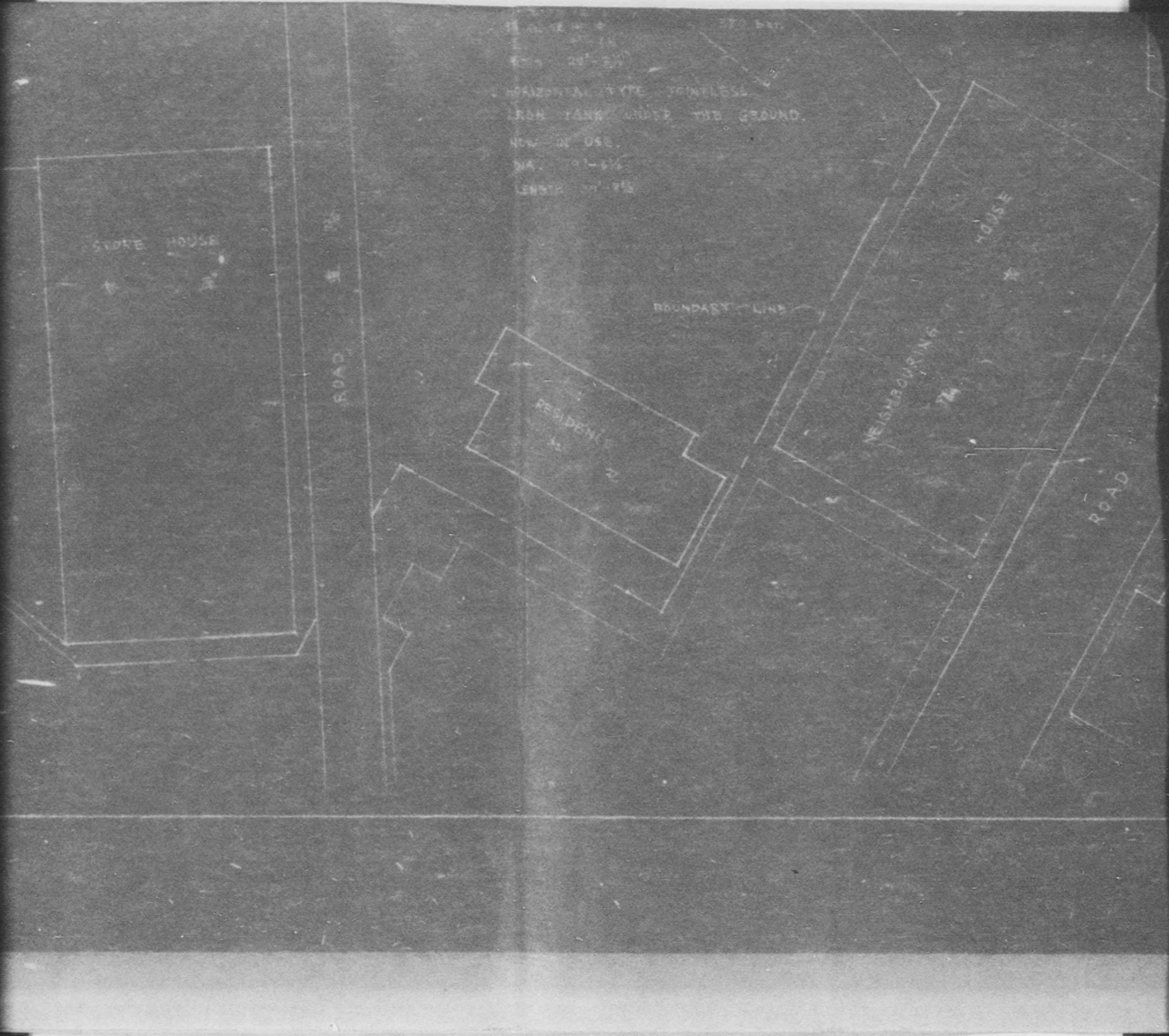



775013

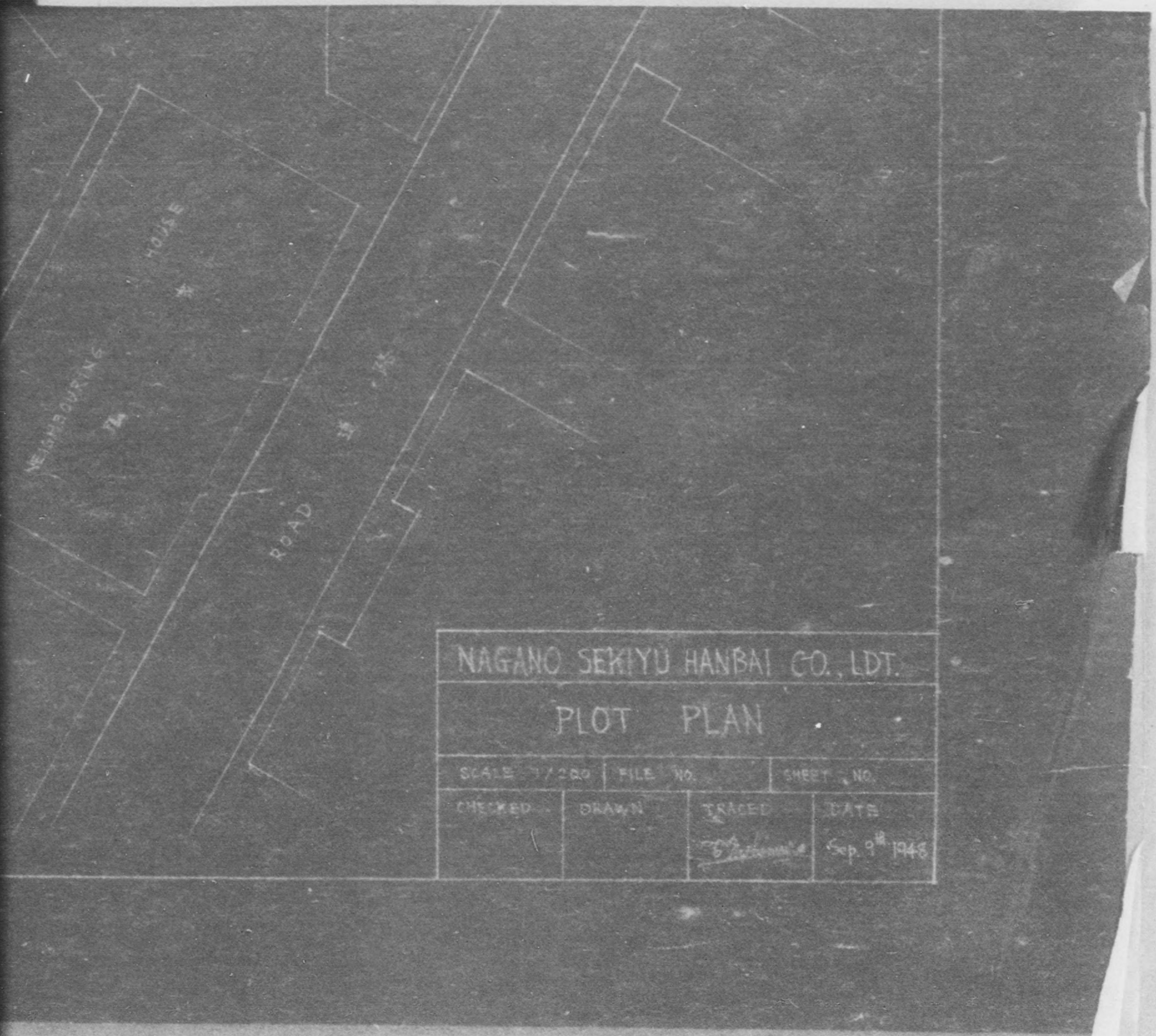

NAGANO SEKIYU HANBAI CO., LTD.			
PLOT PLAN			
SCALE 1/200	FILE NO.	SHEET NO.	
CHECKED	DRAWN	TRACED	DATE
		<i>S. Schmitt</i>	Sep. 9 <sup>th</sup> 1948



## Part A

## Report of individual Tank

1 Identification	None
2 Owner	6, Dec, 1941 Standard Vacuum Oil Co. 15, Aug 1945 "
3 Present User	Petroleum Distribution Kedah
4 Present Use	Gasoline
5 Type of Construction	Aboveground cubical riveted Steel inner surface steel
6 Capacity	509 barrels diameter 12 1/2' height 24 3/4' 5' courses
7 Present Condition	Serviceable
8 Accessories	Valves hatch cover form boxes manhole plate etc are available



B

## Report on individual installation

## 9 Name and Location of Installation:

Petroleum Distribution Kodan Matumoto first depot  
625 Chikuma Matumoto city

## 10 Total Numbers:

Usable 1  
Reparable none  
irreparable none

## 11 Total capacity:

Usable 509 barrels  
reparable none  
irreparable none

## 12 Total Tanks in use:

Clean Tank 1  
dirty Tank none

## 13 Total Tanks not in use: None

## 14 Routes of communication:

Railroad highway facilities enter  
the installation are serviceable  
1 K.M. to Matumoto Station  
None

## 15 Waterways:

## 16 Primary function:

Storage

## 17 Discharging and Loading Facilities:

By Tankcar cargo Lorry

## 18 Capacity of operation in Item 17:

Pipe number 5 inch X 190 feet  
2 X 45  
2 X 20

Pump number 1 (Wing Pump)

## 19 Serviceability:

100 %



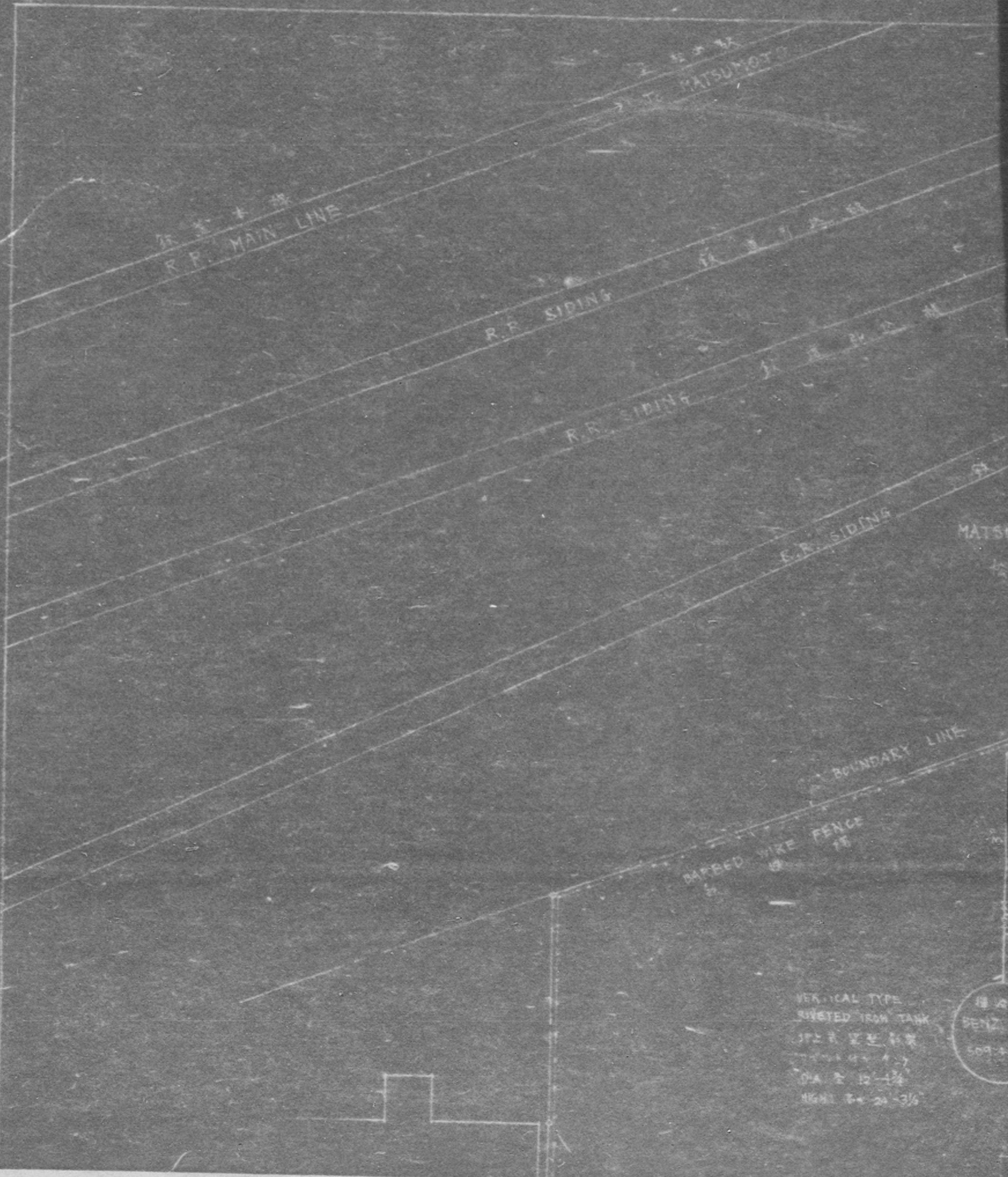



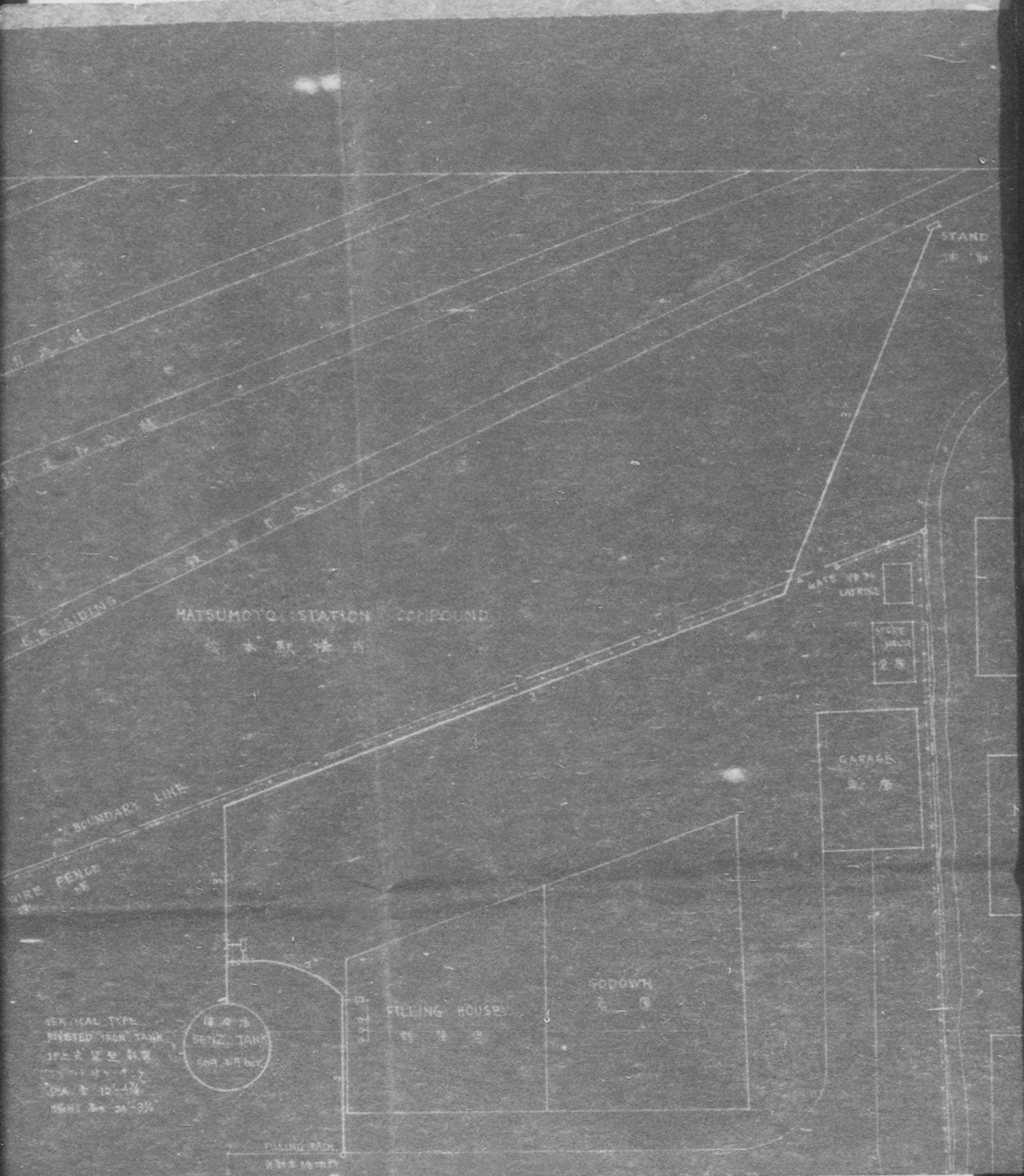



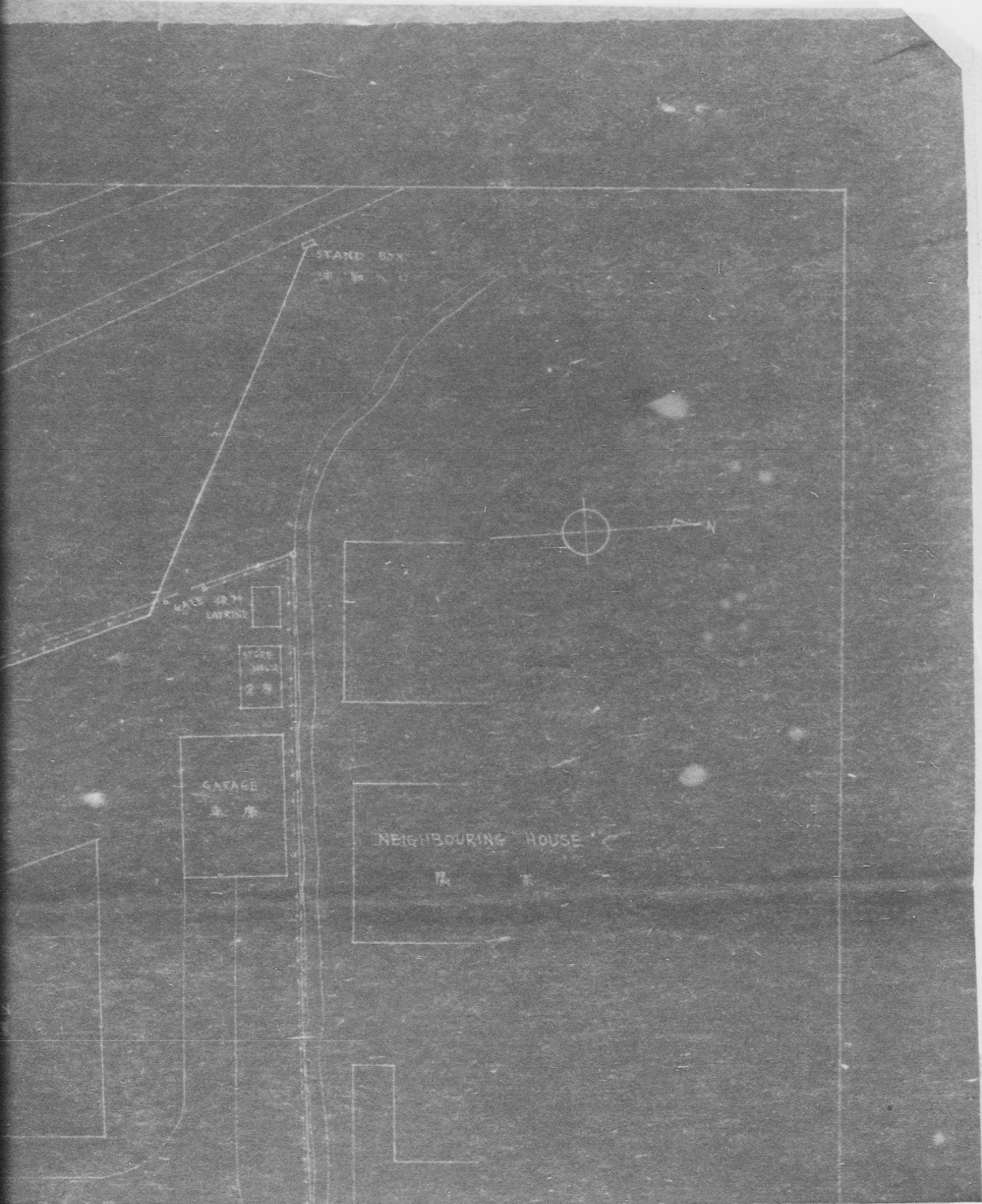



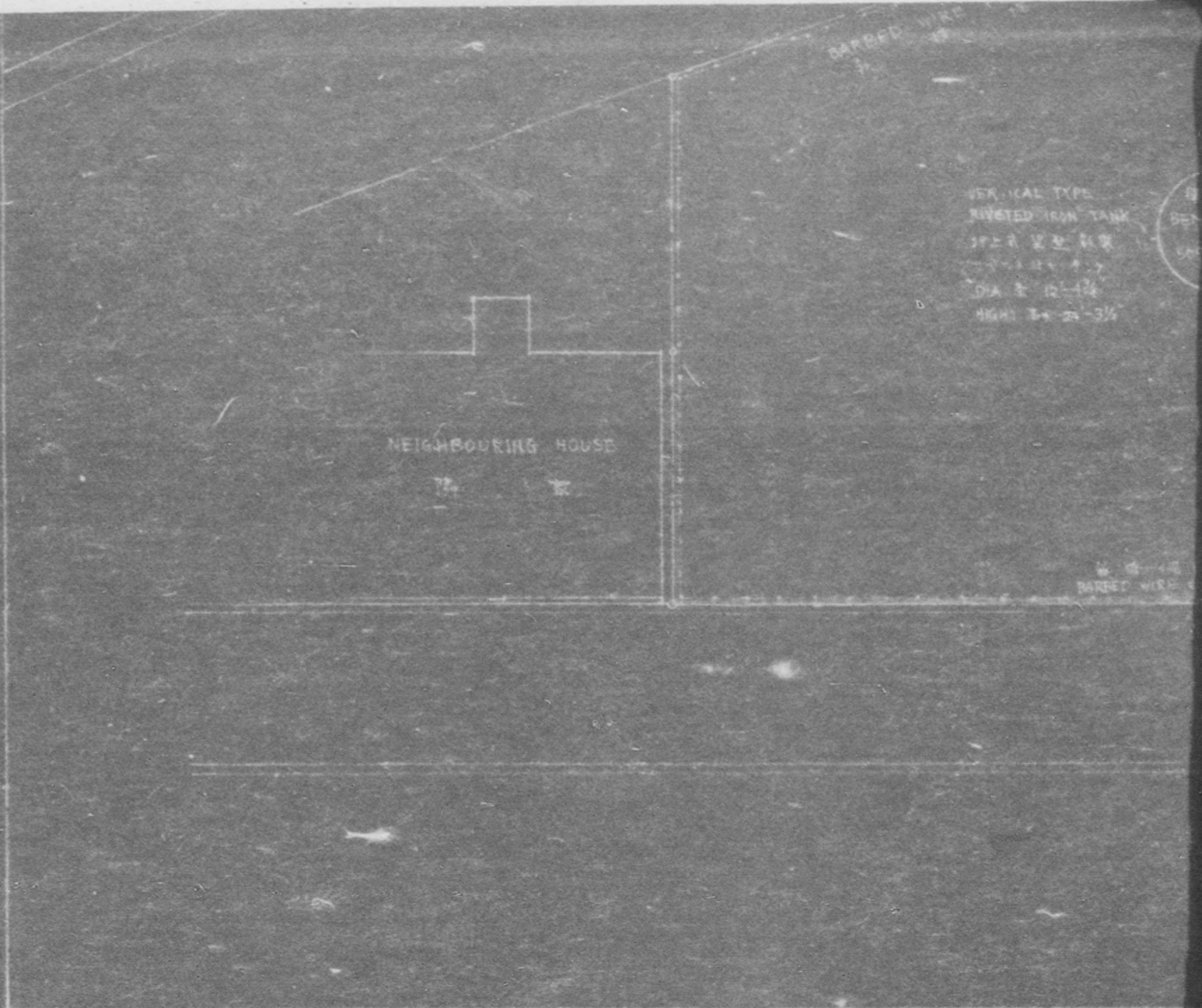



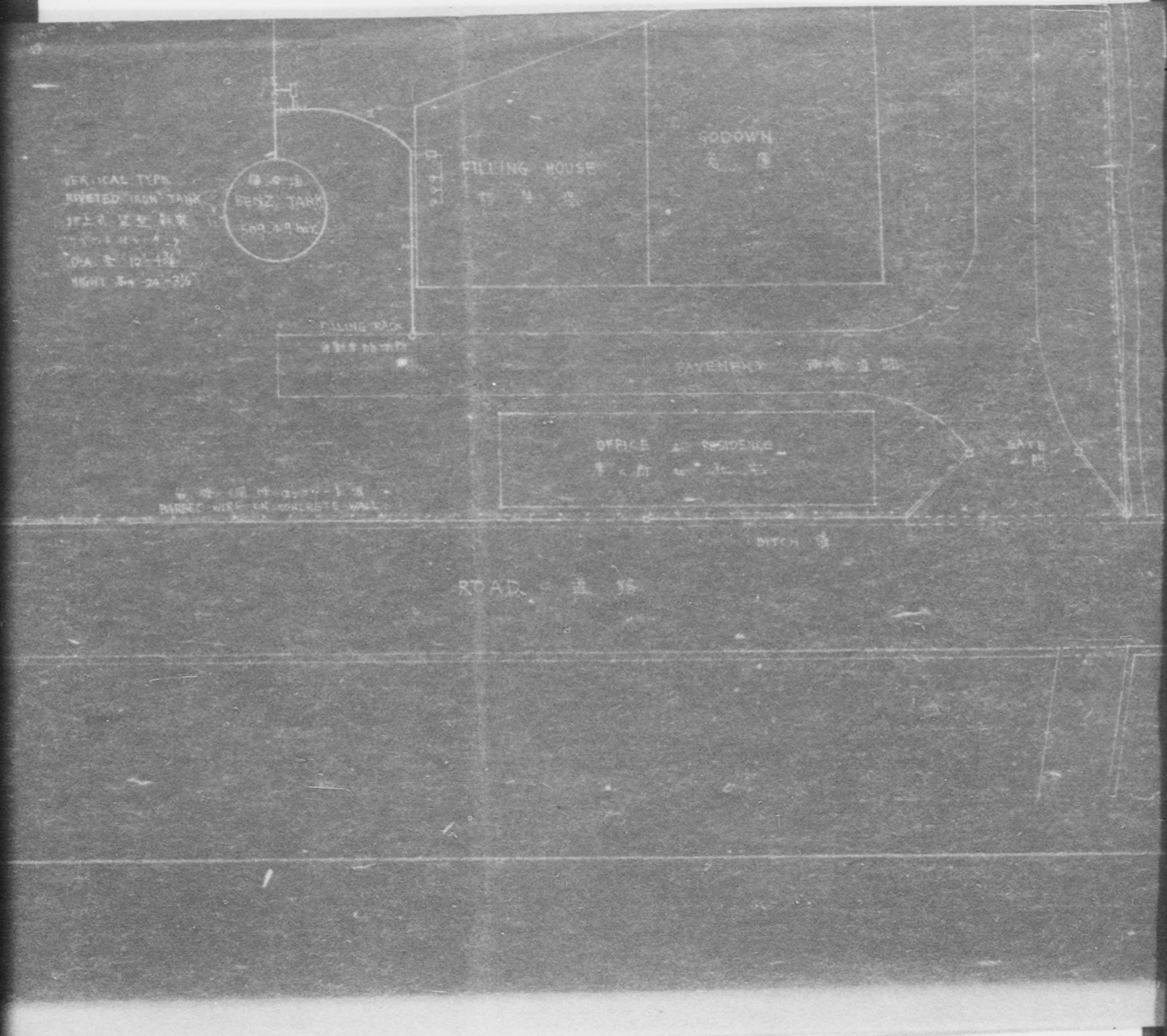



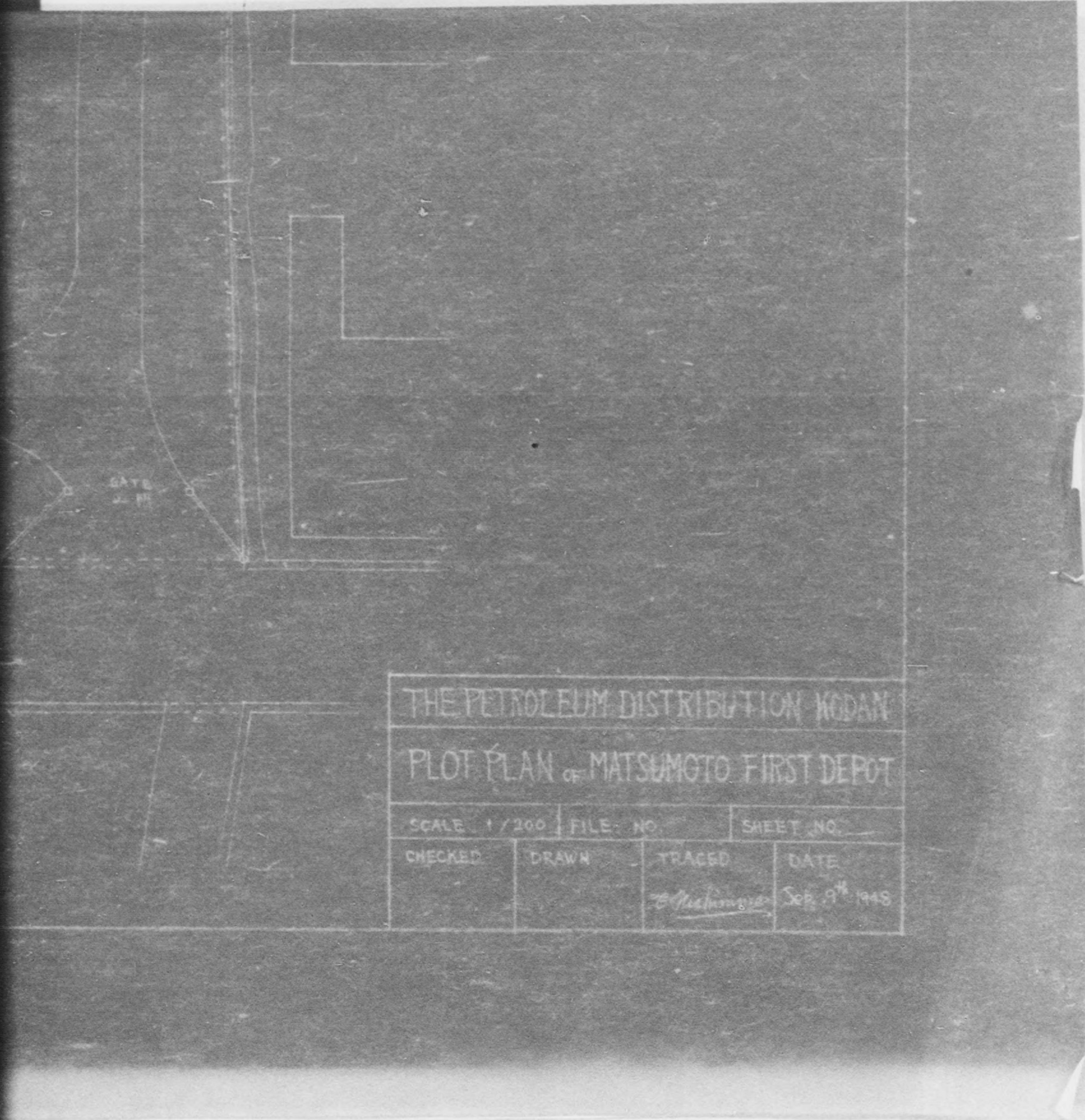

THE PETROLEUM DISTRIBUTION WODAN			
PLOT PLAN OF MATSUMOTO FIRST DEPOT			
SCALE 1/200	FILE NO.	SHEET NO.	
CHECKED	DRAWN	TRACED	DATE
		<i>E. Matsumoto</i>	SEP 9 <sup>th</sup> 1948



## Part A

## Report of Individual Tank

1 Identification:	Tank No 2
2 Owner:	6 Dec 1941 Rising Sun Petroleum Co. 15 Aug 1945 Present
3 Present User:	Petroleum Distribution Kedah
4 Present Use:	Kerosene
5 Type of Construction:	Aboveground cubical riveted Steel inner surface steel
6 Capacity:	421 Barrels diameter 14' 10" covers height 4' 9"
7 Present condition:	Serviceable
8 Accessory:	Valves hatch covers, formboxes, ladder manhole plate, etc, are available



B

Report on individual installation

9 Name and Location of Installation:

Petroleum Distribution Kadan Yashiro Depot  
3036 Kojima Hanau-machi Nagano Ken

10 Total Number of Tanks: Usable 2

reparable none  
irreparable none

11 Total Capacity:

Usable 1471 barrels  
reparable none  
irreparable none

12 Total Tanks in Use:

Clean Tank 1  
dirty Tank none

13 Total Tanks not in Use: Clean Dirty Tank none

14 Routes of Communication: Railroad highway facilities

enter the installation are  
serviceable 0,4K.M. to Yashiro  
Station

15 Waterways:

none

16 Primary Function:

Storage

17 Discharging and Loading. By Tankcar (pipeline) cargo Lorry  
Facilities.

18 Capacity of Operation in Item 17:

Pipe number

4 inch X 124,3 feet		3 inch X 68,7 feet		inch	
4	X 36,7	2	X 15,0	1 1/2	X 26,0 feet
4	X 23,5	2	X 11,8	1 1/2	X 23,8
3	X 52,0	1 1/2	X 3,6	1 1/4	X 48,0
3	X 64,3	1 1/2	X 17,6	1	X 53,7
3	X 64,7	1 1/2	X 47,0	1	X 37,0

PuWP number 5BR 1

19 Serviceability:

100%



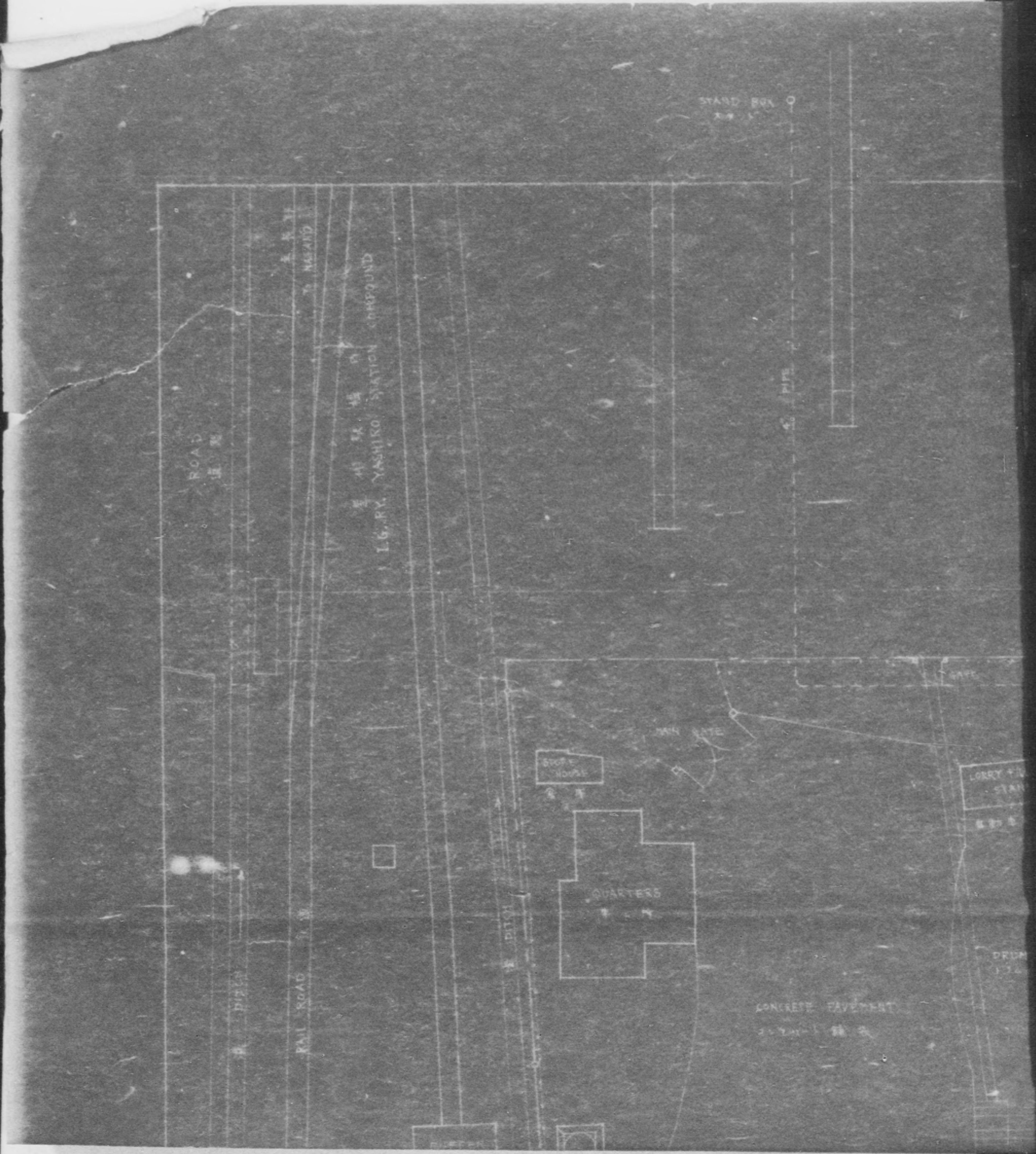



NAGANO DENTETSU CO. RAIL WAY COMPOUND

長野電鉄株式会社

ROAD 12' WIDE



NO. 2  
KEROSENE  
421.43 gal

NO. 1  
ENGINE  
(050.43 gal)

VERTICAL TYP  
IRON TANK  
DIA. 2' 10" H  
HEIGHT 8' 11" 1/2  
NO. 14 USE  
DRAIN RAIL

DRAIN  
FILLING AND  
3 1/2 H  
FILTER



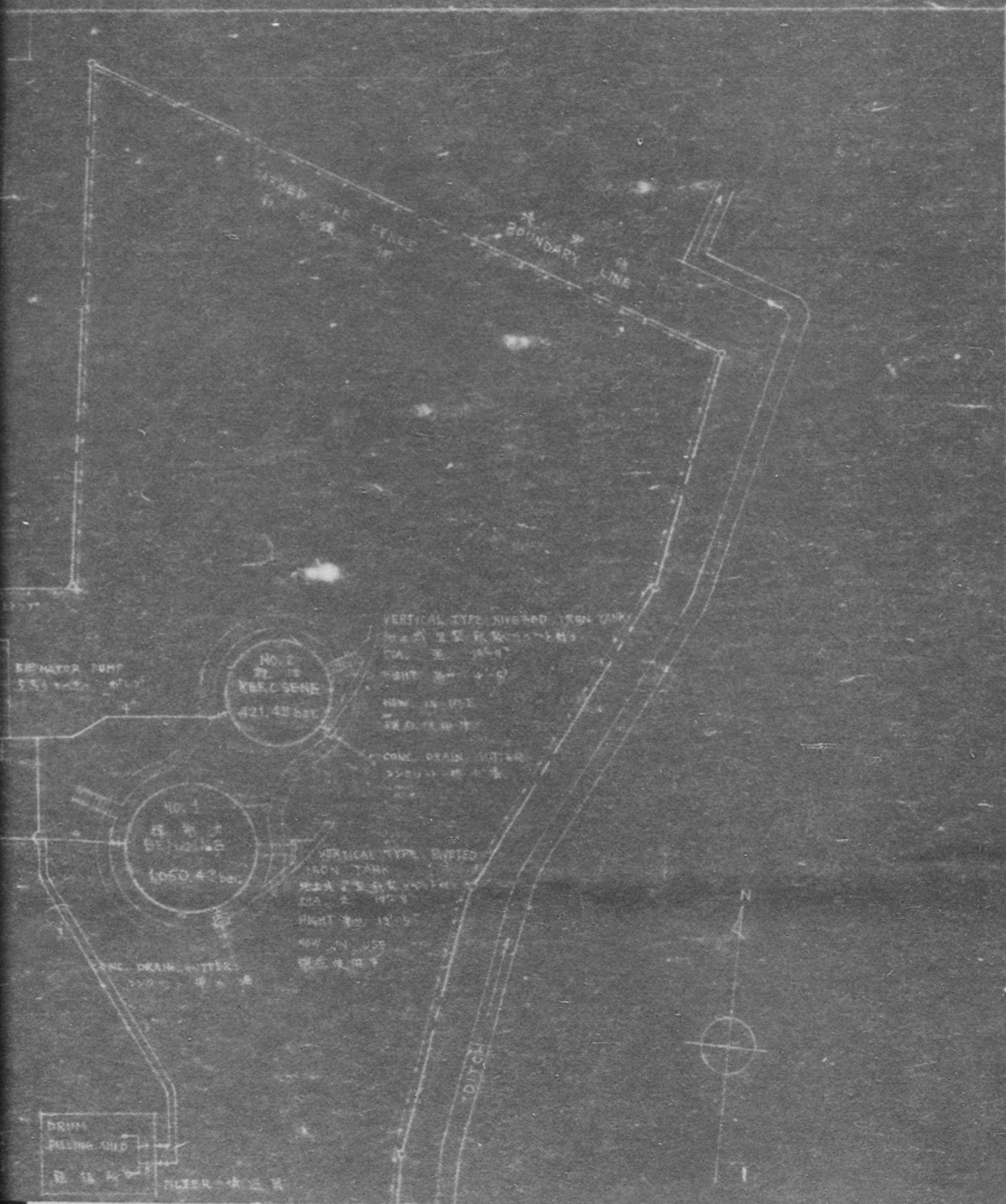



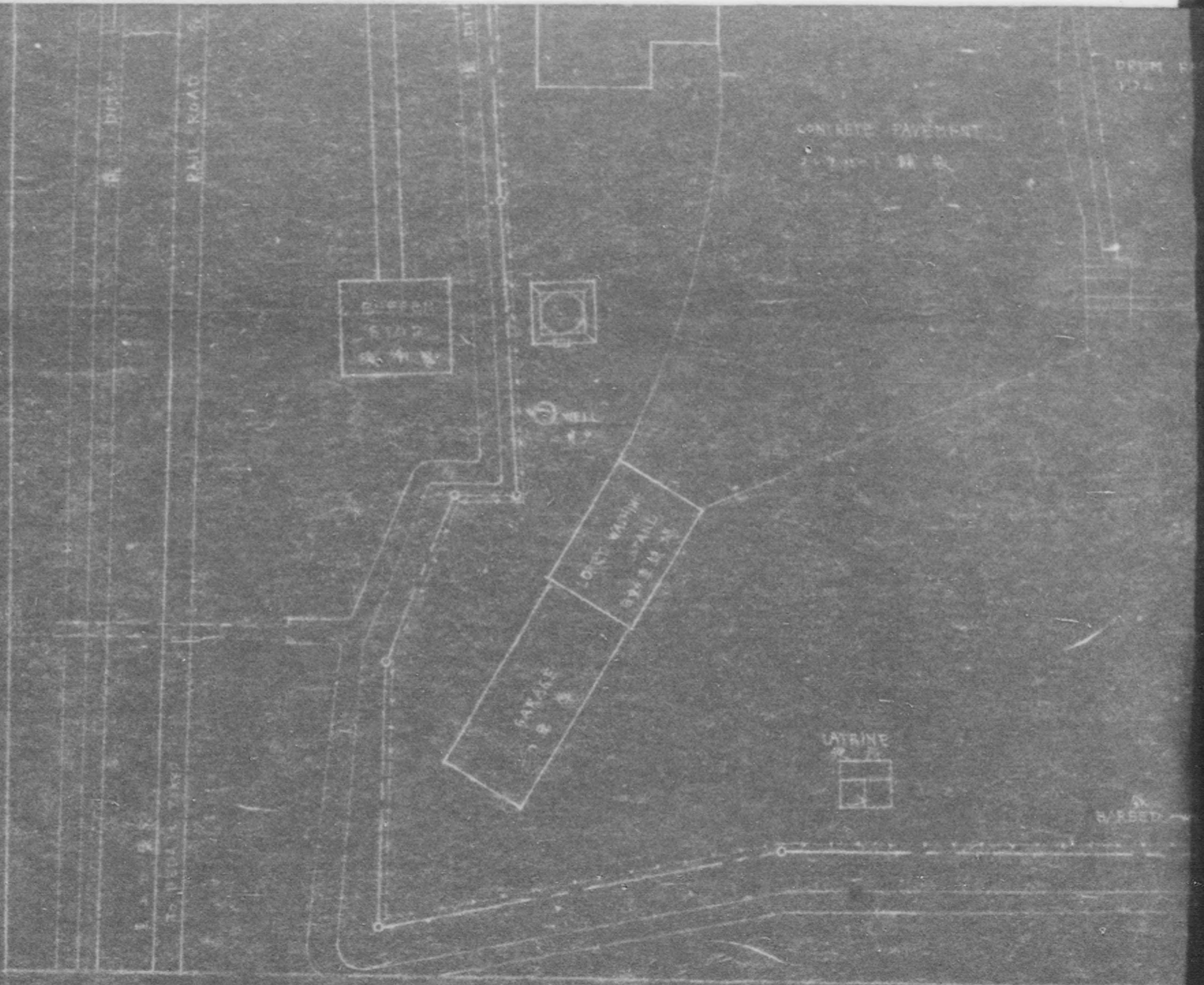



775013

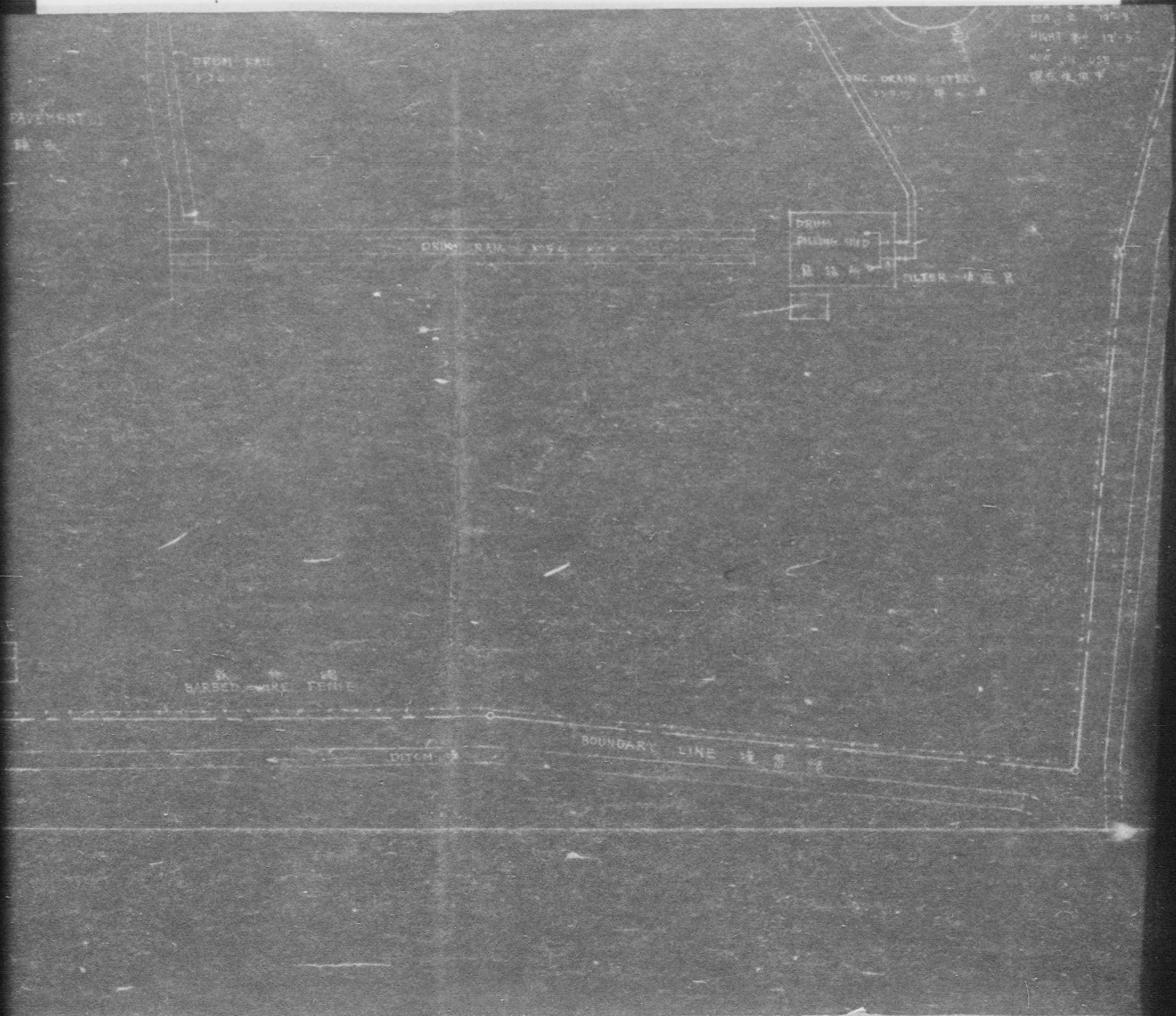



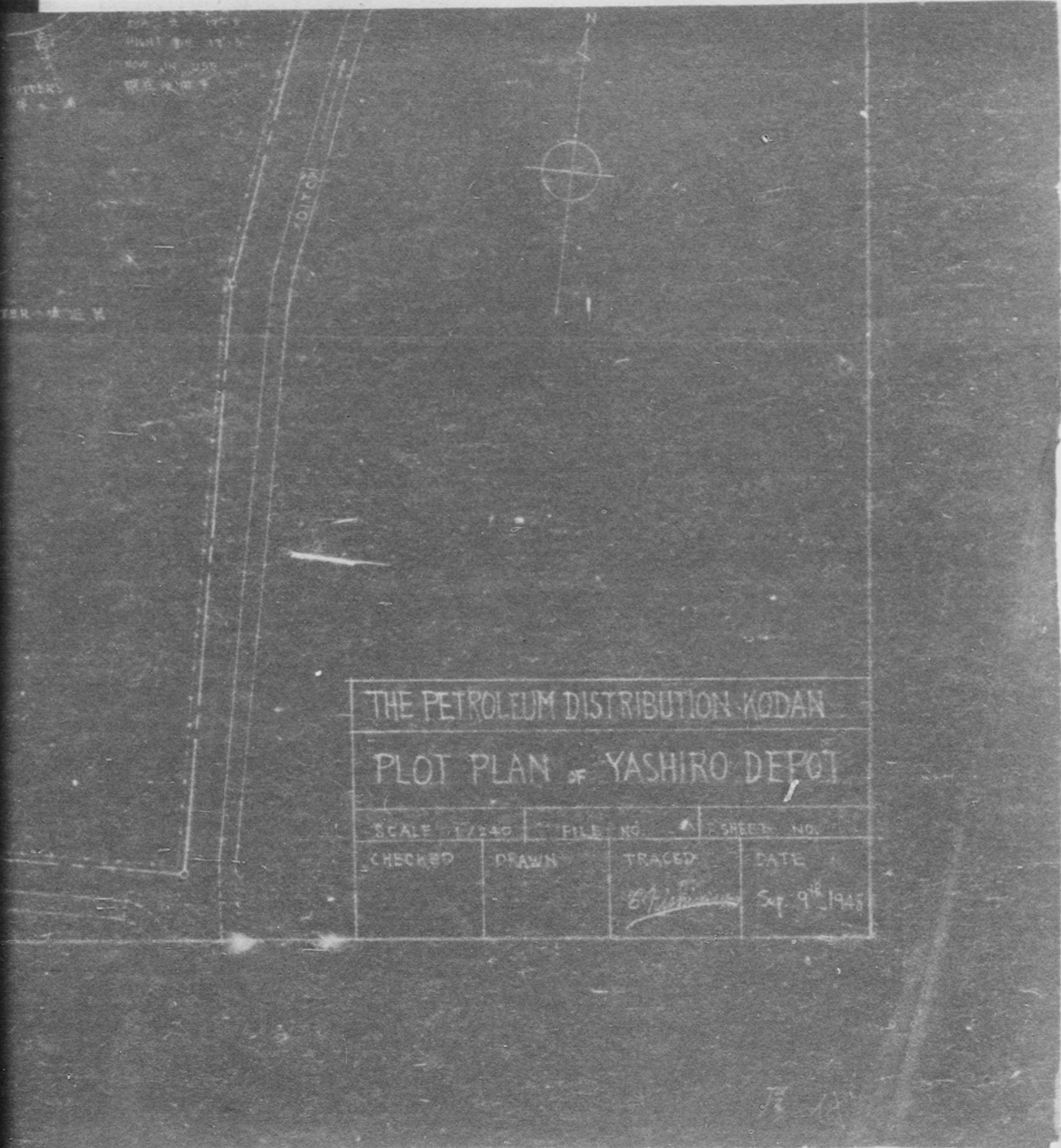

THE PETROLEUM DISTRIBUTION KODAN  
 PLOT PLAN OF YASHIRO DEPOT

SCALE 1/240	FILE NO.	SHEET NO.	
CHECKED	DRAWN	TRACED	DATE
		<i>[Signature]</i>	SEP 9 <sup>th</sup> 1945