

List of
Disposed Materials (determined)
Location; Warehouse S-5

| Materials | No. of Permit or Instructor |
|-------------|-----------------------------|
| Steel Pipe | Kan 660 |
| Gas Pipe | " |
| Iron Wire | " |
| Steel (rod) | " |
| " (Channel) | " |
| " (plate) | " |

Warehouse S-5 (Japan Fertilizer Co. Ltd)

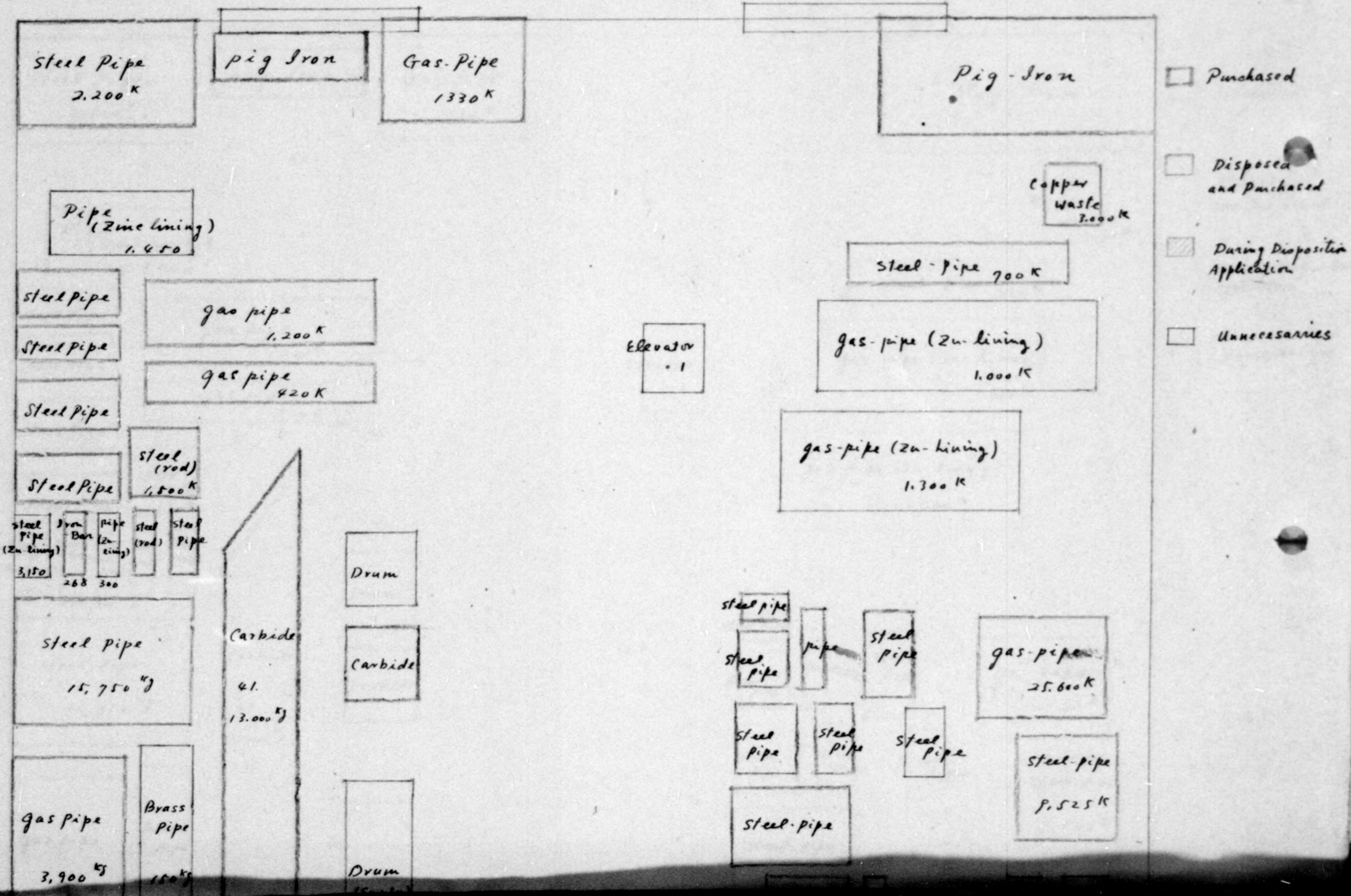

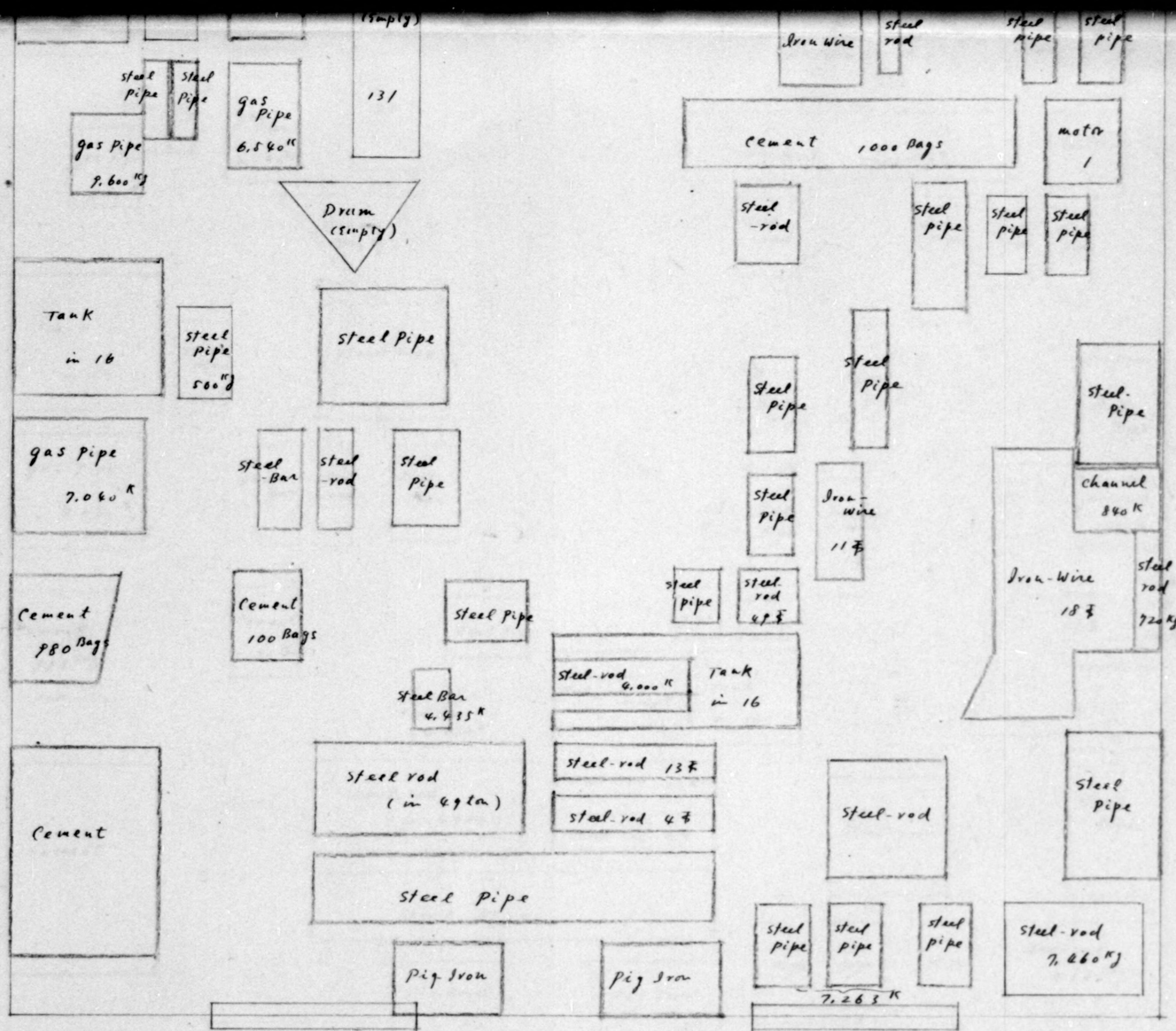

List of Disposed Materials (Determined)

Location: Warehouse Z-7

| | |
|----------------------------|-----------------------------------|
| Materials | Instructor (Heiki Shori Inkar) |
| Drum (empty) | Ordnance Disposition Section |
| Steel Plate (thin) | " |
| Bolts and Nuts | " (Sekiya Kyōhan) |
| Lubricating oil (Kō-3) | Petroleum Sales-guild Section |
| Isolite | Kan 660 |
| Brick | " |
| Lubricating oil (waste) | Petroleum Sales guild Section |
| Linseed Oil | " |
| Dynamo oil | Drum " |
| Steel Plate | Ordnance Disposition Section |
| " " (thin) | Kan 660 |
| Paints | Japan Paints Sales Co. Ltd. |
| Cresol | Petroleum Control Co. Ltd. |
| Cylinder oil | Petroleum Sales guild Section |
| Drum (empty) | Empty drum from disposed oil |
| Drum (5 gallons) empty | Ordnance Disposition Section |
| Isolite | Kan 660 |
| Lubricating oil (Aviation) | Petroleum Sales-guild Section |

Warehouse Z-7 (Japan Fertilizer Co Ltd)

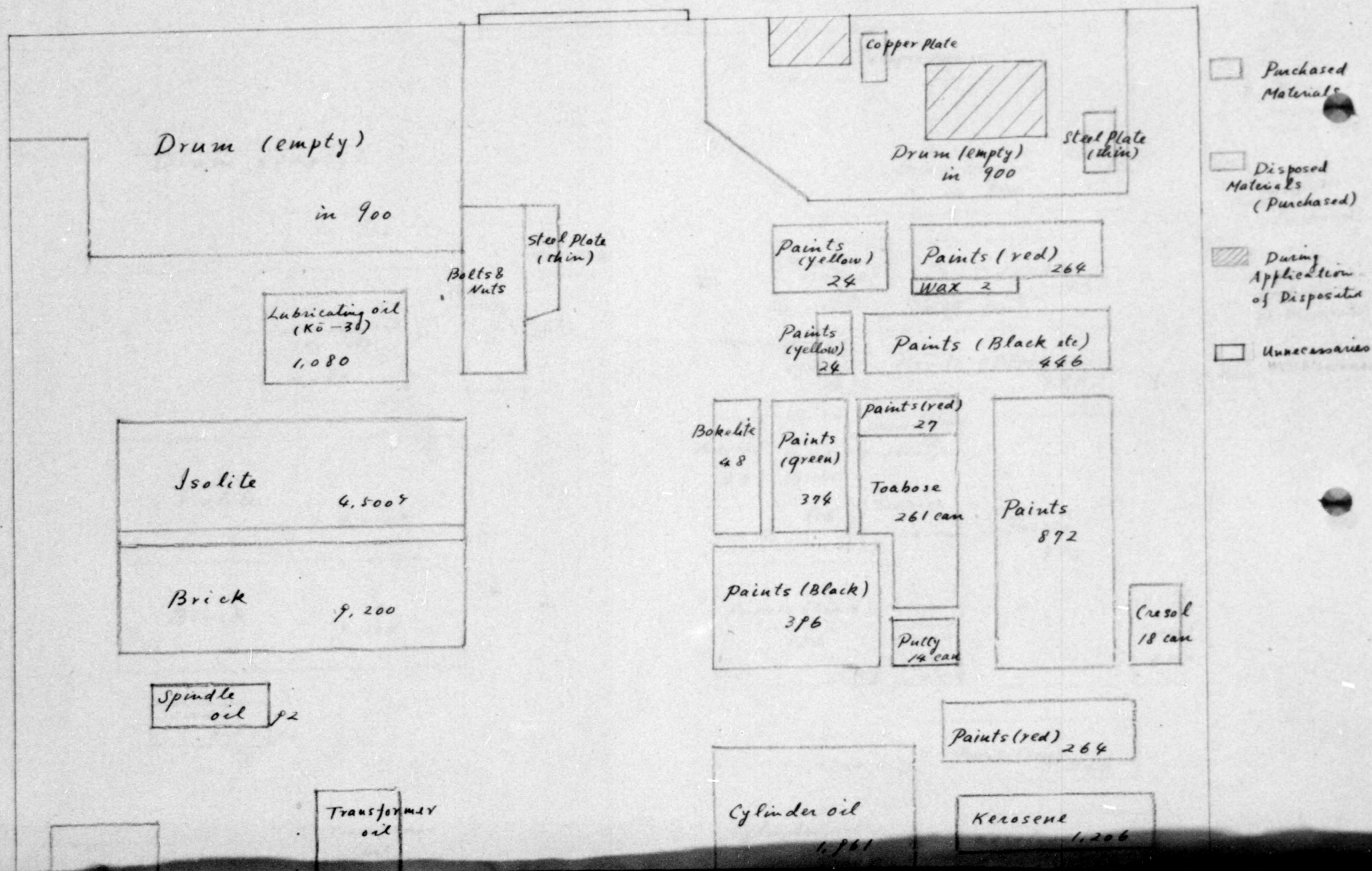

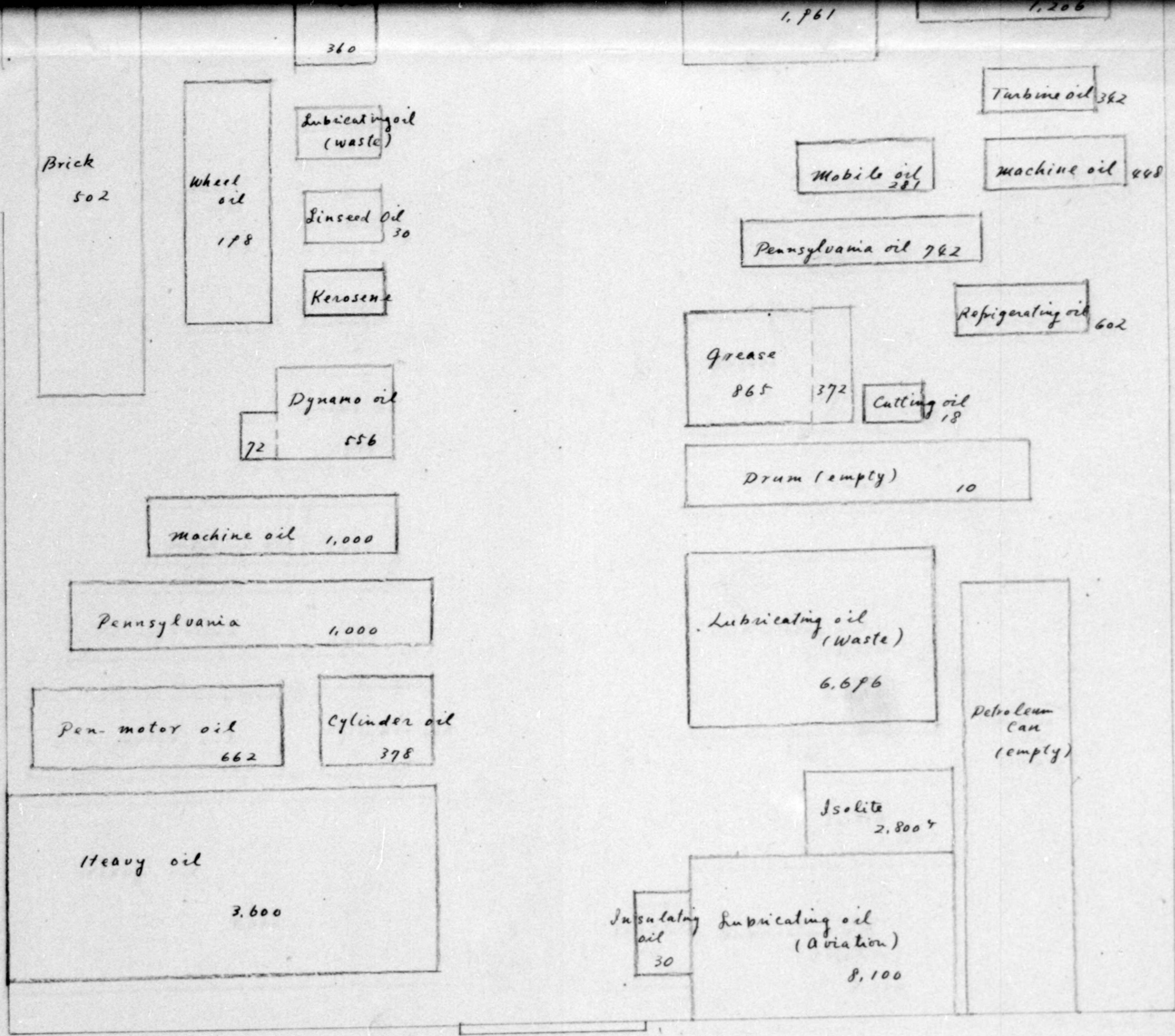

List of Disposed Materials (Potomined)Location S-6

| Materials | Instructor |
|-------------------------|--|
| Timber (plate) | Dwelling Section, Public Works, Miye Pref. |
| " (square) | " " |
| Drum (empty) | Ordnance Disposition Section |
| Steel (rod) | Kan 660- |
| " (band) | " " |
| " (plate) | " " |
| Iron Wire | Kan 660 and Ordnance Disposition Sec. |
| Valve | Ordnance Disposition Sec. |
| Methylene Chloride | Medicine Control Section |
| Brick | Kan 660 |
| Rivets | Ordnance Disposition Section |
| Bolts and Nuts | " |
| Isalite | Kan 660 |
| Brick (different shape) | " |
| Fire Brick | " |
| Steel Plate (checkered) | " |
| Bus-Bar | Ordnance, Disp. Sec. |
| Steel Pipe | |

Warehouse S-6 (Japan Fertilizer Co. Ltd)

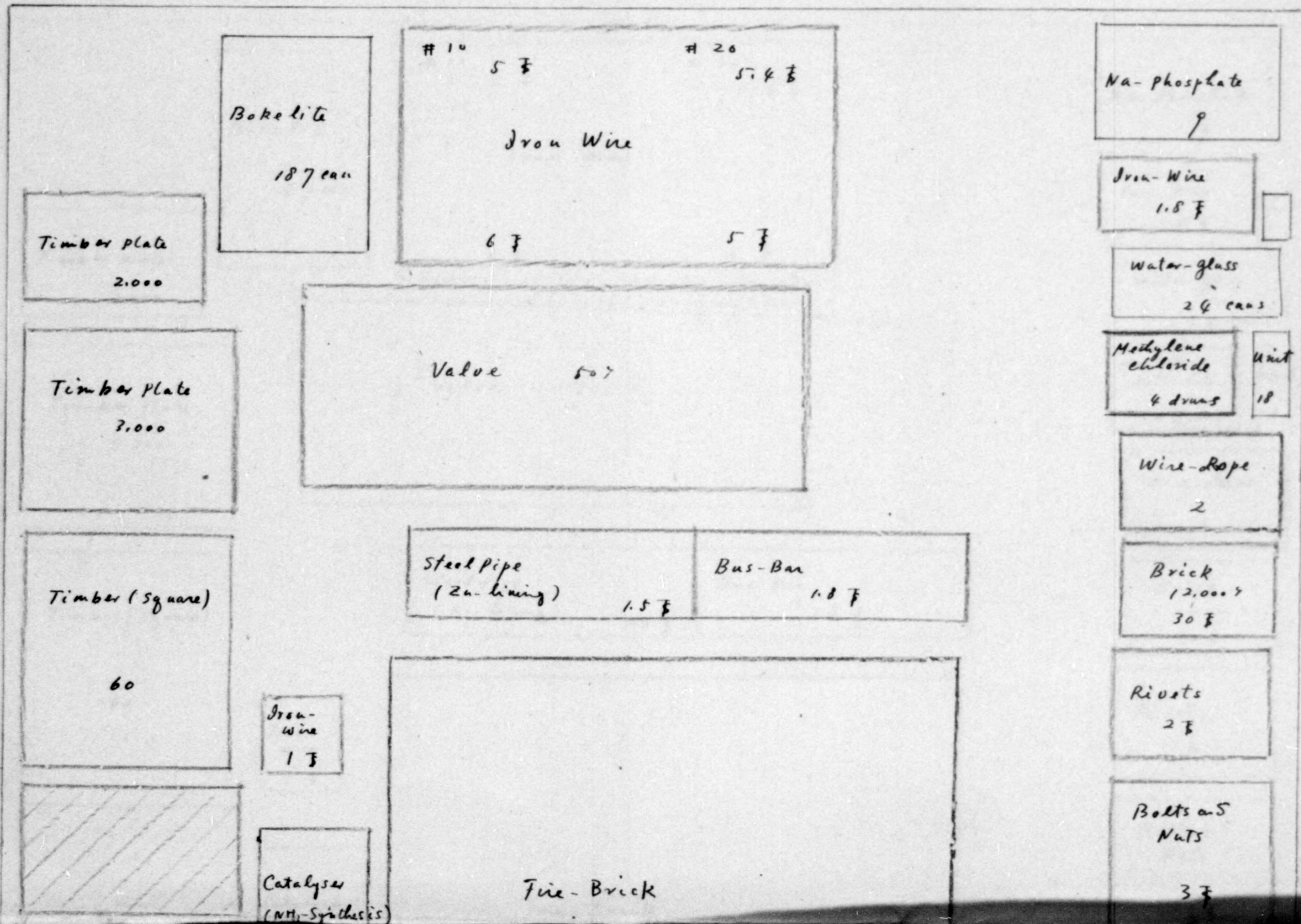

- Purchased
- Disposed & Purchased
- During Disposition Permission Application
- Unnecessaries

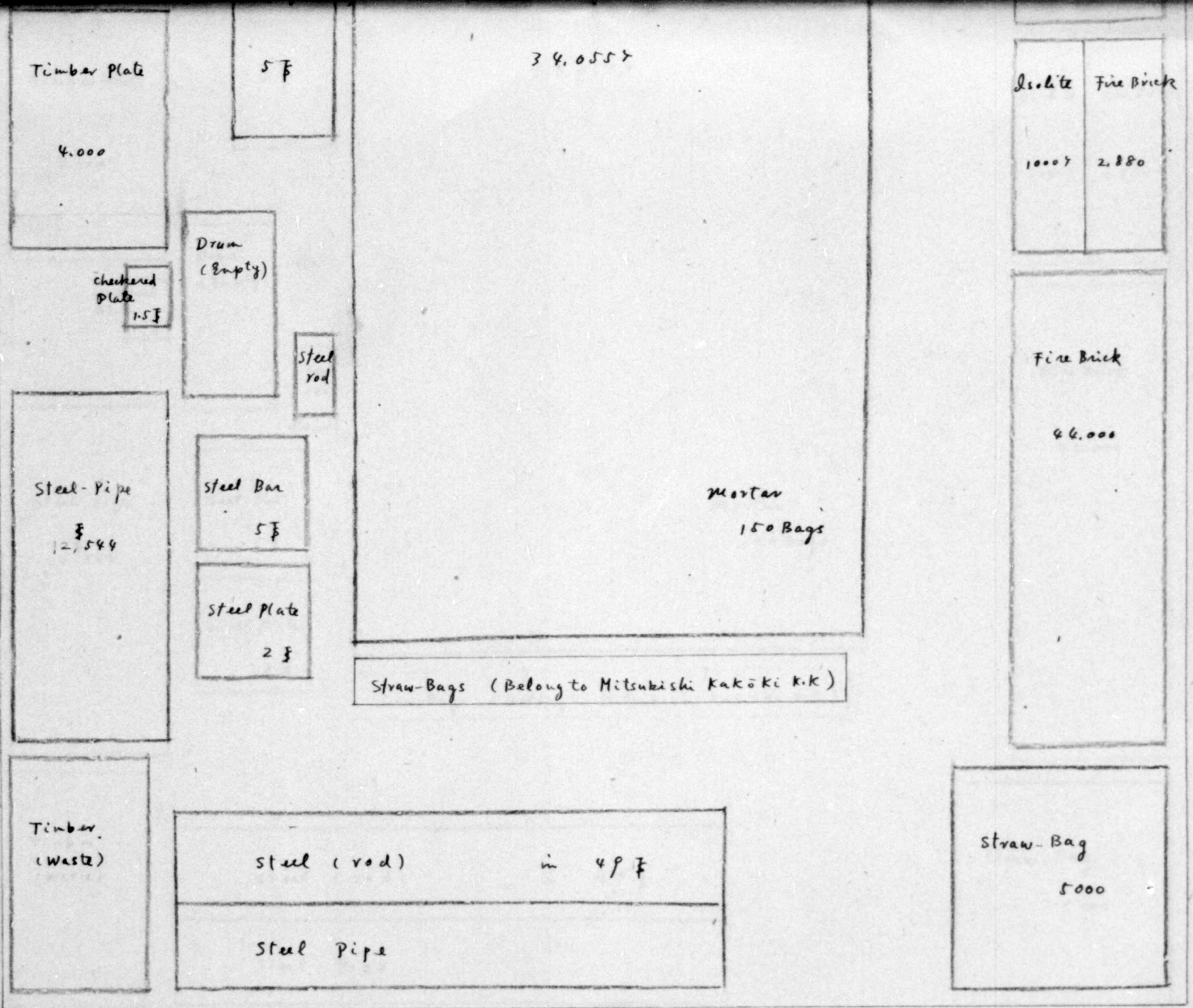

Timber plate
4.000

5 f

34,055

checked
plate
1.5 f

Drum
(Empty)

Steel
rod

Steel-Pipe
f
12,544

Steel Bar
5 f

Steel plate
2 f

mortar
150 Bags

Straw-Bags (Belong to Mitsubishi Kakōki K.K)

Timber
(waste)

Steel (rod) in 49 f
Steel Pipe

Isolite 1000
Fire Bricks 2,880

Fire Brick
46,000

Straw-Bag
5000

List of Disposed Materials (Determined)Location: 3-5

| Materials | Instructor |
|--------------------|--|
| Steel Plate (thin) | Ordnance Disposition Section |
| Welding rod | Kan 660 |
| Copper bar | " |
| Drum (empty) | Ordnance Disposition Sec. and Petroleum sales-guild section |
| Packings | Kan 660 |
| Caustic Soda | Kan 579, 175 |
| Valve | Kan 660 |
| Flange | Kan 660 |
| Felt | Kan 837 |
| Drum (empty) | Ordnance Disposition and Petroleum Sales guild section |
| Steel twisted wire | Kan 660 |
| Paints Drum | Paints Control Section |
| Lead waste | Ordnance Disposition Sec. |

Warehouse Z-5 (Japan Fertilizer Co. Ltd)

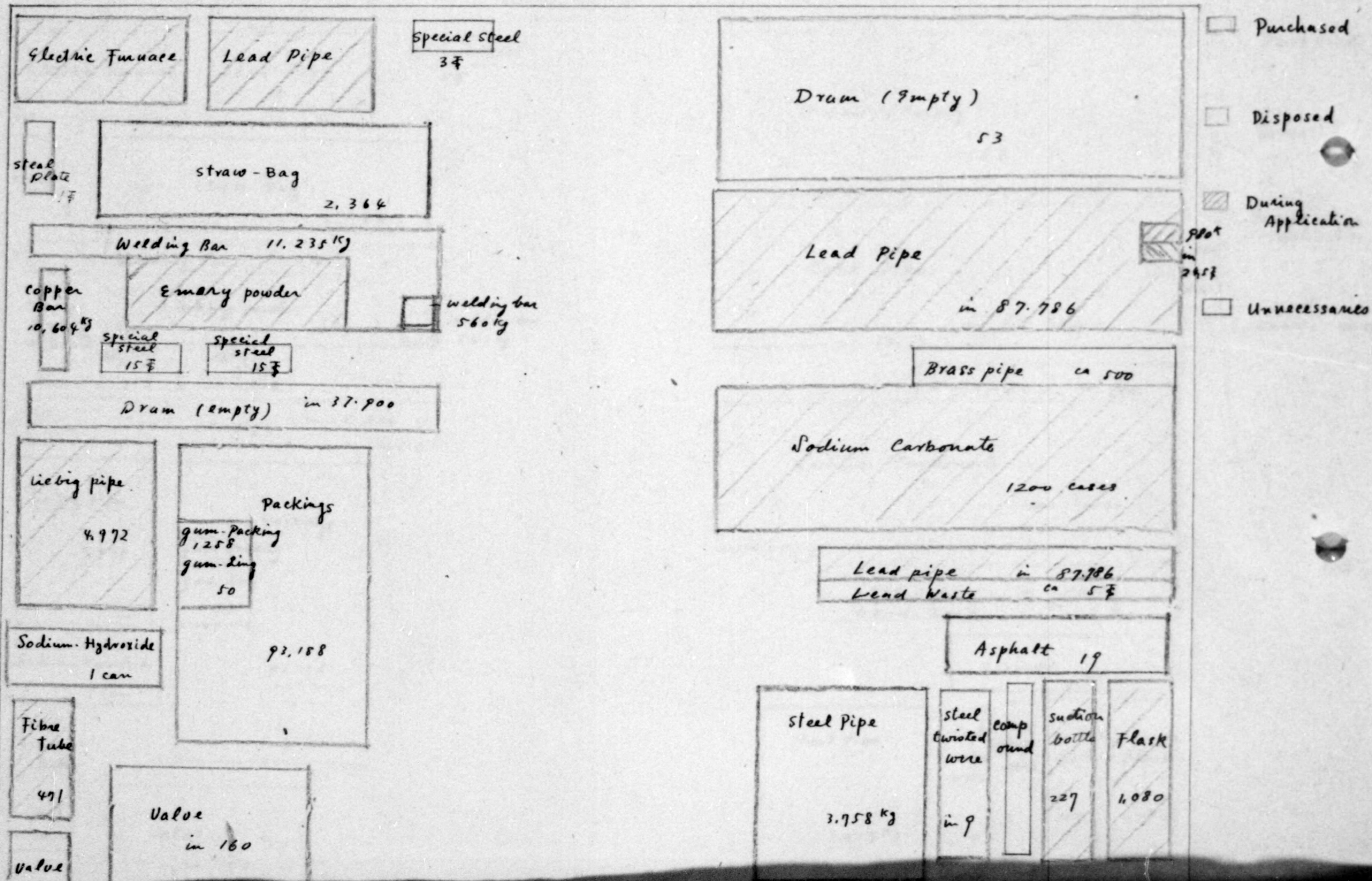

Flange 581

| | |
|------------------------|---------------|
| Bolts & Nuts 10.000 | Rivets 380 |
| Camera 1 set | |
| Valve in 160 | |
| Straw-rope 200 | |
| Felt 4,494 | |

Drum (empty)
45

Na-Silicate
30 can

Drum (empty)
33

Steel twisted wire
in 9

Hand Car
10

Asbest yarn 18 kg

Coil Packing 550 117

Sheet Packing 123

Porcelain Insulator 100

Asbest cloth 499k

Asbest Packing 2,769

Electric shade (porcelain) 263

Electric shade (metal) 941

Asbest plate 689

Liebig tube 318

globe 750

unit 308

Drum (empty) 37

Reparation machine (belong to obegumi) 199

Drum Paints 199

Reparation machine (belong to obegumi)

2nd Naval Fuel Depot

now returned to Arsenal

INSIDE PREFECTURE

| <u>PRESENT LOCATION</u> | <u>NAME OF BORROWER</u> | <u>NAME OF MACHINE</u> | | <u>CODE NO.</u> | <u>REMARKS</u> |
|-------------------------------|-------------------------|------------------------|----------------|-----------------|----------------|
| Torataka-cho Yokkaichi-shi | Taikyo Sekiyu | Motor | | 23 - 13 - 422 | |
| | | Motor | | 23 - 13 - 423 | |
| | | Pump | From | 23 - 13 - 1087 | |
| | | | To | 23 - 13 - 1201 | |
| | | Air Compressor | From | 23 - 13 - 1302 | |
| | | To | 23 - 13 - 1310 | | |
| Ishiwara-cho Yokkaichi-shi | Ishiwara Sangyo K.K. | Grinding Machine | | 23 - 13 - 1421 | |
| | | Welding Machine | | 23 - 13 - 1514 | |
| Chitose-cho Yokkaichi-shi | Azuma Kogyo K.K. | Press | From | 23 - 13 - 1534 | |
| | | | To | 23 - 13 - 1539 | |
| Naga Yokkaichi-shi | Suehiro Tekkoshu | Pump | From | 23 - 13 - 1085 | |
| | | | To | 23 - 13 - 1086 | |
| Kawarada-mura Mie-gun | Kawarada-mura | Pump | From | 23 - 13 - 1078 | |
| | | | To | 23 - 13 - 1081 | |
| Fajiwara-mura Inabe-gun | Onoda Semento K.K. | Welding Machine | | 23 - 13 - 1515 | |
| | | Motor | From | 23 - 13 - 407 | |
| | | | To | 23 - 13 - 411 | |
| Shimoheta Tsu-shi | Mie-ken Nogyokai | Motor | From | 23 - 13 - 424 | |
| | | | To | 23 - 13 - 477 | |
| Yamazato-mura Mie-gun | Yamazato Seizaisho | Motor | From | 23 - 13 - 1613 | |
| | | | To | 23 - 13 - 1614 | |
| | | Pump | From | 23 - 13 - 1615 | |
| | | | To | 23 - 13 - 1617 | |
| | | Welding Machine | From | 23 - 13 - 1618 | |
| | To | 23 - 13 - 1621 | | | |

| <u>PRESENT LOCATION</u> | <u>NAME OF BORROWER</u> | <u>NAME OF MACHINE</u> | <u>CODE NO.</u> | <u>REMARKS</u> |
|----------------------------|-------------------------|------------------------|---------------------|----------------|
| Tamagaki-cho Suzuka-shi | Osaka University | Pump | From 23 - 13 - 1353 | |
| | | | To 23 - 13 - 1354 | |
| | | Motor | 23 - 13 - 1519 | |
| | | Buff Grinder | 23 - 13 - 1422 | |
| Chitose-cho Yokkaichi | Dai Ichi Kogyo Seiyaku | Pump | From 23 - 13 - 1082 | |
| | | | To 23 - 13 - 1084 | |
| | | Pump | 23 - 13 - 1301 | |
| Oinokawa Yokkaichi-shi | Chubu NaidenK.K. | Motor | From 23 - 13 - 412 | |
| | | | To 23 - 13 - 421 | |
| | | Portable Drill | 23 - 13 - 1408 | Stollen |

DECLASSIFIED E.O. 12065 SECTION 3-402/NNDG NO. 775013

OUTSIDE PREFECTURE

| <u>PRESENT LOCATION</u> | <u>NAME OF BORROWER</u> | <u>NAME OF MACHINE</u> | <u>CODE NO.</u> | <u>REMARKS</u> |
|--|---------------------------|------------------------|---------------------------|----------------|
| Mitsuyaminamitori Nigashi Yodogawaku Osaka-shi | Kito Tekkosho | Pump | 23 - 13 - 1203 | |
| | | Welding Machine | 23 - 13 - 1517 | 1516 |
| | | | To 23 - 13 - 1518 | |
| Kani-mura Nakagawachi-gun Osaka-shi | Showa-gumi Kakoki K.K. | Air Compressor | 23 - 13 - 1311 | |
| | | Lathe | From 23 - 13 - 1375 | |
| | | | To 23 - 13 - 1385 | |
| | | Gear Cutting machine | 23 - 13 - 1388 | |
| | | Gear Cutting Machine | 23 - 13 - 1389 | |
| | | Milling Machine | 23 - 13 - 1390 | |
| | | Drilling Machine | From 23 - 13 - 1409 | |
| | | | To 23 - 13 - 1412 | |
| | | Grinding Machine | 23 - 13 - 1423 | |
| | | Threading Machine | From 23 - 13 - 1427 | |
| | | | To 23 - 13 - 1429 | |
| | | Shaper | 23 - 13 - 1431 | |
| | | Slotter | 23 - 13 - 1432 | |
| | | Planer | 23 - 13 - 1433 | |
| | | Back Sawing Machine | 23 - 13 - 1437 | |
| | | Press | 23 - 13 - 1440 | |
| Air Hammer | 23 - 13 - 1441 | | | |
| Bending Roll | 23 - 13 - 1446 | | | |
| Testing Machine | 23 - 13 - 1470 | | | |
| Crane | 23 - 13 - 1493 | | | |