

N Report 23

NX-23 90.17-1694

Japan Wireless Co. Factory #1

This plant identified as a producer of electronics equipment by A.I.C., was found to be the, "Sonoike tool mfg. Co. ltd."

Functions of this plant included production of small tools, gas meters, and as metalurgical research.

There were 6 branch factories three built in 1943 and three in 1945. The new branches were not in full production by the end of the war.

In march of this year dispersal of machines from the main factory was begun.

6 wooden buildings were destroyed within the plant area by the fire raid of 25 May 1945.

These buildings were, the gas meter mfg. bldg., the research laboratory, the forge, two office buildings, and one commercial school.

One fire bomb penetrated the concrete roof of the main building but did no other damage.

JAPAN WIRELESS CO., FACTORY # 1

TOKYO, HONSHU

SMALL TOOLS

SUBJECTS INVESTIGATED

A. Functional Analysis

1. Published material sketchy
2. None available
3. No conclusion

B. Structural Analysis

None

C. Damage Photos

1. Complete ground photos of all damage.

JAPAN WIRELESS CO., FACTORY #2

90.17-1696

MITAKA MACHI, HONSHU

INSANE ASYLUM

SUBJECTS INVESTIGATED

A. Functional Analysis

1. Published material, None
2. No data was required
3. Plant was incorrectly identified

N-X-10

N-REPORT-10

18 October 1945

AÖF 90.17 - Target #1696

N Report X10

Target identified by A.I.C. as the Japan Wireless Co. factory #2.

This target was divided into two sections, the larger 500 yards North of the smaller.

It was found that the larger portion to the north was a Private Sanitarium for the insane, the smaller portion was the village school.

The area designated as the vital area and inclosing the aiming point was the doctors office at the sanitarium.

No further comment necessary

NX-34

N Report 34

90.17-1395 (north)

Japan Wireless Co.

This plant originally designated as a part of target 1395 the Shoda A/C Factory was found to be producing electronics equipment of all types.

Dispersal of workers and machinery begun the first of the year was almost complete.

Dispersal of materials was made to the following branch plants.

Nagano Plant, Ueda Plant, Suwa Plant, Nishijo Plant, Toyano Plant (Nagano Prefecture). Tendo Plant - Yauragata Prefecture
Hamamatsu Plant - Shidzuoka Prefecture.
Katsumiura & Kajikazawa Plants - Yamanashi Prefecture.

All types of radar including submarine and aircraft radar were produced.

The plant was a large producer of vacuum tubes. Producing 20,000 small tubes per month and 2,100 large tubes per month. By the close of the war production of large tubes had dropped to 1,500 per month.

No damage to any installation was done by allied planes.

NX-34

N Report 34

90.17-1395 (north)

Japan Wireless Co.

This plant originally designated as a part of target 1395 the Shoda A/C Factory was found to be producing electronics equipment of all types.

Dispersal of workers and machinery begun the first of the year was almost complete.

Dispersal of materials was made to the following branch plants.

Nagano Plant, Ueda Plant, Suwa Plant, Nishijo Plant, Toyano Plant (Nagano Prefecture). Tendo Plant - Yauragata Prefecture

Hamamatsu Plant - Shidzuoka Prefecture.

Katsumiura & Kajikazawa Plants - Yamanashi Prefecture.

All types of radar including submarine and aircraft radar were produced.

The plant was a large producer of vacuum tubes. Producing 20,000 small tubes per month and 2,100 large tubes per month. By the close of the war production of large tubes had dropped to 1,500 per month.

No damage to any installation was done by allied planes.

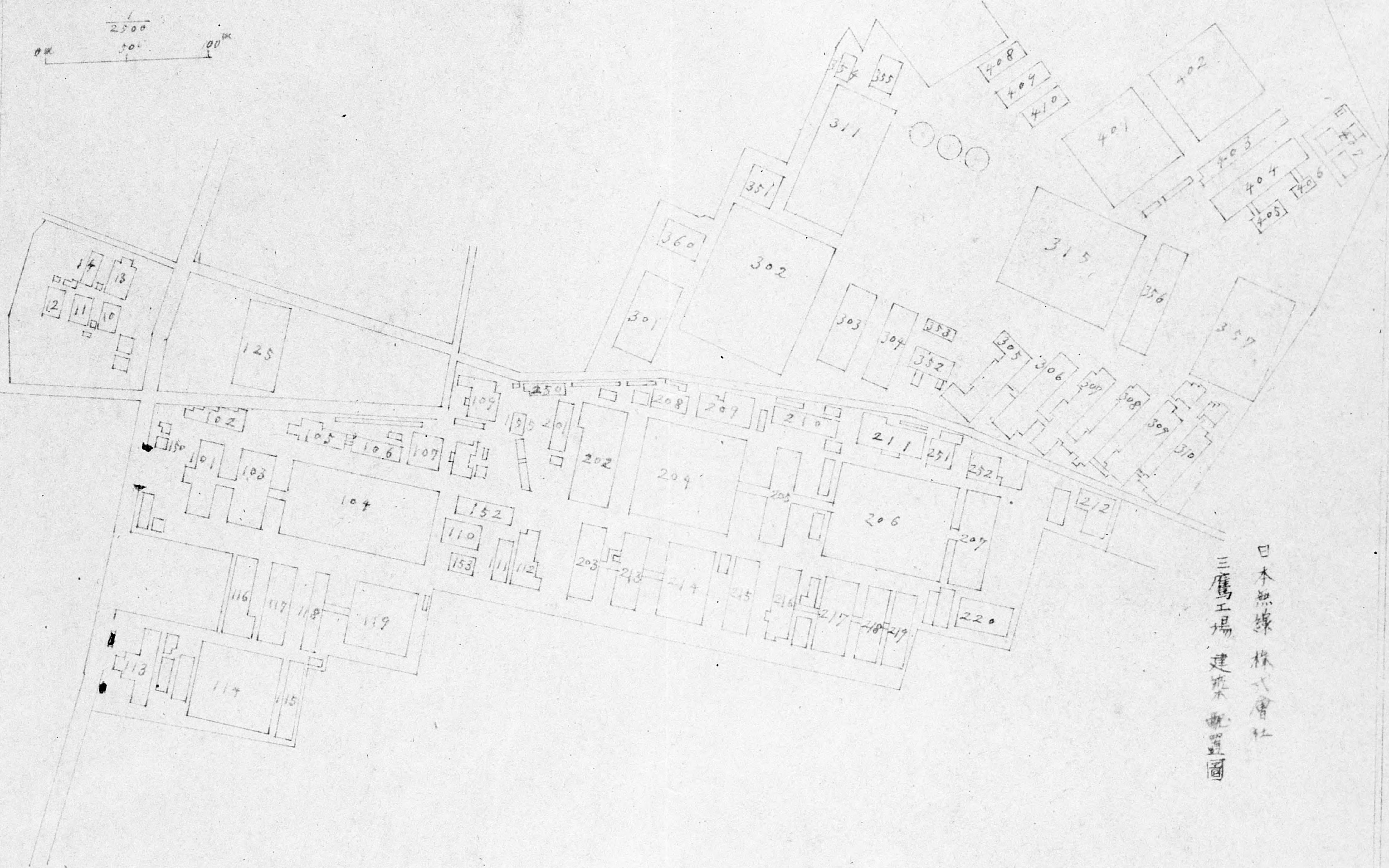
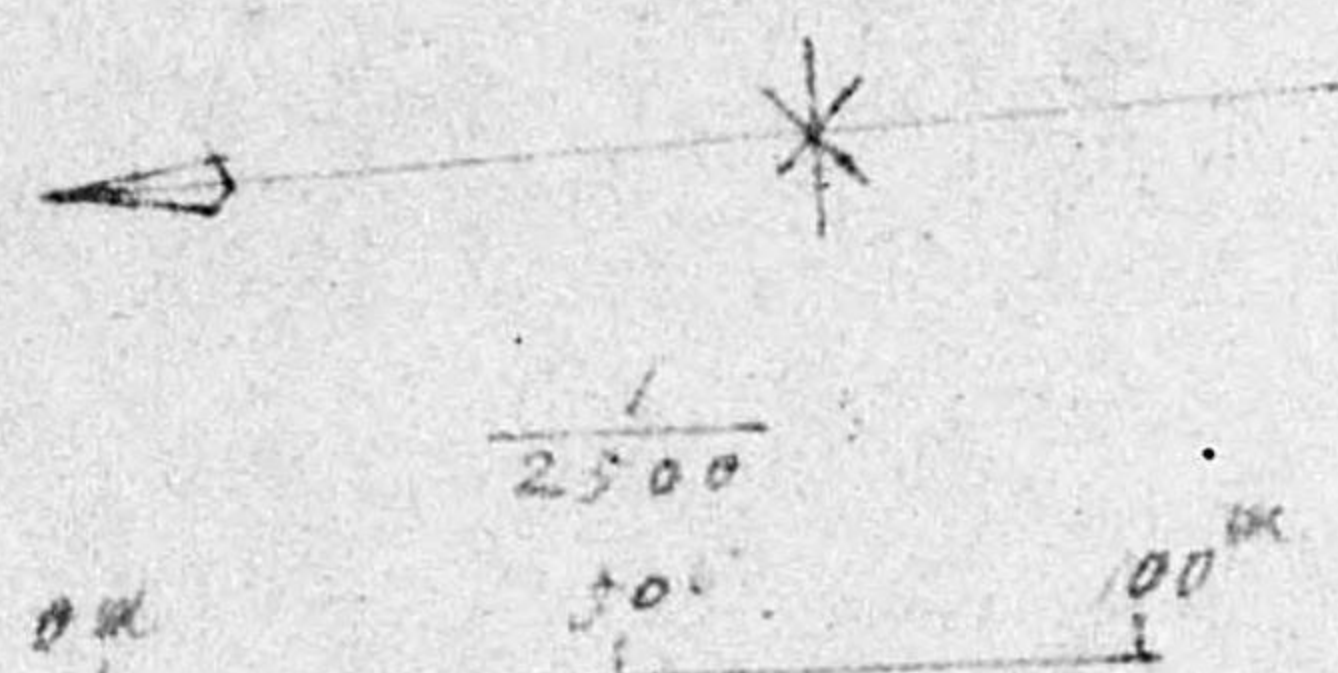

日本無線株式会社
三鷹工場建築配置圖

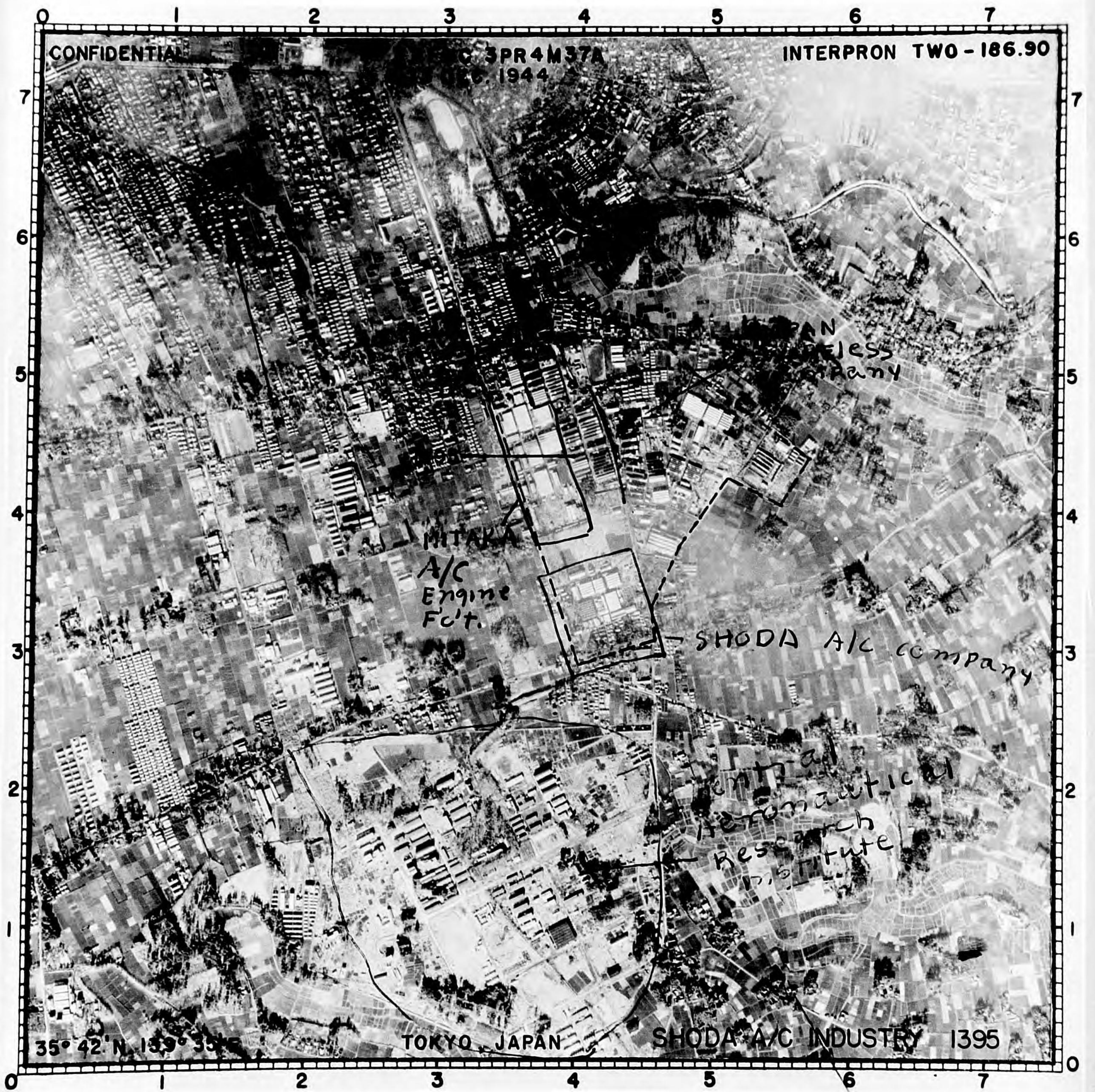

130